

EXPLODED VIEWS
1. MAIN UNIT (SN4R) SECTION

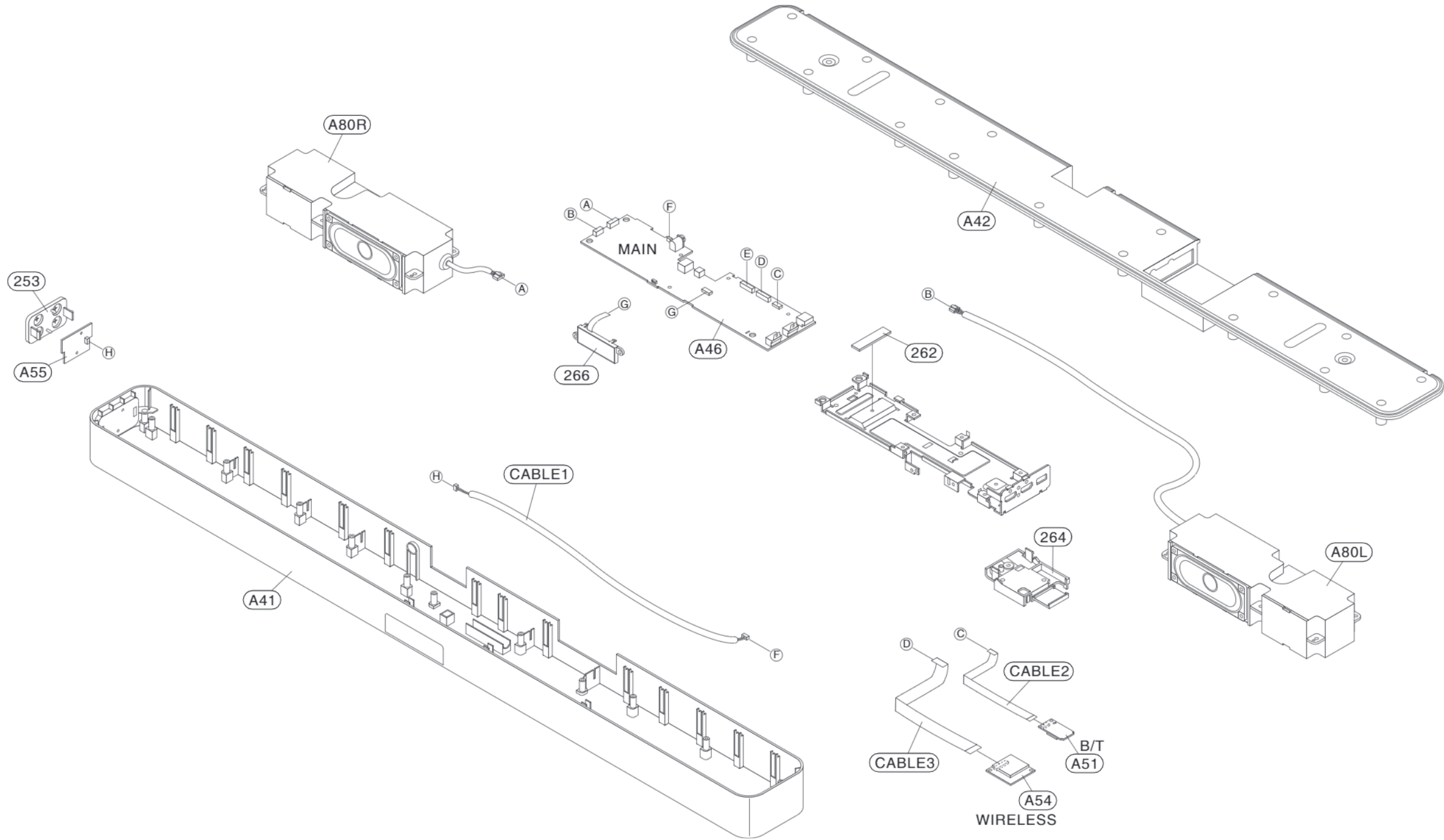

2. WIRELESS SUBWOOFER (SPN4BM-W) SECTION

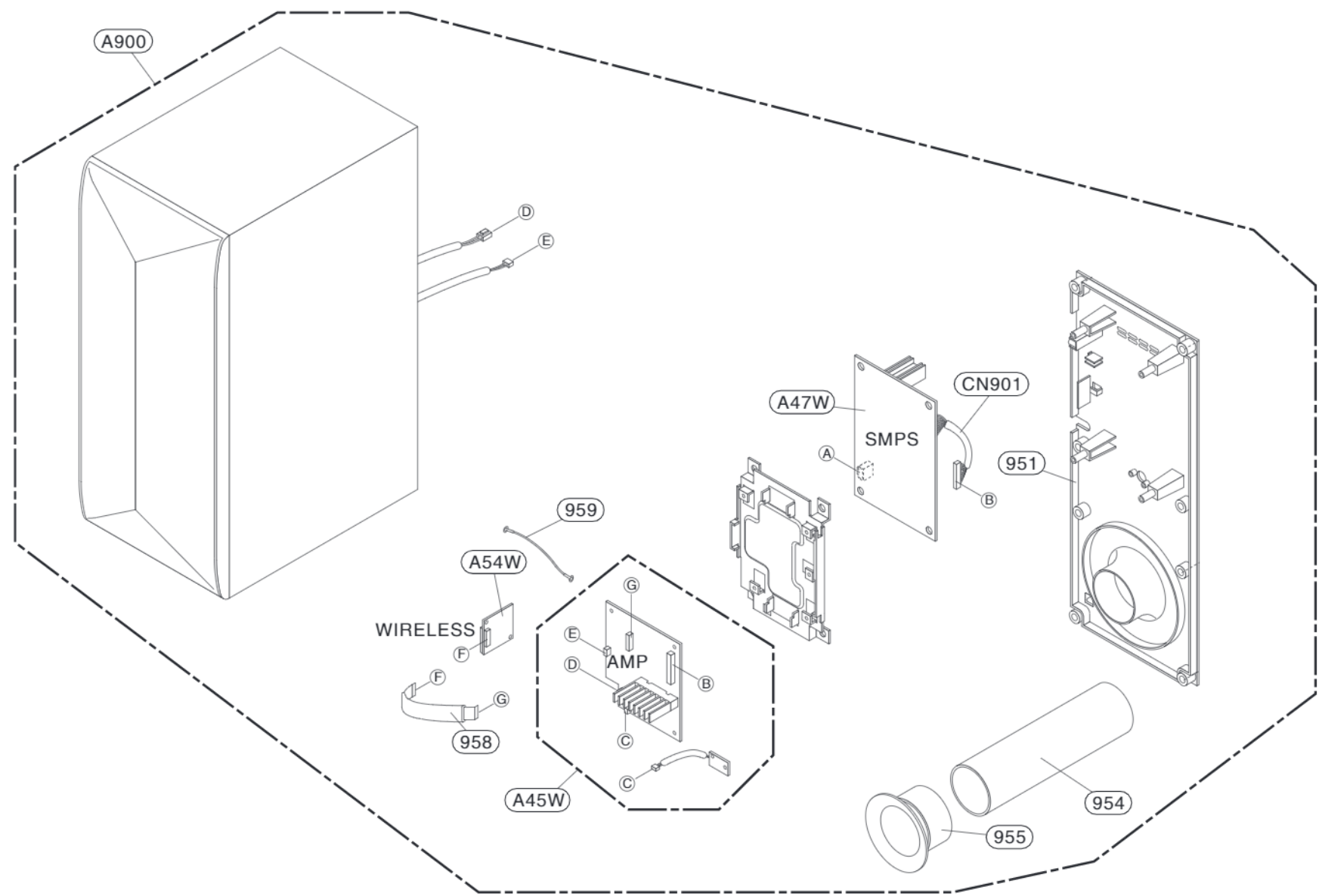

3. WIRELESS RECEIVER (SPK8-S) SECTION

NOTES) THE EXCLAMATION POINT WITHIN AN EQUILATERAL TRIANGLE IS INTENDED TO ALERT THE SERVICE PERSONNEL TO THE PRESENCE OF IMPORTANT SAFETY INFORMATION IN SERVICE LITERATURE.

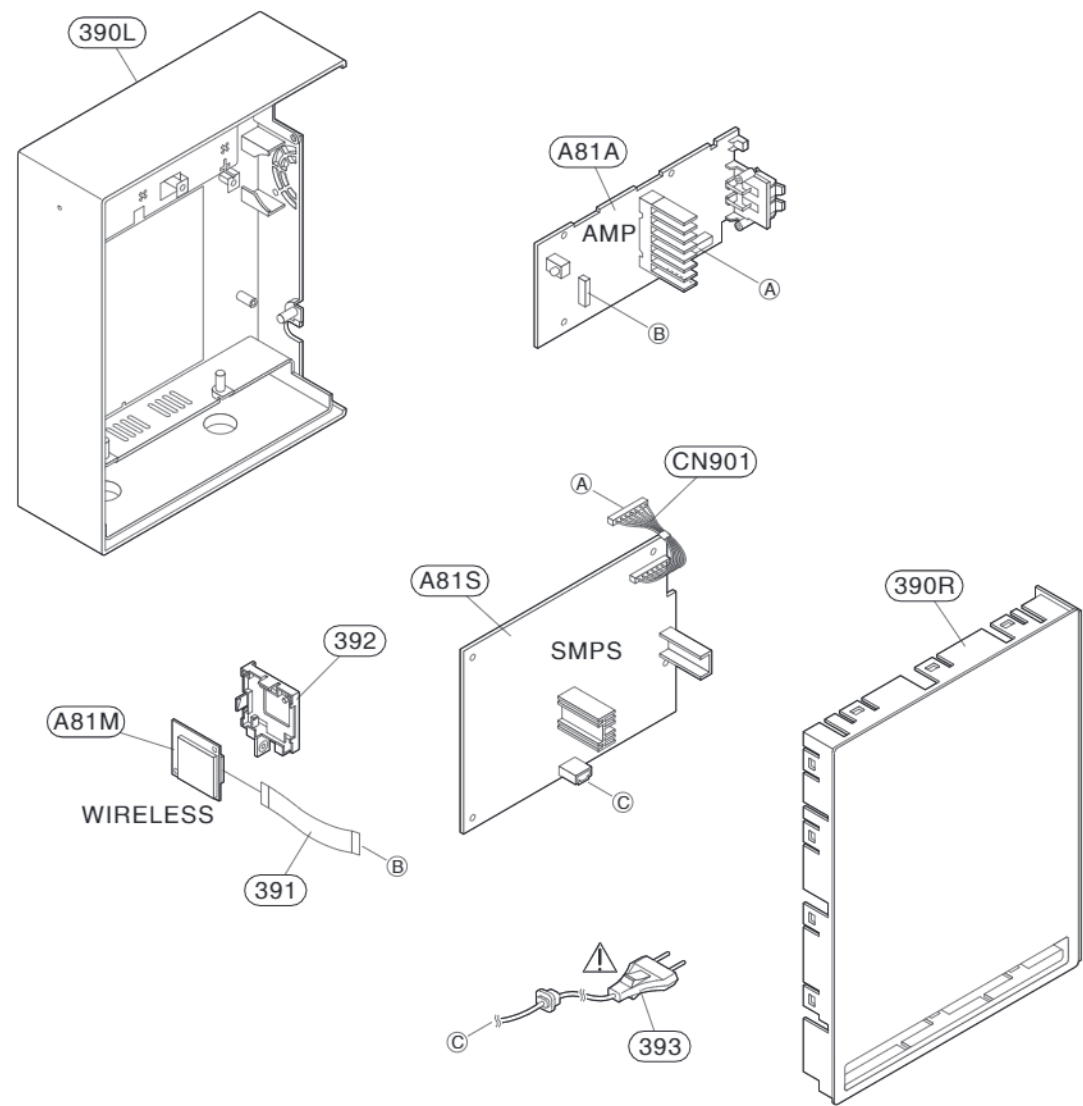

4. REAR SPEAKER (S65S3-S) SECTION

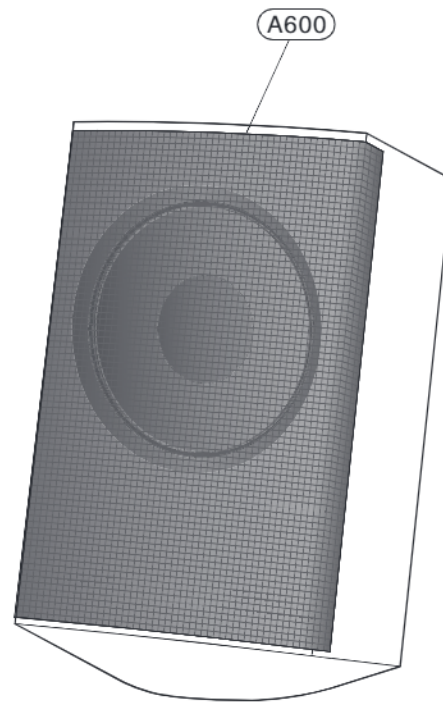

5. PACKING ACCESSORY SECTION

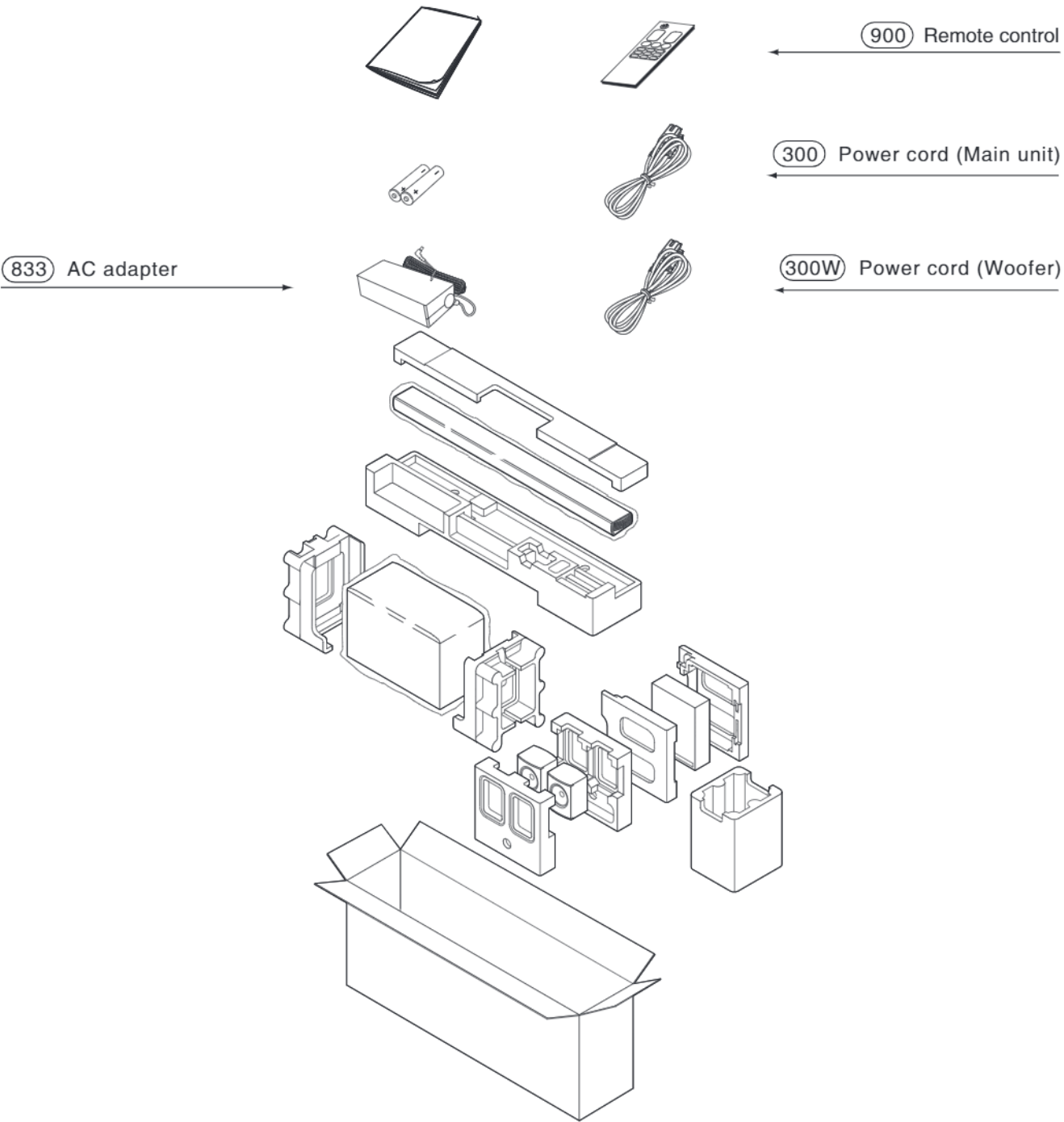

*** Accessory**

826 Filter (Ferrite Core)



WIRE60 SPK cable (Rear Left)

WIRE61 SPK cable (Rear Right)

