

1. Exploded View & Part List

Exploded View

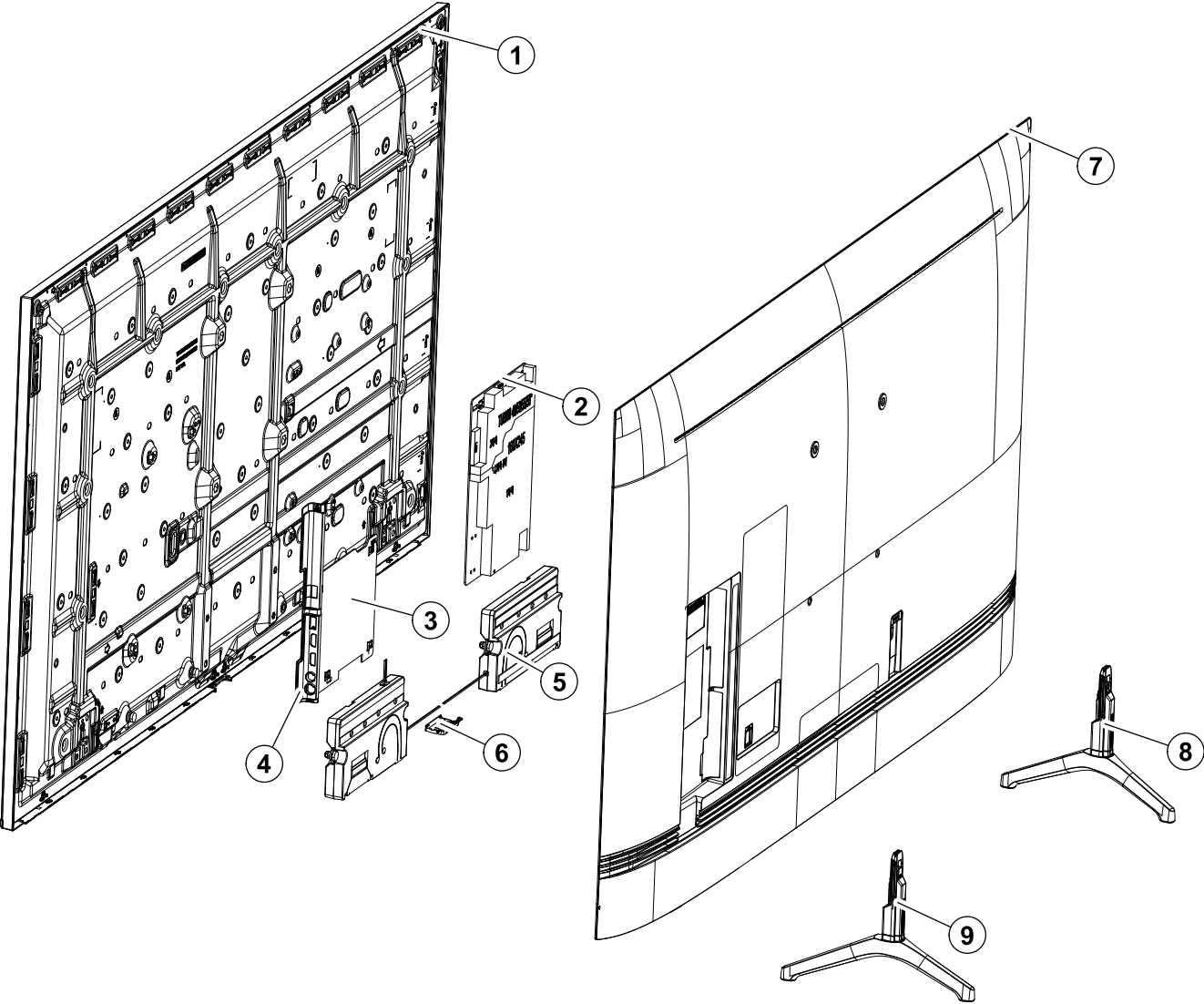

Parts List

No.	Lvl.	Loc.	Material Code	Description & Specification	SNA	Qty.
1	2	PANEL	BN95-06384A	PRODUCT LCD-CHOT; CY-GT070HGJV1H/V,TU7000	SA	1
2	2		BN44-01056A	DC VSS-PD BOARD; L75S6N_THS,AC/DC,235W,AC	SA	1
3	2	M0014	BN94-15312F	ASSY PCB MAIN; UTU7000K	SA	1
4	3	TERMINAL	LBN63-18718D	COVER-TERMINAL SIDE; 65QTQ60F,PC+ABS,V-0,	SA	1
5	2		BN96-49998C	ASSY SPEAKER P-FRONT; TV-SPK,65UTU7000,6o	SA	1
6	2	WLAN	BN59-01341B	NETWORK-WLAN CLIENT; WCT734M,44.17x31.99x	SA	1
7	2	R001A	BN96-50853F	ASSY COVER P-REAR; 70UTU7000K,PC+ABS+ED20	SA	1
8	2		BN96-50865B	ASSY STAND P-COVER TOP RIGHT; 75UTU8000H,	SA	1
9	2		BN96-50864B	ASSY STAND P-COVER TOP LEFT; 75UTU8000H,P	SA	1

2. Electrical Parts List

Level	Loc.	Part Code	Description & Specification	Qty.	SA/SNA
			UE70TU7100UXTK (GA01)		
1		BN90-11425C	ASSY W/I;UTU7000K	1	SNA
.2		BN81-08159Z	A/S PART SET-ELEC W/I;LED TV ELEC spec-C	1	SNA
.2		BN81-17118N	A/S PART SET-MECH W/I;UTU7000K,U70TK*	1	SNA
1	S001A	BN90-11426N	ASSY STAND;UTU7000K	1	SNA
.2		BN96-50864B	ASSY STAND P-COVER TOP LEFT;75UTU8000H,P	1	SA
..3		0203-007085	TAPE-SINGLE FACE;PET,T0.05,W20,L100M,CLE	0	SNA
..3		BN63-18572B	COVER-STAND TOP LEFT;75UTU8000H,PP+GF40%	1	SNA
..3		BN96-49093C	ASSY STAND P-HOLDER CABLE;65QRQ60T,ABS,B	1	SNA
...4		6902-003068	BAG PE;LDPE,T0.05,W70,L80,TRP,RECYCLE,Ho	1	SNA
...4		BN61-16080A	HOLDER-STAND CABLE;65QRQ60T,ABS,BK0007,H	2	SNA
....5		0103-004609	RESIN ABS;HF-0680U,K21294,BK0007,HB,High	8	SNA
.2		BN96-50865B	ASSY STAND P-COVER TOP RIGHT;75UTU8000H,	1	SA
..3		6902-003301	BAG ACCESSORY;LDPE,T0.06,W400,L320,TRP,R	2	SNA
..3	RF01	BN61-13520D	FOOT-RUBBER;40K5500,RUBBER,GRAY,W5,L10,T	4	SNA
..3		BN63-18574B	COVER-STAND TOP RIGHT;75UTU8000H,PP+GF40	1	SNA
...4		0103-011648	RESIN PP;9500G40/9378C,Titan Gray,GY0357	438	SNA
1	R001A	BN90-11474L	ASSY COVER REAR;UTU7000K	1	SNA
.2	R001A	BN96-50853F	ASSY COVER P-REAR;70UTU7000K,PC+ABS+ED20	1	SA
..3	R001	BN63-18643B	COVER-REAR;70UTU7000K,PC+ABS+ED20%,T2.7,	1	SNA
...4		0103-010818	RESIN PC ABS;CM20G/BK00749,BLACK,BK0007,	5481	SNA
..3		BN63-19004A	INSULATOR-SOURCE PCB;65UTU7000K,PC,BLACK	2	SNA
..3		BN64-04336C	INLAY-TERMINAL SIDE;65UTU7000K,PET,T0.12	1	SNA
..3		BN68-03518W	LABEL-STICKER CI SLOT;43UNU7090P,PET,T0.	1	SNA
1	M0017	BN91-21823P	ASSY CHASSIS;UTU7000K	1	SNA
.2	M0014	BN94-15312F	ASSY PCB MAIN;UTU7000K	1	SA
..3		0202-001608	SOLDER-WIRE FLUX;LFC7-107,D0.8,99.3Sn/0.	0	SNA
..3		BN62-00898A	HEAT SINK-PS;UN65TU7000,A1050,W100,L120,	1	SNA
..3	TERMINA	BN63-18718D	COVER-TERMINAL SIDE;65QTQ60F,PC+ABS,V-0,	1	SA
...4		0103-005041	RESIN PC ABS;FR3200TV/901408,Black,BK000	17	SNA
..3		BN97-16648H	ASSY SMD;UTU7000K	1	SNA
...4		0202-001976	SOLDER-CREAM;LST-309M-K21,D20~38um,96.5S	4	SNA
..4	DS01A	0401-001056	DIODE-SWITCHING;MMBD4148SE,100V,200mA,SO	1	SA
..4		0403-001779	DIODE-ZENER;MMSZ5234BT1G,5.89~6.51V,500m	1	SA
...4		0403-001783	DIODE-ZENER;BZB84-C6V2,5.8~6.6V,300mW,SO	2	SNA
...4		0403-001785	DIODE-ZENER;NZH5V1B,4.94~5.2V,500mW,SOD-	3	SA
...4		0403-002014	DIODE-ZENER;KDZ16B,16.2~18.3V,1000mW,SOD	2	SNA
...4		0404-001404	DIODE-SCHOTTKY;BAT721C,40V,200mA,SOT-23,	2	SA

Exploded Views and Parts List

Level	Loc.	Part Code	Description & Specification	Qty.	SA/SNA
...4		0404-001640	DIODE-SCHOTTKY;SS1060HEWS,60V,1000mA,SOD	3	SA
...4		0404-001881	DIODE-SCHOTTKY;SS3040-HE,40V,3000mA,SOD-	3	SA
...4		0404-001953	DIODE-SCHOTTKY;MBRA340F-HAF,40V,3000mA,S	3	SA
...4		0404-001976	DIODE-SCHOTTKY;SV540,40V,5000mA,TO-277,T	1	SA
...4		0406-001200	DIODE-TVS;RClamp0504F,6V,1MAV,TP	4	SA
...4		0406-001290	DIODE-TVS;3.0SMCJ20A,22.2V,24.5V,5MAV,30	1	SNA
...4		0406-001635	DIODE-TVS;SMF5.0A,6.4V,6.7V,7V,200MAV,20	1	SA
...4		0406-001718	DIODE-TVS;SMF36A,40V,44.2V,3.8MAV,1.25VP	1	SA
...4		0406-001778	DIODE-TVS;PUSB3FR4,6V,9V,0.2MAV,0.7VPA,0	1	SA
...4		0406-001786	DIODE-TVS;PJEC5V0V6TM,5V,7V,8V,0.1MAV,9V	1	SA
...4		0406-001820	DIODE-TVS;AZ1023-04F,4.5V,6V,7.5V,0.5MAV	4	SA
...4		0501-000445	TR-SMALL SIGNAL;KTC3875S-Y,NPN,150mW,SOT	5	SC
...4		0502-001346	TR-POWER;FCX591A,PNP,1000mW,SOT89,TR,30/	3	SA
...4		0505-001089	FET-SILICON;AO3409L,P,-30V,-2.6A,0.097/0	2	SA
...4		0505-002560	FET-SILICON;AO6415,P,20V,-3.3A,0.15ohm,1	1	SA
...4		0505-002598	FET-SILICON;AP2317GN,P,20V,-4.2A,0.052oh	1	SA
...4		0505-002660	FET-SILICON;Si2308BDS,N,60V,2.3A,0.156oh	3	SA
...4		0505-002893	FET-SILICON;AO4801AS,P,30V,-5A,2W,SOIC-8	1	SA
...4		0505-003205	FET-SILICON;DMG4435SSS-13,P,30V,-7.3A,1.	1	SA
...4		0505-003391	FET-SILICON;AOD2922,N,100V,8A,140Mohm,18	1	SA
...4		0505-003397	FET-SILICON;2N7002K,N,60V,0.38A,1.19ohm,	4	SA
...4		0505-003507	FET-SILICON;AO3424,N,30V,3.8A,1.4W,SOT-2	1	SA
...4		0505-003752	FET-SILICON;AONR21321,P,30V,50A,0.035ohm	1	SNA
...4		0801-003603	IC-CMOS LOGIC;MC74LCX244MN2TWG,Octal buf	1	SA
...4		1001-001545	IC-ANALOG MULTIPLEX;TS3USB221ERSER,R-PQF	1	SA
...4		1103-001564	IC-EEPROM;S-24C512CI-J800,512Kbit,x8,SOP	1	SA
...4		1105-002853	IC-DDR3 SDRAM;K4B4G1646E-BCNB,DDR3 2133,	2	SA
...4		1105-002996	IC-DDR3 SDRAM;K4B2G1646F-BCNB,DDR3,2Gbit	2	SA
...4		1201-004117	IC-AUDIO AMP;TAS5749M,QFP,48P,7x7x1mm,DU	1	SA
...4		1201-004258	IC-OP AMP;TLV9062,SOT23-8,TP,8P,DUAL,PLA	1	SA
...4		1203-008777	IC-DC/DC CONVERTER;TPS563201,SOT-23,6,1.	2	SA
...4		1203-008918	IC-DC/DC CONVERTER;TPS65235,WQFN,20P,3x3	1	SA
...4		1203-009067	IC-DC/DC CONVERTER;TPS564201,SOT-23,6P,3	1	SA
...4		1203-009186	IC-POSI.ADJUST REG.;TLV759P01PDRVR,TP,6P	3	SA
...4		1203-009188	IC-VOL. DETECTOR;G623F11U,TP,8P,4.9x6x1.	1	SA
...4		1203-009371	IC-DC/DC CONVERTER;VPMS2GMB,QFN,72P,8x8x	1	SA
...4		1203-009377	IC-DC/DC CONVERTER;TPS56C230,VQFN,20P,3x	1	SA
...4		1204-003797	IC-DECODER;SDP19405,HSBGA,754P,27x27x2.1	1	SA
...4		1205-004692	IC-SWITCH;TPS2069CDBVR,SOT-23,5P,2.9x2.8	2	SA
...4		1404-001731	THERMISTOR-NTC;33Kohm,4050K,1MWC,TP,1.6x	1	SNA

Level	Loc.	Part Code	Description & Specification	Qty.	SA/SNA
...4		1405-001271	VARISTOR;35V,20VDC,5A,1005,TP,100V,10pF	12	SA
...4		1405-001381	VARISTOR;11V,8VDC,30A,1608,TP,25V,500pF	4	SA
...4		1405-001382	VARISTOR;24.5V,16VDC,120A,2012,TP,42V,40	2	SA
...4		1405-001452	VARISTOR;15V,12VDC,8A,1608,TP,46V,18pF	4	SA
...4		2007-000052	R-CHIP;10Kohm,1%,1/10W,TP,1608	1	SA
...4		2007-000066	R-CHIP;20Kohm,1%,1/10W,TP,1608	1	SNA
...4		2007-000070	R-CHIP;0ohm,5%,1/10W,TP,1608,T0.45	9	SA
...4		2007-000078	R-CHIP;1Kohm,5%,1/10W,TP,1608	1	SA
...4		2007-000090	R-CHIP;10Kohm,5%,1/10W,TP,1608,T0.45	2	SA
...4		2007-000137	R-CHIP;2Kohm,5%,1/16W,TP,1005	8	SNA
...4		2007-000138	R-CHIP;100ohm,5%,1/16W,TP,1005,T0.35	20	SA
...4		2007-000140	R-CHIP;1Kohm,5%,1/16W,TP,1005,T0.35	5	SNA
...4		2007-000141	R-CHIP;2.2Kohm,5%,1/16W,TP,1005,T0.35	1	SNA
...4		2007-000143	R-CHIP;4.7Kohm,5%,1/16W,TP,1005,T0.35	42	SNA
...4		2007-000146	R-CHIP;6.8Kohm,5%,1/16W,TP,1005	2	SNA
...4		2007-000171	R-CHIP;0ohm,5%,1/16W,TP,1005,T0.35	43	SNA
...4		2007-000173	R-CHIP;22ohm,5%,1/16W,TP,1005,T0.35	2	SNA
...4		2007-000309	R-CHIP;10ohm,5%,1/10W,TP,1608	4	SA
...4		2007-000475	R-CHIP;1Mohm,1%,1/10W,TP,1608	1	SA
...4		2007-000539	R-CHIP;200ohm,5%,1/10W,TP,1608	1	SA
...4		2007-000637	R-CHIP;270Kohm,5%,1/10W,TP,1608	1	SNA
...4		2007-000772	R-CHIP;33Kohm,1%,1/10W,TP,1608,T0.45	1	SA
...4		2007-000779	R-CHIP;33ohm,1%,1/10W,TP,1608	4	SA
...4		2007-000879	R-CHIP;4.7ohm,1%,1/10W,TP,1608	4	SA
...4		2007-000932	R-CHIP;470ohm,5%,1/16W,TP,1005,T0.35	3	SNA
...4		2007-000979	R-CHIP;5.6Kohm,1%,1/10W,TP,1608	1	SA
...4		2007-001125	R-CHIP;68Kohm,1%,1/10W,TP,1608	1	SA
...4		2007-001288	R-CHIP;18ohm,5%,1/16W,TP,1005,T0.35	4	SA
...4		2007-001292	R-CHIP;33ohm,5%,1/16W,TP,1005,T0.35	14	SNA
...4		2007-001298	R-CHIP;51ohm,5%,1/16W,TP,1005,T0.35	6	SNA
...4		2007-002437	R-CHIP;2ohm,5%,1/10W,TP,1608	1	SNA
...4		2007-002899	R-CHIP;10ohm,1%,1/10W,TP,1608	28	SA
...4		2007-002906	R-CHIP;200Kohm,1%,1/10W,TP,1608	1	SA
...4		2007-003010	R-CHIP;20ohm,5%,1/16W,TP,1005	4	SA
...4		2007-007107	R-CHIP;100Kohm,1%,1/16W,TP,1005,T0.35,-	13	SNA
...4		2007-007131	R-CHIP;13Kohm,1%,1/16W,TP,1005,T0.35	2	SA
...4		2007-007132	R-CHIP;15Kohm,1%,1/16W,TP,1005,T0.35	1	SA
...4		2007-007136	R-CHIP;4.7Kohm,1%,1/16W,TP,1005,T0.35	7	SNA
...4		2007-007137	R-CHIP;1.2Kohm,1%,1/16W,TP,1005,T0.35	8	SA
...4		2007-007138	R-CHIP;27Kohm,1%,1/16W,TP,1005,T0.35	2	SA

Exploded Views and Parts List

Level	Loc.	Part Code	Description & Specification	Qty.	SA/SNA
...4		2007-007139	R-CHIP;47Kohm,1%,1/16W,TP,1005,T0.35	7	SA
...4		2007-007142	R-CHIP;10Kohm,1%,1/16W,TP,1005,T0.35	43	SNA
...4		2007-007231	R-CHIP;110Kohm,1%,1/10W,TP,1608	1	SA
...4		2007-007305	R-CHIP;120ohm,1%,1/16W,TP,1005	4	SNA
...4		2007-007306	R-CHIP;100ohm,1%,1/16W,TP,1005,T0.35	2	SNA
...4		2007-007308	R-CHIP;33Kohm,1%,1/16W,TP,1005,T0.35	1	SA
...4		2007-007309	R-CHIP;12Kohm,1%,1/16W,TP,1005,T0.35	6	SA
...4		2007-007311	R-CHIP;22Kohm,1%,1/16W,TP,1005,T0.35	3	SA
...4		2007-007312	R-CHIP;20Kohm,1%,1/16W,TP,1005,T0.35	10	SA
...4		2007-007313	R-CHIP;6.8Kohm,1%,1/16W,TP,1005,T0.35	2	SA
...4		2007-007316	R-CHIP;3.3Kohm,1%,1/16W,TP,1005,T0.35	2	SA
...4		2007-007318	R-CHIP;1Kohm,1%,1/16W,TP,1005,T0.35	29	SNA
...4		2007-007517	R-CHIP;240ohm,1%,1/16W,TP,1005,T0.35	5	SNA
...4		2007-007520	R-CHIP;20ohm,1%,1/10W,TP,1608	2	SA
...4		2007-007528	R-CHIP;1.5Kohm,1%,1/16W,TP,1005,T0.35	1	SA
...4		2007-007671	R-CHIP;11Kohm,1%,1/16W,TP,1005,T0.35	1	SA
...4		2007-007698	R-CHIP;5.1Kohm,1%,1/16W,TP,1005,T0.35	2	SNA
...4		2007-007798	R-CHIP;10ohm,1%,1/16W,TP,1005,T0.35	5	SA
...4		2007-008026	R-CHIP;56ohm,1%,1/16W,TP,1005,T0.35	1	SA
...4		2007-008596	R-CHIP;0.1ohm,1%,1/4W,TP,3216	3	SC
...4		2007-008672	R-CHIP;47ohm,1%,1/16W,TP,1005,T0.35	1	SNA
...4		2007-009322	R-CHIP;1.3Kohm,1%,1/16W,TP,1005	1	SA
...4		2011-001261	R-NETWORK;33ohm,5%,1/16W,L,CHIP,8P,TP,2.	3	SA
...4		2011-001262	R-NETWORK;22ohm,5%,1/16W,L,CHIP,8P,TP,2.	1	SA
...4		2011-001344	R-NETWORK;100ohm,5%,1/16W,L,CHIP,8P,TP,2	6	SA
...4		2011-001345	R-NETWORK;10Kohm,5%,1/16W,L,CHIP,8P,TP,2	2	SA
...4		2011-001396	R-NETWORK;4.7Kohm,5%,1/16W,L,CHIP,8P,TP,	1	SA
...4		2011-001402	R-NETWORK;56ohm,5%,1/16W,L,CHIP,8P,TP,2.	2	SA
...4		2011-001448	R-NETWORK;10ohm,5%,1/16W,L,4P,TP,1.0x1.0	12	SA
...4	AD480	2203-000233	C-CER,CHIP;0.1nF,5%,50V,C0G,TP,1005,T0.5	4	SA
...4	AD480	2203-000278	C-CER,CHIP;0.01nF,0.5pF,50V,C0G,TP,1005	5	SA
...4	AD480	2203-000359	C-CER,CHIP;0.15nF,5%,50V,C0G,TP,1005,T0.	4	SA
...4	AD480	2203-000438	C-CER,CHIP;1nF,10%,50V,X7R,TP,1005,T0.5	6	SA
...4	AD480	2203-000489	C-CER,CHIP;2.2nF,10%,50V,X7R,TP,1005,T0.	2	SA
...4	AD480	2203-000585	C-CER,CHIP;0.22nF,10%,50V,X7R,TP,1005,T0	2	SA
...4	AD480	2203-000627	C-CER,CHIP;0.022nF,5%,50V,C0G,TP,1005	2	SNA
...4	AD480	2203-000679	C-CER,CHIP;0.027nF,5%,50V,C0G,TP,1005	2	SNA
...4	AD480	2203-000812	C-CER,CHIP;0.033nF,5%,50V,C0G,TP,1005	4	SA
...4	AD480	2203-000940	C-CER,CHIP;0.47nF,10%,50V,X7R,TP,1005,T0	1	SA
...4	AD480	2203-001153	C-CER,CHIP;0.068nF,5%,50V,C0G,TP,1005,T0	1	SA

Level	Loc.	Part Code	Description & Specification	Qty.	SA/SNA
...4	AD480	2203-002285	C-CER,CHIP;10nF,10%,50V,X7R,TP,1005	10	SNA
...4	AD480	2203-005083	C-CER,CHIP;220nF,10%,50V,X7R,TP,1608,T0.	6	SA
...4	AD480	2203-005968	C-CER,CHIP;4.7nF,10%,50V,X7R,TP,1005,T0.	2	SNA
...4	AD480	2203-006048	C-CER,CHIP;100nF,10%,10V,X7R,TP,1005,T0.	58	SA
...4	AD480	2203-006126	C-CER,CHIP;47nF,10%,16V,X7R,TP,1005,T0.5	7	SNA
...4	AD480	2203-006562	C-CER,CHIP;1000nF,10%,10V,X5R,TP,1005,T0	3	SNA
...4	AD480	2203-006698	C-CER,CHIP;1000nF,10%,25V,X7R,TP,1608,T0	7	SA
...4	AD480	2203-006838	C-CER,CHIP;2200nF,10%,6.3V,X5R,TP,1005,T	4	SA
...4	AD480	2203-006841	C-CER,CHIP;1000nF,10%,16V,X5R,TP,1005,T0	16	SNA
...4	AD480	2203-006844	C-CER,CHIP;470nF,10%,10V,X5R,TP,1005	1	SA
...4	AD480	2203-007176	C-CER,CHIP;10000nF,10%,16V,X5R,TP,2012,T	7	SNA
...4	AD480	2203-007240	C-CER,CHIP;22000nF,20%,6.3V,X5R,TP,1608,	34	SA
...4	AD480	2203-007269	C-CER,CHIP;22000nF,20%,10V,X5R,TP,2012(2	7	SA
...4	AD480	2203-007271	C-CER,CHIP;2200nF,10%,10V,X5R,TP,1005,T0	5	SNA
...4	AD480	2203-007306	C-CER,CHIP;10000nF,10%,25V,X5R,TP,2012,T	23	SNA
...4	AD480	2203-007393	C-CER,CHIP;4700nF,10%,10V,X5R,TP,1005,T0	2	SNA
...4	AD480	2203-007423	C-CER,CHIP;10000nF,10%,35V,X7R,TP,3216	4	SA
...4	AD480	2203-007544	C-CER,CHIP;100nF,10%,50V,X7R,TP,1005,T0.	20	SA
...4	AD480	2203-007795	C-CER,CHIP;10000nF,20%,10V,X5R,TP,1005,T	24	SA
...4	AD480	2203-007809	C-CER,CHIP;22nF,10%,50V,X7R,TP,1005,T0.5	1	SNA
...4	AD480	2203-008096	C-CER,CHIP;2200nF,10%,50V,X5R,TP,2012,1.	2	SA
...4	AD480	2203-008315	C-CER,CHIP;22000nF,20%,25V,X5R,TP,2012,T	14	SA
...4	AD480	2203-008412	C-CER,CHIP;4700nF,10%,50V,X5R,TP,2012,T1	1	SNA
...4		2409-001240	C-ORGANIC,SMD;33uF,20%,25V,LR,TP,7343	1	SA
...4		2703-000213	INDUCTOR-SMD;470nH,10%,1608,T0.8,1.35Ohm	1	SA
...4		2703-002269	INDUCTOR-SMD;56nH,5%,1005,T0.5,1Ohm,200m	7	SA
...4		2703-003747	INDUCTOR-SMD;22uH,20%,6060,0.135ohm,1300	2	SA
...4		2703-003862	INDUCTOR-SMD;10uH,20%,6060,0.065ohm,1900	5	SA
...4		2703-004724	INDUCTOR-SMD;8.2uH,20%,5050,T4,0.072Ohm,	4	SA
...4		2703-005193	INDUCTOR-SMD;2.2uH,20%,6060,T4.5,0.024Oh	3	SA
...4		2703-005376	INDUCTOR-SMD;10uH,20%,10.7x10mm,T3.8,0.0	1	SA
...4		2703-005715	INDUCTOR-SMD;820nH,20%,11x10mm,T3.8,0.00	1	SNA
...4		2703-005780	INDUCTOR-SMD;10uH,20%,2012,T1.25,0.91Ohm	2	SNA
...4		2801-003773	CRYSTAL-SMD;12MHz,30ppm,28-AAN,20pF,50Oh	1	SA
...4		3301-001364	BEAD-SMD;1000ohm/100Mhz 1000ohm/100Mhz,1	4	SNA
...4		3301-002039	BEAD-SMD;26ohm/100Mhz 26ohm/100Mhz,1.6x0	17	SA
...4		3601-001374	FUSE-SURFACE MOUNT;32V,5A,FAST-ACTING,PL	3	SA
...4		3701-001967	CONNECTOR-HDMI;19P,A,FEMALE,AU,0.5mm,BLK	2	SA
...4		3707-001123	CONNECTOR-OPTICAL;ANGLE,SPDIF,2.5PI	1	SA
...4		3708-003241	CONNECTOR-FPC/FFC/PIC;96P,0.5mm,SMD-A,AU	1	SNA

Exploded Views and Parts List

Level	Loc.	Part Code	Description & Specification	Qty.	SA/SNA
...4		3710-003908	CONNECTOR-SOCKET;64P,2R,0.5mm,SMD-S,AU,B	1	SA
...4	EH01	3711-008098	HEADER-BOARD TO CABLE;BOX,20P,1R,1.25mm,	1	SNA
...4	EH01	3711-008131	HEADER-BOARD TO CABLE;BOX,4P,1R,2.5mm,AN	1	SA
...4	EH01	3711-008859	HEADER-BOARD TO CABLE;BOX,12P,2R,2mm,ANG	1	SA
...4		3711-009106	CONNECTOR-HEADER;BOX,20P,2R,2mm,ANGLE,SN	1	SA
...4		3722-003229	JACK-MODULAR;8P/8C,Y,STRAIGHT,NONE,AU,1P	1	SA
...4		3722-003457	JACK-USB;4P/1C,NI,BLK,ANGLE,A,2.0,13.1x1	1	SA
...4		6302-001376	GASKET-SMD;SMT Gasket,Si,T6,W4.5,L2.5,SI	5	SNA
...4		BN40-00331B	TUNER-DTV AIR CABLE SAT;GT2S2-7B21,DVB-T	1	SA
...4		BN41-02751A	PCB-MAIN;TU7000,FR-4,4L,T1.2,1,193x168mm	1	SNA
...4	CB07	BN61-13312B	BRACKET-SCREWLESS PCB;55KS8000,SK5,T0.3,	4	SNA
...4		BN97-16718A	ASSY MICOM;TCON F/W,KANT-SU2 Built-in,11	1	SNA
....5		1107-002689	IC-NOR FLASH;EN25Q80C-104HIP2A,8Mbit,SOP	1	SNA
....5		BN46-01223A	S/W MICOM;KANT-SU2 Built-in,TCON F/W	1	SNA
...4		BN97-16719A	ASSY MICOM;KU2MICOM_INTV,UTU7000K,1107-0	1	SNA
....5		1107-002690	IC-NOR FLASH;EN25Q40B-104HIP2X,4Mbit,SOP	1	SNA
...4		BN97-16721A	ASSY MICOM;T-KTSU2DEUC,ASSY MICOM_MAIN,U	1	SNA
....5		1107-002623	IC-EMMC;KLM4G1FETE-B041,4Gbyte,BGA,153P,	1	SA
....5		BN46-01245A	S/W MICOM;Factory_PEQ Kant-SU2,Kant-SU2,	1	SNA
....5		BN46-01247A	S/W MICOM;T-KTSU2DEUC,KLM4G1FETE,Kant-SU	1	SNA
...3		BN97-16730A	ASSY MICOM;70O6AUAGT,70 CHOT TU7	1	SNA
...4		BN46-01190A	S/W MICOM;70O6AUAGT,KANT-SU2 Built-in,TU	1	SNA
...3		BN97-16777A	ASSY DRM;KANT-SU2 Built-in,DVB,Nagsam, M	1	SNA
...4		BN46-00109H	KEY CODE-CERTIFICATION;MAC,TV/AV,General	1	SNA
...4		BN46-00110P	KEY CODE-CERTIFICATION;MIRACAST(HDCP2.2)	1	SNA
...4		BN46-01153A	KEY CODE;KANT-SU2,Nagra CSC Data,T-KTSU2	1	SNA
...4		BN46-01155A	KEY CODE;KANT-SU2,CI PLUS,Samsung-iDTV-2	1	SNA
1		BN91-21956K	ASSY SHIELD;UTU7000K	1	SNA
.2		BN02-00102B	TAPE-SINGLE FACE;OPP,T0.15,W25,L50M,WHIT	0	SNA
.2		BN39-02217F	LEAD CONNECTOR-POWER;70KU6000,UL21016,12	1	SA
.2		BN39-02601A	LEAD CONNECTOR-SUB ASSY;UL21451,20P,L475	1	SA
.2		BN44-01056A	DC VSS-PD BOARD;L75S6N_THS,AC/DC,235W,AC	1	SA
.2	WLAN	BN59-01341B	NETWORK-WLAN CLIENT;WCT734M,44.17x31.99x	1	SA
.2		BN96-39820H	FFC CABLE;65/75NU8000,Fold,L500,96P,-	1	SA
.2		BN96-49998C	ASSY SPEAKER P-FRONT;TV-SPK,65UTU7000,6o	1	SA
1		BN92-27086W	ASSY P/MATERIAL;UTU7000K	1	SNA
.2		6902-003324	BAG ROLL;HDPE/PE FOAM,T0.015/T0.5,W1900,	2	SNA
.2		6922-000013	BAND;PP,T0.8,W18,L2300 M,TRP	6	SNA
.2		6932-000004	WRAP;T0.023,W750,L1000m,non stretched fi	4	SNA
.2		BN02-00319B	TAPE-SINGLE FACE;OPP,T0.05,W75,L800M,CLE	2	SNA

Level	Loc.	Part Code	Description & Specification	Qty.	SA/SNA
.2		BN69-17449E	PAD PACKING;LED,PAPER,T3,W50X50,L2200,YE	0	SNA
.2		BN69-20061A	CUSHION-SET FRONT;70UNU6900P,EPS,16.7g/l	1	SNA
..3		0103-005099	RESIN EPS;BASF303/NP,Natural,Natural,HB	563	SNA
.2		BN69-20553A	CUSHION-SET SIDE;70UTU7000,EPS,16.7g/l,W	2	SNA
.2		BN69-20975A	PALLET-WOODEN;UE70TU7000,WOOD,W1140,L175	0	SNA
.2		BN96-51268A	ASSY PACKING P-CUSHION SET;UE70TU7100,EP	1	SNA
..3		BN69-20704A	CUSHION-SET;70UTU7000K,EPS,16.7g/l,WHITE	1	SNA
..3		BN69-20754A	BOX UNIT-IN;70UTU8000H,CB,DW1,C1,L2060,W	1	SNA
1	ACCE1	BN92-27211P	ASSY ACCESSORY;UTU7000K	1	SNA
.2		BN96-51195C	ASSY ACCESSORY MANUAL CABLE;UTU7000K	1	SNA
..3		3709-001791	CONNECTOR-CARD SLOT;64P,0.5mm,SMD-A,AU,P	1	SA
..3	T0268	3903-001118	POWER CORD-DT;EUR,2P-F,250V,2.5A,BLK,L15	1	SA
..3		4301-000121	BATTERY-MN;1.5V,R03,10.5x44.5m,7.5g,AAA	2	SNA
..3		6902-001962	BAG PE;LDPE,BIOBASED,T0.05,W400,L300,TRP	1	SNA
..3		BN59-01315D	REMOCON-TV;2019 TV,SAMSUNG,44KEY,3.0V,WW	1	SA
..3		BN68-02839P	LEAFLET-WARRANTY;TV,Samsung,Turkish,Turk	1	SNA
..3		BN68-02989A	LABEL ETC;ALL MODEL,ALL,ART,W65,L30,65X3	1	SNA
..3		BN68-06877A	LEAFLET-CALL CENTER;Common,Samsung,Turke	1	SNA
..3		BN68-07598A	LEAFLET-REGULATORY GUIDE;QT/UT/LFD/LM/HD	1	SNA
..3		BN68-09371A	LEAFLET-REGULATORY GUIDE;QT/UT,W/W,MOJO,	1	SNA
..3		BN68-10314C	MANUAL USERS;TU7000,TK1,MOJO,1COLOR,EURO	1	SNA
..3		BN68-10314E	MANUAL USERS;TU7000,TK2,MOJO,1COLOR,EURO	1	SNA
..3		BN68-10395A	LEAFLET-ACCESSORY KIT;TU7000,ZG & ZU & XC & XN	1	SNA
1		BN92-27213X	ASSY LABEL;UTU7000K	1	SNA
.2		BN68-06708G	LABEL-RATING;Monitor,WW,PP,T0.161,W93,L7	1	SNA
.2		BN68-07519B	LABEL-ENERGY;ALL JORDAN,WW,PP,T0.135,W60	1	SNA
.2		BN68-10112C	LEAFLET-QUICK SETUP GUIDE;UTU7000K,ZG & ZU	1	SNA
1		BN92-27295W	ASSY BOX;UTU7000K	1	SNA
.2		BN68-06613C	LABEL BOX;TV(Domestic),ART,W60,L110,90g	1	SNA
.2		BN69-20766M	BOX UNIT-OUT;70UTU7100,CB,DW4,F3,L1731,W	1	SNA
1		BN95-06448A	PRODUCT LCD DP;DP,BN95-06384A,CY-GT070HG	1	SA
.2		BN92-27127A	ASSY P/MATERIAL;CY-GT070HGV1H,inhouse	1	SNA
..3		6902-003310	BAG PANEL;LDPE,T0.08,W1800,L1200,TRP,REC	1	SNA
..3		BN69-20448A	CUSHION-PANEL;70UTU7000K,EPS,20g/l,WHITE	0	SNA
..4		0103-005099	RESIN EPS;BASF303/NP,Natural,Natural,HB	1261	SNA
..3		BN69-20836A	PALLET-WOODEN;70" inhouse LCM,EUR type,W	0	SNA
.2	PANEL	BN95-06384A	PRODUCT LCD-CHOT;CY-GT070HGV1H/V,TU7000	1	SA
..3	M0131	BN63-00520A	GASKET-EMI;APPOLO_PAL,FABRIC,T0.13,W10,L	4	SNA
..3		BN68-05722A	LABEL-E PASS;POLYPROPYLENE,NON-COATING	1	SNA
..3		BN74-00053E	TAPE-SINGLE FACE;PAPER,3M2307,T0.14,W20,	0	SNA

Exploded Views and Parts List

Level	Loc.	Part Code	Description & Specification	Qty.	SA/SNA
...3		BN90-11351C	ASSY BACK LIGHT UNIT;70UTU7000K	1	SNA
...4		BN61-17052A	DIFFUSER PLATE;20Y_70INCH_TU7000_DP,PS,T	1	SA
...4		BN61-17100A	OPTICAL SHEET-COMPLEX;20Y_70INCH_TU7000_	1	SNA
...4		BN96-50477C	ASSY CHASSIS REAR P;70UTU7000K,EGI-SECC,	1	SNA
....5		BN02-00102B	TAPE-SINGLE FACE;OPP,T0.15,W25,L50M,WHIT	0	SNA
....5		BN02-00352B	TAPE-SINGLE FACE;PET,T0.05,W30,L50M,BLAC	0	SNA
....5		BN02-00431B	TAPE SINGLE FACE;LFD OHD,PET,T0.05,W20,L	5	SNA
....5		BN02-00586A	TAPE DOUBLE FACE;UNU7100X,ACRYL,T0.3,W3,	4	SNA
....5		BN39-02546A	LEAD CONNECTOR-BLU;70TU8000,UL21016,12P,	1	SNA
....5	CB20	BN61-11982B	BRACKET-WALL;65MU8000,CR-SPCC,NATURAL,M8	4	SNA
....5		BN61-13557L	BRACKET-WIRE;40KU6400,SW-C,T1,NATURAL,ZI	4	SA
....5		BN61-13557P	BRACKET-WIRE;75QNQ8CB,SW-C,T1,SILVER,L66	5	SNA
....5		BN61-13557X	BRACKET-WIRE;65UNU7100X,SW-C,T1,SILVER,L	2	SNA
....5		BN61-16648B	HOLDER-SOURCE PCB;65UTU7000K,PC,T1,BLACK	7	SNA
....6		0103-010254	RESIN PC;SA-1220/K21294,Black,BK0007,V-2	7	SNA
....5		BN61-16784B	FRAME-MIDDLE LEFT RIGHT;70UTU7000K,PC+GF	2	SNA
....6		0103-011580	RESIN PC;LS-3104G/G62373,Gray,GY0287,V-2	84	SNA
....5		BN61-16805A	STUD-PEM;65UTU7000K,SUM24L,L11.7,WhiteSi	8	SNA
....5		BN61-16985A	SUPPORT-PLATE;65TU8000,PC,V-2,CLEAR	12	SNA
....6		0103-005036	RESIN PC;SC-1220R/ENP,Transparent,TP0003	115	SNA
....5		BN61-16998A	OPTICAL SHEET-REFLECTOR;20Y_TU7000_70INC	1	SNA
....5		BN63-18836A	INSULATOR-SMPS;82TU8000,PC,BLACK,L290,W2	1	SNA
....5	CC04	BN64-04313A	CHASSIS-REAR;70UTU7000K,EGI-SECC,-,T0.8,	1	SNA
....6		BN01-00658A	STEEL;Y20,EGI-SECC,L0,0.8mm,930mm,AG	9549	SNA
....5		BN96-50475A	ASSY LED BAR P;20Y 70TU8000,ALUMINUM,Lef	5	SNA
....5		BN96-50489A	ASSY LED BAR P;20Y 70TU8000,ALUMINUM,Rig	5	SNA
....5		BN96-51559B	ASSY FRAME P-MIDDLE BOTTOM;70UTU7000K,PC	1	SNA
....6		BN60-01661A	SPACER-FABRIC;CONDUCTIVE FABRIC,L20,GRAY	2	SNA
....6		BN61-16783B	FRAME-MIDDLE BOTTOM;70UTU7000K,PC+GF10%,	1	SNA
....5		BN96-51569B	ASSY FRAME P-MIDDLE TOP;70UTU7000K,PC+GF	1	SNA
....6		BN02-00586C	TAPE DOUBLE FACE;TU7000,ACRYL,T0.3,W3,L1	3	SNA
....6		BN60-01654A	SPACER-FOAM;TU7K,PU FOAM,L1000,BLACK,T1,	0	SNA
....6		BN61-16779B	FRAME-MIDDLE TOP;70UTU7000K,PC+GF10%,V-2	1	SNA
.....7		0103-011580	RESIN PC;LS-3104G/G62373,Gray,GY0287,V-2	240	SNA
...3		BN96-50415A	ASSY OPEN CELL;CHOT,70Inch,Y20 New,CV700	1	SNA
...4		BN81-19109A	A/S-IC DRIVER SOURCE;IC DRIVER SOURCE,NT	1	SNA
...4		BN81-19110A	A/S-ASSY PCB-SOURCE LEFT;ASSY PCB-SOURCE	1	SNA
...4		BN81-19111A	A/S-ASSY PCB-SOURCE MIDDLE;ASSY PCB-SOUR	1	SNA
...4		BN81-19112A	A/S-ASSY PCB-SOURCE RIGHT;ASSY PCB-SOURC	1	SNA
...4		BN81-19113A	A/S-POLARIZER-C/F;POLARIZER-C/F,VW2-AGA-	1	SNA

Level	Loc.	Part Code	Description & Specification	Qty.	SA/SNA
...4		BN81-19114A	A/S-POLARIZER-TFT;POLARIZER-TFT,VW2-Z000	1	SNA
...3		BN96-50492A	ASSY CHASSIS FRONT P;70UTU7000K,AI,Carbo	1	SNA
...4	SCREW	6003-001912	SCREW-TAPTYPE;CH,+,B,M3,L4,ZPC(BLK),SWRC	2	SNA
...4		BN02-00074E	TAPE SINGLE FACE;U7201,PET,T0.05,W10,L20	4	SNA
...4		BN60-01655A	SPACER-CONDUCTIVE;CONDUCTIVE FABRIC/PU F	2	SNA
...4		BN61-16510A	BRACKET-CORNER TOP;TU7000,SK5,T1.5,NATUR	4	SNA
...4		BN63-17418F	SHEET-PROTECTION COVER;Q7F,PO,T0.05,W25,	3	SNA
...4	AC155	BN64-04309A	CHASSIS-FRONT;70UTU7000K,AI,Carbon Silve	1	SNA
...4	DECO	BN96-51951A	ASSY COVER P-DECORATION;70UTU7000K,PC+AB	1	SNA
....5		BN60-01661A	SPACER-FABRIC;CONDUCTIVE FABRIC,L20,GRAY	2	SNA
....5		BN63-17418A	SHEET-PROTECTION COVER;Q7F,PO,T0.05,W6,L	0	SNA
....5		BN63-17418D	SHEET-PROTECTION COVER;Q7F,PO,T0.05,W8,L	0	SNA
....5		BN63-17418K	SHEET-PROTECTION COVER;LS003,PO,T0.05,W1	1	SNA
....5	FD01	BN63-18566A	COVER-DECORATION;70UTU7000K,PC+ABS+MD18%	1	SNA
....6		0103-011670	RESIN PC ABS;NH-1223/G34343,Carbon Silve	110	SNA