

# 1. Exploded View & Part List

## Exploded View

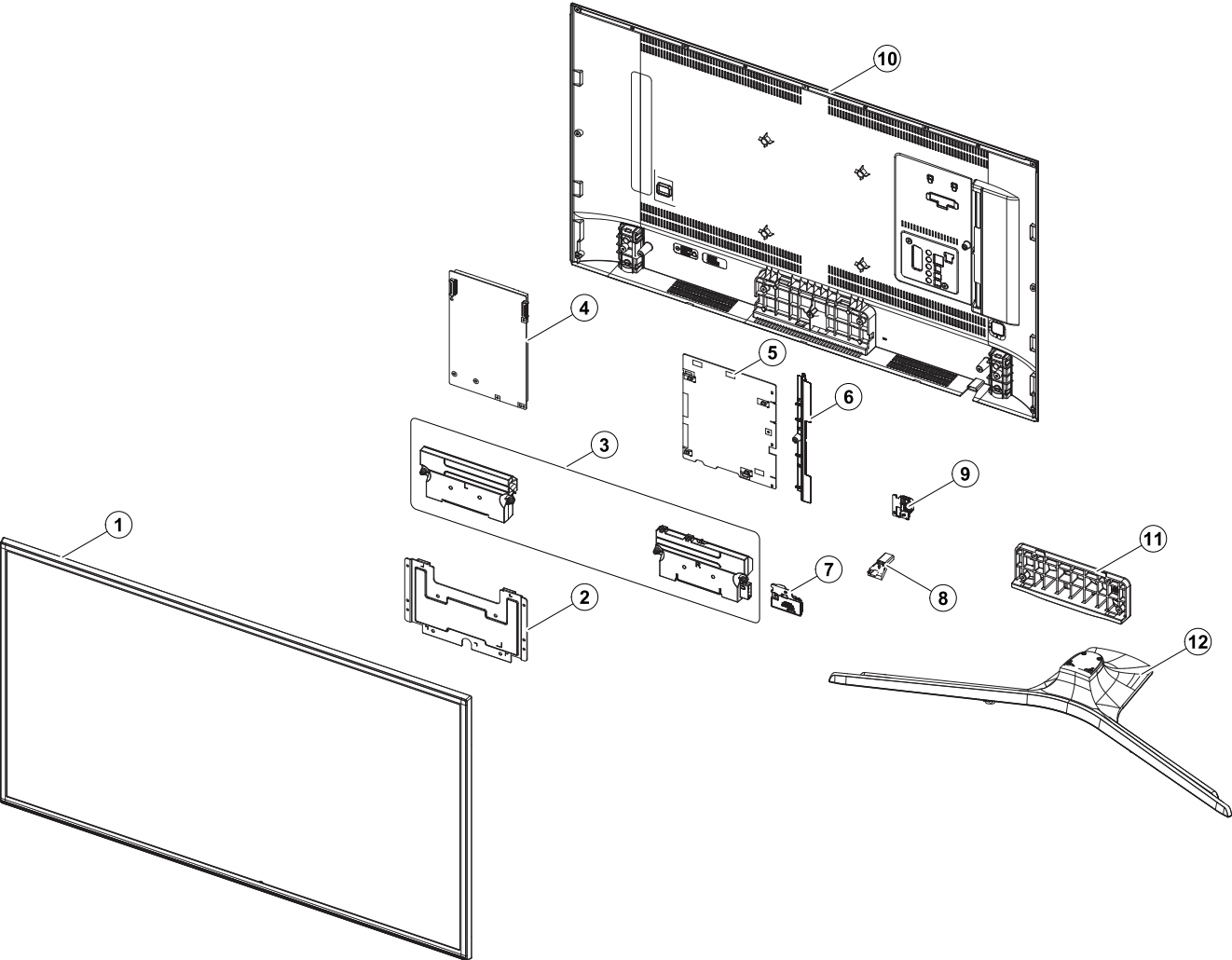

## Parts List

No.	Lvl.	Loc.	Material Code	Description & Specification	SNA	Qty.
1	1	PANEL	BN95-02641U	PRODUCT LCD-INX; CY-GK065HGNVBV/H,KU6000,	SA	1
2	2	CB18	BN61-11517A	BRACKET-STAND LINK; HGI-SGHC,T2,NATURAL	SA	1
3	2	SP01A	BN96-35006C	ASSY SPEAKER P-FRONT; TV-SPK,MU6100,6ohm,	SA	1
4	2		BN44-00808E	DC VSS-PD BOARD; L65S6NR_MSM,AC/DC,262W,A	SA	1
5	2	M0014	BN94-12434B	ASSY PCB MAIN; LEDTV 6K	SA	1
6	3		BN63-16652A	COVER-TERMINAL SIDE; 55MU6400,HIPS,HB,BK0	SA	1
7	2		BN59-01264A	NETWORK-WLAN CLIENT; WCM730Q,78.3x29.3x7.	SA	1
8	2		BN96-39955A	ASSY BOARD P-IR FUNCTION; KU6000,IR ASSY_	SA	1
9	2	JOG	BN96-35345B	ASSY BOARD P-FUNCTION JOG; JU7500,CT15SE8	SA	1
10	2	R001A	BN96-43328C	ASSY COVER P-REAR; 65MU6100,PC+ABS+GF15%,	SA	1
11	2	SG01A	BN96-38553A	ASSY GUIDE P-STAND; 60JS6900,NORTH AMERIC	SA	1
12	2	SB04A	BN96-37971A	ASSY STAND P-BOTTOM; Y15 J6200 60",PC+ABS	SA	1

## 2. Electrical Parts List

Level	Loc.	Part Code	Description & Specification	Qty.	SA/SNA
			<b>UE65MU6105KXXC (DA02)</b>		
1	S001A	BN90-06595Y	ASSY STAND;LED_J6K	1	SNA
..2	SB04A	BN96-37971A	ASSY STAND P-BOTTOM;Y15 J6200 60",PC+ABS	1	SA
..3	SCREW	6003-001001	SCREW-TAPTYPE;FH,+,-,B,M3,L8,ZPC(BLK),SW	2	SA
..3	AS080	BN63-04755H	SHEET-PROTECTION COVER;52LC530,PE,T0.05,	1	SNA
..3	AS080	BN63-04755L	SHEET-PROTECTION COVER;22LC350,PE,T0.05,	1	SNA
..3	RF01	BN67-00398P	FOOT-RUBBER;UH6K,Si,GRAY,W8,L15.5,T2.5	2	SNA
..3		BN95-02371B	ASSY COVER STAND SMT;J6200,60,Silver SMT	1	SNA
..4		0203-007002	TAPE-SINGLE FACE;OPP,T0.06,W75,L66M,CLEA	0	SNA
..4		0204-007674	COATING;UVICHEM CVM93000(VOC) MATT(5)B,C	0	SNA
..4		AA69-07494X	PAD-DP SHEET;CTV,CB,DW,W990,L515,YELLOW	1	SNA
..4		AA69-07610E	PAD-DP SHEET;CTV,CB,DW5,W515,L310	1	SNA
..4		AA69-07629P	MASTER BOX-DP;CB,DW,L315,W525,H1020	1	SNA
..4		AA69-07707A	PAD-DP BOTTOM EPP;CTV,CB,DW,W515,L35	1	SNA
..4		BN01-00337A	TARGET-ALUMINIUM CY;Al,99.9%,1924mm, 132	0	SNA
..4		BN01-00340A	TARGET-CHROMIUM CY;Cr,99.5%,1924mm, 132d	0	SNA
..4		BN63-14512A	COVER-STAND DECORATION;60J6200,PC+ABS,V-	1	SNA
....5		0103-005041	RESIN PC ABS;FR3200TV,901408,BK0008,1.2m	85	SNA
....5	AS080	BN63-07556C	SHEET-PROTECTION COVER;TOC,PO,T0.068,W50	1	SNA
..4		BN68-03920A	LABEL BOX;ALL,ART PAPER,W100,L75,W/W,100	1	SNA
..4		BN69-10617S	PACKING SHEET;48" 6500 INHOUSE,HDPE/PE F	1	SNA
..3	SB02A	BN96-38154A	ASSY STAND P-BOTTOM;J6200 60",PC+ABS+GF2	1	SNA
..4	SCREW	6003-001119	SCREW-TAPTYPE;FH,+S,M4,L10,ZPC(BLK),SWR	8	SA
..4	SCREW	6003-001355	SCREW-TAPTYPE;BH,+S,M4,L20,ZPC(BLK),SWR	2	SNA
..4		BN61-12727A	BRACKET-STAND BOTTOM;HGI,T3,NATURAL	1	SNA
..4		BN61-12728A	BRACKET-STAND BODY;HGI,T1.9,NATURAL	1	SNA
..4		BN63-14511A	COVER-STAND TOP;60J6200,PC+ABS+GF20%,V-1	1	SNA
....5		0103-009946	RESIN PC ABS;HM-1200,BLACK,BK0007,V-1,GF	450	SNA
....5		BN68-00513D	LABEL-RESIN;resin,-,ART,-,W10,L25,-,-,-,	1	SNA
..4	RF01	BN67-00398P	FOOT-RUBBER;UH6K,Si,GRAY,W8,L15.5,T2.5	3	SNA
..4		BN68-05603A	LABEL-E PASS;ART PAPER 90G,W/W	1	SNA
..2	SG01A	BN96-38553A	ASSY GUIDE P-STAND;60JS6900,NORTH AMERIC	1	SA
..3	SG03	BN61-12971A	GUIDE-STAND;60JS6900,PC+GF20%,V-2,BK0007	1	SNA
..3		BN69-08751A	PACKING SHRINKAGE;STAND,PLASTIC OTHERS,P	0	SNA
..3		BN96-32380B	ASSY ACCESSORY-SCREW;LED_H5000,BN69-1058	1	SNA
..4	HOLDER	BN61-09494D	HOLDER-BOLT;KU6500,SWRCH18A,BLACK,B TYPE	4	SA
..4		BN69-10588A	BAG SCREW;LDPE,0.05,70,90,TRP,LED TV,LDP	1	SNA
..3		BN96-38693A	ASSY ACCESSORY-SCREW;JS7200	1	SNA

## Exploded Views and Parts List

Level	Loc.	Part Code	Description & Specification	Qty.	SA/SNA
...4		6902-002601	BAG SCREW;LDPE,T0.05*,W70,90,TRP,RECYCLE	1	SNA
...4	SCREW	BN61-09494B	SCREW-TAPTYPE;BH,+,S,M4,L14,ZPC(BLK),SWR	4	SA
1	R001A	BN90-09062C	ASSY COVER REAR;UMU6100N,65	1	SNA
.2	SCREW	6001-003074	SCREW-MACHINE;BH,+,M3,L6,ZPC(BLK),SWRCH1	18	SA
.2	SCREW	6003-000003	SCREW-TAPTYPE;BH,+,-,B,M4,L10,ZPC(BLK),S	1	SA
.2	R001A	BN96-43328C	ASSY COVER P-REAR;65MU6100,PC+ABS+GF15%,	1	SA
...3	R001	BN63-15587A	COVER-REAR;65KU6000,PC+ABS+GF15%,MOLD,V-	1	SNA
...4		0103-010275	RESIN PC ABS;235GNH15/6919H,Black,BK0007	4940	SNA
...3		BN64-03903A	INLAY-TERMINAL SIDE;55MU6100,PET,T0.125,	1	SNA
...3		BN68-03518R	LABEL-STICKER CI SLOT;55KU6000,PET,T0.12	1	SNA
...3		BN68-05603A	LABEL-E PASS;ART PAPER 90G,W/W	2	SNA
1		BN90-09071E	ASSY W/I;UMU6100N	1	SNA
.2		BN81-08159Z	A/S PART SET-ELEC W/I;LED TV ELEC spec-C	1	SNA
.2		BN81-15300F	A/S PART SET-MECH W/I;UMU6100N,U65MN*	1	SNA
1		BN91-18922P	ASSY SHIELD;UMU6100N,65	1	SNA
.2	SCREW	6001-003081	SCREW-MACHINE;PWH,+,M3,L5,ZPC(WHT),SWRCH	5	SA
.2		BN02-00102B	TAPE-SINGLE FACE;FILAMENT,#8917,T0.15,W2	0	SNA
.2	16P	BN39-02030C	LEAD CONNECTOR-BLU;BLU,UL21016,16P,150mm	1	SA
.2	EC13	BN39-02217A	LEAD CONNECTOR-SUB ASSY;UN50KU6000,UL210	1	SA
.2		BN39-02219B	LEAD CONNECTOR-SUB ASSY;49KU6400,UL21016	1	SA
.2		BN39-02220D	LEAD CONNECTOR-SUB ASSY;65KU6300,UL21016	1	SA
.2		BN44-00808E	DC VSS-PD BOARD;L65S6NR_MSM,AC/DC,262W,A	1	SA
.2		BN59-01264A	NETWORK-WLAN CLIENT;WCM730Q,78.3x29.3x7.	1	SA
.2		BN61-09637A	HOLDER-WIFI;KU6000,ABS,BK0007,HB	1	SA
.2	CB18	BN61-11517A	BRACKET-STAND LINK;HGI-SGHC,T2,NATURAL	1	SA
...3		BN61-09605A	STUD-PEM;LED TV F6100,SUM24L,T0.8,L8,PRE	4	SNA
.2	SP01A	BN96-35006C	ASSY SPEAKER P-FRONT;TV-SPK,MU6100,6ohm,	1	SA
.2	JOG	BN96-35345B	ASSY BOARD P-FUNCTION JOG;JU7500,CT15SE8	1	SA
...3	AH240	BN61-11584A	HOLDER-BUTTON;JU7500,ABS,BK0007,HB	1	SNA
...3	AH297	BN63-11231B	HOLDER-KNOB;HU7000,ABS,BLACK,HB	1	SNA
...3	FK04	BN64-02406B	BUTTON-FUNCTION;LED_HU7000,ABS,HB,BLACK,	1	SNA
...4		0103-004609	RESIN ABS;HF-0680U,K21294,BK0007,HB,High	8	SNA
.2		BN96-39823B	FFC CABLE;65KS7500,Fold,L600,96P	1	SA
.2		BN96-39902A	FFC CABLE;65KU6000,Fold,L750,96P	1	SA
.2		BN96-39955A	ASSY BOARD P-IR FUNCTION;KU6000,IR ASSY_	1	SA
1	M0017	BN91-18929B	ASSY CHASSIS;UMU6100N,65	1	SNA
.2	M0014	BN94-12434B	ASSY PCB MAIN;LEDTV 6K	1	SA
...3		BN62-00834A	HEAT SINK-PS;KANT_M heatsink,A1050,T1.5,	1	SNA
...3		BN63-16652A	COVER-TERMINAL SIDE;55MU6400,HIPS,HB,BK0	1	SA
...4		0103-004628	RESIN HIPS;HF-1690H,K2901,BK0020,1.5mm H	20	SNA

Level	Loc.	Part Code	Description & Specification	Qty.	SA/SNA
..3		BN97-12859A	ASSY DRM;Kant_M,DVB,NagSam, MAC, HDCP, C	1	SNA
...4		BN46-00109H	KEY CODE-CERTIFICATION;MAC,TV/AV,General	1	SNA
...4		BN46-00110P	KEY CODE-CERTIFICATION;MIRACAST(HDCP2.2)	1	SNA
...4		BN46-00601A	KEY CODE-CERTIFICATION;KANT-M,CI PLUS,Sa	1	SNA
...4		BN46-00604A	KEY CODE-CERTIFICATION;KANT-M,Nagra CSC	1	SNA
..3		BN97-12957J	ASSY MICOM;TCON DATA_65INX_F,MU6100	1	SNA
...4		BN46-00661A	S/W MICOM;M6506U0F,65D6AU0VK,65INX_F	1	SNA
..3		BN97-13471B	ASSY SMD;LEDTV 6K	1	SNA
...4		0202-001899	SOLDER-CREAM;M705-GRN360-K2-VT,20-38um,S	5	SNA
...4	DS01A	0401-001056	DIODE-SWITCHING;MMBD4148SE,100V,200mA,SO	1	SA
...4		0403-001783	DIODE-ZENER;BZB84-C6V2,5.8~6.6V,300mW,SO	3	SNA
...4		0404-001307	DIODE-SCHOTTKY;SSC54,40V,5000mA,DO-214AB	1	SA
...4		0404-001404	DIODE-SCHOTTKY;BAT721C,40V,200mA,SOT-23,	2	SA
...4		0404-001640	DIODE-SCHOTTKY;SS1060HEWS,60V,1000mA,SOD	2	SA
...4		0404-001881	DIODE-SCHOTTKY;SS3040-HE,40V,3000mA,SOD-	1	SA
...4		0404-001953	DIODE-SCHOTTKY;MBRA340F-HAF,40V,3000mA,S	3	SA
...4		0406-001200	DIODE-TVS;RClamp0504F,6V,1MAV,TP	5	SA
...4		0406-001635	DIODE-TVS;SMF5.0A,6.4V,6.7V,7V,200MAV,20	1	SA
...4		0406-001718	DIODE-TVS;SMF36A,40V,44.2V,3.8MAV,1.25VP	1	SA
...4		0406-001778	DIODE-TVS;PUSB3FR4,6V,9V,0.2MAV,0.7VPA,0	1	SA
...4		0406-001786	DIODE-TVS;PJEC5V0V6TM,5V,7V,8V,0.1MAV,9V	1	SA
...4		0501-000445	TR-SMALL SIGNAL;KTC3875S-Y,NPN,150mW,SOT	4	SC
...4		0502-001345	TR-POWER;FCX491A,NPN,1000mW,SOT89,TR,900	1	SA
...4		0502-001346	TR-POWER;FCX591A,PNP,1000mW,SOT89,TR,30/	2	SA
...4		0504-000126	TR-DIGITAL;KSR1101,NPN,200mW,4.7K/4.7K,S	1	SA
...4		0505-001844	FET-SILICON;SI4435DDY-T1-GE3,P,30V,-11.4	1	SA
...4		0505-002560	FET-SILICON;AO6415,P,20V,-3.3A,0.15ohm,1	1	SA
...4		0505-002598	FET-SILICON;AP2317GN,P,20V,-4.2A,0.052oh	1	SA
...4		0505-002660	FET-SILICON;Si2308BDS,N,60V,2.3A,0.156oh	1	SA
...4		0505-002893	FET-SILICON;AO4801AS,P,30V,-5A,2W,SOIC-8	1	SA
...4		0505-003205	FET-SILICON;DMG4435SSS-13,P,30V,-7.3A,1.	1	SA
...4		0505-003391	FET-SILICON;AOD2922,N,100V,8A,140Mohm,18	1	SA
...4		0505-003397	FET-SILICON;2N7002K,N,60V,0.38A,1.19ohm,	1	SA
...4		0505-003507	FET-SILICON;AO3424,N,30V,3.8A,1.4W,SOT-2	4	SA
...4		0801-003603	IC-CMOS LOGIC;MC74LCX244MN2TWG,Octal buf	1	SA
...4		1001-001998	IC-ANALOG MULTIPLEX;NX3DV221GM,USB switc	1	SA
...4		1103-001584	IC-EEPROM;M24512-DFMN6TP,512Kbit,64K x 8	1	SNA
...4		1105-002704	IC-DDR4 SDRAM;K4F8E304HB-MGCH,LPDDR4-SDR	2	SA
...4		1201-000166	IC-OP AMP;LM358,SOP,ST,8P,150MIL,DUAL,10	1	SA
...4		1201-004117	IC-AUDIO AMP;TAS5749M,QFP,48P,7x7x1mm,DU	1	SA

Exploded Views and Parts List

Level	Loc.	Part Code	Description & Specification	Qty.	SA/SNA
...4		1203-004363	IC-VOL. DETECTOR;SOT-23,3Z30,2.9x1.6mm,P	1	SA
...4		1203-008082	IC-DC/DC CONVERTER;TPS54627DDAR,SOP 8P,8	1	SA
...4		1203-008104	IC-POSIFIXED REG.;S-13A1D18-E800,HSOP,8	1	SNA
...4		1203-008105	IC-POSIFIXED REG.;S-13A1D33-E800,HSOP,8	1	SNA
...4		1203-008777	IC-DC/DC CONVERTER;TPS563201,SOT-23,6,1.	4	SA
...4		1203-008891	IC-DC/DC CONVERTER;VPM1RT,QFN,68P,8x8x1m	1	SA
...4		1203-008917	IC-DC/DC CONVERTER;G5334CQT1U,QFN4,23P,4	1	SA
...4		1203-008919	IC-DC/DC CONVERTER;SYD104AADC,TSOT23,6P,	1	SA
...4		1203-008921	IC-DC/DC CONVERTER;SYU236ARAC,QFN,20P,3x	1	SA
...4		1203-008933	IC-POSIAJUST REG.;G942F11U,SOP,8P,4.9x	1	SA
...4		1203-009004	IC-VOL. DETECTOR;RT9824CGJ8,TSOT-23-8,8P	1	SA
...4		1204-003741	IC-DECODER;SDP1601,FCPBGA,1147P,31x31x2.	1	SNA
...4		1205-004692	IC-SWITCH;TPS2069CDBVR,SOT-23,5P,2.9x2.8	2	SA
...4		1205-005519	IC-SWITCH;ET20163,SOT23-5,5P,2.95x3.02mm	1	SA
...4		1205-005749	IC-SWITCH;G2897KD1U,TDFN2X3-14,14P,2x3mm	2	SA
...4		1404-001731	THERMISTOR-NTC;33Kohm,4050K,1mW/C,TP,1.6	1	SNA
...4		1405-001232	VARISTOR;6.4V,5.6VDC,30A,1608,TP,19V,200	1	SNA
...4		1405-001271	VARISTOR;35V,20VDC,5A,1005,TP,100V,10pF	22	SA
...4		1405-001381	VARISTOR;11V,8VDC,30A,1608,TP,25V,500pF	5	SA
...4		1405-001382	VARISTOR;24.5V,16VDC,120A,2012,TP,42V,40	1	SA
...4		2007-000039	R-CHIP;0ohm,1%,1/10W,TP,1608	5	SA
...4		2007-000043	R-CHIP;1Kohm,1%,1/10W,TP,1608	1	SA
...4		2007-000052	R-CHIP;10Kohm,1%,1/10W,TP,1608	1	SA
...4		2007-000066	R-CHIP;20Kohm,1%,1/10W,TP,1608	1	SNA
...4		2007-000070	R-CHIP;0ohm,5%,1/10W,TP,1608	18	SA
...4		2007-000137	R-CHIP;2Kohm,5%,1/16W,TP,1005	4	SNA
...4		2007-000138	R-CHIP;100ohm,5%,1/16W,TP,1005	1	SA
...4		2007-000143	R-CHIP;4.7Kohm,5%,1/16W,TP,1005	10	SNA
...4		2007-000146	R-CHIP;6.8Kohm,5%,1/16W,TP,1005	1	SNA
...4		2007-000148	R-CHIP;10Kohm,5%,1/16W,TP,1005	3	SA
...4		2007-000170	R-CHIP;1Mohm,5%,1/16W,TP,1005	1	SNA
...4		2007-000171	R-CHIP;0ohm,5%,1/16W,TP,1005	26	SNA
...4		2007-000287	R-CHIP;100ohm,1%,1/10W,TP,1608	1	SNA
...4		2007-000683	R-CHIP;3.3Kohm,1%,1/10W,TP,1608	1	SA
...4		2007-000772	R-CHIP;33Kohm,1%,1/10W,TP,1608	1	SA
...4		2007-000779	R-CHIP;33ohm,1%,1/10W,TP,1608	3	SA
...4		2007-000932	R-CHIP;470ohm,5%,1/16W,TP,1005	3	SNA
...4		2007-000979	R-CHIP;5.6Kohm,1%,1/10W,TP,1608	1	SA
...4		2007-000999	R-CHIP;510ohm,1%,1/10W,TP,1608	1	SA
...4		2007-001125	R-CHIP;68Kohm,1%,1/10W,TP,1608	2	SA

Level	Loc.	Part Code	Description & Specification	Qty.	SA/SNA
...4		2007-001258	R-CHIP;10ohm,1%,1/4W,TP,3216	2	SA
...4		2007-001288	R-CHIP;18ohm,5%,1/16W,TP,1005	4	SA
...4		2007-001292	R-CHIP;33ohm,5%,1/16W,TP,1005	27	SNA
...4		2007-001298	R-CHIP;51ohm,5%,1/16W,TP,1005	9	SNA
...4		2007-002899	R-CHIP;10ohm,1%,1/10W,TP,1608	4	SA
...4		2007-002906	R-CHIP;200Kohm,1%,1/10W,TP,1608	1	SA
...4		2007-007107	R-CHIP;100Kohm,1%,1/16W,TP,1005	13	SNA
...4		2007-007131	R-CHIP;13Kohm,1%,1/16W,TP,1005	6	SA
...4		2007-007132	R-CHIP;15Kohm,1%,1/16W,TP,1005	3	SA
...4		2007-007136	R-CHIP;4.7Kohm,1%,1/16W,TP,1005	57	SNA
...4		2007-007137	R-CHIP;1.2Kohm,1%,1/16W,TP,1005	2	SA
...4		2007-007138	R-CHIP;27Kohm,1%,1/16W,TP,1005	1	SNA
...4		2007-007139	R-CHIP;47Kohm,1%,1/16W,TP,1005,T0.35	12	SA
...4		2007-007142	R-CHIP;10Kohm,1%,1/16W,TP,1005	33	SNA
...4		2007-007305	R-CHIP;120ohm,1%,1/16W,TP,1005	1	SNA
...4		2007-007306	R-CHIP;100ohm,1%,1/16W,TP,1005	15	SNA
...4		2007-007308	R-CHIP;33Kohm,1%,1/16W,TP,1005	3	SA
...4		2007-007309	R-CHIP;12Kohm,1%,1/16W,TP,1005,T0.35	1	SA
...4		2007-007310	R-CHIP;8.2Kohm,1%,1/16W,TP,1005	5	SA
...4		2007-007311	R-CHIP;22Kohm,1%,1/16W,TP,1005	1	SA
...4		2007-007312	R-CHIP;20Kohm,1%,1/16W,TP,1005	16	SA
...4		2007-007313	R-CHIP;6.8Kohm,1%,1/16W,TP,1005	6	SA
...4		2007-007315	R-CHIP;3.9Kohm,1%,1/16W,TP,1005	1	SNA
...4		2007-007317	R-CHIP;2.2Kohm,1%,1/16W,TP,1005	2	SA
...4		2007-007318	R-CHIP;1Kohm,1%,1/16W,TP,1005	6	SNA
...4		2007-007334	R-CHIP;200Kohm,1%,1/16W,TP,1005	4	SNA
...4		2007-007488	R-CHIP;75Kohm,1%,1/16W,TP,1005	1	SNA
...4		2007-007517	R-CHIP;240ohm,1%,1/16W,TP,1005	5	SNA
...4		2007-007528	R-CHIP;1.5Kohm,1%,1/16W,TP,1005	5	SA
...4		2007-007588	R-CHIP;1.8Kohm,1%,1/16W,TP,1005	1	SA
...4		2007-007697	R-CHIP;2.4Kohm,1%,1/16W,TP,1005	1	SNA
...4		2007-007736	R-CHIP;510Kohm,1%,1/10W,TP,1608	1	SA
...4		2007-007766	R-CHIP;2Kohm,1%,1/16W,TP,1005	21	SNA
...4		2007-007767	R-CHIP;200ohm,1%,1/16W,TP,1005	4	SA
...4		2007-007798	R-CHIP;10ohm,1%,1/16W,TP,1005	6	SA
...4		2007-008015	R-CHIP;75ohm,1%,1/16W,TP,1005	7	SNA
...4		2007-008294	R-CHIP;33ohm,1%,1/16W,TP,1005	4	SA
...4		2007-008298	R-CHIP;49.9ohm,1%,1/16W,TP,1005	5	SA
...4		2007-008596	R-CHIP;0.1ohm,1%,1/4W,TP,3216	3	SC
...4		2007-008779	R-CHIP;0ohm,1%,1/16W,TP,1005	6	SA

Exploded Views and Parts List

Level	Loc.	Part Code	Description & Specification	Qty.	SA/SNA
...4		2007-009322	R-CHIP;1.3Kohm,1%,1/16W,TP,1005	5	SA
...4		2007-009777	R-CHIP;4.99Kohm,1%,1/16W,TP,1005	1	SA
...4		2011-001261	R-NETWORK;33ohm,5%,1/16W,L,CHIP,8P,TP,2.	6	SA
...4		2011-001264	R-NETWORK;10ohm,5%,1/16W,L,CHIP,8P,TP,2.	17	SNA
...4		2011-001344	R-NETWORK;100ohm,5%,1/16W,L,CHIP,8P,TP,2	9	SA
...4		2011-001448	R-NETWORK;10ohm,5%,1/16W,L,4P,TP,1.0x1.0	1	SA
...4		2011-001506	R-NETWORK;10Kohm,5%,1/16W,L,CHIP,4P,TP,1	1	SNA
...4		2011-001527	R-NETWORK;4.7Kohm,5%,1/16W,L,CHIP,4P,TP,	4	SNA
...4		2011-001586	R-NETWORK;1Kohm,5%,1/16W,L,CHIP,4P,TP,1.	2	SNA
...4		2011-001587	R-NETWORK;100ohm,5%,1/16W,L,CHIP,4P,TP,1	3	SNA
...4	AD480	2203-000140	C-CER,CHIP;1.5nF,10%,50V,X7R, TP,1608	1	SNA
...4	AD480	2203-000233	C-CER,CHIP;0.1nF,5%,50V,C0G,TP,1005	4	SA
...4	AD480	2203-000278	C-CER,CHIP;0.01nF,0.5pF,50V,C0G,TP,1005	6	SA
...4	AD480	2203-000359	C-CER,CHIP;0.15nF,5%,50V,C0G, TP,1005,T0.	3	SNA
...4	AD480	2203-000425	C-CER,CHIP;0.018nF,5%,50V,C0G, TP,1005	2	SA
...4	AD480	2203-000438	C-CER,CHIP;1nF,10%,50V,X7R,TP,1005	8	SA
...4	AD480	2203-000489	C-CER,CHIP;2.2nF,10%,50V,X7R, TP,1005	2	SA
...4	AD480	2203-000585	C-CER,CHIP;0.22nF,10%,50V,X7R,TP,1005	4	SA
...4	AD480	2203-000812	C-CER,CHIP;0.033nF,5%,50V,C0G,TP,1005	3	SA
...4	AD480	2203-000940	C-CER,CHIP;0.47nF,10%,50V,X7R, TP,1005	4	SA
...4	AD480	2203-001072	C-CER,CHIP;0.056nF,5%,50V,C0G, TP,1005	1	SA
...4	AD480	2203-001851	C-CER,CHIP;0.016nF,5%,50V,C0G,TP,1608	1	SNA
...4	AD480	2203-002285	C-CER,CHIP;10nF,10%,50V,X7R,TP,1005	8	SNA
...4	AD480	2203-002525	C-CER,CHIP;0.56nF,10%,50V,X7R,TP,1005	1	SNA
...4	AD480	2203-002720	C-CER,CHIP;10nF,10%,25V,X7R,TP,1005,T0.5	1	SNA
...4	AD480	2203-005057	C-CER,CHIP;0.0082nF,0.25pF,50V,C0G, TP,10	2	SA
...4	AD480	2203-005083	C-CER,CHIP;220nF,10%,50V,X7R,TP,1608,T0.	6	SA
...4	AD480	2203-005249	C-CER,CHIP;100nF,10%,50V,X7R,TP,1608	5	SNA
...4	AD480	2203-005344	C-CER,CHIP;22nF,10%,25V,X7R,TP,1005,T0.5	1	SNA
...4	AD480	2203-005642	C-CER,CHIP;0.22nF,5%,50V,C0G,TP,1005	2	SNA
...4	AD480	2203-005968	C-CER,CHIP;4.7nF,10%,50V,X7R,TP,1005,T0.	2	SNA
...4	AD480	2203-005993	C-CER,CHIP;68nF,10%,16V,X7R,1005	1	SA
...4	AD480	2203-006048	C-CER,CHIP;100nF,10%,10V,X7R,TP,1005	1	SA
...4	AD480	2203-006126	C-CER,CHIP;47nF,10%,16V,X7R,TP,1005	3	SNA
...4	AD480	2203-006158	C-CER,CHIP;100nF,10%,16V,X7R,TP,1005,T0.	219	SNA
...4	AD480	2203-006324	C-CER,CHIP;2200nF,10%,10V,X5R,TP,1608	14	SA
...4	AD480	2203-006348	C-CER,CHIP;1000nF,10%,25V,X5R,TP,1608,T0	1	SA
...4	AD480	2203-006562	C-CER,CHIP;1000nF,10%,10V,X5R,TP,1005	18	SNA
...4	AD480	2203-006636	C-CER,CHIP;220nF,10%,25V,X7R,TP,1608	1	SA
...4	AD480	2203-006698	C-CER,CHIP;1000nF,10%,25V,X7R,TP,1608,T0	10	SNA



Level	Loc.	Part Code	Description & Specification	Qty.	SA/SNA
...4	AD480	2203-006824	C-CER,CHIP;4700nF,10%,10V,X5R,TP,1608	4	SNA
...4	AD480	2203-006838	C-CER,CHIP;2200nF,10%,6.3V,X5R,TP,1005	3	SA
...4	AD480	2203-006841	C-CER,CHIP;1000nF,10%,16V,X5R,TP,1005	1	SNA
...4	AD480	2203-006844	C-CER,CHIP;470nF,10%,10V,X5R,TP,1005	2	SA
...4	AD480	2203-006890	C-CER,CHIP;10000nF,20%,6.3V,X5R,TP,1608	66	SNA
...4	AD480	2203-007176	C-CER,CHIP;10000nF,10%,16V,X5R,TP,2012,T	11	SNA
...4	AD480	2203-007240	C-CER,CHIP;22000nF,20%,6.3V,X5R,TP,1608,	63	SA
...4	AD480	2203-007269	C-CER,CHIP;22000nF,20%,10V,X5R,TP,2012(2	19	SA
...4	AD480	2203-007270	C-CER,CHIP;10000nF,10%,10V,X5R,TP,1608,T	10	SNA
...4	AD480	2203-007306	C-CER,CHIP;10000nF,10%,25V,X5R,TP,2012,1	31	SNA
...4	AD480	2203-007423	C-CER,CHIP;10000nF,10%,35V,X7R,TP,3216	4	SA
...4	AD480	2203-007486	C-CER,CHIP;1000nF,10%,50V,X5R,TP,1608	2	SNA
...4	AD480	2203-007544	C-CER,CHIP;100nF,10%,50V,X7R,TP,1005,T0.	14	SA
...4	AD480	2203-008315	C-CER,CHIP;22000nF,20%,25V,X5R,TP,2012,T	6	SA
...4	AD480	2203-008412	C-CER,CHIP;4700nF,10%,50V,X5R,TP,2012,1.	1	SNA
...4		2402-001268	C-AL,SMD;100uF,20%,25V,WT,TP,8x6.3mm	1	SA
...4		2409-001240	C-ORGANIC,SMD;33uF,20%,25V,LR,TP,7343(1.	1	SA
...4		2703-000213	INDUCTOR-SMD;470nH,10%,1.35Ohm,35mA,15,M	1	SA
...4		2703-002269	INDUCTOR-SMD;56nH,5%,1005,T0.5,1.4Ohm,15	3	SA
...4		2703-003747	INDUCTOR-SMD;22uH,20%,6060,0.135ohm,1300	2	SA
...4		2703-003754	INDUCTOR-SMD;1uH,20%,1608,T0.8,0.24Ohm,9	1	SNA
...4		2703-003862	INDUCTOR-SMD;10uH,20%,6060,0.065ohm,1900	4	SA
...4		2703-003937	INDUCTOR-SMD;1uH,20%,70647,T3,0.008Ohm,1	1	SA
...4		2703-004630	INDUCTOR-SMD;2.2uH,20%,7070,T5,0.0025Ohm	2	SNA
...4		2703-004724	INDUCTOR-SMD;8.2uH,20%,5050,T4,0.072Ohm,	4	SA
...4		2703-005191	INDUCTOR-SMD;1.5uH,20%,6060,T4.5,0.02Ohm	5	SA
...4		2703-005376	INDUCTOR-SMD;10uH,20%,10.7x10mm,T3.8,0.0	1	SA
...4		2801-004021	CRYSTAL-SMD;24.576MHz,20ppm,28-AAN,12pF,	2	SA
...4		3301-002039	BEAD-SMD;26ohm,1608,TP	43	SA
...4		3601-001374	FUSE-SURFACE MOUNT;32V,5A,FAST-ACTING,PL	3	SA
...4		3601-001376	FUSE-SURFACE MOUNT;32V,3A,FAST-ACTING,Hi	1	SNA
...4		3701-001967	CONNECTOR-HDMI;19P,A,FEMALE,AU,0.5mm,BLK	3	SA
...4		3707-001104	CONNECTOR-OPTICAL;ANGLE,SPDIF	1	SA
...4		3708-003241	CONNECTOR-FPC/FFC/PIC;96P,0.5mm,SMD-A,AU	2	SNA
...4		3710-003908	CONNECTOR-SOCKET;64P,2R,0.5mm,SMD-S,AU,B	1	SA
...4	EH01	3711-007803	HEADER-BOARD TO CABLE;BOX,12P,1R,1.25mm,	1	SA
...4	EH01	3711-008131	HEADER-BOARD TO CABLE;BOX,4P,1R,2.5mm,AN	1	SA
...4	EH01	3711-008859	HEADER-BOARD TO CABLE;BOX,12P,2R,2mm,ANG	1	SA
...4		3711-009090	CONNECTOR-HEADER;BOX,16P,1R,1.25mm,SMD-A	1	SA
...4		3722-003199	JACK-MODULAR;8P/8C,Y,ANGLE,NONE,AU,1PORT	1	SA

Exploded Views and Parts List

Level	Loc.	Part Code	Description & Specification	Qty.	SA/SNA
...4		3722-003457	JACK-USB;4P/1C,NI,BLK,ANGLE,A,2.0,13.1x1	2	SA
...4		3722-003814	JACK-PHONE;1P/7C,NI/SN,YEL,ANGLE,3.5PI,1	1	SA
...4	JACK	3722-003873	JACK-PHONE;1P/7C,AU/SN,BLU,ANGLE,3.5PI,1	1	SA
...4		6302-001376	GASKET-SMD;,,CONDUCTIVE FABRIC,T14,W43,L	5	SNA
...4		BN40-00330A	TUNER-DTV AIR CABLE;DTOS40EH7A,DVB-TC,38	1	SA
...4		BN41-02568B	PCB-MAIN;MU6,FR-4,4L,1.6T,193x241mm,1,KA	1	SNA
...4	CB07	BN61-13312B	BRACKET-SCREWLESS PCB;55KS8000,SK5,T0.3,	4	SNA
...4		BN97-12857A	ASSY MICOM-SUB;KMMICOM_TV,UMU7000,W25Q40	1	SNA
....5		1107-002226	IC-NOR FLASH;W25Q40CLSSIP,4Mbit,SOIC,8P,	1	SA
...4		BN97-12955B	ASSY MICOM-MAIN;T-KTMDEUC,MU6100/6300,KL	1	SNA
....5		1107-002374	IC-EMMC;KLM4G1FEPD-B031,4Gbyte,BGA,153P,	1	SA
...4		BN97-12956A	ASSY MICOM;T-CON F/W KANT-M,MU6100/6300,	1	SNA
....5		1107-002339	IC-NOR FLASH;W25Q80DV,8Mbit,SOP,5.28x5.2	1	SNA
....5		BN46-00636A	S/W MICOM;KANT-M_TCON F/W	1	SNA
1		BN92-21848E	ASSY BOX;UMU6100N,65	1	SNA
.2		BH68-00662A	LABEL BOX;ALL,ART PAPER,W60,L110,WHT,NO	1	SNA
.2		BN69-16126F	BOX UNIT-OUT;65MU6100,CB,DW4,F3,L1730,W1	1	SNA
.2		BN69-16127A	BOX UNIT-IN;65MU6100,CB,DW1,C1,L2074,W51	1	SNA
1		BN92-21857A	ASSY P/MATERIAL;UMU6100N,65	1	SNA
.2		6902-002233	BAG AIR;LDPE,-,T0.2,W900,L1850,TRP,-,-,-	1	SNA
.2		6902-002695	BAG ROLL;HDPE/PE FOAM,-,T0.02,W1600,L400	2	SNA
.2		6922-000003	BAND;PP,T0.8,W18,L1650M,TRP,DA69-90145A	1	SNA
.2	T0214	AA61-20285C	HOLDER-BOX;ALL,PP,BLACK,HB,HB,17.5g	4	SNA
.2		BN02-00319B	TAPE-SINGLE FACE;OPP,T0.05,W75,L800M,CLE	2	SNA
.2		BN68-02422B	LABEL WARNING;ALL,ART PAPER,T0.05,W240,L	1	SNA
.2		BN69-03982K	PACKING ANGLE;ALL,PAPER,-,-,-,-,-,-,-	1	SNA
.2		BN69-05418M	WRAP;T0.017,500,2000000,2000000,500	0	SNA
.2		BN69-06640E	PAD-PACKING;TRUCK PAD,CB,-,,W410,L2500,,	1	SNA
.2		BN69-06642B	PAD-DP SHEET;PAD,CB,SW4,,W1500,L1100,,,	1	SNA
.2		BN69-13942Y	PALLET-WOODEN;70" KU6000,WOOD,-,W1200,L1	1	SNA
.2		BN69-15602A	CUSHION-SET FRONT;65MU8000,EPS,16.7g/l,W	1	SNA
.2		BN69-15975A	CUSHION-SET;65MU6100,EPS,16.7g/l,WHITE,W	1	SNA
.2		BN69-15978A	CUSHION-SET SIDE;65MU6100,EPS,16.7g/l,WH	2	SNA
...3		0103-005099	RESIN EPS;BASF303,Natural,Natural	1569	SNA
1	ACCE1	BN92-21859K	ASSY ACCESSORY;UMU6100N,40	1	SNA
.2	ACCE4	BN96-43186E	ASSY ACCESSORY-MANUAL;UE65MU6105KXXC	1	SNA
...3		6902-001964	BAG PE;LDPE,BIOBASED,T0.03,W200,L300,TRP	1	SNA
...3		BN68-00514K	LEAFLET-WARRANTY;comm,Samsung,W.Europe,W	1	SNA
...3		BN68-04972E	LEAFLET-REGULATORY GUIDE;ALL,SAMSUNG,W/W	1	SNA
...3		BN68-07598A	LEAFLET-FICHE;ALL,W/P,0	1	SNA

Level	Loc.	Part Code	Description & Specification	Qty.	SA/SNA
..3		BN68-07862U	LEAFLET;TV All,EUROPE,W/P,Wireless Regul	1	SNA
..3		BN68-08446B	MANUAL USERS;MU6100,XC,W/P,EURO B5	1	SNA
.2	ACCE2	BN96-43187A	ASSY ACCESSORY-CABLE;UE65MU6100KXZT	1	SNA
..3		3709-001791	CONNECTOR-CARD SLOT;64P,0.5mm,SMD-A,AU,P	1	SA
..3	T0268	3903-001118	CBF-POWER CORD;DT,EU,Angle,2P(C7),250V,2	1	SA
..3		4301-000101	BATTERY-ALKALINE;1.5V,1650mAH,LR6,14.5x5	2	SNA
..3	EC03	BN39-02189A	GENDER CABLE;DC to RCA Cable,3P,L100,UL2	1	SA
..3	EC03	BN39-02190A	GENDER CABLE;DC to RCA Cable,2P,L100,UL2	1	SA
..3	REMO2	BN59-01274A	REMOCON;2017 TV,Samsung,14KEY,3V,ZAF_RUB	1	SA
..3	T0527	BN68-00513A	LABEL-E PASS;ALL MODEL,WW,YUPO,W50,L15,W	2	SNA
..3		BN68-08112A	LABEL-SECURITY;ALL,PET,T0.05,W55,L52,GLO	1	SNA
..3		BN68-08448E	LEAFLET-ACCESSORY KIT;MU6,EUROPE,EUROPE,	1	SNA
..3		BN69-13918A	BAG ACCESSORY;LDPE,0.07,L350,W500,Transp	1	SNA
1		BN92-21875B	ASSY LABEL;UMU6100N,40	1	SNA
.2		0203-001598	TAPE-SINGLE FACE;FILAMENT,#8915,T0.15,W1	0	SNA
.2		BN68-06708G	LABEL-RATING;Monitor,WW,PP,T0.161,W93,L7	1	SNA
.2		BN68-07519B	LABEL-ENERGY;ALL JORDAN,WW,PP,T0.135,W60	1	SNA
.2		BN68-08438C	LEAFLET-QUICK SETUP GUIDE;UMU6100N,W/W,W	1	SNA
1	PANEL	BN95-02641U	PRODUCT LCD-INX;CY-GK065HGNVBV/H,KU6000,	1	SA
.2	SCREW	6001-003075	SCREW-MACHINE;BH,+,M3,L4,ZPC(WHT),SWRCH1	6	SA
.2	AS080	BN63-07229C	SHEET-PROTECTION COVER;rose70",PET,T0.05	1	SNA
.2		BN68-05722A	LABEL-E PASS;POLYPROPYLENE,NON-COATING	1	SNA
.2		BN90-09375K	ASSY BACK LIGHT UNIT;LCM	1	SNA
..3		BN02-00102B	TAPE-SINGLE FACE;FILAMENT,#8917,T0.15,W2	0	SNA
..3		BN61-11753A	DIFFUSER PLATE;15Y_J6.3K 65INCH_DIFFUSER	1	SNA
..3		BN61-12993A	SUPPORT-PLATE;Y15 LED(SAMEX ONLY),PC,V-2	20	SNA
...4		0103-005036	RESIN PC;M2407,550115,TP0003,0.8 V-0	40	SNA
...4		0103-009493	RESIN PC;LH-1070W,W92853,WT0107,V-0	40	SNA
..3		BN61-13368A	FRAME-MIDDLE TOP;65KU6300,TPV,HB,BK0008,	1	SNA
..3		BN61-13376A	FRAME-MIDDLE BOTTOM;65KU6300,TPV,HB,BK00	1	SNA
..3		BN61-13384A	FRAME-MIDDLE LEFT RIGHT;65KU6300,TPV,HB,	2	SNA
..3		BN63-13519A	OPTICAL SHEET-REFLECTOR;15Y JU7.0K 65inc	1	SNA
..3		BN63-14674A	OPTICAL SHEET-COMPLEX;15Y JU6.0K 65inch	1	SNA
..3		BN63-14938A	OPTICAL SHEET-MLS;15Y_JU6.4K_65inch_UTE2	1	SNA
..3		BN96-37658G	ASSY CHASSIS REAR P;65MU6100,EGI-SECC,IN	1	SNA
...4		0203-006897	TAPE-DOUBLE FACE;Si,T1,W10,L50,WHITE	2	SNA
...4	SCREW	6001-003075	SCREW-MACHINE;BH,+,M3,L4,ZPC(WHT),SWRCH1	1	SA
...4		BN02-00040C	TAPE DOUBLE FACE;F-LED ALL,PET,T0.3,W3,L	6	SNA
...4		BN02-00102B	TAPE-SINGLE FACE;FILAMENT,#8917,T0.15,W2	0	SNA
...4		BN02-00173C	TAPE-SINGLE FACE;PET,T0.05,W40,BLACK	0	SNA

## Exploded Views and Parts List

Level	Loc.	Part Code	Description & Specification	Qty.	SA/SNA
...4		BN02-00352E	TAPE-SINGLE FACE;PET,T0.05,W15,L50M,BLAC	0	SNA
...4		BN61-11394A	FRAME-CHASSIS REAR TOP;65JU7000,PC+GF10%	1	SNA
...4		BN61-11395A	FRAME-CHASSIS REAR BOTTOM;65JU7000,PC+GF	1	SNA
...4		BN61-11396A	FRAME-CHASSIS REAR LEFT RIGHT;65JU7000,P	2	SNA
...5		0103-010237	RESIN PC;LS-3104G/W95265,White,WT0044,V-	259	SNA
...4		BN61-11477A	HOLDER-SOURCE PCB;Y15 JU7K SDC,ABS,BLACK	8	SNA
...5		0103-004609	RESIN ABS;HF-0680U,K21294,BK0007,HB,High	8	SNA
...4		BN63-14961A	GASKET-EMI;GASKET,FABRIC,T7,W15,L25,BLAC	3	SNA
...4		BN63-17299A	INSULATOR-SMPS;58MU6100,PC,BLACK,L346,W2	1	SNA
...4	CC04	BN64-02980C	CHASSIS-REAR;65MU6100,EGI-SECC,-,T0.8,NA	1	SNA
...5	CB20	BN61-11982B	BRACKET-WALL;55KS7000,CR-SPCC,BLACK,"M8,	4	SNA
...4	T0527	BN68-00513A	LABEL-E PASS;ALL MODEL,WW,YUPO,W50,L15,W	1	SNA
...4		BN96-34712A	ASSY PCB P-LED INTERFACE BOARD;65JU6400,	1	SNA
...3		BN96-39667A	ASSY LED BAR P;65inch_KU6000_INX_L,CEM3,	8	SNA
...3		BN96-39668A	ASSY LED BAR P;65inch_KU6000_INX_R,CEM3,	8	SNA
...2		BN96-35638B	ASSY COVER P-SOURCE PCB LEFT;65KU6000,EG	1	SNA
...3		BN62-00537X	INSULATOR-SOURCE PCB COVER LEFT;Y15 JU7K	1	SNA
...3		BN63-13601B	COVER-SOURCE PCB LEFT;65KU6000,EGI-SECC,	1	SNA
...2		BN96-35639A	ASSY COVER P-SOURCE PCB RIGHT;65JU7000,E	1	SNA
...3		BN62-00537W	INSULATOR-SOURCE PCB COVER RIGHT;Y15 JU7	1	SNA
...3		BN63-13600A	COVER-SOURCE PCB RIGHT;65JU6300,EGI-SECC	1	SNA
...2		BN96-37657E	ASSY CHASSIS FRONT P;65KU6300,PC+ABS+MF1	1	SA
...3		BN02-00381J	TAPE SINGLE FACE;Y15 UHD Flat 65",CONDUCT	2	SNA
...3		BN02-00381K	TAPE SINGLE FACE;Y15 UHD Flat 65",CONDUCT	2	SNA
...3		BN60-00715A	SPACER-CONDUCTIVE;Y13 Slim F-LED,CONDUCT	2	SNA
...3		BN60-01115A	SPACER-CONDUCTIVE;Y15 JU8K,CONDUCTIVE FA	7	SNA
...3	CCM1	BN63-02183B	SHEET-PROTECTION COVER;Rhem,PE,T0.04,W15	5	SNA
...3	FD01	BN63-13309C	COVER-DECORATION BOTTOM;65JU5900,PC+ABS+	1	SNA
...3		BN63-14373E	SHEET-PROTECTION COVER;LED_JU7000,AL,T0.	5	SNA
...3	AC155	BN64-02981C	CHASSIS-FRONT;KU6000,PC+ABS+MF15%,V-1,T1	1	SNA
...2		BN96-39170A	ASSY OPEN CELL;INX,65Inch,V650DJ5-QS2,38	1	SNA
...3		BN81-12985A	A/S-IC DRIVER SOURCE;IC DRIVER SOURCE,61	1	SNA
...3		BN81-12986A	A/S-IC DRIVER GATE;IC DRIVER GATE,6101B0	1	SNA
...3		BN81-12987A	A/S-POLARIZER CF;POLARIZER CF,4101B0030B	1	SNA
...3		BN81-12988A	A/S-POLARIZER TFT;POLARIZER TFT,4101B002	1	SNA
...3		BN81-13149A	A/S-SOURCE PCB FRONT LEFT;SOURCE PCB FRO	1	SNA
...3		BN81-13150A	A/S-SOURCE PCB FRONT RIGHT;SOURCE PCB FR	1	SNA
...3		BN81-13151A	A/S-SOURCE PCB BACK LEFT;SOURCE PCB BACK	1	SNA
...3		BN81-13152A	A/S-SOURCE PCB BACK RIGHT;SOURCE PCB BAC	1	SNA