

1. Exploded View & Part List

Exploded View

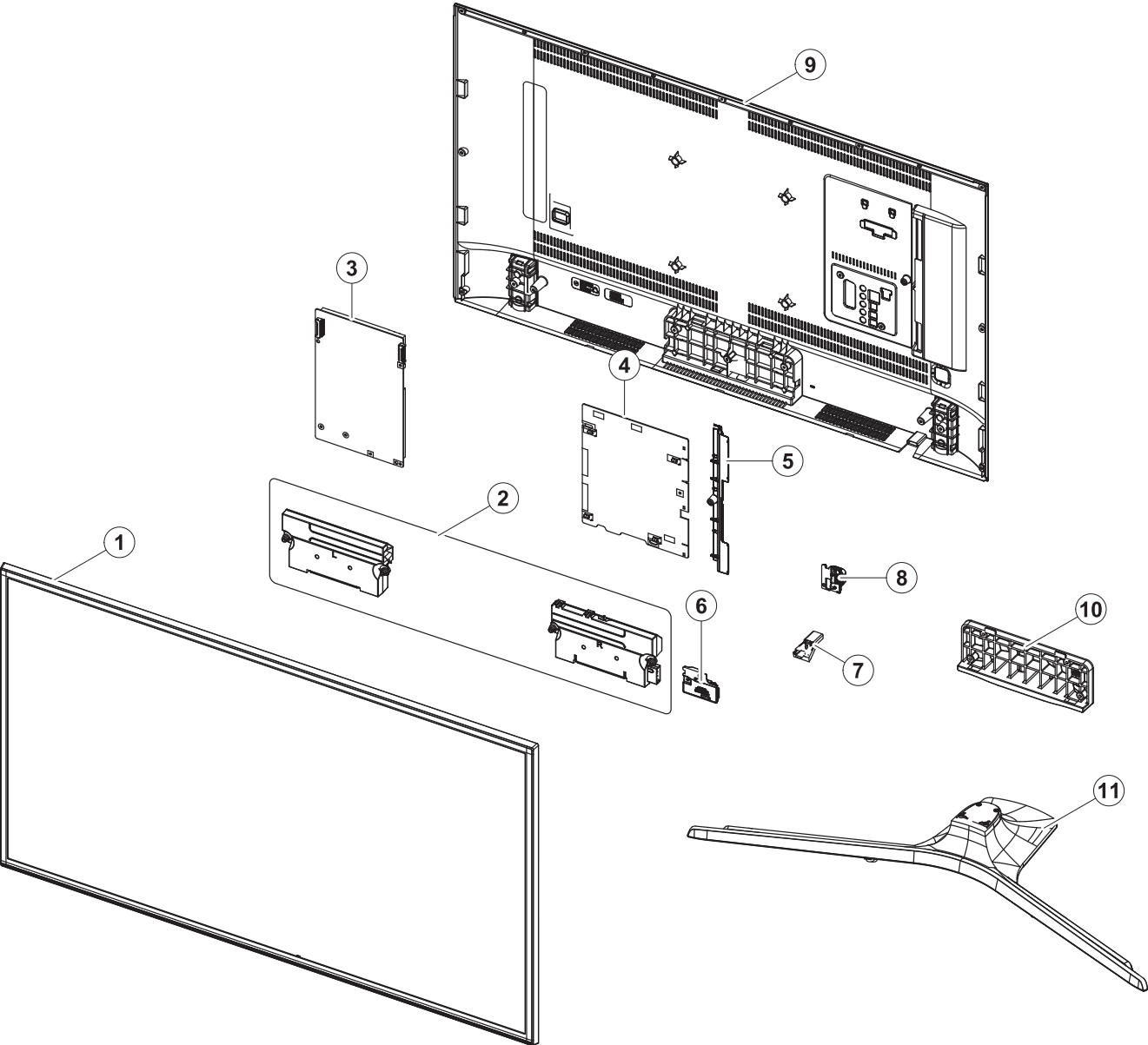

Parts List

| No. | Lvl. | Loc. | Material Code | Description & Specification | SNA | Qty. |
|-----|------|-------|---------------|--|-----|------|
| 1 | 1 | | BN95-04114A | PRODUCT LCD-BOE; CY-GM055HGEV1V/H,MU6100, | SA | 1 |
| 2 | 2 | SP01A | BN96-35006A | ASSY SPEAKER P-FRONT; TV-SPK,MU6100,6ohm, | SA | 1 |
| 3 | 2 | P001A | BN44-00807A | DC VSS-PD BOARD; L55S6_FHS,AC/DC,203W,100 | SA | 1 |
| 4 | 2 | M0014 | BN94-12195J | ASSY PCB MAIN; UMU6100N,55 | SA | 1 |
| 5 | 3 | | BN63-16652A | COVER-TERMINAL SIDE; 55MU6400,HIPS,HB,BK0 | SNA | 1 |
| 6 | 2 | | BN59-01264A | NETWORK-WLAN CLIENT; WCM730Q,78.3x29.3x7. | SA | 1 |
| 7 | 2 | | BN96-39955A | ASSY BOARD P-IR FUNCTION; KU6000,IR ASSY_ | SA | 1 |
| 8 | 2 | JOG | BN96-35345B | ASSY BOARD P-FUNCTION JOG; JU7500,CT15SE8 | SA | 1 |
| 9 | 2 | R001A | BN96-43326E | ASSY COVER P-REAR; 55MU6100,PC+ABS+GF15%, | SA | 1 |
| 10 | 3 | SG03 | BN61-11465A | GUIDE-STAND; 40J5100,PC+GF20%,V-2,BK0007, | SA | 1 |
| 11 | 2 | SB04A | BN96-38964A | ASSY STAND P-BOTTOM; J5500 48,PC+ABS+GF20 | SA | 1 |

2. Electrical Parts List

| Level | Loc. | Part Code | Description & Specification | Qty. | SA/SNA |
|-------|--------|-------------|---|------|--------|
| | | | UE55MU6100WXXN (BA03) | | |
| 1 | S001A | BN90-06671C | ASSY STAND;UJ5000,50" | 1 | SNA |
| ..2 | SG01A | BN96-35223A | ASSY GUIDE P-STAND;J5500 40",PC+GF20%,BL | 1 | SA |
| ..3 | | 0203-001499 | TAPE-OPP;OPP,T0.04,W15,N/A,CLEAR,ROLL | 0 | SNA |
| ..3 | SG03 | BN61-11465A | GUIDE-STAND;40J5100,PC+GF20%,V-2,BK0007, | 1 | SA |
| ...4 | | 0103-007285 | RESIN PC;HF3200H,K21294,BK0007,V-2,GF20% | 330 | SNA |
| ..3 | | BN96-35528A | ASSY ACCESSORY-SCREW;JU7500,40 | 1 | SNA |
| ...4 | | 6902-002474 | BAG SCREW;LDPE,T0.05*,W70,L90,TRP,RECYCL | 1 | SNA |
| ..4 | HOLDER | BN61-09494D | HOLDER-BOLT;KU6500,SWRCH18A,BLACK,B TYPE | 8 | SA |
| ..2 | SB04A | BN96-38964A | ASSY STAND P-BOTTOM;J5500 48,PC+ABS+GF20 | 1 | SA |
| ..3 | SCREW | 6003-001001 | SCREW-TAPTTYPE;FH,+,-,B,M3,L8,ZPC(BLK),SW | 2 | SA |
| ..3 | SCREW | 6003-001239 | SCREW-TAPTTYPE;FH,+,-,B,M4,L10,ZPC(WHT),SWR | 4 | SA |
| ..3 | SCREW | 6003-001315 | SCREW-TAPTTYPE;BH,+,-,B,M4,L20,ZPC(WHT),SWR | 4 | SNA |
| ..3 | | BN61-07463B | TAPE-DOUBLE FACE;ACRYL,T0.25,W7,CLEAR | 0 | SNA |
| ..3 | | BN61-11431B | BRACKET-STAND BODY;Y15 F-LED J5100/5500 | 1 | SNA |
| ..3 | | BN61-13134A | BRACKET-STAND BOTTOM;48J5500,HGI,T2 | 1 | SNA |
| ..3 | AS080 | BN63-04755H | SHEET-PROTECTION COVER;52LC530,PE,T0.05, | 1 | SNA |
| ..3 | AS080 | BN63-04755L | SHEET-PROTECTION COVER;22LC350,PE,T0.05, | 1 | SNA |
| ..3 | | BN63-13128E | SHEET-PROTECTION COVER;LED,AL,T0.05,W13, | 1 | SNA |
| ..3 | | BN63-13259E | COVER-STAND TOP;55J5500,PC+ABS+GF20%,V-1 | 1 | SNA |
| ...4 | | 0103-009946 | RESIN PC ABS;HM-1200,BLACK,BK0007,V-1,GF | 360 | SNA |
| ...4 | | BN68-00513D | LABEL-RESIN;resin,-,ART,-,W10,L25,-,-,-, | 1 | SNA |
| ..3 | RF01 | BN67-00327M | FOOT-RUBBER;STAND,Si,GRAY,W10,L10,T1.5 | 2 | SNA |
| ..3 | RF01 | BN67-00398P | FOOT-RUBBER;UH6K,Si,GRAY,W8,L15.5,T2.5 | 5 | SNA |
| ..3 | | BN95-02141A | ASSY COVER STAND SMT;J5500 STAND,48",Sil | 1 | SA |
| ...4 | | 0203-007002 | TAPE-SINGLE FACE;OPP,T0.06,W75,L66M,CLEA | 0 | SNA |
| ...4 | | 0204-007674 | COATING;UVICHEM CVM93000(VOC) MATT(5),CL | 0 | SNA |
| ..4 | | AA69-07323C | PACKING-SHEET SMT;HDPE,PE FOAM,T0.015,T1 | 1 | SNA |
| ...4 | | AA69-07325Q | PAD-DP SHEET;CTV,CB,DW,W860,L520,YELLOW | 1 | SNA |
| ...4 | | AA69-07416E | MASTER BOX-DP;CB,DW,W325,H550 | 1 | SNA |
| ...4 | | AA69-07495D | PAD-DP SHEET;CTV,CB,DW5,W860,L320,YELLOW | 1 | SNA |
| ...4 | | AA69-07509A | PAD-DP BOTTOM EPP;CTV,CB,W859,L520 | 1 | SNA |
| ...4 | | BN01-00337A | TARGET-ALUMINIUM CY;Al,99.9%,1924mm, 132 | 0 | SNA |
| ...4 | | BN01-00340A | TARGET-CHROMIUM CY;Cr,99.5%,1924mm, 132d | 0 | SNA |
| ...4 | | BN63-13263A | COVER-STAND DECORATION;48J5100,PC+ABS,V- | 1 | SNA |
|5 | | 0103-005041 | RESIN PC ABS;FR3200TV,901408,BK0008,1.2m | 85 | SNA |
|5 | AS080 | BN63-07556C | SHEET-PROTECTION COVER;TOC,PO,T0.068,W50 | 1 | SNA |
| ...4 | | BN68-03920A | LABEL BOX;ALL,ART PAPER,W100,L75,W/W,100 | 1 | SNA |

Exploded Views and Parts List

| Level | Loc. | Part Code | Description & Specification | Qty. | SA/SNA |
|-------|-------|-------------|--|------|--------|
| ...3 | T0382 | BP61-00495C | TAPE SINGLE FACE;ACRYL,PJT,ACRYL FOAM,T0 | 0 | SNA |
| 1 | R001A | BN90-09060E | ASSY COVER REAR;UMU6100N,55 | 1 | SNA |
| .2 | SCREW | 6001-003074 | SCREW-MACHINE;BH,+,M3,L6,ZPC(BLK),SWRCH1 | 18 | SA |
| .2 | R001A | BN96-43326E | ASSY COVER P-REAR;55MU6100,PC+ABS+GF15%, | 1 | SA |
| ...3 | R001 | BN63-15584A | COVER-REAR;55KU6000,PC+ABS+GF15%,MOLD,V- | 1 | SNA |
| ...4 | | 0103-010275 | RESIN PC ABS;235GNH15/6919H,Black,BK0007 | 3500 | SNA |
| ...3 | | BN64-03903A | INLAY-TERMINAL SIDE;55MU6100,PET,T0.125, | 1 | SNA |
| ...3 | | BN68-03518R | LABEL-STICKER CI SLOT;55KU6000,PET,T0.12 | 1 | SNA |
| ...3 | | BN68-05603A | LABEL-E PASS;ART PAPER 90G,W/W | 3 | SNA |
| 1 | | BN90-09071D | ASSY W/I;UMU6100N | 1 | SNA |
| .2 | | BN81-08159Z | A/S PART SET-ELEC W/I;LED TV ELEC spec-C | 1 | SNA |
| .2 | | BN81-15300D | A/S PART SET-MECH W/I;UMU6100N,U55MN* | 1 | SNA |
| 1 | | BN91-18920A | ASSY SHIELD;UMU6100N,55 | 1 | SNA |
| .2 | SCREW | 6001-003081 | SCREW-MACHINE;PWH,+,M3,L5,ZPC(WHT),SWRCH | 5 | SA |
| .2 | | BN02-00102B | TAPE-SINGLE FACE;FILAMENT,#8917,T0.15,W2 | 0 | SNA |
| .2 | 12P | BN39-02025A | LEAD CONNECTOR-POWER;UN40JU6400AFXZA,UL2 | 1 | SA |
| .2 | 16P | BN39-02030F | LEAD CONNECTOR-BLU;BLU(75JU6400),UL21016 | 1 | SNA |
| .2 | | BN39-02219A | LEAD CONNECTOR-SUB ASSY;55KU6500,UL21016 | 1 | SA |
| .2 | | BN39-02220C | LEAD CONNECTOR-SUB ASSY;55KU6300,UL21016 | 1 | SA |
| .2 | P001A | BN44-00807A | DC VSS-PD BOARD;L55S6_FHS,AC/DC,203W,100 | 1 | SA |
| .2 | | BN59-01264A | NETWORK-WLAN CLIENT;WCM730Q,78.3x29.3x7. | 1 | SA |
| .2 | | BN61-09637A | HOLDER-WIFI;KU6000,ABS,BK0007,HB | 1 | SA |
| .2 | SP01A | BN96-35006A | ASSY SPEAKER P-FRONT;TV-SPK,MU6100,6ohm, | 1 | SA |
| .2 | JOG | BN96-35345B | ASSY BOARD P-FUNCTION JOG;JU7500,CT15SE8 | 1 | SA |
| ...3 | AH240 | BN61-11584A | HOLDER-BUTTON;JU7500,ABS,BK0007,HB | 1 | SNA |
| ...3 | AH297 | BN63-11231B | HOLDER-KNOB;HU7000,ABS,BLACK,HB | 1 | SNA |
| ...3 | FK04 | BN64-02406B | BUTTON-FUNCTION;LED_HU7000,ABS,HB,BLACK, | 1 | SNA |
| ...4 | | 0103-004609 | RESIN ABS;HF-0680U,K21294,BK0007,HB,High | 8 | SNA |
| .2 | | BN96-39820D | FFC CABLE;55KS7500,Fold,L500,96P | 1 | SA |
| .2 | | BN96-39903A | FFC CABLE;60KU6000,Fold,L650,96P | 1 | SA |
| .2 | | BN96-39955A | ASSY BOARD P-IR FUNCTION;KU6000,IR ASSY_ | 1 | SA |
| 1 | M0017 | BN91-19030J | ASSY CHASSIS;UMU6100N,55 | 1 | SNA |
| .2 | M0014 | BN94-12195J | ASSY PCB MAIN;UMU6100N,55 | 1 | SA |
| ...3 | | BN62-00834A | HEAT SINK-PS;KANT_M heatsink,A1050,T1.5, | 1 | SNA |
| ...3 | | BN63-16652A | COVER-TERMINAL SIDE;55MU6400,HIPS,HB,BK0 | 1 | SNA |
| ...3 | | BN97-12859A | ASSY DRM;Kant_M,DVB,NagSam, MAC, HDCP, C | 1 | SNA |
| ...4 | | BN46-00109H | KEY CODE-CERTIFICATION;MAC,TV/AV,General | 1 | SNA |
| ...4 | | BN46-00110P | KEY CODE-CERTIFICATION;MIRACAST(HDCP2.2) | 1 | SNA |
| ...4 | | BN46-00601A | KEY CODE-CERTIFICATION;KANT-M,CI PLUS,Sa | 1 | SNA |
| ...4 | | BN46-00604A | KEY CODE-CERTIFICATION;KANT-M,Nagra CSC | 1 | SNA |

| Level | Loc. | Part Code | Description & Specification | Qty. | SA/SNA |
|-------|-------|-------------|--|------|--------|
| ..3 | | BN97-12957F | ASSY MICOM;TCON DATA_55BOE_F,MU6100 | 1 | SNA |
| ...4 | | BN46-00666A | S/W MICOM;M55B6U0F,55B6AU0VM,55BOE_F | 1 | SNA |
| ..3 | | BN97-12961T | ASSY SMD;UMU6100N,55 | 1 | SNA |
| ...4 | | 0202-001899 | SOLDER-CREAM;M705-GRN360-K2-VT,20-38um,S | 5 | SNA |
| ...4 | DS01A | 0401-001056 | DIODE-SWITCHING;MMBD4148SE,100V,200mA,SO | 1 | SA |
| ...4 | | 0403-001783 | DIODE-ZENER;BZB84-C6V2,5.8~6.6V,300mW,SO | 3 | SNA |
| ...4 | | 0403-001831 | DIODE-ZENER;KDZ12B,12~13.5V,1000mW,SOD-1 | 1 | SA |
| ...4 | | 0403-002014 | DIODE-ZENER;KDZ16B,16.2~18.3V,1000mW,SOD | 1 | SNA |
| ...4 | | 0404-001307 | DIODE-SCHOTTKY;SSC54,40V,5000mA,DO-214AB | 1 | SA |
| ...4 | | 0404-001404 | DIODE-SCHOTTKY;BAT721C,40V,200mA,SOT-23, | 2 | SA |
| ...4 | | 0404-001640 | DIODE-SCHOTTKY;SS1060HEWS,60V,1000mA,SOD | 2 | SA |
| ...4 | | 0404-001881 | DIODE-SCHOTTKY;SS3040-HE,40V,3000mA,SOD- | 1 | SA |
| ...4 | | 0404-001953 | DIODE-SCHOTTKY;MBRA340F-HAF,40V,3000mA,S | 3 | SA |
| ...4 | | 0406-001200 | DIODE-TVS;RClamp0504F,6V,1MAV,TP | 5 | SA |
| ...4 | | 0406-001635 | DIODE-TVS;SMF5.0A,6.4V,6.7V,7V,200MAV,20 | 1 | SA |
| ...4 | | 0406-001718 | DIODE-TVS;SMF36A,40V,44.2V,3.8MAV,1.25VP | 1 | SA |
| ...4 | | 0406-001778 | DIODE-TVS;PUSB3FR4,6V,9V,0.2MAV,0.7VPA,0 | 1 | SA |
| ...4 | | 0406-001786 | DIODE-TVS;PJEC5V0V6TM,5V,7V,8V,0.1MAV,9V | 1 | SA |
| ...4 | | 0501-000445 | TR-SMALL SIGNAL;KTC3875S-Y,NPN,150mW,SOT | 4 | SC |
| ...4 | | 0504-000126 | TR-DIGITAL;KSR1101,NPN,200mW,4.7K/4.7K,S | 1 | SA |
| ...4 | | 0505-001844 | FET-SILICON;SI4435DDY-T1-GE3,P,30V,-11.4 | 1 | SA |
| ...4 | | 0505-002560 | FET-SILICON;AO6415,P,20V,-3.3A,0.15ohm,1 | 1 | SA |
| ...4 | | 0505-002598 | FET-SILICON;AP2317GN,P,20V,-4.2A,0.052oh | 1 | SA |
| ...4 | | 0505-002660 | FET-SILICON;Si2308BDS,N,60V,2.3A,0.156oh | 1 | SA |
| ...4 | | 0505-002893 | FET-SILICON;AO4801AS,P,30V,-5A,2W,SOIC-8 | 1 | SA |
| ...4 | | 0505-003205 | FET-SILICON;DMG4435SSS-13,P,30V,-7.3A,1. | 1 | SA |
| ...4 | | 0505-003391 | FET-SILICON;AOD2922,N,100V,8A,140Mohm,18 | 1 | SA |
| ...4 | | 0505-003397 | FET-SILICON;2N7002K,N,60V,0.38A,1.19ohm, | 1 | SA |
| ...4 | | 0505-003507 | FET-SILICON;AO3424,N,30V,3.8A,1.4W,SOT-2 | 7 | SA |
| ...4 | | 0801-003603 | IC-CMOS LOGIC;MC74LCX244MN2TWG,Octal buf | 1 | SA |
| ...4 | | 1001-001998 | IC-ANALOG MULTIPLEX;NX3DV221GM,USB switc | 1 | SA |
| ...4 | | 1003-002878 | IC-LEVEL DRIVER;VLS1RO,QFN,46P,4.5x6.5x1 | 1 | SA |
| ...4 | | 1103-001564 | IC-EEPROM;S-24C512CI-J800,512Kbit,64Kx8, | 1 | SA |
| ...4 | | 1105-002704 | IC-DDR4 SDRAM;K4F8E304HB-MGCH,LPDDR4-SDR | 2 | SA |
| ...4 | | 1201-000166 | IC-OP AMP;LM358,SOP,ST,8P,150MIL,DUAL,10 | 1 | SA |
| ...4 | | 1201-004117 | IC-AUDIO AMP;TAS5749M,QFP,48P,7x7x1mm,DU | 1 | SA |
| ...4 | | 1203-004363 | IC-VOL. DETECTOR;SOT-23,3Z30,2.9x1.6mm,P | 1 | SA |
| ...4 | | 1203-008082 | IC-DC/DC CONVERTER;TPS54627DDAR,SOP 8P,8 | 1 | SA |
| ...4 | | 1203-008104 | IC-POSI.FIXED REG.;S-13A1D18-E800,HSOP,8 | 1 | SNA |
| ...4 | | 1203-008105 | IC-POSI.FIXED REG.;S-13A1D33-E800,HSOP,8 | 1 | SNA |

Exploded Views and Parts List

| Level | Loc. | Part Code | Description & Specification | Qty. | SA/SNA |
|-------|------|-------------|--|------|--------|
| ...4 | | 1203-008392 | IC-VOL. DETECTOR;S-6414AAB-L800X,TSOT-23 | 1 | SA |
| ...4 | | 1203-008777 | IC-DC/DC CONVERTER;TPS563201,SOT-23,6,1. | 4 | SNA |
| ...4 | | 1203-008880 | IC-DC/DC CONVERTER;VPM1RO,QFN,68P,8x8x1m | 1 | SA |
| ...4 | | 1203-008917 | IC-DC/DC CONVERTER;G5334CQT1U,QFN4,23P,4 | 1 | SA |
| ...4 | | 1203-008919 | IC-DC/DC CONVERTER;SYD104AADC,TSOT23,6P, | 1 | SNA |
| ...4 | | 1203-008921 | IC-DC/DC CONVERTER;SYU236ARAC,QFN,20P,3x | 1 | SNA |
| ...4 | | 1203-008933 | IC-POSL.ADJUST REG.;G942F11U,SOP,8P,4.9x | 1 | SA |
| ...4 | | 1204-003714 | IC-DECODER;SDP1601,FCPBGA,1147P,31x31x2. | 1 | SA |
| ...4 | | 1205-005519 | IC-SWITCH;ET20163,SOT23-5,5P,2.95x3.02mm | 3 | SA |
| ...4 | | 1205-005537 | IC-REPEATER;TCA9517,VSSOP,8P,3.00x3.00mm | 3 | SA |
| ...4 | | 1205-005749 | IC-SWITCH;G2897KD1U,TDFN2X3-14,14P,2x3mm | 2 | SA |
| ...4 | | 1404-001731 | THERMISTOR-NTC;33Kohm,4050K,1mW/C,TP,1.6 | 1 | SNA |
| ...4 | | 1405-001232 | VARISTOR;6.4V,5.6VDC,30A,1608,TP,19V,200 | 7 | SNA |
| ...4 | | 1405-001271 | VARISTOR;35V,20VDC,5A,1005,TP,100V,10pF | 25 | SA |
| ...4 | | 1405-001381 | VARISTOR;11V,8VDC,30A,1608,TP,25V,500pF | 3 | SA |
| ...4 | | 1405-001382 | VARISTOR;24.5V,16VDC,120A,2012,TP,42V,40 | 1 | SA |
| ...4 | | 2007-000039 | R-CHIP;0ohm,1%,1/10W,TP,1608 | 4 | SA |
| ...4 | | 2007-000052 | R-CHIP;10Kohm,1%,1/10W,TP,1608 | 1 | SA |
| ...4 | | 2007-000066 | R-CHIP;20Kohm,1%,1/10W,TP,1608 | 1 | SNA |
| ...4 | | 2007-000070 | R-CHIP;0ohm,5%,1/10W,TP,1608 | 22 | SA |
| ...4 | | 2007-000137 | R-CHIP;2Kohm,5%,1/16W,TP,1005 | 4 | SNA |
| ...4 | | 2007-000138 | R-CHIP;100ohm,5%,1/16W,TP,1005 | 1 | SA |
| ...4 | | 2007-000143 | R-CHIP;4.7Kohm,5%,1/16W,TP,1005 | 10 | SNA |
| ...4 | | 2007-000146 | R-CHIP;6.8Kohm,5%,1/16W,TP,1005 | 1 | SNA |
| ...4 | | 2007-000148 | R-CHIP;10Kohm,5%,1/16W,TP,1005 | 3 | SA |
| ...4 | | 2007-000170 | R-CHIP;1Mohm,5%,1/16W,TP,1005 | 1 | SNA |
| ...4 | | 2007-000171 | R-CHIP;0ohm,5%,1/16W,TP,1005 | 18 | SNA |
| ...4 | | 2007-000683 | R-CHIP;3.3Kohm,1%,1/10W,TP,1608 | 1 | SA |
| ...4 | | 2007-000772 | R-CHIP;33Kohm,1%,1/10W,TP,1608 | 1 | SA |
| ...4 | | 2007-000779 | R-CHIP;33ohm,1%,1/10W,TP,1608 | 2 | SA |
| ...4 | | 2007-000932 | R-CHIP;470ohm,5%,1/16W,TP,1005 | 3 | SNA |
| ...4 | | 2007-000979 | R-CHIP;5.6Kohm,1%,1/10W,TP,1608 | 1 | SA |
| ...4 | | 2007-001125 | R-CHIP;68Kohm,1%,1/10W,TP,1608 | 2 | SA |
| ...4 | | 2007-001288 | R-CHIP;18ohm,5%,1/16W,TP,1005 | 4 | SA |
| ...4 | | 2007-001292 | R-CHIP;33ohm,5%,1/16W,TP,1005 | 27 | SNA |
| ...4 | | 2007-001298 | R-CHIP;51ohm,5%,1/16W,TP,1005 | 13 | SNA |
| ...4 | | 2007-002899 | R-CHIP;10ohm,1%,1/10W,TP,1608 | 20 | SA |
| ...4 | | 2007-002906 | R-CHIP;200Kohm,1%,1/10W,TP,1608 | 1 | SA |
| ...4 | | 2007-007107 | R-CHIP;100Kohm,1%,1/16W,TP,1005 | 13 | SNA |
| ...4 | | 2007-007131 | R-CHIP;13Kohm,1%,1/16W,TP,1005 | 6 | SA |

| Level | Loc. | Part Code | Description & Specification | Qty. | SA/SNA |
|-------|------|-------------|--|------|--------|
| ...4 | | 2007-007132 | R-CHIP;15Kohm,1%,1/16W,TP,1005 | 3 | SA |
| ...4 | | 2007-007136 | R-CHIP;4.7Kohm,1%,1/16W,TP,1005 | 67 | SNA |
| ...4 | | 2007-007137 | R-CHIP;1.2Kohm,1%,1/16W,TP,1005 | 2 | SA |
| ...4 | | 2007-007138 | R-CHIP;27Kohm,1%,1/16W,TP,1005 | 2 | SNA |
| ...4 | | 2007-007139 | R-CHIP;47Kohm,1%,1/16W,TP,1005,T0.35 | 10 | SA |
| ...4 | | 2007-007142 | R-CHIP;10Kohm,1%,1/16W,TP,1005 | 34 | SNA |
| ...4 | | 2007-007305 | R-CHIP;120ohm,1%,1/16W,TP,1005 | 1 | SNA |
| ...4 | | 2007-007306 | R-CHIP;100ohm,1%,1/16W,TP,1005 | 14 | SNA |
| ...4 | | 2007-007308 | R-CHIP;33Kohm,1%,1/16W,TP,1005 | 3 | SA |
| ...4 | | 2007-007309 | R-CHIP;12Kohm,1%,1/16W,TP,1005,T0.35 | 1 | SA |
| ...4 | | 2007-007310 | R-CHIP;8.2Kohm,1%,1/16W,TP,1005 | 5 | SA |
| ...4 | | 2007-007311 | R-CHIP;22Kohm,1%,1/16W,TP,1005 | 1 | SA |
| ...4 | | 2007-007312 | R-CHIP;20Kohm,1%,1/16W,TP,1005 | 16 | SA |
| ...4 | | 2007-007313 | R-CHIP;6.8Kohm,1%,1/16W,TP,1005 | 6 | SA |
| ...4 | | 2007-007315 | R-CHIP;3.9Kohm,1%,1/16W,TP,1005 | 1 | SNA |
| ...4 | | 2007-007317 | R-CHIP;2.2Kohm,1%,1/16W,TP,1005 | 2 | SA |
| ...4 | | 2007-007318 | R-CHIP;1Kohm,1%,1/16W,TP,1005 | 13 | SNA |
| ...4 | | 2007-007334 | R-CHIP;200Kohm,1%,1/16W,TP,1005 | 6 | SNA |
| ...4 | | 2007-007488 | R-CHIP;75Kohm,1%,1/16W,TP,1005 | 1 | SNA |
| ...4 | | 2007-007517 | R-CHIP;240ohm,1%,1/16W,TP,1005 | 5 | SNA |
| ...4 | | 2007-007520 | R-CHIP;20ohm,1%,1/10W,TP,1608 | 1 | SA |
| ...4 | | 2007-007528 | R-CHIP;1.5Kohm,1%,1/16W,TP,1005 | 5 | SA |
| ...4 | | 2007-007588 | R-CHIP;1.8Kohm,1%,1/16W,TP,1005 | 1 | SA |
| ...4 | | 2007-007697 | R-CHIP;2.4Kohm,1%,1/16W,TP,1005 | 1 | SNA |
| ...4 | | 2007-007736 | R-CHIP;510Kohm,1%,1/10W,TP,1608 | 1 | SA |
| ...4 | | 2007-007766 | R-CHIP;2Kohm,1%,1/16W,TP,1005 | 21 | SNA |
| ...4 | | 2007-007767 | R-CHIP;200ohm,1%,1/16W,TP,1005 | 4 | SA |
| ...4 | | 2007-007798 | R-CHIP;10ohm,1%,1/16W,TP,1005 | 6 | SA |
| ...4 | | 2007-008015 | R-CHIP;75ohm,1%,1/16W,TP,1005 | 7 | SNA |
| ...4 | | 2007-008294 | R-CHIP;33ohm,1%,1/16W,TP,1005 | 4 | SA |
| ...4 | | 2007-008298 | R-CHIP;49.9ohm,1%,1/16W,TP,1005 | 5 | SA |
| ...4 | | 2007-008596 | R-CHIP;0.1ohm,1%,1/4W,TP,3216 | 3 | SC |
| ...4 | | 2007-009322 | R-CHIP;1.3Kohm,1%,1/16W,TP,1005 | 5 | SA |
| ...4 | | 2007-009777 | R-CHIP;4.99Kohm,1%,1/16W,TP,1005 | 1 | SA |
| ...4 | | 2011-001261 | R-NETWORK;33ohm,5%,1/16W,L,CHIP,8P,TP,2. | 6 | SA |
| ...4 | | 2011-001264 | R-NETWORK;10ohm,5%,1/16W,L,CHIP,8P,TP,2. | 17 | SNA |
| ...4 | | 2011-001344 | R-NETWORK;100ohm,5%,1/16W,L,CHIP,8P,TP,2 | 9 | SA |
| ...4 | | 2011-001448 | R-NETWORK;10ohm,5%,1/16W,L,4P,TP,1.0x1.0 | 1 | SA |
| ...4 | | 2011-001506 | R-NETWORK;10Kohm,5%,1/16W,L,CHIP,4P,TP,1 | 1 | SNA |
| ...4 | | 2011-001527 | R-NETWORK;4.7Kohm,5%,1/16W,L,CHIP,4P,TP, | 4 | SNA |

Exploded Views and Parts List

| Level | Loc. | Part Code | Description & Specification | Qty. | SA/SNA |
|-------|-------|-------------|--|------|--------|
| ...4 | | 2011-001586 | R-NETWORK;1Kohm,5%,1/16W,L,CHIP,4P,TP,1. | 2 | SNA |
| ...4 | | 2011-001587 | R-NETWORK;100ohm,5%,1/16W,L,CHIP,4P,TP,1 | 3 | SNA |
| ...4 | AD480 | 2203-000233 | C-CER,CHIP;0.1nF,5%,50V,C0G,TP,1005 | 4 | SA |
| ...4 | AD480 | 2203-000278 | C-CER,CHIP;0.01nF,0.5pF,50V,C0G,TP,1005 | 6 | SA |
| ...4 | AD480 | 2203-000359 | C-CER,CHIP;0.15nF,5%,50V,C0G,TP,1005,T0. | 3 | SNA |
| ...4 | AD480 | 2203-000425 | C-CER,CHIP;0.018nF,5%,50V,C0G,TP,1005 | 2 | SA |
| ...4 | AD480 | 2203-000438 | C-CER,CHIP;1nF,10%,50V,X7R,TP,1005 | 8 | SA |
| ...4 | AD480 | 2203-000489 | C-CER,CHIP;2.2nF,10%,50V,X7R,TP,1005 | 2 | SA |
| ...4 | AD480 | 2203-000585 | C-CER,CHIP;0.22nF,10%,50V,X7R,TP,1005 | 4 | SA |
| ...4 | AD480 | 2203-000812 | C-CER,CHIP;0.033nF,5%,50V,C0G,TP,1005 | 3 | SA |
| ...4 | AD480 | 2203-000940 | C-CER,CHIP;0.47nF,10%,50V,X7R,TP,1005 | 4 | SA |
| ...4 | AD480 | 2203-001072 | C-CER,CHIP;0.056nF,5%,50V,C0G,TP,1005 | 1 | SA |
| ...4 | AD480 | 2203-001851 | C-CER,CHIP;0.016nF,5%,50V,C0G,TP,1608 | 1 | SNA |
| ...4 | AD480 | 2203-002285 | C-CER,CHIP;10nF,10%,50V,X7R,TP,1005 | 8 | SNA |
| ...4 | AD480 | 2203-002525 | C-CER,CHIP;0.56nF,10%,50V,X7R,TP,1005 | 1 | SNA |
| ...4 | AD480 | 2203-002720 | C-CER,CHIP;10nF,10%,25V,X7R,TP,1005,T0.5 | 1 | SNA |
| ...4 | AD480 | 2203-005057 | C-CER,CHIP;0.0082nF,0.25pF,50V,C0G,TP,10 | 2 | SA |
| ...4 | AD480 | 2203-005083 | C-CER,CHIP;220nF,10%,50V,X7R,TP,1608,T0. | 6 | SA |
| ...4 | AD480 | 2203-005249 | C-CER,CHIP;100nF,10%,50V,X7R,TP,1608 | 5 | SNA |
| ...4 | AD480 | 2203-005642 | C-CER,CHIP;0.22nF,5%,50V,C0G,TP,1005 | 2 | SNA |
| ...4 | AD480 | 2203-005968 | C-CER,CHIP;4.7nF,10%,50V,X7R,TP,1005,T0. | 2 | SNA |
| ...4 | AD480 | 2203-005993 | C-CER,CHIP;68nF,10%,16V,X7R,1005 | 1 | SA |
| ...4 | AD480 | 2203-006048 | C-CER,CHIP;100nF,10%,10V,X7R,TP,1005 | 1 | SA |
| ...4 | AD480 | 2203-006126 | C-CER,CHIP;47nF,10%,16V,X7R,TP,1005 | 3 | SNA |
| ...4 | AD480 | 2203-006158 | C-CER,CHIP;100nF,10%,16V,X7R,TP,1005,T0. | 219 | SNA |
| ...4 | AD480 | 2203-006324 | C-CER,CHIP;2200nF,10%,10V,X5R,TP,1608 | 15 | SA |
| ...4 | AD480 | 2203-006348 | C-CER,CHIP;1000nF,10%,25V,X5R,TP,1608,T0 | 1 | SA |
| ...4 | AD480 | 2203-006562 | C-CER,CHIP;1000nF,10%,10V,X5R,TP,1005 | 19 | SNA |
| ...4 | AD480 | 2203-006636 | C-CER,CHIP;220nF,10%,25V,X7R,TP,1608 | 1 | SA |
| ...4 | AD480 | 2203-006698 | C-CER,CHIP;1000nF,10%,25V,X7R,TP,1608,T0 | 11 | SNA |
| ...4 | AD480 | 2203-006824 | C-CER,CHIP;4700nF,10%,10V,X5R,TP,1608 | 4 | SNA |
| ...4 | AD480 | 2203-006838 | C-CER,CHIP;2200nF,10%,6.3V,X5R,TP,1005 | 3 | SA |
| ...4 | AD480 | 2203-006841 | C-CER,CHIP;1000nF,10%,16V,X5R,TP,1005 | 1 | SNA |
| ...4 | AD480 | 2203-006844 | C-CER,CHIP;470nF,10%,10V,X5R,TP,1005 | 2 | SA |
| ...4 | AD480 | 2203-006890 | C-CER,CHIP;10000nF,20%,6.3V,X5R,TP,1608 | 66 | SNA |
| ...4 | AD480 | 2203-007176 | C-CER,CHIP;10000nF,10%,16V,X5R,TP,2012,1 | 11 | SNA |
| ...4 | AD480 | 2203-007240 | C-CER,CHIP;22000nF,20%,6.3V,X5R,TP,1810, | 63 | SA |
| ...4 | AD480 | 2203-007269 | C-CER,CHIP;22000nF,20%,10V,X5R,TP,2012(2 | 19 | SA |
| ...4 | AD480 | 2203-007270 | C-CER,CHIP;10000nF,10%,10V,X5R,TP,1608,T | 10 | SNA |
| ...4 | AD480 | 2203-007306 | C-CER,CHIP;10000nF,10%,25V,X5R,TP,2012,1 | 33 | SNA |

| Level | Loc. | Part Code | Description & Specification | Qty. | SA/SNA |
|-------|-------|-------------|--|------|--------|
| ...4 | AD480 | 2203-007423 | C-CER,CHIP;10000nF,10%,35V,X7R,TP,3216 | 4 | SA |
| ...4 | AD480 | 2203-007486 | C-CER,CHIP;1000nF,10%,50V,X5R,TP,1608 | 2 | SNA |
| ...4 | AD480 | 2203-007544 | C-CER,CHIP;100nF,10%,50V,X7R,TP,1005,T0. | 14 | SA |
| ...4 | AD480 | 2203-008096 | C-CER,CHIP;2200nF,10%,50V,X5R,TP,2012,1. | 1 | SA |
| ...4 | AD480 | 2203-008315 | C-CER,CHIP;22000nF,20%,25V,X5R,TP,2012,T | 6 | SA |
| ...4 | AD480 | 2203-008412 | C-CER,CHIP;4700nF,10%,50V,X5R,TP,2012,1. | 2 | SNA |
| ...4 | | 2402-001268 | C-AL,SMD;100uF,20%,25V,WT,TP,8x6.3mm | 1 | SA |
| ...4 | | 2409-001240 | C-ORGANIC,SMD;33uF,20%,25V,LR,TP,7343(1. | 1 | SA |
| ...4 | | 2703-000213 | INDUCTOR-SMD;470nH,10%,1.35Ohm,35mA,15,M | 1 | SA |
| ...4 | | 2703-002269 | INDUCTOR-SMD;56nH,5%,1005,T0.5,1.4Ohm,15 | 3 | SA |
| ...4 | | 2703-003747 | INDUCTOR-SMD;22uH,20%,6060,0.135ohm,1300 | 2 | SA |
| ...4 | | 2703-003754 | INDUCTOR-SMD;1uH,20%,1608,T0.8,0.24Ohm,9 | 1 | SNA |
| ...4 | | 2703-003862 | INDUCTOR-SMD;10uH,20%,6060,0.065ohm,1900 | 4 | SA |
| ...4 | | 2703-003937 | INDUCTOR-SMD;1uH,20%,70647,T3,0.008Ohm,1 | 1 | SA |
| ...4 | | 2703-004630 | INDUCTOR-SMD;2.2uH,20%,7070,T5,0.0025Ohm | 2 | SNA |
| ...4 | | 2703-004724 | INDUCTOR-SMD;8.2uH,20%,5050,T4,0.072Ohm, | 4 | SA |
| ...4 | | 2703-005191 | INDUCTOR-SMD;1.5uH,20%,6060,T4.5,0.02Ohm | 5 | SA |
| ...4 | | 2703-005376 | INDUCTOR-SMD;10uH,20%,10.7x10mm,T3.8,0,0 | 1 | SA |
| ...4 | | 2801-004021 | CRYSTAL-SMD;24.576MHz,20ppm,28-AAN,12pF, | 2 | SA |
| ...4 | | 3301-002039 | BEAD-SMD;26ohm,1608,TP | 43 | SA |
| ...4 | | 3601-001374 | FUSE-SURFACE MOUNT;32V,5A,FAST-ACTING,PL | 3 | SA |
| ...4 | | 3601-001376 | FUSE-SURFACE MOUNT;32V,3A,FAST-ACTING,Hi | 1 | SNA |
| ...4 | | 3701-001967 | CONNECTOR-HDMI;19P,A,FEMALE,AU,0.5mm,BLK | 3 | SA |
| ...4 | | 3707-001104 | CONNECTOR-OPTICAL;ANGLE,SPDIF | 1 | SA |
| ...4 | | 3708-003241 | CONNECTOR-FPC/FFC/PIC;96P,0.5mm,SMD-A,AU | 2 | SNA |
| ...4 | | 3710-003908 | CONNECTOR-SOCKET;64P,2R,0.5mm,SMD-S,AU,B | 1 | SA |
| ...4 | EH01 | 3711-007803 | HEADER-BOARD TO CABLE;BOX,12P,1R,1.25mm, | 1 | SA |
| ...4 | EH01 | 3711-008131 | HEADER-BOARD TO CABLE;BOX,4P,1R,2.5mm,AN | 1 | SA |
| ...4 | EH01 | 3711-008859 | HEADER-BOARD TO CABLE;BOX,12P,2R,2mm,ANG | 1 | SA |
| ...4 | | 3711-009090 | CONNECTOR-HEADER;BOX,16P,1R,1.25mm,SMD-A | 1 | SA |
| ...4 | | 3722-003199 | JACK-MODULAR;8P/8C,Y,ANGLE,NONE,AU,1PORT | 1 | SA |
| ...4 | | 3722-003457 | JACK-USB;4P/1C,NI,BLK,ANGLE,A,2.0,13.1x1 | 2 | SA |
| ...4 | | 3722-003814 | JACK-PHONE;1P/7C,NI/SN,YEL,ANGLE,3.5PI,1 | 1 | SA |
| ...4 | JACK | 3722-003873 | JACK-PHONE;1P/7C,AU/SN,BLU,ANGLE,3.5PI,1 | 1 | SA |
| ...4 | | 6302-001376 | GASKET-SMD;,,CONDUCTIVE FABRIC,T14,W43,L | 5 | SNA |
| ...4 | | BN40-00330A | TUNER-DTV AIR CABLE;DTOS40EH7A,DVB-TC,38 | 1 | SA |
| ...4 | | BN41-02568A | PCB-MAIN;MU6400,FR-4,4L,1.6T,1,KANT Buil | 1 | SNA |
| ...4 | CB07 | BN61-13312B | BRACKET-SCREWLESS PCB;55KS8000,SK5,T0.3, | 4 | SNA |
| ...4 | | BN97-12857A | ASSY MICOM-SUB;KMMICOM_TV,UMU7000,W25Q40 | 1 | SNA |
|5 | | 1107-002226 | IC-NOR FLASH;W25Q40CLSSIP,4Mbit,SOIC,8P, | 1 | SA |

Exploded Views and Parts List

| Level | Loc. | Part Code | Description & Specification | Qty. | SA/SNA |
|-------|-------|-------------|--|------|--------|
| ...4 | | BN97-12955B | ASSY MICOM-MAIN;T-KTMDEUC,MU6100/6300,KL | 1 | SNA |
|5 | | 1107-002374 | IC-EMMC;KLM4G1FEPD-B031,4Gbyte,BGA,153P, | 1 | SNA |
| ...4 | | BN97-12956A | ASSY MICOM;T-CON F/W KANT-M,MU6100/6300, | 1 | SNA |
|5 | | 1107-002339 | IC-NOR FLASH;W25Q80DV,8Mbit,SOP,5.28x5.2 | 1 | SNA |
|5 | | BN46-00636A | S/W MICOM;KANT-M_TCON F/W | 1 | SNA |
| 1 | | BN92-21844G | ASSY BOX;UMU6100N,55 | 1 | SNA |
| .2 | | BH68-00662A | LABEL BOX;ALL,ART PAPER,W60,L110,WHT,NO | 1 | SNA |
| .2 | | BN69-16124G | BOX UNIT;55MU6100,CB,DW3,F1,L1517,W169,H | 1 | SNA |
| 1 | | BN92-21855A | ASSY P/MATERIAL;UMU6100N,55 | 1 | SNA |
| .2 | | 6902-001957 | BAG ROLL;HDPE/PE FOAM,HDPE T0.018mm,T0.2 | 3 | SNA |
| .2 | | 6902-002233 | BAG AIR;LDPE,-,T0.2,W900,L1850,TRP,-,-,- | 1 | SNA |
| .2 | | 6922-000003 | BAND;PP,T0.8,W18,L1650M,TRP,DA69-90145A | 1 | SNA |
| .2 | | BN02-00319B | TAPE-SINGLE FACE;OPP,T0.05,W75,L800M,CLE | 3 | SNA |
| .2 | AS080 | BN63-07229A | SHEET-PET;rose70",PET,T0.052,W50,L100000 | 2 | SNA |
| .2 | | BN68-02422B | LABEL WARNING;ALL,ART PAPER,T0.05,W240,L | 1 | SNA |
| .2 | | BN69-03982N | PACKING ANGLE;ALL,PAPER,-,-,-,-,-,-,- | 1 | SNA |
| .2 | | BN69-05418N | WRAP;T0.017,750,2000000,2000000,750 | 0 | SNA |
| .2 | | BN69-06640E | PAD-PACKING;TRUCK PAD,CB,-,,W410,L2500,, | 1 | SNA |
| .2 | | BN69-06642B | PAD-DP SHEET;PAD,CB,SW4,,W1500,L1100,,, | 1 | SNA |
| .2 | | BN69-10937A | PALLET-DP WOODEN;55" H6500,WOOD,-,W1125, | 1 | SNA |
| .2 | | BN69-15601A | CUSHION-SET FRONT;55MU8000,EPS,33.3g/l,W | 1 | SNA |
| .2 | | BN69-15970A | CUSHION-SET;55MU6100,EPS,16.7g/l,WHITE,W | 1 | SNA |
| ...3 | | 0103-005099 | RESIN EPS;BASF303,Natural,Natural | 1116 | SNA |
| 1 | ACCE1 | BN92-21859J | ASSY ACCESSORY;UMU6100N,40 | 1 | SNA |
| .2 | ACCE4 | BN96-43186G | ASSY ACCESSORY-MANUAL;UE40MU6100WXXN | 1 | SNA |
| ...3 | | 6902-001964 | BAG PE;LDPE,BIOBASED,T0.03,W200,L300,TRP | 1 | SNA |
| ...3 | T0527 | BN68-00513A | LABEL-E PASS;ALL MODEL,WW,YUPO,W50,L15,W | 2 | SNA |
| ...3 | | BN68-00514K | LEAFLET-WARRANTY;comm,Samsung,W.Europe,W | 1 | SNA |
| ...3 | | BN68-04972E | LEAFLET-REGULATORY GUIDE;ALL,SAMSUNG,W/W | 1 | SNA |
| ...3 | | BN68-07598A | LEAFLET-FICHE;ALL,W/P,0 | 1 | SNA |
| ...3 | | BN68-08446C | MANUAL USERS;MU6100,XN,W/P,EURO B5 | 1 | SNA |
| .2 | ACCE2 | BN96-43187A | ASSY ACCESSORY-CABLE;UE65MU6100KXZT | 1 | SNA |
| ...3 | | 3709-001791 | CONNECTOR-CARD SLOT;64P,0.5mm,SMD-A,AU,P | 1 | SA |
| ...3 | T0268 | 3903-001118 | CBF-POWER CORD;DT,EU,Angle,2P(C7),250V,2 | 1 | SA |
| ...3 | | 4301-000101 | BATTERY-ALKALINE;1.5V,1650mAH,LR6,14.5x5 | 2 | SNA |
| ...3 | EC03 | BN39-02189A | GENDER CABLE;DC to RCA Cable,3P,L100,UL2 | 1 | SA |
| ...3 | EC03 | BN39-02190A | GENDER CABLE;DC to RCA Cable,2P,L100,UL2 | 1 | SA |
| ...3 | | BN59-01266A | REMOCON-SMART CONTROL;2017 TV,Samsung,14 | 1 | SA |
| ...3 | | BN68-08112A | LABEL-SECURITY;ALL,PET,T0.05,W55,L52,GLO | 1 | SNA |
| ...3 | | BN68-08448E | LEAFLET-ACCESSORY KIT;MU6,EUROPE,W/P,W20 | 1 | SNA |

| Level | Loc. | Part Code | Description & Specification | Qty. | SA/SNA |
|-------|-------|-------------|--|------|--------|
| ..3 | | BN69-13918A | BAG ACCESSORY;LDPE,0.07,L350,W500,Transp | 1 | SNA |
| 1 | | BN92-21875B | ASSY LABEL;UMU6100N,40 | 1 | SNA |
| ..2 | | 0203-001598 | TAPE-SINGLE FACE;FILAMENT,#8915,T0.15,W1 | 0 | SNA |
| ..2 | | BN68-06708G | LABEL-RATING;Monitor,WW,PP,T0.161,W93,L7 | 1 | SNA |
| ..2 | | BN68-07519B | LABEL-ENERGY;ALL JORDAN,WW,PP,T0.135,W60 | 1 | SNA |
| ..2 | | BN68-08455B | LEAFLET-QUICK SETUP GUIDE;MU6100,W/W,W/P | 1 | SNA |
| 1 | | BN92-22124A | ASSY LABEL POP;UMU6100N | 1 | SNA |
| ..2 | | BN68-08547E | LABEL POP-HIGHLIGHT;55MU6100,PET,T0.188, | 1 | SNA |
| 1 | | BN95-04114A | PRODUCT LCD-BOE;CY-GM055HGEV1V/H,MU6100, | 1 | SA |
| ..2 | SCREW | 6001-003075 | SCREW-MACHINE;BH,+,M3,L4,ZPC(WHT),SWRCH1 | 6 | SA |
| ..2 | SCREW | 6001-003079 | SCREW-MACHINE;CH,+,M3,L6,ZPC(BLK),SWRCH1 | 4 | SA |
| ..2 | | BN02-00114A | TAPE SINGLE FACE;NNB 56",PET,T0.07,W12,L | 16 | SNA |
| ..2 | | BN68-05722A | LABEL-E PASS;POLYPROPYLENE,NON-COATING | 1 | SNA |
| ..2 | | BN90-09014B | ASSY BACK LIGHT UNIT;MU6100 55 | 1 | SNA |
| ..3 | | BN02-00102B | TAPE-SINGLE FACE;FILAMENT,#8917,T0.15,W2 | 0 | SNA |
| ..3 | | BN61-11751A | DIFFUSER PLATE;15Y_J6.3K 55INCH_DIFFUSER | 1 | SNA |
| ..3 | | BN61-13694A | OPTICAL SHEET-MLS;Y16_KU6000_55inch_PTD8 | 1 | SNA |
| ..3 | | BN63-13508A | OPTICAL SHEET-REFLECTOR;15Y JU7.0K 55inc | 1 | SNA |
| ..3 | | BN63-14673A | OPTICAL SHEET-COMPLEX;15Y JU6.0K 55inch | 1 | SNA |
| ..3 | | BN96-35400X | ASSY CHASSIS REAR P;55KU6000,EGI-SECC,SD | 1 | SNA |
| ...4 | | 0203-006897 | TAPE-DOUBLE FACE;Si,T1,W10,L50,WHITE | 1 | SNA |
| ...4 | SCREW | 6001-003075 | SCREW-MACHINE;BH,+,M3,L4,ZPC(WHT),SWRCH1 | 1 | SA |
| ...4 | | BN02-00040C | TAPE DOUBLE FACE;F-LED ALL,PET,T0.3,W3,L | 6 | SNA |
| ...4 | | BN02-00173C | TAPE-SINGLE FACE;PET,T0.05,W40,BLACK | 0 | SNA |
| ...4 | | BN02-00352E | TAPE-SINGLE FACE;PET,T0.05,W15,L50M,BLAC | 0 | SNA |
| ...4 | | BN61-09771A | HOLDER-SCREW;Y13 OLED CURVED 55",SWRCH18 | 1 | SNA |
| ...4 | | BN61-11401A | FRAME-CHASSIS REAR TOP;55JU7000,PC+GF10% | 1 | SNA |
| ...4 | | BN61-11402A | FRAME-CHASSIS REAR BOTTOM;55JU7000,PC+GF | 1 | SNA |
| ...4 | | BN61-11403A | FRAME-CHASSIS REAR LEFT RIGHT;55JU7000,P | 2 | SNA |
| ...4 | | BN61-11477A | HOLDER-SOURCE PCB;Y15 JU7K SDC,ABS,BLACK | 4 | SNA |
|5 | | 0103-004628 | RESIN HIPS;HF-1690H,K2901,BK0020,1.5mm H | 4 | SNA |
| ...4 | | BN61-12993A | SUPPORT-PLATE;Y15 LED(SAMEX ONLY),PC,V-2 | 17 | SNA |
| ...4 | | BN62-00690B | INSULATOR-SMPS;JU7500,PC,BLACK,L340,W255 | 1 | SNA |
| ...4 | | BN63-14955A | GASKET-EMI;GASKET,FABRIC,T8,W13,L20,BLAC | 2 | SNA |
| ...4 | | BN63-14962A | GASKET-EMI;GASKET,FABRIC,T8,W15,L5,BLACK | 2 | SNA |
| ...4 | CC04 | BN64-02864H | CHASSIS-REAR;55KU6000,EGI-SECC,PRESS,T0. | 1 | SNA |
|5 | CB20 | BN61-11982B | BRACKET-WALL;55KS7000,CR-SPCC,BLACK,"M8, | 4 | SNA |
| ...4 | T0527 | BN68-00513A | LABEL-E PASS;ALL MODEL,WW,YUPO,W50,L15,W | 1 | SNA |
| ...4 | | BN96-34710A | ASSY PCB P-LED INTERFACE BOARD;55JU6400, | 1 | SNA |
| ..3 | | BN96-36729C | ASSY FRAME P-MIDDLE TOP;55KU6000,PC+GF10 | 1 | SNA |

Exploded Views and Parts List

| Level | Loc. | Part Code | Description & Specification | Qty. | SA/SNA |
|-------|-------|-------------|---|------|--------|
| ...4 | | BN61-12197A | FRAME-MIDDLE TOP;55JU6400,PC+GF10%,V-2,B | 1 | SNA |
| ...3 | | BN96-36730E | ASSY FRAME P-MIDDLE BOTTOM;55MU6100,PC+G | 1 | SNA |
| ...4 | | BN02-00352V | TAPE SINGLE FACE;Y15 FLED 56",PET,T0.05, | 6 | SNA |
| ...4 | | BN60-00744A | SPACER-SILICONE;Y14 F-LED SLIM,Si,L29,SE | 2 | SNA |
| ...4 | | BN60-01023V | SPACER;Y15 FLED,PET,L485,CLEAR,T0.1,W1.5 | 2 | SNA |
| ...4 | | BN60-01023W | SPACER-PET;Y15 FLED,PET,L685,CLEAR,T0.1, | 2 | SNA |
| ...4 | | BN60-01486A | SPACER-FOAM;55KU6000,PU FOAM,L600,GRAY,T | 4 | SNA |
| ...4 | | BN61-12198C | FRAME-MIDDLE BOTTOM;55MU6100,PC+GF10%,V- | 1 | SNA |
| ...3 | | BN96-36731C | ASSY FRAME P-MIDDLE LEFT RIGHT;55KU6000, | 2 | SNA |
| ...4 | | BN60-01023X | SPACER-PET;55JU7000,PET,L679,CLEAR,T0.1, | 2 | SNA |
| ...4 | | BN60-01486B | SPACER-FOAM;55KU6000,PU FOAM,L680,HCS-WA | 2 | SNA |
| ...4 | | BN61-12199A | FRAME-MIDDLE LEFT RIGHT;55JU6400,PC+GF10 | 2 | SNA |
| ...3 | | BN96-40099A | ASSY LED BAR P;55inch_KU6000_CSOT_L,CEM3 | 6 | SNA |
| ...3 | | BN96-40100A | ASSY LED BAR P;55inch_KU6000_CSOT_R,CEM3 | 6 | SNA |
| .2 | | BN96-35018E | ASSY COVER P-SOURCE PCB;55KU6000,EGI-SEC | 1 | SNA |
| ...3 | | BN62-00537L | INSULATOR-SOURCE PCB COVER RIGHT;Y15 JU7 | 1 | SNA |
| ...3 | | BN63-13204E | COVER-SOURCE PCB;55KU6000,EGI-SECC,T0.6, | 1 | SNA |
| ...3 | | BN63-15644C | INSULATOR-SOURCE PCB COVER LEFT;55KU6000 | 1 | SNA |
| .2 | | BN96-36732K | ASSY CHASSIS FRONT P;55KU6000,PC+ABS+MF1 | 1 | SA |
| ...3 | | BN02-00381G | TAPE SINGLE FACE;Y15 UHD Flat 55",CONDUCT | 2 | SNA |
| ...3 | | BN02-00381H | TAPE SINGLE FACE;Y15 UHD Flat 55",CONDUCT | 2 | SNA |
| ...3 | | BN60-00715A | SPACER-CONDUCTIVE;Y13 Slim F-LED,CONDUCT | 2 | SNA |
| ...3 | | BN60-01042V | SPACER;JS9100 78",PU FOAM,L1220.2,BLACK, | 1 | SNA |
| ...3 | | BN60-01115A | SPACER-CONDUCTIVE;Y15 JU8K,CONDUCTIVE FA | 3 | SNA |
| ...3 | FD01 | BN63-13307C | COVER-DECORATION;55JU5900,PC+ABS+MF17%,D | 1 | SNA |
| ...3 | AS080 | BN63-14373D | SHEET-AL;LED_JU7000,AL,T0.068,W30,L10000 | 4 | SNA |
| ...3 | AC157 | BN64-03121A | CHASSIS-FRONT;55JU6400,PC+ABS+MF15%,T1.4 | 1 | SNA |
| .2 | | BN96-41921A | ASSY OPEN CELL;BOE,55Inch,Y17 New Model, | 1 | SNA |
| ...3 | | BN81-15420A | A/S-IC DRIVER SOURCE;HV550QUB-N5A,47-701 | 1 | SNA |
| ...3 | | BN81-15421A | A/S-ASSY PCB-SOURCE RIGHT;HV550QUB-N5A,4 | 1 | SNA |
| ...3 | | BN81-15422A | A/S-ASSY PCB-SOURCE LEFT;HV550QUB-N5A,44 | 1 | SNA |
| ...3 | | BN81-15423A | A/S-POLARIZER-C/F;HV550QUB-N5A,38-100327 | 1 | SNA |
| ...3 | | BN81-15424A | A/S-POLARIZER-TFT;HV550QUB-N5A,38-100327 | 1 | SNA |