

1. Exploded View & Part List

Exploded View

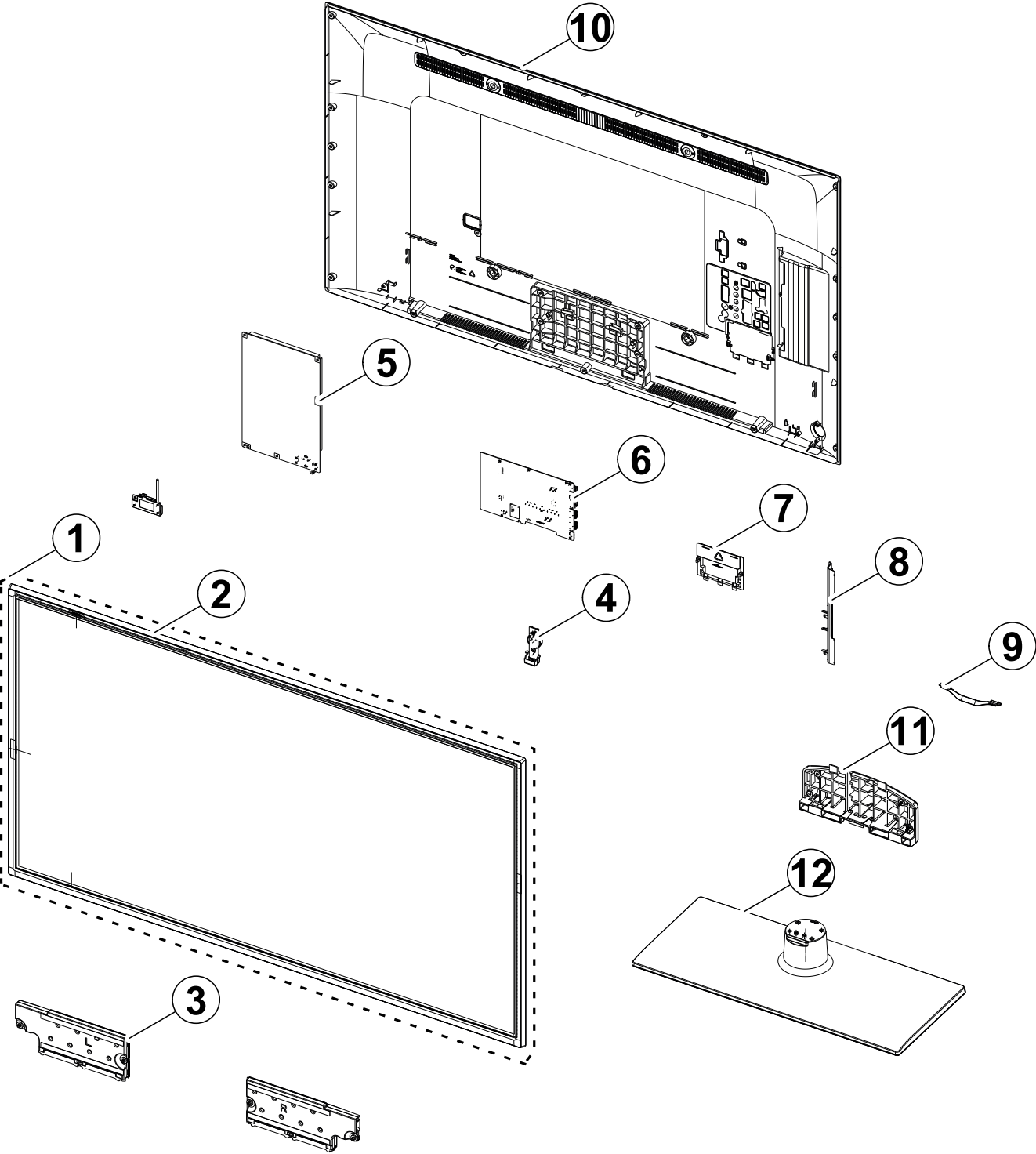

Parts List

No.	Lvl.	Loc.	Material Code	Description & Specification	SNA	Qty.
1	2	PANEL	BN95-00909A	PRODUCT LCD-SHARP; LK400D3HB7K,CY-HF400BG	SA	1
2	3	TC01A	BN96-25295A	ASSY MISC P-CHASSIS TOP; Y13 SF-LED 40(5K	SA	1
3	2	SP01A	BN96-25565A	ASSY SPEAKER P; 6ohm,10W,Enclosure_F6k	SA	1
4	3	FB01A	BN96-26411C	ASSY BOARD P-JOG SWITCH & IR; UE46F5000,F	SA	1
5	2	P001A	BN44-00609E	DC VSS-LED TV PD BD; L42SF_DHS,L42SF_DHS,	SA	1
6	2	M0014	BN94-06787Z	ASSY PCB MAIN; UE40F5000AWXXH	SA	1
7	2	FC05	BN63-10178B	COVER-JACK; UF6100,46,EO,MPPE,BK0020,V1	SNA	1
8	2		BN61-09059A	HOLDER-SIDE AV; UF6100,HIPS,BK0020,HB,EO/	SNA	1
9	2	FD01A	BN96-10973A	ASSY DECORATION P; UF5000,PC,V2,RD0005(SI	SA	1
10	2	R001A	BN96-29951C	ASSY COVER P-REAR; UF5000,40,EUROPE,MPPE,	SA	1
11	2	SG03	BN61-08776A	GUIDE-STAND; UF6100, 55, UO,PC+G/F20%	SA	1
12	2	SB04A	BN96-25361A	ASSY STAND P-BASE; UF5000,40,PC+ABS+G/F20	SA	1

2. Electrical Parts List

Level	Loc.	Part Code	Description & Specification	Qty.	SA/SNA
			UE40F5000AWXXH (HH01)		
1	S001A	BN90-04420A	ASSY STAND;UF5000 40	1	SNA
..2	SG03	BN61-08776A	GUIDE-STAND;UF6100, 55, UO,PC+G/F20%	1	SA
..3		0103-007285	RESIN-PC;MW32020GFU,K032202GFV,BK0007,V2	260	SNA
..2	SB04A	BN96-25361A	ASSY STAND P-BASE;UF5000,40,PC+ABS+G/F20	1	SA
..3		BN63-04755N	COVER-SHEET;32LC350,PE,T0.05,W180mm,200M	1	SNA
..3		BN63-10179A	COVER-STAND BASE;UF5000,40,PC+ABS+G/F20%	1	SNA
...4		0103-009946	RESIN-PC ABS;HM-1200,BLACK,BK0007,V1	950	SNA
..3		BN67-00306B	RUBBER-LEG;UD4000-19",RUBBER,5;6,13*13,G	6	SNA
..3		BN69-08751B	WRAP VINYL-SHRINK;STAND,PLASTIC OTHERS,P	1	SNA
1		BN90-04566A	ASSY W/I;UF5F,U40FF*	1	SNA
..2		BN81-08159H	PART SET-MECH W/I;UF5F,U40FF*	1	SNA
..2		BN81-08159Z	PART SET-ELEC W/I;UF4* ~ UF8* ELEC	1	SNA
1	R001A	BN90-04975M	ASSY COVER REAR;UF5000,40	1	SNA
..2		6001-002755	SCREW-MACHINE;BH,+,M3,L6,ZPC(BLK),SWRCH1	4	SA
..2	SCREW	6003-001782	SCREW-TAPTYPE;BH,+,B,M4,L12,ZPC(BLK),SWR	13	SA
..2	R001A	BN96-29951C	ASSY COVER P-REAR;UF5000,40,EUROPE,MPPE,	1	SA
..3		0203-001598	TAPE-FILAMENT;#8915,0.15,12,55000,CLR	0	SNA
..3	SCREW	6003-000117	SCREW-TAPTYPE;BH,+,B,M3,L6,ZPC(WHT),SWRC	2	SNA
..3	R001	BN63-11568B	COVER-REAR;UF5000,40",EO,MPPE	1	SNA
...4		0103-009565	RESIN-MPPE;ST855,1D129A,BK0020	1550	SNA
..3		BN68-04709G	LABEL-TERMINAL SIDE;UF4000,EO/CIS T2C,PE	1	SNA
..3	FB01A	BN96-26411C	ASSY BOARD P-JOG SWITCH & IR;UE46F5000,F	1	SA
...4	EC13	BN39-01764C	LEAD CONNECTOR;UE46F5000,Flat Connector,	1	SNA
...4		BN96-26411A	ASSY BOARD P-JOG SWITCH & IR;UE32F5000,F	1	SNA
1		BN91-10331A	ASSY LCM-SHARP;BN95-00909A,CY-HF400BGSV1	1	SNA
..2	PANEL	BN95-00909A	PRODUCT LCD-SHARP;LK400D3HB7K,CY-HF400BG	1	SA
..3		6001-002757	SCREW-MACHINE;BH,+,M3,L4,ZPC(WHT),SWRCH1	2	SA
..3		AK68-02233C	LABEL RATING;BD-E,XS,KR,RU,ZW,ART PAPER,	1	SNA
..3		BN02-00102B	TAPE FILAMENT;UE7000,#893,0.15,25,50,WHI	1	SNA
..3		BN02-00114A	TAPE ETC-COF;NNB 55",PET,0.07T,20,12,GRE	8	SNA
..3		BN63-10731A	COVER-SOURCE,PCB(L);Y13 SF-LED 40,ABS,HB	2	SNA
...4		0103-007797	RESIN-ABS;EA-0640,K2007,HB	48	SNA
..3		BN82-01228A	A/S ASSY-FPC CABLE;DFR,59mm,80P FPC CABL	2	SNA
..3		BN90-04457A	ASSY MISC-BLU;Sharip 40	1	SNA
...4		BN02-00152H	TAPE ETC-SHEET FIXING;Y13 Slim F-LED,PET	3	SNA
...4		BN61-08638A	LGP-DIFFUSESR PLATE;40" Slim FLED_Diffus	1	SNA
...4		BN61-09304A	SUPPORT-PLATE;Y13 SLIM / VNB,PC,WHT + CL	8	SNA

Exploded Views and Parts List

Level	Loc.	Part Code	Description & Specification	Qty.	SA/SNA
....5		0103-005036	RESIN-PC;M2407,550115,TP0003	12	SNA
....5		0103-009493	RESIN-PC;LH-1070W,W92853,WT0107,V-2	20	SNA
...4		BN63-10447A	SHEET-REFLECTOR;SY95,SHEET*,0.188,886.6,	1	SNA
...4		BN63-10453A	SHEET-DIFFUSER;40inch, SFLED, UTA10 / DM	1	SNA
...4		BN96-25293B	ASSY FRAME P-MOLD MIDDLE;Y13 SF-LED 40"	1	SNA
....5		BN60-00744A	SPACER-RUBBER;Y13 F-LED SLIM,SH-0140U+AT	2	SNA
....5		BN60-00783E	SPACER-PANEL (U);Y13 SF-LED 40,SHEET+SIL	2	SNA
....5		BN60-00783H	SPACER-PANEL (LR);Y13 SF-LED 40 SHARP,SH	2	SNA
....5		BN61-08718B	FRAME-MOLD MIDDLE;Y13 SF-LED 40" SHARP,P	1	SNA
....6		0103-009559	RESIN-PC;210GNH15,6919A,BK0007,PC ABS GF	125	SNA
...4		BN96-25294E	ASSY MISC P-CHASSIS BOTTOM;Y13 SF-LED 40	1	SNA
....5		6001-002759	SCREW-MACHINE;CH,+,M3,L4,ZPC(BLK),SWRCH1	1	SA
....5		6001-003005	SCREW-MACHINE;BH,+,M3,L6,ZPC(WHT),SWRCH1	4	SNA
....5		BN02-00040C	TAPE DOUBLE FACE-D-PLATE;F-LED ALL,MKT50	2	SNA
....5		BN02-00134E	TAPE ETC-SHEET FIXING;SFLED 32/40/46/55/	6	SNA
....5		BN60-00792A	SPACER-SOURCE PCB GASKET;Y13 Slim F-LED,	2	SNA
....5		BN61-08161A	HOLDER-LED-PCB;Direct-LED,PC,white	2	SNA
....6		0103-009493	RESIN-PC;LH-1070W,W92853,WT0107,V-2	2	SNA
....5		BN61-08815A	HOLDER-SOURCE PCB;SLIM-FLED,ABS+PC,BLK,V	4	SNA
....6		0103-005041	RESIN-PC;FR3200TV,901408,BK0008,1.2mm V-	8	SNA
....5		BN61-09049A	BRACKET-WALL MOUNT;Y13 ALL Model,SPCC,T1	4	SNA
....5		BN61-09101A	SUPPORT-SOURCE PCB;SF-LED,ABS+PC,V0,GRAY	2	SNA
....6		0103-009930	RESIN-PC ABS;NH-1017SG,GRAY,GY0275,V0	4	SNA
....5		BN62-00338M	INSULATION-PD BOARD;Y13 SF-LED 39"~55",P	1	SNA
....5	CC02	BN64-02199B	CHASSIS-BOTTOM;Y13 F-LED Slim 40" SHARP,	1	SNA
....5		BN96-25336A	ASSY BOARD P-D-LED INTERFACE;40inch Slim	1	SNA
...4		BN96-25520A	ASSY MISC P-LED BAR;40inch Sharp Slim Di	7	SNA
...4		BN96-25521A	ASSY MISC P-LED BAR;40inch Sharp Slim Di	7	SNA
...3		BN96-23705B	ASSY OPEN CELL;LK400D3HC1K,0.46125(H)X0.	1	SNA
...4		BN81-08338A	AS-DRIVER IC;DRIVER IC,S6C277G3,miniLVDS	1	SNA
...4		BN81-08340A	AS-GATE IC;GATE IC,LH16E002,272ch, 2pf	1	SNA
...4		BN81-08343A	AS-SOURCE PCB;SOURCE PCB,RUNTK5316TPZZ,F	1	SNA
...4		BN81-08343B	AS-SOURCE PCB;SOURCE PCB,RUNTK5315TPZZ,F	1	SNA
...4		BN81-08346A	AS-POL-C/F;POLARIZER-C/F,PFILV1638TPXZ,S	1	SNA
...4		BN81-08348A	AS-POL-TFT;POLARIZER-TFT,PFILV1639TPXZ,P	1	SNA
...3	TCON	BN96-23812B	ASSY T CON P;LK0DZ1C0491,HF400BGS-V1,150	1	SA
...3	TC01A	BN96-25295A	ASSY MISC P-CHASSIS TOP;Y13 SF-LED 40(5K	1	SA
...4		BN02-00112A	TAPE ETC-ALL;POLYESTER,L65.8M,T0.009,W10	0	SNA
...4		BN60-00667B	SPACER-GASKET;Y13 SF-LED,GASKET(FG200A),	4	SNA
...4		BN60-00701C	SPACER-TOP,UD;Y13 Slim F-LED 40,GASKET,L	2	SNA

Level	Loc.	Part Code	Description & Specification	Qty.	SA/SNA
...4		BN60-00701D	SPACER-TOP,LR;Y13 Slim F-LED 40,GASKET*,	2	SNA
...4		BN60-00715A	SPACER-TOP,CORNER;Y13 Slim F-LED,GASKET*	4	SNA
...4		BN63-07556X	COVER-SHEET;F-LED 3D VE,PO-SHEET,T0.068,	1	SNA
...4		BN63-07556Y	COVER-SHEET;Y13 SF-LED,PO-SHEET,T0.068,W	2	SNA
...4	AC157	BN64-02236A	CHASSIS-TOP;Y13 40" (5K),PC+ABS+G/F15%,B	1	SNA
....5		0103-009559	RESIN-PC;210GNH15,6919A,BK0007,PC ABS GF	180	SNA
1		BN91-11639C	ASSY SHIELD;UF4B,F4000	1	SNA
.2		6001-003016	SCREW-MACHINE;PWH,+,M3.0,L5.0,ZPC(WHT),S	9	SA
.2		BN02-00102B	TAPE FILAMENT;UE7000,#893,0.15,25,50,WHI	0	SNA
.2	EC14	BN39-01455C	LEAD CONNECTOR;UE37D5000,Lead Connector,	1	SA
.2	EC13	BN39-01744B	LEAD CONNECTOR;DIRECT wire-harness,Flat	1	SA
.2	P001A	BN44-00609E	DC VSS-LED TV PD BD;L42SF_DHS,L42SF_DHS,	1	SA
.2		BN61-09059A	HOLDER-SIDE AV;UF6100,HIPS,BK0020,HB,EO/	1	SNA
..3		0103-004631	RESIN-HIPS;HF-1690H,K21294,BK0007,1.5mm	22	SNA
.2	FC05	BN63-10178B	COVER-JACK;UF6100,46,EO,MPPE,BK0020,V1	1	SNA
..3		0103-009565	RESIN-MPPE;ST855,1D129A,BK0020	14	SNA
.2	FD01A	BN96-10973A	ASSY DECORATION P;UF5000,PC,V2,RD0005(SI	1	SA
..3	FD01	BN63-10222A	COVER-DECORATION;UF5000,PC,V2,RD0005(SI-	1	SNA
...4		0103-007267	RESIN-PC;TN-1045S,40700,RD0005,0.8, 3.0	5	SNA
..3		BN63-10770D	COVER-SHEET;UF5000,URETHAME,T0.039,W40mm	0	SNA
.2	LVDS	BN96-24278T	ASSY CABLE P-FFC;UN40F5000,FFC,332mm,51P	1	SA
.2	SP01A	BN96-25565A	ASSY SPEAKER P;6ohm,10W,Enclosure_F6k	1	SA
1	M0017	BN91-11643K	ASSY CHASSIS;UE40F5000AWXXH	1	SNA
.2	M0014	BN94-06787Z	ASSY PCB MAIN;UE40F5000AWXXH	1	SA
..3		0202-001608	SOLDER-WIRE FLUX;LFC7-107,D0.8,99.3Sn/0.	0	SNA
..3		BN97-07183A	ASSY DRM-KEY;BN46-00115J(CI+)	1	SNA
...4		BN46-00115J	KEY CODE-CERTIFI;CI+,TV,2013X,Euro	1	SNA
..3		BN97-07694Q	ASSY SMD;UE32F5000AWXXH,UF5F	1	SNA
...4		0202-001830	SOLDER-CREAM;LFM-48W TM-HP,D20~38um,96.5	6	SNA
..4	DS01A	0401-001056	DIODE-SWITCHING;MMBD4148SE,100V,200mA,SO	1	SA
...4		0403-001783	DIODE-ZENER;BZB84-C6V2,5.8/6.6V,300mW,SO	6	SNA
...4		0403-001785	DIODE-ZENER;NZH5V1B,4.94/5.2V,500mW,SOD-	1	SA
...4		0404-001404	DIODE-SCHOTTKY;BAT721C,40V,200mA,SOT-23,	2	SA
...4		0406-001200	DIODE-TVS;RCLAMP0504F,6/-/V,150W,SC-70	1	SA
...4		0501-000279	TR-SMALL SIGNAL;KSA1182-Y,PNP,150mW,SOT-	1	SA
...4		0501-000445	TR-SMALL SIGNAL;KTC3875S-Y,NPN,150mW,SOT	16	SC
...4		0505-000110	FET-SILICON;2N7002,N,60V,115mA,7.5ohm,0.	10	SA
...4		0505-002560	FET-SILICON;AO6415,P,-20V,-3.3A,0.15ohm,	1	SA
...4		0801-002630	IC-CMOS LOGIC;74AHCT1G08,2-INPUT AND GAT	1	SA
...4		0801-002780	IC-CMOS LOGIC;74LVC1G17,SCHMITT-TRIGGER	1	SA

Exploded Views and Parts List

Level	Loc.	Part Code	Description & Specification	Qty.	SA/SNA
...4		0801-003330	IC-CMOS LOGIC;Octal buffer,DQFN,20P,4.5x	3	SA
...4		0802-001012	IC-CMOS LOGIC;74LCX245,TRANSCEIVER,DQFN,	1	SNA
...4		1001-001545	IC-ANALOG MULTIPLEX;TS3USB221ERSER,R-PQF	1	SA
...4		1103-001531	IC-EEPROM;S-24C256CI-J8T1U4,256Kbit,32Kx	1	SA
...4		1103-001561	IC-EEPROM;S-24C02DI-J800,2Kbit,256X8bit,	1	SA
...4		1105-002227	IC-DDR3 SDRAM;K4B1G1646G-BCK0,DDR3 SDRAM	2	SA
...4		1201-003183	IC-AUDIO AMP;DRV612,HTSSOP,14P,5x4.4mm,D	1	SA
...4		1201-003333	IC-POWER AMP;NTP-7412S,MLF,48P,7x7mm,DUA	1	SA
...4		1203-004364	IC-VOL. DETECTOR;RT9818C-42PV,SOT-23,3P,	1	SA
...4		1203-006017	IC-VOL. DETECTOR;RT9824GJ8,TSOT23,8P,2.9	1	SA
...4		1203-006130	IC-POSIFIXED REG.;S-1172B25-U5T1G,SOT-8	1	SA
...4		1203-006135	IC-POSIFIXED REG.;AP1117D-33-GZ-13-89,T	1	SA
...4		1203-006136	IC-POSIFIXED REG.;AP1117D-18-GZ-13-89,T	1	SA
...4		1203-006138	IC-POSADJUST REG.;AP1117DGZ-13-89,TO-2	1	SA
...4		1203-006337	IC-POSIFIXED REG.;G9091-330T11U,SOT-23-	1	SA
...4		1203-006710	IC-DC/DC CONVERTER;RT8016L-GQW,WQFN,8P,1	2	SA
...4		1203-007502	IC-DC/DC CONVERTER;AOZ3011PI,SO-8,8Z30,4	2	SA
...4		1204-003423	IC-DECODER;SEMS29,LFBGA,557Z30,20.2x20.2	1	SA
...4		1405-001271	VARISTOR;35V,20Vdc,5A,1.0x0.5x0.6mm,TP,1	14	SA
...4		2007-000137	R-CHIP;2Kohm,5%,1/16W,TP,1005	7	SNA
...4		2007-000138	R-CHIP;100ohm,5%,1/16W,TP,1005	23	SA
...4		2007-000142	R-CHIP;2.7Kohm,5%,1/16W,TP,1005	1	SA
...4		2007-000143	R-CHIP;4.7Kohm,5%,1/16W,TP,1005	48	SNA
...4		2007-000148	R-CHIP;10Kohm,5%,1/16W,TP,1005	37	SA
...4		2007-000153	R-CHIP;22Kohm,5%,1/16W,TP,1005	7	SNA
...4		2007-000154	R-CHIP;24Kohm,5%,1/16W,TP,1005	2	SA
...4		2007-000155	R-CHIP;27Kohm,5%,1/16W,TP,1005	1	SNA
...4		2007-000157	R-CHIP;47Kohm,5%,1/16W,TP,1005	7	SNA
...4		2007-000162	R-CHIP;100Kohm,5%,1/16W,TP,1005	4	SNA
...4		2007-000168	R-CHIP;470Kohm,5%,1/16W,TP,1005	1	SA
...4		2007-000170	R-CHIP;1Mohm,5%,1/16W,TP,1005	2	SNA
...4		2007-000172	R-CHIP;10ohm,5%,1/16W,TP,1005	2	SNA
...4		2007-000173	R-CHIP;22ohm,5%,1/16W,TP,1005	3	SNA
...4		2007-000174	R-CHIP;47ohm,5%,1/16W,TP,1005	2	SNA
...4		2007-000256	R-CHIP;1.6Kohm,1%,1/10W,TP,1608	1	SA
...4		2007-000475	R-CHIP;1Mohm,1%,1/10W,TP,1608	2	SA
...4		2007-000691	R-CHIP;3.3Mohm,5%,1/10W,TP,1608	1	SA
...4		2007-000695	R-CHIP;3.3ohm,5%,1/10W,TP,1608	4	SNA
...4		2007-000775	R-CHIP;33Kohm,5%,1/16W,TP,1005	2	SNA
...4		2007-000803	R-CHIP;36Kohm,1%,1/10W,TP,1608	2	SA

Level	Loc.	Part Code	Description & Specification	Qty.	SA/SNA
...4		2007-000932	R-CHIP;470ohm,5%,1/16W,TP,1005	2	SNA
...4		2007-000979	R-CHIP;5.6Kohm,1%,1/10W,TP,1608	1	SA
...4		2007-001168	R-CHIP;75ohm,5%,1/4W,TP,3216	1	SA
...4		2007-001292	R-CHIP;33ohm,5%,1/16W,TP,1005	18	SNA
...4		2007-001298	R-CHIP;51ohm,5%,1/16W,TP,1005	2	SNA
...4		2007-001301	R-CHIP;68ohm,5%,1/16W,TP,1005	7	SA
...4		2007-001313	R-CHIP;330ohm,5%,1/16W,TP,1005	2	SNA
...4		2007-001325	R-CHIP;3.3Kohm,5%,1/16W,TP,1005	1	SNA
...4		2007-001333	R-CHIP;18Kohm,5%,1/16W,TP,1005	4	SNA
...4		2007-002970	R-CHIP;56ohm,5%,1/16W,TP,1005	5	SA
...4		2007-007095	R-CHIP;390ohm,5%,1/16W,TP,1005	1	SA
...4		2007-007142	R-CHIP;10Kohm,1%,1/16W,TP,1005	4	SNA
...4		2007-007156	R-CHIP;1ohm,5%,1/16W,TP,1005	15	SNA
...4		2007-007311	R-CHIP;22Kohm,1%,1/16W,TP,1005	1	SA
...4		2007-007313	R-CHIP;6.8Kohm,1%,1/16W,TP,1005	2	SA
...4		2007-007318	R-CHIP;1Kohm,1%,1/16W,TP,1005	28	SNA
...4		2007-007352	R-CHIP;130Kohm,1%,1/10W,TP,1608	2	SA
...4		2007-007463	R-CHIP;1.1Kohm,1%,1/16W,TP,1005	1	SA
...4		2007-007517	R-CHIP;240ohm,1%,1/16W,TP,1005	2	SNA
...4		2007-007766	R-CHIP;2Kohm,1%,1/16W,TP,1005	6	SNA
...4		2007-008015	R-CHIP;75ohm,1%,1/16W,TP,1005	11	SA
...4		2007-008275	R-CHIP;30Kohm,1%,1/16W,TP,1005	2	SNA
...4		2007-008649	R-CHIP;220ohm,1%,1/16W,TP,1005	1	SNA
...4		2011-000515	R-NETWORK;4.7Kohm,5%,1/16W,L,CHIP,8P,TP,	1	SA
...4		2011-001261	R-NETWORK;33ohm,5%,1/16W,L,CHIP,8P,TP,2.	6	SA
...4		2011-001262	R-NETWORK;22ohm,5%,1/16W,L,CHIP,8P,TP,2.	2	SA
...4		2011-001344	R-NETWORK;100ohm,5%,1/16W,L,CHIP,8P,TP,2	3	SA
...4		2011-001449	R-NETWORK;22ohm,5%,1/16W,L,4P,TP,1010	4	SA
...4		2011-001506	R-NETWORK;10Kohm,5%,1/16W,L,CHIP,4P,TP,1	1	SNA
...4	AD480	2203-000233	C-CER,CHIP;0.1nF,5%,50V,C0G,TP,1005	6	SA
...4	AD480	2203-000438	C-CER,CHIP;1nF,10%,50V,X7R,TP,1005	11	SA
...4	AD480	2203-000489	C-CER,CHIP;2.2nF,10%,50V,X7R,TP,1005	6	SA
...4	AD480	2203-000585	C-CER,CHIP;0.22nF,10%,50V,X7R,TP,1005	2	SA
...4	AD480	2203-000627	C-CER,CHIP;0.022nF,5%,50V,C0G,TP,1005	2	SNA
...4	AD480	2203-000714	C-CER,CHIP;3.3nF,10%,50V,X7R,TP,1005	4	SA
...4	AD480	2203-000812	C-CER,CHIP;0.033nF,5%,50V,C0G,TP,1005	7	SA
...4	AD480	2203-000995	C-CER,CHIP;0.047nF,5%,50V,C0G,TP,1005	4	SA
...4	AD480	2203-002285	C-CER,CHIP;10nF,10%,50V,X7R,TP,1005	11	SNA
...4	AD480	2203-002525	C-CER,CHIP;0.56nF,10%,50V,X7R,TP,1005	4	SNA
...4	AD480	2203-005054	C-CER,CHIP;0.0047nF,0.25pF,50V,NP0,TP,10	2	SA

Exploded Views and Parts List

Level	Loc.	Part Code	Description & Specification	Qty.	SA/SNA
...4	AD480	2203-005249	C-CER,CHIP;100nF,10%,50V,X7R,TP,1608	14	SNA
...4	AD480	2203-005344	C-CER,CHIP;22nF,10%,25V,X7R,TP,1005,0.5T	3	SNA
...4	AD480	2203-006048	C-CER,CHIP;100nF,10%,10V,X7R,TP,1005	84	SA
...4	AD480	2203-006126	C-CER,CHIP;47nF,10%,16V,X7R,TP,1005	16	SNA
...4	AD480	2203-006324	C-CER,CHIP;2200nF,10%,10V,X5R,TP,1608	8	SA
...4	AD480	2203-006474	C-CER,CHIP;22000nF,20%,6.3V,X5R,TP,2012	20	SA
...4	AD480	2203-006562	C-CER,CHIP;1000nF,10%,10V,X5R,TP,1005	13	SNA
...4	AD480	2203-006636	C-CER,CHIP;220nF,10%,25V,X7R,TP,1608	3	SA
...4	AD480	2203-006890	C-CER,CHIP;10000nF,20%,6.3V,X5R,TP,1608	18	SA
...4	AD480	2203-006992	C-CER,CHIP;0.33nF,5%,50V,C0G,TP,1005	2	SNA
...4	AD480	2203-007176	C-CER,CHIP;10000nF,10%,16V,X5R,TP,2012,1	4	SNA
...4	AD480	2203-007513	C-CER,CHIP;10000nF,10%,10V,X5R,TP,1608,0	22	SA
...4		2703-001229	INDUCTOR-SMD;2.2uH,10%,1608,1.150hm,15mA	1	SC
...4		2703-001938	INDUCTOR-SMD;56nH,5%,1005,1.50hm,200mA,1	3	SA
...4		2703-002238	INDUCTOR-SMD;1uH,5%,2012,2.380hm,23,Wire	3	SNA
...4		2703-003343	INDUCTOR-SMD;2.2uH,20%,2520,0.1040hm,130	2	SNA
...4		2703-003790	INDUCTOR-SMD;4.7uH,20%,8080,0.025ohm,450	2	SA
...4		2703-003930	INDUCTOR-SMD;4.7uH,20%,5050,0.0720hm,245	4	SA
...4		2801-003326	CRYSTAL-SMD;24MHz,30ppm,28-ABX,20pF,50oh	1	SA
...4		3301-002039	BEAD-SMD;26ohm,1608,TP	36	SA
...4		3701-001861	CONNECTOR-HDMI;19P,2ROW,FEMALE,SMD-A,AU	2	SA
...4		3707-001106	CONNECTOR-OPTICAL;STRAIGHT W/L,SPDIF	1	SA
...4		3708-003073	CONNECTOR-FPC/FFC/PIC;51P,0.5mm,SMD,AU,N	1	SNA
...4		3709-001712	CONNECTOR-CARD SLOT;68P,1.27mm,ANGLE,AU,	1	SA
...4		3711-007569	CONNECTOR-HEADER;BOX,14P,2R,2.0mm,DIP,SN	1	SA
...4		3711-007585	CONNECTOR-HEADER;BOX,4P,1R,2.5mm,ANGLE-D	1	SA
...4	EH01	3711-008521	HEADER-BOARD TO CABLE;BOX,8P,1R,2mm,ANGL	1	SNA
...4		3722-003457	JACK-USB;4P/1C,NI,BLK,A	1	SA
...4		3722-003546	JACK-PIN;5P+Screw hole,NI+SN,G,Y/BLU/RED	1	SA
...4		3722-003655	JACK-SCART;21P,SN,BLK	1	SA
...4		3722-003667	JACK-PHONE;1P/7C,AU/NI,BLK,STRAIGHT	1	SA
...4	ET01	BN40-00256A	TUNER;DTOS40EIH035A,DTOS40EIH035A,DVB-TC	1	SA
...4		BN41-01955B	PCB MAIN;X13 OS,FR-4,4,1.2T,192*158,1	1	SNA
...4		BN97-07187A	ASSY MICOM-SUB;T-MST13DEUS-XXXX,X13,W25Q	1	SNA
....5		1107-002226	IC-NOR FLASH;W25Q40CLSSIP,4Mbit,SOIC,8P,	1	SNA
...4		BN97-07713A	ASSY MICOM;T-MST13DEUC,BN46-00335A,BN46-	1	SNA
....5		1107-002252	IC-NAND FLASH;F59L1G81A-25TIG,1Gbit,128M	1	SA
....5		BN46-00317C	S/W-E-MANUAL;X13,EU2,XH	1	SNA
....5		BN46-00361A	S/W MICOM;T-MST13DEU-XXXX,EU_ESMT,EU_ESM	1	SNA
1		BN92-11770A	ASSY P/MATERIAL;UF5000 40	1	SNA

Level	Loc.	Part Code	Description & Specification	Qty.	SA/SNA
.2		6902-001671	BAG ROLL;HDPE/PE FOAM,T0.01/T0.3,W750,L3	2	SNA
.2		6922-000013	BAND PP;PP,W18,L2300/L2900,TRP	1	SNA
.2		BN01-00156A	FOIL-STRETCH-HOOD;UE42F5000,LLDPE*,T0.08	0	SNA
.2		BN63-11092A	COVER-SHEET NITRON;PS51F8500,PE,T4.0,W12	1	SNA
.2		BN69-08313A	CUSHION-SET;UF5000 40",EPS	1	SNA
.2		BN69-08430A	CUSHION-FRONT;UF7000 40,EPS,EXPORT	1	SNA
..3		0103-005099	RESIN-EPS;BASF303,Natural,Natural	40	SNA
.2		BN69-09102A	PALLET-WOODEN;UE40F6510,WOOD,1290,1190,1	1	SNA
.2		BN74-00008H	TAPE OPP-MASKING;T0.065,W75,L1500M,NTR,S	3	SNA
1		BN92-11808R	ASSY LABEL;UF4B,F4000(EU,ASIA)	1	SNA
.2	T0527	BP68-00052B	LABEL-00,RATING;FPTV,PET,T0.05,93,73	1	SNA
1		BN92-13263G	ASSY BOX;UF5000,40	1	SNA
.2		BH68-00662A	LABEL BOX-01;ALL MODEL,ART PAPER,60,110,	1	SNA
.2		BN69-09326D	BOX-SET;40UF5000-SS,CB,A-01,SW3,WHT,W114	1	SNA
1	ACCE1	BN92-13640F	ASSY ACCESSORY;UE40F5000AWXXH	1	SNA
.2		BN68-04898M	LEAFLET-02,STAND GUIDE;UF5000,EU N.AFRIC	1	SNA
.2		BN68-05417A	LABEL-STICKER;ALL,EDC,Polypropylene,T0.1	1	SNA
.2	ACCE4	BN96-25468C	ASSY ACCESSORY-MANUAL;UF5F,F5000(EU)	1	SNA
..3		6902-000476	BAG PE;LDPE,T0.03,W250,L350,TRP,Recycle,	1	SNA
..3		BN68-03548J	LEAFLET-05,WARRANTY CARD;comm,Samsung,17	1	SNA
..3		BN68-04784C	MANUAL USERS-05;UF5000W,ENG/POL/SLV/HUN/	1	SNA
..3		BN68-04972A	MANUAL FLYER-02,REGULATORY GUI;ALL,SAMSU	1	SNA
..3		BN68-05115E	LEAFLET-02,FICHE;UF5000(39/42INCH),EUROP	1	SNA
.2	ACCE2	BN96-25470B	ASSY ACCESSORY CABLE;UF5F,F5000(EU)	1	SNA
..3	T0268	3903-000849	CBF-POWER CORD;DT,CEE,LP-21L,250V,2.5A,B	1	SA
..3		4301-000121	BATTERY-MN;1.5V,R03,10.5x44.5m,7.5g,AAA	2	SNA
..3	SCREW	6003-001782	SCREW-TAPTYPE;BH,+,B,M4,L12,ZPC(BLK),SWR	8	SA
..3		6902-000286	BAG PE;LDPE,T0.03,W200,L300,TRP,28,2	1	SNA
..3	REMO2	AA59-00741A	REMOCON;TM1240,44,3.0V,F5020/EU	1	SA
..3		BN69-08449A	BAG VINYL;LDPE,0.04,L1000,W120	0	SNA
..3		BN96-15806B	ASSY HOLDER P-WIRE STAND;UE5500,NYLON,BL	1	SNA
...4		BN61-04731D	BOSS-TAPE;AMBER,ACRYL,T1.1,W20.0mm,WHITE	0	SNA
...4		BN61-05491C	HOLDER-WIRE STAND;UE5500,NYLON,BLK	1	SNA