

1. Exploded View & Part List

UE40D5003BW Exploded View

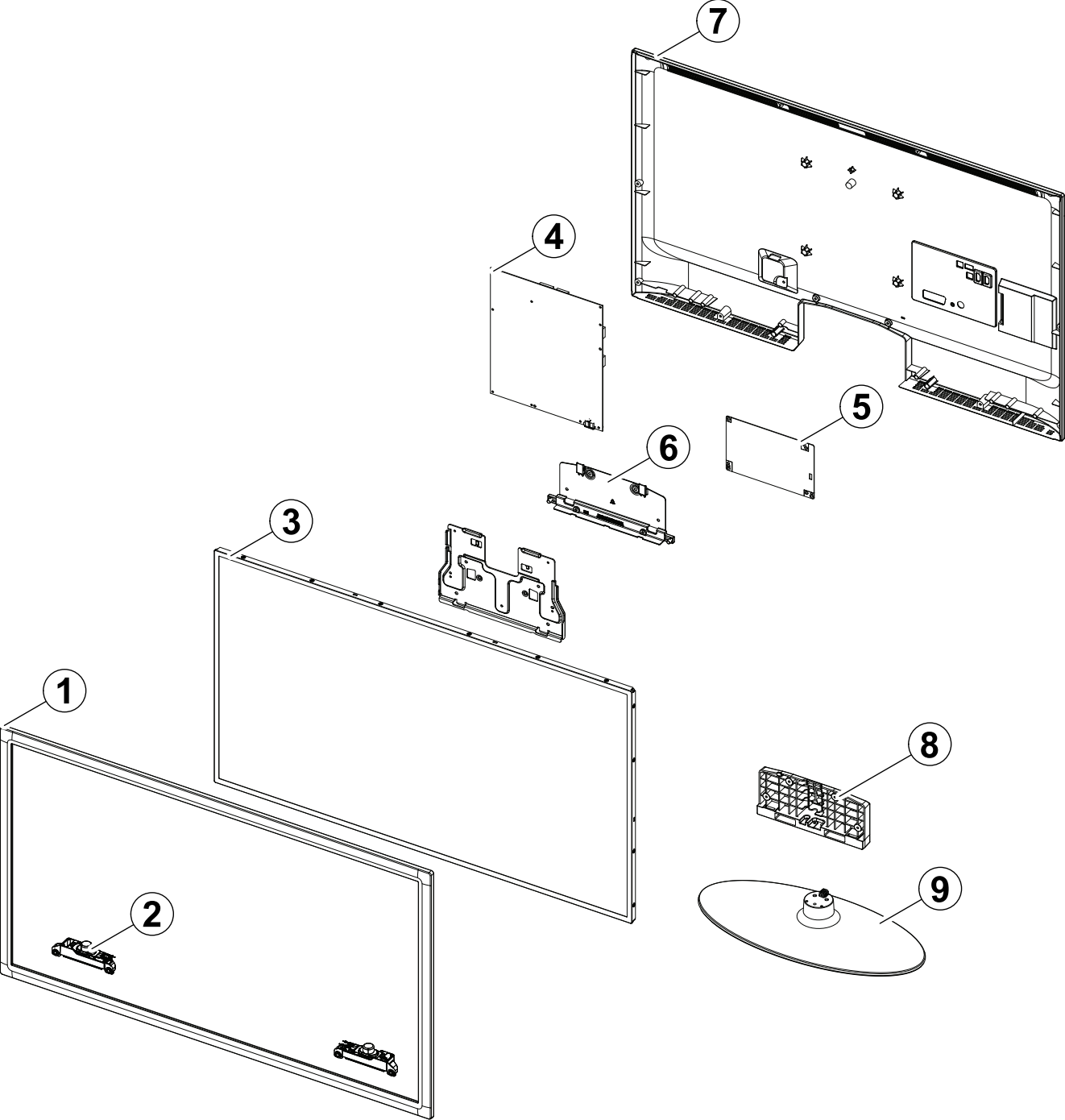

Parts List

No.	Parent	Lvl.	Loc.	Material Code	Description & Specification	SNA	Qty.
1	BN90-03214B	2	F001A	BN96-19849B	ASSY COVER P-FRONT; UD5003 40,EO,PC,V2,GY	SA	1
2	BN91-07727A	2	SP01A	BN96-19642A	ASSY SPEAKER P; 6ohm,4pin,10W,Low_LED_40"	SA	1
3	BN91-07732A	2	PANEL	BN07-00990B	LCD-PANEL; LD400BGC-C2,CLL6BC3,8 bits,40	SA	1
4	BN91-07727A	2	P001A	BN44-00473A	DC VSS-LED TV PD BD; PD46G0_BSM,PSLF121A0	SA	1
5	BN91-07724B	2	M0014	BN94-04940B	ASSY PCB MAIN; UE40D5003BWXXC	SA	1
6	BN91-07727A	2	RB01	BN63-07807C	COVER-BOTTOM; UD5000 37,NH HIPS,V1,BK0020	SNA	1
7	BN90-03241F	2	R001A	BN96-19904A	ASSY COVER P-REAR; UD5003 40,EO,HIPS,V0,B	SA	1
8	BN90-03523C	2	SG03A	BN96-19853A	ASSY STAND P-GUIDE; UD5003 40,W/W,PC,G/F	SA	1
9	BN90-03523C	2	SB04A	BN96-19855B	ASSY STAND P-BASE; UD5003 40,EO,PC+ABS,V0	SA	1

2. Electrical Parts List

Level	Loc.	Part Code	Description & Specification	Qty.	SA/SNA
			UE40D5003BWZG (CN01)		
1		BN90-03214B	ASSY COVER FRONT;UD5003 40	1	SNA
.2	F001A	BN96-19849B	ASSY COVER P-FRONT;UD5003 40,EO,PC,V2,GY	1	SA
..3	CB11P	BN61-07248A	BRACKET-SUPPORT PCB;LD550,SK-5,T0.5,Plat	1	SA
..3	CCM1	BN63-05199C	COVER-SHEET;AMBER,PE,T0.08,W55mm,200M,CL	3	SNA
..3	F001	BN63-08604B	COVER-FRONT;UD5003 40,EO,PC,V2,GY0132,S/	1	SNA
...4		0103-007639	RESIN-PC;NH3022S,3459AQ,TP0032,2.0V0,NH	420	SNA
..3		BN68-00513E	LABEL-AMS;ams,-,art paper,-,10,38,-,whit	1	SNA
..3		BN74-00053A	TAPE-PROTECTION;T460BE1-FB,T550BE1-FB,3M	1	SNA
..3	FB21A	BN96-16729V	ASSY BOARD P-TOUCH FUNCTION & IR;UE40D5003	1	SA
1	R001A	BN90-03241F	ASSY COVER REAR;UD5003 40	1	SNA
.2		6001-002671	SCREW-MACHINE;BH,+,M3,L6,ZPC(BLK),SWRCH1	3	SA
.2	R001A	BN96-19904A	ASSY COVER P-REAR;UD5003 40,EO,HIPS,V0,B	1	SA
..3		BN60-00162Y	SPACER-FOAM;FOAM,50000mm,Dark Gray,0.35T	2	SNA
..3	R001	BN63-08607A	COVER-REAR;UD5003 40,EO,HIPS,V0,BK0020	1	SNA
.2	T0382	BP61-00495C	HOLDER-CARE;PJT,ACRYL-FOAM,T0.25,W30.0mm	0	SNA
1	S001A	BN90-03523C	ASSY STAND;UD5003 40	1	SNA
.2	SG03A	BN96-19853A	ASSY STAND P-GUIDE;UD5003 40,W/W,PC,G/F	1	SA
..3	T0524	6902-001063	BAG PE;LDPE,T0.05,W180,L350,TRP,RECYCLE	1	SNA
..3	SG03	BN61-07627A	GUIDE-STAND;UD5003 40,PC+GF,PC,G/F 20%,V	1	SNA
...4		0103-007285	RESIN-PC;MW32020GFU,BK0007,2.0 V2,PC/GF2	280	SNA
..3		BN68-03735C	MANUAL FLYER-STAND GUIDE;UD5003 40,SAMSU	1	SNA
..3		BN96-18013B	ASSY ACCESSORY-SCREW;6002-001294,4EA,ALL	1	SNA
...4	T0081	6002-001294	SCREW-TAPPING;BH,+,M4,L16,ZPC(BLK)	4	SA
...4	T0524	6902-000341	BAG PE;LDPE,T0.05,L90,W70,TRP,,,PE MARK	1	SNA
..3		BN96-18013F	ASSY ACCESSORY-SCREW;6001-002621,4EA,ALL	1	SNA
...4		6001-002621	SCREW-MACHINE;BH,+,M4,L8,ZPC(BLK),SWRCH1	4	SA
..4		BN69-05418C	PACKING-BAG SCREW;BN96-18013F,-,RED,T0,0	1	SNA
.2	SB04A	BN96-19855B	ASSY STAND P-BASE;UD5003 40,EO,PC+ABS,V0	1	SA
..3	M0081	6003-001239	SCREW-TAPTYPE;FH,+,B,M4,L10,ZPC(WHT),SWR	7	SA
..3		BN61-07646A	BRACKET-STAND BOTTOM;UD5003 40",SECC,T1.	1	SNA
..3		BN61-07734A	BRACKET-STAND, NECK;UD4003 40,SECC,T2.0	1	SNA
..3	CCM1	BN63-02183L	COVER-SHEET;Rhcm,PE Vinyl,T 0.04,300MM,2	1	SNA
..3		BN63-04755G	COVER-SHEET;42PC450,PE,T0.05,W250mm,200M	1	SNA
..3		BN63-08617B	COVER-STAND BASE;UD5003 40,EO,PC+ABS,V0,	1	SNA
...4		0103-005041	RESIN-PC;V0,PC+ABS	400	SNA
...4		BN68-00513D	LABEL-RESIN;resin,-,art paper,-,10,25,-,	1	SNA
..3	AR011	BN73-00052A	RUBBER FOOT;ARES 17,CR Rubber Gray,T1.5	6	SNA

Exploded Views and Parts List

Level	Loc.	Part Code	Description & Specification	Qty.	SA/SNA
1	M0017	BN91-07724B	ASSY CHASSIS;UE40D5003BWXXC	1	SNA
..2	M0014	BN94-04940B	ASSY PCB MAIN;UE40D5003BWXXC	1	SA
...3		0202-001608	SOLDER-WIRE FLUX;LFC7-107,D0.8,99.3Sn/0.	0	SNA
...3		BN63-08541A	COVER-CI, SLOT;LD400,32,EO,HIPS,HB,BK002	1	SNA
...4		0103-004637	RESIN-HIPS;BK0020,V0,HIPS,NoN-Deca,NoN-D	3	SNA
...3		BN97-00688A	ASSY HDCP;BN46-00018A,PS-42V6S,D73A,GENE	1	SNA
...4		BN46-00018A	KEY CODE-CERTIFICATE;(HDCP KEY)PPM42M5S,	1	SNA
...3		BN97-05365A	ASSY DRM-CI PLUS;BN46-00063A,UN4D X5,X6,	1	SNA
...4		BN46-00063A	KEY CODE-CI PLUS;X5/X6,TCTC,SERIAL CODIN	1	SNA
...3		BN97-05954B	ASSY SMD;UE40D5003BWXXC,BN94-04940B	1	SNA
...4		0202-001477	SOLDER-CREAM;LST309-M,D20~45um,96.5Sn/3A	1	SNA
...4	DS01A	0401-001056	DIODE-SWITCHING;MMBD4148SE,100V,200mA,SO	2	SA
...4		0403-001180	DIODE-ZENER;BZX84C6V2,5.8-6.6V,350mW,SOT	1	SA
...4		0403-001783	DIODE-ZENER;BZB84-C6V2,5.8/6.6V,300mW,SO	3	SNA
...4		0403-001785	DIODE-ZENER;NZH5V1B,4.94/5.2V,500mW,SOD-	1	SA
...4		0403-001797	DIODE-ZENER;NZH3V0B,2.85/3.15V,500mW,SOD	1	SNA
...4	D0254	0404-001404	DIODE-SCHOTTKY;BAT721C,40V,200mA,SOT-23,	2	SA
...4	T0139	0406-001200	DIODE-TVS;RCLAMP0504F,6/-/-V,150W,SC-70	1	SA
...4	SD3	0407-000114	DIODE-SWITCHING;KDS184,80V,100mA,SOT-23,	1	SNA
...4	KQ1	0501-000279	TR-SMALL SIGNAL;KSA1182-Y,PNP,150mW,SOT-	1	SA
...4	Q101	0501-000445	TR-SMALL SIGNAL;KTC3875S-Y,NPN,150mW,SOT	11	SC
...4	CEQ2	0505-000110	FET-SILICON;2N7002,N,60V,115mA,7.5ohm,0.	2	SA
...4		0505-002893	FET-SILICON;AO4801AS,P,-30V,-5A,2W,SOIC-	1	SA
...4	IC104	0801-002630	IC-CMOS LOGIC;74AHCT1G08,2-INPUT AND GAT	1	SA
...4	ND51C2	0801-002780	IC-CMOS LOGIC;74LVC1G17,SCHMITT-TRIGGER	1	SA
...4	IC104	0801-003330	IC-CMOS LOGIC;Octal buffer,DQFN,20P,4.5x	2	SA
...4	IC104	0802-001012	IC-CMOS LOGIC;74LCX245,TRANSCEIVER,DQFN,	1	SNA
...4	IC112	1103-001310	IC-EEPROM;24LC02B,256X8BIT,SOIC,8P,3.91X	3	SNA
...4		1103-001487	IC-EEPROM;AT24C256C-SSHL-T,256Kbit,32Kx8	1	SA
...4		1105-002194	IC-DDR3 SDRAM;K4B1G1646G-BCH9,DDR3 SDRAM	2	SA
...4		1201-003153	IC-POWER AMP;NTP-7411S,MLF,48P,7x7mm,DUA	1	SA
...4		1201-003183	IC-AUDIO AMP;DRV612,HTSSOP,14P,5x4.4mm,D	1	SA
...4	T0087	1203-001815	IC-POSIFIXED REG.;78M09,TO-252,3P,PLAST	1	SA
...4	T0087	1203-002835	IC-POSIFIXED REG.;7805,3P,6.6x6.1mm,PLA	1	SA
...4	T0087	1203-002898	IC-POSIFIXED REG.;G950T45R,T0-252,3P,6.	1	SA
...4		1203-004364	IC-VOL. DETECTOR;RT9818C-42PV,SOT-23,3P,	1	SA
...4		1203-006017	IC-VOL. DETECTOR;RT9824GJ8,TSOT23,8P,2.9	1	SA
...4	IC012	1203-006138	IC-POSILADJUST REG.;AP1117DGZ-13-89,TO-2	1	SA
...4		1203-006142	IC-DC/DC CONVERTER;BD8924G,5P,2.9x1.6x1.	1	SA
...4		1203-006337	IC-POSIFIXED REG.;G9091-330T11U,SOT-23-	1	SA

Level	Loc.	Part Code	Description & Specification	Qty.	SA/SNA
...4		1203-006619	IC-DC/DC CONVERTER;AOZ1033AI,SO-8,8P,4.9	1	SA
...4		1203-006684	IC-DC/DC CONVERTER;TPS54327DDAR,HSOP8,8P	1	SNA
...4		1204-003240	IC-DECODER;SEMS20-LF,HSBGA,572P,20x20mm,	1	SNA
...4		1205-003479	IC-SWITCH;TPS2051BDBVR,SOT-23,5P,2.9x1.6	1	SA
...4		1205-003735	IC-SWITCH;AP2151WG-7,SOT25,5P,2.9x1.6mm,	1	SA
...4		1405-001271	VARISTOR;20Vdc,5A,1.0x0.5x0.6mm,TP	2	SA
...4	MR604	2007-000137	R-CHIP;2Kohm,5%,1/16W,TP,1005	9	SNA
...4	R105	2007-000138	R-CHIP;100ohm,5%,1/16W,TP,1005	22	SA
...4	AR49	2007-000140	R-CHIP;1Kohm,5%,1/16W,TP,1005	2	SNA
...4	AVR73	2007-000142	R-CHIP;2.7Kohm,5%,1/16W,TP,1005	1	SNA
...4	R319	2007-000143	R-CHIP;4.7Kohm,5%,1/16W,TP,1005	36	SNA
...4	R104	2007-000148	R-CHIP;10Kohm,5%,1/16W,TP,1005	18	SA
...4	MR36	2007-000153	R-CHIP;22Kohm,5%,1/16W,TP,1005	6	SNA
...4	AR43	2007-000155	R-CHIP;27Kohm,5%,1/16W,TP,1005	1	SNA
...4	RZ07	2007-000156	R-CHIP;30Kohm,5%,1/16W,TP,1005	3	SA
...4	MR13	2007-000157	R-CHIP;47Kohm,5%,1/16W,TP,1005	7	SNA
...4		2007-000160	R-CHIP;68Kohm,5%,1/16W,TP,1005	2	SA
...4	DR39	2007-000162	R-CHIP;100Kohm,5%,1/16W,TP,1005	4	SNA
...4	MR16	2007-000168	R-CHIP;470Kohm,5%,1/16W,TP,1005	1	SNA
...4	R509	2007-000170	R-CHIP;1Mohm,5%,1/16W,TP,1005	1	SNA
...4	R111	2007-000171	R-CHIP;0ohm,5%,1/16W,TP,1005	6	SNA
...4	HDR17	2007-000172	R-CHIP;10ohm,5%,1/16W,TP,1005	2	SNA
...4	R338	2007-000173	R-CHIP;22ohm,5%,1/16W,TP,1005	15	SNA
...4	UR23	2007-000174	R-CHIP;47ohm,5%,1/16W,TP,1005	2	SNA
...4	MR17	2007-000566	R-CHIP;220Kohm,5%,1/16W,TP,1005	1	SNA
...4	S0F0522	2007-000691	R-CHIP;3.3Mohm,5%,1/10W,TP,1608	1	SA
...4	R726	2007-000695	R-CHIP;3.3ohm,5%,1/10W,TP,1608	4	SNA
...4	R124	2007-000775	R-CHIP;33Kohm,5%,1/16W,TP,1005	2	SNA
...4	R2007	2007-000803	R-CHIP;36Kohm,1%,1/10W,TP,1608	1	SA
...4	HR10	2007-000962	R-CHIP;5.1Kohm,1%,1/10W,TP,1608	1	SA
...4	S1G0843	2007-001125	R-CHIP;68Kohm,1%,1/10W,TP,1608	1	SA
...4		2007-001168	R-CHIP;75ohm,5%,1/4W,TP,3216	1	SA
...4		2007-001285	R-CHIP;5.6ohm,5%,1/16W,TP,1005	2	SA
...4	OTR1	2007-001292	R-CHIP;33ohm,5%,1/16W,TP,1005	15	SNA
...4	DR43	2007-001298	R-CHIP;51ohm,5%,1/16W,TP,1005	2	SNA
...4	DR1	2007-001301	R-CHIP;68ohm,5%,1/16W,TP,1005	4	SA
...4	R16	2007-001313	R-CHIP;330ohm,5%,1/16W,TP,1005	2	SNA
...4	R326	2007-001325	R-CHIP;3.3Kohm,5%,1/16W,TP,1005	1	SNA
...4		2007-001333	R-CHIP;18Kohm,5%,1/16W,TP,1005	2	SNA
...4	PR24	2007-002970	R-CHIP;56ohm,5%,1/16W,TP,1005	4	SA

Exploded Views and Parts List

Level	Loc.	Part Code	Description & Specification	Qty.	SA/SNA
...4	HDR8	2007-007095	R-CHIP;390ohm,5%,1/16W,TP,1005	1	SA
...4	DR4	2007-007142	R-CHIP;10Kohm,1%,1/16W,TP,1005	19	SNA
...4		2007-007156	R-CHIP;1ohm,5%,1/16W,TP,1005	5	SNA
...4		2007-007311	R-CHIP;22Kohm,1%,1/16W,TP,1005	1	SA
...4		2007-007318	R-CHIP;1Kohm,1%,1/16W,TP,1005	18	SNA
...4		2007-007463	R-CHIP;1.1Kohm,1%,1/16W,TP,1005	1	SA
...4		2007-007517	R-CHIP;240ohm,1%,1/16W,TP,1005	2	SNA
...4		2007-007766	R-CHIP;2Kohm,1%,1/16W,TP,1005	2	SNA
...4	MR11	2007-008015	R-CHIP;75ohm,1%,1/16W,TP,1005	6	SNA
...4		2007-008649	R-CHIP;220ohm,1%,1/16W,TP,1005	1	SNA
...4	DRP29	2011-000515	R-NETWORK;4.7Kohm,5%,1/16W,L,CHIP,8P,TP,	1	SA
...4	ZRN10	2011-001261	R-NETWORK;33ohm,5%,1/16W,L,CHIP,8P,TP,2.	6	SA
...4	DAR09	2011-001262	R-NETWORK;22ohm,5%,1/16W,L,CHIP,8P,TP,2.	26	SA
...4		2011-001264	R-NETWORK;10ohm,5%,1/16W,L,CHIP,8P,TP,2.	4	SNA
...4	HRP2	2011-001344	R-NETWORK;100ohm,5%,1/16W,L,CHIP,8P,TP,2	2	SA
...4		2011-001449	R-NETWORK;22ohm,5%,1/16W,L,4P,TP,1010	3	SA
...4		2011-001587	R-NETWORK;100ohm,5%,1/16W,L,CHIP-V,4P,TP	1	SNA
...4	PC43	2203-000233	C-CER,CHIP;0.1nF,5%,50V,C0G,TP,1005	7	SA
...4	MC9	2203-000359	C-CER,CHIP;0.15nF,5%,50V,C0G,TP,1005,0.5	1	SNA
...4	C254	2203-000438	C-CER,CHIP;1nF,10%,50V,X7R,TP,1005	11	SA
...4	C507	2203-000489	C-CER,CHIP;2.2nF,10%,50V,X7R,TP,1005	5	SA
...4	AD480	2203-000530	C-CER,CHIP;2.7nF,10%,50V,X7R,TP,1005,-	1	SNA
...4	V1233	2203-000575	C-CER,CHIP;220nF,10%,25V,X7R,TP,2012	2	SNA
...4	AD480	2203-000714	C-CER,CHIP;3.3nF,10%,50V,X7R,TP,1005,-	6	SA
...4	DC25	2203-000812	C-CER,CHIP;0.033nF,5%,50V,C0G,TP,1005	2	SA
...4	AD480	2203-000995	C-CER,CHIP;0.047nF,5%,50V,C0G,TP,1005	2	SA
...4	AD480	2203-001412	C-CER,CHIP;0.03nF,5%,50V,NP0,1005	2	SNA
...4	AD480	2203-001428	C-CER,CHIP;470nF,10%,50V,X7R,TP,2012	2	SNA
...4	AD480	2203-002285	C-CER,CHIP;10nF,10%,50V,X7R,TP,1005	10	SNA
...4	AD480	2203-002525	C-CER,CHIP;0.56nF,10%,50V,X7R,TP,1005	2	SNA
...4	AAC1	2203-005249	C-CER,CHIP;100nF,10%,50V,X7R,TP,1608	11	SNA
...4	AD480	2203-005344	C-CER,CHIP;22nF,10%,25V,X7R,TP,1005,0.5T	1	SNA
...4	VC37	2203-006048	C-CER,CHIP;100nF,10%,10V,X7R,TP,1005	94	SA
...4	AD480	2203-006126	C-CER,CHIP;47nF,10%,16V,X7R,TP,1005	15	SNA
...4	C102	2203-006158	C-CER,CHIP;100nF,10%,16V,X7R,TP,1005,0.5	6	SNA
...4	JC10	2203-006324	C-CER,CHIP;2200nF,10%,10V,X5R,1608	4	SA
...4	C802	2203-006348	C-CER,CHIP;1000nF,10%,25V,X5R,TP,1608,0.	1	SA
...4	C125	2203-006361	C-CER,CHIP;10000nF,10%,10V,X5R,TP,2012	14	SC
...4	C234	2203-006378	C-CER,CHIP;4700nF,10%,6.3V,X5R,TP,1608	1	SNA
...4	HE4	2203-006474	C-CER,CHIP;22000nF,20%,6.3V,X5R,2012	10	SA

Level	Loc.	Part Code	Description & Specification	Qty.	SA/SNA
...4	HDC11	2203-006562	C-CER,CHIP;1000nF,10%,10V,X5R,TP,1005	15	SNA
...4	AD480	2203-006824	C-CER,CHIP;4700nF,10%,10V,X5R,1608	1	SNA
...4	C23	2203-006890	C-CER,CHIP;10000nF,20%,6.3V,X5R,1608	18	SNA
...4	AD480	2203-006992	C-CER,CHIP;0.33nF,5%,50V,COG,TP,1005	2	SNA
...4	AD480	2203-007176	C-CER,CHIP;10000nF,10%,16V,X5R,TP,2012,1	10	SNA
...4	AD480	2203-007230	C-CER,CHIP;47000nF,20%,6.3V,X5R,TP,2012,	2	SA
...4	AD480	2203-007233	C-CER,CHIP;22000nF,10%,16V,X5R,TP,3216,1	4	SA
...4	T0052	2703-000158	INDUCTOR-SMD;1uH,10%,2012	4	SA
...4	T0052	2703-003149	INDUCTOR-SMD;2.2uH,20%,5050	1	SA
...4		2703-003407	INDUCTOR-SMD;120nH,5%,1608	1	SA
...4	T0052	2703-003790	INDUCTOR-SMD;4.7uH,20%,8080	1	SA
...4		2703-003890	INDUCTOR-SMD;47uH,10%,3225	1	SC
...4		2703-003930	INDUCTOR-SMD;4.7uH,20%,5050	4	SA
...4	X202	2801-003326	CRYSTAL-SMD;24MHz,30ppm,28-ABX,20pF,50oh	1	SA
...4	F103	2901-001506	FILTER-EMI SMD;5V,0.13A,0pF,2x1x0.5mm,TP	2	SA
...4	DR32	3301-000314	BEAD-SMD;120ohm,1.6x0.8x0.8mm,-,-,-	5	SNA
...4	T0568	3301-002039	BEAD-SMD;26ohm,1608,TP	33	SA
...4		3701-001591	CONNECTOR-HDMI;19P,2ROW,FEMALE,SMD-S,AU	2	SC
...4		3709-001670	CONNECTOR-CARD SLOT;68P,1.27mm,stamp,AU,	1	SA
...4	HB01A	3711-005601	HEADER-BOARD TO CABLE;BOX,8P,1R,2mm,SMD-	1	SA
...4	HB01A	3711-005925	HEADER-BOARD TO CABLE;BOX,51P,1R,0.5mm,S	1	SA
...4		3711-007569	CONNECTOR-HEADER;BOX,14P,2R,2.0mm,DIP,SN	1	SA
...4		3711-007584	CONNECTOR-HEADER;BOX,4P,1R,2.0mm,STRAIGH	1	SA
...4		3711-007585	CONNECTOR-HEADER;BOX,4P,1R,2.5mm,ANGLE-D	1	SA
...4		3719-001755	CONNECTOR-ACCESSORY;HOLDER-PCB,SPTE 0.5	1	SA
...4		3722-003226	JACK-PHONE;7P/1C,SN,BLK	2	SNA
...4		3722-003248	JACK-USB;4P/1C(W/L),NI/PD/AU/SN,BLK,STRA	1	SA
...4		3722-003252	JACK-SCART;21P,Sn,BLK	1	SA
...4	ET01	BN40-00220A	TUNER;DTM-8B/125S,DTM-8B/125S,DVB-T Half	1	SA
...4		BN41-01702A	PCB MAIN;x5_dvb_reverse_common,FR-4,4,1.	1	SNA
...4		BN97-05856A	ASSY MICOM;U57E/U57F/U56G,2011.03.02,Sub	1	SNA
....5		1107-001938	IC-FLASH MEMORY;W25X40BVSSIG,4Mbit,SOP,8	1	SNA
...4		BN97-05958A	ASSY MICOM-E-MANUAL;U57E/U57F/U56G,T-MSU	1	SNA
....5		1107-001990	IC-NAND FLASH;KFG1GN6W2D-HIB6,1Gbit,64Mx	1	SA
....5		BN46-00090A	S/W MICOM;T-MSU4DEUC-XXXX,EU/AU/SH/MV/AB	1	SNA
....5		BN46-00094D	S/W-E-MANUAL;ALL,DVB EU4,XC XN ZF ZG ZT	1	SNA
..3	T0066	BP62-00017A	HEAT SINK-ES;SP-50L2HX,A6063S,T2.0,26.2,	1	SNA
1		BN91-07727A	ASSY SHIELD;UE40D5003BWXXC	1	SNA
.2	CIS1	0203-001586	TAPE-FILAMENT;#893,0.15,30,55,WHT,FILAME	0	SNA
.2	M-P	6001-002653	SCREW-MACHINE;BH,+,M3,L6,ZPC(WHT),SWRCH1	11	SA

Exploded Views and Parts List

Level	Loc.	Part Code	Description & Specification	Qty.	SA/SNA
.2	SCREW	6003-001782	SCREW-TAPTYPE;BH,+ ,B,M4,L12,ZPC(BLK),SWR	2	SA
.2	EC13	BN39-01455K	LEAD CONNECTOR;UN40D5003,Flat Connector	1	SA
.2	P001A	BN44-00473A	DC VSS-LED TV PD BD;PD46G0_BSM,PSLF121A0	1	SA
.2	RB01	BN63-07807C	COVER-BOTTOM;UD5000 37,NH HIPS,V1,BK0020	1	SNA
..3		0103-007489	RESIN-HIPS;FT875,BK,BK0020,V1,HIPS	70	SNA
..3		BN68-00513D	LABEL-RESIN;resin,-,art paper,-,10,25,-,	1	SNA
.2		BN67-00307A	RUBBER-FOOT;LE40D503,RUBBER,20X20,5T,20X	1	SNA
.2	FL06	BN96-17116M	ASSY CABLE P-FFC;UN40D5003,FFC,294mm,51P	1	SA
.2	SP01A	BN96-19642A	ASSY SPEAKER P;6ohm,4pin,10W,Low_LED_40"	1	SA
1		BN91-07732A	ASSY LCD-CMO;BN07-00990B	1	SNA
.2	PANEL	BN07-00990B	LCD-PANEL;LD400BGC-C2,CLL6BC3,8 bits,40	1	SA
1		BN92-08804G	ASSY BOX;UD5003 40	1	SNA
.2		BH68-00662A	LABEL BOX-00;ALL MODEL,MOJO 90G,60,110,W	1	SNA
.2		BN69-06633E	BOX-SET;40DU5003-PS,CB,A-01,SW2,YEL,W117	1	SNA
1		BN92-08806A	ASSY P/MATERIAL;UD5003 40	1	SNA
.2		6902-000379	BAG AIR;LDPE,T0.2,W1000,L1800,TRP,1260.0	1	SNA
.2	M040	6922-000003	BAND PP;PP,T0.8,W18,L1650M,TRP,DA69-9014	1012	SNA
.2		BN68-02422B	LABEL-WARNING SHIPPING;ALL MODEL,A/P 100	1	SNA
.2		BN69-00257B	PACKING-PAD;- ,PAPER,-,-,CB-SW4,1100,790,	1	SNA
.2		BN69-00257W	PACKING-SHEET PALLET;PACKING SHEET PALLE	1	SNA
.2		BN69-03982E	PAD PACKING-EDGE;LB6T,PAPER,8,120,2060,Y	1	SNA
.2		BN69-05181G	PALLET;PALLET,WOOD,910,1200,135,15000,HU	1	SNA
.2		BN69-05418A	PACKING-BAG WRAPPING;- ,LDPE,-,0,019,500,	2	SNA
.2		BN69-06592A	CUSHION-SET;UD3900 40",EPS	1	SNA
.2		BN69-06681A	PACKING-BAG SHEET ROLL;- ,CB,-,FOAM 0,5mm	2	SNA
.2		BN74-00008D	TAPE-OPP MASKING;OPP,T0.05,W75,L800M,CLR	3	SNA
1		BN92-08867B	ASSY LABEL;UE40D5003BWXXC	1	SNA
.2	CCM1	BN68-01176A	LABEL RATING;W/W,SS,PET POLYESTER,T0.05,	1	SNA
.2		BN68-03783K	LABEL-STICKER;UD5B,PET,T0.05,60,120,Ener	1	SNA
1	ACCE1	BN92-08881T	ASSY ACCESSORY;UE40D5003BWXXZG	1	SNA
.2	ACCE4	BN96-19963T	ASSY ACCESSORY-MANUAL;UE40D5003BWXXZG	1	SNA
..3		6902-000476	BAG PE;LDPE,T0.03,W250,L350,TRP,Recycle,	1	SNA
..3		BN68-00514K	MANUAL FLYER-WARRANTY CARD;comm,Samsung,	1	SNA
..3		BN68-03019A	LEAFLET-SAFETY GUIDE;ALL,SAMSUNG,28LENGS	1	SNA
..3		BN68-03713C	MANUAL USERS;UD4003 UD5003,SAMSUNG,ENG/D	1	SNA
.2	ACCE2	BN96-19963X	ASSY ACCESSORY-CABEL;UE40D5003BWXXN	1	SNA
..3	EC11	3903-000525	CBF-POWER CORD;DT,CEE,LP-21L,250V,2.5A,B	1	SA
..3	T0120	4301-000121	BATTERY-MN;1.5V,R03,10.5x44.5m,HOLDER,7.	2	SNA
..3		6902-001340	BAG PE;LDPE,T0.05,W250,L350,TRP,RECYCLE	1	SNA
..3	REMO2	AA59-00496A	REMOCON;TM940,39,3V,EUROPE iDTV,400	1	SA

Level	Loc.	Part Code	Description & Specification	Qty.	SA/SNA
..3		BN61-05491A	HOLDER-WIRE STAND;UB7000 46inch,NYRON	1	SNA
..3	M9889	BN63-01798B	CLOTH-CLEAN;cloth,180,200,sea blue,ToC	1	SNA
..3	T0527	BN68-00513A	LABEL-E,PASS;ALL MODEL,YUPO(110G),50X15,	1	SNA