

5. Exploded View & Part List

5-1. UE40B6000VP Exploded View

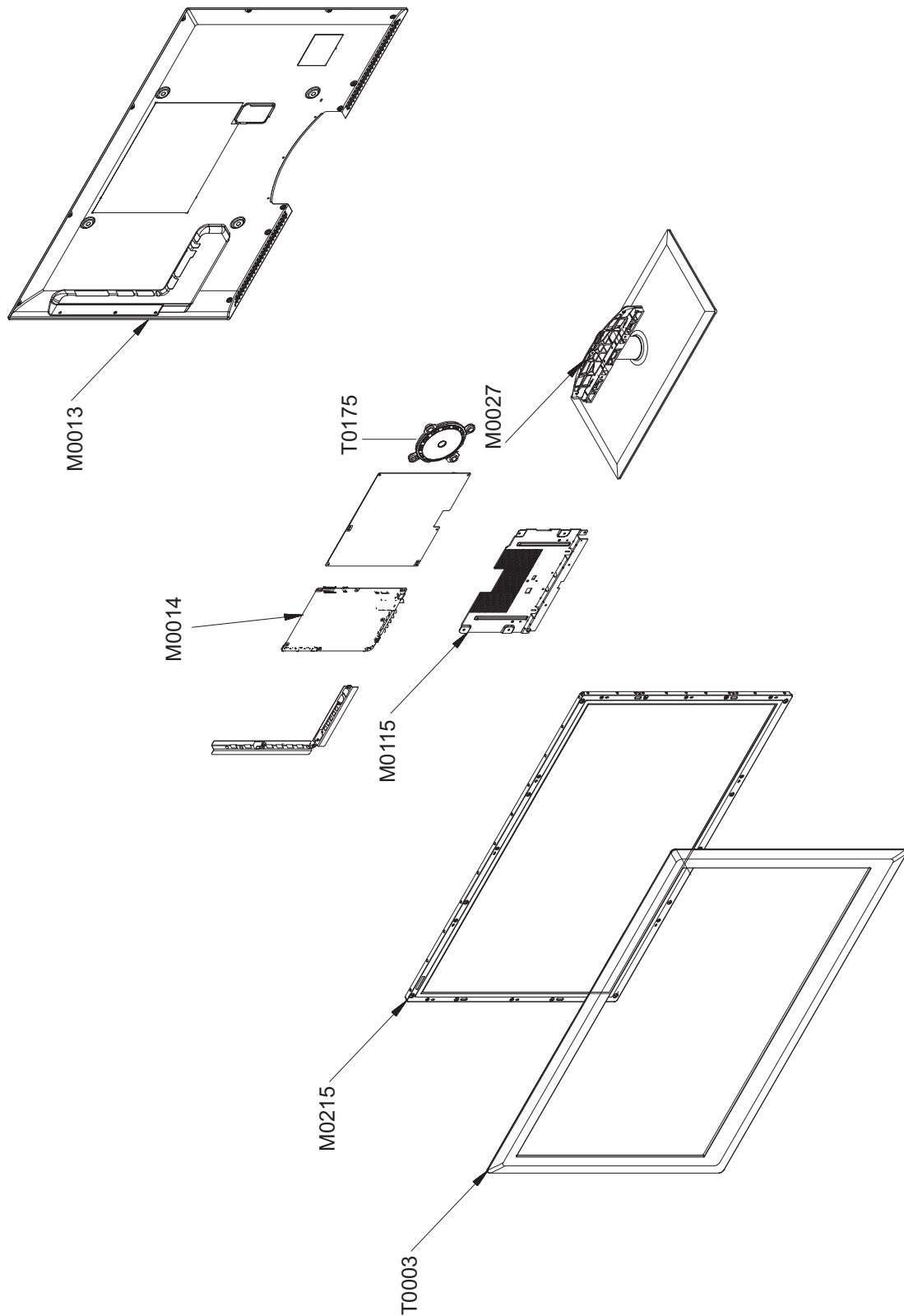

5-1-1. UE40B6000VP Parts List

Location No.	Code No.	Description & Specification	Q'ty	S.A/S.N.A	Remark
T0003	BN96-09980A	ASSY COVER P-FRONT;UB6000 40,PMMA(CLR)+A	1	S.N.A	
M0215	BN07-00700B	LCD-PANEL;LTF400HF08	1	S.A	
	BN07-00734A	LCD-PANEL;LTF400HF08	1	S.A	
T0175	BN96-09470A	ASSY SPEAKER P;8ohm,4pin,15W,R:800 / L:8	1	S.N.A	
	BN96-11608A	ASSY SPEAKER P;8ohm,4pin,15W,R:600,09 LE	1	S.A	
M0115	BN61-04925A	BRACKET-STAND LINK;LB700 40,SECC,T2.0	1	S.N.A	
M0014	BN94-02761B	ASSY PCB MAIN-SQE;UE40B6000VPX*	1	S.A	
M0013	BN96-09981J	ASSY COVER P-REAR;LB6000 40inch,EUROPE,P	1	S.A	
M0027	BN96-10600A	ASSY STAND P-BASE;40 UB6000,ROSE BLACK,P	1	S.N.A	

5-2. UE40B6000VP Parts List

Service Bom (SA: SERVICE AVAILABLE, SNA: SERVICE NOT AVAILABLE)

Level	Location No.	Code No.	Description & Specification	Q'ty	SA/SNA	Remark
		UE40B6000VPXZG	UE40B6000VP,N74A/40BV1-G6V,40,LCD-TV,GER			
0.1	M0002	BN90-02093B	ASSY COVER REAR;UB6000 40	1	S.N.A	
..2	C/REAR+PAN	6003-000133	SCREW-TAPTYPE;BH,+,-,S,M4,L8,ZPC(BLK),SW	2	S.N.A	
..2	M0013	BN96-09981J	ASSY COVER P-REAR;LB6000 40inch,EUROPE,P	1	S.A	
...3	T0069	AA60-00091H	SPACER-FELT;FELT,150X10,BLK,T1.0	3	S.N.A	
...3	M0006	BN63-05321B	COVER-REAR;UB7000 40,PCM,T0.5,BKN-P824	1	S.A	
...3	T0069	AA63-60131R	SPACER-FELT;21Z57,FELT,325,T0.35,7	2	S.N.A	
...3	M0131	BN96-10996A	ASSY MISC P;LEDTV,40/46 6000/7000	1	S.N.A	
...4	T0278	BN60-00122A	SPACER-SPONGE;UB7000,CR,L265,T2.0,W10	2	S.N.A	
...3	M0279	BN63-00870A	FELT;AS17UO,FELT,0.3,10,287	1	S.N.A	
..2	T0081	6001-000799	SCREW-MACHINE;BH,+,-,M3,L5,ZPC(BLK),SWRCH1	3	S.N.A	
..2	H/CORD+PAN	6003-000337	SCREW-TAPTYPE;BH,+,-,S,M4,L10,ZPC(BLK),SWR	1	S.N.A	
..2	C/REAR+C/F	6003-001003	SCREW-TAPTYPE;BH,+,-,B,M4,L12,ZPC(BLK),SWR	12	S.N.A	
..2	C/REAR+PAN	6011-001815	BOLT-ETC;M8,L12,ZPC(Black),SWRCH18A,WSP,	4	S.N.A	
..2		BN61-04922A	HOLDER-CORD;LB7000 46,ABS,V0,BLK	1	S.N.A	
...3		BN81-00199F	RESIN;HIPS V0,BK500,VE-1872,K2901(K2295)	0.05	S.N.A	
...3		BN81-00204R	RESIN;NT-7200,K2901,ABS V0,BK19,-,-,-	0.05	S.N.A	
0.1	M0216	BN90-02121A	ASSY STAND;PB560 42	1	S.N.A	
..2	M0027	BN96-10600A	ASSY STAND P-BASE;40 UB6000,ROSE BLACK,P	1	S.N.A	
...3	B/S/BOT+G/	6003-001003	SCREW-TAPTYPE;BH,+,-,B,M4,L12,ZPC(BLK),SWR	6	S.N.A	
...3	G/STAND+G/	6003-001003	SCREW-TAPTYPE;BH,+,-,B,M4,L12,ZPC(BLK),SWR	4	S.N.A	
...3		BN61-04731B	BOSS-TAPE;AMBER,ACRYL,T1.1,W12.0mm,WHITE	0.29	S.N.A	
...3		BN61-05493A	HOLDER-SWIVEL RING BOTTOM;LB650 40,Aceta	1	S.N.A	
...3		BN63-05781B	COVER-STAND GLASS;37,40,LB650,GLASS,T8.0	1	S.A	
...3	CCM1	BN63-04755A	COVER-SHEET;AMBER,PE,T0.05,W150mm,200M,6	1.14	S.N.A	
...3	M0126	BN73-00215A	RUBBER-FOOT;40LB650,RUBBER,15*25,60,4.0,	2	S.N.A	
...3	M0126	BN73-00217A	RUBBER-FOOT;LB650,RUBBER,DIA30,7.5,Dark	4	S.N.A	
...3	T0920	BN61-04927A	GUIDE-STAND;LB700 46,PET+PC,G/F(15%) V2	1	S.N.A	
...4		BN81-00204H	RESIN;Trirex,3025G20 BK,PC G/F 20%,4249P	0.45	S.N.A	
...3		BN61-05251A	GUIDE-STAND NECK;LB700 46,PC,CLEAR(TP27)	1	S.N.A	
...4		BN61-05268A	HOLDER-INSERT;46 LB750,PC, EXTRUSION,CLE	1	S.N.A	
...4		BN81-00116J	RESIN;PC CLEAR,SC-1220R/70918,HF-1130R,	0.15	S.N.A	
...3	T0056	BN63-05538A	COVER-DECORATION;UB7000 46inch,ABS,PMMA,	1	S.N.A	
...4		BN81-03206A	RESIN;ABS+PMMA,SF-0503,K21294	0.013	S.N.A	
...3		BN61-05244A	BRACKET-SWIVEL BOTTOM;LB700 46,HGI,T3.0	1	S.N.A	
...3		BN61-05652A	BRACKET-STAND BOTTOM;B650 40,SECC,T2.0	1	S.N.A	
...3		BN61-05826A	BOSS-BOND;#760,Poly urethane,Black	1.2	S.N.A	
...3		BN61-04692A	BOSS-PRIMER;#94,clear,35cps	0.1	S.N.A	
...3		BN61-05240A	HOLDER-SWIVEL RING TOP;LB700 46,POM HB,A	1	S.N.A	
...3		BN74-00031A	GREASE;kanto-kasei FL-955,grease,wht	0.4	S.N.A	
0.1	M0001	BN90-02130A	ASSY COVER FRONT;UB6000 40	1	S.N.A	
..2	T0003	BN96-09980A	ASSY COVER P-FRONT;UB6000 40,PMMA(CLR)+A	1	S.N.A	
...3		BN61-04661A	BRACKET-STOPPER;L650,SK-5,T0.4,Plating,H	4	S.N.A	
...3	CCM1	BN63-02183E	COVER-SHEET;Rhcm,PE Vinyl,T0.05,750mm,20	0.85	S.N.A	
...3	CCM1	BN63-05199B	COVER-SHEET;AMBER,PE,T0.08,W65mm,200M,CL	2.8	S.N.A	
...3	CCM1	BN63-05199F	COVER-SHEET;AMBER,PE,T0.08,W95mm,200M,CL	1.2	S.N.A	

5. Exploded View & Part List

Level	Location No.	Code No.	Description & Specification	Q'ty	SA/SNA	Remark
...3		BN96-10736E	ASSY BOARD P-TOUCH FUNCTION&PO;LN40B7100	1	S.A	
...3	T0175	BN96-09470A	ASSY SPEAKER P;8ohm,4pin,15W,R:800 / L:8	1	S.N.A	
...3		BN64-01021A	DECORATION-BOTTOM;UB6000,PC,clear,Hot st	1	S.N.A	
...3	T0382	BP61-00495C	HOLDER-CARE;PJT,ACRYL-FOAM,T0.25,W30.0mm	0.16	S.N.A	
...3	T0069	BN60-00120A	SPACER-FELT;UB7000 46inch,FELT,L16,T0.5,	4	S.N.A	
...3		BN63-01925A	FELT-VIBRATION;42D5,FELT,T0.35,10,370	2	S.N.A	
...3	M0112	BN63-05322A	COVER-FRONT;UB6000 40,PMMA(CLEAR)+ABS-PM	1	S.A	
...4		BN81-00116D	RESIN-TOC;PC V0,TTP01,CLR,TN-1030(NP),TH	0.843	S.N.A	
...4		BN81-00116U	RESIN-TOC;PC V1, TRD03,Light Rose Black,	0.924	S.N.A	
...3		BN96-09978B	ASSY HOLDER P-BOSS;LB7000 40inch,ABS HB,	1	S.N.A	
...4		BN61-04692A	BOSS-PRIMER,#94,clear,35cps	0.001	S.N.A	
...4		BN61-03261Z	BOSS-TAPE;T1.1,W16,DARK GRAY 3M #4711,VH	0.52	S.N.A	
...4		BN61-05728A	BOSS-TAPE;UB7000,T0.4,W10,DARK GRAY	0.288	S.N.A	
...4	T0069	AA60-00091E	SPACER-FELT;FELT,100X10,BLK,T0.5	1	S.N.A	
...4		BN61-05236B	HOLDER-BOSS BOTTOM;UB7000 40,ABS,BK500,H	1	S.N.A	
....5		BN81-00199K	RESIN;ABS HB,HF-0680U,BK19,K2901,Venice,	0.205	S.N.A	
...3	T0069	AA60-00091H	SPACER-FELT;FELT,150X10,BLK,T1.0	3	S.N.A	
...3	T0069	AA60-00091P	SPACER-FELT;,FELT,500X10,BLK,T0.5	2	S.N.A	
0.1	M0112	BN91-03737A	ASSY SHIELD;UE40B6000VWXXC	1	S.N.A	
..2	B/LINK+PAN	6003-000133	SCREW-TAPTYPE;BH,+,-,S,M4,L8,ZPC(BLK),SW	4	S.N.A	
..2	M2893	BN39-01099M	LEAD CONNECTOR;UN40B7000WF,UL1007#26,30	1	S.A	
..2	CCMM1	BN73-00210A	SILICON/RUBBER;UE40B7000WWXXC,SILICON+PO	1	S.N.A	
..2		BN73-00211A	SILICON/RUBBER-GAPPAD;UE40B7000WWXXC,SIL	1	S.N.A	
..2	T0081	6001-002283	SCREW-MACHINE;BH,+,M3,L5,ZPC(WHT),SWRCH1	7	S.N.A	
..2	T0081	6001-002283	SCREW-MACHINE;BH,+,M3,L5,ZPC(WHT),SWRCH1	5	S.N.A	
..2	PANEL+C/FR	6003-001003	SCREW-TAPTYPE;BH,+,B,M4,L12,ZPC(BLK),SWR	4	S.N.A	
..2	WOOFER+PAN	6003-001748	SCREW-TAPTYPE;BH,+,WP,S,M4,L10,ZPC(BLK),	2	S.N.A	
..2	T0081	6001-002289	SCREW-MACHINE;BH,+,WT,M4,L6,ZPC(WHT),SWR	1	S.A	
..2	T0444	BN96-11322A	ASSY BRACKET P-STAND LINK;UB7000 40,SECC	1	S.N.A	
...3	M0131	BN63-02722A	GASKET;LS40BHT,Conductive Fabric,2 mm,8	1	S.N.A	
...3	M0115	BN61-04925A	BRACKET-STAND LINK;LB700 40,SECC,T2.0	1	S.N.A	
..2	M0230	BN96-10889C	ASSY CABLE P-FPCB LVDS;UN40B7000WFXZA,FP	1	S.A	
..2	T0175	BN96-11608A	ASSY SPEAKER P;8ohm,4pin,15W,R:600,09 LE	1	S.A	
..2	T0066	BN96-09872K	ASSY POWER CORD;BK,LP-45,250/10A,Y,BLK,H	1	S.A	
..2		BN44-00269A	SMPS-PD;PSLF171B01A,PD4612F1,AC/DC,211W,	1	S.A	
	T0175	BN96-11609A	ASSY SPEAKER P;8ohm,4pin,15W,R:800/L:400	1	S.A	
0.1		BN91-03834F	ASSY LCD-AMLCD;BN07-00700B,SPVA 82%	1	S.N.A	
..2	M0215	BN07-00700B	LCD-PANEL;LTF400HF08	1	S.A	
...3		BN81-02357A	A/S-T CON LTF400HF05;LTF400HF05	1	S.N.A	
	T0174	BN97-03207G	ASSY SMD;UE46B6000VWX*,BN94-02662G	1	S.N.A	
0.1	M0017	BN91-04358B	ASSY CHASSIS;UE40B6000VPX*	1	S.N.A	
..2	M0014	BN94-02761B	ASSY PCB MAIN-SQE;UE40B6000VPX*	1	S.A	
...3	CIPLUS	BN97-03631A	ASSY HDCP;BN46-00023A,LB5K,LB6T,LB6A,LB7	1	S.N.A	
...4		BN46-00023A	KEY CODE-CI PLUS KEY;CI PLUS KEY,TCTC,SE	1	S.N.A	
...3	T0174	BN97-03644B	ASSY SMD;UE40B6000VPX*,BN94-02761B	1	S.N.A	
...4	M0018	BN97-03212C	ASSY MICOM;N68A,2009.03.27,T-CHL5CIPDEUC	1	S.N.A	
....5	IC7002	1107-001818	IC-NAND FLASH;KFG1G16U2C-DIB6,1024Mbit,6	1	S.A	
...4	CCMM1	BN97-03411A	ASSY MICOM-SUB;61P8E-RG480WT,N74A,2009.1	1	S.N.A	
....5	IC520	0903-001590	IC-MICROCONTROLLER;61P8E-RG480WT,LQFP,48	1	S.A	
...4	SUB05	0202-001477	SOLDER-CREAM;LST309-M,D20~45um,96.5Sn/3A	0.384	S.N.A	

5. Exploded View & Part List

Level	Location No.	Code No.	Description & Specification	Q'ty	SA/SNA	Remark
...4	D2001	0401-001049	DIODE-SWITCHING;LS4148,75V,150mA,SOD-80,	1	S.A	
...4	D4003	0401-001049	DIODE-SWITCHING;LS4148,75V,150mA,SOD-80,	1	S.A	
...4	D4004	0401-001049	DIODE-SWITCHING;LS4148,75V,150mA,SOD-80,	1	S.A	
...4	D4100	0401-001049	DIODE-SWITCHING;LS4148,75V,150mA,SOD-80,	1	S.A	
...4	D4101	0401-001049	DIODE-SWITCHING;LS4148,75V,150mA,SOD-80,	1	S.A	
...4	D4102	0401-001049	DIODE-SWITCHING;LS4148,75V,150mA,SOD-80,	1	S.A	
...4	D4228	0401-001049	DIODE-SWITCHING;LS4148,75V,150mA,SOD-80,	1	S.A	
...4	D4229	0401-001049	DIODE-SWITCHING;LS4148,75V,150mA,SOD-80,	1	S.A	
...4	D3001	0401-001056	DIODE-SWITCHING;MMBD4148SE,100V,200mA,SO	1	S.A	
...4	D3002	0401-001056	DIODE-SWITCHING;MMBD4148SE,100V,200mA,SO	1	S.A	
...4	D3051	0401-001056	DIODE-SWITCHING;MMBD4148SE,100V,200mA,SO	1	S.A	
...4	D3054	0401-001056	DIODE-SWITCHING;MMBD4148SE,100V,200mA,SO	1	S.A	
...4	D3061	0401-001056	DIODE-SWITCHING;MMBD4148SE,100V,200mA,SO	1	S.A	
...4	D3062	0401-001056	DIODE-SWITCHING;MMBD4148SE,100V,200mA,SO	1	S.A	
...4	D3063	0401-001056	DIODE-SWITCHING;MMBD4148SE,100V,200mA,SO	1	S.A	
...4	D3076	0401-001056	DIODE-SWITCHING;MMBD4148SE,100V,200mA,SO	1	S.A	
...4	D3077	0401-001056	DIODE-SWITCHING;MMBD4148SE,100V,200mA,SO	1	S.A	
...4	D3079	0401-001056	DIODE-SWITCHING;MMBD4148SE,100V,200mA,SO	1	S.A	
...4	D3080	0401-001056	DIODE-SWITCHING;MMBD4148SE,100V,200mA,SO	1	S.A	
...4	D4008	0401-001056	DIODE-SWITCHING;MMBD4148SE,100V,200mA,SO	1	S.A	
...4	D4010	0401-001056	DIODE-SWITCHING;MMBD4148SE,100V,200mA,SO	1	S.A	
...4	D5001	0401-001099	DIODE-SWITCHING;1N4148WS,75V,150mA,SOD-3	1	S.N.A	
...4	D4001	0403-000002	DIODE-ZENER;VLZ5V6B,5.45/5.73V,500mW,SOD	1	S.A	
...4	D5011	0403-000002	DIODE-ZENER;VLZ5V6B,5.45/5.73V,500mW,SOD	1	S.A	
...4	D3003	0403-001180	DIODE-ZENER;BZX84C6V2,5.8-6.6V,350mW,SOT	1	S.A	
...4	D3004	0403-001180	DIODE-ZENER;BZX84C6V2,5.8-6.6V,350mW,SOT	1	S.A	
...4	D3005	0403-001180	DIODE-ZENER;BZX84C6V2,5.8-6.6V,350mW,SOT	1	S.A	
...4	D3006	0403-001180	DIODE-ZENER;BZX84C6V2,5.8-6.6V,350mW,SOT	1	S.A	
...4	D3007	0403-001180	DIODE-ZENER;BZX84C6V2,5.8-6.6V,350mW,SOT	1	S.A	
...4	D3008	0403-001180	DIODE-ZENER;BZX84C6V2,5.8-6.6V,350mW,SOT	1	S.A	
...4	D3009	0403-001180	DIODE-ZENER;BZX84C6V2,5.8-6.6V,350mW,SOT	1	S.A	
...4	D3011	0403-001180	DIODE-ZENER;BZX84C6V2,5.8-6.6V,350mW,SOT	1	S.A	
...4	D3015	0403-001180	DIODE-ZENER;BZX84C6V2,5.8-6.6V,350mW,SOT	1	S.A	
...4	D3016	0403-001180	DIODE-ZENER;BZX84C6V2,5.8-6.6V,350mW,SOT	1	S.A	
...4	D3018	0403-001180	DIODE-ZENER;BZX84C6V2,5.8-6.6V,350mW,SOT	1	S.A	
...4	D3019	0403-001180	DIODE-ZENER;BZX84C6V2,5.8-6.6V,350mW,SOT	1	S.A	
...4	D3020	0403-001180	DIODE-ZENER;BZX84C6V2,5.8-6.6V,350mW,SOT	1	S.A	
...4	D3021	0403-001180	DIODE-ZENER;BZX84C6V2,5.8-6.6V,350mW,SOT	1	S.A	
...4	D3023	0403-001180	DIODE-ZENER;BZX84C6V2,5.8-6.6V,350mW,SOT	1	S.A	
...4	D3024	0403-001180	DIODE-ZENER;BZX84C6V2,5.8-6.6V,350mW,SOT	1	S.A	
...4	D3028	0403-001180	DIODE-ZENER;BZX84C6V2,5.8-6.6V,350mW,SOT	1	S.A	
...4	D3029	0403-001180	DIODE-ZENER;BZX84C6V2,5.8-6.6V,350mW,SOT	1	S.A	
...4	D3039	0403-001180	DIODE-ZENER;BZX84C6V2,5.8-6.6V,350mW,SOT	1	S.A	
...4	D3045	0403-001180	DIODE-ZENER;BZX84C6V2,5.8-6.6V,350mW,SOT	1	S.A	
...4	D3056	0403-001180	DIODE-ZENER;BZX84C6V2,5.8-6.6V,350mW,SOT	1	S.A	
...4	D3057	0403-001180	DIODE-ZENER;BZX84C6V2,5.8-6.6V,350mW,SOT	1	S.A	
...4	D3058	0403-001180	DIODE-ZENER;BZX84C6V2,5.8-6.6V,350mW,SOT	1	S.A	
...4	D3060	0403-001180	DIODE-ZENER;BZX84C6V2,5.8-6.6V,350mW,SOT	1	S.A	
...4	D3065	0403-001180	DIODE-ZENER;BZX84C6V2,5.8-6.6V,350mW,SOT	1	S.A	
...4	D3066	0403-001180	DIODE-ZENER;BZX84C6V2,5.8-6.6V,350mW,SOT	1	S.A	
...4	D3067	0403-001180	DIODE-ZENER;BZX84C6V2,5.8-6.6V,350mW,SOT	1	S.A	

5. Exploded View & Part List

Level	Location No.	Code No.	Description & Specification	Q'ty	SA/SNA	Remark
...4	D3068	0403-001180	DIODE-ZENER;BZX84C6V2,5.8-6.6V,350mW,SOT	1	S.A	
...4	D3069	0403-001180	DIODE-ZENER;BZX84C6V2,5.8-6.6V,350mW,SOT	1	S.A	
...4	D3073	0403-001180	DIODE-ZENER;BZX84C6V2,5.8-6.6V,350mW,SOT	1	S.A	
...4	D3074	0403-001180	DIODE-ZENER;BZX84C6V2,5.8-6.6V,350mW,SOT	1	S.A	
...4	D3075	0403-001180	DIODE-ZENER;BZX84C6V2,5.8-6.6V,350mW,SOT	1	S.A	
...4	D3776	0403-001180	DIODE-ZENER;BZX84C6V2,5.8-6.6V,350mW,SOT	1	S.A	
...4	D3779	0403-001180	DIODE-ZENER;BZX84C6V2,5.8-6.6V,350mW,SOT	1	S.A	
...4	D0254	0404-001404	DIODE-SCHOTTKY;BAT721C,40V,200mA,SOT-23,	1	S.A	
...4	D0254	0404-001404	DIODE-SCHOTTKY;BAT721C,40V,200mA,SOT-23,	1	S.A	
...4	D0254	0404-001404	DIODE-SCHOTTKY;BAT721C,40V,200mA,SOT-23,	1	S.A	
...4	D0254	0404-001404	DIODE-SCHOTTKY;BAT721C,40V,200mA,SOT-23,	1	S.A	
...4	D7002	0406-001200	DIODE-TVS;RCLAMP0504F,6/-V,150W,SC-70	1	S.A	
...4	D3901	0406-001271	DIODE-TVS;RCLAMP0524P,6/-V,150W,SLP251	1	S.A	
...4	D3902	0406-001271	DIODE-TVS;RCLAMP0524P,6/-V,150W,SLP251	1	S.A	
...4	D3903	0406-001271	DIODE-TVS;RCLAMP0524P,6/-V,150W,SLP251	1	S.A	
...4	D3904	0406-001271	DIODE-TVS;RCLAMP0524P,6/-V,150W,SLP251	1	S.A	
...4	D3905	0406-001271	DIODE-TVS;RCLAMP0524P,6/-V,150W,SLP251	1	S.A	
...4	D3906	0406-001271	DIODE-TVS;RCLAMP0524P,6/-V,150W,SLP251	1	S.A	
...4	D3907	0406-001271	DIODE-TVS;RCLAMP0524P,6/-V,150W,SLP251	1	S.A	
...4	D3908	0406-001271	DIODE-TVS;RCLAMP0524P,6/-V,150W,SLP251	1	S.A	
...4	D8006_EU	0407-000114	DIODE-SWITCHING;KDS184,80V,100mA,SOT-23,	1	S.N.A	
...4	D7999	0407-000123	DIODE-SWITCHING;DAN202K,80V,100mA,SOT-23	1	S.N.A	
...4	Q4003	0501-000280	TR-SMALL SIGNAL;KSA1182,PNP,150MW,SOT-23	1	S.A	
...4	Q4005	0501-000280	TR-SMALL SIGNAL;KSA1182,PNP,150MW,SOT-23	1	S.A	
...4	Q4020	0501-000280	TR-SMALL SIGNAL;KSA1182,PNP,150MW,SOT-23	1	S.A	
...4	Q8099_CI+	0501-000342	TR-SMALL SIGNAL;KSC1623-Y,NPN,200mW,SOT-	1	S.A	
...4	Q1002_LCD	0501-000445	TR-SMALL SIGNAL;KTC3875S-Y,NPN,150mW,SOT	1	S.A	
...4	Q1005_LCD	0501-000445	TR-SMALL SIGNAL;KTC3875S-Y,NPN,150mW,SOT	1	S.A	
...4	Q3007	0501-000445	TR-SMALL SIGNAL;KTC3875S-Y,NPN,150mW,SOT	1	S.A	
...4	Q3008	0501-000445	TR-SMALL SIGNAL;KTC3875S-Y,NPN,150mW,SOT	1	S.A	
...4	Q4004	0501-000445	TR-SMALL SIGNAL;KTC3875S-Y,NPN,150mW,SOT	1	S.A	
...4	Q4009	0501-000445	TR-SMALL SIGNAL;KTC3875S-Y,NPN,150mW,SOT	1	S.A	
...4	Q4011	0501-000445	TR-SMALL SIGNAL;KTC3875S-Y,NPN,150mW,SOT	1	S.A	
...4	Q3002_EU	0501-002080	TR-SMALL SIGNAL;2SC2412K,NPN,200mW,SC-59	1	S.A	
...4	Q7601_LCD	0501-002080	TR-SMALL SIGNAL;2SC2412K,NPN,200mW,SC-59	1	S.A	
...4	Q7602_LCD	0501-002080	TR-SMALL SIGNAL;2SC2412K,NPN,200mW,SC-59	1	S.A	
...4	Q409	0505-001916	FET-SILICON;Si4800BDY,N,30V,9A,0.03ohm,2	1	S.A	
...4	IC104	0801-002095	IC-CMOS LOGIC;74LCX245,TRANSCEIVER,TSSOP	1	S.A	
...4	IC104	0801-002172	IC-CMOS LOGIC;74LCX16244,BUFFER/LINE DRI	1	S.A	
...4	IC104	0801-002172	IC-CMOS LOGIC;74LCX16244,BUFFER/LINE DRI	1	S.A	
...4	IC104	0801-002172	IC-CMOS LOGIC;74LCX16244,BUFFER/LINE DRI	1	S.A	
...4	IC104	0801-002630	IC-CMOS LOGIC;74AHCT1G08,2-INPUT AND GAT	1	S.A	
...4	IC104	0801-002780	IC-CMOS LOGIC;74LVC1G17,SCHMITT-TRIGGER	1	S.N.A	
...4	IC7008	1001-000164	IC-ANALOG MULTIPLEX;74HC4052,CMOS,SOP,16	1	S.A	
...4	IC106	1001-001177	IC-VIDEO SWITCH;TEA6425D,VIDEO SWITCH,SO	1	S.A	
...4	IC106	1001-001573	IC-VIDEO SWITCH;SiI9287BCNUTR,QFN,72P,10	1	S.A	
...4	IC107	1002-001482	IC-D/A CONVERTER;WM8521H9GED/R,16bit,SOI	1	S.A	
...4	IC3001	1006-001266	IC-LINE TRANSCEIVER;3232,TSSOP,16P,174MI	1	S.A	
...4	IC112	1103-000129	IC-EEPROM;24C02,2Kbit,256x8,SOP,8P,5x4mm	1	S.A	
...4	IC112	1103-000129	IC-EEPROM;24C02,2Kbit,256x8,SOP,8P,5x4mm	1	S.A	
...4	IC112	1103-001385	IC-EEPROM;AT24C256,256Kbit,32Kx8,SOP,8P,	1	S.A	

5. Exploded View & Part List

Level	Location No.	Code No.	Description & Specification	Q'ty	SA/SNA	Remark
...4	IC7003	1105-001931	IC-DDR2 SDRAM;K4T51163Q,DDR2-800,512Mbit	1	S.N.A	
...4	IC7004	1105-001931	IC-DDR2 SDRAM;K4T51163Q,DDR2-800,512Mbit	1	S.N.A	
...4	IC7005	1105-001931	IC-DDR2 SDRAM;K4T51163Q,DDR2-800,512Mbit	1	S.N.A	
...4	IC7006	1105-001931	IC-DDR2 SDRAM;K4T51163Q,DDR2-800,512Mbit	1	S.N.A	
...4	T0124	1201-002796	IC-POWER AMP;STA339BWS,PSSO,36P,10.3x7.5	1	S.A	
...4	T0124	1201-002796	IC-POWER AMP;STA339BWS,PSSO,36P,10.3x7.5	1	S.A	
...4	T0087	1203-001815	IC-POSI.FIXED REG.;78M09,TO-252,3P,PLAST	1	S.A	
...4	T0087	1203-001816	IC-POSI.FIXED REG.;78M08,TO-252,3P,-,PLA	1	S.A	
...4	T0087	1203-002842	IC-POSI.FIXED REG.;AP1117D-33,TO-252,3P,	1	S.A	
...4	T0087	1203-002842	IC-POSI.FIXED REG.;AP1117D-33,TO-252,3P,	1	S.A	
...4	IC012	1203-002995	IC-POSI.ADJUST REG.;AP1117D,TO-252,3P,6.	1	S.A	
...4	IC012	1203-002995	IC-POSI.ADJUST REG.;AP1117D,TO-252,3P,6.	1	S.A	
...4	IC4005	1203-004363	IC-VOL. DETECTOR;RT9818C-29PV,SOT-23,3P,	1	S.A	
...4	IC4004	1203-004364	IC-VOL. DETECTOR;RT9818C-42PV,SOT-23,3P,	1	S.A	
...4	IC1007	1203-004879	IC-DC/DC CONVERTER;MP8668DL,QFN,14P,3x4m	1	S.A	
...4	T0087	1203-005134	IC-POSI.FIXED REG.;RT9167A-33PB,SOT-23-5	1	S.A	
...4	IC1006	1203-005538	IC-DC/DC CONVERTER;AOZ1021HAIL,SOP,8P,4.	1	S.A	
...4	IC5006	1203-005559	IC-BACKLIGHT DRIVER;MP3302DJ,TSOT23,5P,2	1	S.A	
...4	T0087	1203-005713	IC-POSI.FIXED REG.;S-1172B33-E6T1G,HSOP,	1	S.A	
...4	T0087	1203-005713	IC-POSI.FIXED REG.;S-1172B33-E6T1G,HSOP,	1	S.A	
...4	IC118	1204-003010	IC-VIDEO PROCESS;SDP84,PBGA,324P,23x23mm	1	S.A	
...4	IC7001	1204-003011	IC-DECODER;SDP83,PBGA,729P,34x34mm,PLAST	1	S.A	
...4	IC3011	1205-003201	IC-BUS SWITCH;TC7WB125FK,SSOP,8P,2x2.3mm	1	S.A	
...4	IC2001	1205-003352	IC-CODEC;WM8593SEFTV,TQFP,64P,10x10mm,P	1	S.A	
...4	IC8006	1205-003479	IC-SWITCH;TPS2051BDBVR,SOT-23,5P,2.9x1.6	1	S.A	
...4	IC7007	1205-003733	IC-SWITCH;AP2191MPG-13,MSOP-8L-EP,8P,2.9	1	S.A	
...4	IC5010	1209-001830	IC-PLL;IDT6V10012PGG,TSSOP,20P,6.5x4.4mm	1	S.A	
...4	D4110	1405-001185	VARISTOR;24Vdc,1.6x0.8x0.36mm,TP	1	S.A	
...4	D3010	1405-001233	VARISTOR;30Vdc,5A,1.6x0.8x0.8mm,TP	1	S.A	
...4	D3012	1405-001233	VARISTOR;30Vdc,5A,1.6x0.8x0.8mm,TP	1	S.A	
...4	D3013	1405-001233	VARISTOR;30Vdc,5A,1.6x0.8x0.8mm,TP	1	S.A	
...4	D3014	1405-001233	VARISTOR;30Vdc,5A,1.6x0.8x0.8mm,TP	1	S.A	
...4	D3017	1405-001233	VARISTOR;30Vdc,5A,1.6x0.8x0.8mm,TP	1	S.A	
...4	D3025	1405-001233	VARISTOR;30Vdc,5A,1.6x0.8x0.8mm,TP	1	S.A	
...4	D3026	1405-001233	VARISTOR;30Vdc,5A,1.6x0.8x0.8mm,TP	1	S.A	
...4	D3027	1405-001233	VARISTOR;30Vdc,5A,1.6x0.8x0.8mm,TP	1	S.A	
...4	D3041	1405-001233	VARISTOR;30Vdc,5A,1.6x0.8x0.8mm,TP	1	S.A	
...4	D3059	1405-001233	VARISTOR;30Vdc,5A,1.6x0.8x0.8mm,TP	1	S.A	
...4	D3064	1405-001233	VARISTOR;30Vdc,5A,1.6x0.8x0.8mm,TP	1	S.A	
...4	D3070	1405-001233	VARISTOR;30Vdc,5A,1.6x0.8x0.8mm,TP	1	S.A	
...4	D3071	1405-001233	VARISTOR;30Vdc,5A,1.6x0.8x0.8mm,TP	1	S.A	
...4	D3072	1405-001233	VARISTOR;30Vdc,5A,1.6x0.8x0.8mm,TP	1	S.A	
...4	D3078	1405-001233	VARISTOR;30Vdc,5A,1.6x0.8x0.8mm,TP	1	S.A	
...4	D3081	1405-001233	VARISTOR;30Vdc,5A,1.6x0.8x0.8mm,TP	1	S.A	
...4	D4011	1405-001233	VARISTOR;30Vdc,5A,1.6x0.8x0.8mm,TP	1	S.A	
...4	D4012	1405-001233	VARISTOR;30Vdc,5A,1.6x0.8x0.8mm,TP	1	S.A	
...4	D4014	1405-001233	VARISTOR;30Vdc,5A,1.6x0.8x0.8mm,TP	1	S.A	
...4	D4016	1405-001233	VARISTOR;30Vdc,5A,1.6x0.8x0.8mm,TP	1	S.A	
...4	D4017	1405-001233	VARISTOR;30Vdc,5A,1.6x0.8x0.8mm,TP	1	S.A	
...4	D4018	1405-001233	VARISTOR;30Vdc,5A,1.6x0.8x0.8mm,TP	1	S.A	
...4	D7004	1405-001233	VARISTOR;30Vdc,5A,1.6x0.8x0.8mm,TP	1	S.A	

5. Exploded View & Part List

Level	Location No.	Code No.	Description & Specification	Q'ty	SA/SNA	Remark
...4	R7120	2007-000043	R-CHIP;1Kohm,1%,1/10W,TP,1608	1	S.A	
...4	R7121	2007-000043	R-CHIP;1Kohm,1%,1/10W,TP,1608	1	S.A	
...4	R7122	2007-000043	R-CHIP;1Kohm,1%,1/10W,TP,1608	1	S.A	
...4	R7123	2007-000043	R-CHIP;1Kohm,1%,1/10W,TP,1608	1	S.A	
...4	R7152	2007-000043	R-CHIP;1Kohm,1%,1/10W,TP,1608	1	S.A	
...4	R7153	2007-000043	R-CHIP;1Kohm,1%,1/10W,TP,1608	1	S.A	
...4	R7154	2007-000043	R-CHIP;1Kohm,1%,1/10W,TP,1608	1	S.A	
...4	R7155	2007-000043	R-CHIP;1Kohm,1%,1/10W,TP,1608	1	S.A	
...4	R7162	2007-000043	R-CHIP;1Kohm,1%,1/10W,TP,1608	1	S.A	
...4	R7163	2007-000043	R-CHIP;1Kohm,1%,1/10W,TP,1608	1	S.A	
...4	R7164	2007-000043	R-CHIP;1Kohm,1%,1/10W,TP,1608	1	S.A	
...4	R7165	2007-000043	R-CHIP;1Kohm,1%,1/10W,TP,1608	1	S.A	
...4	R7169	2007-000043	R-CHIP;1Kohm,1%,1/10W,TP,1608	1	S.A	
...4	R7170	2007-000043	R-CHIP;1Kohm,1%,1/10W,TP,1608	1	S.A	
...4	R7171	2007-000043	R-CHIP;1Kohm,1%,1/10W,TP,1608	1	S.A	
...4	R7172	2007-000043	R-CHIP;1Kohm,1%,1/10W,TP,1608	1	S.A	
...4	R5034	2007-000060	R-CHIP;100Kohm,1%,1/10W,TP,1608	1	S.N.A	
...4	R5038	2007-000060	R-CHIP;100Kohm,1%,1/10W,TP,1608	1	S.N.A	
...4	R1801	2007-000070	R-CHIP;0ohm,5%,1/10W,TP,1608	1	S.N.A	
...4	R5101	2007-000070	R-CHIP;0ohm,5%,1/10W,TP,1608	1	S.N.A	
...4	R2072	2007-000932	R-CHIP;470ohm,5%,1/16W,TP,1005	1	S.N.A	
...4	R2073	2007-000932	R-CHIP;470ohm,5%,1/16W,TP,1005	1	S.N.A	
...4	R3005_EU	2007-000932	R-CHIP;470ohm,5%,1/16W,TP,1005	1	S.N.A	
...4	R4015	2007-000932	R-CHIP;470ohm,5%,1/16W,TP,1005	1	S.N.A	
...4	R6067	2007-000932	R-CHIP;470ohm,5%,1/16W,TP,1005	1	S.N.A	
...4	R5041	2007-001044	R-CHIP;56ohm,5%,1/10W,TP,1608	1	S.A	
...4	R2047	2007-001292	R-CHIP;33ohm,5%,1/16W,TP,1005	1	S.N.A	
...4	R2052	2007-001292	R-CHIP;33ohm,5%,1/16W,TP,1005	1	S.N.A	
...4	R2053	2007-001292	R-CHIP;33ohm,5%,1/16W,TP,1005	1	S.N.A	
...4	R2074_WF	2007-001292	R-CHIP;33ohm,5%,1/16W,TP,1005	1	S.N.A	
...4	R2075_WF	2007-001292	R-CHIP;33ohm,5%,1/16W,TP,1005	1	S.N.A	
...4	R2076_WF	2007-001292	R-CHIP;33ohm,5%,1/16W,TP,1005	1	S.N.A	
...4	R3246	2007-001292	R-CHIP;33ohm,5%,1/16W,TP,1005	1	S.N.A	
...4	R5046	2007-001292	R-CHIP;33ohm,5%,1/16W,TP,1005	1	S.N.A	
...4	R5047	2007-001292	R-CHIP;33ohm,5%,1/16W,TP,1005	1	S.N.A	
...4	R8028	2007-001292	R-CHIP;33ohm,5%,1/16W,TP,1005	1	S.N.A	
...4	R7194	2007-001308	R-CHIP;200ohm,5%,1/16W,TP,1005	1	S.N.A	
...4	R3111	2007-001325	R-CHIP;3.3Kohm,5%,1/16W,TP,1005	1	S.N.A	
...4	R3112	2007-001325	R-CHIP;3.3Kohm,5%,1/16W,TP,1005	1	S.N.A	
...4	R3113	2007-001325	R-CHIP;3.3Kohm,5%,1/16W,TP,1005	1	S.N.A	
...4	R3114	2007-001325	R-CHIP;3.3Kohm,5%,1/16W,TP,1005	1	S.N.A	
...4	R4152	2007-001325	R-CHIP;3.3Kohm,5%,1/16W,TP,1005	1	S.N.A	
...4	R7410_LCD	2007-001325	R-CHIP;3.3Kohm,5%,1/16W,TP,1005	1	S.N.A	
...4	R1004	2007-002425	R-CHIP;1ohm,5%,1/10W,TP,1608	1	S.N.A	
...4	R1007	2007-002425	R-CHIP;1ohm,5%,1/10W,TP,1608	1	S.N.A	
...4	R1008	2007-002425	R-CHIP;1ohm,5%,1/10W,TP,1608	1	S.N.A	
...4	R1009	2007-002425	R-CHIP;1ohm,5%,1/10W,TP,1608	1	S.N.A	
...4	R5056	2007-002425	R-CHIP;1ohm,5%,1/10W,TP,1608	1	S.N.A	
...4	R5102	2007-002425	R-CHIP;1ohm,5%,1/10W,TP,1608	1	S.N.A	
...4	R1010	2007-007107	R-CHIP;100Kohm,1%,1/16W,TP,1005	1	S.N.A	
...4	R2057	2007-007136	R-CHIP;4.7Kohm,1%,1/16W,TP,1005	1	S.N.A	

5. Exploded View & Part List

Level	Location No.	Code No.	Description & Specification	Q'ty	SA/SNA	Remark
...4	R8013	2007-007136	R-CHIP;4.7Kohm,1%,1/16W,TP,1005	1	S.N.A	
...4	R1019	2007-007142	R-CHIP;10Kohm,1%,1/16W,TP,1005	1	S.N.A	
...4	R1023_LCD	2007-007142	R-CHIP;10Kohm,1%,1/16W,TP,1005	1	S.N.A	
...4	R4028	2007-007142	R-CHIP;10Kohm,1%,1/16W,TP,1005	1	S.N.A	
...4	R4030	2007-007142	R-CHIP;10Kohm,1%,1/16W,TP,1005	1	S.N.A	
...4	R4052	2007-007142	R-CHIP;10Kohm,1%,1/16W,TP,1005	1	S.N.A	
...4	R4053	2007-007142	R-CHIP;10Kohm,1%,1/16W,TP,1005	1	S.N.A	
...4	R4089	2007-007142	R-CHIP;10Kohm,1%,1/16W,TP,1005	1	S.N.A	
...4	R4156	2007-007142	R-CHIP;10Kohm,1%,1/16W,TP,1005	1	S.N.A	
...4	R4168_OP	2007-007142	R-CHIP;10Kohm,1%,1/16W,TP,1005	1	S.N.A	
...4	R5036	2007-007469	R-CHIP;110ohm,1%,1/16W,TP,1005	1	S.N.A	
...4	RA7061	2011-001001	R-NETWORK;0ohm,5%,1/16W,L,CHIP,8P,TP,3.2	1	S.A	
...4	RA5003	2011-001093	R-NETWORK;100ohm,5%,1/16W,L,CHIP,8P,TP,3	1	S.A	
...4	RA7056	2011-001093	R-NETWORK;100ohm,5%,1/16W,L,CHIP,8P,TP,3	1	S.A	
...4	RA7057	2011-001093	R-NETWORK;100ohm,5%,1/16W,L,CHIP,8P,TP,3	1	S.A	
...4	C1027	2203-000489	C-CER,CHIP;2.2nF,10%,50V,X7R,TP,1005	1	S.A	
...4	C3014	2203-000489	C-CER,CHIP;2.2nF,10%,50V,X7R,TP,1005	1	S.A	
...4	C3016	2203-000489	C-CER,CHIP;2.2nF,10%,50V,X7R,TP,1005	1	S.A	
...4	C2111_WF	2203-000925	C-CER,CHIP;470nF,+80-20%,50V,Y5V,2012	1	S.A	
...4	C1013	2203-001596	C-CER,CHIP;2200nF,+80-20%,50V,Y5V,2012	1	S.A	
...4	C1016	2203-001596	C-CER,CHIP;2200nF,+80-20%,50V,Y5V,2012	1	S.A	
...4	C1113	2203-001596	C-CER,CHIP;2200nF,+80-20%,50V,Y5V,2012	1	S.A	
...4	C1116	2203-001596	C-CER,CHIP;2200nF,+80-20%,50V,Y5V,2012	1	S.A	
...4	C2041	2203-005968	C-CER,CHIP;4.7NF,10%,50V,X7R,TP,1005	1	S.N.A	
...4	C2092_WF	2203-005968	C-CER,CHIP;4.7NF,10%,50V,X7R,TP,1005	1	S.N.A	
...4	C6091	2203-005968	C-CER,CHIP;4.7NF,10%,50V,X7R,TP,1005	1	S.N.A	
...4	C2104_WF	2203-006336	C-CER,CHIP;10000nF,10%,25V,X5R,3216	1	S.A	
...4	C5012	2203-006336	C-CER,CHIP;10000nF,10%,25V,X5R,3216	1	S.A	
...4	C5019	2402-001210	C-POLYMER AL CHIP;100uF,20%,10V,WT,TP,7.	1	S.A	
...4	C1051	2409-001118	C-POLYMER ,CHIP;47uF,+20,10V,WT,REEL,3.	1	S.A	
...4	C1052	2409-001118	C-POLYMER ,CHIP;47uF,+20,10V,WT,REEL,3.	1	S.A	
...4	C6005	2409-001118	C-POLYMER ,CHIP;47uF,+20,10V,WT,REEL,3.	1	S.A	
...4	C6014	2409-001118	C-POLYMER ,CHIP;47uF,+20,10V,WT,REEL,3.	1	S.A	
...4	T0052	2703-000380	INDUCTOR-SMD;18uH,5%,3225	1	S.A	
...4	T0052	2703-000398	INDUCTOR-SMD;10uH,10%,3225	1	S.A	
...4	T0052	2703-000398	INDUCTOR-SMD;10uH,10%,3225	1	S.A	
...4	T0052	2703-000398	INDUCTOR-SMD;10uH,10%,3225	1	S.A	
...4	T0052	2703-000398	INDUCTOR-SMD;10uH,10%,3225	1	S.A	
...4	T0052	2703-000398	INDUCTOR-SMD;10uH,10%,3225	1	S.A	
...4	T0052	2703-003559	INDUCTOR-SMD;4.7uH,20%,8080	1	S.A	
...4	T0052	2703-003628	INDUCTOR-SMD;1.5uH,20%,2020	1	S.A	
...4	T0052	2703-003649	INDUCTOR-SMD;15uH,20%,8080	1	S.A	
...4	T0052	2703-003649	INDUCTOR-SMD;15uH,20%,8080	1	S.A	
...4	L2001	2704-000028	INDUCTOR-SMD-ARRAY;15uH,2000mA,2,0.124oh	1	S.N.A	
...4	L2002	2704-000028	INDUCTOR-SMD-ARRAY;15uH,2000mA,2,0.124oh	1	S.N.A	
...4	X202	2801-003326	CRYSTAL-SMD;24MHZ,30PPM,28-ABX,20PF,50OH	1	S.A	
...4	X202	2801-003773	CRYSTAL-SMD;12MHz,30ppm,28-AAN,20pF,50oh	1	S.A	
...4	X202	2801-004629	CRYSTAL-SMD;27MHz,20ppm,12pF,50ohm,TP	1	S.A	
...4	F103	2901-001302	FILTER-EMI SMD;20V,0.3A,0pF,2.0x1.2x1.3m	1	S.N.A	
...4	F103	2901-001302	FILTER-EMI SMD;20V,0.3A,0pF,2.0x1.2x1.3m	1	S.N.A	
...4	F103	2901-001302	FILTER-EMI SMD;20V,0.3A,0pF,2.0x1.2x1.3m	1	S.N.A	

5. Exploded View & Part List

Level	Location No.	Code No.	Description & Specification	Q'ty	SA/SNA	Remark
...4	T0568	3301-001404	BEAD-SMD;30ohm,2012,TP,15.9OHM/30MHz	1	S.A	
...4	T0568	3301-001404	BEAD-SMD;30ohm,2012,TP,15.9OHM/30MHz	1	S.A	
...4	T0568	3301-001404	BEAD-SMD;30ohm,2012,TP,15.9OHM/30MHz	1	S.A	
...4	T0568	3301-001404	BEAD-SMD;30ohm,2012,TP,15.9OHM/30MHz	1	S.A	
...4	T0568	3301-001404	BEAD-SMD;30ohm,2012,TP,15.9OHM/30MHz	1	S.A	
...4	T0568	3301-001404	BEAD-SMD;30ohm,2012,TP,15.9OHM/30MHz	1	S.A	
...4	T0568	3301-001404	BEAD-SMD;30ohm,2012,TP,15.9OHM/30MHz	1	S.A	
...4	T0568	3301-001404	BEAD-SMD;30ohm,2012,TP,15.9OHM/30MHz	1	S.A	
...4	T0568	3301-001404	BEAD-SMD;30ohm,2012,TP,15.9OHM/30MHz	1	S.A	
...4	T0568	3301-001404	BEAD-SMD;30ohm,2012,TP,15.9OHM/30MHz	1	S.A	
...4	T0568	3301-001404	BEAD-SMD;30ohm,2012,TP,15.9OHM/30MHz	1	S.A	
...4	T0568	3301-001404	BEAD-SMD;30ohm,2012,TP,15.9OHM/30MHz	1	S.A	
...4	T0568	3301-001404	BEAD-SMD;30ohm,2012,TP,15.9OHM/30MHz	1	S.A	
...4	T0568	3301-001404	BEAD-SMD;30ohm,2012,TP,15.9OHM/30MHz	1	S.A	
...4	T0568	3301-001404	BEAD-SMD;30ohm,2012,TP,15.9OHM/30MHz	1	S.A	
...4	T0568	3301-001404	BEAD-SMD;30ohm,2012,TP,15.9OHM/30MHz	1	S.A	
...4	T0568	3301-001404	BEAD-SMD;30ohm,2012,TP,15.9OHM/30MHz	1	S.A	
...4	T0568	3301-001404	BEAD-SMD;30ohm,2012,TP,15.9OHM/30MHz	1	S.A	
...4	T0568	3301-001404	BEAD-SMD;30ohm,2012,TP,15.9OHM/30MHz	1	S.A	
...4	T0313	3404-001207	SWITCH-TACT;12V,50mA,160gf,6.2X6.2,SPST	1	S.A	
...4	CN3010	3701-001293	CONNECTOR-HDMI;19P,2R,FEMALE,SMD-A,AU	1	S.A	
...4	CN3013	3701-001293	CONNECTOR-HDMI;19P,2R,FEMALE,SMD-A,AU	1	S.A	
...4	CN3015	3701-001293	CONNECTOR-HDMI;19P,2R,FEMALE,SMD-A,AU	1	S.A	
...4	CN3016	3701-001293	CONNECTOR-HDMI;19P,2R,FEMALE,SMD-A,AU	1	S.A	
...4	CN3002	3710-002276	SOCKET-INTERFACE;24P,1R,0.5mm,SMD-A,AU,B	1	S.A	
...4	CN330	3711-005925	HEADER-BOARD TO CABLE;BOX,51P,1R,0.5mm,S	1	S.N.A	
...4	T0077	BN41-01190B	PCB MAIN;ultra slim eu,FR-4,4,1.2T,200*2	1	S.N.A	
...4	T0010	BP27-00002A	COIL CHOKE;SLF6028T-220MR77,22uF,20%,0.1	1	S.A	
...4	R1031_LCD	2007-000140	R-CHIP;1Kohm,5%,1/16W,TP,1005	1	S.N.A	
...4	R1072	2007-000140	R-CHIP;1Kohm,5%,1/16W,TP,1005	1	S.N.A	
...4	R1172	2007-000140	R-CHIP;1Kohm,5%,1/16W,TP,1005	1	S.N.A	
...4	R3010	2007-000140	R-CHIP;1Kohm,5%,1/16W,TP,1005	1	S.N.A	
...4	R3021	2007-000140	R-CHIP;1Kohm,5%,1/16W,TP,1005	1	S.N.A	
...4	R3022	2007-000140	R-CHIP;1Kohm,5%,1/16W,TP,1005	1	S.N.A	
...4	R3035	2007-000140	R-CHIP;1Kohm,5%,1/16W,TP,1005	1	S.N.A	
...4	R3037	2007-000140	R-CHIP;1Kohm,5%,1/16W,TP,1005	1	S.N.A	
...4	R3069	2007-000140	R-CHIP;1Kohm,5%,1/16W,TP,1005	1	S.N.A	
...4	R3071	2007-000140	R-CHIP;1Kohm,5%,1/16W,TP,1005	1	S.N.A	
...4	R3227	2007-000140	R-CHIP;1Kohm,5%,1/16W,TP,1005	1	S.N.A	
...4	R3228	2007-000140	R-CHIP;1Kohm,5%,1/16W,TP,1005	1	S.N.A	
...4	R4081	2007-000140	R-CHIP;1Kohm,5%,1/16W,TP,1005	1	S.N.A	
...4	R6028	2007-000140	R-CHIP;1Kohm,5%,1/16W,TP,1005	1	S.N.A	
...4	R6064	2007-000140	R-CHIP;1Kohm,5%,1/16W,TP,1005	1	S.N.A	
...4	R6065	2007-000140	R-CHIP;1Kohm,5%,1/16W,TP,1005	1	S.N.A	
...4	R6066	2007-000140	R-CHIP;1Kohm,5%,1/16W,TP,1005	1	S.N.A	
...4	R7045	2007-000140	R-CHIP;1Kohm,5%,1/16W,TP,1005	1	S.N.A	
...4	R7072	2007-000140	R-CHIP;1Kohm,5%,1/16W,TP,1005	1	S.N.A	
...4	R7195	2007-000140	R-CHIP;1Kohm,5%,1/16W,TP,1005	1	S.N.A	
...4	R7196	2007-000140	R-CHIP;1Kohm,5%,1/16W,TP,1005	1	S.N.A	
...4	R7602_LCD	2007-000140	R-CHIP;1Kohm,5%,1/16W,TP,1005	1	S.N.A	
...4	R7999	2007-000140	R-CHIP;1Kohm,5%,1/16W,TP,1005	1	S.N.A	
...4	R2058	2007-000072	R-CHIP;47ohm,5%,1/10W,TP,1608	1	S.N.A	
...4	R2059	2007-000072	R-CHIP;47ohm,5%,1/10W,TP,1608	1	S.N.A	
...4	R2060	2007-000072	R-CHIP;47ohm,5%,1/10W,TP,1608	1	S.N.A	

5. Exploded View & Part List

Level	Location No.	Code No.	Description & Specification	Q'ty	SA/SNA	Remark
...4	R2061	2007-000072	R-CHIP;47ohm,5%,1/10W,TP,1608	1	S.N.A	
...4	R2086_WF	2007-000072	R-CHIP;47ohm,5%,1/10W,TP,1608	1	S.N.A	
...4	R2087_WF	2007-000072	R-CHIP;47ohm,5%,1/10W,TP,1608	1	S.N.A	
...4	R5048	2007-001038	R-CHIP;56Kohm,1%,1/10W,TP,1608	1	S.A	
...4	R1014	2007-001179	R-CHIP;8.2Kohm,5%,1/10W,TP,1608	1	S.N.A	
...4	R3245	2007-001305	R-CHIP;120ohm,5%,1/16W,TP,1005	1	S.N.A	
...4	R3247	2007-001305	R-CHIP;120ohm,5%,1/16W,TP,1005	1	S.N.A	
...4	R1017	2007-002900	R-CHIP;11Kohm,1%,1/10W,TP,1608	1	S.A	
...4	R2054	2007-000141	R-CHIP;2.2Kohm,5%,1/16W,TP,1005	1	S.N.A	
...4	R2081_WF	2007-000141	R-CHIP;2.2Kohm,5%,1/16W,TP,1005	1	S.N.A	
...4	R4019	2007-000141	R-CHIP;2.2Kohm,5%,1/16W,TP,1005	1	S.N.A	
...4	R4085	2007-000141	R-CHIP;2.2Kohm,5%,1/16W,TP,1005	1	S.N.A	
...4	R5030	2007-000141	R-CHIP;2.2Kohm,5%,1/16W,TP,1005	1	S.N.A	
...4	R1800	2007-000608	R-CHIP;240ohm,5%,1/10W,TP,1608	1	S.A	
...4	R5045	2007-000669	R-CHIP;2Kohm,1%,1/10W,TP,1608	1	S.N.A	
...4	R7160	2007-000729	R-CHIP;300ohm,5%,1/10W,TP,1608	1	S.N.A	
...4	R7176	2007-000729	R-CHIP;300ohm,5%,1/10W,TP,1608	1	S.N.A	
...4	R5044	2007-000755	R-CHIP;330Kohm,1%,1/10W,TP,1608	1	S.A	
...4	R5039	2007-000758	R-CHIP;330Kohm,5%,1/16W,TP,1005	1	S.N.A	
...4	R5037	2007-000763	R-CHIP;330ohm,1%,1/10W,TP,1608	1	S.N.A	
...4	R1021	2007-000779	R-CHIP;33ohm,1%,1/10W,TP,1608	1	S.A	
...4	R1012	2007-000803	R-CHIP;36Kohm,1%,1/10W,TP,1608	1	S.A	
...4	R2085_WF	2007-000090	R-CHIP;10Kohm,5%,1/10W,TP,1608	1	S.A	
...4	R7193	2007-007222	R-CHIP;6.04Kohm,1%,1/10W,TP,1608	1	S.A	
...4	R1016	2007-007312	R-CHIP;20Kohm,1%,1/16W,TP,1005	1	S.A	
...4	R1022	2007-007312	R-CHIP;20Kohm,1%,1/16W,TP,1005	1	S.A	
...4	C5001	2203-000550	C-CER,CHIP;0.02nF,5%,50V,C0G,1005	1	S.N.A	
...4	C5002	2203-000550	C-CER,CHIP;0.02nF,5%,50V,C0G,1005	1	S.N.A	
...4	C2070	2203-000575	C-CER,CHIP;220nF,10%,25V,X7R,TP,2012	1	S.N.A	
...4	C2071	2203-000575	C-CER,CHIP;220nF,10%,25V,X7R,TP,2012	1	S.N.A	
...4	C2072	2203-000575	C-CER,CHIP;220nF,10%,25V,X7R,TP,2012	1	S.N.A	
...4	C2073	2203-000575	C-CER,CHIP;220nF,10%,25V,X7R,TP,2012	1	S.N.A	
...4	C2074	2203-000575	C-CER,CHIP;220nF,10%,25V,X7R,TP,2012	1	S.N.A	
...4	C2075	2203-000575	C-CER,CHIP;220nF,10%,25V,X7R,TP,2012	1	S.N.A	
...4	C5037	2203-000595	C-CER,CHIP;0.22nF,5%,50V,C0G,2012	1	S.N.A	
...4	C4009	2203-000679	C-CER,CHIP;0.027nF,5%,50V,C0G,1005	1	S.A	
...4	C4010	2203-000679	C-CER,CHIP;0.027nF,5%,50V,C0G,1005	1	S.A	
...4	C5003	2203-000697	C-CER,CHIP;0.002NF,0.25PF,50V,C0G,TP,160	1	S.A	
...4	C5004	2203-000697	C-CER,CHIP;0.002NF,0.25PF,50V,C0G,TP,160	1	S.A	
...4	C7048	2203-000761	C-CER,CHIP;330nF,10%,16V,X7R,TP,2012,-	1	S.N.A	
...4	C3006	2203-000812	C-CER,CHIP; .033nF,5%,50V,C0G,1005	1	S.A	
...4	C3007	2203-000812	C-CER,CHIP; .033nF,5%,50V,C0G,1005	1	S.A	
...4	C3008	2203-000812	C-CER,CHIP; .033nF,5%,50V,C0G,1005	1	S.A	
...4	C3012_EU	2203-000812	C-CER,CHIP; .033nF,5%,50V,C0G,1005	1	S.A	
...4	C3018	2203-000812	C-CER,CHIP; .033nF,5%,50V,C0G,1005	1	S.A	
...4	C3019	2203-000812	C-CER,CHIP; .033nF,5%,50V,C0G,1005	1	S.A	
...4	C3020	2203-000812	C-CER,CHIP; .033nF,5%,50V,C0G,1005	1	S.A	
...4	C3022	2203-000812	C-CER,CHIP; .033nF,5%,50V,C0G,1005	1	S.A	
...4	R1018	2007-000239	R-CHIP;1.5Kohm,1%,1/10W,TP,1608	1	S.N.A	
...4	R6089	2007-000259	R-CHIP;1.6Kohm,5%,1/10W,TP,1608	1	S.A	
...4	R3254	2007-000287	R-CHIP;100ohm,1%,1/10W,TP,1608	1	S.N.A	

5. Exploded View & Part List

Level	Location No.	Code No.	Description & Specification	Q'ty	SA/SNA	Remark
...4	R3255	2007-000287	R-CHIP;100ohm,1%,1/10W,TP,1608	1	S.N.A	
...4	R5022	2007-000287	R-CHIP;100ohm,1%,1/10W,TP,1608	1	S.N.A	
...4	R7105	2007-000287	R-CHIP;100ohm,1%,1/10W,TP,1608	1	S.N.A	
...4	R7147	2007-000287	R-CHIP;100ohm,1%,1/10W,TP,1608	1	S.N.A	
...4	R2064	2007-000362	R-CHIP;12ohm,5%,1/10W,TP,1608	1	S.A	
...4	R2065	2007-000362	R-CHIP;12ohm,5%,1/10W,TP,1608	1	S.A	
...4	R2066	2007-000362	R-CHIP;12ohm,5%,1/10W,TP,1608	1	S.A	
...4	R2067	2007-000362	R-CHIP;12ohm,5%,1/10W,TP,1608	1	S.A	
...4	R2068	2007-000362	R-CHIP;12ohm,5%,1/10W,TP,1608	1	S.A	
...4	R2069	2007-000362	R-CHIP;12ohm,5%,1/10W,TP,1608	1	S.A	
...4	R2070	2007-000362	R-CHIP;12ohm,5%,1/10W,TP,1608	1	S.A	
...4	R2071	2007-000362	R-CHIP;12ohm,5%,1/10W,TP,1608	1	S.A	
...4	R2088_WF	2007-000362	R-CHIP;12ohm,5%,1/10W,TP,1608	1	S.A	
...4	R2089_WF	2007-000362	R-CHIP;12ohm,5%,1/10W,TP,1608	1	S.A	
...4	R2090_WF	2007-000362	R-CHIP;12ohm,5%,1/10W,TP,1608	1	S.A	
...4	R2091_WF	2007-000362	R-CHIP;12ohm,5%,1/10W,TP,1608	1	S.A	
...4	R3044	2007-000146	R-CHIP;6.8Kohm,5%,1/16W,TP,1005	1	S.N.A	
...4	R3027_EU	2007-000153	R-CHIP;22Kohm,5%,1/16W,TP,1005	1	S.N.A	
...4	R4021	2007-000155	R-CHIP;27Kohm,5%,1/16W,TP,1005	1	S.N.A	
...4	R4061	2007-000155	R-CHIP;27Kohm,5%,1/16W,TP,1005	1	S.N.A	
...4	R3288	2007-000172	R-CHIP;10ohm,5%,1/16W,TP,1005	1	S.N.A	
...4	R3300	2007-000172	R-CHIP;10ohm,5%,1/16W,TP,1005	1	S.N.A	
...4	R3301	2007-000172	R-CHIP;10ohm,5%,1/16W,TP,1005	1	S.N.A	
...4	R3302	2007-000172	R-CHIP;10ohm,5%,1/16W,TP,1005	1	S.N.A	
...4	R3303	2007-000172	R-CHIP;10ohm,5%,1/16W,TP,1005	1	S.N.A	
...4	R4038	2007-000172	R-CHIP;10ohm,5%,1/16W,TP,1005	1	S.N.A	
...4	R5042	2007-000172	R-CHIP;10ohm,5%,1/16W,TP,1005	1	S.N.A	
...4	R5043	2007-000172	R-CHIP;10ohm,5%,1/16W,TP,1005	1	S.N.A	
...4	R2001	2007-000138	R-CHIP;100ohm,5%,1/16W,TP,1005	1	S.N.A	
...4	R2002	2007-000138	R-CHIP;100ohm,5%,1/16W,TP,1005	1	S.N.A	
...4	R2025	2007-000138	R-CHIP;100ohm,5%,1/16W,TP,1005	1	S.N.A	
...4	R2026	2007-000138	R-CHIP;100ohm,5%,1/16W,TP,1005	1	S.N.A	
...4	R3007	2007-000138	R-CHIP;100ohm,5%,1/16W,TP,1005	1	S.N.A	
...4	R3034	2007-000138	R-CHIP;100ohm,5%,1/16W,TP,1005	1	S.N.A	
...4	R3036	2007-000138	R-CHIP;100ohm,5%,1/16W,TP,1005	1	S.N.A	
...4	R3062	2007-000138	R-CHIP;100ohm,5%,1/16W,TP,1005	1	S.N.A	
...4	R3068	2007-000138	R-CHIP;100ohm,5%,1/16W,TP,1005	1	S.N.A	
...4	R3070	2007-000138	R-CHIP;100ohm,5%,1/16W,TP,1005	1	S.N.A	
...4	R3120	2007-000138	R-CHIP;100ohm,5%,1/16W,TP,1005	1	S.N.A	
...4	R3205	2007-000138	R-CHIP;100ohm,5%,1/16W,TP,1005	1	S.N.A	
...4	R3206	2007-000138	R-CHIP;100ohm,5%,1/16W,TP,1005	1	S.N.A	
...4	R3207	2007-000138	R-CHIP;100ohm,5%,1/16W,TP,1005	1	S.N.A	
...4	R3243	2007-000138	R-CHIP;100ohm,5%,1/16W,TP,1005	1	S.N.A	
...4	R4042	2007-000138	R-CHIP;100ohm,5%,1/16W,TP,1005	1	S.N.A	
...4	R4049	2007-000138	R-CHIP;100ohm,5%,1/16W,TP,1005	1	S.N.A	
...4	R4050	2007-000138	R-CHIP;100ohm,5%,1/16W,TP,1005	1	S.N.A	
...4	R4079	2007-000138	R-CHIP;100ohm,5%,1/16W,TP,1005	1	S.N.A	
...4	R4080	2007-000138	R-CHIP;100ohm,5%,1/16W,TP,1005	1	S.N.A	
...4	R4087	2007-000138	R-CHIP;100ohm,5%,1/16W,TP,1005	1	S.N.A	
...4	R4097	2007-000138	R-CHIP;100ohm,5%,1/16W,TP,1005	1	S.N.A	
...4	R4155	2007-000138	R-CHIP;100ohm,5%,1/16W,TP,1005	1	S.N.A	

5. Exploded View & Part List

Level	Location No.	Code No.	Description & Specification	Q'ty	SA/SNA	Remark
...4	R7114	2007-000138	R-CHIP;100ohm,5%,1/16W,TP,1005	1	S.N.A	
...4	R7605_LCD	2007-000138	R-CHIP;100ohm,5%,1/16W,TP,1005	1	S.N.A	
...4	R8311	2007-000138	R-CHIP;100ohm,5%,1/16W,TP,1005	1	S.N.A	
...4	R3008	2007-000174	R-CHIP;47ohm,5%,1/16W,TP,1005	1	S.N.A	
...4	R3256	2007-000174	R-CHIP;47ohm,5%,1/16W,TP,1005	1	S.N.A	
...4	R3257	2007-000174	R-CHIP;47ohm,5%,1/16W,TP,1005	1	S.N.A	
...4	R4039	2007-000174	R-CHIP;47ohm,5%,1/16W,TP,1005	1	S.N.A	
...4	R4040	2007-000174	R-CHIP;47ohm,5%,1/16W,TP,1005	1	S.N.A	
...4	R7217	2007-000174	R-CHIP;47ohm,5%,1/16W,TP,1005	1	S.N.A	
...4	C6044	2203-005493	C-CER,CHIP;220nF,+80-20%,16V,Y5V,1005	1	S.A	
...4	C6045	2203-005493	C-CER,CHIP;220nF,+80-20%,16V,Y5V,1005	1	S.A	
...4	C7053	2203-005659	C-CER,CHIP;0.18nF,5%,50V,NP0,1005	1	S.N.A	
...4	C1032	2203-005834	C-CER,CHIP;2200nF,+80-20%,10V,Y5V,3216	1	S.A	
...4	C1035	2203-005834	C-CER,CHIP;2200nF,+80-20%,10V,Y5V,3216	1	S.A	
...4	C1036	2203-005834	C-CER,CHIP;2200nF,+80-20%,10V,Y5V,3216	1	S.A	
...4	C5025	2203-005834	C-CER,CHIP;2200nF,+80-20%,10V,Y5V,3216	1	S.A	
...4	R2082_WF	2007-000171	R-CHIP;0ohm,5%,1/16W,TP,1005	1	S.N.A	
...4	R3103	2007-000171	R-CHIP;0ohm,5%,1/16W,TP,1005	1	S.N.A	
...4	R3125	2007-000171	R-CHIP;0ohm,5%,1/16W,TP,1005	1	S.N.A	
...4	R3160	2007-000171	R-CHIP;0ohm,5%,1/16W,TP,1005	1	S.N.A	
...4	R3161	2007-000171	R-CHIP;0ohm,5%,1/16W,TP,1005	1	S.N.A	
...4	R3162	2007-000171	R-CHIP;0ohm,5%,1/16W,TP,1005	1	S.N.A	
...4	R3163	2007-000171	R-CHIP;0ohm,5%,1/16W,TP,1005	1	S.N.A	
...4	R3164	2007-000171	R-CHIP;0ohm,5%,1/16W,TP,1005	1	S.N.A	
...4	R3165	2007-000171	R-CHIP;0ohm,5%,1/16W,TP,1005	1	S.N.A	
...4	R3166	2007-000171	R-CHIP;0ohm,5%,1/16W,TP,1005	1	S.N.A	
...4	R3167	2007-000171	R-CHIP;0ohm,5%,1/16W,TP,1005	1	S.N.A	
...4	R3169	2007-000171	R-CHIP;0ohm,5%,1/16W,TP,1005	1	S.N.A	
...4	R3170	2007-000171	R-CHIP;0ohm,5%,1/16W,TP,1005	1	S.N.A	
...4	R3199	2007-000171	R-CHIP;0ohm,5%,1/16W,TP,1005	1	S.N.A	
...4	R3200	2007-000171	R-CHIP;0ohm,5%,1/16W,TP,1005	1	S.N.A	
...4	R3202	2007-000171	R-CHIP;0ohm,5%,1/16W,TP,1005	1	S.N.A	
...4	R3203	2007-000171	R-CHIP;0ohm,5%,1/16W,TP,1005	1	S.N.A	
...4	R3220	2007-000171	R-CHIP;0ohm,5%,1/16W,TP,1005	1	S.N.A	
...4	R3250	2007-000171	R-CHIP;0ohm,5%,1/16W,TP,1005	1	S.N.A	
...4	R3251	2007-000171	R-CHIP;0ohm,5%,1/16W,TP,1005	1	S.N.A	
...4	R3258	2007-000171	R-CHIP;0ohm,5%,1/16W,TP,1005	1	S.N.A	
...4	R3259	2007-000171	R-CHIP;0ohm,5%,1/16W,TP,1005	1	S.N.A	
...4	R3284	2007-000171	R-CHIP;0ohm,5%,1/16W,TP,1005	1	S.N.A	
...4	R3285	2007-000171	R-CHIP;0ohm,5%,1/16W,TP,1005	1	S.N.A	
...4	R3289	2007-000171	R-CHIP;0ohm,5%,1/16W,TP,1005	1	S.N.A	
...4	R3290	2007-000171	R-CHIP;0ohm,5%,1/16W,TP,1005	1	S.N.A	
...4	R3400	2007-000171	R-CHIP;0ohm,5%,1/16W,TP,1005	1	S.N.A	
...4	R3500	2007-000171	R-CHIP;0ohm,5%,1/16W,TP,1005	1	S.N.A	
...4	R3860	2007-000171	R-CHIP;0ohm,5%,1/16W,TP,1005	1	S.N.A	
...4	R4041	2007-000171	R-CHIP;0ohm,5%,1/16W,TP,1005	1	S.N.A	
...4	R4200	2007-000171	R-CHIP;0ohm,5%,1/16W,TP,1005	1	S.N.A	
...4	R4250	2007-000171	R-CHIP;0ohm,5%,1/16W,TP,1005	1	S.N.A	
...4	R5006	2007-000171	R-CHIP;0ohm,5%,1/16W,TP,1005	1	S.N.A	
...4	R5007	2007-000171	R-CHIP;0ohm,5%,1/16W,TP,1005	1	S.N.A	
...4	R5011	2007-000171	R-CHIP;0ohm,5%,1/16W,TP,1005	1	S.N.A	

5. Exploded View & Part List

Level	Location No.	Code No.	Description & Specification	Q'ty	SA/SNA	Remark
...4	R5033	2007-000171	R-CHIP;0ohm,5%,1/16W,TP,1005	1	S.N.A	
...4	R5035	2007-000171	R-CHIP;0ohm,5%,1/16W,TP,1005	1	S.N.A	
...4	R6013	2007-000171	R-CHIP;0ohm,5%,1/16W,TP,1005	1	S.N.A	
...4	R6061	2007-000171	R-CHIP;0ohm,5%,1/16W,TP,1005	1	S.N.A	
...4	R6068	2007-000171	R-CHIP;0ohm,5%,1/16W,TP,1005	1	S.N.A	
...4	R6084	2007-000171	R-CHIP;0ohm,5%,1/16W,TP,1005	1	S.N.A	
...4	R6848	2007-000171	R-CHIP;0ohm,5%,1/16W,TP,1005	1	S.N.A	
...4	R7002	2007-000171	R-CHIP;0ohm,5%,1/16W,TP,1005	1	S.N.A	
...4	R7003	2007-000171	R-CHIP;0ohm,5%,1/16W,TP,1005	1	S.N.A	
...4	R7004	2007-000171	R-CHIP;0ohm,5%,1/16W,TP,1005	1	S.N.A	
...4	R7007	2007-000171	R-CHIP;0ohm,5%,1/16W,TP,1005	1	S.N.A	
...4	R7014	2007-000171	R-CHIP;0ohm,5%,1/16W,TP,1005	1	S.N.A	
...4	R7015	2007-000171	R-CHIP;0ohm,5%,1/16W,TP,1005	1	S.N.A	
...4	R7018	2007-000171	R-CHIP;0ohm,5%,1/16W,TP,1005	1	S.N.A	
...4	R7035	2007-000171	R-CHIP;0ohm,5%,1/16W,TP,1005	1	S.N.A	
...4	R7038	2007-000171	R-CHIP;0ohm,5%,1/16W,TP,1005	1	S.N.A	
...4	R7047	2007-000171	R-CHIP;0ohm,5%,1/16W,TP,1005	1	S.N.A	
...4	R7048	2007-000171	R-CHIP;0ohm,5%,1/16W,TP,1005	1	S.N.A	
...4	R7073	2007-000171	R-CHIP;0ohm,5%,1/16W,TP,1005	1	S.N.A	
...4	R7074	2007-000171	R-CHIP;0ohm,5%,1/16W,TP,1005	1	S.N.A	
...4	R7075	2007-000171	R-CHIP;0ohm,5%,1/16W,TP,1005	1	S.N.A	
...4	R7076	2007-000171	R-CHIP;0ohm,5%,1/16W,TP,1005	1	S.N.A	
...4	R7077	2007-000171	R-CHIP;0ohm,5%,1/16W,TP,1005	1	S.N.A	
...4	R7078	2007-000171	R-CHIP;0ohm,5%,1/16W,TP,1005	1	S.N.A	
...4	R7089	2007-000171	R-CHIP;0ohm,5%,1/16W,TP,1005	1	S.N.A	
...4	R7090	2007-000171	R-CHIP;0ohm,5%,1/16W,TP,1005	1	S.N.A	
...4	R7091	2007-000171	R-CHIP;0ohm,5%,1/16W,TP,1005	1	S.N.A	
...4	R7092	2007-000171	R-CHIP;0ohm,5%,1/16W,TP,1005	1	S.N.A	
...4	R7093	2007-000171	R-CHIP;0ohm,5%,1/16W,TP,1005	1	S.N.A	
...4	R7094	2007-000171	R-CHIP;0ohm,5%,1/16W,TP,1005	1	S.N.A	
...4	R7095	2007-000171	R-CHIP;0ohm,5%,1/16W,TP,1005	1	S.N.A	
...4	R7096	2007-000171	R-CHIP;0ohm,5%,1/16W,TP,1005	1	S.N.A	
...4	R7097	2007-000171	R-CHIP;0ohm,5%,1/16W,TP,1005	1	S.N.A	
...4	R7098	2007-000171	R-CHIP;0ohm,5%,1/16W,TP,1005	1	S.N.A	
...4	R7099	2007-000171	R-CHIP;0ohm,5%,1/16W,TP,1005	1	S.N.A	
...4	R7101	2007-000171	R-CHIP;0ohm,5%,1/16W,TP,1005	1	S.N.A	
...4	R7102	2007-000171	R-CHIP;0ohm,5%,1/16W,TP,1005	1	S.N.A	
...4	R7104	2007-000171	R-CHIP;0ohm,5%,1/16W,TP,1005	1	S.N.A	
...4	R7118	2007-000171	R-CHIP;0ohm,5%,1/16W,TP,1005	1	S.N.A	
...4	R7119	2007-000171	R-CHIP;0ohm,5%,1/16W,TP,1005	1	S.N.A	
...4	R7128	2007-000171	R-CHIP;0ohm,5%,1/16W,TP,1005	1	S.N.A	
...4	R7129	2007-000171	R-CHIP;0ohm,5%,1/16W,TP,1005	1	S.N.A	
...4	R7130	2007-000171	R-CHIP;0ohm,5%,1/16W,TP,1005	1	S.N.A	
...4	R7132	2007-000171	R-CHIP;0ohm,5%,1/16W,TP,1005	1	S.N.A	
...4	R7133	2007-000171	R-CHIP;0ohm,5%,1/16W,TP,1005	1	S.N.A	
...4	R7134	2007-000171	R-CHIP;0ohm,5%,1/16W,TP,1005	1	S.N.A	
...4	R7135_NZIG	2007-000171	R-CHIP;0ohm,5%,1/16W,TP,1005	1	S.N.A	
...4	R7141	2007-000171	R-CHIP;0ohm,5%,1/16W,TP,1005	1	S.N.A	
...4	R7142_NZIG	2007-000171	R-CHIP;0ohm,5%,1/16W,TP,1005	1	S.N.A	
...4	R7143	2007-000171	R-CHIP;0ohm,5%,1/16W,TP,1005	1	S.N.A	
...4	R7144	2007-000171	R-CHIP;0ohm,5%,1/16W,TP,1005	1	S.N.A	

5. Exploded View & Part List

Level	Location No.	Code No.	Description & Specification	Q'ty	SA/SNA	Remark
...4	R7161	2007-000171	R-CHIP;0ohm,5%,1/16W,TP,1005	1	S.N.A	
...4	R7167	2007-000171	R-CHIP;0ohm,5%,1/16W,TP,1005	1	S.N.A	
...4	R7168	2007-000171	R-CHIP;0ohm,5%,1/16W,TP,1005	1	S.N.A	
...4	R7177	2007-000171	R-CHIP;0ohm,5%,1/16W,TP,1005	1	S.N.A	
...4	R7201	2007-000171	R-CHIP;0ohm,5%,1/16W,TP,1005	1	S.N.A	
...4	R7202	2007-000171	R-CHIP;0ohm,5%,1/16W,TP,1005	1	S.N.A	
...4	R7204_120H	2007-000171	R-CHIP;0ohm,5%,1/16W,TP,1005	1	S.N.A	
...4	R7230_120H	2007-000171	R-CHIP;0ohm,5%,1/16W,TP,1005	1	S.N.A	
...4	R7234	2007-000171	R-CHIP;0ohm,5%,1/16W,TP,1005	1	S.N.A	
...4	R7236	2007-000171	R-CHIP;0ohm,5%,1/16W,TP,1005	1	S.N.A	
...4	R7237	2007-000171	R-CHIP;0ohm,5%,1/16W,TP,1005	1	S.N.A	
...4	R7238	2007-000171	R-CHIP;0ohm,5%,1/16W,TP,1005	1	S.N.A	
...4	R7244_120H	2007-000171	R-CHIP;0ohm,5%,1/16W,TP,1005	1	S.N.A	
...4	R7245_120H	2007-000171	R-CHIP;0ohm,5%,1/16W,TP,1005	1	S.N.A	
...4	R7246_120H	2007-000171	R-CHIP;0ohm,5%,1/16W,TP,1005	1	S.N.A	
...4	R7284_LCD	2007-000171	R-CHIP;0ohm,5%,1/16W,TP,1005	1	S.N.A	
...4	R7294_120H	2007-000171	R-CHIP;0ohm,5%,1/16W,TP,1005	1	S.N.A	
...4	R7295_120H	2007-000171	R-CHIP;0ohm,5%,1/16W,TP,1005	1	S.N.A	
...4	R7997	2007-000171	R-CHIP;0ohm,5%,1/16W,TP,1005	1	S.N.A	
...4	R7998	2007-000171	R-CHIP;0ohm,5%,1/16W,TP,1005	1	S.N.A	
...4	R8016	2007-000171	R-CHIP;0ohm,5%,1/16W,TP,1005	1	S.N.A	
...4	R1011	2007-000157	R-CHIP;47Kohm,5%,1/16W,TP,1005	1	S.N.A	
...4	R2007	2007-000157	R-CHIP;47Kohm,5%,1/16W,TP,1005	1	S.N.A	
...4	R2008	2007-000157	R-CHIP;47Kohm,5%,1/16W,TP,1005	1	S.N.A	
...4	R2009	2007-000157	R-CHIP;47Kohm,5%,1/16W,TP,1005	1	S.N.A	
...4	R2010	2007-000157	R-CHIP;47Kohm,5%,1/16W,TP,1005	1	S.N.A	
...4	R2019	2007-000157	R-CHIP;47Kohm,5%,1/16W,TP,1005	1	S.N.A	
...4	R2020	2007-000157	R-CHIP;47Kohm,5%,1/16W,TP,1005	1	S.N.A	
...4	R2021	2007-000157	R-CHIP;47Kohm,5%,1/16W,TP,1005	1	S.N.A	
...4	R2022	2007-000157	R-CHIP;47Kohm,5%,1/16W,TP,1005	1	S.N.A	
...4	R3003	2007-000157	R-CHIP;47Kohm,5%,1/16W,TP,1005	1	S.N.A	
...4	R3040	2007-000157	R-CHIP;47Kohm,5%,1/16W,TP,1005	1	S.N.A	
...4	R3042	2007-000157	R-CHIP;47Kohm,5%,1/16W,TP,1005	1	S.N.A	
...4	R3053	2007-000157	R-CHIP;47Kohm,5%,1/16W,TP,1005	1	S.N.A	
...4	R3055	2007-000157	R-CHIP;47Kohm,5%,1/16W,TP,1005	1	S.N.A	
...4	R3182	2007-000157	R-CHIP;47Kohm,5%,1/16W,TP,1005	1	S.N.A	
...4	R3201	2007-000157	R-CHIP;47Kohm,5%,1/16W,TP,1005	1	S.N.A	
...4	R3204	2007-000157	R-CHIP;47Kohm,5%,1/16W,TP,1005	1	S.N.A	
...4	R3275	2007-000157	R-CHIP;47Kohm,5%,1/16W,TP,1005	1	S.N.A	
...4	R3276	2007-000157	R-CHIP;47Kohm,5%,1/16W,TP,1005	1	S.N.A	
...4	R3820	2007-000157	R-CHIP;47Kohm,5%,1/16W,TP,1005	1	S.N.A	
...4	R4151	2007-000157	R-CHIP;47Kohm,5%,1/16W,TP,1005	1	S.N.A	
...4	R1013	2007-000148	R-CHIP;10Kohm,5%,1/16W,TP,1005	1	S.N.A	
...4	R1015	2007-000148	R-CHIP;10Kohm,5%,1/16W,TP,1005	1	S.N.A	
...4	R2023	2007-000148	R-CHIP;10Kohm,5%,1/16W,TP,1005	1	S.N.A	
...4	R2027	2007-000148	R-CHIP;10Kohm,5%,1/16W,TP,1005	1	S.N.A	
...4	R3168	2007-000148	R-CHIP;10Kohm,5%,1/16W,TP,1005	1	S.N.A	
...4	R3252	2007-000148	R-CHIP;10Kohm,5%,1/16W,TP,1005	1	S.N.A	
...4	R3253	2007-000148	R-CHIP;10Kohm,5%,1/16W,TP,1005	1	S.N.A	
...4	R3310	2007-000148	R-CHIP;10Kohm,5%,1/16W,TP,1005	1	S.N.A	
...4	R3311	2007-000148	R-CHIP;10Kohm,5%,1/16W,TP,1005	1	S.N.A	

5. Exploded View & Part List

Level	Location No.	Code No.	Description & Specification	Q'ty	SA/SNA	Remark
...4	R4017	2007-000148	R-CHIP;10Kohm,5%,1/16W,TP,1005	1	S.N.A	
...4	R4023	2007-000148	R-CHIP;10Kohm,5%,1/16W,TP,1005	1	S.N.A	
...4	R4027	2007-000148	R-CHIP;10Kohm,5%,1/16W,TP,1005	1	S.N.A	
...4	R4078	2007-000148	R-CHIP;10Kohm,5%,1/16W,TP,1005	1	S.N.A	
...4	R4150	2007-000148	R-CHIP;10Kohm,5%,1/16W,TP,1005	1	S.N.A	
...4	R5111	2007-000148	R-CHIP;10Kohm,5%,1/16W,TP,1005	1	S.N.A	
...4	R6847	2007-000148	R-CHIP;10Kohm,5%,1/16W,TP,1005	1	S.N.A	
...4	R7103	2007-000148	R-CHIP;10Kohm,5%,1/16W,TP,1005	1	S.N.A	
...4	R7351	2007-000148	R-CHIP;10Kohm,5%,1/16W,TP,1005	1	S.N.A	
...4	R7411_LCD	2007-000148	R-CHIP;10Kohm,5%,1/16W,TP,1005	1	S.N.A	
...4	R7600_LCD	2007-000148	R-CHIP;10Kohm,5%,1/16W,TP,1005	1	S.N.A	
...4	R7601_LCD	2007-000148	R-CHIP;10Kohm,5%,1/16W,TP,1005	1	S.N.A	
...4	R7603_LCD	2007-000148	R-CHIP;10Kohm,5%,1/16W,TP,1005	1	S.N.A	
...4	R7604_LCD	2007-000148	R-CHIP;10Kohm,5%,1/16W,TP,1005	1	S.N.A	
...4	R8012	2007-000148	R-CHIP;10Kohm,5%,1/16W,TP,1005	1	S.N.A	
...4	R8014	2007-000148	R-CHIP;10Kohm,5%,1/16W,TP,1005	1	S.N.A	
...4	R8015	2007-000148	R-CHIP;10Kohm,5%,1/16W,TP,1005	1	S.N.A	
...4	R8020	2007-000148	R-CHIP;10Kohm,5%,1/16W,TP,1005	1	S.N.A	
...4	R8022	2007-000148	R-CHIP;10Kohm,5%,1/16W,TP,1005	1	S.N.A	
...4	R8023	2007-000148	R-CHIP;10Kohm,5%,1/16W,TP,1005	1	S.N.A	
...4	C2107_WF	2203-000783	C-CER,CHIP;0.33nF,5%,50V,C0G,1608	1	S.A	
...4	C1120	2203-000995	C-CER,CHIP;.047nF,5%,50V,C0G,TP,1005	1	S.A	
...4	C3017	2203-000995	C-CER,CHIP;.047nF,5%,50V,C0G,TP,1005	1	S.A	
...4	C4018	2203-000995	C-CER,CHIP;.047nF,5%,50V,C0G,TP,1005	1	S.A	
...4	C4020	2203-000995	C-CER,CHIP;.047nF,5%,50V,C0G,TP,1005	1	S.A	
...4	C2038	2203-001126	C-CER,CHIP;0.68nF,10%,50V,X7R,1608	1	S.N.A	
...4	C2090_WF	2203-001126	C-CER,CHIP;0.68nF,10%,50V,X7R,1608	1	S.N.A	
...4	C5031	2203-001412	C-CER,CHIP;0.03nF,5%,50V,NP0,TP,1005	1	S.N.A	
...4	C5135	2203-001412	C-CER,CHIP;0.03nF,5%,50V,NP0,TP,1005	1	S.N.A	
...4	C5136	2203-001412	C-CER,CHIP;0.03nF,5%,50V,NP0,TP,1005	1	S.N.A	
...4	C5137	2203-001412	C-CER,CHIP;0.03nF,5%,50V,NP0,TP,1005	1	S.N.A	
...4	R2048	2007-000173	R-CHIP;22ohm,5%,1/16W,TP,1005	1	S.N.A	
...4	R2049	2007-000173	R-CHIP;22ohm,5%,1/16W,TP,1005	1	S.N.A	
...4	R2050	2007-000173	R-CHIP;22ohm,5%,1/16W,TP,1005	1	S.N.A	
...4	R2051	2007-000173	R-CHIP;22ohm,5%,1/16W,TP,1005	1	S.N.A	
...4	R2077_WF	2007-000173	R-CHIP;22ohm,5%,1/16W,TP,1005	1	S.N.A	
...4	R2078_WF	2007-000173	R-CHIP;22ohm,5%,1/16W,TP,1005	1	S.N.A	
...4	R2079_WF	2007-000173	R-CHIP;22ohm,5%,1/16W,TP,1005	1	S.N.A	
...4	R2080_WF	2007-000173	R-CHIP;22ohm,5%,1/16W,TP,1005	1	S.N.A	
...4	R3240	2007-000173	R-CHIP;22ohm,5%,1/16W,TP,1005	1	S.N.A	
...4	R3244	2007-000173	R-CHIP;22ohm,5%,1/16W,TP,1005	1	S.N.A	
...4	R4036	2007-000173	R-CHIP;22ohm,5%,1/16W,TP,1005	1	S.N.A	
...4	R5008	2007-000173	R-CHIP;22ohm,5%,1/16W,TP,1005	1	S.N.A	
...4	R5009	2007-000173	R-CHIP;22ohm,5%,1/16W,TP,1005	1	S.N.A	
...4	R5010	2007-000173	R-CHIP;22ohm,5%,1/16W,TP,1005	1	S.N.A	
...4	R6031	2007-000173	R-CHIP;22ohm,5%,1/16W,TP,1005	1	S.N.A	
...4	R6042	2007-000173	R-CHIP;22ohm,5%,1/16W,TP,1005	1	S.N.A	
...4	R6043	2007-000173	R-CHIP;22ohm,5%,1/16W,TP,1005	1	S.N.A	
...4	R6069	2007-000173	R-CHIP;22ohm,5%,1/16W,TP,1005	1	S.N.A	
...4	R6070	2007-000173	R-CHIP;22ohm,5%,1/16W,TP,1005	1	S.N.A	
...4	R6075	2007-000173	R-CHIP;22ohm,5%,1/16W,TP,1005	1	S.N.A	

5. Exploded View & Part List

Level	Location No.	Code No.	Description & Specification	Q'ty	SA/SNA	Remark
...4	R6076	2007-000173	R-CHIP;22ohm,5%,1/16W,TP,1005	1	S.N.A	
...4	R6184	2007-000173	R-CHIP;22ohm,5%,1/16W,TP,1005	1	S.N.A	
...4	R7115	2007-000173	R-CHIP;22ohm,5%,1/16W,TP,1005	1	S.N.A	
...4	R7124	2007-000173	R-CHIP;22ohm,5%,1/16W,TP,1005	1	S.N.A	
...4	R7126	2007-000173	R-CHIP;22ohm,5%,1/16W,TP,1005	1	S.N.A	
...4	R7127	2007-000173	R-CHIP;22ohm,5%,1/16W,TP,1005	1	S.N.A	
...4	R7159	2007-000173	R-CHIP;22ohm,5%,1/16W,TP,1005	1	S.N.A	
...4	R7175	2007-000173	R-CHIP;22ohm,5%,1/16W,TP,1005	1	S.N.A	
...4	R7200	2007-000173	R-CHIP;22ohm,5%,1/16W,TP,1005	1	S.N.A	
...4	R7650	2007-000173	R-CHIP;22ohm,5%,1/16W,TP,1005	1	S.N.A	
...4	R7651	2007-000173	R-CHIP;22ohm,5%,1/16W,TP,1005	1	S.N.A	
...4	R7652	2007-000173	R-CHIP;22ohm,5%,1/16W,TP,1005	1	S.N.A	
...4	R7653	2007-000173	R-CHIP;22ohm,5%,1/16W,TP,1005	1	S.N.A	
...4	R7654	2007-000173	R-CHIP;22ohm,5%,1/16W,TP,1005	1	S.N.A	
...4	R7655	2007-000173	R-CHIP;22ohm,5%,1/16W,TP,1005	1	S.N.A	
...4	R8021	2007-000173	R-CHIP;22ohm,5%,1/16W,TP,1005	1	S.N.A	
...4	C1004	2203-005249	C-CER,CHIP;100nF,10%,50V,X7R,TP,1608	1	S.N.A	
...4	C1022	2203-005249	C-CER,CHIP;100nF,10%,50V,X7R,TP,1608	1	S.N.A	
...4	C1024	2203-005249	C-CER,CHIP;100nF,10%,50V,X7R,TP,1608	1	S.N.A	
...4	C1048_LCD	2203-005249	C-CER,CHIP;100nF,10%,50V,X7R,TP,1608	1	S.N.A	
...4	C1148_LCD	2203-005249	C-CER,CHIP;100nF,10%,50V,X7R,TP,1608	1	S.N.A	
...4	C1149_LCD	2203-005249	C-CER,CHIP;100nF,10%,50V,X7R,TP,1608	1	S.N.A	
...4	C1150_LCD	2203-005249	C-CER,CHIP;100nF,10%,50V,X7R,TP,1608	1	S.N.A	
...4	C2047	2203-005249	C-CER,CHIP;100nF,10%,50V,X7R,TP,1608	1	S.N.A	
...4	C2048	2203-005249	C-CER,CHIP;100nF,10%,50V,X7R,TP,1608	1	S.N.A	
...4	C2049	2203-005249	C-CER,CHIP;100nF,10%,50V,X7R,TP,1608	1	S.N.A	
...4	C2050	2203-005249	C-CER,CHIP;100nF,10%,50V,X7R,TP,1608	1	S.N.A	
...4	C2051	2203-005249	C-CER,CHIP;100nF,10%,50V,X7R,TP,1608	1	S.N.A	
...4	C2052	2203-005249	C-CER,CHIP;100nF,10%,50V,X7R,TP,1608	1	S.N.A	
...4	C2060	2203-005249	C-CER,CHIP;100nF,10%,50V,X7R,TP,1608	1	S.N.A	
...4	C2061	2203-005249	C-CER,CHIP;100nF,10%,50V,X7R,TP,1608	1	S.N.A	
...4	C2062	2203-005249	C-CER,CHIP;100nF,10%,50V,X7R,TP,1608	1	S.N.A	
...4	C2063	2203-005249	C-CER,CHIP;100nF,10%,50V,X7R,TP,1608	1	S.N.A	
...4	C2066	2203-005249	C-CER,CHIP;100nF,10%,50V,X7R,TP,1608	1	S.N.A	
...4	C2067	2203-005249	C-CER,CHIP;100nF,10%,50V,X7R,TP,1608	1	S.N.A	
...4	C2068	2203-005249	C-CER,CHIP;100nF,10%,50V,X7R,TP,1608	1	S.N.A	
...4	C2069	2203-005249	C-CER,CHIP;100nF,10%,50V,X7R,TP,1608	1	S.N.A	
...4	C2076	2203-005249	C-CER,CHIP;100nF,10%,50V,X7R,TP,1608	1	S.N.A	
...4	C2077	2203-005249	C-CER,CHIP;100nF,10%,50V,X7R,TP,1608	1	S.N.A	
...4	C2078	2203-005249	C-CER,CHIP;100nF,10%,50V,X7R,TP,1608	1	S.N.A	
...4	C2079	2203-005249	C-CER,CHIP;100nF,10%,50V,X7R,TP,1608	1	S.N.A	
...4	C2101_WF	2203-005249	C-CER,CHIP;100nF,10%,50V,X7R,TP,1608	1	S.N.A	
...4	C2102_WF	2203-005249	C-CER,CHIP;100nF,10%,50V,X7R,TP,1608	1	S.N.A	
...4	C2103_WF	2203-005249	C-CER,CHIP;100nF,10%,50V,X7R,TP,1608	1	S.N.A	
...4	C2105_WF	2203-005249	C-CER,CHIP;100nF,10%,50V,X7R,TP,1608	1	S.N.A	
...4	C2106_WF	2203-005249	C-CER,CHIP;100nF,10%,50V,X7R,TP,1608	1	S.N.A	
...4	C2108_WF	2203-005249	C-CER,CHIP;100nF,10%,50V,X7R,TP,1608	1	S.N.A	
...4	C2109_WF	2203-005249	C-CER,CHIP;100nF,10%,50V,X7R,TP,1608	1	S.N.A	
...4	C2110_WF	2203-005249	C-CER,CHIP;100nF,10%,50V,X7R,TP,1608	1	S.N.A	
...4	C2112_WF	2203-005249	C-CER,CHIP;100nF,10%,50V,X7R,TP,1608	1	S.N.A	
...4	C2113_WF	2203-005249	C-CER,CHIP;100nF,10%,50V,X7R,TP,1608	1	S.N.A	

5. Exploded View & Part List

Level	Location No.	Code No.	Description & Specification	Q'ty	SA/SNA	Remark
...4	C2116_WF	2203-005249	C-CER,CHIP;100nF,10%,50V,X7R,TP,1608	1	S.N.A	
...4	C2147_WF	2203-005249	C-CER,CHIP;100nF,10%,50V,X7R,TP,1608	1	S.N.A	
...4	C5021	2203-005249	C-CER,CHIP;100nF,10%,50V,X7R,TP,1608	1	S.N.A	
...4	C5121	2203-005249	C-CER,CHIP;100nF,10%,50V,X7R,TP,1608	1	S.N.A	
...4	C6056	2203-005249	C-CER,CHIP;100nF,10%,50V,X7R,TP,1608	1	S.N.A	
...4	C6057	2203-005249	C-CER,CHIP;100nF,10%,50V,X7R,TP,1608	1	S.N.A	
...4	C6058	2203-005249	C-CER,CHIP;100nF,10%,50V,X7R,TP,1608	1	S.N.A	
...4	C6059	2203-005249	C-CER,CHIP;100nF,10%,50V,X7R,TP,1608	1	S.N.A	
...4	C6062	2203-005249	C-CER,CHIP;100nF,10%,50V,X7R,TP,1608	1	S.N.A	
...4	C6063	2203-005249	C-CER,CHIP;100nF,10%,50V,X7R,TP,1608	1	S.N.A	
...4	C6073	2203-005249	C-CER,CHIP;100nF,10%,50V,X7R,TP,1608	1	S.N.A	
...4	C6074	2203-005249	C-CER,CHIP;100nF,10%,50V,X7R,TP,1608	1	S.N.A	
...4	C6075	2203-005249	C-CER,CHIP;100nF,10%,50V,X7R,TP,1608	1	S.N.A	
...4	C6078	2203-005249	C-CER,CHIP;100nF,10%,50V,X7R,TP,1608	1	S.N.A	
...4	C6094	2203-005249	C-CER,CHIP;100nF,10%,50V,X7R,TP,1608	1	S.N.A	
...4	C6095	2203-005249	C-CER,CHIP;100nF,10%,50V,X7R,TP,1608	1	S.N.A	
...4	C6096	2203-005249	C-CER,CHIP;100nF,10%,50V,X7R,TP,1608	1	S.N.A	
...4	C6100	2203-005249	C-CER,CHIP;100nF,10%,50V,X7R,TP,1608	1	S.N.A	
...4	C7011	2203-005249	C-CER,CHIP;100nF,10%,50V,X7R,TP,1608	1	S.N.A	
...4	C7017	2203-005249	C-CER,CHIP;100nF,10%,50V,X7R,TP,1608	1	S.N.A	
...4	C7049	2203-005249	C-CER,CHIP;100nF,10%,50V,X7R,TP,1608	1	S.N.A	
...4	C7114	2203-005249	C-CER,CHIP;100nF,10%,50V,X7R,TP,1608	1	S.N.A	
...4	C7115	2203-005249	C-CER,CHIP;100nF,10%,50V,X7R,TP,1608	1	S.N.A	
...4	C7121	2203-005249	C-CER,CHIP;100nF,10%,50V,X7R,TP,1608	1	S.N.A	
...4	C7122	2203-005249	C-CER,CHIP;100nF,10%,50V,X7R,TP,1608	1	S.N.A	
...4	C7997	2203-005249	C-CER,CHIP;100nF,10%,50V,X7R,TP,1608	1	S.N.A	
...4	C7998	2203-005249	C-CER,CHIP;100nF,10%,50V,X7R,TP,1608	1	S.N.A	
...4	C2053	2203-006992	C-CER,CHIP;0.33nF,5%,50V,C0G,1005	1	S.N.A	
...4	C2054	2203-006992	C-CER,CHIP;0.33nF,5%,50V,C0G,1005	1	S.N.A	
...4	C3058	2203-006992	C-CER,CHIP;0.33nF,5%,50V,C0G,1005	1	S.N.A	
...4	C3062	2203-006992	C-CER,CHIP;0.33nF,5%,50V,C0G,1005	1	S.N.A	
...4	C1015	2203-007176	C-CER,CHIP;10000nF,10%,16V,X5R,TP,2012 (1	S.N.A	
...4	C1018	2203-007176	C-CER,CHIP;10000nF,10%,16V,X5R,TP,2012 (1	S.N.A	
...4	C2002	2203-007176	C-CER,CHIP;10000nF,10%,16V,X5R,TP,2012 (1	S.N.A	
...4	C2058	2203-007176	C-CER,CHIP;10000nF,10%,16V,X5R,TP,2012 (1	S.N.A	
...4	C5022	2203-007176	C-CER,CHIP;10000nF,10%,16V,X5R,TP,2012 (1	S.N.A	
...4	C6047	2203-007176	C-CER,CHIP;10000nF,10%,16V,X5R,TP,2012 (1	S.N.A	
...4	C2004	2203-006681	C-CER,CHIP;100nF,+80-20%,25V,Y5V,1005	1	S.N.A	
...4	C2008	2203-006681	C-CER,CHIP;100nF,+80-20%,25V,Y5V,1005	1	S.N.A	
...4	C2009	2203-006681	C-CER,CHIP;100nF,+80-20%,25V,Y5V,1005	1	S.N.A	
...4	C2010	2203-006681	C-CER,CHIP;100nF,+80-20%,25V,Y5V,1005	1	S.N.A	
...4	C2056	2203-006681	C-CER,CHIP;100nF,+80-20%,25V,Y5V,1005	1	S.N.A	
...4	C2057	2203-006681	C-CER,CHIP;100nF,+80-20%,25V,Y5V,1005	1	S.N.A	
...4	C2059	2203-006681	C-CER,CHIP;100nF,+80-20%,25V,Y5V,1005	1	S.N.A	
...4	C3077	2203-006681	C-CER,CHIP;100nF,+80-20%,25V,Y5V,1005	1	S.N.A	
...4	C4005	2203-006681	C-CER,CHIP;100nF,+80-20%,25V,Y5V,1005	1	S.N.A	
...4	C5016	2203-006681	C-CER,CHIP;100nF,+80-20%,25V,Y5V,1005	1	S.N.A	
...4	C1005	2203-002285	C-CER,CHIP;10nF,10%,50V,X7R,1005	1	S.N.A	
...4	C1007	2203-002285	C-CER,CHIP;10nF,10%,50V,X7R,1005	1	S.N.A	
...4	C1008	2203-002285	C-CER,CHIP;10nF,10%,50V,X7R,1005	1	S.N.A	
...4	C2006	2203-002285	C-CER,CHIP;10nF,10%,50V,X7R,1005	1	S.N.A	

5. Exploded View & Part List

Level	Location No.	Code No.	Description & Specification	Q'ty	SA/SNA	Remark
...4	C2007	2203-002285	C-CER,CHIP;10nF,10%,50V,X7R,1005	1	S.N.A	
...4	C4008	2203-002285	C-CER,CHIP;10nF,10%,50V,X7R,1005	1	S.N.A	
...4	C4011	2203-002285	C-CER,CHIP;10nF,10%,50V,X7R,1005	1	S.N.A	
...4	C4019	2203-002285	C-CER,CHIP;10nF,10%,50V,X7R,1005	1	S.N.A	
...4	C4021	2203-002285	C-CER,CHIP;10nF,10%,50V,X7R,1005	1	S.N.A	
...4	C4022	2203-002285	C-CER,CHIP;10nF,10%,50V,X7R,1005	1	S.N.A	
...4	C4024	2203-002285	C-CER,CHIP;10nF,10%,50V,X7R,1005	1	S.N.A	
...4	C4100	2203-002285	C-CER,CHIP;10nF,10%,50V,X7R,1005	1	S.N.A	
...4	C5023	2203-002285	C-CER,CHIP;10nF,10%,50V,X7R,1005	1	S.N.A	
...4	C6061	2203-002285	C-CER,CHIP;10nF,10%,50V,X7R,1005	1	S.N.A	
...4	C6077	2203-002285	C-CER,CHIP;10nF,10%,50V,X7R,1005	1	S.N.A	
...4	C6099	2203-002285	C-CER,CHIP;10nF,10%,50V,X7R,1005	1	S.N.A	
...4	C7018	2203-002285	C-CER,CHIP;10nF,10%,50V,X7R,1005	1	S.N.A	
...4	C7136	2203-002285	C-CER,CHIP;10nF,10%,50V,X7R,1005	1	S.N.A	
...4	C7139_LCD	2203-002285	C-CER,CHIP;10nF,10%,50V,X7R,1005	1	S.N.A	
...4	C2036	2203-000280	C-CER,CHIP;0.01nF,0.5pF,50V,C0G,1608	1	S.A	
...4	C2089_WF	2203-000330	C-CER,CHIP;.012nF,5%,50V,C0G,TP,1005	1	S.A	
...4	C6857	2203-000357	C-CER,CHIP;0.15nF,5%,50V,C0G,1608	1	S.N.A	
...4	C7137	2203-000384	C-CER,CHIP;0.015nF,5%,50V,C0G,1608	1	S.N.A	
...4	C1001	2203-000438	C-CER,CHIP;1nF,10%,50V,X7R,TP,1005	1	S.A	
...4	C1029	2203-000438	C-CER,CHIP;1nF,10%,50V,X7R,TP,1005	1	S.A	
...4	C1041_LCD	2203-000438	C-CER,CHIP;1nF,10%,50V,X7R,TP,1005	1	S.A	
...4	C1768	2203-000438	C-CER,CHIP;1nF,10%,50V,X7R,TP,1005	1	S.A	
...4	C4003	2203-000438	C-CER,CHIP;1nF,10%,50V,X7R,TP,1005	1	S.A	
...4	C4012	2203-000438	C-CER,CHIP;1nF,10%,50V,X7R,TP,1005	1	S.A	
...4	C4025	2203-000438	C-CER,CHIP;1nF,10%,50V,X7R,TP,1005	1	S.A	
...4	C4035	2203-000438	C-CER,CHIP;1nF,10%,50V,X7R,TP,1005	1	S.A	
...4	C6090	2203-000438	C-CER,CHIP;1nF,10%,50V,X7R,TP,1005	1	S.A	
...4	RA2001	2011-001262	R-NETWORK;22ohm,5%,1/16W,L,CHIP,8P,TP,2.	1	S.A	
...4	RA2002	2011-001262	R-NETWORK;22ohm,5%,1/16W,L,CHIP,8P,TP,2.	1	S.A	
...4	RA2003	2011-001262	R-NETWORK;22ohm,5%,1/16W,L,CHIP,8P,TP,2.	1	S.A	
...4	RA4001	2011-001262	R-NETWORK;22ohm,5%,1/16W,L,CHIP,8P,TP,2.	1	S.A	
...4	RA4044	2011-001262	R-NETWORK;22ohm,5%,1/16W,L,CHIP,8P,TP,2.	1	S.A	
...4	RA4045	2011-001262	R-NETWORK;22ohm,5%,1/16W,L,CHIP,8P,TP,2.	1	S.A	
...4	RA4046	2011-001262	R-NETWORK;22ohm,5%,1/16W,L,CHIP,8P,TP,2.	1	S.A	
...4	RA4047	2011-001262	R-NETWORK;22ohm,5%,1/16W,L,CHIP,8P,TP,2.	1	S.A	
...4	RA4048	2011-001262	R-NETWORK;22ohm,5%,1/16W,L,CHIP,8P,TP,2.	1	S.A	
...4	RA4051	2011-001262	R-NETWORK;22ohm,5%,1/16W,L,CHIP,8P,TP,2.	1	S.A	
...4	RA6001	2011-001262	R-NETWORK;22ohm,5%,1/16W,L,CHIP,8P,TP,2.	1	S.A	
...4	RA6002	2011-001262	R-NETWORK;22ohm,5%,1/16W,L,CHIP,8P,TP,2.	1	S.A	
...4	RA6003	2011-001262	R-NETWORK;22ohm,5%,1/16W,L,CHIP,8P,TP,2.	1	S.A	
...4	RA6004	2011-001262	R-NETWORK;22ohm,5%,1/16W,L,CHIP,8P,TP,2.	1	S.A	
...4	RA6005	2011-001262	R-NETWORK;22ohm,5%,1/16W,L,CHIP,8P,TP,2.	1	S.A	
...4	RA6006	2011-001262	R-NETWORK;22ohm,5%,1/16W,L,CHIP,8P,TP,2.	1	S.A	
...4	RA6007	2011-001262	R-NETWORK;22ohm,5%,1/16W,L,CHIP,8P,TP,2.	1	S.A	
...4	RA6008	2011-001262	R-NETWORK;22ohm,5%,1/16W,L,CHIP,8P,TP,2.	1	S.A	
...4	RA6009	2011-001262	R-NETWORK;22ohm,5%,1/16W,L,CHIP,8P,TP,2.	1	S.A	
...4	RA6010	2011-001262	R-NETWORK;22ohm,5%,1/16W,L,CHIP,8P,TP,2.	1	S.A	
...4	RA6011	2011-001262	R-NETWORK;22ohm,5%,1/16W,L,CHIP,8P,TP,2.	1	S.A	
...4	RA6012	2011-001262	R-NETWORK;22ohm,5%,1/16W,L,CHIP,8P,TP,2.	1	S.A	
...4	RA6013	2011-001262	R-NETWORK;22ohm,5%,1/16W,L,CHIP,8P,TP,2.	1	S.A	

Level	Location No.	Code No.	Description & Specification	Q'ty	SA/SNA	Remark
...4	RA6015	2011-001262	R-NETWORK;22ohm,5%,1/16W,L,CHIP,8P,TP,2.	1	S.A	
...4	RA7002	2011-001262	R-NETWORK;22ohm,5%,1/16W,L,CHIP,8P,TP,2.	1	S.A	
...4	RA7003	2011-001262	R-NETWORK;22ohm,5%,1/16W,L,CHIP,8P,TP,2.	1	S.A	
...4	RA7004	2011-001262	R-NETWORK;22ohm,5%,1/16W,L,CHIP,8P,TP,2.	1	S.A	
...4	RA7005	2011-001262	R-NETWORK;22ohm,5%,1/16W,L,CHIP,8P,TP,2.	1	S.A	
...4	RA7006	2011-001262	R-NETWORK;22ohm,5%,1/16W,L,CHIP,8P,TP,2.	1	S.A	
...4	RA7007	2011-001262	R-NETWORK;22ohm,5%,1/16W,L,CHIP,8P,TP,2.	1	S.A	
...4	RA7008	2011-001262	R-NETWORK;22ohm,5%,1/16W,L,CHIP,8P,TP,2.	1	S.A	
...4	RA7009	2011-001262	R-NETWORK;22ohm,5%,1/16W,L,CHIP,8P,TP,2.	1	S.A	
...4	RA7010	2011-001262	R-NETWORK;22ohm,5%,1/16W,L,CHIP,8P,TP,2.	1	S.A	
...4	RA7011	2011-001262	R-NETWORK;22ohm,5%,1/16W,L,CHIP,8P,TP,2.	1	S.A	
...4	RA7012	2011-001262	R-NETWORK;22ohm,5%,1/16W,L,CHIP,8P,TP,2.	1	S.A	
...4	RA7041	2011-001262	R-NETWORK;22ohm,5%,1/16W,L,CHIP,8P,TP,2.	1	S.A	
...4	RA7042	2011-001262	R-NETWORK;22ohm,5%,1/16W,L,CHIP,8P,TP,2.	1	S.A	
...4	RA7043	2011-001262	R-NETWORK;22ohm,5%,1/16W,L,CHIP,8P,TP,2.	1	S.A	
...4	RA7044	2011-001262	R-NETWORK;22ohm,5%,1/16W,L,CHIP,8P,TP,2.	1	S.A	
...4	RA7045	2011-001262	R-NETWORK;22ohm,5%,1/16W,L,CHIP,8P,TP,2.	1	S.A	
...4	RA7046	2011-001262	R-NETWORK;22ohm,5%,1/16W,L,CHIP,8P,TP,2.	1	S.A	
...4	RA7047	2011-001262	R-NETWORK;22ohm,5%,1/16W,L,CHIP,8P,TP,2.	1	S.A	
...4	RA7048	2011-001262	R-NETWORK;22ohm,5%,1/16W,L,CHIP,8P,TP,2.	1	S.A	
...4	RA7049	2011-001262	R-NETWORK;22ohm,5%,1/16W,L,CHIP,8P,TP,2.	1	S.A	
...4	RA7050	2011-001262	R-NETWORK;22ohm,5%,1/16W,L,CHIP,8P,TP,2.	1	S.A	
...4	RA7051	2011-001262	R-NETWORK;22ohm,5%,1/16W,L,CHIP,8P,TP,2.	1	S.A	
...4	RA7052	2011-001262	R-NETWORK;22ohm,5%,1/16W,L,CHIP,8P,TP,2.	1	S.A	
...4	RA7500	2011-001262	R-NETWORK;22ohm,5%,1/16W,L,CHIP,8P,TP,2.	1	S.A	
...4	RA7501	2011-001262	R-NETWORK;22ohm,5%,1/16W,L,CHIP,8P,TP,2.	1	S.A	
...4	RA2005	2011-001345	R-NETWORK;10Kohm,5%,1/16W,L,CHIP,8P,TP,2	1	S.N.A	
...4	RA2006	2011-001345	R-NETWORK;10Kohm,5%,1/16W,L,CHIP,8P,TP,2	1	S.N.A	
...4	RA6019	2011-001345	R-NETWORK;10Kohm,5%,1/16W,L,CHIP,8P,TP,2	1	S.N.A	
...4	RA8010	2011-001345	R-NETWORK;10Kohm,5%,1/16W,L,CHIP,8P,TP,2	1	S.N.A	
...4	RA6018	2011-001396	R-NETWORK;4.7Kohm,5%,1/16W,L,CHIP,8P,TP,	1	S.N.A	
...4	RA7013	2011-001396	R-NETWORK;4.7Kohm,5%,1/16W,L,CHIP,8P,TP,	1	S.N.A	
...4	RA7014	2011-001396	R-NETWORK;4.7Kohm,5%,1/16W,L,CHIP,8P,TP,	1	S.N.A	
...4	RA7015	2011-001396	R-NETWORK;4.7Kohm,5%,1/16W,L,CHIP,8P,TP,	1	S.N.A	
...4	RA7020	2011-001396	R-NETWORK;4.7Kohm,5%,1/16W,L,CHIP,8P,TP,	1	S.N.A	
...4	RA7053	2011-001396	R-NETWORK;4.7Kohm,5%,1/16W,L,CHIP,8P,TP,	1	S.N.A	
...4	RA7054	2011-001396	R-NETWORK;4.7Kohm,5%,1/16W,L,CHIP,8P,TP,	1	S.N.A	
...4	RA7502	2011-001396	R-NETWORK;4.7Kohm,5%,1/16W,L,CHIP,8P,TP,	1	S.N.A	
...4	RA7503	2011-001396	R-NETWORK;4.7Kohm,5%,1/16W,L,CHIP,8P,TP,	1	S.N.A	
...4	RA7600	2011-001427	R-NETWORK;0ohm,5%,1/16W,L,CHIP,8P,TP,2.0	1	S.N.A	
...4	RA3006	2011-001449	R-NETWORK;22ohm,5%,1/16W,L,4P,TP,1010	1	S.N.A	
...4	RA3007	2011-001449	R-NETWORK;22ohm,5%,1/16W,L,4P,TP,1010	1	S.N.A	
...4	RA3008	2011-001449	R-NETWORK;22ohm,5%,1/16W,L,4P,TP,1010	1	S.N.A	
...4	RA3009	2011-001449	R-NETWORK;22ohm,5%,1/16W,L,4P,TP,1010	1	S.N.A	
...4	RA4010	2011-001449	R-NETWORK;22ohm,5%,1/16W,L,4P,TP,1010	1	S.N.A	
...4	RA4075	2011-001449	R-NETWORK;22ohm,5%,1/16W,L,4P,TP,1010	1	S.N.A	
...4	RA7060	2011-001589	R-NETWORK;0ohm,5%,1/16W,L,CHIP-V,4P,TP,1	1	S.A	
...4	C6856	2203-000041	C-CER,CHIP;0.01nF,0.25pF,50V,C0G,1608	1	S.N.A	
...4	C2080	2203-000125	C-CER,CHIP;1.2nF,10%,50V,X7R,TP,1608,-	1	S.A	
...4	C2081	2203-000125	C-CER,CHIP;1.2nF,10%,50V,X7R,TP,1608,-	1	S.A	
...4	C2082	2203-000125	C-CER,CHIP;1.2nF,10%,50V,X7R,TP,1608,-	1	S.A	

5. Exploded View & Part List

Level	Location No.	Code No.	Description & Specification	Q'ty	SA/SNA	Remark
...4	C2083	2203-000125	C-CER,CHIP;1.2nF,10%,50V,X7R,TP,1608,-	1	S.A	
...4	C2114_WF	2203-000125	C-CER,CHIP;1.2nF,10%,50V,X7R,TP,1608,-	1	S.A	
...4	C2115_WF	2203-000125	C-CER,CHIP;1.2nF,10%,50V,X7R,TP,1608,-	1	S.A	
...4	R5112	2007-000074	R-CHIP;100ohm,5%,1/10W,TP,1608	1	S.A	
...4	R5001	2007-000402	R-CHIP;150ohm,5%,1/10W,TP,1608	1	S.A	
...4	R3001_EU	2007-000458	R-CHIP;18Kohm,5%,1/10W,TP,1608	1	S.A	
...4	R5031	2007-000563	R-CHIP;220Kohm,1%,1/10W,TP,1608	1	S.A	
...4	BD1613	2007-000572	R-CHIP;220ohm,5%,1/8W,TP,2012	1	S.A	
...4	R5026	2007-000591	R-CHIP;22ohm,1%,1/10W,TP,1608	1	S.A	
...4	R3028_EU	2007-007004	R-CHIP;12Kohm,1%,1/10W,TP,1608	1	S.A	
...4	R5070	2007-007009	R-CHIP;75ohm,5%,1/16W,TP,1005	1	S.N.A	
...4	R5210	2007-007009	R-CHIP;75ohm,5%,1/16W,TP,1005	1	S.N.A	
...4	R5211	2007-007009	R-CHIP;75ohm,5%,1/16W,TP,1005	1	S.N.A	
...4	R5213	2007-007009	R-CHIP;75ohm,5%,1/16W,TP,1005	1	S.N.A	
...4	R5214	2007-007009	R-CHIP;75ohm,5%,1/16W,TP,1005	1	S.N.A	
...4	R5215	2007-007009	R-CHIP;75ohm,5%,1/16W,TP,1005	1	S.N.A	
...4	R6846	2007-007095	R-CHIP;390ohm,5%,1/16W,TP,1005	1	S.N.A	
...4	R2055	2007-007197	R-CHIP;3.3ohm,5%,1/16W,TP,1005	1	S.N.A	
...4	R2056	2007-007197	R-CHIP;3.3ohm,5%,1/16W,TP,1005	1	S.N.A	
...4	R2083_WF	2007-007197	R-CHIP;3.3ohm,5%,1/16W,TP,1005	1	S.N.A	
...4	R2084_WF	2007-007197	R-CHIP;3.3ohm,5%,1/16W,TP,1005	1	S.N.A	
...4	R7111_6V	2007-007318	R-CHIP;1Kohm,1%,1/16W,TP,1005	1	S.N.A	
...4	R7190	2007-007698	R-CHIP;5.1Kohm,1%,1/16W,TP,1005	1	S.N.A	
...4	R7191	2007-007698	R-CHIP;5.1Kohm,1%,1/16W,TP,1005	1	S.N.A	
...4	R7116	2007-007797	R-CHIP;44.2ohm,1%,1/10W,TP,1608	1	S.A	
...4	R7117	2007-007797	R-CHIP;44.2ohm,1%,1/10W,TP,1608	1	S.A	
...4	R3006_EU	2007-008015	R-CHIP;75ohm,1%,1/16W,TP,1005	1	S.N.A	
...4	R3009	2007-008015	R-CHIP;75ohm,1%,1/16W,TP,1005	1	S.N.A	
...4	R3011	2007-008015	R-CHIP;75ohm,1%,1/16W,TP,1005	1	S.N.A	
...4	R3012	2007-008015	R-CHIP;75ohm,1%,1/16W,TP,1005	1	S.N.A	
...4	R3029	2007-008015	R-CHIP;75ohm,1%,1/16W,TP,1005	1	S.N.A	
...4	R3030	2007-008015	R-CHIP;75ohm,1%,1/16W,TP,1005	1	S.N.A	
...4	R3031	2007-008015	R-CHIP;75ohm,1%,1/16W,TP,1005	1	S.N.A	
...4	R3045	2007-008015	R-CHIP;75ohm,1%,1/16W,TP,1005	1	S.N.A	
...4	R3047	2007-008015	R-CHIP;75ohm,1%,1/16W,TP,1005	1	S.N.A	
...4	R3050	2007-008015	R-CHIP;75ohm,1%,1/16W,TP,1005	1	S.N.A	
...4	R3051	2007-008015	R-CHIP;75ohm,1%,1/16W,TP,1005	1	S.N.A	
...4	R3052	2007-008015	R-CHIP;75ohm,1%,1/16W,TP,1005	1	S.N.A	
...4	R3054	2007-008015	R-CHIP;75ohm,1%,1/16W,TP,1005	1	S.N.A	
...4	R3064	2007-008015	R-CHIP;75ohm,1%,1/16W,TP,1005	1	S.N.A	
...4	R3065	2007-008015	R-CHIP;75ohm,1%,1/16W,TP,1005	1	S.N.A	
...4	R3066	2007-008015	R-CHIP;75ohm,1%,1/16W,TP,1005	1	S.N.A	
...4	R3208	2007-008015	R-CHIP;75ohm,1%,1/16W,TP,1005	1	S.N.A	
...4	R3209	2007-008015	R-CHIP;75ohm,1%,1/16W,TP,1005	1	S.N.A	
...4	R3210	2007-008015	R-CHIP;75ohm,1%,1/16W,TP,1005	1	S.N.A	
...4	R3241	2007-008015	R-CHIP;75ohm,1%,1/16W,TP,1005	1	S.N.A	
...4	R3242	2007-008015	R-CHIP;75ohm,1%,1/16W,TP,1005	1	S.N.A	
...4	R5032	2007-008015	R-CHIP;75ohm,1%,1/16W,TP,1005	1	S.N.A	
...4	R1020	2007-008593	R-CHIP;750ohm,1%,1/16W,TP,1005	1	S.A	
...4	R1030_LCD	2007-000143	R-CHIP;4.7Kohm,5%,1/16W,TP,1005	1	S.N.A	
...4	R1060	2007-000143	R-CHIP;4.7Kohm,5%,1/16W,TP,1005	1	S.N.A	

5. Exploded View & Part List

Level	Location No.	Code No.	Description & Specification	Q'ty	SA/SNA	Remark
...4	R1070	2007-000143	R-CHIP;4.7Kohm,5%,1/16W,TP,1005	1	S.N.A	
...4	R1170	2007-000143	R-CHIP;4.7Kohm,5%,1/16W,TP,1005	1	S.N.A	
...4	R2062	2007-000143	R-CHIP;4.7Kohm,5%,1/16W,TP,1005	1	S.N.A	
...4	R2063	2007-000143	R-CHIP;4.7Kohm,5%,1/16W,TP,1005	1	S.N.A	
...4	R3159	2007-000143	R-CHIP;4.7Kohm,5%,1/16W,TP,1005	1	S.N.A	
...4	R3272	2007-000143	R-CHIP;4.7Kohm,5%,1/16W,TP,1005	1	S.N.A	
...4	R3273	2007-000143	R-CHIP;4.7Kohm,5%,1/16W,TP,1005	1	S.N.A	
...4	R3274	2007-000143	R-CHIP;4.7Kohm,5%,1/16W,TP,1005	1	S.N.A	
...4	R4016	2007-000143	R-CHIP;4.7Kohm,5%,1/16W,TP,1005	1	S.N.A	
...4	R4018	2007-000143	R-CHIP;4.7Kohm,5%,1/16W,TP,1005	1	S.N.A	
...4	R4020	2007-000143	R-CHIP;4.7Kohm,5%,1/16W,TP,1005	1	S.N.A	
...4	R4057	2007-000143	R-CHIP;4.7Kohm,5%,1/16W,TP,1005	1	S.N.A	
...4	R4059	2007-000143	R-CHIP;4.7Kohm,5%,1/16W,TP,1005	1	S.N.A	
...4	R4066	2007-000143	R-CHIP;4.7Kohm,5%,1/16W,TP,1005	1	S.N.A	
...4	R4074	2007-000143	R-CHIP;4.7Kohm,5%,1/16W,TP,1005	1	S.N.A	
...4	R4077	2007-000143	R-CHIP;4.7Kohm,5%,1/16W,TP,1005	1	S.N.A	
...4	R4098_CI+	2007-000143	R-CHIP;4.7Kohm,5%,1/16W,TP,1005	1	S.N.A	
...4	R4099_CI+	2007-000143	R-CHIP;4.7Kohm,5%,1/16W,TP,1005	1	S.N.A	
...4	R4771	2007-000143	R-CHIP;4.7Kohm,5%,1/16W,TP,1005	1	S.N.A	
...4	R4772	2007-000143	R-CHIP;4.7Kohm,5%,1/16W,TP,1005	1	S.N.A	
...4	R4773	2007-000143	R-CHIP;4.7Kohm,5%,1/16W,TP,1005	1	S.N.A	
...4	R4774	2007-000143	R-CHIP;4.7Kohm,5%,1/16W,TP,1005	1	S.N.A	
...4	R5017	2007-000143	R-CHIP;4.7Kohm,5%,1/16W,TP,1005	1	S.N.A	
...4	R6015	2007-000143	R-CHIP;4.7Kohm,5%,1/16W,TP,1005	1	S.N.A	
...4	R6021	2007-000143	R-CHIP;4.7Kohm,5%,1/16W,TP,1005	1	S.N.A	
...4	R6023	2007-000143	R-CHIP;4.7Kohm,5%,1/16W,TP,1005	1	S.N.A	
...4	R6038	2007-000143	R-CHIP;4.7Kohm,5%,1/16W,TP,1005	1	S.N.A	
...4	R6039	2007-000143	R-CHIP;4.7Kohm,5%,1/16W,TP,1005	1	S.N.A	
...4	R6040	2007-000143	R-CHIP;4.7Kohm,5%,1/16W,TP,1005	1	S.N.A	
...4	R6048	2007-000143	R-CHIP;4.7Kohm,5%,1/16W,TP,1005	1	S.N.A	
...4	R6053	2007-000143	R-CHIP;4.7Kohm,5%,1/16W,TP,1005	1	S.N.A	
...4	R6100	2007-000143	R-CHIP;4.7Kohm,5%,1/16W,TP,1005	1	S.N.A	
...4	R6101	2007-000143	R-CHIP;4.7Kohm,5%,1/16W,TP,1005	1	S.N.A	
...4	R6102	2007-000143	R-CHIP;4.7Kohm,5%,1/16W,TP,1005	1	S.N.A	
...4	R7010	2007-000143	R-CHIP;4.7Kohm,5%,1/16W,TP,1005	1	S.N.A	
...4	R7012	2007-000143	R-CHIP;4.7Kohm,5%,1/16W,TP,1005	1	S.N.A	
...4	R7013	2007-000143	R-CHIP;4.7Kohm,5%,1/16W,TP,1005	1	S.N.A	
...4	R7017	2007-000143	R-CHIP;4.7Kohm,5%,1/16W,TP,1005	1	S.N.A	
...4	R7033	2007-000143	R-CHIP;4.7Kohm,5%,1/16W,TP,1005	1	S.N.A	
...4	R7034	2007-000143	R-CHIP;4.7Kohm,5%,1/16W,TP,1005	1	S.N.A	
...4	R7036	2007-000143	R-CHIP;4.7Kohm,5%,1/16W,TP,1005	1	S.N.A	
...4	R7037	2007-000143	R-CHIP;4.7Kohm,5%,1/16W,TP,1005	1	S.N.A	
...4	R7060	2007-000143	R-CHIP;4.7Kohm,5%,1/16W,TP,1005	1	S.N.A	
...4	R7063	2007-000143	R-CHIP;4.7Kohm,5%,1/16W,TP,1005	1	S.N.A	
...4	R7064	2007-000143	R-CHIP;4.7Kohm,5%,1/16W,TP,1005	1	S.N.A	
...4	R7065	2007-000143	R-CHIP;4.7Kohm,5%,1/16W,TP,1005	1	S.N.A	
...4	R7067	2007-000143	R-CHIP;4.7Kohm,5%,1/16W,TP,1005	1	S.N.A	
...4	R7068	2007-000143	R-CHIP;4.7Kohm,5%,1/16W,TP,1005	1	S.N.A	
...4	R7131	2007-000143	R-CHIP;4.7Kohm,5%,1/16W,TP,1005	1	S.N.A	
...4	R7136	2007-000143	R-CHIP;4.7Kohm,5%,1/16W,TP,1005	1	S.N.A	
...4	R7137	2007-000143	R-CHIP;4.7Kohm,5%,1/16W,TP,1005	1	S.N.A	

5. Exploded View & Part List

Level	Location No.	Code No.	Description & Specification	Q'ty	SA/SNA	Remark
...4	R7156	2007-000143	R-CHIP;4.7Kohm,5%,1/16W,TP,1005	1	S.N.A	
...4	R7174	2007-000143	R-CHIP;4.7Kohm,5%,1/16W,TP,1005	1	S.N.A	
...4	R7239	2007-000143	R-CHIP;4.7Kohm,5%,1/16W,TP,1005	1	S.N.A	
...4	R7240	2007-000143	R-CHIP;4.7Kohm,5%,1/16W,TP,1005	1	S.N.A	
...4	R7400	2007-000143	R-CHIP;4.7Kohm,5%,1/16W,TP,1005	1	S.N.A	
...4	R7401	2007-000143	R-CHIP;4.7Kohm,5%,1/16W,TP,1005	1	S.N.A	
...4	R7800	2007-000143	R-CHIP;4.7Kohm,5%,1/16W,TP,1005	1	S.N.A	
...4	CA2001	2503-001051	C-NETWORK;100nFx4,20%,16V,2012	1	S.A	
...4	CA2002	2503-001051	C-NETWORK;100nFx4,20%,16V,2012	1	S.A	
...4	CA6003	2503-001051	C-NETWORK;100nFx4,20%,16V,2012	1	S.A	
...4	CA6004	2503-001051	C-NETWORK;100nFx4,20%,16V,2012	1	S.A	
...4	CA6005	2503-001051	C-NETWORK;100nFx4,20%,16V,2012	1	S.A	
...4	CA7600	2503-001051	C-NETWORK;100nFx4,20%,16V,2012	1	S.A	
...4	CA7601	2503-001051	C-NETWORK;100nFx4,20%,16V,2012	1	S.A	
...4	C1040_LCD	2203-006562	C-CER,CHIP;1000nF,10%,10V,X5R,TP,1005	1	S.N.A	
...4	C1042_LCD	2203-006562	C-CER,CHIP;1000nF,10%,10V,X5R,TP,1005	1	S.N.A	
...4	C2023	2203-006562	C-CER,CHIP;1000nF,10%,10V,X5R,TP,1005	1	S.N.A	
...4	C2024	2203-006562	C-CER,CHIP;1000nF,10%,10V,X5R,TP,1005	1	S.N.A	
...4	C2025	2203-006562	C-CER,CHIP;1000nF,10%,10V,X5R,TP,1005	1	S.N.A	
...4	C2026	2203-006562	C-CER,CHIP;1000nF,10%,10V,X5R,TP,1005	1	S.N.A	
...4	C2029	2203-006562	C-CER,CHIP;1000nF,10%,10V,X5R,TP,1005	1	S.N.A	
...4	C2030	2203-006562	C-CER,CHIP;1000nF,10%,10V,X5R,TP,1005	1	S.N.A	
...4	C3901	2203-006562	C-CER,CHIP;1000nF,10%,10V,X5R,TP,1005	1	S.N.A	
...4	C3902	2203-006562	C-CER,CHIP;1000nF,10%,10V,X5R,TP,1005	1	S.N.A	
...4	C3903	2203-006562	C-CER,CHIP;1000nF,10%,10V,X5R,TP,1005	1	S.N.A	
...4	C3904	2203-006562	C-CER,CHIP;1000nF,10%,10V,X5R,TP,1005	1	S.N.A	
...4	C4004	2203-006562	C-CER,CHIP;1000nF,10%,10V,X5R,TP,1005	1	S.N.A	
...4	C6040	2203-006562	C-CER,CHIP;1000nF,10%,10V,X5R,TP,1005	1	S.N.A	
...4	C6041	2203-006562	C-CER,CHIP;1000nF,10%,10V,X5R,TP,1005	1	S.N.A	
...4	C6060	2203-006562	C-CER,CHIP;1000nF,10%,10V,X5R,TP,1005	1	S.N.A	
...4	C6076	2203-006562	C-CER,CHIP;1000nF,10%,10V,X5R,TP,1005	1	S.N.A	
...4	C6097	2203-006562	C-CER,CHIP;1000nF,10%,10V,X5R,TP,1005	1	S.N.A	
...4	C6851	2203-006562	C-CER,CHIP;1000nF,10%,10V,X5R,TP,1005	1	S.N.A	
...4	C6852	2203-006562	C-CER,CHIP;1000nF,10%,10V,X5R,TP,1005	1	S.N.A	
...4	C6853	2203-006562	C-CER,CHIP;1000nF,10%,10V,X5R,TP,1005	1	S.N.A	
...4	C7003	2203-006562	C-CER,CHIP;1000nF,10%,10V,X5R,TP,1005	1	S.N.A	
...4	C7028	2203-006562	C-CER,CHIP;1000nF,10%,10V,X5R,TP,1005	1	S.N.A	
...4	C7030	2203-006562	C-CER,CHIP;1000nF,10%,10V,X5R,TP,1005	1	S.N.A	
...4	C7037	2203-006562	C-CER,CHIP;1000nF,10%,10V,X5R,TP,1005	1	S.N.A	
...4	C7039	2203-006562	C-CER,CHIP;1000nF,10%,10V,X5R,TP,1005	1	S.N.A	
...4	C7040	2203-006562	C-CER,CHIP;1000nF,10%,10V,X5R,TP,1005	1	S.N.A	
...4	C7072	2203-006562	C-CER,CHIP;1000nF,10%,10V,X5R,TP,1005	1	S.N.A	
...4	C7089	2203-006562	C-CER,CHIP;1000nF,10%,10V,X5R,TP,1005	1	S.N.A	
...4	C7097	2203-006562	C-CER,CHIP;1000nF,10%,10V,X5R,TP,1005	1	S.N.A	
...4	C7141	2203-006562	C-CER,CHIP;1000nF,10%,10V,X5R,TP,1005	1	S.N.A	
...4	C7156	2203-006562	C-CER,CHIP;1000nF,10%,10V,X5R,TP,1005	1	S.N.A	
...4	C7204	2203-006562	C-CER,CHIP;1000nF,10%,10V,X5R,TP,1005	1	S.N.A	
...4	C7209	2203-006562	C-CER,CHIP;1000nF,10%,10V,X5R,TP,1005	1	S.N.A	
...4	C5040	2203-006104	C-CER,CHIP;1000nF,10%,50V,X7R,3225	1	S.A	
...4	C6098	2203-006126	C-CER,CHIP;47NF,10%,16V,X7R,TP,1005	1	S.N.A	
...4	C1019	2203-006141	C-CER,CHIP;1000nF,10%,16V,X5R,1608	1	S.N.A	

5. Exploded View & Part List

Level	Location No.	Code No.	Description & Specification	Q'ty	SA/SNA	Remark
...4	C1025	2203-006141	C-CER,CHIP;1000nF,10%,16V,X5R,1608	1	S.N.A	
...4	C1028	2203-006141	C-CER,CHIP;1000nF,10%,16V,X5R,1608	1	S.N.A	
...4	C1060	2203-006141	C-CER,CHIP;1000nF,10%,16V,X5R,1608	1	S.N.A	
...4	C7084	2203-006141	C-CER,CHIP;1000nF,10%,16V,X5R,1608	1	S.N.A	
...4	C7178	2203-006141	C-CER,CHIP;1000nF,10%,16V,X5R,1608	1	S.N.A	
...4	C7601_LCD	2203-006141	C-CER,CHIP;1000nF,10%,16V,X5R,1608	1	S.N.A	
...4	C2084	2203-006382	C-CER,CHIP;10000nF,10%,25V,X7R,TP,3225	1	S.N.A	
...4	C2085	2203-006382	C-CER,CHIP;10000nF,10%,25V,X7R,TP,3225	1	S.N.A	
...4	C2086	2203-006382	C-CER,CHIP;10000nF,10%,25V,X7R,TP,3225	1	S.N.A	
...4	C2087	2203-006382	C-CER,CHIP;10000nF,10%,25V,X7R,TP,3225	1	S.N.A	
...4	C2185_WF	2203-006382	C-CER,CHIP;10000nF,10%,25V,X7R,TP,3225	1	S.N.A	
...4	C2186_WF	2203-006382	C-CER,CHIP;10000nF,10%,25V,X7R,TP,3225	1	S.N.A	
...4	C5010	2203-002494	C-CER,CHIP;470nF,10%,16V,X7R,2012	1	S.N.A	
...4	C7050	2203-005138	C-CER,CHIP;1.8nF,10%,50V,X7R,1005	1	S.A	
...4	C7051	2203-005138	C-CER,CHIP;1.8nF,10%,50V,X7R,1005	1	S.A	
...4	C7052	2203-005138	C-CER,CHIP;1.8nF,10%,50V,X7R,1005	1	S.A	
...4	C2040	2203-000233	C-CER,CHIP;0.1nF,5%,50V,C0G,TP,1005	1	S.A	
...4	C2091_WF	2203-000233	C-CER,CHIP;0.1nF,5%,50V,C0G,TP,1005	1	S.A	
...4	C3002	2203-000233	C-CER,CHIP;0.1nF,5%,50V,C0G,TP,1005	1	S.A	
...4	C3013	2203-000233	C-CER,CHIP;0.1nF,5%,50V,C0G,TP,1005	1	S.A	
...4	C3015	2203-000233	C-CER,CHIP;0.1nF,5%,50V,C0G,TP,1005	1	S.A	
...4	C3021	2203-000233	C-CER,CHIP;0.1nF,5%,50V,C0G,TP,1005	1	S.A	
...4	C3023	2203-000233	C-CER,CHIP;0.1nF,5%,50V,C0G,TP,1005	1	S.A	
...4	C3066	2203-000233	C-CER,CHIP;0.1nF,5%,50V,C0G,TP,1005	1	S.A	
...4	C3250	2203-000233	C-CER,CHIP;0.1nF,5%,50V,C0G,TP,1005	1	S.A	
...4	C3251	2203-000233	C-CER,CHIP;0.1nF,5%,50V,C0G,TP,1005	1	S.A	
...4	RA5005	2011-001261	R-NETWORK;33ohm,5%,1/16W,L,CHIP,8P,TP,2.	1	S.A	
...4	RA5006	2011-001261	R-NETWORK;33ohm,5%,1/16W,L,CHIP,8P,TP,2.	1	S.A	
...4	RA8006	2011-001261	R-NETWORK;33ohm,5%,1/16W,L,CHIP,8P,TP,2.	1	S.A	
...4	RA8007	2011-001261	R-NETWORK;33ohm,5%,1/16W,L,CHIP,8P,TP,2.	1	S.A	
...4	RA8008	2011-001261	R-NETWORK;33ohm,5%,1/16W,L,CHIP,8P,TP,2.	1	S.A	
...4	R7050	2007-000137	R-CHIP;2Kohm,5%,1/16W,TP,1005	1	S.N.A	
...4	R7053	2007-000137	R-CHIP;2Kohm,5%,1/16W,TP,1005	1	S.N.A	
...4	R7056	2007-000137	R-CHIP;2Kohm,5%,1/16W,TP,1005	1	S.N.A	
...4	R7058	2007-000137	R-CHIP;2Kohm,5%,1/16W,TP,1005	1	S.N.A	
...4	R7062	2007-000137	R-CHIP;2Kohm,5%,1/16W,TP,1005	1	S.N.A	
...4	R7066	2007-000137	R-CHIP;2Kohm,5%,1/16W,TP,1005	1	S.N.A	
...4	R7069	2007-000137	R-CHIP;2Kohm,5%,1/16W,TP,1005	1	S.N.A	
...4	R7070	2007-000137	R-CHIP;2Kohm,5%,1/16W,TP,1005	1	S.N.A	
...4	C7009	2203-005344	C-CER,CHIP;22nF,10%,25V,X7R,TP,1005,-	1	S.N.A	
...4	C7016	2203-005344	C-CER,CHIP;22nF,10%,25V,X7R,TP,1005,-	1	S.N.A	
...4	C7025	2203-005344	C-CER,CHIP;22nF,10%,25V,X7R,TP,1005,-	1	S.N.A	
...4	C7029	2203-005344	C-CER,CHIP;22nF,10%,25V,X7R,TP,1005,-	1	S.N.A	
...4	C7059	2203-005344	C-CER,CHIP;22nF,10%,25V,X7R,TP,1005,-	1	S.N.A	
...4	C7063	2203-005344	C-CER,CHIP;22nF,10%,25V,X7R,TP,1005,-	1	S.N.A	
...4	C7065	2203-005344	C-CER,CHIP;22nF,10%,25V,X7R,TP,1005,-	1	S.N.A	
...4	C7073	2203-005344	C-CER,CHIP;22nF,10%,25V,X7R,TP,1005,-	1	S.N.A	
...4	C7088	2203-005344	C-CER,CHIP;22nF,10%,25V,X7R,TP,1005,-	1	S.N.A	
...4	C7105	2203-005344	C-CER,CHIP;22nF,10%,25V,X7R,TP,1005,-	1	S.N.A	
...4	C7106	2203-005344	C-CER,CHIP;22nF,10%,25V,X7R,TP,1005,-	1	S.N.A	
...4	C7148	2203-005344	C-CER,CHIP;22nF,10%,25V,X7R,TP,1005,-	1	S.N.A	

5. Exploded View & Part List

Level	Location No.	Code No.	Description & Specification	Q'ty	SA/SNA	Remark
...4	C7157	2203-005344	C-CER,CHIP;22nF,10%,25V,X7R,TP,1005,-	1	S.N.A	
...4	C7173	2203-005344	C-CER,CHIP;22nF,10%,25V,X7R,TP,1005,-	1	S.N.A	
...4	C7205	2203-005344	C-CER,CHIP;22nF,10%,25V,X7R,TP,1005,-	1	S.N.A	
...4	C7210	2203-005344	C-CER,CHIP;22nF,10%,25V,X7R,TP,1005,-	1	S.N.A	
...4	C7770	2203-005344	C-CER,CHIP;22nF,10%,25V,X7R,TP,1005,-	1	S.N.A	
...4	C3063	2203-005393	C-CER,CHIP;0.005nF,0.1pF,50V,NP0,TP,1005	1	S.N.A	
...4	C2093_WF	2203-005437	C-CER,CHIP;10000nF,+80-20%,10V,Y5V,3216	1	S.N.A	
...4	C2099_WF	2203-005437	C-CER,CHIP;10000nF,+80-20%,10V,Y5V,3216	1	S.N.A	
...4	C1002	2203-006158	C-CER,CHIP;100nF,10%,16V,X7R,1005	1	S.N.A	
...4	C1003	2203-006158	C-CER,CHIP;100nF,10%,16V,X7R,1005	1	S.N.A	
...4	C1006	2203-006158	C-CER,CHIP;100nF,10%,16V,X7R,1005	1	S.N.A	
...4	C1012	2203-006158	C-CER,CHIP;100nF,10%,16V,X7R,1005	1	S.N.A	
...4	C1014	2203-006158	C-CER,CHIP;100nF,10%,16V,X7R,1005	1	S.N.A	
...4	C1030	2203-006158	C-CER,CHIP;100nF,10%,16V,X7R,1005	1	S.N.A	
...4	C1034	2203-006158	C-CER,CHIP;100nF,10%,16V,X7R,1005	1	S.N.A	
...4	C1080	2203-006158	C-CER,CHIP;100nF,10%,16V,X7R,1005	1	S.N.A	
...4	C1091	2203-006158	C-CER,CHIP;100nF,10%,16V,X7R,1005	1	S.N.A	
...4	C1092	2203-006158	C-CER,CHIP;100nF,10%,16V,X7R,1005	1	S.N.A	
...4	C1191	2203-006158	C-CER,CHIP;100nF,10%,16V,X7R,1005	1	S.N.A	
...4	C1192	2203-006158	C-CER,CHIP;100nF,10%,16V,X7R,1005	1	S.N.A	
...4	C1639	2203-006158	C-CER,CHIP;100nF,10%,16V,X7R,1005	1	S.N.A	
...4	C1801	2203-006158	C-CER,CHIP;100nF,10%,16V,X7R,1005	1	S.N.A	
...4	C2027	2203-006158	C-CER,CHIP;100nF,10%,16V,X7R,1005	1	S.N.A	
...4	C2028	2203-006158	C-CER,CHIP;100nF,10%,16V,X7R,1005	1	S.N.A	
...4	C2037	2203-006158	C-CER,CHIP;100nF,10%,16V,X7R,1005	1	S.N.A	
...4	C2039	2203-006158	C-CER,CHIP;100nF,10%,16V,X7R,1005	1	S.N.A	
...4	C2042	2203-006158	C-CER,CHIP;100nF,10%,16V,X7R,1005	1	S.N.A	
...4	C2043	2203-006158	C-CER,CHIP;100nF,10%,16V,X7R,1005	1	S.N.A	
...4	C2044	2203-006158	C-CER,CHIP;100nF,10%,16V,X7R,1005	1	S.N.A	
...4	C2045	2203-006158	C-CER,CHIP;100nF,10%,16V,X7R,1005	1	S.N.A	
...4	C2088_WF	2203-006158	C-CER,CHIP;100nF,10%,16V,X7R,1005	1	S.N.A	
...4	C2094_WF	2203-006158	C-CER,CHIP;100nF,10%,16V,X7R,1005	1	S.N.A	
...4	C2095_WF	2203-006158	C-CER,CHIP;100nF,10%,16V,X7R,1005	1	S.N.A	
...4	C2096_WF	2203-006158	C-CER,CHIP;100nF,10%,16V,X7R,1005	1	S.N.A	
...4	C2097_WF	2203-006158	C-CER,CHIP;100nF,10%,16V,X7R,1005	1	S.N.A	
...4	C2098_WF	2203-006158	C-CER,CHIP;100nF,10%,16V,X7R,1005	1	S.N.A	
...4	C3046	2203-006158	C-CER,CHIP;100nF,10%,16V,X7R,1005	1	S.N.A	
...4	C3054	2203-006158	C-CER,CHIP;100nF,10%,16V,X7R,1005	1	S.N.A	
...4	C3055	2203-006158	C-CER,CHIP;100nF,10%,16V,X7R,1005	1	S.N.A	
...4	C3056	2203-006158	C-CER,CHIP;100nF,10%,16V,X7R,1005	1	S.N.A	
...4	C3057	2203-006158	C-CER,CHIP;100nF,10%,16V,X7R,1005	1	S.N.A	
...4	C3065	2203-006158	C-CER,CHIP;100nF,10%,16V,X7R,1005	1	S.N.A	
...4	C3070	2203-006158	C-CER,CHIP;100nF,10%,16V,X7R,1005	1	S.N.A	
...4	C3071	2203-006158	C-CER,CHIP;100nF,10%,16V,X7R,1005	1	S.N.A	
...4	C3072	2203-006158	C-CER,CHIP;100nF,10%,16V,X7R,1005	1	S.N.A	
...4	C3100	2203-006158	C-CER,CHIP;100nF,10%,16V,X7R,1005	1	S.N.A	
...4	C3101	2203-006158	C-CER,CHIP;100nF,10%,16V,X7R,1005	1	S.N.A	
...4	C3102	2203-006158	C-CER,CHIP;100nF,10%,16V,X7R,1005	1	S.N.A	
...4	C4002	2203-006158	C-CER,CHIP;100nF,10%,16V,X7R,1005	1	S.N.A	
...4	C4006	2203-006158	C-CER,CHIP;100nF,10%,16V,X7R,1005	1	S.N.A	
...4	C4013	2203-006158	C-CER,CHIP;100nF,10%,16V,X7R,1005	1	S.N.A	

5. Exploded View & Part List

Level	Location No.	Code No.	Description & Specification	Q'ty	SA/SNA	Remark
...4	C4014	2203-006158	C-CER,CHIP;100nF,10%,16V,X7R,1005	1	S.N.A	
...4	C4016	2203-006158	C-CER,CHIP;100nF,10%,16V,X7R,1005	1	S.N.A	
...4	C4023	2203-006158	C-CER,CHIP;100nF,10%,16V,X7R,1005	1	S.N.A	
...4	C4026	2203-006158	C-CER,CHIP;100nF,10%,16V,X7R,1005	1	S.N.A	
...4	C4036	2203-006158	C-CER,CHIP;100nF,10%,16V,X7R,1005	1	S.N.A	
...4	C4050	2203-006158	C-CER,CHIP;100nF,10%,16V,X7R,1005	1	S.N.A	
...4	C4103	2203-006158	C-CER,CHIP;100nF,10%,16V,X7R,1005	1	S.N.A	
...4	C5011	2203-006158	C-CER,CHIP;100nF,10%,16V,X7R,1005	1	S.N.A	
...4	C5020	2203-006158	C-CER,CHIP;100nF,10%,16V,X7R,1005	1	S.N.A	
...4	C5024	2203-006158	C-CER,CHIP;100nF,10%,16V,X7R,1005	1	S.N.A	
...4	C5027	2203-006158	C-CER,CHIP;100nF,10%,16V,X7R,1005	1	S.N.A	
...4	C5070	2203-006158	C-CER,CHIP;100nF,10%,16V,X7R,1005	1	S.N.A	
...4	C5071	2203-006158	C-CER,CHIP;100nF,10%,16V,X7R,1005	1	S.N.A	
...4	C5072	2203-006158	C-CER,CHIP;100nF,10%,16V,X7R,1005	1	S.N.A	
...4	C5073	2203-006158	C-CER,CHIP;100nF,10%,16V,X7R,1005	1	S.N.A	
...4	C5112	2203-006158	C-CER,CHIP;100nF,10%,16V,X7R,1005	1	S.N.A	
...4	C6020	2203-006158	C-CER,CHIP;100nF,10%,16V,X7R,1005	1	S.N.A	
...4	C6021	2203-006158	C-CER,CHIP;100nF,10%,16V,X7R,1005	1	S.N.A	
...4	C6027	2203-006158	C-CER,CHIP;100nF,10%,16V,X7R,1005	1	S.N.A	
...4	C6028	2203-006158	C-CER,CHIP;100nF,10%,16V,X7R,1005	1	S.N.A	
...4	C6033	2203-006158	C-CER,CHIP;100nF,10%,16V,X7R,1005	1	S.N.A	
...4	C6042	2203-006158	C-CER,CHIP;100nF,10%,16V,X7R,1005	1	S.N.A	
...4	C6043	2203-006158	C-CER,CHIP;100nF,10%,16V,X7R,1005	1	S.N.A	
...4	C6048	2203-006158	C-CER,CHIP;100nF,10%,16V,X7R,1005	1	S.N.A	
...4	C6052	2203-006158	C-CER,CHIP;100nF,10%,16V,X7R,1005	1	S.N.A	
...4	C6053	2203-006158	C-CER,CHIP;100nF,10%,16V,X7R,1005	1	S.N.A	
...4	C6064	2203-006158	C-CER,CHIP;100nF,10%,16V,X7R,1005	1	S.N.A	
...4	C6065	2203-006158	C-CER,CHIP;100nF,10%,16V,X7R,1005	1	S.N.A	
...4	C6066	2203-006158	C-CER,CHIP;100nF,10%,16V,X7R,1005	1	S.N.A	
...4	C6067	2203-006158	C-CER,CHIP;100nF,10%,16V,X7R,1005	1	S.N.A	
...4	C6068	2203-006158	C-CER,CHIP;100nF,10%,16V,X7R,1005	1	S.N.A	
...4	C6069	2203-006158	C-CER,CHIP;100nF,10%,16V,X7R,1005	1	S.N.A	
...4	C6070	2203-006158	C-CER,CHIP;100nF,10%,16V,X7R,1005	1	S.N.A	
...4	C6079	2203-006158	C-CER,CHIP;100nF,10%,16V,X7R,1005	1	S.N.A	
...4	C6080	2203-006158	C-CER,CHIP;100nF,10%,16V,X7R,1005	1	S.N.A	
...4	C6081	2203-006158	C-CER,CHIP;100nF,10%,16V,X7R,1005	1	S.N.A	
...4	C6082	2203-006158	C-CER,CHIP;100nF,10%,16V,X7R,1005	1	S.N.A	
...4	C6083	2203-006158	C-CER,CHIP;100nF,10%,16V,X7R,1005	1	S.N.A	
...4	C6084	2203-006158	C-CER,CHIP;100nF,10%,16V,X7R,1005	1	S.N.A	
...4	C6085	2203-006158	C-CER,CHIP;100nF,10%,16V,X7R,1005	1	S.N.A	
...4	C6086	2203-006158	C-CER,CHIP;100nF,10%,16V,X7R,1005	1	S.N.A	
...4	C6087	2203-006158	C-CER,CHIP;100nF,10%,16V,X7R,1005	1	S.N.A	
...4	C6088	2203-006158	C-CER,CHIP;100nF,10%,16V,X7R,1005	1	S.N.A	
...4	C6089	2203-006158	C-CER,CHIP;100nF,10%,16V,X7R,1005	1	S.N.A	
...4	C6101	2203-006158	C-CER,CHIP;100nF,10%,16V,X7R,1005	1	S.N.A	
...4	C6102	2203-006158	C-CER,CHIP;100nF,10%,16V,X7R,1005	1	S.N.A	
...4	C6103	2203-006158	C-CER,CHIP;100nF,10%,16V,X7R,1005	1	S.N.A	
...4	C6104	2203-006158	C-CER,CHIP;100nF,10%,16V,X7R,1005	1	S.N.A	
...4	C6105	2203-006158	C-CER,CHIP;100nF,10%,16V,X7R,1005	1	S.N.A	
...4	C6106	2203-006158	C-CER,CHIP;100nF,10%,16V,X7R,1005	1	S.N.A	
...4	C6107	2203-006158	C-CER,CHIP;100nF,10%,16V,X7R,1005	1	S.N.A	

5. Exploded View & Part List

Level	Location No.	Code No.	Description & Specification	Q'ty	SA/SNA	Remark
...4	C6109	2203-006158	C-CER,CHIP;100nF,10%,16V,X7R,1005	1	S.N.A	
...4	C6110	2203-006158	C-CER,CHIP;100nF,10%,16V,X7R,1005	1	S.N.A	
...4	C6111	2203-006158	C-CER,CHIP;100nF,10%,16V,X7R,1005	1	S.N.A	
...4	C6112	2203-006158	C-CER,CHIP;100nF,10%,16V,X7R,1005	1	S.N.A	
...4	C6113	2203-006158	C-CER,CHIP;100nF,10%,16V,X7R,1005	1	S.N.A	
...4	C6114	2203-006158	C-CER,CHIP;100nF,10%,16V,X7R,1005	1	S.N.A	
...4	C6115	2203-006158	C-CER,CHIP;100nF,10%,16V,X7R,1005	1	S.N.A	
...4	C6116	2203-006158	C-CER,CHIP;100nF,10%,16V,X7R,1005	1	S.N.A	
...4	C6150	2203-006158	C-CER,CHIP;100nF,10%,16V,X7R,1005	1	S.N.A	
...4	C6151	2203-006158	C-CER,CHIP;100nF,10%,16V,X7R,1005	1	S.N.A	
...4	C6152	2203-006158	C-CER,CHIP;100nF,10%,16V,X7R,1005	1	S.N.A	
...4	C6153	2203-006158	C-CER,CHIP;100nF,10%,16V,X7R,1005	1	S.N.A	
...4	C7012	2203-006158	C-CER,CHIP;100nF,10%,16V,X7R,1005	1	S.N.A	
...4	C7013	2203-006158	C-CER,CHIP;100nF,10%,16V,X7R,1005	1	S.N.A	
...4	C7019	2203-006158	C-CER,CHIP;100nF,10%,16V,X7R,1005	1	S.N.A	
...4	C7020	2203-006158	C-CER,CHIP;100nF,10%,16V,X7R,1005	1	S.N.A	
...4	C7034	2203-006158	C-CER,CHIP;100nF,10%,16V,X7R,1005	1	S.N.A	
...4	C7038	2203-006158	C-CER,CHIP;100nF,10%,16V,X7R,1005	1	S.N.A	
...4	C7043	2203-006158	C-CER,CHIP;100nF,10%,16V,X7R,1005	1	S.N.A	
...4	C7054	2203-006158	C-CER,CHIP;100nF,10%,16V,X7R,1005	1	S.N.A	
...4	C7055	2203-006158	C-CER,CHIP;100nF,10%,16V,X7R,1005	1	S.N.A	
...4	C7056	2203-006158	C-CER,CHIP;100nF,10%,16V,X7R,1005	1	S.N.A	
...4	C7062	2203-006158	C-CER,CHIP;100nF,10%,16V,X7R,1005	1	S.N.A	
...4	C7064	2203-006158	C-CER,CHIP;100nF,10%,16V,X7R,1005	1	S.N.A	
...4	C7068	2203-006158	C-CER,CHIP;100nF,10%,16V,X7R,1005	1	S.N.A	
...4	C7069	2203-006158	C-CER,CHIP;100nF,10%,16V,X7R,1005	1	S.N.A	
...4	C7074	2203-006158	C-CER,CHIP;100nF,10%,16V,X7R,1005	1	S.N.A	
...4	C7075	2203-006158	C-CER,CHIP;100nF,10%,16V,X7R,1005	1	S.N.A	
...4	C7076	2203-006158	C-CER,CHIP;100nF,10%,16V,X7R,1005	1	S.N.A	
...4	C7077	2203-006158	C-CER,CHIP;100nF,10%,16V,X7R,1005	1	S.N.A	
...4	C7078	2203-006158	C-CER,CHIP;100nF,10%,16V,X7R,1005	1	S.N.A	
...4	C7080	2203-006158	C-CER,CHIP;100nF,10%,16V,X7R,1005	1	S.N.A	
...4	C7081	2203-006158	C-CER,CHIP;100nF,10%,16V,X7R,1005	1	S.N.A	
...4	C7082	2203-006158	C-CER,CHIP;100nF,10%,16V,X7R,1005	1	S.N.A	
...4	C7083	2203-006158	C-CER,CHIP;100nF,10%,16V,X7R,1005	1	S.N.A	
...4	C7086	2203-006158	C-CER,CHIP;100nF,10%,16V,X7R,1005	1	S.N.A	
...4	C7087	2203-006158	C-CER,CHIP;100nF,10%,16V,X7R,1005	1	S.N.A	
...4	C7094	2203-006158	C-CER,CHIP;100nF,10%,16V,X7R,1005	1	S.N.A	
...4	C7095	2203-006158	C-CER,CHIP;100nF,10%,16V,X7R,1005	1	S.N.A	
...4	C7096	2203-006158	C-CER,CHIP;100nF,10%,16V,X7R,1005	1	S.N.A	
...4	C7098	2203-006158	C-CER,CHIP;100nF,10%,16V,X7R,1005	1	S.N.A	
...4	C7099	2203-006158	C-CER,CHIP;100nF,10%,16V,X7R,1005	1	S.N.A	
...4	C7107	2203-006158	C-CER,CHIP;100nF,10%,16V,X7R,1005	1	S.N.A	
...4	C7112	2203-006158	C-CER,CHIP;100nF,10%,16V,X7R,1005	1	S.N.A	
...4	C7113	2203-006158	C-CER,CHIP;100nF,10%,16V,X7R,1005	1	S.N.A	
...4	C7116	2203-006158	C-CER,CHIP;100nF,10%,16V,X7R,1005	1	S.N.A	
...4	C7117	2203-006158	C-CER,CHIP;100nF,10%,16V,X7R,1005	1	S.N.A	
...4	C7134	2203-006158	C-CER,CHIP;100nF,10%,16V,X7R,1005	1	S.N.A	
...4	C7140	2203-006158	C-CER,CHIP;100nF,10%,16V,X7R,1005	1	S.N.A	
...4	C7142	2203-006158	C-CER,CHIP;100nF,10%,16V,X7R,1005	1	S.N.A	
...4	C7143	2203-006158	C-CER,CHIP;100nF,10%,16V,X7R,1005	1	S.N.A	

5. Exploded View & Part List

Level	Location No.	Code No.	Description & Specification	Q'ty	SA/SNA	Remark
...4	C7146	2203-006158	C-CER,CHIP;100nF,10%,16V,X7R,1005	1	S.N.A	
...4	C7147	2203-006158	C-CER,CHIP;100nF,10%,16V,X7R,1005	1	S.N.A	
...4	C7149	2203-006158	C-CER,CHIP;100nF,10%,16V,X7R,1005	1	S.N.A	
...4	C7152	2203-006158	C-CER,CHIP;100nF,10%,16V,X7R,1005	1	S.N.A	
...4	C7160	2203-006158	C-CER,CHIP;100nF,10%,16V,X7R,1005	1	S.N.A	
...4	C7161	2203-006158	C-CER,CHIP;100nF,10%,16V,X7R,1005	1	S.N.A	
...4	C7164	2203-006158	C-CER,CHIP;100nF,10%,16V,X7R,1005	1	S.N.A	
...4	C7165	2203-006158	C-CER,CHIP;100nF,10%,16V,X7R,1005	1	S.N.A	
...4	C7168	2203-006158	C-CER,CHIP;100nF,10%,16V,X7R,1005	1	S.N.A	
...4	C7169	2203-006158	C-CER,CHIP;100nF,10%,16V,X7R,1005	1	S.N.A	
...4	C7172	2203-006158	C-CER,CHIP;100nF,10%,16V,X7R,1005	1	S.N.A	
...4	C7176	2203-006158	C-CER,CHIP;100nF,10%,16V,X7R,1005	1	S.N.A	
...4	C7177	2203-006158	C-CER,CHIP;100nF,10%,16V,X7R,1005	1	S.N.A	
...4	C7180	2203-006158	C-CER,CHIP;100nF,10%,16V,X7R,1005	1	S.N.A	
...4	C7181	2203-006158	C-CER,CHIP;100nF,10%,16V,X7R,1005	1	S.N.A	
...4	C7185	2203-006158	C-CER,CHIP;100nF,10%,16V,X7R,1005	1	S.N.A	
...4	C7200	2203-006158	C-CER,CHIP;100nF,10%,16V,X7R,1005	1	S.N.A	
...4	C7201	2203-006158	C-CER,CHIP;100nF,10%,16V,X7R,1005	1	S.N.A	
...4	C7202	2203-006158	C-CER,CHIP;100nF,10%,16V,X7R,1005	1	S.N.A	
...4	C7203	2203-006158	C-CER,CHIP;100nF,10%,16V,X7R,1005	1	S.N.A	
...4	C7206	2203-006158	C-CER,CHIP;100nF,10%,16V,X7R,1005	1	S.N.A	
...4	C7211	2203-006158	C-CER,CHIP;100nF,10%,16V,X7R,1005	1	S.N.A	
...4	C7220	2203-006158	C-CER,CHIP;100nF,10%,16V,X7R,1005	1	S.N.A	
...4	C7221	2203-006158	C-CER,CHIP;100nF,10%,16V,X7R,1005	1	S.N.A	
...4	C7222	2203-006158	C-CER,CHIP;100nF,10%,16V,X7R,1005	1	S.N.A	
...4	C7223	2203-006158	C-CER,CHIP;100nF,10%,16V,X7R,1005	1	S.N.A	
...4	C7224	2203-006158	C-CER,CHIP;100nF,10%,16V,X7R,1005	1	S.N.A	
...4	C7225	2203-006158	C-CER,CHIP;100nF,10%,16V,X7R,1005	1	S.N.A	
...4	C7226	2203-006158	C-CER,CHIP;100nF,10%,16V,X7R,1005	1	S.N.A	
...4	C7227	2203-006158	C-CER,CHIP;100nF,10%,16V,X7R,1005	1	S.N.A	
...4	C7228	2203-006158	C-CER,CHIP;100nF,10%,16V,X7R,1005	1	S.N.A	
...4	C7400	2203-006158	C-CER,CHIP;100nF,10%,16V,X7R,1005	1	S.N.A	
...4	C7402	2203-006158	C-CER,CHIP;100nF,10%,16V,X7R,1005	1	S.N.A	
...4	C7403	2203-006158	C-CER,CHIP;100nF,10%,16V,X7R,1005	1	S.N.A	
...4	C7404	2203-006158	C-CER,CHIP;100nF,10%,16V,X7R,1005	1	S.N.A	
...4	C7405	2203-006158	C-CER,CHIP;100nF,10%,16V,X7R,1005	1	S.N.A	
...4	C7406	2203-006158	C-CER,CHIP;100nF,10%,16V,X7R,1005	1	S.N.A	
...4	C7407	2203-006158	C-CER,CHIP;100nF,10%,16V,X7R,1005	1	S.N.A	
...4	C7408	2203-006158	C-CER,CHIP;100nF,10%,16V,X7R,1005	1	S.N.A	
...4	C7409	2203-006158	C-CER,CHIP;100nF,10%,16V,X7R,1005	1	S.N.A	
...4	C7410	2203-006158	C-CER,CHIP;100nF,10%,16V,X7R,1005	1	S.N.A	
...4	C7411	2203-006158	C-CER,CHIP;100nF,10%,16V,X7R,1005	1	S.N.A	
...4	C7412	2203-006158	C-CER,CHIP;100nF,10%,16V,X7R,1005	1	S.N.A	
...4	C7413	2203-006158	C-CER,CHIP;100nF,10%,16V,X7R,1005	1	S.N.A	
...4	C7414	2203-006158	C-CER,CHIP;100nF,10%,16V,X7R,1005	1	S.N.A	
...4	C7417	2203-006158	C-CER,CHIP;100nF,10%,16V,X7R,1005	1	S.N.A	
...4	C7418	2203-006158	C-CER,CHIP;100nF,10%,16V,X7R,1005	1	S.N.A	
...4	C7419	2203-006158	C-CER,CHIP;100nF,10%,16V,X7R,1005	1	S.N.A	
...4	C7420	2203-006158	C-CER,CHIP;100nF,10%,16V,X7R,1005	1	S.N.A	
...4	C7423	2203-006158	C-CER,CHIP;100nF,10%,16V,X7R,1005	1	S.N.A	
...4	C7750	2203-006158	C-CER,CHIP;100nF,10%,16V,X7R,1005	1	S.N.A	

5. Exploded View & Part List

Level	Location No.	Code No.	Description & Specification	Q'ty	SA/SNA	Remark
...4	C7751	2203-006158	C-CER,CHIP;100nF,10%,16V,X7R,1005	1	S.N.A	
...4	C7752	2203-006158	C-CER,CHIP;100nF,10%,16V,X7R,1005	1	S.N.A	
...4	C7753	2203-006158	C-CER,CHIP;100nF,10%,16V,X7R,1005	1	S.N.A	
...4	C7754	2203-006158	C-CER,CHIP;100nF,10%,16V,X7R,1005	1	S.N.A	
...4	C7755	2203-006158	C-CER,CHIP;100nF,10%,16V,X7R,1005	1	S.N.A	
...4	C7756	2203-006158	C-CER,CHIP;100nF,10%,16V,X7R,1005	1	S.N.A	
...4	C7757	2203-006158	C-CER,CHIP;100nF,10%,16V,X7R,1005	1	S.N.A	
...4	C7758	2203-006158	C-CER,CHIP;100nF,10%,16V,X7R,1005	1	S.N.A	
...4	C7759	2203-006158	C-CER,CHIP;100nF,10%,16V,X7R,1005	1	S.N.A	
...4	C7760	2203-006158	C-CER,CHIP;100nF,10%,16V,X7R,1005	1	S.N.A	
...4	C7761	2203-006158	C-CER,CHIP;100nF,10%,16V,X7R,1005	1	S.N.A	
...4	C7771	2203-006158	C-CER,CHIP;100nF,10%,16V,X7R,1005	1	S.N.A	
...4	C7772	2203-006158	C-CER,CHIP;100nF,10%,16V,X7R,1005	1	S.N.A	
...4	C7773	2203-006158	C-CER,CHIP;100nF,10%,16V,X7R,1005	1	S.N.A	
...4	C8001	2203-006158	C-CER,CHIP;100nF,10%,16V,X7R,1005	1	S.N.A	
...4	C8002	2203-006158	C-CER,CHIP;100nF,10%,16V,X7R,1005	1	S.N.A	
...4	C8003	2203-006158	C-CER,CHIP;100nF,10%,16V,X7R,1005	1	S.N.A	
...4	C8004	2203-006158	C-CER,CHIP;100nF,10%,16V,X7R,1005	1	S.N.A	
...4	C8007	2203-006158	C-CER,CHIP;100nF,10%,16V,X7R,1005	1	S.N.A	
...4	C8011	2203-006158	C-CER,CHIP;100nF,10%,16V,X7R,1005	1	S.N.A	
...4	C8012	2203-006158	C-CER,CHIP;100nF,10%,16V,X7R,1005	1	S.N.A	
...4	C8013	2203-006158	C-CER,CHIP;100nF,10%,16V,X7R,1005	1	S.N.A	
...4	C8014	2203-006158	C-CER,CHIP;100nF,10%,16V,X7R,1005	1	S.N.A	
...4	C8015	2203-006158	C-CER,CHIP;100nF,10%,16V,X7R,1005	1	S.N.A	
...4	C8016	2203-006158	C-CER,CHIP;100nF,10%,16V,X7R,1005	1	S.N.A	
...4	C8017	2203-006158	C-CER,CHIP;100nF,10%,16V,X7R,1005	1	S.N.A	
...4	C8018	2203-006158	C-CER,CHIP;100nF,10%,16V,X7R,1005	1	S.N.A	
...4	C8019	2203-006158	C-CER,CHIP;100nF,10%,16V,X7R,1005	1	S.N.A	
...4	C8096_CI+	2203-006158	C-CER,CHIP;100nF,10%,16V,X7R,1005	1	S.N.A	
...4	C8097_CI+	2203-006158	C-CER,CHIP;100nF,10%,16V,X7R,1005	1	S.N.A	
...4	C8098_CI+	2203-006158	C-CER,CHIP;100nF,10%,16V,X7R,1005	1	S.N.A	
...4	C8099_CI+	2203-006158	C-CER,CHIP;100nF,10%,16V,X7R,1005	1	S.N.A	
...4	C1017	2203-006361	C-CER,CHIP;10000nF,10%,10V,X5R,TP,2012	1	S.A	
...4	C1020	2203-006361	C-CER,CHIP;10000nF,10%,10V,X5R,TP,2012	1	S.A	
...4	C1021	2203-006361	C-CER,CHIP;10000nF,10%,10V,X5R,TP,2012	1	S.A	
...4	C1023	2203-006361	C-CER,CHIP;10000nF,10%,10V,X5R,TP,2012	1	S.A	
...4	C1031	2203-006361	C-CER,CHIP;10000nF,10%,10V,X5R,TP,2012	1	S.A	
...4	C1033	2203-006361	C-CER,CHIP;10000nF,10%,10V,X5R,TP,2012	1	S.A	
...4	C1050	2203-006361	C-CER,CHIP;10000nF,10%,10V,X5R,TP,2012	1	S.A	
...4	C2001	2203-006361	C-CER,CHIP;10000nF,10%,10V,X5R,TP,2012	1	S.A	
...4	C2003	2203-006361	C-CER,CHIP;10000nF,10%,10V,X5R,TP,2012	1	S.A	
...4	C2005	2203-006361	C-CER,CHIP;10000nF,10%,10V,X5R,TP,2012	1	S.A	
...4	C2011	2203-006361	C-CER,CHIP;10000nF,10%,10V,X5R,TP,2012	1	S.A	
...4	C2014	2203-006361	C-CER,CHIP;10000nF,10%,10V,X5R,TP,2012	1	S.A	
...4	C2035	2203-006361	C-CER,CHIP;10000nF,10%,10V,X5R,TP,2012	1	S.A	
...4	C2046	2203-006361	C-CER,CHIP;10000nF,10%,10V,X5R,TP,2012	1	S.A	
...4	C2055	2203-006361	C-CER,CHIP;10000nF,10%,10V,X5R,TP,2012	1	S.A	
...4	C2064	2203-006361	C-CER,CHIP;10000nF,10%,10V,X5R,TP,2012	1	S.A	
...4	C2065	2203-006361	C-CER,CHIP;10000nF,10%,10V,X5R,TP,2012	1	S.A	
...4	C3009_EU	2203-006361	C-CER,CHIP;10000nF,10%,10V,X5R,TP,2012	1	S.A	
...4	C3037	2203-006361	C-CER,CHIP;10000nF,10%,10V,X5R,TP,2012	1	S.A	

5. Exploded View & Part List

Level	Location No.	Code No.	Description & Specification	Q'ty	SA/SNA	Remark
...4	C3043	2203-006361	C-CER,CHIP;10000nF,10%,10V,X5R,TP,2012	1	S.A	
...4	C3051	2203-006361	C-CER,CHIP;10000nF,10%,10V,X5R,TP,2012	1	S.A	
...4	C3067	2203-006361	C-CER,CHIP;10000nF,10%,10V,X5R,TP,2012	1	S.A	
...4	C3068	2203-006361	C-CER,CHIP;10000nF,10%,10V,X5R,TP,2012	1	S.A	
...4	C3069	2203-006361	C-CER,CHIP;10000nF,10%,10V,X5R,TP,2012	1	S.A	
...4	C3073	2203-006361	C-CER,CHIP;10000nF,10%,10V,X5R,TP,2012	1	S.A	
...4	C3810	2203-006361	C-CER,CHIP;10000nF,10%,10V,X5R,TP,2012	1	S.A	
...4	C4001	2203-006361	C-CER,CHIP;10000nF,10%,10V,X5R,TP,2012	1	S.A	
...4	C4015	2203-006361	C-CER,CHIP;10000nF,10%,10V,X5R,TP,2012	1	S.A	
...4	C5005	2203-006361	C-CER,CHIP;10000nF,10%,10V,X5R,TP,2012	1	S.A	
...4	C5018	2203-006361	C-CER,CHIP;10000nF,10%,10V,X5R,TP,2012	1	S.A	
...4	C5028	2203-006361	C-CER,CHIP;10000nF,10%,10V,X5R,TP,2012	1	S.A	
...4	C5032	2203-006361	C-CER,CHIP;10000nF,10%,10V,X5R,TP,2012	1	S.A	
...4	C5034	2203-006361	C-CER,CHIP;10000nF,10%,10V,X5R,TP,2012	1	S.A	
...4	C5035	2203-006361	C-CER,CHIP;10000nF,10%,10V,X5R,TP,2012	1	S.A	
...4	C5036	2203-006361	C-CER,CHIP;10000nF,10%,10V,X5R,TP,2012	1	S.A	
...4	C5111	2203-006361	C-CER,CHIP;10000nF,10%,10V,X5R,TP,2012	1	S.A	
...4	C6001	2203-006361	C-CER,CHIP;10000nF,10%,10V,X5R,TP,2012	1	S.A	
...4	C6011	2203-006361	C-CER,CHIP;10000nF,10%,10V,X5R,TP,2012	1	S.A	
...4	C6022	2203-006361	C-CER,CHIP;10000nF,10%,10V,X5R,TP,2012	1	S.A	
...4	C6029	2203-006361	C-CER,CHIP;10000nF,10%,10V,X5R,TP,2012	1	S.A	
...4	C6030	2203-006361	C-CER,CHIP;10000nF,10%,10V,X5R,TP,2012	1	S.A	
...4	C6031	2203-006361	C-CER,CHIP;10000nF,10%,10V,X5R,TP,2012	1	S.A	
...4	C6032	2203-006361	C-CER,CHIP;10000nF,10%,10V,X5R,TP,2012	1	S.A	
...4	C6046	2203-006361	C-CER,CHIP;10000nF,10%,10V,X5R,TP,2012	1	S.A	
...4	C6049	2203-006361	C-CER,CHIP;10000nF,10%,10V,X5R,TP,2012	1	S.A	
...4	C6050	2203-006361	C-CER,CHIP;10000nF,10%,10V,X5R,TP,2012	1	S.A	
...4	C6054	2203-006361	C-CER,CHIP;10000nF,10%,10V,X5R,TP,2012	1	S.A	
...4	C6055	2203-006361	C-CER,CHIP;10000nF,10%,10V,X5R,TP,2012	1	S.A	
...4	C6071	2203-006361	C-CER,CHIP;10000nF,10%,10V,X5R,TP,2012	1	S.A	
...4	C6072	2203-006361	C-CER,CHIP;10000nF,10%,10V,X5R,TP,2012	1	S.A	
...4	C6092	2203-006361	C-CER,CHIP;10000nF,10%,10V,X5R,TP,2012	1	S.A	
...4	C6093	2203-006361	C-CER,CHIP;10000nF,10%,10V,X5R,TP,2012	1	S.A	
...4	C7001	2203-006361	C-CER,CHIP;10000nF,10%,10V,X5R,TP,2012	1	S.A	
...4	C7004	2203-006361	C-CER,CHIP;10000nF,10%,10V,X5R,TP,2012	1	S.A	
...4	C7005	2203-006361	C-CER,CHIP;10000nF,10%,10V,X5R,TP,2012	1	S.A	
...4	C7006	2203-006361	C-CER,CHIP;10000nF,10%,10V,X5R,TP,2012	1	S.A	
...4	C7007	2203-006361	C-CER,CHIP;10000nF,10%,10V,X5R,TP,2012	1	S.A	
...4	C7008	2203-006361	C-CER,CHIP;10000nF,10%,10V,X5R,TP,2012	1	S.A	
...4	C7021	2203-006361	C-CER,CHIP;10000nF,10%,10V,X5R,TP,2012	1	S.A	
...4	C7108	2203-006361	C-CER,CHIP;10000nF,10%,10V,X5R,TP,2012	1	S.A	
...4	C7110	2203-006361	C-CER,CHIP;10000nF,10%,10V,X5R,TP,2012	1	S.A	
...4	C7130	2203-006361	C-CER,CHIP;10000nF,10%,10V,X5R,TP,2012	1	S.A	
...4	C7132	2203-006361	C-CER,CHIP;10000nF,10%,10V,X5R,TP,2012	1	S.A	
...4	C7133	2203-006361	C-CER,CHIP;10000nF,10%,10V,X5R,TP,2012	1	S.A	
...4	C7999	2203-006361	C-CER,CHIP;10000nF,10%,10V,X5R,TP,2012	1	S.A	
...4	C8010	2203-006361	C-CER,CHIP;10000nF,10%,10V,X5R,TP,2012	1	S.A	
...4	R2046	2007-001308	R-CHIP;200ohm,5%,1/16W,TP,1005	1	S.N.A	
...3	T0245	0202-001492	SOLDER-WIRE FLUX;HSE-02 LFM48 SR-34 S,-,	0.25	S.N.A	
...3	CN3011	3701-001571	CONNECTOR-DSUB;15P,3ROW,FEMALE,ANGLE,TIN	1	S.A	
...3	CN906	3707-001090	CONNECTOR-OPTICAL;angle(ULTRA SLIM),SPDI	1	S.A	

5. Exploded View & Part List

Level	Location No.	Code No.	Description & Specification	Q'ty	SA/SNA	Remark
...3	CN8001_EU	3709-001569	CONNECTOR-CARD SLOT;68P(ULTRA SLIM 60mm)	1	S.A	
...3	CN330	3711-003847	HEADER-BOARD TO CABLE;BOX,12P,1R,2mm,ANG	1	S.A	
...3	CN1001	3711-005884	HEADER-BOARD TO BOARD;BOX,30P,2R,2mm,ANG	1	S.A	
...3	CN330	3711-006715	HEADER-BOARD TO CABLE;BOX,4P,1R,2.5mm,AN	1	S.N.A	
...3	CN330	3711-006715	HEADER-BOARD TO CABLE;BOX,4P,1R,2.5mm,AN	1	S.N.A	
...3	CN7006	3722-001051	JACK-USB;4P/1C,AU,BLK,ANGLE,A TYPE	1	S.A	
...3	JA330	3722-002844	JACK-PHONE;1/7P,NI,LAUREL-GREEN,ANGLE	1	S.A	
...3	JA330	3722-002845	JACK-PHONE;1/7P,NI,YELLOW,ANGLE	1	S.A	
...3	JA330	3722-002846	JACK-PHONE;1/6,NI,BLACK,ANGLE	1	S.A	
...3	JA330	3722-002846	JACK-PHONE;1/6,NI,BLACK,ANGLE	1	S.A	
...3	T0562	6046-001015	STAND OFF;#4-40,L5,Ni PLT,C3601,M3	2	S.N.A	
...3	CIS3	BN40-00145B	TUNER;TDHG6-K13A,TDHG6-K13A,DVB TC,164CH	1	S.A	
...3	SUB09	BN61-04924C	BRACKET-AV;LB750 40,PCM,T0.5,BKN-P824, P	1	S.N.A	
...3	T0066	BN62-00042A	HEAT SINK-ES;30*30*5,Ceramic,T1.5,TAPE	1	S.A	
...3	T0066	BN62-00043A	HEAT SINK-ES;40*40*5,Ceramic,T1.5,TAPE	1	S.A	
...3		0202-001557	SOLDER-CREAM;LST57-A,D38-63,42SN/57BI/1A	11	S.N.A	
0.1	M0045	BN92-04474S	ASSY ACCESSORY;UE40B6000VWXZG	1	S.N.A	
..2	M0045	BN96-12051A	ASSY ACCESSORY-MANUAL;UE32B6000VWXZG,40,	1	S.A	
...3	T0524	6902-000110	BAG PE;LDPE,T0.05,W250,L400,TRP,28,2,9.2	1	S.N.A	
...3		AA68-03242Q	MANUAL FLYER-04,SAFETY GUIDE;comm,Samsun	1	S.N.A	
...3		BN68-00514E	MANUAL FLYER-03,WARRANTY CARD;comm,Samsu	1	S.N.A	
...3		BN68-00907D	MANUAL FLYER-WEEE BATTERY;COMM,SAMSUNG,2	1	S.N.A	
...3	T0511	BN68-01968M	MANUAL USERS;B6000,SAMSUNG,ENG/GER,GERMA	1	S.N.A	
...3		BN68-02186A	MANUAL FLYER-TOC GUIDE;COMM,SAMSUNG,10 L	1	S.N.A	
...3		BN68-02215E	MANUAL FLYER-STAND GUIDE;COMM,SAMSUNG,W/	1	S.N.A	
..2	M0045	BN96-10038V	ASSY ACCESSORY-CABLE;UE40B6000VWXXU	1	S.A	
...3	T0524	6902-000110	BAG PE;LDPE,T0.05,W250,L400,TRP,28,2,9.2	1	S.N.A	
...3	M0114	BN39-01154C	CBF SIGNAL;Chelsea Slim, STEREO Plug to	1	S.A	
...3	M0114	BN39-01154E	CBF SIGNAL;Chelsea Slim, STEREO Plug to	1	S.A	
...3	M0114	BN39-01154F	CBF SIGNAL;UE40B7000WWXXC,24P/20P,30AWG,	1	S.A	
...3		BN59-00936A	REMOCON-TM970;SAMSUNG,60,3V,EUROPE,146g	1	S.A	
...3		BN61-05596A	HOLDER-WIRE CABLE;LED TV,LDPE,T0.8,L150,	1	S.N.A	
...3	M9889	BN63-01798B	CLOTH-CLEAN;cloth,180,200,sea blue,ToC	1	S.N.A	
...3		BN96-10276B	ASSY HOLDER P-RING;09 LEDTV ALL MODEL,AB	1	S.N.A	
...4		6902-000683	BAG ZIPPER;LDPE,T0.05,W60,L60,TRP,4-PE M	1	S.N.A	
...4		BN61-05280A	HOLDER-RING;LB7000 46inch,ABS, HB,gray	4	S.N.A	
...3	T0010	BN96-10810A	ASSY HOLDER P;09 LEDTV MODEL,NYRON	1	S.N.A	
...4		6902-000031	BAG ZIPPER;LDPE,T0.05,W80,L160,TRP,0,0,4	1	S.N.A	
...4	M0114	BN61-05373A	HOLDER-WIRE;LB7000 46,NYRON	3	S.N.A	
...4		BN61-05491A	HOLDER-WIRE STAND;UB7000 46inch,NYRON	1	S.N.A	
...3	T0531	BN63-05654B	COVER-BOTTOM;LB7000 46,HIPS,HB	1	S.A	
...4		BN81-00199H	RESIN;HIPS HB,BK500,HF-1690H,K2901	0.07	S.N.A	
	T0524	6902-000110	BAG PE;LDPE,T0.05,W250,L400,TRP,28,2,9.2	1	S.N.A	
0.1	M0019	BN92-04475A	ASSY LABEL;UE40B6000VWXXC	1	S.N.A	
					S.A	
0.1	M0003	BN92-04755A	ASSY BOX;UB6000 40	1	S.N.A	
..2		BN69-03630B	BOX-SET,OUT;40UB6000-S,CB,C-01,DW3,ECT50	1	S.N.A	
		BN68-02186A	MANUAL FLYER-TOC GUIDE;COMM,SAMSUNG,10 L	1	S.N.A	
0.1	M0113	BN92-04758A	ASSY P/MATERIAL;UB6000 40	1	S.N.A	
..2	T0003	6902-000604	BAG WRAPPING;LDPE,T0.02,W500,L10000,TRP,	3.78	S.N.A	

5. Exploded View & Part List

Level	Location No.	Code No.	Description & Specification	Q'ty	SA/SNA	Remark
..2	T0524	6902-001043	BAG PE;HDPE/NITRON,T0.015/T0.5,W1200,L80	1	S.N.A	
..2	T0214	BN74-00008A	TAPE-OPP MASKING;OPP-2,T0.05,W100,L800M,	2.69	S.N.A	
..2	T0376	6902-000379	BAG AIR;LDPE,T0.2,W1000,L1800,TRP,1260.0	0.003	S.N.A	
..2		6922-000003	BAND PP;PP,T0.8,W18,L1650M,TRP,DA69-9014	822.6	S.N.A	