

1. Exploded View & Part List

Exploded View

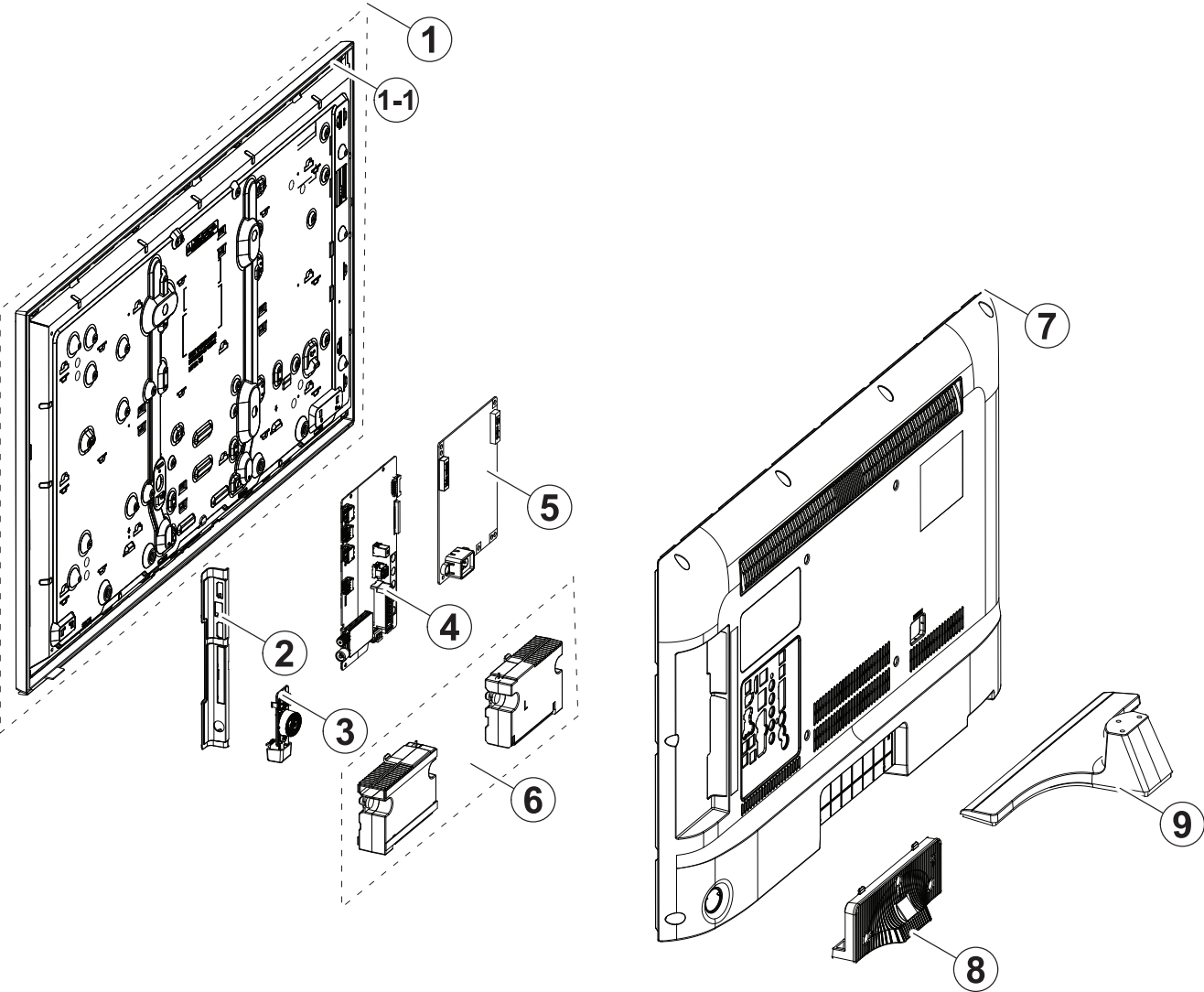

Parts List

No.	Lvl.	Loc.	Material Code	Description & Specification	SNA	Qty.
1	2	PANEL	BN95-01324A	PRODUCT LCD-SHARP; LK315T3HC1K,CY-HH032AG	SA	1
1-1	3	TC01A	BN96-30648B	ASSY CHASSIS TOP P; Y14 32 4K SHARP,BN64-	SA	1
2	3		BN61-09059A	HOLDER-SIDE AV; UF6100,HIPS,BK0020,HB,EO/	SNA	1
3	2	FB01A	BN96-30857C	ASSY BOARD P-JOG SWITCH & IR; UH4000,FUNC	SA	1
4	2	M0014	BN94-09060B	ASSY PCB MAIN; J4100,UH4A	SA	1
5	2	P001A	BN44-00696A	DC VSS-LED TV PD BD; L32S0_ESM,L32S0_ESM,	SA	1
6	2	SP01A	BN96-30337A	ASSY SPEAKER P; 6ohm,10W,Enclosure_H4k	SA	1
7	2	R001A	BN96-34295B	ASSY COVER P-REAR; UH4000 32,EUROPE,ABS+P	SA	1
8	2	SG03	BN61-11150A	GUIDE-STAND; UH5000 32",PC+GF20%,V2,T-Typ	SA	1
9	2	SB04A	BN96-34283C	ASSY STAND P-BASE; 28J4000,PC+ABS,BLACK,E	SA	1

2. Electrical Parts List

Level	Loc.	Part Code	Description & Specification	Qty.	SA/SNA
			UE32J4100AWXZG (MS03)		
1		BN90-05303A	ASSY W/I;UN40F6400AFXZA	1	SNA
.2		BN81-08159Z	PART SET-ELEC W/I;UF**,UH**,UG**,ELEC	1	SNA
.2		BN81-09501A	PART SET-MECH W/I;UH4A,U32HA*	1	SNA
1	R001A	BN90-05446A	ASSY COVER REAR;UH4000	1	SNA
.2	SCREW	6001-002755	SCREW-MACHINE;BH,+,M3,L6,ZPC(BLK),SWRCH1	2	SA
.2	SCREW	6003-001782	SCREW-TAPTYPE;BH,+,B,M4,L12,ZPC(BLK),SWR	11	SA
.2	R001A	BN96-34295B	ASSY COVER P-REAR;UH4000 32,EUROPE,ABS+P	1	SA
..3		BN60-00162H	SPACER-FOAM;FOAM,50000mm,DARK GRAY,0.5T,	0	SNA
..3	R001	BN63-11725W	COVER-REAR;32H4000,ABS+PC,EO,V1	1	SNA
...4		0103-010376	RESIN PC ABS;FR3012 / 901510,BLACK,BK000	950	SNA
..3		BN68-05650C	LABEL-TERMINAL SIDE;UH5K,PET,T0.125,W14.	1	SNA
1	S001A	BN90-07183B	ASSY STAND;UJ4100,28"	1	SNA
.2	SG03	BN61-11150A	GUIDE-STAND;UH5000 32",PC+GF20%,V2,T-Typ	1	SA
..3		0103-007285	RESIN PC;HF3200H,K21294,BK0007,V2	1.5mm	175
.2	SB04A	BN96-34283C	ASSY STAND P-BASE;28J4000,PC+ABS,BLACK,E	1	SA
..3	AS080	BN63-04755L	SHEET-COVER;22LC350,PE,T0.05,W130mm,200M	0	SNA
..3		BN63-12991C	COVER-STAND BASE;28J4000,ABS+PC,V0,BLACK	1	SNA
...4		0103-005041	RESIN PC ABS;FR3200TV,901408,BK0008,1.2m	175	SNA
..3		BN67-00327D	RUBBER-FOOT;STAND,SILICON,13*13,T2,GRAY(5	SNA
..3		BN69-08751A	WRAP VINYL-SHRINK;STAND,PLASTIC OTHERS,P	0	SNA
1		BN91-12013A	ASSY LCM-AMLCD;BN95-01324A,CY-HH032AGSV1	1	SNA
.2	PANEL	BN95-01324A	PRODUCT LCD-SHARP;LK315T3HC1K,CY-HH032AG	1	SA
..3	M0131	BN63-00520A	GASKET;APPOLO_PAL,Conductive Fabric,0.13	1	SNA
..3		BN68-05722A	LABEL-STICKER;ALL MODEL,POLYPROPYLENE,0.	1	SNA
..3		BN74-00053E	TAPE-PAPER;PAPER,3M2307,0.14T,W20,50m,WH	0	SNA
..3		BN90-05178A	ASSY MISC-BLU;H4000 32",CY-HH032AGS	1	SNA
..4		BN02-00152H	TAPE ETC-SHEET FIXING;Y13 Slim F-LED,PET	2	SNA
...4		BN61-10113A	SUPPORT-PLATE;Y14 F-LED,PC,V2,WHT/CLEAR,	4	SNA
....5		0103-005036	RESIN PC;M2407,550115,TP0003	12	SNA
....5		0103-009493	RESIN PC;LH-1070W,W92853,WT0107,V-0	16	SNA
..4		BN61-10232A	LGP-DIFFUSESR PLATE;32inch Diffuser Plat	1	SNA
..4		BN63-11813A	SHEET-REFLECTOR;Y14 32inch HD, SY95S / S	1	SNA
..4		BN63-11817A	SHEET-COMPLEX;Y14 32inch HD DMOP-3R / UT	1	SNA
..4		BN96-30446A	ASSY LED BAR P;32inch HD Direc,FCPkg,7ea	3	SA
..4		BN96-30646A	ASSY CHASSIS BOTTOM P;H4000 32",EGI-SECC	1	SNA
....5	SCREW	6001-003075	SCREW-MACHINE;BH,+,M3,L4,ZPC(WHT),SWRCH1	1	SA
....5		BN02-00040C	TAPE DOUBLE FACE-D-PLATE;F-LED ALL,MKT50	2	SNA

Exploded Views and Parts List

Level	Loc.	Part Code	Description & Specification	Qty.	SA/SNA
....5		BN02-00324A	TAPE-METAL FOIL;Y14 4K,T0.085,W25,NTR,3M	0	SNA
....5		BN02-00352D	TAPE OPP;PET,T0.05,W20,L50M,BLK,ULNO.E16	0	SNA
....5		BN02-00352E	TAPE OPP;PET,T0.05,W15,L50M,BLK,ULNO.E16	0	SNA
....5		BN61-09552A	HOLDER-S-PCB SHARP HD;SHARP HD,ABS,BLK,H	2	SNA
....5		BN61-09552B	HOLDER-S-PCB SHARP HD R;SHARP HD R,ABS,B	2	SNA
....6		0103-004609	RESIN ABS;HF-0680U,K21294,BK0007,1.5mm H	4	SNA
....5		BN61-10114A	BRACKET-WALL MOUNT;Y14 F-LED 32",EGI-SEC	1	SNA
....5		BN61-10207A	HOLDER-WALL RIVET;Y14 F-LED 32",SWRCH10A	3	SNA
....5		BN62-00501H	INSULATION-PD BOARD;Y14 VNB 32" 4K 5K,PC	1	SNA
....5		BN63-08173B	GASKET;S24A300B,Conductive Fabric,80.2	3	SNA
....5	CC02	BN64-02514B	CHASSIS-BOTTOM;Y14 F-LED 32" 4K SHARP,EG	1	SNA
....6		BN01-00173A	STEEL;765,T0.5,455,SECC,AG	1	SNA
....5		BN96-30414A	ASSY BOARD P-LED INTERFACE B'D;32inch HD	1	SNA
...4		BN96-30647A	ASSY FRAME P-MOLD MIDDLE;H4000 32" ,,PC+G	1	SNA
....5		BN60-00744C	SPACER-RUBBER;Y14 SF-LED VNB,SH-0140U+AT	2	SNA
....5		BN60-00815E	SPACER-PANEL (UD);Y14 NNB 32" SHARP,SI,L	2	SNA
....5		BN60-00816C	SPACER-PANEL (LR);Y14 NNB 32" SHARP,SI,L	2	SNA
....5		BN61-10075B	FRAME-MOLD MIDDLE;Y14 F-LED 32" (4K_Shar	1	SNA
....6		0103-007368	RESIN PC;LS-3104G,K2495,BK0048,3.0mm V-2	75	SNA
...3	OC	BN96-30082A	ASSY OPEN CELL;LK315T3HC1K,1366*768,32"	1	SA
...4		BN81-08941A	AS-DRIVER IC;DRIVER IC,S6C274J6,miniLVDS	1	SNA
...4		BN81-08943A	AS-GATE IC;GATE IC,LH163Y06,258ch, dot-i	1	SNA
...4		BN81-09550A	AS-SOURCE PCB;SOURCE PCB,DUNTK5525TPX0,3	1	SNA
...4		BN81-09551A	AS-SOURCE PCB;SOURCE PCB,RUNTK5524TPZZ,3	1	SNA
...4		BN81-09552A	AS-POL-C/F;POLARIZER-C/F,PFILV1860TPXZ,A	1	SNA
...4		BN81-09553A	AS-POL-TFT;POLARIZER-TFT,PFILV1863TPXZ,P	1	SNA
...3	TC01A	BN96-30648B	ASSY CHASSIS TOP P;Y14 32 4K SHARP,BN64-	1	SA
...4		BN02-00112A	TAPE ETC-ALL;POLYESTER,L65.8M,T0.009,W10	0	SNA
...4		BN60-00667A	SPACER-GASKET;Y13 SF-LED,GASKET(FG200A),	4	SNA
...4		BN60-00715A	SPACER-TOP,CORNER;Y13 Slim F-LED,GASKET*	4	SNA
...4		BN60-00930C	SPACER-TOP(UD);Y14 NNB/VNB 32",GASKET+PE	2	SNA
...4		BN60-00930D	SPACER-TOP(LR);Y14 NNB/VNB 32",GASKET+PE	2	SNA
...4	AS080	BN63-07556N	SHEET-COVER;TOC,PO,T0.068,W40mm,100M,ST-	1	SNA
...4	AS080	BN63-07556Y	SHEET-COVER;Y13 SF-LED,PO-SHEET,T0.068,W	2	SNA
...4	AC157	BN64-02486B	CHASSIS-TOP;Y14 F-LED 32" 4K SDC,PC+ABS+	1	SNA
....5		0103-010275	RESIN PC ABS;235GNH15/6919H,Black,BK0007	230	SNA
1		BN91-14255H	ASSY SHIELD;UH4100,28"	1	SNA
.2	SCREW	6001-003016	SCREW-MACHINE;PWH,+M3.0,L5.0,ZPC(WHT),S	8	SA
.2		BN02-00102B	TAPE-FILAMENT;#8917,0.15,25,50,WHITE	0	SNA
.2	M-F	BN39-01873J	LEAD CONNECTOR-FUNCTION;UH4000,Lead Conn	1	SA

Level	Loc.	Part Code	Description & Specification	Qty.	SA/SNA
.2	EC13	BN39-01884A	LEAD CONNECTOR;UN32H4200AF,Lead Connecto	1	SA
.2	EC13	BN39-01885A	LEAD CONNECTOR;UN32H4200AF,Flat Connecto	1	SA
.2	P001A	BN44-00696A	DC VSS-LED TV PD BD;L32S0_ESM,L32S0_ESM,	1	SA
.2		BN67-00364C	RUBBER-FOOT;X13,RUBBER,10*10,6,Gray,SQUA	1	SNA
.2	SP01A	BN96-30337A	ASSY SPEAKER P;6ohm,10W,Enclosure_H4k	1	SA
.2	FB01A	BN96-30857C	ASSY BOARD P-JOG SWITCH & IR;UH4000,FUNC	1	SA
.2	LVDS	BN96-31086D	ASSY CABLE P-FFC CABLE;NT14L UA32H4000,L	1	SA
1	M0017	BN91-15533B	ASSY CHASSIS;J4100,UH4A	1	SNA
.2	M0014	BN94-09060B	ASSY PCB MAIN;J4100,UH4A	1	SA
..3		0202-001608	SOLDER-WIRE FLUX;LFC7-107,D0.8,99.3Sn/0.	0	SNA
..3		BN61-09059A	HOLDER-SIDE AV;UF6100,HIPS,BK0020,HB,EO/	1	SNA
...4		0103-004631	RESIN HIPS;HF-1690H,K21294,BK0007,1.5mm	22	SNA
..3	FB01A	BN97-07120D	ASSY DRM-KEY;NT14L_DRM-KEY(CI+)	1	SNA
...4		BN46-00328B	KEY CODE-CERTIFI;CI+,TV,NT14, EU	1	SNA
..3		BN97-10028A	ASSY SMD;J4100,UH4A,2015/2098	1	SNA
...4		0202-001830	SOLDER-CREAM;LFM-48W TM-HP,D20~38um,96.5	6	SNA
..4	DS01A	0401-001056	DIODE-SWITCHING;MMBD4148SE,100V,200mA,SO	1	SA
...4	DS01A	0401-001116	DIODE-SWITCHING;BAV99DW,75V,215mA,SOT-36	2	SA
...4		0403-001552	DIODE-ZENER;DDZ16,15.69/16.51V,500mW,SOD	1	SA
...4		0403-001783	DIODE-ZENER;BZB84-C6V2,5.8/6.6V,300mW,SO	5	SNA
...4		0403-001784	DIODE-ZENER;NZH7V5C,7.29/7.67V,500mW,SOD	1	SNA
...4		0403-001785	DIODE-ZENER;NZH5V1B,4.94/5.2V,500mW,SOD-	1	SA
...4		0403-001797	DIODE-ZENER;NZH3V0B,2.85/3.15V,500mW,SOD	1	SNA
...4		0404-001404	DIODE-SCHOTTKY;BAT721C,40V,200mA,SOT-23,	2	SA
...4		0406-001200	DIODE-TVS;RCLAMP0504F,6/-V,150W,SC-70	1	SA
...4		0406-001628	DIODE-TVS;AOZ8804ADI,6/-V,150W,SLP2510	4	SA
...4		0501-000279	TR-SMALL SIGNAL;KSA1182-Y,PNP,150mW,SOT-	1	SA
...4		0501-000445	TR-SMALL SIGNAL;KTC3875S-Y,NPN,150mW,SOT	6	SC
...4		0505-002560	FET-SILICON;AO6415,P,-20V,-3.3A,0.15ohm,	3	SA
...4		0505-003397	FET-SILICON;2N7002K,N,60V,380mA,1.19ohm,	6	SA
...4		0801-002780	IC-CMOS LOGIC;74LVC1G17,SCHMITT-TRIGGER	2	SA
...4		0801-003330	IC-CMOS LOGIC;Octal buffer,DQFN,20P,4.5x	1	SA
...4		1001-001860	IC-ANALOG SWITCH;NX5L2750CGU,QFN,10P,1.4	1	SNA
...4		1103-001531	IC-EEPROM;S-24C256CI-J8T1U4,256Kbit,32Kx	1	SA
...4		1105-002527	IC-DDR3 SDRAM;K4B2G1646Q-BCK0,DDR3,2Gbit	1	SA
...4		1201-003183	IC-AUDIO AMP;DRV612,HTSSOP,14P,5x4.4mm,D	1	SA
...4		1201-003671	IC-AUDIO AMP;NTP7414,MLF,48P,7x7mm,DUAL,	1	SA
...4		1203-004363	IC-VOL. DETECTOR;SOT-23,3Z30,2.9x1.6mm,P	1	SA
...4		1203-006017	IC-VOL. DETECTOR;RT9824GJ8,TSOT23,8P,2.9	1	SA
...4		1203-006130	IC-POSI.FIXED REG.;S-1172B25-U5T1G,SOT-8	1	SA

Exploded Views and Parts List

Level	Loc.	Part Code	Description & Specification	Qty.	SA/SNA
...4		1203-007694	IC-DC/DC CONVERTER;SN1106041DDAR,DDA,8Z3	2	SA
...4		1203-007984	IC-DC/DC CONVERTER;AOZ3015PI,SO-8,8P,6.2	1	SA
...4		1203-008103	IC-POSIFIXED REG.;S-13A1D15-E800,HSOP,8	1	SNA
...4		1203-008104	IC-POSIFIXED REG.;S-13A1D18-E800,HSOP,8	1	SNA
...4		1203-008105	IC-POSIFIXED REG.;S-13A1D33-E800,HSOP,8	1	SNA
...4		1204-003492	IC-DECODER;SENK14,LFBGA,624P,21x21mm,PLA	1	SA
...4		1205-004447	IC-SWITCH;TPS2051CDBVR,SOT23-5,5P,3x1.65	2	SA
...4		1405-001271	VARISTOR;35V,20Vdc,5A,1.0x0.5x0.6mm,TP,1	24	SA
...4		2007-000137	R-CHIP;2Kohm,5%,1/16W,TP,1005	5	SNA
...4		2007-000138	R-CHIP;100ohm,5%,1/16W,TP,1005	21	SA
...4		2007-000142	R-CHIP;2.7Kohm,5%,1/16W,TP,1005	3	SA
...4		2007-000143	R-CHIP;4.7Kohm,5%,1/16W,TP,1005	42	SNA
...4		2007-000148	R-CHIP;10Kohm,5%,1/16W,TP,1005	34	SA
...4		2007-000153	R-CHIP;22Kohm,5%,1/16W,TP,1005	9	SNA
...4		2007-000157	R-CHIP;47Kohm,5%,1/16W,TP,1005	6	SNA
...4		2007-000162	R-CHIP;100Kohm,5%,1/16W,TP,1005	6	SNA
...4		2007-000168	R-CHIP;470Kohm,5%,1/16W,TP,1005	3	SA
...4		2007-000171	R-CHIP;0ohm,5%,1/16W,TP,1005	5	SNA
...4		2007-000172	R-CHIP;10ohm,5%,1/16W,TP,1005	2	SNA
...4		2007-000173	R-CHIP;22ohm,5%,1/16W,TP,1005	10	SNA
...4		2007-000174	R-CHIP;47ohm,5%,1/16W,TP,1005	2	SNA
...4		2007-000256	R-CHIP;1.6Kohm,1%,1/10W,TP,1608	1	SA
...4		2007-000475	R-CHIP;1Mohm,1%,1/10W,TP,1608	1	SA
...4		2007-000691	R-CHIP;3.3Mohm,5%,1/10W,TP,1608	1	SA
...4		2007-000695	R-CHIP;3.3ohm,5%,1/10W,TP,1608	4	SNA
...4		2007-000775	R-CHIP;33Kohm,5%,1/16W,TP,1005	2	SNA
...4		2007-000931	R-CHIP;470ohm,5%,1/8W,TP,2012	1	SC
...4		2007-000932	R-CHIP;470ohm,5%,1/16W,TP,1005	7	SNA
...4		2007-001168	R-CHIP;75ohm,5%,1/4W,TP,3216	1	SA
...4		2007-001292	R-CHIP;33ohm,5%,1/16W,TP,1005	12	SNA
...4		2007-001298	R-CHIP;51ohm,5%,1/16W,TP,1005	2	SNA
...4		2007-001313	R-CHIP;330ohm,5%,1/16W,TP,1005	2	SNA
...4		2007-001325	R-CHIP;3.3Kohm,5%,1/16W,TP,1005	1	SNA
...4		2007-003025	R-CHIP;6.8ohm,5%,1/16W,TP,1005	2	SA
...4		2007-007095	R-CHIP;390ohm,5%,1/16W,TP,1005	1	SA
...4		2007-007107	R-CHIP;100Kohm,1%,1/16W,TP,1005	1	SNA
...4		2007-007108	R-CHIP;43.2Kohm,1%,1/16W,TP,1005	1	SA
...4		2007-007139	R-CHIP;47Kohm,1%,1/16W,TP,1005	1	SA
...4		2007-007142	R-CHIP;10Kohm,1%,1/16W,TP,1005	2	SNA
...4		2007-007156	R-CHIP;1ohm,5%,1/16W,TP,1005	14	SNA

Level	Loc.	Part Code	Description & Specification	Qty.	SA/SNA
...4		2007-007306	R-CHIP;100ohm,1%,1/16W,TP,1005	4	SNA
...4		2007-007309	R-CHIP;12Kohm,1%,1/16W,TP,1005,0.35T	1	SA
...4		2007-007311	R-CHIP;22Kohm,1%,1/16W,TP,1005	1	SA
...4		2007-007317	R-CHIP;2.2Kohm,1%,1/16W,TP,1005	2	SA
...4		2007-007318	R-CHIP;1Kohm,1%,1/16W,TP,1005	17	SNA
...4		2007-007517	R-CHIP;240ohm,1%,1/16W,TP,1005	1	SNA
...4		2007-007538	R-CHIP;56Kohm,1%,1/16W,TP,1005	1	SA
...4		2007-008015	R-CHIP;75ohm,1%,1/16W,TP,1005	10	SA
...4		2007-008275	R-CHIP;30Kohm,1%,1/16W,TP,1005	1	SNA
...4		2007-008332	R-CHIP;11.5Kohm,1%,1/16W,TP,1005	2	SA
...4		2007-009138	R-CHIP;33Kohm,1%,1/16W,TP,1005	2	SNA
...4		2011-001261	R-NETWORK;33ohm,5%,1/16W,L,CHIP,8P,TP,2.	2	SA
...4		2011-001262	R-NETWORK;22ohm,5%,1/16W,L,CHIP,8P,TP,2.	2	SA
...4		2011-001344	R-NETWORK;100ohm,5%,1/16W,L,CHIP,8P,TP,2	6	SA
...4		2011-001345	R-NETWORK;10Kohm,5%,1/16W,L,CHIP,8P,TP,2	4	SA
...4		2011-001396	R-NETWORK;4.7Kohm,5%,1/16W,L,CHIP,8P,TP,	5	SA
...4		2011-001449	R-NETWORK;22ohm,5%,1/16W,L,4P,TP,1010	1	SA
...4		2011-001527	R-NETWORK;4.7Kohm,5%,1/16W,L,CHIP,4P,TP,	1	SNA
...4	AD480	2203-000233	C-CER,CHIP;0.1nF,5%,50V,C0G,TP,1005	9	SA
...4	AD480	2203-000278	C-CER,CHIP;0.01nF,0.5pF,50V,C0G,TP,1005	1	SA
...4	AD480	2203-000359	C-CER,CHIP;0.15nF,5%,50V,C0G,TP,1005,0.5	4	SA
...4	AD480	2203-000438	C-CER,CHIP;1nF,10%,50V,X7R,TP,1005	7	SA
...4	AD480	2203-000489	C-CER,CHIP;2.2nF,10%,50V,X7R,TP,1005	1	SA
...4	AD480	2203-000585	C-CER,CHIP;0.22nF,10%,50V,X7R,TP,1005	1	SA
...4	AD480	2203-000627	C-CER,CHIP;0.022nF,5%,50V,C0G,TP,1005	2	SNA
...4	AD480	2203-000714	C-CER,CHIP;3.3nF,10%,50V,X7R,TP,1005	10	SA
...4	AD480	2203-000812	C-CER,CHIP;0.033nF,5%,50V,C0G,TP,1005	1	SA
...4	AD480	2203-000940	C-CER,CHIP;0.47nF,10%,50V,X7R,TP,1005	6	SA
...4	AD480	2203-000995	C-CER,CHIP;0.047nF,5%,50V,C0G,TP,1005	3	SA
...4	AD480	2203-001412	C-CER,CHIP;0.03nF,5%,50V,NP0,TP,1005	6	SNA
...4	AD480	2203-002285	C-CER,CHIP;10nF,10%,50V,X7R,TP,1005	12	SNA
...4	AD480	2203-002443	C-CER,CHIP;0.33nF,10%,50V,X7R,TP,1005	8	SA
...4	AD480	2203-005054	C-CER,CHIP;0.0047nF,0.25pF,50V,NP0,TP,10	2	SA
...4	AD480	2203-005249	C-CER,CHIP;100nF,10%,50V,X7R,TP,1608	13	SNA
...4	AD480	2203-005659	C-CER,CHIP;0.18nF,5%,50V,NP0,TP,1005	1	SNA
...4	AD480	2203-006048	C-CER,CHIP;100nF,10%,10V,X7R,TP,1005	87	SA
...4	AD480	2203-006126	C-CER,CHIP;47nF,10%,16V,X7R,TP,1005	12	SNA
...4	AD480	2203-006324	C-CER,CHIP;2200nF,10%,10V,X5R,TP,1608	5	SA
...4	AD480	2203-006348	C-CER,CHIP;1000nF,10%,25V,X5R,TP,1608,0.	4	SA
...4	AD480	2203-006361	C-CER,CHIP;10000nF,10%,10V,X5R,TP,2012	4	SC

Exploded Views and Parts List

Level	Loc.	Part Code	Description & Specification	Qty.	SA/SNA
...4	AD480	2203-006474	C-CER,CHIP;22000nF,20%,6.3V,X5R,TP,2012	14	SA
...4	AD480	2203-006562	C-CER,CHIP;1000nF,10%,10V,X5R,TP,1005	17	SNA
...4	AD480	2203-006636	C-CER,CHIP;220nF,10%,25V,X7R,TP,1608	2	SA
...4	AD480	2203-006890	C-CER,CHIP;10000nF,20%,6.3V,X5R,TP,1608	34	SA
...4	AD480	2203-007176	C-CER,CHIP;10000nF,10%,16V,X5R,TP,2012,1	6	SNA
...4	AD480	2203-007240	C-CER,CHIP;22000nF,20%,6.3V,X5R,TP,1608(2	SA
...4	AD480	2203-007269	C-CER,CHIP;22000nF,20%,10V,X5R,TP,2012(2	4	SA
...4	AD480	2203-007270	C-CER,CHIP;10000nF,10%,10V,X5R,TP,1608,0	5	SNA
...4	AD480	2203-007306	C-CER,CHIP;10000nF,10%,25V,X5R,TP,2012,1	1	SNA
...4	AD480	2203-007544	C-CER,CHIP;100nF,10%,50V,X7R,TP,1005,0.5	2	SA
...4		2503-001051	C-NETWORK;100nFx4,20%,16V,2012	1	SA
...4		2703-000158	INDUCTOR-SMD;1uH,10%,2012,.40Ohm,50mA,45,	3	SA
...4		2703-000213	INDUCTOR-SMD;470nH,10%,1608,1.35Ohm,35mA	1	SA
...4		2703-001209	INDUCTOR-SMD;1.2uH,10%,1608,.80Ohm,25mA,3	3	SA
...4		2703-002332	INDUCTOR-SMD;330nH,5%,1608,3Ohm,100mA,32	1	SA
...4		2703-003149	INDUCTOR-SMD;2.2uH,20%,5050,0.055Ohm,300	1	SA
...4		2703-003790	INDUCTOR-SMD;4.7uH,20%,8080,0.025ohm,450	1	SA
...4		2703-003930	INDUCTOR-SMD;4.7uH,20%,5050,0.072Ohm,245	4	SA
...4		2703-004145	INDUCTOR-SMD;2.2uH,20%,6.5 x 6.9mm,0.20o	1	SNA
...4		2801-003773	CRYSTAL-SMD;12MHz,30ppm,28-AAN,20pF,50oh	1	SA
...4		3301-002039	BEAD-SMD;26ohm,1608,TP	43	SA
...4		3701-001861	CONNECTOR-HDMI;19P,FEMALE,AU,0.5mm,BLK,S	2	SA
...4		3707-001106	CONNECTOR-OPTICAL,STRAIGHT W/L,SPDIF	1	SA
...4		3708-001150	CONNECTOR-FPC/FFC/PIC;30P,1mm,SMD-A,SN,Z	1	SA
...4		3709-001712	CONNECTOR-CARD SLOT;68P,1.27mm,ANGLE,AU,	1	SA
...4	EH01	3711-008131	HEADER-BOARD TO CABLE;BOX,4P,1R,2.5mm,AN	1	SA
...4	EH01	3711-008521	HEADER-BOARD TO CABLE;BOX,8P,1R,2mm,ANGL	1	SA
...4	EH01	3711-008634	HEADER-BOARD TO CABLE;BOX,10P,2R,2mm,ANG	1	SA
...4		3722-003457	JACK-USB;4P/1C,NI,BLK,A	1	SA
...4	JACK PIN	3722-003546	JACK-PIN;5P+Screw hole,NI+SN,G,Y/BLU/RED	1	SA
...4		3722-003655	JACK-SCART;21P,SN,BLK	1	SA
...4		3722-003667	JACK-PHONE;1P/7C,SN/NI,BLK,STRAIGHT,3.6P	1	SA
...4	ET01	BN40-00282A	TUNER;DTOS40EIH276A,DTOS40EIH276A,DVB-TC	1	SA
...4		BN41-02098B	PCB MAIN;1.2T,122*193.5,1	1	SNA
...4		BN97-07377F	ASSY MICOM-SUB;T-NT14LDEUS-1002,2014.02.	1	SNA
....5		1107-002226	IC-NOR FLASH;W25Q40CLSSIP,4Mbit,SOIC,8P,	1	SA
...4		BN97-07377K	ASSY MICOM;T-NT14LDEUC-XXXX,F59L1G81A-25	1	SNA
....5		1107-002252	IC-NAND FLASH;F59L1G81A-25TIG,1Gbit,128M	1	SA
....5		BN46-00371E	S/W-E-MANUAL;NT14L,EU4,XC, XN, ZF, ZG, Z	1	SNA
....5		BN46-00377A	S/W MICOM;T-NT14LDEUC-XXXX,2013.10.23	1	SNA

Level	Loc.	Part Code	Description & Specification	Qty.	SA/SNA
..3	T0066	BP62-00017A	HEAT SINK-ES;SP-50L2HX,A6063S,T2.0,26.2,	1	SNA
1		BN92-16883B	ASSY LABEL;UH5C	1	SNA
.2		BN68-06708D	LABEL RATING;ALL,SS,PP,T0.05,93,73,Silve	1	SNA
.2		BN68-07035X	LEAFLET-QSG;UJ4100/UJ4105,32",EUROPE,MOJ	1	SNA
1		BN92-17055F	ASSY P/MATERIAL;UH4100,32"	1	SNA
.2		6902-001516	BAG ROLL;HDPE/PE FOAM,T0.01/T0.3,W650,L3	2	SNA
.2		6922-000013	BAND;PP,W18,L2300/L2900,TRP	0	SNA
.2		BN01-00043A	FOIL-STRETCH-HOOD;LLDPE,T0.08,W980,L1400	0	SNA
.2		BN63-10787E	SHEET-COVER;LE32E420,PE,T4.0,W1000,L1500	1	SNA
.2		BN69-08447A	PAD;COMM,CB,SW2,T3,W800,L1000,-,-,-,YE	1	SNA
.2		BN69-12417A	CUSHION SET;32J4000-TS,EPS,16.7g/L	1	SNA
..3		0103-005099	RESIN EPS;BASF303,Natural,Natural	185	SNA
.2		BN69-12470A	PALLET-WOODEN;UE32J4100,WOOD,890,1330,13	1	SNA
.2		BN74-00008N	TAPE OPP,Silent,T0.065,W60,L1500M,NTR,Ac	2	SNA
1		BN92-18083G	ASSY BOX;UJ4100,32"	1	SNA
.2		BH68-00662A	LABEL BOX-01;ALL MODEL,ART PAPER,60,110,	1	SNA
.2		BN69-12423B	BOX UNIT;32J4100-TS,CB,A-01,SW2,W877,D11	1	SNA
1	ACCE1	BN92-18225K	ASSY ACCESSORY;J4*,UH4A	1	SNA
.2		BN68-05417A	LABEL-02,ENERGY;ALL,EDC,PP,T0.135,60,125	1	SNA
.2		BN96-37716K	ASSY ACCESSORY MANUAL;J4*,UH4A	1	SNA
..3		6902-001964	BAG PE;LDPE,BIOBASED,T0.03,W200,L300,TRP	1	SNA
..3		BN68-00514K	MANUAL FLYER-06,WARRANTY CARD;comm,Samsu	1	SNA
..3		BN68-04972A	MANUAL FLYER-09,REGULATORY GUI;ALL,SAMSU	1	SNA
..3		BN68-05730D	LEAFLET-FICHE CARD;NT14L REFRSH,EUROPE,M	1	SNA
..3		BN68-06489X	MANUAL USERS;J5100 J4100,ZG,ENG/DEU/FRA/	1	SNA
.2		BN96-37722A	ASSY ACCESSORY CABLE;J4*,UH4A	1	SNA
..3	T0268	3903-000849	CBF-POWER CORD;DT,CEE,LP-21L,250V,2.5A,B	1	SC
..3		4301-000121	BATTERY-MN;1.5V,R03,10.5x44.5m,7.5g,AAA	2	SNA
..3	SCREW	6003-001782	SCREW-TAPTYPE;BH,+,B,M4,L12,ZPC(BLK),SWR	6	SA
..3		6902-001965	BAG PE;LDPE,BIOBASED,T0.05,W200,L300,TRP	1	SNA
..3	REMO2	AA59-00741A	REMOCON;TM1240,44,3.0V,F5020/EU	1	SA
..3		BN68-02989A	LABEL-PQS;ALL,ALL,Paper,30,65,WHITE,SEH	1	SNA
..3		BN69-07502A	PACKING SHEET;-LDPE,-,0.04,W0.15,L500,-	0	SNA
..3		BN96-15806B	ASSY HOLDER P-WIRE STAND;UE5500,NYLON,BL	1	SNA
..4		BN61-04731D	TAPE-DOUBLE FACE;ACRYL,T1.1,W20.0mm,WHIT	0	SNA
..4		BN61-05491C	HOLDER-WIRE STAND;UE5500,PA,BLK	1	SNA