

## SD-P70DTSE CHASSIS ASSEMBLY

\*Note 1: There are 10 picks between the side of Top Panel (1) and LCD Mask (3).  
Damage to Top Panel and LCD Mask may occur if removing the picks by metal tool.  
(i.e. screwdriver) Please use plastic tool of same strength to remove the picks.

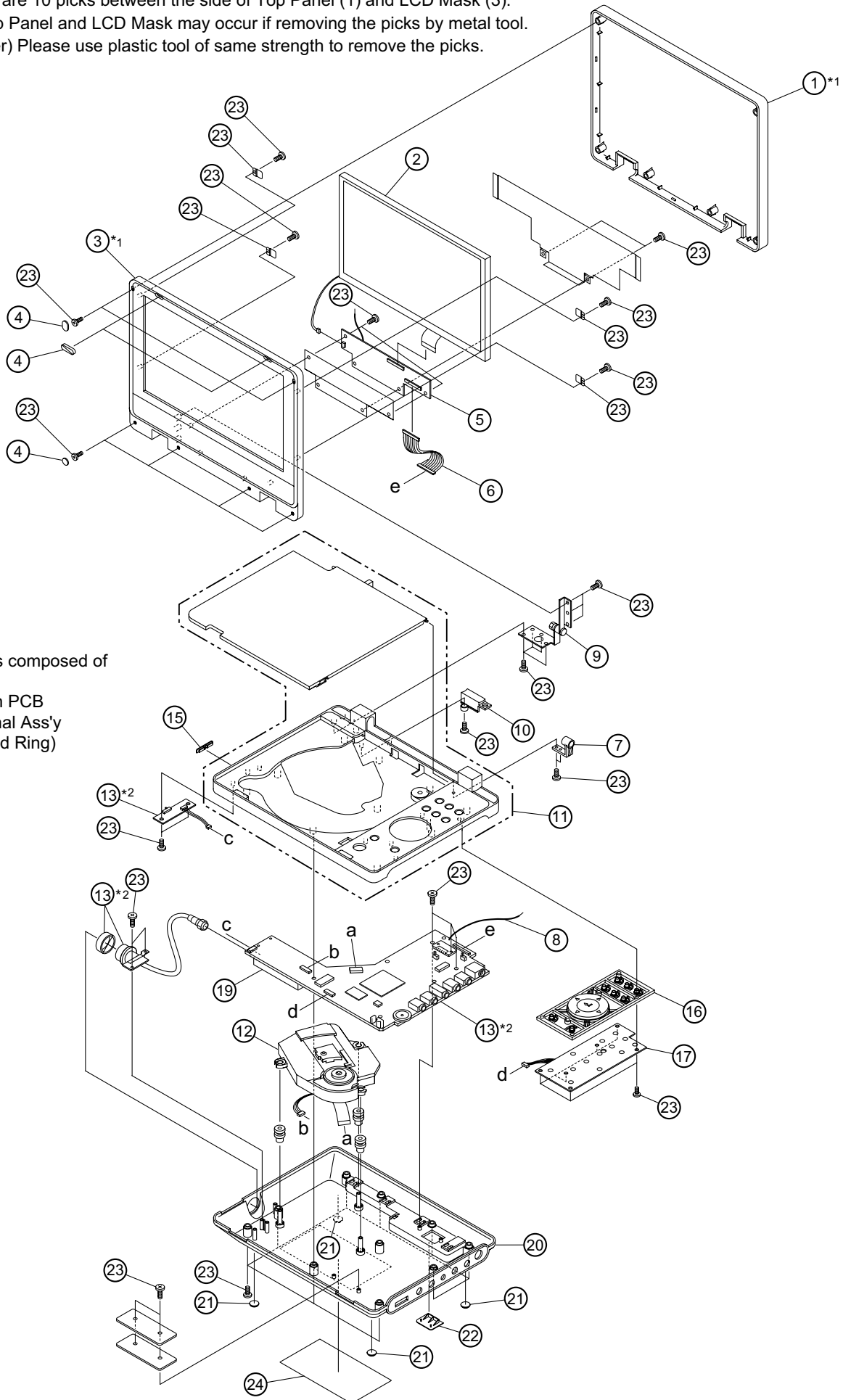

\*Note 2: (13) is composed of  
- Main PCB  
- Power Switch PCB  
- Tuner Terminal Ass'y  
(with PCB and Ring)



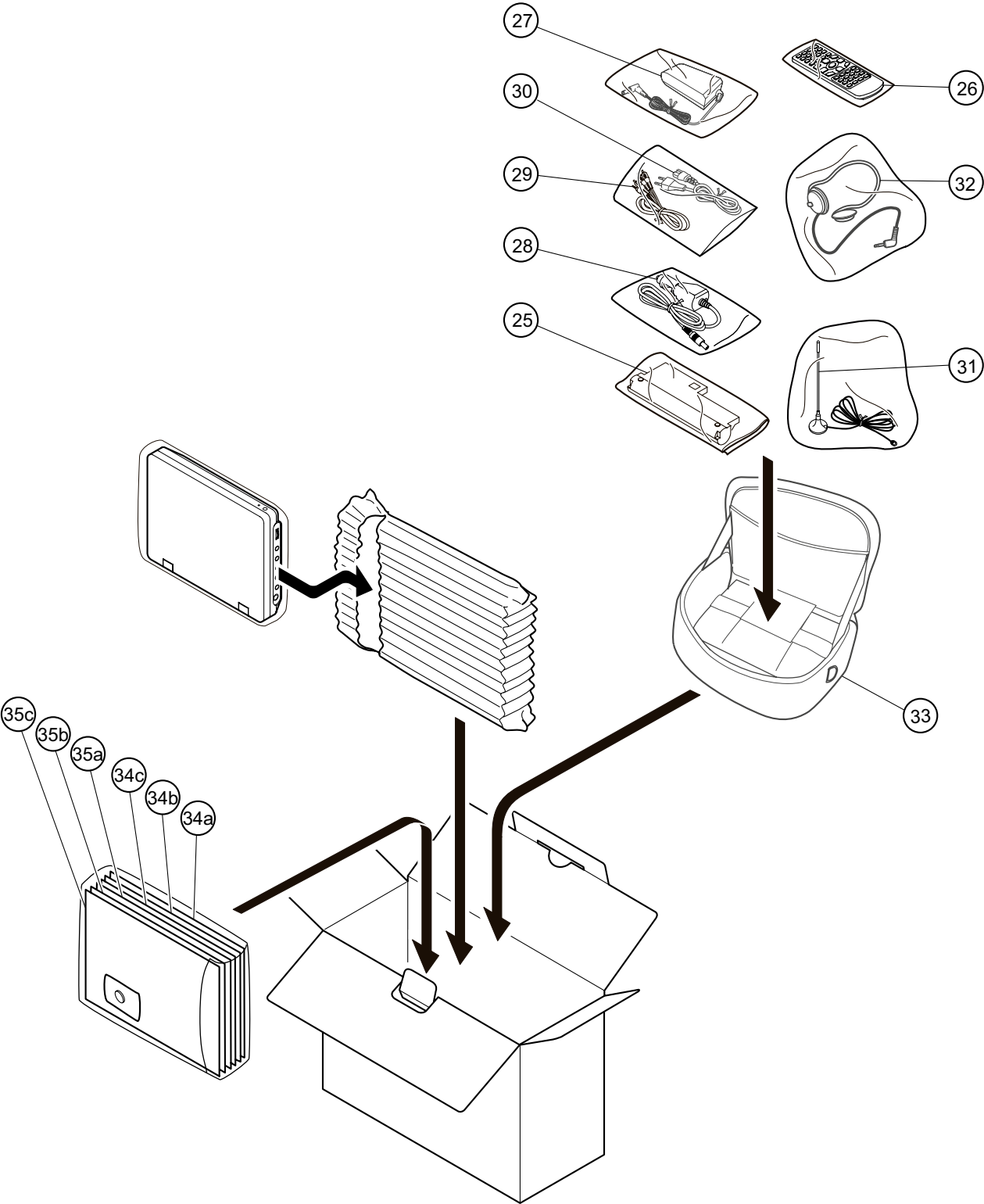







SD-P70DTSE PACKING ASSEMBLY



# PARTS LIST: SD-P70DTSE

## NOTE:

When the bottom cover (20) is replaced with a new one, put a new rating label (24) on the new bottom cover.  
Transcribe the following items (SERIAL NO., MANUFACTURED etc.) described on the old rating label to the new rating label by using a permanent maker.

	Loc. No.	TSB P/N	Ref. P/N	Description
	1	AH302272	e27016	Top cover ass'y
	2	AH302382	ea7187t	LCD unit
	3	AH302274	e27017	LCD mask ass'y
	4	AH302275	e27018	LCD mask pad
	5	AH302383	e25120	LCD PCB
	6	AH302277	e25109	Harness
	7	AH302384	eb45203	Harness holder
	8	AH302385	es31518	Earth wire
	9	AH302278	eb45221	Hinge ass'y
	10	AH302279	eb45201j	Hinge cover
	11	AH302386	e27025	Sub cover ass'y
	12	AH302387	e25121	DVD mecha ass'y
	13	AH302396	e25123	Main PCB / Power Switch PCB / Tuner Terminal Ass'y
	15	AH302283	eb45200j	Power switch knob
	16	AH302284	e27020	Function button
	17	AH302397	e22768	Function PCB
	19	AH302398	ea7959	DVB-T(DNOS604PH104A)
	20	AH302399	e27028	Bottom cover ass'y
	21	AH301617	eb40826	Bottom cover pads
	22	AH301728	eb43054h	Battery slot cover
	23	AH302393	e27027	Screw kit
	24	AH302400	es13099	Rating label without serial number
	25	AH302292	e25112	Battery pack with the rating label, SD-PBP70E
	26	AH302401	es06198	Remoto Contorl, MEDR70EX
	27	AH302148	es9014c	AC adaptor, ADPV16A
	28	AH301125	es8147	Car adaptor, MEDC01AX
	29	AH301124	es3468a	AV cable
	30	AH301380	es2684	VDE POWER CORD
	31	AH301776	es31225	Antenna
	32	AH302255	es4365c	AT-H-SH306AE Headphone
	33	AH301733	es8682a	Carrying Bag
	34a	AH302402	es15239dssa	Owner's Manual, English
	34b	AH302403	es15239dssb	Owner's Manual, French
	34c	AH302404	es15239dssc	Owner's Manual, Garmany
	35a	AH302405	es14398	Quick Guide, Spanish
	35b	AH302406	es14398a	Quick Guide, Dutch
	35c	AH302407	es14398b	Quick Guide, Swedish

## SAFETY PRECAUTION

The parts identified by  mark are critical for safety. Replace only with part number specified.  
The mounting position of replacement is to be identical with originals.  
The substitute replacement parts which do not have the same safety characteristics as specified in the parts list may create shock, fire or other hazards.