

*Note: There are 10 picks between the side of Top Panel (1) and LCD Mask (3).
Damage to Top Panel and LCD Mask may occur if removing the picks by metal tool.
(i.e. screwdriver) Please use plastic tool of same strength to remove the picks.

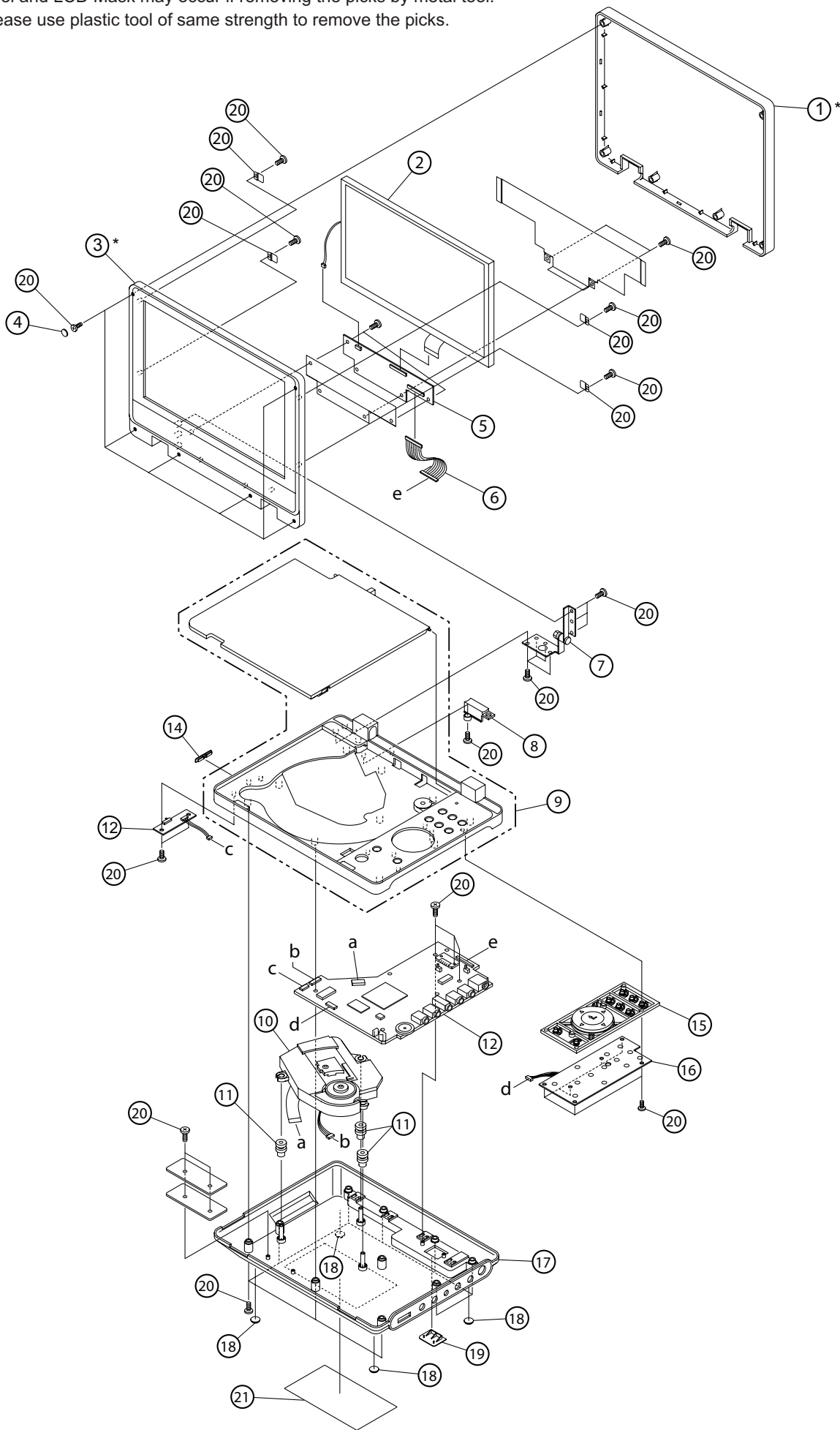

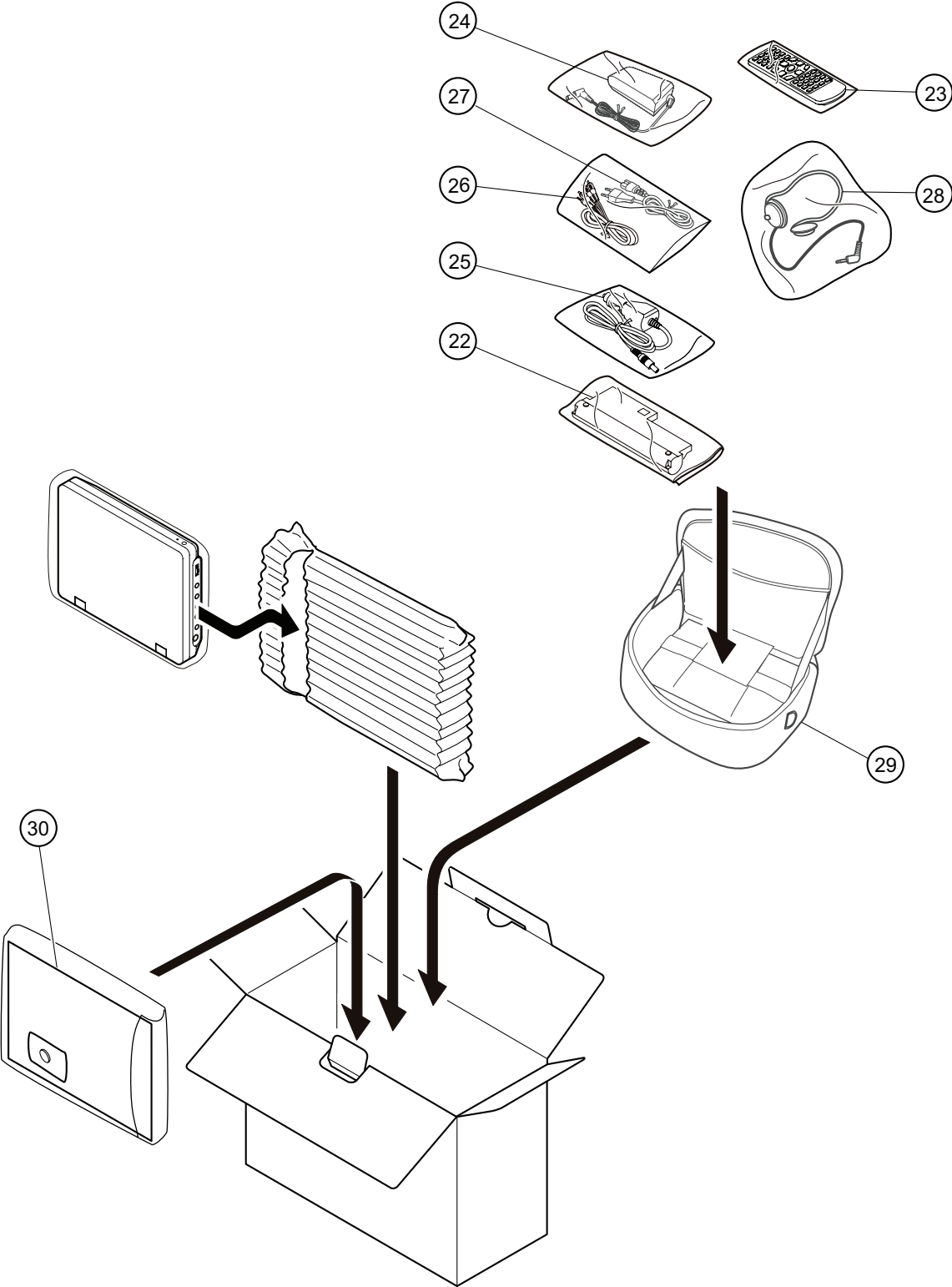







SD-P1704SE PACKING ASSEMBLY



PARTS LIST: SD-P1704SE

NOTE:

When the bottom cover (17) is replaced with a new one, put a new rating label (21) on the new bottom cover.
Transcribe the following items (SERIAL NO., MANUFACTURED etc.) described on the old rating label to the new rating label by using a permanent maker.

	Loc. No.	TSB P/N	Ref. P/N	Description
	1	AH302272	e27016	Top cover ass'y
	2	AH302273	ea7398a	LCD unit
	3	AH302510	e25162	LCD mask ass'y
	4	AH302275	e27018	LCD mask pad
	5	AH302276	e25108	LED PCB
	6	AH302277	e25109	Harness
	7	AH302278	eb45221	Hinge ass'y
	8	AH302279	eb45201j	Hinge cover
	9	AH302511	e25163	Sub cover ass'y
	10	AH302281	e25110	DVD mecha ass'y
	11	AH301644	eb8073	Dumper
	12	AH302282	e25111	Main PCB / Power Switch PCB
	14	AH302283	eb45200j	Power switch knob
	15	AH302284	e27020	Function button
	16	AH302285	e22703	Function PCB
	17	AH302512	e25164	Bottom cover ass'y
	18	AH301467	eb5430	Bottom cover pads
	19	AH301728	eb43054h	Battery slot cover
	20	AH302513	e25165	Screw kit
	21	AH302514	es13360	Rating label without serial number
	22	AH302515	e25166	Battery pack with the rating label, SD-PBP70E
	23	AH301378	es06054c	Remoto Control, MEDR16UX
	24	AH302148	es9014c	AC Adaptor, ADPV16A
	25	AH302516	es8302	Car Adaptor, TOSHIBA, SD-P1704SE
	26	AH301124	es3468a	AV Cable
	27	AH301380	es2684	Power Code, Euro (VDE)
	28	AH302255	es4365c	Headphone, AT-H-SH306AE
	29	AH301733	es8682a	Carrying Bag
	30	AH302517	es15239fss	Owner's Manual, French

SAFETY PRECAUTION

The parts identified by  mark are critical for safety. Replace only with part number specified.
The mounting position of replacement is to be identical with originals.
The substitute replacement parts which do not have the same safety characteristics as specified in the parts list may create shock, fire or other hazards.

TOSHIBA CORPORATION

1-1, SHIBAURA 1-CHOME, MINATO-KU,TOKYO 105-8001,JAPAN