

EXPLODED VIEW

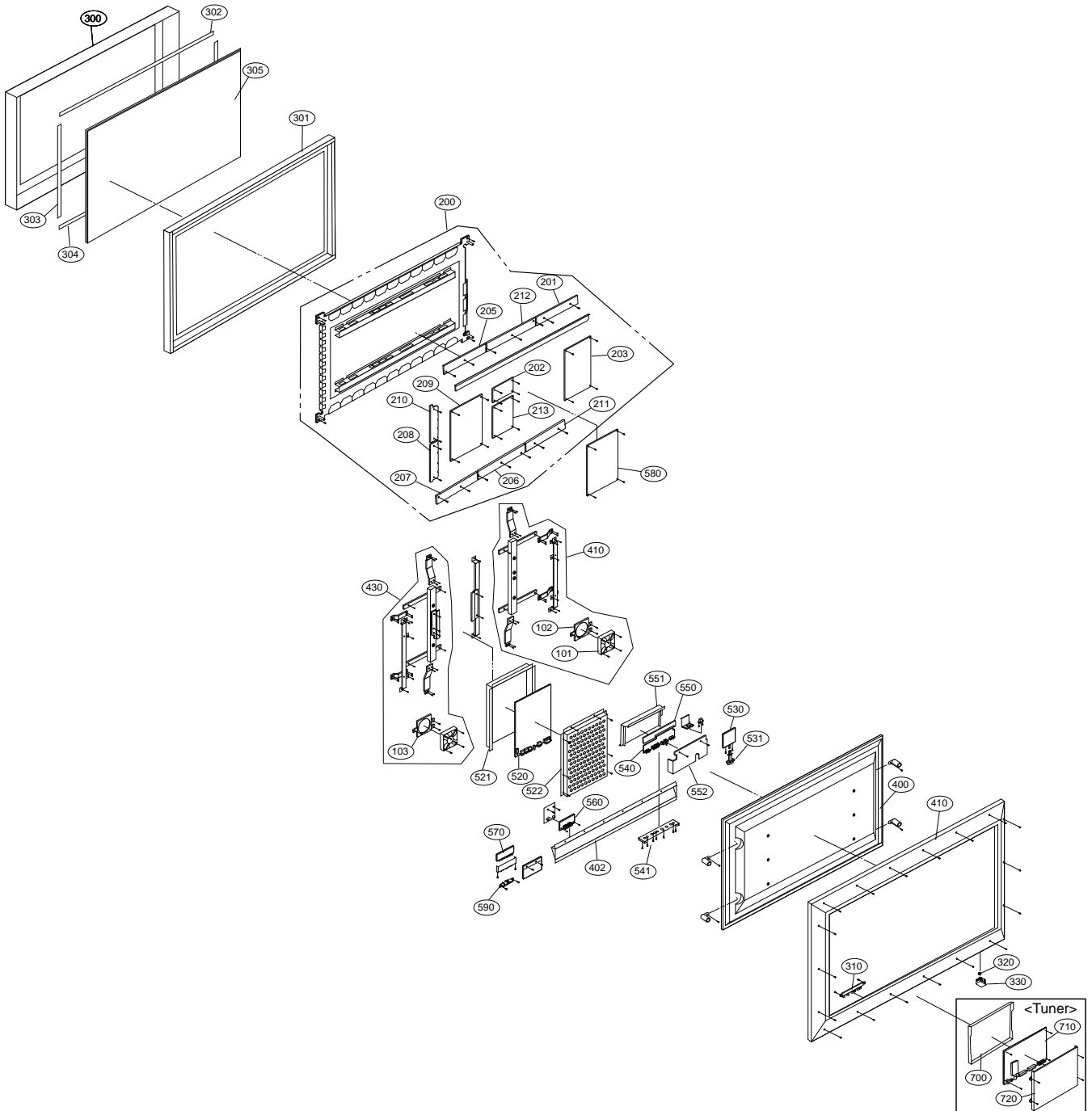

EXPLODED VIEW PARTS LIST

No.	Part No.	Description
101	5900V12001A	FAN,DC G1225S12B2 DONGYANG 12X12X25 12V130MA 1500 168GM MOTOR L=260
102	4980V00781A	SUPPORTER, ASSY NON FAN(L) MN-50PZ10
103	4980V00782A	SUPPORTER, ASSY NON FAN(R) MN-50PZ10
200	6348Q-C032A	PDP, 50 16:9 1365*768 KK, FOR INTERCOMPANY DOMESTIC
201	6871QRH035A	PWB(PCB) ASSEMBLY,DISPLAY XRRT ASSY HAND INSERT 50X2 X_RT 4LAYER 260MM X 280MM
202	6871QPH008A	PWB(PCB) ASSEMBLY,DISPLAY DCDC ASSY HAND INSERT KK MODEL
203	6871QZH031A	PWB(PCB) ASSEMBLY,DISPLAY ZSUS ASSY HAND INSERT 50KK 2LAYER
205	6871QLH032A	PWB(PCB) ASSEMBLY,DISPLAY XRLT ASSY HAND INSERT 50X2 X_LT 4LAYER 352.5 X 280
206	6871QXH021A	PWB(PCB) ASSEMBLY,DISPLAY XRCB ASSY HAND INSERT 50X2 X_CB 4LAYER 415.5MM X 280MM
207	6871QLH033A	PWB(PCB) ASSEMBLY,DISPLAY XRLB ASSY HAND INSERT 50X2 X_LB 4LAYER 352.5 X 280
208	6871QDH049A	PWB(PCB) ASSEMBLY,DISPLAY YDRV ASSY HAND INSERT 50WDXP2 4L(BTM)
209	6871QYH028A	PWB(PCB) ASSEMBLY,DISPLAY YSUS ASSY HAND INSERT 50KK 4LAYER
210	6871QDH048A	PWB(PCB) ASSEMBLY,DISPLAY YDRV ASSY HAND INSERT 50WDXP2 4L(TOP)
211	6871QRH036A	PWB(PCB) ASSEMBLY,DISPLAY XRRB ASSY HAND INSERT 50X2 X_RB 4LAYER 260X 280
212	6871QXH020A	PWB(PCB) ASSEMBLY,DISPLAY XRCT ASSY HAND INSERT 50X2 X_CT 4LAYER 415.5 X 280
213	6871QCH028B	PWB(PCB) ASSEMBLY,DISPLAY CTRL ASSY HAND INSERT 50X2 280*180 PD4021
300	3091V00433X	CABINET ASSEMBLY, MZ-50PZ44 NON RF03GB FOR KK COSMETIC CHANGE
301	3110V00203D	CASE, ASSY MN-50PZ44S EGI .
302	4980V00361A	SUPPORTER, FILTER EGI MN-50PZ40
303	4980V00362A	SUPPORTER, FILTER EGI MN-50PZ40
304	4980V00363A	SUPPORTER, FILTER EGI MN-50PZ40
305	3790V00683B	FILTER(MECH), MN-50PZ41 115001S03E GLASS NBK MESH SINGLE AR
310	5020V00688A	BUTTON, CONTROL MN-50PZ41 . SET
320	320-062H	SPRING, COIL
330	5020V00645A	BUTTON, POWER OUTER MN-50PZ40 SET
400	3809V00292D	BACK COVER ASSEMBLY, MZ-50PZ46 NON PIGGY
401	3809V00293M	BACK COVER ASSEMBLY, MZ-50PZ44 NON FOR KK COS CHANGE
402	3301V00016N	PLATE ASSEMBLY, A/V PIGGY MT-50PZ44V
410	4980V00416E	SUPPORTER, MODULE AL MN-50PZ44VS LEFT
430	4980V00416F	SUPPORTER, MODULE AL MN-50PZ44VS RIGHT
520	6871VMMR01A	PWB(PCB) ASSEMBLY, MAIN RF03FB 50 KK VSC B/D (40)
	6871VMMR01B	PWB(PCB) ASSEMBLY, MAIN RF03FB 50 KK VSC B/D (40)
521	4814V00323B	SHIELD, ASSY MN-50PZ10 NON AL BOTTOM
522	4814V00387A	SHIELD, ASSY MN-50PZ90V NON NON VSC TOP
530	6871VSMV26A	PWB(PCB) ASSEMBLY,SUB, PSW RF03GB 50 KK POWES S/W
531	5020V00648A	BUTTON, POWER INNER MN-50PZ40 SET
540	6871VSMV85A	PWB(PCB) ASSEMBLY,SUB A/V RF03FB 50 KK AV BOARD (RCA)
550	6871VSMV30A	PWB(PCB) ASSEMBLY,SUB A/V RF03GB FIX BOARD
551	4980V00936A	SUPPORTER, NON EGI AV
552	4814V00388B	SHIELD, CASE MN-50PZ90V RF03GB AL AV
560	6871VSMV28A	PWB(PCB) ASSEMBLY,SUB SPK RF03GB 50 KK SPK TERMINAL
570	6871VSMD08A	PWB(PCB) ASSEMBLY,SUB KBD RF-02CA 50IN LOCAL KEY
580	3501V00084D	BOARD ASSEMBLY, POWER MN50PZ10 RF03GB SRX-75 SONY 50KK
590	6871VSMD07A	PWB(PCB) ASSEMBLY,SUB, P/AMP RF-02CA 50IN PRE AMP
TUNER		
700	3110V00237F	CASE, TUNER RT-BA50 EGI BOTTOM ASSY
	3110V00237E	CASE, TUNER RZ-BA50 EGI BOTTOM ASSY
710	6871VMM500C	PWB ASSEMBLY,MAIN RF03FA PIGGYBACK STB-SCART
	6871VMM499B	PWB ASSEMBLY,MAIN RF03FA PIGGYBACK STB-SCART
720	3110V00242F	CASE, TUNER RT-BA50 EGI TOP ASSY
	3110V00242E	CASE, TUNER RZ-BA50 EGI TOP ASSY

REPLACEMENT PARTS LIST

LOCA. NO	PART NO	DESCRIPTION	LOCA. NO	PART NO	DESCRIPTION
IC					
KIC001	0ISM555000A	IC, SDA5550 MQFP100 BK MICOM TXT MC006A	IC743	0ITI745740M	IC, 14P,SOP TP D-TYPE EDGE TRIGGER FLIP FLOP
IC001	0ISO208900A	IC, CXA2089Q 48QFP BK A/V SWITCH	IC744	0IMCRPH017A	IC, 20P SOT360-1 R/TP D-TYPE FLIP-FLOP
IC002	0IZZVA0079B	IC, M27W201 DIP 32P ST RF-03FA PIGGY OTP(RCA)	IC745	0IPH740800L	IC, 74LVT08D 14SOP R/TP LOW VOLTAGE AND DI-32Q82
IC002	0IMCRFA010A	IC, KA7809R, FAIRCHILD 2P D-PAK, R/TP REGULATOR IC	IC746	0IMCRPH015A	IC, 14P SOT108-1 R/TP QUAD 2-IN OR GATE
IC003	0ISS610082A	IC, 32-TSOP R/TP 1M(8BIT-128K)-SRAM(3.3V),70NS MC-006A	IC747	0IMCRPH016A	IC, 16P SOT109-1 R/TP DUAL 2TO4
IC004	0IAL241610B	IC, AT24C16A-10PI-2.7 8PIN DIP ST EEPROM NON	IC748	0IMCRPH014A	IC, 74LV132D PHILIPS 14P SOT108-1 R/TP QUAD 2-IN NAND
IC005	0IKE702700D	IC, KIA7027AF 3, SOT-89 TP RESET IC 2.7V	IC749	0IKE702700D	IC, KIA7027AF 3, SOT-89 TP RESET IC 2.7V
IC006	0ISJ111725A	IC, EZ1117ACST-2.5 3P SOT ST REGULATORS	IC750	0IDS232000A	IC, DS232AS 16P,SOP TP RS-232 DRIVER/RECEIVER
IC008	0ISJ111733A	IC, EZ1117CST-3.3 3P,SOT-223 TP 3.3V CHIP REGULATOR	IC751	0IPH858400A	IC, PCF8584T 20P,SOP TP IIC BUS CONTROLLER
IC101	0IMCRFA015A	IC, KA7805R FAIRCHILD 2P D-PAK R/TP 500MA	IC801	0IMCRSG003A	IC, LA4973D5.1 20P SOP R/TP 5.1V REGULATOR
IC101	0IAL242110A	IC, AT24C21-10SI-2.5 8P,SOP TP 1K EEPROM	IC802	0IMCRSG003A	IC, LA4973D5.1 20P SOP R/TP 5.1V REGULATOR
IC102	0IAL242110A	IC, AT24C21-10SI-2.5 8P,SOP TP 1K EEPROM	IC802	0ISA428200A	IC, LA4282 12S 2CHX10W AUDIO AMP
IC103	0IMCRTI003A	IC, 16P R/TP QUADRUPLE	IC850	0IMCRSJ001A	IC, SC15651ST-1.8 SEMTECH 3P SOT223 TP REGULATOR
IC104	0IPRPBB005A	IC, 16PIN SSOP R/TP BUFFER AMP	IC852	0IMCRFA010A	IC, KA7809R, FAIRCHILD 2P D-PAK, R/TP REGULATOR IC
IC1101	0IDS162100B	IC, DS1621V 8P SOIC ST THERMOSTAT -	IC853	0IMCRRH001A	IC, BA033FP ROHM 3P-SOP,TO252-3 R/TP 3.3V REGULATOR
IC1102	0IMCRPH015A	IC, 14P SOT108-1 R/TP QUAD 2-IN OR GATE	IC857	0IMCRRH001A	IC, BA033FP ROHM 3P-SOP,TO252-3 R/TP 3.3V REGULATOR
IC1103	0ISH092100B	IC, PQ09RD21 4SIP ST REGULATOR -	IC858	0IMCRSH001A	IC, PQ05DZ1U SHARP 5, SMD TYPE R/TP REGULATOR
IC1104	0ISH122100B	IC, PQ12RD21 4SIP ST REGULATOR -	IC859	0IMCRSH001A	IC, PQ05DZ1U SHARP 5, SMD TYPE R/TP REGULATOR
IC1105	0ISH092100B	IC, PQ09RD21 4SIP ST REGULATOR -	IC901	0IMCRMN014A	IC, MSP3440G QA B8 V3 MICRONAS 80 QFP TRAY SOUND IC
IC201	0ISO210100B	IC, CXA2101AQ 80P,QFP BK VIDEO SIGNAL PROCESSOR	IC902	0IKE780800J	IC, KIA7808API 3 ST REGULATOR .
IC202	0IPRPPTI001A	IC, TFP401PZP TEXAS INSTRUMENT 100,TQFP	IC903	0IMCRSH001A	IC, PQ05DZ1U SHARP 5, SMD TYPE R/TP REGULATOR
IC205	0IMCRTI003A	IC, 16P R/TP QUADRUPLE	IC904	0IKE704200J	IC, KIA7042AF SOT-89 TP 4.2V VOLTAGE DETECTOR
IC301	0IMCRAD003A	IC, AD9888KS-140 ANALOG DEVICE 128P MQFP	IC915	0IMCRTI001A	IC, SN74HCT157D TEXAS INSTRUMENT 16P R/TP RL-JA10
IC401	0ISO208900A	IC, CXA2089Q 48QFP BK A/V SWITCH	IC917	0IFA742530B	IC, 74ACT253SC 16P-SOIC, JEDEC MS-012 R/TP IC
IC401	0IIT323000E	IC, VPC3230D C5 80P QFP TRAY VIDEO PROCESSOR PDP50	DIODE		
IC402	0IMCRFA010A	IC, KA7809R, FAIRCHILD 2P D-PAK, R/TP REGULATOR IC	D001	0DD184009AA	DIODE, KDS184S CHIP 85V 300MA KEC TP
IC403	0IFA741230A	IC, DM74LS123MX 16SOP TP DUAL RETRIG.	D001	0DL200000CA	LED, SAM5670(DL-2LRG) BK Y-GREEN -
IC405	0IMCRGN001B	IC, FLI2310BC GENESIS 208P PQFP TRAY	D001	0DD226239AA	DIODE, CHIP KDS226 SOT-23
IC406	0IMMRHY033A	IC, HY57V643220C(L)T-6 HYNIX 86P TSOP	D002	0DD184009AA	DIODE, KDS184S CHIP 85V 300MA KEC TP
IC407	0IIT323000E	IC, VPC3230D C5 80P QFP TRAY VIDEO PROCESSOR PDP50	D002	0DD226239AA	DIODE, CHIP KDS226 SOT-23
IC408	0IMCRGN002B	IC, 208P PQFP TRAY DIGITAL VIDEO CONVERTER	D003	0DD184009AA	DIODE, KDS184S CHIP 85V 300MA KEC TP
IC409	0IMMRHY033A	IC, HY57V643220C(L)T-6 HYNIX 86P TSOP	D003	0DD226239AA	DIODE, CHIP KDS226 SOT-23
IC501	0IMI623200B	IC, 16P SOP TP I/O EXPANDER CN-29Q3	D004	0DD184009AA	DIODE, KDS184S CHIP 85V 300MA KEC TP
IC501	0IMCROT001A	IC, LTD 352BALL TRAY D-DISPLAY CON. CHIP	D004	0DD226239AA	DIODE, CHIP KDS226 SOT-23
IC502	0IMMRHY033A	IC, 86P TSOP TRAY 64M FLASH MEMORY	D005	0DD226239AA	DIODE, CHIP KDS226 SOT-23
IC503	0IMMRHY033A	IC, 86P TSOP TRAY 64M FLASH MEMORY	D006	0DD226239AA	DIODE, CHIP KDS226 SOT-23
IC504	0IMMRHY033A	IC, 86P TSOP TRAY 64M FLASH MEMORY	D006	0DD226239AA	DIODE, CHIP KDS226 SOT-23
IC601	0IMCRMN011D	IC, MSP3410G QA B8 V3 MICRONAS 80P QFP TRAY SOUND	D006	0DD226239AA	DIODE, CHIP KDS226 SOT-23
IC601	0IS5160000A	IC, SII160 100 TQFP ST PANELLINK DIGITAL TRANSMITTER	D010	0DD226239AA	DIODE, CHIP KDS226 SOT-23
IC602	0IKE704200J	IC, KIA7042AF SOT-89 TP 4.2V VOLTAGE DETECTOR	D011	0DD226239AA	DIODE, CHIP KDS226 SOT-23
IC603	0IMCRFA009A	IC, KA78M08RTM, FAIRCHILD 2P D-PAK, R/TP	D011	0DD226239AA	DIODE, CHIP KDS226 SOT-23
IC604	0IMCRFA015A	IC, KA7805R FAIRCHILD 2P D-PAK R/TP 500MA	D012	0DD226239AA	DIODE, CHIP KDS226 SOT-23
IC701	0IMCRRS001A	IC, 100P PQFP TRAY 16BIT MICRO CONTROLLER	D013	0DD226239AA	DIODE, CHIP KDS226 SOT-23
IC702	0IMCRFA015A	IC, KA7805R FAIRCHILD 2P D-PAK R/TP 500MA	D100	0DD226239AA	DIODE, CHIP KDS226 SOT-23
IC702	0IMMRSS064A	IC, K6R4016V1D-TC10 44P TSOP2-400BF R/TP 4M(256K*16)	D101	0DD226239AA	DIODE, CHIP KDS226 SOT-23
IC703	0IMMRMR006B	IC, 48P TSOP R/TP 16M FLASH MEMORY	D101	0DD226239AA	DIODE, CHIP KDS226 SOT-23
IC704	0IMCRFA015A	IC, K 2P D-PAK R/TP 500MA REGULATOR IC	D101	0DD226239AA	DIODE, CHIP KDS226 SOT-23
IC704	0IMMRAL025A	IC, AT24C32AN-10SI-2.7 ATMEL 8PIN SOP TP 32K 3.3V	D102	0DD226239AA	DIODE, CHIP KDS226 SOT-23
IC706	0IMCRTI003A	IC, 16P R/TP QUADRUPLE	D102	0DD226239AA	DIODE, CHIP KDS226 SOT-23
IC741	0IMCRFA013A	IC, 74LCX244MTC FAIRCHILD 20P TSSOP R/TP	D102	0DD226239AA	DIODE, CHIP KDS226 SOT-23
IC742	0IMCRFA013A	IC, 74LCX244MTC FAIRCHILD 20P TSSOP R/TP	D103	0DD226239AA	DIODE, CHIP KDS226 SOT-23
			D105	0DD226239AA	DIODE, CHIP KDS226 SOT-23

LOCA. NO	PART NO	DESCRIPTION
D106	0DD226239AA	DIODE, CHIP KDS226 SOT-23
D107	0DD184009AA	DIODE, KDS184S CHIP 85V 300MA KEC TP
D108	0DD226239AA	DIODE, CHIP KDS226 SOT-23
D109	0DD226239AA	DIODE, CHIP KDS226 SOT-23
D110	0DD226239AA	DIODE, CHIP KDS226 SOT-23
D1101	0DD100009AC	DIODE, RU1V(1) TP SANKEN
D111	0DD226239AA	DIODE, CHIP KDS226 SOT-23
D112	0DD226239AA	DIODE, CHIP KDS226 SOT-23
D113	0DD226239AA	DIODE, CHIP KDS226 SOT-23
D114	0DD226239AA	DIODE, CHIP KDS226 SOT-23
D115	0DD226239AA	DIODE, CHIP KDS226 SOT-23
D117	0DD226239AA	DIODE, CHIP KDS226 SOT-23
D118	0DD226239AA	DIODE, CHIP KDS226 SOT-23
D406	0DD226239AA	DIODE, CHIP KDS226 SOT-23
D407	0DD226239AA	DIODE, CHIP KDS226 SOT-23
D408	0DD226239AA	DIODE, CHIP KDS226 SOT-23
D409	0DD226239AA	DIODE, CHIP KDS226 SOT-23
D411	0DD226239AA	DIODE, CHIP KDS226 SOT-23
D413	0DD226239AA	DIODE, CHIP KDS226 SOT-23
D414	0DD226239AA	DIODE, CHIP KDS226 SOT-23
D415	0DZ510009BF	DIODE, GDZ5.1B TP GRANDE DO34 0.5W 5.1V 0.02A
D450	0DD226239AA	DIODE, CHIP KDS226 SOT-23
D451	0DD226239AA	DIODE, CHIP KDS226 SOT-23
D501	0DD226239AA	DIODE, CHIP KDS226 SOT-23
D502	0DD226239AA	DIODE, CHIP KDS226 SOT-23
D513	0DD226239AA	DIODE, CHIP KDS226 SOT-23
D514	0DD226239AA	DIODE, CHIP KDS226 SOT-23
D601	0DD226239AA	DIODE, CHIP KDS226 SOT-23
D602	0DD226239AA	DIODE, CHIP KDS226 SOT-23
D706	0DD226239AA	DIODE, CHIP KDS226 SOT-23
D707	0DD226239AA	DIODE, CHIP KDS226 SOT-23
D708	0DD184009AA	DIODE, KDS184S CHIP 85V 300MA KEC TP
D709	0DD184009AA	DIODE, KDS184S CHIP 85V 300MA KEC TP
D801	0DR190309AA	DIODE, MBRS190T3 TP 90V 1A 50A 10NSEC 1MA
D803	0DR190309AA	DIODE, MBRS190T3 TP 90V 1A 50A 10NSEC 1MA
D804	0DD226239AA	DIODE, CHIP KDS226 SOT-23
D854	0DD226239AA	DIODE, CHIP KDS226 SOT-23
D855	0DD226239AA	DIODE, CHIP KDS226 SOT-23
D857	0DD226239AA	DIODE, CHIP KDS226 SOT-23
D870	0DD226239AA	DIODE, CHIP KDS226 SOT-23
D872	0DD226239AA	DIODE, CHIP KDS226 SOT-23
D873	0DD226239AA	DIODE, CHIP KDS226 SOT-23
D880	0DL233309AC	LED, GREEN/RED GREEN:10MCD, RED:6MCD
D881	0DL233309AC	LED, GREEN/RED GREEN:10MCD, RED:6MCD
D882	0DL233309AC	LED, GREEN/RED GREEN:10MCD, RED:6MCD
D883	0DL233309AC	LED, GREEN/RED GREEN:10MCD, RED:6MCD
DA105	0DD226239AA	DIODE, CHIP KDS226 SOT-23
LD740	0DL233309AC	LED, GREEN/RED GREEN:10MCD, RED:6MCD
LD741	0DL233309AC	LED, GREEN/RED GREEN:10MCD, RED:6MCD
LD742	0DL233309AC	LED, GREEN/RED GREEN:10MCD, RED:6MCD
LD743	0DL233309AC	LED, GREEN/RED GREEN:10MCD, RED:6MCD
ZD001	0DR050008AA	DIODE, SD05.TC R/TP SEMTECH SOD323 5V 5A 15A

LOCA. NO	PART NO	DESCRIPTION
ZD002	0DR050008AA	DIODE, SD05.TC R/TP SEMTECH SOD323 5V 5A 15A
ZD101	0DZ330009DF	DIODE, MTZJ33B TP ROHM-K DO34 0.5W 33V 5UA
ZD830	0DR050008AA	DIODE, SD05.TC R/TP SEMTECH SOD323 5V 5A 15A
ZD831	0DR050008AA	DIODE, SD05.TC R/TP SEMTECH SOD323 5V 5A 15A
ZD832	0DR050008AA	DIODE, SD05.TC R/TP SEMTECH SOD323 5V 5A 15A
TRANSISTOR		
IC203	0TR830009BA	TR, BSS83 TP PHILIPS NON N-CHANNEL S/W TR
IC204	0TR830009BA	TR, BSS83 TP PHILIPS NON N-CHANNEL S/W TR
IC803	0TR830009BA	TR, BSS83 TP PHILIPS NON N-CHANNEL S/W TR
Q001	0TR150400BA	TR, CHIP 2SA1504S(ASY) KEC
Q001	0TR387500AA	TR, CHIP 2SC3875S(ALY) KEC
Q001	0TR387500AA	TR, CHIP 2SC3875S(ALY) KEC
Q002	0TR150400BA	TR, CHIP 2SA1504S(ASY) KEC
Q002	0TR387500AA	TR, CHIP 2SC3875S(ALY) KEC
Q002	0TR387500AA	TR, CHIP 2SC3875S(ALY) KEC
Q003	0TR830009BA	TR, BSS83 TP PHILIPS NON N-CHANNEL S/W TR
Q003	0TR150400BA	TR, CHIP 2SA1504S(ASY) KEC
Q003	0TR387500AA	TR, CHIP 2SC3875S(ALY) KEC
Q004	0TR830009BA	TR, BSS83 TP PHILIPS NON N-CHANNEL S/W TR
Q004	0TR387500AA	TR, CHIP 2SC3875S(ALY) KEC
Q005	0TR830009BA	TR, BSS83 TP PHILIPS NON N-CHANNEL S/W TR
Q005	0TR387500AA	TR, CHIP 2SC3875S(ALY) KEC
Q006	0TR830009BA	TR, BSS83 TP PHILIPS NON N-CHANNEL S/W TR
Q006	0TR387500AA	TR, CHIP 2SC3875S(ALY) KEC
Q007	0TR830009BA	TR, BSS83 TP PHILIPS NON N-CHANNEL S/W TR
Q007	0TR387500AA	TR, CHIP 2SC3875S(ALY) KEC
Q008	0TR830009BA	TR, BSS83 TP PHILIPS NON N-CHANNEL S/W TR
Q008	0TR387500AA	TR, CHIP 2SC3875S(ALY) KEC
Q008	0TR387500AA	TR, CHIP 2SC3875S(ALY) KEC
Q009	0TR387500AA	TR, CHIP 2SC3875S(ALY) KEC
Q009	0TR387500AA	TR, CHIP 2SC3875S(ALY) KEC
Q101	0TR387500AA	TR, CHIP 2SC3875S(ALY) KEC
Q102	0TR387500AA	TR, CHIP 2SC3875S(ALY) KEC
Q103	0TR387500AA	TR, CHIP 2SC3875S(ALY) KEC
Q104	0TR150400BA	TR, CHIP 2SA1504S(ASY) KEC
Q111	0TR387500AA	TR, CHIP 2SC3875S(ALY) KEC
Q112	0TR387500AA	TR, CHIP 2SC3875S(ALY) KEC
Q200	0TR387500AA	TR, CHIP 2SC3875S(ALY) KEC
Q201	0TR387500AA	TR, CHIP 2SC3875S(ALY) KEC
Q202	0TR387500AA	TR, CHIP 2SC3875S(ALY) KEC
Q203	0TR387500AA	TR, CHIP 2SC3875S(ALY) KEC
Q204	0TR387500AA	TR, CHIP 2SC3875S(ALY) KEC
Q205	0TR387500AA	TR, CHIP 2SC3875S(ALY) KEC
Q206	0TR387500AA	TR, CHIP 2SC3875S(ALY) KEC
Q207	0TR387500AA	TR, CHIP 2SC3875S(ALY) KEC
Q208	0TR387500AA	TR, CHIP 2SC3875S(ALY) KEC
Q209	0TR387500AA	TR, CHIP 2SC3875S(ALY) KEC
Q210	0TR387500AA	TR, CHIP 2SC3875S(ALY) KEC
Q211	0TR387500AA	TR, CHIP 2SC3875S(ALY) KEC
Q212	0TR387500AA	TR, CHIP 2SC3875S(ALY) KEC
Q213	0TR387500AA	TR, CHIP 2SC3875S(ALY) KEC

For Capacitor & Resistors, the characters at 2nd and 3rd digit in the P/No. means as follows;	CC, CX, CK, CN : Ceramic	RD : Carbon Film
	CQ : Polyester	RS : Metal Oxide Film
	CE : Electrolytic	RN : Metal Film
		RF : Fusible

LOCA. NO	PART NO	DESCRIPTION
Q214	0TR387500AA	TR, CHIP 2SC3875S(ALY) KEC
Q215	0TR387500AA	TR, CHIP 2SC3875S(ALY) KEC
Q216	0TR387500AA	TR, CHIP 2SC3875S(ALY) KEC
Q217	0TR387500AA	TR, CHIP 2SC3875S(ALY) KEC
Q218	0TR387500AA	TR, CHIP 2SC3875S(ALY) KEC
Q219	0TR387500AA	TR, CHIP 2SC3875S(ALY) KEC
Q220	0TR387500AA	TR, CHIP 2SC3875S(ALY) KEC
Q221	0TR387500AA	TR, CHIP 2SC3875S(ALY) KEC
Q230	0TR387500AA	TR, CHIP 2SC3875S(ALY) KEC
Q231	0TR387500AA	TR, CHIP 2SC3875S(ALY) KEC
Q232	0TR150400BA	TR, CHIP 2SA1504S(ASY) KEC
Q233	0TR387500AA	TR, CHIP 2SC3875S(ALY) KEC
Q270	0TR150400BA	TR, CHIP 2SA1504S(ASY) KEC
Q271	0TR150400BA	TR, CHIP 2SA1504S(ASY) KEC
Q272	0TR150400BA	TR, CHIP 2SA1504S(ASY) KEC
Q401	0TR387500AA	TR, CHIP 2SC3875S(ALY) KEC
Q403	0TR387500AA	TR, CHIP 2SC3875S(ALY) KEC
Q404	0TR387500AA	TR, CHIP 2SC3875S(ALY) KEC
Q404	0TR387500AA	TR, CHIP 2SC3875S(ALY) KEC
Q404	0TR387500AA	TR, CHIP 2SC3875S(ALY) KEC
Q405	0TR387500AA	TR, CHIP 2SC3875S(ALY) KEC
Q406	0TR387500AA	TR, CHIP 2SC3875S(ALY) KEC
Q407	0TR150400BA	TR, CHIP 2SA1504S(ASY) KEC
Q408	0TR387500AA	TR, CHIP 2SC3875S(ALY) KEC
Q409	0TR150400BA	TR, CHIP 2SA1504S(ASY) KEC
Q410	0TR150400BA	TR, CHIP 2SA1504S(ASY) KEC
Q411	0TR150400BA	TR, CHIP 2SA1504S(ASY) KEC
Q474	0TR387500AA	TR, CHIP 2SC3875S(ALY) KEC
Q475	0TR387500AA	TR, CHIP 2SC3875S(ALY) KEC
Q476	0TR150400BA	TR, CHIP 2SA1504S(ASY) KEC
Q477	0TR387500AA	TR, CHIP 2SC3875S(ALY) KEC
Q478	0TR104009AF	TR, CHIP KRC104S SOT-23 TP KEC
Q601	0TR387500AA	TR, CHIP 2SC3875S(ALY) KEC
Q602	0TR387500AA	TR, CHIP 2SC3875S(ALY) KEC
Q603	0TR387500AA	TR, CHIP 2SC3875S(ALY) KEC
Q604	0TR387500AA	TR, CHIP 2SC3875S(ALY) KEC
Q605	0TR387500AA	TR, CHIP 2SC3875S(ALY) KEC
Q700	0TR387500AA	TR, CHIP 2SC3875S(ALY) KEC
Q720	0TR387500AA	TR, CHIP 2SC3875S(ALY) KEC
Q721	0TR387500AA	TR, CHIP 2SC3875S(ALY) KEC
Q722	0TR387500AA	TR, CHIP 2SC3875S(ALY) KEC
Q723	0TR150400BA	TR, CHIP 2SA1504S(ASY) KEC
Q724	0TR387500AA	TR, CHIP 2SC3875S(ALY) KEC
Q901	0TR387500AA	TR, CHIP 2SC3875S(ALY) KEC
Q902	0TR387500AA	TR, CHIP 2SC3875S(ALY) KEC
Q903	0TR387500AA	TR, CHIP 2SC3875S(ALY) KEC
Q904	0TR387500AA	TR, CHIP 2SC3875S(ALY) KEC
Q905	0TR387500AA	TR, CHIP 2SC3875S(ALY) KEC
Q906	0TR387500AA	TR, CHIP 2SC3875S(ALY) KEC
Q907	0TR387500AA	TR, CHIP 2SC3875S(ALY) KEC
Q908	0TR387500AA	TR, CHIP 2SC3875S(ALY) KEC
Q909	0TR387500AA	TR, CHIP 2SC3875S(ALY) KEC

LOCA. NO	PART NO	DESCRIPTION
CAPACITOR		
C001	0CE476DF618	47UF STD 16V M FL TP5
C002	0CE476DF618	47UF STD 16V M FL TP5
C003	0CE476SF6DC	47UF MVG 16V M SMD R/TP
C005	0CE107SF6DC	100UF MVG 16V M SMD R/TP
C006	0CE476DF618	47UF STD 16V M FL TP5
C006	0CE476SF6DC	47UF MVG 16V M SMD R/TP
C007	0CE476DF618	47UF STD 16V M FL TP5
C007	0CE106SF6DC	10UF MVG 16V 20% R/TP(SMD) SMD
C008	0CE476SF6DC	47UF MVG 16V M SMD R/TP
C009	0CE105BK618	1UF KME 50V M FL TP5
C010	0CE227VF6DC	220UF MV 16V 20% R/TP(SMD) SMD
C012	0CE107SF6DC	100UF MVG 16V M SMD R/TP
C013	0CE476SF6DC	47UF MVG 16V M SMD R/TP
C014	0CE476DF618	47UF STD 16V M FL TP5
C014	0CE476SF6DC	47UF MVG 16V M SMD R/TP
C014	0CE106SF6DC	10UF MVG 16V 20% R/TP(SMD) SMD
C015	0CE476SF6DC	47UF MVG 16V M SMD R/TP
C015	0CE106SF6DC	10UF MVG 16V 20% R/TP(SMD) SMD
C017	0CE107SF6DC	100UF MVG 16V M SMD R/TP
C018	0CE474SK6DC	0.47UF MVG 50V M SMD R/TP
C019	0CE474SK6DC	0.47UF MVG 50V M SMD R/TP
C019	0CE476SF6DC	47UF MVG 16V M SMD R/TP
C020	0CE105SK6DC	1UF MVG 50V M SMD R/TP
C020	0CE335SK6DC	3.3UF MVG 50V 20% SMD R/TP
C021	0CE107DF618	100UF STD 16V M FL TP5
C021	0CE106SF6DC	10UF MVG 16V 20% R/TP(SMD) SMD
C022	0CE105SK6DC	1UF MVG 50V M SMD R/TP
C022	0CE474SK6DC	0.47UF MVG 50V M SMD R/TP
C023	0CE105SK6DC	1UF MVG 50V M SMD R/TP
C023	0CE474SK6DC	0.47UF MVG 50V M SMD R/TP
C024	0CE105SK6DC	1UF MVG 50V M SMD R/TP
C024	0CE474SK6DC	0.47UF MVG 50V M SMD R/TP
C025	0CE476DF618	47UF STD 16V M FL TP5
C025	0CE105SK6DC	1UF MVG 50V M SMD R/TP
C025	0CE474SK6DC	0.47UF MVG 50V M SMD R/TP
C026	0CE105SK6DC	1UF MVG 50V M SMD R/TP
C027	0CE476DF618	47UF STD 16V M FL TP5
C029	0CE107SF6DC	100UF MVG 16V M SMD R/TP
C030	0CE476DF618	47UF STD 16V M FL TP5
C030	0CE105SK6DC	1UF MVG 50V M SMD R/TP
C030	0CE107SF6DC	100UF MVG 16V M SMD R/TP
C031	0CE105SK6DC	1UF MVG 50V M SMD R/TP
C033	0CE107DF618	100UF STD 16V M FL TP5
C034	0CE476SF6DC	47UF MVG 16V M SMD R/TP
C035	0CE105SK6DC	1UF MVG 50V M SMD R/TP
C038	0CE476SF6DC	47UF MVG 16V M SMD R/TP
C039	0CE105SK6DC	1UF MVG 50V M SMD R/TP
C040	0CE227VF6DC	220UF MV 16V 20% R/TP(SMD) SMD
C041	0CE477DK618	470UF STD 50V 20% FL TP 5
C042	0CE476SF6DC	47UF MVG 16V M SMD R/TP

For Capacitor & Resistors, the characters at 2nd and 3rd digit in the P/No. means as follows;	CC, CX, CK, CN : Ceramic CQ : Polyester CE : Electrolytic	RD : Carbon Film RS : Metal Oxide Film RN : Metal Film RF : Fusible
--	---	--

LOCA. NO	PART NO	DESCRIPTION
C042	0CE477DK618	470UF STD 50V 20% FL TP 5
C043	0CE476SF6DC	47UF MVG 16V M SMD R/TP
C044	0CE107DH618	100UF STD 25V M FL TP5
C045	0CE476SF6DC	47UF MVG 16V M SMD R/TP
C045	0CE106SF6DC	10UF MVG 16V 20% R/TP(SMD) SMD
C046	0CQ1521N509	0.0015U 100V K POLY TP
C047	0CE107DH618	100UF STD 25V M FL TP5
C047	0CE476SF6DC	47UF MVG 16V M SMD R/TP
C048	0CQ1521N509	0.0015U 100V K POLY TP
C050	0CE476SF6DC	47UF MVG 16V M SMD R/TP
C053	0CE106SF6DC	10UF MVG 16V 20% R/TP(SMD) SMD
C056	0CE107DH618	100UF STD 25V M FL TP5
C057	0CQ1041N509	0.1U 100V K POLY TP
C058	0CE106SF6DC	10UF MVG 16V 20% R/TP(SMD) SMD
C059	0CQ1041N509	0.1U 100V K POLY TP
C090	0CE474SK6DC	0.47UF MVG 50V M SMD R/TP
C091	0CE474SK6DC	0.47UF MVG 50V M SMD R/TP
C092	0CE476SF6DC	47UF MVG 16V M SMD R/TP
C101	0CE4756F618	4.7UF SMS,SG 16V 20% FL TP 5
C105	0CE107DF618	100UF STD 16V M FL TP5
C106	0CE106DK618	10UF STD 50V M FL TP5
C107	0CE107DF618	100UF STD 16V M FL TP5
C109	0CE476DF618	47UF STD 16V M FL TP5
C109	0CE476SF6DC	47UF MVG 16V M SMD R/TP
C110	0CE476SF6DC	47UF MVG 16V M SMD R/TP
C1102	0CE106SF6DC	10UF MVG 16V 20% R/TP(SMD) SMD
C1106	0CE227VF6DC	220UF MV 16V 20% R/TP(SMD) SMD
C1107	0CE105SK6DC	1UF MVG 50V M SMD R/TP
C1108	0CE105SK6DC	1UF MVG 50V M SMD R/TP
C111	0CE476SF6DC	47UF MVG 16V M SMD R/TP
C112	0CE107SF6DC	100UF MVG 16V M SMD R/TP
C113	0CE107SF6DC	100UF MVG 16V M SMD R/TP
C114	0CE107SF6DC	100UF MVG 16V M SMD R/TP
C117	0CE107SF6DC	100UF MVG 16V M SMD R/TP
C119	0CE477VF6DC	470UF MV 16V 20% R/TP(SMD) SMD
C121	0CE477VF6DC	470UF MV 16V 20% R/TP(SMD) SMD
C123	0CE477VF6DC	470UF MV 16V 20% R/TP(SMD) SMD
C126	0CE476SF6DC	47UF MVG 16V M SMD R/TP
C127	0CE476SF6DC	47UF MVG 16V M SMD R/TP
C211	0CE476SF6DC	47UF MVG 16V M SMD R/TP
C216	0CE476SF6DC	47UF MVG 16V M SMD R/TP
C221	0CE476SF6DC	47UF MVG 16V M SMD R/TP
C273	0CE107SF6DC	100UF MVG 16V M SMD R/TP
C277	0CE476SF6DC	47UF MVG 16V M SMD R/TP
C292	0CE105SK6DC	1UF MVG 50V M SMD R/TP
C294	0CE107SF6DC	100UF MVG 16V M SMD R/TP
C295	0CE107SF6DC	100UF MVG 16V M SMD R/TP
C300	0CE107SF6DC	100UF MVG 16V M SMD R/TP
C310	0CE106SF6DC	10UF MVG 16V 20% R/TP(SMD) SMD
C312	0CN105EJ56A	1.0UF 3216 35V 10% R/TP X7R
C313	0CE476DF618	47UF STD 16V M FL TP5
C314	0CE106SF6DC	10UF MVG 16V 20% R/TP(SMD) SMD

LOCA. NO	PART NO	DESCRIPTION
C387	0CK224DF56A	220000PF 2012 16V 10% R/TP X7R
C388	0CK224DF56A	220000PF 2012 16V 10% R/TP X7R
C389	0CK224DF56A	220000PF 2012 16V 10% R/TP X7R
C390	0CE476SF6DC	47UF MVG 16V M SMD R/TP
C396	0CE476SF6DC	47UF MVG 16V M SMD R/TP
C401	0CE476SF6DC	47UF MVG 16V M SMD R/TP
C402	0CE106DK618	10UF STD 50V M FL TP5
C408	0CE477DF618	470UF STD 16V 20% FL TP 5
C412	0CE475DK618	4.7UF STD 50V 20% FL TP 5
C415	0CE475DK618	4.7UF STD 50V 20% FL TP 5
C416	0CE106SF6DC	10UF MVG 16V 20% R/TP(SMD) SMD
C417	0CE107SF6DC	100UF MVG 16V M SMD R/TP
C419	0CK224DF56A	220000PF 2012 16V 10% R/TP X7R
C433	0CK224DF56A	220000PF 2012 16V 10% R/TP X7R
C434	0CE106SF6DC	10UF MVG 16V 20% R/TP(SMD) SMD
C436	0CK224DF56A	220000PF 2012 16V 10% R/TP X7R
C437	0CK224DF56A	220000PF 2012 16V 10% R/TP X7R
C438	0CK224DF56A	220000PF 2012 16V 10% R/TP X7R
C442	0CK224DF56A	220000PF 2012 16V 10% R/TP X7R
C443	0CK224DF56A	220000PF 2012 16V 10% R/TP X7R
C444	0CK224DF56A	220000PF 2012 16V 10% R/TP X7R
C446	0CE106DF618	10UF STD 16V M FL TP5
C447	0CK224DF56A	220000PF 2012 16V 10% R/TP X7R
C450	0CE227DF618	220UF STD 16V M FL TP5
C452	0CE227DF618	220UF STD 16V M FL TP5
C453	0CE475DK618	4.7UF STD 50V 20% FL TP 5
C456	0CE227DF618	220UF STD 16V M FL TP5
C456	0CE106SF6DC	10UF MVG 16V 20% R/TP(SMD) SMD
C479	0CE106SF6DC	10UF MVG 16V 20% R/TP(SMD) SMD
C485	0CE107SF6DC	100UF MVG 16V M SMD R/TP
C488	0CE106SF6DC	10UF MVG 16V 20% R/TP(SMD) SMD
C489	0CK224DF56A	220000PF 2012 16V 10% R/TP X7R
C491	0CE106SF6DC	10UF MVG 16V 20% R/TP(SMD) SMD
C494	0CK224DF56A	220000PF 2012 16V 10% R/TP X7R
C501	0CE107DF618	100UF STD 16V M FL TP5
C502	0CK224DF56A	220000PF 2012 16V 10% R/TP X7R
C503	0CK224DF56A	220000PF 2012 16V 10% R/TP X7R
C504	0CK224DF56A	220000PF 2012 16V 10% R/TP X7R
C510	0CK224DF56A	220000PF 2012 16V 10% R/TP X7R
C523	0CN105EJ56A	1.0UF 3216 35V 10% R/TP X7R
C524	0CE106SF6DC	10UF MVG 16V 20% R/TP(SMD) SMD
C532	0CE227DF618	220UF STD 16V M FL TP5
C602	0CE107DF618	100UF STD 16V M FL TP5
C603	0CE107DF618	100UF STD 16V M FL TP5
C605	0CE106DF618	10UF STD 16V M FL TP5
C611	0CE107DF618	100UF STD 16V M FL TP5
C612	0CE107DF618	100UF STD 16V M FL TP5
C619	0CE107DF618	100UF STD 16V M FL TP5
C621	0CE107DF618	100UF STD 16V M FL TP5
C623	0CE106DF618	10UF STD 16V M FL TP5
C630	0CE106DF618	10UF STD 16V M FL TP5
C634	0CE107DF618	100UF STD 16V M FL TP5

For Capacitor & Resistors, the characters at 2nd and 3rd digit in the P/No. means as follows;	CC, CX, CK, CN : Ceramic CQ : Polyester CE : Electrolytic	RD : Carbon Film RS : Metal Oxide Film RN : Metal Film RF : Fusible
--	---	--

LOCA. NO	PART NO	DESCRIPTION
C639	0CE107DF618	100UF STD 16V M FL TP5
C671	0CE477DK618	470UF STD 50V 20% FL TP 5
C672	0CE477DK618	470UF STD 50V 20% FL TP 5
C673	0CE477DK618	470UF STD 50V 20% FL TP 5
C674	0CE477DK618	470UF STD 50V 20% FL TP 5
C675	181-120K	2200PF 4KV M E FMTW LEAD 4.5
C676	181-120K	2200PF 4KV M E FMTW LEAD 4.5
C710	0CE107DF618	100UF STD 16V M FL TP5
C714	0CE106DK618	10UF STD 50V M FL TP5
C724	0CE105SK6DC	1UF MVG 50V M SMD R/TP
C758	0CE107DF618	100UF STD 16V M FL TP5
C759	0CE107DF618	100UF STD 16V M FL TP5
C760	0CE477VF6DC	470UF MV 16V 20% R/TP(SMD) SMD
C765	0CE477VF6DC	470UF MV 16V 20% R/TP(SMD) SMD
C766	0CE477VF6DC	470UF MV 16V 20% R/TP(SMD) SMD
C769	0CE107SF6DC	100UF MVG 16V M SMD R/TP
C772	0CE107SF6DC	100UF MVG 16V M SMD R/TP
C785	0CE476SF6DC	47UF MVG 16V M SMD R/TP
C787	0CE107SF6DC	100UF MVG 16V M SMD R/TP
C788	0CE476SF6DC	47UF MVG 16V M SMD R/TP
C789	0CE476SF6DC	47UF MVG 16V M SMD R/TP
C791	0CE227VF6DC	220UF MV 16V 20% R/TP(SMD) SMD
C793	0CE227VF6DC	220UF MV 16V 20% R/TP(SMD) SMD
C801	0CE107DF618	100UF STD 16V M FL TP5
C804	0CE477DF618	470UF STD 16V 20% FL TP 5
C805	0CK224DF56A	220000PF 2012 16V 10% R/TP X7R
C806	0CE477DF618	470UF STD 16V 20% FL TP 5
C808	0CE107DF618	100UF STD 16V M FL TP5
C810	0CE476SF6DC	47UF MVG 16V M SMD R/TP
C813	0CE106DF618	10UF STD 16V M FL TP5
C816	0CE477DF618	470UF STD 16V 20% FL TP 5
C817	0CE107DF618	100UF STD 16V M FL TP5
C820	0CE227VF6DC	220UF MV 16V 20% R/TP(SMD) SMD
C821	0CE477DF618	470UF STD 16V 20% FL TP 5
C824	0CE477DF618	470UF STD 16V 20% FL TP 5
C824	0CE477VF6DC	470UF MV 16V 20% R/TP(SMD) SMD
C826	0CE107SF6DC	100UF MVG 16V M SMD R/TP
C828	0CE477DF618	470UF STD 16V 20% FL TP 5
C828	0CE107SF6DC	100UF MVG 16V M SMD R/TP
C831	0CE106DF618	10UF STD 16V M FL TP5
C833	0CE476SF6DC	47UF MVG 16V M SMD R/TP
C834	0CK224DF56A	220000PF 2012 16V 10% R/TP X7R
C835	0CE107DF618	100UF STD 16V M FL TP5
C839	0CN105EJ56A	1.0UF 3216 35V 10% R/TP X7R
C881	0CE107SF6DC	100UF MVG 16V M SMD R/TP
C884	0CE107SF6DC	100UF MVG 16V M SMD R/TP
C887	0CE107SF6DC	100UF MVG 16V M SMD R/TP
C890	0CE476SF6DC	47UF MVG 16V M SMD R/TP
C893	0CE107SF6DC	100UF MVG 16V M SMD R/TP
C912	0CE476SF6DC	47UF MVG 16V M SMD R/TP
C913	0CE107SF6DC	100UF MVG 16V M SMD R/TP
C914	0CE107SF6DC	100UF MVG 16V M SMD R/TP

LOCA. NO	PART NO	DESCRIPTION
C915	0CE107SF6DC	100UF MVG 16V M SMD R/TP
C949	0CE477VF6DC	470UF MV 16V 20% R/TP(SMD) SMD
C951	0CE477VF6DC	470UF MV 16V 20% R/TP(SMD) SMD
C964	0CE476SF6DC	47UF MVG 16V M SMD R/TP
C965	0CE476SF6DC	47UF MVG 16V M SMD R/TP
C966	0CE107SF6DC	100UF MVG 16V M SMD R/TP
C967	0CE107SF6DC	100UF MVG 16V M SMD R/TP
C968	0CE227VF6DC	220UF MV 16V 20% R/TP(SMD) SMD
C969	0CE227VF6DC	220UF MV 16V 20% R/TP(SMD) SMD
C971	0CE477VF6DC	470UF MV 16V 20% R/TP(SMD) SMD
C973	0CE477VF6DC	470UF MV 16V 20% R/TP(SMD) SMD
C980	0CE107SF6DC	100UF MVG 16V M SMD R/TP
C981	0CE107SF6DC	100UF MVG 16V M SMD R/TP
C982	0CE476SF6DC	47UF MVG 16V M SMD R/TP
C984	0CE227VF6DC	220UF MV 16V 20% R/TP(SMD) SMD
C986	0CE227VF6DC	220UF MV 16V 20% R/TP(SMD) SMD
C993	0CE476SF6DC	47UF MVG 16V M SMD R/TP
C994	0CE107SF6DC	100UF MVG 16V M SMD R/TP
C995	0CE476SF6DC	47UF MVG 16V M SMD R/TP

COIL & INDUCTOR

L001	0LC1032101A	INDUCTOR, 10UH 10% 3216 R/TC FI-C3216-103KJT
L200	0LC0233002A	INDUCTOR, 3.3UH CERATECH R/TP
L400	0LC0233002A	INDUCTOR, 3.3UH CERATECH R/TP
L400	0LC1032101A	INDUCTOR,CHIP 10UH 10% 3216 R/TC FI-C3216-103KJT
L401	0LC0233002A	INDUCTOR, 3.3UH CERATECH R/TP
L401	0LC1032101A	INDUCTOR,10UH 10% 3216 R/TC FI-C3216-103KJT
L402	0LC0233002A	INDUCTOR, 3.3UH CERATECH R/TP
L402	0LC1032101A	INDUCTOR, 10UH 10% 3216 R/TC FI-C3216-103KJT
L403	0LC0233002A	INDUCTOR, 3.3UH CERATECH R/TP
L403	0LC1032101A	INDUCTOR,10UH 10% 3216 R/TC FI-C3216-103KJT
L404	0LC0233002A	INDUCTOR, 3.3UH CERATECH R/TP
L404	0LC1032101A	INDUCTOR,10UH 10% 3216 R/TC FI-C3216-103KJT
L405	0LC0233002A	INDUCTOR, 3.3UH CERATECH R/TP
L406	0LC0233002A	INDUCTOR, 3.3UH CERATECH R/TP
L470	0LC0233002A	INDUCTOR, 3.3UH CERATECH R/TP
L471	0LC0233002A	INDUCTOR, 3.3UH CERATECH R/TP
L472	0LC0233002A	INDUCTOR, 3.3UH CERATECH R/TP
L473	0LC0233002A	INDUCTOR, 3.3UH CERATECH R/TP
L474	0LC0233002A	INDUCTOR, 3.3UH CERATECH R/TP
L801	6140VR0001C	COIL,ENERGY RECOVERY SB1260-470 GET 47UH
L802	6140VR0001C	COIL,ENERGY RECOVERY SB1260-470 GET 47UH
L803	6140VR0001C	COIL,ENERGY RECOVERY SB1260-470 GET 47UH
L870	6140VB0004B	COIL,CHOKE 26UH 1UEWPHY 22.5TURN YL-9N 0.4
L886	6140VB0004B	COIL,CHOKE 26UH 1UEWPHY 22.5TURN YL-9N 0.4
T801	6170VMCA57A	TRANSFORMER,JEPC1716 650UH +-15%, DC-DC CON

JACK

JP1	6612VLH002A	JACK, SP026B PARK ELEC 4P RD/BK/BK/RD
P002	6612VAH001A	JACK, DC (7) BK LN-15A1(NF-99LA)
P101	6612JH003CA	JACK, PPJ137A PARK ELEC. AUDIO L-MONO JACK
P102	380-068E	JACK, UEJ-CV-018 UGCOM D3.5 E/P JACK W/SHIELD

For Capacitor & Resistors, the characters at 2nd and 3rd digit in the P/No. means as follows;	CC, CX, CK, CN : Ceramic CQ : Polyester CE : Electrolytic	RD : Carbon Film RS : Metal Oxide Film RN : Metal Film RF : Fusible
--	---	--

LOCA. NO	PART NO	DESCRIPTION
P102	6612J00010A	JACK, A/V 2P MONO GN-BL-RD W/O S/W COMPONENT
P103	380-363K	JACK, H=8.0 W/O S/W,W/SHIELD,W/O BOSS
P103	6612BBBH6A	JACK, 440062-1 AMP DVI INTERACED RIGHT ANGLE
P104	6612VMV002A	JACK, UCT-EX-020 UGCOM BNC MONO
P104	6612J00010B	JACK, PPJ128A-2 PARKELEC A/V 3P WITH S/W RD-WH-YL
P105	6612JH003CA	JACK, PPJ137A PARK ELEC. AUDIO L-MONO JACK
P105	6612J00010B	JACK, PPJ128A-2 PARKELEC A/V 3P WITH S/W RD-WH-YL
P106	380-068E	JACK, UEJ-CV-018 UGCOM D3.5 E/P JACK W/SHIELD

CONNECTOR

P001	6630V601236	CONNECTOR, MDR-36 FEMALE UNIXSTAR 36PIN 2.54MM
P001A	366-921J	CONNECTOR, 2.5MM 10P GIL-G LG CABLE .
P001B	366-921J	CONNECTOR, 2.5MM 10P GIL-G LG CABLE .
P002A	366-921K	CONNECTOR, 2.5MM 11P GIL-G LG CABLE .
P002B	366-921K	CONNECTOR, 2.5MM 11P GIL-G LG CABLE .
P005A	366-921L	CONNECTOR, 2.5MM 12P GIL-G LG CABLE .
P005B	366-921L	CONNECTOR, 2.5MM 12P GIL-G LG CABLE .
P006	366-921F	CONNECTOR, 2.5MM 7P GIL-G LG CABLE .
P007	366-921E	CONNECTOR, 2.5MM 6P GIL-G LG CABLE .
P036	6630V601236	CONNECTOR, MDR-36 FEMALE UNIXSTAR 36PIN 2.54MM
P100A	6630VL01380	CONNECTOR, 2-557101-1 AMP 80P 2.54MM RECEPTACLE
P101	6630VGA001C	CONNECTOR, 15PIN 2.29MM ANGLE SN
P101A	6630VL04008	CONNECTOR, - AMP 8P 2.5MM 0-0171825-8
P102A	366-932C	CONNECTOR, 2.5MM 4P GIL-G LG CABLE S (STICK)
P104	6630VGA001C	CONNECTOR, 15PIN 2.29MM ANGLE SN
P109B	366-922E	CONNECTOR, 2.5MM 6P GIL-G LG CABLE R/A (B TO C)
P110B	366-921F	CONNECTOR, 2.5MM 7P GIL-G LG CABLE .
P111A	366-932D	CONNECTOR, 2.5MM 5P GIL-G LG CABLE S (STICK)
P600	6602T11001A	CONNECTOR, FI-TWE21P-VF JAE 21P 1.25MM S/T
P741	6630VGA004B	CONNECTOR, 9P 2.77MM FORK LOCK ANGLE GOLD
P800	6602V25009L	CONNECTOR, 2.5MM 12P 1-171825-2 AMP MN-42PZ10
P801	6602V25009F	CONNECTOR, 2.5MM 7P 0-171825-7 AMP MN-42PZ10
P801	6602V39003A	CONNECTOR, 3.96MM 3P 2-178496-1 AMP MN-42PZ10
P802	366-932B	CONNECTOR, 2.5MM 3P GIL-G LG CABLE S (STICK)
P802	6602V39003A	CONNECTOR, 3.96MM 3P 2-178496-1 AMP MN-42PZ10
P803	366-932B	CONNECTOR, 2.5MM 3P GIL-G LG CABLE S (STICK)

RESISTOR

A692	0RRZVTA001D	22 OHM 1 / 16 W 1608 5% R/TP 4P E24 SERIES HN-61A40R
AR260	0RRZVTA001D	22 OHM 1 / 16 W 1608 5% R/TP 4P E24 SERIES HN-61A40R
AR261	0RRZVTA001D	22 OHM 1 / 16 W 1608 5% R/TP 4P E24 SERIES HN-61A40R
AR262	0RRZVTA001D	22 OHM 1 / 16 W 1608 5% R/TP 4P E24 SERIES HN-61A40R
AR263	0RRZVTA001D	22 OHM 1 / 16 W 1608 5% R/TP 4P E24 SERIES HN-61A40R
AR264	0RRZVTA001D	22 OHM 1 / 16 W 1608 5% R/TP 4P E24 SERIES HN-61A40R
AR265	0RRZVTA001D	22 OHM 1 / 16 W 1608 5% R/TP 4P E24 SERIES HN-61A40R
AR266	0RRZVTA001D	22 OHM 1 / 16 W 1608 5% R/TP 4P E24 SERIES HN-61A40R
AR267	0RRZVTA001D	22 OHM 1 / 16 W 1608 5% R/TP 4P E24 SERIES HN-61A40R
AR268	0RRZVTA001D	22 OHM 1 / 16 W 1608 5% R/TP 4P E24 SERIES HN-61A40R
AR269	0RRZVTA001D	22 OHM 1 / 16 W 1608 5% R/TP 4P E24 SERIES HN-61A40R
AR270	0RRZVTA001D	22 OHM 1 / 16 W 1608 5% R/TP 4P E24 SERIES HN-61A40R
AR271	0RRZVTA001D	22 OHM 1 / 16 W 1608 5% R/TP 4P E24 SERIES HN-61A40R
AR330	0RRZVTA001D	22 OHM 1 / 16 W 1608 5% R/TP 4P E24 SERIES HN-61A40R

LOCA. NO	PART NO	DESCRIPTION
AR332	0RRZVTA001D	22 OHM 1 / 16 W 1608 5% R/TP 4P E24 SERIES HN-61A40R
AR333	0RRZVTA001D	22 OHM 1 / 16 W 1608 5% R/TP 4P E24 SERIES HN-61A40R
AR334	0RRZVTA001D	22 OHM 1 / 16 W 1608 5% R/TP 4P E24 SERIES HN-61A40R
AR335	0RRZVTA001D	22 OHM 1 / 16 W 1608 5% R/TP 4P E24 SERIES HN-61A40R
AR336	0RRZVTA001D	22 OHM 1 / 16 W 1608 5% R/TP 4P E24 SERIES HN-61A40R
AR337	0RRZVTA001D	22 OHM 1 / 16 W 1608 5% R/TP 4P E24 SERIES HN-61A40R
AR338	0RRZVTA001D	22 OHM 1 / 16 W 1608 5% R/TP 4P E24 SERIES HN-61A40R
AR339	0RRZVTA001D	22 OHM 1 / 16 W 1608 5% R/TP 4P E24 SERIES HN-61A40R
AR340	0RRZVTA001D	22 OHM 1 / 16 W 1608 5% R/TP 4P E24 SERIES HN-61A40R
AR341	0RRZVTA001D	22 OHM 1 / 16 W 1608 5% R/TP 4P E24 SERIES HN-61A40R
AR342	0RRZVTA001D	22 OHM 1 / 16 W 1608 5% R/TP 4P E24 SERIES HN-61A40R
AR400	0RRZVTA001D	22 OHM 1 / 16 W 1608 5% R/TP 4P E24 SERIES HN-61A40R
AR401	0RRZVTA001D	22 OHM 1 / 16 W 1608 5% R/TP 4P E24 SERIES HN-61A40R
AR402	0RRZVTA001D	22 OHM 1 / 16 W 1608 5% R/TP 4P E24 SERIES HN-61A40R
AR403	0RRZVTA001D	22 OHM 1 / 16 W 1608 5% R/TP 4P E24 SERIES HN-61A40R
AR404	0RRZVTA001D	22 OHM 1 / 16 W 1608 5% R/TP 4P E24 SERIES HN-61A40R
AR405	0RRZVTA001D	22 OHM 1 / 16 W 1608 5% R/TP 4P E24 SERIES HN-61A40R
AR406	0RRZVTA001D	22 OHM 1 / 16 W 1608 5% R/TP 4P E24 SERIES HN-61A40R
AR407	0RRZVTA001D	22 OHM 1 / 16 W 1608 5% R/TP 4P E24 SERIES HN-61A40R
AR460	0RRZVTA001D	22 OHM 1 / 16 W 1608 5% R/TP 4P E24 SERIES HN-61A40R
AR461	0RRZVTA001D	22 OHM 1 / 16 W 1608 5% R/TP 4P E24 SERIES HN-61A40R
AR462	0RRZVTA001D	22 OHM 1 / 16 W 1608 5% R/TP 4P E24 SERIES HN-61A40R
AR463	0RRZVTA001D	22 OHM 1 / 16 W 1608 5% R/TP 4P E24 SERIES HN-61A40R
AR465	0RRZVTA001D	22 OHM 1 / 16 W 1608 5% R/TP 4P E24 SERIES HN-61A40R
AR466	0RRZVTA001D	22 OHM 1 / 16 W 1608 5% R/TP 4P E24 SERIES HN-61A40R
AR467	0RRZVTA001D	22 OHM 1 / 16 W 1608 5% R/TP 4P E24 SERIES HN-61A40R
AR468	0RRZVTA001D	22 OHM 1 / 16 W 1608 5% R/TP 4P E24 SERIES HN-61A40R
AR469	0RRZVTA001D	22 OHM 1 / 16 W 1608 5% R/TP 4P E24 SERIES HN-61A40R
AR470	0RRZVTA001D	22 OHM 1 / 16 W 1608 5% R/TP 4P E24 SERIES HN-61A40R
AR471	0RRZVTA001D	22 OHM 1 / 16 W 1608 5% R/TP 4P E24 SERIES HN-61A40R
AR472	0RRZVTA001D	22 OHM 1 / 16 W 1608 5% R/TP 4P E24 SERIES HN-61A40R
AR473	0RRZVTA001D	22 OHM 1 / 16 W 1608 5% R/TP 4P E24 SERIES HN-61A40R
AR474	0RRZVTA001D	22 OHM 1 / 16 W 1608 5% R/TP 4P E24 SERIES HN-61A40R
AR475	0RRZVTA001D	22 OHM 1 / 16 W 1608 5% R/TP 4P E24 SERIES HN-61A40R
AR512	0RRZVTA001D	22 OHM 1 / 16 W 1608 5% R/TP 4P E24 SERIES HN-61A40R
AR513	0RRZVTA001D	22 OHM 1 / 16 W 1608 5% R/TP 4P E24 SERIES HN-61A40R
AR514	0RRZVTA001D	22 OHM 1 / 16 W 1608 5% R/TP 4P E24 SERIES HN-61A40R
AR515	0RRZVTA001D	22 OHM 1 / 16 W 1608 5% R/TP 4P E24 SERIES HN-61A40R
AR550	0RRZVTA001C	4.7K OHM 1 / 16 W 1608 5% R/TP 4P E24 SERIES HN-61A40R
AR551	0RRZVTA001C	4.7K OHM 1 / 16 W 1608 5% R/TP 4P E24 SERIES HN-61A40R
AR552	0RRZVTA001C	4.7K OHM 1 / 16 W 1608 5% R/TP 4P E24 SERIES HN-61A40R
AR553	0RRZVTA001C	4.7K OHM 1 / 16 W 1608 5% R/TP 4P E24 SERIES HN-61A40R
AR589	0RRZVTA001D	22 OHM 1 / 16 W 1608 5% R/TP 4P E24 SERIES HN-61A40R
AR590	0RRZVTA001D	22 OHM 1 / 16 W 1608 5% R/TP 4P E24 SERIES HN-61A40R
AR677	0RRZVTA001D	22 OHM 1 / 16 W 1608 5% R/TP 4P E24 SERIES HN-61A40R
AR678	0RRZVTA001D	22 OHM 1 / 16 W 1608 5% R/TP 4P E24 SERIES HN-61A40R
AR679	0RRZVTA001D	22 OHM 1 / 16 W 1608 5% R/TP 4P E24 SERIES HN-61A40R
AR680	0RRZVTA001D	22 OHM 1 / 16 W 1608 5% R/TP 4P E24 SERIES HN-61A40R
AR681	0RRZVTA001D	22 OHM 1 / 16 W 1608 5% R/TP 4P E24 SERIES HN-61A40R
AR682	0RRZVTA001D	22 OHM 1 / 16 W 1608 5% R/TP 4P E24 SERIES HN-61A40R
AR691	0RRZVTA001D	22 OHM 1 / 16 W 1608 5% R/TP 4P E24 SERIES HN-61A40R
AR693	0RRZVTA001D	22 OHM 1 / 16 W 1608 5% R/TP 4P E24 SERIES HN-61A40R

For Capacitor & Resistors, the characters at 2nd and 3rd digit in the P/No. means as follows;	CC, CX, CK, CN : Ceramic	RD : Carbon Film
	CQ : Polyester	RS : Metal Oxide Film
	CE : Electrolytic	RN : Metal Film
		RF : Fusible

LOCA. NO	PART NO	DESCRIPTION
AR694	0RRZVTA001D	22 OHM 1 / 16 W 1608 5% R/TP 4P E24 SERIES HN-61A40R
AR695	0RRZVTA001D	22 OHM 1 / 16 W 1608 5% R/TP 4P E24 SERIES HN-61A40R
AR696	0RRZVTA001D	22 OHM 1 / 16 W 1608 5% R/TP 4P E24 SERIES HN-61A40R
R020	0RS2701K607	2.7K OHM 2 W 5.00% TA62
R021	0RS2701K607	2.7K OHM 2 W 5.00% TA62
R030	0RS0221H609	2.2 OHM 1/2 W 5.00% TA52
R032	0RS0221H609	2.2 OHM 1/2 W 5.00% TA52
R1111	0RD0152H609	15 OHM 1/2 W 5.00% TA52
R655	0RD4700H609	470 OHM 1/2 W 5.00% TA52
R656	0RD4700H609	470 OHM 1/2 W 5.00% TA52
SWITCH		
SW001	140-315A	SWITCH, TACT SKHV17910B LG C&D NON 12V
SW002	140-315A	SWITCH, TACT SKHV17910B LG C&D NON 12V
SW003	140-315A	SWITCH, TACT SKHV17910B LG C&D NON 12V
SW004	140-315A	SWITCH, TACT SKHV17910B LG C&D NON 12V
SW005	140-315A	SWITCH, TACT SKHV17910B LG C&D NON 12V
SW006	140-315A	SWITCH, TACT SKHV17910B LG C&D NON 12V
SW102	140-275A	SWITCH, 30V 0.3A HORIZONTAL 500G
SW741	140-313B	SWITCH, TACT 2LEAD 160G(TA) LG C&D NON
SW800	6600VM2006A	SWITCH, 250V 4A HORIZONTAL .G
FILTER & CRYSTAL		
F601	6200VJS001A	FILTER, ZJY51R5-4P TDK DIP DC 50VOLT 2A
F602	6200VJS001B	FILTER, ZJYS51R5-2PL(T) TDK R/TP 50VOLT 2A
F603	6200VJS001B	FILTER, ZJYS51R5-2PL(T) TDK R/TP 50VOLT 2A
L001	6200JB8010L	FILTER, R/TP 1000OHM 350MA
L001	6210VC0006A	FILTER, FBMH3216 HM501NT 3.2X1.6X1.6MM R/TP
L001	6210VC0006A	FILTER, FBMH3216 HM501NT 3.2X1.6X1.6MM R/TP
L001	6210VC0006A	FILTER, FBMH3216 HM501NT 3.2X1.6X1.6MM R/TP
L002	6200JB8010L	FILTER, R/TP 1000OHM 350MA
L002	6210VC0006A	FILTER, FBMH3216 HM501NT 3.2X1.6X1.6MM R/TP
L003	6200JB8010L	FILTER, R/TP 1000OHM 350MA
L003	6210VC0006A	FILTER, FBMH3216 HM501NT 3.2X1.6X1.6MM R/TP
L004	6200JB8010L	FILTER, R/TP 1000OHM 350MA
L004	6210VC0006A	FILTER, FBMH3216 HM501NT 3.2X1.6X1.6MM R/TP
L005	6200JB8010L	FILTER, R/TP 1000OHM 350MA
L006	6200JB8010L	FILTER, R/TP 1000OHM 350MA
L007	6210VC0006A	FILTER, FBMH3216 HM501NT 3.2X1.6X1.6MM R/TP
L008	6210VC0006A	FILTER, FBMH3216 HM501NT 3.2X1.6X1.6MM R/TP
L009	6210VC0006A	FILTER, FBMH3216 HM501NT 3.2X1.6X1.6MM R/TP
L010	6210VC0006A	FILTER, FBMH3216 HM501NT 3.2X1.6X1.6MM R/TP
L010	6210VC0006A	FILTER, FBMH3216 HM501NT 3.2X1.6X1.6MM R/TP
L101	6210VC0006A	FILTER, FBMH3216 HM501NT 3.2X1.6X1.6MM R/TP
L102	6210VC0006A	FILTER, FBMH3216 HM501NT 3.2X1.6X1.6MM R/TP
L201	6210VC0006A	FILTER, FBMH3216 HM501NT 3.2X1.6X1.6MM R/TP
L205	6210VC0006A	FILTER, FBMH3216 HM501NT 3.2X1.6X1.6MM R/TP
L270	6210VC0006A	FILTER, FBMH3216 HM501NT 3.2X1.6X1.6MM R/TP
L271	6210VC0006A	FILTER, FBMH3216 HM501NT 3.2X1.6X1.6MM R/TP
L272	6210VC0006A	FILTER, FBMH3216 HM501NT 3.2X1.6X1.6MM R/TP
L273	6210VC0006A	FILTER, FBMH3216 HM501NT 3.2X1.6X1.6MM R/TP
L274	6210VC0005A	FILTER, BK2125 HS 750 2X1.25X0.85MM R/TP

LOCA. NO	PART NO	DESCRIPTION
L275	6210VC0005A	FILTER, BK2125 HS 750 2X1.25X0.85MM R/TP
L276	6210VC0005A	FILTER, BK2125 HS 750 2X1.25X0.85MM R/TP
L405	6210VC0006A	FILTER, FBMH3216 HM501NT 3.2X1.6X1.6MM R/TP
L501	6210VC0006A	FILTER, FBMH3216 HM501NT 3.2X1.6X1.6MM R/TP
L601	6210VC0006A	FILTER, FBMH3216 HM501NT 3.2X1.6X1.6MM R/TP
L602	6210VC0006A	FILTER, FBMH3216 HM501NT 3.2X1.6X1.6MM R/TP
L603	6210VC0006A	FILTER, FBMH3216 HM501NT 3.2X1.6X1.6MM R/TP
L604	6210VC0006A	FILTER, FBMH3216 HM501NT 3.2X1.6X1.6MM R/TP
L701	6210VC0006A	FILTER, FBMH3216 HM501NT 3.2X1.6X1.6MM R/TP
L708	6210VC0006A	FILTER, FBMH3216 HM501NT 3.2X1.6X1.6MM R/TP
L872	6210VC0006A	FILTER, FBMH3216 HM501NT 3.2X1.6X1.6MM R/TP
L873	6210VC0006A	FILTER, FBMH3216 HM501NT 3.2X1.6X1.6MM R/TP
L874	6210VC0006A	FILTER, FBMH3216 HM501NT 3.2X1.6X1.6MM R/TP
L875	6210VC0006A	FILTER, FBMH3216 HM501NT 3.2X1.6X1.6MM R/TP
L876	6210VC0006A	FILTER, FBMH3216 HM501NT 3.2X1.6X1.6MM R/TP
L877	6210VC0006A	FILTER, FBMH3216 HM501NT 3.2X1.6X1.6MM R/TP
L878	6210VC0006A	FILTER, FBMH3216 HM501NT 3.2X1.6X1.6MM R/TP
L879	6210VC0006A	FILTER, FBMH3216 HM501NT 3.2X1.6X1.6MM R/TP
L881	6210VC0006A	FILTER, FBMH3216 HM501NT 3.2X1.6X1.6MM R/TP
L882	6210VC0006A	FILTER, FBMH3216 HM501NT 3.2X1.6X1.6MM R/TP
L883	6210VC0006A	FILTER, FBMH3216 HM501NT 3.2X1.6X1.6MM R/TP
L884	6210VC0006A	FILTER, FBMH3216 HM501NT 3.2X1.6X1.6MM R/TP
L887	6210VC0006A	FILTER, FBMH3216 HM501NT 3.2X1.6X1.6MM R/TP
L888	6210VC0006A	FILTER, FBMH3216 HM501NT 3.2X1.6X1.6MM R/TP
L889	6210VC0006A	FILTER, FBMH3216 HM501NT 3.2X1.6X1.6MM R/TP
L890	6210VC0006A	FILTER, FBMH3216 HM501NT 3.2X1.6X1.6MM R/TP
L891	6210VC0006A	FILTER, FBMH3216 HM501NT 3.2X1.6X1.6MM R/TP
L892	6210VC0006A	FILTER, FBMH3216 HM501NT 3.2X1.6X1.6MM R/TP
L900	6210VC0006A	FILTER, FBMH3216 HM501NT 3.2X1.6X1.6MM R/TP
L901	6210VC0006A	FILTER, FBMH3216 HM501NT 3.2X1.6X1.6MM R/TP
L901	6200JB8010U	FILTER, OR 14*7*7.5H SMC BK 6.0MH-11.0MH
L902	6210VC0006A	FILTER, FBMH3216 HM501NT 3.2X1.6X1.6MM R/TP
L903	6210VC0006A	FILTER, FBMH3216 HM501NT 3.2X1.6X1.6MM R/TP
L904	6210VC0006A	FILTER, FBMH3216 HM501NT 3.2X1.6X1.6MM R/TP
L905	6210VC0006A	FILTER, FBMH3216 HM501NT 3.2X1.6X1.6MM R/TP
L906	6210VC0006A	FILTER, FBMH3216 HM501NT 3.2X1.6X1.6MM R/TP
L907	6210VC0006A	FILTER, FBMH3216 HM501NT 3.2X1.6X1.6MM R/TP
L908	6210VC0006A	FILTER, FBMH3216 HM501NT 3.2X1.6X1.6MM R/TP
L909	6210VC0006A	FILTER, FBMH3216 HM501NT 3.2X1.6X1.6MM R/TP
L910	6210VC0006A	FILTER, FBMH3216 HM501NT 3.2X1.6X1.6MM R/TP
L911	6210VC0006A	FILTER, FBMH3216 HM501NT 3.2X1.6X1.6MM R/TP
L912	6210VC0006A	FILTER, FBMH3216 HM501NT 3.2X1.6X1.6MM R/TP
L913	6210VC0006A	FILTER, FBMH3216 HM501NT 3.2X1.6X1.6MM R/TP
L914	6210VC0006A	FILTER, FBMH3216 HM501NT 3.2X1.6X1.6MM R/TP
L915	6210VC0006A	FILTER, FBMH3216 HM501NT 3.2X1.6X1.6MM R/TP
L916	6210VC0006A	FILTER, FBMH3216 HM501NT 3.2X1.6X1.6MM R/TP
L917	6210VC0006A	FILTER, FBMH3216 HM501NT 3.2X1.6X1.6MM R/TP
L918	6210VC0006A	FILTER, FBMH3216 HM501NT 3.2X1.6X1.6MM R/TP
L919	6210VC0006A	FILTER, FBMH3216 HM501NT 3.2X1.6X1.6MM R/TP
L920	6210VC0006A	FILTER, FBMH3216 HM501NT 3.2X1.6X1.6MM R/TP
L921	6210VC0006A	FILTER, FBMH3216 HM501NT 3.2X1.6X1.6MM R/TP
L922	6210VC0006A	FILTER, FBMH3216 HM501NT 3.2X1.6X1.6MM R/TP

