

1. Exploded View & Part List

Exploded View

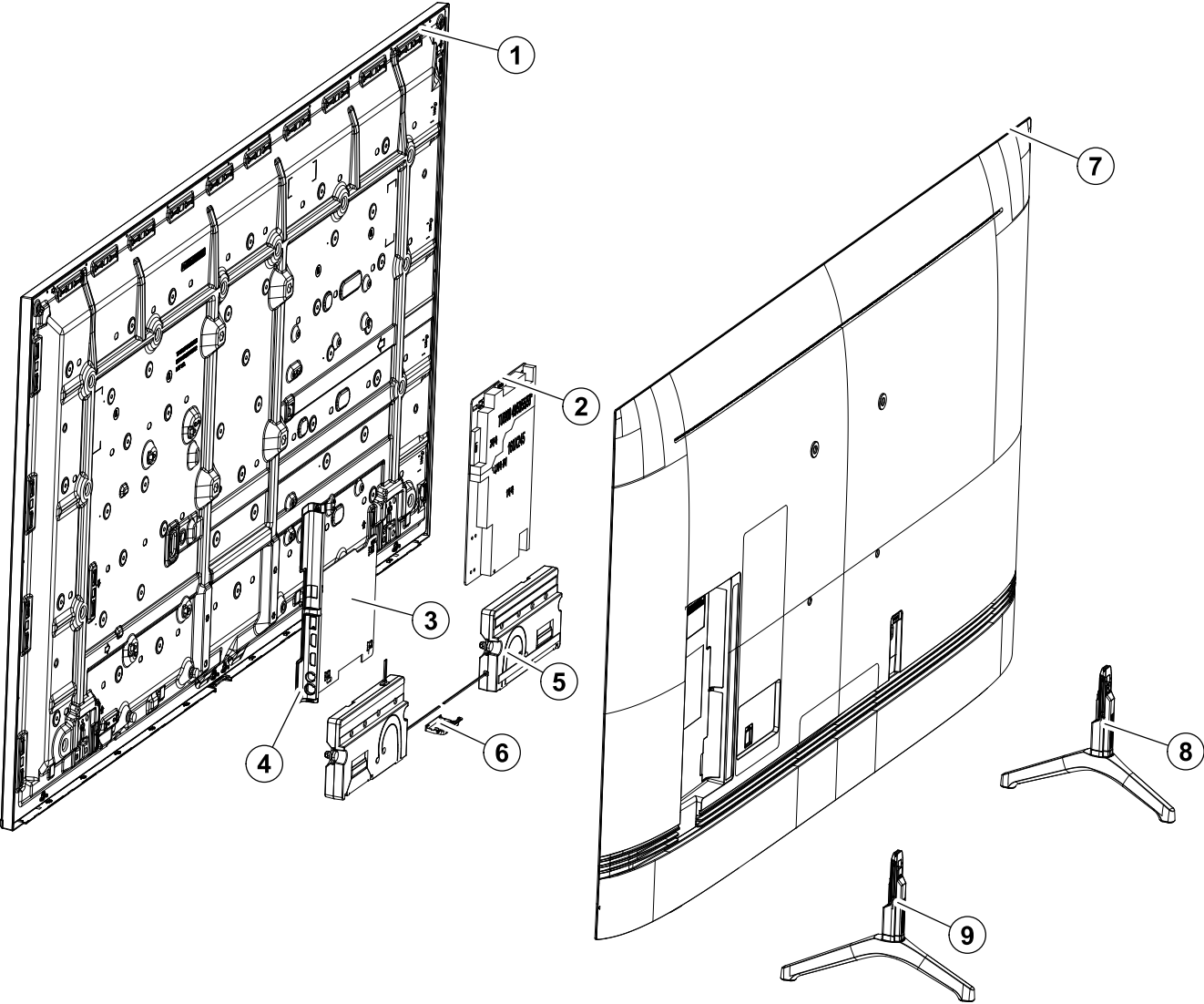

Parts List

No.	Lvl.	Loc.	Material Code	Description & Specification	SNA	Qty.
1	2	PANEL	BN95-06343A	PRODUCT LCD-CSOT; CY-RT075HGHV1V/H,Q60T,B	SA	1
2	2		BN44-01060A	DC VSS-PD BOARD; L75E7N_TSM,AC/DC,230W,AC	SA	1
3	2	M0014	BN94-15232X	ASSY PCB MAIN; QTQ60F	SA	1
4	3	TERMINAL	LBN63-18718B	COVER-TERMINAL SIDE; 65QTQ60F,PC+ABS,V-0,	SA	1
5	2		BN96-45632V	ASSY SPEAKER P-FRONT; TV-SPK,65QTQ70,6ohm	SA	1
6	2	WLAN	BN59-01342A	NETWORK-WLAN CLIENT; WCT733M,44.17x31.99x	SA	1
7	2	R001A	BN96-50735G	ASSY COVER P-REAR; 75QTQ60F,PC+ABS+ED20%,	SA	1
8	2		BN96-50838A	ASSY STAND P-COVER TOP RIGHT; 75QTQ60F,PP	SA	1
9	2		BN96-50831A	ASSY STAND P-COVER TOP LEFT; 75QTQ60F,PP+	SA	1

2. Electrical Parts List

Level	Loc.	Part Code	Description & Specification	Qty.	SA/SNA
			QE75Q60TAUXUA (CA01)		
1		BN90-11389C	ASSY W/I;QTQ60F	1	SNA
.2		BN81-08159Z	A/S PART SET-ELEC W/I;LED TV ELEC spec-C	1	SNA
.2		BN81-17117R	A/S PART SET-MECH W/I;QTQ60F,Q75TF*	1	SNA
1	R001A	BN90-11390F	ASSY COVER REAR;QTQ60F	1	SNA
.2	R001A	BN96-50735G	ASSY COVER P-REAR;75QTQ60F,PC+ABS+ED20%,	1	SA
..3	R001	BN63-18689B	COVER-REAR;75QTQ60F,PC+ABS+ED20%,V-1,BLA	1	SNA
...4		0103-010818	RESIN PC ABS;CM20G/BK00749,BLACK,BK0007,	6580	SNA
..3		BN64-04337C	INLAY-TERMINAL SIDE;65QTQ60F,PET,T0.125,	1	SNA
..3		BN68-03518W	LABEL-STICKER CI SLOT;43UNU7090P,PET,T0.	1	SNA
1	S001A	BN90-11395B	ASSY STAND;QTQ60F	1	SNA
.2		BN96-50831A	ASSY STAND P-COVER TOP LEFT;75QTQ60F,PP+	1	SA
..3		0203-007085	TAPE-SINGLE FACE;PET,T0.05,W20,L100M,CLE	0	SNA
..3		6902-003301	BAG ACCESSORY;LDPE,T0.06,W400,L320,TRP,R	2	SNA
..3		BN63-18709A	COVER-STAND TOP LEFT;75QTQ60F,PP+GF40%,H	1	SNA
..3		BN96-49093C	ASSY STAND P-HOLDER CABLE;65QRQ60T,ABS,B	1	SNA
...4		6902-003068	BAG PE;LDPE,T0.05,W70,L80,TRP,RECYCLE,Ho	1	SNA
...4		BN61-16080A	HOLDER-STAND CABLE;65QRQ60T,ABS,BK0007,H	2	SNA
....5		0103-004609	RESIN ABS;HF-0680U,K21294,BK0007,HB,High	8	SNA
.2		BN96-50838A	ASSY STAND P-COVER TOP RIGHT;75QTQ60F,PP	1	SA
..3	RF01	BN61-13520D	FOOT-RUBBER;40K5500,RUBBER,GRAY,W5,L10,T	4	SNA
..3		BN63-18710A	COVER-STAND TOP RIGHT;75QTQ60F,PP+GF40%,	1	SNA
...4		0103-011475	RESIN PP;9500G40/9379B,Black,BK0020,HB,G	228	SNA
1		BN91-00085F	ASSY SHIELD;TQ60F	1	SNA
.2		BN02-00102B	TAPE-SINGLE FACE;OPP,T0.15,W25,L50M,WHIT	0	SNA
.2		BN39-02217F	LEAD CONNECTOR-POWER;70KU6000,UL21016,12	1	SA
.2		BN39-02601A	LEAD CONNECTOR-SUB ASSY;UL21451,20P,L475	1	SA
.2		BN44-01060A	DC VSS-PD BOARD;L75E7N_TSM,AC/DC,230W,AC	1	SA
.2	WLAN	BN59-01342A	NETWORK-WLAN CLIENT;WCT733M,44.17x31.99x	1	SA
.2		BN96-39820H	FFC CABLE;65/75NU8000,Fold,L500,96P,-	1	SA
.2		BN96-45632V	ASSY SPEAKER P-FRONT;TV-SPK,65QTQ70,6ohm	1	SA
1	M0017	BN91-21764X	ASSY CHASSIS;QTQ60F	1	SNA
.2	M0014	BN94-15232X	ASSY PCB MAIN;QTQ60F	1	SA
..3		0202-001608	SOLDER-WIRE FLUX;LFC7-107,D0.8,99.3Sn/0.	0	SNA
..3		BN62-00895A	HEAT SINK-PS;QN65Q60T,A1050,T1.5,W90,L10	1	SNA
..3	TERMINAL	BN63-18718B	COVER-TERMINAL SIDE;65QTQ60F,PC+ABS,V-0,	1	SA
...4		0103-005041	RESIN PC ABS;FR3200TV/901408,Black,BK000	17	SNA
..3		BN97-16597K	ASSY SMD;QTQ60F	1	SNA

Level	Loc.	Part Code	Description & Specification	Qty.	SA/SNA
...4		0202-001976	SOLDER-CREAM;LST-309M-K21,D20~38um,96.5S	5	SNA
...4	DS01A	0401-001056	DIODE-SWITCHING;MMBD4148SE,100V,200mA,SO	1	SA
...4		0403-001783	DIODE-ZENER;BZB84-C6V2,5.8~6.6V,300mW,SO	4	SNA
...4		0403-002014	DIODE-ZENER;KDZ16B,16.2~18.3V,1000mW,SOD	2	SNA
...4		0403-002067	DIODE-ZENER;PESD5V0U1UT,7.0/8.2V,300mW,S	1	SA
...4		0404-001404	DIODE-SCHOTTKY;BAT721C,40V,200mA,SOT-23,	1	SA
...4		0404-001640	DIODE-SCHOTTKY;SS1060HEWS,60V,1000mA,SOD	3	SA
...4		0404-001881	DIODE-SCHOTTKY;SS3040-HE,40V,3000mA,SOD-	3	SA
...4		0404-001953	DIODE-SCHOTTKY;MBRA340F-HAF,40V,3000mA,S	3	SA
...4		0404-001976	DIODE-SCHOTTKY;SV540,40V,5000mA,TO-277,T	1	SA
...4		0406-001200	DIODE-TVS;RClamp0504F,6V,1MAV,TP	5	SA
...4		0406-001290	DIODE-TVS;3.0SMCJ20A,22.2V,24.5V,5MAV,30	1	SNA
...4		0406-001718	DIODE-TVS;SMF36A,40V,44.2V,3.8MAV,1.25VP	1	SA
...4		0406-001786	DIODE-TVS;PJEC5V0V6TM,5V,7V,8V,0.1MAV,9V	1	SA
...4		0406-001810	DIODE-TVS;uClamp2461P,27V,32V,36V,23000M	1	SA
...4		0501-000462	TR-SMALL SIGNAL;MMBT2907A,PNP,350mW,SOT-	2	SA
...4		0502-001346	TR-POWER;FCX591A,PNP,1000mW,SOT89,TR,30/	3	SA
...4		0505-002560	FET-SILICON;AO6415,P,20V,-3.3A,0.15ohm,1	1	SA
...4		0505-002598	FET-SILICON;AP2317GN,P,20V,-4.2A,0.052oh	1	SA
...4		0505-002660	FET-SILICON;Si2308BDS,N,60V,2.3A,0.156oh	3	SA
...4		0505-002893	FET-SILICON;AO4801AS,P,30V,-5A,2W,SOIC-8	1	SA
...4		0505-003205	FET-SILICON;DMG4435SSS-13,P,30V,-7.3A,1.	1	SA
...4		0505-003391	FET-SILICON;AOD2922,N,100V,8A,140Mohm,18	1	SA
...4		0505-003397	FET-SILICON;2N7002K,N,60V,0.38A,1.19ohm,	8	SA
...4		0505-003752	FET-SILICON;AONR21321,P,30V,50A,0.035ohm	1	SNA
...4		0801-003603	IC-CMOS LOGIC;MC74LCX244MN2TWG,Octal buf	1	SA
...4		1103-001584	IC-EEPROM;M24512-DFMN6TP,512Kbit,64K x 8	1	SNA
...4		1105-002751	IC-DDR4 SDRAM;K4F2E3S4HM-MGCJ,LPDDR4-SDR	1	SA
...4		1105-002853	IC-DDR3 SDRAM;K4B4G1646E-BCNB,DDR3 2133,	1	SA
...4		1201-004117	IC-AUDIO AMP;TAS5749M,QFP,48P,7x7x1mm,DU	1	SA
...4		1201-004258	IC-OP AMP;TLV9062,SOT23-8,TP,8P,DUAL,PLA	1	SA
...4		1203-008777	IC-DC/DC CONVERTER;TPS563201,SOT-23,6,1.	2	SA
...4		1203-008918	IC-DC/DC CONVERTER;TPS65235,WQFN,20P,3x3	1	SA
...4		1203-009067	IC-DC/DC CONVERTER;TPS564201,SOT-23,6P,3	1	SA
...4		1203-009186	IC-POS.IADJUST REG.;TLV759P01PDRVR,TP,6P	1	SA
...4		1203-009188	IC-VOL. DETECTOR;G623F11U,TP,8P,4.9x6x1.	1	SA
...4		1203-009196	IC-DC/DC CONVERTER;TPS565201,SOT-23-THIN	1	SA
...4		1203-009368	IC-DC/DC CONVERTER;G5334DQT1U,QFN4X4-23,	1	SA
...4		1203-009371	IC-DC/DC CONVERTER;VPMS2GMB,QFN,72P,8x8x	1	SA
...4		1204-003798	IC-DECODER;SDP19403,FCPBGA,793P,27x27x1.	1	SA

Level	Loc.	Part Code	Description & Specification	Qty.	SA/SNA
...4		1205-004692	IC-SWITCH;TPS2069CDBVR,SOT-23,5P,2.9x2.8	1	SA
...4		1205-005519	IC-SWITCH;ET20163,SOT23-5,5P,2.95x3.02mm	2	SA
...4		1205-005749	IC-SWITCH;G2897KD1U,TDFN2X3-14,14P,2x3mm	1	SA
...4		1404-001731	THERMISTOR-NTC;33Kohm,4050K,1MWC,TP,1.6x	1	SNA
...4		1405-001232	VARISTOR;6.4V,5.6VDC,30A,1608,TP,19V,200	1	SNA
...4		1405-001271	VARISTOR;35V,20VDC,5A,1005,TP,100V,10pF	11	SA
...4		1405-001306	VARISTOR;11VDC,45A,1608,TP,50V,40pF	1	SA
...4		1405-001381	VARISTOR;11V,8VDC,30A,1608,TP,25V,500pF	3	SA
...4		1405-001382	VARISTOR;24.5V,16VDC,120A,2012,TP,42V,40	1	SA
...4		1405-001452	VARISTOR;15V,12VDC,8A,1608,TP,46V,18pF	6	SA
...4		2007-000039	R-CHIP;0ohm,1%,1/10W,TP,1608	4	SA
...4		2007-000066	R-CHIP;20Kohm,1%,1/10W,TP,1608	1	SNA
...4		2007-000070	R-CHIP;0ohm,5%,1/10W,TP,1608,T0.45	8	SA
...4		2007-000140	R-CHIP;1Kohm,5%,1/16W,TP,1005,T0.35	6	SNA
...4		2007-000146	R-CHIP;6.8Kohm,5%,1/16W,TP,1005	2	SNA
...4		2007-000168	R-CHIP;470Kohm,5%,1/16W,TP,1005,T0.35	2	SA
...4		2007-000171	R-CHIP;0ohm,5%,1/16W,TP,1005,T0.35	46	SNA
...4		2007-000309	R-CHIP;10ohm,5%,1/10W,TP,1608	4	SA
...4		2007-000772	R-CHIP;33Kohm,1%,1/10W,TP,1608,T0.45	2	SA
...4		2007-000929	R-CHIP;470ohm,1%,1/10W,TP,1608	2	SNA
...4		2007-000932	R-CHIP;470ohm,5%,1/16W,TP,1005,T0.35	3	SNA
...4		2007-000979	R-CHIP;5.6Kohm,1%,1/10W,TP,1608	1	SA
...4		2007-001125	R-CHIP;68Kohm,1%,1/10W,TP,1608	2	SA
...4		2007-001288	R-CHIP;18ohm,5%,1/16W,TP,1005,T0.35	8	SA
...4		2007-001298	R-CHIP;51ohm,5%,1/16W,TP,1005,T0.35	3	SNA
...4		2007-002899	R-CHIP;10ohm,1%,1/10W,TP,1608	32	SA
...4		2007-002906	R-CHIP;200Kohm,1%,1/10W,TP,1608	1	SA
...4		2007-007107	R-CHIP;100Kohm,1%,1/16W,TP,1005,T0.35,-	12	SNA
...4		2007-007131	R-CHIP;13Kohm,1%,1/16W,TP,1005,T0.35	1	SA
...4		2007-007132	R-CHIP;15Kohm,1%,1/16W,TP,1005,T0.35	3	SA
...4		2007-007136	R-CHIP;4.7Kohm,1%,1/16W,TP,1005,T0.35	43	SNA
...4		2007-007137	R-CHIP;1.2Kohm,1%,1/16W,TP,1005,T0.35	5	SA
...4		2007-007138	R-CHIP;27Kohm,1%,1/16W,TP,1005,T0.35	1	SA
...4		2007-007139	R-CHIP;47Kohm,1%,1/16W,TP,1005,T0.35	7	SA
...4		2007-007142	R-CHIP;10Kohm,1%,1/16W,TP,1005,T0.35	34	SNA
...4		2007-007231	R-CHIP;110Kohm,1%,1/10W,TP,1608	1	SA
...4		2007-007306	R-CHIP;100ohm,1%,1/16W,TP,1005,T0.35	19	SNA
...4		2007-007309	R-CHIP;12Kohm,1%,1/16W,TP,1005,T0.35	2	SA
...4		2007-007310	R-CHIP;8.2Kohm,1%,1/16W,TP,1005,T0.35	2	SA
...4		2007-007311	R-CHIP;22Kohm,1%,1/16W,TP,1005,T0.35	3	SA

Level	Loc.	Part Code	Description & Specification	Qty.	SA/SNA
...4		2007-007312	R-CHIP;20Kohm,1%,1/16W,TP,1005,T0.35	12	SA
...4		2007-007313	R-CHIP;6.8Kohm,1%,1/16W,TP,1005,T0.35	5	SA
...4		2007-007316	R-CHIP;3.3Kohm,1%,1/16W,TP,1005,T0.35	1	SA
...4		2007-007318	R-CHIP;1Kohm,1%,1/16W,TP,1005,T0.35	24	SNA
...4		2007-007517	R-CHIP;240ohm,1%,1/16W,TP,1005,T0.35	4	SNA
...4		2007-007520	R-CHIP;20ohm,1%,1/10W,TP,1608	2	SA
...4		2007-007528	R-CHIP;1.5Kohm,1%,1/16W,TP,1005,T0.35	1	SA
...4		2007-007588	R-CHIP;1.8Kohm,1%,1/16W,TP,1005,T0.3	1	SA
...4		2007-007736	R-CHIP;510Kohm,1%,1/10W,TP,1608	1	SA
...4		2007-007766	R-CHIP;2Kohm,1%,1/16W,TP,1005,T0.35	16	SNA
...4		2007-007767	R-CHIP;200ohm,1%,1/16W,TP,1005	5	SA
...4		2007-007992	R-CHIP;1ohm,1%,1/10W,TP,1608	2	SA
...4		2007-008015	R-CHIP;75ohm,1%,1/16W,TP,1005,T0.35	6	SA
...4		2007-008026	R-CHIP;56ohm,1%,1/16W,TP,1005,T0.35	1	SA
...4		2007-008294	R-CHIP;33ohm,1%,1/16W,TP,1005,T0.35	18	SA
...4		2007-008298	R-CHIP;49.9ohm,1%,1/16W,TP,1005,T0.35	4	SA
...4		2007-008596	R-CHIP;0.1ohm,1%,1/4W,TP,3216	3	SC
...4		2007-009322	R-CHIP;1.3Kohm,1%,1/16W,TP,1005	2	SA
...4		2011-001261	R-NETWORK;33ohm,5%,1/16W,L,CHIP,8P,TP,2.	6	SA
...4		2011-001264	R-NETWORK;10ohm,5%,1/16W,L,CHIP,8P,TP,2.	1	SNA
...4		2011-001344	R-NETWORK;100ohm,5%,1/16W,L,CHIP,8P,TP,2	7	SA
...4		2011-001448	R-NETWORK;10ohm,5%,1/16W,L,4P,TP,1.0x1.0	13	SA
...4		2011-001587	R-NETWORK;100ohm,5%,1/16W,L,CHIP,4P,TP,1	1	SNA
...4	AD480	2203-000233	C-CER,CHIP;0.1nF,5%,50V,C0G,TP,1005,T0.5	4	SA
...4	AD480	2203-000359	C-CER,CHIP;0.15nF,5%,50V,C0G,TP,1005,T0.	5	SA
...4	AD480	2203-000425	C-CER,CHIP;0.018nF,5%,50V,C0G,TP,1005	2	SA
...4	AD480	2203-000438	C-CER,CHIP;1nF,10%,50V,X7R,TP,1005,T0.5	6	SA
...4	AD480	2203-000489	C-CER,CHIP;2.2nF,10%,50V,X7R,TP,1005,T0.	2	SA
...4	AD480	2203-000812	C-CER,CHIP;0.033nF,5%,50V,C0G,TP,1005	8	SA
...4	AD480	2203-000940	C-CER,CHIP;0.47nF,10%,50V,X7R,TP,1005,T0	2	SA
...4	AD480	2203-002285	C-CER,CHIP;10nF,10%,50V,X7R,TP,1005	14	SNA
...4	AD480	2203-005057	C-CER,CHIP;0.0082nF,0.25pF,50V,C0G,TP,10	2	SA
...4	AD480	2203-005083	C-CER,CHIP;220nF,10%,50V,X7R,TP,1608,T0.	6	SA
...4	AD480	2203-005249	C-CER,CHIP;100nF,10%,50V,X7R,TP,1608	4	SNA
...4	AD480	2203-005642	C-CER,CHIP;0.22nF,5%,50V,C0G,TP,1005,T0.	3	SNA
...4	AD480	2203-005968	C-CER,CHIP;4.7nF,10%,50V,X7R,TP,1005,T0.	4	SNA
...4	AD480	2203-006126	C-CER,CHIP;47nF,10%,16V,X7R,TP,1005,T0.5	5	SNA
...4	AD480	2203-006158	C-CER,CHIP;100nF,10%,16V,X7R,TP,1005,T0.	79	SNA
...4	AD480	2203-006562	C-CER,CHIP;1000nF,10%,10V,X5R,TP,1005,T0	19	SNA
...4	AD480	2203-006698	C-CER,CHIP;1000nF,10%,25V,X7R,TP,1608,T0	10	SA

Level	Loc.	Part Code	Description & Specification	Qty.	SA/SNA
...4	AD480	2203-006844	C-CER,CHIP;470nF,10%,10V,X5R,TP,1005	1	SA
...4	AD480	2203-007176	C-CER,CHIP;10000nF,10%,16V,X5R,TP,2012,T	8	SNA
...4	AD480	2203-007240	C-CER,CHIP;22000nF,20%,6.3V,X5R,TP,1608,	42	SA
...4	AD480	2203-007269	C-CER,CHIP;22000nF,20%,10V,X5R,TP,2012(2	16	SA
...4	AD480	2203-007271	C-CER,CHIP;2200nF,10%,10V,X5R,TP,1005,T0	10	SNA
...4	AD480	2203-007306	C-CER,CHIP;10000nF,10%,25V,X5R,TP,2012,T	29	SNA
...4	AD480	2203-007393	C-CER,CHIP;4700nF,10%,10V,X5R,TP,1005,T0	11	SNA
...4	AD480	2203-007423	C-CER,CHIP;10000nF,10%,35V,X7R,TP,3216	4	SA
...4	AD480	2203-007544	C-CER,CHIP;100nF,10%,50V,X7R,TP,1005,T0.	12	SA
...4	AD480	2203-007795	C-CER,CHIP;10000nF,20%,10V,X5R,TP,1005,T	15	SA
...4	AD480	2203-007809	C-CER,CHIP;22nF,10%,50V,X7R,TP,1005,T0.5	1	SNA
...4	AD480	2203-008096	C-CER,CHIP;2200nF,10%,50V,X5R,TP,2012,1.	2	SA
...4	AD480	2203-008315	C-CER,CHIP;22000nF,20%,25V,X5R,TP,2012,T	16	SA
...4	AD480	2203-008412	C-CER,CHIP;4700nF,10%,50V,X5R,TP,2012,T1	1	SNA
...4		2402-001268	C-AL,SMD;100uF,20%,25V,WT,TP,8x6.3mm	1	SA
...4		2409-001240	C-ORGANIC,SMD;33uF,20%,25V,LR,TP,7343	1	SA
...4		2703-000213	INDUCTOR-SMD;470nH,10%,1608,T0.8,1.35Ohm	1	SA
...4		2703-002269	INDUCTOR-SMD;56nH,5%,1005,T0.5,1Ohm,200m	7	SA
...4		2703-003747	INDUCTOR-SMD;22uH,20%,6060,0.135ohm,1300	2	SA
...4		2703-003862	INDUCTOR-SMD;10uH,20%,6060,0.065ohm,1900	5	SA
...4		2703-004724	INDUCTOR-SMD;8.2uH,20%,5050,T4,0.072Ohm,	4	SA
...4		2703-005191	INDUCTOR-SMD;1.5uH,20%,6060,T4.5,0.02Ohm	2	SA
...4		2703-005193	INDUCTOR-SMD;2.2uH,20%,6060,T4.5,0.024Oh	2	SA
...4		2703-005376	INDUCTOR-SMD;10uH,20%,10.7x10mm,T3.8,0.0	1	SA
...4		2703-005715	INDUCTOR-SMD;820nH,20%,11x10mm,T3.8,0.00	1	SNA
...4		2703-005780	INDUCTOR-SMD;10uH,20%,2012,T1.25,0.91Ohm	2	SNA
...4		2801-004021	CRYSTAL-SMD;24.576MHz,20ppm,28-AAN,12pF,	1	SA
...4		3301-001364	BEAD-SMD;1000ohm/100Mhz 1000ohm/100Mhz,1	4	SNA
...4		3301-002039	BEAD-SMD;26ohm/100Mhz 26ohm/100Mhz,1.6x0	20	SA
...4		3601-001374	FUSE-SURFACE MOUNT;32V,5A,FAST-ACTING,PL	2	SA
...4		3701-001856	CONNECTOR-HDMI;19P,A,FEMALE,AU,0.5mm,BLK	1	SA
...4		3701-001967	CONNECTOR-HDMI;19P,A,FEMALE,AU,0.5mm,BLK	2	SA
...4		3707-001133	CONNECTOR-OPTICAL;STRAIGHT,SPDIF,2.5PI	1	SNA
...4		3708-003241	CONNECTOR-FPC/FFC/PIC;96P,0.5mm,SMD-A,AU	1	SNA
...4		3710-003908	CONNECTOR-SOCKET;64P,2R,0.5mm,SMD-S,AU,B	1	SA
...4	EH01	3711-008131	HEADER-BOARD TO CABLE;BOX,4P,1R,2.5mm,AN	1	SA
...4	EH01	3711-008859	HEADER-BOARD TO CABLE;BOX,12P,2R,2mm,ANG	1	SA
...4		3711-009106	CONNECTOR-HEADER;BOX,20P,2R,2mm,ANGLE,SN	1	SA
...4		3722-003229	JACK-MODULAR;8P/8C,Y,STRAIGHT,NONE,AU,1P	1	SA
...4		3722-003457	JACK-USB;4P/1C,NI,BLK,ANGLE,A,2.0,13.1x1	2	SA

Exploded Views and Parts List

Level	Loc.	Part Code	Description & Specification	Qty.	SA/SNA
...4		3722-004195	JACK-PIN;3P,NI/SN,RED/WHT/YEL,STRAIGHT	1	SNA
...4		6302-001376	GASKET-SMD;SMT Gasket,Si,T6,W4.5,L2.5,SI	5	SNA
...4		6302-001383	GASKET-SMD;SMT Gasket,Sn/Cu plated PI-Fi	1	SNA
...4		BN40-00331B	TUNER-DTV AIR CABLE SAT;GT2S2-7B21,DVB-T	1	SA
...4		BN41-02756B	PCB-MAIN;Q60,FR-4,T1.2,4,193x168mm	1	SNA
...4	CB07	BN61-13312B	BRACKET-SCREWLESS PCB;55KS8000,SK5,T0.3,	4	SNA
...4		BN97-16668A	ASSY MICOM;T-NKLDEUC,ASSY MICOM-MAIN,QTQ	1	SNA
....5		1107-002688	IC-EMMC;THGBMJG6C1LBAIL,8Gbit,64Gbx1,BGA	1	SA
....5		BN46-01240A	S/W;Factory_PEQ,Nike-M/L,PEQ	1	SNA
....5		BN46-01254A	S/W MICOM;T-NKLDEUC,THGBMJG6C1LBAIL,4K_B	1	SNA
...4		BN97-16673A	ASSY MICOM;NLMICOM_TV,Q60/TU8500/TU8000,	1	SNA
....5		1107-002226	IC-NOR FLASH;W25Q40CLSSIP,4Mbit,SOIC,8P,	1	SA
...4		BN97-16686A	ASSY MICOM;TCON F/W,NIKE-L Built-in,1107	1	SNA
....5		1107-002339	IC-NOR FLASH;W25Q80DV,8Mbit,SOP,5.28x5.2	1	SNA
....5		BN46-01182A	S/W MICOM;NIKE-L Built-in,TCON F/W	1	SNA
...3		BN97-16685A	ASSY MICOM;TCON DATA,QTQ60F,75"CSOT	1	SNA
...4		BN46-01181A	S/W MICOM;75S6AU0RT,QTQ60F	1	SNA
...3		BN97-16700A	ASSY DRM;NIKE-L Built-in,DVB,Nagsam, MAC	1	SNA
...4		BN46-00109H	KEY CODE-CERTIFICATION;MAC,TV/AV,General	1	SNA
...4		BN46-00110P	KEY CODE-CERTIFICATION;MIRACAST(HDCP2.2)	1	SNA
...4		BN46-01159A	KEY CODE;NIKE-L,Nagra CSC Data,T-MSLDEUC	1	SNA
...4		BN46-01162A	KEY CODE;NIKE-L,CI PLUS,Samsung-iDTV-N20	1	SNA
1		BN92-27038Z	ASSY LABEL;QTQ60F	1	SNA
.2		BN68-06708G	LABEL-RATING;Monitor,WW,PP,T0.161,W93,L7	1	SNA
.2		BN68-09990A	LABEL-ENERGY;EU,PP,T0.13,W60,L176	1	SNA
.2		BN68-10098A	LABEL-ENERGY;Ukraine,PP,T0.13,W60,L176	1	SNA
.2		BN68-10182A	LEAFLET-QUICK SETUP GUIDE;Q60T Q67T Q70T	1	SNA
1		BN92-27040K	ASSY P/MATERIAL;QTQ60F	1	SNA
.2		6902-003323	BAG ROLL;HDPE/PE FOAM,T0.015/T0.5,W2000,	2	SNA
.2		6922-000013	BAND;PP,T0.8,W18,L2300 M,TRP	6	SNA
.2		6932-000004	WRAP;T0.023,W750,L1000m,non stretched fi	4	SNA
.2		BN02-00319B	TAPE-SINGLE FACE;OPP,T0.05,W75,L800M,CLE	2	SNA
.2		BN69-17449F	PAD PACKING;LED,PAPER,T3,W50X50,L2300,YE	0	SNA
.2		BN69-20430A	CUSHION-SET FRONT;75UTU7000,EPS,16.7g/l,	1	SNA
...3		0103-005099	RESIN EPS;BASF303/NP,Natural,Natural,HB	562	SNA
.2		BN69-20605A	CUSHION-SET SIDE;75QTQ60F,EPS,16.7g/l,WH	2	SNA
.2		BN69-20973A	PALLET-WOODEN;QE75Q60,WOOD,W1190,L1860,H	0	SNA
.2		BN96-50874G	ASSY PACKING P-PAD;75UTU8000,PET,WITH WA	2	SNA
...3		BN68-09932A	LABEL WARNING;ALL MODEL,ART,W40,L74,90g,	2	SNA
...3		BN69-20641G	PAD-SHEET;75UTU8000H,PET,T3.8,W70,L935,W	2	SNA

Level	Loc.	Part Code	Description & Specification	Qty.	SA/SNA
.2		BN96-51035A	ASSY PACKING P-CUSHION SET;QE75Q60,EPS+B	1	SNA
..3		BN69-20604A	CUSHION-SET;75QTQ60F,EPS,16.7g/l,WHITE,Q	1	SNA
..3		BN69-20646A	BOX UNIT-IN;75UTU8000H,CB,DW1,C1,L2154,W	1	SNA
1		BN92-27215K	ASSY BOX;QTQ60F	1	SNA
.2		BH68-00662A	LABEL BOX;ALL,ART,W60,L110,WHT,NO SILK,9	1	SNA
.2		BN69-20775H	BOX UNIT-OUT;75QTQ60F,CB,DW4,F3,L1825,W1	1	SNA
1	ACCE1	BN92-27841T	ASSY ACCESSORY;QTQ60F	1	SNA
.2		BN96-51332Y	ASSY ACCESSORY MANUAL CABLE;QTQ60F	1	SNA
..3		3709-001791	CONNECTOR-CARD SLOT;64P,0.5mm,SMD-A,AU,P	1	SA
..3	T0268	3903-001130	POWER CORD-DT;EUR,2P-F,250V,2.5A,BLK,L30	1	SA
..3		4301-000101	BATTERY-ALKALINE;1.5V,1650mAh,LR6,14.5x5	2	SNA
..3	ANT04	AA59-00853A	MODULE RF-SHIELD BOX;SGLBF-6B,PAL-BG,DK,	1	SA
..3		AA68-03576C	LEAFLET-CALL CENTER;comm,Samsung,Russian	1	SNA
..3		BN59-01330C	REMOCON-SMART CONTROL;2020 TV,SAMSUNG,21	1	SA
..3		BN68-02989A	LABEL ETC;ALL MODEL,ALL,ART,W65,L30,65X3	1	SNA
..3		BN68-07598A	LEAFLET-REGULATORY GUIDE;QT/UT/LFD/LM/HD	1	SNA
..3		BN68-07844A	LEAFLET-WARRANTY;ALL,CIS,W/P,Depending o	1	SNA
..3		BN68-08112A	LABEL-SECURITY;ALL,PET,T0.05,W55,L52,GLO	1	SNA
..3		BN68-08532A	LEAFLET-ADAPTOR GUIDE;KS9500,ASIA_LATIN,	1	SNA
..3		BN68-09371A	LEAFLET-REGULATORY GUIDE;QT/UT,W/W,MOJO,	1	SNA
..3		BN68-10101G	MANUAL USERS;Q60T Q70T Q80T,UA,CIS,MOJO,	1	SNA
..3		BN68-10113C	LEAFLET-ACCESSORY KIT;Q60T,RU & UA & CE,MOJO	1	SNA
..3		BN68-10311A	LEAFLET-PROMOTION;QLED TV, TU8500, TU800	1	SNA
..3		BN69-13935A	BAG ACCESSORY;LDPE,T0.07,W700,L350,TRP,R	1	SNA
1		BN95-06449A	PRODUCT LCD DP;DP,BN95-06343A,CY-RT075HG	1	SA
.2		BN92-27128A	ASSY P/MATERIAL;CY-RT075HGHV1H,inhouse	1	SNA
..3		6902-003311	BAG PANEL;LDPE,T0.08,W2000,L1250,TRP,REC	1	SNA
..3		BN69-20439A	CUSHION-PANEL;75QTQ60F,EPS,20g/l,WHITE	0	SNA
..4		0103-005099	RESIN EPS;BASF303/NP,Natural,Natural,HB	1432	SNA
..3		BN69-20837A	PALLET-WOODEN;75" inhouse LCM,EUR type,W	0	SNA
.2	PANEL	BN95-06343A	PRODUCT LCD-CSOT;CY-RT075HGHV1V/H,Q60T,B	1	SA
..3	M0131	BN63-00520A	GASKET-EMI;APPOLO_PAL,FABRIC,T0.13,W10,L	3	SNA
..3		BN68-05722A	LABEL-E PASS;POLYPROPYLENE,NON-COATING	1	SNA
..3		BN74-00053E	TAPE-SINGLE FACE;PAPER,3M2307,T0.14,W20,	0	SNA
..3		BN90-11318A	ASSY BACK LIGHT UNIT;QTQ60F,75	1	SNA
..4		BN02-00173N	TAPE SINGLE FACE;55UMLS003B,PET,T0.05,W1	4	SNA
..4		BN61-16769A	FRAME-MIDDLE LEFT RIGHT;75QTQ60F,PC+GF10	2	SNA
....5		0103-011284	RESIN PC;LS-3104G/FW9931,White,WT0134,V-	109	SNA
..4		BN61-17045A	LGP;20Y_75INCH_Q70_LGP,PMMA,T3	1	SNA
..4		BN61-17053A	DIFFUSER PLATE;20Y_75INCH_Q70_DP,PS,T1.2	1	SNA

Level	Loc.	Part Code	Description & Specification	Qty.	SA/SNA
...4		BN61-17065A	OPTICAL SHEET-REFLECTOR;20Y_75INCH_Q70_R	1	SNA
...4		BN61-17071A	OPTICAL SHEET-HIGH COLOR;20Y_75INCH_Q70_	1	SNA
...4		BN61-17107A	OPTICAL SHEET-COMPLEX;20Y_75INCH_Q70_DBE	1	SNA
...4		BN96-50336A	ASSY CHASSIS REAR P;75QTQ60F,EGI-SECC,Na	1	SNA
....5		0203-007064	TAPE-DOUBLE FACE;ACRYL,T0.2,W6,N/A,WHITE	2	SNA
....5		6041-001068	RIVET-PH;6SR000032004301_Cr3+WH,SWRCH10A	21	SNA
....5		BN02-00102B	TAPE-SINGLE FACE;OPP,T0.15,W25,L50M,WHIT	0	SNA
....5		BN02-00352D	TAPE-SINGLE FACE;PET,T0.05,W20,L50M,BLAC	0	SNA
....5		BN39-02540A	LEAD CONNECTOR-BLU;75Q70T,UL21016,12P,L1	1	SNA
....5	CB20	BN61-11982B	BRACKET-WALL;65MU8000,CR-SPCC,NATURAL,M8	4	SNA
....5		BN61-13557P	BRACKET-WIRE;75QNQ8CB,SW-C,T1,SILVER,L66	4	SNA
....5		BN61-13557T	BRACKET-WIRE;65UNU7100X,SW-C,T1,SILVER,L	1	SNA
....5		BN61-13557U	BRACKET-WIRE;65UNU7100X,SW-C,T1,SILVER,L	2	SNA
....5		BN61-13557X	BRACKET-WIRE;65UNU7100X,SW-C,T1,SILVER,L	2	SNA
....5		BN61-15538A	HOLDER-LGP TOP LEFT;75QNQ7FC,TPE,BK0020,	1	SNA
....5		BN61-15539A	HOLDER-LGP TOP RIGHT;75QNQ7FC,TPE,BK0020	1	SNA
....5		BN61-16360A	HOLDER-LGP BOTTOM LEFT;82QRQ60T,TPE,BK00	1	SNA
....5		BN61-16361A	HOLDER-LGP BOTTOM RIGHT;82QRQ60T,TPE,BK0	1	SNA
....5		BN61-16805A	STUD-PEM;65UTU7000K,SUM24L,L11.7,WhiteSi	8	SNA
....5		BN61-16849A	BRACKET-LED PCB;75QTQ60T,AI,T1.8,NATURAL	1	SNA
....5		BN63-17628A	INSULATOR-SMPS;75UNU8000F,PC,BLACK,L410,	1	SNA
....5	CC04	BN64-04001D	CHASSIS-REAR;75QTQ60F,EGI-SECC,-,T1,NATU	1	SNA
....6		BN01-00572A	STEEL;75Q7F,EGI-SECC,L0,1mm,1025mm,SESK	14	SNA
....5		BN96-50386A	ASSY LED BAR P;20Y_Q70T_75INCH_EDGE_LED	4	SNA
...4		BN96-50342A	ASSY FRAME P-MIDDLE BOTTOM;75QTQ60F,PC+G	1	SNA
....5		BN60-01661A	SPACER-FABRIC;CONDUCTIVE FABRIC,L20,GRAY	2	SNA
....5		BN60-01666A	SPACER-FOAM;THE FRAME,PU FOAM,L1000,DARK	2	SNA
....5		BN61-16766A	FRAME-MIDDLE BOTTOM;75QTQ60F,PC+GF10%,V-	1	SNA
...4		BN96-51349A	ASSY FRAME P-MIDDLE TOP;75QTQ60F,PC+GF10	1	SNA
....5		BN02-00586C	TAPE DOUBLE FACE;TU7000,ACRYL,T0.3,W3,L1	4	SNA
....5		BN61-16762A	FRAME-MIDDLE TOP;75QTQ60F,PC+GF10%,V-2,W	1	SNA
....6		0103-011284	RESIN PC;LS-3104G/FW9931,White,WT0134,V-	258	SNA
...3		BN96-50288A	ASSY OPEN CELL;CSOT,75Inch,Y20 New,ST746	1	SNA
...4		BN81-18879A	A/S-IC DRIVER SOURCE;IC DRIVER SOURCE,33	1	SNA
...4		BN81-18880A	A/S-ASSY PCB-SOURCE(L);ASSY PCB-SOURCE(L	1	SNA
...4		BN81-18881A	A/S-ASSY PCB-SOURCE(R);ASSY PCB-SOURCE(R	1	SNA
...4		BN81-18882A	A/S-ASSY PCB-SOURCE(M);ASSY PCB-SOURCE(M	1	SNA
...4		BN81-18883A	A/S-POLARIZER-C/F;POLARIZER-C/F,31307041	1	SNA
...4		BN81-18884A	A/S-POLARIZER-TFT;POLARIZER-TFT,31307042	1	SNA
...3		BN96-50325A	ASSY CHASSIS FRONT P;75QTQ60F,PC+ABS+MD1	1	SNA

Level	Loc.	Part Code	Description & Specification	Qty.	SA/SNA
...4		0204-006855	ETHANOL;CS-E-14,gravity 0.8,density 1.59	1	SNA
...4		BN02-00611A	TAPE-DOUBLE FACE;PU FOAM,T0.5,W3.2,N/A,B	4	SNA
...4		BN63-17418N	SHEET-PROTECTION COVER;QTQ60F,PO,T0.05,W	4	SNA
...4	AC155	BN64-04305A	CHASSIS-FRONT;75QTQ60F,PC+ABS+MD18%,V-1,	1	SNA
..3	DECO	BN96-50349A	ASSY COVER P-DECORATION;75QTQ60F,PC+ABS+	1	SNA
...4		BN60-01655A	SPACER-CONDUCTIVE;CONDUCTIVE FABRIC/PU F	2	SNA
...4		BN60-01661A	SPACER-FABRIC;CONDUCTIVE FABRIC,L20,GRAY	2	SNA
...4		BN63-17418C	SHEET-PROTECTION COVER;NU7K,PO,T0.05,W30	2	SNA
...4		BN63-17418D	SHEET-PROTECTION COVER;Q7F,PO,T0.05,W8,L	0	SNA
...4		BN63-17418G	SHEET-PROTECTION COVER;HW-NW700,PO,T0.05	0	SNA
...4	FD01	BN63-18564A	COVER-DECORATION;75QTQ60F,PC+ABS+MD18%,V	1	SNA
....5		0103-011600	RESIN PC ABS;NH-1223/K21294,Black,BK0007	396	SNA