

5. Exploded View & Part List

5-1 PS42C96HDX/XEC Exploded View

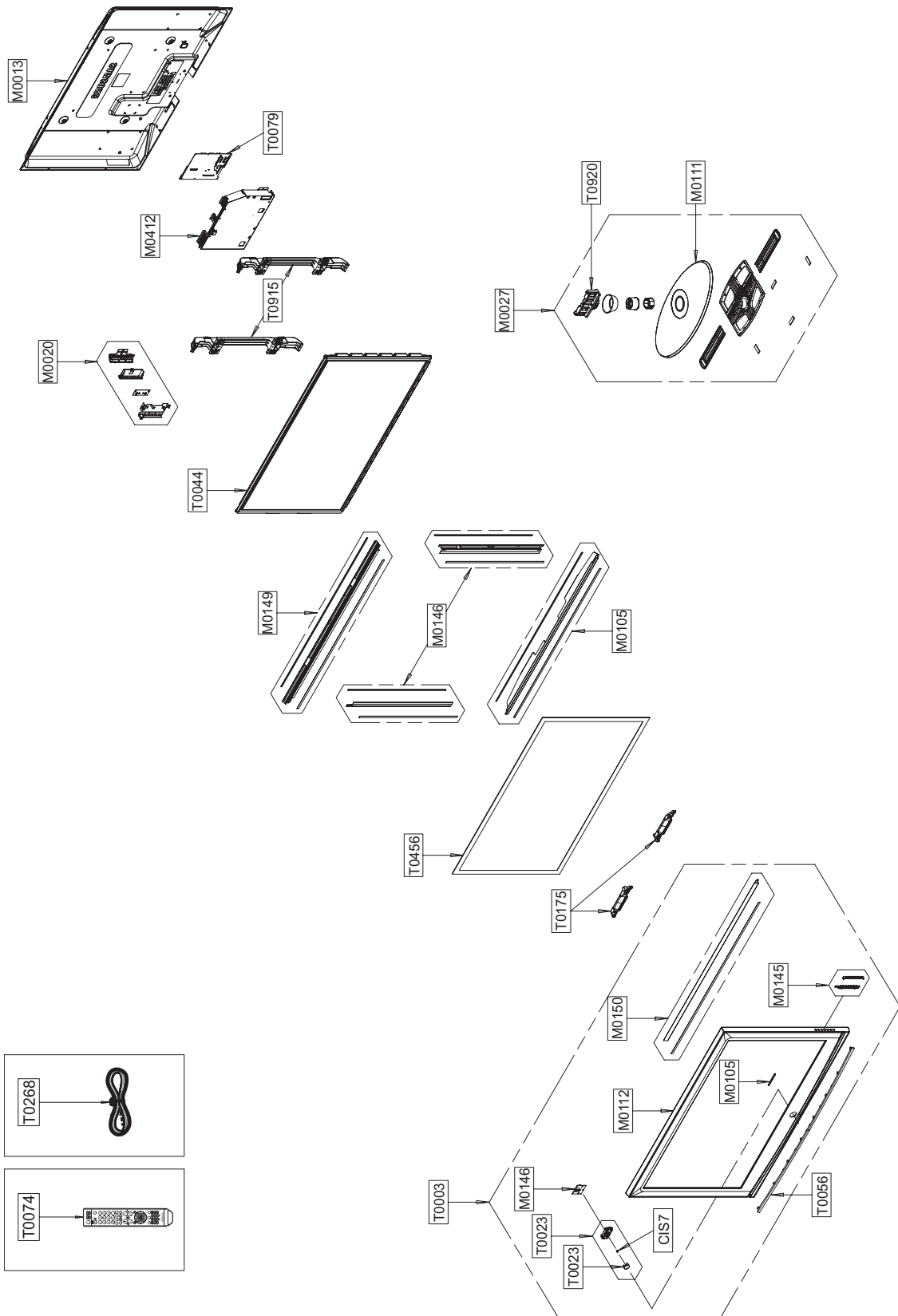

Loc. No.	Code No.	Description	Specification	Q'ty	SA/SNA	Remark
CIS7	AA61-60003B	SPRING ETC-CS	-,SUS304,-,-,OD11.2,N7,OD1	1	S.N.A	
M0013	BN96-04709B	ASSY COVER P-REAR	42Q9/C9,EU(iDTV),PCM T	1	S.A	
M0020	BN96-04900D	ASSY BOARD P-SIDE A/V	LILY 42",SJ06-01-0	1	S.N.A	
M0027	BN96-04714B	ASSY STAND P-BASE	C9/Q9,ABS HB SF-0507,B	1	S.A	
M0105	BN67-00190A	LENS-LED	42Q9,PC,light blue,Material of	1	S.N.A	
M0111	BN63-03049B	COVER-STAND	42Q9,ABS SF-0507,BK23	1	S.N.A	
M0112	BN63-03047D	COVER-FRONT	42C9,ABS,HB,BK23,STEAM MOLD	1	S.N.A	
M0145	BN96-04853B	ASSY BOARD P-FUNCTION	Lily/Calla,CT5000-	1	S.A	
M0146	BN96-04687A	ASSY BRACKET P-FILTER SIDE	42Q9,AL6063,T	2	S.N.A	
M0146	BN96-04861D	ASSY BOARD P-POWER & IR	Lily/Calla,CT500	1	S.A	
M0149	BN96-04685A	ASSY BRACKET P-FILTER TOP	42Q9,AL6063,T1	1	S.N.A	
M0150	BN96-04686A	ASSY BRACKET P-FILTER BOTTOM	42Q9,AL6063	1	S.N.A	
M0150	BN96-04691B	ASSY BRACKET P-SUPPORT FILTER	42Q9,Al 60	1	S.N.A	
M0412	BN96-04903C	ASSY BRACKET P-PCB	42Q9,SECC T0.8	1	S.N.A	
T0003	BN96-04712D	ASSY COVER P-FRONT	42C9,ABS HB,BK23,STEA	1	S.A	
T0023	BN96-04707A	ASSY COVER P-KNOB POWER	C9/Q9,ABS HB	1	S.A	
T0023	BN64-00567A	KNOB POWER	42Q9,PC,VIOLET	1	S.N.A	
T0044	BN96-04592A	ASSY PDP MODULE P-MODULE	42HD W2,PL42AX0	1	S.A	△
T0056	BN63-03091A	COVER-DECORATION	42C9,ABS,HB,BLK	1	S.N.A	
T0074	BN59-00611A	REMOCON	JASMINE , LILY,TM87C,SAMSUNG 28p	1	S.A	
T0079	BN94-01221B	ASSY PCB MISC-MAIN	PS42C96HD,MAIN,BN41-0	1	S.A	△
T0175	BN96-04704A	ASSY SPEAKER P	8ohm,C9,10W,4P connector,	1	S.A	
T0268	3903-000145	CBF-POWER CORD	DT,EU,FP3/YES,U(IEC C13-R	1	S.A	
T0456	BN67-00188A	GLASS-FILTER EMI	42" C7 HD,Sputter,with	1	S.A	△
T0915	BN61-02894B	HOLDER-MODULE	42Q9,PC ABS	2	S.N.A	
T0920	BN61-02990A	GUIDE-STAND	42Q9,PC GF20%	1	S.N.A	

5-2 PS50C96HDX/XEC Exploded View

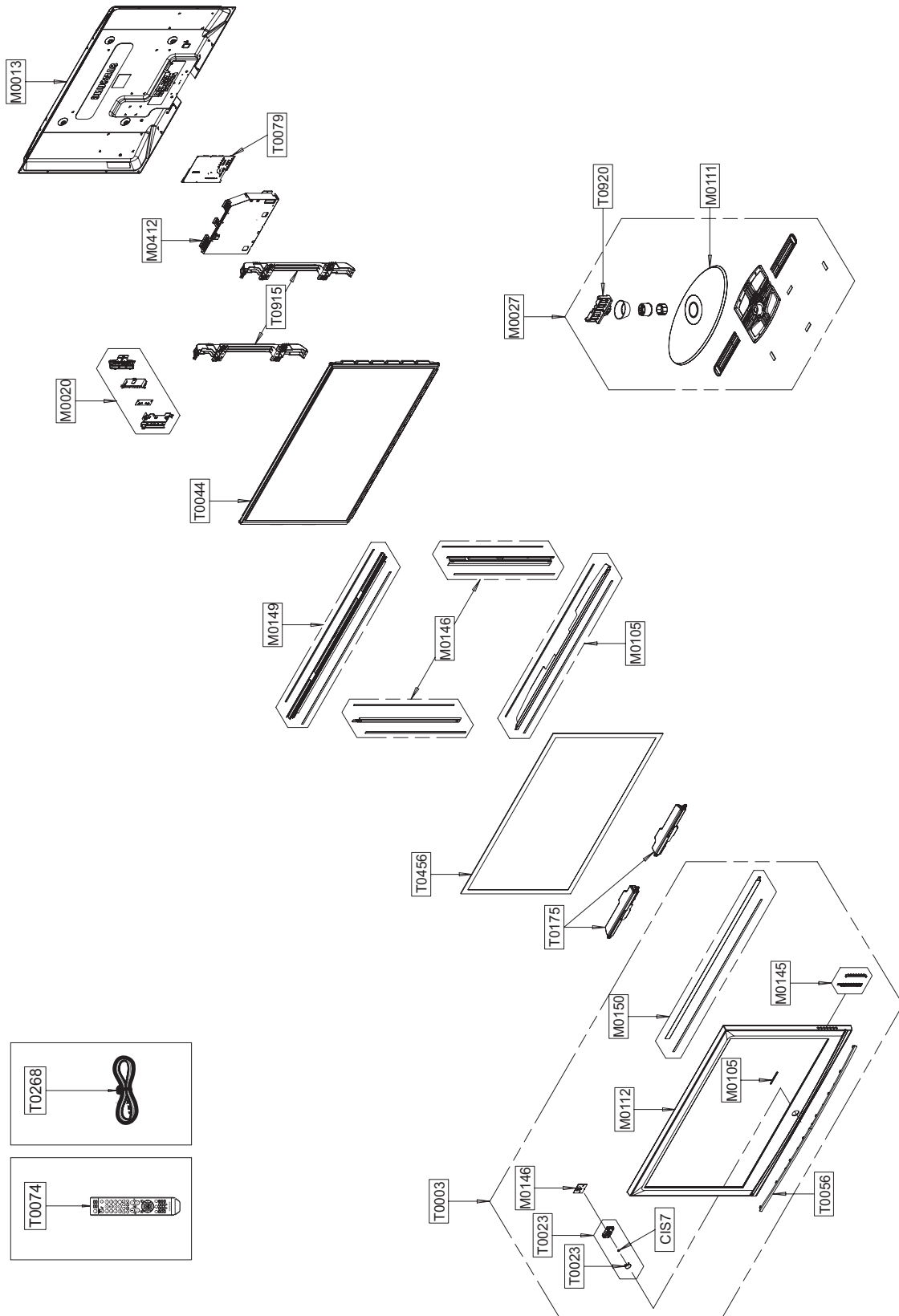

Loc. No.	Code No.	Description	Specification	Q'ty	SA/SNA	Remark
CIS7	AA61-60003B	SPRING ETC-CS	-,SUS304,-,-,OD11.2,N7,OD1	1	S.N.A	
M0013	BN96-04711B	ASSY COVER P-REAR	50Q9/C9,EU(iDTV),PCM T	1	S.A	
M0020	BN96-04900E	ASSY BOARD P-SIDE A/V	LILY 50",SJ06-01-0	1	S.N.A	
M0027	BN96-04714B	ASSY STAND P-BASE	C9/Q9,ABS HB SF-0507,B	1	S.A	
M0105	BN67-00190A	LENS-LED	42Q9,PC,light blue,Material of	1	S.N.A	
M0111	BN63-03049B	COVER-STAND	42Q9,ABS SF-0507,BK23	1	S.N.A	
M0112	BN63-03067D	COVER-FRONT	50C9,ABS,HB,BK23,STEAM MOLD	1	S.N.A	
M0145	BN96-04853B	ASSY BOARD P-FUNCTION	Lily/Calla,CT5000-	1	S.A	
M0146	BN96-04690A	ASSY BRACKET P-FILTER SIDE	50Q9,AL6063,T	2	S.N.A	
M0146	BN96-04861D	ASSY BOARD P-POWER & IR	Lily/Calla,CT500	1	S.A	
M0149	BN96-04688A	ASSY BRACKET P-FILTER TOP	50Q9,AL6063,T1	1	S.N.A	
M0150	BN96-04692A	ASSY BRACKET P-SUPPORT FILTER	50Q9,AL606	1	S.A	
M0150	BN96-04689A	ASSY BRACKET P-FILTER BOTTOM	50Q9,AL6063	1	S.N.A	
M0412	BN96-04903C	ASSY BRACKET P-PCB	42Q9,SECC T0.8	1	S.N.A	
T0003	BN96-04713D	ASSY COVER P-FRONT	50C9,ABS HB,BK23,STEAM	1	S.A	
T0023	BN96-04707A	ASSY COVER P-KNOB POWER	C9/Q9,ABS HB	1	S.A	
T0023	BN64-00567A	KNOB POWER	42Q9,PC,VIOLET	1	S.N.A	
T0044	BN96-04775A	ASSY PDP MODULE P	50HD W2A,M1,W2A,1365*7	1	S.A	△
T0056	BN63-03081A	COVER-DECORATION	50C9,ABS,HB BLK	1	S.N.A	
T0074	BN59-00611A	REMOCON	JASMINE , LILY,TM87C,SAMSUNG 28p	1	S.A	
T0079	BN94-01223B	ASSY PCB MISC-MAIN	PS50C96HD,MAIN,BN41-0	1	S.A	△
T0175	BN96-04704A	ASSY SPEAKER P	8ohm,C9,10W,4P connector,	1	S.A	
T0268	3903-000145	CBF-POWER CORD	DT,EU,FP3/YES,U(IEC C13-R	1	S.A	
T0456	BN67-00197A	GLASS-FILTER EMI	50 W2, C9,Sputter, wit	1	S.A	△
T0915	BN61-02895B	HOLDER-MODULE	50Q9,PCABS	2	S.N.A	
T0920	BN61-02990A	GUIDE-STAND	42Q9,PC GF20%	1	S.N.A	

5-3 PS42C96HDX/XEC Service Item

※ This is the list which is available to repair the real material at the time of service.

Loc. No.	Code No.	Description	Specification	Q'ty	Remark
M0013	BN96-04709B	ASSY COVER P-REAR	42Q9/C9,EU(iDTV),PCM T	1	
M0027	BN96-04714B	ASSY STAND P-BASE	C9/Q9,ABS HB SF-0507,B	1	
M2893	BN39-00859A	LEAD CONNECTOR	CALLA 50",UL20276#30,UL/C	1	
M2893	BN39-00881A	LEAD CONNECTOR	LILLY 42"/50",UL1007#26,U	1	
T0003	BN96-04712D	ASSY COVER P-FRONT	42C9,ABS HB,BK23,STE A	1	
T0023	BN96-04707A	ASSY COVER P-KNOB POWER	C9/Q9,ABS HB	1	
T0044	BN96-04592A	ASSY PDP MODULE P-MODULE	42HD W2,PL42AX0	1	△
T0074	BN59-00611A	REMOCON	JASMINE , LILY, TM87C, SAMSUNG 28p	1	
T0079	BN94-01221B	ASSY PCB MISC-MAIN	PS42C96HD,MAIN,BN41-0	1	△
T0175	BN96-04704A	ASSY SPEAKER P	8ohm,C9,10W,4P connector,	1	
T0764	BN44-00161A	SMPS-PDP TV	HPS4253,SEM,AC/DC,370W,AC100	1	△
T1910	BN96-04593A	ASSY PDP MODULE P-X-MAIN	42HD W2,PL42AX0	1	△
T1911	BN96-04594A	ASSY PDP MODULE P-Y-MAIN	42HD W2,PL42AX0	1	△
T1914	BN96-04597A	ASSY PDP MODULE P-ADDRESS-E BU	42HD W2,P	1	
T1915	BN96-04598A	ASSY PDP MODULE P-ADDRESS-F BU	42HD W2,P	1	
T1917	BN96-04596A	ASSY PDP MODULE P-LOGIC MAIN	42HD W2,PL4	1	
T9698	BN96-04595A	ASSY PDP MODULE P-Y-MAIN SCAN	42HD W2,PL	1	

5-4 PS50C96HDX/XEC Service Item

※ This is the list which is available to repair the real material at the time of service.

Loc. No.	Code No.	Description	Specification	Q'ty	Remark
M0013	BN96-04711B	ASSY COVER P-REAR	50Q9/C9,EU(iDTV),PCM T	1	
M0027	BN96-04714B	ASSY STAND P-BASE	C9/Q9,ABS HB SF-0507,B	1	
M2893	BN39-00859A	LEAD CONNECTOR	CALLA 50",UL20276#30,UL/C	1	
M2893	BN39-00881A	LEAD CONNECTOR	LILLY 42"/50",UL1007#26,U	1	
T0003	BN96-04713D	ASSY COVER P-FRONT	50C9,ABS HB,BK23,STE A	1	
T0023	BN96-04707A	ASSY COVER P-KNOB POWER	C9/Q9,ABS HB	1	
T0044	BN96-04775A	ASSY PDP MODULE P	50HD W2A,M1,W2A,1365*7	1	△
T0074	BN59-00611A	REMOCON	JASMINE , LILY,TM87C,SAMSUNG 28p	1	
T0079	BN94-01223B	ASSY PCB MISC-MAIN	PS50C96HD,MAIN,BN41-0	1	△
T0175	BN96-04704A	ASSY SPEAKER P	8ohm,C9,10W,4P connector,	1	
T0764	BN44-00162A	SMPS-PDP TV	HPS5053,SEM,AC/DC,460W,AC100	1	△
T1910	BN96-04573A	ASSY PDP MODULE P-X-MAIN	50HD W2,PL50HW0	1	△
T1911	BN96-04574A	ASSY PDP MODULE P-Y-MAIN	50HD W2,PL50HW0	1	△
T1914	BN96-04578A	ASSY PDP MODULE P-ADDRESS E_BU	50HD W2,P	1	
T1915	BN96-04579A	ASSY PDP MODULE P-ADDRESS F_BU	50HD W2,P	1	
T1917	BN96-04881A	ASSY PDP MODULE P-LOGIC MAIN	PL50HW021A,	1	
T1960	BN96-04575A	ASSY PDP MODULE P-Y-MAIN UPPER	50HD W2,P	1	
T1961	BN96-04576A	ASSY PDP MODULE P-Y-MAIN LOWWE	50HD W2,P	1	

MEMO