

5. Exploded View & Part List

5-1. LE46C550J1 Exploded View

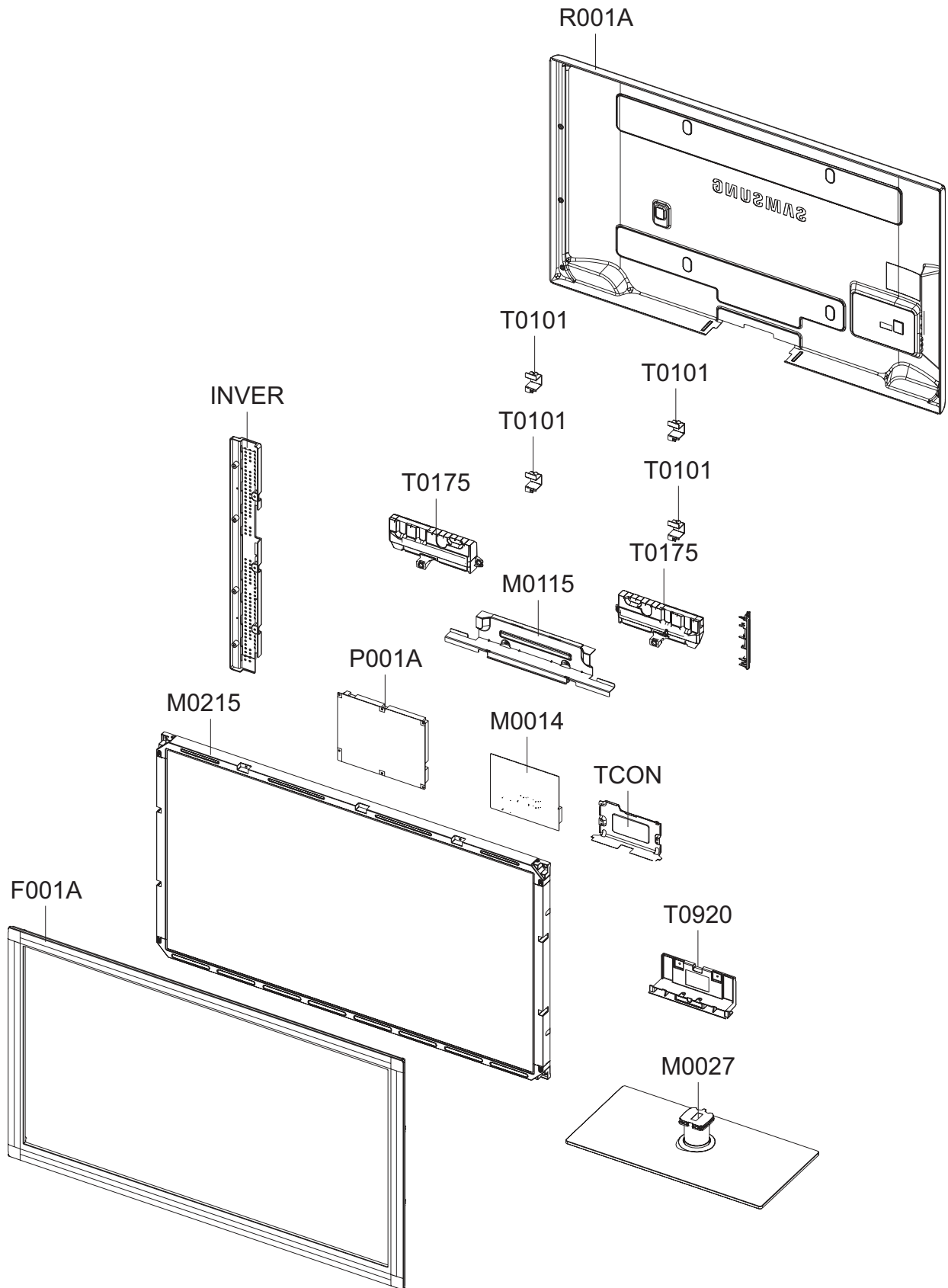

5-2. LE46C550J1 Parts List

Location No.	Code No.	Description & Specification	Q'ty	S.A/S.N.A	Remark
F001A	BN96-12809B	ASSY COVER P-FRONT;46,LC550,EO,PC+PC,V2,	1	SA	
INVER	BN81-04443A	A/S-BB-L T460HW03 VJ;T460HW03 VJ	1	SA	
M0014	BN94-03391P	ASSY PCB MAIN-AAH;LE46C550J1WX*	1	SA	
M0027	BN96-12763A	ASSY STAND P-BASE;46,EXPORT,TEMPERED GLA	1	SA	
M0115	BN61-05998A	BRACKET-STAND LINK;LC650 46,SECC,T1.6	1	SNA	
M0215	BN07-00832A	LCD-PANEL;T460HW03 VJ,AU46H3J,8bit,46,16	1	SA	
P001A	BN44-00341B	IP BOARD-TV;I46F1_AHS,I46F1_AHS,14mA,16m	1	SA	
R001A	BN96-12768H	ASSY COVER P-REAR;46,LC550,EO,PCM,T0.5,B	1	SA	
T0101	BN61-05997A	BRACKET-WALL;LC650 46,SECC,T1.6	4	SNA	
T0175	BN96-12837B	ASSY SPEAKER P;6ohm,4pin,10W,L:630 R:290	1	SA	
T0920	BN61-06003A	GUIDE-STAND;37,40,46,LC650,PC+G/F,20%,V2	1	SNA	
TCON	BN81-04413A	A/S-T CON T460HW03_VJ;T460HW03 VJ	1	SA	

5-2-1. LE46C550J1 Parts List

Service Bom (SA: SERVICE AVAILABLE, SNA: SERVICE NOT AVAILABLE)

Level	Location No.	Code No.	Description & Specification	Q'ty	SA/SNA	Remark
0.1	S001A	BN90-02444B	ASSY STAND;46,LC650,W/W,2COAT,ROSE BLACK	1	SNA	
..2	M0027	BN96-12763A	ASSY STAND P-BASE;46,EXPORT,TEMPERED GLA	1	SA	
...3	M0081	6003-001003	SCREW-TAPTYPE;BH,+,B,M4,L12,ZPC(BLK),SWR	6	SA	
...3		BN61-04692A	BOSS-PRIMER;#94,clear,35cps	0.1	SNA	
...3		BN61-04731D	BOSS-TAPE;AMBER,ACRYL,T1.1,W20.0mm,WHITE	0.39	SNA	
...3		BN61-05244A	BRACKET-SWIVEL BOTTOM;LB700 46,HGI,T3.0	1	SNA	
...3		BN61-05493A	HOLDER-SWIVEL RING BOTTOM;LB650 40,Aceta	1	SNA	
...3		BN61-05826A	BOSS-BOND;#760,Poly urethane,Black	2.4	SNA	
...3	GSN01	BN61-05994A	GUIDE-STAND NECK;40,LC650,PETG,V2,TP0003	1	SNA	
...4		0103-007257	RESIN-PETG;ECOZEN-SE,NP01,TP0003,3.2 V2,	150	SNA	
...4		BN61-06079A	GUIDE-NECK-INSERT;40,LC650,PETG,HB,TP000	1	SNA	
...3	CCM1	BN63-04755A	COVER-SHEET;AMBER,PE,T0.05,W150mm,200M,6	1.22	SNA	
...3		BN63-05227D	COVER-STAND GLASS;46,LC650,GLASS,T8.0,2C	1	SNA	
...3	T0527	BN68-00513A	LABEL-E,PASS;ALL MODEL,YUPO(110G),50X15,	1	SNA	
...3	T0527	BN68-01648B	LABEL WARNING;WW,PET,T0.05,40,25,EXPORT	1	SNA	
...3	M0126	BN73-00215A	RUBBER-FOOT;40LB650,RUBBER,15*25,60,4.0,	4	SNA	
...3	M0126	BN73-00217A	RUBBER-FOOT;LB650,RUBBER,DIA30,7.5,Dark	4	SNA	
...3		BN74-00031A	GREASE;kanto-kasei FL-955,grease,wht	0.4	SNA	
...3		BN61-05652A	BRACKET-STAND BOTTOM;B650 40,SECC,T2.0	1	SNA	
...3	FD01	BN63-06913A	COVER-DECORATION;LB7000 46,ABS+PMMA,HB,H	1	SNA	
...4		0103-005096	RESIN-ABS;HB,ABS+PMMA	13	SNA	
..2	SG03A	BN96-12795D	ASSY STAND P-GUIDE;37,40,46,LC650,W/W,PC	1	SA	
...3	T0920	BN61-06003A	GUIDE-STAND;37,40,46,LC650,PC+G/F,20%,V2	1	SNA	
...4		0103-007285	RESIN-PC;BK0007,2.0 V2,PC/GF20%,Glass fi	478	SNA	
...3	T0527	BN68-00513A	LABEL-E,PASS;ALL MODEL,YUPO(110G),50X15,	1	SNA	
...3		BN68-02766B	MANUAL FLYER-STAND GUIDE;L550~L750,SAMSU	1	SNA	
...3		BN96-12031G	ASSY ACCESSORY-SCREW;10 LCD-TV,6003-0010	1	SNA	
...4	M0081	6003-001003	SCREW-TAPTYPE;BH,+,B,M4,L12,ZPC(BLK),SWR	9	SA	
...4	T0524	6902-000341	BAG PE;LDPE,T0.05,L90,W70,TRP,,,PE MARK	1	SNA	
...3	T0524	6902-001063	BAG PE;LDPE,T0.05,W180,L350,TRP,RECYCLE	1	SNA	
0.1	R001A	BN90-02449H	ASSY COVER REAR;46,LC550,EO	1	SNA	
..2	M0081	6003-001003	SCREW-TAPTYPE;BH,+,B,M4,L12,ZPC(BLK),SWR	14	SA	
..2	R001A	BN96-12768H	ASSY COVER P-REAR;46,LC550,EO,PCM,T0.5,B	1	SA	
...3	R001	BN63-06337C	COVER-REAR;46,LC550/530,EO,PCM,T0.5,BLK,	1	SNA	
...3		BN64-01269D	INLAY-AV;LC550,EO,PS SHEET,T0.5,BLK,H/GL	1	SNA	
...3	T0071	BN64-01297C	INLAY-TERMINAL;LC550,EO,PS SHEET,T0.5,BL	1	SNA	
...3	T0139	BN65-00003A	CLAMPER BAG;42C7,LDPE,HB,BLK	1	SNA	
...3		BN60-00162X	SPACER-FOAM;FOAM,30000mm,Dark Gray,1T,15	1.95	SNA	
...3	AH358	BN61-06545A	HOLDER-REAR;LC650 37/40/46,PP,BLK	1	SNA	
...3		BN63-06630A	SHEET-INSULATOR SMPS;UC6100 40inch,PC,T0	1	SNA	
...3	M0131	AA63-01308A	GASKET;Twister,Conductive Fabric,1.5mm,3	1	SNA	
...3	M0131	BN63-03845A	GASKET;EMT4-10-4-110R-DM8,4T,10MM,100MM	2	SNA	
...3		BP63-00120A	GASKET;SP50L2HX,Conductive Fabric,4.0mm,	2	SNA	
..2	T0382	BP61-00495C	HOLDER-CARE;PJT,ACRYL-FOAM,T0.25,W30.0mm	0.1	SNA	
0.1		BN90-02475B	ASSY COVER FRONT;46,LC550,EO	1	SNA	
..2	F001A	BN96-12809B	ASSY COVER P-FRONT;46,LC550,EO,PC+PC,V2,	1	SA	
...3		BN60-00163J	SPACER-FOAM;LC650-46",FOAM,1024,T 0.5,20	1	SNA	
...3	AB326	BN61-04661A	BRACKET-STOPPER;L650,SK-5,T0.4,Plating,H	5	SNA	

5. Exploded View & Part List

Level	Location No.	Code No.	Description & Specification	Q'ty	SA/SNA	Remark
...3	CCM1	BN63-05199B	COVER-SHEET;AMBER,PE,T0.08,W65mm,200M,CL	2.55	SNA	
...3	CCM1	BN63-05199D	COVER-SHEET;AMBER,PE,T0.08,W75mm,200M,CL	1.15	SNA	
...3	F001	BN63-06387B	COVER-FRONT;46,LC550,EO,PC+PC,V2,TP0010+	1	SNA	
...4		0103-007267	RESIN-PC;RD0005,2.0V0,NH PC,NH PC 2.0 V2	1,036.00	SNA	
...4		0103-007268	RESIN-PC;TP0010,2.0V0,NH PC,NH PC 2.0 V2	853	SNA	
...3		BN96-12778B	ASSY HOLDER P-BOSS BOTTOM;46,LC630,ABS,H	1	SNA	
...4		BN61-04731A	BOSS-TAPE;AMBER,ACRYL,T1.1,W8.0mm,WHITE	0.51	SNA	
...4		BN61-06076B	HOLDER-BOSS BOTTOM;46,LC630,ABS,HB,WT003	1	SNA	
....5		0103-004618	RESIN-ABS;WT0034,HB,ABS,High Flow ABS	145	SNA	
...3	M0125	BN96-13451C	ASSY BOARD P-TOUCH FUNCTION&IR;LN46C550J	1	SA	
...3		BN74-00052A	TAPE-PAPER;LB530,Crepe Paper,0.17mm, 10m	0.05	SNA	
...3		BN60-00163D	SPACER-FOAM;LC650-46",FOAM,590,0.5,25,Bo	2	SNA	
..2	T0175	BN96-12837B	ASSY SPEAKER P;6ohm,4pin,10W,L:630 R:290	1	SA	
0.1	M0017	BN91-04662G	ASSY CHASSIS;LE37C570J1SX*	1	SNA	
..2	M0014	BN94-03391P	ASSY PCB MAIN-AAH;LE46C550J1WX*	1	SA	
...3		0202-001608	SOLDER-WIRE FLUX;LFC7-107,D0.8,99.3Sn/0.	0.25	SNA	
...3		3701-001480	CONNECTOR-DSUB;15P,3R,FEMAIL,STAMPED PIN	1	SA	
...3	CN906	3707-001096	CONNECTOR-OPTICAL;STRAIGHT W/L,SPDIF	1	SA	
...3		3709-001601	CONNECTOR-CARD SLOT;68P W/L,1.27mm,PCMC1	1	SA	
...3		3711-007302	HEADER-BOARD TO BOARD;BOX,18P,2R,2mm,ANG	1	SA	
...3		3722-002920	JACK-USB;4P/1C,Ni/Pd/Au/Sn,BLK,STRAIGHT,	1	SA	
...3		3722-003037	JACK-USB;4P/1C W/L,AU/NI,BLK,ANGLE,A	1	SA	
...3	JA330	3722-003038	JACK-PHONE;7P/1C W/L,SN,BLK	2	SA	
...3		3722-003039	JACK-SCART;21P,Sn,BLK	1	SA	
...3	JA333	3722-003040	JACK-PIN;3P W/L,SN,BLK/YEL/WHT/RED,ANGLE	1	SA	
...3		3722-003041	JACK-PIN;5P RCA(SCART) W/L,NI,RED/WHT/RE	1	SA	
...3		3722-003058	JACK-MODULAR;8P/8C W/L,Y,STRAIGHT,N,AU,1	1	SA	
...3	CIS3	BN40-00173A	TUNER;DTOS40CVL081A,DVB-T/C,164CH,38.9MH	1	SA	
...3	T0066	BN62-00040A	HEAT SINK-ES;SAPPHIRE,T2.0,36*36*6.6,BLK	1	SNA	
...3	M0412	BN96-11826C	ASSY BRACKET P-PCB;LB450 40,SPT E T0.5 +	1	SNA	
...4		BN61-04928C	BRACKET-SUPPORT PCB;SPT E,T 0.5,SCREW-M4	1	SNA	
...4		BN61-05262B	HOLDER-BOSS PCB;52,LB550(EO),PBT+G/F(30%	1	SNA	
...3		BN97-03935P	ASSY SMD;LE46C550J1WX*,BN94-03391P	1	SNA	
...4		0202-001767	SOLDER-CREAM;LST-5710,D20~38,Sn-57Bi-1Ag	0.409	SNA	
...4	DS01A	0401-001056	DIODE-SWITCHING;MMBD4148SE,100V,200mA,SO	18	SA	
...4	D0254	0402-000553	DIODE-SCHOTTKY;SS24/B240,40V,2000mA,DO-2	2	SA	
...4		0403-001164	DIODE-ZENER;MMSZ5232B,5.32-5.88V,500MW,S	1	SA	
...4		0403-001180	DIODE-ZENER;BZX84C6V2,5.8-6.6V,350mW,SOT	1	SA	
...4		0403-001783	DIODE-ZENER;BZB84-C6V2,5.8/6.6V,300mW,SO	17	SNA	
...4	D0254	0404-001271	DIODE-SCHOTTKY;SSA34,40V,3000mA,SMA,TP	1	SA	
...4	D0254	0404-001404	DIODE-SCHOTTKY;BAT721C,40V,200mA,SOT-23,	1	SA	
...4	T0139	0406-001200	DIODE-TVS;RCLAMP0504F,6/-/V,150W,SC-70	2	SA	
...4	T0139	0406-001271	DIODE-TVS;RCLAMP0524P,6/-/V,150W,SLP251	9	SNA	
...4	SD3	0407-000114	DIODE-SWITCHING;KDS184,80V,100mA,SOT-23,	3	SNA	
...4	KQ1	0501-000279	TR-SMALL SIGNAL;KSA1182-Y,PNP,150mW,SOT-	1	SA	
...4	Q101	0501-000445	TR-SMALL SIGNAL;KTC3875S-Y,NPN,150mW,SOT	12	SA	
...4	CEQ2	0505-000110	FET-SILICON;2N7002,N,60V,115mA,7.5ohm,0.	5	SA	
...4	Q409	0505-000274	FET-SILICON;AO4435L,P,-30V,-11A,0.014ohm	1	SNA	
...4	IC104	0801-002630	IC-CMOS LOGIC;74AHCT1G08,2-INPUT AND GAT	1	SA	
...4	ND51C2	0801-002780	IC-CMOS LOGIC;74LVC1G17,SCHMITT-TRIGGER	1	SA	

5. Exploded View & Part List

Level	Location No.	Code No.	Description & Specification	Q'ty	SA/SNA	Remark
...4	IC104	0801-003330	IC-CMOS LOGIC;Octal buffer,DQFN,20P,4.5x	3	SA	
...4	IC104	0802-001012	IC-CMOS LOGIC;74LCX245,TRANSCEIVER,DQFN,	1	SNA	
...4	T0596	0904-002554	IC-USC;AU6256-JBF,QFN,28P,5x5mm,12MHz,TP	1	SA	
...4	IC106	1001-001573	IC-VIDEO SWITCH;SiI9287BCNUTR,QFN,72P,10	1	SNA	
...4		1006-001474	IC-LINE DRIVER;DRV604PWP,HPSSOP,28P,9.8x	1	SA	
...4	IC112	1103-000129	IC-EEPROM;24C02,2Kbit,256x8,SOP,8P,5x4mm	2	SA	
...4	IC112	1103-001385	IC-EEPROM;AT24C256,256Kbit,32Kx8,SOP,8P,	1	SA	
...4		1105-002058	IC-DDR2 SDRAM;K4T1G164QE-HCF8,DDR2,1Gbit	2	SA	
...4	T0124	1201-002992	IC-POWER AMP;STA369BWS,PSSO,36P,10.3x7.5	1	SA	
...4	T0087	1203-001815	IC-POSI.FIXED REG.;78M09,TO-252,3P,PLAST	1	SA	
...4	T0087	1203-002835	IC-POSI.FIXED REG.;KIA7805AF,DPAK,3P,6.6	1	SA	
...4	T0087	1203-002898	IC-POSI.FIXED REG.;G950T45R,TO-252,3P,6.	1	SA	
...4		1203-004364	IC-VOL. DETECTOR;RT9818C-42PV,SOT-23,3P,	1	SA	
...4	T0087	1203-005134	IC-POSI.FIXED REG.;RT9167A-33PB,SOT-23-5	1	SNA	
...4		1203-005538	IC-DC/DC CONVERTER;AOZ1021HAIL,SOP,8P,4.	1	SA	
...4		1203-005559	IC-BACKLIGHT DRIVER;MP3302DJ,TSOT23,5P,2	1	SA	
...4		1203-006013	IC-DC/DC CONVERTER;AOZ1031AI,SO-8,8P,4.9	1	SA	
...4		1203-006017	IC-VOL. DETECTOR;RT9824GJ8,TSOT23,8P,2.9	1	SA	
...4	T0087	1203-006135	IC-POSI.FIXED REG.;AP1117D-33-GZ-13-89,T	1	SA	
...4	T0087	1203-006136	IC-POSI.FIXED REG.;AP1117D-18-GZ-13-89,T	1	SA	
...4	IC012	1203-006138	IC-POSI.ADJUST REG.;AP1117DGZ-13-89,TO-2	1	SA	
...4		1203-006288	IC-VOL. DETECTOR;RT9818B-18GV,SOT-23-3,3	1	SA	
...4		1204-003088	IC-DEMODULATOR;DRX39XYK,PQFN,64P,9x9x0.8	1	SA	
...4		1204-003096	IC-VIDEO DECODER;HIDTVPRO-SX,PBGA,580P,P	1	SA	
...4		1205-003201	IC-BUS SWITCH;TC7WB125FK,SSOP,8P,2x2.3mm	2	SA	
...4		1205-003479	IC-SWITCH;TPS2051BDBVR,SOT-23,5P,2.9x1.6	1	SA	
...4		1205-003733	IC-SWITCH;AP2191MPG-13,MSOP-8L-EP,8P,2.9	1	SA	
...4		1205-003735	IC-SWITCH;AP2151WG-7,SOT25,5P,2.9x1.6mm,	1	SA	
...4		1405-001185	VARISTOR;24Vdc,1.6x0.8x0.36mm,TP	1	SA	
...4		1405-001271	VARISTOR;20Vdc,5A,1.0x0.5x0.6mm,TP	25	SA	
...4	PR6	2007-000072	R-CHIP;47ohm,5%,1/10W,TP,1608	4	SNA	
...4	R105	2007-000138	R-CHIP;100ohm,5%,1/16W,TP,1005	36	SNA	
...4	HDR7	2007-000139	R-CHIP;220ohm,5%,1/16W,TP,1005	3	SNA	
...4	AR49	2007-000140	R-CHIP;1Kohm,5%,1/16W,TP,1005	7	SNA	
...4	MR306	2007-000141	R-CHIP;2.2Kohm,5%,1/16W,TP,1005	14	SNA	
...4	R319	2007-000143	R-CHIP;4.7Kohm,5%,1/16W,TP,1005	48	SNA	
...4		2007-000146	R-CHIP;6.8Kohm,5%,1/16W,TP,1005	2	SNA	
...4	R104	2007-000148	R-CHIP;10Kohm,5%,1/16W,TP,1005	52	SNA	
...4	R102	2007-000149	R-CHIP;12Kohm,5%,1/16W,TP,1005	8	SA	
...4	HDR2	2007-000151	R-CHIP;15Kohm,5%,1/16W,TP,1005	1	SNA	
...4	HDR9	2007-000152	R-CHIP;20Kohm,5%,1/16W,TP,1005	2	SNA	
...4	MR36	2007-000153	R-CHIP;22Kohm,5%,1/16W,TP,1005	8	SNA	
...4	AR43	2007-000155	R-CHIP;27Kohm,5%,1/16W,TP,1005	2	SNA	
...4	MR13	2007-000157	R-CHIP;47Kohm,5%,1/16W,TP,1005	8	SNA	
...4	R123	2007-000159	R-CHIP;56Kohm,5%,1/16W,TP,1005	3	SNA	
...4	DR39	2007-000162	R-CHIP;100Kohm,5%,1/16W,TP,1005	2	SNA	
...4	MR16	2007-000168	R-CHIP;470Kohm,5%,1/16W,TP,1005	1	SNA	
...4	R509	2007-000170	R-CHIP;1Mohm,5%,1/16W,TP,1005	1	SNA	
...4	R111	2007-000171	R-CHIP;0ohm,5%,1/16W,TP,1005	10	SNA	
...4	HDR17	2007-000172	R-CHIP;10ohm,5%,1/16W,TP,1005	4	SNA	
...4	R338	2007-000173	R-CHIP;22ohm,5%,1/16W,TP,1005	11	SNA	

5. Exploded View & Part List

Level	Location No.	Code No.	Description & Specification	Q'ty	SA/SNA	Remark
...4	UR23	2007-000174	R-CHIP;47ohm,5%,1/16W,TP,1005	2	SNA	
...4	MR9	2007-000455	R-CHIP;18Kohm,1%,1/10W,TP,1608	1	SA	
...4	ER13	2007-000669	R-CHIP;2Kohm,1%,1/10W,TP,1608	1	SNA	
...4	R726	2007-000695	R-CHIP;3.3ohm,5%,1/10W,TP,1608	1	SNA	
...4		2007-000755	R-CHIP;330Kohm,1%,1/10W,TP,1608	1	SA	
...4	R124	2007-000775	R-CHIP;33Kohm,5%,1/16W,TP,1005	3	SNA	
...4	HR3	2007-000903	R-CHIP;430ohm,1%,1/10W,TP,1608	1	SNA	
...4	DR37	2007-000932	R-CHIP;470ohm,5%,1/16W,TP,1005	1	SNA	
...4		2007-001285	R-CHIP;5.6ohm,5%,1/16W,TP,1005	4	SA	
...4	OTR1	2007-001292	R-CHIP;33ohm,5%,1/16W,TP,1005	9	SNA	
...4	DR43	2007-001298	R-CHIP;51ohm,5%,1/16W,TP,1005	1	SNA	
...4		2007-001317	R-CHIP;910ohm,5%,1/16W,TP,1005	1	SNA	
...4	R326	2007-001325	R-CHIP;3.3Kohm,5%,1/16W,TP,1005	11	SNA	
...4		2007-002768	R-CHIP;6.2Kohm,1%,1/10W,TP,1608	1	SA	
...4	MR316	2007-002796	R-CHIP;510ohm,5%,1/16W,TP,1005	1	SA	
...4	PR24	2007-002970	R-CHIP;56ohm,5%,1/16W,TP,1005	2	SA	
...4	TR30	2007-007009	R-CHIP;75ohm,5%,1/16W,TP,1005	11	SA	
...4		2007-007134	R-CHIP;39Kohm,1%,1/16W,TP,1005	1	SA	
...4		2007-007135	R-CHIP;18Kohm,1%,1/16W,TP,1005	1	SNA	
...4	DR4	2007-007142	R-CHIP;10Kohm,1%,1/16W,TP,1005	3	SNA	
...4		2007-007156	R-CHIP;1ohm,5%,1/16W,TP,1005	6	SNA	
...4		2007-007316	R-CHIP;3.3Kohm,1%,1/16W,TP,1005	1	SNA	
...4		2007-007317	R-CHIP;2.2Kohm,1%,1/16W,TP,1005	1	SA	
...4		2007-007318	R-CHIP;1Kohm,1%,1/16W,TP,1005	8	SNA	
...4		2007-007334	R-CHIP;200Kohm,1%,1/16W,TP,1005	4	SNA	
...4	MR11	2007-008015	R-CHIP;75ohm,1%,1/16W,TP,1005	13	SNA	
...4		2007-008134	R-CHIP;12.4Kohm,1%,1/16W,TP,1005	1	SC	
...4		2007-008275	R-CHIP;30Kohm,1%,1/16W,TP,1005	1	SNA	
...4		2007-008298	R-CHIP;49.9ohm,1%,1/16W,TP,1005	4	SA	
...4		2007-008563	R-CHIP;270ohm,1%,1/16W,TP,1005	1	SA	
...4		2007-008593	R-CHIP;750ohm,1%,1/16W,TP,1005	1	SA	
...4	ZRN10	2011-001261	R-NETWORK;33ohm,5%,1/16W,L,CHIP,8P,TP,2.	6	SA	
...4	DAR09	2011-001262	R-NETWORK;22ohm,5%,1/16W,L,CHIP,8P,TP,2.	5	SA	
...4		2011-001448	R-NETWORK;10ohm,5%,1/16W,L,4P,T,1010	4	SA	
...4		2011-001449	R-NETWORK;22ohm,5%,1/16W,L,4P,TP,1010	8	SA	
...4	DRP9	2011-001474	R-NETWORK;47ohm,5%,1/16W,L,CHIP,8P,TP,2.	1	SA	
...4		2011-001519	R-NETWORK;33OHM,5%,1/16W,L,CHIP,4P,TP,1.	2	SA	
...4		2011-001527	R-NETWORK;4.7Kohm,5%,1/16W,L,CHIP,4P,TP,	7	SNA	
...4		2011-001589	R-NETWORK;0ohm,5%,1/16W,L,CHIP-V,4P,TP,1	16	SNA	
...4	DC30	2203-000138	C-CER,CHIP;1.5nF,10%,50V,X7R,TP,1005,-	2	SNA	
...4	PC43	2203-000233	C-CER,CHIP;0.1nF,5%,50V,C0G,TP,1005	4	SA	
...4	MC302	2203-000425	C-CER,CHIP;0.18nF,5%,50V,C0G,TP,1005	4	SA	
...4	C254	2203-000438	C-CER,CHIP;1nF,10%,50V,X7R,TP,1005	13	SA	
...4	AC139	2203-000491	C-CER,CHIP;2.2nF,10%,50V,X7R,1608	2	SA	
...4	V1233	2203-000575	C-CER,CHIP;220nF,10%,25V,X7R,TP,2012	6	SNA	
...4	MC9	2203-000627	C-CER,CHIP;0.22nF,5%,50V,C0G,TP,1005	2	SNA	
...4	DC374	2203-000659	C-CER,CHIP;0.27nF,5%,50V,C0G,1608	1	SA	
...4	AD480	2203-000679	C-CER,CHIP;0.027nF,5%,50V,C0G,1005	1	SA	
...4	DC25	2203-000812	C-CER,CHIP;0.33nF,5%,50V,C0G,1005	11	SA	
...4	CK40B	2203-000838	C-CER,CHIP;0.39nF,5%,50V,C0G,TP,1608	3	SNA	
...4	KFC6	2203-000872	C-CER,CHIP;0.0030nF,0.25pF,50V,C0G,1608	2	SNA	

5. Exploded View & Part List

Level	Location No.	Code No.	Description & Specification	Q'ty	SA/SNA	Remark
...4	HDC5	2203-001072	C-CER,CHIP;0.056nF,5%,50V,NP0,1005	4	SA	
...4	C101	2203-001124	C-CER,CHIP;0.68nF,10%,50V,X7R,TP,1005	1	SA	
...4	DC87	2203-001153	C-CER,CHIP;.068nF,5%,50V,NP0,1005	2	SA	
...4	AD480	2203-001428	C-CER,CHIP;470nF,10%,50V,X7R,TP,2012	2	SNA	
...4	AD480	2203-002285	C-CER,CHIP;10nF,10%,50V,X7R,1005	17	SNA	
...4	AD480	2203-002525	C-CER,CHIP;0.56nF,10%,50V,X7R,TP,1005	8	SNA	
...4	C711	2203-002982	C-CER,CHIP;6.8nF,10%,50V,X7R,1005	1	SA	
...4	AAC1	2203-005249	C-CER,CHIP;100nF,10%,50V,X7R,TP,1608	7	SNA	
...4	DC9	2203-005481	C-CER,CHIP;47nF,10%,10V,X7R,TP,1005	3	SA	
...4	AD480	2203-005511	C-CER,CHIP;27nF,10%,10V,X7R,TP,1005	1	SA	
...4	AD480	2203-005968	C-CER,CHIP;4.7nF,10%,50V,X7R,TP,1005	1	SNA	
...4	PC11	2203-006141	C-CER,CHIP;1000nF,10%,16V,X5R,1608	1	SNA	
...4	C102	2203-006158	C-CER,CHIP;100nF,10%,16V,X7R,1005	130	SNA	
...4	JC10	2203-006324	C-CER,CHIP;2200nF,10%,10V,X5R,1608	2	SA	
...4	AD480	2203-006336	C-CER,CHIP;10000nF,10%,25V,X5R,3216	18	SA	
...4	C125	2203-006361	C-CER,CHIP;10000nF,10%,10V,X5R,TP,2012	50	SC	
...4	HE4	2203-006474	C-CER,CHIP;22000nF,20%,6.3V,X5R,2012	3	SA	
...4	HDC11	2203-006562	C-CER,CHIP;1000nF,10%,10V,X5R,TP,1005	15	SNA	
...4	AD480	2203-006824	C-CER,CHIP;4700nF,10%,10V,X5R,1608	1	SNA	
...4	AD480	2203-006841	C-CER,CHIP;1000nF,10%,16V,X5R,1005	16	SNA	
...4	AD480	2203-006992	C-CER,CHIP;0.33nF,5%,50V,C0G,TP,1005	2	SNA	
...4	T0052	2703-000158	INDUCTOR-SMD;1uH,10%,2012	4	SA	
...4	T0052	2703-000296	INDUCTOR-SMD;680nH,10%,1608	1	SA	
...4	VL6	2703-000398	INDUCTOR-SMD;10uH,10%,3225	5	SA	
...4	L1103	2703-000403	INDUCTOR-SMD;22uH,10%,3225	1	SA	
...4	T0052	2703-001239	INDUCTOR-SMD;3.3uH,10%,1608	3	SA	
...4	L607	2703-001254	INDUCTOR-SMD;1.8uH,10%,2012	1	SA	
...4	T0052	2703-002268	INDUCTOR-SMD;8.2nH,5%,1005	4	SNA	
...4	T0052	2703-003149	INDUCTOR-SMD;2.2uH,20%,5050	2	SA	
...4	T0052	2703-003150	INDUCTOR-SMD;4.7uH,20%,5050	4	SNA	
...4	X202	2801-003326	CRYSTAL-SMD;24MHz,30ppm,28-ABX,20pF,50oh	1	SA	
...4	X202	2801-004004	CRYSTAL-SMD;20.25MHz,20ppm,28-AAN,13pF,2	1	SA	
...4	X202	2801-004775	CRYSTAL-SMD;12MHz,30ppm,16pF,30ohm,TP	1	SNA	
...4	F103	2901-001506	FILTER-EMI SMD;5V,0.13A,0pF,2x1x0.5mm,TP	2	SA	
...4	T0568	3301-001236	BEAD-SMD;60ohm,1608	7	SNA	
...4	T0568	3301-002039	BEAD-SMD;26ohm,1608,TP	37	SA	
...4		3601-001374	FUSE-SURFACE MOUNT;32V,5A,FAST-ACTING,Hi	1	SNA	
...4		3701-001591	CONNECTOR-HDMI;19P,2ROW,FEMALE,SMD-S,AU	3	SNA	
...4		3701-001693	CONNECTOR-HDMI;19P,2ROW,FEMALE,SMD-A	1	SA	
...4	AC510	3708-002797	CONNECTOR-FPC/FFC/PIC;51P,0.50mm,SMD,AU,	1	SA	
...4	CON_US	3711-005616	HEADER-BOARD TO CABLE;BOX,10P,1R,2mm,SMD	1	SNA	
...4	HB01A	3711-007336	HEADER-BOARD TO CABLE;BOX,4P,1R,2.5mm,SM	1	SA	
...4		BN41-01331B	PCB MAIN;SX1 DVB (4/5series),FR-4,4,1.0,	1	SNA	
...4		BN97-04023A	ASSY MICOM-MAIN;N82A,2009.11.10,T-TDT5DE	1	SNA	
....5		1107-001818	IC-NAND FLASH;KFG1G16U2C-DIB6,1024Mbit,6	1	SNA	
...4		BN97-04024A	ASSY MICOM-SUB;N82A,2009.11.10,T-TDT5DEU	1	SNA	
....5	IC115	1107-001580	IC-FLASH MEMORY;MX25L4005,4Mbit,512Kx8,S	1	SNA	
...3		BN97-04098A	ASSY CI PLUS;BN46-00025A,LC5F,SX1 platfo	1	SNA	
...4		BN46-00025A	KEY CODE-CI PLUS KEY;CI PLUS KEY,TCTC,SE	1	SNA	
0.1		BN91-04915A	ASSY LCD-AUO;BN07-00832A	1	SNA	
..2	M0215	BN07-00832A	LCD-PANEL;T460HW03 VJ,AU46H3J,8bit,46,16	1	SA	

5. Exploded View & Part List

Level	Location No.	Code No.	Description & Specification	Q'ty	SA/SNA	Remark
...3	TCON	BN81-04413A	A/S-T CON T460HW03_VJ;T460HW03 VJ	1	SA	
...3	INVER	BN81-04443A	A/S-BB-L T460HW03 VJ;T460HW03 VJ	1	SA	
0.1		BN91-05091A	ASSY SHIELD;LE46C550J1WX*	1	SNA	
..2	T0081	6001-002284	SCREW-MACHINE;BH,+,M4,L8,ZPC(WHT),SWRCH1	10	SA	
..2	M0081	6003-000337	SCREW-TAPTYPE;BH,+,S,M4,L10,ZPC(BLK),SWR	6	SA	
..2	M0081	6003-001003	SCREW-TAPTYPE;BH,+,B,M4,L12,ZPC(BLK),SWR	6	SA	
..2	M2893	BN39-01267F	LEAD CONNECTOR;LB6T,UL2651#26,18P,350mm,	1	SA	
..2	P001A	BN44-00341B	IP BOARD-TV;I46F1_AHS,I46F1_AHS,14mA,16m	1	SA	
..2		BN61-06023A	HOLDER-SIDE AV;LC450 32,EO,PC+ABS,V0,BK0	1	SNA	
...3		0103-005041	RESIN-PC;V0,PC+ABS	21	SNA	
..2	M0523	BN96-12974A	ASSY BRACKET P-WALL;46,52,55,LC650,SECC,	4	SNA	
...3	T0101	BN61-05997A	BRACKET-WALL;LC650 46,SECC,T1.6	4	SNA	
...3		BN60-00188A	SPACER-FOAM;LCD,FELT,20,3.0,30,Center :	4	SNA	
..2	M0230	BN96-13171D	ASSY CABLE P-FFC;LN46C530F1FXZA,FFC,0.5m	1	SA	
..2	M2893	BN39-01024E	LEAD CONNECTOR;LC5F,UL3239#24,2P,175mm,1	1	SA	
..2	T0081	6001-002604	SCREW-MACHINE;BH,+,M4,L10,ZPC(WHT),SWRCH	2	SA	
..2		BN61-06441A	HOLDER-INLET;LC530,ABS,V0	1	SNA	
...3		0103-004627	RESIN-ABS;VE-0812/K2901,BK0020,V0,ABS,No	18	SNA	
..2	M2893	BN39-01279F	LEAD CONNECTOR;LN46C650L1FXZA,UL1061 #28	1	SA	
..2		BN61-06559A	HOLDER-GROUND;LC550,SUS304,0.3	2	SNA	
..2		BN73-00273B	SILICON/RUBBER-GAPPAD;UE32C6500,SILICON+	1	SNA	
..2	SB05A	BN96-13342C	ASSY BRACKET P-STAND LINK;LC530,550,46,G	1	SNA	
...3		BN61-02429K	STUD-PEM;PNB,M3.8,D7,L14.9,ZPC(SIL),SUM2	2	SNA	
...3		BN61-05281A	HOLDER-CLAMP;LCD,NYLON 66,WHT	3	SNA	
...3	M0115	BN61-05998A	BRACKET-STAND LINK;LC650 46,SECC,T1.6	1	SNA	
...3	T0073	AA63-01109C	GASKET-EMI;42D5,T0.5,10,25,45Kg/m3,Fabri	2	SNA	
0.1		BN92-05722A	ASSY LABEL;LN32C550J1FX*,37,40,46	1	SNA	
..2	T0527	BP68-00052B	LABEL-00,RATING;CCTV,TETRON PAPER,T0.05,	1	SNA	
..2		AA68-03752D	LABEL-STICKER;WW,ALL,Art Paper(90g),44.5	1	SNA	
0.1	ACCE1	BN92-05798W	ASSY ACCESSORY;LE46C550J1WXZT	1	SNA	
..2		BN96-13269J	ASSY ACCESSORY-MANUAL;LE32C550J1WXZT,37,	1	SNA	
...3	T0524	6902-000110	BAG PE;LDPE,T0.05,W250,L400,TRP,28,2,9.2	1	SNA	
...3	T0527	BN68-00513A	LABEL-E,PASS;ALL MODEL,YUPO(110G),50X15,	1	SNA	
...3		BN68-00514E	MANUAL FLYER-05,WARRANTY CARD;comm,Samsu	1	SNA	
...3		BN68-02186A	MANUAL FLYER-TOC GUIDE;COMM,SAMSUNG,11 L	1	SNA	
...3		BN68-02688G	MANUAL USERS;C550,SAMSUNG,4LANGS,ZT,W/P	1	SNA	
...3		AA68-03242V	MANUAL FLYER-SAFETY GUIDE;comm,Samsung,1	1	SNA	
..2	ACCE2	BN96-13269U	ASSY ACCESSORY-CABLE;LE46C550J1WX*	1	SNA	
...3	T0268	3903-000456	CBF-POWER CORD;DT,EU/KR,CP3,IEC320 C13-R	1	SA	
...3	T0120	4301-000121	BATTERY-MN;1.5V,R03,10.5x44.5m,HOLDER,7.	2	SNA	
...3	REMO2	BN59-01014A	REMOCON;TM1050,SAMSUNG,20PIN SINGLE,48KE	1	SA	
...3		BN61-05596A	HOLDER-WIRE CABLE;LED TV,LDPE,T0.8,L150,	1	SNA	
...3	M9889	BN63-01798B	CLOTH-CLEAN;cloth,180,200,sea blue,ToC	1	SA	
...3	T0527	BN68-00513A	LABEL-E,PASS;ALL MODEL,YUPO(110G),50X15,	1	SNA	
...3	T0010	BN96-08624A	ASSY HOLDER P;08 PDP MODEL,ABS HB,GRAY	1	SNA	
...4		6902-000683	BAG ZIPPER;LDPE,T0.05,W60,L60,TRP,4-PE M	1	SNA	
...4	T0010	BN61-04529A	HOLDER-RING;ABS, HB,GRAY	4	SNA	
...3	T0531	BN63-06339B	COVER-BOTTOM;37,40,46,LC650,HIPS,V0,BK00	1	SA	
...4		0103-004637	RESIN-HIPS;BK0020,V0,HIPS,NoN-Deca,NoN-D	70	SNA	
...3	T0524	6902-000110	BAG PE;LDPE,T0.05,W250,L400,TRP,28,2,9.2	1	SNA	
0.1		BN92-05857A	ASSY P/MATERIAL;46,LC650	1	SNA	

5. Exploded View & Part List

Level	Location No.	Code No.	Description & Specification	Q'ty	SA/SNA	Remark
..2	T0214	0203-001595	TAPE-OPP MASKING;OPP-2,0.075,75,800M,CLR	3.03	SNA	
..2		6902-000604	BAG WRAPPING;LDPE,T0.02,W500,L10000,TRP,	4.07	SNA	
..2	M040	6922-000003	BAND PP;PP,T0.8,W18,L1650M,TRP,DA69-9014	0.89	SNA	
..2		BN69-00257E	PACKING-BAG SHEET;-,-,CB,-,1400,500,-,-,WH	1	SNA	
..2		BN69-03982C	PAD PACKING-EDGE;LB6T,PAPER,8,120,1690,Y	1	SNA	
..2	T0246	BN69-04339A	CUSHION-01,SET;46LC550/630/640/650/670-G	1	SNA	
..2		BN68-02422B	LABEL-WARNING SHIPPING;ALL MODEL,A/P 100	1	SNA	
..2		6902-001183	BAG PE;HDPE/NITRON,T0.015/T0.5,W1300,L90	1	SNA	
..2		BN69-00257C	PACKING-PAD;PAPER,CB-SW4,1350,830,YEL,36	1	SNA	
..2		BN69-04451A	PALLET;-,-,WOOD,1040,1360,135,14000,-,-,SESK	1	SNA	
..2		6902-000379	BAG AIR;LDPE,T0.2,W1000,L1800,TRP,1260.0	1	SNA	
0.1		BN92-05898C	ASSY BOX;46,LC550,EO	1	SNA	
..2		BN69-04653D	BOX-SET;46LC550-S,CB,A-01,DW2,ECT50,YEL,	1	SNA	
..2		BH68-00662A	LABEL BOX-00;ALL MODEL,MOJO 90G,60,110,W	1	SNA	