

6 Electrical Parts List

-You can search for updated part codes through ITSELF web site.

URL : <http://itself.sec.samsung.co.kr/>

6-1 LE40R86BDX Parts List

Level	Loc. No.	Code No.	Description & Specification	Q'ty	SA/SNA
		LE40R86BDX/XEC	LE40R86BD,N30A/40R80-GBP,40,LCD-TV,SPAIN		
0.1	M0001	BN90-01143B	ASSY COVER FRONT;40R86,EO(IDTV),-,ABS+PM	1	S.N.A
..2	T0003	BN96-04656B	ASSY COVER P-FRONT;40R86,EO(IDTV),-,ABS+	1	S.A
...3	T0081	6002-001294	SCREW-TAPPING;BH,+,M4,L16,ZPC(BLK)	2	S.A
...3	M0081	6003-001188	SCREW-TAPTITE;BH,+,B,M4,L10,ZPC(WHT),S	1	S.N.A
...3	CCM1	BN63-02183G	COVER-SHEET;Rhc,PE Vinyl,T0.05,1100mm,2	1.983	S.N.A
...3	M0112	BN63-03112B	COVER-FRONT;40R81,EO(IDTV),ABS+PMMA,-,-,	1	S.N.A
...3	T0603	BN64-00588A	WINDOW-RMC;32,BORDEAUX PLUS,PC,-,-,HB,	1	S.N.A
...3		BN96-04700A	ASSY HOLDER P-BOSS;37,40R81,-,HIPS,HB,-,	1	S.N.A
...4		BN61-02959A	HOLDER-BOSS BOTTOM;37,40R81,HIPS,HB,-,-,	1	S.N.A
...4	T0069	AA60-00091M	SPACER-FELT,-,FELT,35X10,-,-,BLK,T0.5,-,	4	S.N.A
...4		BN61-03261A	BOSS-TAPE;Tulip,ACRYL,T1.1,W12mm,GRAY,TA	1.45	S.N.A
...3		BN96-04802A	ASSY MISC P-BLU;Bordeaux Plus.BACK LIGHT	1	S.N.A
...3	M0145	BN96-04809C	ASSY BOARD P-FUNCTION&R;LE40R81BDX,CT50	1	S.A
...3	T0056	BN63-03417A	COVER-DECORATION;40 BORDEAUX PLUS,PC,CLE	1	S.N.A
...3	T0069	AA60-00091J	SPACER-FELT,-,FELT,330X10,-,-,BLK,T0.5,-,	5	S.N.A
...3	T0069	BN60-00051C	SPACER-FELT;FELT,L70,BLK,T0.5,W4	2	S.N.A
..2	T0175	BN96-04768A	ASSY SPEAKER P;8ohm,4pin,10W,Bordeaux PI	1	S.A
0.1	M0216	BN90-01148A	ASSY STAND;37,40R81,SWIVEL,-,-,-,-	1	S.N.A
..2	T0081	6002-001294	SCREW-TAPPING;BH,+,M4,L16,ZPC(BLK)	4	S.A
..2	M0027	BN96-04661A	ASSY STAND P-BASE;37,40R81,SWIVEL,-,ABS+	1	S.A
...3	T0081	6002-001294	SCREW-TAPPING;BH,+,M4,L16,ZPC(BLK)	4	S.A
...3	M0081	6003-001239	SCREW-TAPTITE;FH,+,B,M4,L10,ZPC(WHT),S	8	S.A
...3		BN61-02248A	HOLDER-SWIVEL RING;40R71,ACETAL NATUAL,T	1	S.N.A
...3		BN61-02883A	BRACKET-STAND BOTTOM;BORDEAUX PLUS,40,SE	1	S.N.A
...3		BN61-02885A	HOLDER-SWIVEL RING;MURANO40,ACETAL NATUR	1	S.N.A
...3		BN61-02886A	BRACKET-HINGE SWIVEL;BORDEAUX PLUS,40,SE	1	S.N.A
...3	T0920	BN61-02984A	GUIDE-STAND;40R81,ABS,V0,-,-,BK500,-	1	S.N.A
...4		BN61-02981A	BRACKET-SUPPORT STAND;40 BORDEAUX PLUS,S	1	S.N.A
...4		BN61-03045A	BRACKET-SUPPORT STAND;40 BORDEAUX PLUS,S	1	S.N.A
...3	CCM1	BN63-02183E	COVER-SHEET;Rhc,PE Vinyl,T0.05,750mm,20	0.5	S.N.A
...3	T0004	BN63-03030A	COVER-STAND BASE;40R81,ABS+PMMA,-,-,HB	1	S.N.A
...3	T0132	BN73-00052A	RUBBER FOOT;ARES 17,CR Rubber Gray,T1.5	4	S.N.A
0.1	M0002	BN90-01151B	ASSY COVER REAR;40R81,EO(IDTV),-,ABS+PMM	1	S.N.A
..2	T0081	6002-001294	SCREW-TAPPING;BH,+,M4,L16,ZPC(BLK)	2	S.A
..2	T0081	6002-001294	SCREW-TAPPING;BH,+,M4,L16,ZPC(BLK)	1	S.A
..2	T0081	6002-001294	SCREW-TAPPING;BH,+,M4,L16,ZPC(BLK)	12	S.A
..2	M0013	BN96-04669A	ASSY COVER P-REAR;40R81,EO(IDTV),-,ABS+P	1	S.A
...3	M0081	6003-001188	SCREW-TAPTITE;BH,+,B,M4,L10,ZPC(WHT),S	2	S.N.A
...3	CCM1	BN63-02183G	COVER-SHEET;Rhc,PE Vinyl,T0.05,1100mm,2	0.99	S.N.A
...3	M0006	BN63-03166A	COVER-REAR;40R81,EO(IDTV),ABS+PMMA,-,-,	1	S.N.A
...3	T0071	BN64-00555B	INLAY-TERMINAL;07,COMMON,EO(IDTV),PS SHE	1	S.N.A
...3	T0064	BN65-00002A	CLAMPER CORE;BORDEAUX,PP,V0,BLK	1	S.N.A
...3	T0069	AA60-00091F	SPACER-FELT,-,FELT,150X10,-,-,BLK,T0.5,-,	2	S.N.A
...3	T0101	BN61-03348A	BRACKET-WALL;LCD TV 32",SECC T1.6	2	S.N.A
0.1		BN91-01329A	ASSY SHIELD-SQE;LE40R86BDX/*	1	S.N.A
..2	M0081	6003-000115	SCREW-TAPTITE;BH,+,B,M3,L6,ZPC(BLK),SWRC	1	S.A
..2	M0081	6003-000115	SCREW-TAPTITE;BH,+,B,M3,L6,ZPC(BLK),SWRC	6	S.A
..2	M0081	6003-000115	SCREW-TAPTITE;BH,+,B,M3,L6,ZPC(BLK),SWRC	6	S.A
..2	M0081	6003-000115	SCREW-TAPTITE;BH,+,B,M3,L6,ZPC(BLK),SWRC	1	S.A
..2	M0081	6003-000337	SCREW-TAPTITE;BH,+,S,M4,L10,ZPC(BLK),SWR	5	S.A
..2	M0081	6003-001188	SCREW-TAPTITE;BH,+,B,M4,L10,ZPC(WHT),S	2	S.N.A

6 Electrical Parts List

Level	Loc. No.	Code No.	Description & Specification	Q'ty	SA/SNA
..2	M0081	6003-001188	SCREW-TAPTITE;BH,+,-,B,M4,L10,ZPC(WHT),S	13	S.N.A
..2	M0081	6003-001439	SCREW-TAPTITE;BH,+,-,S,M4,L8,ZPC(WHT),SW	1	S.N.A
..2	M2893	BH39-00362G	LEAD CONNECTOR;SONOMA,UL1007#26,5PIN,100	1	S.A
..2	M2893	BN39-00802B	LEAD CONNECTOR;LE40R86BDX,UL1007#26,24PI	1	S.A
..2	M0174	BN44-00165A	IP BOARD;IP-231135A,40" TULIP,44mA,86mA,	1	S.A
..2	M0146	BN61-02256B	BRACKET-PANEL SIDE;Bordeaux 40,SECC,T1.2	1	S.N.A
..2	M0146	BN61-02257B	BRACKET-PANEL SIDE;Bordeaux 40,SECC,T1.2	1	S.N.A
..2	M0114	BN61-02500A	HOLDER-WIRE;NYLON6.6,NATURAL	2	S.N.A
..2	M0115	BN61-02882A	BRACKET-STAND LINK;TULIP,40,SECC,T1.6,-,	1	S.A
..2		BN61-02952B	HOLDER-SIDE AV;07 COMMON,EO,ABS+PMMA,HB,	1	S.N.A
..2	M0107	BN63-03039A	SHIELD-COVER;MURANO40,PCM,T0.5,IDTV	1	S.N.A
..2	M2893	BN39-00829A	LEAD CONNECTOR;LNT4042HX/XAA,UL1061#28,5	1	S.A
..2	M2893	BN39-00716B	LEAD CONNECTOR;LE40R71BX/XEC,UL3239#24,2	1	S.A
..2	M2893	BN39-00889A	LEAD CONNECTOR;LE40R86BDX,UL1571#30,30P,	1	S.A
..2	T0447	BN96-04679D	ASSY BRACKET P-PANEL;40R81,IP BOARD,SPAC	1	S.A
...3	M0081	6003-000115	SCREW-TAPTITE;BH,+,-,B,M3,L6,ZPC(BLK),SWRC	1	S.A
...3	M0081	6003-000115	SCREW-TAPTITE;BH,+,-,B,M3,L6,ZPC(BLK),SWRC	2	S.A
...3		BN61-02963A	BRACKET-GUIDE POWER;40 BORDEAUX PLUS,SEC	1	S.N.A
...3	T0101	BN61-02968A	BRACKET-WALL;40 BORDEAUX PLUS,SECC,T1.2,	1	S.N.A
...3	M0146	BN61-02972A	BRACKET-PANEL TOP;40 BORDEAUX PLUS,SECC,	1	S.N.A
...3		BN61-02975A	BRACKET-GUIDE POWER;40 BORDEAUX PLUS,SEC	1	S.N.A
...3		BN61-02979A	BRACKET-PANEL BOTTOM;40 BORDEAUX PLUS,SE	1	S.N.A
...3		BN61-02982A	BRACKET-GUIDE MAIN;40 BORDEAUX PLUS,SECC	1	S.N.A
...3	M0107	BN61-03036A	BRACKET-PCB;40 BORDEAUX PLUS,SECC,T1.2,S	1	S.N.A
...3	M0131	BN63-02628A	GASKET;Oxford,Conductive Fabric,8,12,300	1	S.N.A
...3	M0131	BN63-03327A	GASKET;BORDEAUX PLUS,Conductive Fabric,2	2	S.N.A
...3	T0069	BP60-00015D	SPACER-FELT;617W,FELT,L760,T0.5,W10	1	S.N.A
..2	T0275	BN96-05361A	ASSY MISC P-INLET;LE37M87BDX/XEC,200/150	1	S.N.A
0.1		BN91-01702B	ASSY LCD-AMLCD;LNT4042HX*	1	S.N.A
..2	M0215	BN07-00451A	LCD-PANEL;LTA400WT-L07,8bit,40inch,16.7M	1	S.A
0.1	M0017	BN91-01770B	ASSY CHASSIS;LE40R86BDX*	1	S.A
..2	M0014	BN94-01472B	ASSY PCB MAIN-AMLCD VE;LE40R86BDX*	1	S.N.A
...3	T0245	0202-001492	SOLDER-WIRE FLUX;HSE-02 LFM48 SR-34 S,-,	0.25	S.N.A
...3	JA1410_NSI	3701-001388	CONNECTOR-HDMI;20P,Phosphor Bronze,ANGLE	1	S.A
...3	JA1406_OP	3701-001400	CONNECTOR-DSUB;15P,3R,FEMALE,STRAIGHT,Ni	1	S.A
...3	CN906	3707-001081	CONNECTOR-OPTICAL;STRAIGHT,SPDIF	1	S.A
...3	JA3201_OP	3709-001477	CONNECTOR-CARD SLOT;68P,1.27mm,ANGLE,AU,	1	S.A
...3	CN330	3711-000058	HEADER-BOARD TO CABLE;BOX,4P,1R,2.5MM,AN	1	S.A
...3	CN330	3711-004484	HEADER-BOARD TO CABLE;BOX,5P,1R,2mm,STRA	1	S.A
...3	CN330	3711-004531	HEADER-BOARD TO CABLE;BOX,10P,1R,2mm,ANG	1	S.A
...3	CN330	3711-005606	HEADER-BOARD TO CABLE;BOX,30P,2R,2mm,STR	1	S.A
...3	CN330	3711-005842	HEADER-BOARD TO CABLE;BOX,24P,2R,2MM,STR	1	S.A
...3	JA330	3722-000143	JACK-PHONE;1P(VER),AG,BLK,ANGLE	1	S.A
...3	JA1601_EU	3722-000498	JACK-SCART;21P,-,SN,BLK,NO	1	S.A
...3	JA1608_EU	3722-000498	JACK-SCART;21P,-,SN,BLK,NO	1	S.A
...3	JA330	3722-001061	JACK-PHONE;1P,3.6PI,AG,BLK,N	1	S.A
...3	JA330	3722-001061	JACK-PHONE;1P,3.6PI,AG,BLK,N	1	S.A
...3	JA332	3722-001163	JACK-VHS;4P,AU,BLK,ANGLE	1	S.A
...3	JA333	3722-002360	JACK-PIN;3P,AU,GRN/BLU/RED,STRAIGHT	1	S.A
...3	JA333	3722-002362	JACK-PIN;2P,Sn,WHT/RED,STRAIGHT	1	S.A
...3	JA333	3722-002362	JACK-PIN;2P,Sn,WHT/RED,STRAIGHT	1	S.A
...3	JA333	3722-002362	JACK-PIN;2P,Sn,WHT/RED,STRAIGHT	1	S.A
...3	JA333	3722-002543	JACK-PIN;3P,Sn,RED/WHT/YEL,ANGLE	1	S.A
...3	CIS3	BN40-00096A	TUNER;DNOS403MH261B(S),PAL Hyper,181CH,	1	S.A
...3	T0603	BN63-02494A	SHIELD-PCB MAIN;MOSEL 40",SPTE,T0.3,EURO	1	S.N.A
...3	T0603	BN63-03197A	SHIELD-PCB MAIN;TULIP PAL,SPTE,T0.5	1	S.N.A
...3	M0131	BN63-03549A	GASKET;BORDEAUX PLUS,Conductive Fabric,1	1	S.N.A
...3	CCMM1	BN73-00024D	SILICON/RUBBER;BORDEAUX,SILICON,28x28X76	1	S.N.A
...3	CCMM1	BN73-00151A	SILICON/RUBBER;GP1500 380MIL,20X20X9.5T	1	S.N.A
...3	T0174	BN97-01773B	ASSY SMD;LE40R86BDX*	1	S.N.A

Level	Loc. No.	Code No.	Description & Specification	Q'ty	SA/SNA
....4	SUB05	0202-001477	SOLDER-CREAM;LST309-M,-,D20~45\$,96.5Sn/	4.57	S.N.A
....4	D1107	0401-000133	DIODE-SWITCHING;RLS4148,75V,150mA,LL-34,	1	S.A
....4	D1204	0401-000133	DIODE-SWITCHING;RLS4148,75V,150mA,LL-34,	1	S.A
....4	D1208	0401-000133	DIODE-SWITCHING;RLS4148,75V,150mA,LL-34,	1	S.A
....4	D1209	0401-000133	DIODE-SWITCHING;RLS4148,75V,150mA,LL-34,	1	S.A
....4	D1210	0401-000133	DIODE-SWITCHING;RLS4148,75V,150mA,LL-34,	1	S.A
....4	D1211	0401-000133	DIODE-SWITCHING;RLS4148,75V,150mA,LL-34,	1	S.A
....4	D1212	0401-000133	DIODE-SWITCHING;RLS4148,75V,150mA,LL-34,	1	S.A
....4	D1213	0401-000133	DIODE-SWITCHING;RLS4148,75V,150mA,LL-34,	1	S.A
....4	D1214	0401-000133	DIODE-SWITCHING;RLS4148,75V,150mA,LL-34,	1	S.A
....4	D1218	0401-000133	DIODE-SWITCHING;RLS4148,75V,150mA,LL-34,	1	S.A
....4	D1219	0401-000133	DIODE-SWITCHING;RLS4148,75V,150mA,LL-34,	1	S.A
....4	D1640	0401-000133	DIODE-SWITCHING;RLS4148,75V,150mA,LL-34,	1	S.A
....4	D1641	0401-000133	DIODE-SWITCHING;RLS4148,75V,150mA,LL-34,	1	S.A
....4	D2201_LUX	0401-000133	DIODE-SWITCHING;RLS4148,75V,150mA,LL-34,	1	S.A
....4	D1101	0401-001056	DIODE-SWITCHING;MMBD4148SE,100V,200mA,SO	1	S.A
....4	D1403	0401-001056	DIODE-SWITCHING;MMBD4148SE,100V,200mA,SO	1	S.A
....4	D1404	0401-001056	DIODE-SWITCHING;MMBD4148SE,100V,200mA,SO	1	S.A
....4	D1407	0401-001056	DIODE-SWITCHING;MMBD4148SE,100V,200mA,SO	1	S.A
....4	D1410	0401-001056	DIODE-SWITCHING;MMBD4148SE,100V,200mA,SO	1	S.A
....4	D1411	0401-001056	DIODE-SWITCHING;MMBD4148SE,100V,200mA,SO	1	S.A
....4	D1412	0401-001056	DIODE-SWITCHING;MMBD4148SE,100V,200mA,SO	1	S.A
....4	D1424	0401-001056	DIODE-SWITCHING;MMBD4148SE,100V,200mA,SO	1	S.A
....4	D1425	0401-001056	DIODE-SWITCHING;MMBD4148SE,100V,200mA,SO	1	S.A
....4	D1426	0401-001056	DIODE-SWITCHING;MMBD4148SE,100V,200mA,SO	1	S.A
....4	D1434	0401-001056	DIODE-SWITCHING;MMBD4148SE,100V,200mA,SO	1	S.A
....4	D1435	0401-001056	DIODE-SWITCHING;MMBD4148SE,100V,200mA,SO	1	S.A
....4	D1450_NSID	0401-001056	DIODE-SWITCHING;MMBD4148SE,100V,200mA,SO	1	S.A
....4	D1451_NSID	0401-001056	DIODE-SWITCHING;MMBD4148SE,100V,200mA,SO	1	S.A
....4	D1472	0401-001056	DIODE-SWITCHING;MMBD4148SE,100V,200mA,SO	1	S.A
....4	D1473	0401-001056	DIODE-SWITCHING;MMBD4148SE,100V,200mA,SO	1	S.A
....4	D1474	0401-001056	DIODE-SWITCHING;MMBD4148SE,100V,200mA,SO	1	S.A
....4	D1475	0401-001056	DIODE-SWITCHING;MMBD4148SE,100V,200mA,SO	1	S.A
....4	D1476	0401-001056	DIODE-SWITCHING;MMBD4148SE,100V,200mA,SO	1	S.A
....4	D1477	0401-001056	DIODE-SWITCHING;MMBD4148SE,100V,200mA,SO	1	S.A
....4	D1478	0401-001056	DIODE-SWITCHING;MMBD4148SE,100V,200mA,SO	1	S.A
....4	D1479	0401-001056	DIODE-SWITCHING;MMBD4148SE,100V,200mA,SO	1	S.A
....4	D1482	0401-001056	DIODE-SWITCHING;MMBD4148SE,100V,200mA,SO	1	S.A
....4	D1483	0401-001056	DIODE-SWITCHING;MMBD4148SE,100V,200mA,SO	1	S.A
....4	D1484	0401-001056	DIODE-SWITCHING;MMBD4148SE,100V,200mA,SO	1	S.A
....4	D1485	0401-001056	DIODE-SWITCHING;MMBD4148SE,100V,200mA,SO	1	S.A
....4	D1486	0401-001056	DIODE-SWITCHING;MMBD4148SE,100V,200mA,SO	1	S.A
....4	D1487	0401-001056	DIODE-SWITCHING;MMBD4148SE,100V,200mA,SO	1	S.A
....4	D1488	0401-001056	DIODE-SWITCHING;MMBD4148SE,100V,200mA,SO	1	S.A
....4	D1489	0401-001056	DIODE-SWITCHING;MMBD4148SE,100V,200mA,SO	1	S.A
....4	D1492_NSID	0401-001056	DIODE-SWITCHING;MMBD4148SE,100V,200mA,SO	1	S.A
....4	D1493_NSID	0401-001056	DIODE-SWITCHING;MMBD4148SE,100V,200mA,SO	1	S.A
....4	D1494_NSID	0401-001056	DIODE-SWITCHING;MMBD4148SE,100V,200mA,SO	1	S.A
....4	D1495_NSID	0401-001056	DIODE-SWITCHING;MMBD4148SE,100V,200mA,SO	1	S.A
....4	D1496_NSID	0401-001056	DIODE-SWITCHING;MMBD4148SE,100V,200mA,SO	1	S.A
....4	D1497_NSID	0401-001056	DIODE-SWITCHING;MMBD4148SE,100V,200mA,SO	1	S.A
....4	D1498_NSID	0401-001056	DIODE-SWITCHING;MMBD4148SE,100V,200mA,SO	1	S.A
....4	D1499_NSID	0401-001056	DIODE-SWITCHING;MMBD4148SE,100V,200mA,SO	1	S.A
....4	D1603_OP	0401-001056	DIODE-SWITCHING;MMBD4148SE,100V,200mA,SO	1	S.A
....4	D1621_OP	0401-001056	DIODE-SWITCHING;MMBD4148SE,100V,200mA,SO	1	S.A
....4	D1624_OP	0401-001056	DIODE-SWITCHING;MMBD4148SE,100V,200mA,SO	1	S.A
....4	D1643	0401-001056	DIODE-SWITCHING;MMBD4148SE,100V,200mA,SO	1	S.A
....4	D1644	0401-001056	DIODE-SWITCHING;MMBD4148SE,100V,200mA,SO	1	S.A
....4	D1645	0401-001056	DIODE-SWITCHING;MMBD4148SE,100V,200mA,SO	1	S.A
....4	D1646_PAD	0401-001056	DIODE-SWITCHING;MMBD4148SE,100V,200mA,SO	1	S.A
....4	D1647	0401-001056	DIODE-SWITCHING;MMBD4148SE,100V,200mA,SO	1	S.A
....4	D1648_LAMP	0401-001056	DIODE-SWITCHING;MMBD4148SE,100V,200mA,SO	1	S.A

6 Electrical Parts List

Level	Loc. No.	Code No.	Description & Specification	Q'ty	SA/SNA
....4	D1649	0401-001056	DIODE-SWITCHING;MMBD4148SE,100V,200mA,SO	1	S.A
....4	D1650	0401-001056	DIODE-SWITCHING;MMBD4148SE,100V,200mA,SO	1	S.A
....4	D1653	0401-001056	DIODE-SWITCHING;MMBD4148SE,100V,200mA,SO	1	S.A
....4	D1808	0401-001056	DIODE-SWITCHING;MMBD4148SE,100V,200mA,SO	1	S.A
....4	D1507	0401-001099	DIODE-SWITCHING;1N4148WS,75V,150mA,SOD-3	1	S.A
....4	D1508	0401-001099	DIODE-SWITCHING;1N4148WS,75V,150mA,SOD-3	1	S.A
....4	D1509	0401-001099	DIODE-SWITCHING;1N4148WS,75V,150mA,SOD-3	1	S.A
....4	D1651	0401-001099	DIODE-SWITCHING;1N4148WS,75V,150mA,SOD-3	1	S.A
....4	D1652	0401-001099	DIODE-SWITCHING;1N4148WS,75V,150mA,SOD-3	1	S.A
....4	D1654	0401-001099	DIODE-SWITCHING;1N4148WS,75V,150mA,SOD-3	1	S.A
....4	D0254	0402-001019	DIODE-SCHOTTKY;MBRS340,40V,3000mA,DO-214	1	S.A
....4	D0254	0402-001019	DIODE-SCHOTTKY;MBRS340,40V,3000mA,DO-214	1	S.A
....4	D1436	0403-000258	DIODE-ZENER;BZX84C5V6,5.2-6V,225mW,SOT-2	1	S.A
....4	D1104	0403-000614	DIODE-ZENER;RLZ8.2B,7.78-8.19V,500mW,LL-	1	S.A
....4	D1215	0403-000620	DIODE-ZENER;RLZ5.6B,5.45-5.73V,500mW,LL-	1	S.A
....4	D1217	0403-000620	DIODE-ZENER;RLZ5.6B,5.45-5.73V,500mW,LL-	1	S.A
....4	D1429	0403-000620	DIODE-ZENER;RLZ5.6B,5.45-5.73V,500mW,LL-	1	S.A
....4	D1430	0403-000620	DIODE-ZENER;RLZ5.6B,5.45-5.73V,500mW,LL-	1	S.A
....4	D1431	0403-000620	DIODE-ZENER;RLZ5.6B,5.45-5.73V,500mW,LL-	1	S.A
....4	D1432	0403-000620	DIODE-ZENER;RLZ5.6B,5.45-5.73V,500mW,LL-	1	S.A
....4	D1433	0403-000620	DIODE-ZENER;RLZ5.6B,5.45-5.73V,500mW,LL-	1	S.A
....4	D1452	0403-000620	DIODE-ZENER;RLZ5.6B,5.45-5.73V,500mW,LL-	1	S.A
....4	D1453	0403-000620	DIODE-ZENER;RLZ5.6B,5.45-5.73V,500mW,LL-	1	S.A
....4	D1454_NSID	0403-000620	DIODE-ZENER;RLZ5.6B,5.45-5.73V,500mW,LL-	1	S.A
....4	D1500	0403-001016	DIODE-ZENER;RLZ6.2B,5.96-6.27V,500mW,LL-	1	S.A
....4	D1501	0403-001016	DIODE-ZENER;RLZ6.2B,5.96-6.27V,500mW,LL-	1	S.A
....4	D1502_NSID	0403-001016	DIODE-ZENER;RLZ6.2B,5.96-6.27V,500mW,LL-	1	S.A
....4	D1503	0403-001016	DIODE-ZENER;RLZ6.2B,5.96-6.27V,500mW,LL-	1	S.A
....4	D1504	0403-001016	DIODE-ZENER;RLZ6.2B,5.96-6.27V,500mW,LL-	1	S.A
....4	D1505	0403-001016	DIODE-ZENER;RLZ6.2B,5.96-6.27V,500mW,LL-	1	S.A
....4	D1506	0403-001016	DIODE-ZENER;RLZ6.2B,5.96-6.27V,500mW,LL-	1	S.A
....4	D1402	0403-001052	DIODE-ZENER;RD8.2MB,7.7-8.7V,200mW,SOT-2	1	S.A
....4	D1428	0403-001052	DIODE-ZENER;RD8.2MB,7.7-8.7V,200mW,SOT-2	1	S.A
....4	D1449_NSID	0403-001052	DIODE-ZENER;RD8.2MB,7.7-8.7V,200mW,SOT-2	1	S.A
....4	D1804	0403-001052	DIODE-ZENER;RD8.2MB,7.7-8.7V,200mW,SOT-2	1	S.A
....4	D1810	0403-001052	DIODE-ZENER;RD8.2MB,7.7-8.7V,200mW,SOT-2	1	S.A
....4	D1608	0403-001169	DIODE-ZENER;RLZ16C,15.96-16.51V,500MW,LL	1	S.A
....4	D1636	0403-001169	DIODE-ZENER;RLZ16C,15.96-16.51V,500MW,LL	1	S.A
....4	D1105	0403-001425	DIODE-ZENER;BZX84C33,31-35V,350mW,SOT-23	1	S.A
....4	D1405	0406-001172	DIODE-TVS;CDS3C30GTH,48V,SMD	1	S.A
....4	D1406	0406-001172	DIODE-TVS;CDS3C30GTH,48V,SMD	1	S.A
....4	D1408	0406-001172	DIODE-TVS;CDS3C30GTH,48V,SMD	1	S.A
....4	D1409	0406-001172	DIODE-TVS;CDS3C30GTH,48V,SMD	1	S.A
....4	D1422	0406-001172	DIODE-TVS;CDS3C30GTH,48V,SMD	1	S.A
....4	D1423	0406-001172	DIODE-TVS;CDS3C30GTH,48V,SMD	1	S.A
....4	D1446	0406-001172	DIODE-TVS;CDS3C30GTH,48V,SMD	1	S.A
....4	D1447	0406-001172	DIODE-TVS;CDS3C30GTH,48V,SMD	1	S.A
....4	D1601_OP	0406-001172	DIODE-TVS;CDS3C30GTH,48V,SMD	1	S.A
....4	D1602_OP	0406-001172	DIODE-TVS;CDS3C30GTH,48V,SMD	1	S.A
....4	D1604_EU	0406-001172	DIODE-TVS;CDS3C30GTH,48V,SMD	1	S.A
....4	D1605	0406-001172	DIODE-TVS;CDS3C30GTH,48V,SMD	1	S.A
....4	D1606_EU	0406-001172	DIODE-TVS;CDS3C30GTH,48V,SMD	1	S.A
....4	D1607	0406-001172	DIODE-TVS;CDS3C30GTH,48V,SMD	1	S.A
....4	D1615	0406-001172	DIODE-TVS;CDS3C30GTH,48V,SMD	1	S.A
....4	D1616_OP	0406-001172	DIODE-TVS;CDS3C30GTH,48V,SMD	1	S.A
....4	D1617_OP	0406-001172	DIODE-TVS;CDS3C30GTH,48V,SMD	1	S.A
....4	D1618_OP	0406-001172	DIODE-TVS;CDS3C30GTH,48V,SMD	1	S.A
....4	D1619	0406-001172	DIODE-TVS;CDS3C30GTH,48V,SMD	1	S.A
....4	D1620_EU	0406-001172	DIODE-TVS;CDS3C30GTH,48V,SMD	1	S.A
....4	D1622_OP	0406-001172	DIODE-TVS;CDS3C30GTH,48V,SMD	1	S.A
....4	D1623_OP	0406-001172	DIODE-TVS;CDS3C30GTH,48V,SMD	1	S.A
....4	D1630	0406-001172	DIODE-TVS;CDS3C30GTH,48V,SMD	1	S.A

6 Electrical Parts List

Level	Loc. No.	Code No.	Description & Specification	Q'ty	SA/SNA
....4	IC106	1001-001082	IC-VIDEO SWITCH;BA7657F,-,SOP,24P,300MIL	1	SA
....4	IC106	1001-001440	IC-VIDEO SWITCH;Sii9185CTU,QFP,80P,3.3V,	1	SA
....4	IC107	1002-001482	IC-D/A CONVERTER;WM8521H9GED/R,16bit,SOI	1	SA
....4	IC110	1006-001076	IC-DRIVER/RECEIVER;MAX232ECWE+T,SOP,16P,	1	SA
....4	IC112	1103-000129	IC-EEPROM;24C02,2Kbit,256x8Bit,SOP,8P,5x	1	SA
....4	IC112	1103-000129	IC-EEPROM;24C02,2Kbit,256x8Bit,SOP,8P,5x	1	SA
....4	IC112	1103-000129	IC-EEPROM;24C02,2Kbit,256x8Bit,SOP,8P,5x	1	SA
....4	IC112	1103-000129	IC-EEPROM;24C02,2Kbit,256x8Bit,SOP,8P,5x	1	SA
....4	IC112	1103-001385	IC-EEPROM;24C256,256Kbit,32Kx8,SOP,8P,5x	1	SA
....4	IC112	1103-001385	IC-EEPROM;24C256,256Kbit,32Kx8,SOP,8P,5x	1	SA
....4	IC113	1105-001712	IC-DRAM;HYB25D256163CE,DDR,256Mbit,16Mx1	1	SA
....4	IC113	1105-001791	IC-DRAM;EM6A9320BI,DDR,128Mbit,4Mx32,FBG	1	SA
....4	DU410	1201-000166	IC-OP AMP;LM358,SOP,ST,8P,150MIL,DUAL,10	1	SA
....4	T0124	1201-002430	IC-POWER AMP;NTP-3000,QFN,56P,8x8mm,DUAL	1	SA
....4	IC012	1203-001519	IC-POSI.ADJUST REG.;LM317,SOT223,3P,274	1	SA
....4	T0087	1203-001815	IC-POSI.FIXED REG.;78M09,TO-252,3P,-,PLA	1	SA
....4	T0087	1203-002842	IC-POSI.FIXED REG.;AP1117D-33A,TO-252,3P	1	SA
....4	T0087	1203-002855	IC-POSI.FIXED REG.;MC33269DTRK-5.0,DPRK,	1	SA
....4	T0087	1203-002898	IC-POSI.FIXED REG.;G950T45R,TO-252,3P,6.	1	SA
....4	T0087	1203-002974	IC-POSI.FIXED REG.;AP1117D-25A,TO-252,3P	1	SA
....4	IC012	1203-002995	IC-POSI.ADJUST REG.;AP1117D-A,TO-252,3P,	1	SA
....4	IC012	1203-002995	IC-POSI.ADJUST REG.;AP1117D-A,TO-252,3P,	1	SA
....4	T0170	1203-003059	IC-SWITCH VOL. REG.;MP1583,SOIC,8P,4.9x3	1	SA
....4	T0087	1203-003696	IC-POSI.FIXED REG.;NCP1117DT18T5G,DPAK,3	1	SA
....4	IC1809	1203-004363	IC-VOL. DETECTOR;RT9818C-29PV,SOT-23,3P,	1	SA
....4	IC1303	1203-004364	IC-VOL. DETECTOR;RT9818C-42PV,SOT-23,3P,	1	SA
....4	IC3001	1203-004364	IC-VOL. DETECTOR;RT9818C-42PV,SOT-23,3P,	1	SA
....4	IC1113	1203-004379	IC-DC/DC CONVERTER;AP1530SA,SOP,8P,5x3.9	1	SA
....4	IC3101	1204-002697	IC-DECODER;STx5105,PBGA,324P,23x23mm,PLA	1	SA
....4	IC118	1204-002718	IC-VIDEO PROCESS;SVP-UX68,BGA,336P,27x27	1	SA
....4	IC1202	1204-002719	IC-AUDIO PROCESSOR;SGTV5810,LQFP,100P,14	1	SA
....4	IC118	1204-002729	IC-VIDEO PROCESS;S4LF119X01,PBGA,208P,17	1	SA
....4	D1471	1405-001185	VARISTOR;24Vdc,1.6x0.8x0.36mm,TP	1	SA
....4	D1481	1405-001185	VARISTOR;24Vdc,1.6x0.8x0.36mm,TP	1	SA
....4	D1491_NSID	1405-001185	VARISTOR;24Vdc,1.6x0.8x0.36mm,TP	1	SA
....4	D1612	1405-001185	VARISTOR;24Vdc,1.6x0.8x0.36mm,TP	1	SA
....4	D1613	1405-001185	VARISTOR;24Vdc,1.6x0.8x0.36mm,TP	1	SA
....4	D1614	1405-001185	VARISTOR;24Vdc,1.6x0.8x0.36mm,TP	1	SA
....4	D1809	1405-001185	VARISTOR;24Vdc,1.6x0.8x0.36mm,TP	1	SA
....4	R1527	2007-000042	R-CHIP;499ohm,1%,1/10W,TP,1608	1	SA
....4	R2139	2007-000043	R-CHIP;1Kohm,1%,1/10W,TP,1608	1	SA
....4	R2226	2007-000043	R-CHIP;1Kohm,1%,1/10W,TP,1608	1	SA
....4	R2227	2007-000043	R-CHIP;1Kohm,1%,1/10W,TP,1608	1	SA
....4	R1903	2007-000052	R-CHIP;10Kohm,1%,1/10W,TP,1608	1	SA
....4	R1904	2007-000052	R-CHIP;10Kohm,1%,1/10W,TP,1608	1	SA
....4	R1905	2007-000052	R-CHIP;10Kohm,1%,1/10W,TP,1608	1	SA
....4	R1906	2007-000052	R-CHIP;10Kohm,1%,1/10W,TP,1608	1	SA
....4	R1907	2007-000052	R-CHIP;10Kohm,1%,1/10W,TP,1608	1	SA
....4	R1908	2007-000052	R-CHIP;10Kohm,1%,1/10W,TP,1608	1	SA
....4	R1909	2007-000052	R-CHIP;10Kohm,1%,1/10W,TP,1608	1	SA
....4	R1910	2007-000052	R-CHIP;10Kohm,1%,1/10W,TP,1608	1	SA
....4	R1941	2007-000052	R-CHIP;10Kohm,1%,1/10W,TP,1608	1	SA
....4	R1944	2007-000052	R-CHIP;10Kohm,1%,1/10W,TP,1608	1	SA
....4	R1993_LCD	2007-000052	R-CHIP;10Kohm,1%,1/10W,TP,1608	1	SA
....4	R1111	2007-000060	R-CHIP;100Kohm,1%,1/10W,TP,1608	1	SA
....4	R2206	2007-000060	R-CHIP;100Kohm,1%,1/10W,TP,1608	1	SA
....4	R1117	2007-000066	R-CHIP;20Kohm,1%,1/10W,TP,1608	1	SA
....4	R1118	2007-000067	R-CHIP;15Kohm,1%,1/10W,TP,1608	1	SA
....4	R1130_UX	2007-000070	R-CHIP;0ohm,5%,1/10W,TP,1608	1	SA
....4	R1266	2007-000070	R-CHIP;0ohm,5%,1/10W,TP,1608	1	SA
....4	R1333_UX	2007-000070	R-CHIP;0ohm,5%,1/10W,TP,1608	1	SA
....4	R1334_UX	2007-000070	R-CHIP;0ohm,5%,1/10W,TP,1608	1	SA

Level	Loc. No.	Code No.	Description & Specification	Q'ty	SA/SNA
....4	R1335_UX	2007-000070	R-CHIP;0ohm,5%,1/10W,TP,1608	1	SA
....4	R1336_UX	2007-000070	R-CHIP;0ohm,5%,1/10W,TP,1608	1	SA
....4	R1337_UX	2007-000070	R-CHIP;0ohm,5%,1/10W,TP,1608	1	SA
....4	R1338_UX	2007-000070	R-CHIP;0ohm,5%,1/10W,TP,1608	1	SA
....4	R1339_UX	2007-000070	R-CHIP;0ohm,5%,1/10W,TP,1608	1	SA
....4	R1340_UX	2007-000070	R-CHIP;0ohm,5%,1/10W,TP,1608	1	SA
....4	R1418	2007-000070	R-CHIP;0ohm,5%,1/10W,TP,1608	1	SA
....4	R1456	2007-000070	R-CHIP;0ohm,5%,1/10W,TP,1608	1	SA
....4	R1464	2007-000070	R-CHIP;0ohm,5%,1/10W,TP,1608	1	SA
....4	R1501_HDMI	2007-000070	R-CHIP;0ohm,5%,1/10W,TP,1608	1	SA
....4	R1502	2007-000070	R-CHIP;0ohm,5%,1/10W,TP,1608	1	SA
....4	R1507_HDMI	2007-000070	R-CHIP;0ohm,5%,1/10W,TP,1608	1	SA
....4	R1519	2007-000070	R-CHIP;0ohm,5%,1/10W,TP,1608	1	SA
....4	R1524	2007-000070	R-CHIP;0ohm,5%,1/10W,TP,1608	1	SA
....4	R1525	2007-000070	R-CHIP;0ohm,5%,1/10W,TP,1608	1	SA
....4	R1526_NSID	2007-000070	R-CHIP;0ohm,5%,1/10W,TP,1608	1	SA
....4	R1542	2007-000070	R-CHIP;0ohm,5%,1/10W,TP,1608	1	SA
....4	R1543	2007-000070	R-CHIP;0ohm,5%,1/10W,TP,1608	1	SA
....4	R1550	2007-000070	R-CHIP;0ohm,5%,1/10W,TP,1608	1	SA
....4	R1553	2007-000070	R-CHIP;0ohm,5%,1/10W,TP,1608	1	SA
....4	R1554	2007-000070	R-CHIP;0ohm,5%,1/10W,TP,1608	1	SA
....4	R1555	2007-000070	R-CHIP;0ohm,5%,1/10W,TP,1608	1	SA
....4	R1556	2007-000070	R-CHIP;0ohm,5%,1/10W,TP,1608	1	SA
....4	R1557	2007-000070	R-CHIP;0ohm,5%,1/10W,TP,1608	1	SA
....4	R1558	2007-000070	R-CHIP;0ohm,5%,1/10W,TP,1608	1	SA
....4	R1559	2007-000070	R-CHIP;0ohm,5%,1/10W,TP,1608	1	SA
....4	R1574	2007-000070	R-CHIP;0ohm,5%,1/10W,TP,1608	1	SA
....4	R1575	2007-000070	R-CHIP;0ohm,5%,1/10W,TP,1608	1	SA
....4	R1576	2007-000070	R-CHIP;0ohm,5%,1/10W,TP,1608	1	SA
....4	R1578	2007-000070	R-CHIP;0ohm,5%,1/10W,TP,1608	1	SA
....4	R1581_NSID	2007-000070	R-CHIP;0ohm,5%,1/10W,TP,1608	1	SA
....4	R1584	2007-000070	R-CHIP;0ohm,5%,1/10W,TP,1608	1	SA
....4	R1585	2007-000070	R-CHIP;0ohm,5%,1/10W,TP,1608	1	SA
....4	R1586_HDMI	2007-000070	R-CHIP;0ohm,5%,1/10W,TP,1608	1	SA
....4	R1587_HDMI	2007-000070	R-CHIP;0ohm,5%,1/10W,TP,1608	1	SA
....4	R1621_EU	2007-000070	R-CHIP;0ohm,5%,1/10W,TP,1608	1	SA
....4	R1655	2007-000070	R-CHIP;0ohm,5%,1/10W,TP,1608	1	SA
....4	R1708_NMMS	2007-000070	R-CHIP;0ohm,5%,1/10W,TP,1608	1	SA
....4	R1709_NMMS	2007-000070	R-CHIP;0ohm,5%,1/10W,TP,1608	1	SA
....4	R1710_NMMS	2007-000070	R-CHIP;0ohm,5%,1/10W,TP,1608	1	SA
....4	R1805	2007-000070	R-CHIP;0ohm,5%,1/10W,TP,1608	1	SA
....4	R1826	2007-000070	R-CHIP;0ohm,5%,1/10W,TP,1608	1	SA
....4	R1827	2007-000070	R-CHIP;0ohm,5%,1/10W,TP,1608	1	SA
....4	R1828	2007-000070	R-CHIP;0ohm,5%,1/10W,TP,1608	1	SA
....4	R1830	2007-000070	R-CHIP;0ohm,5%,1/10W,TP,1608	1	SA
....4	R1831	2007-000070	R-CHIP;0ohm,5%,1/10W,TP,1608	1	SA
....4	R1834	2007-000070	R-CHIP;0ohm,5%,1/10W,TP,1608	1	SA
....4	R1837	2007-000070	R-CHIP;0ohm,5%,1/10W,TP,1608	1	SA
....4	R1838	2007-000070	R-CHIP;0ohm,5%,1/10W,TP,1608	1	SA
....4	R1839	2007-000070	R-CHIP;0ohm,5%,1/10W,TP,1608	1	SA
....4	R1840	2007-000070	R-CHIP;0ohm,5%,1/10W,TP,1608	1	SA
....4	R1844	2007-000070	R-CHIP;0ohm,5%,1/10W,TP,1608	1	SA
....4	R1879	2007-000070	R-CHIP;0ohm,5%,1/10W,TP,1608	1	SA
....4	R1895	2007-000070	R-CHIP;0ohm,5%,1/10W,TP,1608	1	SA
....4	R1927	2007-000070	R-CHIP;0ohm,5%,1/10W,TP,1608	1	SA
....4	R1932	2007-000070	R-CHIP;0ohm,5%,1/10W,TP,1608	1	SA
....4	R1934	2007-000070	R-CHIP;0ohm,5%,1/10W,TP,1608	1	SA
....4	R1935	2007-000070	R-CHIP;0ohm,5%,1/10W,TP,1608	1	SA
....4	R1936	2007-000070	R-CHIP;0ohm,5%,1/10W,TP,1608	1	SA
....4	R1937	2007-000070	R-CHIP;0ohm,5%,1/10W,TP,1608	1	SA
....4	R1957	2007-000070	R-CHIP;0ohm,5%,1/10W,TP,1608	1	SA
....4	R1975	2007-000070	R-CHIP;0ohm,5%,1/10W,TP,1608	1	SA

Level	Loc. No.	Code No.	Description & Specification	Q'ty	SA/SNA
....4	R3206	2007-000074	R-CHIP;100ohm,5%,1/10W,TP,1608	1	SA
....4	R3207	2007-000074	R-CHIP;100ohm,5%,1/10W,TP,1608	1	SA
....4	R3230	2007-000074	R-CHIP;100ohm,5%,1/10W,TP,1608	1	SA
....4	R3233	2007-000074	R-CHIP;100ohm,5%,1/10W,TP,1608	1	SA
....4	R3235	2007-000074	R-CHIP;100ohm,5%,1/10W,TP,1608	1	SA
....4	R3238	2007-000074	R-CHIP;100ohm,5%,1/10W,TP,1608	1	SA
....4	R3253	2007-000074	R-CHIP;100ohm,5%,1/10W,TP,1608	1	SA
....4	R3254	2007-000074	R-CHIP;100ohm,5%,1/10W,TP,1608	1	SA
....4	R3255	2007-000074	R-CHIP;100ohm,5%,1/10W,TP,1608	1	SA
....4	R3259	2007-000074	R-CHIP;100ohm,5%,1/10W,TP,1608	1	SA
....4	R3261	2007-000074	R-CHIP;100ohm,5%,1/10W,TP,1608	1	SA
....4	R3263	2007-000074	R-CHIP;100ohm,5%,1/10W,TP,1608	1	SA
....4	R3266	2007-000074	R-CHIP;100ohm,5%,1/10W,TP,1608	1	SA
....4	R3267	2007-000074	R-CHIP;100ohm,5%,1/10W,TP,1608	1	SA
....4	R3016	2007-000075	R-CHIP;220ohm,5%,1/10W,TP,1608	1	SA
....4	R3017	2007-000075	R-CHIP;220ohm,5%,1/10W,TP,1608	1	SA
....4	R1101	2007-000076	R-CHIP;330ohm,5%,1/10W,TP,1608	1	SA
....4	R1267	2007-000076	R-CHIP;330ohm,5%,1/10W,TP,1608	1	SA
....4	R1268	2007-000076	R-CHIP;330ohm,5%,1/10W,TP,1608	1	SA
....4	R1582	2007-000076	R-CHIP;330ohm,5%,1/10W,TP,1608	1	SA
....4	R1583	2007-000076	R-CHIP;330ohm,5%,1/10W,TP,1608	1	SA
....4	R1604_EU	2007-000076	R-CHIP;330ohm,5%,1/10W,TP,1608	1	SA
....4	R1607_EU	2007-000076	R-CHIP;330ohm,5%,1/10W,TP,1608	1	SA
....4	R1654	2007-000076	R-CHIP;330ohm,5%,1/10W,TP,1608	1	SA
....4	R1659	2007-000076	R-CHIP;330ohm,5%,1/10W,TP,1608	1	SA
....4	R1891	2007-000076	R-CHIP;330ohm,5%,1/10W,TP,1608	1	SA
....4	R3250	2007-000076	R-CHIP;330ohm,5%,1/10W,TP,1608	1	SA
....4	R1347	2007-000077	R-CHIP;470ohm,5%,1/10W,TP,1608	1	SA
....4	R1403	2007-000077	R-CHIP;470ohm,5%,1/10W,TP,1608	1	SA
....4	R1404	2007-000077	R-CHIP;470ohm,5%,1/10W,TP,1608	1	SA
....4	R1407	2007-000077	R-CHIP;470ohm,5%,1/10W,TP,1608	1	SA
....4	R1412	2007-000077	R-CHIP;470ohm,5%,1/10W,TP,1608	1	SA
....4	R1442	2007-000077	R-CHIP;470ohm,5%,1/10W,TP,1608	1	SA
....4	R1444	2007-000077	R-CHIP;470ohm,5%,1/10W,TP,1608	1	SA
....4	R1605	2007-000077	R-CHIP;470ohm,5%,1/10W,TP,1608	1	SA
....4	R1613	2007-000077	R-CHIP;470ohm,5%,1/10W,TP,1608	1	SA
....4	R1628_OP	2007-000077	R-CHIP;470ohm,5%,1/10W,TP,1608	1	SA
....4	R1629_OP	2007-000077	R-CHIP;470ohm,5%,1/10W,TP,1608	1	SA
....4	R1657	2007-000077	R-CHIP;470ohm,5%,1/10W,TP,1608	1	SA
....4	R1661	2007-000077	R-CHIP;470ohm,5%,1/10W,TP,1608	1	SA
....4	R1672_UX	2007-000077	R-CHIP;470ohm,5%,1/10W,TP,1608	1	SA
....4	R1688	2007-000077	R-CHIP;470ohm,5%,1/10W,TP,1608	1	SA
....4	R1691	2007-000077	R-CHIP;470ohm,5%,1/10W,TP,1608	1	SA
....4	R2052	2007-000077	R-CHIP;470ohm,5%,1/10W,TP,1608	1	SA
....4	R2246_LCD	2007-000077	R-CHIP;470ohm,5%,1/10W,TP,1608	1	SA
....4	R2287_LCD	2007-000077	R-CHIP;470ohm,5%,1/10W,TP,1608	1	SA
....4	R1265	2007-000078	R-CHIP;1Kohm,5%,1/10W,TP,1608	1	SA
....4	R1408	2007-000078	R-CHIP;1Kohm,5%,1/10W,TP,1608	1	SA
....4	R1416	2007-000078	R-CHIP;1Kohm,5%,1/10W,TP,1608	1	SA
....4	R1463	2007-000078	R-CHIP;1Kohm,5%,1/10W,TP,1608	1	SA
....4	R1470	2007-000078	R-CHIP;1Kohm,5%,1/10W,TP,1608	1	SA
....4	R1495_NSID	2007-000078	R-CHIP;1Kohm,5%,1/10W,TP,1608	1	SA
....4	R1500_HDMI	2007-000078	R-CHIP;1Kohm,5%,1/10W,TP,1608	1	SA
....4	R1640_OP	2007-000078	R-CHIP;1Kohm,5%,1/10W,TP,1608	1	SA
....4	R1641_OP	2007-000078	R-CHIP;1Kohm,5%,1/10W,TP,1608	1	SA
....4	R1675_UX	2007-000078	R-CHIP;1Kohm,5%,1/10W,TP,1608	1	SA
....4	R1698_PAD	2007-000078	R-CHIP;1Kohm,5%,1/10W,TP,1608	1	SA
....4	R1702_LAMP	2007-000078	R-CHIP;1Kohm,5%,1/10W,TP,1608	1	SA
....4	R1823	2007-000078	R-CHIP;1Kohm,5%,1/10W,TP,1608	1	SA
....4	R1829	2007-000078	R-CHIP;1Kohm,5%,1/10W,TP,1608	1	SA
....4	R1833	2007-000078	R-CHIP;1Kohm,5%,1/10W,TP,1608	1	SA
....4	R1845	2007-000078	R-CHIP;1Kohm,5%,1/10W,TP,1608	1	SA

6 Electrical Parts List

Level	Loc. No.	Code No.	Description & Specification	Q'ty	SA/SNA
....4	R1846	2007-000078	R-CHIP;1Kohm,5%,1/10W,TP,1608	1	SA
....4	R1915_LCD	2007-000078	R-CHIP;1Kohm,5%,1/10W,TP,1608	1	SA
....4	R1929	2007-000078	R-CHIP;1Kohm,5%,1/10W,TP,1608	1	SA
....4	R1939	2007-000078	R-CHIP;1Kohm,5%,1/10W,TP,1608	1	SA
....4	R1951	2007-000078	R-CHIP;1Kohm,5%,1/10W,TP,1608	1	SA
....4	R2008	2007-000078	R-CHIP;1Kohm,5%,1/10W,TP,1608	1	SA
....4	R2061	2007-000078	R-CHIP;1Kohm,5%,1/10W,TP,1608	1	SA
....4	R2252_LCD	2007-000078	R-CHIP;1Kohm,5%,1/10W,TP,1608	1	SA
....4	R2284_LCD	2007-000078	R-CHIP;1Kohm,5%,1/10W,TP,1608	1	SA
....4	R2293_LCD	2007-000078	R-CHIP;1Kohm,5%,1/10W,TP,1608	1	SA
....4	R3010	2007-000078	R-CHIP;1Kohm,5%,1/10W,TP,1608	1	SA
....4	R3132	2007-000078	R-CHIP;1Kohm,5%,1/10W,TP,1608	1	SA
....4	R3134	2007-000078	R-CHIP;1Kohm,5%,1/10W,TP,1608	1	SA
....4	R3135	2007-000078	R-CHIP;1Kohm,5%,1/10W,TP,1608	1	SA
....4	R3136	2007-000078	R-CHIP;1Kohm,5%,1/10W,TP,1608	1	SA
....4	R1816	2007-000082	R-CHIP;3.3Kohm,5%,1/10W,TP,1608	1	SA
....4	R1820	2007-000082	R-CHIP;3.3Kohm,5%,1/10W,TP,1608	1	SA
....4	R1821	2007-000082	R-CHIP;3.3Kohm,5%,1/10W,TP,1608	1	SA
....4	R1851	2007-000082	R-CHIP;3.3Kohm,5%,1/10W,TP,1608	1	SA
....4	R1866	2007-000082	R-CHIP;3.3Kohm,5%,1/10W,TP,1608	1	SA
....4	R1867	2007-000082	R-CHIP;3.3Kohm,5%,1/10W,TP,1608	1	SA
....4	R1894	2007-000082	R-CHIP;3.3Kohm,5%,1/10W,TP,1608	1	SA
....4	R2288_LCD	2007-000082	R-CHIP;3.3Kohm,5%,1/10W,TP,1608	1	SA
....4	R2289_LCD	2007-000082	R-CHIP;3.3Kohm,5%,1/10W,TP,1608	1	SA
....4	R1109_LCD	2007-000084	R-CHIP;4.7Kohm,5%,1/10W,TP,1608	1	SA
....4	R1248	2007-000084	R-CHIP;4.7Kohm,5%,1/10W,TP,1608	1	SA
....4	R1250	2007-000084	R-CHIP;4.7Kohm,5%,1/10W,TP,1608	1	SA
....4	R1256	2007-000084	R-CHIP;4.7Kohm,5%,1/10W,TP,1608	1	SA
....4	R1257	2007-000084	R-CHIP;4.7Kohm,5%,1/10W,TP,1608	1	SA
....4	R1348	2007-000084	R-CHIP;4.7Kohm,5%,1/10W,TP,1608	1	SA
....4	R1411	2007-000084	R-CHIP;4.7Kohm,5%,1/10W,TP,1608	1	SA
....4	R1467	2007-000084	R-CHIP;4.7Kohm,5%,1/10W,TP,1608	1	SA
....4	R1497_HDMI	2007-000084	R-CHIP;4.7Kohm,5%,1/10W,TP,1608	1	SA
....4	R1520	2007-000084	R-CHIP;4.7Kohm,5%,1/10W,TP,1608	1	SA
....4	R1521	2007-000084	R-CHIP;4.7Kohm,5%,1/10W,TP,1608	1	SA
....4	R1523	2007-000084	R-CHIP;4.7Kohm,5%,1/10W,TP,1608	1	SA
....4	R1552	2007-000084	R-CHIP;4.7Kohm,5%,1/10W,TP,1608	1	SA
....4	R1560	2007-000084	R-CHIP;4.7Kohm,5%,1/10W,TP,1608	1	SA
....4	R1561	2007-000084	R-CHIP;4.7Kohm,5%,1/10W,TP,1608	1	SA
....4	R1673_UX	2007-000084	R-CHIP;4.7Kohm,5%,1/10W,TP,1608	1	SA
....4	R1697_RED	2007-000084	R-CHIP;4.7Kohm,5%,1/10W,TP,1608	1	SA
....4	R1802	2007-000084	R-CHIP;4.7Kohm,5%,1/10W,TP,1608	1	SA
....4	R1803	2007-000084	R-CHIP;4.7Kohm,5%,1/10W,TP,1608	1	SA
....4	R1807	2007-000084	R-CHIP;4.7Kohm,5%,1/10W,TP,1608	1	SA
....4	R1818	2007-000084	R-CHIP;4.7Kohm,5%,1/10W,TP,1608	1	SA
....4	R1819	2007-000084	R-CHIP;4.7Kohm,5%,1/10W,TP,1608	1	SA
....4	R1824	2007-000084	R-CHIP;4.7Kohm,5%,1/10W,TP,1608	1	SA
....4	R1825	2007-000084	R-CHIP;4.7Kohm,5%,1/10W,TP,1608	1	SA
....4	R1865	2007-000084	R-CHIP;4.7Kohm,5%,1/10W,TP,1608	1	SA
....4	R1885	2007-000084	R-CHIP;4.7Kohm,5%,1/10W,TP,1608	1	SA
....4	R1886	2007-000084	R-CHIP;4.7Kohm,5%,1/10W,TP,1608	1	SA
....4	R1887	2007-000084	R-CHIP;4.7Kohm,5%,1/10W,TP,1608	1	SA
....4	R1888	2007-000084	R-CHIP;4.7Kohm,5%,1/10W,TP,1608	1	SA
....4	R1892	2007-000084	R-CHIP;4.7Kohm,5%,1/10W,TP,1608	1	SA
....4	R1893	2007-000084	R-CHIP;4.7Kohm,5%,1/10W,TP,1608	1	SA
....4	R1902	2007-000084	R-CHIP;4.7Kohm,5%,1/10W,TP,1608	1	SA
....4	R1912	2007-000084	R-CHIP;4.7Kohm,5%,1/10W,TP,1608	1	SA
....4	R1913	2007-000084	R-CHIP;4.7Kohm,5%,1/10W,TP,1608	1	SA
....4	R1917	2007-000084	R-CHIP;4.7Kohm,5%,1/10W,TP,1608	1	SA
....4	R1918	2007-000084	R-CHIP;4.7Kohm,5%,1/10W,TP,1608	1	SA
....4	R1923	2007-000084	R-CHIP;4.7Kohm,5%,1/10W,TP,1608	1	SA
....4	R1925	2007-000084	R-CHIP;4.7Kohm,5%,1/10W,TP,1608	1	SA

Level	Loc. No.	Code No.	Description & Specification	Q'ty	SA/SNA
....4	R1930	2007-000084	R-CHIP;4.7Kohm,5%,1/10W,TP,1608	1	S.A
....4	R1959	2007-000084	R-CHIP;4.7Kohm,5%,1/10W,TP,1608	1	S.A
....4	R1974	2007-000084	R-CHIP;4.7Kohm,5%,1/10W,TP,1608	1	S.A
....4	R1989	2007-000084	R-CHIP;4.7Kohm,5%,1/10W,TP,1608	1	S.A
....4	R1991	2007-000084	R-CHIP;4.7Kohm,5%,1/10W,TP,1608	1	S.A
....4	R1992	2007-000084	R-CHIP;4.7Kohm,5%,1/10W,TP,1608	1	S.A
....4	R1994_PAD	2007-000084	R-CHIP;4.7Kohm,5%,1/10W,TP,1608	1	S.A
....4	R1995	2007-000084	R-CHIP;4.7Kohm,5%,1/10W,TP,1608	1	S.A
....4	R1997	2007-000084	R-CHIP;4.7Kohm,5%,1/10W,TP,1608	1	S.A
....4	R1998	2007-000084	R-CHIP;4.7Kohm,5%,1/10W,TP,1608	1	S.A
....4	R1999	2007-000084	R-CHIP;4.7Kohm,5%,1/10W,TP,1608	1	S.A
....4	R2254_LCD	2007-000084	R-CHIP;4.7Kohm,5%,1/10W,TP,1608	1	S.A
....4	R2286_LCD	2007-000084	R-CHIP;4.7Kohm,5%,1/10W,TP,1608	1	S.A
....4	R2294_LUX	2007-000084	R-CHIP;4.7Kohm,5%,1/10W,TP,1608	1	S.A
....4	R2295_LCD	2007-000084	R-CHIP;4.7Kohm,5%,1/10W,TP,1608	1	S.A
....4	R2371_FBE	2007-000084	R-CHIP;4.7Kohm,5%,1/10W,TP,1608	1	S.A
....4	R2372_FBE	2007-000084	R-CHIP;4.7Kohm,5%,1/10W,TP,1608	1	S.A
....4	R2373_FBE	2007-000084	R-CHIP;4.7Kohm,5%,1/10W,TP,1608	1	S.A
....4	R2374_HD	2007-000084	R-CHIP;4.7Kohm,5%,1/10W,TP,1608	1	S.A
....4	R3001	2007-000084	R-CHIP;4.7Kohm,5%,1/10W,TP,1608	1	S.A
....4	R3002	2007-000084	R-CHIP;4.7Kohm,5%,1/10W,TP,1608	1	S.A
....4	R3007	2007-000084	R-CHIP;4.7Kohm,5%,1/10W,TP,1608	1	S.A
....4	R3009	2007-000084	R-CHIP;4.7Kohm,5%,1/10W,TP,1608	1	S.A
....4	R3029	2007-000084	R-CHIP;4.7Kohm,5%,1/10W,TP,1608	1	S.A
....4	R3231	2007-000084	R-CHIP;4.7Kohm,5%,1/10W,TP,1608	1	S.A
....4	R3234	2007-000084	R-CHIP;4.7Kohm,5%,1/10W,TP,1608	1	S.A
....4	R3243	2007-000084	R-CHIP;4.7Kohm,5%,1/10W,TP,1608	1	S.A
....4	R3246	2007-000084	R-CHIP;4.7Kohm,5%,1/10W,TP,1608	1	S.A
....4	R3268	2007-000084	R-CHIP;4.7Kohm,5%,1/10W,TP,1608	1	S.A
....4	R1114	2007-000086	R-CHIP;5.6Kohm,5%,1/10W,TP,1608	1	S.A
....4	R1121	2007-000086	R-CHIP;5.6Kohm,5%,1/10W,TP,1608	1	S.A
....4	R1627	2007-000087	R-CHIP;6.8Kohm,5%,1/10W,TP,1608	1	S.A
....4	R1669	2007-000087	R-CHIP;6.8Kohm,5%,1/10W,TP,1608	1	S.A
....4	R1106_LCD	2007-000090	R-CHIP;10Kohm,5%,1/10W,TP,1608	1	S.A
....4	R1107_LCD	2007-000090	R-CHIP;10Kohm,5%,1/10W,TP,1608	1	S.A
....4	R1119	2007-000090	R-CHIP;10Kohm,5%,1/10W,TP,1608	1	S.A
....4	R1204	2007-000090	R-CHIP;10Kohm,5%,1/10W,TP,1608	1	S.A
....4	R1207	2007-000090	R-CHIP;10Kohm,5%,1/10W,TP,1608	1	S.A
....4	R1208	2007-000090	R-CHIP;10Kohm,5%,1/10W,TP,1608	1	S.A
....4	R1209	2007-000090	R-CHIP;10Kohm,5%,1/10W,TP,1608	1	S.A
....4	R1212	2007-000090	R-CHIP;10Kohm,5%,1/10W,TP,1608	1	S.A
....4	R1401	2007-000090	R-CHIP;10Kohm,5%,1/10W,TP,1608	1	S.A
....4	R1402	2007-000090	R-CHIP;10Kohm,5%,1/10W,TP,1608	1	S.A
....4	R1409	2007-000090	R-CHIP;10Kohm,5%,1/10W,TP,1608	1	S.A
....4	R1445	2007-000090	R-CHIP;10Kohm,5%,1/10W,TP,1608	1	S.A
....4	R1446	2007-000090	R-CHIP;10Kohm,5%,1/10W,TP,1608	1	S.A
....4	R1453	2007-000090	R-CHIP;10Kohm,5%,1/10W,TP,1608	1	S.A
....4	R1454	2007-000090	R-CHIP;10Kohm,5%,1/10W,TP,1608	1	S.A
....4	R1457	2007-000090	R-CHIP;10Kohm,5%,1/10W,TP,1608	1	S.A
....4	R1465	2007-000090	R-CHIP;10Kohm,5%,1/10W,TP,1608	1	S.A
....4	R1466	2007-000090	R-CHIP;10Kohm,5%,1/10W,TP,1608	1	S.A
....4	R1490_HDMI	2007-000090	R-CHIP;10Kohm,5%,1/10W,TP,1608	1	S.A
....4	R1491_HDMI	2007-000090	R-CHIP;10Kohm,5%,1/10W,TP,1608	1	S.A
....4	R1496_HDMI	2007-000090	R-CHIP;10Kohm,5%,1/10W,TP,1608	1	S.A
....4	R1522	2007-000090	R-CHIP;10Kohm,5%,1/10W,TP,1608	1	S.A
....4	R1801	2007-000090	R-CHIP;10Kohm,5%,1/10W,TP,1608	1	S.A
....4	R1813	2007-000090	R-CHIP;10Kohm,5%,1/10W,TP,1608	1	S.A
....4	R1814	2007-000090	R-CHIP;10Kohm,5%,1/10W,TP,1608	1	S.A
....4	R1815	2007-000090	R-CHIP;10Kohm,5%,1/10W,TP,1608	1	S.A
....4	R1876	2007-000090	R-CHIP;10Kohm,5%,1/10W,TP,1608	1	S.A
....4	R1880	2007-000090	R-CHIP;10Kohm,5%,1/10W,TP,1608	1	S.A
....4	R1881	2007-000090	R-CHIP;10Kohm,5%,1/10W,TP,1608	1	S.A

6 Electrical Parts List

Level	Loc. No.	Code No.	Description & Specification	Q'ty	SA/SNA
....4	R1882	2007-000090	R-CHIP;10Kohm,5%,1/10W,TP,1608	1	SA
....4	R1883	2007-000090	R-CHIP;10Kohm,5%,1/10W,TP,1608	1	SA
....4	R1889	2007-000090	R-CHIP;10Kohm,5%,1/10W,TP,1608	1	SA
....4	R1896	2007-000090	R-CHIP;10Kohm,5%,1/10W,TP,1608	1	SA
....4	R1931_2M	2007-000090	R-CHIP;10Kohm,5%,1/10W,TP,1608	1	SA
....4	R1938_2M	2007-000090	R-CHIP;10Kohm,5%,1/10W,TP,1608	1	SA
....4	R1972	2007-000090	R-CHIP;10Kohm,5%,1/10W,TP,1608	1	SA
....4	R1996	2007-000090	R-CHIP;10Kohm,5%,1/10W,TP,1608	1	SA
....4	R2013	2007-000090	R-CHIP;10Kohm,5%,1/10W,TP,1608	1	SA
....4	R2150	2007-000090	R-CHIP;10Kohm,5%,1/10W,TP,1608	1	SA
....4	R2151	2007-000090	R-CHIP;10Kohm,5%,1/10W,TP,1608	1	SA
....4	R2152	2007-000090	R-CHIP;10Kohm,5%,1/10W,TP,1608	1	SA
....4	R2201	2007-000090	R-CHIP;10Kohm,5%,1/10W,TP,1608	1	SA
....4	R2290_FBE	2007-000090	R-CHIP;10Kohm,5%,1/10W,TP,1608	1	SA
....4	R3011_TEST	2007-000090	R-CHIP;10Kohm,5%,1/10W,TP,1608	1	SA
....4	R3012_TEST	2007-000090	R-CHIP;10Kohm,5%,1/10W,TP,1608	1	SA
....4	R3019	2007-000090	R-CHIP;10Kohm,5%,1/10W,TP,1608	1	SA
....4	R3020	2007-000090	R-CHIP;10Kohm,5%,1/10W,TP,1608	1	SA
....4	R3120	2007-000090	R-CHIP;10Kohm,5%,1/10W,TP,1608	1	SA
....4	R3121	2007-000090	R-CHIP;10Kohm,5%,1/10W,TP,1608	1	SA
....4	R3131	2007-000090	R-CHIP;10Kohm,5%,1/10W,TP,1608	1	SA
....4	R3201	2007-000090	R-CHIP;10Kohm,5%,1/10W,TP,1608	1	SA
....4	R3202	2007-000090	R-CHIP;10Kohm,5%,1/10W,TP,1608	1	SA
....4	R3208	2007-000090	R-CHIP;10Kohm,5%,1/10W,TP,1608	1	SA
....4	R3215	2007-000090	R-CHIP;10Kohm,5%,1/10W,TP,1608	1	SA
....4	R3216	2007-000090	R-CHIP;10Kohm,5%,1/10W,TP,1608	1	SA
....4	R3217	2007-000090	R-CHIP;10Kohm,5%,1/10W,TP,1608	1	SA
....4	R3218	2007-000090	R-CHIP;10Kohm,5%,1/10W,TP,1608	1	SA
....4	R3219	2007-000090	R-CHIP;10Kohm,5%,1/10W,TP,1608	1	SA
....4	R3220	2007-000090	R-CHIP;10Kohm,5%,1/10W,TP,1608	1	SA
....4	R3221	2007-000090	R-CHIP;10Kohm,5%,1/10W,TP,1608	1	SA
....4	R3222	2007-000090	R-CHIP;10Kohm,5%,1/10W,TP,1608	1	SA
....4	R1126	2007-000092	R-CHIP;15Kohm,5%,1/10W,TP,1608	1	SA
....4	R1104	2007-000094	R-CHIP;22Kohm,5%,1/10W,TP,1608	1	SA
....4	R1201	2007-000094	R-CHIP;22Kohm,5%,1/10W,TP,1608	1	SA
....4	R1202	2007-000094	R-CHIP;22Kohm,5%,1/10W,TP,1608	1	SA
....4	R1221	2007-000094	R-CHIP;22Kohm,5%,1/10W,TP,1608	1	SA
....4	R1223	2007-000094	R-CHIP;22Kohm,5%,1/10W,TP,1608	1	SA
....4	R1224	2007-000094	R-CHIP;22Kohm,5%,1/10W,TP,1608	1	SA
....4	R1227	2007-000094	R-CHIP;22Kohm,5%,1/10W,TP,1608	1	SA
....4	R1242	2007-000094	R-CHIP;22Kohm,5%,1/10W,TP,1608	1	SA
....4	R1245	2007-000094	R-CHIP;22Kohm,5%,1/10W,TP,1608	1	SA
....4	R1687	2007-000094	R-CHIP;22Kohm,5%,1/10W,TP,1608	1	SA
....4	R1690	2007-000094	R-CHIP;22Kohm,5%,1/10W,TP,1608	1	SA
....4	R1812	2007-000094	R-CHIP;22Kohm,5%,1/10W,TP,1608	1	SA
....4	R2235	2007-000094	R-CHIP;22Kohm,5%,1/10W,TP,1608	1	SA
....4	R1540	2007-000097	R-CHIP;47Kohm,5%,1/10W,TP,1608	1	SA
....4	R1541	2007-000097	R-CHIP;47Kohm,5%,1/10W,TP,1608	1	SA
....4	R1614_EU	2007-000097	R-CHIP;47Kohm,5%,1/10W,TP,1608	1	SA
....4	R1615_EU	2007-000097	R-CHIP;47Kohm,5%,1/10W,TP,1608	1	SA
....4	R1684_EU	2007-000097	R-CHIP;47Kohm,5%,1/10W,TP,1608	1	SA
....4	R1685_EU	2007-000097	R-CHIP;47Kohm,5%,1/10W,TP,1608	1	SA
....4	R3004	2007-000097	R-CHIP;47Kohm,5%,1/10W,TP,1608	1	SA
....4	R3006	2007-000097	R-CHIP;47Kohm,5%,1/10W,TP,1608	1	SA
....4	R1102_LCD	2007-000102	R-CHIP;100Kohm,5%,1/10W,TP,1608	1	SA
....4	R1103	2007-000102	R-CHIP;100Kohm,5%,1/10W,TP,1608	1	SA
....4	R1120_12V	2007-000102	R-CHIP;100Kohm,5%,1/10W,TP,1608	1	SA
....4	R1699_LAMP	2007-000102	R-CHIP;100Kohm,5%,1/10W,TP,1608	1	SA
....4	R1990	2007-000107	R-CHIP;470Kohm,5%,1/10W,TP,1608	1	SA
....4	R1271	2007-000113	R-CHIP;33ohm,5%,1/10W,TP,1608	1	SA
....4	R1272	2007-000113	R-CHIP;33ohm,5%,1/10W,TP,1608	1	SA
....4	R2017_UX	2007-000113	R-CHIP;33ohm,5%,1/10W,TP,1608	1	SA

Level	Loc. No.	Code No.	Description & Specification	Q'ty	SA/SNA
....4	R2019_UX	2007-000113	R-CHIP;33ohm,5%,1/10W,TP,1608	1	SA
....4	R2020_UX	2007-000113	R-CHIP;33ohm,5%,1/10W,TP,1608	1	SA
....4	R2025	2007-000113	R-CHIP;33ohm,5%,1/10W,TP,1608	1	SA
....4	R2209	2007-000113	R-CHIP;33ohm,5%,1/10W,TP,1608	1	SA
....4	R2210	2007-000113	R-CHIP;33ohm,5%,1/10W,TP,1608	1	SA
....4	R2211	2007-000113	R-CHIP;33ohm,5%,1/10W,TP,1608	1	SA
....4	R2214	2007-000113	R-CHIP;33ohm,5%,1/10W,TP,1608	1	SA
....4	R2215	2007-000113	R-CHIP;33ohm,5%,1/10W,TP,1608	1	SA
....4	R2216	2007-000113	R-CHIP;33ohm,5%,1/10W,TP,1608	1	SA
....4	R2217	2007-000113	R-CHIP;33ohm,5%,1/10W,TP,1608	1	SA
....4	R2218	2007-000113	R-CHIP;33ohm,5%,1/10W,TP,1608	1	SA
....4	R2219	2007-000113	R-CHIP;33ohm,5%,1/10W,TP,1608	1	SA
....4	R2220	2007-000113	R-CHIP;33ohm,5%,1/10W,TP,1608	1	SA
....4	R2221	2007-000113	R-CHIP;33ohm,5%,1/10W,TP,1608	1	SA
....4	R3101	2007-000113	R-CHIP;33ohm,5%,1/10W,TP,1608	1	SA
....4	R3104	2007-000113	R-CHIP;33ohm,5%,1/10W,TP,1608	1	SA
....4	R3105	2007-000113	R-CHIP;33ohm,5%,1/10W,TP,1608	1	SA
....4	R3106	2007-000113	R-CHIP;33ohm,5%,1/10W,TP,1608	1	SA
....4	R3108	2007-000113	R-CHIP;33ohm,5%,1/10W,TP,1608	1	SA
....4	R3110	2007-000113	R-CHIP;33ohm,5%,1/10W,TP,1608	1	SA
....4	R3111	2007-000113	R-CHIP;33ohm,5%,1/10W,TP,1608	1	SA
....4	R3112	2007-000113	R-CHIP;33ohm,5%,1/10W,TP,1608	1	SA
....4	R3113	2007-000113	R-CHIP;33ohm,5%,1/10W,TP,1608	1	SA
....4	R3114	2007-000113	R-CHIP;33ohm,5%,1/10W,TP,1608	1	SA
....4	R3115	2007-000113	R-CHIP;33ohm,5%,1/10W,TP,1608	1	SA
....4	R3119	2007-000113	R-CHIP;33ohm,5%,1/10W,TP,1608	1	SA
....4	R3138	2007-000113	R-CHIP;33ohm,5%,1/10W,TP,1608	1	SA
....4	R3139	2007-000113	R-CHIP;33ohm,5%,1/10W,TP,1608	1	SA
....4	R3140	2007-000113	R-CHIP;33ohm,5%,1/10W,TP,1608	1	SA
....4	R3141	2007-000113	R-CHIP;33ohm,5%,1/10W,TP,1608	1	SA
....4	R3227	2007-000113	R-CHIP;33ohm,5%,1/10W,TP,1608	1	SA
....4	R3241	2007-000113	R-CHIP;33ohm,5%,1/10W,TP,1608	1	SA
....4	R3242	2007-000113	R-CHIP;33ohm,5%,1/10W,TP,1608	1	SA
....4	R3245	2007-000113	R-CHIP;33ohm,5%,1/10W,TP,1608	1	SA
....4	R1350	2007-000119	R-CHIP;560ohm,5%,1/10W,TP,1608	1	SA
....4	R1940	2007-000120	R-CHIP;680ohm,5%,1/10W,TP,1608	1	SA
....4	R1108_LCD	2007-000124	R-CHIP;2.2Kohm,5%,1/10W,TP,1608	1	SA
....4	R1349	2007-000124	R-CHIP;2.2Kohm,5%,1/10W,TP,1608	1	SA
....4	R1694_RED	2007-000124	R-CHIP;2.2Kohm,5%,1/10W,TP,1608	1	SA
....4	R1695_RED	2007-000124	R-CHIP;2.2Kohm,5%,1/10W,TP,1608	1	SA
....4	R1696_RED	2007-000124	R-CHIP;2.2Kohm,5%,1/10W,TP,1608	1	SA
....4	R1942	2007-000124	R-CHIP;2.2Kohm,5%,1/10W,TP,1608	1	SA
....4	R1973	2007-000129	R-CHIP;27Kohm,5%,1/10W,TP,1608	1	SA
....4	R2208	2007-000133	R-CHIP;330Kohm,5%,1/10W,TP,1608	1	SA
....4	R1124	2007-000208	R-CHIP;1.1Kohm,1%,1/10W,TP,1608	1	SA
....4	R1113	2007-000219	R-CHIP;1.2Kohm,1%,1/10W,TP,1608	1	SA
....4	R1420	2007-000309	R-CHIP;10ohm,5%,1/10W,TP,1608	1	SA
....4	R1421	2007-000309	R-CHIP;10ohm,5%,1/10W,TP,1608	1	SA
....4	R1423	2007-000309	R-CHIP;10ohm,5%,1/10W,TP,1608	1	SA
....4	R1424	2007-000309	R-CHIP;10ohm,5%,1/10W,TP,1608	1	SA
....4	R1428	2007-000309	R-CHIP;10ohm,5%,1/10W,TP,1608	1	SA
....4	R1429	2007-000309	R-CHIP;10ohm,5%,1/10W,TP,1608	1	SA
....4	R1430	2007-000309	R-CHIP;10ohm,5%,1/10W,TP,1608	1	SA
....4	R1431	2007-000309	R-CHIP;10ohm,5%,1/10W,TP,1608	1	SA
....4	R1432	2007-000309	R-CHIP;10ohm,5%,1/10W,TP,1608	1	SA
....4	R1433	2007-000309	R-CHIP;10ohm,5%,1/10W,TP,1608	1	SA
....4	R1434	2007-000309	R-CHIP;10ohm,5%,1/10W,TP,1608	1	SA
....4	R1435	2007-000309	R-CHIP;10ohm,5%,1/10W,TP,1608	1	SA
....4	R1436	2007-000309	R-CHIP;10ohm,5%,1/10W,TP,1608	1	SA
....4	R1437	2007-000309	R-CHIP;10ohm,5%,1/10W,TP,1608	1	SA
....4	R1438	2007-000309	R-CHIP;10ohm,5%,1/10W,TP,1608	1	SA
....4	R1439	2007-000309	R-CHIP;10ohm,5%,1/10W,TP,1608	1	SA

6 Electrical Parts List

Level	Loc. No.	Code No.	Description & Specification	Q'ty	SA/SNA
....4	R1472	2007-000309	R-CHIP;10ohm,5%,1/10W,TP,1608	1	SA
....4	R1473	2007-000309	R-CHIP;10ohm,5%,1/10W,TP,1608	1	SA
....4	R1474	2007-000309	R-CHIP;10ohm,5%,1/10W,TP,1608	1	SA
....4	R1475	2007-000309	R-CHIP;10ohm,5%,1/10W,TP,1608	1	SA
....4	R1476	2007-000309	R-CHIP;10ohm,5%,1/10W,TP,1608	1	SA
....4	R1477	2007-000309	R-CHIP;10ohm,5%,1/10W,TP,1608	1	SA
....4	R1478	2007-000309	R-CHIP;10ohm,5%,1/10W,TP,1608	1	SA
....4	R1479	2007-000309	R-CHIP;10ohm,5%,1/10W,TP,1608	1	SA
....4	R1480	2007-000309	R-CHIP;10ohm,5%,1/10W,TP,1608	1	SA
....4	R1481	2007-000309	R-CHIP;10ohm,5%,1/10W,TP,1608	1	SA
....4	R1482	2007-000309	R-CHIP;10ohm,5%,1/10W,TP,1608	1	SA
....4	R1483	2007-000309	R-CHIP;10ohm,5%,1/10W,TP,1608	1	SA
....4	R1484	2007-000309	R-CHIP;10ohm,5%,1/10W,TP,1608	1	SA
....4	R1485	2007-000309	R-CHIP;10ohm,5%,1/10W,TP,1608	1	SA
....4	R1486	2007-000309	R-CHIP;10ohm,5%,1/10W,TP,1608	1	SA
....4	R1487	2007-000309	R-CHIP;10ohm,5%,1/10W,TP,1608	1	SA
....4	R1504_HDMI	2007-000309	R-CHIP;10ohm,5%,1/10W,TP,1608	1	SA
....4	R1506_HDMI	2007-000309	R-CHIP;10ohm,5%,1/10W,TP,1608	1	SA
....4	R1508_HDMI	2007-000309	R-CHIP;10ohm,5%,1/10W,TP,1608	1	SA
....4	R1509_HDMI	2007-000309	R-CHIP;10ohm,5%,1/10W,TP,1608	1	SA
....4	R1510_HDMI	2007-000309	R-CHIP;10ohm,5%,1/10W,TP,1608	1	SA
....4	R1511_HDMI	2007-000309	R-CHIP;10ohm,5%,1/10W,TP,1608	1	SA
....4	R1512_HDMI	2007-000309	R-CHIP;10ohm,5%,1/10W,TP,1608	1	SA
....4	R1513_HDMI	2007-000309	R-CHIP;10ohm,5%,1/10W,TP,1608	1	SA
....4	R1514_HDMI	2007-000309	R-CHIP;10ohm,5%,1/10W,TP,1608	1	SA
....4	R1515_HDMI	2007-000309	R-CHIP;10ohm,5%,1/10W,TP,1608	1	SA
....4	R1516_HDMI	2007-000309	R-CHIP;10ohm,5%,1/10W,TP,1608	1	SA
....4	R1518_HDMI	2007-000309	R-CHIP;10ohm,5%,1/10W,TP,1608	1	SA
....4	R1538_HDMI	2007-000309	R-CHIP;10ohm,5%,1/10W,TP,1608	1	SA
....4	R1539_HDMI	2007-000309	R-CHIP;10ohm,5%,1/10W,TP,1608	1	SA
....4	R1544_HDMI	2007-000309	R-CHIP;10ohm,5%,1/10W,TP,1608	1	SA
....4	R1546_HDMI	2007-000309	R-CHIP;10ohm,5%,1/10W,TP,1608	1	SA
....4	R1577	2007-000309	R-CHIP;10ohm,5%,1/10W,TP,1608	1	SA
....4	R1579	2007-000309	R-CHIP;10ohm,5%,1/10W,TP,1608	1	SA
....4	R1580_NSID	2007-000309	R-CHIP;10ohm,5%,1/10W,TP,1608	1	SA
....4	R1841	2007-000309	R-CHIP;10ohm,5%,1/10W,TP,1608	1	SA
....4	R1842	2007-000309	R-CHIP;10ohm,5%,1/10W,TP,1608	1	SA
....4	R1847	2007-000309	R-CHIP;10ohm,5%,1/10W,TP,1608	1	SA
....4	R1848_1M2M	2007-000309	R-CHIP;10ohm,5%,1/10W,TP,1608	1	SA
....4	R1849_1M2M	2007-000309	R-CHIP;10ohm,5%,1/10W,TP,1608	1	SA
....4	R1857	2007-000309	R-CHIP;10ohm,5%,1/10W,TP,1608	1	SA
....4	R1859	2007-000309	R-CHIP;10ohm,5%,1/10W,TP,1608	1	SA
....4	R1860	2007-000309	R-CHIP;10ohm,5%,1/10W,TP,1608	1	SA
....4	R1863	2007-000309	R-CHIP;10ohm,5%,1/10W,TP,1608	1	SA
....4	R1869	2007-000309	R-CHIP;10ohm,5%,1/10W,TP,1608	1	SA
....4	R1871	2007-000309	R-CHIP;10ohm,5%,1/10W,TP,1608	1	SA
....4	R1872	2007-000309	R-CHIP;10ohm,5%,1/10W,TP,1608	1	SA
....4	R1873	2007-000309	R-CHIP;10ohm,5%,1/10W,TP,1608	1	SA
....4	R1953_2M	2007-000309	R-CHIP;10ohm,5%,1/10W,TP,1608	1	SA
....4	R1637_OP	2007-000312	R-CHIP;10ohm,5%,1/4W,TP,3216	1	SA
....4	R1638_OP	2007-000312	R-CHIP;10ohm,5%,1/4W,TP,3216	1	SA
....4	R1112	2007-000402	R-CHIP;150ohm,5%,1/10W,TP,1608	1	SA
....4	R1616	2007-000458	R-CHIP;18Kohm,5%,1/10W,TP,1608	1	SA
....4	R1665	2007-000458	R-CHIP;18Kohm,5%,1/10W,TP,1608	1	SA
....4	R1686	2007-000458	R-CHIP;18Kohm,5%,1/10W,TP,1608	1	SA
....4	R1689	2007-000458	R-CHIP;18Kohm,5%,1/10W,TP,1608	1	SA
....4	R2021	2007-000475	R-CHIP;1Mohm,1%,1/10W,TP,1608	1	SA
....4	R3109	2007-000539	R-CHIP;200ohm,5%,1/10W,TP,1608	1	SA
....4	C1125	2007-000608	R-CHIP;240ohm,5%,1/10W,TP,1608	1	SA
....4	C1857_WX	2007-000608	R-CHIP;240ohm,5%,1/10W,TP,1608	1	SA
....4	R1123	2007-000640	R-CHIP;270ohm,1%,1/10W,TP,1608	1	SA
....4	R2318_FBE	2007-000669	R-CHIP;2Kohm,1%,1/10W,TP,1608	1	SA

Level	Loc. No.	Code No.	Description & Specification	Q'ty	SA/SNA
....4	R1258	2007-000683	R-CHIP;3.3Kohm,1%,1/10W,TP,1608	1	S.A
....4	R3014	2007-000763	R-CHIP;330ohm,1%,1/10W,TP,1608	1	S.A
....4	R3015	2007-000763	R-CHIP;330ohm,1%,1/10W,TP,1608	1	S.A
....4	R3021	2007-000763	R-CHIP;330ohm,1%,1/10W,TP,1608	1	S.A
....4	R3022	2007-000763	R-CHIP;330ohm,1%,1/10W,TP,1608	1	S.A
....4	R3024	2007-000763	R-CHIP;330ohm,1%,1/10W,TP,1608	1	S.A
....4	R3025	2007-000763	R-CHIP;330ohm,1%,1/10W,TP,1608	1	S.A
....4	R3026	2007-000763	R-CHIP;330ohm,1%,1/10W,TP,1608	1	S.A
....4	R3027	2007-000763	R-CHIP;330ohm,1%,1/10W,TP,1608	1	S.A
....4	R1269	2007-000869	R-CHIP;4.7Kohm,1%,1/10W,TP,1608	1	S.A
....4	R1246	2007-000882	R-CHIP;4.7ohm,5%,1/10W,TP,1608	1	S.A
....4	R1247	2007-000882	R-CHIP;4.7ohm,5%,1/10W,TP,1608	1	S.A
....4	R1249	2007-000882	R-CHIP;4.7ohm,5%,1/10W,TP,1608	1	S.A
....4	R1251	2007-000882	R-CHIP;4.7ohm,5%,1/10W,TP,1608	1	S.A
....4	R1252	2007-000882	R-CHIP;4.7ohm,5%,1/10W,TP,1608	1	S.A
....4	R1253	2007-000882	R-CHIP;4.7ohm,5%,1/10W,TP,1608	1	S.A
....4	R1259	2007-000882	R-CHIP;4.7ohm,5%,1/10W,TP,1608	1	S.A
....4	R1260	2007-000882	R-CHIP;4.7ohm,5%,1/10W,TP,1608	1	S.A
....4	R1410	2007-000950	R-CHIP;47ohm,5%,1/4W,TP,3216	1	S.A
....4	R1415	2007-000950	R-CHIP;47ohm,5%,1/4W,TP,3216	1	S.A
....4	R1422	2007-000950	R-CHIP;47ohm,5%,1/4W,TP,3216	1	S.A
....4	R1601_OP	2007-000950	R-CHIP;47ohm,5%,1/4W,TP,3216	1	S.A
....4	R1602_OP	2007-000950	R-CHIP;47ohm,5%,1/4W,TP,3216	1	S.A
....4	R1618	2007-000950	R-CHIP;47ohm,5%,1/4W,TP,3216	1	S.A
....4	R1619	2007-000950	R-CHIP;47ohm,5%,1/4W,TP,3216	1	S.A
....4	R1620	2007-000950	R-CHIP;47ohm,5%,1/4W,TP,3216	1	S.A
....4	R1633_OP	2007-000950	R-CHIP;47ohm,5%,1/4W,TP,3216	1	S.A
....4	R1125	2007-000962	R-CHIP;5.1Kohm,1%,1/10W,TP,1608	1	S.A
....4	R1115	2007-000979	R-CHIP;5.6Kohm,1%,1/10W,TP,1608	1	S.A
....4	R2233	2007-001014	R-CHIP;51OHM,5%,1/10W,TP,1608	1	S.A
....4	R2237	2007-001014	R-CHIP;51OHM,5%,1/10W,TP,1608	1	S.A
....4	R1131	2007-001135	R-CHIP;68ohm,5%,1/4W,TP,3216	1	S.A
....4	R1132	2007-001135	R-CHIP;68ohm,5%,1/4W,TP,3216	1	S.A
....4	R3116	2007-001139	R-CHIP;7.5Kohm,1%,1/10W,TP,1608	1	S.A
....4	R1425	2007-001164	R-CHIP;75ohm,1%,1/10W,TP,1608	1	S.A
....4	R1426	2007-001164	R-CHIP;75ohm,1%,1/10W,TP,1608	1	S.A
....4	R1427	2007-001164	R-CHIP;75ohm,1%,1/10W,TP,1608	1	S.A
....4	R1611_OP	2007-001164	R-CHIP;75ohm,1%,1/10W,TP,1608	1	S.A
....4	R1612_OP	2007-001164	R-CHIP;75ohm,1%,1/10W,TP,1608	1	S.A
....4	R1624	2007-001164	R-CHIP;75ohm,1%,1/10W,TP,1608	1	S.A
....4	R1625	2007-001164	R-CHIP;75ohm,1%,1/10W,TP,1608	1	S.A
....4	R1626	2007-001164	R-CHIP;75ohm,1%,1/10W,TP,1608	1	S.A
....4	R1635_OP	2007-001164	R-CHIP;75ohm,1%,1/10W,TP,1608	1	S.A
....4	R1636	2007-001164	R-CHIP;75ohm,1%,1/10W,TP,1608	1	S.A
....4	R1670_EU	2007-001164	R-CHIP;75ohm,1%,1/10W,TP,1608	1	S.A
....4	R1440	2007-001167	R-CHIP;75ohm,5%,1/10W,TP,1608	1	S.A
....4	R1441	2007-001167	R-CHIP;75ohm,5%,1/10W,TP,1608	1	S.A
....4	R1443	2007-001167	R-CHIP;75ohm,5%,1/10W,TP,1608	1	S.A
....4	R1447	2007-001167	R-CHIP;75ohm,5%,1/10W,TP,1608	1	S.A
....4	R1448	2007-001167	R-CHIP;75ohm,5%,1/10W,TP,1608	1	S.A
....4	R1449	2007-001167	R-CHIP;75ohm,5%,1/10W,TP,1608	1	S.A
....4	R1455	2007-001167	R-CHIP;75ohm,5%,1/10W,TP,1608	1	S.A
....4	R1458	2007-001167	R-CHIP;75ohm,5%,1/10W,TP,1608	1	S.A
....4	R1623_DE	2007-001167	R-CHIP;75ohm,5%,1/10W,TP,1608	1	S.A
....4	R1632_EU	2007-001167	R-CHIP;75ohm,5%,1/10W,TP,1608	1	S.A
....4	R1667_EU	2007-001167	R-CHIP;75ohm,5%,1/10W,TP,1608	1	S.A
....4	R2055	2007-001167	R-CHIP;75ohm,5%,1/10W,TP,1608	1	S.A
....4	R2056	2007-001167	R-CHIP;75ohm,5%,1/10W,TP,1608	1	S.A
....4	R2212	2007-001167	R-CHIP;75ohm,5%,1/10W,TP,1608	1	S.A
....4	R3003_TEST	2007-001167	R-CHIP;75ohm,5%,1/10W,TP,1608	1	S.A
....4	R3005_TEST	2007-001167	R-CHIP;75ohm,5%,1/10W,TP,1608	1	S.A
....4	R3117	2007-008467	R-CHIP;2.26Kohm,1%,1/10W,TP,1608	1	S.A

6 Electrical Parts List

Level	Loc. No.	Code No.	Description & Specification	Q'ty	SA/SNA
....4	RA2201	2011-000002	R-NET;22ohm,5%,1/16W,L,CHIP,8P,TP,3216	1	SA
....4	RA2202	2011-000002	R-NET;22ohm,5%,1/16W,L,CHIP,8P,TP,3216	1	SA
....4	RA2203	2011-000002	R-NET;22ohm,5%,1/16W,L,CHIP,8P,TP,3216	1	SA
....4	RA2204	2011-000002	R-NET;22ohm,5%,1/16W,L,CHIP,8P,TP,3216	1	SA
....4	RA2205	2011-000002	R-NET;22ohm,5%,1/16W,L,CHIP,8P,TP,3216	1	SA
....4	RA2206	2011-000002	R-NET;22ohm,5%,1/16W,L,CHIP,8P,TP,3216	1	SA
....4	RA2207	2011-000002	R-NET;22ohm,5%,1/16W,L,CHIP,8P,TP,3216	1	SA
....4	RA2208	2011-000002	R-NET;22ohm,5%,1/16W,L,CHIP,8P,TP,3216	1	SA
....4	RA1804	2011-000651	R-NET;10ohm,5%,1/16W,L,CHIP,8P,TP,3216	1	SA
....4	RA1805	2011-000651	R-NET;10ohm,5%,1/16W,L,CHIP,8P,TP,3216	1	SA
....4	RA1807	2011-000651	R-NET;10ohm,5%,1/16W,L,CHIP,8P,TP,3216	1	SA
....4	RA1808	2011-000651	R-NET;10ohm,5%,1/16W,L,CHIP,8P,TP,3216	1	SA
....4	RA1809	2011-000651	R-NET;10ohm,5%,1/16W,L,CHIP,8P,TP,3216	1	SA
....4	RA1811	2011-000651	R-NET;10ohm,5%,1/16W,L,CHIP,8P,TP,3216	1	SA
....4	RA1814	2011-000881	R-NET;33ohm,5%,1/16W,L,CHIP,8P,TP,3.2x1.	1	SA
....4	RA3105	2011-000881	R-NET;33ohm,5%,1/16W,L,CHIP,8P,TP,3.2x1.	1	SA
....4	RA3107	2011-000881	R-NET;33ohm,5%,1/16W,L,CHIP,8P,TP,3.2x1.	1	SA
....4	RA3110	2011-000881	R-NET;33ohm,5%,1/16W,L,CHIP,8P,TP,3.2x1.	1	SA
....4	RA3112	2011-000881	R-NET;33ohm,5%,1/16W,L,CHIP,8P,TP,3.2x1.	1	SA
....4	RA3114	2011-000881	R-NET;33ohm,5%,1/16W,L,CHIP,8P,TP,3.2x1.	1	SA
....4	RA3115	2011-000881	R-NET;33ohm,5%,1/16W,L,CHIP,8P,TP,3.2x1.	1	SA
....4	RA3205	2011-000881	R-NET;33ohm,5%,1/16W,L,CHIP,8P,TP,3.2x1.	1	SA
....4	RA3206	2011-000881	R-NET;33ohm,5%,1/16W,L,CHIP,8P,TP,3.2x1.	1	SA
....4	RA3207	2011-000881	R-NET;33ohm,5%,1/16W,L,CHIP,8P,TP,3.2x1.	1	SA
....4	RA3208	2011-000881	R-NET;33ohm,5%,1/16W,L,CHIP,8P,TP,3.2x1.	1	SA
....4	RA3209	2011-000881	R-NET;33ohm,5%,1/16W,L,CHIP,8P,TP,3.2x1.	1	SA
....4	RA3210	2011-000881	R-NET;33ohm,5%,1/16W,L,CHIP,8P,TP,3.2x1.	1	SA
....4	RA1401_NSI	2011-001001	R-NET;0ohm,5%,1/16W,L,CHIP,8P,TP,3.2x1.6	1	SA
....4	RA1402_NSI	2011-001001	R-NET;0ohm,5%,1/16W,L,CHIP,8P,TP,3.2x1.6	1	SA
....4	RA1403_NSI	2011-001001	R-NET;0ohm,5%,1/16W,L,CHIP,8P,TP,3.2x1.6	1	SA
....4	RA2011_FBE	2011-001001	R-NET;0ohm,5%,1/16W,L,CHIP,8P,TP,3.2x1.6	1	SA
....4	RA2012_FBE	2011-001001	R-NET;0ohm,5%,1/16W,L,CHIP,8P,TP,3.2x1.6	1	SA
....4	RA2013_FBE	2011-001001	R-NET;0ohm,5%,1/16W,L,CHIP,8P,TP,3.2x1.6	1	SA
....4	RA2209_FBE	2011-001001	R-NET;0ohm,5%,1/16W,L,CHIP,8P,TP,3.2x1.6	1	SA
....4	RA2212	2011-001001	R-NET;0ohm,5%,1/16W,L,CHIP,8P,TP,3.2x1.6	1	SA
....4	RA2213	2011-001001	R-NET;0ohm,5%,1/16W,L,CHIP,8P,TP,3.2x1.6	1	SA
....4	RA2214	2011-001001	R-NET;0ohm,5%,1/16W,L,CHIP,8P,TP,3.2x1.6	1	SA
....4	RA2215	2011-001001	R-NET;0ohm,5%,1/16W,L,CHIP,8P,TP,3.2x1.6	1	SA
....4	RA3001_TES	2011-001011	R-NET;10Kohm,5%,1/16W,L,CHIP,8P,TP,3.2x1	1	SA
....4	RA1802	2011-001093	R-NET;100OHM,5%,1/16W,L,CHIP,8P,TP,3216	1	SA
....4	RA1803	2011-001093	R-NET;100OHM,5%,1/16W,L,CHIP,8P,TP,3216	1	SA
....4	RA1806	2011-001093	R-NET;100OHM,5%,1/16W,L,CHIP,8P,TP,3216	1	SA
....4	RA1810	2011-001093	R-NET;100OHM,5%,1/16W,L,CHIP,8P,TP,3216	1	SA
....4	RA1812	2011-001093	R-NET;100OHM,5%,1/16W,L,CHIP,8P,TP,3216	1	SA
....4	RA1813	2011-001093	R-NET;100OHM,5%,1/16W,L,CHIP,8P,TP,3216	1	SA
....4	RA1815	2011-001093	R-NET;100OHM,5%,1/16W,L,CHIP,8P,TP,3216	1	SA
....4	RA1816	2011-001093	R-NET;100OHM,5%,1/16W,L,CHIP,8P,TP,3216	1	SA
....4	RA1818	2011-001093	R-NET;100OHM,5%,1/16W,L,CHIP,8P,TP,3216	1	SA
....4	RA1820	2011-001093	R-NET;100OHM,5%,1/16W,L,CHIP,8P,TP,3216	1	SA
....4	RA1821	2011-001093	R-NET;100OHM,5%,1/16W,L,CHIP,8P,TP,3216	1	SA
....4	RA1822	2011-001093	R-NET;100OHM,5%,1/16W,L,CHIP,8P,TP,3216	1	SA
....4	RA1823	2011-001093	R-NET;100OHM,5%,1/16W,L,CHIP,8P,TP,3216	1	SA
....4	RA3201	2011-001093	R-NET;100OHM,5%,1/16W,L,CHIP,8P,TP,3216	1	SA
....4	RA3202	2011-001093	R-NET;100OHM,5%,1/16W,L,CHIP,8P,TP,3216	1	SA
....4	C1106	2203-000189	C-CER,CHIP;100nF,+80-20%,25V,Y5V,1608	1	SA
....4	C1111	2203-000189	C-CER,CHIP;100nF,+80-20%,25V,Y5V,1608	1	SA
....4	C1118	2203-000189	C-CER,CHIP;100nF,+80-20%,25V,Y5V,1608	1	SA
....4	C1120	2203-000189	C-CER,CHIP;100nF,+80-20%,25V,Y5V,1608	1	SA
....4	C1122	2203-000189	C-CER,CHIP;100nF,+80-20%,25V,Y5V,1608	1	SA
....4	C1129	2203-000189	C-CER,CHIP;100nF,+80-20%,25V,Y5V,1608	1	SA
....4	C1143	2203-000189	C-CER,CHIP;100nF,+80-20%,25V,Y5V,1608	1	SA
....4	C1144	2203-000189	C-CER,CHIP;100nF,+80-20%,25V,Y5V,1608	1	SA

6 Electrical Parts List

Level	Loc. No.	Code No.	Description & Specification	Q'ty	SA/SNA
....4	C2121	2203-000189	C-CER,CHIP;100nF,+80-20%,25V,Y5V,1608	1	SA
....4	C2224	2203-000189	C-CER,CHIP;100nF,+80-20%,25V,Y5V,1608	1	SA
....4	C2272_FBE	2203-000189	C-CER,CHIP;100nF,+80-20%,25V,Y5V,1608	1	SA
....4	C2273_FBE	2203-000189	C-CER,CHIP;100nF,+80-20%,25V,Y5V,1608	1	SA
....4	C2274_FBE	2203-000189	C-CER,CHIP;100nF,+80-20%,25V,Y5V,1608	1	SA
....4	C2281_FBE	2203-000189	C-CER,CHIP;100nF,+80-20%,25V,Y5V,1608	1	SA
....4	C2282_FBE	2203-000189	C-CER,CHIP;100nF,+80-20%,25V,Y5V,1608	1	SA
....4	C2283_FBE	2203-000189	C-CER,CHIP;100nF,+80-20%,25V,Y5V,1608	1	SA
....4	C2302_FBE	2203-000189	C-CER,CHIP;100nF,+80-20%,25V,Y5V,1608	1	SA
....4	C2304_FBE	2203-000189	C-CER,CHIP;100nF,+80-20%,25V,Y5V,1608	1	SA
....4	C2305_FBE	2203-000189	C-CER,CHIP;100nF,+80-20%,25V,Y5V,1608	1	SA
....4	C2316_FBE	2203-000189	C-CER,CHIP;100nF,+80-20%,25V,Y5V,1608	1	SA
....4	C2227	2203-000204	C-CER,CHIP;100nF,10%,25V,X7R,2012	1	SA
....4	C2228	2203-000204	C-CER,CHIP;100nF,10%,25V,X7R,2012	1	SA
....4	C2217	2203-000206	C-CER,CHIP;100nF,10%,50V,X7R,2012	1	SA
....4	C1293	2203-000236	C-CER,CHIP;0.1nF,5%,50V,COG,1608	1	SA
....4	C1309	2203-000236	C-CER,CHIP;0.1nF,5%,50V,COG,1608	1	SA
....4	C1408	2203-000236	C-CER,CHIP;0.1nF,5%,50V,COG,1608	1	SA
....4	C1409	2203-000236	C-CER,CHIP;0.1nF,5%,50V,COG,1608	1	SA
....4	C1417	2203-000236	C-CER,CHIP;0.1nF,5%,50V,COG,1608	1	SA
....4	C1418	2203-000236	C-CER,CHIP;0.1nF,5%,50V,COG,1608	1	SA
....4	C1419	2203-000236	C-CER,CHIP;0.1nF,5%,50V,COG,1608	1	SA
....4	C1420	2203-000236	C-CER,CHIP;0.1nF,5%,50V,COG,1608	1	SA
....4	C1601_OP	2203-000236	C-CER,CHIP;0.1nF,5%,50V,COG,1608	1	SA
....4	C1605	2203-000236	C-CER,CHIP;0.1nF,5%,50V,COG,1608	1	SA
....4	C1607	2203-000236	C-CER,CHIP;0.1nF,5%,50V,COG,1608	1	SA
....4	C1608_OP	2203-000236	C-CER,CHIP;0.1nF,5%,50V,COG,1608	1	SA
....4	C1611_EU	2203-000236	C-CER,CHIP;0.1nF,5%,50V,COG,1608	1	SA
....4	C1620	2203-000236	C-CER,CHIP;0.1nF,5%,50V,COG,1608	1	SA
....4	C1622	2203-000236	C-CER,CHIP;0.1nF,5%,50V,COG,1608	1	SA
....4	C1623_EU	2203-000236	C-CER,CHIP;0.1nF,5%,50V,COG,1608	1	SA
....4	C3026	2203-000236	C-CER,CHIP;0.1nF,5%,50V,COG,1608	1	SA
....4	C1101	2203-000257	C-CER,CHIP;10nF,10%,50V,X7R,1608	1	SA
....4	C1116	2203-000257	C-CER,CHIP;10nF,10%,50V,X7R,1608	1	SA
....4	C1121	2203-000257	C-CER,CHIP;10nF,10%,50V,X7R,1608	1	SA
....4	C1130	2203-000257	C-CER,CHIP;10nF,10%,50V,X7R,1608	1	SA
....4	C1138	2203-000257	C-CER,CHIP;10nF,10%,50V,X7R,1608	1	SA
....4	C1148	2203-000257	C-CER,CHIP;10nF,10%,50V,X7R,1608	1	SA
....4	C1155	2203-000257	C-CER,CHIP;10nF,10%,50V,X7R,1608	1	SA
....4	C1164	2203-000257	C-CER,CHIP;10nF,10%,50V,X7R,1608	1	SA
....4	C1173	2203-000257	C-CER,CHIP;10nF,10%,50V,X7R,1608	1	SA
....4	C1174	2203-000257	C-CER,CHIP;10nF,10%,50V,X7R,1608	1	SA
....4	C1647	2203-000257	C-CER,CHIP;10nF,10%,50V,X7R,1608	1	SA
....4	C1652	2203-000257	C-CER,CHIP;10nF,10%,50V,X7R,1608	1	SA
....4	C1653	2203-000257	C-CER,CHIP;10nF,10%,50V,X7R,1608	1	SA
....4	C1654_PAD	2203-000257	C-CER,CHIP;10nF,10%,50V,X7R,1608	1	SA
....4	C1655	2203-000257	C-CER,CHIP;10nF,10%,50V,X7R,1608	1	SA
....4	C1656_LAMP	2203-000257	C-CER,CHIP;10nF,10%,50V,X7R,1608	1	SA
....4	C1853	2203-000257	C-CER,CHIP;10nF,10%,50V,X7R,1608	1	SA
....4	C2027	2203-000257	C-CER,CHIP;10nF,10%,50V,X7R,1608	1	SA
....4	C2032	2203-000257	C-CER,CHIP;10nF,10%,50V,X7R,1608	1	SA
....4	C2033	2203-000257	C-CER,CHIP;10nF,10%,50V,X7R,1608	1	SA
....4	C2034	2203-000257	C-CER,CHIP;10nF,10%,50V,X7R,1608	1	SA
....4	C2035	2203-000257	C-CER,CHIP;10nF,10%,50V,X7R,1608	1	SA
....4	C2043	2203-000257	C-CER,CHIP;10nF,10%,50V,X7R,1608	1	SA
....4	C2044	2203-000257	C-CER,CHIP;10nF,10%,50V,X7R,1608	1	SA
....4	C2045	2203-000257	C-CER,CHIP;10nF,10%,50V,X7R,1608	1	SA
....4	C2105	2203-000257	C-CER,CHIP;10nF,10%,50V,X7R,1608	1	SA
....4	C2106	2203-000257	C-CER,CHIP;10nF,10%,50V,X7R,1608	1	SA
....4	C2107	2203-000257	C-CER,CHIP;10nF,10%,50V,X7R,1608	1	SA
....4	C2108	2203-000257	C-CER,CHIP;10nF,10%,50V,X7R,1608	1	SA
....4	C2109	2203-000257	C-CER,CHIP;10nF,10%,50V,X7R,1608	1	SA

Level	Loc. No.	Code No.	Description & Specification	Q'ty	SA/SNA
....4	C2110	2203-000257	C-CER,CHIP;10nF,10%,50V,X7R,1608	1	S.A
....4	C2111	2203-000257	C-CER,CHIP;10nF,10%,50V,X7R,1608	1	S.A
....4	C2112	2203-000257	C-CER,CHIP;10nF,10%,50V,X7R,1608	1	S.A
....4	C2113	2203-000257	C-CER,CHIP;10nF,10%,50V,X7R,1608	1	S.A
....4	C2114	2203-000257	C-CER,CHIP;10nF,10%,50V,X7R,1608	1	S.A
....4	C2115	2203-000257	C-CER,CHIP;10nF,10%,50V,X7R,1608	1	S.A
....4	C2116	2203-000257	C-CER,CHIP;10nF,10%,50V,X7R,1608	1	S.A
....4	C2117	2203-000257	C-CER,CHIP;10nF,10%,50V,X7R,1608	1	S.A
....4	C2118	2203-000257	C-CER,CHIP;10nF,10%,50V,X7R,1608	1	S.A
....4	C2119	2203-000257	C-CER,CHIP;10nF,10%,50V,X7R,1608	1	S.A
....4	C2120	2203-000257	C-CER,CHIP;10nF,10%,50V,X7R,1608	1	S.A
....4	C2206	2203-000257	C-CER,CHIP;10nF,10%,50V,X7R,1608	1	S.A
....4	C2207	2203-000257	C-CER,CHIP;10nF,10%,50V,X7R,1608	1	S.A
....4	C2208	2203-000257	C-CER,CHIP;10nF,10%,50V,X7R,1608	1	S.A
....4	C2209	2203-000257	C-CER,CHIP;10nF,10%,50V,X7R,1608	1	S.A
....4	C2210	2203-000257	C-CER,CHIP;10nF,10%,50V,X7R,1608	1	S.A
....4	C2221	2203-000257	C-CER,CHIP;10nF,10%,50V,X7R,1608	1	S.A
....4	C2231	2203-000257	C-CER,CHIP;10nF,10%,50V,X7R,1608	1	S.A
....4	C2268_LCD	2203-000257	C-CER,CHIP;10nF,10%,50V,X7R,1608	1	S.A
....4	C2269_LCD	2203-000257	C-CER,CHIP;10nF,10%,50V,X7R,1608	1	S.A
....4	C2275_FBE	2203-000257	C-CER,CHIP;10nF,10%,50V,X7R,1608	1	S.A
....4	C2276_FBE	2203-000257	C-CER,CHIP;10nF,10%,50V,X7R,1608	1	S.A
....4	C2277_FBE	2203-000257	C-CER,CHIP;10nF,10%,50V,X7R,1608	1	S.A
....4	C2284_FBE	2203-000257	C-CER,CHIP;10nF,10%,50V,X7R,1608	1	S.A
....4	C2285_FBE	2203-000257	C-CER,CHIP;10nF,10%,50V,X7R,1608	1	S.A
....4	C2286_FBE	2203-000257	C-CER,CHIP;10nF,10%,50V,X7R,1608	1	S.A
....4	C2293_FBE	2203-000257	C-CER,CHIP;10nF,10%,50V,X7R,1608	1	S.A
....4	C2294_FBE	2203-000257	C-CER,CHIP;10nF,10%,50V,X7R,1608	1	S.A
....4	C2295_FBE	2203-000257	C-CER,CHIP;10nF,10%,50V,X7R,1608	1	S.A
....4	C2296_FBE	2203-000257	C-CER,CHIP;10nF,10%,50V,X7R,1608	1	S.A
....4	C2297_FBE	2203-000257	C-CER,CHIP;10nF,10%,50V,X7R,1608	1	S.A
....4	C2312_FBE	2203-000257	C-CER,CHIP;10nF,10%,50V,X7R,1608	1	S.A
....4	C2313_FBE	2203-000257	C-CER,CHIP;10nF,10%,50V,X7R,1608	1	S.A
....4	C2314_FBE	2203-000257	C-CER,CHIP;10nF,10%,50V,X7R,1608	1	S.A
....4	C2315_FBE	2203-000257	C-CER,CHIP;10nF,10%,50V,X7R,1608	1	S.A
....4	C2317_FBE	2203-000257	C-CER,CHIP;10nF,10%,50V,X7R,1608	1	S.A
....4	C3010	2203-000257	C-CER,CHIP;10nF,10%,50V,X7R,1608	1	S.A
....4	C3011	2203-000257	C-CER,CHIP;10nF,10%,50V,X7R,1608	1	S.A
....4	C1855	2203-000332	C-CER,CHIP;0.012nF,5%,50V,COG,1608	1	S.A
....4	C1856	2203-000332	C-CER,CHIP;0.012nF,5%,50V,COG,1608	1	S.A
....4	C1112	2203-000405	C-CER,CHIP;0.18nF,5%,50V,COG,1608	1	S.A
....4	C1205	2203-000426	C-CER,CHIP;0.018nF,5%,50V,COG,1608	1	S.A
....4	C1206	2203-000426	C-CER,CHIP;0.018nF,5%,50V,COG,1608	1	S.A
....4	C2080	2203-000426	C-CER,CHIP;0.018nF,5%,50V,COG,1608	1	S.A
....4	C2082	2203-000426	C-CER,CHIP;0.018nF,5%,50V,COG,1608	1	S.A
....4	C1215	2203-000440	C-CER,CHIP;1nF,10%,50V,X7R,1608	1	S.A
....4	C1230	2203-000440	C-CER,CHIP;1nF,10%,50V,X7R,1608	1	S.A
....4	C1272	2203-000440	C-CER,CHIP;1nF,10%,50V,X7R,1608	1	S.A
....4	C1273	2203-000440	C-CER,CHIP;1nF,10%,50V,X7R,1608	1	S.A
....4	C1274	2203-000440	C-CER,CHIP;1nF,10%,50V,X7R,1608	1	S.A
....4	C1277	2203-000440	C-CER,CHIP;1nF,10%,50V,X7R,1608	1	S.A
....4	C1279	2203-000440	C-CER,CHIP;1nF,10%,50V,X7R,1608	1	S.A
....4	C1283	2203-000440	C-CER,CHIP;1nF,10%,50V,X7R,1608	1	S.A
....4	C1291	2203-000440	C-CER,CHIP;1nF,10%,50V,X7R,1608	1	S.A
....4	C1292	2203-000440	C-CER,CHIP;1nF,10%,50V,X7R,1608	1	S.A
....4	C1294	2203-000440	C-CER,CHIP;1nF,10%,50V,X7R,1608	1	S.A
....4	C1299	2203-000440	C-CER,CHIP;1nF,10%,50V,X7R,1608	1	S.A
....4	C1308	2203-000440	C-CER,CHIP;1nF,10%,50V,X7R,1608	1	S.A
....4	C1310	2203-000440	C-CER,CHIP;1nF,10%,50V,X7R,1608	1	S.A
....4	C1311	2203-000440	C-CER,CHIP;1nF,10%,50V,X7R,1608	1	S.A
....4	C1816	2203-000440	C-CER,CHIP;1nF,10%,50V,X7R,1608	1	S.A
....4	C1818	2203-000440	C-CER,CHIP;1nF,10%,50V,X7R,1608	1	S.A

6 Electrical Parts List

Level	Loc. No.	Code No.	Description & Specification	Q'ty	SA/SNA
....4	C1823	2203-000440	C-CER,CHIP;1nF,10%,50V,X7R,1608	1	SA
....4	C1843	2203-000440	C-CER,CHIP;1nF,10%,50V,X7R,1608	1	SA
....4	C2219	2203-000440	C-CER,CHIP;1nF,10%,50V,X7R,1608	1	SA
....4	C2257_LCD	2203-000440	C-CER,CHIP;1nF,10%,50V,X7R,1608	1	SA
....4	C2288_FBE	2203-000440	C-CER,CHIP;1nF,10%,50V,X7R,1608	1	SA
....4	C2289_FBE	2203-000440	C-CER,CHIP;1nF,10%,50V,X7R,1608	1	SA
....4	C2299_FBE	2203-000440	C-CER,CHIP;1nF,10%,50V,X7R,1608	1	SA
....4	C2300_FBE	2203-000440	C-CER,CHIP;1nF,10%,50V,X7R,1608	1	SA
....4	C2301_FBE	2203-000440	C-CER,CHIP;1nF,10%,50V,X7R,1608	1	SA
....4	C1105	2203-000491	C-CER,CHIP;2.2nF,10%,50V,X7R,1608	1	SA
....4	C2019	2203-000531	C-CER,CHIP;2.7nF,10%,50V,X7R,1608	1	SA
....4	C2030	2203-000531	C-CER,CHIP;2.7nF,10%,50V,X7R,1608	1	SA
....4	C1824	2203-000626	C-CER,CHIP;0.022nF,5%,50V,C0G,1608	1	SA
....4	C1825	2203-000626	C-CER,CHIP;0.022nF,5%,50V,C0G,1608	1	SA
....4	C3223	2203-000626	C-CER,CHIP;0.022nF,5%,50V,C0G,1608	1	SA
....4	C3224	2203-000626	C-CER,CHIP;0.022nF,5%,50V,C0G,1608	1	SA
....4	C3005	2203-000659	C-CER,CHIP;0.27nF,5%,50V,C0G,1608	1	SA
....4	C3019	2203-000659	C-CER,CHIP;0.27nF,5%,50V,C0G,1608	1	SA
....4	C3023	2203-000659	C-CER,CHIP;0.27nF,5%,50V,C0G,1608	1	SA
....4	C3030	2203-000659	C-CER,CHIP;0.27nF,5%,50V,C0G,1608	1	SA
....4	C1134	2203-000715	C-CER,CHIP;3.3nF,10%,50V,X7R,1608	1	SA
....4	C1403	2203-000783	C-CER,CHIP;0.33nF,5%,50V,C0G,1608	1	SA
....4	C1404	2203-000783	C-CER,CHIP;0.33nF,5%,50V,C0G,1608	1	SA
....4	C1411	2203-000783	C-CER,CHIP;0.33nF,5%,50V,C0G,1608	1	SA
....4	C1412	2203-000783	C-CER,CHIP;0.33nF,5%,50V,C0G,1608	1	SA
....4	C1457	2203-000783	C-CER,CHIP;0.33nF,5%,50V,C0G,1608	1	SA
....4	C1458	2203-000783	C-CER,CHIP;0.33nF,5%,50V,C0G,1608	1	SA
....4	C1603_OP	2203-000783	C-CER,CHIP;0.33nF,5%,50V,C0G,1608	1	SA
....4	C1604_EU	2203-000783	C-CER,CHIP;0.33nF,5%,50V,C0G,1608	1	SA
....4	C1606_EU	2203-000783	C-CER,CHIP;0.33nF,5%,50V,C0G,1608	1	SA
....4	C1609_OP	2203-000783	C-CER,CHIP;0.33nF,5%,50V,C0G,1608	1	SA
....4	C1610_OP	2203-000783	C-CER,CHIP;0.33nF,5%,50V,C0G,1608	1	SA
....4	C1613_OP	2203-000783	C-CER,CHIP;0.33nF,5%,50V,C0G,1608	1	SA
....4	C1614_OP	2203-000783	C-CER,CHIP;0.33nF,5%,50V,C0G,1608	1	SA
....4	C1615_OP	2203-000783	C-CER,CHIP;0.33nF,5%,50V,C0G,1608	1	SA
....4	C1619	2203-000783	C-CER,CHIP;0.33nF,5%,50V,C0G,1608	1	SA
....4	C1621	2203-000783	C-CER,CHIP;0.33nF,5%,50V,C0G,1608	1	SA
....4	C1317_DE	2203-000815	C-CER,CHIP;0.033nF,5%,50V,C0G,1608	1	SA
....4	C1318_DE	2203-000815	C-CER,CHIP;0.033nF,5%,50V,C0G,1608	1	SA
....4	C3004	2203-000815	C-CER,CHIP;0.033nF,5%,50V,C0G,1608	1	SA
....4	C3014	2203-000815	C-CER,CHIP;0.033nF,5%,50V,C0G,1608	1	SA
....4	C3022	2203-000815	C-CER,CHIP;0.033nF,5%,50V,C0G,1608	1	SA
....4	C1107	2203-000888	C-CER,CHIP;4.7nF,10%,50V,X7R,1608	1	SA
....4	C1233	2203-000888	C-CER,CHIP;4.7nF,10%,50V,X7R,1608	1	SA
....4	C1234	2203-000888	C-CER,CHIP;4.7nF,10%,50V,X7R,1608	1	SA
....4	C1235	2203-000888	C-CER,CHIP;4.7nF,10%,50V,X7R,1608	1	SA
....4	C1236	2203-000888	C-CER,CHIP;4.7nF,10%,50V,X7R,1608	1	SA
....4	C1257	2203-000888	C-CER,CHIP;4.7nF,10%,50V,X7R,1608	1	SA
....4	C1258	2203-000888	C-CER,CHIP;4.7nF,10%,50V,X7R,1608	1	SA
....4	C1259	2203-000888	C-CER,CHIP;4.7nF,10%,50V,X7R,1608	1	SA
....4	C1260	2203-000888	C-CER,CHIP;4.7nF,10%,50V,X7R,1608	1	SA
....4	C1261	2203-000888	C-CER,CHIP;4.7nF,10%,50V,X7R,1608	1	SA
....4	C1262	2203-000888	C-CER,CHIP;4.7nF,10%,50V,X7R,1608	1	SA
....4	C1263	2203-000888	C-CER,CHIP;4.7nF,10%,50V,X7R,1608	1	SA
....4	C1264	2203-000888	C-CER,CHIP;4.7nF,10%,50V,X7R,1608	1	SA
....4	C1265	2203-000888	C-CER,CHIP;4.7nF,10%,50V,X7R,1608	1	SA
....4	C1266	2203-000888	C-CER,CHIP;4.7nF,10%,50V,X7R,1608	1	SA
....4	C1267	2203-000888	C-CER,CHIP;4.7nF,10%,50V,X7R,1608	1	SA
....4	C1268	2203-000888	C-CER,CHIP;4.7nF,10%,50V,X7R,1608	1	SA
....4	C2203	2203-000888	C-CER,CHIP;4.7nF,10%,50V,X7R,1608	1	SA
....4	C2204	2203-000888	C-CER,CHIP;4.7nF,10%,50V,X7R,1608	1	SA
....4	C1278	2203-000925	C-CER,CHIP;470nF,+80-20%,50V,Y5V,2012	1	SA

Level	Loc. No.	Code No.	Description & Specification	Q'ty	SA/SNA
....4	C1302	2203-000925	C-CER,CHIP;470nF,+80-20%,50V,Y5V,2012	1	S.A
....4	C1136	2203-000972	C-CER,CHIP;47nF,10%,16V,X7R,1608	1	S.A
....4	C1612	2203-000998	C-CER,CHIP;0.047nF,5%,50V,C0G,1608	1	S.A
....4	C1624_EU	2203-000998	C-CER,CHIP;0.047nF,5%,50V,C0G,1608	1	S.A
....4	C1651	2203-000998	C-CER,CHIP;0.047nF,5%,50V,C0G,1608	1	S.A
....4	C1800	2203-000998	C-CER,CHIP;0.047nF,5%,50V,C0G,1608	1	S.A
....4	C1801	2203-000998	C-CER,CHIP;0.047nF,5%,50V,C0G,1608	1	S.A
....4	C2319_FBE	2203-001034	C-CER,CHIP;5.6nF,10%,50V,X7R,1608	1	S.A
....4	C2320_FBE	2203-001052	C-CER,CHIP;0.56nF,10%,50V,X7R,TP,1608	1	S.A
....4	C1203	2203-001222	C-CER,CHIP;0.82nF,10%,50V,X7R,1608	1	S.A
....4	C1226	2203-001222	C-CER,CHIP;0.82nF,10%,50V,X7R,1608	1	S.A
....4	C1227	2203-001222	C-CER,CHIP;0.82nF,10%,50V,X7R,1608	1	S.A
....4	C1202	2203-001402	C-CER,CHIP;220nF,+80-20%,16V,Y5V,TP,1608	1	S.A
....4	C1139	2203-001607	C-CER,CHIP;0.22nF,5%,50V,NP0,1608	1	S.A
....4	C3001	2203-001630	C-CER,CHIP;330nF,+80-20%,16V,Y5V,1608	1	S.A
....4	C3002	2203-001630	C-CER,CHIP;330nF,+80-20%,16V,Y5V,1608	1	S.A
....4	C1630_UX	2203-001656	C-CER,CHIP;0.47nF,5%,50V,NP0,1608	1	S.A
....4	C1284	2203-002398	C-CER,CHIP;22nF,10%,50V,X7R,1608	1	S.A
....4	C1285	2203-002398	C-CER,CHIP;22nF,10%,50V,X7R,1608	1	S.A
....4	C1290	2203-002398	C-CER,CHIP;22nF,10%,50V,X7R,1608	1	S.A
....4	C1316	2203-002398	C-CER,CHIP;22nF,10%,50V,X7R,1608	1	S.A
....4	C1109	2203-005005	C-CER,CHIP;100nF,10%,16V,X7R,1608	1	S.A
....4	C1119	2203-005005	C-CER,CHIP;100nF,10%,16V,X7R,1608	1	S.A
....4	C1128	2203-005005	C-CER,CHIP;100nF,10%,16V,X7R,1608	1	S.A
....4	C1145	2203-005005	C-CER,CHIP;100nF,10%,16V,X7R,1608	1	S.A
....4	C1147	2203-005005	C-CER,CHIP;100nF,10%,16V,X7R,1608	1	S.A
....4	C1153	2203-005005	C-CER,CHIP;100nF,10%,16V,X7R,1608	1	S.A
....4	C1154	2203-005005	C-CER,CHIP;100nF,10%,16V,X7R,1608	1	S.A
....4	C1157	2203-005005	C-CER,CHIP;100nF,10%,16V,X7R,1608	1	S.A
....4	C1159	2203-005005	C-CER,CHIP;100nF,10%,16V,X7R,1608	1	S.A
....4	C1161_LCD	2203-005005	C-CER,CHIP;100nF,10%,16V,X7R,1608	1	S.A
....4	C1162	2203-005005	C-CER,CHIP;100nF,10%,16V,X7R,1608	1	S.A
....4	C1183	2203-005005	C-CER,CHIP;100nF,10%,16V,X7R,1608	1	S.A
....4	C1425	2203-005005	C-CER,CHIP;100nF,10%,16V,X7R,1608	1	S.A
....4	C1625	2203-005005	C-CER,CHIP;100nF,10%,16V,X7R,1608	1	S.A
....4	C1628_UX	2203-005005	C-CER,CHIP;100nF,10%,16V,X7R,1608	1	S.A
....4	C1631_UX	2203-005005	C-CER,CHIP;100nF,10%,16V,X7R,1608	1	S.A
....4	C1633_UX	2203-005005	C-CER,CHIP;100nF,10%,16V,X7R,1608	1	S.A
....4	C1635_UX	2203-005005	C-CER,CHIP;100nF,10%,16V,X7R,1608	1	S.A
....4	C1637_UX	2203-005005	C-CER,CHIP;100nF,10%,16V,X7R,1608	1	S.A
....4	C1638_UX	2203-005005	C-CER,CHIP;100nF,10%,16V,X7R,1608	1	S.A
....4	C1640_UX	2203-005005	C-CER,CHIP;100nF,10%,16V,X7R,1608	1	S.A
....4	C1650_RED	2203-005005	C-CER,CHIP;100nF,10%,16V,X7R,1608	1	S.A
....4	C1826	2203-005005	C-CER,CHIP;100nF,10%,16V,X7R,1608	1	S.A
....4	C1827	2203-005005	C-CER,CHIP;100nF,10%,16V,X7R,1608	1	S.A
....4	C1829	2203-005005	C-CER,CHIP;100nF,10%,16V,X7R,1608	1	S.A
....4	C1830	2203-005005	C-CER,CHIP;100nF,10%,16V,X7R,1608	1	S.A
....4	C1831	2203-005005	C-CER,CHIP;100nF,10%,16V,X7R,1608	1	S.A
....4	C1836	2203-005005	C-CER,CHIP;100nF,10%,16V,X7R,1608	1	S.A
....4	C1837	2203-005005	C-CER,CHIP;100nF,10%,16V,X7R,1608	1	S.A
....4	C1838	2203-005005	C-CER,CHIP;100nF,10%,16V,X7R,1608	1	S.A
....4	C1847	2203-005005	C-CER,CHIP;100nF,10%,16V,X7R,1608	1	S.A
....4	C1849	2203-005005	C-CER,CHIP;100nF,10%,16V,X7R,1608	1	S.A
....4	C1854	2203-005005	C-CER,CHIP;100nF,10%,16V,X7R,1608	1	S.A
....4	C2201	2203-005005	C-CER,CHIP;100nF,10%,16V,X7R,1608	1	S.A
....4	C2202	2203-005005	C-CER,CHIP;100nF,10%,16V,X7R,1608	1	S.A
....4	C2214	2203-005005	C-CER,CHIP;100nF,10%,16V,X7R,1608	1	S.A
....4	C2215	2203-005005	C-CER,CHIP;100nF,10%,16V,X7R,1608	1	S.A
....4	C2216	2203-005005	C-CER,CHIP;100nF,10%,16V,X7R,1608	1	S.A
....4	C2218	2203-005005	C-CER,CHIP;100nF,10%,16V,X7R,1608	1	S.A
....4	C2253_LCD	2203-005005	C-CER,CHIP;100nF,10%,16V,X7R,1608	1	S.A
....4	C2265_LCD	2203-005005	C-CER,CHIP;100nF,10%,16V,X7R,1608	1	S.A

6 Electrical Parts List

Level	Loc. No.	Code No.	Description & Specification	Q'ty	SA/SNA
....4	C1276	2203-005249	C-CER,CHIP;100nF,10%,50V,X7R,1608	1	S.A
....4	C1280	2203-005249	C-CER,CHIP;100nF,10%,50V,X7R,1608	1	S.A
....4	C1297	2203-005249	C-CER,CHIP;100nF,10%,50V,X7R,1608	1	S.A
....4	C1305	2203-005249	C-CER,CHIP;100nF,10%,50V,X7R,1608	1	S.A
....4	C1321	2203-005249	C-CER,CHIP;100nF,10%,50V,X7R,1608	1	S.A
....4	C1322	2203-005249	C-CER,CHIP;100nF,10%,50V,X7R,1608	1	S.A
....4	C1323	2203-005249	C-CER,CHIP;100nF,10%,50V,X7R,1608	1	S.A
....4	C1324	2203-005249	C-CER,CHIP;100nF,10%,50V,X7R,1608	1	S.A
....4	C1102	2203-005809	C-CER,CHIP;1000nF,10%,16V,X7R,-,2012	1	S.A
....4	C2213	2203-005809	C-CER,CHIP;1000nF,10%,16V,X7R,-,2012	1	S.A
....4	C2235	2203-005809	C-CER,CHIP;1000nF,10%,16V,X7R,-,2012	1	S.A
....4	C2266_LCD	2203-005809	C-CER,CHIP;1000nF,10%,16V,X7R,-,2012	1	S.A
....4	C3012	2203-005809	C-CER,CHIP;1000nF,10%,16V,X7R,-,2012	1	S.A
....4	C3027	2203-005809	C-CER,CHIP;1000nF,10%,16V,X7R,-,2012	1	S.A
....4	C1222	2203-005918	C-CER,CHIP;1000nF,10%,6.3V,X7R,1608	1	S.A
....4	C1223	2203-005918	C-CER,CHIP;1000nF,10%,6.3V,X7R,1608	1	S.A
....4	C1224	2203-005918	C-CER,CHIP;1000nF,10%,6.3V,X7R,1608	1	S.A
....4	C1225	2203-005918	C-CER,CHIP;1000nF,10%,6.3V,X7R,1608	1	S.A
....4	C1237	2203-005918	C-CER,CHIP;1000nF,10%,6.3V,X7R,1608	1	S.A
....4	C1238	2203-005918	C-CER,CHIP;1000nF,10%,6.3V,X7R,1608	1	S.A
....4	C1239	2203-005918	C-CER,CHIP;1000nF,10%,6.3V,X7R,1608	1	S.A
....4	C1240	2203-005918	C-CER,CHIP;1000nF,10%,6.3V,X7R,1608	1	S.A
....4	C1241	2203-005918	C-CER,CHIP;1000nF,10%,6.3V,X7R,1608	1	S.A
....4	C1242	2203-005918	C-CER,CHIP;1000nF,10%,6.3V,X7R,1608	1	S.A
....4	C1243	2203-005918	C-CER,CHIP;1000nF,10%,6.3V,X7R,1608	1	S.A
....4	C1244	2203-005918	C-CER,CHIP;1000nF,10%,6.3V,X7R,1608	1	S.A
....4	C1245	2203-005918	C-CER,CHIP;1000nF,10%,6.3V,X7R,1608	1	S.A
....4	C1247	2203-005918	C-CER,CHIP;1000nF,10%,6.3V,X7R,1608	1	S.A
....4	C1249	2203-005918	C-CER,CHIP;1000nF,10%,6.3V,X7R,1608	1	S.A
....4	C1250	2203-005918	C-CER,CHIP;1000nF,10%,6.3V,X7R,1608	1	S.A
....4	C3217	2203-005918	C-CER,CHIP;1000nF,10%,6.3V,X7R,1608	1	S.A
....4	C1103	2203-006361	C-CER,CHIP;10000nF,10%,10V,X5R,2012	1	S.A
....4	C1114	2203-006361	C-CER,CHIP;10000nF,10%,10V,X5R,2012	1	S.A
....4	C1124	2203-006361	C-CER,CHIP;10000nF,10%,10V,X5R,2012	1	S.A
....4	C1160_LCD	2203-006361	C-CER,CHIP;10000nF,10%,10V,X5R,2012	1	S.A
....4	C1166_LCD	2203-006361	C-CER,CHIP;10000nF,10%,10V,X5R,2012	1	S.A
....4	C1208	2203-006361	C-CER,CHIP;10000nF,10%,10V,X5R,2012	1	S.A
....4	C1211	2203-006361	C-CER,CHIP;10000nF,10%,10V,X5R,2012	1	S.A
....4	C1212	2203-006361	C-CER,CHIP;10000nF,10%,10V,X5R,2012	1	S.A
....4	C1213	2203-006361	C-CER,CHIP;10000nF,10%,10V,X5R,2012	1	S.A
....4	C1228	2203-006361	C-CER,CHIP;10000nF,10%,10V,X5R,2012	1	S.A
....4	C1229	2203-006361	C-CER,CHIP;10000nF,10%,10V,X5R,2012	1	S.A
....4	C1246	2203-006361	C-CER,CHIP;10000nF,10%,10V,X5R,2012	1	S.A
....4	C1248	2203-006361	C-CER,CHIP;10000nF,10%,10V,X5R,2012	1	S.A
....4	C1251	2203-006361	C-CER,CHIP;10000nF,10%,10V,X5R,2012	1	S.A
....4	C1252	2203-006361	C-CER,CHIP;10000nF,10%,10V,X5R,2012	1	S.A
....4	C1253	2203-006361	C-CER,CHIP;10000nF,10%,10V,X5R,2012	1	S.A
....4	C1254	2203-006361	C-CER,CHIP;10000nF,10%,10V,X5R,2012	1	S.A
....4	C1255	2203-006361	C-CER,CHIP;10000nF,10%,10V,X5R,2012	1	S.A
....4	C1271	2203-006361	C-CER,CHIP;10000nF,10%,10V,X5R,2012	1	S.A
....4	C1301	2203-006361	C-CER,CHIP;10000nF,10%,10V,X5R,2012	1	S.A
....4	C1304	2203-006361	C-CER,CHIP;10000nF,10%,10V,X5R,2012	1	S.A
....4	C1401	2203-006361	C-CER,CHIP;10000nF,10%,10V,X5R,2012	1	S.A
....4	C1413	2203-006361	C-CER,CHIP;10000nF,10%,10V,X5R,2012	1	S.A
....4	C1415	2203-006361	C-CER,CHIP;10000nF,10%,10V,X5R,2012	1	S.A
....4	C1422_NSID	2203-006361	C-CER,CHIP;10000nF,10%,10V,X5R,2012	1	S.A
....4	C1424	2203-006361	C-CER,CHIP;10000nF,10%,10V,X5R,2012	1	S.A
....4	C1426	2203-006361	C-CER,CHIP;10000nF,10%,10V,X5R,2012	1	S.A
....4	C1431	2203-006361	C-CER,CHIP;10000nF,10%,10V,X5R,2012	1	S.A
....4	C1432	2203-006361	C-CER,CHIP;10000nF,10%,10V,X5R,2012	1	S.A
....4	C1433	2203-006361	C-CER,CHIP;10000nF,10%,10V,X5R,2012	1	S.A
....4	C1434	2203-006361	C-CER,CHIP;10000nF,10%,10V,X5R,2012	1	S.A

Level	Loc. No.	Code No.	Description & Specification	Q'ty	SA/SNA
....4	C1435	2203-006361	C-CER,CHIP;10000nF,10%,10V,X5R,2012	1	SA
....4	C1447	2203-006361	C-CER,CHIP;10000nF,10%,10V,X5R,2012	1	SA
....4	C1455	2203-006361	C-CER,CHIP;10000nF,10%,10V,X5R,2012	1	SA
....4	C1456	2203-006361	C-CER,CHIP;10000nF,10%,10V,X5R,2012	1	SA
....4	C1459	2203-006361	C-CER,CHIP;10000nF,10%,10V,X5R,2012	1	SA
....4	C1460	2203-006361	C-CER,CHIP;10000nF,10%,10V,X5R,2012	1	SA
....4	C1461	2203-006361	C-CER,CHIP;10000nF,10%,10V,X5R,2012	1	SA
....4	C1626	2203-006361	C-CER,CHIP;10000nF,10%,10V,X5R,2012	1	SA
....4	C1632_UX	2203-006361	C-CER,CHIP;10000nF,10%,10V,X5R,2012	1	SA
....4	C1634_UX	2203-006361	C-CER,CHIP;10000nF,10%,10V,X5R,2012	1	SA
....4	C1636_UX	2203-006361	C-CER,CHIP;10000nF,10%,10V,X5R,2012	1	SA
....4	C1639_UX	2203-006361	C-CER,CHIP;10000nF,10%,10V,X5R,2012	1	SA
....4	C1641_UX	2203-006361	C-CER,CHIP;10000nF,10%,10V,X5R,2012	1	SA
....4	C1642_UX	2203-006361	C-CER,CHIP;10000nF,10%,10V,X5R,2012	1	SA
....4	C1646	2203-006361	C-CER,CHIP;10000nF,10%,10V,X5R,2012	1	SA
....4	C1821	2203-006361	C-CER,CHIP;10000nF,10%,10V,X5R,2012	1	SA
....4	C1822	2203-006361	C-CER,CHIP;10000nF,10%,10V,X5R,2012	1	SA
....4	C1828	2203-006361	C-CER,CHIP;10000nF,10%,10V,X5R,2012	1	SA
....4	C1839	2203-006361	C-CER,CHIP;10000nF,10%,10V,X5R,2012	1	SA
....4	C1840	2203-006361	C-CER,CHIP;10000nF,10%,10V,X5R,2012	1	SA
....4	C1846	2203-006361	C-CER,CHIP;10000nF,10%,10V,X5R,2012	1	SA
....4	C1850	2203-006361	C-CER,CHIP;10000nF,10%,10V,X5R,2012	1	SA
....4	C2089	2203-006361	C-CER,CHIP;10000nF,10%,10V,X5R,2012	1	SA
....4	C2090	2203-006361	C-CER,CHIP;10000nF,10%,10V,X5R,2012	1	SA
....4	C2205	2203-006361	C-CER,CHIP;10000nF,10%,10V,X5R,2012	1	SA
....4	C2220	2203-006361	C-CER,CHIP;10000nF,10%,10V,X5R,2012	1	SA
....4	C2232	2203-006361	C-CER,CHIP;10000nF,10%,10V,X5R,2012	1	SA
....4	C2270	2203-006361	C-CER,CHIP;10000nF,10%,10V,X5R,2012	1	SA
....4	C2271	2203-006361	C-CER,CHIP;10000nF,10%,10V,X5R,2012	1	SA
....4	C2280_FBE	2203-006361	C-CER,CHIP;10000nF,10%,10V,X5R,2012	1	SA
....4	C2287_FBE	2203-006361	C-CER,CHIP;10000nF,10%,10V,X5R,2012	1	SA
....4	C2298_FBE	2203-006361	C-CER,CHIP;10000nF,10%,10V,X5R,2012	1	SA
....4	C3007	2203-006361	C-CER,CHIP;10000nF,10%,10V,X5R,2012	1	SA
....4	C3008	2203-006361	C-CER,CHIP;10000nF,10%,10V,X5R,2012	1	SA
....4	C3015	2203-006361	C-CER,CHIP;10000nF,10%,10V,X5R,2012	1	SA
....4	C3018	2203-006361	C-CER,CHIP;10000nF,10%,10V,X5R,2012	1	SA
....4	C1117	2402-001128	C-AL,SMD;100µF,20%,16V,-,TP,6.3X5.7mm	1	SA
....4	C1123	2402-001128	C-AL,SMD;100µF,20%,16V,-,TP,6.3X5.7mm	1	SA
....4	C1127	2402-001128	C-AL,SMD;100µF,20%,16V,-,TP,6.3X5.7mm	1	SA
....4	C1131	2402-001128	C-AL,SMD;100µF,20%,16V,-,TP,6.3X5.7mm	1	SA
....4	C1140	2402-001128	C-AL,SMD;100µF,20%,16V,-,TP,6.3X5.7mm	1	SA
....4	C1150	2402-001128	C-AL,SMD;100µF,20%,16V,-,TP,6.3X5.7mm	1	SA
....4	C1158	2402-001128	C-AL,SMD;100µF,20%,16V,-,TP,6.3X5.7mm	1	SA
....4	C1204	2402-001128	C-AL,SMD;100µF,20%,16V,-,TP,6.3X5.7mm	1	SA
....4	C1269	2402-001128	C-AL,SMD;100µF,20%,16V,-,TP,6.3X5.7mm	1	SA
....4	C1270	2402-001128	C-AL,SMD;100µF,20%,16V,-,TP,6.3X5.7mm	1	SA
....4	C2211	2402-001128	C-AL,SMD;100µF,20%,16V,-,TP,6.3X5.7mm	1	SA
....4	C2212	2402-001128	C-AL,SMD;100µF,20%,16V,-,TP,6.3X5.7mm	1	SA
....4	C2267_LCD	2402-001128	C-AL,SMD;100µF,20%,16V,-,TP,6.3X5.7mm	1	SA
....4	C3212	2402-001128	C-AL,SMD;100µF,20%,16V,-,TP,6.3X5.7mm	1	SA
....4	C1149	2402-001129	C-AL,SMD;47UF,20%,16V,WT,TP,6.3X5.2MM	1	SA
....4	C1179	2402-001129	C-AL,SMD;47UF,20%,16V,WT,TP,6.3X5.2MM	1	SA
....4	C1627_UX	2402-001129	C-AL,SMD;47UF,20%,16V,WT,TP,6.3X5.2MM	1	SA
....4	C1649	2402-001129	C-AL,SMD;47UF,20%,16V,WT,TP,6.3X5.2MM	1	SA
....4	C2222	2402-001129	C-AL,SMD;47UF,20%,16V,WT,TP,6.3X5.2MM	1	SA
....4	C1137	2402-001183	C-AL,SMD;22UF,20%,16V,WT,TP,5.3X5.3X6MM	1	SA
....4	C1209	2402-001226	C-AL,SMD;4.7UF,20%,35V,HR,TP,4.3X4.3X5.8	1	SA
....4	C1104	2402-001238	C-AL,SMD;1uF,20%,50V,HR,TP,4.3x4.3x5.2mm	1	SA
....4	C1110	2402-001263	C-AL,SMD;1000uF,20%,10V,WT,SMD,10x10	1	SA
....4	C1165	2402-001263	C-AL,SMD;1000uF,20%,10V,WT,SMD,10x10	1	SA
....4	C1167	2402-001263	C-AL,SMD;1000uF,20%,10V,WT,SMD,10x10	1	SA
....4	C1177	2402-001263	C-AL,SMD;1000uF,20%,10V,WT,SMD,10x10	1	SA

6 Electrical Parts List

Level	Loc. No.	Code No.	Description & Specification	Q'ty	SA/SNA
....4	C1275	2402-001273	C-AL,SMD;220uF,20%,35V,WT,REEL,10X10mm	1	S.A
....4	C1287	2402-001273	C-AL,SMD;220uF,20%,35V,WT,REEL,10X10mm	1	S.A
....4	C1108	2409-001051	C-ORGANIC;82UF,20%,6.3V,WT,TP,6.3*5.9MM,	1	S.A
....4	C1115	2409-001051	C-ORGANIC;82UF,20%,6.3V,WT,TP,6.3*5.9MM,	1	S.A
....4	C1126	2409-001051	C-ORGANIC;82UF,20%,6.3V,WT,TP,6.3*5.9MM,	1	S.A
....4	C1141	2409-001051	C-ORGANIC;82UF,20%,6.3V,WT,TP,6.3*5.9MM,	1	S.A
....4	C2046	2409-001051	C-ORGANIC;82UF,20%,6.3V,WT,TP,6.3*5.9MM,	1	S.A
....4	C2099	2409-001051	C-ORGANIC;82UF,20%,6.3V,WT,TP,6.3*5.9MM,	1	S.A
....4	T0052	2703-000125	INDUCTOR-SMD;10uH,10%,2012	1	S.A
....4	T0052	2703-000125	INDUCTOR-SMD;10uH,10%,2012	1	S.A
....4	T0052	2703-000125	INDUCTOR-SMD;10uH,10%,2012	1	S.A
....4	T0052	2703-000125	INDUCTOR-SMD;10uH,10%,2012	1	S.A
....4	T0052	2703-000274	INDUCTOR-SMD;2.2uH,10%,2012	1	S.A
....4	T0052	2703-000398	INDUCTOR-SMD;10uH,10%,3225	1	S.A
....4	T0052	2703-000398	INDUCTOR-SMD;10uH,10%,3225	1	S.A
....4	T0052	2703-000398	INDUCTOR-SMD;10uH,10%,3225	1	S.A
....4	T0052	2703-000398	INDUCTOR-SMD;10uH,10%,3225	1	S.A
....4	T0052	2703-000398	INDUCTOR-SMD;10uH,10%,3225	1	S.A
....4	T0052	2703-000398	INDUCTOR-SMD;10uH,10%,3225	1	S.A
....4	T0052	2703-000398	INDUCTOR-SMD;10uH,10%,3225	1	S.A
....4	T0052	2703-000398	INDUCTOR-SMD;10uH,10%,3225	1	S.A
....4	T0052	2703-000398	INDUCTOR-SMD;10uH,10%,3225	1	S.A
....4	T0052	2703-000398	INDUCTOR-SMD;10uH,10%,3225	1	S.A
....4	T0052	2703-000398	INDUCTOR-SMD;10uH,10%,3225	1	S.A
....4	T0052	2703-000398	INDUCTOR-SMD;10uH,10%,3225	1	S.A
....4	T0052	2703-000417	INDUCTOR-SMD;220uH,5%,3225	1	S.A
....4	T0052	2703-001229	INDUCTOR-SMD;2.2uH,10%,1608	1	S.A
....4	T0052	2703-001229	INDUCTOR-SMD;2.2uH,10%,1608	1	S.A
....4	T0052	2703-001229	INDUCTOR-SMD;2.2uH,10%,1608	1	S.A
....4	T0052	2703-001229	INDUCTOR-SMD;2.2uH,10%,1608	1	S.A
....4	T0052	2703-001229	INDUCTOR-SMD;2.2uH,10%,1608	1	S.A
....4	T0052	2703-001229	INDUCTOR-SMD;2.2uH,10%,1608	1	S.A
....4	T0052	2703-001426	INDUCTOR-SMD;680uH,20%,7070	1	S.A
....4	T0052	2703-001778	INDUCTOR-SMD;3.3uH,20%,3225	1	S.A
....4	T0052	2703-001778	INDUCTOR-SMD;3.3uH,20%,3225	1	S.A
....4	T0052	2703-002722	INDUCTOR-SMD;22uH,20%,12x12mm	1	S.A
....4	T0052	2703-002722	INDUCTOR-SMD;22uH,20%,12x12mm	1	S.A
....4	L1201	2704-000018	INDUCTOR-SMD-ARRAY;15uH,2000mA,2.0.124oh	1	S.N.A
....4	L1202	2704-000018	INDUCTOR-SMD-ARRAY;15uH,2000mA,2.0.124oh	1	S.N.A
....4	X1802	2801-003326	CRYSTAL-SMD;24MHZ,30PPM,28-ABX,20PF,50OH	1	S.A
....4	X2001	2801-003326	CRYSTAL-SMD;24MHZ,30PPM,28-ABX,20PF,50OH	1	S.A
....4	X1201	2801-003804	CRYSTAL-SMD;24.576MHz,30ppm,28-AAN,20pF,	1	S.A
....4	X1801	2801-003923	CRYSTAL-SMD;10MHz,30ppm,28-AAN,20pF,60oh	1	S.A
....4	X3201	2801-003954	CRYSTAL-SMD;27MHz,30ppm,28-AAN,16pF,50oh	1	S.A
....4	F103	2901-001114	FILTER-EMI SMD;25VDC,2.0ADC,-,100nF,3.2x	1	S.A
....4	T0568	3301-000314	BEAD-SMD;120ohm,1.6x0.8x0.8mm,-,-,-	1	S.N.A
....4	T0568	3301-000314	BEAD-SMD;120ohm,1.6x0.8x0.8mm,-,-,-	1	S.N.A
....4	T0568	3301-001145	BEAD-SMD;60ohm,4516,TP,70ohm/45MHz,82ohm	1	S.N.A
....4	T0568	3301-001145	BEAD-SMD;60ohm,4516,TP,70ohm/45MHz,82ohm	1	S.N.A
....4	T0568	3301-001145	BEAD-SMD;60ohm,4516,TP,70ohm/45MHz,82ohm	1	S.N.A
....4	T0568	3301-001145	BEAD-SMD;60ohm,4516,TP,70ohm/45MHz,82ohm	1	S.N.A
....4	T0568	3301-001145	BEAD-SMD;60ohm,4516,TP,70ohm/45MHz,82ohm	1	S.N.A
....4	T0568	3301-001145	BEAD-SMD;60ohm,4516,TP,70ohm/45MHz,82ohm	1	S.N.A
....4	T0568	3301-001145	BEAD-SMD;60ohm,4516,TP,70ohm/45MHz,82ohm	1	S.N.A
....4	T0568	3301-001145	BEAD-SMD;60ohm,4516,TP,70ohm/45MHz,82ohm	1	S.N.A
....4	T0568	3301-001148	BEAD-SMD;60ohm,1608,TP,-,-	1	S.N.A
....4	T0568	3301-001163	BEAD-SMD;80ohm,2012,TP,-,192ohm/867MHz	1	S.N.A
....4	T0568	3301-001163	BEAD-SMD;80ohm,2012,TP,-,192ohm/867MHz	1	S.N.A
....4	T0568	3301-001176	BEAD-SMD;80ohm,2012,TP,-,-	1	S.N.A
....4	T0568	3301-001236	BEAD-SMD;60ohm,1608,-,-,-	1	S.N.A
....4	T0568	3301-001236	BEAD-SMD;60ohm,1608,-,-,-	1	S.N.A
....4	T0568	3301-001236	BEAD-SMD;60ohm,1608,-,-,-	1	S.N.A
....4	T0568	3301-001324	BEAD-SMD;15ohm,2012,600mA,TP,,0.1ohm	1	S.A
....4	T0568	3301-001324	BEAD-SMD;15ohm,2012,600mA,TP,,0.1ohm	1	S.A

6 Electrical Parts List

Level	Loc. No.	Code No.	Description & Specification	Q'ty	SA/SNA
...3	T0268	3903-000145	CBF-POWER CORD;DT,EU,FP3YES,U(IEC C13-R	1	S.A
...3	T0524	6902-000110	BAG PE;LDPE,T0.05,W250,L400,TRP,28,2	1	S.NA
...3	ACCESSORY	BN63-01798A	CLOTH-CLEAN;RE40**,CLOTH,180,200,RHCM	1	S.NA
...3	T0531	BN63-03113A	COVER-BOTTOM;37,40R81,HIPS,-,-,HB,-,BK	1	S.A
...3	T0074	BN59-00603A	REMOCON;BORDEAUX PLUS,TM87C,samsung 28p+	1	S.A
0.1	M0019	BN92-02374H	ASSY LABEL;LE40R86BDX/*	1	S.NA
0.1	M0003	BN92-02409B	ASSY BOX;40R81,UO,EO,LO,-,-,-	1	S.NA
.2		BN69-01723A	BOX-SET, IN;40R8,CB,C-03,W777,L1492	1.02	S.NA
.2	M0006	BN69-01724A	BOX-00.SET,OUT;40R8,CB,DY-01,AB,YEL,C3,H	1.02	S.NA
0.1	M0113	BN92-02410A	ASSY P/MATERIAL;40R81,-,-,-,-	1	S.NA
.2	T0376	6902-000001	BAG AIR;LDPE,T0.2,L1800,W1000,TRP,,,LDPE	0.016	S.NA
.2	T0524	6902-000524	BAG PE;HDPE/NITRON,T0.015/T0.5,W1200,L11	1	S.NA
.2	T0214	AA61-20285A	HOLDER-BOX;CTV,PP,NTR,HB	2	S.NA
.2	T0172	AA69-02609A	BAND-PP,-,PP,-,W18,-,CLEA,1G,-,-	4.94	S.NA

5 Exploded View and Parts List

- You can search for updated part codes through ITSELF web site.
URL : <http://itself.sec.samsung.co.kr/>

5-1 LE40R86BDX Exploded View

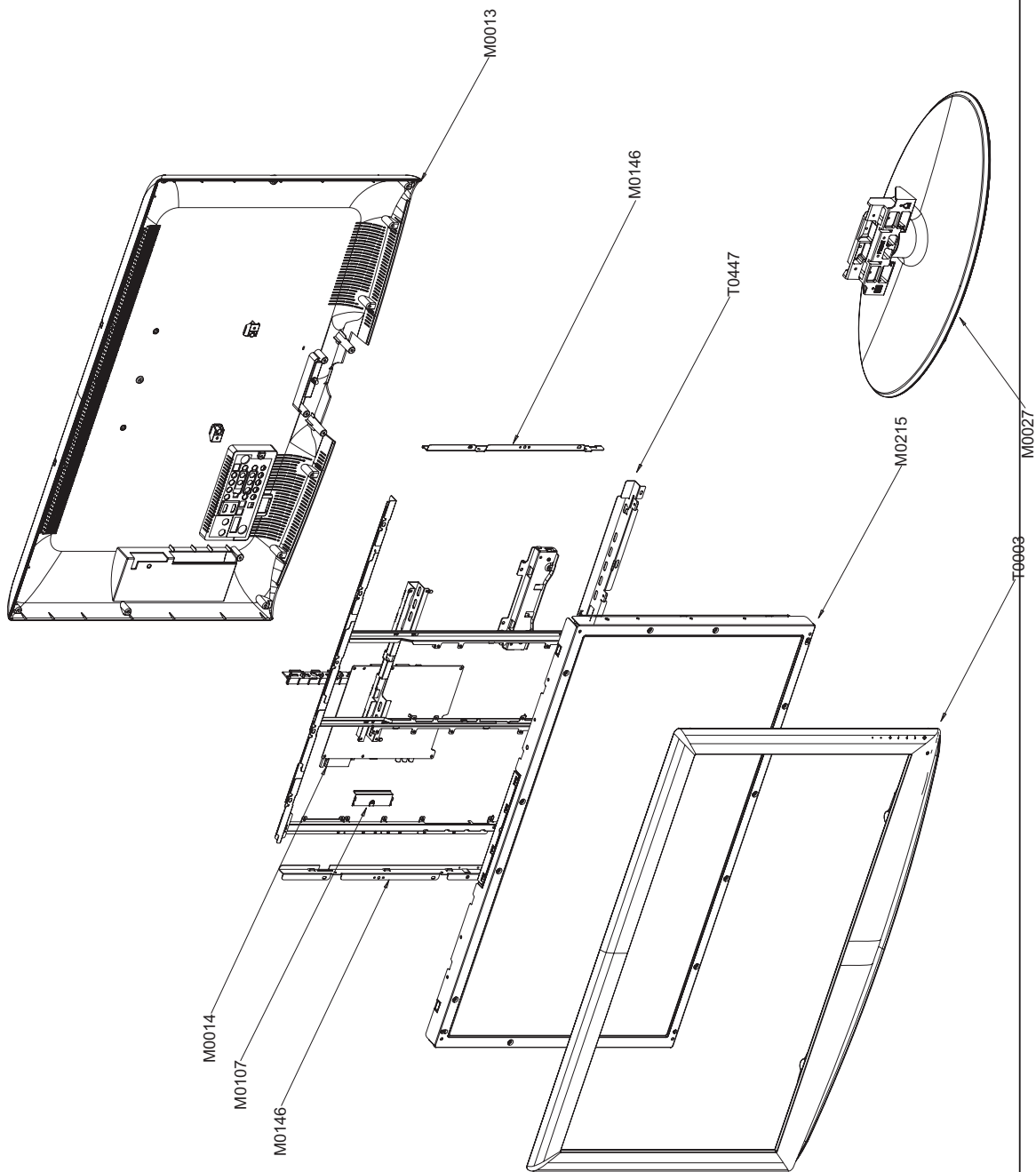

5-2 LE40R86BDX Parts list

Location	Code No	Item & Specification	Q'ty	S.A/SNA	Remark
T0003	BN96-04656B	ASSY COVER P-FRONT;40R86,EO(IDTV),-ABS+	1	S.A	
T0175	BN96-04768A	ASSY SPEAKER P;8ohm;4pin,10W,Bordeaux PI	1	S.A	
M0215	BN07-00451A	LCD-PANEL;LTA400WT-L07,8bit,40inch,16.7M	1	S.A	
T0447	BN96-04679D	ASSY BRACKET P-PANEL;40R81,JP BOARD,SPAC	1	S.A	
M0107	BN63-03039A	SHIELD-COVER;MURANO40,PCM,T0,5,IDTV	1	S.N.A	
M0146	BN61-02256B	BRACKET-PANEL SIDE;Bordeaux 40,SECC,T1,2	1	S.N.A	
M0146	BN61-02257B	BRACKET-PANEL SIDE;Bordeaux 40,SECC,T1,2	1	S.N.A	
M0027	BN96-04661A	ASSY STAND P-BASE;37,40R81,SWIVEL,-,ABS+	1	S.A	
M0013	BN96-04669A	ASSY COVER P-REAR;40R81,EO(IDTV),-ABS+P	1	S.A	