

## 5. Exploded View & Part List

### 5-1. LE40B62\* Exploded View

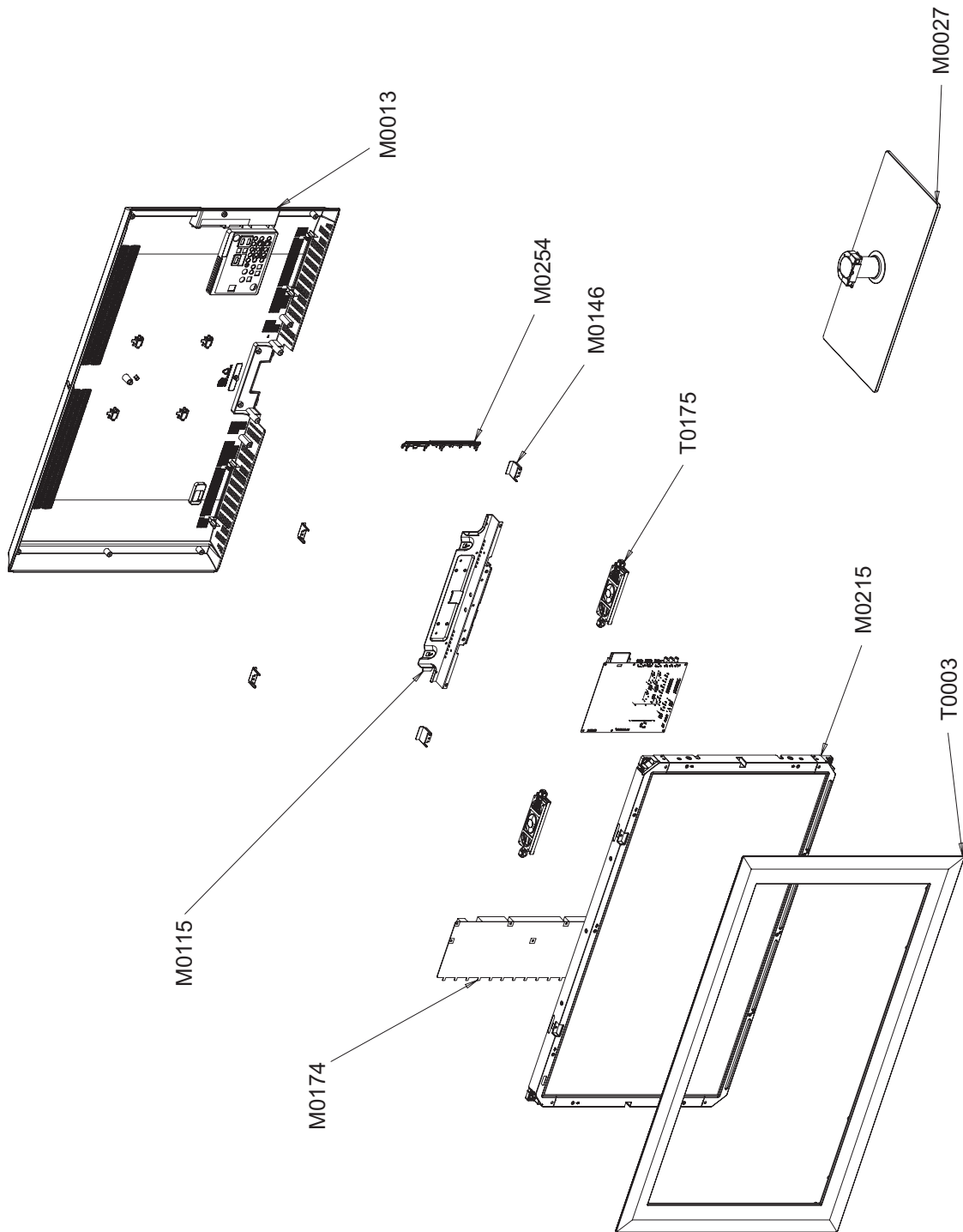

**5-1-1. LE40B62\* Parts List**

Location No.	Code No.	Description & Specification	Q'ty	S.A/S.N.A	Remark
T0003	BN96-09558B	ASSY COVER P-FRONT;40,LB620,EO,PMMA(CLR)	1	S.A	
M0215	BN07-00662A	LCD-PANEL;V400H1-LH3,CM40H13A,10bits,40.	1	S.A	
	BN07-00691D	LCD-PANEL;V400H1-LH3 LTF400HF12,12V,SPVA 72%	1	S.A	
	BN81-02391A	A/S-T CON V400H1-LH3;V400H1-LH3	1	S.N.A	
T0175	BN96-09463C	ASSY SPEAKER P;8ohm,4pin,10W,R:250/ L:60	1	S.A	
M0115	BN61-04918A	BRACKET-STAND LINK;40, B610,SECC,T1.6	1	S.A	
M0174	BN44-00264A	IP BOARD;PSIV231I01A,H40F1_9SS,0.11mA,11	1	S.A	
T0101	BN61-04816A	BRACKET-WALL;40, B610,SECC,T1.2	4	S.N.A	
M0146	BN61-03056A	BRACKET-PANEL TOP;TULIP52,SECC,T1.2	2	S.N.A	
M0254	BN61-04801C	HOLDER-SIDE AV;EO,HIPS,HB,BK500,1USB,1HD	1	S.A	
M0013	BN96-09602A	ASSY COVER P-REAR;40,LB620,EO,HIPS,HB,BK	1	S.A	
M0027	BN96-10793E	ASSY STAND P-BASE;37,40,EXPORT,TEMPERED	1	S.A	

## 5-2. LE40B62\* Parts List

Service Bom (SA: SERVICE AVAILABLE, SNA: SERVICE NOT AVAILABLE)

Level	Location No.	Code No.	Description & Specification	Q'ty	SA/SNA	Remark
			LE40B620R3PXZG			
0.1		BN90-01924B	ASSY COVER FRONT;40,LB620,EO,CHARCOAL GR	1	S.N.A	
..2	T0175	BN96-09463C	ASSY SPEAKER P;8ohm,4pin,10W,R:250/ L:60	1	S.A	
..2	T0003	BN96-09558B	ASSY COVER P-FRONT;40,LB620,EO,PMMA(CLR)	1	S.A	
...3	M0081	6003-001188	SCREW-TAPTYPE;BH,+,-,B,M4,L10,ZPC(WHT),S	2	S.N.A	
...3	AB326	BN61-04661A	BRACKET-STOPPER;L650,SK-5,T0.4,Plating,H	4	S.N.A	
...3		BN61-04692A	BOSS-PRIMER,#94,clear,35cps	0.8	S.N.A	
...3	CCM1	BN63-02183E	COVER-SHEET;Rhcm,PE Vinyl,T0.05,750mm,20	0.7	S.N.A	
...3	CCM1	BN63-05199D	COVER-SHEET;AMBER,PE,T0.08,W75mm,200M,CL	1.1	S.A	
...3	CCM1	BN63-05199E	COVER-SHEET;AMBER,PE,T0.08,W85mm,200M,CL	2.5	S.A	
...3	M0125	BN96-10421B	ASSY BOARD P-TOUCH FUNCTION&IR;LN46B640R	1	S.A	
...3	T0069	BN60-00027G	SPACER-FELT;L650-40,FELT,890,0.5,20	2	S.N.A	
...3	T0069	BN60-00027P	SPACER-FELT;L650 40,FELT,502,0.5,20	2	S.N.A	
...3	T0245	BN61-05372A	HOLDER-PCB;B640,HIPS V0,BLK	1	S.N.A	
....4		BN81-00199H	RESIN;HIPS HB,BK500,HF-1690H,K2901	0.025	S.N.A	
...3	M0112	BN63-04137M	COVER-FRONT;40,LB620,EO,PMMA(CLR)+PMMA(C	1	S.N.A	
....4		BN81-00116G	RESIN;ABS+PMMA,TTP01,TF-0959H,70784,FT61	1,046.10	S.N.A	
....4		BN81-00116X	RESIN;ABS+PMMA,SF-0505H/LD0114,SD6320,71	1.34	S.N.A	
...3		BN96-07665C	ASSY HOLDER P-BOSS SIDE RIGHT;40,L750,,A	1	S.N.A	
....4		BN61-04692A	BOSS-PRIMER,#94,clear,35cps	0.2	S.N.A	
....4		BN61-04731C	BOSS-TAPE;AMBER,ACRYL,T1.1,W16.0mm,WHITE	0.06	S.A	
....4		BN61-04731D	BOSS-TAPE;AMBER,ACRYL,T1.1,W20.0mm,WHITE	0.31	S.N.A	
....4		BN61-04088C	HOLDER-BOSS SIDE RIGHT;40AR1,ABS+PMMA,HB	1	S.N.A	
....5		BN81-03206A	RESIN;ABS+PMMA,SF-0503,K21294	0.07	S.N.A	
...3		BN96-07665D	ASSY HOLDER P-BOSS SIDE LEFT;40,L750,,AB	1	S.N.A	
....4		BN61-04692A	BOSS-PRIMER,#94,clear,35cps	0.2	S.N.A	
....4		BN61-04731C	BOSS-TAPE;AMBER,ACRYL,T1.1,W16.0mm,WHITE	0.06	S.A	
....4		BN61-04731D	BOSS-TAPE;AMBER,ACRYL,T1.1,W20.0mm,WHITE	0.31	S.N.A	
....4		BN61-04088D	HOLDER-BOSS SIDE LEFT;40AR1,ABS+PMMA,HB,	1	S.N.A	
....5		BN81-03206A	RESIN;ABS+PMMA,SF-0503,K21294	0.07	S.N.A	
...3		BN96-09567B	ASSY HOLDER P-BOSS BOTTOM;40,LB640,HIPS,	1	S.N.A	
....4		BN61-04692A	BOSS-PRIMER,#94,clear,35cps	0.4	S.N.A	
....4		BN61-04731C	BOSS-TAPE;AMBER,ACRYL,T1.1,W16.0mm,WHITE	0.07	S.A	
....4		BN61-04731D	BOSS-TAPE;AMBER,ACRYL,T1.1,W20.0mm,WHITE	0.89	S.N.A	
....4		BN61-05005B	HOLDER-BOSS BOTTOM;40,LB640,HIPS,HB,BK50	1	S.N.A	
....5		BN81-00199H	RESIN;HIPS HB,BK500,HF-1690H,K2901	212.3	S.N.A	
...3		BN74-00052A	TAPE-PAPER;LB530,Crepe Paper,0.17mm, 10m	0.1	S.N.A	
0.1	M0216	BN90-01928A	ASSY STAND;40,LB640,BLACK,CLEAR NECK	1	S.N.A	
..2	M0027	BN96-10793E	ASSY STAND P-BASE;37,40,EXPORT,TEMPERED	1	S.A	
...3	M0081	6003-001003	SCREW-TAPTYPE;BH,+,-,B,M4,L12,ZPC(BLK),SWR	6	S.A	
...3		BN61-04692A	BOSS-PRIMER,#94,clear,35cps	0.1	S.N.A	
...3		BN61-04731B	BOSS-TAPE;AMBER,ACRYL,T1.1,W12.0mm,WHITE	0.29	S.N.A	
...3		BN61-05244A	BRACKET-SWIVEL BOTTOM;LB700 46,HGI,T3.0	1	S.N.A	
...3	GSN01	BN61-05251A	GUIDE-STAND NECK;LB700 46,PC,CLEAR(TP27)	1	S.A	
....4	AH506	BN61-05268A	HOLDER-INSERT;46 LB750,PC, EXTRUSION,CLE	1	S.N.A	
....4		BN81-00116J	RESIN;PC CLEAR,SC-1220R/70918,HF-1130R,	0.15	S.N.A	
...3		BN61-05493A	HOLDER-SWIVEL RING BOTTOM;LB650 40,Aceta	1	S.N.A	

5. Exploded View & Part List

Level	Location No.	Code No.	Description & Specification	Q'ty	SA/SNA	Remark
...3		BN61-05652A	BRACKET-STAND BOTTOM;B650 40,SECC,T2.0	1	S.N.A	
...3		BN61-05826A	BOSS-BOND;#760,Poly urethane,Black	1.2	S.N.A	
...3	CCM1	BN63-04755A	COVER-SHEET;AMBER,PE,T0.05,W150mm,200M,6	1.14	S.A	
...3	T0056	BN63-05538A	COVER-DECORATION;UB7000 46inch,ABS,PMMA,	1	S.N.A	
...4		BN81-03206A	RESIN;ABS+PMMA,SF-0503,K21294	0.013	S.N.A	
...3		BN63-05781C	COVER-STAND GLASS;37,40,LB650,GLASS,T8.0	1	S.N.A	
...3	T0527	BN68-00513A	LABEL-E,PASS;ALL MODEL,YUPO(110G),50X15,	1	S.N.A	
...3	T0527	BN68-01648B	LABEL WARNING;WW,PET,T0.05,40,25,EXPORT	1	S.N.A	
...3	M0126	BN73-00215A	RUBBER-FOOT;40LB650,RUBBER,15*25,60,4.0,	4	S.N.A	
...3	M0126	BN73-00217A	RUBBER-FOOT;LB650,RUBBER,DIA30,7.5,Dark	4	S.N.A	
...3		BN61-05240A	HOLDER-SWIVEL RING TOP;LB700 46,POM HB,A	1	S.N.A	
...3		BN74-00031A	GREASE;kanto-kasei FL-955,grease,wht	0.4	S.N.A	
..2	M0523	BN96-12038A	ASSY STAND P-GUIDE;40,LB750,PC+GF 20%,BL	1	S.A	
...3	T0524	6902-001063	BAG PE;LDPE,T0.05,W180,L350,TRP,RECYCLE	1	S.N.A	
...3	T0920	BN61-04996A	GUIDE-STAND;LB640 40,PC+GF 20%,BLK	1	S.N.A	
...4		BN81-00204H	RESIN;Trirex,3025G20 BK,PC G/F 20%,4249P	0.175	S.N.A	
...3	T0527	BN68-00513A	LABEL-E,PASS;ALL MODEL,YUPO(110G),50X15,	1	S.N.A	
...3		BN68-02215F	MANUAL FLYER-STAND GUIDE;B610 ~ 750,SAMS	1	S.N.A	
...3		BN96-12031B	ASSY ACCESSORY-SCREW;09 LCD-TV,6002-0012	1	S.N.A	
...4	T0081	6002-001294	SCREW-TAPPING;BH,+,,M4,L16,ZPC(BLK)	8	S.N.A	
...4		6902-000336	BAG ZIPPER;LDPE,T0.05,W70,L80,TRP,0.500g	1	S.N.A	
...4		BN68-02215J	MANUAL FLYER-STAND GUIDE;B610 ~ 750,SAMS	1	S.N.A	
0.1	M0002	BN90-01931A	ASSY COVER REAR;40,LB620,EO	1	S.N.A	
..2	T0081	6002-001294	SCREW-TAPPING;BH,+,,M4,L16,ZPC(BLK)	10	S.N.A	
..2	M0013	BN96-09602A	ASSY COVER P-REAR;40,LB620,EO,HIPS,HB,BK	1	S.A	
...3	T0101	BN61-04816A	BRACKET-WALL;40, B610,SECC,T1.2	4	S.N.A	
...3	T0139	BN65-00002A	CLAMPER CORE;BORDEAUX,LDPE,BLK	1	S.N.A	
...3	T0069	AA60-00091J	SPACER-FELT;FELT,330X10,BLK,T0.5	2	S.N.A	
...3	M0006	BN63-05382A	COVER-REAR;40,LB620,EO,HIPS,HB,BK500	1	S.N.A	
...4		BN81-00199H	RESIN;HIPS HB,BK500,HF-1690H,K2901	2.761	S.N.A	
...3	T0071	BN64-01028B	INLAY-TERMINAL;LB550/620,EO,PS SHEET,T0.	1	S.N.A	
..2	M0081	6003-001334	SCREW-TAPTYPE;BH,+ ,S,M4,L14,ZPC(BLK),SWR	1	S.N.A	
0.1		BN91-03377B	ASSY LCD-CMO;LE40B620R3WXXC	1	S.N.A	
..2	M0215	BN07-00662A	LCD-PANEL;V400H1-LH3,CM40H13A,10bits,40.	1	S.A	
...3		BN81-02391A	A/S-T CON V400H1-LH3;V400H1-LH3	1	S.N.A	
0.1		BN91-03734A	ASSY SHIELD;LE40B620R3WXXC	1	S.N.A	
..2	M0081	6003-000337	SCREW-TAPTYPE;BH,+ ,S,M4,L10,ZPC(BLK),SWR	4	S.A	
..2	M0081	6003-001188	SCREW-TAPTYPE;BH,+ ,-,B,M4,L10,ZPC(WHT),S	6	S.N.A	
..2	M0081	6003-001439	SCREW-TAPTYPE;BH,+ ,S,M4,L8,ZPC(WHT),SWRC	1	S.N.A	
..2	M2893	BN39-01099K	LEAD CONNECTOR;LB5P,LB5K,UL1007#26,30P,7	1	S.A	
..2	M0174	BN44-00264A	IP BOARD;PSIV231101A,H40F1_9SS,0.11mA,11	1	S.A	
..2	M0146	BN61-03056A	BRACKET-PANEL TOP;TULIP52,SECC,T1.2	2	S.N.A	
..2	M0254	BN61-04801C	HOLDER-SIDE AV;EO,HIPS,HB,BK500,1USB,1HD	1	S.A	
...3		BN81-00199H	RESIN;HIPS HB,BK500,HF-1690H,K2901	0.01	S.N.A	
..2	M0115	BN61-04918A	BRACKET-STAND LINK;40, B610,SECC,T1.6	1	S.A	
..2	AC271	BN63-05259A	COVER-MAIN;EO,ABS+PMMA,HB,BK23,H/GLOSSY	1	S.N.A	
...3		BN81-03206A	RESIN;ABS+PMMA,SF-0503,K21294	0.015	S.N.A	
..2	M0251	BN96-10076A	ASSY CABLE P-FPCB LVDS;LA46A650A1,FPCB L	1	S.A	
..2	T0081	6001-002284	SCREW-MACHINE;BH,+ ,M4,L8,ZPC(WHT),SWRCH1	10	S.A	
..2	CIS1	0203-001586	TAPE-FILAMENT;#893,0.15,30,55	0.63	S.N.A	
0.1		BN92-04459A	ASSY LABEL;LE40B620R3WXXC	1	S.N.A	

## 5. Exploded View &amp; Part List

Level	Location No.	Code No.	Description & Specification	Q'ty	SA/SNA	Remark
.2	T0527	AA68-03752B	LABEL-STICKER;WW,ALL,Art Paper(90g),25,3	1	S.N.A	
.2	CCM1	BN68-01176A	LABEL RATING;W/W,SS,PET POLYESTER,T0.05,	1	S.N.A	
0.1		BN92-04805B	ASSY BOX;40,LB620,EO,CHARCOAL GRAY	1	S.N.A	
.2	T0077	BH68-00329D	LABEL BAR CODE-02;NO CE,NO WT'Y,MPRII,LA	1	S.N.A	
.2		BN69-04035C	BOX-02,SET;40LB640-SS(SLIM PACKAGE),CB,A	1	S.N.A	
0.1		BN92-04810A	ASSY P/MATERIAL;40,LB640	1	S.N.A	
.2		6902-000604	BAG WRAPPING;LDPE,T0.02,W500,L10000,TRP,	4.32	S.N.A	
.2	T0214	BN74-00008A	TAPE-OPP MASKING;OPP-2,T0.05,W100,L800M,	2.65	S.N.A	
.2	T0603	BN69-02096P	PALLET;WOOD,1300,1010,130,sesk-52	1	S.N.A	
.2		BH69-40383L	PACKING INNER-00,PAD;COMM,CB-SW4,1200,90	1	S.N.A	
.2		6902-000379	BAG AIR;LDPE,T0.2,W1000,L1800,TRP,1260.0	1	S.N.A	
.2		BN69-03982F	PAD PACKING-EDGE;LB6T,PAPER,8,120,2160,Y	1	S.N.A	
.2	M040	6922-000003	BAND PP;PP,T0.8,W18,L1650M,TRP,DA69-9014	669.6	S.N.A	
.2	T0246	BN69-03953A	CUSHION-SET;40LB620/640,EPS,SLIM PACKAGE	1	S.N.A	
.2		BN69-00257F	PACKING-BAG SHEET;- ,CB,- ,1200,500,- ,-,WH	1	S.N.A	
.2	T0524	6902-001043	BAG PE;HDPE/NITRON,T0.015/T0.5,W1200,L80	1	S.N.A	
0.1	M0017	BN91-04355F	ASSY CHASSIS;LE40B620R3PX*	1	S.N.A	
.2		BN94-02763L	ASSY PCB MAIN-CNE;LE40B620R3PX*	1	S.A	
...3		0202-001463	SOLDER-WIRE;LFC2-W3.0,-,D3,99.79Sn/0.2Cu	4.288	S.N.A	
...3		0202-001608	SOLDER-WIRE FLUX;LFC7-107,D0.8,99.3Sn/0.	0.25	S.N.A	
...3		0204-002420	SOLVENT;1M-1000,C3H7OH,96	6.63	S.N.A	
...3		0204-002607	FLUX;DF-234U,13%,14KG,Gravity 0.82	4.311	S.N.A	
...3		3701-001388	CONNECTOR-HDMI;20P,Phosphor Bronze,ANGLE	1	S.A	
...3		3701-001480	CONNECTOR-DSUB;15P,3R,FEMAIL,STAMPED PIN	1	S.A	
...3	CN906	3707-001081	CONNECTOR-OPTICAL;STRAIGHT,SPDIF	1	S.A	
...3		3709-001551	CONNECTOR-CARD SLOT;68P,1.27mm,DIP,AU50U	1	S.A	
...3		3711-003847	HEADER-BOARD TO CABLE;BOX,12P,1R,2mm,ANG	1	S.N.A	
...3		3711-005884	HEADER-BOARD TO BOARD;BOX,30P,2R,2mm,ANG	1	S.A	
...3		3711-006715	HEADER-BOARD TO CABLE;BOX,4P,1R,2.5mm,AN	1	S.N.A	
...3	JA330	3722-001061	JACK-PHONE;1P,3.6PI,AG,BLK,N	4	S.A	
...3	AJACK4	3722-002546	JACK-USB;4P/1C,AU,BLK,ANGLE,A type	1	S.A	
...3	JA333	3722-002635	JACK-PIN;3P,Sn,YEL/WHT/RED,ANGLE	1	S.A	
...3	SJACK1	3722-002681	JACK-SCART;42P,SN,BLK	1	S.A	
...3	JA333	3722-002691	JACK-PIN;2P,Ni,WHT/RED,STRAIGHT	2	S.A	
...3	JA333	3722-002703	JACK-PIN;3P,Ni,GRN/BLU/RED,STRAIGHT	1	S.A	
...3	CIS3	BN40-00145A	TUNER;TDHG6-K12A,TDHG6-K12A,DVB-TC,164CH	1	S.A	
...3	T0066	BN62-00043A	HEAT SINK-ES;40*40*5,Ceramic,T1.5,TAPE	1	S.N.A	
...3		BN97-03631A	ASSY HDCP;BN46-00023A,LB5K,LB6T,LB6A,LB7	1	S.N.A	
...4		BN46-00023A	KEY CODE-CI PLUS KEY;CI PLUS KEY,TCTC,SE	1	S.N.A	
...3	T0174	BN97-03647L	ASSY SMD;LE40B620R3PX*,BN94-02763L	1	S.N.A	
...4		0202-001477	SOLDER-CREAM;LST309-M,D20~45um,96.5Sn/3A	1	S.N.A	
...4		0401-001049	DIODE-SWITCHING;LS4148,75V,150mA,SOD-80,	4	S.A	
...4		0401-001056	DIODE-SWITCHING;MMBD4148SE,100V,200mA,SO	13	S.A	
...4	D1	0401-001099	DIODE-SWITCHING;1N4148WS,75V,150mA,SOD-3	1	S.A	
...4	D0254	0402-001207	DIODE-SCHOTTKY;UPS5819,40V,1000mA,DO-216	1	S.A	
...4		0402-001614	DIODE-RECTIFIER;S1G,400V,1A,DO-214AC,TP	1	S.A	
...4		0403-000002	DIODE-ZENER;VLZ5V6B,5.45/5.73V,500mW,SOD	2	S.A	
...4		0403-000584	DIODE-ZENER;VLZ3V6B,3.6/3.845V,500mW,SOD	1	S.N.A	
...4		0403-001180	DIODE-ZENER;BZX84C6V2,5.8-6.6V,350mW,SOT	45	S.A	
...4	D0254	0404-001404	DIODE-SCHOTTKY;BAT721C,40V,200mA,SOT-23,	5	S.A	
...4	T0139	0406-001200	DIODE-TVS;RCLAMP0504F,6/-V,150W,SC-70	1	S.A	

5. Exploded View & Part List

Level	Location No.	Code No.	Description & Specification	Q'ty	SA/SNA	Remark
...4	T0139	0406-001271	DIODE-TVS;RCLAMP0524P,6/-V,150W,SLP251	8	S.A	
...4	SD3	0407-000114	DIODE-SWITCHING;KDS184,80V,100mA,SOT-23,	2	S.A	
...4		0501-000280	TR-SMALL SIGNAL;KSA1182,PNP,150MW,SOT-23	3	SC	
...4		0501-000342	TR-SMALL SIGNAL;KSC1623-Y,NPN,200mW,SOT-	1	S.A	
...4	Q101	0501-000445	TR-SMALL SIGNAL;KTC3875S-Y,NPN,150mW,SOT	9	S.A	
...4	PQ02	0501-002080	TR-SMALL SIGNAL;2SC2412K,NPN,200mW,SC-59	4	S.A	
...4	CEQ2	0505-000110	FET-SILICON;2N7002,N,60V,115mA,7.5ohm,0.	2	S.A	
...4	Q409	0505-001916	FET-SILICON;Si4800BDY,N,30V,9A,0.03ohm,2	1	S.A	
...4	IC104	0801-002095	IC-CMOS LOGIC;74LCX245,TRANSCEIVER,TSSOP	1	S.N.A	
...4	IC104	0801-002172	IC-CMOS LOGIC;74LCX16244,BUFFER/LINE DRI	3	S.A	
...4	IC104	0801-002630	IC-CMOS LOGIC;74AHCT1G08,2-INPUT AND GAT	1	S.A	
...4	ND51C2	0801-002780	IC-CMOS LOGIC;74LVC1G17,SCHMITT-TRIGGER	1	S.A	
...4		1001-000164	IC-ANALOG MULTIPLEX;74HC4052,CMOS,SOP,16	1	S.A	
...4	IC106	1001-001177	IC-VIDEO SWITCH;TEA6425D,VIDEO SWITCH,SO	1	S.A	
...4	IC106	1001-001573	IC-VIDEO SWITCH;Si19287BCNUTR,QFN,72P,10	1	S.A	
...4	IC107	1002-001482	IC-D/A CONVERTER;WM8521H9GED/R,16bit,SOI	1	S.A	
...4		1006-001266	IC-LINE TRANSCEIVER;3232,TSSOP,16P,174MI	1	S.A	
...4	IC112	1103-000129	IC-EEPROM;24C02,2Kbit,256x8,SOP,8P,5x4mm	2	S.A	
...4	IC112	1103-001310	IC-EEPROM;24LC02B,256X8BIT,SOIC,8P,3.91X	1	S.N.A	
...4	IC112	1103-001385	IC-EEPROM;AT24C256,256Kbit,32Kx8,SOP,8P,	1	S.A	
...4		1105-001931	IC-DDR2 SDRAM;K4T51163Q,DDR2-800,512Mbit	4	S.N.A	
...4	T0124	1201-002796	IC-POWER AMP;STA339BWS,PSSO,36P,10.3x7.5	1	S.A	
...4	T0087	1203-001815	IC-POSI.FIXED REG.;78M09,TO-252,3P,PLAST	1	S.A	
...4	T0087	1203-001816	IC-POSI.FIXED REG.;78M08,TO-252,3P,-,PLA	1	S.A	
...4	T0087	1203-002842	IC-POSI.FIXED REG.;AP1117D-33,TO-252,3P,	3	S.A	
...4		1203-004363	IC-VOL. DETECTOR;RT9818C-29PV,SOT-23,3P,	1	S.A	
...4		1203-004364	IC-VOL. DETECTOR;RT9818C-42PV,SOT-23,3P,	1	S.A	
...4		1203-004879	IC-DC/DC CONVERTER;MP8668DL,QFN,14P,3x4m	1	S.A	
...4	T0087	1203-005134	IC-POSI.FIXED REG.;RT9167A-33PB,SOT-23-5	1	S.A	
...4		1203-005538	IC-DC/DC CONVERTER;AOZ1021HAIL,SOP,8P,4.	1	S.A	
...4		1203-005559	IC-BACKLIGHT DRIVER;MP3302DJ,TSOT23,5P,2	1	S.A	
...4	IC012	1203-005756	IC-POSI.ADJUST REG.;AP7173-SP,SOP-8L-EP,	1	S.A	
...4	IC118	1204-003010	IC-VIDEO PROCESS;SDP84,PBGA,324P,23x23mm	1	S.A	
...4		1204-003011	IC-DECODER;SDP83,PBGA,729P,34x34mm,PLAST	1	S.A	
...4		1205-003201	IC-BUS SWITCH;TC7WB125FK,SSOP,8P,2x2.3mm	1	S.A	
...4		1205-003352	IC-CODEC;WM8593SEFT/V,TQFP,64P,10x10mm,P	1	S.A	
...4		1205-003479	IC-SWITCH;TPS2051BDBVR,SOT-23,5P,2.9x1.6	1	S.A	
...4		1205-003733	IC-SWITCH;AP2191MPG-13,MSOP-8L-EP,8P,2.9	1	S.A	
...4		1209-001830	IC-PLL;IDT6V10012PGG,TSSOP,20P,6.5x4.4mm	1	S.A	
...4		1405-001185	VARISTOR;24Vdc,1.6x0.8x0.36mm,TP	1	S.A	
...4		1405-001233	VARISTOR;30Vdc,5A,1.6x0.8x0.8mm,TP	36	S.A	
...4	DR1	2007-000043	R-CHIP;1Kohm,1%,1/10W,TP,1608	16	S.A	
...4	KAR21	2007-000070	R-CHIP;0ohm,5%,1/10W,TP,1608	3	S.N.A	
...4	PR6	2007-000072	R-CHIP;47ohm,5%,1/10W,TP,1608	4	S.N.A	
...4	AR30	2007-000074	R-CHIP;100ohm,5%,1/10W,TP,1608	1	S.A	
...4	MR604	2007-000137	R-CHIP;2Kohm,5%,1/16W,TP,1005	8	S.N.A	
...4	R105	2007-000138	R-CHIP;100ohm,5%,1/16W,TP,1005	27	S.N.A	
...4	AR49	2007-000140	R-CHIP;1Kohm,5%,1/16W,TP,1005	25	S.N.A	
...4	MR306	2007-000141	R-CHIP;2.2Kohm,5%,1/16W,TP,1005	4	S.N.A	
...4	R319	2007-000143	R-CHIP;4.7Kohm,5%,1/16W,TP,1005	43	S.N.A	
...4		2007-000146	R-CHIP;6.8Kohm,5%,1/16W,TP,1005	2	S.N.A	

## 5. Exploded View &amp; Part List

Level	Location No.	Code No.	Description & Specification	Q'ty	SA/SNA	Remark
....4	R104	2007-000148	R-CHIP;10Kohm,5%,1/16W,TP,1005	32	S.N.A	
....4	R102	2007-000149	R-CHIP;12Kohm,5%,1/16W,TP,1005	2	S.A	
....4	MR36	2007-000153	R-CHIP;22Kohm,5%,1/16W,TP,1005	2	S.N.A	
....4	AR43	2007-000155	R-CHIP;27Kohm,5%,1/16W,TP,1005	1	S.N.A	
....4	MR13	2007-000157	R-CHIP;47Kohm,5%,1/16W,TP,1005	16	S.N.A	
....4	R123	2007-000159	R-CHIP;56Kohm,5%,1/16W,TP,1005	1	S.N.A	
....4	DR39	2007-000162	R-CHIP;100Kohm,5%,1/16W,TP,1005	1	S.N.A	
....4	R111	2007-000171	R-CHIP;0ohm,5%,1/16W,TP,1005	25	S.N.A	
....4	HDR17	2007-000172	R-CHIP;10ohm,5%,1/16W,TP,1005	7	S.N.A	
....4	R338	2007-000173	R-CHIP;22ohm,5%,1/16W,TP,1005	27	S.N.A	
....4	UR23	2007-000174	R-CHIP;47ohm,5%,1/16W,TP,1005	44	S.N.A	
....4	R2136	2007-000239	R-CHIP;1.5Kohm,1%,1/10W,TP,1608	1	S.A	
....4	S1G0843	2007-000259	R-CHIP;1.6Kohm,5%,1/10W,TP,1608	1	S.A	
....4	R1035	2007-000287	R-CHIP;100ohm,1%,1/10W,TP,1608	3	S.N.A	
....4	R414	2007-000362	R-CHIP;12ohm,5%,1/10W,TP,1608	8	S.N.A	
....4	KR7	2007-000402	R-CHIP;150ohm,5%,1/10W,TP,1608	1	S.A	
....4	R320	2007-000458	R-CHIP;18Kohm,5%,1/10W,TP,1608	2	S.A	
....4	MR17	2007-000566	R-CHIP;220Kohm,5%,1/16W,TP,1005	1	S.N.A	
....4	HR12	2007-000591	R-CHIP;22ohm,1%,1/10W,TP,1608	1	S.N.A	
....4		2007-000606	R-CHIP;240ohm,1%,1/10W,TP,1608	2	S.A	
....4	ZR46	2007-000608	R-CHIP;240ohm,5%,1/10W,TP,1608	2	S.A	
....4	ER13	2007-000669	R-CHIP;2Kohm,1%,1/10W,TP,1608	1	S.N.A	
....4	R346	2007-000729	R-CHIP;300ohm,5%,1/10W,TP,1608	2	S.N.A	
....4		2007-000755	R-CHIP;330Kohm,1%,1/10W,TP,1608	1	S.A	
....4		2007-000758	R-CHIP;330Kohm,5%,1/16W,TP,1005	1	S.N.A	
....4	R19	2007-000763	R-CHIP;330ohm,1%,1/10W,TP,1608	1	S.N.A	
....4	R2007	2007-000803	R-CHIP;36Kohm,1%,1/10W,TP,1608	1	S.A	
....4	DR37	2007-000932	R-CHIP;470ohm,5%,1/16W,TP,1005	4	S.N.A	
....4	R441	2007-001042	R-CHIP;56ohm,1%,1/10W,TP,1608	1	S.N.A	
....4	R509	2007-001179	R-CHIP;8.2Kohm,5%,1/10W,TP,1608	1	S.A	
....4	OTR1	2007-001292	R-CHIP;33ohm,5%,1/16W,TP,1005	1	S.N.A	
....4	CER07	2007-001308	R-CHIP;200ohm,5%,1/16W,TP,1005	2	S.N.A	
....4	R326	2007-001325	R-CHIP;3.3Kohm,5%,1/16W,TP,1005	5	S.N.A	
....4	R1	2007-002425	R-CHIP;1ohm,5%,1/10W,TP,1608	5	S.N.A	
....4	ER19	2007-002899	R-CHIP;10ohm,1%,1/10W,TP,1608	1	S.A	
....4		2007-002900	R-CHIP;11Kohm,1%,1/10W,TP,1608	1	S.A	
....4	TR30	2007-007009	R-CHIP;75ohm,5%,1/16W,TP,1005	7	S.A	
....4	HDR8	2007-007095	R-CHIP;390ohm,5%,1/16W,TP,1005	1	S.A	
....4	R365	2007-007107	R-CHIP;100Kohm,1%,1/16W,TP,1005	2	S.N.A	
....4		2007-007136	R-CHIP;4.7Kohm,1%,1/16W,TP,1005	2	S.N.A	
....4	DR4	2007-007142	R-CHIP;10Kohm,1%,1/16W,TP,1005	7	S.N.A	
....4		2007-007197	R-CHIP;3.3ohm,5%,1/16W,TP,1005	2	S.N.A	
....4		2007-007222	R-CHIP;6.04Kohm,1%,1/10W,TP,1608	1	S.A	
....4		2007-007312	R-CHIP;20Kohm,1%,1/16W,TP,1005	2	S.A	
....4		2007-007316	R-CHIP;3.3Kohm,1%,1/16W,TP,1005	1	S.N.A	
....4		2007-007318	R-CHIP;1Kohm,1%,1/16W,TP,1005	1	S.N.A	
....4		2007-007469	R-CHIP;110ohm,1%,1/16W,TP,1005	1	S.N.A	
....4		2007-007671	R-CHIP;11Kohm,1%,1/16W,TP,1005	1	S.A	
....4		2007-007698	R-CHIP;5.1Kohm,1%,1/16W,TP,1005	2	S.N.A	
....4		2007-007797	R-CHIP;44.2ohm,1%,1/10W,TP,1608	2	S.A	
....4	MR11	2007-008015	R-CHIP;75ohm,1%,1/16W,TP,1005	22	S.N.A	

5. Exploded View & Part List

Level	Location No.	Code No.	Description & Specification	Q'ty	SA/SNA	Remark
...4		2007-008593	R-CHIP;750ohm,1%,1/16W,TP,1005	1	S.A	
...4	ZRN10	2011-001261	R-NETWORK;33ohm,5%,1/16W,L,CHIP,8P,TP,2.	4	S.A	
...4	DAR09	2011-001262	R-NETWORK;22ohm,5%,1/16W,L,CHIP,8P,TP,2.	38	S.A	
...4	HRP2	2011-001344	R-NETWORK;100ohm,5%,1/16W,L,CHIP,8P,TP,2	3	S.A	
...4		2011-001345	R-NETWORK;10Kohm,5%,1/16W,L,CHIP,8P,TP,2	4	S.A	
...4	DRP29	2011-001396	R-NETWORK;4.7Kohm,5%,1/16W,L,CHIP,8P,TP,	12	S.A	
...4		2011-001397	R-NETWORK;47Kohm,5%,1/16W,L,CHIP,8P,TP,2	2	S.A	
...4		2011-001448	R-NETWORK;10ohm,5%,1/16W,L,4P,T,1010	18	S.A	
...4		2011-001449	R-NETWORK;22ohm,5%,1/16W,L,4P,TP,1010	8	S.A	
...4		2011-001497	R-NETWORK;470ohm,5%,1/16W,L,CHIP,4P,TP,1	2	S.N.A	
...4		2011-001506	R-NETWORK;10Kohm,5%,1/16W,L,CHIP,4P,TP,1	3	S.N.A	
...4		2011-001519	R-NETWORK;33OHM,5%,1/16W,L,CHIP,4P,TP,1.	3	S.A	
...4		2011-001527	R-NETWORK;4.7Kohm,5%,1/16W,L,CHIP,4P,TP,	4	S.N.A	
...4		2011-001582	R-NETWORK;150,5%,1/16W,L,CHIP-V,8P,TP,2.	1	S.N.A	
...4		2011-001586	R-NETWORK;1Kohm,5%,1/16W,L,CHIP-V,4P,TP,	4	S.A	
...4		2011-001587	R-NETWORK;100ohm,5%,1/16W,L,CHIP-V,4P,TP	4	S.A	
...4		2011-001588	R-NETWORK;75ohm,5%,1/16W,L,CHIP-V,4P,TP,	1	S.A	
...4		2011-001589	R-NETWORK;0ohm,5%,1/16W,L,CHIP-V,4P,TP,1	4	S.N.A	
...4		2011-001590	R-NETWORK;47Kohm,5%,1/16W,L,CHIP-V,4P,TP	2	S.N.A	
...4	AC1	2203-000125	C-CER,CHIP;1.2nF,10%,50V,X7R,TP,1608,-	4	S.A	
...4	PC43	2203-000233	C-CER,CHIP;0.1nF,5%,50V,C0G,TP,1005	13	S.A	
...4	RC34	2203-000280	C-CER,CHIP;0.01nF,0.5pF,50V,C0G,1608	1	S.A	
...4	VC4	2203-000357	C-CER,CHIP;0.15nF,5%,50V,C0G,1608	1	S.N.A	
...4	C3	2203-000384	C-CER,CHIP;0.015nF,5%,50V,C0G,1608	1	S.N.A	
...4	C254	2203-000438	C-CER,CHIP;1nF,10%,50V,X7R,TP,1005	9	S.A	
...4	C507	2203-000489	C-CER,CHIP;2.2nF,10%,50V,X7R,TP,1005	5	S.A	
...4	AD480	2203-000550	C-CER,CHIP;0.02nF,5%,50V,C0G,1005	2	S.N.A	
...4	V1233	2203-000575	C-CER,CHIP;220nF,10%,25V,X7R,TP,2012	6	S.N.A	
...4	AD480	2203-000585	C-CER,CHIP;0.22nF,10%,50V,X7R,1005	1	S.A	
...4	AD480	2203-000679	C-CER,CHIP;0.027nF,5%,50V,C0G,1005	2	S.A	
...4	C1101	2203-000697	C-CER,CHIP;0.002NF,0.25PF,50V,C0G,TP,160	2	S.A	
...4	AD480	2203-000761	C-CER,CHIP;330nF,10%,16V,X7R,TP,2012,-	1	S.N.A	
...4	DC25	2203-000812	C-CER,CHIP;.033nF,5%,50V,C0G,1005	8	S.A	
...4	AD480	2203-000995	C-CER,CHIP;.047nF,5%,50V,C0G,TP,1005	5	S.A	
...4	KAC5	2203-001126	C-CER,CHIP;0.68nF,10%,50V,X7R,1608	1	S.N.A	
...4	AD480	2203-001412	C-CER,CHIP;0.03nF,5%,50V,NP0,TP,1005	4	S.N.A	
...4	MC22R	2203-001596	C-CER,CHIP;2200nF,+80-20%,50V,Y5V,2012	2	S.A	
...4	AD480	2203-002285	C-CER,CHIP;10nF,10%,50V,X7R,1005	21	S.N.A	
...4	AD480	2203-002494	C-CER,CHIP;470nF,10%,16V,X7R,2012	1	S.N.A	
...4	DC18	2203-005138	C-CER,CHIP;1.8nF,10%,50V,X7R,1005	3	S.A	
...4	AAC1	2203-005249	C-CER,CHIP;100nF,10%,50V,X7R,TP,1608	47	S.N.A	
...4	AD480	2203-005344	C-CER,CHIP;22nF,10%,25V,X7R,TP,1005,-	16	S.N.A	
...4	AD480	2203-005393	C-CER,CHIP;0.005nF,0.1pF,50V,NP0,TP,1005	1	S.N.A	
...4	AD480	2203-005493	C-CER,CHIP;220nF,+80-20%,16V,Y5V,1005	2	S.A	
...4	AD480	2203-005659	C-CER,CHIP;0.18nF,5%,50V,NP0,1005	1	S.N.A	
...4	EC9	2203-005834	C-CER,CHIP;22000nF,+80-20%,10V,Y5V,3216	5	S.A	
...4	AD480	2203-005968	C-CER,CHIP;4.7NF,10%,50V,X7R,TP,1005	2	S.N.A	
...4	AD480	2203-006104	C-CER,CHIP;1000nF,10%,50V,X7R,3225	1	S.A	
...4	AD480	2203-006126	C-CER,CHIP;47NF,10%,16V,X7R,TP,1005	3	S.N.A	
...4	PC11	2203-006141	C-CER,CHIP;1000nF,10%,16V,X5R,1608	8	S.N.A	
...4	C102	2203-006158	C-CER,CHIP;100nF,10%,16V,X7R,1005	213	S.N.A	



## 5. Exploded View &amp; Part List

Level	Location No.	Code No.	Description & Specification	Q'ty	SA/SNA	Remark
...4	AD480	2203-006336	C-CER,CHIP;10000nF,10%,25V,X5R,3216	1	S.A	
...4	C125	2203-006361	C-CER,CHIP;10000nF,10%,10V,X5R,TP,2012	65	SC	
...4	HDC11	2203-006562	C-CER,CHIP;1000nF,10%,10V,X5R,TP,1005	44	S.N.A	
...4	AD480	2203-006681	C-CER,CHIP;100nF,+80-20%,25V,Y5V,1005	10	S.N.A	
...4	AD480	2203-006992	C-CER,CHIP;0.33nF,5%,50V,C0G,TP,1005	9	S.N.A	
...4	AD480	2203-007176	C-CER,CHIP;10000nF,10%,16V,X5R,TP,2012 (	6	S.N.A	
...4	C	2402-001128	C-AL,SMD;100#F,20%,16V,-,TP,6.3X5.7mm	3	S.A	
...4		2402-001210	C-POLYMER AL CHIP;100uF,20%,10V,WT,TP,7.	1	S.A	
...4		2409-001118	C-POLYMER ,CHIP;47uF,-+20,10V,WT,REEL,3.	3	S.A	
...4		2503-001051	C-NETWORK;100nFx4,20%,16V,2012	1	S.A	
...4	T0052	2703-000380	INDUCTOR-SMD;18uH,5%,3225	1	S.A	
...4	VL6	2703-000398	INDUCTOR-SMD;10uH,10%,3225	12	S.A	
...4	T0052	2703-001239	INDUCTOR-SMD;3.3uH,10%,1608	1	S.A	
...4	T0052	2703-003559	INDUCTOR-SMD;4.7uH,20%,8080	1	S.N.A	
...4	T0052	2703-003713	INDUCTOR-SMD;1.5uH,20%,7366	1	S.A	
...4	T0052	2704-000018	INDUCTOR-SMD-ARRAY;15uH,2000mA,2,0.124oh	2	S.A	
...4	X202	2801-003326	CRYSTAL-SMD;24MHZ,30PPM,28-ABX,20PF,50OH	1	S.A	
...4	X202	2801-003773	CRYSTAL-SMD;12MHZ,30ppm,28-AAN,20pF,50oh	1	S.A	
...4	X202	2801-004629	CRYSTAL-SMD;27MHz,20ppm,12pF,50ohm,TP	1	S.A	
...4	F103	2901-001506	FILTER-EMI SMD;5V,0.13A,0pF,2x1x0.5mm,TP	2	S.A	
...4	DR32	3301-000314	BEAD-SMD;120ohm,1.6x0.8x0.8mm,-,-,-	2	S.N.A	
...4	L2011	3301-001145	BEAD-SMD;60ohm,4516,TP,70ohm/45MHz,82ohm	1	S.N.A	
...4	T0568	3301-001236	BEAD-SMD;60ohm,1608	14	S.N.A	
...4	T0568	3301-001404	BEAD-SMD;30ohm,2012,TP,15.9OHM/30MHz	46	S.A	
...4		3701-001591	CONNECTOR-HDMI;19P,2ROW,FEMALE,SMD-S,AU	3	S.N.A	
...4		3711-005925	HEADER-BOARD TO CABLE;BOX,51P,1R,0.5mm,S	1	S.A	
...4	T0077	BN41-01167C	PCB MAIN;Chelsea-Arsnal,FR-4,4,MP1.1,1.2	1	S.N.A	
...4	M0018	BN97-03213A	ASSY MICOM;WT61P8-RG480WT,N68A,2008.11.2	1	S.N.A	
....5	IC520	0903-001552	IC-MICROCONTROLLER;WT61P8-RG480WT,LQFP,4	1	S.N.A	
...4	M0018	BN97-03760A	ASSY MICOM;N74A,2009.5.20,T-CHL5CIPDEUC,	1	S.N.A	
....5		1107-001818	IC-NAND FLASH;KFG1G16U2C-DIB6,1024Mbit,6	1	S.N.A	
...4	T0010	BP27-00002A	COIL CHOKE;SLF6028T-220MR77,22uF,20%,0.1	1	S.A	
...4	AD480	2203-007132	C-CER,CHIP;10000nF,10%,25V,X7R,TP,3216(1	4	S.A	
...4	IC012	1203-003700	IC-POSI.ADJUST REG.;LD1117ADT-R,DPAK,3P,	1	S.A	
...4	AD480	2203-006307	C-CER,CHIP;1000nF,10%,25V,X5R,2012	1	S.N.A	
...3	T0066	BP62-00017A	HEAT SINK-ES;SP-50L2HX,A6063S,T2.0,26.2,	1	S.N.A	
0.1	M0045	BN92-05014T	ASSY ACCESSORY;LE40B620R3PXZG	1	S.N.A	
..2		BN96-12162V	ASSY ACCESSORY-MANUAL;LE40B620R3WXZG.46,	1	S.A	
...3	T0524	6902-000110	BAG PE;LDPE,T0.05,W250,L400,TRP,28,2,9.2	1	S.N.A	
...3		AA68-03242Q	MANUAL FLYER-04,SAFETY GUIDE;comm,Samsun	1	S.N.A	
...3	T0527	BN68-00513A	LABEL-E,PASS;ALL MODEL,YUPO(110G),50X15,	1	S.N.A	
...3		BN68-00514E	MANUAL FLYER-03,WARRANTY CARD;comm,Samsu	1	S.N.A	
...3		BN68-00907D	MANUAL FLYER-WEEE BATTERY;COMM,SAMSUNG,2	1	S.N.A	
...3		BN68-02186A	MANUAL FLYER-TOC GUIDE;COMM,SAMSUNG,10 L	1	S.N.A	
...3	M0156	BN68-02326D	MANUAL USERS-02;B620,SAMSUNG,ENG/GER,GER	1	S.N.A	
..2	M0045	BN96-12164A	ASSY ACCESSORY-CABLE;LE40B620R3WXXC	1	S.A	
...3	T0268	3903-000456	CBF-POWER CORD;DT,EU/KR,CP3,IEC320 C13-R	1	S.A	
...3	T0120	4301-000121	BATTERY-MN;1.5V,R03,10.5x44.5m,HOLDER,7.	2	S.N.A	
...3	T0524	6902-000110	BAG PE;LDPE,T0.05,W250,L400,TRP,28,2,9.2	1	S.N.A	
...3		BN59-00939A	REMOCON-TM950;SAMSUNG,48,3V,EUROPE,124g	1	S.A	
...3		BN61-05596A	HOLDER-WIRE CABLE;LED TV,LDPE,T0.8,L150,	1	S.N.A	

5. Exploded View & Part List

Level	Location No.	Code No.	Description & Specification	Q'ty	SA/SNA	Remark
...3	M9889	BN63-01798B	CLOTH-CLEAN;cloth,180,200,sea blue,ToC	1	S.N.A	
...3	T0531	BN63-05385B	COVER-BOTTOM;40,LB620,HIPS,HB,BK500	1	S.A	
...4		BN81-00199H	RESIN;HIPS HB,BK500,HF-1690H,K2901	58.3	S.N.A	
...3	T0527	BN68-00513A	LABEL-E,PASS;ALL MODEL,YUPO(110G),50X15,	1	S.N.A	
...3	M0045	BN96-01800A	ASSY ACCESSORY-SCREW ZIPPER;ROME32,SCREW	1	S.N.A	
...4	T0081	6002-001294	SCREW-TAPPING;BH,+,,M4,L16,ZPC(BLK)	4	S.N.A	
...4		6902-000683	BAG ZIPPER;LDPE,T0.05,W60,L60,TRP,4-PE M	1	S.N.A	