

5. Exploded View & Part List

5-1. LE32B65* Exploded View

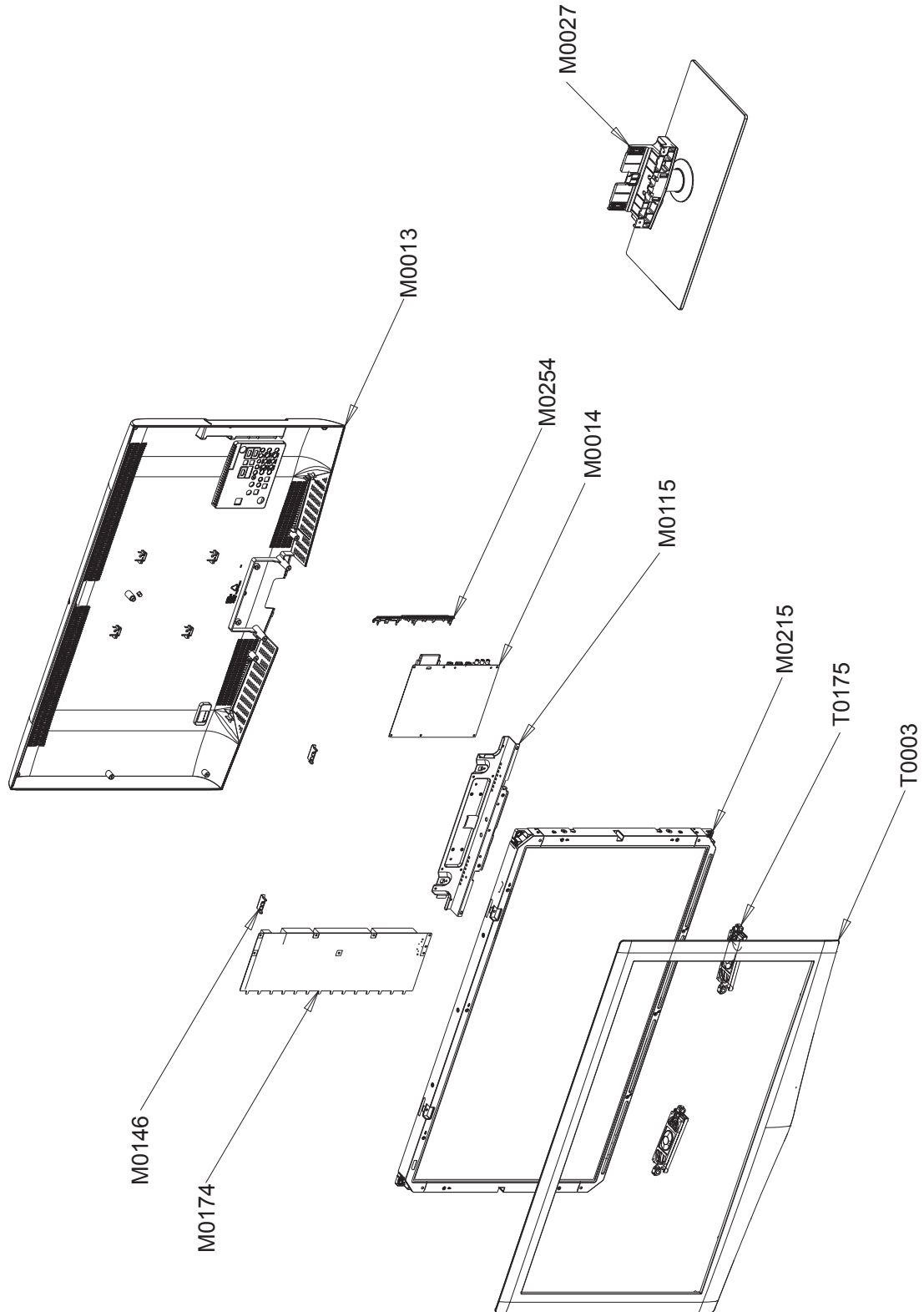

5-1-1. LE32B65* Parts List

| Location No. | Code No. | Description & Specification | Q'ty | S.A/S.N.A | Remark |
|--------------|-------------|--|------|-----------|--------|
| T0003 | BN96-09492C | ASSY COVER P-FRONT;32,LB650,EO,PMMA(CLR) | 1 | S.A | |
| M0215 | BN07-00641A | LCD-PANEL;T315HW02 V3,AU31H23,8bit,31.5i | 1 | S.A | |
| | BN81-02346A | A/S-T CON T315HW02_V3;T315HW02_V3 | 1 | S.N.A | |
| T0175 | BN96-09463A | ASSY SPEAKER P;8ohm,4pin,10W,R:200 / L:4 | 1 | S.A | |
| M0115 | BN61-04820A | BRACKET-STAND LINK;B650-32,SECC,T1.2 | 1 | S.N.A | |
| M0146 | BN61-04818A | BRACKET-PANEL TOP;B650-32,SECC,T1.2 | 2 | S.N.A | |
| M0174 | BN44-00261A | IP BOARD;PSIV161C01A,H32F1_9SS,0.12mA,12 | 1 | S.A | |
| M0014 | BN94-02667J | ASSY PCB MAIN-AAE;LE32B650T2PX* | 1 | S.A | |
| M0254 | BN61-04800A | HOLDER-SIDE AV;EO,ABS+PMMA,HB,BK23,H/GLO | 1 | S.N.A | |
| M0013 | BN96-09502A | ASSY COVER P-REAR;32,LB650,EO,ABS+PMMA,H | 1 | S.A | |
| M0027 | BN96-09497B | ASSY STAND P-BASE;32,LB650,TEMPERED GLAS | 1 | S.A | |

5-2. LE32B65* Parts List

Service Bom (SA: SERVICE AVAILABLE, SNA: SERVICE NOT AVAILABLE)

| Level | Location No. | Code No. | Description & Specification | Q'ty | SA/SNA | Remark |
|-------|--------------|-------------|---|-------|--------|--------|
| | | | LE32B650T2PXZG | | | |
| 0.1 | | BN90-01893C | ASSY COVER FRONT;32,LB650,EO,CHARCOAL GR | 1 | S.N.A | |
| ..2 | T0175 | BN96-09463A | ASSY SPEAKER P;8ohm,4pin,10W,R:200 / L:4 | 1 | S.A | |
| ..2 | T0003 | BN96-09492C | ASSY COVER P-FRONT;32,LB650,EO,PMMA(CLR) | 1 | S.A | |
| ...3 | M0081 | 6003-001188 | SCREW-TAPTYPE;BH,+,-,B,M4,L10,ZPC(WHT),S | 3 | S.N.A | |
| ...3 | AB326 | BN61-04661A | BRACKET-STOPPER;L650,SK-5,T0.4,Plating,H | 6 | S.N.A | |
| ...3 | CCM1 | BN63-02183E | COVER-SHEET;Rhcm,PE Vinyl,T0.05,750mm,20 | 0.7 | S.N.A | |
| ...3 | CCM1 | BN63-05199B | COVER-SHEET;AMBER,PE,T0.08,W65mm,200M,CL | 2.4 | S.A | |
| ...3 | CCM1 | BN63-05199G | COVER-SHEET;AMBER,PE,T0.08,W115mm,200M,C | 1 | S.A | |
| ...3 | T0603 | BN64-01036A | WINDOW-RMC;B650 46,PC VIOLET | 1 | S.N.A | |
| ...3 | M0125 | BN96-10279D | ASSY BOARD P-TOUCH FUNCTION&IR;LE32B651T | 1 | S.A | |
| ...3 | AS078 | BN63-05304B | SHEET-FUNCTION;LB650 46,PET,T0.12,WHITE | 1 | S.N.A | |
| ...3 | T0069 | BN60-00027N | SPACER-FELT;L650 32,FELT,383,0.5,20 | 2 | S.N.A | |
| ...3 | T0069 | BN60-00027T | SPACER-FELT;L650 32,FELT,700,0.5,20 | 2 | S.N.A | |
| ...3 | M0112 | BN63-05349C | COVER-FRONT;32,LB650,EO,PMMA(CLR)+PMMA(C | 1 | S.N.A | |
|4 | | BN81-00116G | RESIN;ABS+PMMA,TTP01,TF-0959H,70784,FT61 | 655.6 | S.N.A | |
|4 | | BN81-00116X | RESIN;ABS+PMMA,SF-0505H/LD0114,SD6320,71 | 0.484 | S.N.A | |
| ...3 | | BN96-09505C | ASSY HOLDER P-BOSS SIDE RIGHT;32,LB650,P | 1 | S.N.A | |
|4 | | BN61-04692A | BOSS-PRIMER;#94,clear,35cps | 0.1 | S.N.A | |
|4 | | BN61-04731A | BOSS-TAPE;AMBER,ACRYL,T1.1,W8.0mm,WHITE | 0.03 | S.N.A | |
|4 | | BN61-04731F | BOSS-TAPE;AMBER,ACRYL,T1.1,W6.0mm,WHITE, | 0.26 | S.N.A | |
|4 | | BN61-04842C | HOLDER-BOSS SIDE R;32,LB650,ABS+PMMA,HB, | 1 | S.N.A | |
|5 | | BN81-03206A | RESIN;ABS+PMMA,SF-0503,K21294 | 0.035 | S.N.A | |
| ...3 | | BN96-09505D | ASSY HOLDER P-BOSS SIDE LEFT;32,LB650,PM | 1 | S.N.A | |
|4 | | BN61-04692A | BOSS-PRIMER;#94,clear,35cps | 0.1 | S.N.A | |
|4 | | BN61-04731A | BOSS-TAPE;AMBER,ACRYL,T1.1,W8.0mm,WHITE | 0.03 | S.N.A | |
|4 | | BN61-04731F | BOSS-TAPE;AMBER,ACRYL,T1.1,W6.0mm,WHITE, | 0.26 | S.N.A | |
|4 | | BN61-04842D | HOLDER-BOSS SIDE L;32,LB650,ABS+PMMA,HB, | 1 | S.N.A | |
|5 | | BN81-03206A | RESIN;ABS+PMMA,SF-0503,K21294 | 0.035 | S.N.A | |
| ...3 | | BN96-09544B | ASSY HOLDER P-BOSS BOTTOM;32,L650,ABS,HB | 1 | S.N.A | |
|4 | | BN61-04692A | BOSS-PRIMER;#94,clear,35cps | 0.3 | S.N.A | |
|4 | | BN61-04731D | BOSS-TAPE;AMBER,ACRYL,T1.1,W20.0mm,WHITE | 0.06 | S.N.A | |
|4 | | BN61-04731A | BOSS-TAPE;AMBER,ACRYL,T1.1,W8.0mm,WHITE | 0.68 | S.N.A | |
|4 | | BN61-04973B | HOLDER-BOSS BOTTOM;B650-2,32,ABS,HB,WH12 | 1 | S.N.A | |
|5 | | BN81-00116F | RESIN;ABS HB,WHT,HF-0680U,W91902,-,-,- | 191.9 | S.N.A | |
| ...3 | | BN61-05741A | HOLDER-CONTROL;LB650 U,HIPS,BLK,V0 | 1 | S.N.A | |
|4 | | BN81-00199H | RESIN;HIPS HB,BK500,HF-1690H,K2901 | 0.004 | S.N.A | |
| ...3 | | BN74-00052A | TAPE-PAPER;LB530,Crepe Paper,0.17mm, 10m | 0.05 | S.N.A | |
| 0.1 | M0216 | BN90-01903B | ASSY STAND;32,LB650,BLACK,GRAY NECK | 1 | S.N.A | |
| ..2 | M0027 | BN96-09497B | ASSY STAND P-BASE;32,LB650,TEMPERED GLAS | 1 | S.A | |
| ...3 | M0081 | 6003-001003 | SCREW-TAPTYPE;BH,+ ,B,M4,L12,ZPC(BLK),SWR | 3 | S.A | |
| ...3 | | BN61-04692A | BOSS-PRIMER;#94,clear,35cps | 0.1 | S.N.A | |
| ...3 | | BN61-04731B | BOSS-TAPE;AMBER,ACRYL,T1.1,W12.0mm,WHITE | 0.29 | S.N.A | |
| ...3 | | BN61-04855A | BRACKET-SWIVEL BOTTOM;B650 40,SECC,T2.0 | 1 | S.N.A | |
| ...3 | | BN61-05254A | HOLDER-SWIVEL RING BOTTOM;LB700 40,POM H | 1 | S.N.A | |
| ...3 | T0527 | BN68-01648B | LABEL WARNING;WW,PET,T0.05,40,25,EXPORT | 1 | S.N.A | |
| ...3 | T0527 | BN68-00513A | LABEL-E,PASS;ALL MODEL,YUPO(110G),50X15, | 1 | S.N.A | |

5. Exploded View & Part List

| Level | Location No. | Code No. | Description & Specification | Q'ty | SA/SNA | Remark |
|-------|--------------|-------------|---|-------|--------|--------|
| ...3 | CCM1 | BN63-04755A | COVER-SHEET;AMBER,PE,T0.05,W150mm,200M,6 | 1.1 | S.A | |
| ...3 | M0126 | BN73-00215A | RUBBER-FOOT;40LB650,RUBBER,15*25,60,4.0, | 4 | S.N.A | |
| ...3 | M0126 | BN73-00217A | RUBBER-FOOT;LB650,RUBBER,DIA30,7.5,Dark | 4 | S.N.A | |
| ...3 | GSN01 | BN61-05248B | GUIDE-STAND NECK;LB650,32,PC,C/GRAY(TP27 | 1 | S.A | |
| ...4 | AH506 | BN61-05271B | HOLDER-INSERT;LB610 40,PC EXTRUSION,C/GR | 1 | S.N.A | |
| ...4 | | BN81-00116J | RESIN;PC CLEAR,SC-1220R/70918,HF-1130R, | 0.15 | S.N.A | |
| ...3 | T0056 | BN63-05537A | COVER-DECORATION;UB7000 40inch,ABS,PMMA, | 1 | S.N.A | |
| ...4 | | BN81-03206A | RESIN;ABS+PMMA,SF-0503,K21294 | 0.01 | S.N.A | |
| ...3 | | BN63-05530C | COVER-STAND GLASS;32,LB650,GLASS,T8.0,BL | 1 | S.N.A | |
| ...3 | | BN61-05653A | BRACKET-STAND BOTTOM;B650 32,SECC,T2.0 | 1 | S.N.A | |
| ...3 | | BN61-05826A | BOSS-BOND;#760,Poly urethane,Black | 1.2 | S.N.A | |
| ...3 | | BN61-05238A | HOLDER-SWIVEL RING TOP;LB700 40,POM HB,A | 1 | S.N.A | |
| ...3 | | BN74-00031A | GREASE;kanto-kasei FL-955,grease,wht | 0.4 | S.N.A | |
| ..2 | M0523 | BN96-10598A | ASSY STAND P-GUIDE;32,LB650,PC+G/F,20%,B | 1 | S.A | |
| ...3 | T0527 | BN68-00513A | LABEL-E,PASS;ALL MODEL,YUPO(110G),50X15, | 1 | S.N.A | |
| ...3 | T0920 | BN61-04812A | GUIDE-STAND;32,PET+PC+G/F (15%) V2,BK500 | 1 | S.N.A | |
| ...4 | | BN81-00204H | RESIN;Trirex,3025G20 BK,PC G/F 20%,4249P | 0.3 | S.N.A | |
| 0.1 | M0002 | BN90-01908A | ASSY COVER REAR;32,LB650,EO | 1 | S.N.A | |
| ..2 | T0081 | 6002-001294 | SCREW-TAPPING;BH,+,,M4,L16,ZPC(BLK) | 10 | S.N.A | |
| ..2 | M0013 | BN96-09502A | ASSY COVER P-REAR;32,LB650,EO,ABS+PMMA,H | 1 | S.A | |
| ...3 | T0101 | BN61-04816A | BRACKET-WALL;40, B610,SECC,T1.2 | 4 | S.N.A | |
| ...3 | CCM1 | BN63-02183E | COVER-SHEET;Rhcm,PE Vinyl,T0.05,750mm,20 | 0.9 | S.N.A | |
| ...3 | T0139 | BN65-00002A | CLAMPER CORE;BORDEAUX,LDPE,BLK | 1 | S.N.A | |
| ...3 | T0069 | AA63-60131N | SPACER-FELT;L2,FELT,280*10,BLK,T0.5 | 2 | S.N.A | |
| ...3 | | BN63-02224B | FELT-VIBRATION;50E7,FELT,T0.5,679,10 | 1 | S.N.A | |
| ...3 | M0006 | BN63-05344A | COVER-REAR;32,LB650,EO,ABS+PMMA,HB,BK23, | 1 | S.N.A | |
| ...3 | T0071 | BN64-01028A | INLAY-TERMINAL;LB650/750,EO,PS SHEET,T0. | 1 | S.N.A | |
| 0.1 | | BN91-03501B | ASSY SHIELD;LE32B650T2WXXC,T3 | 1 | S.N.A | |
| ..2 | CIS1 | 0203-001586 | TAPE-FILAMENT;#893,0.15,30,55 | 0.25 | S.N.A | |
| ..2 | M0081 | 6003-000337 | SCREW-TAPTYPE;BH,+ ,S,M4,L10,ZPC(BLK),SWR | 4 | S.A | |
| ..2 | M0081 | 6003-001188 | SCREW-TAPTYPE;BH,+,-,B,M4,L10,ZPC(WHT),S | 5 | S.N.A | |
| ..2 | M0081 | 6003-001439 | SCREW-TAPTYPE;BH,+ ,S,M4,L8,ZPC(WHT),SWRC | 1 | S.N.A | |
| ..2 | M2893 | BN39-01099J | LEAD CONNECTOR;LB5P,LB5K,UL1007#26,30P,6 | 1 | S.A | |
| ..2 | M0254 | BN61-04800A | HOLDER-SIDE AV;EO,ABS+PMMA,HB,BK23,H/GLO | 1 | S.N.A | |
| ...3 | | BN81-03206A | RESIN;ABS+PMMA,SF-0503,K21294 | 17.3 | S.N.A | |
| ..2 | M0146 | BN61-04818A | BRACKET-PANEL TOP;B650-32,SECC,T1.2 | 2 | S.N.A | |
| ..2 | M0115 | BN61-04820A | BRACKET-STAND LINK;B650-32,SECC,T1.2 | 1 | S.N.A | |
| ..2 | AC271 | BN63-05259A | COVER-MAIN;EO,ABS+PMMA,HB,BK23,H/GLOSSY | 1 | S.N.A | |
| ...3 | | BN81-03206A | RESIN;ABS+PMMA,SF-0503,K21294 | 0.015 | S.N.A | |
| ..2 | | BN96-10077A | ASSY CABLE P-FPCB LVDS;LA46A650A1,FPCB L | 1 | S.A | |
| ..2 | T0081 | 6001-002284 | SCREW-MACHINE;BH,+ ,M4,L8,ZPC(WHT),SWRCH1 | 10 | S.A | |
| ..2 | M0174 | BN44-00261A | IP BOARD;PSIV161C01A,H32F1_9SS,0.12mA,12 | 1 | S.A | |
| 0.1 | | BN91-03829A | ASSY LCD-AUO;LE32B653T5WXXC | 1 | S.N.A | |
| ..2 | M0215 | BN07-00641A | LCD-PANEL;T315HW02 V3,AU31H23,8bit,31.5i | 1 | S.A | |
| ...3 | | BN81-02346A | A/S-T CON T315HW02_V3;T315HW02_V3 | 1 | S.N.A | |
| 0.1 | | BN92-04323A | ASSY LABEL;LE32B653T5WXXC | 1 | S.N.A | |
| ..2 | CCM1 | BN68-01176A | LABEL RATING;W/W,SS,PET POLYESTER,T0.05, | 1 | S.N.A | |
| ..2 | T0527 | AA68-03752B | LABEL-STICKER;WW,ALL,Art Paper(90g),25,3 | 1 | S.N.A | |
| 0.1 | | BN92-04608A | ASSY P/MATERIAL;32,LB650 | 1 | S.N.A | |
| ..2 | | 6902-000604 | BAG WRAPPING;LDPE,T0.02,W500,L10000,TRP, | 3.42 | S.N.A | |
| ..2 | | BN69-00617Z | PALLET-WOODEN;BE46PS,WOOD-WoodEN,1250,91 | 1 | S.N.A | |

5. Exploded View & Part List

| Level | Location No. | Code No. | Description & Specification | Q'ty | SA/SNA | Remark |
|-------|--------------|-------------|---|-------|--------|--------|
| .2 | T0246 | BN69-03212A | CUSHION-SET;32LB650,EPS,16.7g/l | 1 | S.N.A | |
| .2 | T0214 | BN74-00008A | TAPE-OPP MASKING;OPP-2,T0.05,W100,L800M, | 2.08 | S.N.A | |
| .2 | | BN69-00257B | PACKING-PAD;PAPER,CB-SW4,1130,820,YEL,28 | 1 | S.N.A | |
| .2 | T0524 | 6902-000738 | BAG PE;HDPE/HDPE/NITRON,T0.015/T0.015/T1 | 1 | S.N.A | |
| .2 | | 6902-000379 | BAG AIR;LDPE,T0.2,W1000,L1800,TRP,1260.0 | 1 | S.N.A | |
| .2 | | BN69-03982F | PAD PACKING-EDGE;LB6T,PAPER,8,120,2160,Y | 1 | S.N.A | |
| 0.1 | | BN92-04614G | ASSY BOX;32BT2,EO,LB650 | 1 | S.N.A | |
| .2 | T0077 | BH68-00329D | LABEL BAR CODE-02;NO CE,NO WT`Y,MPRII,LA | 1 | S.N.A | |
| .2 | | BN69-03514E | BOX-03;32LB650-T2,CB,A-01, DW3, AB, YEL,W | 1 | S.N.A | |
| 0.1 | M0017 | BN91-04326J | ASSY CHASSIS;LE37B650T2PX* | 1 | S.N.A | |
| .2 | M0014 | BN94-02667J | ASSY PCB MAIN-AAE;LE32B650T2PX* | 1 | S.A | |
| ...3 | | 0202-001463 | SOLDER-WIRE;LFC2-W3.0,-,D3,99.79Sn/0.2Cu | 4.288 | S.N.A | |
| ...3 | | 0202-001608 | SOLDER-WIRE FLUX;LFC7-107,D0.8,99.3Sn/0. | 0.25 | S.N.A | |
| ...3 | | 0204-002420 | SOLVENT;1M-1000,C3H70H,96 | 6.63 | S.N.A | |
| ...3 | | 0204-002607 | FLUX;DF-234U,13%,14KG,Gravity 0.82 | 4.311 | S.N.A | |
| ...3 | | 3701-001388 | CONNECTOR-HDMI;20P,Phosphor Bronze,ANGLE | 1 | S.A | |
| ...3 | | 3701-001480 | CONNECTOR-DSUB;15P,3R,FEMAIL,STAMPED PIN | 1 | S.A | |
| ...3 | CN906 | 3707-001081 | CONNECTOR-OPTICAL;STRAIGHT,SPDIF | 1 | S.A | |
| ...3 | | 3709-001551 | CONNECTOR-CARD SLOT;68P,1.27mm,DIP,AU50U | 1 | S.A | |
| ...3 | | 3711-003847 | HEADER-BOARD TO CABLE;BOX,12P,1R,2mm,ANG | 1 | S.N.A | |
| ...3 | | 3711-005884 | HEADER-BOARD TO BOARD;BOX,30P,2R,2mm,ANG | 1 | S.A | |
| ...3 | | 3711-006715 | HEADER-BOARD TO CABLE;BOX,4P,1R,2.5mm,AN | 1 | S.N.A | |
| ...3 | JA330 | 3722-001061 | JACK-PHONE;1P,3.6PI,AG,BLK,N | 4 | S.A | |
| ...3 | | 3722-002426 | JACK-MODULAR;8P/8C,N,STRAIGHT,GRN/YEL,AU | 1 | S.A | |
| ...3 | AJACK4 | 3722-002546 | JACK-USB;4P/1C,AU,BLK,ANGLE,A type | 2 | S.A | |
| ...3 | JA333 | 3722-002635 | JACK-PIN;3P,Sn,YEL/WHT/RED,ANGLE | 1 | S.A | |
| ...3 | SJACK1 | 3722-002681 | JACK-SCART;42P,SN,BLK | 1 | S.A | |
| ...3 | JA333 | 3722-002691 | JACK-PIN;2P,Ni,WHT/RED,STRAIGHT | 2 | S.A | |
| ...3 | JA333 | 3722-002703 | JACK-PIN;3P,Ni,GRN/BLU/RED,STRAIGHT | 1 | S.A | |
| ...3 | CIS3 | BN40-00145A | TUNER;TDHG6-K12A,TDHG6-K12A,DVB-TC,164CH | 1 | S.A | |
| ...3 | T0174 | BN97-03612J | ASSY SMD;LE32B650T2PX*,BN94-02667J | 1 | S.N.A | |
| ...4 | | 0202-001477 | SOLDER-CREAM;LST309-M,D20~45um,96.5Sn/3A | 1 | S.N.A | |
| ...4 | | 0401-001049 | DIODE-SWITCHING;LS4148,75V,150mA,SOD-80, | 3 | S.A | |
| ...4 | | 0401-001056 | DIODE-SWITCHING;MMBD4148SE,100V,200mA,SO | 19 | S.A | |
| ...4 | D1 | 0401-001099 | DIODE-SWITCHING;1N4148WS,75V,150mA,SOD-3 | 1 | S.A | |
| ...4 | D0254 | 0402-001207 | DIODE-SCHOTTKY;UPS5819,40V,1000mA,DO-216 | 1 | S.A | |
| ...4 | | 0403-000002 | DIODE-ZENER;VLZ5V6B,5.45/5.73V,500mW,SOD | 2 | S.A | |
| ...4 | | 0403-000584 | DIODE-ZENER;VLZ3V6B,3.6/3.845V,500mW,SOD | 1 | S.N.A | |
| ...4 | | 0403-001180 | DIODE-ZENER;BZX84C6V2,5.8-6.6V,350mW,SOT | 45 | S.A | |
| ...4 | D0254 | 0404-001404 | DIODE-SCHOTTKY;BAT721C,40V,200mA,SOT-23, | 5 | S.A | |
| ...4 | T0139 | 0406-001200 | DIODE-TVS;RCLAMP0504F,6/-V,150W,SC-70 | 2 | S.A | |
| ...4 | T0139 | 0406-001271 | DIODE-TVS;RCLAMP0524P,6/-V,150W,SLP251 | 8 | S.A | |
| ...4 | SD3 | 0407-000114 | DIODE-SWITCHING;KDS184,80V,100mA,SOT-23, | 2 | S.A | |
| ...4 | | 0501-000280 | TR-SMALL SIGNAL;KSA1182,PNP,150MW,SOT-23 | 3 | SC | |
| ...4 | Q101 | 0501-000445 | TR-SMALL SIGNAL;KTC3875S-Y,NPN,150mW,SOT | 11 | S.A | |
| ...4 | PQ02 | 0501-002080 | TR-SMALL SIGNAL;2SC2412K,NPN,200mW,SC-59 | 4 | S.A | |
| ...4 | CEQ2 | 0505-000110 | FET-SILICON;2N7002,N,60V,115mA,7.5ohm,0. | 2 | S.A | |
| ...4 | Q409 | 0505-001916 | FET-SILICON;Si4800BDY,N,30V,9A,0.03ohm,2 | 1 | S.A | |
| ...4 | IC104 | 0801-002095 | IC-CMOS LOGIC;74LCX245,TRANSCEIVER,TSSOP | 1 | S.N.A | |
| ...4 | IC104 | 0801-002172 | IC-CMOS LOGIC;74LCX16244,BUFFER/LINE DRI | 3 | S.A | |
| ...4 | IC104 | 0801-002630 | IC-CMOS LOGIC;74AHCT1G08,2-INPUT AND GAT | 1 | S.A | |

5. Exploded View & Part List

| Level | Location No. | Code No. | Description & Specification | Q'ty | SA/SNA | Remark |
|-------|--------------|-------------|--|------|--------|--------|
| ...4 | ND51C2 | 0801-002780 | IC-CMOS LOGIC;74LVC1G17,SCHMITT-TRIGGER | 1 | S.A | |
| ...4 | | 1001-000164 | IC-ANALOG MULTIPLEX;74HC4052,CMOS,SOP,16 | 1 | S.A | |
| ...4 | | 1001-001109 | IC-ANALOG SWITCH;FST3125M,BUS SWITCH & C | 1 | S.A | |
| ...4 | IC106 | 1001-001177 | IC-VIDEO SWITCH;TEA6425D,VIDEO SWITCH,SO | 1 | S.A | |
| ...4 | IC106 | 1001-001573 | IC-VIDEO SWITCH;SiI9287BCNUTR,QFN,72P,10 | 1 | S.A | |
| ...4 | IC107 | 1002-001482 | IC-D/A CONVERTER;WM8521H9GED/R,16bit,SOI | 1 | S.A | |
| ...4 | | 1006-001266 | IC-LINE TRANSCEIVER;3232,TSSOP,16P,174MI | 1 | S.A | |
| ...4 | IC112 | 1103-000129 | IC-EEPROM;24C02,2Kbit,256x8,SOP,8P,5x4mm | 2 | S.A | |
| ...4 | IC112 | 1103-001310 | IC-EEPROM;24LC02B,256X8BIT,SOIC,8P,3.91X | 1 | S.N.A | |
| ...4 | IC112 | 1103-001385 | IC-EEPROM;AT24C256,256Kbit,32Kx8,SOP,8P, | 1 | S.A | |
| ...4 | IC112 | 1103-001415 | IC-EEPROM;AT93C46D,1Kbit,128x8/64x16,SOP | 1 | S.N.A | |
| ...4 | | 1105-001859 | IC-DDR2 SDRAM;K4T1G164QD-ZCE7,DDR2,1Gbit | 4 | S.A | |
| ...4 | T0124 | 1201-002796 | IC-POWER AMP;STA339BWS,PSSO,36P,10.3x7.5 | 1 | S.A | |
| ...4 | T0087 | 1203-001815 | IC-POSI.FIXED REG.;78M09,TO-252,3P,PLAST | 1 | S.A | |
| ...4 | T0087 | 1203-001816 | IC-POSI.FIXED REG.;78M08,TO-252,3P,-,PLA | 1 | S.A | |
| ...4 | T0087 | 1203-002842 | IC-POSI.FIXED REG.;AP1117D-33,TO-252,3P, | 2 | S.A | |
| ...4 | T0087 | 1203-002898 | IC-POSI.FIXED REG.;G950T45R,TO-252,3P,6. | 1 | S.A | |
| ...4 | IC012 | 1203-002995 | IC-POSI.ADJUST REG.;AP1117D,TO-252,3P,6. | 2 | S.A | |
| ...4 | | 1203-004363 | IC-VOL. DETECTOR;RT9818C-29PV,SOT-23,3P, | 1 | S.A | |
| ...4 | | 1203-004364 | IC-VOL. DETECTOR;RT9818C-42PV,SOT-23,3P, | 1 | S.A | |
| ...4 | | 1203-004879 | IC-DC/DC CONVERTER;MP8668DL,QFN,14P,3x4m | 1 | S.A | |
| ...4 | T0087 | 1203-005134 | IC-POSI.FIXED REG.;RT9167A-33PB,SOT-23-5 | 1 | S.A | |
| ...4 | | 1203-005538 | IC-DC/DC CONVERTER;AOZ1021HAIL,SOP,8P,4. | 1 | S.A | |
| ...4 | | 1203-005559 | IC-BACKLIGHT DRIVER;MP3302DJ,TSOT23,5P,2 | 1 | S.A | |
| ...4 | IC012 | 1203-005756 | IC-POSI.ADJUST REG.;AP7173-SP,SOP-8L-EP, | 1 | S.A | |
| ...4 | IC118 | 1204-003010 | IC-VIDEO PROCESS;SDP84,PBGA,324P,23x23mm | 1 | S.A | |
| ...4 | | 1204-003011 | IC-DECODER;SDP83,PBGA,729P,34x34mm,PLAST | 1 | S.A | |
| ...4 | | 1205-002941 | IC-ETHERNET CONTROLLER;RTL8100CSL-LF,LQF | 1 | S.N.A | |
| ...4 | | 1205-003201 | IC-BUS SWITCH;TC7WB125FK,SSOP,8P,2x2.3mm | 1 | S.A | |
| ...4 | | 1205-003352 | IC-CODEC;WM8593SEFTV,TQFP,64P,10x10mm,P | 1 | S.A | |
| ...4 | | 1205-003479 | IC-SWITCH;TPS2051BDBVR,SOT-23,5P,2.9x1.6 | 1 | S.A | |
| ...4 | | 1205-003733 | IC-SWITCH;AP2191MPG-13,MSOP-8L-EP,8P,2.9 | 1 | S.A | |
| ...4 | | 1205-003735 | IC-SWITCH;AP2151WG-7,SOT25,5P,2.9x1.6mm, | 1 | S.A | |
| ...4 | | 1209-001830 | IC-PLL;IDT6V10012PGG,TSSOP,20P,6.5x4.4mm | 1 | S.A | |
| ...4 | | 1405-001185 | VARISTOR;24Vdc,1.6x0.8x0.36mm,TP | 1 | S.A | |
| ...4 | | 1405-001233 | VARISTOR;30Vdc,5A,1.6x0.8x0.8mm,TP | 37 | S.A | |
| ...4 | DR1 | 2007-000043 | R-CHIP;1Kohm,1%,1/10W,TP,1608 | 16 | S.A | |
| ...4 | KAR21 | 2007-000070 | R-CHIP;0ohm,5%,1/10W,TP,1608 | 3 | S.N.A | |
| ...4 | PR6 | 2007-000072 | R-CHIP;47ohm,5%,1/10W,TP,1608 | 4 | S.N.A | |
| ...4 | AR30 | 2007-000074 | R-CHIP;100ohm,5%,1/10W,TP,1608 | 1 | S.A | |
| ...4 | MR604 | 2007-000137 | R-CHIP;2Kohm,5%,1/16W,TP,1005 | 8 | S.N.A | |
| ...4 | R105 | 2007-000138 | R-CHIP;100ohm,5%,1/16W,TP,1005 | 27 | S.N.A | |
| ...4 | AR49 | 2007-000140 | R-CHIP;1Kohm,5%,1/16W,TP,1005 | 26 | S.N.A | |
| ...4 | MR306 | 2007-000141 | R-CHIP;2.2Kohm,5%,1/16W,TP,1005 | 4 | S.N.A | |
| ...4 | R319 | 2007-000143 | R-CHIP;4.7Kohm,5%,1/16W,TP,1005 | 44 | S.N.A | |
| ...4 | | 2007-000146 | R-CHIP;6.8Kohm,5%,1/16W,TP,1005 | 2 | S.N.A | |
| ...4 | R104 | 2007-000148 | R-CHIP;10Kohm,5%,1/16W,TP,1005 | 33 | S.N.A | |
| ...4 | R102 | 2007-000149 | R-CHIP;12Kohm,5%,1/16W,TP,1005 | 2 | S.A | |
| ...4 | MR36 | 2007-000153 | R-CHIP;22Kohm,5%,1/16W,TP,1005 | 2 | S.N.A | |
| ...4 | AR43 | 2007-000155 | R-CHIP;27Kohm,5%,1/16W,TP,1005 | 1 | S.N.A | |
| ...4 | MR13 | 2007-000157 | R-CHIP;47Kohm,5%,1/16W,TP,1005 | 18 | S.N.A | |

5. Exploded View & Part List

| Level | Location No. | Code No. | Description & Specification | Q'ty | SA/SNA | Remark |
|-------|--------------|-------------|--|------|--------|--------|
|4 | R123 | 2007-000159 | R-CHIP;56Kohm,5%,1/16W,TP,1005 | 1 | S.N.A | |
|4 | DR39 | 2007-000162 | R-CHIP;100Kohm,5%,1/16W,TP,1005 | 1 | S.N.A | |
|4 | R111 | 2007-000171 | R-CHIP;0ohm,5%,1/16W,TP,1005 | 75 | S.N.A | |
|4 | HDR17 | 2007-000172 | R-CHIP;10ohm,5%,1/16W,TP,1005 | 7 | S.N.A | |
|4 | R338 | 2007-000173 | R-CHIP;22ohm,5%,1/16W,TP,1005 | 27 | S.N.A | |
|4 | UR23 | 2007-000174 | R-CHIP;47ohm,5%,1/16W,TP,1005 | 44 | S.N.A | |
|4 | R2136 | 2007-000239 | R-CHIP;1.5Kohm,1%,1/10W,TP,1608 | 1 | S.A | |
|4 | S1G0843 | 2007-000259 | R-CHIP;1.6Kohm,5%,1/10W,TP,1608 | 1 | S.A | |
|4 | R1035 | 2007-000287 | R-CHIP;100ohm,1%,1/10W,TP,1608 | 3 | S.N.A | |
|4 | R414 | 2007-000362 | R-CHIP;12ohm,5%,1/10W,TP,1608 | 8 | S.N.A | |
|4 | KR7 | 2007-000402 | R-CHIP;150ohm,5%,1/10W,TP,1608 | 1 | S.A | |
|4 | R320 | 2007-000458 | R-CHIP;18Kohm,5%,1/10W,TP,1608 | 2 | S.A | |
|4 | MR17 | 2007-000566 | R-CHIP;220Kohm,5%,1/16W,TP,1005 | 1 | S.N.A | |
|4 | HR12 | 2007-000591 | R-CHIP;22ohm,1%,1/10W,TP,1608 | 1 | S.N.A | |
|4 | | 2007-000606 | R-CHIP;240ohm,1%,1/10W,TP,1608 | 2 | S.A | |
|4 | ZR46 | 2007-000608 | R-CHIP;240ohm,5%,1/10W,TP,1608 | 1 | S.A | |
|4 | ER13 | 2007-000669 | R-CHIP;2Kohm,1%,1/10W,TP,1608 | 1 | S.N.A | |
|4 | R346 | 2007-000729 | R-CHIP;300ohm,5%,1/10W,TP,1608 | 2 | S.N.A | |
|4 | | 2007-000755 | R-CHIP;330Kohm,1%,1/10W,TP,1608 | 1 | S.A | |
|4 | | 2007-000758 | R-CHIP;330Kohm,5%,1/16W,TP,1005 | 1 | S.N.A | |
|4 | R19 | 2007-000763 | R-CHIP;330ohm,1%,1/10W,TP,1608 | 1 | S.N.A | |
|4 | R2007 | 2007-000803 | R-CHIP;36Kohm,1%,1/10W,TP,1608 | 1 | S.A | |
|4 | DR37 | 2007-000932 | R-CHIP;470ohm,5%,1/16W,TP,1005 | 4 | S.N.A | |
|4 | FR18 | 2007-000982 | R-CHIP;5.6Kohm,5%,1/16W,TP,1005 | 2 | S.A | |
|4 | R441 | 2007-001042 | R-CHIP;56ohm,1%,1/10W,TP,1608 | 1 | S.N.A | |
|4 | R509 | 2007-001179 | R-CHIP;8.2Kohm,5%,1/10W,TP,1608 | 1 | S.A | |
|4 | OTR1 | 2007-001292 | R-CHIP;33ohm,5%,1/16W,TP,1005 | 2 | S.N.A | |
|4 | DR1 | 2007-001301 | R-CHIP;68ohm,5%,1/16W,TP,1005 | 1 | S.A | |
|4 | CER07 | 2007-001308 | R-CHIP;200ohm,5%,1/16W,TP,1005 | 1 | S.N.A | |
|4 | R326 | 2007-001325 | R-CHIP;3.3Kohm,5%,1/16W,TP,1005 | 5 | S.N.A | |
|4 | R1 | 2007-002425 | R-CHIP;1ohm,5%,1/10W,TP,1608 | 7 | S.N.A | |
|4 | ER19 | 2007-002899 | R-CHIP;10ohm,1%,1/10W,TP,1608 | 1 | S.A | |
|4 | | 2007-002900 | R-CHIP;11Kohm,1%,1/10W,TP,1608 | 1 | S.A | |
|4 | TR30 | 2007-007009 | R-CHIP;75ohm,5%,1/16W,TP,1005 | 11 | S.A | |
|4 | HDR8 | 2007-007095 | R-CHIP;390ohm,5%,1/16W,TP,1005 | 1 | S.A | |
|4 | R365 | 2007-007107 | R-CHIP;100Kohm,1%,1/16W,TP,1005 | 2 | S.N.A | |
|4 | | 2007-007136 | R-CHIP;4.7Kohm,1%,1/16W,TP,1005 | 2 | S.N.A | |
|4 | DR4 | 2007-007142 | R-CHIP;10Kohm,1%,1/16W,TP,1005 | 7 | S.N.A | |
|4 | | 2007-007197 | R-CHIP;3.3ohm,5%,1/16W,TP,1005 | 2 | S.N.A | |
|4 | | 2007-007222 | R-CHIP;6.04Kohm,1%,1/10W,TP,1608 | 1 | S.A | |
|4 | | 2007-007312 | R-CHIP;20Kohm,1%,1/16W,TP,1005 | 2 | S.A | |
|4 | | 2007-007316 | R-CHIP;3.3Kohm,1%,1/16W,TP,1005 | 1 | S.N.A | |
|4 | | 2007-007469 | R-CHIP;110ohm,1%,1/16W,TP,1005 | 1 | S.N.A | |
|4 | | 2007-007671 | R-CHIP;11Kohm,1%,1/16W,TP,1005 | 1 | S.A | |
|4 | | 2007-007698 | R-CHIP;5.1Kohm,1%,1/16W,TP,1005 | 2 | S.N.A | |
|4 | | 2007-007797 | R-CHIP;44.2ohm,1%,1/10W,TP,1608 | 2 | S.A | |
|4 | MR11 | 2007-008015 | R-CHIP;75ohm,1%,1/16W,TP,1005 | 22 | S.N.A | |
|4 | | 2007-008298 | R-CHIP;49.9ohm,1%,1/16W,TP,1005 | 4 | S.A | |
|4 | | 2007-008593 | R-CHIP;750ohm,1%,1/16W,TP,1005 | 1 | S.A | |
|4 | ZRN10 | 2011-001261 | R-NETWORK;33ohm,5%,1/16W,L,CHIP,8P,TP,2. | 4 | S.A | |
|4 | DAR09 | 2011-001262 | R-NETWORK;22ohm,5%,1/16W,L,CHIP,8P,TP,2. | 39 | S.A | |

5. Exploded View & Part List

| Level | Location No. | Code No. | Description & Specification | Q'ty | SA/SNA | Remark |
|-------|--------------|-------------|--|------|--------|--------|
| ...4 | HRP2 | 2011-001344 | R-NETWORK;100ohm,5%,1/16W,L,CHIP,8P,TP,2 | 3 | S.A | |
| ...4 | | 2011-001345 | R-NETWORK;10Kohm,5%,1/16W,L,CHIP,8P,TP,2 | 4 | S.A | |
| ...4 | DRP29 | 2011-001396 | R-NETWORK;4.7Kohm,5%,1/16W,L,CHIP,8P,TP, | 12 | S.A | |
| ...4 | | 2011-001397 | R-NETWORK;47Kohm,5%,1/16W,L,CHIP,8P,TP,2 | 2 | S.A | |
| ...4 | | 2011-001448 | R-NETWORK;10ohm,5%,1/16W,L,4P,T,1010 | 18 | S.A | |
| ...4 | | 2011-001449 | R-NETWORK;22ohm,5%,1/16W,L,4P,TP,1010 | 8 | S.A | |
| ...4 | | 2011-001497 | R-NETWORK;470ohm,5%,1/16W,L,CHIP,4P,TP,1 | 3 | S.N.A | |
| ...4 | | 2011-001506 | R-NETWORK;10Kohm,5%,1/16W,L,CHIP,4P,TP,1 | 3 | S.N.A | |
| ...4 | | 2011-001519 | R-NETWORK;33OHM,5%,1/16W,L,CHIP,4P,TP,1. | 3 | S.A | |
| ...4 | | 2011-001527 | R-NETWORK;4.7Kohm,5%,1/16W,L,CHIP,4P,TP, | 5 | S.N.A | |
| ...4 | | 2011-001586 | R-NETWORK;1Kohm,5%,1/16W,L,CHIP-V,4P,TP, | 4 | S.A | |
| ...4 | | 2011-001587 | R-NETWORK;100ohm,5%,1/16W,L,CHIP-V,4P,TP | 4 | S.A | |
| ...4 | | 2011-001588 | R-NETWORK;75ohm,5%,1/16W,L,CHIP-V,4P,TP, | 1 | S.A | |
| ...4 | | 2011-001589 | R-NETWORK;0ohm,5%,1/16W,L,CHIP-V,4P,TP,1 | 9 | S.N.A | |
| ...4 | | 2011-001590 | R-NETWORK;47Kohm,5%,1/16W,L,CHIP-V,4P,TP | 2 | S.N.A | |
| ...4 | AC1 | 2203-000125 | C-CER,CHIP;1.2nF,10%,50V,X7R,TP,1608,- | 4 | S.A | |
| ...4 | PC43 | 2203-000233 | C-CER,CHIP;0.1nF,5%,50V,C0G,TP,1005 | 13 | S.A | |
| ...4 | RC34 | 2203-000280 | C-CER,CHIP;0.01nF,0.5pF,50V,C0G,1608 | 1 | S.A | |
| ...4 | VC4 | 2203-000357 | C-CER,CHIP;0.15nF,5%,50V,C0G,1608 | 1 | S.N.A | |
| ...4 | C3 | 2203-000384 | C-CER,CHIP;0.015nF,5%,50V,C0G,1608 | 3 | S.N.A | |
| ...4 | C254 | 2203-000438 | C-CER,CHIP;1nF,10%,50V,X7R,TP,1005 | 9 | S.A | |
| ...4 | C507 | 2203-000489 | C-CER,CHIP;2.2nF,10%,50V,X7R,TP,1005 | 5 | S.A | |
| ...4 | AD480 | 2203-000550 | C-CER,CHIP;0.02nF,5%,50V,C0G,1005 | 2 | S.N.A | |
| ...4 | V1233 | 2203-000575 | C-CER,CHIP;220nF,10%,25V,X7R,TP,2012 | 6 | S.N.A | |
| ...4 | AD480 | 2203-000585 | C-CER,CHIP;0.22nF,10%,50V,X7R,1005 | 1 | S.A | |
| ...4 | AD480 | 2203-000679 | C-CER,CHIP;0.027nF,5%,50V,C0G,1005 | 2 | S.A | |
| ...4 | C1101 | 2203-000697 | C-CER,CHIP;0.002NF,0.25PF,50V,C0G,TP,160 | 2 | S.A | |
| ...4 | AD480 | 2203-000761 | C-CER,CHIP;330nF,10%,16V,X7R,TP,2012,- | 1 | S.N.A | |
| ...4 | DC25 | 2203-000812 | C-CER,CHIP;.033nF,5%,50V,C0G,1005 | 8 | S.A | |
| ...4 | AD480 | 2203-000995 | C-CER,CHIP;.047nF,5%,50V,C0G,TP,1005 | 5 | S.A | |
| ...4 | HDC5 | 2203-001072 | C-CER,CHIP;0.056nF,5%,50V,NP0,1005 | 1 | S.A | |
| ...4 | KAC5 | 2203-001126 | C-CER,CHIP;0.68nF,10%,50V,X7R,1608 | 1 | S.N.A | |
| ...4 | AD480 | 2203-001412 | C-CER,CHIP;0.03nF,5%,50V,NP0,TP,1005 | 4 | S.N.A | |
| ...4 | MC22R | 2203-001596 | C-CER,CHIP;2200nF,+80-20%,50V,Y5V,2012 | 2 | S.A | |
| ...4 | AD480 | 2203-002285 | C-CER,CHIP;10nF,10%,50V,X7R,1005 | 21 | S.N.A | |
| ...4 | AD480 | 2203-002494 | C-CER,CHIP;470nF,10%,16V,X7R,2012 | 1 | S.N.A | |
| ...4 | DC18 | 2203-005138 | C-CER,CHIP;1.8nF,10%,50V,X7R,1005 | 3 | S.A | |
| ...4 | AAC1 | 2203-005249 | C-CER,CHIP;100nF,10%,50V,X7R,TP,1608 | 48 | S.N.A | |
| ...4 | AD480 | 2203-005344 | C-CER,CHIP;22nF,10%,25V,X7R,TP,1005,- | 16 | S.N.A | |
| ...4 | AD480 | 2203-005393 | C-CER,CHIP;0.005nF,0.1pF,50V,NP0,TP,1005 | 1 | S.N.A | |
| ...4 | AD480 | 2203-005493 | C-CER,CHIP;220nF,+80-20%,16V,Y5V,1005 | 2 | S.A | |
| ...4 | AD480 | 2203-005659 | C-CER,CHIP;0.18nF,5%,50V,NP0,1005 | 1 | S.N.A | |
| ...4 | EC9 | 2203-005834 | C-CER,CHIP;22000nF,+80-20%,10V,Y5V,3216 | 5 | S.A | |
| ...4 | AD480 | 2203-005968 | C-CER,CHIP;4.7NF,10%,50V,X7R,TP,1005 | 2 | S.N.A | |
| ...4 | AD480 | 2203-006039 | C-CER,CHIP;1nF,10%,2000V,X7R,3216 | 2 | S.A | |
| ...4 | AD480 | 2203-006104 | C-CER,CHIP;1000nF,10%,50V,X7R,3225 | 1 | S.A | |
| ...4 | AD480 | 2203-006126 | C-CER,CHIP;47NF,10%,16V,X7R,TP,1005 | 3 | S.N.A | |
| ...4 | PC11 | 2203-006141 | C-CER,CHIP;1000nF,10%,16V,X5R,1608 | 8 | S.N.A | |
| ...4 | C102 | 2203-006158 | C-CER,CHIP;100nF,10%,16V,X7R,1005 | 233 | S.N.A | |
| ...4 | AD480 | 2203-006336 | C-CER,CHIP;10000nF,10%,25V,X5R,3216 | 1 | S.A | |
| ...4 | C125 | 2203-006361 | C-CER,CHIP;10000nF,10%,10V,X5R,TP,2012 | 74 | SC | |

5. Exploded View & Part List

| Level | Location No. | Code No. | Description & Specification | Q'ty | SA/SNA | Remark |
|-------|--------------|-------------|--|-------|--------|--------|
| ...4 | HE4 | 2203-006474 | C-CER,CHIP;22000nF,20%,6.3V,X5R,2012 | 2 | S.A | |
| ...4 | HDC11 | 2203-006562 | C-CER,CHIP;1000nF,10%,10V,X5R,TP,1005 | 44 | S.N.A | |
| ...4 | AD480 | 2203-006681 | C-CER,CHIP;100nF,+80-20%,25V,Y5V,1005 | 10 | S.N.A | |
| ...4 | AD480 | 2203-006992 | C-CER,CHIP;0.33nF,5%,50V,C0G,1005 | 9 | S.N.A | |
| ...4 | AD480 | 2203-007176 | C-CER,CHIP;10000nF,10%,16V,X5R,TP,2012 (| 6 | S.N.A | |
| ...4 | C | 2402-001128 | C-AL,SMD;100#F,20%,16V,-,TP,6.3X5.7mm | 2 | S.A | |
| ...4 | | 2402-001210 | C-POLYMER AL CHIP;100uF,20%,10V,WT,TP,7. | 1 | S.A | |
| ...4 | | 2503-001051 | C-NETWORK;100nFx4,20%,16V,2012 | 1 | S.A | |
| ...4 | | 2601-001056 | TRANS-SMD,PULSE;350UH,-,1:1,1:1,12.7X6.7 | 1 | S.A | |
| ...4 | T0052 | 2703-000380 | INDUCTOR-SMD;18uH,5%,3225 | 1 | S.A | |
| ...4 | VL6 | 2703-000398 | INDUCTOR-SMD;10uH,10%,3225 | 12 | S.A | |
| ...4 | T0052 | 2703-001239 | INDUCTOR-SMD;3.3uH,10%,1608 | 1 | S.A | |
| ...4 | T0052 | 2703-003559 | INDUCTOR-SMD;4.7uH,20%,8080 | 1 | S.N.A | |
| ...4 | T0052 | 2703-003628 | INDUCTOR-SMD;1.5uH,20%,2020 | 1 | S.N.A | |
| ...4 | T0052 | 2704-000018 | INDUCTOR-SMD-ARRAY;15uH,2000mA,2,0.124oh | 2 | S.A | |
| ...4 | X202 | 2801-003326 | CRYSTAL-SMD;24MHZ,30PPM,28-ABX,20PF,50OH | 1 | S.A | |
| ...4 | X202 | 2801-003773 | CRYSTAL-SMD;12MHz,30ppm,28-AAN,20pF,50oh | 1 | S.A | |
| ...4 | X202 | 2801-004629 | CRYSTAL-SMD;27MHz,20ppm,12pF,50ohm,TP | 1 | S.A | |
| ...4 | X202 | 2801-004734 | CRYSTAL-SMD;25.000000MHz,20ppm,28-AAN,12 | 1 | S.A | |
| ...4 | F103 | 2901-001506 | FILTER-EMI SMD;5V,0.13A,0pF,2x1x0.5mm,TP | 2 | S.A | |
| ...4 | DR32 | 3301-000314 | BEAD-SMD;120ohm,1.6x0.8x0.8mm,-,-,- | 2 | S.N.A | |
| ...4 | L2011 | 3301-001145 | BEAD-SMD;60ohm,4516,TP,70ohm/45MHz,82ohm | 1 | S.N.A | |
| ...4 | T0568 | 3301-001236 | BEAD-SMD;60ohm,1608 | 14 | S.N.A | |
| ...4 | T0568 | 3301-001404 | BEAD-SMD;30ohm,2012,TP,15.9OHM/30MHz | 46 | S.A | |
| ...4 | | 3711-005925 | HEADER-BOARD TO CABLE;BOX,51P,1R,0.5mm,S | 1 | S.A | |
| ...4 | T0077 | BN41-01167B | PCB MAIN;Chelsea-Arsnal,FR-4,4,MP1.1,1.2 | 1 | S.N.A | |
| ...4 | M0018 | BN97-03213A | ASSY MICOM;WT61P8-RG480WT,N68A,2008.11.2 | 1 | S.N.A | |
|5 | IC520 | 0903-001552 | IC-MICROCONTROLLER;WT61P8-RG480WT,LQFP,4 | 1 | S.N.A | |
| ...4 | M0018 | BN97-03759A | ASSY MICOM;N68A,2009.5.20,T-CHLCIPDEUC-X | 1 | S.N.A | |
|5 | | 1107-001740 | IC-NAND FLASH;KFH8GH6U4M-DIB6,8Gbit,512M | 1 | S.N.A | |
| ...4 | T0010 | BP27-00002A | COIL CHOKE;SLF6028T-220MR77,22uF,20%,0.1 | 1 | S.A | |
| ...4 | | 3701-001591 | CONNECTOR-HDMI;19P,2ROW,FEMALE,SMD-S,AU | 3 | S.N.A | |
| ...4 | | 2011-001582 | R-NETWORK;150,5%,1/16W,L,CHIP-V,8P,TP,2. | 1 | S.N.A | |
| ...4 | AD480 | 2203-007132 | C-CER,CHIP;10000nF,10%,25V,X7R,TP,3216(1 | 4 | S.A | |
| ...3 | | BN97-03631A | ASSY HDCP;BN46-00023A,LB5K,LB6T,LB6A,LB7 | 1 | S.N.A | |
| ...4 | | BN46-00023A | KEY CODE-CI PLUS KEY;CI PLUS KEY,TCTC,SE | 1 | S.N.A | |
| ...3 | T0066 | BP62-00016B | HEAT SINK-ES;SUNRAY,A6063,T2.0,36.2,36.2 | 1 | S.N.A | |
| ...3 | T0066 | BP62-00017A | HEAT SINK-ES;SP-50L2HX,A6063S,T2.0,26.2, | 1 | S.N.A | |
| 0.1 | M0045 | BN92-05014G | ASSY ACCESSORY;LE32B650T2PXZG | 1 | S.N.A | |
| ..2 | M0045 | BN96-09727N | ASSY ACCESSORY-CABLE;LE32B653T5WXXC | 1 | S.A | |
| ...3 | T0268 | 3903-000456 | CBF-POWER CORD;DT,EU/KR,CP3,IEC320 C13-R | 1 | S.A | |
| ...3 | T0120 | 4301-000121 | BATTERY-MN;1.5V,R03,10.5x44.5m,HOLDER,7. | 2 | S.N.A | |
| ...3 | T0524 | 6902-000110 | BAG PE;LDPE,T0.05,W250,L400,TRP,28,2,9.2 | 1 | S.N.A | |
| ...3 | | BN59-00938A | REMOCON-TM960;SAMSUNG,49,3V,EUROPE,152g | 1 | S.A | |
| ...3 | | BN61-05596A | HOLDER-WIRE CABLE;LED TV,LDPE,T0.8,L150, | 1 | S.N.A | |
| ...3 | M9889 | BN63-01798B | CLOTH-CLEAN;cloth,180,200,sea blue,ToC | 1 | S.N.A | |
| ...3 | T0531 | BN63-05284B | COVER-BOTTOM;B650 32,HIPS,HB,BK500 | 1 | S.A | |
| ...4 | | BN81-00199H | RESIN;HIPS HB,BK500,HF-1690H,K2901 | 0.033 | S.N.A | |
| ...3 | T0527 | BN68-00513A | LABEL-E,PASS;ALL MODEL,YUPO(110G),50X15, | 1 | S.N.A | |
| ...3 | | BN96-01800E | ASSY ACCESSORY-SCREW ZIPPER;32,LB650,GUI | 1 | S.N.A | |
| ...4 | T0081 | 6002-001294 | SCREW-TAPPING;BH,+,,M4,L16,ZPC(BLK) | 8 | S.N.A | |

5. Exploded View & Part List

| Level | Location No. | Code No. | Description & Specification | Q'ty | SA/SNA | Remark |
|-------|--------------|-------------|--|------|--------|--------|
|4 | | 6902-000683 | BAG ZIPPER;LDPE,T0.05,W60,L60,TRP,4-PE M | 1 | S.N.A | |
| ..2 | | BN96-10012W | ASSY ACCESSORY-MANUAL;LE32B653T5WXZG,37, | 1 | S.A | |
| ...3 | T0524 | 6902-000110 | BAG PE;LDPE,T0.05,W250,L400,TRP,28,2,9.2 | 1 | S.N.A | |
| ...3 | | AA68-03242Q | MANUAL FLYER-04,SAFETY GUIDE;comm,Samsun | 1 | S.N.A | |
| ...3 | | BN59-00726D | S/W DRIVER-CD;LN40B650T1F,DLNA,WorldWide | 1 | S.N.A | |
| ...3 | T0527 | BN68-00513A | LABEL-E,PASS;ALL MODEL,YUPO(110G),50X15, | 1 | S.N.A | |
| ...3 | | BN68-00514E | MANUAL FLYER-03,WARRANTY CARD;comm,Samsu | 1 | S.N.A | |
| ...3 | | BN68-00907D | MANUAL FLYER-WEEE BATTERY;COMM,SAMSUNG,2 | 1 | S.N.A | |
| ...3 | | BN68-02186A | MANUAL FLYER-TOC GUIDE;COMM,SAMSUNG,10 L | 1 | S.N.A | |
| ...3 | M0284 | BN68-02325D | MANUAL USERS-03;B650,SAMSUNG,ENG/GER,GER | 1 | S.N.A | |