

SEC 5. EXPLODED VIEWS

- Items with no part number and no description are not stocked because they are seldom required for routine service.
- The construction parts of an assembled part are indicated with a collation number in the remark column.
- Items marked " * " are not stocked since they are seldom required for routine service. Some delay should be anticipated.

The components identified by shading and mark \triangle are critical for safety. Replace only with part number specified.

The components identified by mark \square contain confidential information. Strictly follow the instructions whenever the components are repaired and/or replaced.

5-1. KDL-40HX800

5-1-1. CHASSIS-1

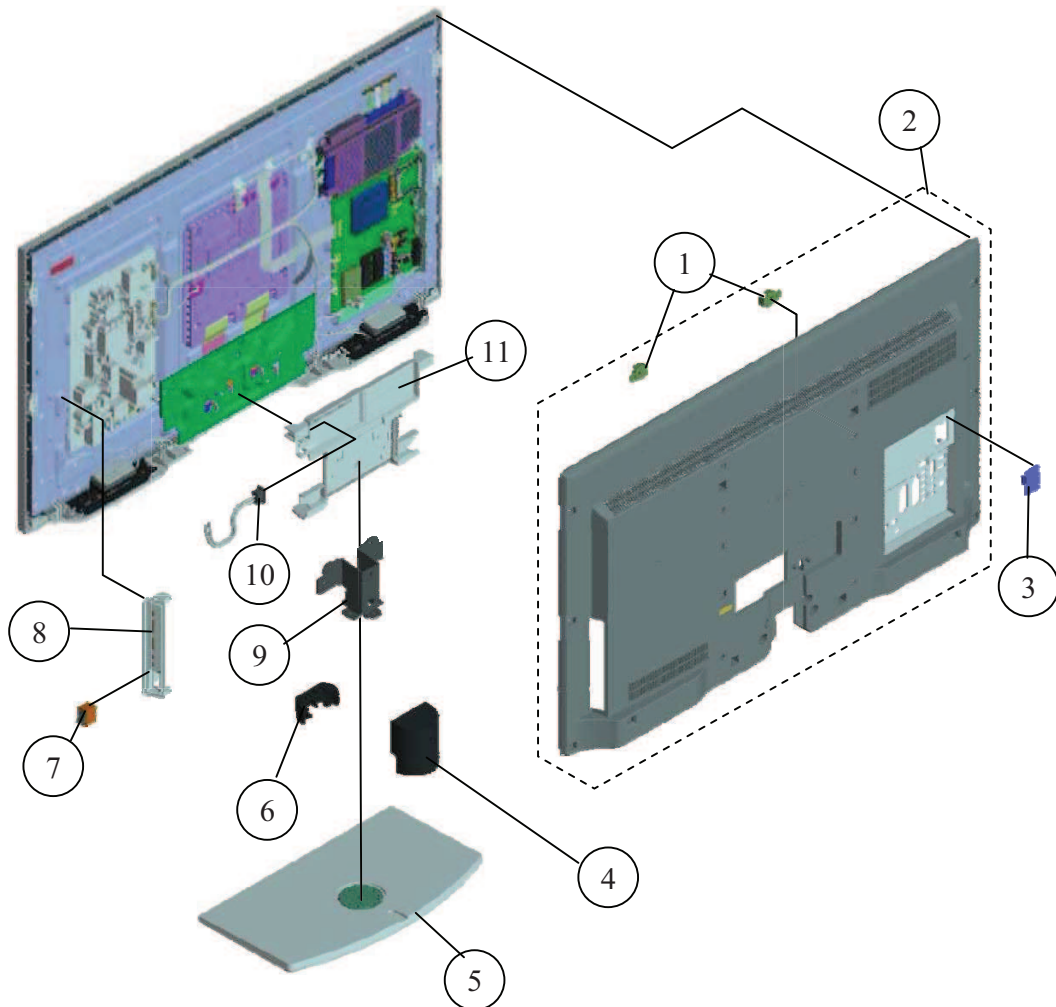

REF. No.	PART No.	DE
1	4-167-326-01	BF
2	X-2548-709-1	RE
	X-2549-271-1	RE
3	4-115-101-41	CO
4	4-170-485-01	CO
	4-189-302-01	CO
5	X-2548-216-1	BA
	X-2546-096-3	BA
6	4-170-477-01	CO
	4-189-301-01	CO
7	1-798-309-11	PC
	1-798-309-21	PC
8	1-487-807-11	SW
9	4-170-450-01	NE
10	⚠ 1-842-031-11	AC
11	4-176-839-01	CO

5-1. KDL-40HX800
5-1-2. CHASSIS-2

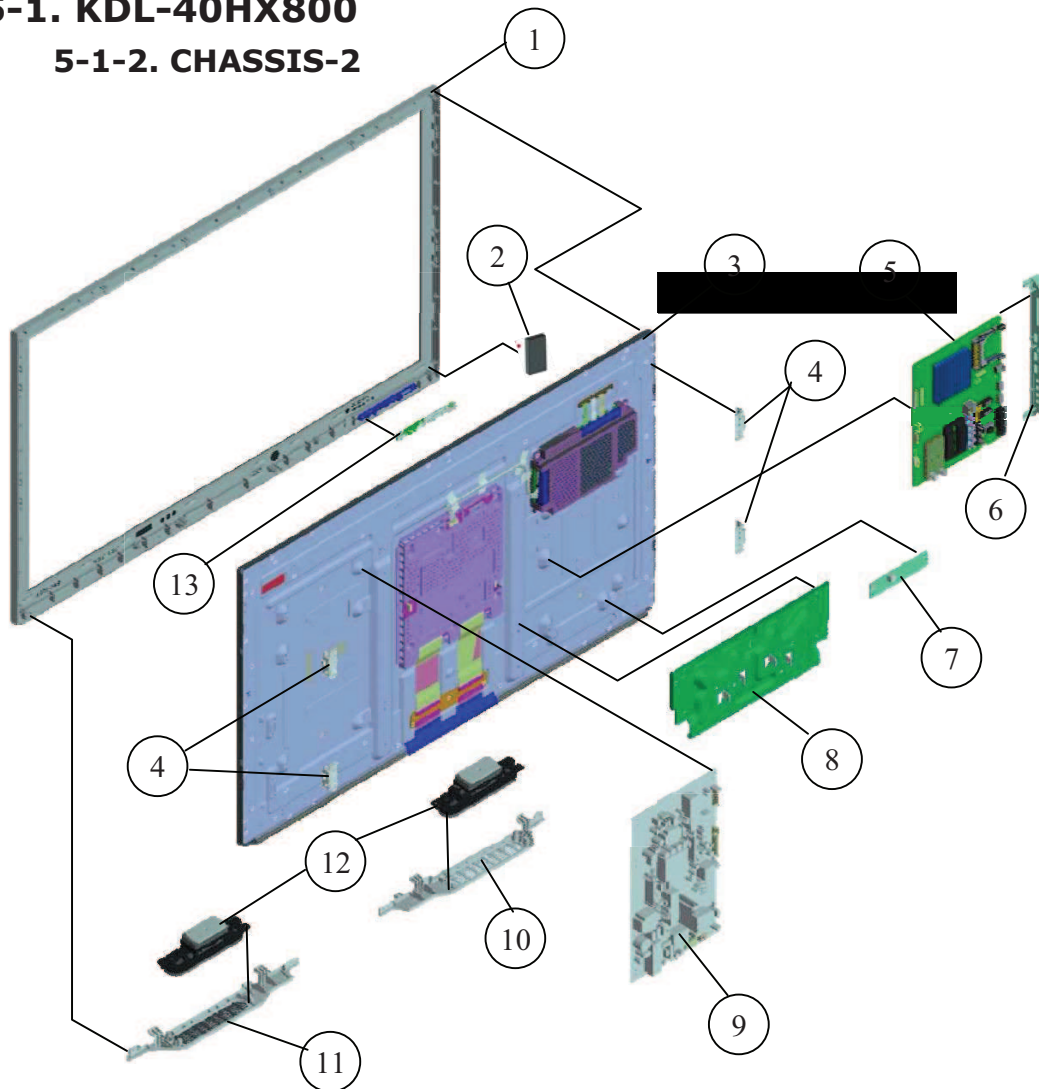

REF. No.	PART No.
1	X-2548-708-1
2	4-182-211-01
3	1-811-127-11
4	UNSTOCKED
5	A-1781-104-A
6	4-156-944-31
7	A-1745-590-A
8	UNSTOCKED
9	1-474-238-11
10	X-2548-471-1
11	X-2548-472-1
12	1-826-873-41
13	A-1772-859-A

5-1. KDL-40HX800

5-1-3. SCREWS

	PART No.	DESCRIPTION
■	2-580-640-01	SCREW, +BVTP 4X16 TYPE2 IT-3
▼	7-685-648-79	SCREW +BVTP 3X12 TYPE2 IT-3
▽	2-580-608-01	SCREW, +PSW M5X16
●	2-580-592-01	SCREW, +PSW M3X8
○	4-159-298-01	SCREW, +PSW M4X10

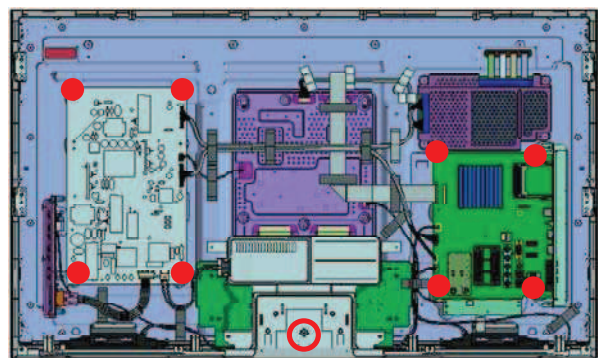
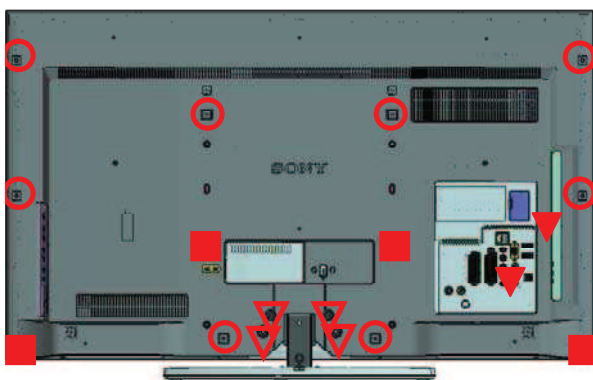

5-2. KDL-46HX800

5-2-1. CHASSIS-1

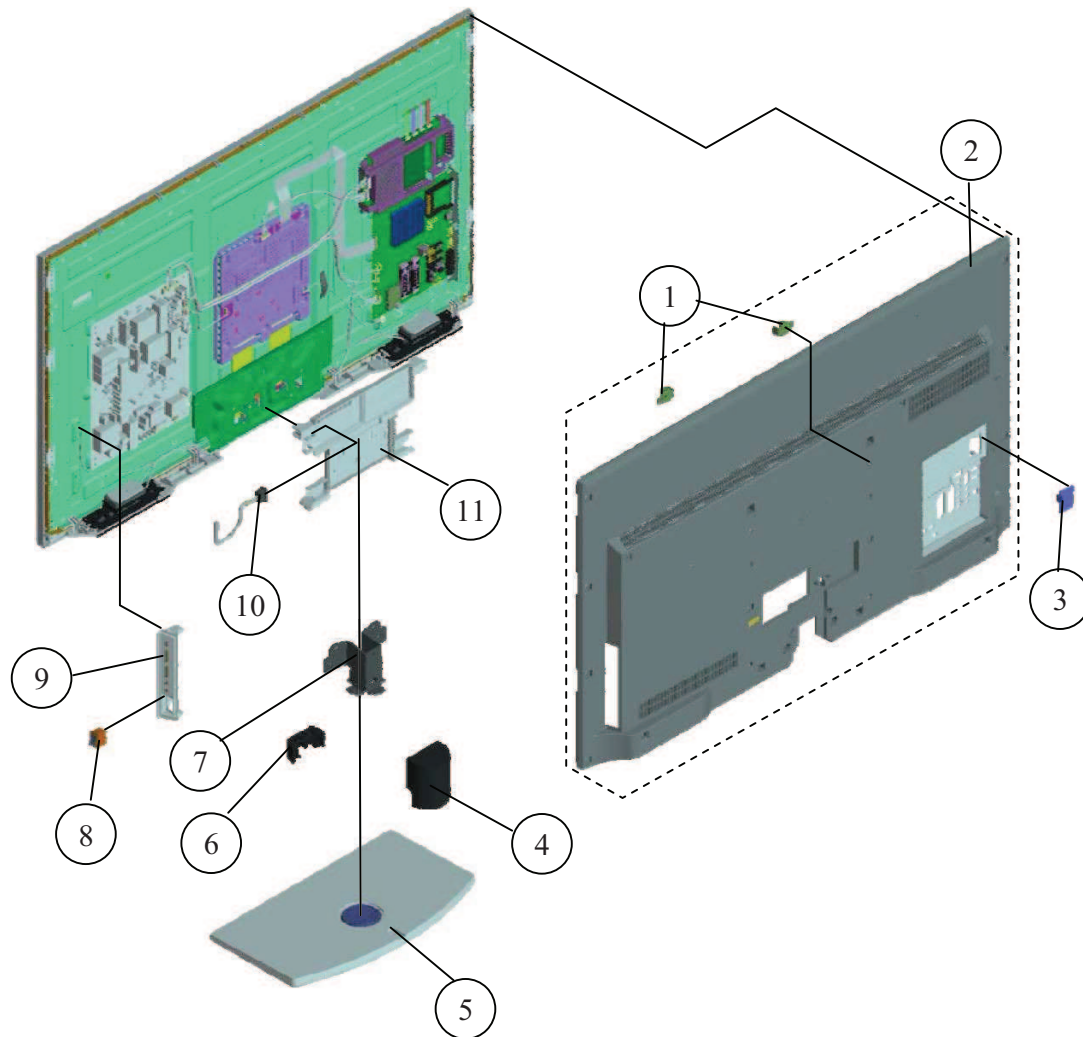

REF. No.	PART No.
1	4-167-326-01
2	X-2548-707-1
3	4-115-101-41
4	4-170-485-01 4-189-302-01
5	X-2547-475-2 X-2548-679-1
6	4-170-477-01 4-189-301-01
7	4-170-450-01
8	1-798-309-11 1-798-309-21
9	1-487-807-11
10	 1-842-031-11
11	4-176-839-01

5-2. KDL-46HX800

5-2-2. CHASSIS-2

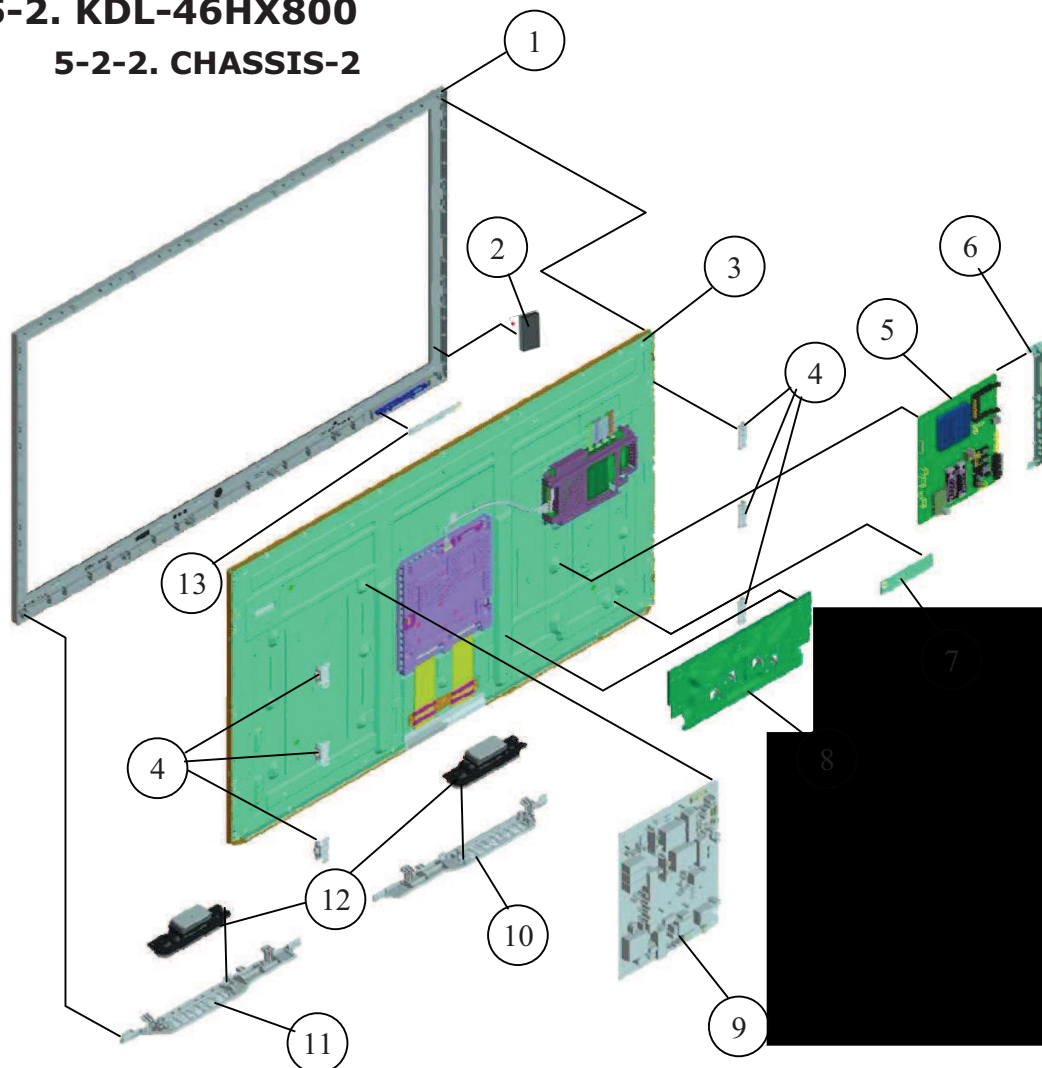

REF. No.	PART No.
1	X-2548-706-2
2	4-182-211-01
3	⚠ 1-811-128-11
4	UNSTOCKED
5	🔒 A-1781-104-A
6	4-156-944-31
7	A-1745-590-A
8	UNSTOCKED
9	⚠ 1-474-240-11
10	X-2548-473-1
11	X-2548-474-1
12	1-826-873-42
13	A-1772-859-A

5-2. KDL-46HX800

5-2-3. SCREWS

	PART No.	DESCRIPTION
■	2-580-640-01	SCREW, +BVTP 4X16 TYPE2 IT-3
▼	7-685-648-79	SCREW +BVTP 3X12 TYPE2 IT-3
▽	2-580-608-01	SCREW, +PSW M5X16
●	2-580-592-01	SCREW, +PSW M3X8
○	4-159-298-01	SCREW, +PSW M4X10

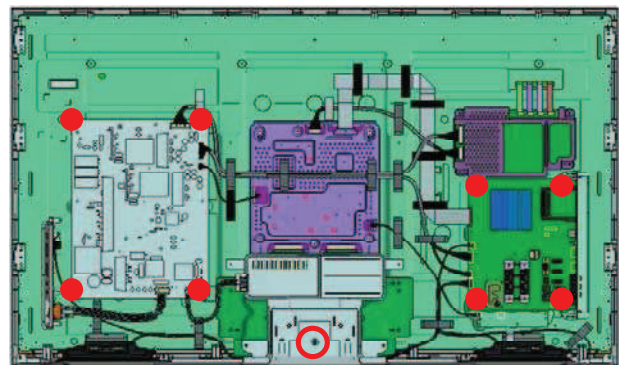
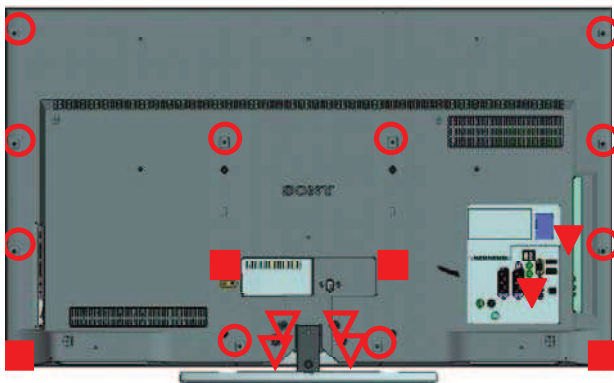

5-3. KDL-55HX800

5-3-1. CHASSIS-1

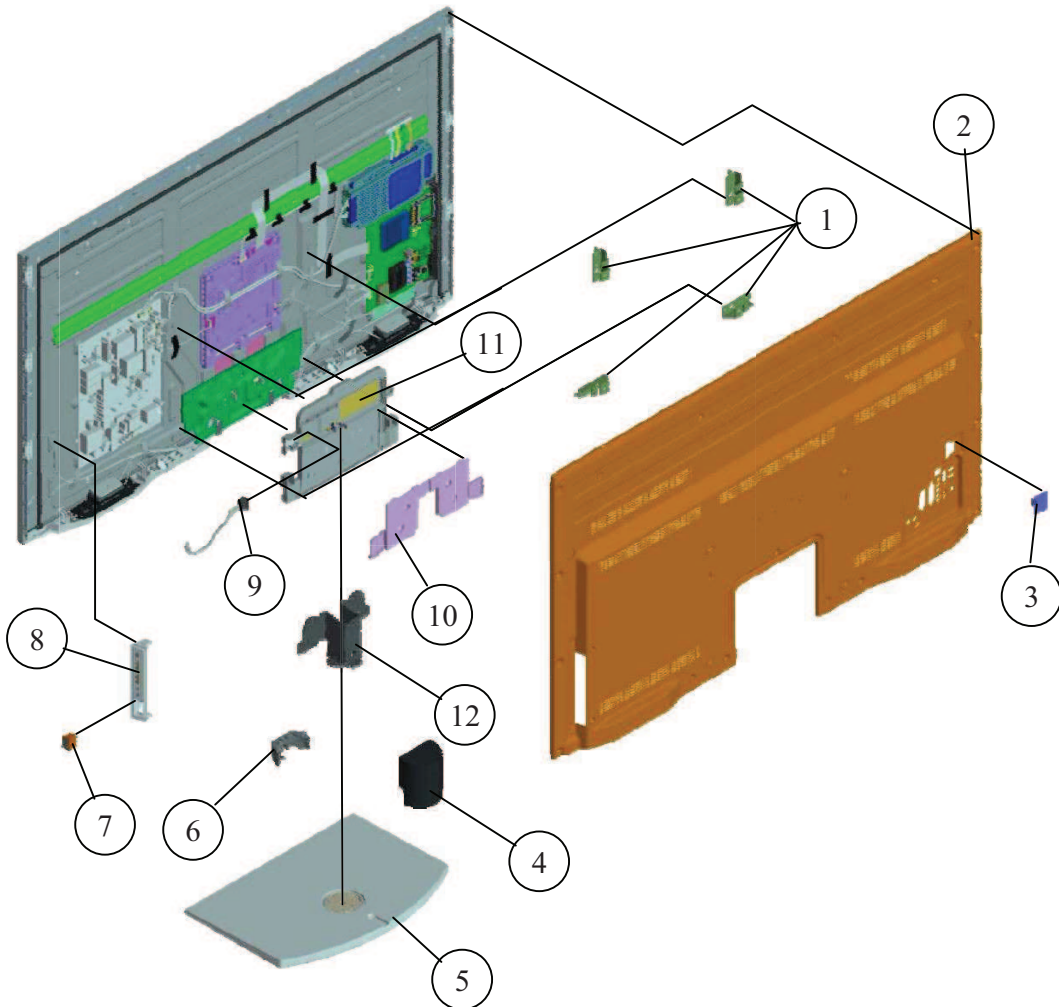



REF. No.	PART No.
1	4-164-305-01
2	X-2547-039-2
3	4-115-101-41
4	4-170-487-01 4-187-665-01
5	X-2546-098-1 X-2547-877-1
6	4-170-479-01 4-187-664-01
7	1-798-309-11 1-798-309-21
8	1-487-807-11
9	⚠ 1-842-031-11
10	4-180-932-01
11	X-2548-510-1
12	4-170-451-01

5-3. KDL-55HX800

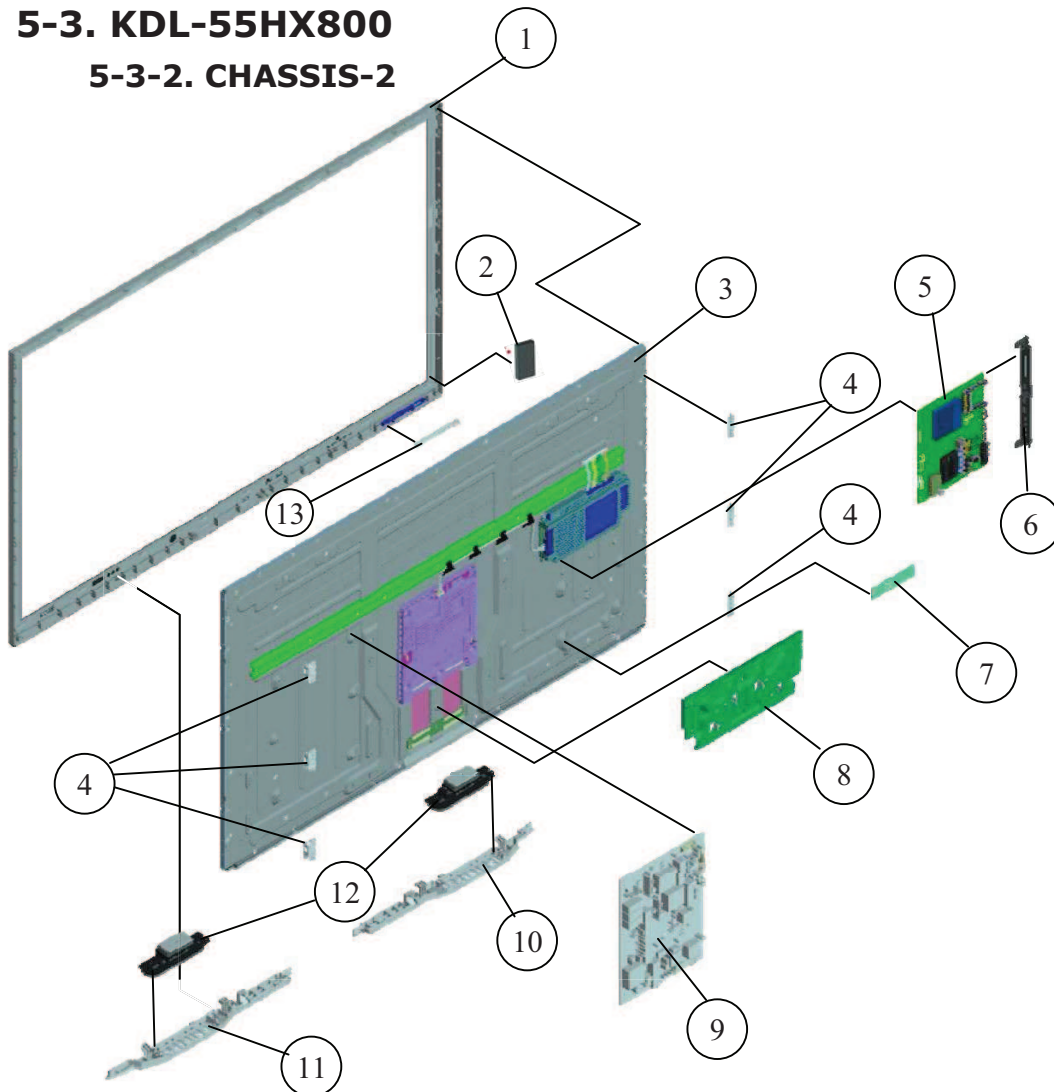
5-3-2. CHASSIS-2



REF. No.	PART No.	
1	X-2548-703-1	E
2	4-182-211-01	C
3	 1-811-129-11	L
4	UNSTOCKED	E
5	 A-1781-104-A	E
6	4-166-898-01	E
7	A-1745-590-A	H
8	UNSTOCKED	F
9	 1-474-240-11	S
10	X-2548-511-1	E
11	X-2548-512-1	E
12	1-826-873-41	L
13	A-1772-859-A	H

5-3. KDL-55HX800

5-3-3. SCREWS

	PART No.	DESCRIPTION
■	2-580-639-01	SCREW, +BVTP 4X12 TYPE2 IT-3
□	2-580-611-01	SCREW, +PSW M6X16
▼	7-685-648-79	SCREW +BVTP 3X12 TYPE2 IT-3
▽	2-580-608-01	SCREW, +PSW M5X16
●	2-580-592-01	SCREW, +PSW M3X8
○	4-159-298-01	SCREW, +PSW M4X10
◎	2-580-591-01	SCREW, +PSW M3X5

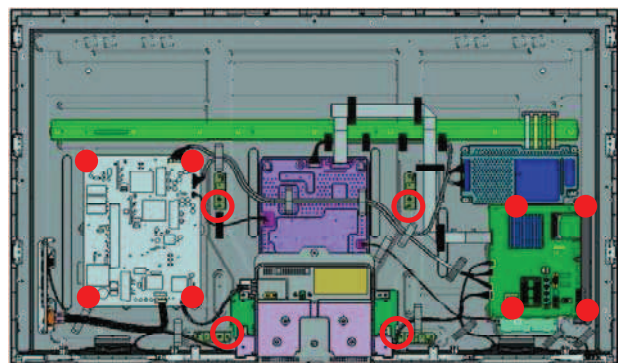
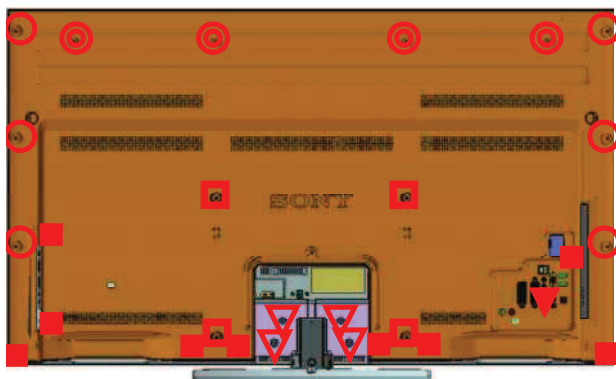

5-4. OTHER PART (KDL-40HX800)



5-4-1. MISCELLANEOUS

<u>PART NO.</u>	<u>DESCRIPTION</u>
	<u>CONNECTOR</u>
* 1-837-663-12	CONNECTOR ASSY(CN6102-ACSW(1))
1-910-101-14	CONNECTOR ASSY 11P(CN6201-CN3800 CN2561(1))
1-910-101-15	CONNECTOR ASSY 14P(CN6401-DRV(1))
1-910-101-16	CONNECTOR ASSY 4P(CN6403-TCON(1))
1-910-101-17	CONNECTOR ASSY 8P(CN5500-TCON(1))
1-838-016-11	FLEXIBLE FLAT CABLE(CN2600-TCON(1))
* 1-910-100-55	HARNESS ASSY (40)(CN2602 CN4300-CN002 SP(1))

OTHERS

4-100-136-01 SHEET (CORE), C

5-4-2. PACKING

* 4-195-037-01	CARTON, INDIVISUAL (DR40)
* 4-183-025-01	CUSHION, LOWER (GUI40)
* 4-183-024-01	CUSHION, UPPER (GUI40)
 1-837-646-12	POWER-SUPPLY CORD (EXCEPT AUSTRALIA)
 1-837-650-12	POWER-SUPPLY CORD SET (AUSTRALIA)
 1-837-642-12	POWER-SUPPLY CORD SET (MIDDLE EAST)

5-4-3. ACCESSORIES

<u>PART NO.</u>	<u>DESCRIPTION</u>
4-187-886-11	MANUAL, IN
4-187-886-21	MANUAL, IN

5-4-4. REMOTE COMMAND

1-487-912-12	REMOTE CO
--------------	-----------

(KDL-46HX800)



5-4-5. MISCELLANEOUS

<u>PART NO.</u>	<u>DESCRIPTION</u>
	<u>CONNECTOR</u>
1-910-101-09	CONNECTOR ASSY 11P (CN6152-CN3800 CN2561(1))
1-910-101-10	CONNECTOR ASSY 14P (CN6753-DRV(1))
1-910-101-11	CONNECTOR ASSY 6P (CN6151-TCON(1))
1-910-101-12	CONNECTOR ASSY 8P (CN5500-TCON(1))
1-838-017-11	FLEXIBLE FLAT CABLE (CN2600-TCON(1))
* 1-910-100-57	HARNESS ASSY (46) (CN2602 CN4300-CN002 SW SP(1))

OTHERS

4-100-136-01	SHEET (CORE), C (/CH/BTN(1) FFC(4) G-T_ CON(1))
--------------	--

5-4-6. PACKING

* 4-182-600-01	CARTON,INDIVIDUAL(46DR)
* 4-183-098-01	CUSHION, LOWER (GUI46)
* 4-183-097-01	CUSHION, UPPER (GUI46)
 1-837-646-12	POWER-SUPPLY CORD (EXCEPT AUSTRALIA)
 1-837-650-12	POWER-SUPPLY CORD SET (AUSTRALIA)
 1-837-642-12	POWER-SUPPLY CORD SET (MIDDLE EAST)

5-4-7. ACCESSORIES

<u>PART NO.</u>	<u>DESC</u>
4-187-886-11	MANU
4-187-886-21	MANU

5-4-8. REMOTE COMMA



1-487-912-12	REM
--------------	-----

(KDL-55HX800)

5-4-9. MISCELLANEOUS

<u>PART NO.</u>	<u>DESCRIPTION</u>
	<u>CONNECTOR</u>
1-838-133-11	CONNECTOR ASSY (CN6003-ACSW(1)) (EA, ME)
1-910-101-04	CONNECTOR ASSY 11P(CN6152-CN3800 CN2561(1)) (ME)
1-910-101-05	CONNECTOR ASSY 14P(CN6753-DRV(1))
1-910-101-06	CONNECTOR ASSY 6P(CN6151-TCON(1))
1-910-101-07	CONNECTOR ASSY 8P(CN5500-TCON(1))
1-838-018-11	FLEXIBLE FLAT CABLE (CN2600-TCON(1))
1-910-101-03	HARNESS ASSY (CN2602 CN4300-CN002 SW SP(1))
	<u>LABEL</u>
* 4-164-923-11	LABEL, REAR TERMINAL
	<u>OTHERS</u>
4-100-136-01	SHEET (CORE), C(/CH/ BTN(1) FFC(4) G-T_CON(1))
4-179-970-02	SHEET, INSULATOR (G6B)
X-2549-247-1	SHEET, INSULATOR ASSY (G6B)
7-685-646-79	SCREW +BVTP 3X8 TYPE2 IT-3

5-4-10. PACKING

<u>PART NO.</u>	<u>DES</u>
* 4-182-599-01	CAR
* 4-183-158-01	CUS
* 4-183-157-01	CUS
4-183-160-01	TRA
 1-837-646-12	POW
 1-837-650-12	POW
 1-837-642-12	POW

5-4-11. ACCESSORI

4-187-886-11	MAN
4-187-886-21	MAN

5-4-12. REMOTE C

1-487-912-12	REM
--------------	-----

END

9-888-329-01

KDL-40/46/55HX800(AUSTRALIA, GA-ANALOG)

Sony Corporation
Sony EMCS (Malaysia) Sdn. Bhd.
TVEG