

# EXPLODED VIEW

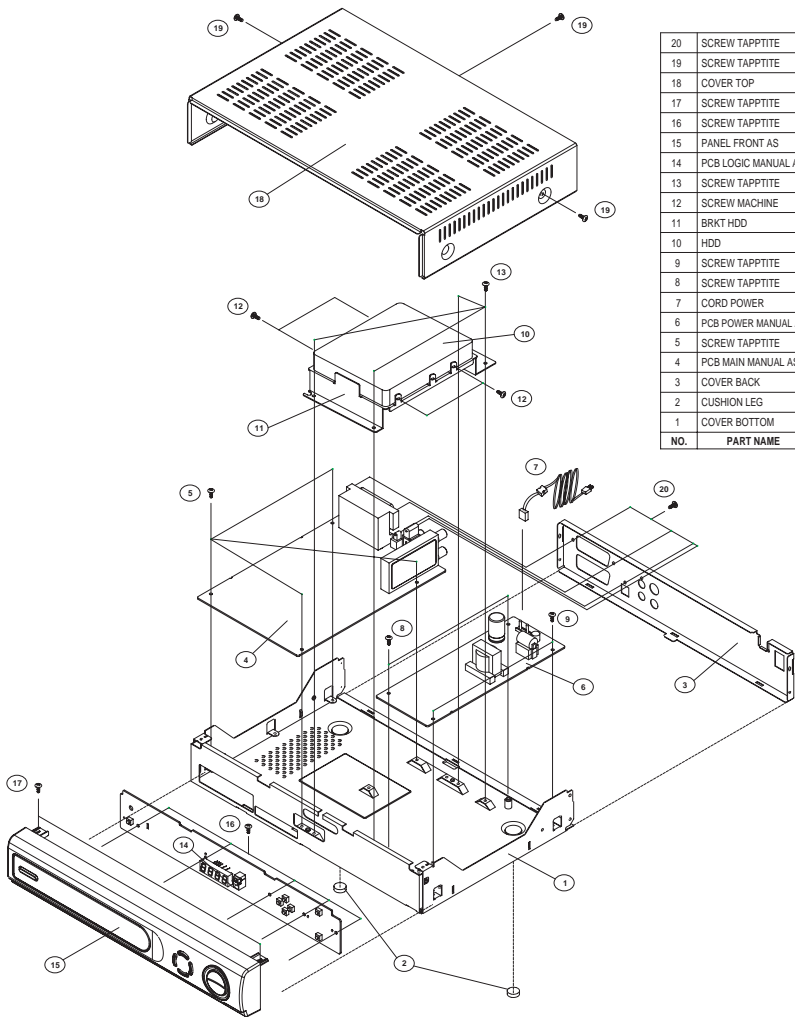

20	SCREW TAPPTITE	7173300812	4	TT2 BIN 3X8 MFZN BK	JACK FIX
19	SCREW TAPPTITE	7173300812	3	TT2 BIN 3X8 MFZN BK	COVER TOP FIX
18	COVER TOP	4952101600	1	SECC T0.6+PCM	
17	SCREW TAPPTITE	7174300811	2	TT2 RND 3X8 MFZN	PANEL FRONT FIX
16	SCREW TAPPTITE	7174301011	5	TT2 RND 3X10 MFZN	PCB LOGIC FIX
15	PANEL FRONT AS	97PP345000	1	DSD-9256M	
14	PCB LOGIC MANUAL AS		1		
13	SCREW TAPPTITE	7174300811	4	TT2 RND 3X8 MFZN	BRKT+BOTTOM FIX
12	SCREW MACHINE	7043350611	4	BIN M3.5*6	HDD+BRKT FIX
11	BRKT HDD	97P2448300	1	SECC T1.0	
10	HDD	97P5100100	1	SGT 89G 5400RPMST3800(12ACE)	
9	SCREW TAPPTITE	7274300811	2	TT2 RND 3X8 MFZN	PCB POWER RIGHT FIX
8	SCREW TAPPTITE	7278300611	2	TT3 WAS 3X8 MFZN	PCB POWER LEFT FIX
7	CORD POWER	97P69PB90B	1	U.K KKP-660 YFH800 2.1M	
6	PCB POWER MANUAL AS		1		
5	SCREW TAPPTITE	7174300811	4	TT2 RND 3X8 MFZN	PCB MAIN FIX
4	PCB MAIN MANUAL AS		1		
3	COVER BACK	97P0485200	1	SECC T0.6	
2	CUSHION LEG	97P4220200	2	EVA T4.0	
1	COVER BOTTOM	97P0485100	1	SECC T=0.8	
NO.	PART NAME	PART NO.	QTY	MATERIAL	REMARK