

**PARTS LIST**  
**LISTE PIECES DETACHEES**  
**ERSATZTEILLISTE**  
**LISTA PARTI DI RICAMBIO**  
**LISTA DE PIEZAS DE REPUESTO**

**THOMSON**  
**DPL943W**  
**Chassis ASMP105043**

### MODULES

<b>MAIN</b>	<b>MAIN</b>	<b>55972840</b>
<b>KDB</b>	<b>DISPLAY/CONTROL</b>	<b>55972780</b>
<b>SMPS</b>	<b>SMPS</b>	<b>55972750</b>



<b>IC001</b>	PJ1117CW-ADJ FLAT	55906980
<b>IC101 (MAIN)</b>	BU4052BF FLAT	20718780
<b>IC101 (KDB)</b>	HT48C05-001P FLAT	56024970
<b>IC102 (KDB)</b>	PT6315 FLAT	55298040
<b>IC102,801</b>	BA4558F FLAT	20976940
<b>IC103,701</b>	KIA7029 FLAT	15260970
<b>IC301</b>	CS5340-CZZ FLAT	55966360
<b>IC401</b>	BA5954FP FLAT	10682770
<b>IC402</b>	BA6289F FLAT $\Delta$	55930020
<b>IC403</b>	M24C02WMIN6 FLAT	35096320
<b>IC404</b>	ES6603SF FLAT	55884390
<b>IC405</b>	TL3472CDR FLAT	55884380
<b>IC502</b>	ES6698FDF FLAT	55977770
<b>IC504</b>	V6309MSP3B FLAT	55884160
<b>IC505</b>	K4S641632H-UC75T00 FLAT	55960330
<b>IC601,602,603</b>	74VHC574TTR FLAT	55300130
<b>IC604</b>	74LS138 FLAT	10511600
<b>IC702</b>	STA308A FLAT	55891160
<b>IC901,902,903,904</b>	E-STA51513TR FLAT	55977780
<b>RM101</b>	HRM557BC5109	56019990
<b>U1</b>	VIPER53	35911570
<b>U2</b>	L6565N	35911580



<b>PC1,2,3,4</b>	LTV817B	20406340
<b>Q1</b>	2N5551	20534520
<b>Q2</b>	SPP11N80C3	35911610
<b>Q3,5,6,8</b>	PN2222A	35741490
<b>Q4</b>	KTC3205Y/KTC2236Y	10449020
<b>Q101,102,201,202,209,210,211,212,213,214,219,704,706,710,711,712,713</b>	DTC323TK SMD	35095360

<b>Q203,204,205,206,207,208</b>	2SC2412KQLT1G	55812680
<b>Q215,218,220,701,901,902,903,904</b>	DTC114YKA SMD	35095340
<b>Q216,905,906,907,908</b>	DTA114YKA SMD	35095350
<b>Q217</b>	KTC2874	55157120
<b>Q221,703,707</b>	KTC3198GR	20508070
<b>Q401,404</b>	2SB1132	55201820
<b>Q402,403</b>	DTC114TUA SMD	55100110
<b>Q405,406</b>	2SK2731 SMD	55884270
<b>Q702</b>	KTC3203Y/KTC2120Y	20538220
<b>Q705</b>	KTC2804Y	55095800



<b>D001</b>	1N5391	35057360
<b>D1,2</b>	1N4007	16008210
<b>D7,8</b>	1N4148	44009209
<b>D9</b>	FUF5404	20150190
<b>D10</b>	SB5100	35911620
<b>D11</b>	SR306	35699390
<b>D12,14,15,16,3,4,5,6</b>	UF4007	35741540
<b>D13</b>	1N5819	15042270
<b>D19</b>	1N5229B 4V3	20526760
<b>D101,102</b>	BZX55C7V5	80444150
<b>D101</b>	BAT54S	35132120
<b>D102,103,104,105,106,107,201,202,203,204,205,402,404,405,701,702</b>	LL4148 SMD	16012450
<b>D108</b>	CT-3SGTA LED	55199400
<b>D109</b>	LTL-1CHE3 LED	35095420
<b>D703</b>	1N5230B 4.7V	20289370
<b>D704</b>	1N5221B 2V4	20845050
<b>D705</b>	1N4002	11070780
<b>ZD1</b>	1N5240B 10V	20725840
<b>ZD2,3</b>	1N5231B 5.1V	35033870
<b>ZD4</b>	P6KE180A	20726700



<b>X101</b>	8MHZ	55849210
<b>Y001</b>	27MHZ	55439460



<b>R700</b>	PTC 100R OHM 16V	$\Delta$ 55830280
-------------	------------------	-------------------

For any requests, please contact THOMSON multimedia after sales service area  
 Pour toutes précisions, contactez votre service après vente local THOMSON multimedia  
 Für weitere Auskünfte, wenden Sie sich bitte an die THOMSON multimedia Kundendienst  
 Per precisazioni, contattate l'assistenza tecnica THOMSON multimedia  
 Para cualquier pregunta, por favor contactar con el responsable de zona del servicio postventa de THOMSON multimedia

**VERSION 1 04 / 2005 35914540**  
**VERSION 2 00 / 0000**

**OTHER PARTS  
AUTRES PIECES  
SONSTIGE TEILE  
ALTRE PARTI  
OTRAS PIEZAS**

	RDH4010S 12V 1.08W FAN $\Delta$ 55993270 RDH4010S 12V 1.08W VENTILATEUR RDH4010S 12V 1.08W VENTILATOR RDH4010S 12V 1.08W VENTOLA RDH4010S 12V 1.08W VENTILADOR	
	KST-ML104FA1-63 TUNER 55984450 KST-ML104FA1-63 TETE KST-ML104FA1-63 TUNER KST-ML104FA1-63 SINTONIZZATORE KST-ML104FA1-63 SINTONIZADOR	
CP403	CABLE FLAT 24 PINS 170MM 55960530 CABLE NAPPE 24 VOIES 170MM 0.5MM KABEL FLACH 24 PINS 170MM 0.5MM CAVO FALDA 24 SPINOTTI 170MM 0.5MM CABLE 24 PUNTOS 170MM 0.5MM	
CP602	CABLE FLAT 12 PINS 160MM 55989700 CABLE NAPPE 12 VOIES 1.25MM 160MM KABEL FLACH 12 PINS 1.25MM 160MM CAVO FALDA 12 SPINOTTI 1.25MM 160MM CABLE 12 PUNTOS 1.25MM 160MM	
F001	3A15T 250V TIME-LAG FUSE 10119590 3A15T 250V FUSIBLE TEMPORISE 3A15T 250V SICHERUNG 3A15T 250V FUSIBILE TEMPORIZZATO 3A15T 250V FUSIBLE TEMPORIZADO	
JK101	CINCH SOCKET X4 56027120 PRISE CINCH X4 CHINCH-BUCHSE X4 PRESA CINCH X4 TOMA CINCH X4	
JK201	CINCH SOCKET X3 55149420 PRISE CINCH X3 CHINCH-BUCHSE X3 PRESA CINCH X3 TOMA CINCH X3	
JK202	CINCH/DIN SOCKET 55149520 PRISE CINCH/DIN CHINCH/DIN-BUCHSE PRESA CINCH/DIN TOMA CINCH/DIN	
JK203	SCART SOCKET 55176340 PRISE PERITEL EURO-AV-BUCHSE EUROPRESA NORMALIZZATA EUROCONNECTOR	
JK801	RJ45 SOCKET 55978490 PRISE RJ45 RJ45-BUCHSE PRESA RJ45 TOMA RJ45	
JK901	LOUDSPEAKER SOCKET 5599036A PRISE HAUT PARLEUR LAUTSPRECHERBUCHSE PRESA ALTOPARLANTE TOMA ALTAVOZ	
SW101,102, 103,104,105, 106,107,108, 109,110	MICROSWITCH 56024260 MICROCONTACTEUR MIKROSCHALTER MICROINTERRUPTORE MICROCONTACTOR	
VFD101	DISPLAY VFD 55995210 AFFICHEUR VFD VFD-ANZEIGE VISUALIZZATORE VFD VISUALIZADOR VFD	

**EQUIPMENT/PRESENTATION  
EQUIPEMENT/PRESENTATION  
AUSSTATTUNG/GEHAEUSE  
PARTI VARIE  
EQUIPO/PRESENTACION**

	RCT311AC1 REMOTE CONTROL 21361180 RCT311AC1 TELECOMMANDE RCT311AC1 FERNBEDIENUNG RCT311AC1 TELECOMANDO RCT311AC1 TELEMANDO	
	DPL943W LOUDSPEAKER BOX ASSY X6 55989570 DPL943W ENCEINTES ACOUSTIQUES X6 DPL943W LAUTSPRECHERBOX K.P.L X6 DPL943W CASSA ACUSTICA COMPLETO X6 DPL943W CAJA ACUSTICA EQUIPADO X6	
	MAIN LOUDSPEAKER BOX RIGHT OR LEFT 35914640 ENCEINTE ACOUS.PRINCIP. DROITE OU GAUCHE MAIN LAUTSPRECHERBOX RECHTS ODER LINKS CASSA ACUSTIC.PRINCIP. DESTRA O SINISTRA CAJA ACUSTIC.PRINCIP.DERECHA O IZQUIERDA	
	SURROUND LOUDSPEAKER BOX RIGHT OR LEFT 35914650 ENCEINTE ACOUS SURROUND DROITE OU GAUCHE SURROUND LAUTSPRECHERBOX RECH. OD. LINKS CASSA ACUSTICA SURR. DESTRA O SINISTRA CAJA ACUSTICA SURR. DERECHA O IZQUIEDA	
	CENTRAL LOUDSPEAKER BOX 35914630 ENCEINTE ACOUSTIQUE CENTRALE CENTRAL LAUTSPRECHERBOX CASSA ACUSTICA PRINCIPALE CENTRALE CAJA ACUSTICA PRINCIPAL CENTRAL	
	LOUDSPEAKER BOX SUBWOOFER ASSY 35914660 ENCEINTE ACOUSTIQUE SUBWOOFER COMPLETE LAUTSPRECHERBOX SUBWOOFER K.P.L CASSA ACUSTICA SUBWOOFER COMPLETA CAJA ACUSTICA SUBWOOFER EQUIPADA	
	WIRELESS UNIT RECEIVER ASSY 35915080 RECEPTEUR SIGNAL SANA FIL CPL SCHNURLOSER SIGNALEMPFÄNGER K.P.L RICEVITORE SENZA FILI DEL SEGNALE CPL RECEPTOR DE SENAL SIN CABLES CPL	
	FITTING RIGHT 56017010 CALE DROITE POLSTER RECHTS Distanziatore DESTRO CALZO DERECHO	
	FITTING LEFT 56017000 CALE GAUCHE POLSTER LINKS Distanziatore SINISTRO CALZO IZQUIERDO	
	FOLDING BOX(DPL943W) 55999110 EMBALLAGE CARTON(DPL943W) KARTON(DPL943W) IMBALLAGGIO CARTONE(DPL943W) EMBALAJE CARTON(DPL943W)	
	POWER SUPPLY LEAD $\Delta$ 55190790 CORDON D'ALIMENTATION NETZKABEL CAVO DI ALIMENTAZIONE CABLE DE ALIMENTACION	
	FM ANTENNA 55127460 ANTENNE FM FM ANTENNE ANTENNA FM ANTENA FM	
	CONNECTION LEAD 1+1 CINCH 35093990 CORDON DE LIAISON 1+1 CINCH ANSCHLUSSKABEL 1+1 CINCH CAVO DI ALLACCIAMENTO 1+1 CINCH CAVO DI ALLACCIAMENTO 1+1 CINCH	
	SCART CABLE 20418260 CORDON PERITEL EURO-AV-KABEL CAVO SCART CABLE EUROCONNECTOR	

**MECHANISM  
MECANIQUE  
MECHANIK  
MECCANICA  
MECANISMO**

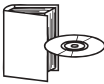
	DM3421 OPTICAL PLAYER + CD MECHANISM 55994630 DM3421 LECTEUR OPTIQUE + MECANISME CD DM3421 CD-LAUFWERK/DVD SPIELER KPL DM3421 ASSIEME OTTICA + CD MECCANICA DM3421 MECANISMO OPTICO + CD MECANISMO	
		
	DPL943W UM TH 56020180 DPL943W NU TH DPL943W BA TH DPL943W IU TH DPL943W IU TH	
	DPL943W PARTS LIST 35914540 DPL943W LISTE DE PIECES DETACHEES DPL943W ERSATZTEILLISTE DPL943W LISTA PARTI DI RICAMBIO DPL943W LISTA DE PIEZAS DE REPUESTO	
	ASMP1050 TH SERVICE MANUAL 35911450 ASMP1050 TH DOCUMENTATION TECHNIQUE ASMP1050 TH TECHNISCHE DOKUMENTATION ASMP1050 TH DOCUMENTAZIONE TECNICA ASMP1050 TH DOCUMENTACION TECNICA	

**CHASSIS AND PRESENTATION  
CHASSIS ET PRESENTATION  
CHASSIS UND GEHAEUSETEILE  
TELAIO E DI PRESENTAZIONE  
CHASIS Y PRESENTACION**

010	FRONT PANEL FACADE FRONTPLATTE PANNELLO FRONTALE PANEL FRONTAL	56027690
020	DVD DOOR VOLET DVD DVD KLAPPE SPORTELLO DVD TAPA DVD	55983360
030	VOLUME KNOB BOUTON VOLUME LAUTSTAERKEKNOPF TASTO DI VOLUME TECLA MANDO VOLUMEN	55983490
040	BUTTON STRIP SOURCE/SUBWOOFER BARRETTE TOUCHES SOURCE/SUBWOOFER TASTENLEISTE SOURCE/SUBWOOFER PIATTINA TASTI SOURCE/SUBWOOFER PLACA DE TECLAS SOURCE/SUBWOOFER	55983500
050	OPEN KNOB TOUCHE EJECT OPEN TASTE TASTO OPEN TECLA OPEN	55983510
060	PLAY/PAUSE BUTTON TOUCHE LECTURE/PAUSE TASTENKNOPF PLAY/PAUSE TASTO LETTURA/PAUSE TECLA LECTURA/PAUSE	55983520
070	STOP "OR" REW "OR" FF BUTTON TOUCHE STOP "OU" REW "OU" FF TASTENKNOPF STOP "ODER" REW "ODER" FF TASTO STOP "O" REW "O" FF TECLA STOP "O" REW "O" FF	55983530
080	ON/OFF BUTTON TOUCHE MARCHE/ARRET EIN-AUS TASTE TASTO ACCESO/SPENTO TECLA MARCHA/PARADA	55986100
090	SIDE PANEL LEFT PANNEAU LATERAL GAUCHE SEITENTEIL LINKS PANNELLO LATERALE SINISTRO PANEL LATERAL IZQUIERDO	56010840
100	SIDE PANEL RIGHT PANNEAU LATERAL DROIT SEITENTEIL RECHTS PANNELLO LATERALE DESTRO PANEL LATERAL DERECHO	56010850
120	HOLDER BUTTONS SUPPORT DE TOUCHES HALTER KUNSTSTOFF SUPPORTO TASTI SOPORTE TECLAS	55983740
160	DISPLAY WINDOW GLACE AFFICHEUR ANZEIGEFENSTER VETRO DEL VISUALIZZATORE CRISTAL DEL VISUALIZADOR	55983840

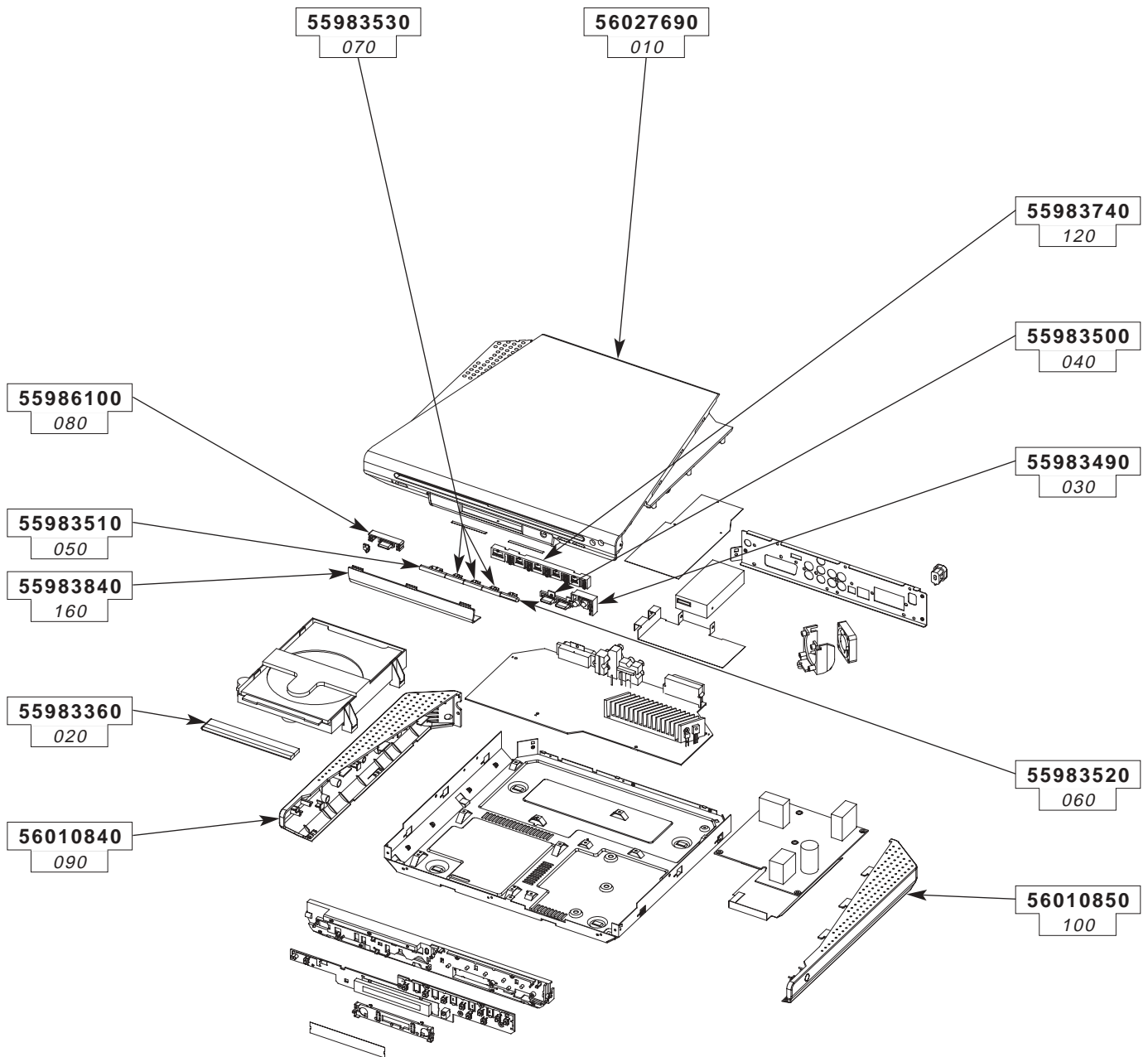

## CHASSIS AND PRESENTATION / CHASSIS ET PRESENTATION / CHASSIS UND GEHAEUSETEILE / TELAIO E DI PRESENTAZIONE / CHASIS Y PRESENTACION

DPL943W

4/4

The description and characteristics given here are of informative significance only, and non committal. To keep up the high quality of our products, we reserve the right to make any changes or improvement without previous notice. • Les descriptions et caractéristiques figurant sur ce document sont données à titre d'information et non d'engagement. En effet, soucieux de la qualité de nos produits, nous nous réservons le droit d'effectuer, sans préavis, toute modification ou amélioration. • Die Beschreibungen und Daten in dieser Anleitung dienen nur zur Information und sind nicht bindend. Um die Qualität unserer Produkte ständig zu verbessern, behalten wir uns das Recht auf Änderungen vor. • Le descrizioni e le caratteristiche date su questo documento sono fornite a semplice titolo informativo e senza impegno. Ci riserviamo il diritto di eseguire, senza preavviso, qualsiasi modifica o miglioramento. • Las descripciones y características que figuran en este documento se dan a título de información y no de compromiso. En efecto, en bien de la calidad de nuestros productos, nos reservamos el derecho de efectuar, sin previo aviso, cualquier modificación o mejora.