

1. Exploded View & Part List

Exploded View

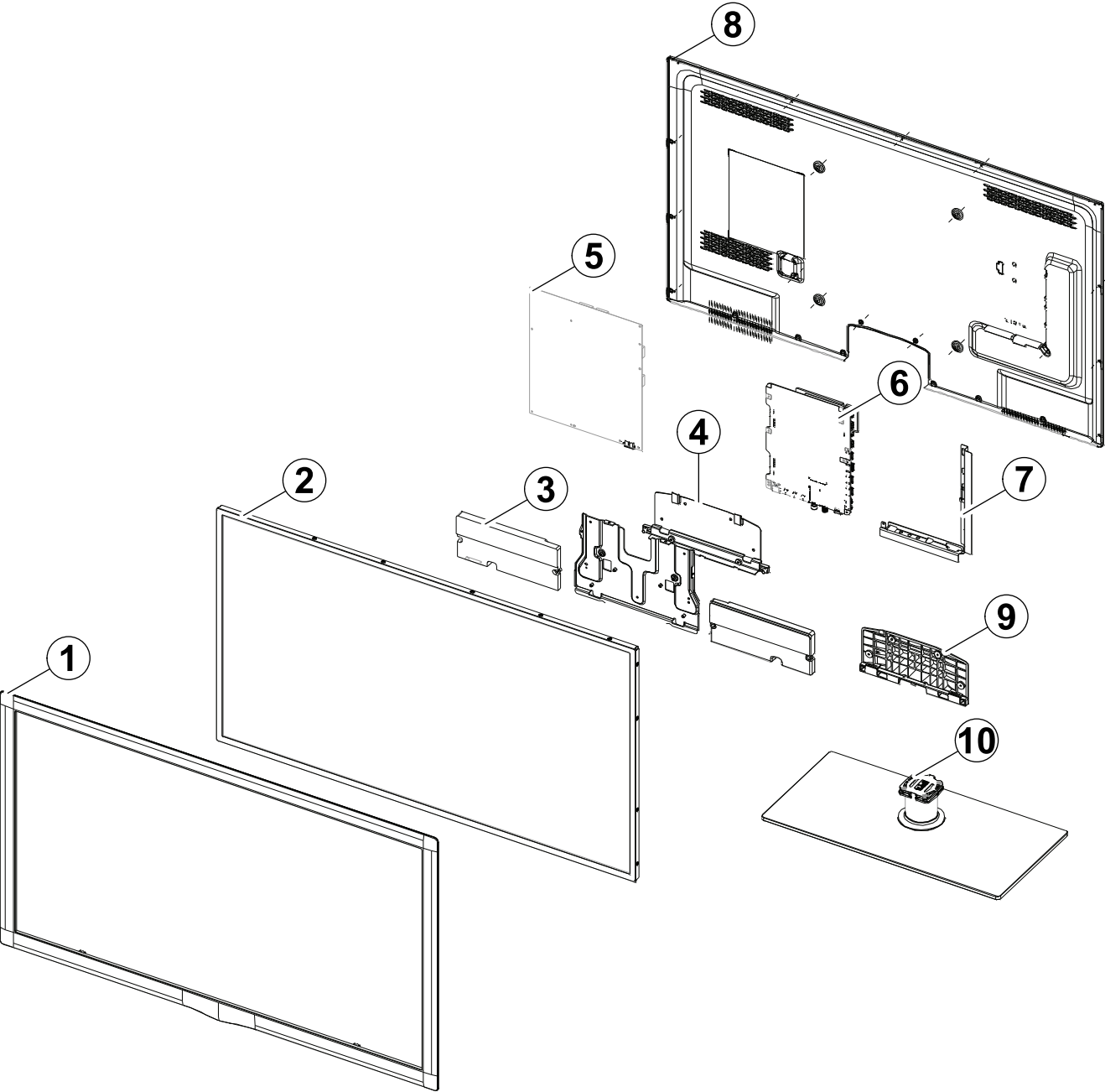

Parts List

No.	Parent	Lvl.	Loc.	Material Code	Description & Specification	SNA	Qty.
1	BN90-03122H	2	F001A	BN96-16838H	ASSY COVER P-FRONT; UD6120,55,EO,PC+PC,V2	SA	1
2	BN91-07354A	2	PANEL	BN95-00466A	PRODUCT LCD; 6K 55 3D_LTJ550HW03-V	SA	1
3	BN91-06862A	2	SP01A	BN96-18088A	ASSY SPEAKER P; 6ohm,4pin,15W,Enclosure t	SA	1
4	BN91-06862A	2	RB01	BN63-07807C	COVER-BOTTOM; UD5000 37,NH HIPS,V1,BK0020	SNA	1
5	BN91-07354A	2	P001A	BN44-00457A	DC VSS-LED TV PD BD; PD55A1D_BHS,PD55A1D_	SA	1
6	BN91-06866K	2	M0014	BN94-04627P	ASSY PCB MAIN; UE55D6300SSXXN	SA	1
7	BN94-04627P	3	CB01	BN61-07083H	BRACKET-AV; UD6400,PCM,T0.45,BKN-P824,EUR	SNA	1
8	BN90-03127J	2	R001A	BN96-16843J	ASSY COVER P-REAR; UD6000,55,EO(SATELLITE)	SA	1
9	BN90-03131E	2	SG03A	BN96-16722A	ASSY STAND P-GUIDE; UD5000-6000,W/W,PC,G/	SA	1
10	BN90-03131E	2	SB04A	BN96-16847A	ASSY STAND P-BASE; UD6000,55,TEMPERED GLA	SA	1

2. Electrical Parts List

Level	Loc.	Part Code	Description & Specification	Qty.	SA/SNA
			UE55D6320SSXXN (H301)		
1		BN90-03122H	ASSY COVER FRONT;UD6120,55,EO	1	SNA
.2	F001A	BN96-16838H	ASSY COVER P-FRONT;UD6120,55,EO,PC+PC,V2	1	SA
..3	XT01	0201-001578	ADHESIVE-HM;HM-555,WHT,4,000 Cps	0	SNA
..3	T0069	BN60-00051A	SPACER-FELT;FELT,20.0,0.5,12.0	4	SNA
..3		BN60-00162C	SPACER-FOAM;FOAM,50000mm,Dark Gray,0.5T,	0	SNA
..3		BN60-00162W	SPACER-FOAM;FOAM,30000mm,Dark Gray,1T,10	4	SNA
..3	CB11P	BN61-07248A	BRACKET-SUPPORT PCB;LD550,SK-5,T0.5,Plat	1	SA
..3	CCM1	BN63-05199B	COVER-SHEET;AMBER,PE,T0.08,W65mm,200M,CL	1	SNA
..3	CCM1	BN63-05199C	COVER-SHEET;AMBER,PE,T0.08,W55mm,200M,CL	3	SNA
..3	F001	BN63-07866H	COVER-FRONT;UD6120,55,EO,PC+PC,V2,TP0010	1	SNA
...4		0103-007268	RESIN-PC;TP0010,2.0V0,NH PC,NH PC 2.0 V2	610	SNA
...4		0103-007269	RESIN-PC;GY0132,2.0V0,NH PC,NH PC 2.0 V2	412	SNA
..3		BN68-03542D	LABEL-01,TV POP;5500,PET,T0.1,100,100,BI	1	SNA
..3		BN74-00052A	TAPE-PAPER;LB530,Crepe Paper,0.17mm, 10m	0	SNA
..3	FB21A	BN96-16729T	ASSY BOARD P-TOUCH FUNCTION & IR;UN55D6000	1	SA
1	R001A	BN90-03127J	ASSY COVER REAR;UD6000,55,EO(SATELLITE)	1	SNA
.2		6001-002671	SCREW-MACHINE;BH,+,M3,L6,ZPC(BLK),SWRCH1	5	SA
.2	R001A	BN96-16843J	ASSY COVER P-REAR;UD6000,55,EO(SATELLITE)	1	SA
..3		BN60-00162Y	SPACER-FOAM;FOAM,50000mm,Dark Gray,0.35T	1	SNA
..3	R001	BN63-07752B	COVER-REAR;UD6100 55,PCM,T0.45,BKN-P824	1	SNA
..3		BN63-08088A	SHEET-INSULATOR;UD6050 55,PC SHEET,T0.43	1	SNA
..3		BN68-00513E	LABEL-AMS;ams,-,art paper,-,10,38,-,whit	1	SNA
..3		BN68-03297Q	LABEL-TERMINAL BOTTOM;UD6200~6700,Europe	1	SNA
..3		BN68-03298N	LABEL-TERMINAL SIDE;UD6000~6100,Europe,D	1	SNA
..3		BN68-03518A	LABEL-STICKER;WW,ALL,60.5,68.8,LABEL-CI	1	SNA
..3	T0067	BP60-00067E	SPACER-SCREEN;L6,50,10,BLK,T4.0,DLP	4	SNA
1	S001A	BN90-03131E	ASSY STAND;UD6000,55,BLACK,W/W	1	SNA
.2	SG03A	BN96-16722A	ASSY STAND P-GUIDE;UD5000-6000,W/W,PC,G/	1	SA
..3	T0524	6902-001063	BAG PE;LDPE,T0.05,W180,L350,TRP,RECYCLE	1	SNA
..3	SG03	BN61-07057A	GUIDE-STAND;UD5000 37,PC+G/F 20%,V2,BK00	1	SNA
..3		BN68-03388C	MANUAL FLYER-03,STAND GUIDE;U5000(32~55)	1	SNA
..3		BN96-18013E	ASSY ACCESSORY-SCREW;6003-001782,4EA,ALL	1	SNA
...4	SCREW	6003-001782	SCREW-TAPTYPE;BH,+,B,M4,L12,ZPC(BLK),SWR	4	SA
...4		BN69-05418B	PACKING-BAG SCREW;BN96-18013E,-,GREEN,T0	1	SNA
..3		BN96-18013F	ASSY ACCESSORY-SCREW;6001-002621,4EA,ALL	1	SNA
...4		6001-002621	SCREW-MACHINE;BH,+,M4,L8,ZPC(BLK),SWRCH1	4	SA
...4		BN69-05418C	PACKING-BAG SCREW;BN96-18013F,-,RED,T0,0	1	SNA

Exploded Views and Parts List

Level	Loc.	Part Code	Description & Specification	Qty.	SA/SNA
.2	SB04A	BN96-16847A	ASSY STAND P-BASE;UD6000,55,TEMPERED GLA	1	SA
...3	SCREW	6003-001374	SCREW-TAPTYPE;FH,+,B,M4,L12,NI PLT,SWRCH	5	SA
...3	SCREW	6003-001782	SCREW-TAPTYPE;BH,+,B,M4,L12,ZPC(BLK),SWR	2	SA
...3		BN61-04692A	BOSS-PRIMER;#94,clear,35cps	0	SNA
...3		BN61-04731D	BOSS-TAPE;AMBER,ACRYL,T1.1,W20.0mm,WHITE	0	SNA
...3		BN61-05826A	BOSS-BOND;#760,Poly urethane,Black	2	SNA
...3	SG01	BN61-06998A	GUIDE-STAND NECK;LD550,46,PETG,V2,TP0003	1	SNA
...4		0103-007257	RESIN-PETG;ECOZEN-SE,NP01,TP0003,3.2 V2,	125	SNA
...4		BN61-06079B	GUIDE-NECK-INSERT;LC650,40,PETG HB,TP000	1	SNA
...4		BN68-00513D	LABEL-RESIN;resin,-,art paper,-,10,25,-,	1	SNA
...3		BN61-07119A	HOLDER-NECK FRONT;LD550,46,PC+G/F 20%,BK	1	SNA
...3		BN61-07122A	HOLDER-NECK REAR;LD550,46,PC+G/F 20%,BK0	1	SNA
...4		0103-007285	RESIN-PC;MW32020GFU,BK0007,2.0 V2,PC/GF2	20	SNA
...3		BN61-07244A	HOLDER-SWIVEL RING;LD550,40,POM,60pie,NC	1	SNA
...3		BN61-07353A	BRACKET-STAND BOTTOM;PD550 51",SECC,T3.0	1	SNA
...3	CCM1	BN63-04755A	COVER-SHEET;AMBER,PE,T0.05,W150mm,200M,6	1	SNA
...3	FD01	BN63-07892A	COVER-DECORATION;LD550,37/40/46,ABS+PMMA	1	SNA
...4		0103-005096	RESIN-ABS;HB,ABS+PMMA	13	SNA
...3		BN63-08124A	COVER-STAND GLASS;UD6000,55,Glass,8.0,30	1	SNA
...3	T0527	BN68-01648B	LABEL WARNING;WW,PET,T0.05,40,25,EXPORT	1	SNA
...3	AR011	BN73-00079A	RUBBER FOOT;MD230,CR Rubber Black,T3.0,5	4	SNA
...3		BN73-00300A	RUBBER-FOOT;LC650 40,RUBBER,27*27,BLACK	4	SNA
...3		BN74-00031A	GREASE;kanto-kasei FL-955.grease,wht	0	SNA
1		BN91-06862A	ASSY SHIELD;UE55D6000TWXXC	1	SNA
.2	CIS1	0203-001586	TAPE-FILAMENT;#893,0.15,30,55,WHT,FILAME	0	SNA
.2	SCREW	6003-001782	SCREW-TAPTYPE;BH,+,B,M4,L12,ZPC(BLK),SWR	2	SA
.2	EC13	BN39-01486E	LEAD CONNECTOR;UE55C6000,Flat Connector	1	SNA
.2	RB01	BN63-07807C	COVER-BOTTOM;UD5000 37,NH HIPS,V1,BK0020	1	SNA
...3		0103-007489	RESIN-HIPS;FT875,BK,BK0020,V1,HIPS	70	SNA
...3		BN68-00513D	LABEL-RESIN;resin,-,art paper,-,10,25,-,	1	SNA
.2		BN73-00211C	PAD GAP;UN32D6500,PAD GAP,4.5 mm,35mm*35	1	SNA
.2	FB03A	BN96-17107B	ASSY BOARD P-RF MODULE;Bluetooth Module,	1	SA
.2	FL06	BN96-17116K	ASSY CABLE P-FFC;UE55C8000,FFC,425mm,51P	1	SA
.2	SP01A	BN96-18088A	ASSY SPEAKER P;6ohm,4pin,15W,Enclosure t	1	SA
1	M0017	BN91-06866K	ASSY CHASSIS;UE55D6300SSXXN	1	SNA
.2	M0014	BN94-04627P	ASSY PCB MAIN;UE55D6300SSXXN	1	SA
...3		0202-001608	SOLDER-WIRE FLUX;LFC7-107,D0.8,99.3Sn/0.	0	SNA
...3	HDP01	BN61-06644A	HOLDER-PCB;LC750,NYNOL66,V0	1	SA
...3	CB01	BN61-07083H	BRACKET-AV;UD6400,PCM,T0.45,BKN-P824,EUR	1	SNA
...3		BN97-05444A	ASSY DRM-CI PLUS;BN46-00068A,U55A	1	SNA

Level	Loc.	Part Code	Description & Specification	Qty.	SA/SNA
...4		BN46-00068A	KEY CODE-CI PLUS;Genoa,TCTC,SERIAL CODIN	1	SNA
..3		BN97-05511E	ASSY SMD;UE55D6300SSXXN	1	SNA
...4		0202-001477	SOLDER-CREAM;LST309-M,D20~45um,96.5Sn/3A	3	SNA
...4	DS01A	0401-001056	DIODE-SWITCHING;MMBD4148SE,100V,200mA,SO	13	SA
...4		0403-001783	DIODE-ZENER;BZB84-C6V2,5.8/6.6V,300mW,SO	16	SNA
...4	D0254	0404-001271	DIODE-SCHOTTKY;SSA34,40V,3000mA,SMA,TP	3	SA
...4	D0254	0404-001404	DIODE-SCHOTTKY;BAT721C,40V,200mA,SOT-23,	6	SA
...4	T0139	0406-001200	DIODE-TVS;RCLAMP0504F,6/-V,150W,SC-70	2	SA
...4	T0139	0406-001271	DIODE-TVS;RCLAMP0524P,6/-V,150W,SLP251	1	SNA
...4		0406-001290	DIODE-TVS;3.0SMCJ20A,22.2/-/24.5V,3000W,	1	SNA
...4	Q101	0501-000445	TR-SMALL SIGNAL;KTC3875S-Y,NPN,150mW,SOT	2	SA
...4		0501-000669	TR-SMALL SIGNAL;KTA1505Y,PNP,150mW,SOT-2	1	SA
...4	CEQ2	0505-000110	FET-SILICON;2N7002,N,60V,115mA,7.5ohm,0.	4	SA
...4	Q409	0505-002386	FET-SILICON;AO3415AL,P,-20V,-4A,0.045ohm	2	SA
...4		0505-002854	FET-SILICON;AO5404E,N,20V,0.5A,0.55ohm,0	1	SNA
...4		0505-002894	FET-SILICON;MMBFJ177LT1G,P,20mA,300ohm,0	1	SNA
...4	IC104	0801-002630	IC-CMOS LOGIC;74AHCT1G08,2-INPUT AND GAT	1	SA
...4	ND51C2	0801-002780	IC-CMOS LOGIC;74LVC1G17,SCHMITT-TRIGGER	1	SA
...4	IC104	0801-003330	IC-CMOS LOGIC;Octal buffer,DQFN,20P,4.5x	3	SA
...4	IC104	0802-001012	IC-CMOS LOGIC;74LCX245,TRANSCEIVER,DQFN,	1	SNA
...4		0904-002631	IC-USC;QFN,28P,5.0mm X 5.0mm,12MHz,TP,PL	1	SA
...4		1001-001683	IC-VIDEO SWITCH;SiI9489,QFP,128P,14x14x1	1	SNA
...4		1001-001686	IC-ANALOG MULTIPLEX;74LV4052,CMOS,TT SOP,	1	SA
...4		1103-001500	IC-EEPROM;AT24C02C-SSHM-T,2Kbit,256x8,SO	1	SA
...4		1103-001506	IC-EEPROM;M24512-RMN6TP,512Kbit,64Kx8,SO	1	SA
...4		1105-002194	IC-DDR3 SDRAM;K4B1G1646G-BCH9,DDR3 SDRAM	4	SA
...4		1201-003158	IC-POWER AMP;TAS5725,PQFP,48P,7x7mm,DUAL	1	SA
...4	T0087	1203-002835	IC-POSI.FIXED REG.;7805,3P,6.6x6.1mm,PLA	1	SA
...4	IC703	1203-003121	IC-POSI.FIXED REG.;FAN1112,SOT-223,3P,6.	1	SA
...4		1203-004363	IC-VOL. DETECTOR;RT9818C-29PV,SOT-23,3P,	1	SA
...4		1203-005988	IC-DC/DC CONVERTER;TPS54620RGY,QFN,14P,3	1	SA
...4		1203-006017	IC-VOL. DETECTOR;RT9824GJ8,TSOT23,8P,2.9	1	SA
...4	T0087	1203-006109	IC-POSI.FIXED REG.;S-1206B33-M3T1G,SOT-2	1	SA
...4	T0087	1203-006130	IC-POSI.FIXED REG.;S-1172B25-U5T1G,SOT-8	1	SA
...4	T0087	1203-006135	IC-POSI.FIXED REG.;AP1117D-33-GZ-13-89,T	2	SA
...4	T0087	1203-006136	IC-POSI.FIXED REG.;AP1117D-18-GZ-13-89,T	1	SA
...4	T0087	1203-006141	IC-POSI.FIXED REG.;S-1172B33-U5T1G,SOT-8	1	SA
...4		1203-006619	IC-DC/DC CONVERTER;AOZ1033AI,SO-8,8P,4.9	3	SA
...4		1203-006683	IC-DC/DC CONVERTER;A8294SESTR-T,QFN,20P,	1	SNA
...4	IC118	1204-003101	IC-VIDEO PROCESS;SDP94,PBGA,345P,19x19mm	1	SA

Exploded Views and Parts List

Level	Loc.	Part Code	Description & Specification	Qty.	SA/SNA
...4		1204-003217	IC-DECODER;SDP1001,FCBGA,937P,35x35mm,PL	1	SA
...4		1205-003201	IC-BUS SWITCH;TC7WB125FK,SSOP,8P,2x2.3mm	1	SA
...4		1205-003479	IC-SWITCH;TPS2051BDBVR,SOT-23,5P,2.9x1.6	3	SA
...4		1205-003733	IC-SWITCH;AP2191MPG-13,MSOP-8L-EP,8P,2.9	1	SA
...4		1205-003735	IC-SWITCH;AP2151WG-7,SOT25,5P,2.9x1.6mm,	2	SA
...4		1205-003834	IC-ETHERNET CONTROLLER;RTL8201E-VC-GRT,Q	1	SA
...4		1205-004095	IC-CODEC;AK4686EQ,LQFP,48P,9.0x9.0x1.7mm	1	SA
...4		1405-001271	VARISTOR;20Vdc,5A,1.0x0.5x0.6mm,TP	28	SA
...4	MR604	2007-000137	R-CHIP;2Kohm,5%,1/16W,TP,1005	5	SNA
...4	R105	2007-000138	R-CHIP;100ohm,5%,1/16W,TP,1005	19	SA
...4	AR49	2007-000140	R-CHIP;1Kohm,5%,1/16W,TP,1005	30	SNA
...4	MR306	2007-000141	R-CHIP;2.2Kohm,5%,1/16W,TP,1005	14	SNA
...4	R319	2007-000143	R-CHIP;4.7Kohm,5%,1/16W,TP,1005	52	SNA
...4		2007-000146	R-CHIP;6.8Kohm,5%,1/16W,TP,1005	1	SNA
...4	R104	2007-000148	R-CHIP;10Kohm,5%,1/16W,TP,1005	23	SA
...4	HDR2	2007-000151	R-CHIP;15Kohm,5%,1/16W,TP,1005	1	SNA
...4	MR36	2007-000153	R-CHIP;22Kohm,5%,1/16W,TP,1005	1	SNA
...4	AR43	2007-000155	R-CHIP;27Kohm,5%,1/16W,TP,1005	1	SNA
...4	MR13	2007-000157	R-CHIP;47Kohm,5%,1/16W,TP,1005	24	SNA
...4	DR39	2007-000162	R-CHIP;100Kohm,5%,1/16W,TP,1005	9	SNA
...4	R509	2007-000170	R-CHIP;1Mohm,5%,1/16W,TP,1005	4	SNA
...4	R111	2007-000171	R-CHIP;0ohm,5%,1/16W,TP,1005	19	SNA
...4	HDR17	2007-000172	R-CHIP;10ohm,5%,1/16W,TP,1005	6	SNA
...4	R338	2007-000173	R-CHIP;22ohm,5%,1/16W,TP,1005	28	SNA
...4	UR23	2007-000174	R-CHIP;47ohm,5%,1/16W,TP,1005	3	SNA
...4		2007-000231	R-CHIP;1.3Kohm,1%,1/10W,TP,1608	2	SA
...4	MR39	2007-000242	R-CHIP;1.5Kohm,5%,1/16W,TP,1005	1	SNA
...4	RT01	2007-000483	R-CHIP;1ohm,5%,1/8W,TP,2012	2	SNA
...4		2007-000758	R-CHIP;330Kohm,5%,1/16W,TP,1005	1	SNA
...4	DR37	2007-000932	R-CHIP;470ohm,5%,1/16W,TP,1005	4	SNA
...4	VR88	2007-001116	R-CHIP;680ohm,1%,1/10W,TP,1608	1	SA
...4		2007-001168	R-CHIP;75ohm,5%,1/4W,TP,3216	2	SA
...4		2007-001288	R-CHIP;18ohm,5%,1/16W,TP,1005	4	SA
...4	OTR1	2007-001292	R-CHIP;33ohm,5%,1/16W,TP,1005	11	SNA
...4	DR43	2007-001298	R-CHIP;51ohm,5%,1/16W,TP,1005	1	SNA
...4	MR31	2007-001305	R-CHIP;120ohm,5%,1/16W,TP,1005	1	SNA
...4	CER07	2007-001308	R-CHIP;200ohm,5%,1/16W,TP,1005	1	SNA
...4	R19548	2007-001311	R-CHIP;270ohm,5%,1/16W,TP,1005	1	SA
...4	R16	2007-001313	R-CHIP;330ohm,5%,1/16W,TP,1005	1	SNA
...4		2007-001316	R-CHIP;820ohm,5%,1/16W,TP,1005	1	SA

Level	Loc.	Part Code	Description & Specification	Qty.	SA/SNA
...4	R326	2007-001325	R-CHIP;3.3Kohm,5%,1/16W,TP,1005	1	SNA
...4	PR24	2007-002970	R-CHIP;56ohm,5%,1/16W,TP,1005	1	SA
...4	DR8	2007-007001	R-CHIP;3.9Kohm,5%,1/16W,TP,1005	1	SA
...4	PR8	2007-007015	R-CHIP;13Kohm,5%,1/16W,TP,1005	1	SNA
...4		2007-007100	R-CHIP;10Mohm,5%,1/16W,TP,1005	1	SA
...4		2007-007132	R-CHIP;15Kohm,1%,1/16W,TP,1005	2	SA
...4		2007-007134	R-CHIP;39Kohm,1%,1/16W,TP,1005	1	SA
...4		2007-007135	R-CHIP;18Kohm,1%,1/16W,TP,1005	3	SNA
...4		2007-007137	R-CHIP;1.2Kohm,1%,1/16W,TP,1005	4	SA
...4		2007-007138	R-CHIP;27Kohm,1%,1/16W,TP,1005	1	SNA
...4	DR4	2007-007142	R-CHIP;10Kohm,1%,1/16W,TP,1005	22	SNA
...4		2007-007156	R-CHIP;1ohm,5%,1/16W,TP,1005	4	SNA
...4		2007-007306	R-CHIP;100ohm,1%,1/16W,TP,1005	2	SNA
...4		2007-007318	R-CHIP;1Kohm,1%,1/16W,TP,1005	13	SNA
...4	HDR44	2007-007470	R-CHIP;7.5Kohm,1%,1/16W,TP,1005	4	SNA
...4		2007-007488	R-CHIP;75Kohm,1%,1/16W,TP,1005	1	SNA
...4		2007-007517	R-CHIP;240ohm,1%,1/16W,TP,1005	6	SNA
...4		2007-007617	R-CHIP;2.49Kohm,1%,1/10W,TP,1608	1	SA
...4		2007-007698	R-CHIP;5.1Kohm,1%,1/16W,TP,1005	2	SNA
...4		2007-007730	R-CHIP;6.8Mohm,1%,1/10W,TP,1608	1	SA
...4		2007-007797	R-CHIP;44.2ohm,1%,1/10W,TP,1608	2	SA
...4	MR11	2007-008015	R-CHIP;75ohm,1%,1/16W,TP,1005	18	SNA
...4		2007-008137	R-CHIP;24Kohm,1%,1/16W,TP,1005	3	SNA
...4		2007-008263	R-CHIP;3Kohm,1%,1/16W,TP,1005	2	SA
...4		2007-008275	R-CHIP;30Kohm,1%,1/16W,TP,1005	1	SNA
...4		2007-008391	R-CHIP;6.34Kohm,1%,1/16W,TP,1005	2	SA
...4		2007-009853	R-CHIP;1.6Kohm,1%,1/16W,TP,1005	1	SNA
...4	ZRN10	2011-001261	R-NETWORK;33ohm,5%,1/16W,L,CHIP,8P,TP,2.	4	SA
...4	DAR09	2011-001262	R-NETWORK;22ohm,5%,1/16W,L,CHIP,8P,TP,2.	8	SA
...4		2011-001345	R-NETWORK;10Kohm,5%,1/16W,L,CHIP,8P,TP,2	2	SA
...4	DRP29	2011-001396	R-NETWORK;4.7Kohm,5%,1/16W,L,CHIP,8P,TP,	2	SA
...4		2011-001449	R-NETWORK;22ohm,5%,1/16W,L,4P,TP,1010	12	SA
...4		2011-001497	R-NETWORK;470ohm,5%,1/16W,L,CHIP,4P,TP,1	2	SNA
...4		2011-001519	R-NETWORK;33OHM,5%,1/16W,L,CHIP,4P,TP,1.	1	SA
...4		2011-001527	R-NETWORK;4.7Kohm,5%,1/16W,L,CHIP,4P,TP,	4	SNA
...4	PC43	2203-000233	C-CER,CHIP;0.1nF,5%,50V,C0G,TP,1005	11	SA
...4	DC54	2203-000278	C-CER,CHIP;0.01nF,0.5pF,50V,C0G,TP,1005	1	SA
...4	DC2	2203-000330	C-CER,CHIP;0.012nF,5%,50V,C0G,TP,1005	8	SA
...4	DC1	2203-000386	C-CER,CHIP;0.015nF,5%,50V,C0G,TP,1005	8	SA
...4	MC302	2203-000425	C-CER,CHIP;0.018nF,5%,50V,C0G,TP,1005	2	SA

Exploded Views and Parts List

Level	Loc.	Part Code	Description & Specification	Qty.	SA/SNA
...4	C254	2203-000438	C-CER,CHIP;1nF,10%,50V,X7R,TP,1005	10	SA
...4	C507	2203-000489	C-CER,CHIP;2.2nF,10%,50V,X7R,TP,1005	4	SA
...4	V1233	2203-000575	C-CER,CHIP;220nF,10%,25V,X7R,TP,2012	8	SNA
...4	AD480	2203-000714	C-CER,CHIP;3.3nF,10%,50V,X7R,TP,1005,-	5	SA
...4	DC25	2203-000812	C-CER,CHIP;0.033nF,5%,50V,C0G,TP,1005	7	SA
...4	AD480	2203-000995	C-CER,CHIP;0.047nF,5%,50V,C0G,TP,1005	4	SA
...4	AD480	2203-002285	C-CER,CHIP;10nF,10%,50V,X7R,TP,1005	20	SNA
...4	DC18	2203-005138	C-CER,CHIP;1.8nF,10%,50V,X7R,1005	5	SA
...4	C231	2203-005221	C-CER,CHIP;15nF,10%,50V,X7R,1608	1	SNA
...4	AAC1	2203-005249	C-CER,CHIP;100nF,10%,50V,X7R,TP,1608	19	SNA
...4	AD480	2203-005344	C-CER,CHIP;22nF,10%,25V,X7R,TP,1005,0.5T	16	SNA
...4	PC8	2203-005642	C-CER,CHIP;0.22nF,5%,50V,NP0,1005	2	SNA
...4	AD480	2203-005968	C-CER,CHIP;4.7nF,10%,50V,X7R,TP,1005,0.5	3	SNA
...4	VC37	2203-006048	C-CER,CHIP;100nF,10%,10V,X7R,TP,1005	209	SA
...4	AD480	2203-006126	C-CER,CHIP;47nF,10%,16V,X7R,TP,1005	7	SNA
...4	C802	2203-006348	C-CER,CHIP;1000nF,10%,25V,X5R,TP,1608	5	SA
...4	C125	2203-006361	C-CER,CHIP;10000nF,10%,10V,X5R,TP,2012	27	SC
...4	AD480	2203-006460	C-CER,CHIP;2200nF,10%,16V,X5R,TP,1608,-	2	SA
...4	HE4	2203-006474	C-CER,CHIP;22000nF,20%,6.3V,X5R,2012	8	SA
...4	HDC11	2203-006562	C-CER,CHIP;1000nF,10%,10V,X5R,TP,1005	41	SNA
...4	AD480	2203-006824	C-CER,CHIP;4700nF,10%,10V,X5R,1608	11	SNA
...4	AD480	2203-006841	C-CER,CHIP;1000nF,10%,16V,X5R,TP,1005	1	SNA
...4	C23	2203-006890	C-CER,CHIP;10000nF,20%,6.3V,X5R,1608	62	SNA
...4	AD480	2203-006992	C-CER,CHIP;0.33nF,5%,50V,C0G,TP,1005	2	SNA
...4	AD480	2203-007306	C-CER,CHIP;10000nF,10%,25V,X5R,TP,2012,1	4	SNA
...4	AD480	2203-007513	C-CER,CHIP;10000nF,10%,10V,X5R,TP,1608	6	SA
...4		2402-001403	C-AL,SMD;100uF,20%,35V,TP,10.3X10.3	2	SNA
...4	T0052	2703-000158	INDUCTOR-SMD;1uH,10%,2012	3	SA
...4	S1Q036	12703-000408	INDUCTOR-SMD;3.3uH,20%,3225	1	SA
...4	T0052	2703-001239	INDUCTOR-SMD;3.3uH,10%,1608	8	SA
...4	T0052	2703-002268	INDUCTOR-SMD;8.2nH,5%,1005	2	SNA
...4	T0052	2703-003713	INDUCTOR-SMD;1.5uH,20%,7366	1	SA
...4	T0052	2703-003790	INDUCTOR-SMD;4.7uH,20%,8080	3	SA
...4		2703-003879	INDUCTOR-SMD;33uH,20%,10.0mmX10.0mm	1	SA
...4		2703-003930	INDUCTOR-SMD;4.7uH,20%,5050	4	SA
...4	X202	2801-003948	CRYSTAL-SMD;12MHz,30ppm,28-AAN,12pF,60oh	1	SA
...4	PX1	2801-004021	CRYSTAL-SMD;24.576MHz,20ppm,28-AAN,12pF,	1	SA
...4	X202	2801-004629	CRYSTAL-SMD;27MHz,20ppm,12pF,50ohm,TP	1	SNA
...4	X202	2801-004734	CRYSTAL-SMD;25.000000MHz,20ppm,28-AAN,12	1	SA
...4	X202	2801-004774	CRYSTAL-SMD;24MHz,30ppm,14pF,30ohm,TP	2	SA

Level	Loc.	Part Code	Description & Specification	Qty.	SA/SNA
...4	X202	2801-004775	CRYSTAL-SMD;12MHz,30ppm,16pF,30ohm,TP	1	SNA
...4	F103	2901-001506	FILTER-EMI SMD;5V,0.13A,0pF,2x1x0.5mm,TP	2	SA
...4	DR32	3301-000314	BEAD-SMD;120ohm,1.6x0.8x0.8mm,-,-,-	12	SNA
...4	T0568	3301-001236	BEAD-SMD;60ohm,1608	3	SNA
...4	T0568	3301-002039	BEAD-SMD;26ohm,1608,TP	48	SA
...4	F201	3601-001374	FUSE-SURFACE MOUNT;32V,5A,FAST-ACTING,Hi	1	SA
...4	CN401	3701-001724	CONNECTOR-DSUB;15P,3ROW,FEMALE,ANGLE,NI	1	SA
...4	CN601	3701-001736	CONNECTOR-HDMI;19P,2ROW,FEMALE,SMD-A	4	SA
...4	CN303	3707-001104	CONNECTOR-OPTICAL;SMD-A(Ultra Slim),SPDI	1	SA
...4		3710-002276	SOCKET-INTERFACE;24P,1R,0.5mm,SMD-A,AU,B	1	SA
...4		3710-003374	CONNECTOR-SOCKET;64P,2R,0.5mm,ANGLE,NI+S	1	SA
...4	HB01A	3711-005925	HEADER-BOARD TO CABLE;BOX,51P,1R,0.5mm,S	1	SA
...4	HB01A	3711-007319	HEADER-BOARD TO CABLE;SMD,4P,1R,2.50mm,S	1	SA
...4		3711-007571	CONNECTOR-HEADER;BOX,18P,2R,2.0mm,ANGLE,	1	SA
...4	EH01	3711-007742	HEADER-BOARD TO CABLE;BOX,20P,2R,2mm,ANG	1	SA
...4	CN1501	3722-003044	JACK-USB;4P/1C,NI,BLK,SMD-A,A-TYPE	3	SA
...4	CN302	3722-003158	JACK-PHONE;1/6P,NI,BLK,ANGLE	2	SA
...4	CN1701	3722-003199	JACK-MODULAR;8P/8C,ANGLE,AU,1P	1	SA
...4	CN501	3722-003207	JACK-PHONE;2P/9C,AU,LIMEGRN,SMD-A(DIP)	1	SA
...4	ET01	BN40-00217A	TUNER;DNSS243VH142A,DNSS243VH142A,DVB-TC	1	SA
...4		BN41-01683A	PCB MAIN;FR-4,4,1.2T,192x240	1	SNA
...4		BN97-05338A	ASSY MICOM-INAND;T-GAS6DEUC-1004.0,2011.	1	SNA
....5		1107-001983	IC-NAND FLASH;SDIN5D2-2G-944D,2GByte,BGA	1	SNA
...4		BN97-05339A	ASSY MICOM;T-GAS6DEUC-XXXX,U69A,KFG1GN6W	1	SNA
....5		1107-001990	IC-NAND FLASH;KFG1GN6W2D-HIB6,1Gbit,64Mx	1	SA
...4		BN97-05512A	ASSY MICOM;T-GENDEUS1-XXXX,U69A, U68A,20	1	SNA
....5		0903-001718	IC-MICROCONTROLLER;61P805-RG480WT,LQFP,4	1	SNA
1		BN91-07354A	ASSY LCM-AMLCD VD;BN95-00466A,BN44-00457	1	SNA
.2	M-P	6001-002653	SCREW-MACHINE;BH,+,M3,L6,ZPC(WHT),SWRCH1	5	SA
.2	P001A	BN44-00457A	DC VSS-LED TV PD BD;PD55A1D_BHS,PD55A1D_	1	SA
.2	PANEL	BN95-00466A	PRODUCT LCD;6K 55 3D_LTJ550HW03-V	1	SA
..3	TCON	BN96-16498A	ASSY PCB P-T-CON;LSJ550HW01-S,FR4,SUWON,	1	SA
1		BN92-07871A	ASSY P/MATERIAL;UD6000,55	1	SNA
.2	T0214	0203-001269	TAPE-OPP MASKING;#301,T0.06,W75,L50000,N	1	SNA
.2		6902-000379	BAG AIR;LDPE,T0.2,W1000,L1800,TRP,1260.0	1	SNA
.2	M040	6922-000003	BAND PP;PP,T0.8,W18,L1650M,TRP,DA69-9014	1	SNA
.2	T0214	AA61-20285C	HOLDER-BOX;CORAL,PP,BLACK,HB,17.5g	4	SNA
.2		BN68-02422B	LABEL-WARNING SHIPPING;ALL MODEL,A/P 100	1	SNA
.2		BN69-03982C	PAD PACKING-EDGE;LB6T,PAPER,6,120,1690,-	1	SNA
.2		BN69-05184N	PALLET;50D5000,WOOD,1575,1190,135,20000,	1	SNA

Exploded Views and Parts List

Level	Loc.	Part Code	Description & Specification	Qty.	SA/SNA
.2		BN69-05418A	PACKING-BAG WRAPPING;-LDPE,-,0,019,500,	3	SNA
.2		BN69-05692A	CUSHION-SET;UD6100 55",EPS,EXPORT, DENSI	1	SNA
.2		BN69-05791A	CUSHION-FRONT;55UD7000,EPS	1	SNA
.2		BN69-06642B	PACKING-PAD;PAD,PAPER,-,-,CB-SW4,1500,11	1	SNA
.2		BN69-06675A	PACKING-SHEET PALLET;PACKING SHEET PALLE	1	SNA
.2		BN69-06679A	PACKING-BAG SHEET ROLL;-,-,CB,-,FOAM 0,5mm	4	SNA
.2		BN74-00008D	TAPE-OPP MASKING;OPP,T0.05,W75,L800M,CLR	2	SNA
1	ACCE1	BN92-08063A	ASSY ACCESSORY;UE32D6300SSXXN	1	SNA
.2	ACCE4	BN96-18581A	ASSY ACCESSORY-MANUAL;UE32D6300SSXXN	1	SNA
..3		6902-000476	BAG PE;LDPE,T0.03,W250,L350,TRP,Recycle,	1	SNA
..3		BN68-00514K	MANUAL FLYER-WARRANTY CARD;comm,Samsung,	1	SNA
..3		BN68-03019A	LEAFLET-SAFETY GUIDE;ALL,SAMSUNG,28LENGS	1	SNA
..3		BN68-03476E	MANUAL USERS;UD6300,6320,Samsung,4Langs,	1	SNA
..3		BN68-03602F	MANUAL FLYER-01,SAMART TV GUIDE;UD5500~,	1	SNA
.2	ACCE2	BN96-18581C	ASSY ACCESSORY-CABEL;UE32D6200TSXXN	1	SNA
..3		3709-001663	CONNECTOR-CARD EDGE;64P,0.5mm,MALE,PCMC1	1	SA
..3	EC11	3903-000525	CBF-POWER CORD;DT,CEE,LP-21L,250V,2.5A,B	1	SA
..3	T0120	4301-000121	BATTERY-MN;1.5V,R03,10.5x44.5m,HOLDER,7.	2	SNA
..3		6902-001340	BAG PE;LDPE,T0.05,W250,L350,TRP,RECYCLE	1	SNA
..3	REMO2	AA59-00507A	REMOCON;TM1050,49,3V,EUROPE iDTV,6320,63	1	SA
..3	EC03	BN39-01154A	CBF SIGNAL;Chelsea Slim,24P/20P,30AWG,20	1	SA
..3	EC03	BN39-01154W	CBF SIGNAL;COMPONENT GENDER / UD8000,2P,	1	SA
..3		BN61-05491A	HOLDER-WIRE STAND;UB7000 46inch,NYRON	1	SNA
..3	M9889	BN63-01798B	CLOTH-CLEAN;cloth,180,200,sea blue,ToC	1	SNA
..3	T0527	BN68-00513A	LABEL-E,PASS;ALL MODEL,YUPO(110G),50X15,	1	SNA
..3	EH03A	BN96-18153A	ASSY HOLDER P-RING;11 LED-TV	1	SNA
...4		6902-001404	BAG ZIPPER;LDPE,T0.05,W80,L100,TRP	1	SNA
...4	AH365	BN61-07295A	HOLDER-RING;40UD5500,ABS,BK0007,HB	4	SNA
1		BN92-08598C	ASSY BOX;UD6320,55,EO(SATELLITE)	1	SNA
.2		BH68-00662A	LABEL BOX-00;ALL MODEL,MOJO 90G,60,110,W	1	SNA
.2		BN69-06462A	BOX-SET,IN;55UD6000,CB,C-01,DW1, YEL,W18	1	SNA
.2		BN69-06540C	BOX-SET,OUT;55UD6320,CB,C-03,DW3, YEL,W1	1	SNA
1		BN92-08666E	ASSY LABEL;UE55D6300SSXXN	1	SNA
.2		BN68-03652L	LABEL-STICKER;UD6U,T0.05,60,120,Energy R	1	SNA
.2	T0527	BP68-00052B	LABEL-00,RATING;CCTV,TETRON PAPER,T0.05,	1	SNA