

### 5-3. UE55B7000WW Exploded View

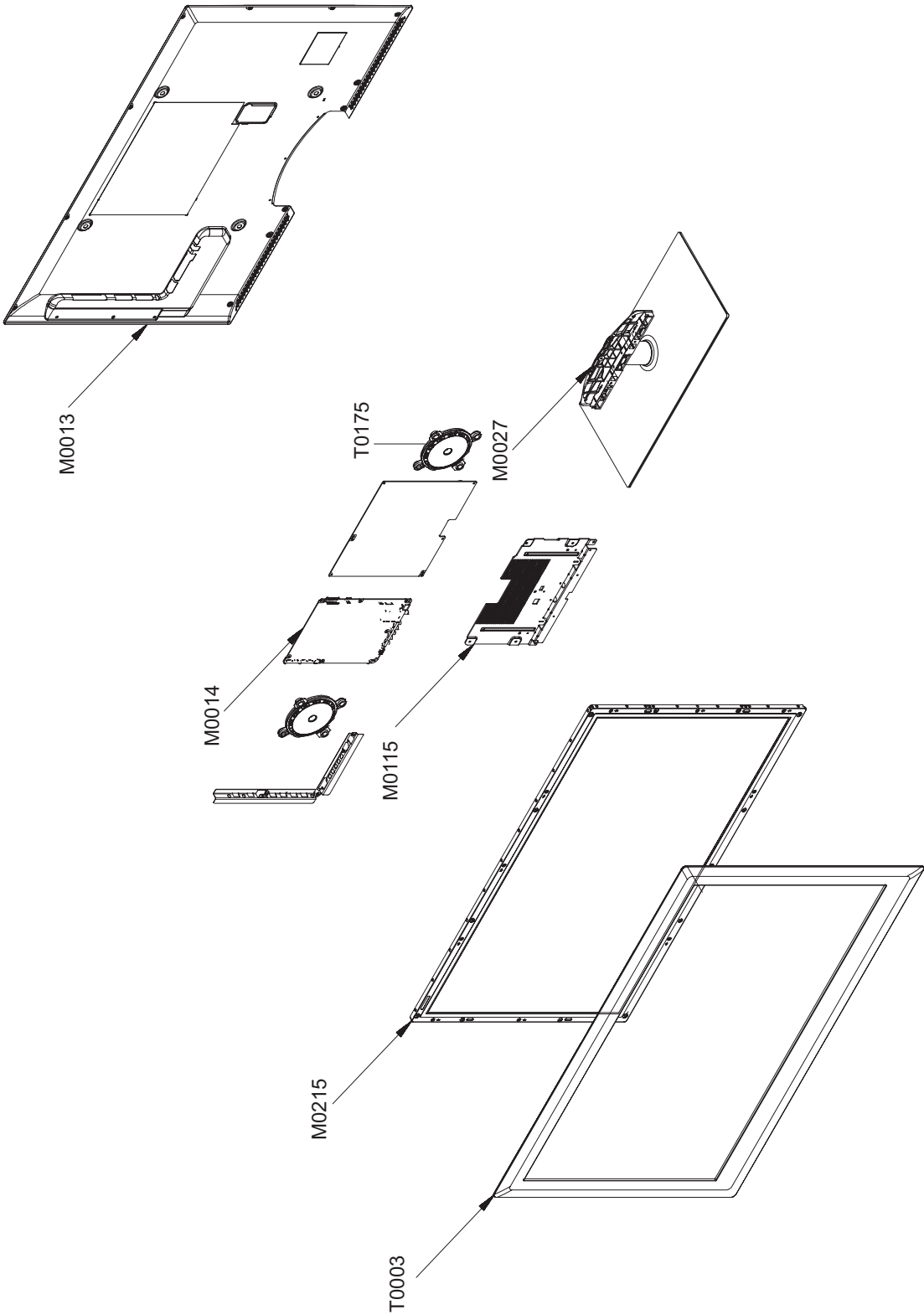

**5-3-1. UE55B7000WW Parts List**

Location No.	Code No.	Description & Specification	Q'ty	S.A/S.N.A	Remark
T0003	BN96-09973C	ASSY COVER P-FRONT;UB7000 55,PC(CLR)+PC(	1	S.A	
M0215	BN07-00702B BN07-00736A	LCD-PANEL;LTF550HF04	1	S.A	
T0175	BN96-09468C	ASSY SPEAKER P;8ohm,4pin,Diameter: 120mm	1	S.A	
T0175	BN96-09470C	ASSY SPEAKER P;8ohm,4pin,15W,R:950 / L:6	1	S.A	
M0115	BN61-05536A	BRACKET-STAND LINK;UB7000 46inch,HGI,T3.	1	S.N.A	
M0014	BN94-02706C	ASSY PCB MAIN;UE55B7000WWXXC	1	S.A	
M0013	BN96-09974B	ASSY COVER P-REAR;LB7000 55inch,PCM T0.5	1	S.A	
M0027	BN96-09480B	ASSY STAND P-BASE;52 LB7000,PI50 X L96,G	1	S.A	

**5-3-2. UE55B7020WW Parts List**

Location No.	Code No.	Description & Specification	Q'ty	S.A/S.N.A	Remark
T0003	BN96-09973D	ASSY COVER P-FRONT;UB7020 55,PC(CLR)+PC(	1	S.A	
M0215	BN07-00702B	LCD-PANEL;LTF550HF04	1	S.A	
T0175	BN96-09470C	ASSY SPEAKER P;8ohm,4pin,15W,R:950 / L:6	1	S.A	
T0175	BN96-11610A	ASSY SPEAKER P;8ohm,4pin,15W,R:1000/L:50	1	S.A	
M0115	BN61-05536A	BRACKET-STAND LINK;UB7000 46inch,HGI,T3.	1	S.N.A	
M0014	BN94-02706P	ASSY PCB MAIN-SQE;UE55B7000WWX*	1	S.A	
M0013	BN96-09974B	ASSY COVER P-REAR;LB7000 55inch,PCM T0.5	1	S.A	
M0027	BN96-09480C	ASSY STAND P-BASE;55 B7000,PI50 X L96,GL	1	S.A	