

# 1. Exploded View & Part List

## Exploded View

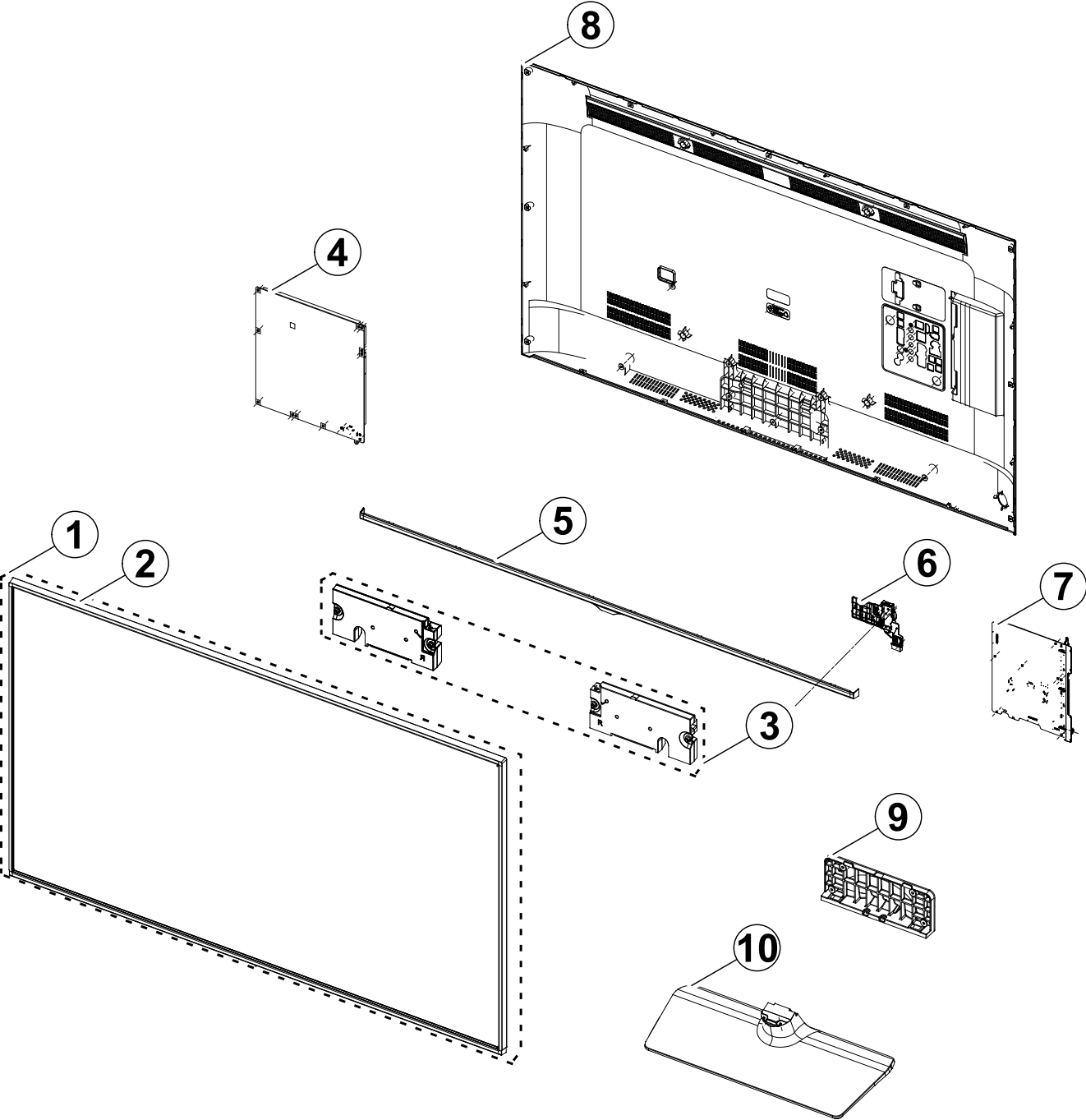

**Parts List**

No.	Lvl.	Loc.	Material Code	Description & Specification	SNA	Qty.
1	2	PANEL	BN95-01317B	PRODUCT LCD-AMLCD; LSF480HN01-G,CY-GH048B	SA	1
2	3	TC01A	BN96-30693A	ASSY CHASSIS TOP P; H5.5K 48",PC+ABS-(GF1	SA	1
3	2	SP01A	BN96-30334A	ASSY SPEAKER P; 6ohm,10W,Enclosure_H5k	SA	1
4	2	P001A	BN44-00703A	DC VSS-LED TV PD BD; L48S1_ESM,L48S1_ESM,	SA	1
5	2	CD01A	BN95-01397E	ASSY DECORATION SMT; UH5500,48,LIGHT TITA	SA	1
6	2	FB01A	BN96-30902C	ASSY BOARD P-FUNCTION ASSY; UH5500,Functi	SA	1
7	2	M0014	BN94-07369N	ASSY PCB MAIN; UH5K	SA	1
8	2	R001A	BN96-31667C	ASSY COVER P-REAR; H5000 48,EUROPE,MASTER	SA	1
9	2	SG01A	BN96-30590A	ASSY GUIDE P-STAND; UH5000/5500 40/48/50,	SA	1
10	2	SB04A	BN96-31507A	ASSY STAND P-BASE; UH5500 50",PC+ABS+G/F2	SA	1

## 2. Electrical Parts List

Level	Loc.	Part Code	Description & Specification	Qty.	SA/SNA
			<b>UE48H5500AWXXH (TS01)</b>		
1	R001A	BN90-05196E	ASSY COVER REAR;UH5K	1	SNA
.2	SCREW	6001-003074	SCREW-MACHINE;BH,+,M3,L6,ZPC(BLK),SWRCH1	16	SA
.2	SCREW	6003-001782	SCREW-TAPTYPE;BH,+,B,M4,L12,ZPC(BLK),SWR	2	SA
.2	R001A	BN96-31667C	ASSY COVER P-REAR;H5000 48,EUROPE,MASTER	1	SA
..3	R001	BN63-11620R	COVER-REAR;UH5500 48",ABS+PC,V0,BLK,EO(O	1	SNA
...4		0103-005041	RESIN PC ABS;FR3200TV,901408,BK0008,1.2m	2180	SNA
..3		BN68-03518F	LABEL-STICKER-CI SLOT;WW,ALL,PET,0.1,134	1	SNA
..3		BN68-05721F	LABEL-TERMINAL SIDE;UH5K,PET,T0.125,W14.	1	SNA
1	S001A	BN90-05212C	ASSY STAND;UH5K	1	SNA
.2	SG01A	BN96-30590A	ASSY GUIDE P-STAND;UH5000/5500 40/48/50,	1	SA
..3	SG03	BN61-09997A	GUIDE-STAND;UH5000 40",PC+G/F20%,V2	1	SA
...4		0103-007285	RESIN-PC;MW32020GFU,K032202GFV,BK0007,V2	210	SNA
..3		BN69-08751A	WRAP VINYL-SHRINK;STAND,PLASTIC OTHERS,P	0	SNA
..3		BN96-18013E	ASSY ACCESSORY-SCREW;6003-001782,4EA,ALL	1	SNA
...4	SCREW	6003-001782	SCREW-TAPTYPE;BH,+,B,M4,L12,ZPC(BLK),SWR	4	SA
...4		BN69-08203E	PACKING-BAG-SCREW;LDPE,0.05,70,90,TRP,Vi	1	SNA
..3		BN96-32380B	ASSY ACCESSORY-SCREW;LED-TV,M4,L14,B-ty	1	SNA
...4		BN61-09494D	HOLDER-BOLT;BH+,SWRCH18A,L14,M4,B TYPE	4	SA
...4		BN69-10588A	PACKING-BAG-SCREW;LED TV,LDPE,0.05,70,90	1	SNA
.2	SB04A	BN96-31507A	ASSY STAND P-BASE;UH5500 50",PC+ABS+G/F2	1	SA
..3	AS080	BN63-04755H	SHEET-COVER;52LC530,PE,T0.05,W275mm,200M	1	SNA
..3		BN63-11660A	COVER-STAND BASE;UH5500 46",PC+ABS+G/F20	1	SNA
...4		0103-009946	RESIN-PC ABS;HM-1200,BLACK,BK0007,V1	1000	SNA
...4		BN68-00513D	LABEL-RESIN;resin,-,art paper,-,10,25,-,	1	SNA
..3		BN67-00327D	RUBBER-FOOT;STAND,SILICON,13*13,T2,GRAY(	8	SNA
..3		BN68-05603A	LABEL-E,PASS;ALL MODEL,ART PAPER 90G,60,	1	SNA
1		BN90-05303G	ASSY W/I;UN40F6400AFXZA	1	SNA
.2		BN81-08159Z	PART SET-ELEC W/I;UF4~UF8,UH4~UH9 ELEC	1	SNA
.2		BN81-08368K	PART SET-MECH W/I;UH5H,U48HH*	1	SNA
1	M0017	BN91-11600N	ASSY CHASSIS;UH5K	1	SNA
.2	M0014	BN94-07369N	ASSY PCB MAIN;UH5K	1	SA
..3		BN61-10547A	HOLDER-SIDE AV;U5.5K,HIPS,BLK,CIS(6x0x)	1	SNA
...4		0103-004628	RESIN-HIPS;HF-1690H,K2901,BK0020,1.5mm H	13	SNA
..3		BN62-00273B	HEAT SINK-PS;TV Echo-P,A6063,5t,BLACK,40	1	SNA
..3		BN62-00367A	PAD GAP;F6400,SILICON,35 35 mm,6.5,Grey,	1	SNA
..3		BN97-07056A	ASSY SMD;UF7K,UF7000	1	SNA
...4		0202-001899	SOLDER-CREAM;M705-GRN360-K2-VT,25-36um,S	5	SNA

Exploded Views and Parts List

Level	Loc.	Part Code	Description & Specification	Qty.	SA/SNA
...4	DS01A	0401-001056	DIODE-SWITCHING;MMBD4148SE,100V,200mA,SO	1	SA
...4		0403-001783	DIODE-ZENER;BZB84-C6V2,5.8/6.6V,300mW,SO	2	SNA
...4		0404-001404	DIODE-SCHOTTKY;BAT721C,40V,200mA,SOT-23,	3	SA
...4		0406-001200	DIODE-TVS;RCLAMP0504F,6/-/V,150W,SC-70	3	SA
...4		0406-001628	DIODE-TVS;AOZ8804ADI,6/-/V,150W,SLP2510	1	SA
...4		0406-001635	DIODE-TVS;SMF5.0A,6.4V, 6.7V, 7V,200W,SM	9	SA
...4		0501-000279	TR-SMALL SIGNAL;KSA1182-Y,PNP,150mW,SOT-	2	SA
...4		0501-000445	TR-SMALL SIGNAL;KTC3875S-Y,NPN,150mW,SOT	5	SC
...4		0505-002560	FET-SILICON;AO6415,P,-20V,-3.3A,0.15ohm,	1	SA
...4		0505-002598	FET-SILICON;AP2317GN,P,-20V,-4.2A,0.052o	1	SA
...4		0505-002893	FET-SILICON;AO4801AS,P,-30V,-5A,2W,SOIC-	1	SA
...4		0505-002917	FET-SILICON;AO3406,N,30V,3.6A,1.4W,SOT-2	2	SA
...4		0505-003397	FET-SILICON;2N7002K,N,60V,380mA,1.19ohm,	8	SA
...4		0801-002780	IC-CMOS LOGIC;74LVC1G17,SCHMITT-TRIGGER	2	SA
...4		0801-003330	IC-CMOS LOGIC;Octal buffer,DQFN,20P,4.5x	3	SA
...4		1001-001860	IC-ANALOG SWITCH;NX5L2750CGU,QFN,10P,1.4	1	SNA
...4		1103-001564	IC-EEPROM;S-24C512CI-J800,512Kbit,64Kx8,	1	SA
...4		1105-002528	IC-DDR3 SDRAM;K4B4G1646D-BCMA,DDR3 1866,	1	SA
...4		1105-002534	IC-DDR3 SDRAM;K4B2G1646Q-BCMA,DDR3 SDRAM	2	SA
...4		1201-003183	IC-AUDIO AMP;DRV612,HTSSOP,14P,5x4.4mm,D	1	SA
...4		1201-003671	IC-AUDIO AMP;NTP7414,MLF,48P,7x7mm,DUAL,	1	SA
...4		1203-004364	IC-VOL. DETECTOR;RT9818C-42PV,SOT-23,3P,	1	SA
...4		1203-006017	IC-VOL. DETECTOR;RT9824GJ8,TSOT23,8P,2.9	1	SA
...4		1203-006109	IC-POSI.FIXED REG.;S-1206B33-M3T1G,SOT-2	1	SA
...4		1203-007238	IC-PWM CONTROLLER;TPS54427,DDA,8P,4.8x3.	2	SNA
...4		1203-007242	IC-POSI.ADJUST REG.;G2992BP11U,SOP-8,8P,	1	SA
...4		1203-007694	IC-DC/DC CONVERTER;SN1106041DDAR,DDA,8Z3	1	SA
...4		1203-007984	IC-DC/DC CONVERTER;AOZ3015PI,SO-8,8P,6.2	1	SA
...4		1203-008104	IC-POSI.FIXED REG.;S-13A1D18-E8001,HSOP,	2	SNA
...4		1203-008105	IC-POSI.FIXED REG.;S-13A1D33-E8001,HSOP,	1	SNA
...4		1203-008118	IC-DC/DC CONVERTER;AOZ3013PI,SO-8,8P,4.9	1	SNA
...4		1203-008183	IC-DC/DC CONVERTER;AOZ3015PI-1,EPAD SO-8	1	SA
...4		1204-003535	IC-DECODER;SEMS31T,PBGA,709P,23x23mm,PLA	1	SA
...4		1205-004447	IC-SWITCH;TPS2051CDBVR,SOT23-5,5P,3x1.65	2	SA
...4		1205-004983	IC-SWITCH;BD82032FVJ,TSSOP-B8J,8P,3.0x4.	1	SA
...4		1405-001271	VARISTOR;35V,20Vdc,5A,1.0x0.5x0.6mm,TP,1	28	SA
...4		2007-000137	R-CHIP;2Kohm,5%,1/16W,TP,1005	17	SNA
...4		2007-000138	R-CHIP;100ohm,5%,1/16W,TP,1005	39	SA
...4		2007-000142	R-CHIP;2.7Kohm,5%,1/16W,TP,1005	1	SNA
...4		2007-000143	R-CHIP;4.7Kohm,5%,1/16W,TP,1005	38	SNA

Level	Loc.	Part Code	Description & Specification	Qty.	SA/SNA
...4		2007-000147	R-CHIP;8.2Kohm,5%,1/16W,TP,1005	1	SA
...4		2007-000148	R-CHIP;10Kohm,5%,1/16W,TP,1005	38	SA
...4		2007-000153	R-CHIP;22Kohm,5%,1/16W,TP,1005	6	SNA
...4		2007-000157	R-CHIP;47Kohm,5%,1/16W,TP,1005	16	SNA
...4		2007-000162	R-CHIP;100Kohm,5%,1/16W,TP,1005	1	SNA
...4		2007-000171	R-CHIP;0ohm,5%,1/16W,TP,1005	16	SNA
...4		2007-000172	R-CHIP;10ohm,5%,1/16W,TP,1005	6	SNA
...4		2007-000173	R-CHIP;22ohm,5%,1/16W,TP,1005	13	SNA
...4		2007-000174	R-CHIP;47ohm,5%,1/16W,TP,1005	2	SNA
...4		2007-000503	R-CHIP;2.2ohm,5%,1/10W,TP,1608	4	SA
...4		2007-000695	R-CHIP;3.3ohm,5%,1/10W,TP,1608	5	SNA
...4		2007-000803	R-CHIP;36Kohm,1%,1/10W,TP,1608	2	SA
...4		2007-000831	R-CHIP;39Kohm,5%,1/16W,TP,1005	1	SA
...4		2007-000932	R-CHIP;470ohm,5%,1/16W,TP,1005	1	SNA
...4		2007-001116	R-CHIP;680ohm,1%,1/10W,TP,1608	1	SA
...4		2007-001125	R-CHIP;68Kohm,1%,1/10W,TP,1608	1	SA
...4		2007-001168	R-CHIP;75ohm,5%,1/4W,TP,3216	1	SA
...4		2007-001292	R-CHIP;33ohm,5%,1/16W,TP,1005	12	SNA
...4		2007-001295	R-CHIP;39ohm,5%,1/16W,TP,1005	1	SNA
...4		2007-001301	R-CHIP;68ohm,5%,1/16W,TP,1005	3	SA
...4		2007-001313	R-CHIP;330ohm,5%,1/16W,TP,1005	2	SNA
...4		2007-001325	R-CHIP;3.3Kohm,5%,1/16W,TP,1005	1	SNA
...4		2007-001333	R-CHIP;18Kohm,5%,1/16W,TP,1005	2	SNA
...4		2007-002970	R-CHIP;56ohm,5%,1/16W,TP,1005	4	SA
...4		2007-003015	R-CHIP;2.2ohm,5%,1/16W,TP,1005	4	SNA
...4		2007-007001	R-CHIP;3.9Kohm,5%,1/16W,TP,1005	1	SA
...4		2007-007107	R-CHIP;100Kohm,1%,1/16W,TP,1005	4	SNA
...4		2007-007135	R-CHIP;18Kohm,1%,1/16W,TP,1005	4	SNA
...4		2007-007136	R-CHIP;4.7Kohm,1%,1/16W,TP,1005	1	SNA
...4		2007-007142	R-CHIP;10Kohm,1%,1/16W,TP,1005	4	SNA
...4		2007-007156	R-CHIP;1ohm,5%,1/16W,TP,1005	2	SNA
...4		2007-007306	R-CHIP;100ohm,1%,1/16W,TP,1005	2	SNA
...4		2007-007311	R-CHIP;22Kohm,1%,1/16W,TP,1005	6	SA
...4		2007-007312	R-CHIP;20Kohm,1%,1/16W,TP,1005	1	SA
...4		2007-007316	R-CHIP;3.3Kohm,1%,1/16W,TP,1005	1	SNA
...4		2007-007318	R-CHIP;1Kohm,1%,1/16W,TP,1005	29	SNA
...4		2007-007470	R-CHIP;7.5Kohm,1%,1/16W,TP,1005	2	SNA
...4		2007-007488	R-CHIP;75Kohm,1%,1/16W,TP,1005	1	SNA
...4		2007-007517	R-CHIP;240ohm,1%,1/16W,TP,1005	3	SNA
...4		2007-007538	R-CHIP;56Kohm,1%,1/16W,TP,1005	1	SA

Exploded Views and Parts List

Level	Loc.	Part Code	Description & Specification	Qty.	SA/SNA
...4		2007-007671	R-CHIP;11Kohm,1%,1/16W,TP,1005	1	SA
...4		2007-007766	R-CHIP;2Kohm,1%,1/16W,TP,1005	1	SNA
...4		2007-007942	R-CHIP;1Mohm,1%,1/16W,TP,1005	1	SNA
...4		2007-008015	R-CHIP;75ohm,1%,1/16W,TP,1005	8	SNA
...4		2007-008275	R-CHIP;30Kohm,1%,1/16W,TP,1005	1	SNA
...4		2007-008294	R-CHIP;33ohm,1%,1/16W,TP,1005	1	SA
...4		2007-008332	R-CHIP;11.5Kohm,1%,1/16W,TP,1005	1	SA
...4		2007-008779	R-CHIP;0ohm,1%,1/16W,TP,1005	2	SA
...4		2011-001261	R-NETWORK;33ohm,5%,1/16W,L,CHIP,8P,TP,2.	8	SA
...4		2011-001344	R-NETWORK;100ohm,5%,1/16W,L,CHIP,8P,TP,2	4	SA
...4		2011-001345	R-NETWORK;10Kohm,5%,1/16W,L,CHIP,8P,TP,2	1	SA
...4		2011-001449	R-NETWORK;22ohm,5%,1/16W,L,4P,TP,1010	4	SA
...4		2011-001506	R-NETWORK;10Kohm,5%,1/16W,L,CHIP,4P,TP,1	3	SNA
...4		2011-001527	R-NETWORK;4.7Kohm,5%,1/16W,L,CHIP,4P,TP,	2	SNA
...4		2011-001587	R-NETWORK;100ohm,5%,1/16W,L,CHIP-V,4P,TP	4	SNA
...4	AD480	2203-000233	C-CER,CHIP;0.1nF,5%,50V,C0G,TP,1005	7	SA
...4	AD480	2203-000278	C-CER,CHIP;0.01nF,0.5pF,50V,C0G,TP,1005	4	SA
...4	AD480	2203-000438	C-CER,CHIP;1nF,10%,50V,X7R,TP,1005	13	SA
...4	AD480	2203-000489	C-CER,CHIP;2.2nF,10%,50V,X7R,TP,1005	8	SA
...4	AD480	2203-000530	C-CER,CHIP;2.7nF,10%,50V,X7R,TP,1005,-	2	SNA
...4	AD480	2203-000627	C-CER,CHIP;0.022nF,5%,50V,C0G,TP,1005	1	SNA
...4	AD480	2203-000679	C-CER,CHIP;0.027nF,5%,50V,C0G,TP,1005	2	SA
...4	AD480	2203-000714	C-CER,CHIP;3.3nF,10%,50V,X7R,TP,1005	4	SA
...4	AD480	2203-000812	C-CER,CHIP;0.033nF,5%,50V,C0G,TP,1005	7	SA
...4	AD480	2203-000995	C-CER,CHIP;0.047nF,5%,50V,C0G,TP,1005	4	SA
...4	AD480	2203-002285	C-CER,CHIP;10nF,10%,50V,X7R,TP,1005	13	SNA
...4	AD480	2203-002525	C-CER,CHIP;0.56nF,10%,50V,X7R,TP,1005	4	SNA
...4	AD480	2203-002711	C-CER,CHIP;100nF,10%,25V,X7R,TP,1608	2	SA
...4	AD480	2203-005249	C-CER,CHIP;100nF,10%,50V,X7R,TP,1608	12	SNA
...4	AD480	2203-005344	C-CER,CHIP;22nF,10%,25V,X7R,TP,1005,0.5T	4	SNA
...4	AD480	2203-005642	C-CER,CHIP;0.22nF,5%,50V,NP0,TP,1005	1	SNA
...4	AD480	2203-006048	C-CER,CHIP;100nF,10%,10V,X7R,TP,1005	98	SA
...4	AD480	2203-006126	C-CER,CHIP;47nF,10%,16V,X7R,TP,1005	11	SNA
...4	AD480	2203-006158	C-CER,CHIP;100nF,10%,16V,X7R,TP,1005,0.5	7	SNA
...4	AD480	2203-006260	C-CER,CHIP;220nF,10%,10V,X5R,TP,1005	8	SNA
...4	AD480	2203-006324	C-CER,CHIP;2200nF,10%,10V,X5R,TP,1608	7	SA
...4	AD480	2203-006348	C-CER,CHIP;1000nF,10%,25V,X5R,TP,1608,0.	5	SA
...4	AD480	2203-006361	C-CER,CHIP;10000nF,10%,10V,X5R,TP,2012	10	SC
...4	AD480	2203-006399	C-CER,CHIP;1000nF,10%,6.3V,X5R,TP,1005	1	SA
...4	AD480	2203-006474	C-CER,CHIP;22000nF,20%,6.3V,X5R,TP,2012	21	SA

Level	Loc.	Part Code	Description & Specification	Qty.	SA/SNA
...4	AD480	2203-006562	C-CER,CHIP;1000nF,10%,10V,X5R,TP,1005	20	SNA
...4	AD480	2203-006636	C-CER,CHIP;220nF,10%,25V,X7R,TP,1608	2	SA
...4	AD480	2203-006824	C-CER,CHIP;4700nF,10%,10V,X5R,TP,1608	5	SNA
...4	AD480	2203-006842	C-CER,CHIP;0.47nF,5%,50V,C0G,TP,1005	1	SNA
...4	AD480	2203-006890	C-CER,CHIP;10000nF,20%,6.3V,X5R,TP,1608	21	SNA
...4	AD480	2203-006960	C-CER,CHIP;1000nF,10%,50V,X7R,TP,2012	1	SNA
...4	AD480	2203-006992	C-CER,CHIP;0.33nF,5%,50V,C0G,TP,1005	2	SNA
...4	AD480	2203-007176	C-CER,CHIP;10000nF,10%,16V,X5R,TP,2012,1	6	SNA
...4	AD480	2203-007240	C-CER,CHIP;22000nF,20%,6.3V,X5R,TP,1608,	2	SA
...4	AD480	2203-007269	C-CER,CHIP;22000nF,20%,10V,X5R,TP,2012,0	30	SNA
...4	AD480	2203-007270	C-CER,CHIP;10000nF,10%,10V,X5R,TP,1608,0	4	SNA
...4	AD480	2203-007513	C-CER,CHIP;10000nF,10%,10V,X5R,TP,1608,0	6	SA
...4	AD480	2203-007544	C-CER,CHIP;100nF,10%,50V,X7R,TP,1005	4	SA
...4		2703-000158	INDUCTOR-SMD;1uH,10%,2012,40ohm,50mA,45,	4	SA
...4		2703-000213	INDUCTOR-SMD;470nH,10%,1608,1.35Ohm,35mA	1	SA
...4		2703-001938	INDUCTOR-SMD;56nH,5%,1005,1.5Ohm,200mA,1	3	SA
...4		2703-003149	INDUCTOR-SMD;2.2uH,20%,5050,0.055Ohm,300	1	SA
...4		2703-003713	INDUCTOR-SMD;1.5uH,20%,7366,0.015ohm,700	3	SA
...4		2703-003790	INDUCTOR-SMD;4.7uH,20%,8080,0.025ohm,450	2	SA
...4		2703-003930	INDUCTOR-SMD;4.7uH,20%,5050,0.072Ohm,245	4	SA
...4		2801-003326	CRYSTAL-SMD;24MHz,30ppm,28-ABX,20pF,50oh	1	SA
...4		3301-000314	BEAD-SMD;120ohm,1608,TP,120ohm/100MHz	7	SNA
...4		3301-002039	BEAD-SMD;26ohm,1608,TP	32	SA
...4		3601-001374	FUSE-SURFACE MOUNT;32V,5A,FAST-ACTING,PL	1	SA
...4		3701-001856	CONNECTOR-HDMI;19P,2ROW,FEMALE,SMD-S,AU	1	SA
...4		3701-001861	CONNECTOR-HDMI;19P,2ROW,FEMALE,SMD-A,AU	2	SA
...4		3707-001106	CONNECTOR-OPTICAL;STRAIGHT W/L,SPDIF	1	SA
...4		3708-003073	CONNECTOR-FPC/FFC/PIC;51P,0.5mm,SMD,AU,N	1	SA
...4		3710-003908	CONNECTOR-SOCKET;64P,2R,0.5mm,SMD-S,AU,B	1	SA
...4	EH01	3711-008131	HEADER-BOARD TO CABLE;BOX,4P,1R,2.5mm,AN	1	SA
...4	EH01	3711-008453	HEADER-BOARD TO CABLE;BOX,18P,2R,2mm,ANG	1	SA
...4	EH01	3711-008558	HEADER-BOARD TO CABLE;BOX,26P,2R,1.25mm,	1	SA
...4		3722-003229	JACK-MODULAR;8P/8C W/L,Y,STRAIGHT,N,Au,1	1	SA
...4		3722-003457	JACK-USB;4P/1C,NI,BLK,A	2	SA
...4	JACK PIN	3722-003546	JACK-PIN;5P+Screw hole,NI+SN,G,Y/BLU/RED	1	SA
...4		3722-003617	JACK-PHONE;14P/2C,SN,BLK,STRAIGHT,3.6PI,	1	SA
...4		3722-003655	JACK-SCART;21P,SN,BLK	1	SA
...4	ET01	BN40-00282A	TUNER;DTOS40EIH276A,DTOS40EIH276A,DVB-TC	1	SA
...4		BN41-02156A	PCB MAIN;X14H, EU, LED 6 Series,FR-4,4,A	1	SNA
...4		BN97-08274A	ASSY MICOM;T-MST14DEUC-XXXX,X14H,U8DC,EU	1	SNA

## Exploded Views and Parts List

Level	Loc.	Part Code	Description & Specification	Qty.	SA/SNA
....5		1107-002290	IC-EMMC;MTFC4GMCAM-1M WT,4Gbyte,BGA,153P	1	SA
...4		BN97-08278A	ASSY MICOM;T-MST14DEUS-1004,2014.02.27	1	SNA
....5		1107-002226	IC-NOR FLASH;W25Q40CLSSIP,4Mbit,SOIC,8P,	1	SNA
...4		BN97-08425A	ASSY MICOM-BLASTER;Blaster-Version:* **,	1	SNA
....5		BN13-00067A	PLD;MAXQ636V-2584+T,WLP,9	1	SNA
...3		BN97-08279A	ASSY DRM-KEY;H6*,EU,X14	1	SNA
...4		BN46-00109H	KEY CODE-CERTIFI;MAC,TV/AV,General	1	SNA
...4		BN46-00110N	KEY CODE-CERTIFI;MIRACAST,TV,X12 /X13	1	SNA
...4		BN46-00115K	KEY CODE-CERTIFI;CI+,TV,X14, EU	1	SNA
1		BN91-12035B	ASSY LCM-AMLCD;BN95-01317B,CY-GH048BGLV2	1	SNA
2	PANEL	BN95-01317B	PRODUCT LCD-AMLCD;LSF480HN01-G,CY-GH048B	1	SA
...3	SCREW	6001-003075	SCREW-MACHINE;BH,+,M3,L4,ZPC(WHT),SWRCH1	2	SA
...3	SCREW	6001-003083	SCREW-MACHINE;CH,+,M3,L8,ZPC(BLK),SWRCH1	5	SA
...3		BN60-00667C	SPACER-GASKET;Y13 SF-LED,GASKET(FG200A),	2	SNA
...3		BN62-00504C	INSULATION-SOURCE PCB L;Y14 VNB 48",PC,0	1	SNA
...3		BN62-00504D	INSULATION-SOURCE PCB R;Y14 VNB 48",PC,0	1	SNA
...3		BN68-05722A	LABEL-STICKER;ALL MODEL,POLYPROPYLENE,0.	1	SNA
...3		BN90-05183A	ASSY MISC-BLU;H5000 48",CY-GH048	1	SNA
...4		BN02-00152H	TAPE ETC-SHEET FIXING;Y13 Slim F-LED,PET	1	SNA
...4		BN61-10113A	SUPPORT-PLATE;Y14 F-LED,PC,V2,CLEAR,OD-1	14	SNA
...4		BN61-10228A	LGP-DIFFUSERS PLATE;48inch Diffuser Plat	1	SNA
...4		BN63-11821A	SHEET-COMPLEX;Y14 48inch VNB DMOP/UTA11C	1	SNA
...4		BN63-11825A	SHEET-REFLECTOR;Y14 48" VNB SY95S,PET*,0	1	SNA
...4		BN96-30453A	ASSY LED BAR P;48inch FHD Dire,FCPkg,6ea	6	SNA
...4		BN96-30454A	ASSY LED BAR P;48inch FHD Dire,FCPkg,3ea	6	SNA
...4		BN96-30685A	ASSY FRAME P-MOLD MIDDLE(U);H5K,5.5K 48"	1	SNA
....5		BN61-10079A	FRAME-MOLD MIDDLE(UD);Y14 F-LED 48" (5K)	1	SNA
...4		BN96-30687A	ASSY FRAME P-MOLD MIDDLE(D);H5K,5.5K 48"	1	SNA
....5		BN60-00735R	SPACER-MIDDLE;Y14 VNB 48,PET,L420,NTR,T0	1	SNA
....5		BN60-00735U	SPACER-MIDDLE;Y14 VNB 48,PET,L590,NTR,T0	1	SNA
....5		BN60-00744C	SPACER-RUBBER;Y14 SF-LED VNB,SH-0140U+AT	1	SNA
....5		BN60-00815F	SPACER-PANEL (UD);14 SF-LED 48,SHEET+SIL	2	SNA
....5		BN61-10177A	FRAME-MOLD MIDDLE(D);Y14 F-LED 48" (5K),	1	SNA
...4		BN96-30689A	ASSY FRAME P-MOLD MIDDLE(LR);H5K~6.5K 48	2	SNA
....5		BN60-00815G	SPACER-PANEL (LR);14 SF-LED 48,SHEET+SIL	2	SNA
....5		BN61-10080A	FRAME-MOLD MIDDLE(LR);Y14 F-LED 48" (5K)	2	SNA
...4		BN96-30690F	ASSY CHASSIS BOTTOM P;Y14 VNB 48,SECC T0	1	SNA
....5		BN02-00040C	TAPE DOUBLE FACE-D-PLATE;F-LED ALL,MKT50	2	SNA
....5		BN02-00074A	TAPE PET;CCFL 32"/40",3M1360NH(B),T0.05,	9	SNA
....5		BN02-00094A	TAPE PET;Y12 F-LED,MT-PFR,T 0.05,W30,L40	16	SNA



Level	Loc.	Part Code	Description & Specification	Qty.	SA/SNA
....5		BN02-00324A	TAPE ABSORBER-DUST;Y14 4K,3M 244,0.085T,	0	SNA
....5		BN61-10100A	HOLDER-MIDDLE(U);Y14 F-LED 48" (5K),PC+G	1	SNA
....5		BN61-10101A	HOLDER-MIDDLE(LR);Y14 F-LED 48" (5K),PC+	2	SNA
....5		BN61-10185A	HOLDER-MIDDLE(D);Y14 F-LED 48" (5K),PC+G	1	SNA
....5		BN61-10207A	HOLDER-WALL RIVET;Y14 F-LED 32",SWRCH10A	4	SNA
....5		BN62-00501D	INSULATION-PD BOARD;Y14 VNB 39_40_42_48	1	SNA
....5	T0073	BN63-03871A	GASKET-EMI;58P9,Fabric,2,15,11	4	SNA
....5	CC02	BN64-02518A	CHASSIS-BOTTOM;Y14 F-LED 48" (VNB),EGI-S	1	SNA
....5		BN96-30418A	ASSY BOARD P-LED INTERFACE B'D;48inch FH	1	SNA
..3	TCON	BN95-01306A	ASSY T CON;LSF480HN01-G,48F60 VNB	1	SA
..4		BN97-07971A	ASSY SMD;BN95-01306A	1	SNA
....5		0202-001899	SOLDER-CREAM;M705-GRN360-K2-VT,25-36um,S	1	SNA
....5		0406-001317	DIODE-TVS;SMAJ14A,15.6/-/17.2V,400W,SMA	2	SNA
....5		0406-001445	DIODE-TVS;RClamp7512N,2.7/2.8/2.9,300W,S	2	SA
....5		0406-001578	DIODE-TVS;P4SMAJ40A,44.4,51.1,400W,SMA	1	SA
....5	EL02	0601-002037	LED;SMD(TOP VIEW),BLUE,1.6x0.8mm,465/470	3	SA
....5		1203-007955	IC-DC/DC CONVERTER;BM81222MWV,QFN,48P,6x	1	SNA
....5		1203-007966	IC-DC/DC CONVERTER;BM81224MUV,QFN,36P,6x	1	SNA
....5		1405-001381	VARISTOR;11V,8VDC,30A,1.6x0.8x0.9mm,TP,2	3	SA
....5		1405-001382	VARISTOR;24.5V,16VDC,120A,2.0x1.25x1.1mm	2	SA
....5		2007-000039	R-CHIP;0ohm,1%,1/10W,TP,1608	4	SA
....5		2007-000052	R-CHIP;10Kohm,1%,1/10W,TP,1608	2	SA
....5		2007-000060	R-CHIP;100Kohm,1%,1/10W,TP,1608	2	SNA
....5		2007-000067	R-CHIP;15Kohm,1%,1/10W,TP,1608	1	SNA
....5		2007-000092	R-CHIP;15Kohm,5%,1/10W,TP,1608	1	SA
....5		2007-000113	R-CHIP;33ohm,5%,1/10W,TP,1608	1	SA
....5		2007-000138	R-CHIP;100ohm,5%,1/16W,TP,1005	4	SA
....5		2007-000148	R-CHIP;10Kohm,5%,1/16W,TP,1005	1	SA
....5		2007-000171	R-CHIP;0ohm,5%,1/16W,TP,1005	8	SNA
....5		2007-000287	R-CHIP;100ohm,1%,1/10W,TP,1608	3	SNA
....5		2007-000336	R-CHIP;120Kohm,1%,1/10W,TP,1608	2	SA
....5		2007-000570	R-CHIP;220ohm,1%,1/10W,TP,1608	1	SA
....5		2007-000708	R-CHIP;3.9Kohm,1%,1/10W,TP,1608	1	SNA
....5		2007-000736	R-CHIP;30Kohm,1%,1/10W,TP,1608	1	SA
....5		2007-000763	R-CHIP;330ohm,1%,1/10W,TP,1608	1	SNA
....5		2007-000779	R-CHIP;33ohm,1%,1/10W,TP,1608	9	SA
....5		2007-000821	R-CHIP;390ohm,1%,1/10W,TP,1608	1	SNA
....5		2007-000869	R-CHIP;4.7Kohm,1%,1/10W,TP,1608	1	SA
....5		2007-000939	R-CHIP;47Kohm,1%,1/10W,TP,1608	1	SA
....5		2007-000962	R-CHIP;5.1Kohm,1%,1/10W,TP,1608	2	SA

Exploded Views and Parts List

Level	Loc.	Part Code	Description & Specification	Qty.	SA/SNA
....5		2007-001068	R-CHIP;6.8Kohm,1%,1/10W,TP,1608	1	SA
....5		2007-001240	R-CHIP;910ohm,5%,1/10W,TP,1608	1	SNA
....5		2007-001298	R-CHIP;51ohm,5%,1/16W,TP,1005	5	SNA
....5		2007-002768	R-CHIP;6.2Kohm,1%,1/10W,TP,1608	1	SA
....5		2007-007135	R-CHIP;18Kohm,1%,1/16W,TP,1005	1	SNA
....5		2007-007136	R-CHIP;4.7Kohm,1%,1/16W,TP,1005	10	SNA
....5		2007-007306	R-CHIP;100ohm,1%,1/16W,TP,1005	2	SNA
....5		2007-007315	R-CHIP;3.9Kohm,1%,1/16W,TP,1005	1	SNA
....5		2007-007590	R-CHIP;82Kohm,1%,1/16W,TP,1005	1	SNA
....5		2007-007698	R-CHIP;5.1Kohm,1%,1/16W,TP,1005	2	SNA
....5		2007-008117	R-CHIP;2.7Kohm,1%,1/16W,TP,1005	2	SA
....5		2007-008263	R-CHIP;3Kohm,1%,1/16W,TP,1005	1	SA
....5		2011-001264	R-NETWORK;10ohm,5%,1/16W,L,CHIP,8P,TP,2.	4	SNA
....5	AD480	2203-000254	C-CER,CHIP;10nF,10%,16V,X7R,TP,1005	1	SA
....5	AD480	2203-000715	C-CER,CHIP;3.3nF,10%,50V,X7R,TP,1608	1	SNA
....5	AD480	2203-001414	C-CER,CHIP;330nF,10%,50V,X7R,TP,2012	1	SNA
....5	AD480	2203-002711	C-CER,CHIP;100nF,10%,25V,X7R,TP,1608	2	SA
....5	AD480	2203-005138	C-CER,CHIP;1.8nF,10%,50V,X7R,TP,1005	1	SA
....5	AD480	2203-005249	C-CER,CHIP;100nF,10%,50V,X7R,TP,1608	1	SNA
....5	AD480	2203-005918	C-CER,CHIP;1000nF,10%,6.3V,X7R,TP,1608	2	SNA
....5	AD480	2203-006048	C-CER,CHIP;100nF,10%,10V,X7R,TP,1005	2	SA
....5	AD480	2203-006158	C-CER,CHIP;100nF,10%,16V,X7R,TP,1005,0.5	13	SNA
....5	AD480	2203-006399	C-CER,CHIP;1000nF,10%,6.3V,X5R,TP,1005	10	SA
....5	AD480	2203-006460	C-CER,CHIP;2200nF,10%,16V,X5R,TP,1608,-	4	SA
....5	AD480	2203-006698	C-CER,CHIP;1000nF,10%,25V,X7R,TP,1608,0.	12	SNA
....5	AD480	2203-006890	C-CER,CHIP;10000nF,20%,6.3V,X5R,TP,1608	5	SNA
....5	AD480	2203-006960	C-CER,CHIP;1000nF,10%,50V,X7R,TP,2012	1	SNA
....5	AD480	2203-007176	C-CER,CHIP;10000nF,10%,16V,X5R,TP,2012,1	20	SNA
....5	AD480	2203-007240	C-CER,CHIP;22000nF,20%,6.3V,X5R,TP,1608,	7	SA
....5	AD480	2203-007306	C-CER,CHIP;10000nF,10%,25V,X5R,TP,2012,1	19	SNA
....5	AD480	2203-007425	C-CER,CHIP;2200nF,10%,25V,X5R,TP,1608,0.	1	SNA
....5	AD480	2203-007544	C-CER,CHIP;100nF,10%,50V,X7R,TP,1005	1	SA
....5		2703-003747	INDUCTOR-SMD;22uH,20%,6060,0.135ohm,1300	2	SA
....5		2703-003862	INDUCTOR-SMD;10uH,20%,6060,0.065ohm,1900	2	SA
....5		2703-003913	INDUCTOR-SMD;2.2uH,20%,2520,1.2T,0.116Oh	1	SNA
....5		2901-001362	FILTER-EMI/ESD;5.5V,0A,50pF,2.05x1.25x0.	1	SNA
....5		3301-002039	BEAD-SMD;26ohm,1608,TP	18	SA
....5		3601-001038	FUSE-SURFACE MOUNT;125V,3A,FAST-ACTING,C	1	SA
....5		3708-003073	CONNECTOR-FPC/FFC/PIC;51P,0.5mm,SMD,AU,N	1	SA
....5		3708-003176	CONNECTOR-FPC/FFC/PIC;68P,0.5mm,SMD-A,AU	2	SA

Level	Loc.	Part Code	Description & Specification	Qty.	SA/SNA
...5	EH01	3711-005601	HEADER-BOARD TO CABLE;BOX,8P,1R,2mm,SMD-	1	SA
...5		BN13-00064A	IC ASIC;S6T0LT3,EF11,169,3.3,-20to+70C,F	1	SA
...5		BN41-02111A	PCB-T CON;2014 FHD 60Hz,FR-4,4,1.0T,150*	1	SNA
...5		BN97-08159B	ASSY MICOM;0H48A6F110_140122_MP,2014.02.	1	SNA
....6		1103-001565	IC-EEPROM;M24C64-WMN6TPK,100pF,SO8,8Q,4.	1	SA
..3		BN96-30179A	ASSY OPEN CELL;LSF480HN01-G,8bit,48 INCH	1	SNA
...4		BN81-07434A	A/S-ADHESIVE-A.C.F(CP);ADHESIVE-A.C.F,1-	1	SNA
...4		BN81-07943A	A/S-ADHESIVE-A.C.F(TP500B);ADHESIVE-A.C.	1	SNA
...4		BN81-09623A	A/S-IC DRIVER SOURCE;IC DRIVER SOURCE,S6	1	SNA
...4		BN81-09624A	A/S-POLARIZER-TFT;POLARIZER-TFT,SMLK41FP	1	SNA
...4		BN81-09625A	A/S-POLARIZER-C/F;POLARIZER-C/F,SMLK41FP	1	SNA
...4		BN81-09626A	A/S-ASSY PCB-SOURCE(L);ASSY PCB-SOURCE(L	1	SNA
...4		BN81-09627A	A/S-ASSY PCB-SOURCE(R);ASSY PCB-SOURCE(R	1	SNA
..3	TC01A	BN96-30693A	ASSY CHASSIS TOP P;H5.5K 48",PC+ABS-(GF1	1	SA
...4		BN60-00930G	SPACER-TOP(UD);Y14 VNB 48",GASKET+PET,L1	2	SNA
...4		BN60-00930H	SPACER-TOP(LR);Y14 VNB 48",GASKET+PET,L5	2	SNA
...4		BN60-00997A	SPACER-GASKET;Y14 SF-LED,GASKET(DW 1200	3	SNA
...4	AS080	BN63-10945C	SHEET-COVER;Y13 SF-LED,PO-SHEET,T0.068,W	2	SNA
...4		BN63-11875A	SHEET-COVER;Y14 SF-LED,POLY*,0.068,W25,L	2	SNA
...4	FW04	BN64-02480A	WINDOW-RMC;UH5500 40",PC,V2,Violet, T25%	1	SNA
...4	AC157	BN64-02495A	CHASSIS-TOP;Y14 F-LED 48" (5.5K-6K),PC+A	1	SNA
..3	OC-TC	BN96-30720A	ASSY CABLE P-FFC;H5000,FFC,NH,54mm 1,68	2	SNA
1		BN91-12234T	ASSY SHIELD;UN40F6400AFXZA	1	SNA
.2	SCREW	6001-003081	SCREW-MACHINE;PWH,+,M3,L5,ZPC(WHT),SWRCH	9	SA
.2		BN02-00102B	TAPE FILAMENT;UE7000,#8917,0.15,25,50,WH	0	SNA
.2	EC13	BN39-01884B	LEAD CONNECTOR;UN40H5200AF,Lead Connecto	1	SA
.2	M-F	BN39-01888C	LEAD CONNECTOR-FUNCTION;UH5500 48",Lead	1	SA
.2	EC13	BN39-01889J	LEAD CONNECTOR;UE48H6300,Flat Connector,	1	SA
.2	P001A	BN44-00703A	DC VSS-LED TV PD BD;L48S1_ESM,L48S1_ESM,	1	SA
.2	WIFI	BN59-01174A	NETWORK-WIFI MODULE;WIDT-30Q,Internal Wi	1	SA
.2	CD01A	BN95-01397E	ASSY DECORATION SMT;UH5500,48,LIGHT TITA	1	SA
..3		0203-001269	TAPE-OPP MASKING;#301,T0.06,W75,L50000,N	0	SNA
..3		BN01-00160A	TARGET-CHROMIUM-CY;Chromium target,99.95	1	SNA
..3		BN01-00161A	TARGET-CHROMIUM-PL;chromium target,over	1	SNA
..3		BN01-00168A	COATING-AFS;99.5% AFS,99.50%,1.5,AF Sput	2	SNA
..3	FD01	BN63-11615A	COVER-DECORATION;UH5500 46",PC+ABS+G/F15	1	SNA
...4		0103-010275	RESIN PC ABS;235GNH15/6919H,Black,BK0007	165	SNA
..3	AS108	BN63-12354D	SHEET-PROTECTION;UH5500,PET,0.04,W10mm,1	1	SNA
..3		BN69-10522D	PACKING-TRAY;TRAY 48"-50",PAPER,-,-,30,5	1	SNA
..3		BN69-10523E	BOX-SMT;48"-50" SMT DECORATION,PAPER,-,-	1	SNA

Exploded Views and Parts List

Level	Loc.	Part Code	Description & Specification	Qty.	SA/SNA
..3		BN69-10617L	PACKING-SHEET SMT;48"-50" INHOUSE,HDPE,P	1	SNA
.2	SP01A	BN96-30334A	ASSY SPEAKER P;6ohm,10W,Enclosure_H5k	1	SA
.2	FB01A	BN96-30902C	ASSY BOARD P-FUNCTION ASSY;UH5500,Funci	1	SA
..3	JOG	BN96-30902A	ASSY BOARD P-JOG SWITCH PBA;UH5000,Func	1	SNA
..3	IR	BN96-30904A	ASSY BOARD P-IR PBA;UH5500,Function Assy	1	SNA
.2	FL06	BN96-31530Z	ASSY CABLE P-FFC;UE48H5500,FFC,NH,450mm,	1	SA
1		BN92-13975C	ASSY P/MATERIAL;UH5K	1	SNA
.2		0203-001595	TAPE-OPP MASKING;OPP-2,0.075,75,800M,CLR	3	SNA
.2		6902-000379	BAG AIR;LDPE,T0.2,W1000,L1800,TRP,1260.0	1	SNA
.2		6902-001956	BAG ROLL;HDPE/PE FOAM,HDPE T0.018mm,T0.2	2	SNA
.2		6922-000003	BAND PP;PP,T0.8,W18,L1650M,TRP,DA69-9014	0	SNA
.2		BN68-02422B	LABEL-WARNING SHIPPING;ALL MODEL,A/P 100	1	SNA
.2		BN69-03982L	PAD PACKING-EDGE;EDGE,PAPER,-,T5,W100,L2	1	SNA
.2		BN69-05418A	PACKING-BAG WRAPPING;-LDPE,-,0,019,500,	3	SNA
.2		BN69-06640A	PACKING-PAD;PAD,PAPER,-,-,CB-SW4,1120,95	1	SNA
.2		BN69-06640E	PACKING-TRUCK PAD;TRUCK PAD,PAPER,-,-,DW	1	SNA
.2		BN69-09347J	PALLET;48" H5000,WOOD,17mm,1070,1300,144	1	SNA
.2		BN69-09568A	CUSHION-SET;UH5000/5500 48",EPS,16.7g/l,	1	SNA
.2		BN69-09784A	CUSHION-FRONT;UH5000-50,EPS	1	SNA
..3		0103-005099	RESIN-EPS;BASF303,Natural,Natural	82	SNA
1		BN92-14045P	ASSY BOX;UH5K	1	SNA
.2		BH68-00662A	LABEL BOX-01;ALL MODEL,ART PAPER,60,110,	1	SNA
.2		BN68-05640A	LABEL-01,BOX;ALL MODEL,ART PAPER 90G,110	1	SNA
.2		BN69-09889E	BOX-SET;48UH5500-SS,CB,A-01,DW2,YEL,W127	1	SNA
1		BN92-14074T	ASSY LABEL;UN40F6400AFXZA	1	SNA
.2		0203-001598	TAPE-FILAMENT;#8915,0.15,12,55000,CLR	0	SNA
.2		BN68-06017A	LEAFLET-QSG;UH5500/5570,SAMSUNG,wordless	1	SNA
.2		BN68-06129A	LABEL-HIGHLIGHT POP;H70XX, H65XX, H64XX,	1	SNA
.2	T0527	BP68-00052B	LABEL-00,RATING;FPTV,PET,T0.05,93,73	1	SNA
1	ACCE1	BN92-15117C	ASSY ACCESSORY;UH5900 48	1	SNA
.2		BN68-05417B	LABEL-STICKER;ALL,EDC,Polypropylene,T0.1	1	SNA
.2		BN96-31491M	ASSY ACCESSORY MANUAL;UH5K	1	SNA
..3		6902-001964	BAG PE;LDPE,BIOBASED,T0.03,W200,L300,TRP	1	SNA
..3		BN68-03548J	LEAFLET-06,WARRANTY CARD;comm,Samsung,17	1	SNA
..3		BN68-04972A	MANUAL FLYER-05,REGULATORY GUI;ALL,SAMSU	1	SNA
..3		BN68-05944R	LEAFLET-02,FICHE;UH55Series,EU,W/P,B5	1	SNA
..3		BN68-06010C	MANUAL USERS;UH5500,16LANGS,XH,W/P*,EURO	1	SNA
.2		BN96-31515G	ASSY ACCESSORY CABLE;UH5K	1	SNA
..3		3709-001791	CONNECTOR-CARD SLOT;64P,0.5mm,SMD-A,AU,P	1	SA
..3	T0268	3903-000849	CBF-POWER CORD;DT,CEE,LP-21L,250V,2.5A,B	1	SC

Level	Loc.	Part Code	Description & Specification	Qty.	SA/SNA
..3		4301-000121	BATTERY-MN;1.5V,R03,10.5x44.5m,7.5g,AAA	2	SNA
..3		6902-001965	BAG PE;LDPE,BIOBASED,T0.05,W200,L300,TRP	1	SNA
..3	REMO2	BN59-01178B	REMOCON;TM1250A,49,3.0V,TM1250A_EUROPE(W	1	SA
..3	HOLDER	BN61-08370A	HOLDER-WIRE STAND;26UE4000 GUIDE STAND,N	1	SA
..3	T0527	BN68-00513A	LABEL-E,PASS;ALL MODEL,YUPO(110G),BLACK,	1	SNA
..3	CAIR	BN96-31644A	ASSY CABLE P;IR BLASTER,UL1185 28AWG,LS0	1	SA