

1. Exploded View & Part List

Exploded View

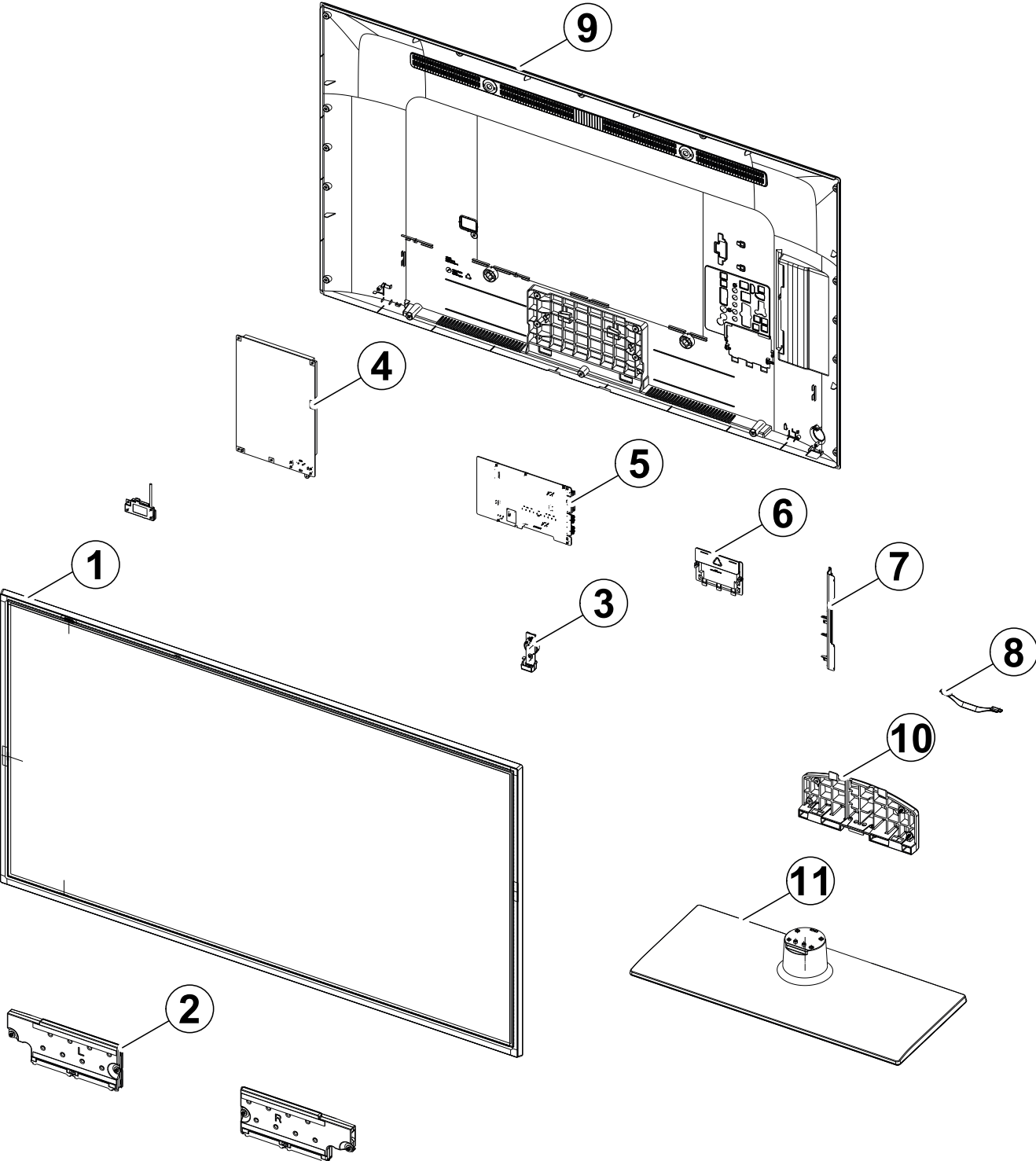

Parts List

No.	Lvl.	Loc.	Material Code	Description & Specification	SNA	Qty.
1	2	PANEL	BN95-00891A	PRODUCT LCD-AMLCD; LSF460HN02,CY-HF460BGL	SA	1
2	2	SP01A	BN96-25565B	ASSY SPEAKER P; 6ohm,10W,Enclosure_6000	SA	1
3	3	FB01A	BN96-26411C	ASSY BOARD P-JOG SWITCH & IR; UE46F5000,F	SA	1
4	2	P001A	BN44-00610B	DC VSS-LED TV PD BD; L46SF_DPN,L46SF_DPN,	SA	1
5	2	M0014	BN94-06273G	ASSY PCB MAIN; UF5F,F5000	SA	1
6	2	FC05	BN63-10178B	COVER-JACK; UF6100,46,EO,MPPE,BK0020,V1	SNA	1
7	3		BN61-09059A	HOLDER-SIDE AV; UF6100,HIPS,BK0020,HB,EO/	SNA	1
8	2	FD01A	BN96-10973A	ASSY DECORATION P; UF5000,PC,V2,RD0005(SI	SA	1
9	2	R001A	BN96-25357A	ASSY COVER P-REAR; UF5000,46,EO,MPPE,V1,B	SA	1
10	2	SG01A	BN96-26469A	ASSY GUIDE P-STAND; UF5000,40,W/W,PC+G/F2	SA	1
11	2	SB04A	BN96-25361A	ASSY STAND P-BASE; UF5000,40,PC+ABS+G/F20	SA	1

2. Electrical Parts List

Level	Loc.	Part Code	Description & Specification	Qty.	SA/SNA
			UE46F5000AWXXN (TP01)		
1	S001A	BN90-04420A	ASSY STAND;UF5000 40	1	SNA
.2	SB04A	BN96-25361A	ASSY STAND P-BASE;UF5000,40,PC+ABS+G/F20	1	SA
..3		BN63-04755L	COVER-SHEET;22LC350,PE,T0.05,W130mm,200M	1	SNA
..3		BN63-10179A	COVER-STAND BASE;UF5000,40,PC+ABS+G/F20%	1	SNA
...4		0103-009946	RESIN-PC ABS;HM-1200,BLACK,BK0007,V1	1450	SNA
..3		BN67-00327D	RUBBER-FOOT;STAND,SILICON,13*13,T2,GRAY(6	SNA
..3		BN69-08751B	WRAP VINYL-SHRINK;STAND,PLASTIC OTHERS,P	1	SNA
.2	SG01A	BN96-26469A	ASSY GUIDE P-STAND;UF5000,40,W/W,PC+G/F2	1	SA
..3	SG03	BN61-08776A	GUIDE-STAND;UF6100,55,UO,PC+G/F20%	1	SNA
...4		0103-007285	RESIN-PC;MW32020GFU,K032202GFV,BK0007,V2	260	SNA
...4		BN68-00513D	LABEL-RESIN;resin,-,art paper,-,10,25,-,	1	SNA
..3	T0527	BN68-00513A	LABEL-E,PASS;ALL MODEL,YUPO(110G),50X15,	1	SNA
..3		BN69-08751A	WRAP VINYL-SHRINK;STAND,PLASTIC OTHERS,P	0	SNA
..3		BN96-18013E	ASSY ACCESSORY-SCREW;6003-001782,4EA,ALL	2	SNA
...4	SCREW	6003-001782	SCREW-TAPTYPE;BH,+,B,M4,L12,ZPC(BLK),SWR	8	SA
...4		BN69-08203E	PACKING-BAG-SCREW;LDPE,0.05,70,90,TRP,Vi	2	SNA
1	R001A	BN90-04431A	ASSY COVER REAR;UF5000 46	1	SNA
.2		6001-002755	SCREW-MACHINE;BH,+,M3,L6,ZPC(BLK),SWRCH1	4	SA
.2	SCREW	6003-001782	SCREW-TAPTYPE;BH,+,B,M4,L12,ZPC(BLK),SWR	16	SA
.2	R001A	BN96-25357A	ASSY COVER P-REAR;UF5000,46,EO,MPPE,V1,B	1	SA
..3		0203-001598	TAPE-FILAMENT;#8915,0.15,12,55000,CLR	0	SNA
..3	SCREW	6003-000115	SCREW-TAPTYPE;BH,+,B,M3,L6,ZPC(BLK),SWRC	2	SNA
..3	R001	BN63-10211A	COVER-REAR;UF5000,46,EO,MPPE,V1,BK0020	1	SNA
...4		0103-009565	RESIN-MPPE;ST855,1D129A,BK0020	1000	SNA
..3		BN63-10851A	SHEET-COVER;UF5000,PET,0.145,16,BLACK	2	SNA
..3	T0071	BN64-02224B	INLAY-TERMINAL;F4000/F5000,PS SHEET,T0.5	1	SNA
..3		BN68-04709G	LABEL-TERMINAL SIDE;UF4000,EO/CIS T2C,PE	1	SNA
..3		BN74-00052A	TAPE-PAPER;LB550,Crepe Paper,0.18mm,10m	0	SNA
..3	FB01A	BN96-26411C	ASSY BOARD P-JOG SWITCH & IR;UE46F5000,F	1	SA
...4	EC13	BN39-01764C	LEAD CONNECTOR;UE46F5000,Falt Connector,	1	SNA
...4		BN96-26411A	ASSY BOARD P-JOG SWITCH & IR;UE32F5000,F	1	SNA
1		BN90-04567A	ASSY W/I;UF5F,U46FF*	1	SNA
.2		BN81-08159K	PART SET-MECH W/I;UF5F,U46FF*	1	SNA
.2		BN81-08159Z	PART SET-ELEC W/I;UF4* ~ UF8* ELEC	1	SNA
1		BN91-10233A	ASSY LCM;BN95-00891A	1	SNA
.2	PANEL	BN95-00891A	PRODUCT LCD-AMLCD;LSF460HN02,CY-HF460BGL	1	SA
..3		6001-002757	SCREW-MACHINE;BH,+,M3,L4,ZPC(WHT),SWRCH1	6	SA

Exploded Views and Parts List

Level	Loc.	Part Code	Description & Specification	Qty.	SA/SNA
...3		BN02-00102B	TAPE FILAMENT;UE7000,#893,0.15,25,50,WHI	1	SNA
...3		BN68-02471A	LABEL-STICKER;WW,Art Paper,80,40,AV	1	SNA
...3		BN90-04393A	ASSY MISC-BLU;Slim F-LED,5K	1	SNA
...4		BN61-08639A	LGP-DIFFUSESR PLATE;46" Slim FLED_Diffus	1	SNA
...4		BN61-09304A	SUPPORT-PLATE;Y13 SLIM / VNB,PC,WHT + CL	10	SNA
...4		BN63-10449A	SHEET-DIFFUSER;DMOP-5T, 46inch, S-NNB,SH	1	SNA
...4		BN63-10450A	SHEET-REFLECTOR;UXJP175,SHEET*,0.175,104	1	SNA
...4		BN96-25100A	ASSY FRAME P-MOLD MIDDLE(U);Y13 F-LED SI	1	SNA
....5		BN61-08720A	FRAME-MOLD MIDDLE(U);Y13 F-LED Slim 46",	1	SNA
...4		BN96-25101A	ASSY FRAME P-MOLD MIDDLE(D);Y13 F-LED SI	1	SNA
....5		BN02-00152A	TAPE ETC-SHEET FIXING;Y13 Slim F-LED,PET	1	SNA
....5		BN60-00744A	SPACER-RUBBER;Y13 F-LED SLIM,SH-0140U+AT	1	SNA
....5		BN60-00748K	SPACER-PANEL (UP/DOWN);13 SF-LED 46,SILI	1	SNA
....5		BN61-08721A	FRAME-MOLD MIDDLE(D);Y13 F-LED Slim 46",	1	SNA
...4		BN96-25102A	ASSY FRAME P-MOLD MIDDLE(LR);Y13 F-LED S	2	SNA
....5		BN60-00748L	SPACER-PANEL (LR);13 SF-LED 46,SILICON+T	2	SNA
....5		BN60-00748M	SPACER-PANEL (CORNER);13 SF-LED 46,SILIC	4	SNA
....5		BN61-08722A	FRAME-MOLD MIDDLE(LR);Y13 F-LED Slim 46"	2	SNA
...4		BN96-25308A	ASSY MISC P-LED BAR;46inch Slim Direct L	8	SNA
...4		BN96-25309A	ASSY MISC P-LED BAR;46inch Slim Direct L	8	SNA
...4		BN96-25333A	ASSY MISC P-CHASSIS BOTTOM;Y13 SF-LED 46	1	SNA
....5		6001-002757	SCREW-MACHINE;BH,+,M3,L4,ZPC(WHT),SWRCH1	1	SA
....5		6001-003005	SCREW-MACHINE;BH,+,M3,L6,ZPC(WHT),SWRCH1	4	SNA
....5		BN02-00040C	TAPE DOUBLE FACE-D-PLATE;F-LED ALL,MKT50	2	SNA
....5		BN02-00043D	TAPE ETC-SHEET FIXING;Y13 slim F-LED,PET	2	SNA
....5		BN61-08161A	HOLDER-LED-PCB;Direct-LED,PC,white	1	SNA
....6		0103-009493	RESIN-PC;LH-1070W,W92853,WT0107,V-2	1	SNA
....5		BN61-08815A	HOLDER-SOURCE PCB;SLIM-FLED,ABS+PC,BLK,V	4	SNA
....6		0103-005041	RESIN-PC;FR3200TV,901408,BK0008,1.2mm V-	12	SNA
....5		BN61-09049A	BRACKET-WALL MOUNT;Y13 ALL Model,SPCC,T1	4	SNA
....5		BN61-09101A	SUPPORT-SOURCE PCB;SF-LED,ABS+PC,V0,GRAY	8	SNA
....6		0103-009930	RESIN-PC ABS;NH-1017SG,GRAY,GY0275,V0	24	SNA
....5		BN62-00338E	INSULATION CABI-PD BOARD;Y13 SF-LED 39"~	1	SNA
....5	CC02	BN64-02201A	CHASSIS-BOTTOM;Y13 SF-LED 46,EGI-SECC,T0	1	SNA
....5		BN96-25337A	ASSY BOARD P-D-LED INTERFACE;46inch Slim	1	SNA
....5		GL63-00014A	SHIELD-EMI GASKET DTB-H390V/XEE;DTB-H390	2	SNA
...3	TC-OC	BN96-24430A	ASSY CABLE P-FFC;E6K 2D,FFC,57mm 1,68P,	2	SNA
...3		BN96-24844A	ASSY OPEN CELL;LSF460HN02-A,8bit,46 INCH	1	SNA
...4		BN81-07434A	A/S-ADHESIVE-A.C.F(CP);ADHESIVE-A.C.F,1-	1	SNA
...4		BN81-07882A	A/S-IC DRIVER SOURCE;IC DRIVER SOURCE,13	1	SNA

Level	Loc.	Part Code	Description & Specification	Qty.	SA/SNA
...4		BN81-07893A	A/S-POLARIZER-C/F;8-POLARIZER-C/F	1	SNA
...4		BN81-07905A	A/S-POLARIZER-TFT;POLARIZER-TFT	1	SNA
...4		BN81-07925B	A/S-ASSY PCB-SOURCE LEFT;ASSY PCB-SOURCE	1	SNA
...4		BN81-07943A	A/S-ADHESIVE-A.C.F(TP500B);ADHESIVE-A.C.	1	SNA
...4		BN81-07945A	A/S-IC DRIVER GATE;IC DRIVER GATE	1	SNA
...4		BN81-08412A	A/S-ASSY PCB-SOURCE RIGHT;ASSY PCB-SOURC	1	SNA
..3		BN96-26728A	ASSY MISC P-SHIELD SOURCE,PCB;Y13 SF-LED	1	SNA
...4		BN62-00379E	INSULATION CABI-SHILED FHD L;Y13 SLIM 46	1	SNA
..3		BN96-26728B	ASSY MISC P-SHIELD SOURCE,PCB R;Y13 SF-L	1	SNA
...4		BN02-00152A	TAPE ETC-SHEET FIXING;Y13 Slim F-LED,PET	1	SNA
...4		BN02-00152F	TAPE ETC-SHEET FIXING;Y13 Slim F-LED,PET	2	SNA
...4		BN62-00379F	INSULATION CABI-SHILED FHD R;Y13 SF-LED	1	SNA
...4		BN63-10491A	SHIELD-SOURCE PCB;Y13 SF-LED 46",EGI-SEC	1	SNA
1		BN91-10311R	ASSY SHIELD;F5000	1	SNA
.2		6001-003016	SCREW-MACHINE;PWH,+,M3.0,L5.0,ZPC(WHT),S	9	SA
.2		BN02-00102B	TAPE FILAMENT;UE7000,#893,0.15,25,50,WHI	0	SNA
.2	EC13	BN39-01455X	LEAD CONNECTOR;UN46F5000,Flat Connector	1	SA
.2	EC13	BN39-01744B	LEAD CONNECTOR;DIRECT wire-harness,Flat	1	SA
.2	P001A	BN44-00610B	DC VSS-LED TV PD BD;L46SF_DPN,L46SF_DPN,	1	SA
.2	FC05	BN63-10178B	COVER-JACK;UF6100,46,EO,MPPE,BK0020,V1	1	SNA
..3		0103-009565	RESIN-MPPE;ST855,1D129A,BK0020	35	SNA
.2	FD01A	BN96-10973A	ASSY DECORATION P;UF5000,PC,V2,RD0005(SI	1	SA
..3		BN63-07229T	COVER-SHEET;Y12 F-LED,SILICONE,T0.052,W	0	SNA
..3	FD01	BN63-10222A	COVER-DECORATION;UF5000,PC,V2,RD0005(SI-	1	SNA
...4		0103-007267	RESIN-PC;TN-1045S,40700,RD0005,0.8, 3.0	5	SNA
.2	LVDS	BN96-24278S	ASSY CABLE P-FFC;UE46F5000,FFC,428mm,51P	1	SA
.2	SP01A	BN96-25565B	ASSY SPEAKER P;6ohm,10W,Enclosure_6000	1	SA
1	M0017	BN91-10508G	ASSY CHASSIS;UF5F,F5000	1	SNA
.2	M0014	BN94-06273G	ASSY PCB MAIN;UF5F,F5000	1	SA
..3		0202-001608	SOLDER-WIRE FLUX;LFC7-107,D0.8,99.3Sn/0.	0	SNA
..3		BN61-09059A	HOLDER-SIDE AV;UF6100,HIPS,BK0020,HB,EO/	1	SNA
...4		0103-004628	RESIN-HIPS;HF-1690H,K2901,BK0020,1.5mm H	13	SNA
..3		BN67-00364C	RUBBER-FOOT;X13,RUBBER,10*10,6,Dark Gray	1	SNA
..3		BN97-07027G	ASSY SMD;UF5F,F5000,UF5F	1	SNA
...4		0202-001899	SOLDER-CREAM;M705-GRN360-K2-VT,25-36um,S	8	SNA
...4	DS01A	0401-001056	DIODE-SWITCHING;MMBD4148SE,100V,200mA,SO	1	SA
...4		0403-001783	DIODE-ZENER;BZB84-C6V2,5.8/6.6V,300mW,SO	6	SNA
...4		0403-001785	DIODE-ZENER;NZH5V1B,4.94/5.2V,500mW,SOD-	1	SA
...4		0404-001404	DIODE-SCHOTTKY;BAT721C,40V,200mA,SOT-23,	2	SA
...4		0406-001200	DIODE-TVS;RCLAMP0504F,6/-/V,150W,SC-70	1	SA

Exploded Views and Parts List

Level	Loc.	Part Code	Description & Specification	Qty.	SA/SNA
...4		0501-000279	TR-SMALL SIGNAL;KSA1182-Y,PNP,150mW,SOT-	1	SA
...4		0501-000445	TR-SMALL SIGNAL;KTC3875S-Y,NPN,150mW,SOT	14	SC
...4		0505-000110	FET-SILICON;2N7002,N,60V,115mA,7.5ohm,0.	9	SA
...4		0505-002560	FET-SILICON;AO6415,P,-20V,-3.3A,0.15ohm,	1	SA
...4		0801-002630	IC-CMOS LOGIC;74AHCT1G08,2-INPUT AND GAT	1	SA
...4		0801-002780	IC-CMOS LOGIC;74LVC1G17,SCHMITT-TRIGGER	1	SA
...4		0801-003330	IC-CMOS LOGIC;Octal buffer,DQFN,20P,4.5x	3	SA
...4		0802-001012	IC-CMOS LOGIC;74LCX245,TRANSCEIVER,DQFN,	1	SNA
...4		1001-001545	IC-ANALOG MULTIPLEX;TS3USB221ERSER,R-PQF	1	SA
...4		1103-001531	IC-EEPROM;S-24C256CI-J8T1U4,256Kbit,32Kx	1	SA
...4		1103-001561	IC-EEPROM;S-24C02DI-J800,2Kbit,256X8bit,	1	SA
...4		1105-002227	IC-DDR3 SDRAM;K4B1G1646G-BCK0,DDR3 SDRAM	2	SA
...4		1201-003183	IC-AUDIO AMP;DRV612,HTSSOP,14P,5x4.4mm,D	1	SA
...4		1201-003333	IC-POWER AMP;NTP-7412S,MLF,48P,7x7mm,DUA	1	SA
...4		1203-006130	IC-POSI.FIXED REG.;S-1172B25-U5T1G,SOT-8	1	SA
...4		1203-006135	IC-POSI.FIXED REG.;AP1117D-33-GZ-13-89,T	1	SA
...4		1203-006136	IC-POSI.FIXED REG.;AP1117D-18-GZ-13-89,T	1	SA
...4		1203-006138	IC-POSI.ADJUST REG.;AP1117DGZ-13-89,TO-2	1	SA
...4		1203-006337	IC-POSI.FIXED REG.;G9091-330T11U,SOT-23-	1	SA
...4		1203-006710	IC-DC/DC CONVERTER;RT8016L-GQW,WQFN,8P,1	2	SA
...4		1203-007502	IC-DC/DC CONVERTER;AOZ3011PI,SO-8,8Z30,4	2	SA
...4		1203-007728	IC-VOL. DETECTOR;RT9831GQW,QW : WQFN-20L	1	SA
...4		1204-003423	IC-DECODER;SEMS29,LFBGA,557Z30,20.2x20.2	1	SA
...4		1205-003201	IC-BUS SWITCH;TC7WB125FK,SSOP,8P,2x2.3mm	1	SA
...4		1405-001271	VARISTOR;35V,20Vdc,5A,1.0x0.5x0.6mm,TP,1	14	SA
...4		2007-000137	R-CHIP;2Kohm,5%,1/16W,TP,1005	7	SNA
...4		2007-000138	R-CHIP;100ohm,5%,1/16W,TP,1005	23	SA
...4		2007-000142	R-CHIP;2.7Kohm,5%,1/16W,TP,1005	1	SNA
...4		2007-000143	R-CHIP;4.7Kohm,5%,1/16W,TP,1005	48	SNA
...4		2007-000148	R-CHIP;10Kohm,5%,1/16W,TP,1005	37	SA
...4		2007-000153	R-CHIP;22Kohm,5%,1/16W,TP,1005	7	SNA
...4		2007-000154	R-CHIP;24Kohm,5%,1/16W,TP,1005	2	SA
...4		2007-000155	R-CHIP;27Kohm,5%,1/16W,TP,1005	1	SNA
...4		2007-000157	R-CHIP;47Kohm,5%,1/16W,TP,1005	7	SNA
...4		2007-000162	R-CHIP;100Kohm,5%,1/16W,TP,1005	4	SNA
...4		2007-000168	R-CHIP;470Kohm,5%,1/16W,TP,1005	1	SNA
...4		2007-000170	R-CHIP;1Mohm,5%,1/16W,TP,1005	2	SNA
...4		2007-000172	R-CHIP;10ohm,5%,1/16W,TP,1005	2	SNA
...4		2007-000173	R-CHIP;22ohm,5%,1/16W,TP,1005	3	SNA
...4		2007-000174	R-CHIP;47ohm,5%,1/16W,TP,1005	2	SNA

Level	Loc.	Part Code	Description & Specification	Qty.	SA/SNA
...4		2007-000256	R-CHIP;1.6Kohm,1%,1/10W,TP,1608	1	SA
...4		2007-000475	R-CHIP;1Mohm,1%,1/10W,TP,1608	2	SA
...4		2007-000691	R-CHIP;3.3Mohm,5%,1/10W,TP,1608	1	SA
...4		2007-000695	R-CHIP;3.3ohm,5%,1/10W,TP,1608	4	SNA
...4		2007-000775	R-CHIP;33Kohm,5%,1/16W,TP,1005	1	SNA
...4		2007-000803	R-CHIP;36Kohm,1%,1/10W,TP,1608	3	SA
...4		2007-000857	R-CHIP;4.3Kohm,1%,1/10W,TP,1608	5	SNA
...4		2007-000932	R-CHIP;470ohm,5%,1/16W,TP,1005	2	SNA
...4		2007-000979	R-CHIP;5.6Kohm,1%,1/10W,TP,1608	1	SA
...4		2007-001168	R-CHIP;75ohm,5%,1/4W,TP,3216	1	SA
...4		2007-001292	R-CHIP;33ohm,5%,1/16W,TP,1005	18	SNA
...4		2007-001298	R-CHIP;51ohm,5%,1/16W,TP,1005	2	SNA
...4		2007-001301	R-CHIP;68ohm,5%,1/16W,TP,1005	7	SA
...4		2007-001313	R-CHIP;330ohm,5%,1/16W,TP,1005	2	SNA
...4		2007-001325	R-CHIP;3.3Kohm,5%,1/16W,TP,1005	1	SNA
...4		2007-001333	R-CHIP;18Kohm,5%,1/16W,TP,1005	4	SNA
...4		2007-002912	R-CHIP;33.2Kohm,1%,1/10W,TP,1608	1	SA
...4		2007-002970	R-CHIP;56ohm,5%,1/16W,TP,1005	5	SA
...4		2007-007095	R-CHIP;390ohm,5%,1/16W,TP,1005	1	SA
...4		2007-007142	R-CHIP;10Kohm,1%,1/16W,TP,1005	4	SNA
...4		2007-007156	R-CHIP;1ohm,5%,1/16W,TP,1005	15	SNA
...4		2007-007238	R-CHIP;8.25Kohm,1%,1/10W,TP,1608	1	SA
...4		2007-007311	R-CHIP;22Kohm,1%,1/16W,TP,1005	1	SA
...4		2007-007313	R-CHIP;6.8Kohm,1%,1/16W,TP,1005	2	SA
...4		2007-007318	R-CHIP;1Kohm,1%,1/16W,TP,1005	24	SNA
...4		2007-007331	R-CHIP;90.9Kohm,1%,1/10W,TP,1608	1	SA
...4		2007-007352	R-CHIP;130Kohm,1%,1/10W,TP,1608	2	SA
...4		2007-007463	R-CHIP;1.1Kohm,1%,1/16W,TP,1005	1	SA
...4		2007-007517	R-CHIP;240ohm,1%,1/16W,TP,1005	3	SNA
...4		2007-007766	R-CHIP;2Kohm,1%,1/16W,TP,1005	6	SNA
...4		2007-008015	R-CHIP;75ohm,1%,1/16W,TP,1005	11	SNA
...4		2007-008133	R-CHIP;56.2Kohm,1%,1/10W,TP,1608	1	SA
...4		2007-008275	R-CHIP;30Kohm,1%,1/16W,TP,1005	2	SNA
...4		2007-008426	R-CHIP;12.4Kohm,1%,1/10W,TP,1608	1	SA
...4		2007-008649	R-CHIP;220ohm,1%,1/16W,TP,1005	1	SNA
...4		2007-008807	R-CHIP;53.6Kohm,1%,1/16W,TP,1005	1	SA
...4		2011-000515	R-NETWORK;4.7Kohm,5%,1/16W,L,CHIP,8P,TP,	1	SA
...4		2011-001261	R-NETWORK;33ohm,5%,1/16W,L,CHIP,8P,TP,2.	6	SA
...4		2011-001262	R-NETWORK;22ohm,5%,1/16W,L,CHIP,8P,TP,2.	2	SA
...4		2011-001264	R-NETWORK;10ohm,5%,1/16W,L,CHIP,8P,TP,2.	4	SNA

Exploded Views and Parts List

Level	Loc.	Part Code	Description & Specification	Qty.	SA/SNA
...4		2011-001344	R-NETWORK;100ohm,5%,1/16W,L,CHIP,8P,TP,2	3	SA
...4		2011-001449	R-NETWORK;22ohm,5%,1/16W,L,4P,TP,1010	5	SA
...4		2011-001506	R-NETWORK;10Kohm,5%,1/16W,L,CHIP,4P,TP,1	1	SNA
...4	AD480	2203-000233	C-CER,CHIP;0.1nF,5%,50V,C0G,TP,1005	6	SA
...4	AD480	2203-000438	C-CER,CHIP;1nF,10%,50V,X7R,TP,1005	11	SA
...4	AD480	2203-000489	C-CER,CHIP;2.2nF,10%,50V,X7R,TP,1005	7	SA
...4	AD480	2203-000585	C-CER,CHIP;0.22nF,10%,50V,X7R,TP,1005	2	SA
...4	AD480	2203-000627	C-CER,CHIP;0.022nF,5%,50V,C0G,TP,1005	2	SNA
...4	AD480	2203-000714	C-CER,CHIP;3.3nF,10%,50V,X7R,TP,1005	4	SA
...4	AD480	2203-000812	C-CER,CHIP;0.033nF,5%,50V,C0G,TP,1005	7	SA
...4	AD480	2203-000995	C-CER,CHIP;0.047nF,5%,50V,C0G,TP,1005	4	SA
...4	AD480	2203-002285	C-CER,CHIP;10nF,10%,50V,X7R,TP,1005	11	SNA
...4	AD480	2203-002525	C-CER,CHIP;0.56nF,10%,50V,X7R,TP,1005	4	SNA
...4	AD480	2203-005054	C-CER,CHIP;0.0047nF,0.25pF,50V,NP0,TP,10	2	SA
...4	AD480	2203-005249	C-CER,CHIP;100nF,10%,50V,X7R,TP,1608	14	SNA
...4	AD480	2203-005344	C-CER,CHIP;22nF,10%,25V,X7R,TP,1005,0.5T	3	SNA
...4	AD480	2203-006048	C-CER,CHIP;100nF,10%,10V,X7R,TP,1005	85	SA
...4	AD480	2203-006126	C-CER,CHIP;47nF,10%,16V,X7R,TP,1005	16	SNA
...4	AD480	2203-006324	C-CER,CHIP;2200nF,10%,10V,X5R,TP,1608	8	SA
...4	AD480	2203-006474	C-CER,CHIP;22000nF,20%,6.3V,X5R,TP,2012	20	SA
...4	AD480	2203-006562	C-CER,CHIP;1000nF,10%,10V,X5R,TP,1005	12	SNA
...4	AD480	2203-006636	C-CER,CHIP;220nF,10%,25V,X7R,TP,1608	3	SA
...4	AD480	2203-006890	C-CER,CHIP;10000nF,20%,6.3V,X5R,TP,1608	18	SNA
...4	AD480	2203-006992	C-CER,CHIP;0.33nF,5%,50V,C0G,TP,1005	2	SNA
...4	AD480	2203-007176	C-CER,CHIP;10000nF,10%,16V,X5R,TP,2012,1	4	SNA
...4	AD480	2203-007513	C-CER,CHIP;10000nF,10%,10V,X5R,TP,1608,0	22	SA
...4		2703-001229	INDUCTOR-SMD;2.2uH,10%,1608,1.150hm,15mA	1	SC
...4		2703-001938	INDUCTOR-SMD;56nH,5%,1005,1.50hm,200mA,1	3	SA
...4		2703-002238	INDUCTOR-SMD;1uH,5%,2012,2.380hm,23,Wire	3	SNA
...4		2703-003343	INDUCTOR-SMD;2.2uH,20%,2520,0.1040hm,130	2	SNA
...4		2703-003790	INDUCTOR-SMD;4.7uH,20%,8080,0.025ohm,450	2	SA
...4		2703-003930	INDUCTOR-SMD;4.7uH,20%,5050,0.0720hm,245	4	SA
...4		2801-003326	CRYSTAL-SMD;24MHz,30ppm,28-ABX,20pF,50oh	1	SA
...4		3301-002039	BEAD-SMD;26ohm,1608,TP	36	SA
...4		3701-001861	CONNECTOR-HDMI;19P,2ROW,FEMALE,SMD-A,AU	2	SA
...4		3707-001106	CONNECTOR-OPTICAL;STRAIGHT W/L,SPDIF	1	SA
...4		3708-003073	CONNECTOR-FPC/FFC/PIC;51P,0.5mm,SMD,AU,N	1	SNA
...4		3709-001712	CONNECTOR-CARD SLOT;68P,1.27mm,ANGLE,AU,	1	SA
...4		3711-007569	CONNECTOR-HEADER;BOX,14P,2R,2.0mm,DIP,SN	1	SA
...4	EH01	3711-007582	HEADER-BOARD TO CABLE;BOX,8P,1R,2.0mm,AN	1	SA

Level	Loc.	Part Code	Description & Specification	Qty.	SA/SNA
...4		3711-007585	CONNECTOR-HEADER;BOX,4P,1R,2.5mm,ANGLE-D	1	SA
...4		3722-003457	JACK-USB;4P/1C,NI,BLK,A	1	SA
...4		3722-003546	JACK-PIN;5P+Screw hole,NI+SN,G,Y/BLU/RED	1	SA
...4		3722-003655	JACK-SCART;21P,SN,BLK	1	SA
...4		3722-003667	JACK-PHONE;1P/7C,AU/NI,BLK,STRAIGHT	1	SA
...4	ET01	BN40-00256A	TUNER;DTOS40EIH035A,DTOS40EIH035A,DVB-TC	1	SA
...4		BN41-01955A	PCB MAIN;X13 OS,FR-4,4,1.2T,158*193.5,1	1	SNA
...4		BN97-07099A	ASSY MICOM-MAIN FLASH;T-MST13DEUC,U85B,K	1	SNA
....5		1107-002049	IC-NAND FLASH;K9F1G08U0D-SCB0,1Gbit,128M	1	SNA
....5		BN46-00317E	S/W-E-MANUAL;X13,EU4,XC, XN, ZF, ZG, ZT,	1	SNA
....5		BN46-00335A	S/W MICOM;T-MST13DEUC-XXXX,EU/RU/XH/AB,E	1	SNA
...4		BN97-07187A	ASSY MICOM-SUB;T-MST13DEUS-XXXX,X13,W25Q	1	SNA
....5		1107-002226	IC-NOR FLASH;W25Q40CLSSIP,4Mbit,SOIC,8P,	1	SNA
..3		BN97-07183A	ASSY DRM-KEY;BN46-00115J(CI+)	1	SNA
...4		BN46-00115J	KEY CODE-CERTIFI;CI+,TV,2013X,Euro	1	SNA
1		BN92-11772A	ASSY P/MATERIAL;UF5000 46	1	SNA
.2		6902-000379	BAG AIR;LDPE,T0.2,W1000,L1800,TRP,1260.0	1	SNA
.2		6922-000003	BAND PP;PP,T0.8,W18,L1650M,TRP,DA69-9014	1	SNA
.2		BN68-02422B	LABEL-WARNING SHIPPING;ALL MODEL,A/P 100	1	SNA
.2		BN69-00257Y	PACKING-SHEET PALLET;PACKING SHEET PALLE	1	SNA
.2		BN69-03982L	PAD PACKING-EDGE;EDGE,PAPER,-,T5,W100,L2	1	SNA
.2		BN69-05418A	PACKING-BAG WRAPPING;-LDPE,-,0,019,500,	3	SNA
.2		BN69-06640A	PACKING-PAD;PAD,PAPER,-,CB-SW4,1120,95	1	SNA
.2		BN69-06679A	PACKING-BAG SHEET ROLL;-CB,-,FOAM 0,5mm	3	SNA
.2		BN69-08095L	PALLET;F5 46",WOOD,20mm,920,1305,140,140	1	SNA
.2		BN69-08268A	CUSHION-FRONT;UF6100, 50,EPS	1	SNA
.2		BN69-08310A	CUSHION-SET;UF5000 46",EPS	1	SNA
.2		BN74-00008D	TAPE-OPP MASKING;OPP,T0.05,W75,L800M,CLR	3	SNA
1		BN92-11788F	ASSY BOX;UF5000 46	1	SNA
.2		BH68-00662A	LABEL BOX-00;ALL MODEL,MOJO 90G,60,110,W	1	SNA
.2		BN69-08555D	BOX-01,SET;46UF5000-SS,CB,A-01,DW3,YEL,W	1	SNA
1		BN92-11808R	ASSY LABEL;UF4B,F4000(EU,ASIA)	1	SNA
.2	T0527	BP68-00052B	LABEL-00,RATING;FPTV,PET,T0.05,93,73	1	SNA
1	ACCE1	BN92-12046V	ASSY ACCESSORY;UE46F5000AWXZF	1	SNA
.2		BN68-04777G	LABEL-STICKER;UF5F,EDC,PET,T0.1,60,125,E	1	SNA
.2		BN96-26582E	ASSY ACCESSORY-MANUAL/CABLE;UE46F5000AWX	1	SNA
..3	T0268	3903-000849	CBF-POWER CORD;DT,CEE,LP-21L,250V,2.5A,B	1	SA
..3		4301-000121	BATTERY-MN;1.5V,R03,10.5x44.5m,HOLDER,7.	2	SNA
..3	REMO2	AA59-00741A	REMOCON;TM1240,44,3.0V,F5020/EU	1	SA
..3		BN61-08370A	HOLDER-WIRE STAND;26UE4000 GIUDE STAND,N	1	SNA

Exploded Views and Parts List

Level	Loc.	Part Code	Description & Specification	Qty.	SA/SNA
..3		BN68-00514K	MANUAL FLYER-02,WARRANTY CARD;comm,Samsu	1	SNA
..3		BN68-04735A	LABEL-E,PASS;ALL MODEL,ART PAPER 90G,50,	1	SNA
..3		BN68-04784E	MANUAL USERS;UF5000W,ENG/FRA/DEU/DUT,XN	1	SNA
..3		BN68-04898M	LEAFLET-02,STAND GUIDE;UF5000,EU N.AFRIC	1	SNA
..3		BN68-04972A	MANUAL FLYER-01,REGULATORY GUIDE;ALL,SAM	1	SNA
..3		BN68-05115D	LEAFLET-FICHE UF5000(32/46INCH);ALL,ENG,	1	SNA
..3		BN69-08226A	BOX-05,ACCESSORY;E7000,PAPER,CCP 400g,NO	1	SNA
..3		BN69-08472A	PAD-01,TYPE;ACCESSORY,CB,Black Paper 400	1	SNA
..3		BN69-08751D	WRAP VINYL-SHRINK;ACCESSORY BOX,PLASTIC	0	SNA
..3	EH03A	BN96-18153B	ASSY HOLDER P-RING;UF5000 SERIES	1	SNA
...4		6902-001404	BAG ZIPPER;LDPE,T0.05,W80,L100,TRP	1	SNA
...4	AH365	BN61-07295A	HOLDER-RING;40UD5500,ABS,BK0007,HB	2	SNA