

## 5. Exploded View & Part List

### 5-1. UE46C6710US Exploded View

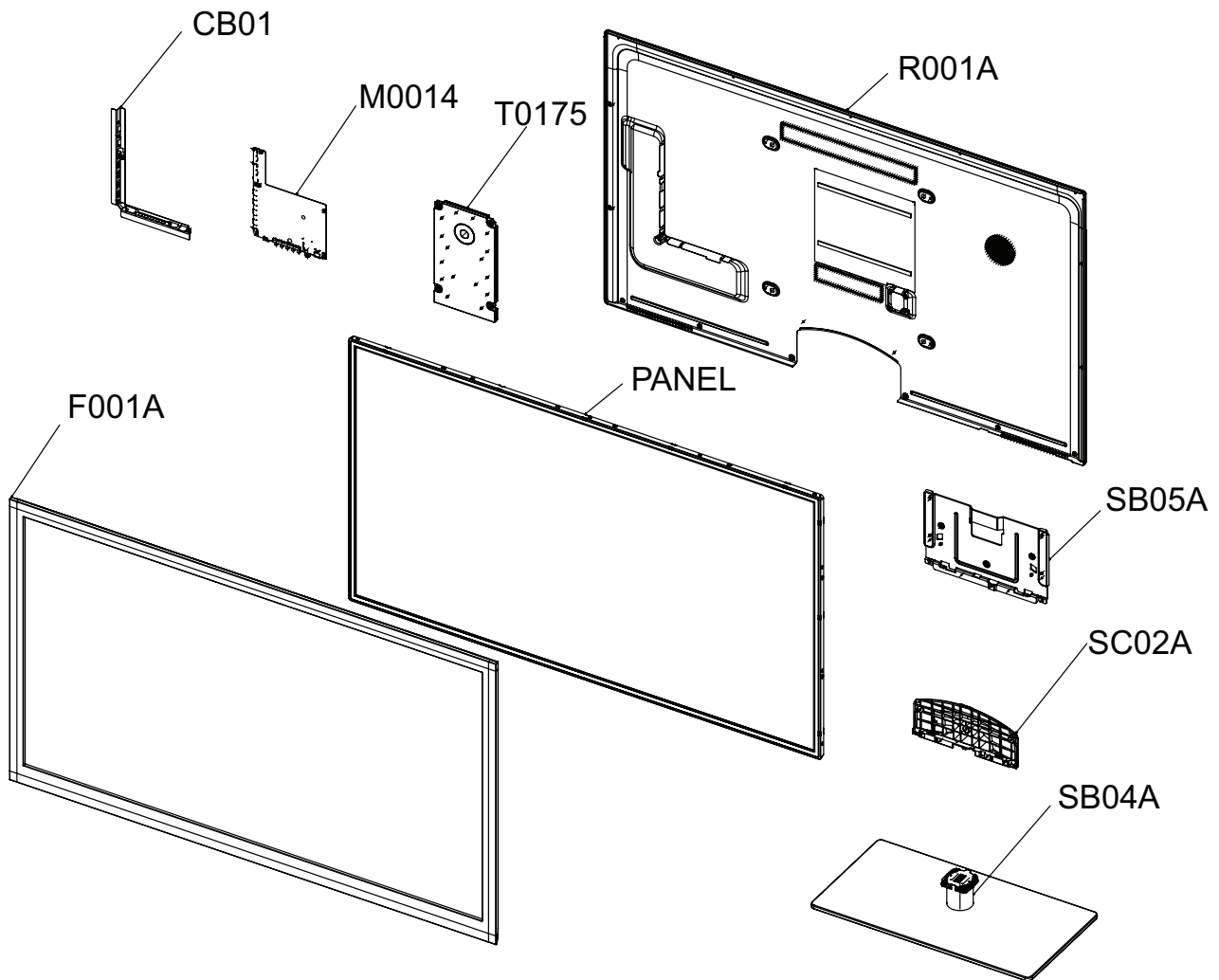

#### 5-1-1. UE46C6710US Parts List

Location No.	Code No.	Description & Specification	Q'ty	SA/SNA	Remark
F001A	BN96-13997A	ASSY COVER P-FRONT;UC6510 46,PC(CLR)+PC(	1	SA	
PANEL	BN95-00385A	ASSY PRODUCT LCD;T460FBE1-FA,SLL7CA1,10b	1	SA	
CB01	BN61-04924G	BRACKET-AV;UC6510,PCM,T0.5,WHN-P918	1	SNA	
M0014	BN94-03406J	ASSY PCB MAIN;UE46C6710USXZG	1	SA	
T0175	BN96-12965A	ASSY SPEAKER P;4ohm,4pin,20W,R: 680,Encl	1	SA	
R001A	BN96-12915X	ASSY COVER P-REAR;UC6000 46,PCM,CDQ,T0.4	1	SA	
SB05A	BN96-12929C	ASSY BRACKET P-STAND LINK;UC6500-46,,T2.	1	SNA	
SC02A	BN96-13131C	ASSY COVER P-GUIDE STAND;UC7000,PC+ABS G	1	SA	
SB04A	BN96-13133F	ASSY STAND P-BASE;46/55,FOUR-LEG,PC+ABS,	1	SA	

## 5-2. UE46C6710US Parts List

Service Bom (SA: SERVICE AVAILABLE, SNA: SERVICE NOT AVAILABLE)

Level	Location No.	Code No.	Description & Specification	Q'ty	SA/SNA	Remark
			UE46C6710USXZG			
0.1		BN90-02576A	ASSY COVER FRONT;PC540 50	1	SNA	
..2	F001A	BN96-13997A	ASSY COVER P-FRONT;UC6510 46,PC(CLR)+PC(	1	SA	
...3	CIS1	0203-001598	TAPE-FILAMENT;#8915,0.15,12,55000,CLR	0.12	SNA	
...3		BN60-00162Y	SPACER-FOAM;FOAM,50000mm,Dark Gray,0.35T	3	SNA	
...3	AB326	BN61-04661A	BRACKET-STOPPER;L650,SK-5,T0.4,Plating,H	3	SNA	
...3		BN61-06213A	BRACKET-STOPPER BOSS;C8K,SECC+SK5,T1.2	11	SNA	
...3	CCM1	BN63-05199B	COVER-SHEET;AMBER,PE,T0.08,W65mm,200M,CL	3.7	SNA	
...3	F001	BN63-06617A	COVER-FRONT;UC6510 46,PC(CLR)+PC(WHITE),	1	SNA	
....4		0103-004672	RESIN-PC;WT0044,2.0V2,PC,ToC 2nd PC	480	SNA	
....4		0103-007268	RESIN-PC;TP0010,2.0V0,NH PC,NH PC 2.0 V2	600	SNA	
...3		BN96-12922A	ASSY HOLDER P-BOSS;UC6400 46,ABS V0,BK00	1	SNA	
....4		BN61-04692A	BOSS-PRIMER;#94,clear,35cps	0.001	SNA	
....4		BN61-05915A	BOSS-TAPE;LB650 65",T1.1,W12.0mm,DARK GR	0.5	SNA	
....4		BN61-05915B	BOSS-TAPE;LB650 65",3M #4711,T1.1,W6.0mm	0.03	SNA	
....4		BN61-06239A	HOLDER-BOSS BOTTOM;UC6100 46inch,ABS,HB	1	SNA	
....5		0103-004609	RESIN-ABS;BK0007,HB,ABS,High Flow ABS	300	SNA	
...3	T0176	BN96-12941D	ASSY SPEAKER P;8ohm,4pin,10,L:440 R:810,	1	SA	
...3	FB21A	BN96-13685J	ASSY BOARD P-TOUCH FUNCTION&IR;UC6510,CT	1	SA	
...3	T0382	BP61-00495C	HOLDER-CARE;PJT,ACRYL-FOAM,T0.25,W30.0mm	0.08	SNA	
...3		BN60-00228A	SPACER-FELT;-FELT,7,-,-,2,7,-	1	SNA	
...3		BN68-02701A	LABEL-LED-POP;Highlight Sticker Color,PE	1	SNA	
...3	FW04	BN64-01311A	WINDOW-RMC;UC6510 40",PC,WT0026,V2	1	SNA	
....4		0103-004678	RESIN-PC;WT0026,V2,PC,Tio2 0.5%	1	SNA	
0.1	S001A	BN90-02594Q	ASSY STAND;UC7000 46	1	SNA	
..2	SC02A	BN96-13131C	ASSY COVER P-GUIDE STAND;UC7000,PC+ABS G	1	SA	
...3	T0524	6902-001063	BAG PE;LDPE,T0.05,W180,L350,TRP,RECYCLE	1	SNA	
...3	SG03	BN61-06221B	GUIDE-STAND;UC6510 40inch,PC, G/F 20%,WH	1	SNA	
....4		0103-007332	RESIN-PC;WT0062,1.5V2,PC/GF20%,Glass fib	450	SNA	
...3	T0527	BN68-00513A	LABEL-E,PASS;ALL MODEL, YUPO(110G),50X15,	1	SNA	
...3		BN68-02825B	MANUAL FLYER-01,STAND GUIDE;7~9 series,S	1	SNA	
...3		BN96-12031V	ASSY ACCESSORY-SCREW;UE6510/6710,6001-00	1	SNA	
....4		6001-000154	SCREW-MACHINE;BH,+,M4,L8,NI PLT,SWRCH18A	9	SNA	
....4		BN69-04419R	PACKING-BAG PE;UC6510,LDPE,70,90,4X8, 9E	1	SNA	
..2	SB04A	BN96-13133F	ASSY STAND P-BASE;46/55,FOUR-LEG,PC+ABS,	1	SA	
...3	M0081	6003-001003	SCREW-TAPTYPE;BH,+,B,M4,L12,ZPC(BLK),SWR	13	SA	
...3	SCREW	6003-001785	SCREW-TAPTYPE;FH,+,B,M4,L8,ZPC(BLK),SWRC	4	SA	
...3		BN61-05240A	HOLDER-SWIVEL RING TOP;LB700 46,POM HB,A	1	SNA	
...3		BN61-06200A	BRACKET-STAND, FRONT;46,55 FOUR-LEG,HGI,	2	SNA	
...3		BN61-06204A	BRACKET-STAND, REAR;46,55 FOUR-LEG,HGI,T	2	SNA	
...3		BN61-06331A	HOLDER-SWIVEL RING BOTTOM;UC7K 46/55,POM	1	SNA	
...3		BN63-06582F	COVER-STAND, BASE;46/55,FOUR-LEG,ABS+PC,	1	SNA	
....4		0103-007442	RESIN-PC ABS;NH-1017SG/W91902,WT0034,2.0	180	SNA	
...3	T0527	BN68-00513A	LABEL-E,PASS;ALL MODEL, YUPO(110G),50X15,	1	SNA	
...3	M0126	BN73-00052E	RUBBER-FOOT;4-LEG,CR RUBBER,T1.5 DIA17,R	4	SNA	
...3		BN74-00031A	GREASE;kanto-kasei FL-955,grease,wht	0.6	SNA	
...3		BN63-06574A	COVER-STAND, TOP;46/55,FOUR-LEG,ABS,HB,NC	1	SNA	

## 5. Exploded View &amp; Part List

Level	Location No.	Code No.	Description & Specification	Q'ty	SA/SNA	Remark
...3		BN63-06575A	COVER-STAND, TOP; 46/55, FOUR-LEG, ABS, HB, NC	1	SNA	
...3		BN63-06946A	COVER-STAND FRONT; 46/55, FOUR-LEG, ABS, HB,	1	SNA	
...3		BN96-13563A	ASSY BRACKET P-SWIVEL BOT; 4-LEG(55), BRKT	1	SNA	
...4		BN61-02428Q	STUD-PEM; PNA, M4, D7, L9.3, ZPC(SIL), SUM24L	4	SNA	
...4		BN61-06269A	BRACKET-SWIVEL BOT; SPC, T 3.0, Zn-Plating,	1	SNA	
...3	AB323	BN61-06196A	BRACKET-STAND; 46, 55 FOUR-LEG, ALDC12, ALDC	1	SNA	
...3		BN61-06268A	BRACKET-SWIVEL TOP; SPC, T 3.0, Zn-Plating,	1	SNA	
...3	T0382	BP61-00495C	HOLDER-CARE; PJT, ACRYL-FOAM, T0.25, W30.0mm	0.18	SNA	
...3		BN63-05135E	COVER-SHEET; 4-LEG, Rhcm PE Vinyl, T0.05, W6	2	SNA	
0.1	R001A	BN90-02791B	ASSY COVER REAR; UC6510 46	1	SNA	
..2		6001-002611	SCREW-MACHINE; BH, +, M4, L6, NI PLT, SWRCH18A	8	SA	
..2	SCREW	6003-001783	SCREW-TAPTYPE; BH, +, B, M4, L12, NI PLT, SWRCH	15	SA	
..2	R001A	BN96-12915X	ASSY COVER P-REAR; UC6000 46, PCM, CDQ, T0.4	1	SA	
...3		BN60-00162A	SPACER-FOAM; FOAM, 50000L, BLK, 0.35T, 20W	1.05	SNA	
...3		BN60-00162Y	SPACER-FOAM; FOAM, 50000mm, Dark Gray, 0.35T	0.4	SNA	
...3		BN60-00221A	SPACER-FOAM; FOAM, 50000mm, White, 0.35T, 7W	0.38	SNA	
...3	R001	BN63-06519F	COVER-REAR; UC6500 46inch, PCM, T0.5, BKN-P8	1	SNA	
...3		BN68-02543Z	LABEL-TERMINAL BOTTOM; Rev.01 UC6710, EURO	1	SNA	
...3		BN68-02544T	LABEL-TERMINAL SIDE; Rev.01 UC6000(White)	1	SNA	
...3		BN96-12924B	ASSY MISC P-INSULATOR; UC6500 37/40, PC, T0	1	SNA	
...4	T0278	BN60-00122E	SPACER-SPONGE; UC6500, CR, L200, T2.0, W10	2	SNA	
...4		BN63-06630A	SHEET-INSULATOR SMPS; UC6100 40inch, PC, T0	1	SNA	
...3	M0909	BP60-00061Q	SPACER-SCREEN; SP20UO, SPONGE, 35, T2.0, 20, E	2	SNA	
...3		BN61-06853A	BRACKET-SIDE LED; -, SECC, T2.6, 520, -, -	1	SNA	
...3		BN61-04692A	BOSS-PRIMER; #94, clear, 35cps	0.001	SNA	
...3		BN61-04248D	BOSS-TAPE; #4920, acryl, 0.45mm, 20mm, 3M, whi	0.18	SNA	
..2	T0382	BP61-00495C	HOLDER-CARE; PJT, ACRYL-FOAM, T0.25, W30.0mm	0.1	SNA	
0.1		BN91-05072B	ASSY SHIELD; UE46C6510UWXXC	1	SNA	
..2	CIS1	0203-001586	TAPE-FILAMENT; #893, 0.15, 25, 55	0.2	SNA	
..2	T0081	6001-000115	SCREW-MACHINE; BH, +, -, M3, L10, ZPC(WHT), SWR	2	SNA	
..2	T0081	6001-002283	SCREW-MACHINE; BH, +, M3, L5, ZPC(WHT), SWRCH1	9	SNA	
..2		6001-002611	SCREW-MACHINE; BH, +, M4, L6, NI PLT, SWRCH18A	4	SA	
..2	SCREW	6003-001783	SCREW-TAPTYPE; BH, +, B, M4, L12, NI PLT, SWRCH	1	SA	
..2	M2893	BN39-01267N	LEAD CONNECTOR; UN40C6400, UL2651, #26, 18P,	1	SA	
..2	P001A	BN44-00357B	DC VSS-LED TV PD BD; PD46AF1E_ZDY, PD46AF1	1	SA	
...3		BN81-04724A	A/S-DIODE; 400V, 2A, DD807, DD406, DD407, D9	2	SA	
...3		BN81-04734A	A/S-FUSE; 250V, 6.3A, FS801S, FS802S	2	SA	
...3		BN81-04743A	A/S-MOSFET; 400V, 3.4A, QD407, QD411	2	SA	
...3		BN81-04750A	A/S-MOSFET; 600V, 11A, QP801S, QP801, QP802	2	SA	
...3		BN81-04773A	A/S-PWM CONTROL IC; 650V, 0.65#, ICB801	1	SA	
..2	M0131	BN63-00209A	GASKET; RS24NS, CONDUCTIVE FAB, 4mm, 10mm, 30	1	SNA	
..2		BN73-00273A	SILICON/RUBBER-GAPPAD; UE46B7700, SILICON+	1	SNA	
..2	M0251	BN96-12723M	ASSY CABLE P-FPCB LVDS; LED120Hz-46inch, F	1	SA	
..2	T0175	BN96-12965A	ASSY SPEAKER P; 4ohm, 4pin, 20W, R: 680, Encl	1	SA	
..2	SB05A	BN96-12929C	ASSY BRACKET P-STAND LINK; UC6500-46,, T2.	1	SNA	
...3		BN60-00184A	SPACER-FOAM; FOAM, 30000mm, DARK GRAY, 1T, 30	0.19	SNA	
...3		BN61-02932G	BRACKET-STOPPER NUT; LED TV, M4, D6, L6.5, BR	5	SNA	
...3	M0115	BN61-06167A	BRACKET-STAND LINK; UC6500 46inch, HGI, T3.	1	SNA	
0.1		BN91-05168A	ASSY LCD-AUO; BN95-00385A, HQ	1	SNA	
..2	PANEL	BN95-00385A	ASSY PRODUCT LCD; T460FBE1-FA, SLL7CA1, 10b	1	SA	
...3		BN01-00012A	FILM-PROTECTION; T460FAE1-FA, LLDPE 3120, 0	1	SNA	

5. Exploded View & Part List

Level	Location No.	Code No.	Description & Specification	Q'ty	SA/SNA	Remark
...3		BN74-00053A	TAPE-PROTECTION;T460BE1-FB,T550BE1-FB,3M	10	SNA	
...3		BN90-02747A	ASSY MISC-BLU;T460FBE1-FA,120HZ	1	SNA	
....4		BN63-07042A	SHEET-REFLECTOR;T460FAE1-FA,SLP7-7C,0.4,	1	SNA	
....4		BN63-07044A	SHEET-PRISM H;T460FAE1-FA,PTX538,0.3,584	1	SNA	
....4		BN63-07046A	SHEET-DBEF-D;T460FAE1-FA,DBEF-D2-400,0.4	1	SNA	
....4		BN63-07072A	SHEET-DIFFUSER;T460FBE1-FA,PTR873,0.3,58	1	SNA	
....4		BN96-13849A	ASSY FRAME P-MOLD MIDDLE (U);T460FAE1-FA	1	SNA	
.....5		BN60-00174A	SPACER-PANEL(UD);T460FAE1-FA,SI(TES2523U)	2	SNA	
.....5		BN60-00175A	SPACER-PANEL(SM);T460FAE1-FA,SI(TES2523U)	4	SNA	
.....5		BN61-06306A	FRAME-MIDDLE MOLD(U);46,PC+GF,black,1.0,	1	SNA	
.....5		BN69-05038A	PAD-REFLECTOR (UD);T460FAE1-FA, T460FBE1	2	SNA	
....4		BN96-13850A	ASSY FRAME P-MOLD MIDDLE (D);T460FAE1-FA	1	SNA	
.....5		BN60-00174A	SPACER-PANEL(UD);T460FAE1-FA,SI(TES2523U)	2	SNA	
.....5		BN60-00175A	SPACER-PANEL(SM);T460FAE1-FA,SI(TES2523U)	4	SNA	
.....5		BN61-06307A	FRAME-MIDDLE MOLD(D);46,PC+GF,black,1.0,	1	SNA	
.....5		BN69-05038A	PAD-REFLECTOR (UD);T460FAE1-FA, T460FBE1	2	SNA	
....4		BN96-13853A	ASSY FRAME P-MOLD MIDDLE (L);T460FAE1-FA	1	SNA	
.....5		BN60-00176A	SPACER-PANEL(LR);T460FAE1-FA,SI(TES2523U)	1	SNA	
.....5		BN61-06308A	FRAME-MIDDLE MOLD(L);46,PC+GF,black,1.0,	1	SNA	
.....5		BN69-05039A	PAD-SILICON MIDDLE;T460FAE1-FA,T460FBE1-	2	SNA	
....4		BN96-13854A	ASSY FRAME P-MOLD MIDDLE (R);T460FAE1-FA	1	SNA	
.....5		BN60-00176A	SPACER-PANEL(LR);T460FAE1-FA,SI(TES2523U)	1	SNA	
.....5		BN61-06309A	FRAME-MIDDLE MOLD(R);46,PC+GF,black,1.0,	1	SNA	
.....5		BN69-05039A	PAD-SILICON MIDDLE;T460FAE1-FA,T460FBE1-	2	SNA	
....4		BN96-13866A	ASSY MISC P-LGP-LED;T460FBE1-FA	1	SNA	
.....5		BN74-00065A	TAPE-REFLECTOR LGP V;T460FAE1-FA, T460FB	4	SNA	
.....5		BN74-00066A	TAPE-REFLECTOR LGP V;T460FAE1-FA,T460FBE	4	SNA	
.....5		BN61-06493A	LGP-LED;T460FBE1-FA,PMMA,3.0T,1037.68*58	1	SNA	
....4		BN96-13945A	ASSY MISC P-CHASSIS BOTTOM;T460FBE1-FA	1	SNA	
.....5	EC13	BN39-01306A	LEAD CONNECTOR;46" 120Hz G/D wire-harnes	1	SA	
.....5		BN62-00067A	INSULATION-POWER;T460FAE1-FA, T460FBE1-F	1	SNA	
.....5		BN62-00068A	INSULATION-SOURCE LR;T460FAE1-FA, T460FB	2	SNA	
.....5	CC02	BN64-01304A	CHASSIS-BOTTOM;46,AL 5052-0,1.0,1051.3,6	1	SNA	
.....5		BN74-00059A	TAPE-PET WIRE;T460FAE1-FA, T550FAE1-FA,	14	SNA	
.....5		BN74-00060A	TAPE-PET PD BRD;T460FAE1-FA, T550FAE1-F	1	SNA	
.....5		BN74-00061A	TAPE-BOTTOM CHASSIS;T460FAE1-FA, T550FA	4	SNA	
.....5		BN61-06492A	HOLDER-WIRE;T460FAE1-FA, T550FAE1-FA,Sil	1	SNA	
....4		BN96-14027A	ASSY MISC P-CHASSIS-BOTTOM-BAR(U);T460FB	1	SNA	
.....5		BN62-00047A	HEAT SINK-UP;46,AL 6063-T5,4.3,1036.1,30	1	SNA	
.....5		BN74-00062A	TAPE-REFLECTOR;T460FAE1-FA,SK2100HE,BK,1	2	SNA	
....4		BN96-14028A	ASSY MISC P-CHASSIS-BOTTOM-BAR(D);T460FB	1	SNA	
.....5		BN62-00050A	HEAT SINK-DOWN;46,AL 6063-T5,4.3,1036.1,	1	SNA	
.....5		BN74-00062A	TAPE-REFLECTOR;T460FAE1-FA,SK2100HE,BK,1	2	SNA	
....4		BN74-00055A	TAPE-WIRE;DW-0.1T,30*12*0.05T	10	SNA	
....4		6001-002615	SCREW-MACHINE;CH,+,M1.6,L3.5,NI PLT,SWRC	24	SNA	
....4		6001-002617	SCREW-MACHINE;CH,+,M3,L4,NI_PLT (White),	19	SNA	
....4		BN74-00100A	TAPE-THERMAL;T460FBE1-FB,e-GRAF,200*100*	4	SNA	
....4		BN96-13570B	ASSY MISC P-LED BAR;UC6000 46inch,SEC VD	4	SNA	
...3		BN96-12879A	ASSY OPEN CELL;T460HW04 V4,46,16:9,AMVA3	1	SNA	
...3	TCON	BN96-13687A	ASSY PCB P-T-CON;T460FAE1-FA,SUWON,120HZ	1	SA	
...3		BN96-13861A	ASSY COVER P-SOURCE (L);T460FAE1-FA, T46	1	SNA	

## 5. Exploded View &amp; Part List

Level	Location No.	Code No.	Description & Specification	Q'ty	SA/SNA	Remark
....4		BN60-00173A	SPACER-SOURCE;T460FAE1-FA,W/S CR POM TAP	2	SNA	
....4		BN62-00074A	INSULATION-COVER(L);T460FAE1-FA,SWT-9132	1	SNA	
....4		BN63-06754A	SHIELD-PCB_COVER_L;46,SECC,0.8,515.25,30	1	SNA	
...3		BN96-13862A	ASSY MISC P-CHASSIS TOP;T460FAE1-FA, T46	1	SNA	
....4		BN60-00171A	SPACER-TOP(UD);T460FAE1-FA,SKC SB00(0.1T	4	SNA	
....4		BN60-00172A	SPACER-TOP(LR);T460FAE1-FA,SKC SB00(0.1T	2	SNA	
....4	AC157	BN64-01303A	CHASSIS-TOP;46,SECC,0.8,1056.5,610.8	1	SNA	
....4		BN74-00101A	TAPE-CORNER;T460FBE1-FB,PC-0.4T,16*16*0.	4	SNA	
...3		BN96-13863A	ASSY COVER P-SOURCE (R);T460FAE1-FA, T46	1	SNA	
....4		BN60-00173A	SPACER-SOURCE;T460FAE1-FA,W/S CR POM TAP	2	SNA	
....4		BN63-06755A	SHIELD-PCB_COVER_R;46,SECC,0.8,514.85,30	1	SNA	
....4		BN62-00075A	INSULATION-COVER(R);T460FAE1-FA,T460FBE1	1	SNA	
...3		BN01-00014A	FILM-T-CON;T460FAE1-FA, T460FBE1-FA,CI93	1	SNA	
...3		6001-002614	SCREW-MACHINE;CH,+,M2.5,L14,ZPC (BLK),SW	16	SNA	
...3		6001-002617	SCREW-MACHINE;CH,+,M3,L4,Ni_PLT (White),	11	SNA	
...3		BN68-02471A	LABEL-STICKER;WW,Art Paper,80,40,AV	1	SNA	
0.1	M0017	BN91-05254H	ASSY CHASSIS;UE46C6710USXZG	1	SNA	
.2	M0014	BN94-03406J	ASSY PCB MAIN;UE46C6710USXZG	1	SA	
...3		0202-001608	SOLDER-WIRE FLUX;LFC7-107,D0.8,99.3Sn/0.	0.25	SNA	
...3		3701-001698	CONNECTOR-DSUB;15P,3ROW,FEMALE,ANGLE,NI	1	SA	
...3		3709-001603	CONNECTOR-CARD SLOT;68P(U/SLIM 60mm) W/L	1	SA	
...3		3711-007302	HEADER-BOARD TO BOARD;BOX,18P,2R,2mm,ANG	1	SA	
...3	JA330	3722-002844	JACK-PHONE;1/7P,NI,LAUREL-GREEN,ANGLE	1	SA	
...3	JA330	3722-002845	JACK-PHONE;1/7P,NI,YELLOW,ANGLE	1	SA	
...3	JA330	3722-002846	JACK-PHONE;1/6,NI,BLACK,ANGLE	2	SNA	
...3		3722-002849	JACK-MODULAR;8P/8C(ULTRA SLIM),YES,ANGLE	1	SNA	
...3	ET01	BN40-00175A	TUNER;DNSS24CVH161A,DVB-T/C+S2,164CH,38.	1	SA	
...3	CB01	BN61-04924G	BRACKET-AV;UC6510,PCM,T0.5,WHN-P918	1	SNA	
...3	T0066	BN62-00071A	HEAT SINK-ES;22*22*2.5,Ceramic,T2.6,TAPE	2	SNA	
...3	T0066	BN62-00072A	HEAT SINK-ES;40*40*2.5,Ceramic,T2.6,TAPE	1	SNA	
...3		BN97-04151J	ASSY SMD;UE46C6710USXZG,BN94-03406G	1	SNA	
....4		0202-001767	SOLDER-CREAM;LST-5710,D20~38,42Sn/57Bi/1	4.852	SNA	
....4	DS01A	0401-001056	DIODE-SWITCHING;MMBD4148SE,100V,200mA,SO	18	SA	
....4		0403-001164	DIODE-ZENER;MMSZ5232B,5.32-5.88V,500MW,S	1	SA	
....4		0403-001783	DIODE-ZENER;BZB84-C6V2,5.8/6.6V,300mW,SO	19	SNA	
....4	D0254	0404-001271	DIODE-SCHOTTKY;SSA34,40V,3000mA,SMA,TP	4	SA	
....4	D0254	0404-001404	DIODE-SCHOTTKY;BAT721C,40V,200mA,SOT-23,	8	SA	
....4	T0139	0406-001200	DIODE-TVS;RCLAMP0504F,6/-V,150W,SC-70	2	SA	
....4	T0139	0406-001271	DIODE-TVS;RCLAMP0524P,6/-V,150W,SLP251	8	SNA	
....4	SD3	0407-000114	DIODE-SWITCHING;KDS184,80V,100mA,SOT-23,	1	SNA	
....4	Q101	0501-000445	TR-SMALL SIGNAL;KTC3875S-Y,NPN,150mW,SOT	13	SA	
....4		0501-000669	TR-SMALL SIGNAL;KTA1505Y,PNP,150mW,SOT-2	2	SA	
....4	CEQ2	0505-000110	FET-SILICON;2N7002,N,60V,115mA,7.5ohm,0.	3	SA	
....4	Q409	0505-000274	FET-SILICON;AO4435L,P,-30V,-11A,0.014ohm	1	SNA	
....4	Q409	0505-002386	FET-SILICON;AO3415AL,P,-20V,-4A,0.045ohm	1	SA	
....4	IC104	0801-002630	IC-CMOS LOGIC;74AHCT1G08,2-INPUT AND GAT	1	SA	
....4	ND51C2	0801-002780	IC-CMOS LOGIC;74LVC1G17,SCHMITT-TRIGGER	1	SA	
....4	IC104	0801-003330	IC-CMOS LOGIC;Octal buffer,DQFN,20P,4.5x	4	SA	
....4	IC104	0802-001012	IC-CMOS LOGIC;74LCX245,TRANSCEIVER,DQFN,	1	SNA	
....4		1001-000164	IC-ANALOG MULTIPLEX;74HC4052,CMOS,SOP,16	1	SA	
....4	IC106	1001-001573	IC-VIDEO SWITCH;SiI9287BCNUTR,QFN,72P,10	1	SNA	

5. Exploded View & Part List

Level	Location No.	Code No.	Description & Specification	Q'ty	SA/SNA	Remark
....4	IC112	1103-000129	IC-EEPROM;24C02,2Kbit,256x8,SOP,8P,5x4mm	1	SA	
....4	IC112	1103-001310	IC-EEPROM;24LC02B,256X8BIT,SOIC,8P,3.91X	1	SNA	
....4	IC112	1103-001475	IC-EEPROM;M24256-BR,256Kbit,32Kx8,SOP,8P	1	SNA	
....4		1105-001931	IC-DDR2 SDRAM;K4T51163Q,DDR2-800,512Mbit	2	SA	
....4		1105-002058	IC-DDR2 SDRAM;K4T1G164QE-HCF8,DDR2,1Gbit	2	SA	
....4		1105-002075	IC-DDR2 SDRAM;K4T1G084QE-HCF8,DDR2,1Gbit	4	SA	
....4	T0085	1201-002487	IC-AUDIO AMP;MAX9728A,QFN,12P,3x3mm,DUAL	1	SA	
....4	T0124	1201-002992	IC-POWER AMP;STA369BWS,PSSO,36P,10.3x7.5	2	SA	
....4	T0087	1203-002519	IC-POSI.FIXED REG.;KIA7809AF,DPAK,3P,240	1	SA	
....4	IC012	1203-003544	IC-POSI.ADJUST REG.;RT9173BPS,SOP-8,8P,5	1	SA	
....4		1203-004363	IC-VOL. DETECTOR;RT9818C-29PV,SOT-23,3P,	1	SA	
....4		1203-004364	IC-VOL. DETECTOR;RT9818C-42PV,SOT-23,3P,	1	SA	
....4		1203-005538	IC-DC/DC CONVERTER;AOZ1021HAIL,SOP,8P,4.	3	SA	
....4		1203-005663	IC-DC/DC CONVERTER;LNBH23QTR,QFN,32P,5x5	1	SA	
....4	IC012	1203-005756	IC-POSI.ADJUST REG.;AP7173-SP,SOP-8L-EP,	1	SA	
....4		1203-006012	IC-DC/DC CONVERTER;MP8725EL,QFN14,14P,3x	1	SA	
....4	T0087	1203-006109	IC-POSI.FIXED REG.;S-1206B33-M3T1G,SOT-2	1	SA	
....4	IC012	1203-006138	IC-POSI.ADJUST REG.;AP1117DGZ-13-89,TO-2	1	SA	
....4	T0087	1203-006141	IC-POSI.FIXED REG.;S-1172B33-U5T1G,SOT-8	3	SA	
....4		1203-006142	IC-DC/DC CONVERTER;BD8924G,5P,2.9x1.6x1.	1	SA	
....4		1203-006167	IC-POSI.FIXED REG.;S-1172B12-U5T1G,SOT-8	1	SA	
....4	IC118	1204-003085	IC-VIDEO PROCESS;SDP91-PS,PBGA,496P,23x2	1	SA	
....4		1204-003100	IC-DECODER;SDP92,FCPBGAH,937P,35x35mm,PL	1	SA	
....4	IC118	1204-003101	IC-VIDEO PROCESS;SDP94,PBGA,345P,19x19mm	1	SNA	
....4		1205-003201	IC-BUS SWITCH;TC7WB125FK,SSOP,8P,2x2.3mm	1	SA	
....4		1205-003479	IC-SWITCH;TPS2051BDBVR,SOT-23,5P,2.9x1.6	1	SA	
....4		1205-003733	IC-SWITCH;AP2191MPG-13,MSOP-8L-EP,8P,2.9	1	SA	
....4		1205-003735	IC-SWITCH;AP2151WG-7,SOT25,5P,2.9x1.6mm,	1	SA	
....4		1205-003834	IC-ETHERNET CONTROLLER;RTL8201E-VC-GR,QF	1	SA	
....4		1205-003840	IC-CODEC;WM8595GEFL/RS,QFN,48P,7x7x0.9mm	1	SA	
....4		1405-001185	VARISTOR;24Vdc,1.6x0.8x0.36mm,TP	1	SA	
....4		1405-001233	VARISTOR;30Vdc,5A,1.6x0.8x0.8mm,TP	28	SA	
....4	PR6	2007-000072	R-CHIP;47ohm,5%,1/10W,TP,1608	6	SNA	
....4	MR604	2007-000137	R-CHIP;2Kohm,5%,1/16W,TP,1005	12	SNA	
....4	R105	2007-000138	R-CHIP;100ohm,5%,1/16W,TP,1005	27	SA	
....4	AR49	2007-000140	R-CHIP;1Kohm,5%,1/16W,TP,1005	25	SNA	
....4	MR306	2007-000141	R-CHIP;2.2Kohm,5%,1/16W,TP,1005	5	SNA	
....4	R319	2007-000143	R-CHIP;4.7Kohm,5%,1/16W,TP,1005	53	SNA	
....4		2007-000146	R-CHIP;6.8Kohm,5%,1/16W,TP,1005	1	SNA	
....4	R104	2007-000148	R-CHIP;10Kohm,5%,1/16W,TP,1005	28	SA	
....4	R102	2007-000149	R-CHIP;12Kohm,5%,1/16W,TP,1005	1	SA	
....4	RR33	2007-000154	R-CHIP;24Kohm,5%,1/16W,TP,1005	1	SA	
....4	AR43	2007-000155	R-CHIP;27Kohm,5%,1/16W,TP,1005	1	SNA	
....4	MR13	2007-000157	R-CHIP;47Kohm,5%,1/16W,TP,1005	17	SNA	
....4	DR39	2007-000162	R-CHIP;100Kohm,5%,1/16W,TP,1005	8	SNA	
....4	R509	2007-000170	R-CHIP;1Mohm,5%,1/16W,TP,1005	4	SNA	
....4	R111	2007-000171	R-CHIP;0ohm,5%,1/16W,TP,1005	43	SNA	
....4	HDR17	2007-000172	R-CHIP;10ohm,5%,1/16W,TP,1005	6	SNA	
....4	R338	2007-000173	R-CHIP;22ohm,5%,1/16W,TP,1005	40	SNA	
....4	UR23	2007-000174	R-CHIP;47ohm,5%,1/16W,TP,1005	8	SNA	
....4		2007-000231	R-CHIP;1.3Kohm,1%,1/10W,TP,1608	2	SA	



## 5. Exploded View &amp; Part List

Level	Location No.	Code No.	Description & Specification	Q'ty	SA/SNA	Remark
....4	MR39	2007-000242	R-CHIP;1.5Kohm,5%,1/16W,TP,1005	1	SNA	
....4	UR53	2007-000305	R-CHIP;10Mohm,5%,1/10W,TP,1608	1	SA	
....4	HR12	2007-000591	R-CHIP;22ohm,1%,1/10W,TP,1608	1	SNA	
....4		2007-000606	R-CHIP;240ohm,1%,1/10W,TP,1608	2	SA	
....4	JR11	2007-000614	R-CHIP;24Kohm,1%,1/10W,TP,1608	2	SNA	
....4	KAR28	2007-000637	R-CHIP;270Kohm,5%,1/10W,TP,1608	1	SNA	
....4	R945	2007-000726	R-CHIP;300ohm,1%,1/10W,TP,1608	1	SA	
....4	R19	2007-000763	R-CHIP;330ohm,1%,1/10W,TP,1608	1	SNA	
....4	R528	2007-000835	R-CHIP;39ohm,1%,1/10W,TP,1608	1	SA	
....4	DR37	2007-000932	R-CHIP;470ohm,5%,1/16W,TP,1005	4	SNA	
....4	R740	2007-001217	R-CHIP;82ohm,5%,1/16W,TP,1005	1	SNA	
....4	OTR1	2007-001292	R-CHIP;33ohm,5%,1/16W,TP,1005	6	SNA	
....4	DR43	2007-001298	R-CHIP;51ohm,5%,1/16W,TP,1005	1	SNA	
....4	CER07	2007-001308	R-CHIP;200ohm,5%,1/16W,TP,1005	3	SNA	
....4	R326	2007-001325	R-CHIP;3.3Kohm,5%,1/16W,TP,1005	6	SNA	
....4		2007-001333	R-CHIP;18Kohm,5%,1/16W,TP,1005	1	SNA	
....4		2007-001335	R-CHIP;36Kohm,5%,1/16W,TP,1005	2	SA	
....4	MR316	2007-002796	R-CHIP;510ohm,5%,1/16W,TP,1005	1	SA	
....4	PR24	2007-002970	R-CHIP;56ohm,5%,1/16W,TP,1005	1	SA	
....4	AVR22	2007-003013	R-CHIP;2.4Kohm,5%,1/16W,TP,1005	1	SNA	
....4		2007-003022	R-CHIP;62ohm,5%,1/16W,TP,1005	17	SNA	
....4		2007-007008	R-CHIP;300ohm,5%,1/16W,TP,1005	1	SNA	
....4	TR30	2007-007009	R-CHIP;75ohm,5%,1/16W,TP,1005	4	SA	
....4	PR8	2007-007015	R-CHIP;13Kohm,5%,1/16W,TP,1005	1	SNA	
....4	R365	2007-007107	R-CHIP;100Kohm,1%,1/16W,TP,1005	3	SNA	
....4		2007-007132	R-CHIP;15Kohm,1%,1/16W,TP,1005	1	SA	
....4		2007-007134	R-CHIP;39Kohm,1%,1/16W,TP,1005	1	SA	
....4		2007-007136	R-CHIP;4.7Kohm,1%,1/16W,TP,1005	7	SNA	
....4		2007-007137	R-CHIP;1.2Kohm,1%,1/16W,TP,1005	1	SA	
....4		2007-007138	R-CHIP;27Kohm,1%,1/16W,TP,1005	2	SNA	
....4		2007-007139	R-CHIP;47Kohm,1%,1/16W,TP,1005	1	SA	
....4	DR4	2007-007142	R-CHIP;10Kohm,1%,1/16W,TP,1005	10	SNA	
....4		2007-007156	R-CHIP;1ohm,5%,1/16W,TP,1005	5	SNA	
....4		2007-007197	R-CHIP;3.3ohm,5%,1/16W,TP,1005	2	SNA	
....4		2007-007306	R-CHIP;100ohm,1%,1/16W,TP,1005	17	SNA	
....4		2007-007318	R-CHIP;1Kohm,1%,1/16W,TP,1005	32	SNA	
....4		2007-007352	R-CHIP;130Kohm,1%,1/10W,TP,1608	1	SA	
....4		2007-007469	R-CHIP;110ohm,1%,1/16W,TP,1005	1	SNA	
....4	HDR44	2007-007470	R-CHIP;7.5Kohm,1%,1/16W,TP,1005	2	SNA	
....4		2007-007617	R-CHIP;2.49Kohm,1%,1/10W,TP,1608	1	SA	
....4		2007-007697	R-CHIP;2.4Kohm,1%,1/16W,TP,1005	1	SNA	
....4		2007-007698	R-CHIP;5.1Kohm,1%,1/16W,TP,1005	2	SNA	
....4		2007-007724	R-CHIP;40.2ohm,1%,1/10W,TP,1608	2	SA	
....4		2007-007730	R-CHIP;6.8Mohm,1%,1/10W,TP,1608	1	SA	
....4		2007-007947	R-CHIP;36ohm,1%,1/10W,TP,1608	1	SA	
....4	MR11	2007-008015	R-CHIP;75ohm,1%,1/16W,TP,1005	24	SNA	
....4		2007-008263	R-CHIP;3Kohm,1%,1/16W,TP,1005	1	SA	
....4		2007-008275	R-CHIP;30Kohm,1%,1/16W,TP,1005	1	SNA	
....4		2007-008391	R-CHIP;6.34Kohm,1%,1/16W,TP,1005	1	SA	
....4		2007-008811	R-CHIP;1.5ohm,5%,1/16W,TP,1005	1	SA	
....4		2007-009853	R-CHIP;1.6Kohm,1%,1/16W,TP,1005	1	SNA	

5. Exploded View & Part List

Level	Location No.	Code No.	Description & Specification	Q'ty	SA/SNA	Remark
....4		2011-001015	R-NETWORK;1Kohm,5%,1/16W,L,CHIP,8P,TP,3.	4	SC	
....4	MR38	2011-001093	R-NETWORK;100ohm,5%,1/16W,L,CHIP,8P,TP,3	1	SA	
....4	ZRN10	2011-001261	R-NETWORK;33ohm,5%,1/16W,L,CHIP,8P,TP,2.	5	SA	
....4	DAR09	2011-001262	R-NETWORK;22ohm,5%,1/16W,L,CHIP,8P,TP,2.	25	SA	
....4		2011-001264	R-NETWORK;10ohm,5%,1/16W,L,CHIP,8P,TP,2.	6	SNA	
....4		2011-001345	R-NETWORK;10Kohm,5%,1/16W,L,CHIP,8P,TP,2	2	SA	
....4	DRP29	2011-001396	R-NETWORK;4.7Kohm,5%,1/16W,L,CHIP,8P,TP,	1	SA	
....4		2011-001427	R-NETWORK;0ohm,5%,1/16W,L,CHIP,8P,TP,2.0	2	SA	
....4		2011-001449	R-NETWORK;22ohm,5%,1/16W,L,4P,TP,1010	8	SA	
....4		2011-001497	R-NETWORK;470ohm,5%,1/16W,L,CHIP,4P,TP,1	2	SNA	
....4		2011-001587	R-NETWORK;100ohm,5%,1/16W,L,CHIP-V,4P,TP	1	SNA	
....4	C24	2203-000041	C-CER,CHIP;0.01nF,0.25pF,50V,C0G,1608	1	SA	
....4	AC1	2203-000125	C-CER,CHIP;1.2nF,10%,50V,X7R,TP,1608,-	6	SA	
....4	PC43	2203-000233	C-CER,CHIP;0.1nF,5%,50V,C0G,TP,1005	11	SA	
....4	MC2	2203-000254	C-CER,CHIP;10nF,10%,16V,X7R,TP,1005	6	SA	
....4	C134	2203-000257	C-CER,CHIP;10nF,10%,50V,X7R,TP,1608	1	SA	
....4	DC54	2203-000278	C-CER,CHIP;.01nF,0.5pF,50V,C0G,TP,1005	3	SA	
....4	RC34	2203-000280	C-CER,CHIP;0.01nF,0.5pF,50V,C0G,1608	3	SA	
....4	C3	2203-000384	C-CER,CHIP;0.015nF,5%,50V,C0G,1608	2	SNA	
....4	C304	2203-000405	C-CER,CHIP;0.18nF,5%,50V,C0G,1608	1	SNA	
....4	MC302	2203-000425	C-CER,CHIP;.018nF,5%,50V,C0G,TP,1005	8	SA	
....4	C254	2203-000438	C-CER,CHIP;1nF,10%,50V,X7R,TP,1005	14	SA	
....4	C507	2203-000489	C-CER,CHIP;2.2nF,10%,50V,X7R,TP,1005	3	SA	
....4	V1233	2203-000575	C-CER,CHIP;220nF,10%,25V,X7R,TP,2012	2	SNA	
....4	AD480	2203-000585	C-CER,CHIP;0.22nF,10%,50V,X7R,1005	1	SA	
....4	ZC14	2203-000626	C-CER,CHIP;0.022nF,5%,50V,C0G,1608	2	SNA	
....4	AD480	2203-000679	C-CER,CHIP;0.027nF,5%,50V,C0G,1005	1	SA	
....4	AD480	2203-000714	C-CER,CHIP;3.3nF,10%,50V,X7R,TP,1005,-	1	SA	
....4	DC25	2203-000812	C-CER,CHIP;.033nF,5%,50V,C0G,1005	9	SA	
....4	CK40B	2203-000838	C-CER,CHIP;0.39nF,5%,50V,C0G,TP,1608	3	SNA	
....4	C132	2203-000854	C-CER,CHIP;0.039nF,5%,50V,C0G,1005	4	SA	
....4	AD480	2203-000995	C-CER,CHIP;.047nF,5%,50V,C0G,TP,1005	3	SA	
....4	AC124	2203-000998	C-CER,CHIP;0.047nF,5%,50V,C0G,1608	2	SNA	
....4	HDC5	2203-001072	C-CER,CHIP;0.056nF,5%,50V,NP0,1005	1	SA	
....4	C101	2203-001124	C-CER,CHIP;0.68nF,10%,50V,X7R,TP,1005	1	SA	
....4	KAC5	2203-001126	C-CER,CHIP;0.68nF,10%,50V,X7R,1608	2	SNA	
....4	AD480	2203-001428	C-CER,CHIP;470nF,10%,50V,X7R,TP,2012	1	SNA	
....4	AD480	2203-001851	C-CER,CHIP;0.016nF,5%,50V,NP0,TP,1608	2	SNA	
....4	AD480	2203-002285	C-CER,CHIP;10nF,10%,50V,X7R,1005	18	SNA	
....4	AVC08	2203-002398	C-CER,CHIP;22nF,10%,50V,X7R,1608	10	SNA	
....4	AD480	2203-002525	C-CER,CHIP;0.56nF,10%,50V,X7R,TP,1005	1	SNA	
....4	AD480	2203-002720	C-CER,CHIP;10nF,10%,25V,X7R,TP,1005	2	SNA	
....4	C711	2203-002982	C-CER,CHIP;6.8nF,10%,50V,X7R,1005	1	SA	
....4	AD480	2203-005054	C-CER,CHIP;0.0047nF,0.25pF,50V,NP0,TP,10	3	SA	
....4	DC18	2203-005138	C-CER,CHIP;1.8nF,10%,50V,X7R,1005	6	SA	
....4	AAC1	2203-005249	C-CER,CHIP;100nF,10%,50V,X7R,TP,1608	35	SNA	
....4	AD480	2203-005344	C-CER,CHIP;22nF,10%,25V,X7R,TP,1005,-	11	SNA	
....4	AD480	2203-005393	C-CER,CHIP;0.005nF,0.1pF,50V,NP0,TP,1005	2	SNA	
....4	AD480	2203-005533	C-CER,CHIP;1000nF,20%,6.3V,X7R,TP,1608	2	SNA	
....4	PC8	2203-005642	C-CER,CHIP;0.22nF,5%,50V,NP0,1005	1	SNA	
....4	AD480	2203-005968	C-CER,CHIP;4.7nF,10%,50V,X7R,TP,1005	3	SNA	



## 5. Exploded View &amp; Part List

Level	Location No.	Code No.	Description & Specification	Q'ty	SA/SNA	Remark
....4	AD480	2203-006039	C-CER,CHIP;1nF,10%,2000V,X7R,3216	1	SA	
....4	AD480	2203-006104	C-CER,CHIP;1000nF,10%,50V,X7R,3225	1	SA	
....4	AD480	2203-006126	C-CER,CHIP;47nF,10%,16V,X7R,1005	3	SNA	
....4	PC11	2203-006141	C-CER,CHIP;1000nF,10%,16V,X5R,1608	5	SNA	
....4	C102	2203-006158	C-CER,CHIP;100nF,10%,16V,X7R,1005	256	SNA	
....4	AD480	2203-006307	C-CER,CHIP;1000nF,10%,25V,X5R,2012	1	SNA	
....4	AD480	2203-006333	C-CER,CHIP;10000nF,20%,16V,X5R,TP,3216	10	SNA	
....4	AD480	2203-006336	C-CER,CHIP;10000nF,10%,25V,X5R,3216	11	SA	
....4	C125	2203-006361	C-CER,CHIP;10000nF,10%,10V,X5R,TP,2012	4	SC	
....4	HE4	2203-006474	C-CER,CHIP;22000nF,20%,6.3V,X5R,2012	12	SA	
....4	HDC11	2203-006562	C-CER,CHIP;1000nF,10%,10V,X5R,TP,1005	26	SNA	
....4	AD480	2203-006636	C-CER,CHIP;220nF,10%,25V,X7R,1608	9	SA	
....4	AD480	2203-006824	C-CER,CHIP;4700nF,10%,10V,X5R,1608	4	SNA	
....4	AD480	2203-006992	C-CER,CHIP;0.33nF,5%,50V,C0G,TP,1005	2	SNA	
....4	AD480	2203-007176	C-CER,CHIP;10000nF,10%,16V,X5R,TP,2012	2	SNA	
....4	AD480	2203-007233	C-CER,CHIP;22000nF,10%,16V,X5R,TP,3216	2	SA	
....4	AD480	2203-007270	C-CER,CHIP;10000nF,10%,10V,X5R,TP,1608	85	SNA	
....4	C	2402-001254	C-AL,SMD;10uF,20%,50V,WT,TP,6.3x5.2mm	1	SA	
....4	C	2402-001268	C-AL,SMD;100uF,20%,25V,WT,TP,8x6.3mm	3	SA	
....4		2503-001051	C-NETWORK;100nFx4,20%,16V,2012	10	SA	
....4		2601-001056	TRANS-SMD,PULSE;350UH,-,1:1:1:1,12.7X6.7	1	SA	
....4	T0052	2703-000158	INDUCTOR-SMD;1uH,10%,2012	4	SA	
....4	T0052	2703-000222	INDUCTOR-SMD;560nH,10%,2012	3	SA	
....4	T0052	2703-000296	INDUCTOR-SMD;680nH,10%,1608	1	SA	
....4	VL6	2703-000398	INDUCTOR-SMD;10uH,10%,3225	8	SA	
....4	S1Q0361	2703-000408	INDUCTOR-SMD;3.3uH,20%,3225	1	SA	
....4	T0052	2703-001239	INDUCTOR-SMD;3.3uH,10%,1608	1	SA	
....4	T0052	2703-002238	INDUCTOR-SMD;1UH,5%,2012	2	SNA	
....4	T0052	2703-002332	INDUCTOR-SMD;330nH,5%,1608	1	SA	
....4	T0052	2703-002557	INDUCTOR-SMD;270NH,5%,1608	3	SNA	
....4	T0052	2703-003150	INDUCTOR-SMD;4.7uH,20%,5050	4	SNA	
....4		2703-003296	INDUCTOR-SMD;47uH,10%,2012	1	SNA	
....4	T0052	2703-003559	INDUCTOR-SMD;4.7uH,20%,8080	4	SNA	
....4	T0052	2703-003636	INDUCTOR-SMD;270uH,20%,10x10mm	1	SA	
....4	T0052	2703-003637	INDUCTOR-SMD;22uH,20%,7070	1	SA	
....4	T0052	2703-003713	INDUCTOR-SMD;1.5uH,20%,7366	2	SA	
....4	X202	2801-003326	CRYSTAL-SMD;24MHz,30ppm,28-ABX,20pF,50oh	2	SA	
....4	X202	2801-003773	CRYSTAL-SMD;12MHz,30ppm,28-AAN,20pF,50oh	1	SA	
....4	X202	2801-003954	CRYSTAL-SMD;27MHz,30ppm,28-AAN,16pF,50oh	1	SA	
....4	X202	2801-004629	CRYSTAL-SMD;27MHz,20ppm,12pF,50ohm,TP	1	SNA	
....4	X202	2801-004734	CRYSTAL-SMD;25.000000MHz,20ppm,28-AAN,12	1	SA	
....4		2804-001878	OSCILLATOR-CLOCK;49.152MHz,50ppm,10TTL/1	1	SA	
....4	F103	2901-001506	FILTER-EMI SMD;5V,0.13A,0pF,2x1x0.5mm,TP	2	SA	
....4	T0568	3301-001236	BEAD-SMD;60ohm,1608	14	SNA	
....4	T0568	3301-001404	BEAD-SMD;30ohm,2012,TP,15.9OHM/30MHz	47	SA	
....4	T0568	3301-001526	BEAD-SMD;10ohm,1.6x0.8x0.8mm,1000mA,TP,,	14	SNA	
....4	T0568	3301-002039	BEAD-SMD;26ohm,1608,TP	10	SA	
....4		3701-001293	CONNECTOR-HDMI;19P,2R,FEMALE,SMD-A,AU	4	SA	
....4	CN906	3707-001095	CONNECTOR-OPTICAL;SMD-A(Ultra Slim),SPDI	1	SA	
....4	AC510	3708-002777	CONNECTOR-FPC/FFC/PIC;82P,0.5mm/0.75mm,S	1	SA	
....4		3710-002276	SOCKET-INTERFACE;24P,1R,0.5mm,SMD-A,AU,B	1	SA	

5. Exploded View & Part List

Level	Location No.	Code No.	Description & Specification	Q'ty	SA/SNA	Remark
...4	CON_US	3711-005616	HEADER-BOARD TO CABLE;BOX,10P,1R,2mm,SMD	1	SNA	
...4	HB01A	3711-007336	HEADER-BOARD TO CABLE;BOX,4P,1R,2.5mm,SM	2	SA	
...4		3722-003044	JACK-USB;4P/1C,NI,BLK,SMD-A,A-TYPE	2	SA	
...4		BN41-01444B	PCB MAIN;C6500 valencia eu,FR-4,4,1.2T,2	1	SNA	
...4		BN97-04194A	ASSY MICOM-MAIN;T-VALDEUC-1013.2,2010.05	1	SNA	
....5		1107-001868	IC-NAND FLASH;KFG8GH6U4M-AIB6,1GByte,512	1	SNA	
...4		BN97-04244A	ASSY MICOM-SUB;T-VAL8DEUS-1005,2010.04.2	1	SNA	
....5	IC520	0903-001651	IC-MICROCONTROLLER;61P802-RG480WT,LQFP,4	1	SNA	
...3		BN97-04241A	ASSY CI PLUS;BN46-00027A,platform Euro C	1	SNA	
...4		BN46-00027A	KEY CODE-CI PLUS;CI PLUS KEY,TCTC,SERIAL	1	SNA	
0.1		BN92-05617B	ASSY P/MATERIAL;UC6200 46	1	SNA	
.2	T0214	0203-001595	TAPE-OPP MASKING;OPP-2,0.075,75,800M,CLR	3	SNA	
.2	M040	6922-000003	BAND PP;PP,T0.8,W18,L1650M,TRP,DA69-9014	1.29	SNA	
.2		BN68-02422B	LABEL-WARNING SHIPPING;ALL MODEL,A/P 100	1	SNA	
.2		BN69-00257E	PACKING-BAG SHEET;- ,CB,- ,1400,500,-,-,WH	1	SNA	
.2		BN69-03982C	PAD PACKING-EDGE;LB6T,PAPER,8,120,1690,Y	1	SNA	
.2		BN69-04539A	CUSHION-SET;46UC6-FS,EPS,15.4g/l	1	SNA	
.2		BN69-04822V	PALLET;- ,WOOD,1355,1160,130,-,-,SESK-80	1	SNA	
.2		6902-001183	BAG PE;HDPE/NITRON,T0.015/T0.5,W1300,L90	1	SNA	
.2		BN69-00257C	PACKING-PAD;PAPER,CB-SW4,1350,830,YEL,36	1	SNA	
.2		6902-000379	BAG AIR;LDPE,T0.2,W1000,L1800,TRP,1260.0	1	SNA	
.2		BN69-05418A	PACKING-BAG WRAPPING;- ,LDPE,- ,0,019,500,	3.59	SNA	
0.1		BN92-05653B	ASSY BOX;UC6510 46	1	SNA	
.2		BH68-00662A	LABEL BOX-00;ALL MODEL,MOJO 90G,60,110,W	1	SNA	
.2		BN69-05067A	BOX-01,SET;46UC6710-FS,CB,A-01,DW3, YEL,	1	SNA	
0.1		BN92-05795B	ASSY LABEL;UE32C6510UWXXC	1	SNA	
.2	T0527	BP68-00052B	LABEL-00,RATING;CCTV,TETRON PAPER,T0.05,	1	SNA	
0.1	ACCE1	BN92-05937T	ASSY ACCESSORY;UE40C6710USXZG	1	SNA	
.2	ACCE4	BN96-13318D	ASSY ACCESSORY-MANUAL;UE32C6700USXZG	1	SNA	
...3	T0524	6902-000110	BAG PE;LDPE,T0.05,W250,L400,TRP,28,2,9.2	1	SNA	
...3	T0527	BN68-00513A	LABEL-E,PASS;ALL MODEL,YUPO(110G),50X15,	1	SNA	
...3		BN68-00514E	MANUAL FLYER-05,WARRANTY CARD;comm,Samsu	1	SNA	
...3		BN68-02186A	MANUAL FLYER-TOC GUIDE;COMM,SAMSUNG,11 L	1	SNA	
...3		BN68-02841A	MANUAL USERS;C6700,SAMSUNG,4LANGS,ZG,W/P	1	SNA	
...3		AA68-03242V	MANUAL FLYER-SAFETY GUIDE;comm,Samsung,1	1	SNA	
.2	ACCE2	BN96-14059B	ASSY ACCESSORY-CABEL;UE40C6510UWXXC	1	SNA	
...3	EC11	3903-000525	CBF-POWER CORD;DT,CEE,LP-21L,250V,2.5A,B	1	SA	
...3	T0120	4301-000121	BATTERY-MN;1.5V,R03,10.5x44.5m,HOLDER,7.	2	SNA	
...3	REMO2	BN59-01078A	REMOCON;TM1060,SAMSUNG,20PIN SINGLE,49KE	1	SA	
...3		BN61-05596A	HOLDER-WIRE CABLE;LED TV,LDPE,T0.8,L150,	1	SNA	
...3	M9889	BN63-01798B	CLOTH-CLEAN;cloth,180,200,sea blue,ToC	1	SNA	
...3	T0527	BN68-00513A	LABEL-E,PASS;ALL MODEL,YUPO(110G),50X15,	1	SNA	
...3	EH03A	BN96-10276B	ASSY HOLDER P-RING;09 LEDTV ALL MODEL,AB	1	SA	
...4		6902-000683	BAG ZIPPER;LDPE,T0.05,W60,L60,TRP,4-PE M	1	SNA	
...4	AH365	BN61-05280A	HOLDER-RING;LB7000 46inch,ABS, HB,gray	4	SNA	
...3	EH02A	BN96-10810A	ASSY HOLDER P;09 LEDTV MODEL,NYRON	1	SA	
...4	BAG	6902-000031	BAG ZIPPER;LDPE,T0.05,W80,L160,TRP,0,0,4	1	SNA	
...4	M0114	BN61-05373A	HOLDER-WIRE;LB7000 46,NYRON	3	SNA	
...4		BN61-05491A	HOLDER-WIRE STAND;UB7000 46inch,NYRON	1	SNA	
...3	M0114	BN39-01154C	CBF SIGNAL;Chelsea Slim, STEREO Plug to	1	SA	
...3	M0114	BN39-01154F	CBF SIGNAL;UE40B7000WWXXC,24P/20P,30AWG,	1	SA	

## 5. Exploded View &amp; Part List

Level	Location No.	Code No.	Description & Specification	Q'ty	SA/SNA	Remark
...3	M0114	BN39-01154H	CBF SIGNAL;UE40B7000WWXXC,RCA 3PIN,30AWG	1	SA	
...3	T0524	6902-000110	BAG PE;LDPE,T0.05,W250,L400,TRP,28,2,9.2	1	SNA	
...3		BN96-14099A	ASSY ACCESSORY-CLAMP;10 LEDTV(40/46/55),	1	SNA	
....4		AA65-30023A	CLAMPER CORE-CABLE;NYLON-66,BLK	1	SA	
....4		BN69-04419J	PACKING-BAG PE;UC5000,LDPE,70,90,Power-C	1	SNA	
...3		BN96-12031W	ASSY ACCESSORY-SCREW;UC6510/6710,Europe,	1	SNA	
....4		6001-000154	SCREW-MACHINE;BH,+,M4,L8,NI PLT,SWRCH18A	1	SNA	
....4		BN69-04419E	PACKING-BAG PE;LB650,LDPE,70,90,6003-000	1	SNA	
...3	RB01	BN63-06543F	COVER-BOTTOM;UC6500 40inch,ABS+PC,V0,WT0	1	SA	
....4		0103-007442	RESIN-PC ABS;NH-1017SG/W91902,WT0034,2.0	70	SNA	