

5-2. UE46B7000WP Exploded View

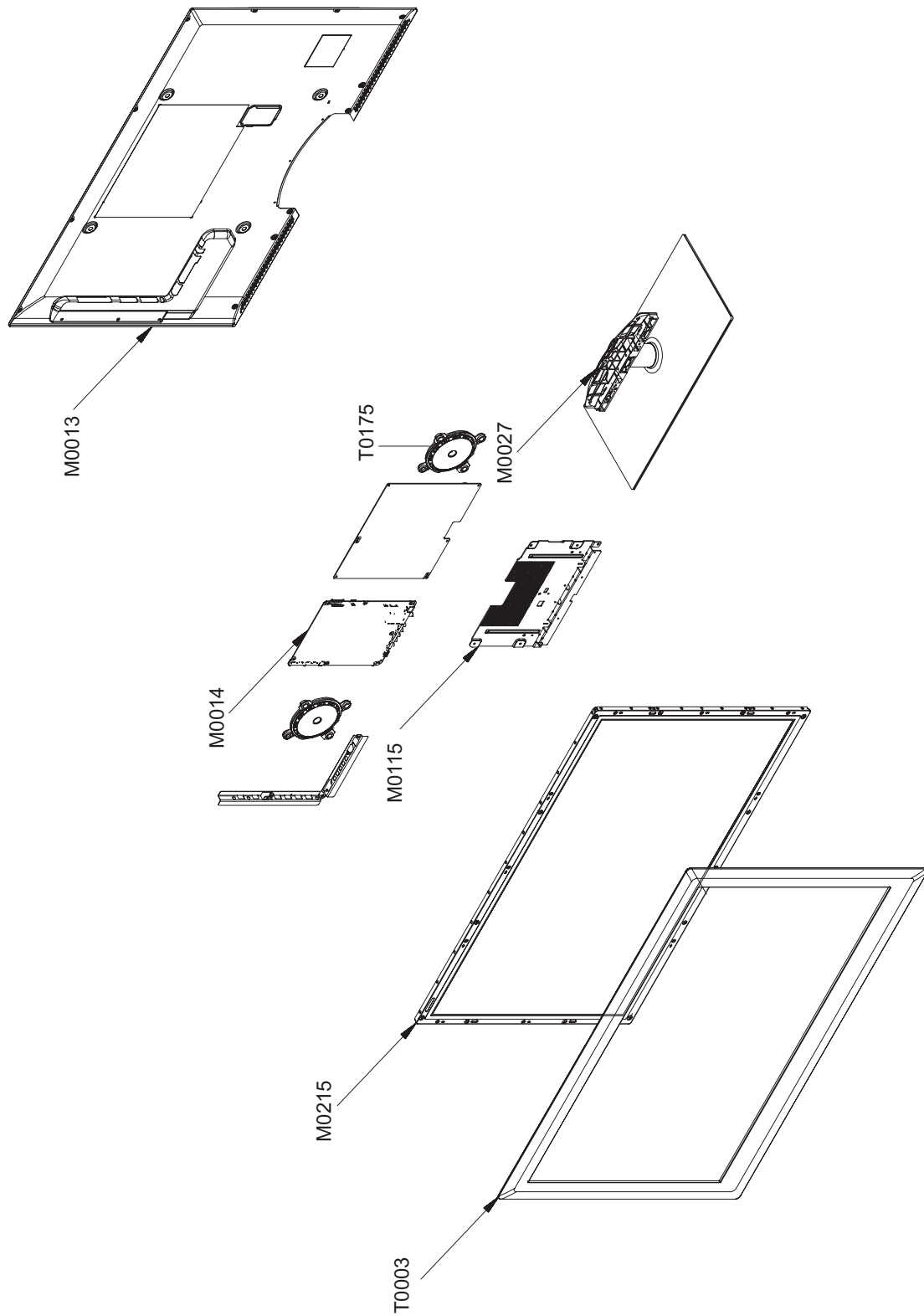

5-2-1. UE46B7000WP Parts List

Location No.	Code No.	Description & Specification	Q'ty	S.A/S.N.A	Remark
T0003	BN96-09972C	ASSY COVER P-FRONT;UB7000 46,PC(CLR)+PC(1	S.A	
M0215	BN07-00701B BN07-00735A	LCD-PANEL	1	S.A	
T0175	BN96-09468B	ASSY SPEAKER P;8ohm,4pin,Diameter: 120mm	1	S.A	
T0175	BN96-09470B	ASSY SPEAKER P;8ohm,4pin,15W,R:850 / L:5	1	S.A	
M0115	BN61-05536A	BRACKET-STAND LINK;UB7000 46inch,HGI,T3.	1	S.N.A	
M0014	BN94-02764D	ASSY PCB MAIN-SQE;UE46B7000WPX*	1	S.A	
M0013	BN96-09977B	ASSY COVER P-REAR;LB7000 46inch,PCM T0.5	1	S.A	
M0027	BN96-09477C	ASSY STAND P-BASE;46 LB7000,PI50 X L96,G	1	S.A	

5-2-2. UE46B7020WW Parts List

Location No.	Code No.	Description & Specification	Q'ty	S.A/S.N.A	Remark
T0003	BN96-09972D	ASSY COVER P-FRONT;UB7020 46,PC(CLR)+PC(1	S.A	
M0215	BN07-00701B BN07-00735A	LCD-PANEL	1	S.A	
T0175	BN96-09468B	ASSY SPEAKER P;8ohm,4pin,Diameter: 120mm	1	S.A	
T0175	BN96-09470B	ASSY SPEAKER P;8ohm,4pin,15W,R:850 / L:5	1	S.A	
M0115	BN61-05536A	BRACKET-STAND LINK;UB7000 46inch,HGI,T3.	1	S.N.A	
M0014	BN94-02706N	ASSY PCB MAIN-SQE;UE46B7000WWX*	1	S.A	
M0013	BN96-09977B	ASSY COVER P-REAR;LB7000 46inch,PCM T0.5	1	S.A	
M0027	BN96-09477C	ASSY STAND P-BASE;46 LB7000,PI50 X L96,G	1	S.A	