

# 1. Exploded View & Part List

## Exploded View

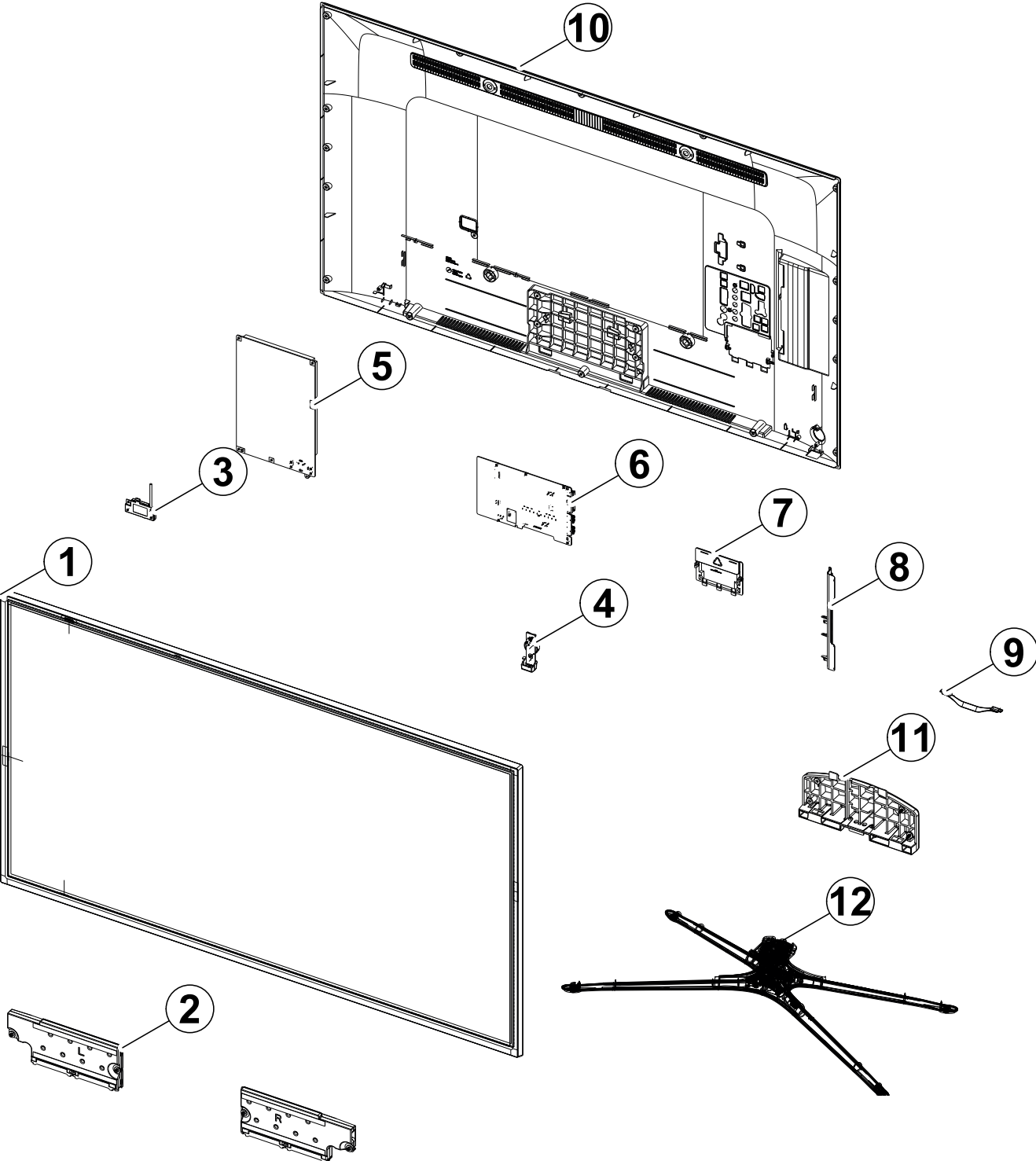

**Parts List**

No.	Lvl.	Loc.	Material Code	Description & Specification	SNA	Qty.
1	2	PANEL	BN07-01273A	LCD-PANEL; HF420BGA-B1,BFHEBA1,10bit,42 I	SA	1
2	2	SP01A	BN96-25565B	ASSY SPEAKER P; 6ohm,10W,Enclosure_6000	SA	1
3	2	NW01	BN59-01161A	NETWORK; WIDT-30Q,Internal WiFi,USB,IEEE8	SA	1
4	3	FB01A	BN96-26411L	ASSY BOARD P-JOG SWITCH & IR; UE42F5500,F	SA	1
5	2	P001A	BN44-00645A	DC VSS-LED TV PD BD; L42S1_DSM,PSLF121S05	SA	1
6	2	M0014	BN94-06309M	ASSY PCB MAIN; UF5F,F5000	SA	1
7	2	FC05	BN63-10178B	COVER-JACK; UF6100,46,EO,MPPE,BK0020,V1	SNA	1
8	3		BN61-09108A	HOLDER-SIDE AV; UF5500,HIPS,W/W 1Tuner	SNA	1
9	2	FD01A	BN96-10973C	ASSY DECORATION P; UF5500,ABS+PC,SILVER L	SA	1
10	2	R001A	BN96-25356D	ASSY COVER P-REAR; UF5500,42,EO,MPPE,V1,B	SA	1
11	2	SG01A	BN96-25543A	ASSY GUIDE P-STAND; UF6100 40,QUAD	SA	1
12	2	SB04A	BN96-25364F	ASSY STAND P-BASE; F6300(QUAD),40,EO,BLAC	SA	1

## 2. Electrical Parts List

Level	Loc.	Part Code	Description & Specification	Qty.	SA/SNA
			<b>UE42F5500AWXXC (AS02)</b>		
1	S001A	BN90-04144W	ASSY STAND;UF6400 40	1	SNA
.2	SB04A	BN96-25364F	ASSY STAND P-BASE;F6300(QUAD),40,EO,BLAC	1	SA
..3		6002-001294	SCREW-TAPPING;BH,+,M4,L16,ZPC(BLK)	4	SA
..3	SCREW	6003-001315	SCREW-TAPTYPE;BH,+,B,M4,L20,ZPC(WHT),SWR	4	SNA
..3	SCREW	6003-001425	SCREW-TAPTYPE;BH,+,B,M4,L25,ZPC(BLK),SWR	1	SNA
..3	SCREW	6003-001785	SCREW-TAPTYPE;FH,+,B,M4,L8,ZPC(BLK),SWRC	4	SA
..3		BN61-07171C	HOLDER-SWIVEL, TOP;40 QUAD STAND,ACETAL,D	1	SNA
..3		BN61-07175A	BRACKET-SWIVEL, TOP;UD8000 32/3740 QUAD,S	1	SNA
..3		BN61-07738A	BRACKET-SWIVEL,BOTTOM;UD8000 37/40 QUAD,	1	SNA
..3		BN61-08733A	HOLDER-SWIVEL,BOTTOM;32-40 SLIM QUAD STA	1	SNA
...4		0103-009825	RESIN-POM;TS-25A,Dark Gray,GY0199,HB	4	SNA
..3		BN61-08734A	HOLDER-STAND,NECK;32-40 SLIM QUAD STAND,	1	SNA
..3		BN61-08735A	BRACKET-STAND, TOP;32-40 SLIM QUAD STAND,	1	SNA
..3		BN61-08736A	BRACKET-STAND,BOTTOM;32-40 SLIM QUAD STA	1	SNA
..3		BN63-05135E	COVER-SHEET;4-LEG,Rhcm PE Vinyl,T0.05,W6	1	SNA
..3		BN63-10157A	COVER-STAND,BASE;32-40 SLIM QUAD STAND,A	1	SNA
..3		BN63-10702D	COVER-STAND, TOP-FRONT;F5500,42,ABS+PC,-,	1	SNA
..3		BN63-10705D	COVER-STAND, TOP-REAR, LEFT;F5500,42,ABS+	1	SNA
..3		BN63-10708D	COVER-STAND, TOP-REAR, RIGHT;F5500,42,ABS+	1	SNA
...4		0103-005041	RESIN-PC;FR3200TV,901408,BK0008,1.2mm V-	55	SNA
..3		BN67-00385D	RUBBER-FOOT;RUBBER-FOOT,SILICONE,ROUND,1	4	SNA
.2	SG01A	BN96-25543A	ASSY GUIDE P-STAND;UF6100 40,QUAD	1	SA
..3	SG03	BN61-08823A	GUIDE-STAND;UF6100 55",PC+GF,G/F 20%	1	SNA
...4		0103-007285	RESIN-PC;MW32020GFU,K032202GFV,BK0007,V2	250	SNA
...4		BN68-00513D	LABEL-RESIN;resin,-,art paper,-,10,25,-,	1	SNA
..3	T0527	BN68-00513A	LABEL-E,PASS;ALL MODEL,YUPO(110G),50X15,	1	SNA
..3		BN69-08751A	WRAP VINYL-SHRINK;STAND,PLASTIC OTHERS,P	0	SNA
..3		BN96-18013E	ASSY ACCESSORY-SCREW;6003-001782,4EA,ALL	2	SNA
...4	SCREW	6003-001782	SCREW-TAPTYPE;BH,+,B,M4,L12,ZPC(BLK),SWR	8	SA
...4		BN69-08203E	PACKING-BAG-SCREW;LDPE,0.05,70,90,TRP,Vi	2	SNA
1	R001A	BN90-04430D	ASSY COVER REAR;UF5000 42	1	SNA
.2		6001-002755	SCREW-MACHINE;BH,+,M3,L6,ZPC(BLK),SWRCH1	4	SA
.2	SCREW	6003-001782	SCREW-TAPTYPE;BH,+,B,M4,L12,ZPC(BLK),SWR	14	SA
.2	R001A	BN96-25356D	ASSY COVER P-REAR;UF5500,42,EO,MPPE,V1,B	1	SA
..3		0203-001598	TAPE-FILAMENT;#8915,0.15,12,55000,CLR	0	SNA
..3	SCREW	6003-000115	SCREW-TAPTYPE;BH,+,B,M3,L6,ZPC(BLK),SWRC	2	SNA
..3	R001	BN63-10425C	COVER-REAR;UF5300,42,EO MASTER,MPPE,V1,B	1	SNA

Exploded Views and Parts List

Level	Loc.	Part Code	Description & Specification	Qty.	SA/SNA
...4		0103-009565	RESIN-MPPE;ST855,1D129A,BK0020	1880	SNA
...3		BN63-10851A	SHEET-COVER;UF5000,PET,0.1,45,16,BLACK	2	SNA
...3	T0071	BN64-02224W	INLAY-TERMINAL;F6100,PS SHEET,T0.5,UK	1	SNA
...3		BN68-03518D	LABEL-STICKER-CI SLOT;WW,ALL,PE,132.5,72	1	SNA
...3		BN68-04734A	LABEL-TERMINAL SIDE;F5300/5500,PET,T0.05	1	SNA
...3		BN74-00052A	TAPE-PAPER;LB550,Crepe Paper,0.18mm, 10m	0	SNA
...3	FB01A	BN96-26411L	ASSY BOARD P-JOG SWITCH & IR;UE42F5500,F	1	SA
...4	EC13	BN39-01765M	LEAD CONNECTOR;UE42F5500,Flat Connector	1	SNA
...4		BN96-26411A	ASSY BOARD P-JOG SWITCH & IR;UE32F5000,F	1	SNA
1		BN90-04604A	ASSY W/I;UF5K,U42FK*	1	SNA
.2		BN81-08159Z	PART SET-ELEC W/I;UF4* ~ UF8* ELEC	1	SNA
.2		BN81-08368A	PART SET-MECH W/I;UF5K,U42FK*	1	SNA
1		BN91-10310V	ASSY SHIELD;F5000	1	SNA
.2		6001-003016	SCREW-MACHINE;PWH,+,M3.0,L5.0,ZPC(WHT),S	9	SA
.2	SCREW	6003-000115	SCREW-TAPTYPE;BH,+,B,M3,L6,ZPC(BLK),SWRC	1	SNA
.2		BN02-00102B	TAPE FILAMENT;UE7000,#893,0.15,25,50,WHI	0	SNA
.2	EC13	BN39-01652W	LEAD CONNECTOR;UE42F5500,Lead Connector,	1	SNA
.2	EC13	BN39-01800B	LEAD CONNECTOR;39inch 42inch Top-Side Di	1	SA
.2	P001A	BN44-00645A	DC VSS-LED TV PD BD;L42S1_DSM,PSLF121S05	1	SA
.2	NW01	BN59-01161A	NETWORK;WIDT-30Q,Internal WiFi,USB,IEEE8	1	SA
.2	FC05	BN63-10178B	COVER-JACK;UF6100,46,EO,MPPE,BK0020,V1	1	SNA
...3		0103-009565	RESIN-MPPE;ST855,1D129A,BK0020	18	SNA
.2	FD01A	BN96-10973C	ASSY DECORATION P;UF5500,ABS+PC,SILVER L	1	SA
...3		BN63-07229T	COVER-SHEET;Y12 F-LED,SILICONE,T0.052,W	0	SNA
...3	FD01	BN63-10222C	COVER-DECORATION;UF5500,ABS+PC,V2,SV0016	1	SNA
...4		0103-009959	RESIN-PC ABS;LM-1090,Silver,SV0016,V1 (1	5	SNA
.2	SP01A	BN96-25565B	ASSY SPEAKER P;6ohm,10W,Enclosure_6000	1	SA
.2	FL06	BN96-26699M	ASSY CABLE P-FFC;UE42F5500,FFC,358mm,51P	1	SA
1		BN91-10461A	ASSY LCD;BN07-01273A	1	SNA
.2	PANEL	BN07-01273A	LCD-PANEL;HF420BGA-B1,BFHEBA1,10bit,42 I	1	SA
...3	TC01A	BN81-08317A	A/S-CHASS-TOP;F5000 42",AUO(Brивiew)	1	SNA
...3	TCON	BN96-25502A	ASSY T CON P;HF420BGA-B1,10bit,42 inch,F	1	SNA
1	M0017	BN91-10596J	ASSY CHASSIS;UF5K,F5000	1	SNA
.2	M0014	BN94-06309M	ASSY PCB MAIN;UF5F,F5000	1	SA
...3		BN61-09108A	HOLDER-SIDE AV;UF5500,HIPS,W/W 1Tuner	1	SNA
...4		0103-004628	RESIN-HIPS;HF-1690H,K2901,BK0020,1.5mm H	13	SNA
...3		BN62-00365A	HEAT SINK-PS;UN46ESF8000AF,A1050,ANODIZI	1	SNA
...3		BN62-00367A	PAD GAP;F6400,SILICON,35 35 mm,6.5,Light	1	SNA
...3		BN67-00364C	RUBBER-FOOT;X13,RUBBER,10*10,6,Dark Gray	1	SNA
...3		BN97-07024E	ASSY SMD;UF5H,F5000,UF5H	1	SNA

Level	Loc.	Part Code	Description & Specification	Qty.	SA/SNA
...4		0202-001899	SOLDER-CREAM;M705-GRN360-K2-VT,25-36um,S	8	SNA
...4	DS01A	0401-001056	DIODE-SWITCHING;MMBD4148SE,100V,200mA,SO	2	SA
...4		0403-001783	DIODE-ZENER;BZB84-C6V2,5.8/6.6V,300mW,SO	3	SNA
...4		0404-001404	DIODE-SCHOTTKY;BAT721C,40V,200mA,SOT-23,	3	SA
...4		0406-001200	DIODE-TVS;RCLAMP0504F,6/-V,150W,SC-70	4	SA
...4		0406-001271	DIODE-TVS;RCLAMP0524P,6/-V,150W,SLP251	1	SNA
...4		0501-000279	TR-SMALL SIGNAL;KSA1182-Y,PNP,150mW,SOT-	2	SA
...4		0501-000445	TR-SMALL SIGNAL;KTC3875S-Y,NPN,150mW,SOT	9	SC
...4		0505-000110	FET-SILICON;2N7002,N,60V,115mA,7.5ohm,0.	8	SA
...4		0505-002560	FET-SILICON;AO6415,P,-20V,-3.3A,0.15ohm,	1	SA
...4		0505-002598	FET-SILICON;AP2317GN,P,-20V,-4.2A,0.052o	1	SA
...4		0801-002701	IC-CMOS LOGIC;74VHCT125A,BUFFER,TSSOP,14	1	SA
...4		0801-002780	IC-CMOS LOGIC;74LVC1G17,SCHMITT-TRIGGER	1	SA
...4		0801-003330	IC-CMOS LOGIC;Octal buffer,DQFN,20P,4.5x	1	SA
...4		0904-002803	IC-USC;AU6258S-JKF,QFN,28Z30,5.0mm X 5.0	1	SNA
...4		1001-001545	IC-ANALOG MULTIPLEX;TS3USB221ERSER,R-PQF	1	SA
...4		1103-001487	IC-EEPROM;AT24C256C-SSHL-T,256Kbit,32Kx8	1	SA
...4		1105-002338	IC-DDR3 SDRAM;K4B4G1646B-HCMA,DDR3 1866,	1	SA
...4		1105-002430	IC-DDR3 SDRAM;K4B2G1646E-BCMA,DDR3 1866,	2	SA
...4		1201-003183	IC-AUDIO AMP;DRV612,HTSSOP,14P,5x4.4mm,D	1	SA
...4		1201-003526	IC-AUDIO AMP;TAS5745,QFP,48Z30,7x7mm,DUA	1	SNA
...4		1203-004364	IC-VOL. DETECTOR;RT9818C-42PV,SOT-23,3P,	1	SA
...4		1203-006109	IC-POSI.FIXED REG.;S-1206B33-M3T1G,SOT-2	2	SA
...4		1203-006130	IC-POSI.FIXED REG.;S-1172B25-U5T1G,SOT-8	1	SA
...4		1203-006135	IC-POSI.FIXED REG.;AP1117D-33-GZ-13-89,T	1	SA
...4		1203-006136	IC-POSI.FIXED REG.;AP1117D-18-GZ-13-89,T	1	SA
...4		1203-006138	IC-POSI.ADJUST REG.;AP1117DGZ-13-89,TO-2	1	SA
...4		1203-007238	IC-PWM CONTROLLER;TPS54427,DDA,8P,4.8x3.	1	SNA
...4		1203-007242	IC-POSI.ADJUST REG.;G2992BP11U,SOP-8,8P,	1	SA
...4		1203-007502	IC-DC/DC CONVERTER;AOZ3011PI,SO-8,8Z30,4	1	SA
...4		1203-007695	IC-DC/DC CONVERTER;AOZ3018,SO-8,8Z30,4,9	1	SNA
...4		1203-007728	IC-VOL. DETECTOR;RT9831GQW,QW : WQFN-20L	1	SA
...4		1204-003421	IC-DECODER;SEMS30,PBGA,729Z30,21.6x21.6m	1	SA
...4		1205-004447	IC-SWITCH;TPS2051CDBVR,SOT23-5,5P,3x1.65	3	SA
...4		1205-004691	IC-SWITCH;BD82022FVJ,MSOP-8L JEDEC,8Z30,	1	SNA
...4		1405-001271	VARISTOR;35V,20Vdc,5A,1.0x0.5x0.6mm,TP,1	27	SA
...4		2007-000137	R-CHIP;2Kohm,5%,1/16W,TP,1005	13	SNA
...4		2007-000138	R-CHIP;100ohm,5%,1/16W,TP,1005	13	SA
...4		2007-000142	R-CHIP;2.7Kohm,5%,1/16W,TP,1005	1	SNA
...4		2007-000143	R-CHIP;4.7Kohm,5%,1/16W,TP,1005	41	SNA

## Exploded Views and Parts List

Level	Loc.	Part Code	Description & Specification	Qty.	SA/SNA
...4		2007-000148	R-CHIP;10Kohm,5%,1/16W,TP,1005	41	SA
...4		2007-000153	R-CHIP;22Kohm,5%,1/16W,TP,1005	6	SNA
...4		2007-000155	R-CHIP;27Kohm,5%,1/16W,TP,1005	1	SNA
...4		2007-000157	R-CHIP;47Kohm,5%,1/16W,TP,1005	14	SNA
...4		2007-000170	R-CHIP;1Mohm,5%,1/16W,TP,1005	3	SNA
...4		2007-000171	R-CHIP;0ohm,5%,1/16W,TP,1005	11	SNA
...4		2007-000172	R-CHIP;10ohm,5%,1/16W,TP,1005	4	SNA
...4		2007-000173	R-CHIP;22ohm,5%,1/16W,TP,1005	12	SNA
...4		2007-000174	R-CHIP;47ohm,5%,1/16W,TP,1005	2	SNA
...4		2007-000256	R-CHIP;1.6Kohm,1%,1/10W,TP,1608	1	SA
...4		2007-000336	R-CHIP;120Kohm,1%,1/10W,TP,1608	1	SA
...4		2007-000583	R-CHIP;22Kohm,1%,1/10W,TP,1608	2	SA
...4		2007-000695	R-CHIP;3.3ohm,5%,1/10W,TP,1608	2	SNA
...4		2007-000775	R-CHIP;33Kohm,5%,1/16W,TP,1005	1	SNA
...4		2007-000803	R-CHIP;36Kohm,1%,1/10W,TP,1608	2	SA
...4		2007-000857	R-CHIP;4.3Kohm,1%,1/10W,TP,1608	5	SNA
...4		2007-000932	R-CHIP;470ohm,5%,1/16W,TP,1005	3	SNA
...4		2007-000979	R-CHIP;5.6Kohm,1%,1/10W,TP,1608	1	SA
...4		2007-001116	R-CHIP;680ohm,1%,1/10W,TP,1608	1	SA
...4		2007-001125	R-CHIP;68Kohm,1%,1/10W,TP,1608	1	SA
...4		2007-001168	R-CHIP;75ohm,5%,1/4W,TP,3216	1	SA
...4		2007-001288	R-CHIP;18ohm,5%,1/16W,TP,1005	4	SA
...4		2007-001292	R-CHIP;33ohm,5%,1/16W,TP,1005	14	SNA
...4		2007-001298	R-CHIP;51ohm,5%,1/16W,TP,1005	2	SNA
...4		2007-001301	R-CHIP;68ohm,5%,1/16W,TP,1005	7	SA
...4		2007-002970	R-CHIP;56ohm,5%,1/16W,TP,1005	4	SA
...4		2007-003015	R-CHIP;2.2ohm,5%,1/16W,TP,1005	1	SNA
...4		2007-003022	R-CHIP;62ohm,5%,1/16W,TP,1005	26	SNA
...4		2007-007095	R-CHIP;390ohm,5%,1/16W,TP,1005	1	SA
...4		2007-007107	R-CHIP;100Kohm,1%,1/16W,TP,1005	7	SNA
...4		2007-007135	R-CHIP;18Kohm,1%,1/16W,TP,1005	4	SNA
...4		2007-007138	R-CHIP;27Kohm,1%,1/16W,TP,1005	1	SNA
...4		2007-007142	R-CHIP;10Kohm,1%,1/16W,TP,1005	2	SNA
...4		2007-007156	R-CHIP;1ohm,5%,1/16W,TP,1005	9	SNA
...4		2007-007238	R-CHIP;8.25Kohm,1%,1/10W,TP,1608	1	SA
...4		2007-007316	R-CHIP;3.3Kohm,1%,1/16W,TP,1005	3	SNA
...4		2007-007318	R-CHIP;1Kohm,1%,1/16W,TP,1005	30	SNA
...4		2007-007331	R-CHIP;90.9Kohm,1%,1/10W,TP,1608	1	SA
...4		2007-007463	R-CHIP;1.1Kohm,1%,1/16W,TP,1005	1	SA
...4		2007-007470	R-CHIP;7.5Kohm,1%,1/16W,TP,1005	1	SNA

Level	Loc.	Part Code	Description & Specification	Qty.	SA/SNA
...4		2007-007517	R-CHIP;240ohm,1%,1/16W,TP,1005	4	SNA
...4		2007-007538	R-CHIP;56Kohm,1%,1/16W,TP,1005	1	SA
...4		2007-007766	R-CHIP;2Kohm,1%,1/16W,TP,1005	1	SNA
...4		2007-007942	R-CHIP;1Mohm,1%,1/16W,TP,1005	1	SNA
...4		2007-007981	R-CHIP;180Kohm,1%,1/16W,TP,1005	1	SNA
...4		2007-008015	R-CHIP;75ohm,1%,1/16W,TP,1005	11	SNA
...4		2007-008133	R-CHIP;56.2Kohm,1%,1/10W,TP,1608	1	SA
...4		2007-008137	R-CHIP;24Kohm,1%,1/16W,TP,1005	2	SNA
...4		2007-008275	R-CHIP;30Kohm,1%,1/16W,TP,1005	1	SNA
...4		2007-008298	R-CHIP;49.9ohm,1%,1/16W,TP,1005	4	SA
...4		2007-008426	R-CHIP;12.4Kohm,1%,1/10W,TP,1608	1	SA
...4		2007-008649	R-CHIP;220ohm,1%,1/16W,TP,1005	1	SNA
...4		2007-008807	R-CHIP;53.6Kohm,1%,1/16W,TP,1005	1	SA
...4		2011-001261	R-NETWORK;33ohm,5%,1/16W,L,CHIP,8P,TP,2.	2	SA
...4		2011-001262	R-NETWORK;22ohm,5%,1/16W,L,CHIP,8P,TP,2.	1	SA
...4		2011-001344	R-NETWORK;100ohm,5%,1/16W,L,CHIP,8P,TP,2	4	SA
...4		2011-001449	R-NETWORK;22ohm,5%,1/16W,L,4P,TP,1010	4	SA
...4		2011-001506	R-NETWORK;10Kohm,5%,1/16W,L,CHIP,4P,TP,1	6	SNA
...4		2011-001527	R-NETWORK;4.7Kohm,5%,1/16W,L,CHIP,4P,TP,	4	SNA
...4		2011-001587	R-NETWORK;100ohm,5%,1/16W,L,CHIP-V,4P,TP	5	SNA
...4	AD480	2203-000233	C-CER,CHIP;0.1nF,5%,50V,C0G,TP,1005	6	SA
...4	AD480	2203-000386	C-CER,CHIP;0.015nF,5%,50V,C0G,TP,1005	3	SA
...4	AD480	2203-000425	C-CER,CHIP;0.018nF,5%,50V,C0G,TP,1005	3	SA
...4	AD480	2203-000438	C-CER,CHIP;1nF,10%,50V,X7R,TP,1005	9	SA
...4	AD480	2203-000489	C-CER,CHIP;2.2nF,10%,50V,X7R,TP,1005	7	SA
...4	AD480	2203-000530	C-CER,CHIP;2.7nF,10%,50V,X7R,TP,1005,-	1	SNA
...4	AD480	2203-000575	C-CER,CHIP;220nF,10%,25V,X7R,TP,2012	6	SNA
...4	AD480	2203-000679	C-CER,CHIP;0.027nF,5%,50V,C0G,TP,1005	2	SA
...4	AD480	2203-000812	C-CER,CHIP;0.033nF,5%,50V,C0G,TP,1005	7	SA
...4	AD480	2203-000995	C-CER,CHIP;0.047nF,5%,50V,C0G,TP,1005	3	SA
...4	AD480	2203-002285	C-CER,CHIP;10nF,10%,50V,X7R,TP,1005	21	SNA
...4	AD480	2203-002525	C-CER,CHIP;0.56nF,10%,50V,X7R,TP,1005	4	SNA
...4	AD480	2203-002711	C-CER,CHIP;100nF,10%,25V,X7R,TP,1608	3	SA
...4	AD480	2203-003039	C-CER,CHIP;0.008nF,0.25pF,50V,C0G,TP,100	2	SNA
...4	AD480	2203-005249	C-CER,CHIP;100nF,10%,50V,X7R,TP,1608	5	SNA
...4	AD480	2203-005344	C-CER,CHIP;22nF,10%,25V,X7R,TP,1005,0.5T	3	SNA
...4	AD480	2203-005642	C-CER,CHIP;0.22nF,5%,50V,NP0,TP,1005	2	SNA
...4	AD480	2203-005968	C-CER,CHIP;4.7nF,10%,50V,X7R,TP,1005,0.5	2	SNA
...4	AD480	2203-006048	C-CER,CHIP;100nF,10%,10V,X7R,TP,1005	120	SA
...4	AD480	2203-006126	C-CER,CHIP;47nF,10%,16V,X7R,TP,1005	17	SNA

Exploded Views and Parts List

Level	Loc.	Part Code	Description & Specification	Qty.	SA/SNA
...4	AD480	2203-006324	C-CER,CHIP;2200nF,10%,10V,X5R,TP,1608	6	SA
...4	AD480	2203-006348	C-CER,CHIP;1000nF,10%,25V,X5R,TP,1608,0.	3	SA
...4	AD480	2203-006361	C-CER,CHIP;10000nF,10%,10V,X5R,TP,2012	19	SC
...4	AD480	2203-006474	C-CER,CHIP;22000nF,20%,6.3V,X5R,TP,2012	26	SA
...4	AD480	2203-006562	C-CER,CHIP;1000nF,10%,10V,X5R,TP,1005	19	SNA
...4	AD480	2203-006824	C-CER,CHIP;4700nF,10%,10V,X5R,TP,1608,-	8	SNA
...4	AD480	2203-006890	C-CER,CHIP;10000nF,20%,6.3V,X5R,TP,1608	20	SNA
...4	AD480	2203-006992	C-CER,CHIP;0.33nF,5%,50V,C0G,TP,1005	2	SNA
...4	AD480	2203-007176	C-CER,CHIP;10000nF,10%,16V,X5R,TP,2012,1	8	SNA
...4	AD480	2203-007513	C-CER,CHIP;10000nF,10%,10V,X5R,TP,1608,0	4	SA
...4		2703-000158	INDUCTOR-SMD;1uH,10%,2012,.40ohm,50mA,45,	3	SA
...4		2703-001229	INDUCTOR-SMD;2.2uH,10%,1608,1.150hm,15mA	1	SC
...4		2703-001938	INDUCTOR-SMD;56nH,5%,1005,1.50hm,200mA,1	3	SA
...4		2703-003713	INDUCTOR-SMD;1.5uH,20%,7366,0.015ohm,700	2	SA
...4		2703-003790	INDUCTOR-SMD;4.7uH,20%,8080,0.025ohm,450	1	SA
...4		2703-003930	INDUCTOR-SMD;4.7uH,20%,5050,0.0720hm,245	4	SA
...4		2801-000102	CRYSTAL-SMD;12MHz,30ppm,12pF,100ohm,TP	1	SA
...4		2801-003326	CRYSTAL-SMD;24MHz,30ppm,28-ABX,20pF,50oh	1	SA
...4		2801-003856	CRYSTAL-SMD;0.032768MHz,20ppm,28-ACP,7pF	1	SNA
...4		2801-004775	CRYSTAL-SMD;12MHz,30ppm,16pF,30ohm,TP	1	SNA
...4		3301-000314	BEAD-SMD;120ohm,1608,TP,120ohm/100MHz	8	SNA
...4		3301-002039	BEAD-SMD;26ohm,1608,TP	26	SA
...4		3601-001374	FUSE-SURFACE MOUNT;32V,5A,FAST-ACTING,PL	1	SA
...4		3701-001856	CONNECTOR-HDMI;19P,2ROW,FEMALE,SMD-S,AU	1	SA
...4		3701-001861	CONNECTOR-HDMI;19P,2ROW,FEMALE,SMD-A,AU	2	SA
...4		3707-001106	CONNECTOR-OPTICAL;STRAIGHT W/L,SPDIF	1	SA
...4		3708-003073	CONNECTOR-FPC/FFC/PIC;51P,0.5mm,SMD,AU,N	1	SNA
...4		3710-003374	CONNECTOR-SOCKET;64P,2R,0.5mm,ANGLE,NI+S	1	SA
...4	EH01	3711-007742	HEADER-BOARD TO CABLE;BOX,20P,2R,2mm,ANG	1	SA
...4	EH01	3711-008131	HEADER-BOARD TO CABLE;BOX,4P,1R,2.5mm,AN	1	SA
...4	EH01	3711-008558	HEADER-BOARD TO CABLE;BOX,26P,2R,1.25mm,	1	SA
...4		3722-003229	JACK-MODULAR;8P/8C W/L,Y,STRAIGHT,N,Au,1	1	SA
...4		3722-003457	JACK-USB;4P/1C,NI,BLK,A	2	SA
...4		3722-003546	JACK-PIN;5P+Screw hole,NI+SN,G,Y/BLU/RED	1	SA
...4		3722-003617	JACK-PHONE;14P/2C,SN,BLK,STRAIGHT,3.6PI,	1	SA
...4		3722-003655	JACK-SCART;21P,SN,BLK	1	SA
...4	ET01	BN40-00256A	TUNER;DTOS40EIH035A,DTOS40EIH035A,DVB-TC	1	SA
...4		BN41-01958A	PCB MAIN;X12, LED 6 Series,FR-4,4,A,1.2T	1	SNA
...4		BN97-07121A	ASSY MICOM;X12-PM51-0008-121223,2013.02.	1	SNA
....5		1107-002226	IC-NOR FLASH;W25Q40CLSSIP,4Mbit,SOIC,8P,	1	SNA



Level	Loc.	Part Code	Description & Specification	Qty.	SA/SNA
...4		BN97-07122A	ASSY MICOM;T-MST12DEUC-XXXX,U85A,2012.11	1	SNA
....5		1107-002077	IC-NAND FLASH;KLM4G1FE3B-B001,4Gbyte,32G	1	SNA
...4		BN97-07123A	ASSY MICOM;T-MST12DEUS-XXXX,U85A,2012.11	1	SNA
....5		0903-001863	IC-MICROCONTROLLER;WT61P807-RG48,LQFP,48	1	SNA
...4		BN97-07278A	ASSY MICOM-BLASTER;Blaster-Version:3.03,	1	SNA
....5		BN13-00063A	PLD;MAXQ610J,QFN,44	1	SNA
..3		BN97-07143A	ASSY DRM-KEY;CI(BN46-00115J),HDCP(BN46-0	1	SNA
...4		BN46-00109H	KEY CODE-CERTIFI;MAC,TV/AV,General	1	SNA
...4		BN46-00110N	KEY CODE-CERTIFI;MIRACAST,TV,X12 /X13	1	SNA
...4		BN46-00115J	KEY CODE-CERTIFI;CI+,TV,2013X,Euro	1	SNA
1		BN92-11811P	ASSY LABEL;F5000	1	SNA
.2		BN68-04914A	LABEL-LED-HIGHLIGHT STICKER;F63XX,62XX,5	1	SNA
.2	T0527	BP68-00052B	LABEL-00,RATING;FPTV,PET,T0.05,93,73	1	SNA
1		BN92-12103A	ASSY P/MATERIAL;UF5500,42	1	SNA
.2		6902-000379	BAG AIR;LDPE,T0.2,W1000,L1800,TRP,1260.0	1	SNA
.2		6922-000003	BAND PP;PP,T0.8,W18,L1650M,TRP,DA69-9014	0	SNA
.2		BN68-02422B	LABEL-WARNING SHIPPING;ALL MODEL,A/P 100	1	SNA
.2		BN69-00257Y	PACKING-SHEET PALLET;PACKING SHEET PALLE	1	SNA
.2		BN69-03982L	PAD PACKING-EDGE;EDGE,PAPER,-,T5,W100,L2	1	SNA
.2		BN69-05418A	PACKING-BAG WRAPPING;-LDPE,-,0,019,500,	3	SNA
.2		BN69-06640A	PACKING-PAD;PAD,PAPER,-,-,CB-SW4,1120,95	1	SNA
.2		BN69-06680A	PACKING-BAG SHEET ROLL;-CB,-,FOAM 0,5mm	2	SNA
.2		BN69-08095P	PALLET;F55 42",WOOD,20mm,1160,1240,140,1	1	SNA
.2		BN69-08430A	CUSHION-FRONT;UF7000 40,EPS,EXPORT	1	SNA
..3		0103-005099	RESIN-EPS;BASF303,Natural,Natural	47	SNA
.2		BN69-08441A	CUSHION-SET;UF5500 42",EPS	1	SNA
.2		BN74-00008D	TAPE-OPP MASKING;OPP,T0.05,W75,L800M,CLR	3	SNA
1		BN92-12106C	ASSY BOX;UF5500,42	1	SNA
.2		BH68-00662A	LABEL BOX-00;ALL MODEL,paper,60,110,WHT,	1	SNA
.2		BN69-08667B	BOX-02,SET;42UF5500-QS,CB,A-01,SW3,YEL,W	1	SNA
1	ACCE1	BN92-12322B	ASSY ACCESSORY;UF5K,F5500	1	SNA
.2		BN68-04839C	LABEL-STICKER;UF5K,EDC,PET,T0.1,60,125,E	1	SNA
.2		BN96-25467R	ASSY ACCESSORY MANUAL/CABLE;F5000	1	SNA
..3		3709-001791	CONNECTOR-CARD SLOT;64P,0.5mm,SMD-A,AU,P	1	SA
..3	T0268	3903-000849	CBF-POWER CORD;DT,CEE,LP-21L,250V,2.5A,B	1	SA
..3		4301-000121	BATTERY-MN;1.5V,R03,10.5x44.5m,HOLDER,7.	2	SNA
..3	REMO2	AA59-00790A	REMOCON;TM1250,49,3.0V,F6370, F6300, F62	1	SA
..3		BN61-08370A	HOLDER-WIRE STAND;26UE4000 GIUDE STAND,N	1	SNA
..3		BN68-00514K	MANUAL FLYER-02,WARRANTY CARD;comm,Samsu	1	SNA
..3		BN68-04735A	LABEL-E,PASS;ALL MODEL,ART PAPER 90G,50,	1	SNA

Exploded Views and Parts List

Level	Loc.	Part Code	Description & Specification	Qty.	SA/SNA
..3		BN68-04825A	MANUAL USERS;UF5500 UF5700,SAMSUNG,ENG/F	1	SNA
..3		BN68-04972A	MANUAL FLYER-02,REGULATORY GUI;ALL,SAMSU	1	SNA
..3		BN68-05115E	LEAFLET-FICHE;UF5000(39/42INCH),EUROPE,W	1	SNA
..3		BN68-05118E	LEAFLET-01,QSG;UF5500 ~ UF5700,EU N.AFRI	1	SNA
..3		BN69-08226B	BOX-01,ACCESSORY;E7000,PAPER,CCP 400g,NO	1	SNA
..3		BN69-08472A	PAD-02,TYPE;ACCESSORY,CB,Black Paper 400	1	SNA
..3		BN69-08751D	WRAP VINYL-SHRINK;ACCESSORY BOX,PLASTIC	0	SNA
..3	FL06	BN96-26652A	ASSY CABLE P;IR BLASTER,IR BLASTER CABL,	1	SA