

5. Exploded View & Part List

5-1. UE40C5100QW Exploded View

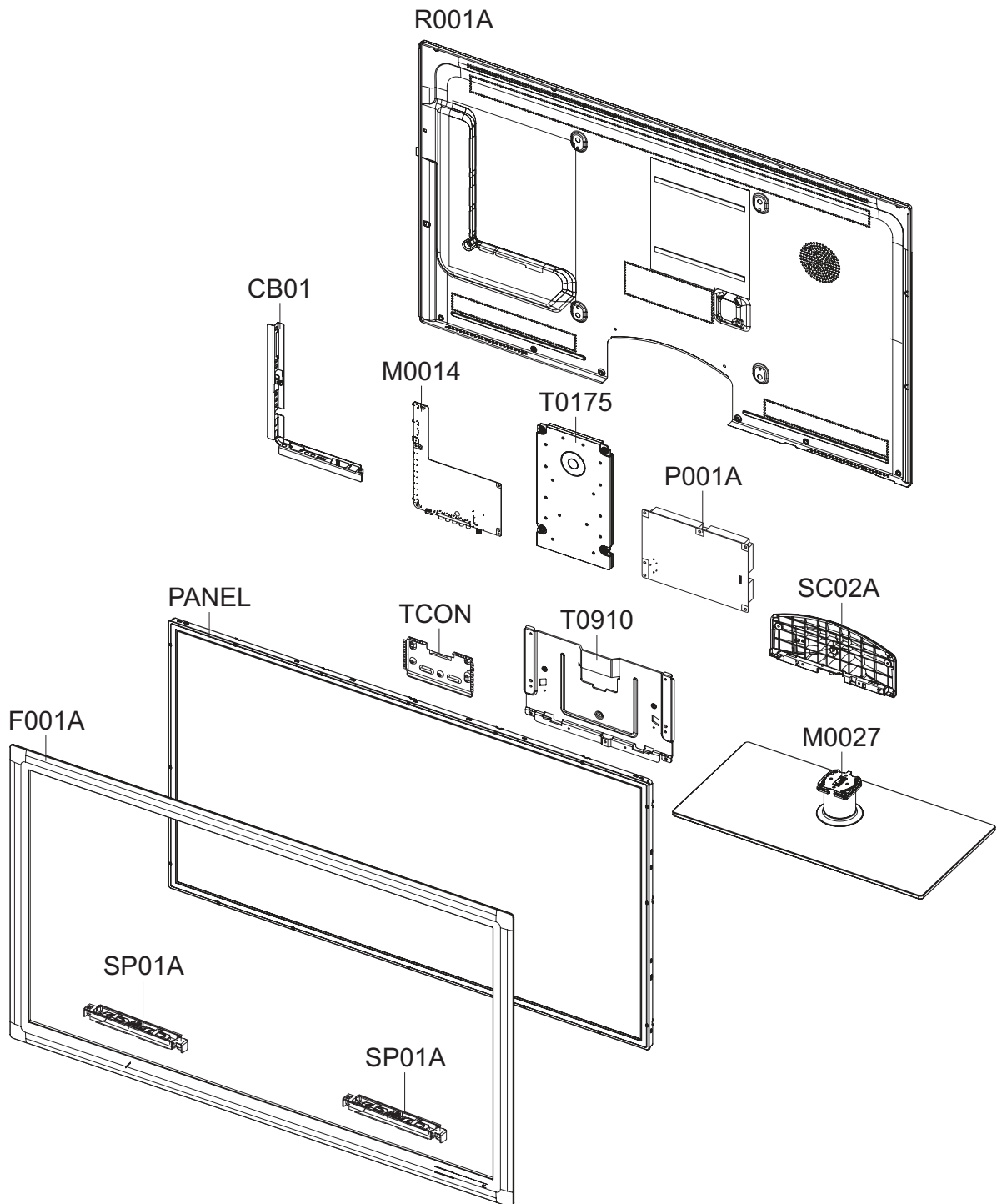

5-2. UE40C5100QW Parts List

| Location No. | Code No. | Description & Specification | Q'ty | S.A/S.N.A | Remark |
|--------------|-------------|--|------|-----------|--------|
| CB01 | BN61-04924A | BRACKET-AV;LB700 40,PCM,T0.5,BKN-P824, P | 1 | SNA | |
| F001A | BN96-12891B | ASSY COVER P-FRONT;UC5100 40,PC(CLR)+PC(| 1 | SA | |
| M0014 | BN94-03368C | ASSY PCB MAIN;UE40C5100QFXXC | 1 | SA | |
| M0027 | BN96-12762B | ASSY STAND P-BASE;37,40,EXPORT,TEMPERED | 1 | SA | |
| P001A | BN44-00353A | DC VSS-LED TV PD BD;PD46AF0E_ZSM,PSLF121 | 1 | SA | |
| PANEL | BN07-00856A | LCD-PANEL;T400FAE1-DB,CLL6BC1,8bits,40,1 | 1 | SA | |
| R001A | BN90-02552C | ASSY COVER REAR;UC5000 40 | 1 | SNA | |
| SC02A | BN96-13131E | ASSY COVER P-GUIDE STAND;UC7000,PC+ABS G | 1 | SA | |
| SP01A | BN96-12941G | ASSY SPEAKER P;8ohm,4pin,10,L:410 R:760, | 1 | SA | |
| T0175 | BN96-12965A | ASSY SPEAKER P;4ohm,4pin,20W,R: 680,Encl | 1 | SA | |
| T0910 | BN96-12928A | ASSY BRACKET P-STAND LINK;UC6500 40,SECC | 1 | SNA | |
| TCON | BN81-04455A | A/S-T CON T400FAE1-DB;T400FAE1-DB | 1 | SA | |

5-2-1. UE40C5100QW Parts List

Service Bom (SA: SERVICE AVAILABLE, SNA: SERVICE NOT AVAILABLE)

| Level | Location No. | Code No. | Description & Specification | Q'ty | SA/SNA | Remark |
|-------|--------------|-------------|--|-------|--------|--------|
| 0.1 | | BN90-02530C | ASSY COVER FRONT;UC5000 40 | 1 | SNA | |
| ..2 | F001A | BN96-12891B | ASSY COVER P-FRONT;UC5100 40,PC(CLR)+PC(| 1 | SA | |
| ...3 | AB326 | BN61-04661A | BRACKET-STOPPER;L650,SK-5,T0.4,Plating,H | 3 | SNA | |
| ...3 | | BN61-06213A | BRACKET-STOPPER BOSS;C8K,SECC+SK5,T1.2 | 8 | SNA | |
| ...3 | | BN61-06215A | BRACKET-STOPPER PANEL;C8K,SK5,0.5T | 1 | SNA | |
| ...3 | CCM1 | BN63-05199B | COVER-SHEET;AMBER,PE,T0.08,W65mm,200M,CL | 3.3 | SNA | |
| ...3 | F001 | BN63-06611B | COVER-FRONT;UC5100 40,PC(CLR)+PC(Charcoa | 1 | SNA | |
| ...4 | | 0103-007268 | RESIN-PC;TP0010,2.0V0,NH PC,NH PC 2.0 V2 | 825 | SNA | |
| ...4 | | 0103-007269 | RESIN-PC;GY0132,2.0V0,NH PC,NH PC 2.0 V2 | 924 | SNA | |
| ...3 | | BN96-12921A | ASSY HOLDER P-BOSS;UC6400 40,ABS V0,BK00 | 1 | SNA | |
| ...4 | | BN61-04692A | BOSS-PRIMER,#94,clear,35cps | 0.001 | SNA | |
| ...4 | | BN61-05915A | BOSS-TAPE;LB650 65",T1.1,W12.0mm,DARK GR | 0.43 | SNA | |
| ...4 | | BN61-05915B | BOSS-TAPE;LB650 65",3M #4711,T1.1,W6.0mm | 0.03 | SNA | |
| ...4 | | BN61-06238A | HOLDER-BOSS BOTTOM;UC6100 40inch,ABS,HB | 1 | SNA | |
|5 | | 0103-004609 | RESIN-ABS;BK0007,HB,ABS,High Flow ABS | 250 | SNA | |
| ...3 | T0382 | BP61-00495C | HOLDER-CARE;PJT,ACRYL-FOAM,T0.25,W30.0mm | 0.16 | SNA | |
| ...3 | M0125 | BN96-13047D | ASSY BOARD P-TOUCH FUNCTION&IR;UC5000,CT | 1 | SA | |
| ...3 | | BN68-02700A | LABEL-LED-POP;Highlight Sticker Color,PE | 1 | SNA | |
| ...3 | SP01A | BN96-12941G | ASSY SPEAKER P;8ohm,4pin,10,L:410 R:760, | 1 | SA | |
| ...3 | | BN61-06630A | BOSS-BOND;UC5000,Acrylated, 3276,Clear,A | 1 | SNA | |
| ...3 | CIS1 | 0203-001598 | TAPE-FILAMENT;#8915,0.15,12,55000,CLR | 0.06 | SNA | |
| ...3 | | BN60-00162Y | SPACER-FOAM;FOAM,50000mm,Dark Gray,0.35T | 2.76 | SA | |
| 0.1 | R001A | BN90-02552C | ASSY COVER REAR;UC5000 40 | 1 | SNA | |
| ..2 | R001A | BN96-12914J | ASSY COVER P-REAR;UC6000 40,EUROPE,PCM,C | 1 | SA | |
| ...3 | | BN68-02543B | LABEL-TERMINAL BOTTOM;REV.01 UC5000,PET, | 1 | SNA | |
| ...3 | | BN68-02544B | LABEL-TERMINAL SIDE;Rev.01 UC5000/6000,E | 1 | SNA | |
| ...3 | R001 | BN63-06518D | COVER-REAR;UC6500 40inch,PCM,T0.5,BKN-P8 | 1 | SNA | |
| ...3 | | BN96-12924B | ASSY MISC P-INSULATOR;UC6500 37/40,PC,T0 | 1 | SNA | |
| ...4 | T0278 | BN60-00122E | SPACER-SPONGE;UC6500,CR,L200,T2.0,W10 | 2 | SNA | |
| ...4 | | BN63-06630A | SHEET-INSULATOR SMPS;UC6100 40inch,PC,T0 | 1 | SNA | |
| ...3 | T0069 | AA63-60131R | SPACER-FELT;21Z57,FELT,325,T0.35,7 | 1 | SNA | |
| ...3 | | BN60-00162A | SPACER-FOAM;FOAM,50000L,BLK,0.35T,20W | 0.92 | SNA | |
| ...3 | | BN60-00162Y | SPACER-FOAM;FOAM,50000mm,Dark Gray,0.35T | 0.8 | SA | |
| ..2 | T0081 | 6001-002610 | SCREW-MACHINE;BH,+,M4,L6,ZPC(BLK),SWRCH1 | 8 | SA | |
| ..2 | SCREW | 6003-001782 | SCREW-TAPTYPE;BH,+,B,M4,L12,ZPC(BLK),SWR | 11 | SA | |
| ..2 | T0382 | BP61-00495C | HOLDER-CARE;PJT,ACRYL-FOAM,T0.25,W30.0mm | 0.1 | SNA | |
| 0.1 | S001A | BN90-02558E | ASSY STAND;UC5000 37 | 1 | SNA | |
| ..2 | SC02A | BN96-13131E | ASSY COVER P-GUIDE STAND;UC7000,PC+ABS G | 1 | SA | |
| ...3 | T0524 | 6902-001063 | BAG PE;LDPE,T0.05,W180,L350,TRP,RECYCLE | 1 | SNA | |
| ...3 | T0920 | BN61-06221A | GUIDE-STAND;UC6500 40inch,PC,G/F 20%,V2, | 1 | SNA | |
| ...4 | | 0103-007285 | RESIN-PC;BK0007,2.0 V2,PC/GF20%,Glass fi | 450 | SNA | |
| ...3 | T0527 | BN68-00513A | LABEL-E,PASS;ALL MODEL,YUPO(110G),50X15, | 1 | SNA | |
| ...3 | | BN68-02824B | MANUAL FLYER-01,STAND GUIDE;5 ~ 6 series | 1 | SNA | |
| ...3 | | BN96-12031C | ASSY ACCESSORY-SCREW;09 LEDTV,6003-00013 | 1 | SNA | |
| ...4 | M0081 | 6003-000133 | SCREW-TAPTYPE;BH,+,-,S,M4,L8,ZPC(BLK),SW | 5 | SA | |
| ...4 | | 6902-000336 | BAG ZIPPER;LDPE,T0.05,W70,L80,TRP,0.500g | 1 | SNA | |
| ...4 | | BN68-02215H | MANUAL FLYER-STAND GUIDE;B6000 ~ 8000,SA | 1 | SNA | |
| ...3 | | BN96-12031M | ASSY ACCESSORY-SCREW;10 LEDTV(40/46/55), | 1 | SNA | |

5. Exploded View & Part List

| Level | Location No. | Code No. | Description & Specification | Q'ty | SA/SNA | Remark |
|-------|--------------|-------------|--|-------|--------|--------|
| ...4 | M0081 | 6003-001003 | SCREW-TAPTYPE;BH,+,B,M4,L12,ZPC(BLK),SWR | 5 | SA | |
| ...4 | | BN69-04419K | PACKING-BAG PE;UC5000,LDPE,70,90,4X12, 5 | 1 | SNA | |
| ..2 | M0027 | BN96-12762B | ASSY STAND P-BASE;37,40,EXPORT,TEMPERED | 1 | SA | |
| ...3 | M0081 | 6003-001003 | SCREW-TAPTYPE;BH,+,B,M4,L12,ZPC(BLK),SWR | 6 | SA | |
| ...3 | | BN61-04692A | BOSS-PRIMER,#94,clear,35cps | 0.1 | SNA | |
| ...3 | | BN61-04731D | BOSS-TAPE;AMBER,ACRYL,T1.1,W20.0mm,WHITE | 0.29 | SNA | |
| ...3 | | BN61-05244A | BRACKET-SWIVEL BOTTOM;LB700 46,HGI,T3.0 | 1 | SNA | |
| ...3 | | BN61-05493A | HOLDER-SWIVEL RING BOTTOM;LB650 40,Aceta | 1 | SNA | |
| ...3 | | BN61-05652A | BRACKET-STAND BOTTOM;B650 40,SECC,T2.0 | 1 | SNA | |
| ...3 | | BN61-05826A | BOSS-BOND;#760,Poly urethane,Black | 2.6 | SNA | |
| ...3 | GSN01 | BN61-05994A | GUIDE-STAND NECK;40,LC650,PETG,V2,TP0003 | 1 | SNA | |
| ...4 | | 0103-007257 | RESIN-PETG;ECOZEN-SE,NP01,TP0003,3.2 V2, | 150 | SNA | |
| ...4 | | BN61-06079A | GUIDE-NECK-INSERT;40,LC650,PETG,HB,TP000 | 1 | SNA | |
| ...3 | CCM1 | BN63-04755A | COVER-SHEET;AMBER,PE,T0.05,W150mm,200M,6 | 1.14 | SNA | |
| ...3 | | BN63-05781C | COVER-STAND GLASS;37,40,LB650,GLASS,T8.0 | 1 | SNA | |
| ...3 | T0527 | BN68-00513A | LABEL-E,PASS;ALL MODEL,YUPO(110G),50X15, | 1 | SNA | |
| ...3 | T0527 | BN68-01648B | LABEL WARNING;WW,PET,T0.05,40,25,EXPORT | 1 | SNA | |
| ...3 | M0126 | BN73-00215A | RUBBER-FOOT;40LB650,RUBBER,15*25,60,4.0, | 4 | SNA | |
| ...3 | M0126 | BN73-00217A | RUBBER-FOOT;LB650,RUBBER,DIA30,7.5,Dark | 4 | SNA | |
| ...3 | | BN74-00031A | GREASE;kanto-kasei FL-955,grease,wht | 0.4 | SNA | |
| ...3 | FD01 | BN63-06913A | COVER-DECORATION;LB7000 46,ABS+PMMA,HB,H | 1 | SNA | |
| ...4 | | 0103-005096 | RESIN-ABS;HB,ABS+PMMA | 13 | SNA | |
| 0.1 | | BN91-05036A | ASSY SHIELD;UE40C5100QFXXC | 1 | SNA | |
| ..2 | T0081 | 6001-002283 | SCREW-MACHINE;BH,+,M3,L5,ZPC(WHT),SWRCH1 | 9 | SNA | |
| ..2 | P001A | BN44-00353A | DC VSS-LED TV PD BD;PD46AF0E_ZSM,PSLF121 | 1 | SA | |
| ..2 | T0910 | BN96-12928A | ASSY BRACKET P-STAND LINK;UC6500 40,SECC | 1 | SNA | |
| ...3 | M0115 | BN61-06165A | BRACKET-STAND LINK;UC6500 40inch,SECC,T2 | 1 | SNA | |
| ...3 | | BN61-02932G | BRACKET-STOPPER NUT;LED TV,M4,D6,L6.5,BR | 5 | SNA | |
| ...3 | | BN60-00184A | SPACER-FOAM;FOAM,30000mm,DARK GRAY,1T,30 | 0.18 | SNA | |
| ..2 | T0175 | BN96-12965A | ASSY SPEAKER P;4ohm,4pin,20W,R: 680,Encl | 1 | SA | |
| ..2 | T0081 | 6001-000115 | SCREW-MACHINE;BH,+,-,M3,L10,ZPC(WHT),SWR | 2 | SNA | |
| ..2 | M2893 | BN39-01267C | LEAD CONNECTOR;LE37B530,UL 2651 AWG#26,1 | 1 | SA | |
| ..2 | FL06 | BN96-13171R | ASSY CABLE P-FFC;UE40C5100,FFC,0.5mm,489 | 1 | SA | |
| ..2 | T0081 | 6001-002610 | SCREW-MACHINE;BH,+,M4,L6,ZPC(BLK),SWRCH1 | 4 | SA | |
| ..2 | SCREW | 6003-001782 | SCREW-TAPTYPE;BH,+,B,M4,L12,ZPC(BLK),SWR | 1 | SA | |
| ..2 | CIS1 | 0203-001586 | TAPE-FILAMENT;#893,0.15,25,55 | 0.15 | SNA | |
| ..2 | M0131 | BN63-00209A | GASKET;RS24NS,CONDUCTIVE FAB,4mm,10mm,30 | 3 | SNA | |
| 0.1 | | BN91-05201A | ASSY LCD;BN07-00856A | 1 | SNA | |
| ..2 | PANEL | BN07-00856A | LCD-PANEL;T400FAE1-DB,CLL6BC1,8bits,40,1 | 1 | SA | |
| ...3 | TCON | BN81-04455A | A/S-T CON T400FAE1-DB;T400FAE1-DB | 1 | SA | |
| 0.1 | | BN92-05579C | ASSY BOX;UC5000 40 | 1 | SNA | |
| ..2 | | BN69-04861B | BOX-SET;40UC5100-GS,CB,A-01,DW2,,W1185,D | 1 | SNA | |
| ..2 | | BH68-00662A | LABEL BOX-00;ALL MODEL,MOJO 90G,60,110,W | 1 | SNA | |
| 0.1 | | BN92-05601A | ASSY P/MATERIAL;UC5000 40 | 1 | SNA | |
| ..2 | T0214 | 0203-001595 | TAPE-OPP MASKING;OPP-2,0.075,75,800M,CLR | 2.68 | SNA | |
| ..2 | | 6902-000604 | BAG WRAPPING;LDPE,T0.02,W500,L10000,TRP, | 2.1 | SNA | |
| ..2 | M040 | 6922-000003 | BAND PP;PP,T0.8,W18,L1650M,TRP,DA69-9014 | 521.2 | SNA | |
| ..2 | | BN69-00257F | PACKING-BAG SHEET;-,-,CB,-,-,1200,500,-,-,WH | 1 | SNA | |
| ..2 | | BN69-03982F | PAD PACKING-EDGE;LB6T,PAPER,8,120,2160,Y | 1 | SNA | |
| ..2 | T0246 | BN69-04593A | CUSHION-SET;UC5000 40inch,EPS,M65 | 1 | SNA | |
| ..2 | | BN68-02422B | LABEL-WARNING SHIPPING;ALL MODEL,A/P 100 | 1 | SNA | |

5. Exploded View & Part List

| Level | Location No. | Code No. | Description & Specification | Q'ty | SA/SNA | Remark |
|-------|--------------|-------------|---|-------|--------|--------|
| .2 | | 6902-001176 | BAG PE;HDPE/NITRON,T0.015/T0.5,W1200,L50 | 1 | SNA | |
| .2 | | BH69-40383L | PACKING INNER-00,PAD;COMM,CB,1200,900,YE | 1 | SNA | |
| .2 | | BN69-05272A | PALLET;- ,WOOD,1175,1200,135,17000,2010,S | 1 | SNA | |
| .2 | | 6902-000379 | BAG AIR;LDPE,T0.2,W1000,L1800,TRP,1260.0 | 1 | SNA | |
| 0.1 | | BN92-05760A | ASSY LABEL;UE32C5100QFXXC | 1 | SNA | |
| .2 | T0527 | AA68-03752B | LABEL-STICKER;WW,ALL,Art Paper(90g),25,3 | 1 | SNA | |
| .2 | T0527 | BP68-00052B | LABEL-00,RATING;CCTV,TETRON PAPER,T0.05, | 1 | SNA | |
| 0.1 | ACCE1 | BN92-05762D | ASSY ACCESSORY;UE46C5100QFXXC | 1 | SNA | |
| .2 | ACCE2 | BN96-13188C | ASSY ACCESSORY-CABEL;UE37C5100QFXXC | 1 | SNA | |
| ...3 | EC11 | 3903-000525 | CBF-POWER CORD;DT,CEE,LP-21L,250V,2.5A,B | 1 | SA | |
| ...3 | T0120 | 4301-000121 | BATTERY-MN;1.5V,R03,10.5x44.5m,HOLDER,7. | 2 | SNA | |
| ...3 | M0114 | BN39-01154C | CBF SIGNAL;Chelsea Slim, STEREO Plug to | 1 | SA | |
| ...3 | M0114 | BN39-01154F | CBF SIGNAL;UE40B7000WWXXC,24P/20P,30AWG, | 1 | SA | |
| ...3 | M0114 | BN39-01154H | CBF SIGNAL;UE40B7000WWXXC,RCA 3PIN,30AWG | 1 | SA | |
| ...3 | REMO2 | BN59-01015A | REMOCON;TM1060,SAMSUNG,20PIN SINGLE,49KE | 1 | SA | |
| ...3 | | BN61-05596A | HOLDER-WIRE CABLE;LED TV,LDPE,T0.8,L150, | 1 | SNA | |
| ...3 | M9889 | BN63-01798B | CLOTH-CLEAN;cloth,180,200,sea blue,ToC | 1 | SA | |
| ...3 | T0527 | BN68-00513A | LABEL-E,PASS;ALL MODEL,YUPO(110G),50X15, | 1 | SNA | |
| ...3 | EH03A | BN96-10276B | ASSY HOLDER P-RING;09 LEDTV ALL MODEL,AB | 1 | SA | |
| ...4 | | 6902-000683 | BAG ZIPPER;LDPE,T0.05,W60,L60,TRP,4-PE M | 1 | SNA | |
| ...4 | AH365 | BN61-05280A | HOLDER-RING;LB7000 46inch,ABS, HB,gray | 4 | SNA | |
| ...3 | EH02A | BN96-10810A | ASSY HOLDER P;09 LEDTV MODEL,NYRON | 1 | SA | |
| ...4 | BAG | 6902-000031 | BAG ZIPPER;LDPE,T0.05,W80,L160,TRP,0,0,4 | 1 | SNA | |
| ...4 | M0114 | BN61-05373A | HOLDER-WIRE;LB7000 46,NYRON | 3 | SNA | |
| ...4 | | BN61-05491A | HOLDER-WIRE STAND;UB7000 46inch,NYRON | 1 | SNA | |
| ...3 | | BN96-12031D | ASSY ACCESSORY-SCREW;09 LEDTV(40/46/55), | 1 | SNA | |
| ...4 | M0081 | 6003-000133 | SCREW-TAPTYPE;BH,+,-,S,M4,L8,ZPC(BLK),SW | 1 | SA | |
| ...4 | | BN69-04419E | PACKING-BAG PE;LB650,LDPE,70,90,6003-000 | 1 | SNA | |
| ...3 | T0524 | 6902-000110 | BAG PE;LDPE,T0.05,W250,L400,TRP,28,2,9.2 | 1 | SNA | |
| ...3 | | BN96-14099A | ASSY ACCESSORY-CLAMP;10 LEDTV(40/46/55), | 1 | SNA | |
| ...4 | | AA65-30023A | CLAMPER CORE-CABLE;NYLON-66,BLK | 1 | SNA | |
| ...4 | | BN69-04419J | PACKING-BAG PE;UC5000,LDPE,70,90,Power-C | 1 | SNA | |
| ...3 | RB01 | BN63-06543B | COVER-BOTTOM;UC7000 40,HIPS,V0,BK0020 | 1 | SA | |
| ...4 | | 0103-004637 | RESIN-HIPS;BK0020,V0,HIPS,NoN-Deca,NoN-D | 70 | SNA | |
| .2 | | BN96-13188G | ASSY ACCESSORY-MANUAL;UE32C5100QFXZT | 1 | SNA | |
| ...3 | T0524 | 6902-000110 | BAG PE;LDPE,T0.05,W250,L400,TRP,28,2,9.2 | 1 | SNA | |
| ...3 | T0527 | BN68-00513A | LABEL-E,PASS;ALL MODEL,YUPO(110G),50X15, | 1 | SNA | |
| ...3 | | BN68-00514E | MANUAL FLYER-05,WARRANTY CARD;comm,Samsu | 1 | SNA | |
| ...3 | | BN68-02186A | MANUAL FLYER-TOC GUIDE;COMM,SAMSUNG,11 L | 1 | SNA | |
| ...3 | | BN68-02656D | MANUAL USERS;C5000,SAMSUNG,4LANGS,XN ZF, | 1 | SNA | |
| ...3 | | AA68-03242V | MANUAL FLYER-SAFETY GUIDE;comm,Samsung,1 | 1 | SNA | |
| 0.1 | M0017 | BN91-05033C | ASSY CHASSIS;UE40C5100QWXXC | 1 | SNA | |
| .2 | M0014 | BN94-03368C | ASSY PCB MAIN;UE40C5100QFXXC | 1 | SA | |
| ...3 | | BN97-04054C | ASSY SMD;UE40C5100QFXXC,BN94-03368A | 1 | SNA | |
| ...4 | | BN97-04023A | ASSY MICOM-MAIN;N82A,2009.11.10,T-TDT5DE | 1 | SNA | |
|5 | | 1107-001818 | IC-NAND FLASH;KFG1G16U2C-DIB6,1024Mbit,6 | 1 | SNA | |
| ...4 | | BN97-04024A | ASSY MICOM-SUB;N82A,2009.11.10,T-TDT5DEU | 1 | SNA | |
|5 | IC115 | 1107-001580 | IC-FLASH MEMORY;MX25L4005,4Mbit,512Kx8,S | 1 | SNA | |
| ...4 | | 0202-001767 | SOLDER-CREAM;LST-5710,D20~38,Sn-57Bi-1Ag | 2.072 | SNA | |
| ...4 | DS01A | 0401-001056 | DIODE-SWITCHING;MMBD4148SE,100V,200mA,SO | 22 | SA | |
| ...4 | D0254 | 0402-000553 | DIODE-SCHOTTKY;SS24/B240,40V,2000mA,DO-2 | 2 | SA | |

5. Exploded View & Part List

| Level | Location No. | Code No. | Description & Specification | Q'ty | SA/SNA | Remark |
|-------|--------------|-------------|--|------|--------|--------|
| ...4 | | 0403-001164 | DIODE-ZENER;MMSZ5232B,5.32-5.88V,500mW,S | 1 | SA | |
| ...4 | | 0403-001180 | DIODE-ZENER;BZX84C6V2,5.8-6.6V,350mW,SOT | 1 | SA | |
| ...4 | | 0403-001783 | DIODE-ZENER;BZB84-C6V2,5.8/6.6V,300mW,SO | 17 | SNA | |
| ...4 | D0254 | 0404-001404 | DIODE-SCHOTTKY;BAT721C,40V,200mA,SOT-23, | 1 | SA | |
| ...4 | T0139 | 0406-001200 | DIODE-TVS;RCLAMP0504F,6/-V,150W,SC-70 | 2 | SA | |
| ...4 | T0139 | 0406-001271 | DIODE-TVS;RCLAMP0524P,6/-V,150W,SLP251 | 9 | SNA | |
| ...4 | SD3 | 0407-000114 | DIODE-SWITCHING;KDS184,80V,100mA,SOT-23, | 3 | SNA | |
| ...4 | KQ1 | 0501-000279 | TR-SMALL SIGNAL;KSA1182-Y,PNP,150mW,SOT- | 1 | SA | |
| ...4 | Q101 | 0501-000445 | TR-SMALL SIGNAL;KTC3875S-Y,NPN,150mW,SOT | 12 | SA | |
| ...4 | CEQ2 | 0505-000110 | FET-SILICON;2N7002,N,60V,115mA,7.5ohm,0. | 5 | SA | |
| ...4 | Q409 | 0505-000274 | FET-SILICON;AO4435L,P,-30V,-11A,0.014ohm | 1 | SNA | |
| ...4 | IC104 | 0801-002630 | IC-CMOS LOGIC;74AHCT1G08,2-INPUT AND GAT | 1 | SA | |
| ...4 | ND51C2 | 0801-002780 | IC-CMOS LOGIC;74LVC1G17,SCHMITT-TRIGGER | 1 | SA | |
| ...4 | IC104 | 0801-003330 | IC-CMOS LOGIC;Octal buffer,DQFN,20P,4.5x | 3 | SA | |
| ...4 | IC104 | 0802-001012 | IC-CMOS LOGIC;74LCX245,TRANSCEIVER,DQFN, | 1 | SNA | |
| ...4 | IC106 | 1001-001573 | IC-VIDEO SWITCH;Sii9287BCNUTR,QFN,72P,10 | 1 | SNA | |
| ...4 | | 1006-001474 | IC-LINE DRIVER;DRV604PWP,HPSSOP,28P,9.8x | 1 | SA | |
| ...4 | IC112 | 1103-000129 | IC-EEPROM;24C02,2Kbit,256x8,SOP,8P,5x4mm | 2 | SA | |
| ...4 | IC112 | 1103-001385 | IC-EEPROM;AT24C256,256Kbit,32Kx8,SOP,8P, | 1 | SA | |
| ...4 | | 1105-002058 | IC-DDR2 SDRAM;K4T1G164QE-HCF8,DDR2,1Gbit | 2 | SA | |
| ...4 | T0124 | 1201-002992 | IC-POWER AMP;STA369BWS,PSSO,36P,10.3x7.5 | 2 | SA | |
| ...4 | T0087 | 1203-001815 | IC-POSI.FIXED REG.;78M09,TO-252,3P,PLAST | 1 | SA | |
| ...4 | T0087 | 1203-002835 | IC-POSI.FIXED REG.;KIA7805AF,DPAK,3P,6.6 | 1 | SA | |
| ...4 | T0087 | 1203-002898 | IC-POSI.FIXED REG.;G950T45R,TO-252,3P,6. | 1 | SA | |
| ...4 | | 1203-004364 | IC-VOL. DETECTOR;RT9818C-42PV,SOT-23,3P, | 1 | SA | |
| ...4 | T0087 | 1203-005134 | IC-POSI.FIXED REG.;RT9167A-33PB,SOT-23-5 | 1 | SNA | |
| ...4 | | 1203-005538 | IC-DC/DC CONVERTER;AOZ1021HAIL,SOP,8P,4. | 1 | SA | |
| ...4 | | 1203-005559 | IC-BACKLIGHT DRIVER;MP3302DJ,TSOT23,5P,2 | 1 | SA | |
| ...4 | | 1203-006013 | IC-DC/DC CONVERTER;AOZ1031AI,SO-8,8P,4.9 | 1 | SA | |
| ...4 | | 1203-006017 | IC-VOL. DETECTOR;RT9824GJ8,TSOT23,8P,2.9 | 1 | SA | |
| ...4 | T0087 | 1203-006135 | IC-POSI.FIXED REG.;AP1117D-33-GZ-13-89,T | 1 | SA | |
| ...4 | T0087 | 1203-006136 | IC-POSI.FIXED REG.;AP1117D-18-GZ-13-89,T | 1 | SA | |
| ...4 | IC012 | 1203-006138 | IC-POSI.ADJUST REG.;AP1117DGZ-13-89,TO-2 | 1 | SA | |
| ...4 | | 1203-006288 | IC-VOL. DETECTOR;RT9818B-18GV,SOT-23-3,3 | 1 | SA | |
| ...4 | | 1204-003088 | IC-DEMODULATOR;DRX39XYK,PQFN,64P,9x9x0.8 | 1 | SA | |
| ...4 | | 1204-003096 | IC-VIDEO DECODER;HIDTVPRO-SX,PBGA,580P,P | 1 | SA | |
| ...4 | | 1205-003201 | IC-BUS SWITCH;TC7WB125FK,SSOP,8P,2x2.3mm | 2 | SA | |
| ...4 | | 1205-003479 | IC-SWITCH;TPS2051BDBVR,SOT-23,5P,2.9x1.6 | 1 | SA | |
| ...4 | | 1205-003735 | IC-SWITCH;AP2151WG-7,SOT25,5P,2.9x1.6mm, | 1 | SA | |
| ...4 | | 1405-001185 | VARISTOR;24Vdc,1.6x0.8x0.36mm,TP | 1 | SA | |
| ...4 | | 1405-001271 | VARISTOR;20Vdc,5A,1.0x0.5x0.6mm,TP | 23 | SA | |
| ...4 | PR6 | 2007-000072 | R-CHIP;47ohm,5%,1/10W,TP,1608 | 6 | SNA | |
| ...4 | R105 | 2007-000138 | R-CHIP;100ohm,5%,1/16W,TP,1005 | 34 | SA | |
| ...4 | AR49 | 2007-000140 | R-CHIP;1Kohm,5%,1/16W,TP,1005 | 5 | SNA | |
| ...4 | MR306 | 2007-000141 | R-CHIP;2.2Kohm,5%,1/16W,TP,1005 | 15 | SNA | |
| ...4 | R319 | 2007-000143 | R-CHIP;4.7Kohm,5%,1/16W,TP,1005 | 44 | SNA | |
| ...4 | | 2007-000146 | R-CHIP;6.8Kohm,5%,1/16W,TP,1005 | 2 | SNA | |
| ...4 | R104 | 2007-000148 | R-CHIP;10Kohm,5%,1/16W,TP,1005 | 54 | SA | |
| ...4 | R102 | 2007-000149 | R-CHIP;12Kohm,5%,1/16W,TP,1005 | 6 | SA | |
| ...4 | HDR2 | 2007-000151 | R-CHIP;15Kohm,5%,1/16W,TP,1005 | 1 | SNA | |
| ...4 | MR36 | 2007-000153 | R-CHIP;22Kohm,5%,1/16W,TP,1005 | 8 | SNA | |

5. Exploded View & Part List

| Level | Location No. | Code No. | Description & Specification | Q'ty | SA/SNA | Remark |
|-------|--------------|-------------|--|------|--------|--------|
| ...4 | AR43 | 2007-000155 | R-CHIP;27Kohm,5%,1/16W,TP,1005 | 2 | SNA | |
| ...4 | MR13 | 2007-000157 | R-CHIP;47Kohm,5%,1/16W,TP,1005 | 9 | SNA | |
| ...4 | R123 | 2007-000159 | R-CHIP;56Kohm,5%,1/16W,TP,1005 | 3 | SNA | |
| ...4 | DR39 | 2007-000162 | R-CHIP;100Kohm,5%,1/16W,TP,1005 | 2 | SNA | |
| ...4 | MR16 | 2007-000168 | R-CHIP;470Kohm,5%,1/16W,TP,1005 | 1 | SNA | |
| ...4 | R509 | 2007-000170 | R-CHIP;1Mohm,5%,1/16W,TP,1005 | 1 | SNA | |
| ...4 | R111 | 2007-000171 | R-CHIP;0ohm,5%,1/16W,TP,1005 | 8 | SNA | |
| ...4 | HDR17 | 2007-000172 | R-CHIP;10ohm,5%,1/16W,TP,1005 | 12 | SNA | |
| ...4 | R338 | 2007-000173 | R-CHIP;22ohm,5%,1/16W,TP,1005 | 14 | SNA | |
| ...4 | UR23 | 2007-000174 | R-CHIP;47ohm,5%,1/16W,TP,1005 | 2 | SNA | |
| ...4 | MR9 | 2007-000455 | R-CHIP;18Kohm,1%,1/10W,TP,1608 | 1 | SA | |
| ...4 | ER13 | 2007-000669 | R-CHIP;2Kohm,1%,1/10W,TP,1608 | 1 | SNA | |
| ...4 | R726 | 2007-000695 | R-CHIP;3.3ohm,5%,1/10W,TP,1608 | 2 | SNA | |
| ...4 | | 2007-000755 | R-CHIP;330Kohm,1%,1/10W,TP,1608 | 1 | SA | |
| ...4 | R124 | 2007-000775 | R-CHIP;33Kohm,5%,1/16W,TP,1005 | 3 | SNA | |
| ...4 | HR3 | 2007-000903 | R-CHIP;430ohm,1%,1/10W,TP,1608 | 1 | SNA | |
| ...4 | DR37 | 2007-000932 | R-CHIP;470ohm,5%,1/16W,TP,1005 | 1 | SNA | |
| ...4 | | 2007-001285 | R-CHIP;5.6ohm,5%,1/16W,TP,1005 | 4 | SA | |
| ...4 | OTR1 | 2007-001292 | R-CHIP;33ohm,5%,1/16W,TP,1005 | 9 | SNA | |
| ...4 | DR43 | 2007-001298 | R-CHIP;51ohm,5%,1/16W,TP,1005 | 1 | SNA | |
| ...4 | R326 | 2007-001325 | R-CHIP;3.3Kohm,5%,1/16W,TP,1005 | 11 | SNA | |
| ...4 | | 2007-002768 | R-CHIP;6.2Kohm,1%,1/10W,TP,1608 | 1 | SA | |
| ...4 | MR316 | 2007-002796 | R-CHIP;510ohm,5%,1/16W,TP,1005 | 1 | SA | |
| ...4 | PR24 | 2007-002970 | R-CHIP;56ohm,5%,1/16W,TP,1005 | 2 | SA | |
| ...4 | TR30 | 2007-007009 | R-CHIP;75ohm,5%,1/16W,TP,1005 | 14 | SA | |
| ...4 | | 2007-007134 | R-CHIP;39Kohm,1%,1/16W,TP,1005 | 1 | SA | |
| ...4 | | 2007-007135 | R-CHIP;18Kohm,1%,1/16W,TP,1005 | 1 | SNA | |
| ...4 | DR4 | 2007-007142 | R-CHIP;10Kohm,1%,1/16W,TP,1005 | 3 | SNA | |
| ...4 | | 2007-007156 | R-CHIP;1ohm,5%,1/16W,TP,1005 | 9 | SNA | |
| ...4 | | 2007-007312 | R-CHIP;20Kohm,1%,1/16W,TP,1005 | 2 | SA | |
| ...4 | | 2007-007316 | R-CHIP;3.3Kohm,1%,1/16W,TP,1005 | 1 | SNA | |
| ...4 | | 2007-007317 | R-CHIP;2.2Kohm,1%,1/16W,TP,1005 | 1 | SA | |
| ...4 | | 2007-007318 | R-CHIP;1Kohm,1%,1/16W,TP,1005 | 10 | SNA | |
| ...4 | | 2007-007334 | R-CHIP;200Kohm,1%,1/16W,TP,1005 | 4 | SNA | |
| ...4 | | 2007-007733 | R-CHIP;51ohm,1%,1/10W,TP,1608 | 2 | SA | |
| ...4 | MR11 | 2007-008015 | R-CHIP;75ohm,1%,1/16W,TP,1005 | 14 | SNA | |
| ...4 | | 2007-008134 | R-CHIP;12.4Kohm,1%,1/16W,TP,1005 | 1 | SC | |
| ...4 | | 2007-008275 | R-CHIP;30Kohm,1%,1/16W,TP,1005 | 1 | SNA | |
| ...4 | | 2007-008298 | R-CHIP;49.9ohm,1%,1/16W,TP,1005 | 2 | SA | |
| ...4 | | 2007-008563 | R-CHIP;270ohm,1%,1/16W,TP,1005 | 1 | SA | |
| ...4 | | 2007-008593 | R-CHIP;750ohm,1%,1/16W,TP,1005 | 1 | SA | |
| ...4 | | 2007-008649 | R-CHIP;220ohm,1%,1/16W,TP,1005 | 4 | SNA | |
| ...4 | ZRN10 | 2011-001261 | R-NETWORK;33ohm,5%,1/16W,L,CHIP,8P,TP,2. | 6 | SA | |
| ...4 | DAR09 | 2011-001262 | R-NETWORK;22ohm,5%,1/16W,L,CHIP,8P,TP,2. | 5 | SA | |
| ...4 | | 2011-001449 | R-NETWORK;22ohm,5%,1/16W,L,4P,TP,1010 | 8 | SA | |
| ...4 | DRP9 | 2011-001474 | R-NETWORK;47ohm,5%,1/16W,L,CHIP,8P,TP,2. | 1 | SA | |
| ...4 | | 2011-001519 | R-NETWORK;33OHM,5%,1/16W,L,CHIP,4P,TP,1. | 3 | SA | |
| ...4 | | 2011-001527 | R-NETWORK;4.7Kohm,5%,1/16W,L,CHIP,4P,TP, | 7 | SNA | |
| ...4 | | 2011-001589 | R-NETWORK;0ohm,5%,1/16W,L,CHIP-V,4P,TP,1 | 16 | SNA | |
| ...4 | DC30 | 2203-000138 | C-CER,CHIP;1.5nF,10%,50V,X7R,TP,1005,- | 2 | SNA | |
| ...4 | PC43 | 2203-000233 | C-CER,CHIP;0.1nF,5%,50V,C0G,TP,1005 | 4 | SA | |

5. Exploded View & Part List

| Level | Location No. | Code No. | Description & Specification | Q'ty | SA/SNA | Remark |
|-------|--------------|-------------|--|------|--------|--------|
| ...4 | MC302 | 2203-000425 | C-CER,CHIP;.018nF,5%,50V,C0G,TP,1005 | 4 | SA | |
| ...4 | C254 | 2203-000438 | C-CER,CHIP;1nF,10%,50V,X7R,TP,1005 | 15 | SA | |
| ...4 | AC139 | 2203-000491 | C-CER,CHIP;2.2nF,10%,50V,X7R,1608 | 2 | SA | |
| ...4 | V1233 | 2203-000575 | C-CER,CHIP;220nF,10%,25V,X7R,TP,2012 | 9 | SNA | |
| ...4 | MC9 | 2203-000627 | C-CER,CHIP;.022nF,5%,50V,C0G,TP,1005 | 2 | SNA | |
| ...4 | DC374 | 2203-000659 | C-CER,CHIP;0.27nF,5%,50V,C0G,1608 | 1 | SA | |
| ...4 | AD480 | 2203-000679 | C-CER,CHIP;0.027nF,5%,50V,C0G,1005 | 1 | SA | |
| ...4 | DC25 | 2203-000812 | C-CER,CHIP;.033nF,5%,50V,C0G,1005 | 11 | SA | |
| ...4 | CK40B | 2203-000838 | C-CER,CHIP;0.39nF,5%,50V,C0G,TP,1608 | 4 | SNA | |
| ...4 | KFC6 | 2203-000872 | C-CER,CHIP;0.0030nF,0.25pF,50V,C0G,1608 | 2 | SNA | |
| ...4 | HDC5 | 2203-001072 | C-CER,CHIP;0.056nF,5%,50V,NP0,1005 | 4 | SA | |
| ...4 | C101 | 2203-001124 | C-CER,CHIP;0.68nF,10%,50V,X7R,TP,1005 | 2 | SA | |
| ...4 | DC87 | 2203-001153 | C-CER,CHIP;.068nF,5%,50V,NP0,1005 | 2 | SA | |
| ...4 | AD480 | 2203-001428 | C-CER,CHIP;470nF,10%,50V,X7R,TP,2012 | 2 | SNA | |
| ...4 | AD480 | 2203-002285 | C-CER,CHIP;10nF,10%,50V,X7R,1005 | 15 | SNA | |
| ...4 | AD480 | 2203-002525 | C-CER,CHIP;0.56nF,10%,50V,X7R,TP,1005 | 6 | SNA | |
| ...4 | C711 | 2203-002982 | C-CER,CHIP;6.8nF,10%,50V,X7R,1005 | 1 | SA | |
| ...4 | AAC1 | 2203-005249 | C-CER,CHIP;100nF,10%,50V,X7R,TP,1608 | 9 | SNA | |
| ...4 | AD480 | 2203-005511 | C-CER,CHIP;27nF,10%,10V,X7R,TP,1005 | 1 | SA | |
| ...4 | AD480 | 2203-005968 | C-CER,CHIP;4.7nF,10%,50V,X7R,TP,1005 | 2 | SNA | |
| ...4 | AD480 | 2203-006039 | C-CER,CHIP;1nF,10%,2000V,X7R,3216 | 2 | SA | |
| ...4 | AD480 | 2203-006126 | C-CER,CHIP;47nF,10%,16V,X7R,1005 | 3 | SNA | |
| ...4 | C102 | 2203-006158 | C-CER,CHIP;100nF,10%,16V,X7R,1005 | 136 | SNA | |
| ...4 | JC10 | 2203-006324 | C-CER,CHIP;2200nF,10%,10V,X5R,1608 | 2 | SA | |
| ...4 | AD480 | 2203-006336 | C-CER,CHIP;10000nF,10%,25V,X5R,3216 | 29 | SA | |
| ...4 | C125 | 2203-006361 | C-CER,CHIP;10000nF,10%,10V,X5R,TP,2012 | 44 | SC | |
| ...4 | HE4 | 2203-006474 | C-CER,CHIP;22000nF,20%,6.3V,X5R,2012 | 3 | SA | |
| ...4 | AD480 | 2203-006841 | C-CER,CHIP;1000nF,10%,16V,X5R,1005 | 31 | SNA | |
| ...4 | AD480 | 2203-006992 | C-CER,CHIP;0.33nF,5%,50V,C0G,TP,1005 | 2 | SNA | |
| ...4 | | 2601-001056 | TRANS-SMD,PULSE;350UH,-,1:1,1:1,12.7X6.7 | 1 | SA | |
| ...4 | T0052 | 2703-000158 | INDUCTOR-SMD;1uH,10%,2012 | 4 | SA | |
| ...4 | T0052 | 2703-000296 | INDUCTOR-SMD;680nH,10%,1608 | 1 | SA | |
| ...4 | VL6 | 2703-000398 | INDUCTOR-SMD;10uH,10%,3225 | 4 | SA | |
| ...4 | L1103 | 2703-000403 | INDUCTOR-SMD;22uH,10%,3225 | 1 | SA | |
| ...4 | T0052 | 2703-001239 | INDUCTOR-SMD;3.3uH,10%,1608 | 3 | SA | |
| ...4 | L607 | 2703-001254 | INDUCTOR-SMD;1.8uH,10%,2012 | 1 | SA | |
| ...4 | T0052 | 2703-002268 | INDUCTOR-SMD;8.2nH,5%,1005 | 4 | SNA | |
| ...4 | T0052 | 2703-003149 | INDUCTOR-SMD;2.2uH,20%,5050 | 2 | SA | |
| ...4 | T0052 | 2703-003150 | INDUCTOR-SMD;4.7uH,20%,5050 | 4 | SNA | |
| ...4 | T0052 | 2703-003790 | INDUCTOR-SMD;4.7uH,20%,8080 | 2 | SA | |
| ...4 | X202 | 2801-003326 | CRYSTAL-SMD;24MHz,30ppm,28-ABX,20pF,50oh | 1 | SA | |
| ...4 | X202 | 2801-004004 | CRYSTAL-SMD;20.25MHz,20ppm,28-AAN,13pF,2 | 1 | SA | |
| ...4 | F103 | 2901-001506 | FILTER-EMI SMD;5V,0.13A,0pF,2x1x0.5mm,TP | 2 | SA | |
| ...4 | T0568 | 3301-001236 | BEAD-SMD;60ohm,1608 | 5 | SNA | |
| ...4 | T0568 | 3301-002039 | BEAD-SMD;26ohm,1608,TP | 41 | SA | |
| ...4 | | 3701-001293 | CONNECTOR-HDMI;19P,2R,FEMALE,SMD-A,AU | 4 | SA | |
| ...4 | CN906 | 3707-001095 | CONNECTOR-OPTICAL;SMD-A(Ultra Slim),SPDI | 1 | SA | |
| ...4 | AC510 | 3708-002797 | CONNECTOR-FPC/FFC/PIC;51P,0.50mm,SMD,AU, | 1 | SA | |
| ...4 | | 3710-002276 | SOCKET-INTERFACE;24P,1R,0.5mm,SMD-A,AU,B | 1 | SA | |
| ...4 | CON_US | 3711-005616 | HEADER-BOARD TO CABLE;BOX,10P,1R,2mm,SMD | 1 | SNA | |
| ...4 | HB01A | 3711-007336 | HEADER-BOARD TO CABLE;BOX,4P,1R,2.5mm,SM | 2 | SA | |

5. Exploded View & Part List

| Level | Location No. | Code No. | Description & Specification | Q'ty | SA/SNA | Remark |
|-------|--------------|-------------|--|------|--------|--------|
| ...4 | | 3722-003044 | JACK-USB;4P/1C,NI,BLK,SMD-A,A-TYPE | 2 | SA | |
| ...4 | | BN41-01378A | PCB MAIN;SX1 5000 DVB,FR-4,4,1.0,1.2T,19 | 1 | SNA | |
| ...4 | T0568 | 3301-001186 | BEAD-SMD;600ohm,3216,2500mA,TP,553ohm/93 | 1 | SNA | |
| ...4 | T0596 | 0904-002554 | IC-USC;AU6256-JBF,QFN,28P,5x5mm,12MHz,TP | 1 | SA | |
| ...4 | | 1205-003733 | IC-SWITCH;AP2191MPG-13,MSOP-8L-EP,8P,2.9 | 1 | SA | |
| ...4 | | 2007-001317 | R-CHIP;910ohm,5%,1/16W,TP,1005 | 1 | SNA | |
| ...4 | AD480 | 2203-006824 | C-CER,CHIP;4700nF,10%,10V,X5R,1608 | 1 | SNA | |
| ...4 | X202 | 2801-004775 | CRYSTAL-SMD;12MHz,30ppm,16pF,30ohm,TP | 1 | SNA | |
| ...3 | | BN97-04098A | ASSY CI PLUS;BN46-00025A,LC5F,SX1 platfo | 1 | SNA | |
| ...4 | | BN46-00025A | KEY CODE-CI PLUS KEY;CI PLUS KEY,TCTC,SE | 1 | SNA | |
| ...3 | | 0202-001608 | SOLDER-WIRE FLUX;LFC7-107,D0.8,99.3Sn/0. | 0.25 | SNA | |
| ...3 | | 3701-001698 | CONNECTOR-DSUB;15P,3ROW,FEMALE,ANGLE,NI | 1 | SA | |
| ...3 | | 3709-001603 | CONNECTOR-CARD SLOT;68P(U/SLIM 60mm) W/L | 1 | SA | |
| ...3 | | 3711-007302 | HEADER-BOARD TO BOARD;BOX,18P,2R,2mm,ANG | 1 | SA | |
| ...3 | JA330 | 3722-002844 | JACK-PHONE;1/7P,NI,LAUREL-GREEN,ANGLE | 1 | SA | |
| ...3 | JA330 | 3722-002845 | JACK-PHONE;1/7P,NI,YELLOW,ANGLE | 1 | SA | |
| ...3 | JA330 | 3722-002846 | JACK-PHONE;1/6,NI,BLACK,ANGLE | 2 | SNA | |
| ...3 | | 3722-002849 | JACK-MODULAR;8P/8C(ULTRA SLIM),YES,ANGLE | 1 | SNA | |
| ...3 | ET01 | BN40-00172A | TUNER;DTOS40CVH081A,DVB-T/C,164CH,38.9MH | 1 | SA | |
| ...3 | T0066 | BN62-00042A | HEAT SINK-ES;30*30*5,Ceramic,T1.5,TAPE | 1 | SNA | |
| ...3 | T0066 | BP62-00047A | HEAT SINK-ES;DLP,A6063S,T2.5,13,13,TAPE | 2 | SNA | |
| ...3 | CCMM1 | BN73-00211B | SILICON/RUBBER;UN46B9000XFXZA,SILICON+PO | 1 | SNA | |
| ...3 | | BN96-14857A | ASSY BRACKET P-AV;UE5100,EO,PCM,T0.5,BKN | 1 | SNA | |
| ...4 | CB01 | BN61-04924A | BRACKET-AV;LB700 40,PCM,T0.5,BKN-P824, P | 1 | SNA | |
| ...4 | M0131 | BN63-01251A | GASKET;NB24BS,CONDUCTIVE FABRIC,0.7mm,12 | 1 | SNA | |