

5. Exploded View & Part List

Level	Location No.	Code No.	Description & Specification	Q'ty	SA/SNA	Remark
...3	M0114	BN39-01154H	CBF SIGNAL;UE40B7000WWXXC,RCA 3PIN,30AWG	1	SA	
...3	REMO2	BN59-01015A	REMOCON;TM1060,SAMSUNG,20PIN SINGLE,49KE	1	SA	
...3		BN61-05596A	HOLDER-WIRE CABLE;LED TV,LDPE,T0.8,L150,	1	SNA	
...3	M9889	BN63-01798B	CLOTH-CLEAN;cloth,180,200,sea blue,ToC	1	SA	
...3	T0527	BN68-00513A	LABEL-E,PASS;ALL MODEL,YUPO(110G),50X15,	1	SNA	
...3	EH03A	BN96-10276B	ASSY HOLDER P-RING;09 LEDTV ALL MODEL,AB	1	SA	
...4		6902-000683	BAG ZIPPER;LDPE,T0.05,W60,L60,TRP,4-PE M	1	SNA	
...4	AH365	BN61-05280A	HOLDER-RING;LB7000 46inch,ABS, HB,gray	4	SNA	
...3	EH02A	BN96-10810A	ASSY HOLDER P;09 LEDTV MODEL,NYRON	1	SA	
...4	BAG	6902-000031	BAG ZIPPER;LDPE,T0.05,W80,L160,TRP,0,0,4	1	SNA	
...4	M0114	BN61-05373A	HOLDER-WIRE;LB7000 46,NYRON	3	SNA	
...4		BN61-05491A	HOLDER-WIRE STAND;UB7000 46inch,NYRON	1	SNA	
...3		BN96-12031D	ASSY ACCESSORY-SCREW;09 LEDTV(40/46/55),	1	SNA	
...4	M0081	6003-000133	SCREW-TAPTYPE;BH,+,-,S,M4,L8,ZPC(BLK),SW	1	SA	
...4		BN69-04419E	PACKING-BAG PE;LB650,LDPE,70,90,6003-000	1	SNA	
...3	T0524	6902-000110	BAG PE;LDPE,T0.05,W250,L400,TRP,28,2,9.2	1	SNA	
...3		BN96-14099A	ASSY ACCESSORY-CLAMP;10 LEDTV(40/46/55),	1	SNA	
...4		AA65-30023A	CLAMPER CORE-CABLE;NYLON-66,BLK	1	SNA	
...4		BN69-04419J	PACKING-BAG PE;UC5000,LDPE,70,90,Power-C	1	SNA	
...3	T0531	BN63-06542B	COVER-BOTTOM;UC4000 32,HIPS,V0,BK0020	1	SA	
...4		0103-004637	RESIN-HIPS;BK0020,V0,HIPS,NoN-Deca,NoN-D	60	SNA	
..2		BN96-13188F	ASSY ACCESSORY-MANUAL;UE32C5100QFXZG	1	SNA	
...3	T0524	6902-000110	BAG PE;LDPE,T0.05,W250,L400,TRP,28,2,9.2	1	SNA	
...3	T0527	BN68-00513A	LABEL-E,PASS;ALL MODEL,YUPO(110G),50X15,	1	SNA	
...3		BN68-00514E	MANUAL FLYER-05,WARRANTY CARD;comm,Samsu	1	SNA	
...3		BN68-02186A	MANUAL FLYER-TOC GUIDE;COMM,SAMSUNG,11 L	1	SNA	
...3		BN68-02656B	MANUAL USERS;C5100,SAMSUNG,4LANGS,GERMAN	1	SNA	
...3		AA68-03242V	MANUAL FLYER-SAFETY GUIDE;comm,Samsung,1	1	SNA	

5. Exploded View & Part List

5-1. UE37C5100QW Exploded View

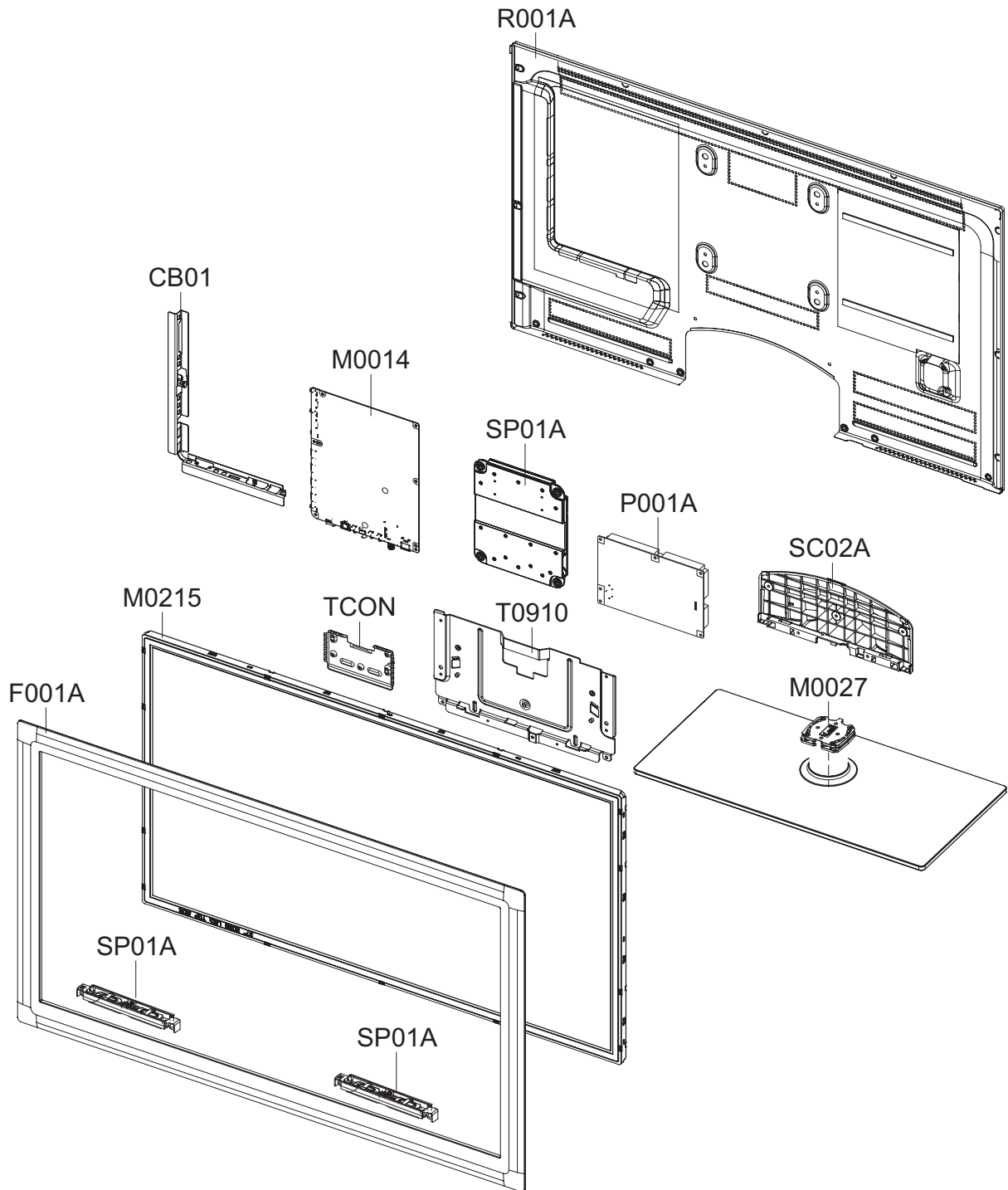

5-1-1. UE37C5100QW Parts List

Location No.	Code No.	Description & Specification	Q'ty	S.A/S.N.A	Remark
CB01	BN61-04924A	BRACKET-AV;LB700 40,PCM,T0.5,BKN-P824, P	1	SNA	
F001A	BN96-12886B	ASSY COVER P-FRONT;UC5000 37,PC(CLR)+PC(1	SA	
M0014	BN94-03368B	ASSY PCB MAIN;UE37C5100QFXXC	1	SA	
M0027	BN96-12762B	ASSY STAND P-BASE;37,40,EXPORT,TEMPERED	1	SA	
M0215	BN07-00880A	LCD-PANEL;T370FAE1-DA,CLL5BA1,8bits,37,1	1	SA	
P001A	BN44-00351B	DC VSS-LED TV PD BD;PD37AF0E_ZDY,PD37AF0	1	SA	
R001A	BN96-12913J	ASSY COVER P-REAR;UC6000 37,EUROPE,PCM,C	1	SA	
SC02A	BN96-13131E	ASSY COVER P-GUIDE STAND;UC7000,PC+ABS G	1	SA	
SP01A	BN96-12944D	ASSY SPEAKER P;4ohm,4pin,10,R: 210,9030	1	SA	
SP01A	BN96-12941F	ASSY SPEAKER P;8ohm,4pin,10,L:350 R:700,	1	SA	
T0910	BN96-12928A	ASSY BRACKET P-STAND LINK;UC6500 40,SECC	1	SNA	
TCON	BN81-04428A	A/S-T CON T370FAE1-DA;T370FAE1-DA	1	SA	

5-2. UE37C5100QW Parts List

Service Bom (SA: SERVICE AVAILABLE, SNA: SERVICE NOT AVAILABLE)

Level	Location No.	Code No.	Description & Specification	Q'ty	SA/SNA	Remark
0.1		BN90-02529C	ASSY COVER FRONT;UC5000 37	1	SNA	
..2	F001A	BN96-12886B	ASSY COVER P-FRONT;UC5000 37,PC(CLR)+PC(1	SA	
...3	AB326	BN61-04661A	BRACKET-STOPPER;L650,SK-5,T0.4,Plating,H	2	SNA	
...3		BN61-06213A	BRACKET-STOPPER BOSS;C8K,SECC+SK5,T1.2	8	SNA	
...3		BN61-06215A	BRACKET-STOPPER PANEL;C8K,SK5,0.5T	1	SNA	
...3	CCM1	BN63-05199B	COVER-SHEET;AMBER,PE,T0.08,W65mm,200M,CL	3	SNA	
...3	F001	BN63-06609B	COVER-FRONT;UC5100 37,PC(CLR)+PC(Charcoa	1	SNA	
...4		0103-007268	RESIN-PC;TP0010,2.0V0,NH PC,NH PC 2.0 V2	700	SNA	
...4		0103-007269	RESIN-PC;GY0132,2.0V0,NH PC,NH PC 2.0 V2	800	SNA	
...3		BN96-12920A	ASSY HOLDER P-BOSS;UC6400 37,ABS V0,BK00	1	SNA	
...4		BN61-04692A	BOSS-PRIMER,#94,clear,35cps	0.5	SNA	
...4		BN61-05915A	BOSS-TAPE;LB650 65",T1.1,W12.0mm,DARK GR	0.39	SNA	
...4		BN61-05915B	BOSS-TAPE;LB650 65",3M #4711,T1.1,W6.0mm	0.03	SNA	
...4		BN61-06237A	HOLDER-BOSS BOTTOM;UC6100 37inch,ABS,HB	1	SNA	
....5		0103-004609	RESIN-ABS;BK0007,HB,ABS,High Flow ABS	225	SNA	
...3	T0382	BP61-00495C	HOLDER-CARE;PJT,ACRYL-FOAM,T0.25,W30.0mm	0.16	SNA	
...3	M0125	BN96-13047C	ASSY BOARD P-TOUCH FUNCTION&IR;UC5000,CT	1	SA	
...3		BN68-02700A	LABEL-LED-POP;Highlight Sticker Color,PE	1	SNA	
...3	SP01A	BN96-12941F	ASSY SPEAKER P;8ohm,4pin,10,L:350 R:700,	1	SA	
...3		BN61-06630A	BOSS-BOND;UC5000,Acrylated, 3276,Clear,A	0.9	SNA	
...3	CIS1	0203-001598	TAPE-FILAMENT;#8915,0.15,12,55000,CLR	0.06	SNA	
...3		BN60-00162Y	SPACER-FOAM;FOAM,50000mm,Dark Gray,0.35T	2.46	SA	
0.1	R001A	BN90-02551C	ASSY COVER REAR;UC5000 37	1	SNA	
..2	R001A	BN96-12913J	ASSY COVER P-REAR;UC6000 37,EUROPE,PCM,C	1	SA	
...3		BN68-02543B	LABEL-TERMINAL BOTTOM;REV.01 UC5000,PET,	1	SNA	
...3		BN68-02544B	LABEL-TERMINAL SIDE;Rev.01 UC5000/6000,E	1	SNA	
...3	R001	BN63-06517D	COVER-REAR;UC6500 37,PCM,T0.5,BKN-P824	1	SNA	
...3		BN96-12924B	ASSY MISC P-INSULATOR;UC6500 37/40,PC,T0	1	SNA	
...4	T0278	BN60-00122E	SPACER-SPONGE;UC6500,CR,L200,T2.0,W10	2	SNA	
...4		BN63-06630A	SHEET-INSULATOR SMPS;UC6100 40inch,PC,T0	1	SNA	
...3	T0069	AA63-60131R	SPACER-FELT;21Z57,FELT,325,T0.35,7	1	SNA	
...3		BN60-00162A	SPACER-FOAM;FOAM,50000L,BLK,0.35T,20W	0.85	SNA	
...3		BN60-00162Y	SPACER-FOAM;FOAM,50000mm,Dark Gray,0.35T	0.4	SA	
..2	T0081	6001-002610	SCREW-MACHINE;BH,+,M4,L6,ZPC(BLK),SWRCH1	7	SA	
..2	SCREW	6003-001782	SCREW-TAPTYPE;BH,+,B,M4,L12,ZPC(BLK),SWR	11	SA	
..2	T0382	BP61-00495C	HOLDER-CARE;PJT,ACRYL-FOAM,T0.25,W30.0mm	0.1	SNA	
0.1	S001A	BN90-02558E	ASSY STAND;UC5000 37	1	SNA	
..2	SC02A	BN96-13131E	ASSY COVER P-GUIDE STAND;UC7000,PC+ABS G	1	SA	
...3	T0524	6902-001063	BAG PE;LDPE,T0.05,W180,L350,TRP,RECYCLE	1	SNA	
...3	T0920	BN61-06221A	GUIDE-STAND;UC6500 40inch,PC,G/F 20%,V2,	1	SNA	
...4		0103-007285	RESIN-PC;BK0007,2.0 V2,PC/GF20%,Glass fi	450	SNA	
...3	T0527	BN68-00513A	LABEL-E,PASS;ALL MODEL,YUPO(110G),50X15,	1	SNA	
...3		BN68-02824B	MANUAL FLYER-01,STAND GUIDE;5 ~ 6 series	1	SNA	
...3		BN96-12031C	ASSY ACCESSORY-SCREW;09 LEDTV,6003-00013	1	SNA	
...4	M0081	6003-000133	SCREW-TAPTYPE;BH,+,-,S,M4,L8,ZPC(BLK),SW	5	SA	
...4		6902-000336	BAG ZIPPER;LDPE,T0.05,W70,L80,TRP,0.500g	1	SNA	
...4		BN68-02215H	MANUAL FLYER-STAND GUIDE;B6000 ~ 8000,SA	1	SNA	
...3		BN96-12031M	ASSY ACCESSORY-SCREW;10 LEDTV(40/46/55),	1	SNA	

5. Exploded View & Part List

Level	Location No.	Code No.	Description & Specification	Q'ty	SA/SNA	Remark
...4	M0081	6003-001003	SCREW-TAPTYPE;BH,+,B,M4,L12,ZPC(BLK),SWR	5	SA	
...4		BN69-04419K	PACKING-BAG PE;UC5000,LDPE,70,90,4X12, 5	1	SNA	
..2	M0027	BN96-12762B	ASSY STAND P-BASE;37,40,EXPORT,TEMPERED	1	SA	
...3	M0081	6003-001003	SCREW-TAPTYPE;BH,+,B,M4,L12,ZPC(BLK),SWR	6	SA	
...3		BN61-04692A	BOSS-PRIMER,#94,clear,35cps	0.1	SNA	
...3		BN61-04731D	BOSS-TAPE;AMBER,ACRYL,T1.1,W20.0mm,WHITE	0.29	SNA	
...3		BN61-05244A	BRACKET-SWIVEL BOTTOM;LB700 46,HGI,T3.0	1	SNA	
...3		BN61-05493A	HOLDER-SWIVEL RING BOTTOM;LB650 40,Aceta	1	SNA	
...3		BN61-05652A	BRACKET-STAND BOTTOM;B650 40,SECC,T2.0	1	SNA	
...3		BN61-05826A	BOSS-BOND;#760,Poly urethane,Black	2.6	SNA	
...3	GSN01	BN61-05994A	GUIDE-STAND NECK;40,LC650,PETG,V2,TP0003	1	SNA	
...4		0103-007257	RESIN-PETG;ECOZEN-SE,NP01,TP0003,3.2 V2,	150	SNA	
...4		BN61-06079A	GUIDE-NECK-INSERT;40,LC650,PETG,HB,TP000	1	SNA	
...3	CCM1	BN63-04755A	COVER-SHEET;AMBER,PE,T0.05,W150mm,200M,6	1.14	SNA	
...3		BN63-05781C	COVER-STAND GLASS;37,40,LB650,GLASS,T8.0	1	SNA	
...3	T0527	BN68-00513A	LABEL-E,PASS;ALL MODEL,YUPO(110G),50X15,	1	SNA	
...3	T0527	BN68-01648B	LABEL WARNING;WW,PET,T0.05,40,25,EXPORT	1	SNA	
...3	M0126	BN73-00215A	RUBBER-FOOT;40LB650,RUBBER,15*25,60,4.0,	4	SNA	
...3	M0126	BN73-00217A	RUBBER-FOOT;LB650,RUBBER,DIA30,7.5,Dark	4	SNA	
...3		BN74-00031A	GREASE;kanto-kasei FL-955,grease,wht	0.4	SNA	
...3	FD01	BN63-06913A	COVER-DECORATION;LB7000 46,ABS+PMMA,HB,H	1	SNA	
...4		0103-005096	RESIN-ABS;HB,ABS+PMMA	13	SNA	
0.1		BN91-05035A	ASSY SHIELD;UE37C5100QFXXC	1	SNA	
..2	T0081	6001-002283	SCREW-MACHINE;BH,+,M3,L5,ZPC(WHT),SWRCH1	9	SNA	
..2	P001A	BN44-00351B	DC VSS-LED TV PD BD;PD37AF0E_ZDY,PD37AF0	1	SA	
..2	T0910	BN96-12928A	ASSY BRACKET P-STAND LINK;UC6500 40,SECC	1	SNA	
...3	M0115	BN61-06165A	BRACKET-STAND LINK;UC6500 40inch,SECC,T2	1	SNA	
...3		BN61-02932G	BRACKET-STOPPER NUT;LED TV,M4,D6,L6.5,BR	5	SNA	
...3		BN60-00184A	SPACER-FOAM;FOAM,30000mm,DARK GRAY,1T,30	0.18	SNA	
..2	T0081	6001-000115	SCREW-MACHINE;BH,+,-,M3,L10,ZPC(WHT),SWR	2	SNA	
..2	M2893	BN39-01267D	LEAD CONNECTOR;LE52B530,UL 2651 AWG#26,1	1	SA	
..2	FL06	BN96-13171Q	ASSY CABLE P-FFC;UE37C5100,FFC,0.5mm,444	1	SA	
..2	SP01A	BN96-12944D	ASSY SPEAKER P;4ohm,4pin,10,R: 210,9030	1	SA	
..2	T0081	6001-002610	SCREW-MACHINE;BH,+,M4,L6,ZPC(BLK),SWRCH1	4	SA	
..2	SCREW	6003-001782	SCREW-TAPTYPE;BH,+,B,M4,L12,ZPC(BLK),SWR	1	SA	
..2	CIS1	0203-001586	TAPE-FILAMENT;#893,0.15,25,55	0.05	SNA	
..2	M0131	BN63-00209A	GASKET;RS24NS,CONDUCTIVE FAB,4mm,10mm,30	3	SNA	
0.1		BN91-05163A	ASSY LCD-AUO;BN07-00880A	1	SNA	
..2	M0215	BN07-00880A	LCD-PANEL;T370FAE1-DA,CLL5BA1,8bits,37,1	1	SA	
...3	TCON	BN81-04428A	A/S-T CON T370FAE1-DA;T370FAE1-DA	1	SA	
0.1		BN92-05578C	ASSY BOX;UC5000 37	1	SNA	
..2		BN69-04860B	BOX-SET;37UC5100,CB,A-01,DW2,,W1130,D105	1	SNA	
..2		BH68-00662A	LABEL BOX-00;ALL MODEL,MOJO 90G,60,110,W	1	SNA	
0.1		BN92-05600A	ASSY P/MATERIAL;UC5000 37	1	SNA	
..2	T0214	0203-001595	TAPE-OPP MASKING;OPP-2,0.075,75,800M,CLR	2.57	SNA	
..2		6902-000604	BAG WRAPPING;LDPE,T0.02,W500,L10000,TRP,	2.05	SNA	
..2	M040	6922-000003	BAND PP;PP,T0.8,W18,L1650M,TRP,DA69-9014	0.51	SNA	
..2		BN69-00257F	PACKING-BAG SHEET;-,CB,-,1200,500,-,-,WH	1	SNA	
..2		BN69-03982F	PAD PACKING-EDGE;LB6T,PAPER,8,120,2160,Y	1	SNA	
..2	T0246	BN69-04591A	CUSHION-SET;UC5000 37inch,EPS,M50	1	SNA	
..2		BN68-02422B	LABEL-WARNING SHIPPING;ALL MODEL,A/P 100	1	SNA	

5. Exploded View & Part List

Level	Location No.	Code No.	Description & Specification	Q'ty	SA/SNA	Remark
.2		BN69-05182A	PALLET;-;WOOD,1140,1155,135,8500,2010-65	1	SNA	
.2		6902-001176	BAG PE;HDPE/NITRON,T0.015/T0.5,W1200,L50	1	SNA	
.2		BN69-00257B	PACKING-PAD;PAPER,CB-SW4,1130,820,YEL,28	1	SNA	
.2		6902-000379	BAG AIR;LDPE,T0.2,W1000,L1800,TRP,1260.0	1	SNA	
0.1		BN92-05760A	ASSY LABEL;UE32C5100QFXXC	1	SNA	
.2	T0527	AA68-03752B	LABEL-STICKER;WW,ALL,Art Paper(90g),25,3	1	SNA	
.2	T0527	BP68-00052B	LABEL-00,RATING;CCTV,TETRON PAPER,T0.05,	1	SNA	
0.1	ACCE1	BN92-05762F	ASSY ACCESSORY;UE37C5100QFXZG	1	SNA	
.2	ACCE2	BN96-13188C	ASSY ACCESSORY-CABEL;UE37C5100QFXXC	1	SNA	
...3	EC11	3903-000525	CBF-POWER CORD;DT,CEE,LP-21L,250V,2.5A,B	1	SA	
...3	T0120	4301-000121	BATTERY-MN;1.5V,R03,10.5x44.5m,HOLDER,7.	2	SNA	
...3	M0114	BN39-01154C	CBF SIGNAL;Chelsea Slim, STEREO Plug to	1	SA	
...3	M0114	BN39-01154F	CBF SIGNAL;UE40B7000WWXXC,24P/20P,30AWG,	1	SA	
...3	M0114	BN39-01154H	CBF SIGNAL;UE40B7000WWXXC,RCA 3PIN,30AWG	1	SA	
...3	REMO2	BN59-01015A	REMOCON;TM1060,SAMSUNG,20PIN SINGLE,49KE	1	SA	
...3		BN61-05596A	HOLDER-WIRE CABLE;LED TV,LDPE,T0.8,L150,	1	SNA	
...3	M9889	BN63-01798B	CLOTH-CLEAN;cloth,180,200,sea blue,ToC	1	SA	
...3	T0527	BN68-00513A	LABEL-E,PASS;ALL MODEL,YUPO(110G),50X15,	1	SNA	
...3	EH03A	BN96-10276B	ASSY HOLDER P-RING;09 LEDTV ALL MODEL,AB	1	SA	
...4		6902-000683	BAG ZIPPER;LDPE,T0.05,W60,L60,TRP,4-PE M	1	SNA	
...4	AH365	BN61-05280A	HOLDER-RING;LB7000 46inch,ABS, HB,gray	4	SNA	
...3	EH02A	BN96-10810A	ASSY HOLDER P;09 LEDTV MODEL,NYRON	1	SA	
...4	BAG	6902-000031	BAG ZIPPER;LDPE,T0.05,W80,L160,TRP,0,0,4	1	SNA	
...4	M0114	BN61-05373A	HOLDER-WIRE;LB7000 46,NYRON	3	SNA	
...4		BN61-05491A	HOLDER-WIRE STAND;UB7000 46inch,NYRON	1	SNA	
...3		BN96-12031D	ASSY ACCESSORY-SCREW;09 LEDTV(40/46/55),	1	SNA	
...4	M0081	6003-000133	SCREW-TAPTYPE;BH,+,-,S,M4,L8,ZPC(BLK),SW	1	SA	
...4		BN69-04419E	PACKING-BAG PE;LB650,LDPE,70,90,6003-000	1	SNA	
...3	T0524	6902-000110	BAG PE;LDPE,T0.05,W250,L400,TRP,28,2,9.2	1	SNA	
...3		BN96-14099A	ASSY ACCESSORY-CLAMP;10 LEDTV(40/46/55),	1	SNA	
...4		AA65-30023A	CLAMPER CORE-CABLE;NYLON-66,BLK	1	SNA	
...4		BN69-04419J	PACKING-BAG PE;UC5000,LDPE,70,90,Power-C	1	SNA	
...3	RB01	BN63-06543B	COVER-BOTTOM;UC7000 40,HIPS,V0,BK0020	1	SA	
...4		0103-004637	RESIN-HIPS;BK0020,V0,HIPS,NoN-Deca,NoN-D	70	SNA	
.2		BN96-13188F	ASSY ACCESSORY-MANUAL;UE32C5100QFXZG	1	SNA	
...3	T0524	6902-000110	BAG PE;LDPE,T0.05,W250,L400,TRP,28,2,9.2	1	SNA	
...3	T0527	BN68-00513A	LABEL-E,PASS;ALL MODEL,YUPO(110G),50X15,	1	SNA	
...3		BN68-00514E	MANUAL FLYER-05,WARRANTY CARD;comm,Samsu	1	SNA	
...3		BN68-02186A	MANUAL FLYER-TOC GUIDE;COMM,SAMSUNG,11 L	1	SNA	
...3		BN68-02656B	MANUAL USERS;C5100,SAMSUNG,4LANGS,GERMAN	1	SNA	
...3		AA68-03242V	MANUAL FLYER-SAFETY GUIDE;comm,Samsung,1	1	SNA	
0.1	M0017	BN91-05033B	ASSY CHASSIS;UE37C5100QWXXC	1	SNA	
.2	M0014	BN94-03368B	ASSY PCB MAIN;UE37C5100QFXXC	1	SA	
...3		BN97-04054B	ASSY SMD;UE37C5100QFXXC,BN94-03368A	1	SNA	
...4		BN97-04023A	ASSY MICOM-MAIN;N82A,2009.11.10,T-TDT5DE	1	SNA	
....5		1107-001818	IC-NAND FLASH;KFG1G16U2C-DIB6,1024Mbit,6	1	SNA	
...4		BN97-04024A	ASSY MICOM-SUB;N82A,2009.11.10,T-TDT5DEU	1	SNA	
....5	IC115	1107-001580	IC-FLASH MEMORY;MX25L4005,4Mbit,512Kx8,S	1	SNA	
...4		0202-001767	SOLDER-CREAM;LST-5710,D20~38,Sn-57Bi-1Ag	2.072	SNA	
...4	DS01A	0401-001056	DIODE-SWITCHING;MMBD4148SE,100V,200mA,SO	22	SA	
...4	D0254	0402-000553	DIODE-SCHOTTKY;SS24/B240,40V,2000mA,DO-2	2	SA	

5. Exploded View & Part List

Level	Location No.	Code No.	Description & Specification	Q'ty	SA/SNA	Remark
...4		0403-001164	DIODE-ZENER;MMSZ5232B,5.32-5.88V,500mW,S	1	SA	
...4		0403-001180	DIODE-ZENER;BZX84C6V2,5.8-6.6V,350mW,SOT	1	SA	
...4		0403-001783	DIODE-ZENER;BZB84-C6V2,5.8/6.6V,300mW,SO	17	SNA	
...4	D0254	0404-001404	DIODE-SCHOTTKY;BAT721C,40V,200mA,SOT-23,	1	SA	
...4	T0139	0406-001200	DIODE-TVS;RCLAMP0504F,6/-V,150W,SC-70	2	SA	
...4	T0139	0406-001271	DIODE-TVS;RCLAMP0524P,6/-V,150W,SLP251	9	SNA	
...4	SD3	0407-000114	DIODE-SWITCHING;KDS184,80V,100mA,SOT-23,	3	SNA	
...4	KQ1	0501-000279	TR-SMALL SIGNAL;KSA1182-Y,PNP,150mW,SOT-	1	SA	
...4	Q101	0501-000445	TR-SMALL SIGNAL;KTC3875S-Y,NPN,150mW,SOT	12	SA	
...4	CEQ2	0505-000110	FET-SILICON;2N7002,N,60V,115mA,7.5ohm,0.	5	SA	
...4	Q409	0505-000274	FET-SILICON;AO4435L,P,-30V,-11A,0.014ohm	1	SNA	
...4	IC104	0801-002630	IC-CMOS LOGIC;74AHCT1G08,2-INPUT AND GAT	1	SA	
...4	ND51C2	0801-002780	IC-CMOS LOGIC;74LVC1G17,SCHMITT-TRIGGER	1	SA	
...4	IC104	0801-003330	IC-CMOS LOGIC;Octal buffer,DQFN,20P,4.5x	3	SA	
...4	IC104	0802-001012	IC-CMOS LOGIC;74LCX245,TRANSCEIVER,DQFN,	1	SNA	
...4	IC106	1001-001573	IC-VIDEO SWITCH;Sii9287BCNUTR,QFN,72P,10	1	SNA	
...4		1006-001474	IC-LINE DRIVER;DRV604PWP,HPSSOP,28P,9.8x	1	SA	
...4	IC112	1103-000129	IC-EEPROM;24C02,2Kbit,256x8,SOP,8P,5x4mm	2	SA	
...4	IC112	1103-001385	IC-EEPROM;AT24C256,256Kbit,32Kx8,SOP,8P,	1	SA	
...4		1105-002058	IC-DDR2 SDRAM;K4T1G164QE-HCF8,DDR2,1Gbit	2	SA	
...4	T0124	1201-002992	IC-POWER AMP;STA369BWS,PSSO,36P,10.3x7.5	2	SA	
...4	T0087	1203-001815	IC-POSI.FIXED REG.;78M09,TO-252,3P,PLAST	1	SA	
...4	T0087	1203-002835	IC-POSI.FIXED REG.;KIA7805AF,DPAK,3P,6.6	1	SA	
...4	T0087	1203-002898	IC-POSI.FIXED REG.;G950T45R,TO-252,3P,6.	1	SA	
...4		1203-004364	IC-VOL. DETECTOR;RT9818C-42PV,SOT-23,3P,	1	SA	
...4	T0087	1203-005134	IC-POSI.FIXED REG.;RT9167A-33PB,SOT-23-5	1	SNA	
...4		1203-005538	IC-DC/DC CONVERTER;AOZ1021HAIL,SOP,8P,4.	1	SA	
...4		1203-005559	IC-BACKLIGHT DRIVER;MP3302DJ,TSOT23,5P,2	1	SA	
...4		1203-006013	IC-DC/DC CONVERTER;AOZ1031AI,SO-8,8P,4.9	1	SA	
...4		1203-006017	IC-VOL. DETECTOR;RT9824GJ8,TSOT23,8P,2.9	1	SA	
...4	T0087	1203-006135	IC-POSI.FIXED REG.;AP1117D-33-GZ-13-89,T	1	SA	
...4	T0087	1203-006136	IC-POSI.FIXED REG.;AP1117D-18-GZ-13-89,T	1	SA	
...4	IC012	1203-006138	IC-POSI.ADJUST REG.;AP1117DGZ-13-89,TO-2	1	SA	
...4		1203-006288	IC-VOL. DETECTOR;RT9818B-18GV,SOT-23-3,3	1	SA	
...4		1204-003088	IC-DEMODULATOR;DRX39XYK,PQFN,64P,9x9x0.8	1	SA	
...4		1204-003096	IC-VIDEO DECODER;HIDTVPRO-SX,PBGA,580P,P	1	SA	
...4		1205-003201	IC-BUS SWITCH;TC7WB125FK,SSOP,8P,2x2.3mm	2	SA	
...4		1205-003479	IC-SWITCH;TPS2051BDBVR,SOT-23,5P,2.9x1.6	1	SA	
...4		1205-003733	IC-SWITCH;AP2191MPG-13,MSOP-8L-EP,8P,2.9	1	SA	
...4		1205-003735	IC-SWITCH;AP2151WG-7,SOT25,5P,2.9x1.6mm,	1	SA	
...4		1405-001185	VARISTOR;24Vdc,1.6x0.8x0.36mm,TP	1	SA	
...4		1405-001271	VARISTOR;20Vdc,5A,1.0x0.5x0.6mm,TP	23	SA	
...4	PR6	2007-000072	R-CHIP;47ohm,5%,1/10W,TP,1608	6	SNA	
...4	R105	2007-000138	R-CHIP;100ohm,5%,1/16W,TP,1005	34	SA	
...4	AR49	2007-000140	R-CHIP;1Kohm,5%,1/16W,TP,1005	5	SNA	
...4	MR306	2007-000141	R-CHIP;2.2Kohm,5%,1/16W,TP,1005	15	SNA	
...4	R319	2007-000143	R-CHIP;4.7Kohm,5%,1/16W,TP,1005	44	SNA	
...4		2007-000146	R-CHIP;6.8Kohm,5%,1/16W,TP,1005	2	SNA	
...4	R104	2007-000148	R-CHIP;10Kohm,5%,1/16W,TP,1005	54	SA	
...4	R102	2007-000149	R-CHIP;12Kohm,5%,1/16W,TP,1005	6	SA	
...4	HDR2	2007-000151	R-CHIP;15Kohm,5%,1/16W,TP,1005	1	SNA	

5. Exploded View & Part List

Level	Location No.	Code No.	Description & Specification	Q'ty	SA/SNA	Remark
...4	MR36	2007-000153	R-CHIP;22Kohm,5%,1/16W,TP,1005	8	SNA	
...4	AR43	2007-000155	R-CHIP;27Kohm,5%,1/16W,TP,1005	2	SNA	
...4	MR13	2007-000157	R-CHIP;47Kohm,5%,1/16W,TP,1005	9	SNA	
...4	R123	2007-000159	R-CHIP;56Kohm,5%,1/16W,TP,1005	3	SNA	
...4	DR39	2007-000162	R-CHIP;100Kohm,5%,1/16W,TP,1005	2	SNA	
...4	MR16	2007-000168	R-CHIP;470Kohm,5%,1/16W,TP,1005	1	SNA	
...4	R509	2007-000170	R-CHIP;1Mohm,5%,1/16W,TP,1005	1	SNA	
...4	R111	2007-000171	R-CHIP;0ohm,5%,1/16W,TP,1005	8	SNA	
...4	HDR17	2007-000172	R-CHIP;10ohm,5%,1/16W,TP,1005	12	SNA	
...4	R338	2007-000173	R-CHIP;22ohm,5%,1/16W,TP,1005	14	SNA	
...4	UR23	2007-000174	R-CHIP;47ohm,5%,1/16W,TP,1005	2	SNA	
...4	MR9	2007-000455	R-CHIP;18Kohm,1%,1/10W,TP,1608	1	SA	
...4	ER13	2007-000669	R-CHIP;2Kohm,1%,1/10W,TP,1608	1	SNA	
...4	R726	2007-000695	R-CHIP;3.3ohm,5%,1/10W,TP,1608	2	SNA	
...4		2007-000755	R-CHIP;330Kohm,1%,1/10W,TP,1608	1	SA	
...4	R124	2007-000775	R-CHIP;33Kohm,5%,1/16W,TP,1005	3	SNA	
...4	HR3	2007-000903	R-CHIP;430ohm,1%,1/10W,TP,1608	1	SNA	
...4	DR37	2007-000932	R-CHIP;470ohm,5%,1/16W,TP,1005	1	SNA	
...4		2007-001285	R-CHIP;5.6ohm,5%,1/16W,TP,1005	4	SA	
...4	OTR1	2007-001292	R-CHIP;33ohm,5%,1/16W,TP,1005	9	SNA	
...4	DR43	2007-001298	R-CHIP;51ohm,5%,1/16W,TP,1005	1	SNA	
...4	R326	2007-001325	R-CHIP;3.3Kohm,5%,1/16W,TP,1005	11	SNA	
...4		2007-002768	R-CHIP;6.2Kohm,1%,1/10W,TP,1608	1	SA	
...4	MR316	2007-002796	R-CHIP;510ohm,5%,1/16W,TP,1005	1	SA	
...4	PR24	2007-002970	R-CHIP;56ohm,5%,1/16W,TP,1005	2	SA	
...4	TR30	2007-007009	R-CHIP;75ohm,5%,1/16W,TP,1005	14	SA	
...4		2007-007134	R-CHIP;39Kohm,1%,1/16W,TP,1005	1	SA	
...4		2007-007135	R-CHIP;18Kohm,1%,1/16W,TP,1005	1	SNA	
...4	DR4	2007-007142	R-CHIP;10Kohm,1%,1/16W,TP,1005	3	SNA	
...4		2007-007156	R-CHIP;1ohm,5%,1/16W,TP,1005	9	SNA	
...4		2007-007312	R-CHIP;20Kohm,1%,1/16W,TP,1005	2	SA	
...4		2007-007316	R-CHIP;3.3Kohm,1%,1/16W,TP,1005	1	SNA	
...4		2007-007317	R-CHIP;2.2Kohm,1%,1/16W,TP,1005	1	SA	
...4		2007-007318	R-CHIP;1Kohm,1%,1/16W,TP,1005	10	SNA	
...4		2007-007334	R-CHIP;200Kohm,1%,1/16W,TP,1005	4	SNA	
...4		2007-007733	R-CHIP;51ohm,1%,1/10W,TP,1608	2	SA	
...4	MR11	2007-008015	R-CHIP;75ohm,1%,1/16W,TP,1005	14	SNA	
...4		2007-008134	R-CHIP;12.4Kohm,1%,1/16W,TP,1005	1	SC	
...4		2007-008275	R-CHIP;30Kohm,1%,1/16W,TP,1005	1	SNA	
...4		2007-008298	R-CHIP;49.9ohm,1%,1/16W,TP,1005	2	SA	
...4		2007-008563	R-CHIP;270ohm,1%,1/16W,TP,1005	1	SA	
...4		2007-008593	R-CHIP;750ohm,1%,1/16W,TP,1005	1	SA	
...4		2007-008649	R-CHIP;220ohm,1%,1/16W,TP,1005	4	SNA	
...4	ZRN10	2011-001261	R-NETWORK;33ohm,5%,1/16W,L,CHIP,8P,TP,2.	6	SA	
...4	DAR09	2011-001262	R-NETWORK;22ohm,5%,1/16W,L,CHIP,8P,TP,2.	5	SA	
...4		2011-001449	R-NETWORK;22ohm,5%,1/16W,L,4P,TP,1010	8	SA	
...4	DRP9	2011-001474	R-NETWORK;47ohm,5%,1/16W,L,CHIP,8P,TP,2.	1	SA	
...4		2011-001519	R-NETWORK;33OHM,5%,1/16W,L,CHIP,4P,TP,1.	3	SA	
...4		2011-001527	R-NETWORK;4.7Kohm,5%,1/16W,L,CHIP,4P,TP,	7	SNA	
...4		2011-001589	R-NETWORK;0ohm,5%,1/16W,L,CHIP-V,4P,TP,1	16	SNA	
...4	DC30	2203-000138	C-CER,CHIP;1.5nF,10%,50V,X7R,TP,1005,-	2	SNA	

5. Exploded View & Part List

Level	Location No.	Code No.	Description & Specification	Q'ty	SA/SNA	Remark
...4	PC43	2203-000233	C-CER,CHIP;0.1nF,5%,50V,C0G,TP,1005	4	SA	
...4	MC302	2203-000425	C-CER,CHIP;.018nF,5%,50V,C0G,TP,1005	4	SA	
...4	C254	2203-000438	C-CER,CHIP;1nF,10%,50V,X7R,TP,1005	15	SA	
...4	AC139	2203-000491	C-CER,CHIP;2.2nF,10%,50V,X7R,1608	2	SA	
...4	V1233	2203-000575	C-CER,CHIP;220nF,10%,25V,X7R,TP,2012	9	SNA	
...4	MC9	2203-000627	C-CER,CHIP;.022nF,5%,50V,C0G,TP,1005	2	SNA	
...4	DC374	2203-000659	C-CER,CHIP;0.27nF,5%,50V,C0G,1608	1	SA	
...4	AD480	2203-000679	C-CER,CHIP;0.027nF,5%,50V,C0G,1005	1	SA	
...4	DC25	2203-000812	C-CER,CHIP;.033nF,5%,50V,C0G,1005	11	SA	
...4	CK40B	2203-000838	C-CER,CHIP;0.39nF,5%,50V,C0G,TP,1608	4	SNA	
...4	KFC6	2203-000872	C-CER,CHIP;0.0030nF,0.25pF,50V,C0G,1608	2	SNA	
...4	HDC5	2203-001072	C-CER,CHIP;0.056nF,5%,50V,NP0,1005	4	SA	
...4	C101	2203-001124	C-CER,CHIP;0.68nF,10%,50V,X7R,TP,1005	2	SA	
...4	DC87	2203-001153	C-CER,CHIP;.068nF,5%,50V,NP0,1005	2	SA	
...4	AD480	2203-001428	C-CER,CHIP;470nF,10%,50V,X7R,TP,2012	2	SNA	
...4	AD480	2203-002285	C-CER,CHIP;10nF,10%,50V,X7R,1005	15	SNA	
...4	AD480	2203-002525	C-CER,CHIP;0.56nF,10%,50V,X7R,TP,1005	6	SNA	
...4	C711	2203-002982	C-CER,CHIP;6.8nF,10%,50V,X7R,1005	1	SA	
...4	AAC1	2203-005249	C-CER,CHIP;100nF,10%,50V,X7R,TP,1608	9	SNA	
...4	AD480	2203-005511	C-CER,CHIP;27nF,10%,10V,X7R,TP,1005	1	SA	
...4	AD480	2203-005968	C-CER,CHIP;4.7nF,10%,50V,X7R,TP,1005	2	SNA	
...4	AD480	2203-006039	C-CER,CHIP;1nF,10%,2000V,X7R,3216	2	SA	
...4	AD480	2203-006126	C-CER,CHIP;47nF,10%,16V,X7R,1005	3	SNA	
...4	C102	2203-006158	C-CER,CHIP;100nF,10%,16V,X7R,1005	136	SNA	
...4	JC10	2203-006324	C-CER,CHIP;2200nF,10%,10V,X5R,1608	2	SA	
...4	AD480	2203-006336	C-CER,CHIP;10000nF,10%,25V,X5R,3216	29	SA	
...4	C125	2203-006361	C-CER,CHIP;10000nF,10%,10V,X5R,TP,2012	44	SC	
...4	HE4	2203-006474	C-CER,CHIP;22000nF,20%,6.3V,X5R,2012	3	SA	
...4	AD480	2203-006841	C-CER,CHIP;1000nF,10%,16V,X5R,1005	31	SNA	
...4	AD480	2203-006992	C-CER,CHIP;0.33nF,5%,50V,C0G,TP,1005	2	SNA	
...4		2601-001056	TRANS-SMD,PULSE;350uH,-,1:1,1:1,12.7X6.7	1	SA	
...4	T0052	2703-000158	INDUCTOR-SMD;1uH,10%,2012	4	SA	
...4	T0052	2703-000296	INDUCTOR-SMD;680nH,10%,1608	1	SA	
...4	VL6	2703-000398	INDUCTOR-SMD;10uH,10%,3225	4	SA	
...4	L1103	2703-000403	INDUCTOR-SMD;22uH,10%,3225	1	SA	
...4	T0052	2703-001239	INDUCTOR-SMD;3.3uH,10%,1608	3	SA	
...4	L607	2703-001254	INDUCTOR-SMD;1.8uH,10%,2012	1	SA	
...4	T0052	2703-002268	INDUCTOR-SMD;8.2nH,5%,1005	4	SNA	
...4	T0052	2703-003149	INDUCTOR-SMD;2.2uH,20%,5050	2	SA	
...4	T0052	2703-003150	INDUCTOR-SMD;4.7uH,20%,5050	4	SNA	
...4	T0052	2703-003790	INDUCTOR-SMD;4.7uH,20%,8080	2	SA	
...4	X202	2801-003326	CRYSTAL-SMD;24MHz,30ppm,28-ABX,20pF,50oh	1	SA	
...4	X202	2801-004004	CRYSTAL-SMD;20.25MHz,20ppm,28-AAN,13pF,2	1	SA	
...4	F103	2901-001506	FILTER-EMI SMD;5V,0.13A,0pF,2x1x0.5mm,TP	2	SA	
...4	T0568	3301-001236	BEAD-SMD;60ohm,1608	5	SNA	
...4	T0568	3301-002039	BEAD-SMD;26ohm,1608,TP	41	SA	
...4		3701-001293	CONNECTOR-HDMI;19P,2R,FEMALE,SMD-A,AU	4	SA	
...4	CN906	3707-001095	CONNECTOR-OPTICAL;SMD-A(Ultra Slim),SPDI	1	SA	
...4	AC510	3708-002797	CONNECTOR-FPC/FFC/PIC;51P,0.50mm,SMD,AU,	1	SA	
...4		3710-002276	SOCKET-INTERFACE;24P,1R,0.5mm,SMD-A,AU,B	1	SA	
...4	CON_US	3711-005616	HEADER-BOARD TO CABLE;BOX,10P,1R,2mm,SMD	1	SNA	

5. Exploded View & Part List

Level	Location No.	Code No.	Description & Specification	Q'ty	SA/SNA	Remark
...4	HB01A	3711-007336	HEADER-BOARD TO CABLE;BOX,4P,1R,2.5mm,SM	2	SA	
...4		3722-003044	JACK-USB;4P/1C,NI,BLK,SMD-A,A-TYPE	2	SA	
...4		BN41-01378A	PCB MAIN;SX1 5000 DVB,FR-4,4,1.0,1.2T,19	1	SNA	
...4	T0568	3301-001186	BEAD-SMD;600ohm,3216,2500mA,TP,553ohm/93	1	SNA	
...4	T0596	0904-002554	IC-USC;AU6256-JBF,QFN,28P,5x5mm,12MHz,TP	1	SA	
...4		2007-001317	R-CHIP;910ohm,5%,1/16W,TP,1005	1	SNA	
...4	AD480	2203-006824	C-CER,CHIP;4700nF,10%,10V,X5R,1608	1	SNA	
...4	X202	2801-004775	CRYSTAL-SMD;12MHz,30ppm,16pF,30ohm,TP	1	SNA	
...3		BN97-04098A	ASSY CI PLUS;BN46-00025A,LC5F,SX1 platfo	1	SNA	
...4		BN46-00025A	KEY CODE-CI PLUS KEY;CI PLUS KEY,TCTC,SE	1	SNA	
...3		0202-001608	SOLDER-WIRE FLUX;LFC7-107,D0.8,99.3Sn/0.	0.25	SNA	
...3		3701-001698	CONNECTOR-DSUB;15P,3ROW,FEMALE,ANGLE,NI	1	SA	
...3		3709-001603	CONNECTOR-CARD SLOT;68P(U/SLIM 60mm) W/L	1	SA	
...3		3711-007302	HEADER-BOARD TO BOARD;BOX,18P,2R,2mm,ANG	1	SA	
...3	JA330	3722-002844	JACK-PHONE;1/7P,NI,LAUREL-GREEN,ANGLE	1	SA	
...3	JA330	3722-002845	JACK-PHONE;1/7P,NI,YELLOW,ANGLE	1	SA	
...3	JA330	3722-002846	JACK-PHONE;1/6,NI,BLACK,ANGLE	2	SNA	
...3		3722-002849	JACK-MODULAR;8P/8C(ULTRA SLIM),YES,ANGLE	1	SNA	
...3	ET01	BN40-00172A	TUNER;DTOS40CVH081A,DVB-T/C,164CH,38.9MH	1	SA	
...3	T0066	BN62-00042A	HEAT SINK-ES;30*30*5,Ceramic,T1.5,TAPE	1	SNA	
...3	T0066	BP62-00047A	HEAT SINK-ES;DLP,A6063S,T2.5,13,13,TAPE	2	SNA	
...3	CCMM1	BN73-00211B	SILICON/RUBBER;UN46B9000FXZA,SILICON+PO	1	SNA	
...3		BN96-14857A	ASSY BRACKET P-AV;UE5100,EO,PCM,T0.5,BKN	1	SNA	
...4	CB01	BN61-04924A	BRACKET-AV;LB700 40,PCM,T0.5,BKN-P824, P	1	SNA	
...4	M0131	BN63-01251A	GASKET;NB24BS,CONDUCTIVE FABRIC,0.7mm,12	1	SNA	