

## 20 Exploded View and Replacement Parts List

### 20.1. Exploded View and Mechanical replacement Parts List

#### 20.1.1. Cabinet Parts Location

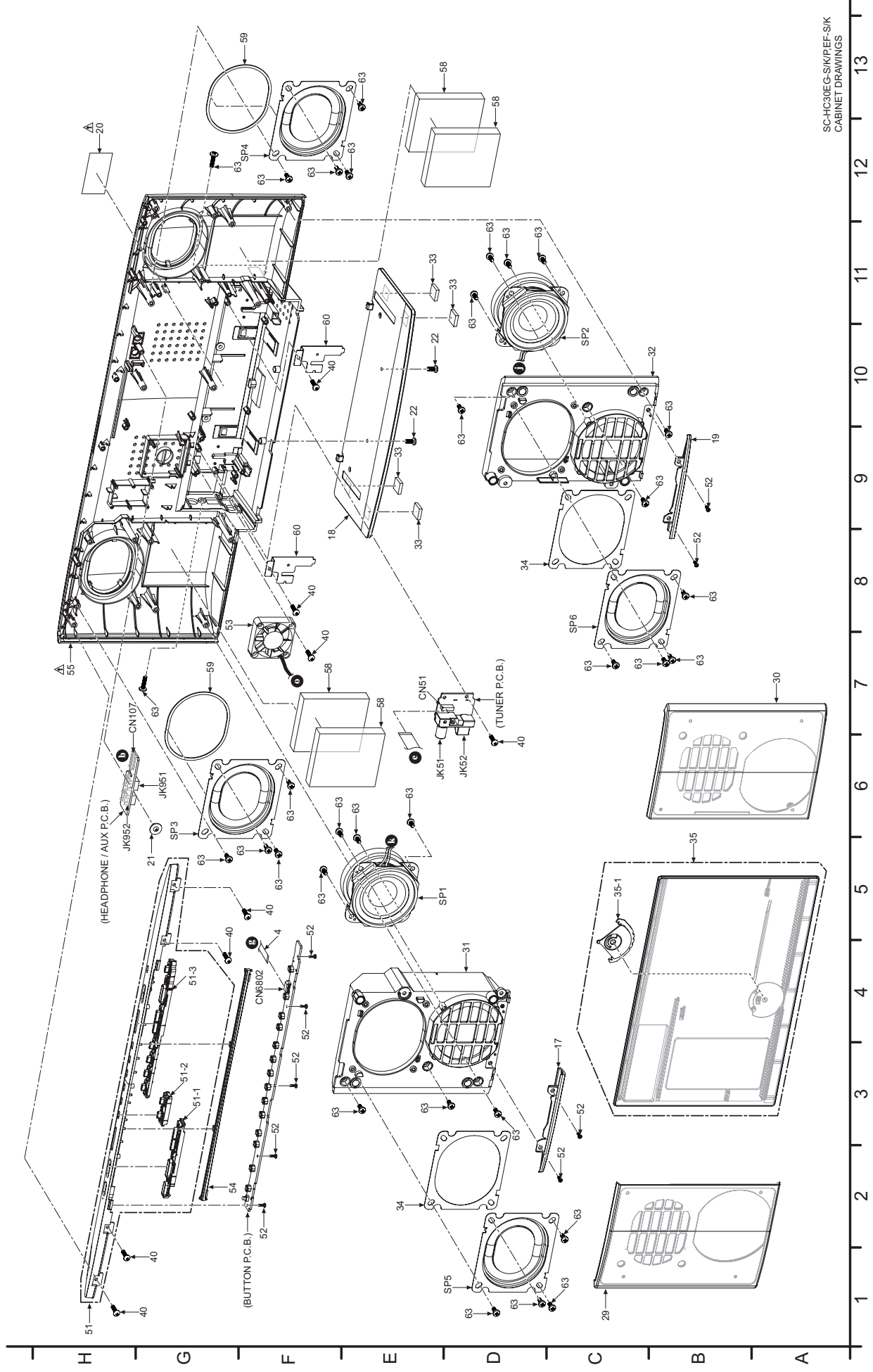

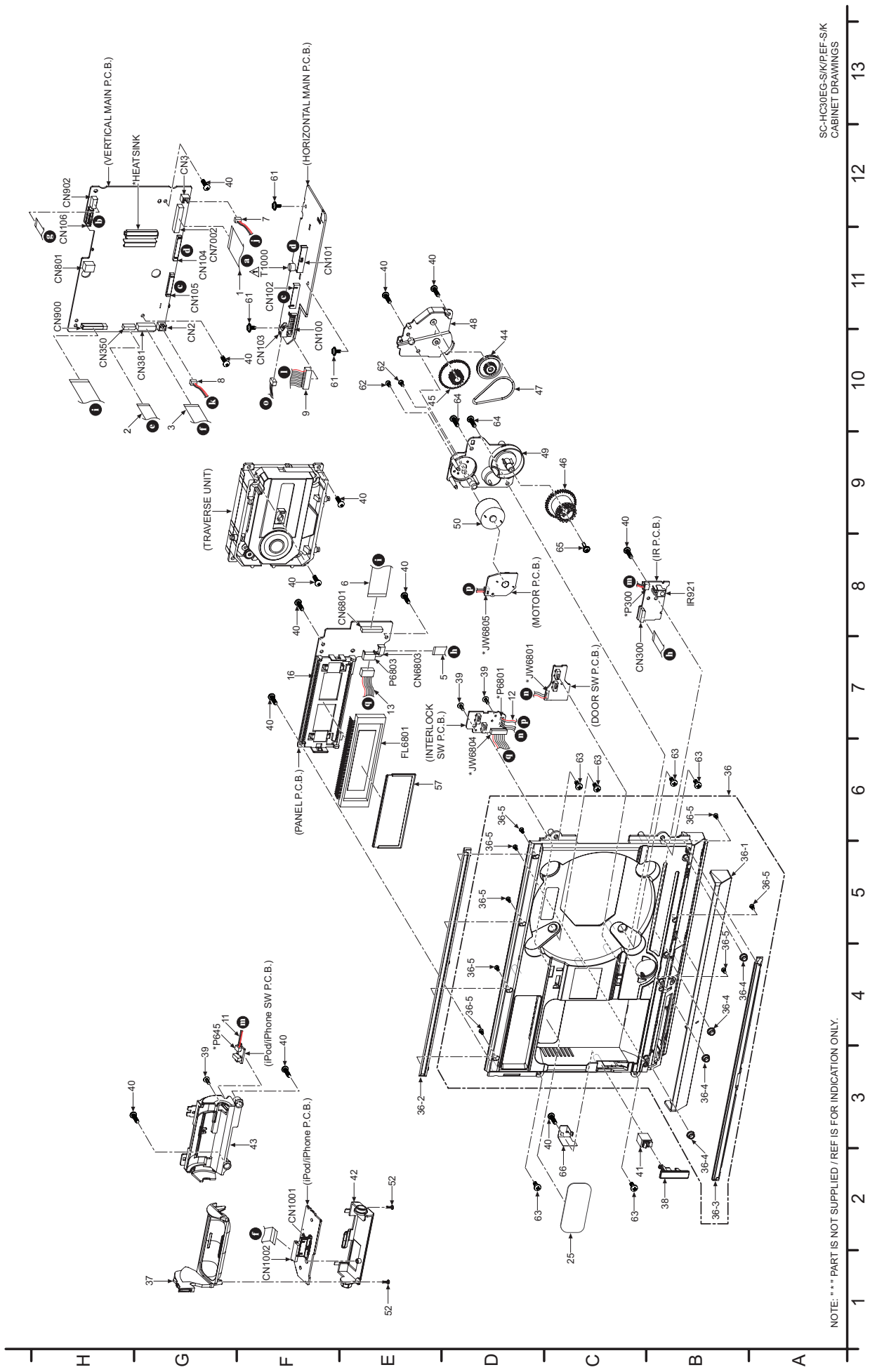

SC-H30EG-S/KPEF-S/K  
CABINET DRAWINGS

NOTE: \* \* \* PART IS NOT SUPPLIED / REF IS FOR INDICATION ONLY.

TRAVERSE UNIT

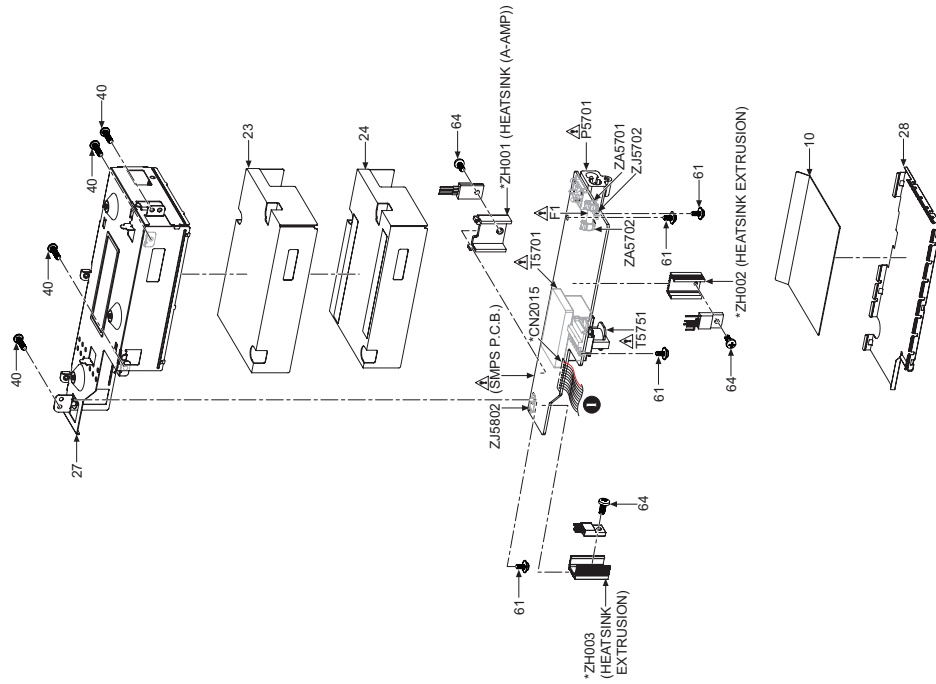
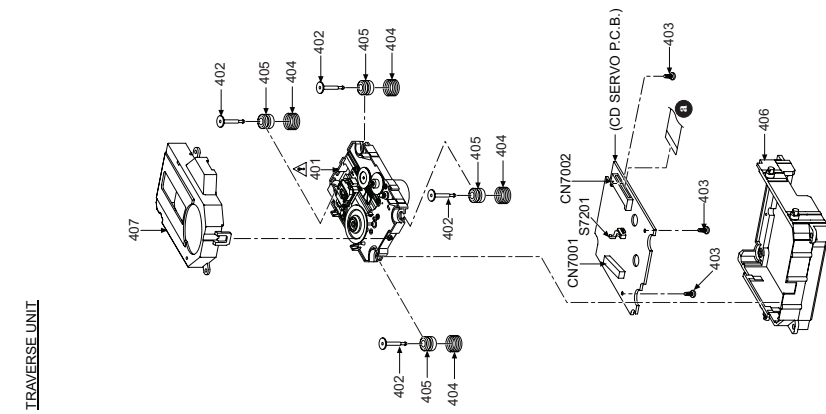

NOTE: "\*" PART IS NOT SUPPLIED / REF IS FOR INDICATION ONLY.



20.1.2. Packaging

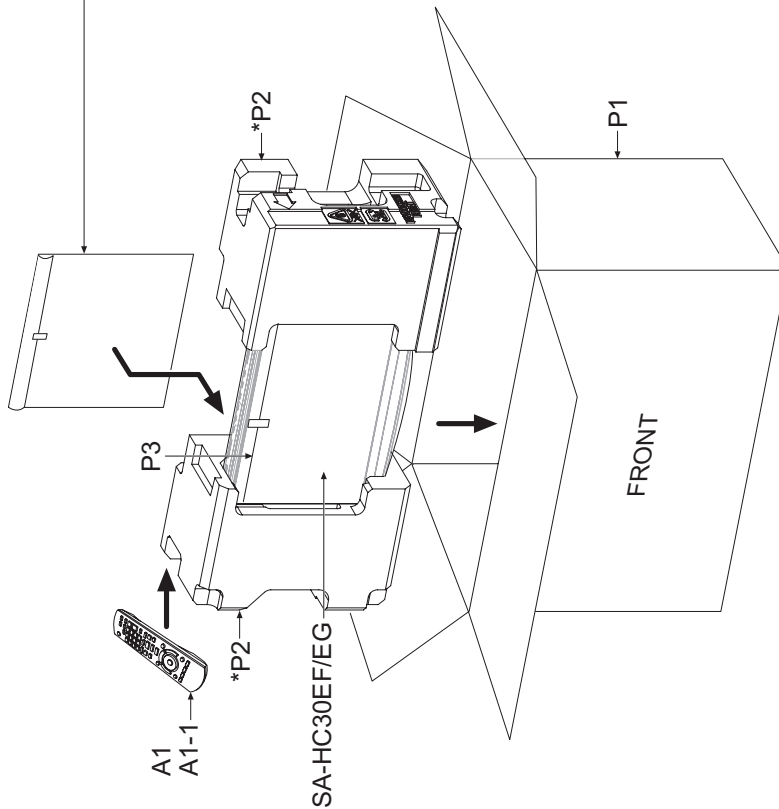
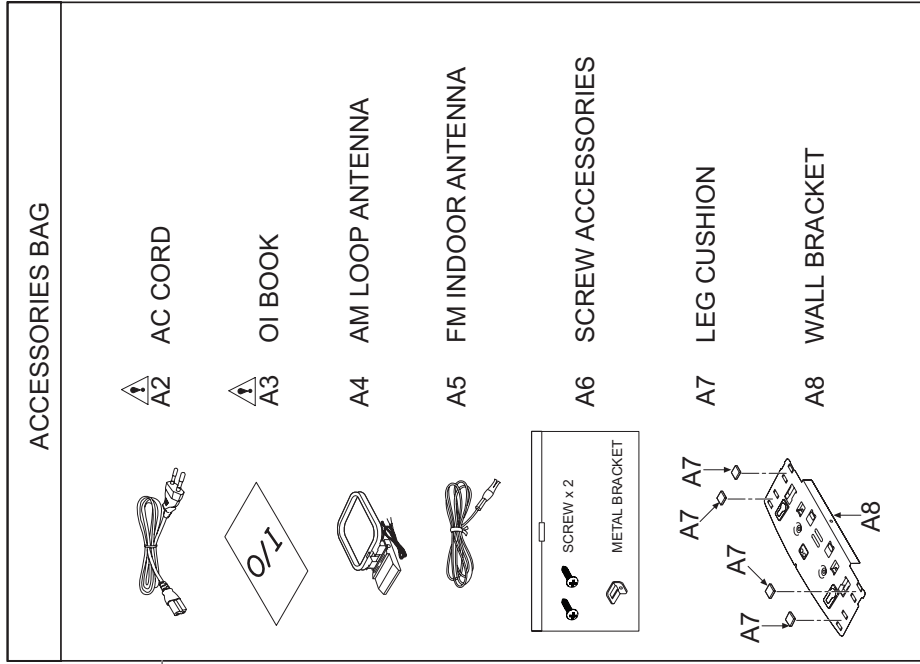

\*P2 POLYFOAM (LEFT)  
POLYFOAM (RIGHT)

SC-HC30EG-SJK/PEF-SJK  
PACKAGING DRAWINGS



### 20.1.3. Mechanical Replacement Parts List

#### Important Safety Notice

*Components identified by  $\Delta$  mark have special characteristics important for safety. When replacing any of these components, use only manufacturer's specified parts.*

#### RTL (Retention Time Limited)

**Note:** The marking (RTL) indicates that the Retention Time is Limited for this item.

After the discontinuation of this assembly in production, the item will continue to be available for a specific period of time. The retention period of availability is dependant on the type of assembly, and in accordance with the laws governing part and product retention. After the end of this period, the assembly will no longer be available.

**Note:**

- When replacing any of these components, be sure to use only manufacturer's specified parts shown in the replacement part list.
- The parenthesized indications on the Remarks column specify the destination & product color (Refer to the cover page for the information).
- Parts without these indications shall be used for all areas.
- This product uses a laser diode. Refer to "Precaution of Laser Diode".
- All parts mentioned are supplied by PAVCSG unless indicated likewise.
- Parts mentioned [SPG] in the Remarks column are supplied by PAVC-CSG.
- Reference for O/I book languages are as follows:

Ar:	Arabic	Du:	Dutch	It:	Italian	Sp:	Spanish
Cf:	Canadian French	En:	English	Ko:	Korean	Sw:	Swedish
Cz:	Czech	Fr:	French	Po:	Polish	Co:	Traditional Chinese
Da:	Danish	Ge:	German	Ru:	Russian	Cn:	Simplified Chinese
Pe:	Persian	Ur:	Ukraine	Pr:	Portuguese		

Safety	Ref. No.	Part No.	Part Name & Description	QTY	Remarks
			CABINET AND CHASSIS		
	1	REEX1128	25P FFC (CD-VERTICAL MAIN)	1	
	2	REEX1129	9P FFC (TUNER-VERTICAL MAIN)	1	
	3	REEX1130-1	15P (iPod/iPhone-VERTICAL MAIN)	1	
	4	REEX1163	7P FFC (BUTTON VERTICAL MAIN)	1	
	5	REEX1172	10P FFC (PANEL-IR)	1	
	6	REEX1173	25P FFC (PANEL-VERTICAL MAIN)	1	
	7	REXX1074	2P FLAT WIRE (SPEAKER-VERTICAL MAIN)	1	
	8	REXX1075	2P FLAT WIRE (SPEAKER VERTICAL -MAIN)	1	
	9	REXX1067-1	11P FLAT WIRE (SMPS-HORIZONTAL MAIN)	1	
	10	RMNX1029	SMPS INSULATOR C	1	
	11	REXX1071	2P WIRE (IR-iPod/iPhone SW)	1	
	12	REXX1073-1	5P FLAT WIRE (INTERLOCK SW-MOTOR/DOOR SW)	1	
	13	REXX1085	7P FLAT WIRE (INTERLOCK SW-PANEL)	1	
	16	RMNX0307	FL HOLDER	1	

Safety	Ref. No.	Part No.	Part Name & Description	QTY	Remarks
	17	RGKX1013-K	BOTTOM ORNAMENT (L)	1	
	18	RGKX1015-K	BASE STAND	1	
	19	RGKX1028-K	BOTTOM ORNAMENT (R)	1	
$\Delta$	20	RGNX1043H-K	NAME PLATE LABEL	1	
	21	RHD26016-1L	SCREW	1	
	22	XTB3+8JFJK	SCREW	2	
	23	RMNX1008	SMPS INSULATOR A	1	
	24	RMNX1009	SMPS INSULATOR B	1	
	25	RMQX1046	IPOD CUSHION	1	
	27	RSCX1018	SMPS BRACKET	1	
	28	RSCX1019	SMPS SHIELD	1	
	29	RYBX1002-K	NET FRAME UNIT (L)	1	
	30	RYBX1003-K	NET FRAME UNIT (R)	1	
	31	RKPX1004-K	SPEAKER FRONT CABINET (L)	1	
	32	RKPX1005-K	SPEAKER FRONT CABINET (R)	1	
	33	RKAX0028-K	LEG CUSHION	4	
	34	RMQX0362	EVA PACKING PASSIVE FRONT	2	
	35	RYPX1015B-S1	DOOR UNIT	1	EF-S, EG-S
	35	RYPX1015E-K1	DOOR UNIT	1	EF-K, EG-K
	35	RYPX1015B-P1	DOOR UNIT	1	EG-P
	35-1	RDKX0001-2	GEAR CAM	1	
	36	RYPX1018-K	FRONT CABINET UNIT	1	
	36-1	RGKX1034-K	FRONT ORNAMENT	1	
	36-2	RGPX1013-K	GUIDE RAIL TOP	1	

Safety	Ref. No.	Part No.	Part Name & Description	QTY	Remarks
	36-3	RGPX1014-K	GUIDE RAIL BOT-TOM	1	
	36-4	RDPV0001	LID ROLLER	4	
	36-5	VHD1224-1	ADJ SPRING HOLDER SCREW	8	
	37	RGQX1002-K	DOCKING TUB	1	
	38	RGV0379-K3	PUSH LEVER	1	
	39	RHD14136	SCREW	3	
	40	RHD26045-L	SCREW	25	
	41	RHQX0003	MINI SIDE LOCK	1	
	42	RMQX1023-K	DOCKING COVER	1	
	43	RMQX1024-K	DOCKING HOLDER	1	
	44	RDG0546	BELT PULLEY	1	
	45	RDGX0050	GEAR (MIDDLE)	1	
	46	RDGX0051	GEAR (GRIVE)	1	
	47	RDVX0001	BELT	1	
	48	RMKX0159-1	GEAR FIXTURE	1	
	49	RMKX0160-1	GEAR BASE	1	
	50	RXQ1690	MOTOR UNIT	1	
	51	RYPX1029E-S	TOP ORNAMENT UNIT	1	
	51-1	RGUX1015B2SJ	POWER BUTTON	1	
	51-2	RGUX1019-1SJ	IPOD PLAY BUTTON	1	
	51-3	RGUX1012A2SJ	CD EJECT BUTTON	1	
	52	VHD1224-1	ADJ SPRING HOLDER SCREW	11	
	53	L6FAYYYH0122	FAN UNIT	1	
	54	RGLX1004-K	LIGHTING BAR	1	
△	55	RYKX1026E-K	REAR CABINET UNIT	1	
	57	RGQX1005	FL FILTER	1	
	58	RMFX0091	ACOUSTIC ABSORBER	4	
	59	RMQX0361	EVA PACKING PASSIVE REAR	2	
	60	RSCX1030	BRACKET R	2	
	61	RHDX301002	SCREW	7	
	62	XSN2+4FJ	SCREW	2	
	63	XTB3+10JFJK	SCREW	38	
	64	XTB3+8JFJ	SCREW	5	
	65	XTW3+16TFJK	SCREW	1	
	66	RMC0780A	iPod SPRING PLATE	1	
			SPEAKERS		
	SP1	EAS65P144B	FRONT SPEAKER	1	
	SP2	EAS65P144B	FRONT SPEAKER	1	
	SP3	EAS8DY01B	PASSIVE RADIATOR	1	
	SP4	EAS8DY01B	PASSIVE RADIATOR	1	
	SP5	EAS8DY01B	PASSIVE RADIATOR	1	
	SP6	EAS8DY01B	PASSIVE RADIATOR	1	
			TRAVERSE DECK		
△	401	RAE0165T-V	TRAVERSE UNIT ASS'Y	1	
	402	RMS0757-1	FIXED PIN	4	
	403	XTN2+6GFJ	SCREW	3	
	404	RME0109-1	FLOATING SPRING	4	
	405	RMG0730-G	FLOATING RUBBER	4	
	406	RMR1395A-X	MIDDLE CHASSIS	1	
	407	RMR1396-K	TRAVERSE COVER	1	
			PACKING MATERIALS		
	P1	RPGX3096	PACKING CASE	1	EG-K
	P1	RPGX3098	PACKING CASE	1	EF-K
	P1	RPGX3159	PACKING CASE	1	EG-S
	P1	RPGX3160	PACKING CASE	1	EF-S
	P1	RPGX3279	PACKING CASE	1	EG-P
	P2	RPNX1022	POLYFOAM	1	
	P3	RPFX0262-1	MIRAMAT SHEET	1	

Safety	Ref. No.	Part No.	Part Name & Description	QTY	Remarks
			ACCESSORIES		
	A1	N2QAYB000522	REMOTE CONTROL	1	
	A1-1	RKK-PT470EBK	R/C BATTERY COVER	1	
△	A2	K2CQ2CA00007	AC CORD	1	
△	A3	RQTX1068-D	O/I BOOK (Ge/It/Fr/Sp/Du/Da/Sw)	1	EG-K, EG-S/P
△	A3	RQTX1069-H	OI BOOK (Fr)	1	EF-K/S
	A4	N1DY0000010	AM LOOP ANTENNA	1	
	A5	RSAX0002	FM INDOOR ANTENNA	1	
	A6	RFAX1020	SCREW ACCESSORIES	1	
	A7	RKAX0028-K	LEG CUSHION	4	
	A8	RGQX1004	WALL BRACKET	1	

## 20.2. Electrical Replacement Parts List

### Important Safety Notice

Components identified by  $\Delta$  mark have special characteristics important for safety. When replacing any of these components, use only manufacturer's specified parts.

#### RTL (Retention Time Limited)

**Note:** The marking (RTL) indicates that the Retention Time is Limited for this item.

After the discontinuation of this assembly in production, the item will continue to be available for a specific period of time. The retention period of availability is dependant on the type of assembly, and in accordance with the laws governing part and product retention. After the end of this period, the assembly will no longer be available.

#### Note:

- When replacing any of these components, be sure to use only manufacturer's specified parts shown in the replacement part list.
- The parenthesized indications on the Remarks column specify the destination & product color (Refer to the cover page for the information).
- Parts without these indications shall be used for all areas.
- This product uses a laser diode. Refer to "Precaution of Laser Diode".
- Capacitor value are in microfarads (uF) unless specified otherwise, P=Pico-farads (pF), F=Farads.
- Resistance values are in ohms, unless specified otherwise, 1K=1000 (OHM).
- All parts mentioned are supplied by PAVCSG unless indicated likewise.
- Parts mentioned [SPG] in the Remarks column are supplied by PAVC-CSG.

Safety	Ref. No.	Part No.	Part Name & Description	QTY	Remarks
			PRINTED CIRCUIT BOARDS		
	PCB1	REPX0723A	CD SERVO P.C.B.	1	(RTL)
	PCB2	REPX0819CA	VERTICAL MAIN P.C.B.	1	(RTL)
	PCB3	REPX0819CB	HORIZONTAL MAIN P.C.B.	1	(RTL)
	PCB4	REPX0819CD	TUNER P.C.B.	1	(RTL)
	PCB5	REPX0819CE	IR P.C.B.	1	(RTL)
	PCB6	REPX0819CE	iPod/iPhone SWITCH P.C.B.	1	(RTL)
$\Delta$	PCB7	REPX0820EA	SMPS P.C.B.	1	(RTL)
	PCB8	REPX0820EB	PANEL P.C.B.	1	(RTL)
	PCB9	REPX0820ED	BUTTON P.C.B.	1	(RTL)
	PCB10	REPX0820EE	MOTOR P.C.B.	1	(RTL)
	PCB11	REPX0820EE	DOOR SWITCH P.C.B.	1	(RTL)
	PCB12	REPX0820EE	INTERLOCK SWITCH P.C.B.	1	(RTL)
	PCB13	REPX0820EF	HEADPHONE/AUX P.C.B.	1	(RTL)
	PCB14	REPX0855A	iPod/iPhone P.C.B.	1	(RTL)
			INTERGRATED CIRCUITS		
	IC1	C1AB00003012	IC	1	
	IC52	VUEALLPT039	IC	1	[SPG]
	IC101	C1AB00003256	IC	1	
	IC103	COABBB000216	IC	1	
	IC300	MFI341S2164	IC	1	
	IC503	COCBCBC00140	IC	1	
	IC505	CODAEJG00001	IC	1	
	IC650	COGAE0000007	IC	1	
	IC705	COEBJ0000336	IC	1	
	IC800	C3EBFY000006	IC	1	

Safety	Ref. No.	Part No.	Part Name & Description	QTY	Remarks
	IC801	RFKWMHC30-K	IC	1	
	IC802	C0DBFY000049	IC	1	
	IC803	COEBE0000434	IC	1	
	IC2801	COABBB000179	IC	1	
	IC2802	COABBB000179	IC	1	
	IC2910	CODAAYH00001	IC	1	
	IC5701	CODAAMH00015	IC	1	
	IC5799	MIP2F20MSSCF	IC	1	
	IC5801	CODAEMZ00001	IC	1	
	IC6801	COHBB0000061	IC	1	
	IC7001	MN6627954AMA	IC	1	
	IC7002	BA5948FPE2	IC	1	
	IC7003	C3ARMB000050	IC	1	
			TRANSISTORS		
	Q102	B1GFGCAA00001	TRANSISTOR	1	
	Q106	B1GFGCAA00001	TRANSISTOR	1	
	Q300	B1CFGC000004	TRANSISTOR	1	
	Q301	B1CFGC000004	TRANSISTOR	1	
	Q302	B1GBCFLL0037	TRANSISTOR	1	
	Q303	B1ADCE000012	TRANSISTOR	1	
	Q382	B1ADCE000012	TRANSISTOR	1	
	Q509	B1BAAJ000003	TRANSISTOR	1	
	Q512	B1ACND000003	TRANSISTOR	1	
	Q551	B1ACKD000006	TRANSISTOR	1	
	Q552	B1ABCF000176	TRANSISTOR	1	
	Q553	B1ABCF000176	TRANSISTOR	1	
	Q554	B1ABCF000176	TRANSISTOR	1	
	Q555	B1ABCF000176	TRANSISTOR	1	
	Q580	B1ABDF000026	TRANSISTOR	1	
	Q1000	B1BABK000001	TRANSISTOR	1	
	Q5601	B1ABEC000010	TRANSISTOR	1	
	Q5899	B1ABCF000011	TRANSISTOR	1	
	Q7601	B1ADCF000001	TRANSISTOR	1	
	QR1	B1GBCFJJ0051	TRANSISTOR	1	
	QR2	B1GBCFJJ0051	TRANSISTOR	1	
	QR3	B1GBCFJJ0051	TRANSISTOR	1	

Safety	Ref. No.	Part No.	Part Name & Description	QTY	Remarks
	QR4	B1GBCFJJ0051	TRANSISTOR	1	
	QR101	B1GDCFGG0026	TRANSISTOR	1	
	QR121	B1GBCFNN0038	TRANSISTOR	1	
	QR384	B1GBCFJJ0051	TRANSISTOR	1	
	QR801	B1GBCFJJ0051	TRANSISTOR	1	
	QR802	B1GBCFJJ0051	TRANSISTOR	1	
	QR803	B1GBCFJJ0051	TRANSISTOR	1	
	QR804	B1GDCFJJ0044	TRANSISTOR	1	
	QR805	B1GBCFJJ0051	TRANSISTOR	1	
			DIODES		
	D3	B0JCME000035	DIODE	1	
	D4	B0JCME000035	DIODE	1	
	D5	B0JCME000035	DIODE	1	
	D6	B0JCME000035	DIODE	1	
	D9	MAZ8033G0L	DIODE	1	
	D10	MA2SD320GL	DIODE	1	
	D11	MA2SD320GL	DIODE	1	
	D12	MA2J1110GL	DIODE	1	
	D13	MA2J1110GL	DIODE	1	
	D105	B0ACCK000012	DIODE	1	
	D501	B0ACCK000012	DIODE	1	
	D512	B0EAKM000117	DIODE	1	
	D513	B0ACCK000012	DIODE	1	
	D517	B0ACCK000012	DIODE	1	
	D518	B0BC6R2A0266	DIODE	1	
	D519	B0EAKM000117	DIODE	1	
	D521	B0EAKM000117	DIODE	1	
	D522	B0EAKM000117	DIODE	1	
	D523	B0EAKM000117	DIODE	1	
	D524	B0EAKM000117	DIODE	1	
	D526	B0EAKM000117	DIODE	1	
	D527	B0EAKM000117	DIODE	1	
	D528	B0EAKM000117	DIODE	1	
	D529	B0EAKM000117	DIODE	1	
	D530	B0EAKM000117	DIODE	1	
	D531	B0EAKM000117	DIODE	1	
	D551	B0ACCK000012	DIODE	1	
	D553	B0ACCK000012	DIODE	1	
	D555	B0ACCK000012	DIODE	1	
	D801	B0ACCE000003	DIODE	1	
	D851	B0ACCK000012	DIODE	1	
	D853	B0ACCK000012	DIODE	1	
	D896	B0BC3R3A0262	DIODE	1	
	D900	B3AAA0000381	DIODE	1	
	D1000	B0BC036A0264	DIODE	1	
	D1002	B0BC027A0264	DIODE	1	
	D1003	B0EAMM000057	DIODE	1	
	D1004	B0JAME000029	DIODE	1	
	D1005	B0BC3R0A0262	DIODE	1	
	D2800	B0ACCK000005	DIODE	1	
	D2910	B0JCPD000025	DIODE	1	
	D5701	B0EBNR000045	DIODE	1	
	D5703	B0EAKU000001	DIODE	1	
	D5724	B0HAJM000005	DIODE	1	
	D5725	B0BC6R100010	DIODE	1	
	D5727	B0HAJM000005	DIODE	1	
	D5729	B0HAJM000005	DIODE	1	
	D5732	B0BC030A0264	DIODE	1	
	D5793	B0HAMP000094	DIODE	1	
	D5798	B0EAMM000057	DIODE	1	
	D5799	B0EDKT000009	DIODE	1	
	D5802	B0ABSM000008	DIODE	1	
	D5892	B0BC011A0267	DIODE	1	
	D5893	B0BC3R0A0262	DIODE	1	
	D5896	B0JAMF000011	DIODE	1	
	D5899	B0ACCK000012	DIODE	1	
	D7650	MAZ8056GML	DIODE	1	
A	DZ5701	ERZVA5Z471	ZNR	1	
			VARISTORS		

Safety	Ref. No.	Part No.	Part Name & Description	QTY	Remarks
	VA51	EZAEG2A50AX	ESD SUPPRESSOR	1	
			SWITCHES		
	S641	K0L1BA000078	SW LEFT	1	
	S642	K0L1BA000078	SW RIGHT	1	
	S643	K0L1BA000078	SW CENTER	1	
	S644	K0L1BA000078	SW INTERLOCK	1	
	S645	K0L1BA000078	SW iPod DOCK OPEN	1	
	S901	EVQ11G04M	SW POWER	1	
	S902	EVQ11G04M	SW iPod OPEN/CLOSE	1	
	S903	EVQ11G04M	SW FM	1	
	S904	EVQ11G04M	SW AM	1	
	S905	EVQ11G04M	SW AUX	1	
	S906	EVQ11G04M	SW CD PLAY/PAUSE	1	
	S907	EVQ11G04M	SW CD OPEN/CLOSE	1	
	S908	EVQ11G04M	SW STOP	1	
	S911	EVQ11G04M	SW REW	1	
	S912	EVQ11G04M	SW FWD	1	
	S913	EVQ11G04M	SW iPod PLAY/PAUSE	1	
	S914	EVQ11G04M	SW VOL-	1	
	S915	EVQ11G04M	SW VOL+	1	
	S916	EVQ11G04M	SW D.BASS	1	
	S7201	RSH1A048-A	SW RESET	1	
			CONNECTORS		
	CN2	K1KA02AA0180	2P CONNECTOR	1	
	CN3	K1KA02AA0180	2P CONNECTOR	1	
	CN51	K1MN09AA0003	9P CONNECTOR	1	
	CN100	K1KA11AA0194	11P CONNECTOR	1	
	CN101	K1KA13AA0031	13P CONNECTOR	1	
	CN102	K1KA12AA0031	12P CONNECTOR	1	
	CN103	K1KA02BA0125	2P CONNECTOR	1	
	CN104	K1KB13B00017	13P CONNECTOR	1	
	CN105	K1KB12B00037	12P CONNECTOR	1	
	CN106	K1KA08AA0031	8P CONNECTOR	1	
	CN107	K1KB08B00041	8P CONNECTOR	1	
	CN300	K1MN10AA0003	10P CONNECTOR	1	
	CN350	K1MN09AA0003	9P CONNECTOR	1	
	CN381	K1MN15AA0003	15P CONNECTOR	1	
	CN801	K1MN06C00005	6P CONNECTOR	1	
	CN900	K1MN25AA0004	25P CONNECTOR	1	
	CN902	K1MN07AA0003	7P CONNECTOR	1	
	CN1001	MFI514S0117	30P CONNECTOR	1	
	CN1002	K1MN15BA0139	15P CONNECTOR	1	
	CN6801	K1MN25B00019	25P CONNECTOR	1	
	CN6802	K1MN07B00009	7P CONNECTOR	1	
	CN6803	K1MN10BA0004	10P CONNECTOR	1	
	CN7001	K1MN16B00154	16P CONNECTOR	1	
	CN7002	K1MN25AA0004	25P CONNECTOR	1	PCB2
	CN7002	K1MN25B00019	25P CONNECTOR	1	PCB1
	P6803	K1KA07BA0061	7P CONNECTOR	1	
			COILS AND INDUCTORS		
	L1	G1C100M00045	INDUCTOR	1	
	L2	G1C100M00045	INDUCTOR	1	
	L6	G0AR76Y00003	INDUCTOR	1	
	L7	G0AR76Y00003	INDUCTOR	1	
	L8	G0AR76Y00003	INDUCTOR	1	
	L9	G0AR76Y00003	INDUCTOR	1	
	L51	G1CR18JA0020	INDUCTOR	1	
	L52	G2A380Y00001	ANTENNA COIL	1	
	L101	J0JBC0000030	INDUCTOR	1	
	L102	J0JBC0000030	INDUCTOR	1	
	L103	J0JBC0000030	INDUCTOR	1	
	L114	J0JBC0000030	INDUCTOR	1	
	L212	J0JBC0000030	INDUCTOR	1	
	L213	J0JBC0000030	INDUCTOR	1	



Safety	Ref. No.	Part No.	Part Name & Description	QTY	Remarks
	L214	J0JBC0000030	INDUCTOR	1	
	L219	J0JBC0000030	INDUCTOR	1	
	L220	J0JBC0000030	INDUCTOR	1	
	L242	J0JBC0000030	INDUCTOR	1	
	L258	J0JBC0000030	INDUCTOR	1	
	L302	J0JHC0000034	INDUCTOR	1	
	L314	J0JBC0000030	INDUCTOR	1	
	L350	J0JBC0000030	INDUCTOR	1	
	L381	J0JHC0000034	INDUCTOR	1	
	L382	J0JHC0000034	INDUCTOR	1	
	L420	J0JBC0000030	INDUCTOR	1	
	L442	J0JBC0000030	INDUCTOR	1	
	L458	J0JBC0000030	INDUCTOR	1	
	L501	J0JHC0000034	INDUCTOR	1	
	L951	J0JBC0000019	INDUCTOR	1	
	L952	J0JBC0000019	INDUCTOR	1	
	L953	J0JBC0000019	INDUCTOR	1	
	L954	J0JBC0000019	INDUCTOR	1	
	L955	J0JBC0000019	INDUCTOR	1	
	L956	J0JBC0000019	INDUCTOR	1	
	L957	J0JBC0000019	INDUCTOR	1	
	L958	J0JBC0000019	INDUCTOR	1	
	L1000	G0C390JA0055	FIXED INDUCTOR	1	
	L1001	J0JBC0000041	INDUCTOR	1	
	L1001	J0JFC0000006	INDUCTOR	1	
	L1002	J0JFC0000006	INDUCTOR	1	
	L1003	J0JGC0000071	INDUCTOR	1	
	L1004	J0JGC0000071	INDUCTOR	1	
	L1005	J0JGC0000071	INDUCTOR	1	
	L1006	J0JGC0000071	INDUCTOR	1	
	L1007	J0JHC0000107	INDUCTOR	1	
	L1008	J0JFC0000006	INDUCTOR	1	
	L1009	J0JFC0000006	INDUCTOR	1	
	L1010	J0JGC0000071	INDUCTOR	1	
	L1011	J0JFC0000006	INDUCTOR	1	
	L1021	D0GBR00JA008	0 1/16W	1	
	L1022	D0GBR00JA008	0 1/16W	1	
	L1023	D0GBR00JA008	0 1/16W	1	
	L1024	D0GBR00JA008	0 1/16W	1	
	L1025	D0GBR00JA008	0 1/16W	1	
	L1026	D0GBR00JA008	0 1/16W	1	
	L1027	D0GBR00JA008	0 1/16W	1	
	L1028	D0GBR00JA008	0 1/16W	1	
	L1029	D0GBR00JA008	0 1/16W	1	
	L1030	D0GBR00JA008	0 1/16W	1	
	L1031	D0GBR00JA008	0 1/16W	1	
	L1032	J0JBC0000015	INDUCTOR	1	
	L1033	D0GBR00JA008	0 1/16W	1	
	L2911	G0A101ZA0028	CHOKE COIL	1	
	L2913	G0A100GA0013	CHOKE COIL	1	
△	L5701	G0B453G00003	LINE FILTER	1	
	L6802	G0C3R3JA0055	FIXED INDUCTOR	1	
	L6806	G0C101JA0055	FIXED INDUCTOR	1	
	LB51	J0JBC0000032	INDUCTOR	1	
			TRANSFORMERS		
△	T1000	G4D1A0000117	SWITCHING TRANS-FORMER	1	
△	T5701	ETS28BH186AC	MAIN TRANSFORMER	1	
△	T5751	ETS19AB221AG	SUB TRANSFORMER	1	
			PHOTO COUPLER		
△	PC5720	B3PBA0000402	PHOTO COUPLER	1	
			EARTH TERMINALS		
	ZJ5702	K4CZ01000027	TERMINAL	1	
	ZJ5802	K4CZ01000027	TERMINAL	1	
	IR921	B3RAC0000017	REMOTE CONTROL SENSOR	1	

Safety	Ref. No.	Part No.	Part Name & Description	QTY	Remarks
			OSCILLATOR		
	X51	H0A327200097	CRYSTAL OSCILLA	1	
	X801	H0A327200097	CRYSTAL OSCILLA	1	
	X802	H2B800400005	CRYSTAL OSCILLA	1	
	X7201	H0H169500013	CRYSTAL RESON.	1	
			RELAY		
△	RY5701	K6B1AEA00003	RELAY	1	
			FL DISPLAY		
	FL6801	A2BB00000172	LCD DISPLAY	1	
			FUSES		
△	F1	K5D162BK0005	FUSE	1	
			FUSE HOLDERS		
	ZA5701	K3GE1ZZ00001	FUSE HOLDER	1	
	ZA5702	K3GE1ZZ00001	FUSE HOLDER	1	
			FUSE PROTECTORS		
△	FP1000	K5H7512A0010	PROTECTOR	1	
			THERMISTORS		
△	TH5701	D4CC11040013	THERMISTOR	1	EF-K
△	TH5702	D4CAC8R00002	THERMISTOR	1	EG-S
			JACKS		
	JK51	K4ZZ02000103	JK FM ANT	1	EF-S
	JK52	K4AC02B00042	JK AM ANT	1	EG-P
	JK951	K2HC1YYB0033	JK AUX	1	
	JK952	K2HC1YYB0033	JK HEADPHONE	1	
△	P5701	K2AA2B000011	AC INLET	1	
			CHIP JUMPERS		
	K502	D0GDR00JA017	0 1/10W	1	
	K503	D0GDR00JA017	0 1/10W	1	
	K505	D0GDR00JA017	0 1/10W	1	
	K506	D0GBR00JA008	0 1/16W	1	
	K5721	D0GBR00JA008	0 1/16W	1	
	W1	D0GBR00JA008	0 1/16W	1	
	W2	D0GBR00JA008	0 1/16W	1	
	W3	D0GBR00JA008	0 1/16W	1	EG-K, EG-P, EG-S
	W10	D0GDR00JA017	0 1/10W	1	EF-K, EF-S
	W91	D0GDR00JA017	0 1/10W	1	
	L232	D0GBR00JA008	0 1/16W	1	
	L383	D0GBR00JA008	0 1/16W	1	
	L384	D0GBR00JA008	0 1/16W	1	
	L385	D0GBR00JA008	0 1/16W	1	
			RESISTORS		
	LB7262	D0GB221JA008	220 1/16W	1	
	LB7263	D0GB221JA008	220 1/16W	1	
	LB7264	D0GB221JA008	220 1/16W	1	
	R1	D0GB223JA008	22K 1/16W	1	
	R2	D0GB223JA008	22K 1/16W	1	
	R3	D0GB223JA008	22K 1/16W	1	
	R7	D0GB392JA008	3.9K 1/16W	1	
	R9	D0GB183JA008	18K 1/16W	1	
	R11	D0GB103JA008	10K 1/16W	1	

Safety	Ref. No.	Part No.	Part Name & Description	QTY	Remarks
	R12	D0GB104JA008	100K 1/16W	1	
	R13	D0GB104JA008	100K 1/16W	1	
	R16	D0GD682JA017	6.8K 1/10W	1	
	R17	D0GD682JA017	6.8K 1/10W	1	
	R18	D0GD122JA017	1.2K 1/10W	1	
	R19	D0GD122JA017	1.2K 1/10W	1	
	R20	D0GD183JA017	18K 1/10W	1	
	R21	D0GD183JA017	18K 1/10W	1	
	R22	D0GB102JA008	1K 1/16W	1	
	R23	D0GB225JA008	2.2M 1/16W	1	
	R24	D0GB102JA008	1K 1/16W	1	
	R51	D0GB102JA008	1K 1/16W	1	
	R52	D0GB102JA008	1K 1/16W	1	
	R53	D0GA472JA023	4.7K 1/16W	1	
	R54	D0GA472JA023	4.7K 1/16W	1	
	R55	D0GA221JA023	220 1/16W	1	
	R56	D0GB221JA007	220 1/10W	1	
	R57	D0GA102JA023	1K 1/16W	1	
	R59	D0GB222JA008	2.2K 1/16W	1	
	R61	D0GB473JA008	47K 1/16W	1	
	R62	D0GB473JA008	47K 1/16W	1	
	R64	D0GBR00JA008	0 1/16W	1	
	R101	D0GBR00JA008	0 1/16W	1	
	R102	D0GB394JA008	390K 1/16W	1	
	R103	D0GB103JA008	10K 1/16W	1	
	R104	D0GB272JA008	2.7K 1/16W	1	
	R105	D0GDR00JA017	0 1/10W	1	
	R106	D0GDR00JA017	0 1/10W	1	
	R117	D0GD102JA017	1K 1/10W	1	
	R118	D0GD122JA017	1.2K 1/10W	1	
	R119	ERJ6GEYJ104V	100K 1/8W	1	
	R120	ERJ6GEYJ104V	100K 1/8W	1	
	R121	D0GD392JA017	3.9K 1/10W	1	
	R122	D0GD392JA017	3.9K 1/10W	1	
	R123	D0GD392JA017	3.9K 1/10W	1	
	R124	D0GD392JA017	3.9K 1/10W	1	
	R125	D0GD820JA017	82 1/10W	1	
	R126	D0GD820JA017	82 1/10W	1	
	R137	D0GB221JA008	220 1/16W	1	
	R138	D0GB103JA008	10K 1/16W	1	
	R139	D0GB103JA008	10K 1/16W	1	
	R140	D0GB102JA008	1K 1/16W	1	
	R206	D0GB682JA008	6.8K 1/16W	1	
	R220	D0GB122JA008	1.2K 1/16W	1	
	R221	D0GB472JA008	4.7K 1/16W	1	
	R222	D0GB682JA008	6.8K 1/16W	1	
	R230	D0GB334JA008	330K 1/16W	1	
	R253	D0GDR00JA017	0 1/10W	1	
	R254	D0GD332JA017	3.3K 1/10W	1	
	R255	D0GD681JA017	680 1/10W	1	
	R256	ERJ6GEYJ104V	100K 1/8W	1	
	R257	D0GD123JA017	12K 1/8W	1	
	R258	ERJ6GEYJ273V	27K 1/8W	1	
	R260	ERJ6GEYJ104V	100K 1/8W	1	
	R261	D0GD820JA017	82 1/10W	1	
	R262	D0GD820JA017	82 1/10W	1	
	R263	D0GD392JA017	3.9K 1/10W	1	
	R264	D0GDR00JA017	0 1/10W	1	
	R267	D0GDR00JA017	0 1/10W	1	
	R300	D0GB221JA008	220 1/16W	1	
	R301	D0GB221JA008	220 1/16W	1	
	R303	D0GB103JA008	10K 1/16W	1	
	R312	D0GB103JA008	10K 1/16W	1	
	R313	D0GB103JA008	10K 1/16W	1	
	R314	D0GB104JA008	100K 1/16W	1	
	R315	D0GB104JA008	100K 1/16W	1	
	R316	D0GB473JA008	47K 1/16W	1	
	R319	D0GB152JA008	1.5K 1/16W	1	
	R320	D0GB103JA008	10K 1/16W	1	
	R321	D0GB103JA008	10K 1/16W	1	
	R392	D0GB104JA008	100K 1/16W	1	
	R393	D0GB472JA008	4.7K 1/16W	1	
	R394	D0GB473JA008	47K 1/16W	1	

Safety	Ref. No.	Part No.	Part Name & Description	QTY	Remarks
	R406	D0GB682JA008	6.8K 1/16W	1	
	R420	D0GB122JA008	1.2K 1/16W	1	
	R421	D0GB472JA008	4.7K 1/16W	1	
	R422	D0GB682JA008	6.8K 1/16W	1	
	R453	D0GDR00JA017	0 1/10W	1	
	R454	D0GD332JA017	3.3K 1/10W	1	
	R455	D0GD681JA017	680 1/10W	1	
	R456	ERJ6GEYJ104V	100K 1/8W	1	
	R457	D0GD123JA017	12K 1/10W	1	
	R458	ERJ6GEYJ273V	27K 1/8W	1	
	R460	ERJ6GEYJ104V	100K 1/8W	1	
	R461	D0GD820JA017	82 1/10W	1	
	R462	D0GD820JA017	82 1/10W	1	
	R463	D0GD392JA017	3.9K 1/10W	1	
	R464	D0GDR00JA017	0 1/10W	1	
	R467	D0GDR00JA017	0 1/10W	1	
	R512	D0GBR00JA008	0 1/16W	1	
	R518	D0GB122JA008	1.2K 1/16W	1	
	R519	D0GB101JA008	100 1/16W	1	
	R525	D0GD823JA017	82K 1/8W	1	
	R526	D0GD272JA017	2.7K 1/8W	1	
	R527	ERJ6GEYJ273V	27K 1/8W	1	
	R551	D0GBR00JA008	0 1/16W	1	
	R552	D0GB334JA008	330K 1/16W	1	
	R553	D0GB472JA008	4.7K 1/16W	1	
	R554	D0GB103JA008	10K 1/16W	1	
	R557	D0GB562JA008	5.6K 1/16W	1	
	R558	D0GB103JA008	10K 1/16W	1	
	R559	D0AF270JA039	27 1/2W	1	
	R560	D0GB563JA008	56K 1/16W	1	
	R561	D0GB101JA008	100 1/16W	1	
	R562	D0GB224JA008	220K 1/16W	1	
	R563	D0GB824JA008	820K 1/16W	1	
	R564	D0GB563JA008	56K 1/16W	1	
	R566	D0GB683JA008	68K 1/16W	1	
	R567	D0GB561JA008	560 1/16W	1	
	R568	D0GB473JA008	47K 1/16W	1	
	R569	D0GB273JA008	27K 1/16W	1	
	R584	D0GB104JA008	100K 1/16W	1	
	R585	D0GB472JA008	4.7K 1/16W	1	
	R586	D0GB473JA008	47K 1/16W	1	
	R801	D0GBR00JA008	0 1/16W	1	
	R802	D0GB224JA008	220K 1/16W	1	
	R803	D0GB102JA008	1K 1/16W	1	
	R805	D0GB472JA008	4.7K 1/16W	1	
	R807	D0GB101JA008	100 1/16W	1	
	R808	D0GB101JA008	100 1/16W	1	
	R809	D0GB101JA008	100 1/16W	1	
	R810	D0GB562JA008	5.6K 1/16W	1	
	R811	D0GB562JA008	5.6K 1/16W	1	
	R812	D0GB102JA008	1K 1/16W	1	
	R813	D0GB472JA008	4.7K 1/16W	1	
	R814	D0GB104JA008	100K 1/16W	1	
	R818	D0GB103JA008	10K 1/16W	1	
	R819	D0GB102JA008	1K 1/16W	1	
	R820	D0GB103JA008	10K 1/16W	1	
	R821	D0GB102JA008	1K 1/16W	1	
	R822	D0GB102JA008	1K 1/16W	1	
	R823	D0GB102JA008	1K 1/16W	1	
	R824	D0GB102JA008	1K 1/16W	1	
	R826	D0GB104JA008	100K 1/16W	1	
	R827	D0GB102JA008	1K 1/16W	1	
	R828	D0GB101JA008	100 1/16W	1	
	R829	D0GB101JA008	100 1/16W	1	
	R830	D0GB101JA008	100 1/16W	1	
	R831	D0GB102JA008	1K 1/16W	1	
	R832	D0GB104JA008	100K 1/16W	1	
	R833	D0GB101JA008	100 1/16W	1	
	R834	D0GB102JA008	1K 1/16W	1	
	R835	D0GB102JA008	1K 1/16W	1	
	R836	D0GB103JA008	10K 1/16W	1	
	R837	D0GB103JA008	10K 1/16W	1	
	R838	D0GB103JA008	10K 1/16W	1	

Safety	Ref. No.	Part No.	Part Name & Description	QTY	Remarks
	R839	D0GB223JA008	22K 1/16W	1	
	R840	D0GB223JA008	22K 1/16W	1	
	R845	D0GB472JA008	4.7K 1/16W	1	
	R846	D0GB472JA008	4.7K 1/16W	1	
	R849	D0GB102JA008	1K 1/16W	1	
	R850	D0GB104JA008	100K 1/16W	1	
	R851	D0GB101JA008	100 1/16W	1	
	R852	D0GB101JA008	100 1/16W	1	
	R853	D0GB101JA008	100 1/16W	1	
	R854	D0GB101JA008	100 1/16W	1	
	R855	D0GB101JA008	100 1/16W	1	
	R856	D0GB564JA008	560K 1/16W	1	
	R857	D0GB102JA008	1K 1/16W	1	
	R858	D0GB474JA008	470K 1/16W	1	
	R860	D0GB102JA008	1K 1/16W	1	
	R861	D0GB102JA008	1K 1/16W	1	
	R863	D0GB102JA008	1K 1/16W	1	
	R867	D0GB101JA008	100 1/16W	1	
	R870	D0GB101JA008	100 1/16W	1	
	R871	D0GB102JA008	1K 1/16W	1	
	R872	D0GB472JA008	4.7K 1/16W	1	
	R873	D0GB473JA008	47K 1/16W	1	
	R874	D0GB682JA008	6.8K 1/16W	1	
	R875	D0GB103JA008	10K 1/16W	1	
	R876	D0GB823JA008	82K 1/16W	1	
	R877	D0GB103JA008	10K 1/16W	1	
	R880	D0GB101JA008	100 1/16W	1	
	R881	D0GB334JA008	330K 1/16W	1	
	R882	D0GB224JA008	220K 1/16W	1	
	R883	D0GB101JA008	100 1/16W	1	
	R884	D0GB101JA008	100 1/16W	1	
	R885	D0GB104JA008	100K 1/16W	1	
	R886	D0GB104JA008	100K 1/16W	1	
	R887	D0GB101JA008	100 1/16W	1	
	R888	D0GB104JA008	100K 1/16W	1	
	R889	D0GB123JA008	12K 1/16W	1	
	R895	D0GB122JA008	1.2K 1/16W	1	
	R896	D0GB151JA008	150 1/16W	1	
	R897	D0GB472JA008	4.7K 1/16W	1	
	R898	D0GB103JA008	10K 1/16W	1	
	R899	D0GB103JA008	10K 1/16W	1	
	R901	D0GB101JA008	100 1/16W	1	
	R910	D0GB331JA008	330 1/16W	1	
	R911	D0GB122JA008	1.2K 1/16W	1	
	R912	D0GB152JA008	1.5K 1/16W	1	
	R913	D0GB222JA008	2.2K 1/16W	1	
	R914	D0GB332JA008	3.3K 1/16W	1	
	R915	D0GB472JA008	4.7K 1/16W	1	
	R920	D0GB470JA008	47 1/16W	1	
	R921	D0GB122JA008	1.2K 1/16W	1	
	R922	D0GB152JA008	1.5K 1/16W	1	
	R923	D0GB222JA008	2.2K 1/16W	1	
	R924	D0GB332JA008	3.3K 1/16W	1	
	R925	D0GB472JA008	4.7K 1/16W	1	
	R926	D0GB682JA008	6.8K 1/16W	1	
	R927	D0GB123JA008	12K 1/16W	1	
	R949	D0GB471JA008	470 1/16W	1	
	R950	D0GB471JA008	470 1/16W	1	
	R951	D0GBR00JA008	0 1/16W	1	
	R952	D0GBR00JA008	0 1/16W	1	
	R953	D0GB101JA008	100 1/16W	1	
	R955	D0GB101JA008	100 1/16W	1	
	R957	D0GB104JA008	100K 1/16W	1	
	R958	D0GB101JA008	100 1/16W	1	
	R964	D0GB102JA008	1K 1/16W	1	
	R1000	D0GB472JA008	4.7K 1/16W	1	
	R1001	D0GB473JA008	47K 1/16W	1	
	R1001	D0GA221JA023	220 1/16W	1	
	R1002	D0GB470JA008	47 1/16W	1	
	R1002	D0GA221JA023	220 1/16W	1	
	R1003	D0GA104JA023	100K 1/16W	1	
	R1003	D0GBR00JA008	0 1/16W	1	
	R1004	D0GA104JA023	100K 1/16W	1	

Safety	Ref. No.	Part No.	Part Name & Description	QTY	Remarks
	R1005	D0GA753Z0001	75K 1/10W	1	
	R1006	D0GA753Z0001	75K 1/10W	1	
	R1007	D0GA513Z0002	51K 1/10W	1	
	R1008	D0GA513Z0002	51K 1/10W	1	
	R1009	ERJ2GEJ151X	150 1/16W	1	
	R1010	ERJ2GEJ151X	150 1/16W	1	
	R1011	J0JFC0000006	INDUCTOR	1	
	R1012	D0GBR00JA008	0 1/16W	1	
	R1013	D0GA102JA023	1K 1/16W	1	
	R1014	ERJ2GEOR00X	0 1/16W	1	
	R1015	D0GBR00JA008	0 1/16W	1	
	R1025	D0GB2R7JA008	2.7 1/16W	1	
	R1026	D0GB2R7JA008	2.7 1/16W	1	
	R2827	D0GB104JA008	100K 1/16W	1	
	R2828	D0GB104JA008	100K 1/16W	1	
	R2829	D0GB104JA008	100K 1/16W	1	
	R2830	D0GB104JA008	100K 1/16W	1	
	R2831	D0GB104JA008	100K 1/16W	1	
	R2832	D0GB103JA008	10K 1/16W	1	
	R2833	D0GB103JA008	10K 1/16W	1	
	R2834	D0GB104JA008	100K 1/16W	1	
	R2835	D0GB103JA008	10K 1/16W	1	
	R2836	D0GB101JA008	100 1/16W	1	
	R2837	D0GB103JA008	10K 1/16W	1	
	R2838	D0GB472JA008	4.7K 1/16W	1	
	R2839	D0GB104JA008	100K 1/16W	1	
	R2840	D0GB103JA008	10K 1/16W	1	
	R2841	D0GB682JA008	6.8K 1/16W	1	
	R2842	D0GB122JA008	1.2K 1/16W	1	
	R2843	D0GB102JA008	1K 1/16W	1	
	R2910	D0GD473JA017	47K 1/8W	1	
	R2911	D0GD102JA017	1K 1/10W	1	
	R2912	D0GDR00JA017	0 1/10W	1	
	R2913	D0GD822JA017	8.2K 1/10W	1	
	R5600	D0GD101JA017	100 1/10W	1	
	R5601	D0GD152JA017	1.5K 1/10W	1	
	R5603	D0GD102JA017	1K 1/10W	1	
	R5606	D0GB153JA008	15K 1/16W	1	
	R5607	D0GD152JA017	1.5K 1/10W	1	
	R5608	ERG2SJ680P	68 2W	1	
	R5609	ERG2SJ680P	68 2W	1	
	R5700	ERJ8GEYJ105V	1M 1/4W	1	
	R5701	ERJ8GEYJ224V	220K 1/4W	1	
	R5702	ERJ8GEYJ683V	68K 1/4W	1	
	R5703	ERJ8GEYJ683V	68K 1/4W	1	
	R5704	ERJ8GEYJ683V	68K 1/4W	1	
	R5705	ERJ8GEYJ683V	68K 1/4W	1	
	R5710	ERJ8GEYJ105V	1M 1/4W	1	
	R5720	D0GF121JA017	120 1/4W	1	
	R5722	D0GD272JA017	2.7K 1/8W	1	
	R5723	ERJ8GEYJ153V	15K 1/4W	1	
	R5724	ERJ8GEYJ183V	18K 1/4W	1	
	R5725	D0GD272JA017	2.7K 1/8W	1	
	R5726	ERX2SJR33P	33 2W	1	
	R5728	D0GF121JA017	120 1/4W	1	
	R5730	D0GD102JA017	1K 1/10W	1	
	R5732	D0GB101JA008	100 1/16W	1	
	R5786	ERJ1TYJ104U	100K 1/2W	1	
	R5795	D0GD474JA017	470K 1/8W	1	
	R5798	D0GB220JA008	22 1/16W	1	
	R5800	D0GD272JA017	2.7K 1/8W	1	
	R5801	D0GDR00JA017	0 1/10W	1	
	R5802	D0GD392JA017	3.9K 1/10W	1	
	R5803	D0GD123JA017	12K 1/10W	1	
	R5806	D0GD103JA017	10K 1/10W	1	
	R5807	D0GD122JA017	1.2K 1/10W	1	
	R5808	D0GD102JA017	1K 1/10W	1	
	R5842	D0GD681JA017	680 1/10W	1	
	R5898	D0GD472JA017	4.7K 1/10W	1	
	R5899	D0GD473JA017	47K 1/8W	1	
	R6804	D0GB104JA008	100K 1/16W	1	
	R6805	D0GB103JA008	10K 1/16W	1	
	R6806	D0GB102JA008	1K 1/16W	1	

Safety	Ref. No.	Part No.	Part Name & Description	QTY	Remarks
	R6807	D0GB102JA008	1K 1/16W	1	
	R6808	D0GB102JA008	1K 1/16W	1	
	R7110	D0GBR00JA008	0 1/16W	1	
	R7111	D0GB103JA008	10K 1/16W	1	
	R7211	D0GB823JA008	82K 1/16W	1	
	R7212	D0GB821JA008	820 1/16W	1	
	R7214	D0GB471JA008	470 1/16W	1	
	R7217	D0GB102JA008	1K 1/16W	1	
	R7218	D0GB102JA008	1K 1/16W	1	
	R7220	D0GB105JA008	1M 1/16W	1	
	R7221	D0GB101JA008	100 1/16W	1	
	R7253	D0GB100JA008	10 1/16W	1	
	R7254	D0GB102JA008	1K 1/16W	1	
	R7315	D0GB332JA008	3.3K 1/16W	1	
	R7323	D0GB332JA008	3.3K 1/16W	1	
	R7325	D0GB331JA008	330 1/16W	1	
	R7327	D0GB102JA008	1K 1/16W	1	
	R7328	D0GB103JA008	10K 1/16W	1	
	R7329	D0GB102JA008	1K 1/16W	1	
	R7330	D0GB562JA008	5.6K 1/16W	1	
	R7331	D0GB223JA008	22K 1/16W	1	
	R7332	D0GB102JA008	1K 1/16W	1	
	R7335	D0GB101JA008	100 1/16W	1	
	R7336	D0GB100JA008	10 1/16W	1	
	R7339	D0GB102JA008	1K 1/16W	1	
	R7349	D0GB183JA008	18K 1/16W	1	
	R7401	D0GBR00JA008	0 1/16W	1	
	R7601	D0GB4R7JA008	4.7 1/16W	1	
	R7650	D0GB5R6JA008	5.6 1/16W	1	
			CAPACITORS		
	C1	F1K1C1060001	10uF 16V	1	
	C2	F1H1H104A783	0.1uF 50V	1	
	C3	F1H1H104A783	0.1uF 50V	1	
	C4	F1H1C105A118	1uF 16V	1	
	C5	F2A1V330A379	33uF 35V	1	
	C6	F1H1H104A783	0.1uF 50V	1	
	C7	F1J1E105A171	1uF 25V	1	
	C8	F1J1E105A171	1uF 25V	1	
	C9	F2A1V330A379	33uF 35V	1	
	C10	F2A1V330A379	33uF 35V	1	
	C11	F1K1H105A138	1uF 50V	1	
	C12	F1K1H105A138	1uF 50V	1	
	C13	ECQV1H104JL3	0.1uF 50V	1	
	C16	ECQV1H104JL3	0.1uF 50V	1	
	C17	F1K1H105A138	1uF 50V	1	
	C18	F1K1H105A138	1uF 50V	1	
	C21	F1J1E105A171	1uF 25V	1	
	C22	F1J1E105A171	1uF 25V	1	
	C23	F1K1E335A029	3.3uF 25V	1	
	C25	ECQV1H104JL3	0.1uF 50V	1	
	C26	ECQV1H104JL3	0.1uF 50V	1	
	C28	ECQV1H334JL3	0.33uF 50V	1	
	C29	ECQV1H334JL3	0.33uF 50V	1	
	C30	F1H1H561A013	560pF 50V	1	
	C31	F1H1H561A013	560pF 50V	1	
	C34	F1J1E4750002	4.7uF 25V	1	
	C35	F1J1E4750002	4.7uF 25V	1	
	C38	F1H1E334A068	0.33uF 25V	1	
	C39	F1H1E334A068	0.33uF 25V	1	
	C40	F1H1H102A219	1000pF 50V	1	
	C41	F1H1C224A074	0.22uF 16V	1	
	C44	F1H1H103A219	0.01uF 50V	1	
	C45	F1H1H103A219	0.01uF 50V	1	
	C51	F1H1H102A219	1000pF 50V	1	
	C52	F1H1A474A025	0.47uF 10V	1	
	C53	F1H1H103A219	0.01uF 50V	1	
	C54	F1H1H103A219	0.01uF 50V	1	
	C55	F1H1H103A219	0.01uF 50V	1	
	C56	F1H1H103A219	0.01uF 50V	1	
	C57	F1H1H120A230	12pF 50V	1	
	C58	F1H1H120A230	12pF 50V	1	

Safety	Ref. No.	Part No.	Part Name & Description	QTY	Remarks
	C59	F1H1A105A025	1uF 10V	1	
	C60	F1H1A105A025	1uF 10V	1	
	C61	F1G1C104A077	0.1uF 16V	1	
	C62	F1G1C104A077	0.1uF 16V	1	
	C102	F1H1H103A219	0.01uF 50V	1	
	C103	F3F0J4760004	47uF 6.3V	1	
	C104	F1H1C823A001	0.083uF 16V	1	
	C105	F1H1C823A001	0.083uF 16V	1	
	C107	D0GDR00JA017	0 1/10W	1	
	C108	F1H1E474A068	0.47uF 25V	1	
	C114	F3H1C107A068	100uF 16V	1	
	C115	F1H1H331A792	330pF 50V	1	
	C116	F1H1H331A792	330pF 50V	1	
	C117	F1H1H103A219	0.01uF 50V	1	
	C118	F3H1C107A068	100uF 16V	1	
	C122	F2A1H4R7A234	4.7uF 50V	1	
	C204	F1H1A105A004	1uF 10V	1	
	C206	F1H1A5640001	0.56uF 10V	1	
	C207	F1H1H221A748	220pF 50V	1	
	C208	F1H1A105A004	1uF 10V	1	
	C212	F1H1A105A004	1uF 10V	1	
	C213	F1H0J106A009	10uF 6.3V	1	
	C214	F1H1A105A004	1uF 10V	1	
	C219	F1H1C224A074	0.22uF 16V	1	
	C220	F1H1E334A068	0.33uF 25V	1	
	C221	F1H1H332A013	3300pF 50V	1	
	C222	F1H1H103A219	0.01uF 50V	1	
	C223	F1H1H103A219	0.01uF 50V	1	
	C224	F1H1C104A042	0.1uF 50V	1	
	C225	F1H1C154A002	0.15uF 16V	1	
	C226	F1H1H332A013	3300pF 50V	1	
	C230	F1H1A105A004	1uF 10V	1	
	C231	F1H1A105A004	1uF 10V	1	
	C232	F1H1A105A004	1uF 10V	1	
	C241	F1J0J475A008	4.7uF 6.3V	1	
	C255	F1H1C105A118	1uF 16V	1	
	C256	F1H1H393A962	0.039uF 50V	1	
	C257	F1H1H223A219	0.022uF 50V	1	
	C258	F1H1A105A004	1uF 10V	1	
	C259	F1H1H101A230	100pF 50V	1	
	C260	F1H1H560A230	56pF 50V	1	
	C262	F1H1C224A074	0.22uF 16V	1	
	C263	F1K1A1060017	10uF 10V	1	
	C264	F1H1E474A068	0.47uF 25V	1	
	C265	F1H1H103A219	0.01uF 50V	1	
	C266	F1J1A475A039	4.7uF 10V	1	
	C301	F1H1H102A219	1000pF 50V	1	
	C302	F1H1H101A230	100pF 50V	1	
	C303	F1H1H102A219	1000pF 50V	1	
	C304	F1H1H102A219	1000pF 50V	1	
	C305	F1H1A105A004	1uF 10V	1	
	C306	F1H1C104A042	0.1uF 16V	1	
	C350	F1H1H103A219	0.01uF 50V	1	
	C404	F1H1A105A004	1uF 10V	1	
	C406	F1H1A5640001	0.56uF 10V	1	
	C407	F1H1H221A748	220pF 50V	1	
	C408	F1H1A105A004	1uF 10V	1	
	C412	F1H1A105A004	1uF 10V	1	
	C419	F1H1C224A074	0.22uF 16V	1	
	C420	F1H1E334A068	0.33uF 25V	1	
	C421	F1H1H332A013	3300pF 50V	1	
	C422	F1H1H103A219	0.01uF 50V	1	
	C423	F1H1H103A219	0.01uF 50V	1	
	C424	F1H1C104A042	0.1uF 16V	1	
	C425	F1H1C154A002	0.15uF 16V	1	
	C441	F1J0J475A008	4.7uF 6.3V	1	
	C455	F1H1C105A118	1uF 16V	1	
	C456	F1H1H393A962	0.039uF 50V	1	
	C457	F1H1H223A219	0.022uF 50V	1	
	C458	F1H1A105A004	1uF 10V	1	
	C459	F1H1H101A230	100pF 50V	1	
	C460	F1H1H560A230	56pF 50V	1	
	C462	F1H1C224A074	0.22uF 16V	1	

Safety	Ref. No.	Part No.	Part Name & Description	QTY	Remarks
	C463	F1K1A1060017	10uF 10V	1	
	C464	F1H1E474A068	0.47uF 25V	1	
	C465	F1H1H103A219	0.01uF 50V	1	
	C466	F1J1A475A039	4.7uF 10V	1	
	C502	F2A1C1020067	1000uF 16V	1	
	C507	F1H1E474A068	0.47uF 25V	1	
	C509	F1H1E474A068	0.47uF 25V	1	
	C510	F1K1H105A138	1uF 50V	1	
	C511	F2A0J101A245	100uF 6.3V	1	
	C513	F1K1A1060017	10uF 10V	1	
	C515	F2A1C100A234	10uF 16V	1	
	C516	F1H1C105A118	1uF 16V	1	
	C521	F2A1A470A204	47uF 10V	1	
	C522	F1H1H102A219	1000pF 50V	1	
	C523	F1H1H102A219	1000pF 50V	1	
	C524	F2A1A470A204	47uF 10V	1	
	C526	F2A1C100A234	10uF 16V	1	
	C552	F2A1H4R7A234	4.7uF 50V	1	
	C553	F2A1C470A016	47uF 16V	1	
	C555	F1H1C104A042	0.1uF 16V	1	
	C556	F2A0J221A211	220uF 6.3V	1	
	C557	F2A0J101A245	100uF 6.3V	1	
	C558	D0GBR00JA008	0 1/16W	1	
	C559	F1K1A1060017	10uF 10V	1	
	C560	F1H1C105A118	1uF 16V	1	
	C650	F2A0J221A211	220uF 6.3V	1	
	C805	F1H1H220A004	22pF 50V	1	
	C806	F1H1H220A004	22pF 50V	1	
	C807	F1H1H102A219	1000pF 50V	1	
	C808	F1H1C104A042	0.1uF 16V	1	
	C810	F1H1H221A748	220pF 50V	1	
	C812	F1H1H221A748	220pF 50V	1	
	C813	F1H1H102A219	1000pF 50V	1	
	C814	F1H1H102A219	1000pF 50V	1	
	C815	F1H1H681A013	680pF 50V	1	
	C816	F1H1H681A013	680pF 50V	1	
	C817	F1H1H102A219	1000pF 50V	1	
	C820	F1H1C104A042	0.1uF 16V	1	
	C821	F1H1H101A230	100pF 50V	1	
	C825	F1H1A105A004	1uF 10V	1	
	C827	F1K1C1060001	10uF 16V	1	
	C828	F1K1A1060017	10uF 10V	1	
	C830	F1H1H331A219	330pF 50V	1	
	C831	F1H1H331A219	330pF 50V	1	
	C832	F1H1H331A219	330pF 50V	1	
	C833	F1H1H223A219	0.022uF 50V	1	
	C853	F1K1A1060017	10uF 10V	1	
	C871	F1H1H102A219	1000pF 50V	1	
	C872	F1H1H102A219	1000pF 50V	1	
	C873	F1H1H102A219	1000pF 50V	1	
	C874	F1H1H102A219	1000pF 50V	1	
	C875	F1H1H102A219	1000pF 50V	1	
	C876	F1H1H102A219	1000pF 50V	1	
	C896	F1H1H104A783	0.1uF 50V	1	
	C922	F1H1H102A219	1000pF 50V	1	
	C951	F1H1H473A748	0.047uF 50V	1	
	C952	F1H1H473A748	0.047uF 50V	1	
	C953	F1H1H472A013	4700pF 50V	1	
	C954	F1H1C104A042	0.1uF 16V	1	
	C955	F1H1H472A013	4700pF 50V	1	
	C956	F1H1C104A042	0.1uF 16V	1	
	C1000	F2A1C330A234	33uF 16V	1	
	C1001	F1H1H392A013	3900pF 50V	1	
	C1002	F2A1V330A379	33uF 35V	1	
	C1002	F1G1C104A083	0.1uF 16V	1	
	C1003	F2A1C101A155	100uF 16V	1	
	C1003	F1G1C104A083	0.1uF 16V	1	
	C1004	F1G1C104A083	0.1uF 16V	1	
	C2808	F1H1A105A025	1uF 10V	1	
	C2821	F1H1A105A025	1uF 10V	1	
	C2822	F1H0J106A009	10uF 6.3V	1	
	C2823	F1H1H470A004	47pF 50V	1	
	C2824	F1H1H470A004	47pF 50V	1	

Safety	Ref. No.	Part No.	Part Name & Description	QTY	Remarks
	C2825	F1H1A105A025	1uF 10V	1	
	C2826	F1H1H104A083	0.1uF 50V	1	
	C2827	F1H1H104A083	0.1uF 50V	1	
	C2828	F1J1H104A459	0.1uF 50V	1	
	C2911	F1H1H103A219	0.01uF 50V	1	
	C2913	F2A1C681B473	680uF 16V	1	
	C2914	F1H1H103A219	0.01uF 50V	1	
	C5600	F1H1E105A116	1uF 25V	1	
△	C5700	F1BAF1020020	1000pF	1	
△	C5701	ECQU2A334MLA	0.33uF 250Vac	1	
△	C5702	ECQU2A104MLC	0.1uF 250Vac	1	
△	C5706	F1BAF1020020	1000pF	1	
△	C5708	F1BAF1020020	1000pF	1	
△	C5709	F1BAF1020020	1000pF	1	
	C5712	F2A2G1010016	100uF 400V	1	
△	C5713	ECQE6103KF	0.01uF 630V	1	
	C5721	F1H1H2210001	220pF 50V	1	
	C5722	F1H1H472A219	4700pF 50V	1	
	C5723	F1H1H471A219	470pF 50V	1	
	C5725	F1H1H223A219	0.022uF 50V	1	
	C5726	F2A1V220A184	22uF 35V	1	
	C5727	F1H1H472A219	4700pF 50V	1	
	C5728	F1H1H223A219	0.022uF 50V	1	
	C5730	F2A1H1R0A234	1.0uF 50V	1	
	C5737	ECKE3D821KBP	820pF 2000V	1	
	C5790	F1K2J2220002	2200pF 630V	1	
	C5795	F1H1H102A219	1000pF 50V	1	
	C5796	F1J1H104A717	0.1uF 50V	1	
	C5798	F2A1H220A234	22uF 50V	1	
	C5799	F2B2G1000001	10uF 400V	1	
	C5800	D0GDR00JA017	0 1/10W	1	
	C5808	F2A1E1020049	1000uF 25V	1	
	C5818	F1H1H104A013	0.1uF 50V	1	
	C5838	F1J2E1030004	0.01uF 250V	1	
	C5839	F1J2E1030004	0.01uF 250V	1	
	C5843	F1J0J106A014	10uF 6.3V	1	
	C5899	F2A1A102A206	1000uF 10V	1	
	C6801	F2A1V220A184	22uF 35V	1	
	C6805	F1H1H102A219	1000pF 50V	1	
	C6806	F1H1H102A219	1000pF 50V	1	
	C6807	F1H1H102A219	1000pF 50V	1	
	C6808	F1H1H102A219	1000pF 50V	1	
	C6809	F1H1H102A219	1000pF 50V	1	
	C6810	F1H1H102A219	1000pF 50V	1	
	C6811	F1H1H102A219	1000pF 50V	1	
	C6814	F1H1H102A219	1000pF 50V	1	
	C6815	F1H1H102A219	1000pF 50V	1	
	C6816	F1H1H102A219	1000pF 50V	1	
	C6819	F1H1H102A219	1000pF 50V	1	
	C6820	F1H1E474A068	0.47uF 25V	1	
	C6821	F1H1H221A748	220pF 50V	1	
	C6822	F1H1H221A748	220pF 50V	1	
	C6823	F1H1H221A748	220pF 50V	1	
	C6824	F1H1E474A068	0.47uF 25V	1	
	C6825	ECA1AAK220XB	22uF 10V	1	
	C6826	F2A1V220A184	22uF 35V	1	
	C6827	F1H1H104A783	0.1uF 50V	1	
	C6828	F2A1V220A184	22uF 35V	1	
	C6829	F2A1V220A184	22uF 35V	1	
	C7102	F1H1A474A025	0.47uF 10V	1	
	C7107	F1H1H223A219	0.022uF 50V	1	
	C7142	F1H1H332A013	3300pF 50V	1	
	C7154	F1H1C104A042	0.1uF 16V	1	
	C7155	F1H1C104A042	0.1uF 16V	1	
	C7161	F1H1C104A042	0.1uF 16V	1	
	C7164	F1J1A106A076	10uF 10V	1	
	C7165	F1J1A106A076	10uF 10V	1	
	C7166	F1H1H103A219	0.01uF 50V	1	
	C7203	F2A0J221A200	220uF 6.3V	1	
	C7204	F1H1C104A042	0.1uF 16V	1	
	C7216	F1H1H681A013	680pF 50V	1	
	C7217	F1H1C104A042	0.1uF 16V	1	

Safety	Ref. No.	Part No.	Part Name & Description	QTY	Remarks
	C7218	F1H1C823A001	0.082uF 16V	1	
	C7221	F1H1H150A971	15pF 50V	1	
	C7222	F1H1H150A971	15pF 50V	1	
	C7223	F2A1H4R70037	4.7uF 50V	1	
	C7225	F1H1H102A219	1000pF 50V	1	
	C7226	F1H1H102A219	1000pF 50V	1	
	C7227	ECA1HAK010XI	1uF 50V	1	
	C7228	ECA1HAK010XI	1uF 50V	1	
	C7230	F1H1C104A042	0.1uF 16V	1	
	C7231	F2A0J221A200	220uF 6.3V	1	
	C7232	F2A0J221A200	220uF 6.3V	1	
	C7233	F1H1C104A008	0.1uF 16V	1	
	C7234	F1H1C104A042	0.1uF 16V	1	
	C7235	F2A1C100A133	10uF 16V	1	
	C7241	F1H1H102A219	1000pF 50V	1	
	C7243	F1H1C104A008	0.1uF 16V	1	
	C7244	F1H1C153A001	0.015uF 16V	1	
	C7253	F1H1H471A219	470pF 50V	1	
	C7263	F1H1C104A042	0.1uF 16V	1	
	C7264	F1H1C104A042	0.1uF 16V	1	
	C7315	F1H1A474A025	0.47uF 10V	1	
	C7334	ECEA1AKA221I	220uF 10V	1	
	C7335	F1H1C104A008	0.1uF 16V	1	
	C7338	F1H1C563A055	0.056uF 16V	1	
	C7339	F1H1C183A001	0.018uF 16V	1	
	C7352	F1H1C183A001	0.018uF 16V	1	
	C7401	F1H1C104A042	0.1uF 16V	1	
	C7402	F1H1C104A042	0.1uF 16V	1	
	C7601	ECEA0JKA330I	33uF 6.3V	1	
	C7613	F1H1C104A042	0.1uF 16V	1	
	C7614	F2A0J101A198	100uF 6.3V	1	
	C7626	F1H1C104A042	0.1uF 16V	1	
	C7670	F1H1C104A042	0.1uF 16V	1	

FLE1002