

2-1. EXPLODED VIEWS

2-1-1. TOP/LCD SECTION

ns: not supplied

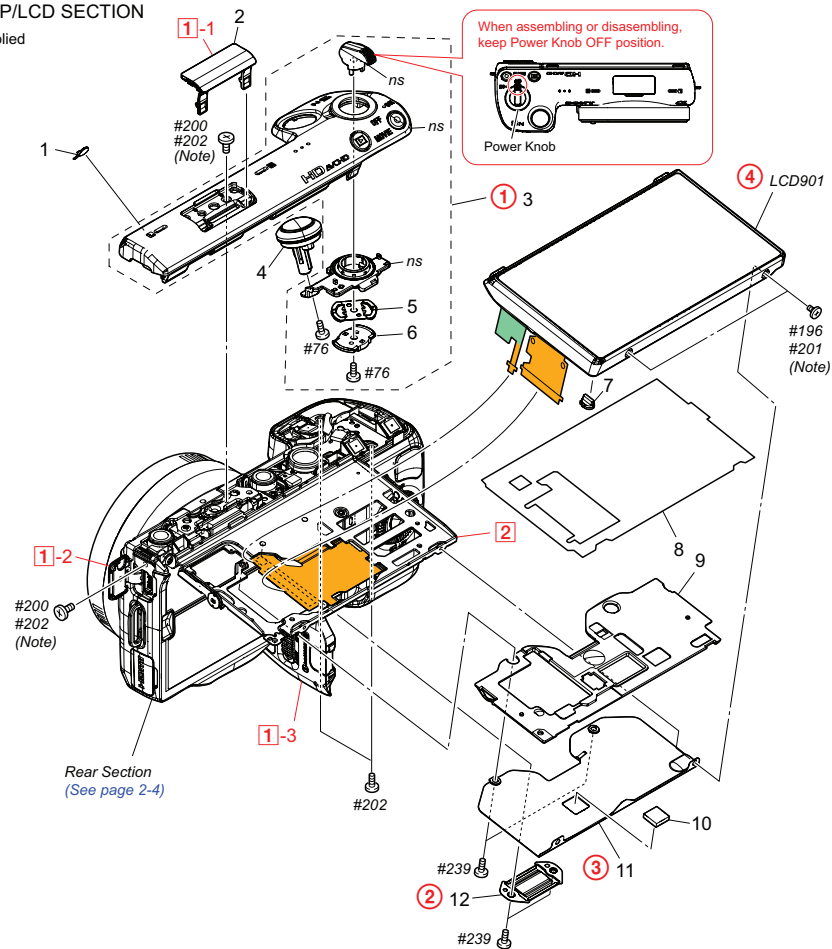

Ref. No.	Part No.	Description
1	4-186-543-01	PLATE, LOGO (BLACK)
1	4-186-543-11	PLATE, LOGO (SILVER)
1	4-186-543-71	PLATE, LOGO (WHITE)
2	4-292-147-01	COVER, SHOE (BLACK)
2	4-292-147-11	COVER, SHOE (SILVER)
2	4-292-147-21	COVER, SHOE (WHITE)
3	A-1836-739-A	CABINET (TOP) BLOCK ASSY (BLACK)
3	A-1836-741-A	(TOP) BLOCK ASSY (SILVER) (SILVER)
3	A-1836-743-A	CABINET (TOP) BLOCK ASSY (WHITE) (WHITE)
4	A-1845-453-A	BUTTON BLOCK ASSY (SERVICE),RL
* 5	4-186-537-01	SPRING, PW KNOB
* 6	4-186-524-01	RETAINER, PW KNOB
* 7	4-186-555-01	LIGHT (LC), GUIDE
8	4-292-167-01	SHEET, LC LIGHT INTERCEPTION
9	4-292-144-01	CABINET (REAR), LC

Ref. No.	Part No.	Description
10	1-471-591-11	MAGNET (ND5.4X5.4X1.4)
11	4-292-134-01	PLATE, LC CABINET (REAR)
12	4-292-148-01	RETAINER, LC FLEXIBLE
LCD901	A-1845-450-A	BLOCK ASSY (BLACK) (SERVICE) (BLACK)
LCD901	A-1845-451-A	BLOCK ASSY (SILVER) (SERVICE) (SILVER)
LCD901	A-1845-452-A	BLOCK ASSY (WHITE) (SERVICE) (WHITE)
#76	2-666-551-11	SCREW, TAPPING, P2
#196	4-178-124-01	SPECIAL (M1.4 (D2.75)) (Note)
#200	4-178-124-11	SPECIAL (M1.4 (D2.75)) (Note)
#201	4-178-124-21	SPECIAL (M1.4 (D2.75)) (Note)
#202	4-178-124-31	SPECIAL (M1.4 (D2.75)) (Note)
#239	4-287-435-11	SCREW (M1.4 EUROPE) TYPE

NEX-5N/5ND/5NK/5NY_L2

DISASSEMBLY

1. Remove to numerical order (① to ④) in the left figure.

① Open the Shoe Cover (①-1) → #200/#202 X 1 → Open the USB Cover (①-2) → #200/#202 X 1 → Open the BT Lid (①-3) → #202 X 2

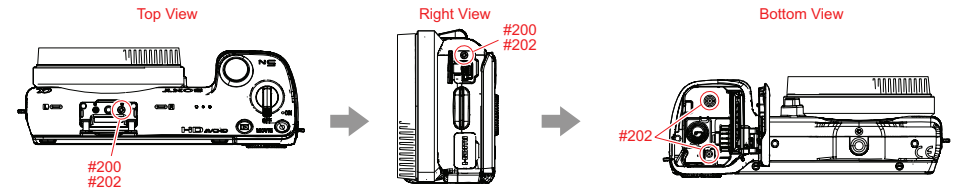

② #239 X 2

③ #239 X 2 → #196/#201 X 2

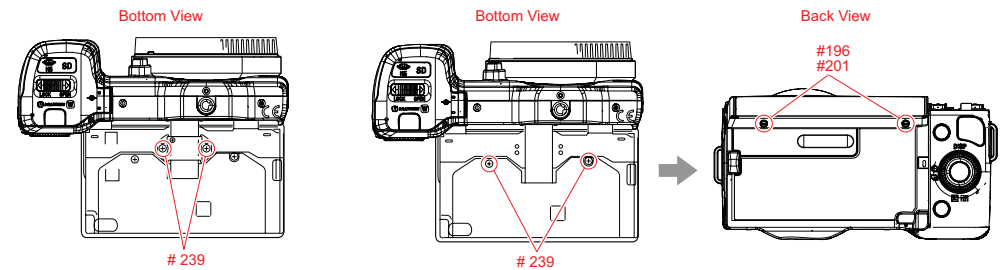

Screw

Part No.	Description	Part No.	Description	Part No.	Description	Part No.	Description	Part No.	Description		
#76: M1.7 X 4.0 (Tapping) (Silver) 2-666-551-11		#196: M1.4 X 2.0 (Black) 4-178-124-01		#200: M1.4 X 3.8 (Black) 4-178-124-11		#201: M1.4 X 2.0 (Silver) 4-178-124-21		#202: M1.4 X 3.8 (Silver) 4-178-124-31		#239: M1.4 X 1.4 (Red) 4-287-435-11	

Note

Note

THE COMBINATION OF CABINET'S COLOR AND SCREW

The screw pointed is different according to the cabinet's color. For the combination of cabinet's color and screw, please refer to Table 2-1.

Table 2-1

Screw's Ref. No. (Parts Color.)	Cabinet's Color
#196/#200 (Black)	BLACK
#201/#202 (Silver)	SILVER/WHITE

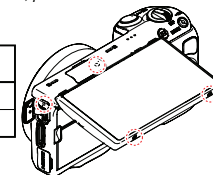

2-1-2. REAR SECTION

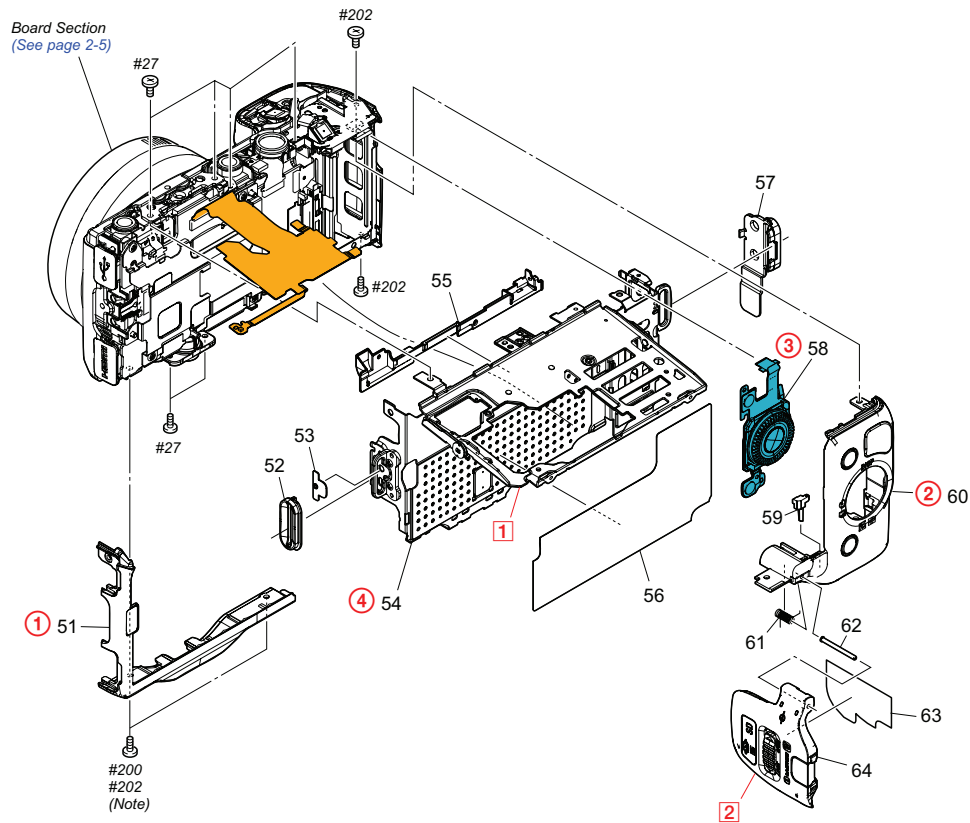

Ref. No.	Part No.	Description
51	4-292-141-01	COVER, SIDE (BLACK)
51	4-292-141-11	COVER, SIDE (SILVER)
51	4-292-141-21	COVER, SIDE (WHITE)
52	4-292-158-01	BASE (L), STRAP (BLACK)
52	4-292-158-11	BASE (L), STRAP (SILVER)
52	4-292-158-21	BASE (L), STRAP (WHITE)
53	X-2581-934-1	PIN ASSY, S LOCK
54	X-2582-228-1	FRAME ASSY
55	4-292-145-01	COVER (REAR), MAIN FRAME
56	4-292-258-01	SHEET (J), FRAME (J)
56	4-292-258-11	SHEET (E), FRAME (EXCEPT J)
57	4-292-149-01	BASE (G), STRAP (BLACK)
57	4-292-149-11	BASE (G), STRAP (SILVER)
57	4-292-149-21	BASE (G), STRAP (WHITE)
58	1-489-775-11	SWITCH BLOCK, CONTROL (BK75500) (BLACK)

Ref. No.	Part No.	Description
58	1-489-775-21	SWITCH BLOCK, CONTROL (BK75500) (SILVER)
58	1-489-775-31	SWITCH BLOCK, CONTROL (BK75500) (WHITE)
59	4-292-133-01	LIGHT (MS), GUIDE
60	X-2582-230-1	PLATE ASSY (BLACK), ORNAMENTAL (BLACK)
60	X-2582-231-1	PLATE ASSY (SILVER), ORNAMENTAL (SILVER)
60	X-2582-232-1	PLATE ASSY (WHITE), ORNAMENTAL (WHITE)
61	4-292-152-01	SPRING, BT LID OPEN
62	4-292-161-01	SHAFT, BT LID
63	4-191-980-01	LABEL, MS
64	X-2582-233-1	LID ASSY (BLACK), BT (BLACK)
64	X-2582-234-1	LID ASSY (SILVER), BT (SILVER)
64	X-2582-235-1	LID ASSY (WHITE), BT (WHITE)
#27	2-662-396-11	SCREW (M1.4), NEW, TRUSTAR, P2
#200	4-178-124-11	SPECIAL (M1.4 (D2.75)) (Note)
#202	4-178-124-31	SPECIAL (M1.4 (D2.75)) (Note)

DISASSEMBLY

1. Remove to numerical order (1 to 4) in the left figure.

① #200/#202 X 2

Bottom view

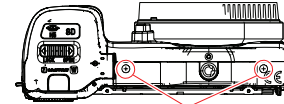

#200
#202

② #202 X 1 → Open the BT Lid (2) → #202 X 1

Top view

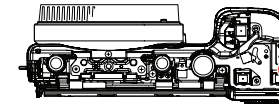

#202 #202

Bottom view

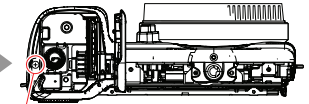

④ #27 X 6

Top view

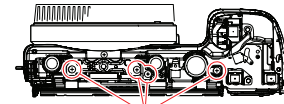

#27

Bottom view

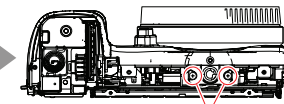

#27

Screw

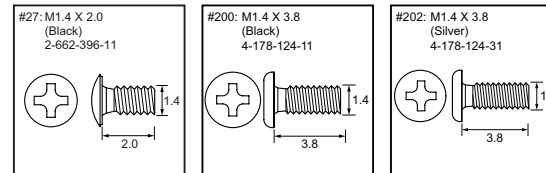

Note

Note

THE COMBINATION OF CABINET'S COLOR AND SCREW

The screw pointed  is different according to the cabinet's color.
For the combination of cabinet's color and screw, please refer to Table 2-1.

Table 2-1

Screw's Ref. No. (Parts Color.)	Cabinet's Color
#200 (Black)	BLACK
#202 (Silver)	SILVER/WHITE



2-1-3. BOARD SECTION

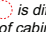
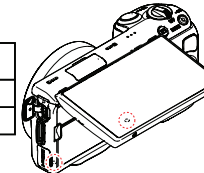
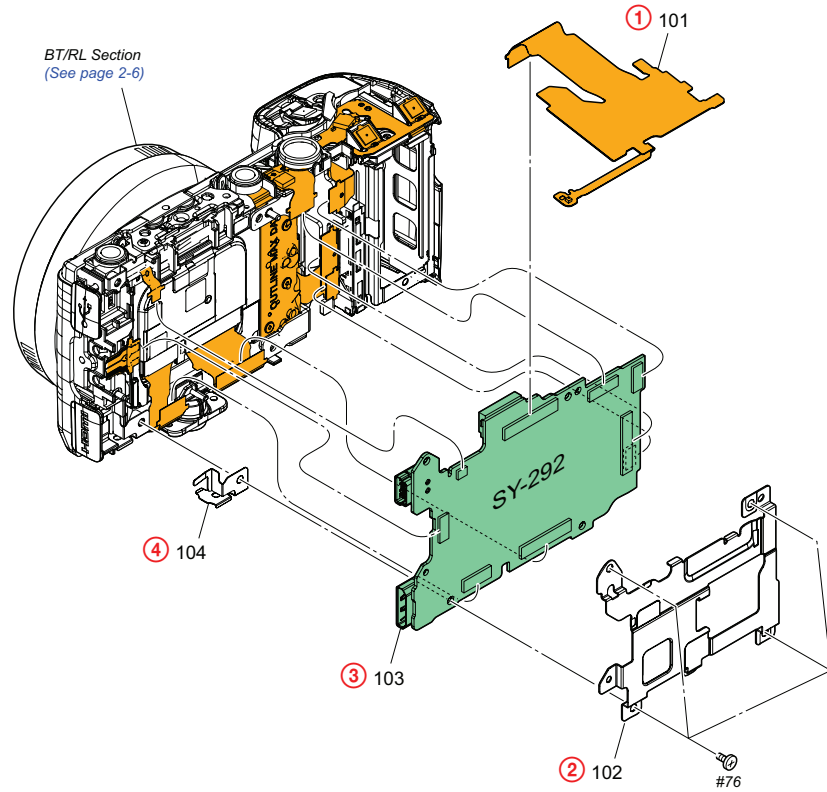

Ref. No.	Part No.	Description
101	A-1833-601-A	LC-097 FLEXIBLE BOARD, COMPLETE
102	4-292-137-01	HEAT SINK (MF)
103	A-1845-449-A	SY-292 BOARD, COMPLETE (SERVICE)
104	4-292-139-01	PLATE, BOTTOM GROUND

Ref. No.	Part No.	Description
#76	2-666-551-11	SCREW, TAPPING, P2

DISASSEMBLY

1. Remove to numerical order (① to ④) in the left figure.

② #76 X 4

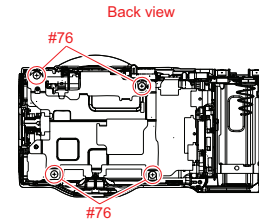

Screw

#76: M1.7 X 4.0 (Tapping)
(Silver)
2-666-551-11

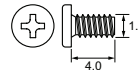

2-1-4. BT/RL SECTION

ns: not supplied

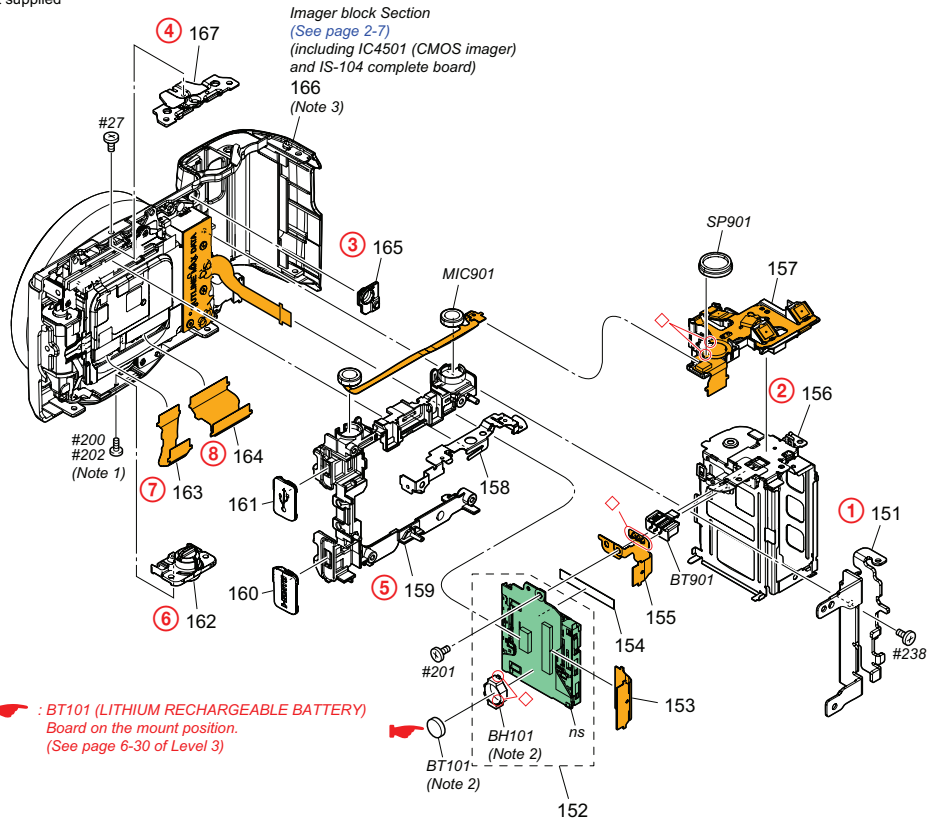

Ref. No.	Part No.	Description
151	4-292-138-01	HEAT SINK, BT LID BASE
152	A-1833-599-A	CN-474 BOARD, COMPLETE
153	1-884-156-11	FP-1451 FLEXIBLE BOARD
154	4-292-163-01	SHEET, MS RADIATION
155	1-884-154-21	BT-074 FLEXIBLE BOARD
156	X-2582-229-1	FRAME ASSY, BT
157	A-1845-454-A	RL-113 FLEXIBLE BOARD, COMPLETE (SERVICE)
158	4-292-140-01	PLATE, TOP GROUND
159	4-292-146-01	BASE, JACK COVER (BLACK)
159	4-292-146-11	BASE, JACK COVER (SILVER)
159	4-292-146-21	BASE, JACK COVER (WHITE)
160	4-186-554-31	COVER, HDMI (WHITE)
160	4-186-554-41	COVER, HDMI (BLACK)
160	4-186-554-51	COVER, HDMI (SILVER)
161	4-186-553-31	COVER, USB (WHITE)
161	4-186-553-41	COVER, USB (BLACK)
161	4-186-553-51	COVER, USB (SILVER)
162	4-292-160-01	SCREW, TRIPOD
163	1-880-963-11	IS-075 FLEXIBLE BOARD
164	1-880-964-11	IS-076 FLEXIBLE BOARD

Ref. No.	Part No.	Description
165	4-292-142-01	WINDOW (AF)
166	A-1842-087-A	(FRONT) BLOCK ASSY (BLACK) SA (BLACK) (including IC4501 (CMOS imager) and IS-104 complete board) (Note 3)
166	A-1842-088-A	(FRONT) BLOCK ASSY (SILVER) SA (SILVER) (including IC4501 (CMOS imager) and IS-104 complete board) (Note 3)
166	A-1842-089-A	(FRONT) BLOCK ASSY (WHITE) SA (WHITE) (including IC4501 (CMOS imager) and IS-104 complete board) (Note 3)
167	4-292-135-01	PLATE (METAL), SHOE NUT
△BH101	1-251-928-21	SOCKET, BATTERY (Note 2)
△BT101	1-756-134-15	BATTERY, LITHIUM (SECONDARY) (Note 2)
△BT901	1-780-858-11	TERMINAL BOARD BATTERY
MIC901	1-542-888-11	MICROPHONE UNIT
SP901	1-826-403-91	LOUDSPEAKER (1.0CM)
#27	2-662-396-11	SCREW (M1.4), NEW, TRUSTAR, P2
#200	4-178-124-11	SPECIAL (M1.4 (D2.75)) (Note 1)
#201	4-178-124-21	SPECIAL (M1.4 (D2.75))
#202	4-178-124-31	SPECIAL (M1.4 (D2.75)) (Note 1)
#238	4-287-436-01	SCREW (M1.7)

DISASSEMBLY

- Remove to numerical order (① to ⑥) in the left figure.
- The meaning of the sign in left figure is as follows. Be careful when it removes.
◇: Solder

① #238 X 1

Back view

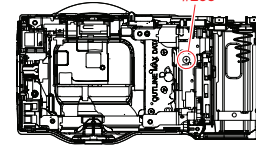

④ #27 X 1

Top view

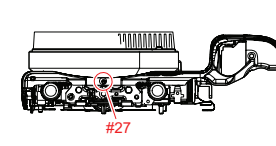

⑥ #200/#202 X 1

Top view

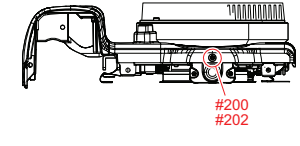

Screw

#27: M1.4 X 2.0
(Black)
2-662-396-11

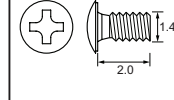

#200: M1.4 X 3.8
(Black)
4-178-124-11

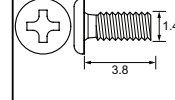

#201: M1.4 X 2.0
(Silver)
4-178-124-21

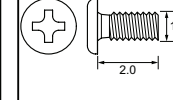

#202: M1.4 X 3.8
(Silver)
4-178-124-31

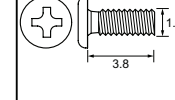

#238: M1.7 X 3.5
(Black)
4-287-436-01

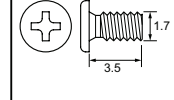

Note

Note 1

THE COMBINATION OF CABINET'S COLOR AND SCREW

The screw pointed ◇ is different according to the cabinet's color.
For the combination of cabinet's color and screw, please refer to Table 2-1.

Table 2-1

Screw's Ref. No. (Parts Color.)	Cabinet's Color
#200 (Black)	BLACK
#202 (Silver)	SILVER/WHITE

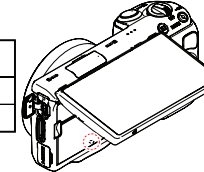

Note 2: Replace the battery holder (BH101) together when replacing the lithium secondary battery (BT101) on the CN-474 board. (The battery holder removed once cannot be used again.) When mounting these parts, mount new battery holder first and attach new lithium storage battery next.

Note 2: CN-474基板のリチウム蓄電池 (BT101) を交換する場合はバッテリーホルダ (BH101) も同時に新品に交換してください。(一度使用したバッテリーホルダは再使用できません。) 部品取り付けの際は、先にバッテリーホルダを取り付けてからリチウム蓄電池を装着してください。

Note 3: The Cabinet (front) block assy (service) includes a protective BODY CAP. This part is supplied only with the Cabinet (front) block assy (service).

Note 3: サービス用キャビフフロント組立には保護用のボディキャップが含まれます。この部品はサービス用キャビフフロント組立のみに付属されます。

CAUTION

Danger of explosion if battery is incorrectly replaced.
Replace only with the same or equivalent type.
Dispose of used batteries according to the instructions.

注意

電池の交換は、正しく行わないと破裂する恐れがあります。電池を交換する場合には必ず同じ型名の電池又は同等品と交換してください。使用済み電池は、取扱指示に従って処分してください。

2-1-5. IMAGER BLOCK SECTION

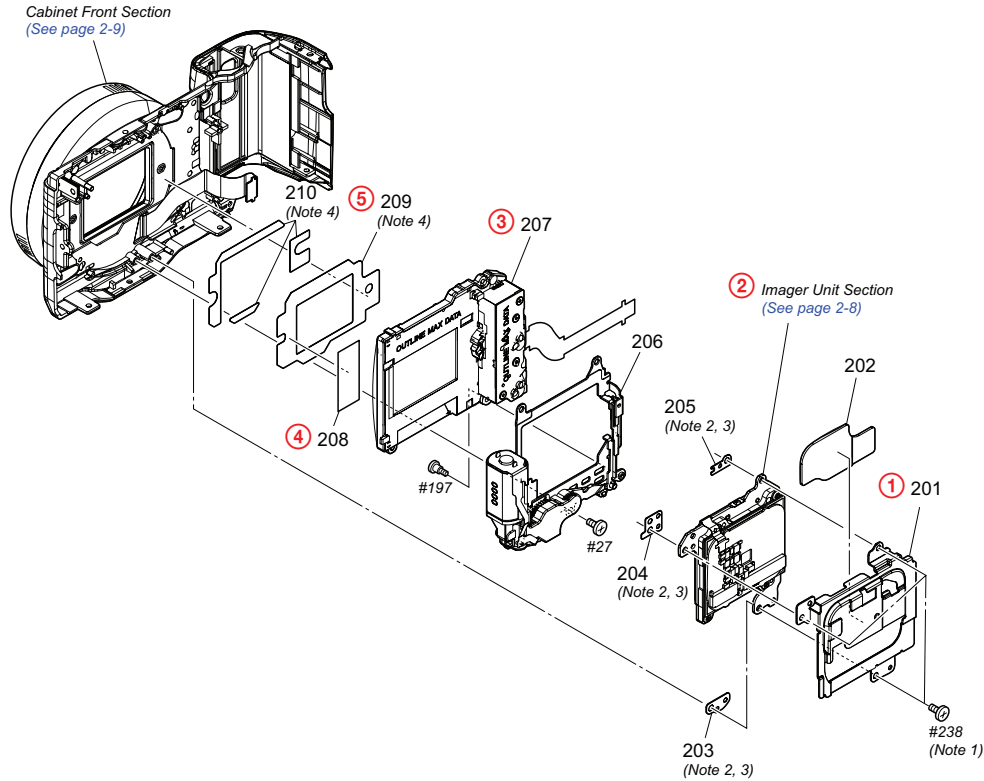

Ref. No.	Part No.	Description
201	4-292-136-01	HEAT SINK (IM)
202	4-292-165-01	SHEET, IMAGER ELECTRIC HEAT
203	Selection Parts	IM WASHER (C), ADJUST (Note 2, 3)
204	Selection Parts	IM WASHER (B), ADJUST (Note 2, 3)
205	Selection Parts	IM WASHER (A), ADJUST (Note 2, 3)
206	A-1817-096-A	MB CHARGE UNIT (755)
207	1-487-960-11	SHUTTER UNIT (AFE-3032)

Ref. No.	Part No.	Description
208	4-196-544-01	TAPE (AS (210))
209	4-277-282-01	MB SHEET (754), MASK (Note 4)
210	4-281-196-01	SHEET, MASK SHEET ADHESIVE (Note 4)
#27	2-662-396-11	SCREW (M1.4), NEW, TRUSTAR, P2
#197	4-185-990-01	MB SCREW, CHARGE UNIT FIXED
#238	4-287-436-01	SCREW (M1.7) (Note 1)

DISASSEMBLY

1. Remove to numerical order (① to ⑤) in the left figure.

① #238 X 3

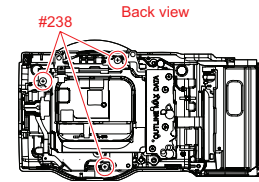

③ #27 X 1

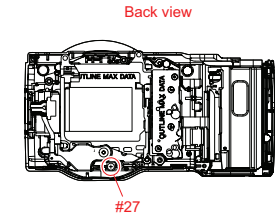

Screw

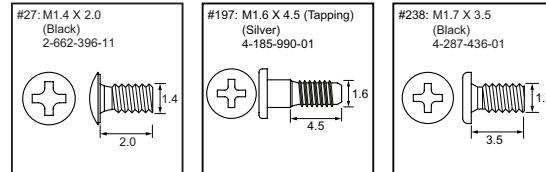

Note

Note 1: Refer to "Assembly-1: Screw tightening sequence when assembling the Heat Sink (IM)."

Note 1: "Assembly-1: Screw tightening sequence when assembling the Heat Sink (IM)."を参照してください。

Note 2: Refer to "Assembly-2: IM Adjust Washer (A, B, C) putting position."

Note 2: "Assembly-2: IM Adjust Washer (A, B, C) putting position."を参照してください。

Note 3: The type of these parts should be selected when performing adjustments. Refer to "2-2. SELECTION PARTS" on page 2-10.

Note 3: これらの部品は調整によって種類を選択する必要があります。2-10ページの"2-2. SELECTION PARTS"を参照してください。

Note 4: Refer to "Assembly-4: Method of attachment of MB Mask sheet (754)."

Note 4: "Assembly-4: Method of attachment of MB Mask sheet (754)."を参照してください。

2-1-6. IMAGER UNIT SECTION

ns: not supplied

(All mounted parts and IS-104 complete board are not supplied, but they are included in Cabinet (Front) Block Assy)

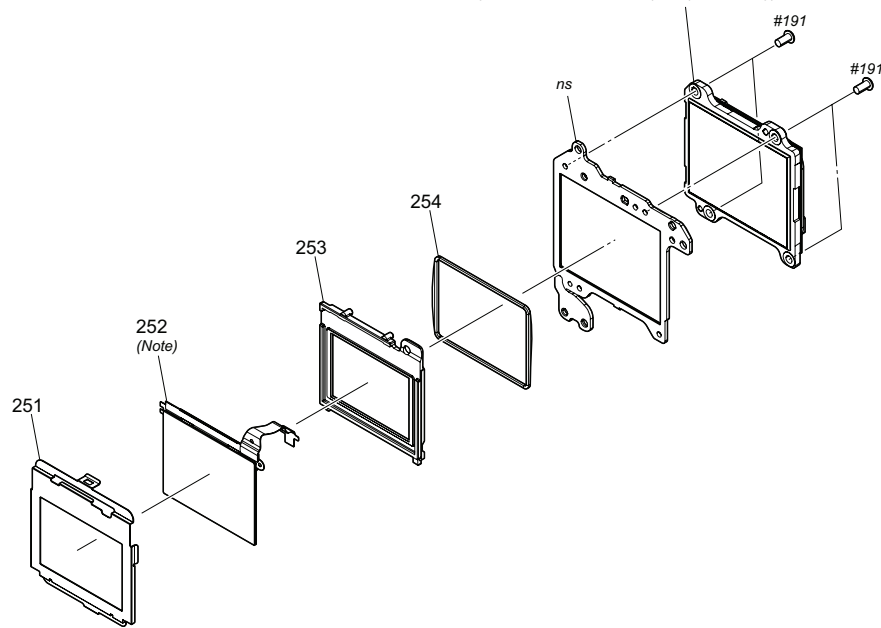

Ref. No.	Part No.	Description
251	4-259-691-01	IM PLATE (755), GLASS RETAINER
252	A-1817-089-A	IM IR GLASS ASSY (755) (Note)
253	4-259-692-01	IM PLATE (755), SPACE
254	4-277-280-01	IM RUBBER (754), SEAL

Ref. No.	Part No.	Description
#191	4-188-735-01	SCREW (M1.7)

NEX-5N/5ND/5NK/5NY_L2

Screw

#191: M1.7 X 3.5 (Tapping)
(Black)
4-188-735-01

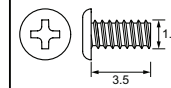

Note

Note: Refer to the following when assembling the Optical Filter Block and the Imager.

- Attach the IM IR Glass Assy (755), Space IM Plate (755), Glass Retainer IM Plate (754), and Seal IM Rubber (754) to the Imager IM Plate (755).

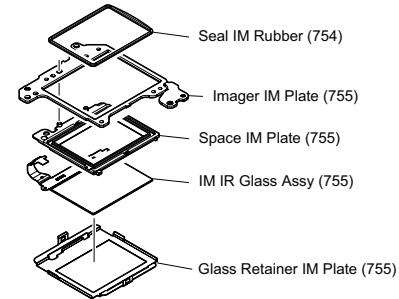

- Set the parts assembled in step (1) and the Imager onto the optical filter block attachment jig (J-6082-737-A) while aligning them with two pins.
- Secure the Imager with four screws.

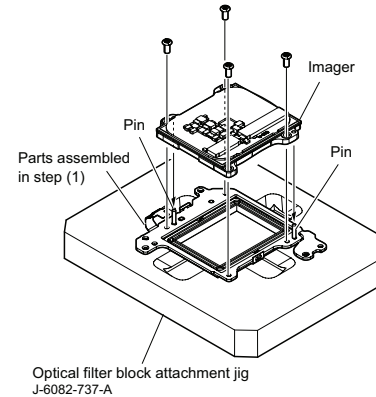

Note: IM IR ガラスASSYとイメージャを組み立てる際は、下記を参照してください。

- IM イメージャ台板 (755) に、IM IR ガラスASSY (755)、IM 間隔板 (755)、IM IR ガラスASSY (755)、IM シールラバー (754) を取り付けます。

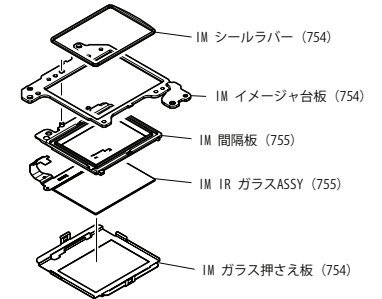

- ピン2箇所位置を合わせて、(1)で取り付けられた部品とイメージャを、光学フィルタブロック貼り付け治具 (J-6082-737-A) にセットする。
- ねじ4本でイメージャを固定する。

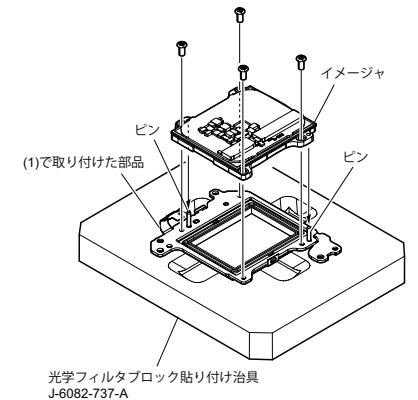

2-1-7. CABINET FRONT SECTION

ns: not supplied

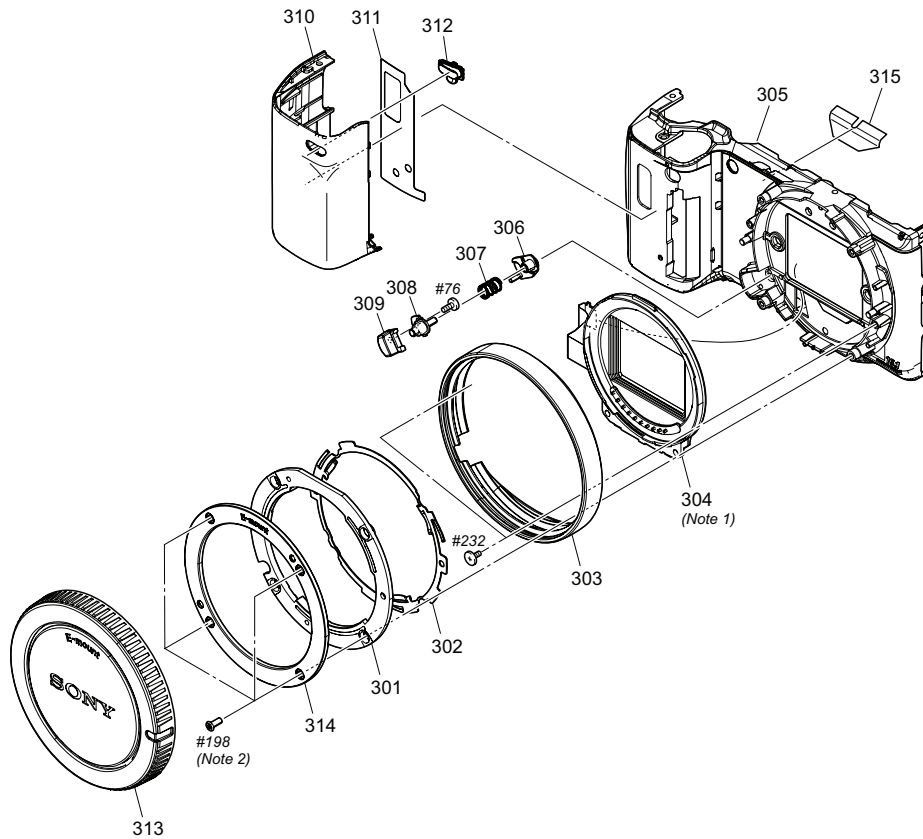

Ref. No.	Part No.	Description
301	4-284-623-01	MB N PLATE (B) 755
* 302	4-185-963-01	MB N PLATE SP
303	4-292-151-01	RING, ORNAMENTAL
304	A-1773-802-A	MB CONTACT UNIT, N (Note 1)
305	4-292-150-01	CABINET (FRONT) (BLACK)
305	4-292-150-11	CABINET (FRONT) (SILVER)
305	4-292-150-21	CABINET (FRONT) (WHITE)
* 306	4-186-536-01	HOLDER, L LOCK (BLACK)
* 307	4-186-538-01	SPRING, LENS LOCK (BLACK)
308	X-2581-299-1	PIN ASSY (410), L LOCK
* 309	4-186-534-01	BUTTON, L LOCK (BLACK)

Ref. No.	Part No.	Description
* 309	4-186-534-11	BUTTON, L LOCK (SILVER)
* 309	4-186-534-31	BUTTON, L LOCK (WHITE)
310	4-292-154-01	GRIP (BLACK)
310	4-292-154-11	GRIP (SILVER)
310	4-292-154-21	GRIP (WHITE)
311	4-292-155-01	SHEET, GRIP ADHESIVE
312	4-292-153-01	WINDOW (IR)
313	4-188-536-01	CAP, BODY
314	4-283-999-02	MB N PLATE A (754)
315	4-297-588-01	SHEET, LIGHT INTERCEPTION
#76	2-666-551-11	SCREW, TAPPING, P2
#198	4-186-545-01	SCREW, 0+Z M1.7 SG (SPIN) (Note 2)
#232	4-287-437-01	SPECIAL (M1.7X2.5 (D4X0.5))

Screw

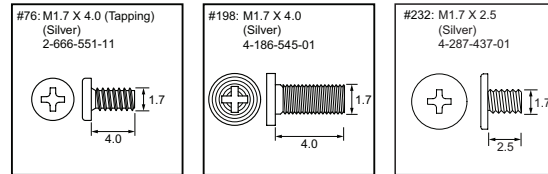

Note

Note 1: Hold the N MB Contact Unit at the center of both sides.

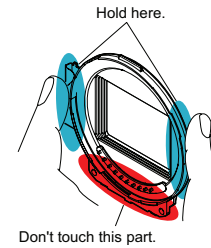

Note 1: N MB Contact Unitの両側の中央部を持ってください。

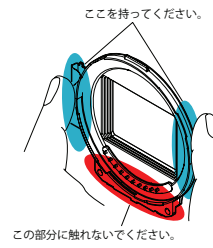

Note 2: Refer to "Assembly-3: Screw tightening sequence when assembling the MB N PLATE A (754)."

Note 2: "Assembly-3: Screw tightening sequence when assembling the MB N PLATE A (754)." を参照してください。

ACCESSORIES

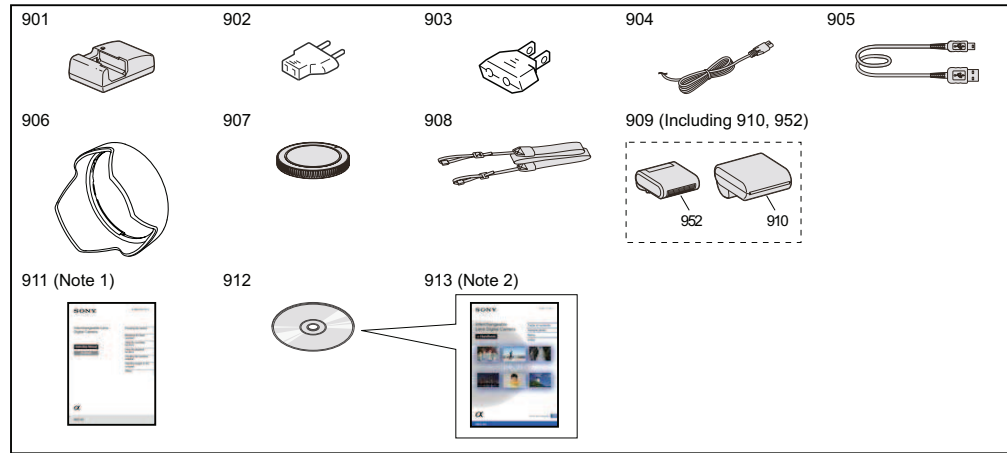

Ref. No.	Part No.	Description	Ref. No.	Part No.	Description
901	△ 1-487-907-21	Battery charger BC-VW1 (US, CND)	* 911	4-288-919-11	Instruction Manual (INDONESIAN) (Note 1)
901	△ 1-487-907-41	Battery charger BC-VW1 (EXCEPT US, CND)	912	4-288-915-01	CD-ROM "Application Software for a camera" "a Handbook"
902	△ 1-569-007-12	Conversion (2P) Adaptor (JE)	* 913	4-288-171-01	α Handbook (JAPANESE) (Note 2)
903	△ 1-569-008-33	Conversion (2P) Adaptor (E (Southeast Asia), E38)	* 913	4-288-171-11	α Handbook (ENGLISH) (Note 2)
904	△ 1-832-121-51	Power cord (mains lead) (E)	* 913	4-288-171-21	α Handbook (FRENCH) (Note 2)
904	△ 1-837-421-11	Power cord (mains lead) (UK, (Saudi, Hong Kong))	* 913	4-288-171-31	α Handbook (ITALIAN) (Note 2)
904	△ 1-837-422-11	Power cord (mains lead) (JE)	* 913	4-288-171-41	α Handbook (SPANISH) (Note 2)
904	△ 1-837-427-11	Power cord (mains lead) (AEP, E (EXCEPT Saudi, Hong Kong))	* 913	4-288-171-51	α Handbook (PORTUGUESE) (Note 2)
904	△ 1-837-428-11	Power cord (mains lead) (KR)	* 913	4-288-171-61	α Handbook (GERMAN) (Note 2)
904	△ 1-837-429-11	Power cord (mains lead) (AUS)	* 913	4-288-171-71	α Handbook (DUTCH) (Note 2)
905	1-837-287-21	USB cable	* 913	4-288-171-81	α Handbook (TRADITIONAL CHINESE) (Note 2)
906	4-159-703-02	Lens hood (NEX-5ND/5NK/5NY)	* 913	4-288-171-91	α Handbook (SIMPLIFIED CHINESE) (Note 2)
907	4-188-536-01	Body cap (NEX-5N)	* 913	4-288-172-11	α Handbook (RUSSIAN) (Note 2)
908	4-188-538-01	Shoulder strap	* 913	4-288-172-21	α Handbook (PORTUGUESE) (Note 2)
909	A-1774-691-A	Flash HVL-F7S, Flash case	* 913	4-288-172-31	α Handbook (PERSIAN) (Note 2)
910	4-186-787-01	Flash case	* 913	4-288-172-41	α Handbook (KOREAN) (Note 2)
911	4-288-916-01	Instruction Manual (JAPANESE) (Note 1)	* 913	4-288-172-51	α Handbook (POLISH) (Note 2)
911	4-288-916-11	Instruction Manual (ENGLISH) (Note 1)	* 913	4-288-172-61	α Handbook (CZECH) (Note 2)
* 911	4-288-916-21	Instruction Manual (FRENCH, ITALIAN) (Note 1)	* 913	4-288-172-71	α Handbook (HUNGARIAN) (Note 2)
* 911	4-288-916-31	Instruction Manual (SPANISH, PORTUGUESE) (Note 1)	* 913	4-288-172-81	α Handbook (SLOVAK) (Note 2)
* 911	4-288-916-41	Instruction Manual (GERMAN, DUTCH) (Note 1)	* 913	4-288-172-91	α Handbook (SWEDISH) (Note 2)
* 911	4-288-916-51	Instruction Manual (TRADITIONAL CHINESE, SIMPLIFIED CHINESE) (E, JE) (Note 1)	* 913	4-288-173-11	α Handbook (FINNISH) (Note 2)
* 911	4-288-916-61	Instruction Manual (RUSSIAN, UKRAINIAN) (Note 1)	* 913	4-288-173-21	α Handbook (NORWEGIAN) (Note 2)
* 911	4-288-916-71	Instruction Manual (ARABIC, PERSIAN) (Note 1)	* 913	4-288-173-31	α Handbook (DANISH) (Note 2)
911	4-288-916-81	Instruction Manual (KOREAN) (Note 1)	* 913	4-288-173-41	α Handbook (THAI) (Note 2)
911	4-288-916-91	Instruction Manual (SIMPLIFIED CHINESE) (CH) (Note 1)	* 913	4-288-173-51	α Handbook (UKRAINIAN) (Note 2)
* 911	4-288-917-11	Instruction Manual (POLISH) (Note 1)			
* 911	4-288-918-11	Instruction Manual (HUNGARIAN) (Note 1)			
* 911	4-288-918-21	Instruction Manual (SLOVAK) (Note 1)			
* 911	4-288-918-31	Instruction Manual (CZECH) (Note 1)			
* 911	4-288-918-41	Instruction Manual (SWEDISH) (Note 1)			
* 911	4-288-918-51	Instruction Manual (FINNISH) (Note 1)			
* 911	4-288-918-61	Instruction Manual (NORWEGIAN) (Note 1)			
* 911	4-288-918-71	Instruction Manual (DANISH) (Note 1)			
* 911	4-288-918-81	Instruction Manual (THAI) (Note 1)			

(Note 1)

(Only for destination Japanese model)
日本語、英語、韓国語、中国語のみ部品供給可能です。

(Note 2)

The CD-ROM supplied contains all of language version of the α Handbook (PDF) for printing.
• The printed matter is not supplied. If required, please order it with the part number below.
• (Only for destination Japanese model)
日本国内については日本語のみが印刷での部品供給可能です。

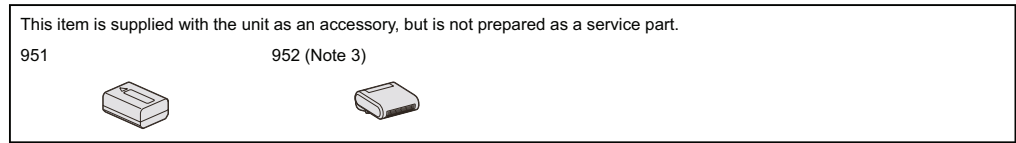

Ref. No.	Part No.	Description
951	△ (Not supplied)	Rechargeable battery pack (NP-FV70)
952	(Not supplied)	Flash HVL-F7S (Note 3)

(Note 3)

Ref. No. 952 is not supplied, but it is included in Ref. No. 909.

2-2. SELECTION PARTS

Ref. No.203

Select the optimum thickness of washer.

Part No.	Description
4-185-999-01	IM WASHER (C), ADJUST (t = 0.05)
4-185-999-11	IM WASHER (C), ADJUST (t = 0.1)
4-185-999-21	IM WASHER (C), ADJUST (t = 0.15)
4-185-999-31	IM WASHER (C), ADJUST (t = 0.2)
4-185-999-41	IM WASHER (C), ADJUST (t = 0.25)
4-185-999-51	IM WASHER (C), ADJUST (t = 0.3)
4-185-999-61	IM WASHER (C), ADJUST (t = 0.35)
4-185-999-71	IM WASHER (C), ADJUST (t = 0.4)
4-185-999-81	IM WASHER (C), ADJUST (t = 0.45)
4-185-999-91	IM WASHER (C), ADJUST (t = 0.495)

Ref. No.204

Select the optimum thickness of washer.

Part No.	Description
4-185-998-01	IM WASHER (B), ADJUST (t = 0.05)
4-185-998-11	IM WASHER (B), ADJUST (t = 0.1)
4-185-998-21	IM WASHER (B), ADJUST (t = 0.15)
4-185-998-31	IM WASHER (B), ADJUST (t = 0.2)
4-185-998-41	IM WASHER (B), ADJUST (t = 0.25)
4-185-998-51	IM WASHER (B), ADJUST (t = 0.3)
4-185-998-61	IM WASHER (B), ADJUST (t = 0.35)
4-185-998-71	IM WASHER (B), ADJUST (t = 0.4)
4-185-998-81	IM WASHER (B), ADJUST (t = 0.45)
4-185-998-91	IM WASHER (B), ADJUST (t = 0.495)

Ref. No.205

Select the optimum thickness of washer.

Part No.	Description
4-185-995-01	IM WASHER (A), ADJUST (t = 0.05)
4-185-995-11	IM WASHER (A), ADJUST (t = 0.1)
4-185-995-21	IM WASHER (A), ADJUST (t = 0.15)
4-185-995-31	IM WASHER (A), ADJUST (t = 0.2)
4-185-995-41	IM WASHER (A), ADJUST (t = 0.25)
4-185-995-51	IM WASHER (A), ADJUST (t = 0.3)
4-185-995-61	IM WASHER (A), ADJUST (t = 0.35)
4-185-995-71	IM WASHER (A), ADJUST (t = 0.4)
4-185-995-81	IM WASHER (A), ADJUST (t = 0.45)
4-185-995-91	IM WASHER (A), ADJUST (t = 0.495)

3. ASSEMBLY

3-1. ASSEMBLY

Assembly-1: Screw tightening sequence when assembling the Heat Sink (IM).

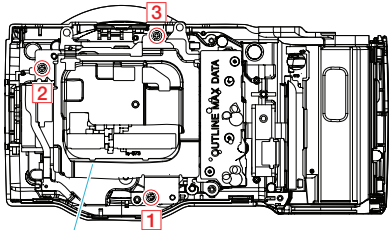

Heat Sink (IM)

Assembly-2: IM Adjust Washer (A, B, C) putting position.

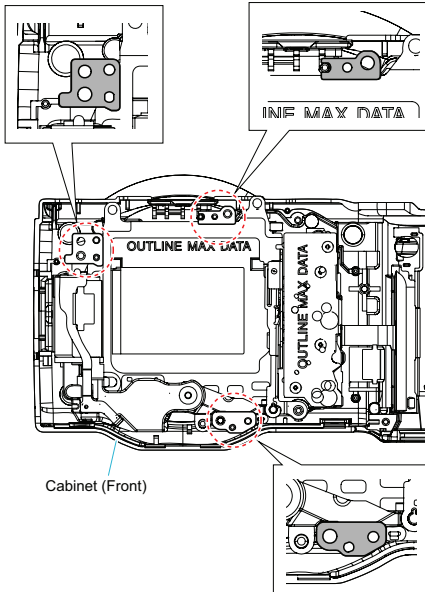

Cabinet (Front)

Assembly-3: Screw tightening sequence when assembling the MB N Plate A (754).

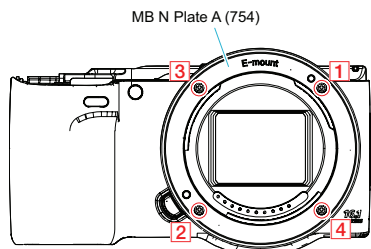

MB N Plate A (754)

Assembly-4: Method of attachment of MB Mask Sheet (754).

Note: There should not be any misalignment when attaching MB Mask Sheet (754).

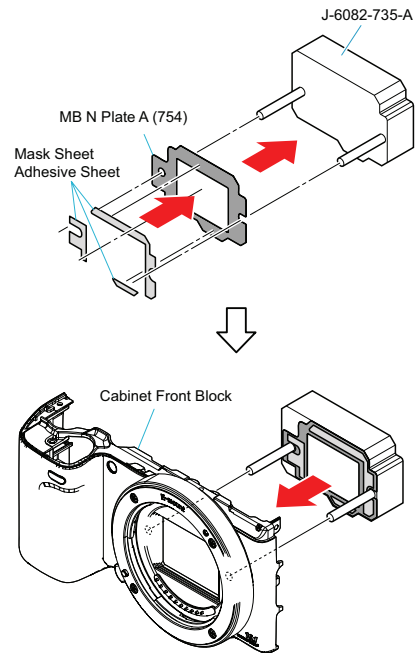

3-2. CLEANING PROCEDURE OF OLPF

<Preparation for Remedy>

If you use the new Jig (J-6082-663-A) below, make sure to clean the CCD Cleaning Jig (Tip) below before using, please.

Note: Protection sheet is for preventing the scratch of a surface on the Jig (Tip).

The protection sheet may be come off the Jig when you take the Jig from a bag, but it is no problem.

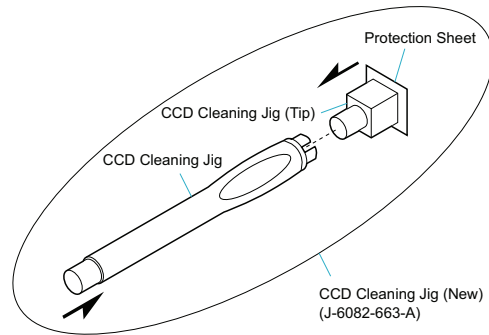

<Cleaning Procedure for Tip of CCD Cleaning Jig>

1. Put the two cleaning cloths on a tray like below.
 - ① Soak the one cleaning cloth in ethyl alcohol.
 - ② Put the other cleaning cloth on a tray as it is dry.
2. Dab the tip of CCD cleaning jig at the cleaning cloth of ① 5 or 6 times.
 - * Do not slide the tip from right to left or up and down while dabbing.
3. Dab the tip of CCD cleaning jig at the cleaning cloth of ② 5 or 6 times.
 - * Do not slide from right to left or up and down while dabbing.
4. Wait until the tip will be dried completely.

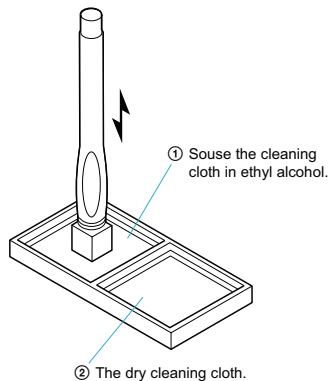

<Cleaning Procedure for the OLPF>

1. Clean up the tip of CCD cleaning jig.
2. Dab the tip of CCD cleaning jig at the OLPF, and pull up straight.
 - * Do not slide from right to left or up and down while dabbing.
3. Repeat "3" several times to clean up.
4. According to service manual, check if there is dirt on the CCD.

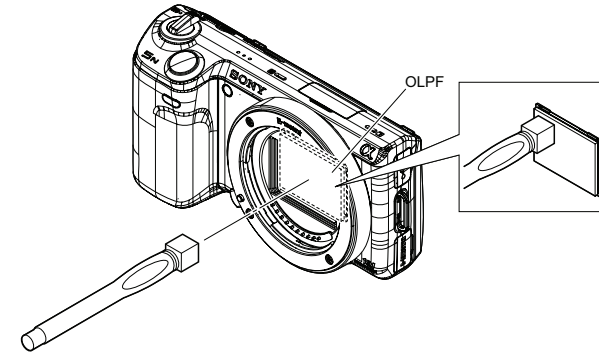

<ATTENTION>

If you cannot remove dirt with remedy above, cleaning by the following jig are used.

Soak a small amount of EE3310 (Liquid cleaner) after wrapping the cleaning cloth (J-6082-636-A) around the cleaning jig (J-6082-635-A).

