

Ver.1.2 2010.07
The changed portions from Ver.1.1 are shown in blue.

2-1. EXPLODED VIEWS

2-1-1. OVERALL SECTION (NEX-5A/5D/SK/5CK/5H)

ns: not supplied

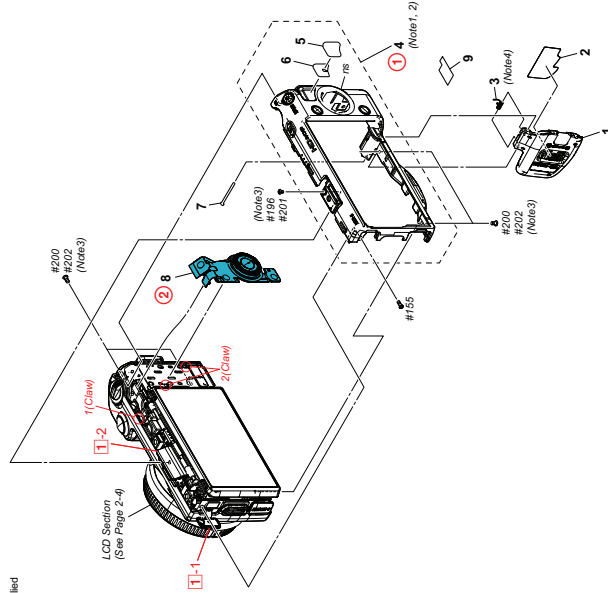

Note3: Refer to "THE COMBINATION OF CABINET'S COLOR AND SCREW (NEX-5A/5D/SK/5CK/5H)" on page 2-1 about the combination of cabinet's color and screw.

Note4: Refer to "Assembly-6: Method of attachment of BT Lid Assy when you assemble."

Ref. No.	Part No.	Description
1	X-2547-297-2	LID ASSY (BLACK), BT (BLACK)
1	X-2547-298-2	LID ASSY (SILVER), BT (SILVER)
* 2	4-191-380-01	LABEL, MS
3	4-186-475-01	SPRING, BT LID OPEN (Nss)
4	X-2547-295-1	CABINET (REAR) ASSY (BLACK) (BLACK) (Note1, 2)
4	X-2547-296-1	CABINET (REAR) ASSY (SILVER) (SILVER) (Note1, 2)
5	4-186-478-01	GRP (REAR), BLACK (BLACK)

Note3: キャビネットの色とネジの組み合わせについては、2-1 ページの「THE COMBINATION OF CABINET'S COLOR AND SCREW (NEX-5A/5D/SK/5CK/5H)」を参照してください。

Note4: 組立順序は「Assembly-6: Method of attachment of BT Lid Assy」を参照してください。

Ref. No.	Part No.	Description
8	1-467-968-12	SWITCH BLOCK, CONTROL (BLACK)
8	1-467-968-22	SWITCH BLOCK, CONTROL (SILVER)
* 9	4-186-341-01	LABEL, VOC/ JAPAN/ RECYCLE MARK (J)
#155	3-056-204-31	SCREW, TAPPING, PZ
#200	4-178-124-11	SPECIAL (M1.4 D2.75) (BLACK) (Nss3)
#201	4-178-124-21	SPECIAL (M1.4 D2.75) (SILVER) (Nss3)

DISASSEMBLY

1. Remove to numerical order (1) to (3) in the left figure.

① #200 / #202 X 4 → USB Cover Open (1-1) → #155 X 1 → Shoe Cover Open (1-2) → #196 / #201 X 1 → LCD Panel Open

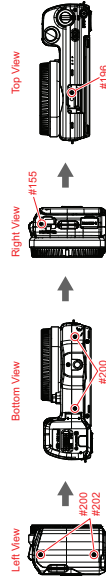

Screw

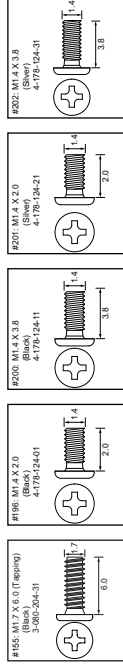

Note

Note1: Perform the following procedures to remove Cabinet (Rear) Assy.

(1) Open LCD at the angle shown below.



(2) Raise the lower part of Cabinet (Rear) Assy, and slide it upward.

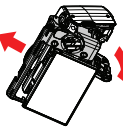

(3) Remove Cabinet (Rear) Assy while turning it in the direction indicated by arrows.

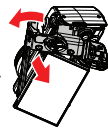

Note1: 後キャビネット Assy を取り外す場合、以下の手順で行ってください。

(1) LCD を下部の角度に開きます。



(2) 後キャビネット Assy の下部を手前へ起こし、後キャビネット Assy を上部へスライドします。

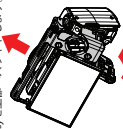

(3) 後キャビネット Assy を矢印の方向に回転させながら、取り外します。

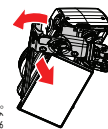

2-1-2. LCD SECTION
(NEX-5A/5D/5K/5CK/5H)

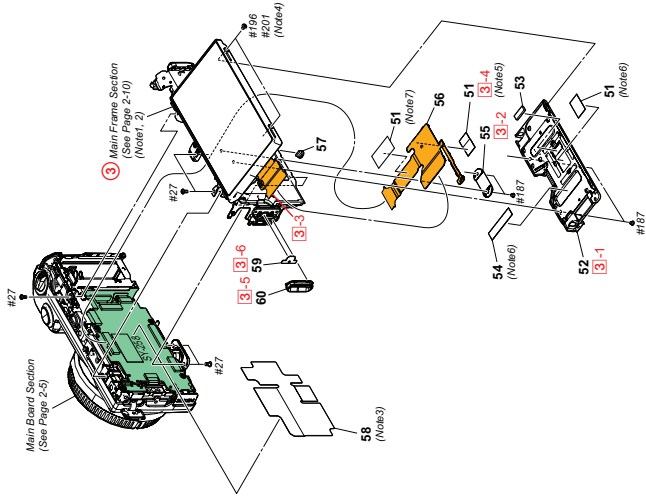

Part No.	Description	Part No.	Description
* 51	INSULATING SHEET, LC FLEXIBLE (Nm5, 6, 7)	* 59	X-25T-550-1 PIN ASSY'S LOCK
* 52	X-25T-561-1 CABINET REAR ASSY, LC	* 60	4-186-568-01 BASE (L), STRAP (BLACK)
* 53	X-25T-561-1 CABINET REAR ASSY, LC	* 60	4-186-568-11 BASE (L), STRAP (SILVER)
* 54	4-186-568-01 INSULATING SHEET, LC CONNECTOR (Nm6)		
* 55	4-186-569-01 RETAINER, LC FLEXIBLE	* 67	2-662-398-11 SCREW (M1.4), NEW, TRUSTAR, PZ

DISASSEMBLY

1. Remove to numerical order (3) in the left figure.

- ③ #187 X 2 → #196 / #201 X 2 → LC Cabinet (Rear Assy) (3-1) → #187 X 2 → LC Flexible Retainer (3-2) → Release LCD Flexible Board (3-3) → Peel off LC Flexible Insulating Sheet (3-4) → #27 X 5 → Strap Base (L) (3-5) → S Lock Pin Assy (3-6)

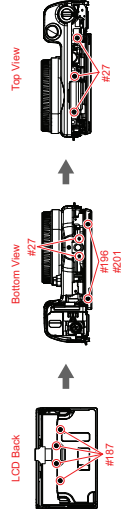

Screw

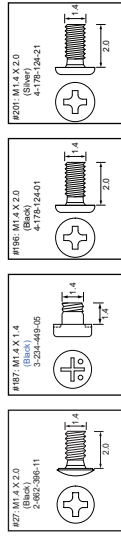

Note

- Note1:** To remove Frame Assy, firstly remove LCD Flexible Board and LC Flexible Insulating Sheet, then untix FP-1237 Flexible Complete Board.
- Note2:** Refer to "Assembly-2: Temporarily secure FP-1237 Flexible Complete Board when you assemble."
- Note3:** Refer to "Assembly-3: Insulating Sheet A (SV) putting position" when you assemble.
- Note4:** Refer to "THE COMBINATION OF CABINET'S COLOR AND SCREW (NEX-5A/5D/5K/5CK/5H)" on page 2-1 about the combination of cabinet's color and screw.
- Note5:** Refer to "Assembly-4: LC Flexible Insulating Sheet putting position" when you assemble.
- Note6:** Refer to "Assembly-5: LC Connector Insulating Sheet, LC Flexible Insulating Sheet putting position" when you assemble.
- Note7:** Refer to "Assembly-9: LC Flexible Insulating Sheet putting position" when you assemble.
- Note8:** To remove Frame Assy, firstly remove LCD Flexible Board and LC Flexible Insulating Sheet, then untix FP-1237 Flexible Complete Board.
- Note9:** Refer to "Assembly-2: Temporarily secure FP-1237 Flexible Complete Board when you assemble."
- Note10:** Refer to "Assembly-3: Insulating Sheet A (SV) putting position" when you assemble.
- Note11:** Refer to "THE COMBINATION OF CABINET'S COLOR AND SCREW (NEX-5A/5D/5K/5CK/5H)" on page 2-1 about the combination of cabinet's color and screw.
- Note12:** Refer to "Assembly-4: LC Flexible Insulating Sheet putting position" when you assemble.
- Note13:** Refer to "Assembly-5: LC Connector Insulating Sheet, LC Flexible Insulating Sheet putting position" when you assemble.
- Note14:** Refer to "Assembly-9: LC Flexible Insulating Sheet putting position" when you assemble.

Ver.1.2 2010.07
 The changed portions from
 Ver.1.1 are shown in blue.

2-1-3. MAIN BOARD SECTION
 (NEX-5A/5D/5K/5C/5H)

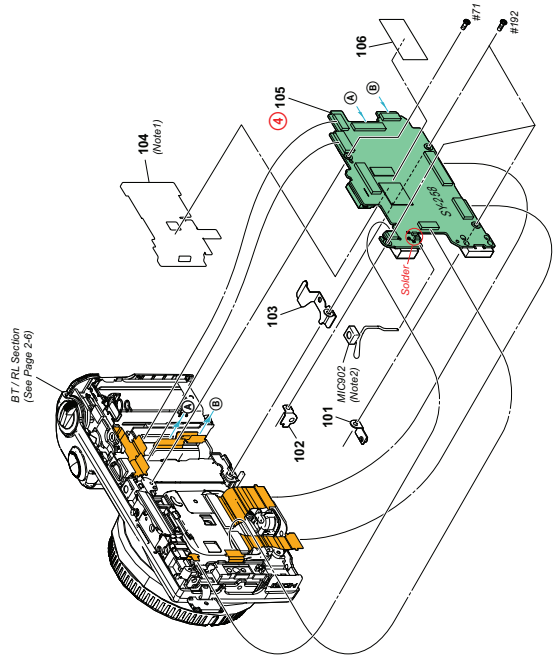

Part No.	Description
* 101	GROUND PLATE (L) BOTTOM
* 102	GROUND PLATE (R) BOTTOM
* 103	GROUND PLATE (L) BOTTOM
* 104	INSULATING SHEET B (SY) (Notes)

Part No.	Description
MIC002	MICROPHONE UNIT (Note2)
#71	SCREW (TPI, 4) P2
#192	SCREW (TPI, 4) P2

DISASSEMBLY

1. Remove to numerical order (④) in the left figure.

④ #192 X 3 → #71 X 1

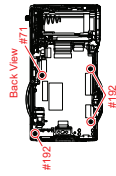

Screw

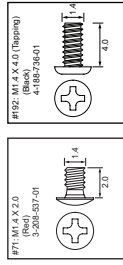

Note

Note1: Refer to "Assembly-10: Insulating Sheet B (SY) putting position" when you assemble.

Note2: Refer to "Assembly-11: Routing of Microphone Harness" when you assemble.

Note1: 組立時は "Assembly-10: Insulating Sheet B (SY) putting position" を参照してください。

Note2: 組立時は "Assembly-11: Routing of Microphone Harness" を参照してください。

2-1-4. BT / RL SECTION
(NEX-5A/5D/5K/5CK/5GH)

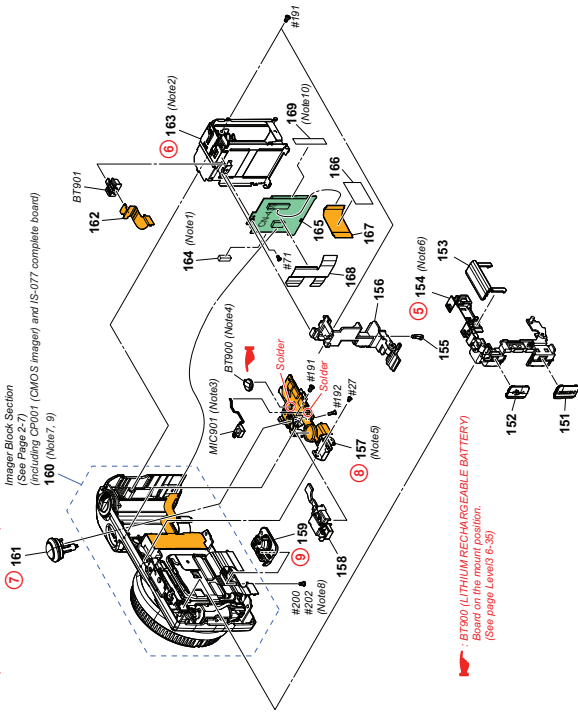

Part No.	Description
* 151	A-186-554-01 COVER, HDMI (BLACK)
* 151	A-186-554-11 COVER, HDMI (SILVER)
* 152	A-186-553-01 COVER, USB (SILVER)
* 153	A-186-553-01 COVER, USB (BLACK)
* 153	A-186-553-01 COVER, SHOE (BLACK)
* 153	A-186-553-11 COVER, SHOE (SILVER)
* 154	A-186-553-02 BASE, JACK COVER (BLACK) (Note4)
* 154	A-186-553-02 BASE, JACK COVER (SILVER) (Note4)
* 155	A-186-446-01 LIGHT, IAS, GUIDE.
* 156	A-186-444-01 BASE, BT, LD.
* 157	A-1782-038-A RL BLOCK ASSY (SERVICE) (Note5)
* 158	A-186-475-01 HOLDER, SPD
* 159	A-1782-023-A CABINET FRONT BLOCK ASSY (SERVICE) (BLACK)
* 159	A-1782-023-A CABINET FRONT BLOCK ASSY (SERVICE) (SILVER)
* 160	A-1782-033-A CABINET FRONT BLOCK ASSY (SERVICE) (BLACK)
* 160	A-1782-033-A CABINET FRONT BLOCK ASSY (SERVICE) (SILVER)

Part No.	Description
162	1-880-985-11 BT900 FLEXIBLE BOARD
163	X-2847-895-1 BT FRAME ASSY (Note2)
*	A-186-553-01 COVER, USB (SILVER)
*	A-1773-791-A CN-48 BOARD, COMPLETE
166	A-186-489-01 SHEET (CN FPC)
167	A-186-987-11 FP-128 FLEXIBLE BOARD
* 168	A-186-474-01 INSULATING SHEET (MS)
169	A-186-988-01 INSULATING SHEET (LC CONNECTOR) (Note10)
Δ BT900	1-756-913-11 LITHIUM RECHARGEABLE BATTERY (Note4)
Δ BT900	1-760-888-11 TERMINAL BOARD BATTERY
MI-C901	1-542-797-61 MICROPHONE UNIT (Note4)
#77	0-650-286-11 SCREW (M1.6, NEW, TRUSSTAR, P2)
#71	3-208-97-01 SCREW (M2.0, NEW, TORASUTA)
#191	A-186-785-01 SCREW (M1.7)
#192	A-186-786-01 SCREW (TR1.4)

Caution
Danger of explosion occurs if battery is incorrectly replaced. Replace only with the same or equivalent type. Dispose of used batteries according to the instructions.

Caution
電圧の交換は、正しく行わないと爆発する恐れがあります。電池を交換する場合には必ず同じ容量の電池を同容量と交換してください。使用済み電池は、取扱説明書に基づいて処分してください。

DISASSEMBLY

1. Remove to numerical order (⑤ in ⑥) in the left figure.

⑥ #191 X 2

Back View

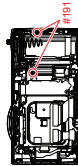

⑥ #27 X 1 → #191 X 1

Back View

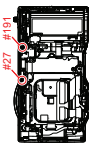

⑦ #192 X 1

Bottom View

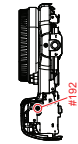

⑧ #200 / #202 X 1

Bottom View

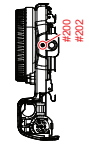

Screw

#27: M1.4 X 2.0 2-062-296-11	#71: M1.4 X 2.0 3-208-97-01	#191: M1.7 X 3.5 4-186-736-01	#192: M1.4 X 4.0 (Thru) 4-186-736-01	#200: M1.4 X 3.0 4-1791-24-11	#202: M1.4 X 3.8 4-1791-24-31

Note

- Note1: Refer to "Assembly-12: Inserting Gasket (MS) (NEX-5A/5D/5K/5CK/5GH)" when you assemble.
- Note2: Refer to "Assembly-13: Assemble BT Holder Block Assy (NEX-5A/5D/5K/5CK/5GH)" when you assemble.
- Note3: Refer to "Assembly-14: Routing of Microphone Harness (NEX-5A/5D/5K/5CK/5GH)" when you assemble.
- Note4: Refer to "Assembly-15: Lithium Rechargeable Battery putting position" when you assemble.
- Note5: Refer to "Assembly-16: Note when assembling RL Block Assy (NEX-5A/5D/5K/5CK/5GH)" when you assemble.
- Note6: Refer to "Assembly-19: Note on Alignment of the Flexible Board (NEX-5A/5D/5K/5CK/5GH)" when you assemble.
- Note7: Refer to "Precaution on Replacing the Cabinet Front Block Assy (Service)" on page 2-1 about the combination of cabinet's color and section.
- Note8: Refer to "Precaution on Replacing the Cabinet Front Block Assy (Service)" on page 1-1 when replacing cabinet front block Assy (Service).
- Note9: Refer to "Assembly-3: LC Connector Insulating Sheet (NEX-5A/5D/5K/5CK/5GH)" when you assemble.
- Note10: Refer to "Assembly-3: LC Connector Insulating Sheet (NEX-5A/5D/5K/5CK/5GH)" when you assemble.
- Note11: Refer to "Assembly-12: Inserting Gasket (MS) (NEX-5A/5D/5K/5CK/5GH)" when you assemble.
- Note12: Refer to "Assembly-13: Assemble BT Holder Block Assy (NEX-5A/5D/5K/5CK/5GH)" when you assemble.
- Note13: Refer to "Assembly-14: Routing of Microphone Harness (NEX-5A/5D/5K/5CK/5GH)" when you assemble.
- Note14: Refer to "Assembly-15: Lithium Rechargeable Battery putting position" when you assemble.
- Note15: Refer to "Assembly-16: Note when assembling RL Block Assy (NEX-5A/5D/5K/5CK/5GH)" when you assemble.
- Note16: Refer to "Assembly-19: Note on Alignment of the Flexible Board (NEX-5A/5D/5K/5CK/5GH)" when you assemble.
- Note17: Refer to "Precaution on Replacing the Cabinet Front Block Assy (Service)" on page 2-1 about the combination of cabinet's color and section.
- Note18: Refer to "Precaution on Replacing the Cabinet Front Block Assy (Service)" on page 1-1 when replacing cabinet front block Assy (Service).
- Note19: Refer to "Assembly-3: LC Connector Insulating Sheet (NEX-5A/5D/5K/5CK/5GH)" when you assemble.

DISASSEMBLY

1. Remove to numerical order (⑤ in ⑥) in the left figure.

⑥ #191 X 2

Back View

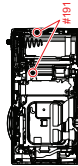

⑥ #27 X 1 → #191 X 1

Back View

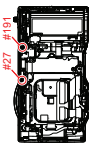

⑦ #192 X 1

Bottom View

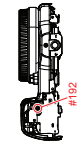

⑧ #200 / #202 X 1

Bottom View

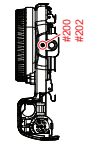

Screw

#27: M1.4 X 2.0 2-062-296-11	#71: M1.4 X 2.0 3-208-97-01	#191: M1.7 X 3.5 4-186-736-01	#192: M1.4 X 4.0 (Thru) 4-186-736-01	#200: M1.4 X 3.0 4-1791-24-11	#202: M1.4 X 3.8 4-1791-24-31

Note

- Note1: Refer to "Assembly-12: Inserting Gasket (MS) (NEX-5A/5D/5K/5CK/5GH)" when you assemble.
- Note2: Refer to "Assembly-13: Assemble BT Holder Block Assy (NEX-5A/5D/5K/5CK/5GH)" when you assemble.
- Note3: Refer to "Assembly-14: Routing of Microphone Harness (NEX-5A/5D/5K/5CK/5GH)" when you assemble.
- Note4: Refer to "Assembly-15: Lithium Rechargeable Battery putting position" when you assemble.
- Note5: Refer to "Assembly-16: Note when assembling RL Block Assy (NEX-5A/5D/5K/5CK/5GH)" when you assemble.
- Note6: Refer to "Assembly-19: Note on Alignment of the Flexible Board (NEX-5A/5D/5K/5CK/5GH)" when you assemble.
- Note7: Refer to "Precaution on Replacing the Cabinet Front Block Assy (Service)" on page 2-1 about the combination of cabinet's color and section.
- Note8: Refer to "Precaution on Replacing the Cabinet Front Block Assy (Service)" on page 1-1 when replacing cabinet front block Assy (Service).
- Note9: Refer to "Assembly-3: LC Connector Insulating Sheet (NEX-5A/5D/5K/5CK/5GH)" when you assemble.
- Note10: Refer to "Assembly-3: LC Connector Insulating Sheet (NEX-5A/5D/5K/5CK/5GH)" when you assemble.
- Note11: Refer to "Assembly-12: Inserting Gasket (MS) (NEX-5A/5D/5K/5CK/5GH)" when you assemble.
- Note12: Refer to "Assembly-13: Assemble BT Holder Block Assy (NEX-5A/5D/5K/5CK/5GH)" when you assemble.
- Note13: Refer to "Assembly-14: Routing of Microphone Harness (NEX-5A/5D/5K/5CK/5GH)" when you assemble.
- Note14: Refer to "Assembly-15: Lithium Rechargeable Battery putting position" when you assemble.
- Note15: Refer to "Assembly-16: Note when assembling RL Block Assy (NEX-5A/5D/5K/5CK/5GH)" when you assemble.
- Note16: Refer to "Assembly-19: Note on Alignment of the Flexible Board (NEX-5A/5D/5K/5CK/5GH)" when you assemble.
- Note17: Refer to "Precaution on Replacing the Cabinet Front Block Assy (Service)" on page 2-1 about the combination of cabinet's color and section.
- Note18: Refer to "Precaution on Replacing the Cabinet Front Block Assy (Service)" on page 1-1 when replacing cabinet front block Assy (Service).
- Note19: Refer to "Assembly-3: LC Connector Insulating Sheet (NEX-5A/5D/5K/5CK/5GH)" when you assemble.

Ver.1.2 2010.07
 The changed portions from
 Ver.1.1 are shown in blue.

2-1-5. IMAGER BLOCK SECTION
 (NEX-5A/5D/5K/5CK/5H)

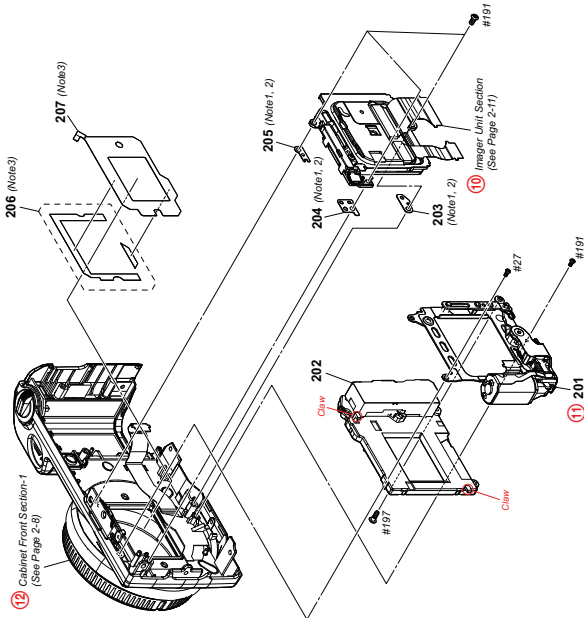

Ref. No.	Part No.	Description
4-201	4-1773-503-A	IM CHARGE UNIT
4-202	1-4872-10-11	SHUTTER UNIT (H594)
* 203	Selection Parts	IM WASHER (C), ADJUST (Note 1, 2)
* 204	Selection Parts	IM WASHER (B), ADJUST (Note 1, 2)
* 205	Selection Parts	IM WASHER (A), ADJUST (Note 1, 2)
Ref. No.	Part No.	Description
#27	2-682-398-11	SCREW (M1.4), NEW, TRUSTAR, P2
#191	4-182-735-01	SCREW (M1.7)
#191	4-182-990-01	MB SCREW, CHARGE UNIT FIXED

DISASSEMBLY

1. Remove to numerical order (㉑ to ㉓) in the left figure.

㉑ #191 X 3

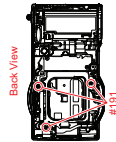

㉒ #27 X 1 → #191 X 1

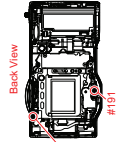

Screw

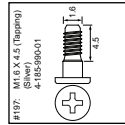
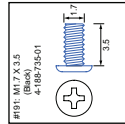
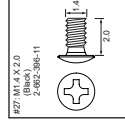

Note

Note1: The type of these parts should be selected when performing adjustments. Refer to 2-3. SELECTION PARTS on page 2-23.

Note2: Refer to "Assembly-20" IM Adjust Washer (A, B, C) putting position when you assemble.

Note3: Refer to "Assembly-24" Method of attachment of MB Mask Sheet when you assemble.

Note1: これらの部品は調整によって種類を選択する必要があります。2-23ページの2.3. SELECTION PARTSを参照してください。

Note2: 組立調整"Assembly-20" IM Adjust Washer (A, B, C) putting positionを参照してください。

Note3: 組立調整"Assembly-24" Method of attachment of MB Mask Sheet"を参照してください。

Ver.1.2 2010.07
 The changed portions from
 Ver.1.1 are shown in blue.

2-1-6. CABINET FRONT SECTION - 1
 (NEX-5A/5D/5K/5CK/5H)

Screw

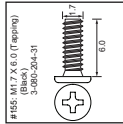

Note

Note1: Refer to "Assembly-25: BT Slider Sheet (front) putting position (NEX-5A/5D/5K/5CK/5H)" when you assemble.
Note2: Refer to "Assembly-26: BT Slider Sheet (horizontal) putting position (NEX-5A/5D/5K/5CK/5H)" when you assemble.
Note3: Refer to "Assembly-34: Tape AS (210) putting position (NEX-5A/5D/5K/5CK/5H)" when you assemble.

Note1: 組立時は "Assembly-25: BT Slider Sheet (front) putting position (NEX-5A/5D/5K/5CK/5H)" を参照してください。
Note2: 組立時は "Assembly-26: BT Slider Sheet (horizontal) putting position (NEX-5A/5D/5K/5CK/5H)" を参照してください。
Note3: 組立時は "Assembly-34: Tape AS (210) putting position (NEX-5A/5D/5K/5CK/5H)" を参照してください。

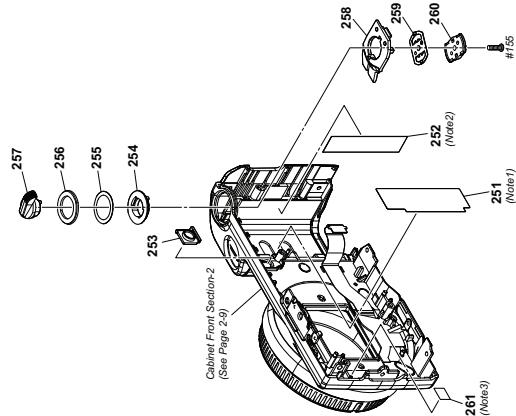

Part No.	Description	Part No.	Description
* 251	SHEET (FRONT), BT SLIDER (Note 1)	4-186-530-11	KNOB PW (SILVER)
* 252	SHEET (HORIZONTAL), BT SLIDER (Note 2)	4-186-528-01	BASE (REAR), PW KNOB
* 253	WINDOW (AF)	4-186-527-01	SPRING PW KNOB
* 254	RETAINER (AF)	4-186-524-01	RETAINER PW KNOB
* 255	SHEET PW RING ADHESIVE	4-186-544-01	TAPE (AS (210)) (Note 3)
		* 257	# T55

Ver.1.2 2010.07
 The changed portions from
 Ver.1.1 are shown in blue.

2-1-7. CABINET FRONT SECTION - 2
 (NEX-5A/5D/5K/5G/5H)

ns: not supplied

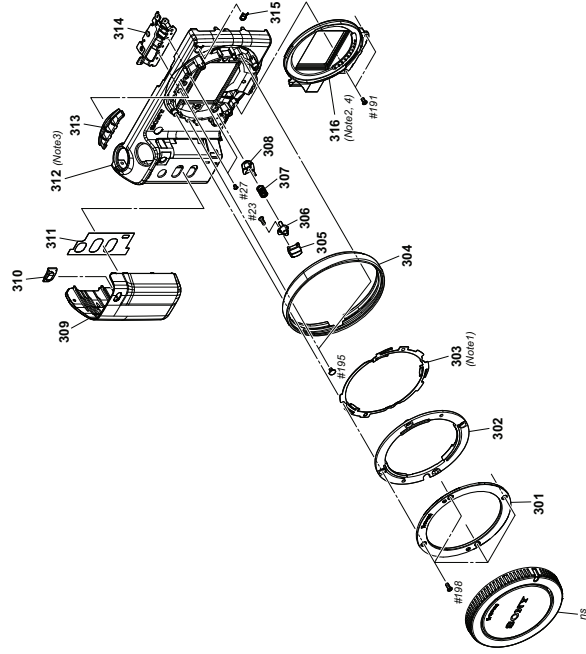

Part No.	Description	Part No.	Description
301	MB N PLATE (A)	312	CABINET FRONT (SILVER) (Note3)
* 302	MB N PLATE (B)	4-188-517-11	CABINET FRONT (SILVER) (Note3)
* 303	MB N PLATE SP (Note1)	4-188-532-01	COVER, ORNAMENTAL RING (BLACK)
* 304	COVER, ORNAMENTAL RING (SILVER)	* 313	COVER, ORNAMENTAL RING (BLACK)
* 305	BUTTON LOCK (BLACK)	* 314	PLATE ASSY, SHOE UNIT
* 306	BUTTON LOCK (SILVER)	4-188-538-11	PLATE ASSY, SHOE UNIT
* 307	PIN ASSY, L LOCK	315	PLATE LOGO (BLACK)
* 308	SPRING, LEIS LOCK	4-188-543-01	PLATE LOGO (SILVER)
* 309	GRP (BLACK)	4-188-543-11	PLATE LOGO (SILVER)
309	GRP (SILVER)	A-1773-802-A	MB CONTACT UNIT, N (Note2, 4)
		3-088-204-11	SCREW, TRIPPING, P2
		2-662-398-11	SCREW (M1.4), NEW TRUSTAR, P2
		* 191	SCREW (M1.7)

Screw

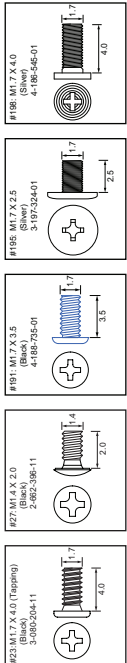

Note

- Note1: Refer to "Assembly-27: Apply grease on MB N Plate SP" when you assemble.
- Note2: Refer to "Assembly-28: MB N Contact Unit holding position" when you assemble.
- Note3: Refer to "PRECAUTION ON REPLACING THE CABINET FRONT" on page 1-1 when replacing Cabinet (Front).
- Note4: Refer to "PRECAUTION ON REPLACING THE CABINET FRONT" on page 1-1 when replacing MB N Contact Unit.

- Note1: 組立時は "Assembly-27: Apply grease on MB N Plate SP" を参照してください。
- Note2: 組立時は "Assembly-28: MB N Contact Unit holding position" を参照してください。
- Note3: 前ネジピネットを交換する場合は、1-2ページの「PRECAUTION ON REPLACING THE CABINET FRONT」を参照してください。
- Note4: MB N 部品ユニットを交換する場合は、1-2ページの「PRECAUTION ON REPLACING THE CABINET FRONT」を参照してください。

Ver.1.2 2010.07
 The changed portions from
 Ver.1.1 are shown in blue.

**2-1-8. MAIN FRAME SECTION
 (NEX-SA5D/SK6CK/SH)**

na: not supplied

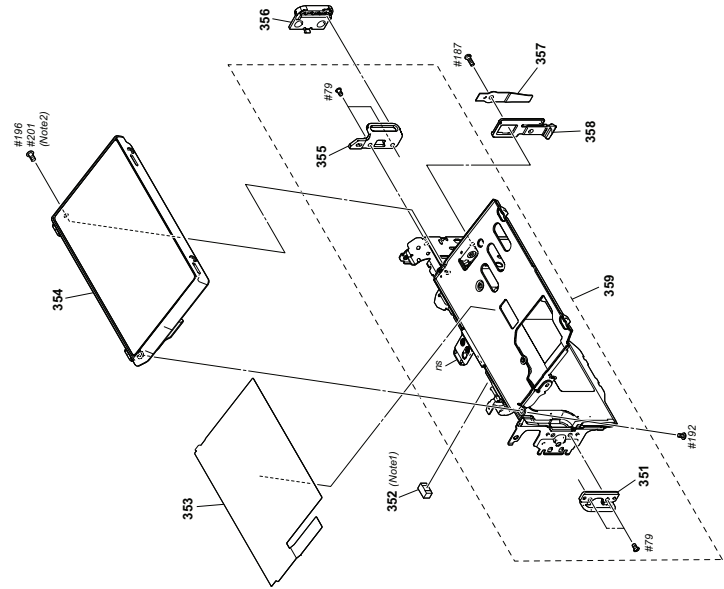

Part No.	Description	Part No.	Description
* 351	4-186-425-01 BRACKET (L) STRAP	358	4-186-437-01 CLAW, BT LOCK
* 352	4-195-258-01 SHAF, CUSHION (MF) (Note1)	359	X-297-935-1 FRAME ASSY
△353	4-196-571-01 SHET, LC LIGHT INTERCEPTION	#79	3-552-451-11 SCREW (M4), NEW TRUSTAR P2
△354	A1774-800-A PANEL BLOCK ASSY (BLACK)	#187	3-236-449-05 SCREW (M4)
△354	A1774-801-A PANEL BLOCK ASSY (SILVER)	#192	4-198-736-01 SCREW (TR 4)
* 355	4-186-424-01 BRACKET (G) STRAP		

Screw

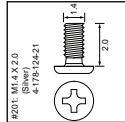
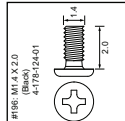
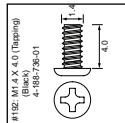
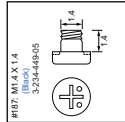
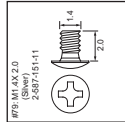

Note

Note1: Refer to "Assembly-8: Shaft Cushion (MF) putting position" when you assemble.

Note2: Refer to "THE COMBINATION OF CABINET'S COLOR AND SCREW (NEX-SA5D/SK6CK/SH)" on page 2-1 about the combination of cabinet's color and screw.

Note1: 組立時は "Assembly-8: Shaft Cushion (MF) putting position" を参照してください。

Note2: キャビネット色とネジの組み合わせについては、2-1 ページの「NEX-SA5D/SK6CK/SH」を参照してください。

Ver.1.2 2010.07
The changed portions from Ver.1.1 are shown in blue.

2-1-9 IMAGER UNIT SECTION
(NEX-5A/5D/5K/5CK/5H)

na: not supplied

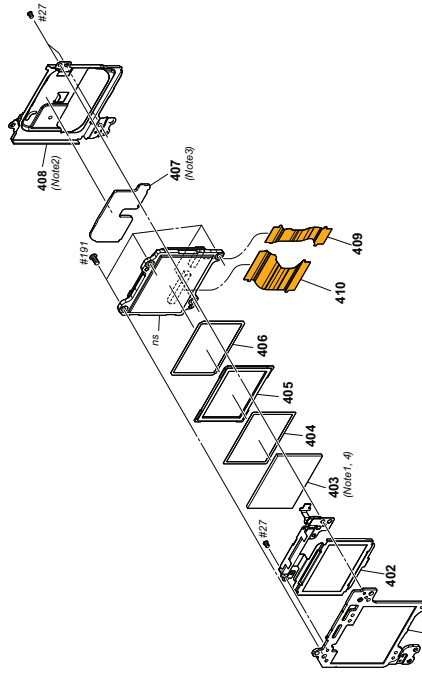

Note2: Refer to "Assembly:2-9. Note when assembling Heat Sink" when you assemble.

Note3: Refer to "Assembly:3-1: Radiation Sheet (S) putting position" when you assemble.

Note4: Refer to "3-2. CLEANING PROCEDURE OF OUPF" on page 3-5 for method of cleaning the OUPF.

Part No.	Description
* 401	4-185-996-01 IM PLATE, IMAGER
402	A-1773-85-A IM PLATE, UNIT, LOWPASS RETAINER
403	4-585-102-11 OPTICAL FILTER BLOCK, (OFL-01-09) (Note 1, 4)
404	4-185-996-01 IM SHEET, SPACER (S)
405	4-185-996-01 IM SHEET, SPACER

Part No.	Description
* 408	4-186-455-01 HEAT SINK (Note2)
409	1-880-963-11 IS-075 FLEXIBLE BOARD
410	1-880-964-11 IS-076 FLEXIBLE BOARD
#27	2-662-398-11 SCREW (M1.4), NEW, TRISTAR P2
#191	4-188-735-01 SCREW (M1.7)

Note2: 組立時は「Assembly:2-9. Note when assembling Heat Sink」を参照してください。

Note3: 組立時は「Assembly:3-1: Radiation Sheet (S) putting position」を参照してください。

Note4: OUPFの清掃方法は「3-2. CLEANING PROCEDURE OF OUPF」を参照してください。

Screw

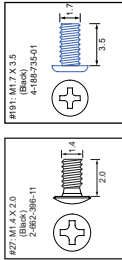

Note

Note1: Refer to the following statements when replacing the Optical filter block.

Method of Removal
(1) Peel off the IM spacer sheet and the Optical filter block by aligning them with the outer shape of the IM spacer sheet evenly.
* Wait for that the adhesive power of the IM spacer fixed tape weakens.
(2) Remove the IM spacer sheet from the imager.

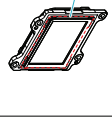

Method of Attachment
(1) Peel off the IM spacer sheet and the Optical filter block by aligning them with the outer shape of the IM spacer sheet evenly.
* The two-layer side of the Optical filter block is on the imager side.
(2) Attach the IM spacer fixed tape by aligning it with the outer shape of the IM spacer sheet evenly.

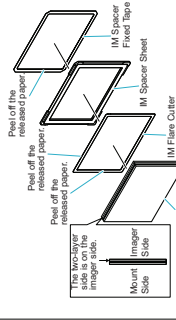

(3) Set the Optical filter block in its attachment jig facing upward.
(4) Press the imager down into the jig as shown below to attach it to the Optical filter block.

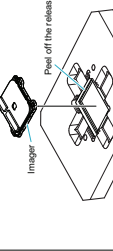

Notes

光學フィルタブロックを交換する際は、下記を参照してください。

取り外し方
(1) IM間隔紙とIM間隔板の間に溶剤アルコールまたはクリーニング剤を流し込み、IM間隔紙固定テープの粘着力が弱くなるのを待ってください。
(2) イメージャーからIM間隔紙を取り外す。

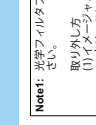

取り付け方
(1) IM間隔紙とイメージャーを揃えて、IM間隔紙の裏面に溶剤アルコールまたはクリーニング剤を流し込み、IM間隔紙固定テープの粘着力が弱くなるのを待ってください。
* 光學フィルタブロックは溶剤がイメージャー側になります。
(2) IM間隔紙に対し、上下左右が揃うようにIM間隔板固定テープを貼り付けます。

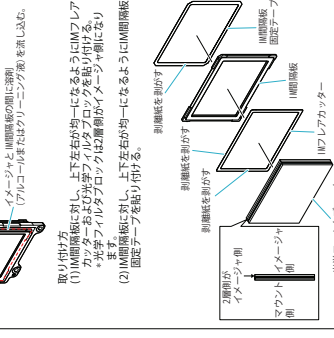

(3) 貼り付けたIM間隔紙固定テープが上になるように、光学フィルタブロックをイメージャーの向きに押し付け、光學フィルタブロックに貼り付ける。



IDENTIFYING PARTS

Follow the disassembly in the given numerical order.

(NEX-3A3D3K)

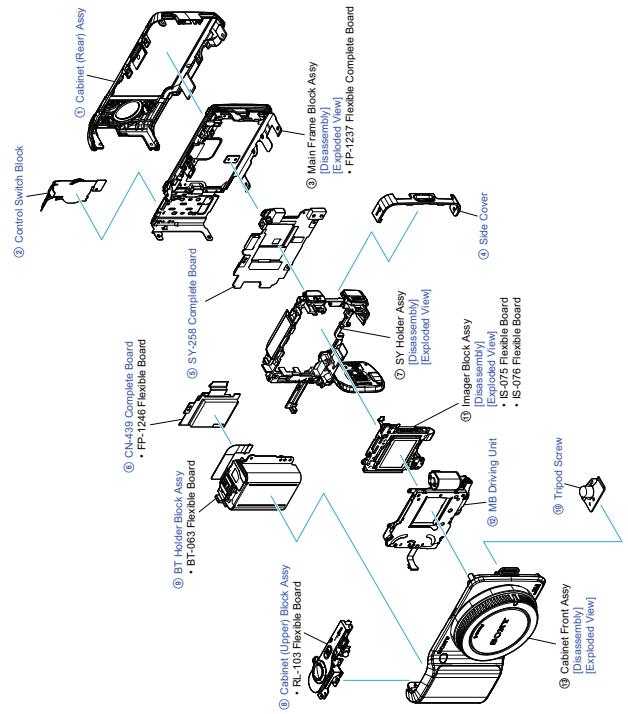

(ENGLISH)

NOTE:

- -XX, -X mean standardized parts, so they may have some differences from the original one.
- Items marked with * are not stocked since they are seldom required for routine service. Some delay may occur when ordering these items.
- The mechanical parts with no reference number in the exploded views are not supplied.
- Due to standardization, replacements in the parts list may be different from the parts specified in the diagrams or the components used on the set.

(JAPANESE)

【取組上の注意】

- -XX, -Xは標準化部品のため、セットに付いている部品と異なる場合があります。
- *印の部品は在庫限り品であり、ご注文の際は納期に遅延が生じる場合があります。
- 図面に記載されている部品は、補修用部品であるため、回路図及びセットに付いている部品と異なる場合があります。

When indicating parts by reference number, please include the board name.

The components identified by mark, * or dotted line with mark, * are critical for safety. Replace only with part number specified.

Les composants identifiés par une marque * ou une ligne pointillée avec une marque * sont critiques pour la sécurité. Remplacez-les uniquement par une pièce portant le numéro spécifié.

Color Indication of Appearance Parts
 (SILVER) : Cabinet's Color
 (Silver) : Parts Color

同色部品の部品を指定するときは株式会社ニセモノを併せて指定してください。
 本印の部品、または点線で示された部品は、安全性を確保するため、必ず指定の部品を使用してください。

例：
 (SILVER) : セットの色を表す。
 (Silver) : 部品の色を表す。

THE COMBINATION OF CABINETS COLOR AND SCREW

This screw pointed * is different according to the cabinet's color.
 For the combination of cabinet's color and screw, please refer to Table 2-2.

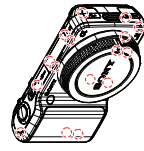
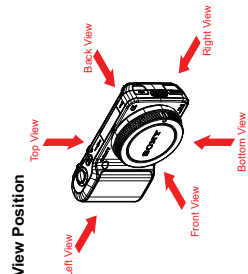

Table 2-2

Screw's Ref. No. (Parts Color.)	Cabinet's Color
#10 (Silver), #207 (Silver)	SILVER, WHITE, PINK
#2 (Black), #596 (Black)	BLACK, RED, BROWN



NOTE FOR REPAIR

- Make sure that the flat cable and flexible board are not cracked or bent at the terminal.
Do not insert the cable insufficiently nor crookedly.
- When remove a connector, do not pull at wire of connector. It is possible that a wire is snapped.
- When installing a connector, do not press down at wire of connector. It is possible that a wire is snapped.
- Do not apply excessive load to the gilded flexible board.

Cut and remove the part of gilt which comes off at the point.
(Be careful that some pieces of gilt may be left inside)



修理時の注意

- フラットケーブルおよびフレキシブル基板の端子面に穴、折れ等がないことを確認する。
また、コネクタへの接続は、差し込み不足や斜め差しにならないように注意する。
- コネクタを取り外す際に、導体部(極間)を持って引っ張ると断線する恐れがありますので、絶縁に導体部(極間)を持って引っ張らないでください。
- 導体部(極間)を挿すときにコネクタを差し込むと、導体部(極間)が断線する恐れがありますので、絶縁に導体部(極間)には負担をかけないようにください。
- 金メッキされているフレキシブル基板には、強い負担をかけないようにください。

先端の割れたメッキ部はカットして除去してください。
(メッキ破片がコネクタ内に残っている場合もあるので注意してください)



Ver.1.4 2010.10
The changed portions from Ver.1.3 are shown in blue.

2-2. EXPLODED VIEWS

2-2-1. OVERALL SECTION (NEX-3A/3D/3K)

ns: not supplied

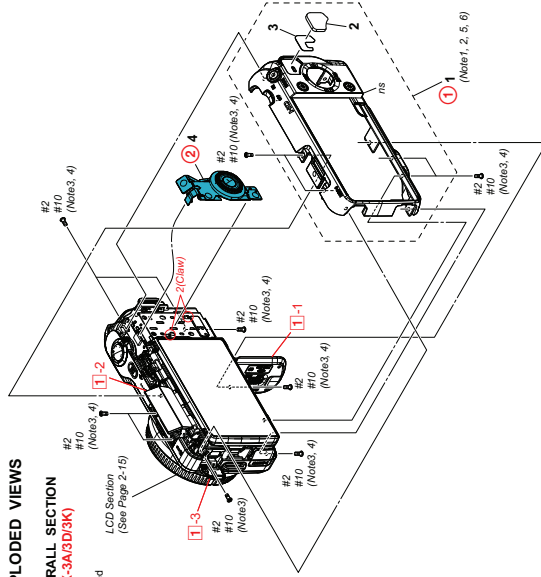

Note4: Refer to "Assembly 7. Screw tightening sequence when assembling the exterior parts (NEX-3A/3D/3K)" when you assemble.

Note5: When assembling or disassembling, keep Power Knob in a position between ON and OFF.

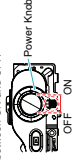

Note6: When assembling or disassembling, loosen the two screws as shown below.



Rfl. No.	Part No.	Description
1	X-2548-25-1	CABINET (REAR ASSY) (2/0B) (BLACK) (Note 1, 2, 5, 6)
1	X-2548-25-1	CABINET (REAR ASSY) (2/1S) (SILVER) (Note 1, 2, 5, 6)
1	X-2548-25-1	CABINET (REAR ASSY) (2/0R) (RED) (Note 1, 2, 5, 6)
1	X-2548-25-1	CABINET (REAR ASSY) (2/0W) (WHITE) (Note 1, 2, 5, 6)
1	X-2580-115-1	CABINET (REAR ASSY) (2/1OP) (PINK) (Note 1, 2, 5, 6)
1	X-2580-118-1	CABINET (REAR ASSY) (2/1BR) (BROWN) (Note 1, 2, 5, 6)

Note4: 組立時は「Assembly 7. Screw tightening sequence when assembling the exterior parts (NEX-3A/3D/3K)」を参照してください。

Note5: 分解・組立時は、パワーノブをON、OFFの中間にしてください。

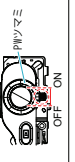

Note6: 分解・組立時は、下記2箇所のビスを緩めてください。



Rfl. No.	Part No.	Description
2	4-190-793-31	GRP (2/10) (REAR) (PINK) (WHITE)
3	4-190-794-01	SHEET (2/10) (REAR GRIP ADHESIVE)
4	1-482-988-12	SWITCH BLOCK CONTROL (BLACK) (BROWN)
4	1-482-988-32	SWITCH BLOCK CONTROL (BLACK) (SILVER)
4	1-482-988-41	SWITCH BLOCK CONTROL (WHITE)

DISASSEMBLY

1. Remove to numerical order (① to ④) in the left figure.

① #2 / #10 X 6 → BT Lid Open (1-1) → #2 / #10 X 1 → Shoe Cover Open (1-2) → #2 / #10 X 4 → USB Cover Open (1-3) → #2 / #10 X 1 → LCD Panel Open

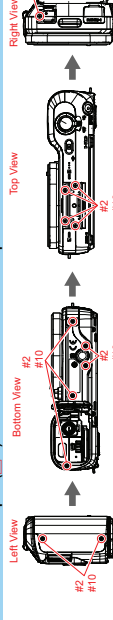

Screw

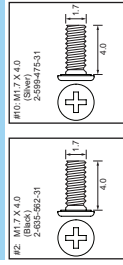

Note

Note1: Perform the following procedures to remove Cabinet (Rear) Assy.

(1) Open LCD at the angle shown below.



(2) Raise the lower part of Cabinet (Rear) Assy, and slide it upward.

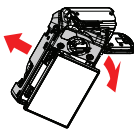

(3) Remove Cabinet (Rear) Assy while turning it in the direction indicated by arrows.

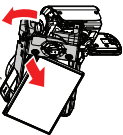

Note1: 後キャビネットAssyを取り外す場合、以下の手順で行ってください。

(1) LCDを下図の角度に開きます。



(2) 後キャビネットAssyの下部を手前へ起こし、後キャビネットAssyを上図へスライドします。

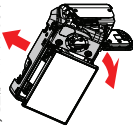

(3) 後キャビネットAssyを矢印の方向に回転させながら、取り外します。

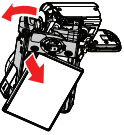

Note2: Refer to "Assembly 1. Method of attachment of Cabinet (Rear) Assy" when you assemble.

Note2: 組立時は「Assembly 1. Method of attachment of Cabinet (Rear) Assy」を参照してください。

2-2-2. LCD SECTION
(NEX-3A(3D/3K))

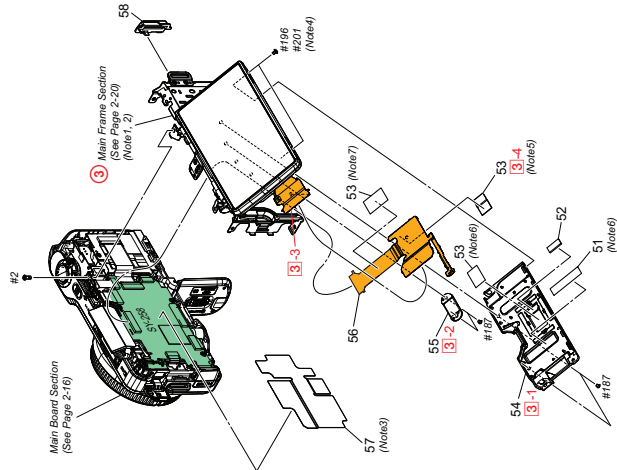

Part No.	Description	Part No.	Description
51	INSULATING SHEET, LC CONNECTOR (N46)	* 58	BASE (G) (210), STRAP (WHITE)
* 52	MANNET (N07.9X2.9X1.2)	* 58	BASE (G) (210), STRAP (PINK)
53	INSULATING SHEET, LC FLEXIBLE (N46(5.6.7))	* 58	BASE (G) (210), STRAP (BROWN)
* 54	REINFORCING SHEET, LC FLEXIBLE (N46)	#2	2-635-962-31 SCREW (M1.7) (N46)
* 55	REINFORCING SHEET, LC FLEXIBLE	#167	3-224-449-05 SCREW (M1.4)
56	FP-1237 FLEXIBLE BOARD, COMPLETE	#196	4-178-124-01 SPECIAL (M1.4 (D2.75)) (RED, BLACK, BROWN) (N46)
57	INSULATING SHEET (SY) (N46)		

DISASSEMBLY

1. Remove to numerical order (3) in the left figure.

③ #187 X 2 → #196 / #201 X 2 → LC Cabinet (Rear) Assy (3-4) → #187 X 2 → LC Flexible Retainer (3-2) → Release LCD Flexible Board (3-3) → Peel off LC Flexible Insulating Sheet (3-4) → #2 / #10 X 1

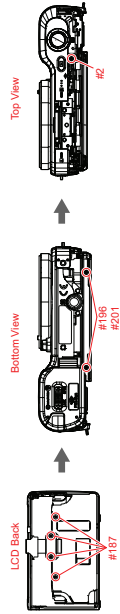

Screw

#2 103.174.0 103.174.0 2-635-962-31	#187 101.4 X 1.4 3-264-449-05	#196 M1.4 X 2.0 4-178-124-01	#201 M1.4 X 2.0 4-178-124-21
--	-------------------------------------	------------------------------------	------------------------------------

Note

- Note1:** To remove Frame Assy, firstly remove LCD Flexible Board and LC Flexible Insulating Sheet, then unfix FP-1237 Flexible Complete Board.
- Note2:** Refer to "Assembly-2: Temporarily secure FP-1237 Flexible Complete Board" when you assemble.
- Note3:** Refer to "Assembly-3: Insulating Sheet A (SY) putting position" when you assemble.
- Note4:** Refer to "THE COMBINATION OF CABINET'S COLOR AND SCREW (NEX-3A(3D/3K))" on page 2-12 about the combination of cabinet's color and screw.
- Note5:** Refer to "Assembly-4: LC Flexible Insulating Sheet putting position" when you assemble.
- Note6:** Refer to "Assembly-5: LC Connector Insulating Sheet, LC Flexible Insulating Sheet putting position" when you assemble.
- Note7:** Refer to "Assembly-9: LC Flexible Insulating Sheet putting position" when you assemble.
- Note8:** To remove LCD Flexion Board, firstly remove LCD Flexible Board and LC Flexible Insulating Sheet, then unfix FP-1237 Flexible Complete Board.
- Note9:** Refer to "Assembly-2: Temporarily secure FP-1237 Flexible Complete Board" when you assemble.
- Note10:** Refer to "Assembly-3: Insulating Sheet A (SY) putting position" when you assemble.
- Note11:** Refer to "THE COMBINATION OF CABINET'S COLOR AND SCREW (NEX-3A(3D/3K))" on page 2-12 about the combination of cabinet's color and screw.
- Note12:** Refer to "Assembly-4: LC Flexible Insulating Sheet putting position" when you assemble.
- Note13:** Refer to "Assembly-5: LC Connector Insulating Sheet, LC Flexible Insulating Sheet putting position" when you assemble.
- Note14:** Refer to "Assembly-9: LC Flexible Insulating Sheet putting position" when you assemble.

Ver.1.4 2010.10
The changed portions from Ver.1.3 are shown in blue.

2-2-3. MAIN BOARD SECTION
(NEX-3A3D/3K)

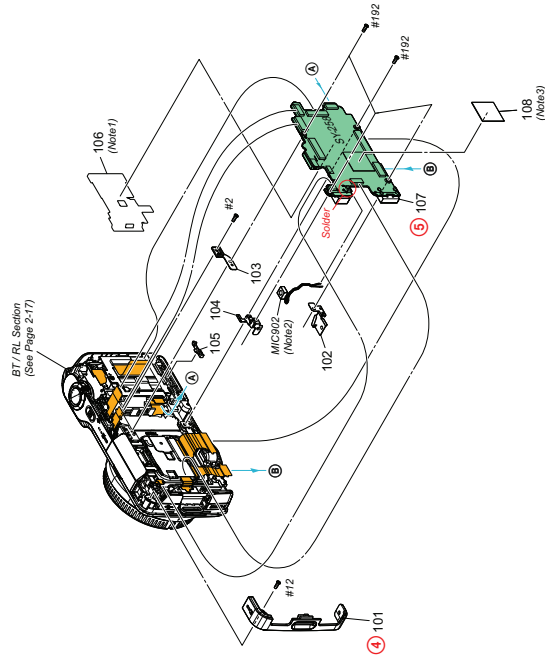

Part No.	Description	Part No.	Description
101	COVER, SIDE (210) (BLACK)	* 105	4190-957-01 LIGHT (MS), GUIDE (210)
101	COVER, SIDE (210) (SILVER)	106	4190-973-01 INSULATING SHEET B (SY) (Note1)
101	COVER, SIDE (210) (RED)	107	A1702-2462A SPS/BOARD COMPLETE (SERVICE SHEET (SY) (210), RADIATION(NBS))
101	COVER, SIDE (210) (PINK)	108	4191-035-01 SHEET (SY) (210), RADIATION(NBS)
101	COVER, SIDE (210) (BROWN)	MIC002	1542-757-51 MICROPHONE UNIT (Note2)

DISASSEMBLY

1. Remove to numerical order (④) to (⑥) in the left figure.

④ #12 X 1

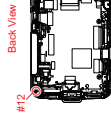

⑤ #192 X 4

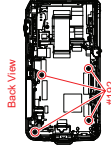

Screw

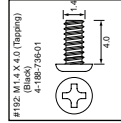
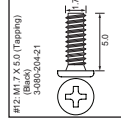
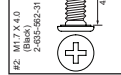

Note

Note1: Refer to "Assembly-10: Insulating Sheet B (SY) putting position" when you assemble.

Note2: Refer to "Assembly-11: Routing of Microphone Harness" when you assemble.

Note3: Refer to "Assembly-18: Radiation Sheet (SY) (210) putting position (NEX-3A3D/3K)" when you assemble.

Note1: 組立時は"Assembly-10: Insulating Sheet B (SY) putting position"を参照してください。

Note2: 組立時は"Assembly-11: Routing of Microphone Harness"を参照してください。

Note3: 組立時は"Assembly-18: Radiation Sheet (SY) (210) putting position (NEX-3A3D/3K)"を参照してください。

2-2-5. IMAGER BLOCK SECTION
 (NEX-3A/3D/3K)

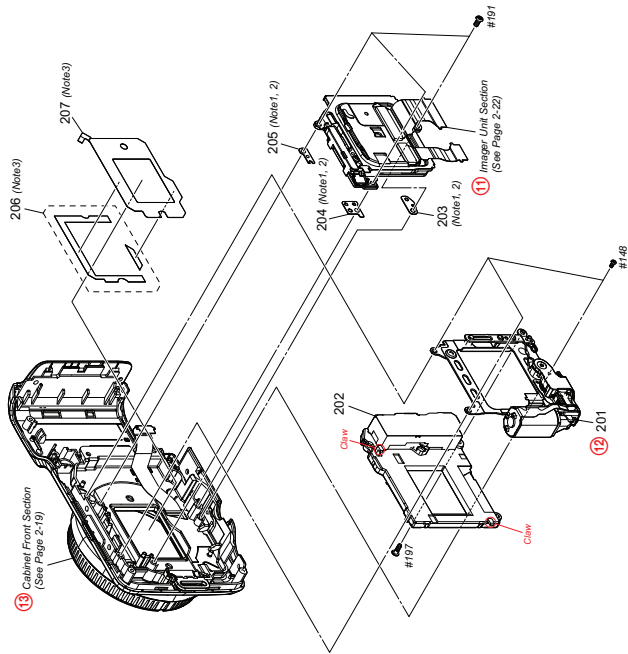

Ref. No.	Part No.	Description
4-201	4-1773-903-A	IM CHARGE UNIT
4-202	1-4872-6-10-11	SHUTTER UNIT (HSA)
* 203	Selection Parts	IM WASHER (C) ADJUST (Note1, 2)
* 204	Selection Parts	IM WASHER (B) ADJUST (Note1, 2)
* 205	Selection Parts	IM WASHER (A) ADJUST (Note1, 2)
Ref. No.	Part No.	Description
#148	3-057-030-21	SCREW (M1.7), NEW TRUSTAR PZ (NEX-3A/3D/3K)
#191	4-186-735-01	SCREW (M1.7)
#197	4-186-990-01	IM SCREW, CHARGE UNIT FIXED

DISASSEMBLY

1. Remove to numerical order (1) to (3) in the left figure.

(1) #191 X 3

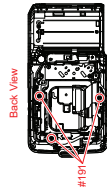

(2) #148 X 3

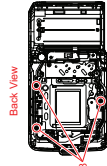

Screw

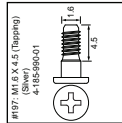
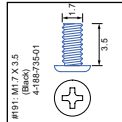

Note

Note1: The type of these parts should be selected when performing adjustments.
 Refer to "2-3. SELECTION PARTS" on page 2-23.

Note1: これらの部品は調整によって種類を選択する必要があります。
 2-23ページの2.3. SELECTION PARTSを参照してください。

Note2: Refer to "Assembly-23: IM Adjust Washer (A, B, C) putting position" when you assemble.

Note2: 組立項目"Assembly-23: IM Adjust Washer (A, B, C) putting position"を参照してください。

Note3: Refer to "Assembly-24: Method of attachment of IM Mask Sheet" when you assemble.

Note3: 組立項目"Assembly-24: Method of attachment of IM Mask Sheet"を参照してください。

Ver.1.4 2010.10

The changed portions from Ver.1.3 are shown in blue.

2-2-6. CABINET FRONT SECTION
(NEX-3A3(D)3(K))

ns: not supplied

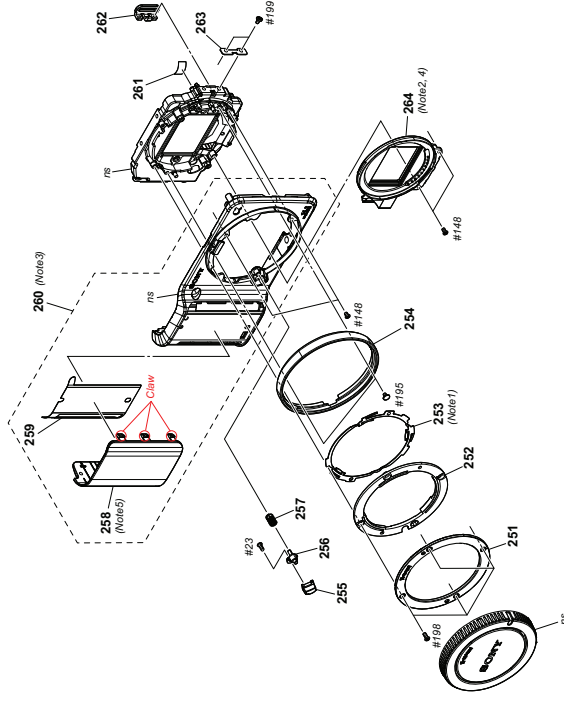

Ref. No.	Part No.	Description	Ref. No.	Part No.	Description
251	4186-696-03	MB N PLATE (A)	280	X-268-233-1	CABINET FRONT ASSY (10B) (BLACK) (No.63)
252	4186-992-01	MB N PLATE (B)	290	X-268-233-1	CABINET FRONT ASSY (20S) (SILVER) (No.63)
253	4186-992-01	MB N PLATE SP (No.6)	290	X-268-234-1	CABINET FRONT ASSY (210F) (RED) (No.63)
254	4189-512-01	RING (210), ORNAMENTAL	280	X-268-235-1	CABINET FRONT ASSY (210W) (WHITE) (No.63)
255	4186-534-01	BUTTON LOCK (BLACK, BROWN)	290	X-268-110-1	CABINET FRONT ASSY (210P) (PINK) (No.63)
255	4186-534-21	BUTTON LOCK (RED)	290	4186-544-01	TAPE (AS 210)
255	4186-534-31	BUTTON LOCK (PINK, WHITE)	* 262	4188-417-01	BRACKET (U) STRAP (210)
255	4186-534-41	BUTTON LOCK (SILVER)	* 263	4183-982-01	WASHER, MF
256	X-2547-507-1	PN ASSY, L LOCK	* 264	A-1773-822-A	MB CONTACT UNIT N (No.62, 4)
257	4186-538-01	SPRING, LENS LOCK	#23	3-090-204-11	SCREW, TAPPING, P2
258	4186-142-01	GRP (210) (BLACK) (No.6)	#148	3-057-082-21	SCREW, TAPPING, P2
258	4186-142-21	GRP (210) (SILVER) (No.6)	#195	3-193-324-01	M1.7X2.5X3GF (DAX0.5)
258	4186-142-31	GRP (210) (RED) (No.6)	4186-545-01	M1.7X4 SPN	
258	4186-142-41	GRP (210) (WHITE) (No.6)			
259	4186-142-41	GRP (210) (PINK) (No.6)			

Screw

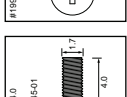
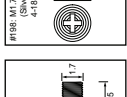
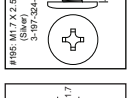
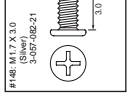
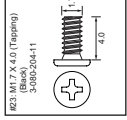

Note

- Note1: Refer to "Assembly-27: Apply grease on MB N Plate SP" when you assemble.
- Note2: Refer to "Assembly-28: MB N Contact Unit holding position" when you assemble.
- Note3: Refer to "PRECAUTION ON REPLACING THE CABINET FRONT" on page 1-1 when replacing Cabinet (Front) Assy.
- Note4: Refer to "PRECAUTION ON REPLACING THE CABINET FRONT" on page 1-1 when replacing MB N Contact Unit.
- Note5: To avoid damaging the claws, remove @BT Frame Assy (210) before removing Grip (210).

- Note1: 組立時は「Assembly-27: Apply grease on MB N Plate SP」を参照してください。
- Note2: 組立時は「Assembly-28: MB N Contact Unit holding position」を参照してください。
- Note3: 本体がボタン Assy を交換する場合は「1-2ページの「PRECAUTION ON REPLACING THE CABINET FRONT」」を参照してください。
- Note4: MB N 部品ユニットを交換する場合は「1-2ページの「PRECAUTION ON REPLACING THE CABINET FRONT」」を参照してください。
- Note5: グリップ(210)を取り外す場合、爪を破損しない為に、分解手順⑥BTフレーム Assy (210)を取り外してから作業を行ってください。

Ver.1.4 2010.10
 The changed portions from
 Ver.1.3 are shown in blue.

**2-2-7. MAIN FRAME SECTION
 (NEX-3A/G/D/3K)**

ns: not supplied

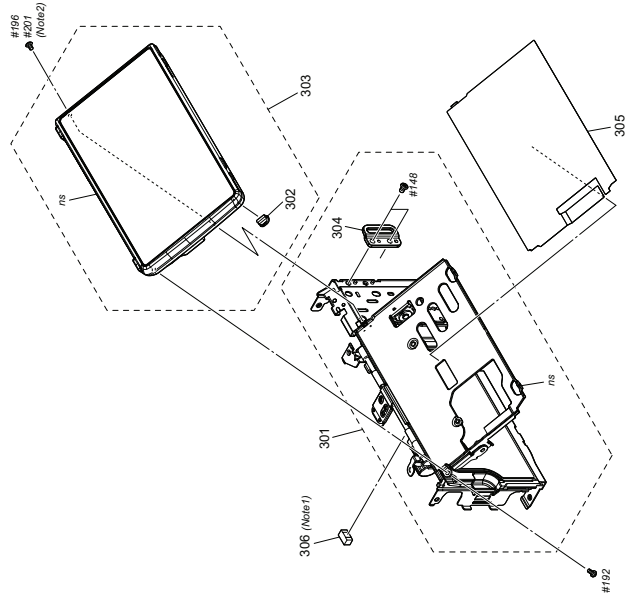

Part No.	Description	Part No.	Description
301	X-2548-25-1 FRAME ASSY (210)	305	4-186-571-01 SHEET, L.C. LIGHT INTERCEPTION
* 302	4-186-555-01 LIGHT (LC), GUIDE	* 306	4-186-258-01 SHFT CUSHION (MF) (Note1)
△ 303	A-1779-68-A PANEL BLOCK ASSY (BLACK)	#198	3-057-082-21 SCREW (M7.1) NEWTRU-STAR PZ
△ 303	A-1779-69-A PANEL BLOCK ASSY (SILVER)	#192	4-186-786-01 SCREW (TP1.4) PZ
△ 303	A-1779-70-A PANEL BLOCK ASSY (RED)	#196	4-178-124-01 SPECIAL (M4, D2.75) (RED, BLACK, BROWN)
△ 303	A-1779-74-A PANEL BLOCK ASSY (WHITE)		

Screw

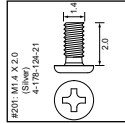
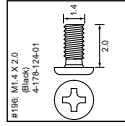
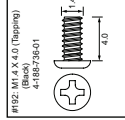
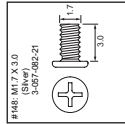

Note

Note1: Refer to "Assembly-8: Shaft Cushion (MF) putting position" when you assemble.

Note2: Refer to "THE COMBINATION OF CABINET'S COLOR AND SCREW COLOR" on page 2-12 about the combination of cabinet's color and screw.

Note1: 組立時は"Assembly-8: Shaft Cushion (MF) putting position"を参照してください。

Note2: キャビネット色とネジの組合わせについては、2-12ページ「キャビネットの色とネジの色との組み合わせ」を参照してください。

Ver.1.4 2010.10
 The changed portions from
 Ver.1.3 are shown in blue.

2-2-8. SY HOLDER SECTION
 (NEX-3A(3D/3K))

na; not supplied

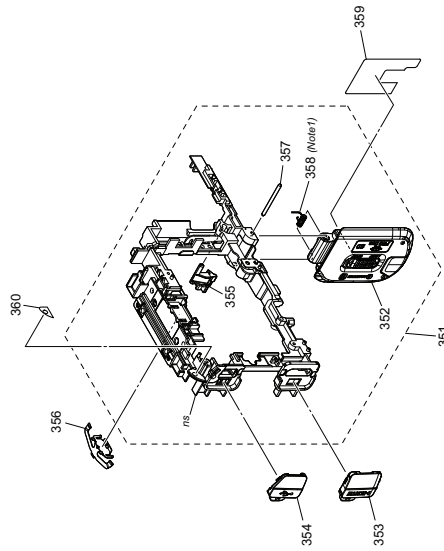

Part No.	Description	Part No.	Description
350	X-2548-275-1 HOLDER ASSY (2108) (BLACK)	353	X-2548-295-1 COVER ASSY (210W), HDMI (WHITE)
351	X-2548-276-1 HOLDER ASSY (210S), SY (SILVER)	353	X-2580-116-1 COVER ASSY (210P), HDMI (PINK)
351	X-2548-277-1 HOLDER ASSY (210R), SY (RED)	353	X-2580-123-1 COVER ASSY (210BR), HDMI (BROWN)
351	X-2548-278-1 HOLDER ASSY (210W), SY (WHITE)	354	X-2548-288-1 COVER ASSY USB (210B) (BLACK)
351	X-2580-111-1 HOLDER ASSY (210P), SY (PINK)	354	X-2548-289-1 COVER ASSY (210S), USB (SILVER)
351	X-2580-119-1 HOLDER ASSY (210BR), SY (BROWN)	354	X-2548-290-1 COVER ASSY (210R), USB (RED)
352	X-2548-655-1 LD ASSY (210E) (SERVICE), BT (BLACK)	354	X-2548-291-1 COVER ASSY (210W), USB (WHITE)
352	X-2548-656-1 LD ASSY (210S) (SERVICE), BT (SILVER)	354	X-2580-115-1 COVER ASSY (210W), USB (PINK)
352	X-2548-657-1 LD ASSY (210R) (SERVICE), BT (RED)	354	X-2580-122-1 COVER ASSY (210BR), USB (BROWN)
352	X-2548-658-1 LD ASSY (210W) (SERVICE), BT (WHITE)	355	4198-98901 CLAMP LOCK (210)
352	X-2580-142-1 LD ASSY (210BR) (SERVICE), BT (BROWN)	* 356	4198-58901 PLATE SHOE COVER
352	X-2580-144-1 LD ASSY (210P) (SERVICE), BT (PINK)	* 357	4198-98901 SHAFT (210), BT LD

Note

Note1: Refer to "Assembly-S. Method of attachment of BT Lid Assy" when you assemble.

Note1: 組立時は"Assembly-S. Method of attachment of BT Lid Assy"を参照してください。

Ver.1.1 2010.07
The changed portions from Ver.1.0 are shown in blue.

2-2-9. IMAGER UNIT SECTION
(NEX-3A(3D/3K))

na: not supplied

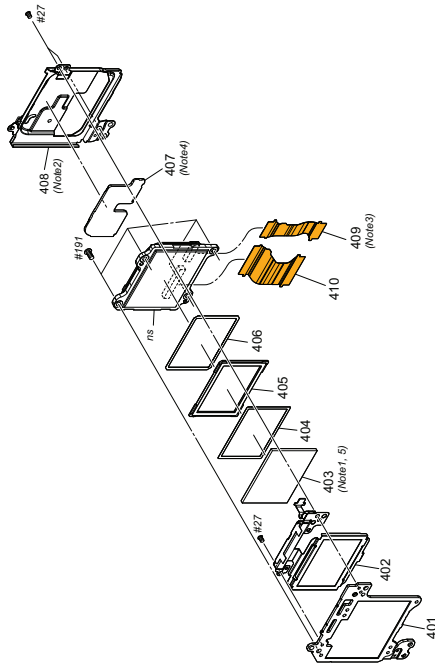

Part No.	Description
* 401	4-185-996-01 IM PLATE, IMAGER
402	A-1773-85-A IM PLATE UNIT, LOWPASS RETAINER
403	E-856-102-11 OPTICAL FILTER BLOCK (OFB-01-09) (Note 1, 5)
404	E-856-102-11 OPTICAL FILTER BLOCK (OFB-01-09) (Note 1, 5)
405	4-185-993-01 IM SHEET, SPACER
406	4-185-996-01 IM PLATE, IMAGER
* 408	4-188-415-01 HEAT SINK (210) (Note2)
409	1-880-963-11 IS-075 FLEXIBLE BOARD (Note3)
410	1-880-964-11 IS-076 FLEXIBLE BOARD (Note4)
#27	2-662-398-11 SCREW (M1.4), NEW, TRISTAR P2
#191	4-188-735-01 SCREW (M1.7)

Part No.	Description
* 408	4-188-415-01 HEAT SINK (210) (Note2)
409	1-880-963-11 IS-075 FLEXIBLE BOARD (Note3)
410	1-880-964-11 IS-076 FLEXIBLE BOARD (Note4)
#27	2-662-398-11 SCREW (M1.4), NEW, TRISTAR P2
#191	4-188-735-01 SCREW (M1.7)

Note2: Refer to "Assembly-29: Note when assembling 'Heat Sink'" when you assemble.

Note3: Refer to "Assembly-29: Prior insertion of IS-075 Flexible Board (NEX-3A(3D/3K))" when you assemble.

Note4: Refer to "Assembly-31: Radiation Sheet (IS) putting position" when you assemble.

Note5: Refer to "3-2. CLEANING PROCEDURE OF OLFP" on page 3-5 for method of cleaning the OLFP.

Screw

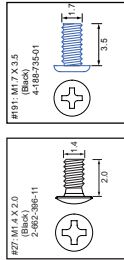

Note

Note1: Refer to the following statements when replacing the Optical filter block.

- Method of Removal
- Four resolvent (alcohol or cleaning agent) between the imager and the IM spacer sheet.
* Wait for that the adhesive power of the IM spacer fixed
 - Remove the IM spacer sheet from the imager.

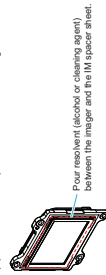

- Method of Attachment
- Attach the IM filter cutter and the Optical filter block by aligning them with the outer shape of the IM spacer sheet evenly.
* The two-layer side of the Optical filter block is on the
 - Attach the IM spacer fixed tape by aligning it with the outer shape of the IM spacer sheet evenly.

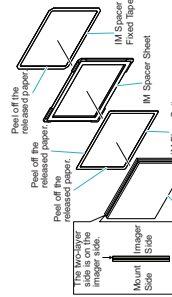

- Set the Optical filter block in its attachment jig (E-692-737-A), with the attached IM spacer fixed tape facing forward.
- Press the imager down into the jig as shown below to attach it to the Optical filter block.

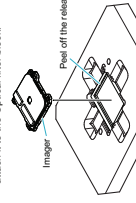

Note1: 光学フィルタブロックを交換する際は、下記を参照してください。

- 取り外し方
- イメージャとIM間隔板の間に溶剤アルコールまたはイメージャとIM間隔板固定テープの接着剤が弱くなるのを待つてください。
 - イメージャからIM間隔板を取り外す。

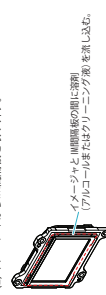

- 取り付け方
- IM間隔板に対し、上下左右が均一になるようにIMプレアッターおよび光学フィルタブロックを貼り付けます。
* 光学フィルタブロックは層側がイメージャ側になり、IM間隔板に対し、上下左右が均一になるようにIM間隔板固定テープを貼り付けます。

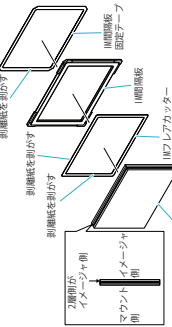

- セットしたIM間隔板固定テープは均一に、光学フィルタブロック取付装置(E-692-737-A)にセットする。
- イメージャを均一に器具に押し付け、光学フィルタブロックに貼り付ける。

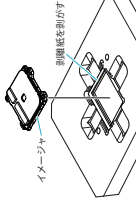

Checking supplied accessories.

Note: This item is supplied with the unit as an accessory, but is not prepared as a service part.

Battery charger
 (E) A-1487-307-11 (U)
 △ A-1487-307-21 (US, CND)
 △ A-1487-307-41 (EXCEPT US, CND, J)

Rechargeable battery pack
 (E) A-1487-307-11 (U)
 △ A-1487-307-21 (US, CND)
 △ A-1487-307-41 (EXCEPT US, CND, J)

USB cable
 E-829-868-31

Conversion (PP) Adaptor
 △ A-1787-305-A (NEX-GH)
 (E (Southeast Asia, Taiwan & Latin Area))

Flash
 A-1774-891-A

Flash case
 A-1787-305-A (NEX-GH)

Shoulder strap
 A-188-859-01

Body cap
 A-188-856-01

Instruction Manual
 (Only for destination Japanese model)
 日本語, 英語, 韓国語, 中国語のみ印刷品提供可能です。
 * 4-188-856-01 (JAPANESE)
 * 4-188-856-02 (ENGLISH)
 * 4-188-856-03 (ITALIAN)
 * 4-188-856-04 (SPANISH, PORTUGUESE)
 * 4-188-856-05 (GERMAN, DUTCH)
 * 4-188-856-06 (SIMPLIFIED CHINESE, TRADITIONAL CHINESE)
 * 4-188-856-07 (ARABIC, PERSIAN)
 * 4-188-856-08 (RUSSIAN)
 * 4-188-856-09 (HINDI)
 * 4-188-856-10 (VIETNAMESE)
 * 4-188-856-11 (POLISH)
 * 4-188-856-12 (CHINESE)

CD-ROM
 - Application Software for α camera
 - α Handbook
 NEX-3A/20iK
 4-191-926-01
 NEX-5A/20iK/GC/GC/iH
 4-191-823-01

α Handbook (PDF)
 * 4-188-856-01 (JAPANESE)
 * 4-188-856-02 (ENGLISH)
 * 4-188-856-03 (ITALIAN)
 * 4-188-856-04 (SPANISH)
 * 4-188-856-05 (GERMAN)
 * 4-188-856-06 (RUSSIAN)
 * 4-188-856-07 (DUTCH)
 * 4-188-856-08 (TRADITIONAL CHINESE)
 * 4-188-856-09 (SIMPLIFIED CHINESE)
 * 4-188-856-10 (ARABIC)
 * 4-188-856-11 (POLISH)
 * 4-188-856-12 (CHINESE)

The CD-ROM supplied contains all of language version of the α Handbook (PDF) for printing.
 * The printed matter is not supplied. If required, please order it with the part number below.
 日本語版については日本語のみ印刷品の部品提供可能です。

α Handbook (PDF)
 * 4-188-856-01 (JAPANESE)
 * 4-188-856-02 (ENGLISH)
 * 4-188-856-03 (ITALIAN)
 * 4-188-856-04 (SPANISH)
 * 4-188-856-05 (GERMAN)
 * 4-188-856-06 (RUSSIAN)
 * 4-188-856-07 (DUTCH)
 * 4-188-856-08 (TRADITIONAL CHINESE)
 * 4-188-856-09 (SIMPLIFIED CHINESE)
 * 4-188-856-10 (ARABIC)
 * 4-188-856-11 (POLISH)
 * 4-188-856-12 (CHINESE)

2-3. SELECTION PARTS

Ref. No.203

Select the optimum thickness of washer.

Part No.	Description
4-188-998-01	M WASHER (C), ADJUST (f=0.05)
4-188-998-02	M WASHER (C), ADJUST (f=0.1)
4-188-998-03	M WASHER (C), ADJUST (f=0.15)
4-188-998-04	M WASHER (C), ADJUST (f=0.2)
4-188-998-05	M WASHER (C), ADJUST (f=0.25)
4-188-998-06	M WASHER (C), ADJUST (f=0.3)
4-188-998-07	M WASHER (C), ADJUST (f=0.35)
4-188-998-08	M WASHER (C), ADJUST (f=0.4)
4-188-998-09	M WASHER (C), ADJUST (f=0.45)
4-188-998-10	M WASHER (C), ADJUST (f=0.48)

Ref. No.204

Select the optimum thickness of washer.

Part No.	Description
4-188-998-01	M WASHER (B), ADJUST (f=0.05)
4-188-998-02	M WASHER (B), ADJUST (f=0.1)
4-188-998-03	M WASHER (B), ADJUST (f=0.15)
4-188-998-04	M WASHER (B), ADJUST (f=0.2)
4-188-998-05	M WASHER (B), ADJUST (f=0.25)
4-188-998-06	M WASHER (B), ADJUST (f=0.3)
4-188-998-07	M WASHER (B), ADJUST (f=0.35)
4-188-998-08	M WASHER (B), ADJUST (f=0.4)
4-188-998-09	M WASHER (B), ADJUST (f=0.45)
4-188-998-10	M WASHER (B), ADJUST (f=0.48)

Ref. No.205

Select the optimum thickness of washer.

Part No.	Description
4-188-998-01	M WASHER (A), ADJUST (f=0.05)
4-188-998-02	M WASHER (A), ADJUST (f=0.1)
4-188-998-03	M WASHER (A), ADJUST (f=0.15)
4-188-998-04	M WASHER (A), ADJUST (f=0.2)
4-188-998-05	M WASHER (A), ADJUST (f=0.25)
4-188-998-06	M WASHER (A), ADJUST (f=0.3)
4-188-998-07	M WASHER (A), ADJUST (f=0.35)
4-188-998-08	M WASHER (A), ADJUST (f=0.4)
4-188-998-09	M WASHER (A), ADJUST (f=0.45)
4-188-998-10	M WASHER (A), ADJUST (f=0.48)

3. ASSEMBLY

Assembly-1: Method of attachment of Cabinet (Rear) Assy
Open the LCD as shown below.

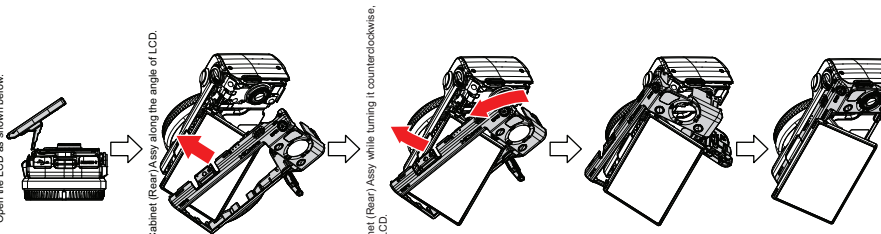

Fit the Cabinet (Rear) Assy along the angle of LCD.

Incline Cabinet (Rear) Assy while turning it counterclockwise, then fit it in LCD.

Assembly-2: Temporarily secure FP-1237 Flexible Complete Board
Before assembling Frame Assy, temporarily secure FP-1237 Flexible Complete Board.

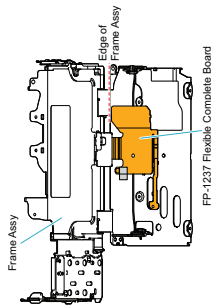

Assembly-3: Insulating Sheet A (SY) putting position

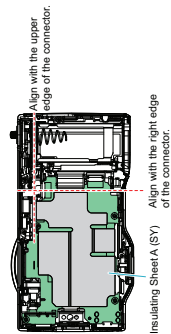

Assembly-4: LC Flexible Insulating Sheet putting position

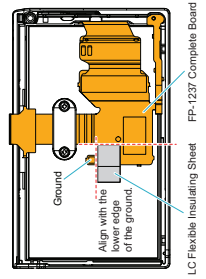

Assembly-5: LC Connector Insulating Sheet, LC Flexible Insulating Sheet putting position

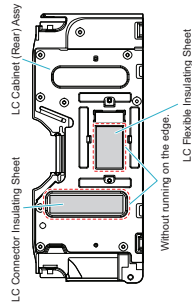

Assembly-6: Method of attachment of BT Lid Assy

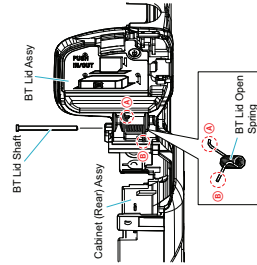

Assembly-7: Screw tightening sequence when assembling the exterior parts (NEX-3A/3D/3K)

Tighten the four screws in sequence of 1 to 4 as shown below.

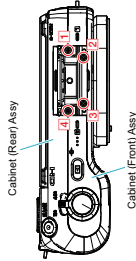

Tighten the two screws in sequence of 1 to 2 as shown below.

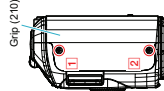

Tighten the five screws in sequence of 1 to 5 as shown below.

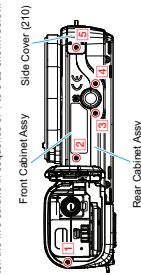

Assembly-8: Shaft Cushion (MF) putting position

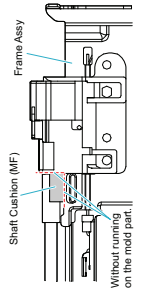

Without running on the mold part.

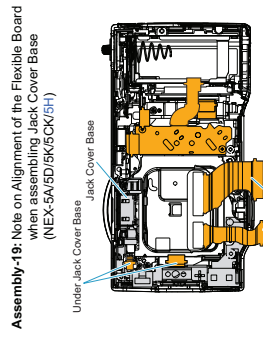
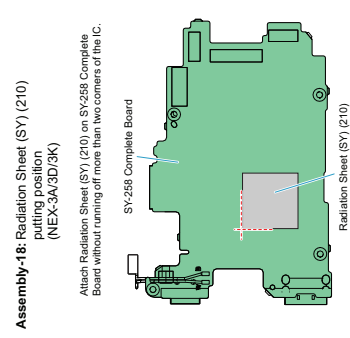
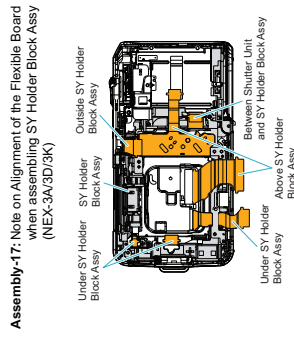
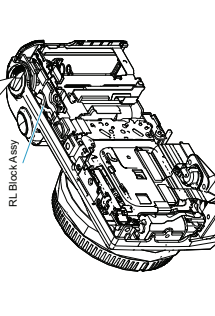
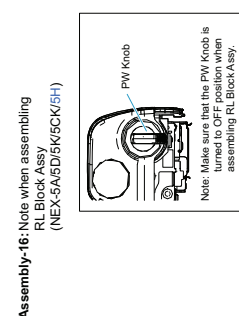
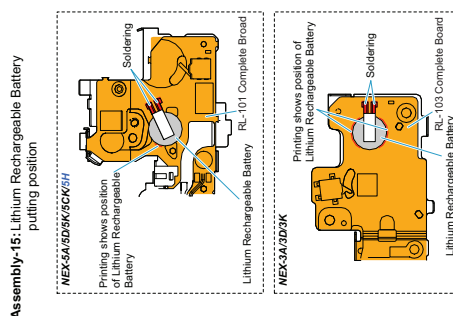
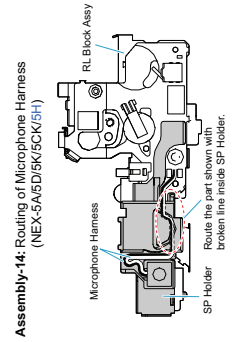
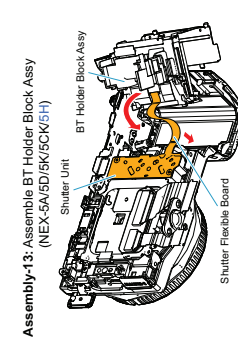
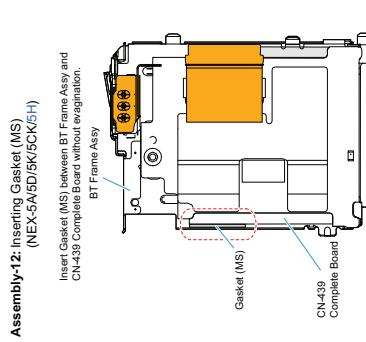
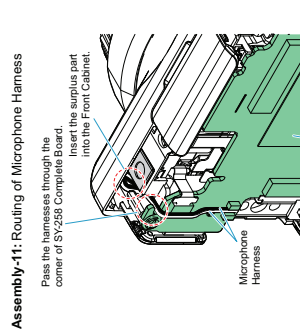
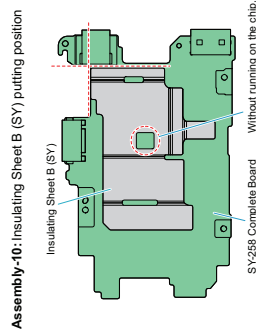
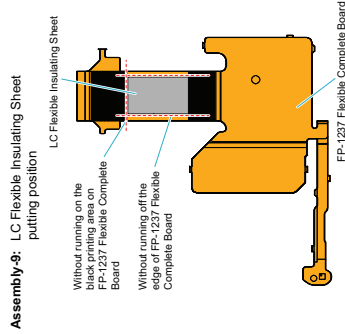

**Assembly-20: Routing of Microphone Harness
 (NEX-3A/3D/3K)**

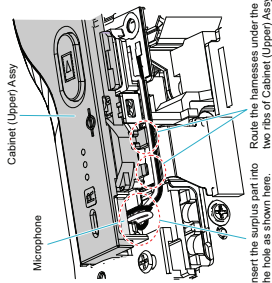

Route the harness under the two ribs of Cabinet (Upper) Assy.
 Insert the surplus into the hole as shown here.

**Assembly-21: Assemble Cabinet (Upper) Assy
 (NEX-3A/3D/3K)**

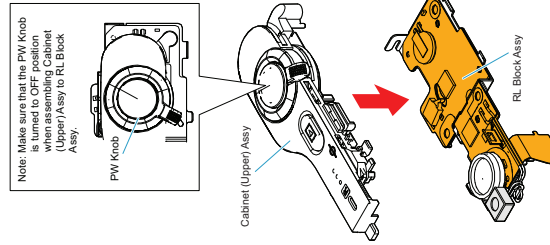

Note: Make sure that the PW Knob is turned to OFF position when assembling Cabinet (Upper) Assy to RL Block Assy.

**Assembly-22: Radiation Sheet (CN) (210)
 putting position
 (NEX-3A/3D/3K)**

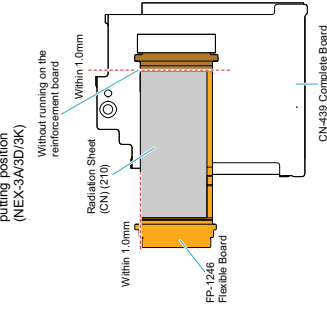

**Assembly-23: IM Adjust Washer (A, B, C)
 putting position**

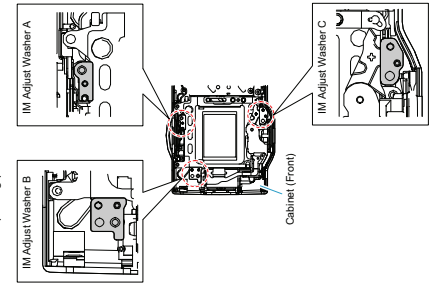

Assembly-24: Method of attachment of MB Mask Sheet

Note: There should not be any misalignment when attaching MB Mask Sheet.

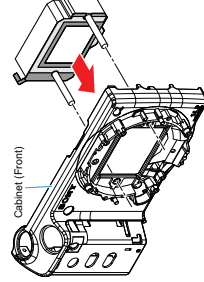
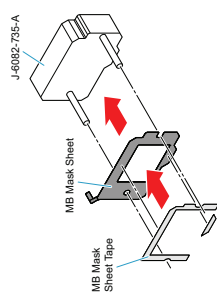

**Assembly-25: BT Slider Sheet (front) putting position
 (NEX-5A/5D/5K/5CK/5H)**

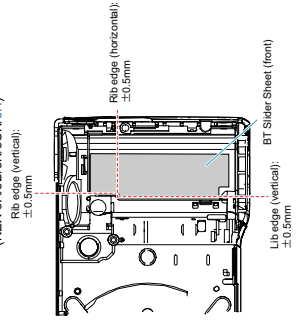

**Assembly-26: BT Slider Sheet (horizontal)
 putting position
 (NEX-3A/5D/5K/5CK/5H)**

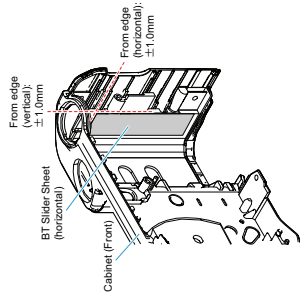

Assembly-27: Apply grease on MB N Plate SP

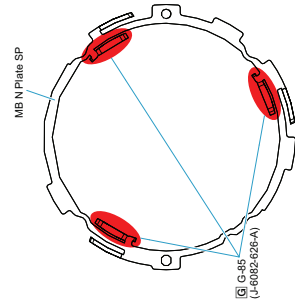

Ver.1.2 2010.07
 The changed portions from
 Ver.1.1 are shown in blue.

Assembly-28: MB N Contact Unit holding position

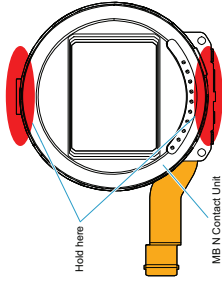

Assembly-29: Note when assembling Heat Sink

Align with the positioning hole.

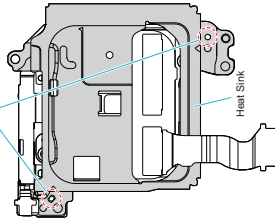

Assembly-30: Prior insertion of IS-075 Flexible Board (NEX-3A/3D/3K)

Insert IS-075 Flexible Board into the connector on IM Imager Unit 14M, then lock the connector.

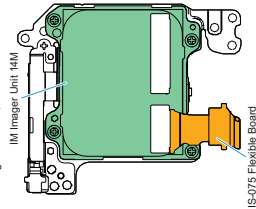

Assemble Heat Sink and IM Imager Unit 14M.

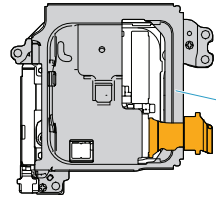

Note: IS-075 Flexible Board cannot be inserted after assembling Heat Sink.

Assembly-31: Radiation Sheet (IS) putting position

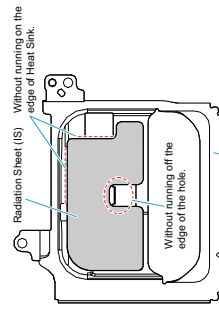

Assembly-32: How to handle the Shutter Flexible Board (NEX-3A/3D/3K)

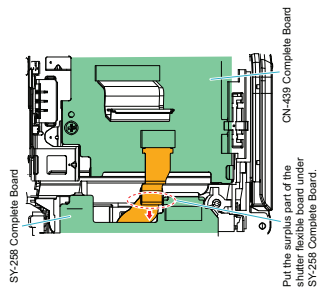

Assembly-33: LC Connector Insulating Sheet putting position

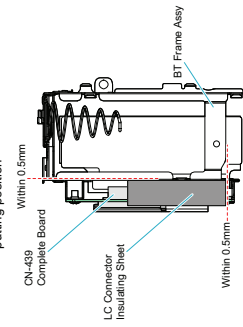

Assembly-34: Tape AS (Z10) putting position (NEX-5A/5D/5K/5CK/5H)

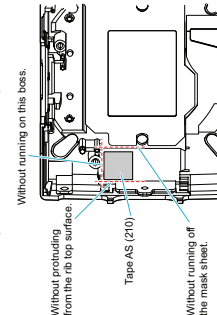

Assembly-35: Method of attachment of LC Flexible Insulating Sheet (NEX-3A/3D/3K)

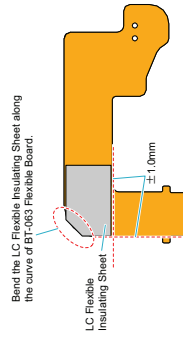

3-2. CLEANING PROCEDURE OF OLPF

<Preparation for Remedy>

If you use the jig (J-6082-635-A) below, make sure to clean the CCD Cleaning Jig (Tip) below before using, please.
Note Protection sheet is for preventing the scratch of a surface on the jig (Tip).
 The protection sheet may be come off the jig when you take the jig from a bag, but it is no problem.

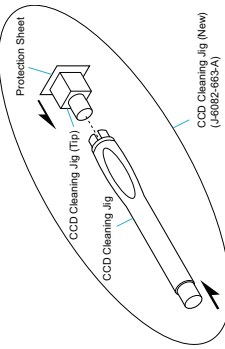

<Cleaning Procedure for Tip of CCD Cleaning Jig>

- Put the two cleaning cloths on a tray like below.
 - Soak the one cleaning cloth in ethyl alcohol.
 - Put the other cleaning cloth on a tray as it is dry.
- Dab the tip of CCD cleaning jig at the cleaning cloth of ① 5 or 6 times.
- Dab the tip from right to left or up and down while dabbing.
 - Do not slide from right to left or up and down while dabbing.
 - Do not slide from left to right or up and down while dabbing.
- Wait until the tip will be dried completely.

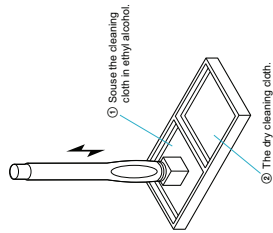

<Cleaning Procedure for the OLPF>

- Clean up the tip of CCD cleaning jig.
- Dab the tip of CCD cleaning jig at the OLPF, and pull up straight.
 - * Do not slide from right to left or up and down while dabbing.
- Repeat "3" several times to clean up.
- According to service manual, check if there is dirt on the CCD.

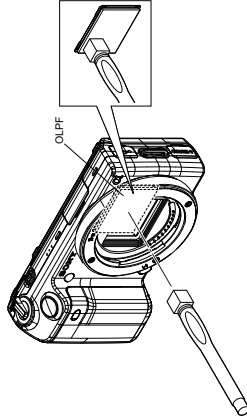

<ATTENTION>

If you cannot remove dirt with remedy above, cleaning by the following jig are used.
 Soak a small amount of EE3310 (Liquid cleaner) after wrapping the cleaning cloth (J-6082-635-A) around the cleaning jig (J-6082-635-A).

