

7. Exploded Views and Parts List

7-1 Exploded Views

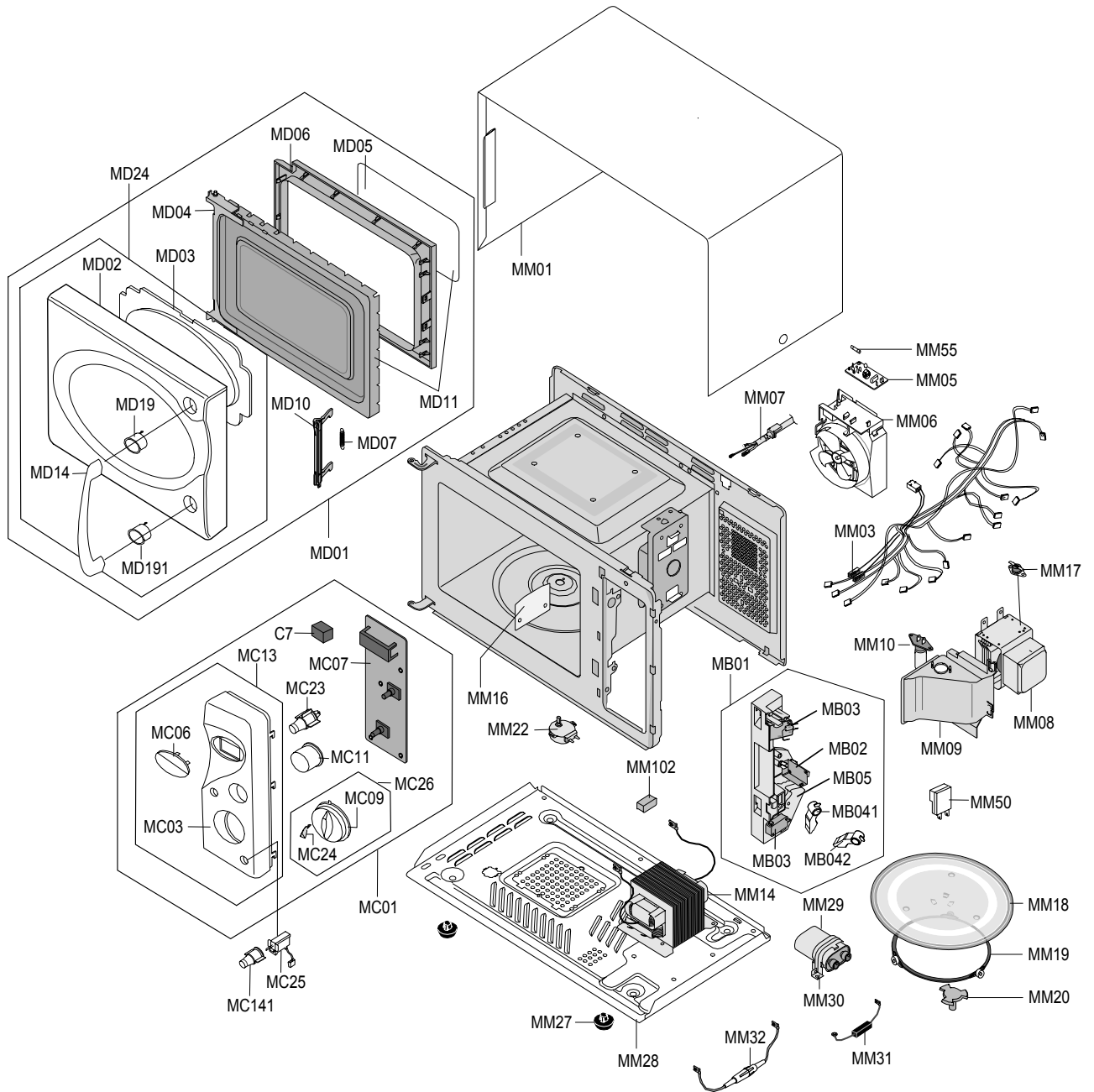

7-2 Main Parts List

No.	Code No.	Description	Specification	Q'ty	Remark
MB01	DE96-00120B	ASSY BODY LATCH	M1717N,NC2000(HANDLE)	1	
MB02	3405-000175	SWITCH-MICRO	250V,15A,200gf,SPST-NO	1	
MB03	3405-000178	SWITCH-MICRO	250V,15A,200gf,SPST-NO	2	
MB041	DE66-00093A	LEVER-SWITCH(A)	NC2000,PP-TH53,NTR,HANDLE	1	
MB042	DE66-00094A	LEVER-SWITCH(B)	NC2000,PP-TH53,-,-,-,NTR,HANDLE	1	
MB05	DE72-00137A	BODY-LATCH	NC2000(0.6/0.8/1.2),PP,WHT,-	1	
MM01	DE70-00011S	PANEL-OUTER	NC-2000,SECC,T0.6,W360,L1128,-,EPOXY-COATING	1	
MM03	DE39-00165B	WIRE HARNESS-A	M1927,230V50HZ,-,-,-,-	1	
MM05	DE96-00010A	ASSY NOISE FILTER	SN-3WED,250V10A,3W NO-INRUSH TC,-,-,-,-	1	
MM06	DE96-00070A	ASSY-MOTOR FAN	SMF-2N2EA1,230V50Hz,2420RPM,2N2,9mm	1	
MM07	DE39-00224B	ASSY POWER CORD	M1933,-,KDK-4819D,250V10A,1.0mm/3C,GRY,-,VDE,-	1	
MM08	OM75P(31)ESS	ASSY-MAGNETRON:OM75P		1	
MM09	DE71-60458A	COVER-AIR	3RD-1.0/1.3 MW5896W,PP(TB53),78g,WHT,-,-,-	1	
MM10	4713-001031	LAMP-INCANDESCENT	230V,173mA,40W,ORG,-,-,25x69mm	1	CV/AIR
MM102	DE63-00058A	CUSHION-HVT	3rd-1.0 VE,CR-SPONGE,T22,W22,L25,BLK,-	1	H.V.T
MM14	DE26-00063A	TRANS-H.V	SHV-E2914A,230V,50HZ,2340V/3.45V,-,-,H,-	1	
MM16	DE71-00015A	COVER-CEILING	CE2933,-,T0.3,W114.2,L121.5,-,-,CE2933	1	
MM17	DE47-20033A	THERMOSTAT	PW-2N,80/70,125V15A/250V7.5A,1	1	CAVITY
MM18	DE74-20015G	TRAY-COOKING	-,T6,-,-	1	
MM19	DE92-90189Z	ASSY-GUIDE ROLLER	3RD-1.0CUFT,SPS(C832) BROWN,D14.7,-	1	
MM20	DE67-60081A	COUPLER	PPS,-,-,BROWN,3RD-1.0/1.3,-	1	
MM22	DE31-10154A	MOTOR-SYNCHRONOUS	M2HJ49ZR02,ST-16,50/60HZ,-	1	
MM27	DE61-40066A	FOOT	-,PP,-,BLK,-,-,-	2	
MM28	DE80-10001N	BASE-PLATE	3RD(1.0-NEW),-,T0.8,W345,L565,-,CMO-VE	1	
MM29	2501-001015	C-OIL	1.0uF,2100V,BK,35X54X80,20mm	1	
MM30	DE61-50106A	BRACKET-HVC	-,SECC,T0.8,W31,L125.8,-,-	1	
MM31	DE91-70063A	ASSY-HVD	V2M6,PI9.0,0.05MT,-,-	1	
MM32	DE91-70061A	ASSY-H.V.FUSE	THV060T-0800-H,5KV/0.80A,WHT	1	
MM50	DE27-10020C	COIL-CHOKE	TC-104,0.9UH*2,-,L31*W20*H32,-,ABS,AC250V/14	1	
MM55	3601-000448	FUSE-CARTRIDGE	250V,10A,SLOW-BLOW,CERAMIC,6.35x31.8mm	1	

7-3 Control & Door Parts List

No.	Code No.	Description	Specification	Q'ty	Remark
MC01	-	ASSY CONTROL-BOX	-,M1927N/XEN,P/WHT,-	1	S.N.A
MC03	DE72-00083M	CONTROL-PANEL	M1927N/XEN,ABS,-,-,-,P-WHT,-	1	
MC06	DE64-00095A	WINDOW-DISPLAY	SAN,-,M1727/M1927,-	1	
MC07	RC-EASY4R-08	ASSY PCB PARTS:M1927		1	
MC09	DE64-00097A	KNOB-POWER	ABS,-,M1727/M1927,-,POWER,-,-,-	1	
MC11	DE64-00096A	KNOB-TIMER	ABS,-,M1727/M1927,-,-,-,-	1	
MC13	DE94-00303M	ASSY CONTROL-PANEL	-,M1927N/XEN,P-WHT,ABS	1	
MC141	DE66-00009A	BUTTON-SELECT(A)	M1914,ABS,-,-,-,WHT,3g,M1914,D10	1	
MC23	DE64-00100A	BUTTON-CLOCK	ABS,-,M1727/M1927,CLOCK	1	
MC24	DE64-00113A	KNOB-CAP	ABS,C-BLUE,-,M1727/M1927,-,-,-,-	1	
MC25	DE39-00059A	WIRE HARNESS-SWITCH	-,230V50HZ,T/TABLE S/W,-,M1914,EUROPE	1	
MC26	DE97-00165A	ASSY-KNOB POWER	M1727,POSERKJEON,WHT+BLU,-	1	
MD01	-	ASSY DOOR	M1927N/XEN,P/WHT,NC2000	1	S.N.A
MD02	DE64-00098A	DOOR-A	ABS,-,-,-,P-WHT,M1928,-,-,-	1	
MD03	DE63-00018A	SCREEN-DOOR	SAN,-,-,-,SMOG,M1928,-	1	
MD04	DE94-00075B	ASSY DOOR-E	3RD-1.0,BLK,COATING,-,-,-,-	1	
MD05	DE01-00118A	FILM-DOOR		1	
MD06	DE64-40012A	DOOR-C	RESIN-PP(TB53),T2.0,CE945GF,BL	1	
MD07	DE61-00199A	SPRING-KEY	M1977,HSWR,D6,-,-,25 1/4,-,T0.7,-,-,NC2000(1.0)	1	
MD10	DE64-00264A	DOOR-KEY	3RD-W NEW,POM,-,BLK,-,-,-	1	
MD11	DE94-00073B	ASSY DOOR-SUB	3RD-1.0,MW5897G,BLK,-,-,-,-	1	
MD14	DE64-00099C	HANDLE-DOOR	M1927/M1727,ABS,-,-,-,P/WHT,-	1	
MD19	DE64-00093D	HANDLE-RING(A)	M1927/M1727,ABS(HR0370),-,-,-,-,P/WHT,-	1	
MD191	DE64-00094D	HANDLE-RING(B)	M1927/M1727,ABS(HR0370),-,-,-,-,P/WHT,-	1	
MD24	DE94-00302G	ASSY DOOR-A	CE2927/XET,P-WHT,HANDLE+H/RING+DOOR-A	1	

S.N.A : SERVICE NOT AVAILABLE

7-4 Standard Parts List

Code No.	Description	Specification	Q'ty	Remark
DE60-10012A	SCREW-TAP TITE	-,SWR10,M4,L10,TH,+,-,3,ZPC2,-	1	N/F-EAR
DE60-10012A	SCREW-TAP TITE	-,SWR10,M4,L10,TH,+,-,3,ZPC2,-	1	P/C-EAR
DE60-10063A	SCREW-TAP TH	-,FEFN,-,TH,M4,-,L12,-,-	1	P/OUT
DE60-10080B	SCREW-WASHER	-,2S,SWRCH18A,ZP2,PH,PI5,-,L10,-,-	4	MGT
DE60-10080B	SCREW-WASHER	-,2S,SWRCH18A,ZP2,PH,PI5,-,L10,-,-	4	TNS-HV
DE60-10082H	SCREW-A	-,,-,-,2S-4X12,TOOTHED,-,-,-,-	3	B-PLTE
DE60-10082H	SCREW-A	-,,-,-,2S-4X12,TOOTHED,-,-,-,-	2	BD-LAT
DE60-10082H	SCREW-A	-,,-,-,2S-4X12,TOOTHED,-,-,-,-	2	CN-BOX
DE60-10082H	SCREW-A	-,,-,-,2S-4X12,TOOTHED,-,-,-,-	1	CV/AIR
DE60-10082H	SCREW-A	-,,-,-,2S-4X12,TOOTHED,-,-,-,-	2	MO/FAN
DE60-10082H	SCREW-A	-,,-,-,2S-4X12,TOOTHED,-,-,-,-	5	PN/OUT
DE60-10082H	SCREW-A	-,,-,-,2S-4X12,TOOTHED,-,-,-,-	2	TCO
DE60-10098A	SCREW-ASSY TAP TITE	-,GLD,SWRCH18A,ZPC2,PH,TC,-,M4X8,WT,-	2	M/DRV
DE60-10122A	SCREW-TAP TH	-,FE,FN,TAP,TH,-,2-4X8,-,-	2	C/CEILING
DE60-10088A	SCREW-TAP PH	-,FEFZY,PLAIN,PH,M3,-,L8,-,-	7	
DE60-10069A	SCREW-TAP TH	-,FRFZY,-,TH,M4,-,L10,-,-	2	HANDLE
DE60-10098A	SCREW-ASSY TAP TITE	-,GLD,SWRCH18A,ZPC2,PH,TC,-,M4X8,WT,-	1	
DE60-10012A	SCREW-TAP TITE	-,SWR10,M4,L10,TH,+,-,3,ZPC2,-	1	