

5-8. LE46B65* Exploded View

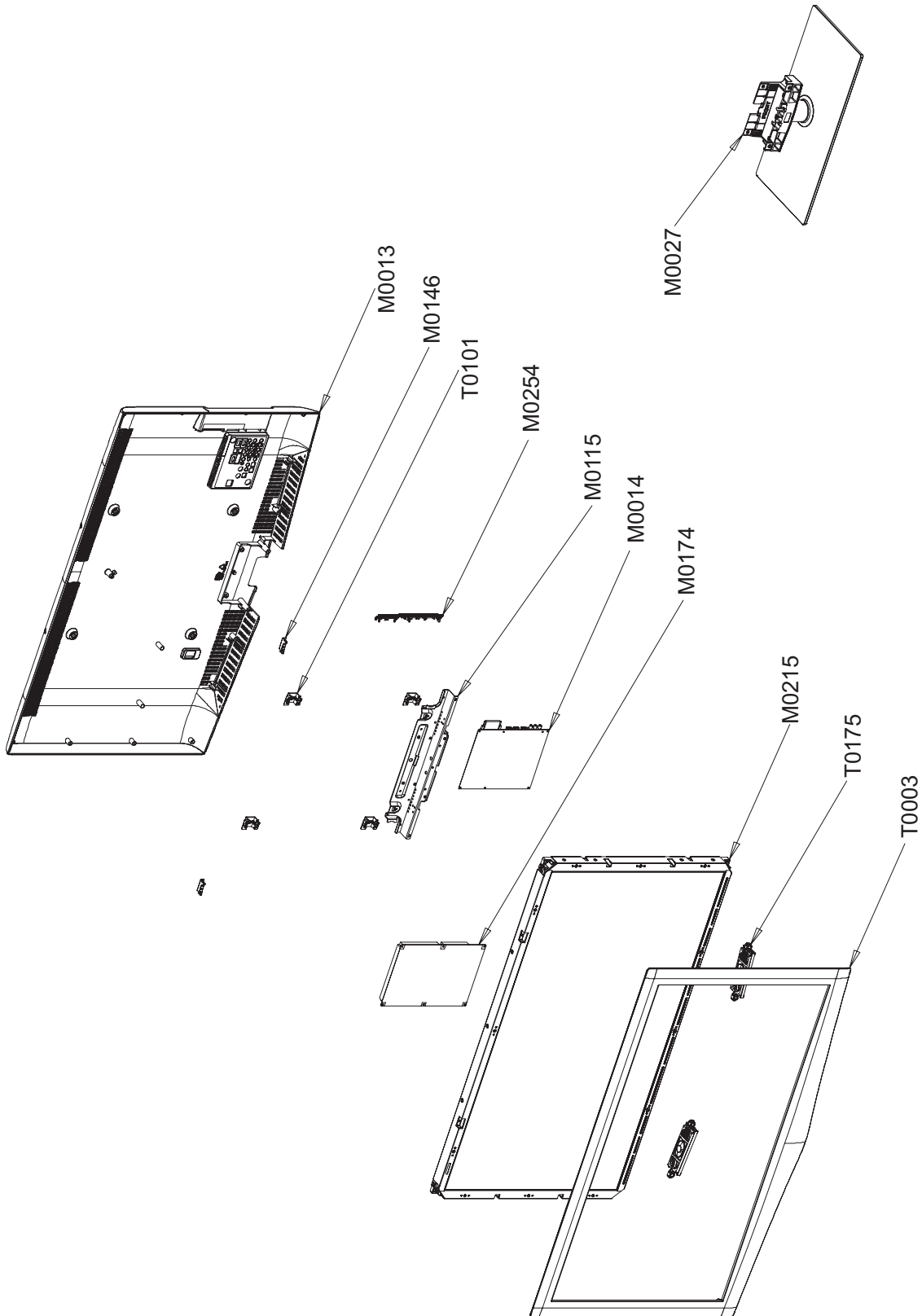

5-8-1. LE46B65* Parts List

Location No.	Code No.	Description & Specification	Q'ty	S.A/S.N.A	Remark
T0003	BN96-09490B	ASSY COVER P-FRONT;46,LB650,EO,PC(CLR)+P	1	S.A	
M0215	BN07-00666A BN07-00655A	LCD-PANEL;T460HW03 V8,12V,AMVA 72%	1	S.A	
T0175	BN96-09463D	ASSY SPEAKER P;8ohm,4pin,10W,R:250/ L:70	1	S.A	
M0115	BN61-04788A	BRACKET-STAND LINK;46, B610,SECC,T2.0	1	S.N.A	
M0174	BN44-00265A	IP BOARD;PSIV281609A,I46F1_9SS,0.1mA,10.	1	S.A	
T0101	BN61-04817A	BRACKET-WALL;46, B610,SECC,T1.6	4	S.N.A	
M0146	BN61-04818A	BRACKET-PANEL TOP;B650-32,SECC,T1.2	2	S.N.A	
M0014	BN94-02583D	ASSY PCB MAIN;LE46B653T5WXXC	1	S.A	
M0254	BN61-04800A	HOLDER-SIDE AV;EO,ABS+PMMA,HB,BK23,H/GLO	1	S.N.A	
M0013	BN96-09508A	ASSY COVER P-REAR;46,LB650,EO,ABS+PMMA,H	1	S.A	
M0027	BN96-09501A	ASSY STAND P-BASE;46,LB650,TEMPERED GLAS	1	S.A	