

5. REPAIR PARTS LIST

5-1. EXPLODED VIEWS

5-1-1. OVERALL SECTION

DISASSEMBLY

HARDWARE LIST

Note: When you exchange CABINET (L), SERVICE be sure to read "1-6. PRECAUTION ON REPLACING THE CABINET (L)" on page 1-4.

Note: サービス用キャビネット (L) 交換時は1-10ページの "1-6.キャビネット (L) 交換時の注意" を必ずお読みください。

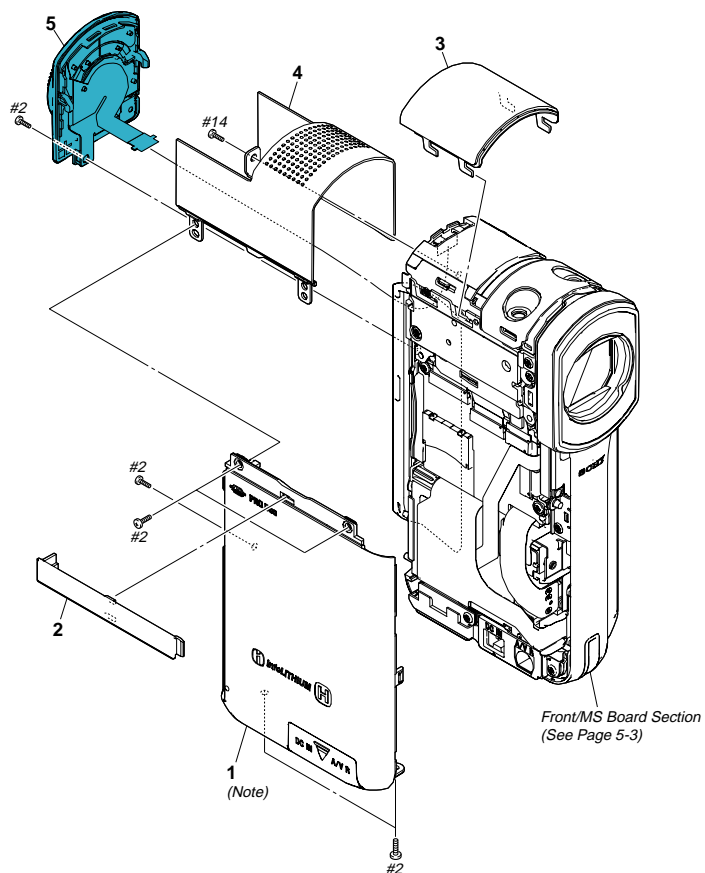

| Ref. No. | Part No. | Description |
|----------|--------------|------------------------------|
| 1 | (Note) | CABINET (L), SERVICE |
| 2 | 4-141-282-01 | ORNAMENT, CABINET (L) |
| 3 | 4-141-277-01 | COVER, GM (TG5V/TG5VE/TG7VE) |
| 3 | 4-141-277-11 | COVER, GM (TG5/TG5E) |
| 4 | X-2348-712-1 | CABINET (TOP) ASSY |

| Ref. No. | Part No. | Description |
|----------|--------------|---|
| 5 | 1-487-139-11 | SWITCH BLOCK, CONTROL (PS31500) (TG5V/TG5VE/TG7VE) |
| 5 | 1-487-139-21 | SWITCH BLOCK, CONTROL (PS31500) (TG5/TG5E) |
| #2 | 2-635-562-31 | SCREW (M1.7) (Black) |
| #14 | 2-599-475-11 | SCREW (M1.7) (Silver) |

5. REPAIR PARTS LIST

DISASSEMBLY

HARDWARE LIST

5-1-2. FRONT/MS BOARD SECTION

CAUTION
 Danger of explosion if battery is incorrectly replaced.
 Replace only with the same or equivalent type.
 Dispose of used batteries according to the instructions.

注意
 電池の交換は、正しく行わないと破裂する恐れがあります。
 電池を交換する場合には必ず同じ型名の電池又は同等品と交換してください。
 使用済み電池は、取扱指示に従って処分してください。

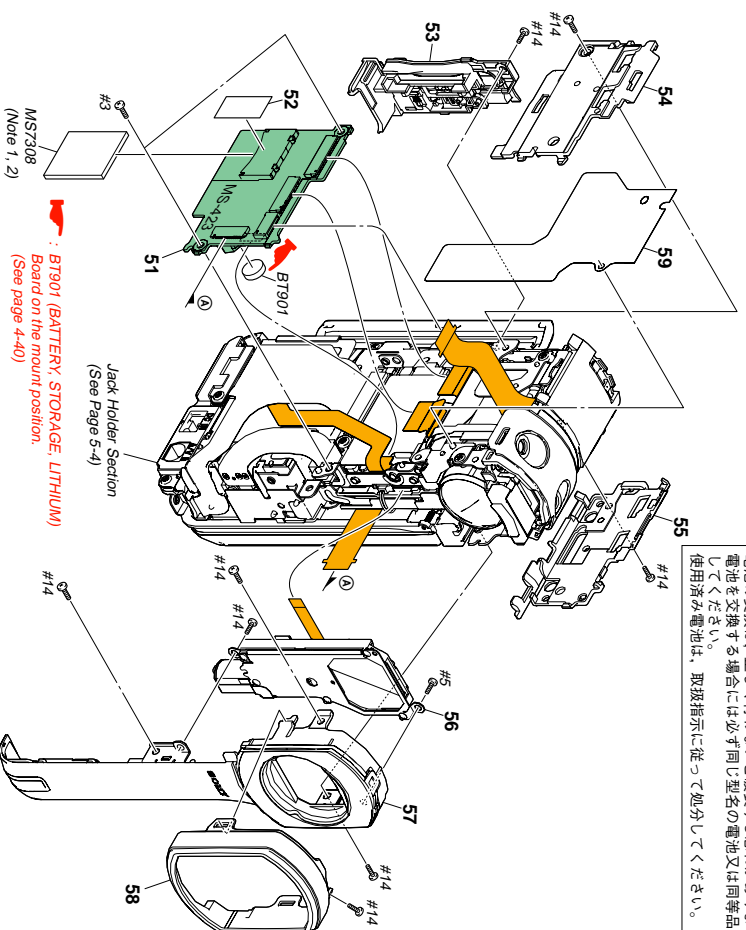

Note 1: When replacing the internal memory (MS7308 that has been inserted in the MS-423 board), start the Adjust Manual in the Adjust Station and refer to the "INTERNAL MEMORY ADJUSTMENTS".

Note 1: 内蔵メモリー (MS-423基板) に挿入されたMS7308) を交換の際は、Adjust StationからAdjust Manualを起動させて「INTERNAL MEMORY ADJUSTMENTS」を参照してください。

Note 2: Do not factory check the internal memory (MS7308 that has been inserted in the MS-423 board) in which Map Data is installed (TGSV/TGSVE/TG7VE). The map data is erased when the factory check is done.

Note 2: 地図データ入り内蔵メモリー (MS-423基板) に挿入されたMS7308) (TGSV/TGSVE/TG7VE) にはフラクトリマーチップを行わないでください。フラクトリマーチップを行うと、地図データが消去されてしまいます。

| Ref. No. | Part No. | Description |
|----------|--------------|------------------------------|
| 51 | A-1709-853-A | MS-423 BOARD, COMPLETE |
| 52 | 2-590-635-01 | TAPE (AS 1/2) |
| 53 | X-2348-710-1 | HOLDER ASSY, MS (TGSV/TGSVE) |
| 53 | X-2348-711-1 | HOLDER ASSY, MS (TGS/TGSB) |
| * 54 | 4-141-289-01 | CABINET, INNER (SIDE) |
| * 55 | 4-141-280-01 | CABINET (R), INNER (SIDE) |
| 56 | A-1707-506-A | LENS BARRIER UNIT |
| 57 | X-2348-728-1 | CABINET (F) ASSY |
| 58 | 4-141-354-01 | RING, LENS |

* Refer to page 5-1 for mark Δ

| Ref. No. | Part No. | Description |
|----------|--------------|--|
| * 59 | 4-148-020-01 | SHEET (WP) |
| Δ BT901 | 1-756-134-12 | BATTERY, STORAGE, LITHIUM |
| MS7308 | 1-481-365-11 | MEMORY MODULE, SIP (16GB) (TGS/TGSB) |
| MS7308 | A-1716-857-A | SERVICE, MEMORY MODULE SIP 16GB (Note 1) |
| #3 | 2-660-401-01 | SCREW (M1.7), NEW TRU-STAR, P2 (Red) |
| #5 | 3-080-204-01 | SCREW, TAPPING, P2 (Black) |
| #14 | 2-599-475-11 | SCREW (M1.7) (Silver) |

5. REPAIR PARTS LIST

DISASSEMBLY

HARDWARE LIST

5-1-3. JACK HOLDER SECTION

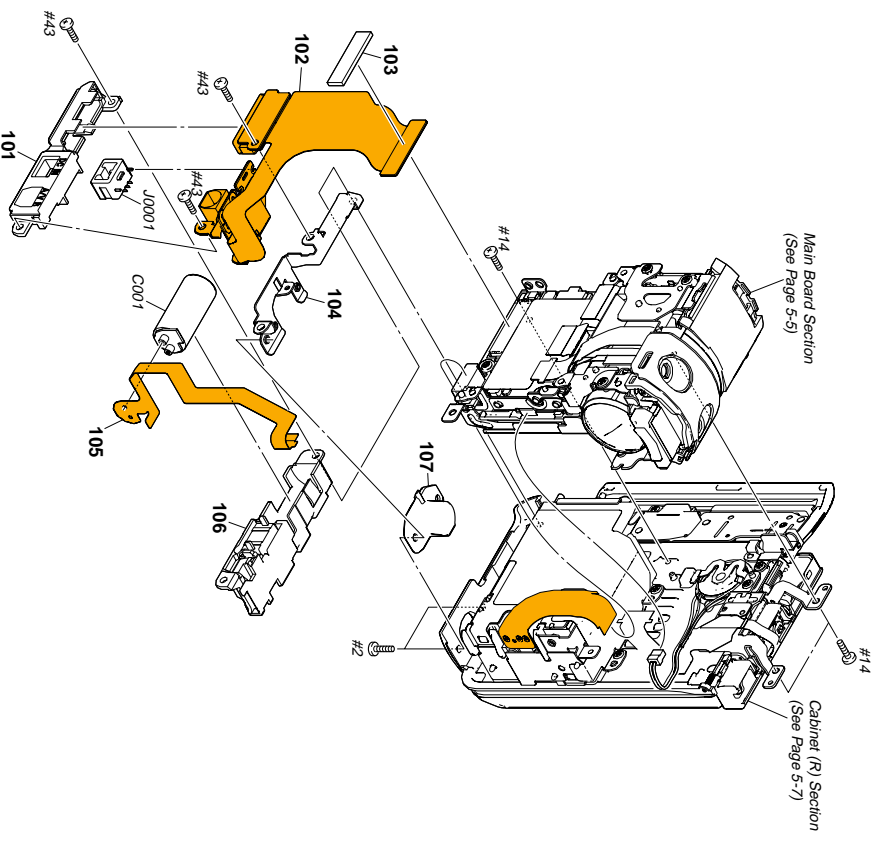

• Refer to page 5-1 for mark Δ

| Ref. No. | Part No. | Description |
|----------|--------------|----------------------------------|
| * 101 | 4-141-285-01 | HOLDER, JK |
| * 102 | A-1709-835-A | FP-1076 FLEXIBLE BOARD, COMPLETE |
| 103 | 4-141-284-01 | SPACER (315), CR |
| * 104 | 4-141-288-01 | FRAME, BOTTOM |
| Δ 105 | 1-878-041-11 | FP-1083 FLEXIBLE BOARD |
| * 106 | 4-141-287-01 | RETAINER, JACK |

| Ref. No. | Part No. | Description |
|----------|--------------|--------------------------------------|
| 107 | 4-141-286-01 | WASHER, TRIPOD |
| Δ C001 | 1-116-039-11 | ALUMINUM ELECTROLYTIC CAPACITOR |
| Δ J0001 | 1-815-792-11 | CONNECTOR, DC-IN (72V) (DC IN) |
| # 2 | 2-635-562-31 | SCREW (M1.7) (Black) |
| # 14 | 2-599-475-11 | SCREW (M1.7) (Silver) |
| # 43 | 2-660-401-31 | SCREW (M1.7), NEW TRU-STAR, P2 (Red) |

5. REPAIR PARTS LIST

5-1-4. MAIN BOARD SECTION

DISASSEMBLY

HARDWARE LIST

ns: not supplied

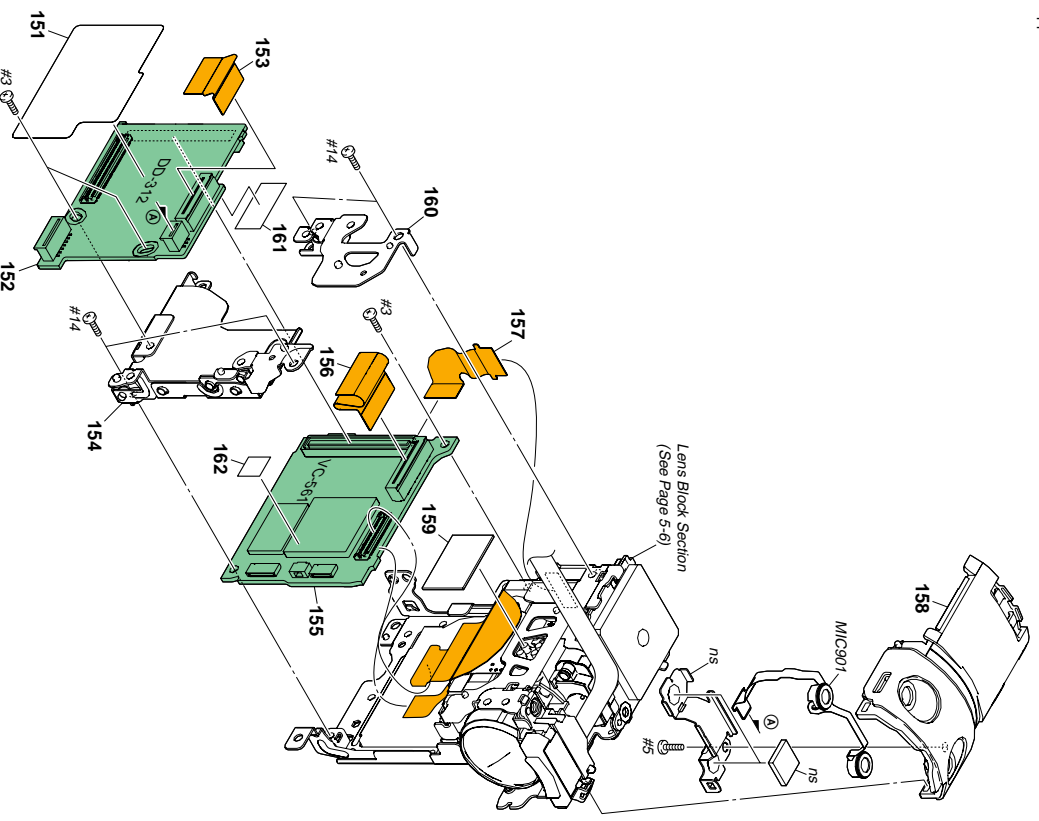

| Ref. No. | Part No. | Description |
|----------|--------------|---|
| 151 | 4-141-283-01 | LABEL, FUSE REPLACEMENT CAUTION |
| 152 | A-1709-849-A | DD-312 BOARD, COMPLETE (TGSV/TGSVE/TG7VE) |
| 153 | A-1709-890-A | DD-312 BOARD, COMPLETE (TGSV/TGSVE/TG7VE) |
| 154 | X-2348-708-1 | FRAME ASSY, MAIN |
| 155 | A-1710-118-A | VC-561 BOARD, COMPLETE (SERVICE) (TGS/TGSV) |
| 155 | A-1710-119-A | VC-561 BOARD, COMPLETE (SERVICE) (TGS/TGSV) |
| 155 | A-1710-120-A | VC-561 BOARD, COMPLETE (SERVICE) (TGSV/TGSVE) (TG7VE) |

| Ref. No. | Part No. | Description |
|----------|--------------|--------------------------------------|
| 156 | 1-878-038-11 | PP-1080 FLEXIBLE BOARD |
| 157 | 1-878-037-11 | PP-1079 FLEXIBLE BOARD |
| 158 | X-2348-713-1 | CABINET ASSY, INNER (TOP) |
| * 159 | 4-142-595-01 | CUSHION (L) |
| * 160 | 4-142-163-01 | FRAME (REAR) |
| 161 | 2-590-635-01 | TAPE (AS 1/2) |
| 162 | 3-300-092-01 | SHEET (NI), RADIATION |
| MIC901 | 1-542-791-11 | MICROPHONE UNIT |
| #3 | 2-660-401-01 | SCREW (M1.7), NEW TRU-STAR, P2 (Red) |
| #5 | 3-080-204-01 | SCREW, TAPPING, P2 (Black) |
| #14 | 2-599-475-11 | SCREW (M1.7) (Silver) |

5. REPAIR PARTS LIST

DISASSEMBLY

HARDWARE LIST

5-1-5. LENS BLOCK SECTION

Note: Be sure to read "Precautions for Replacement of Imager" on page 4-2 when changing the imager.

Note: イマージヤの交換時は4-3ページの「イマージヤ交換時の注意」を必ずお読みください。

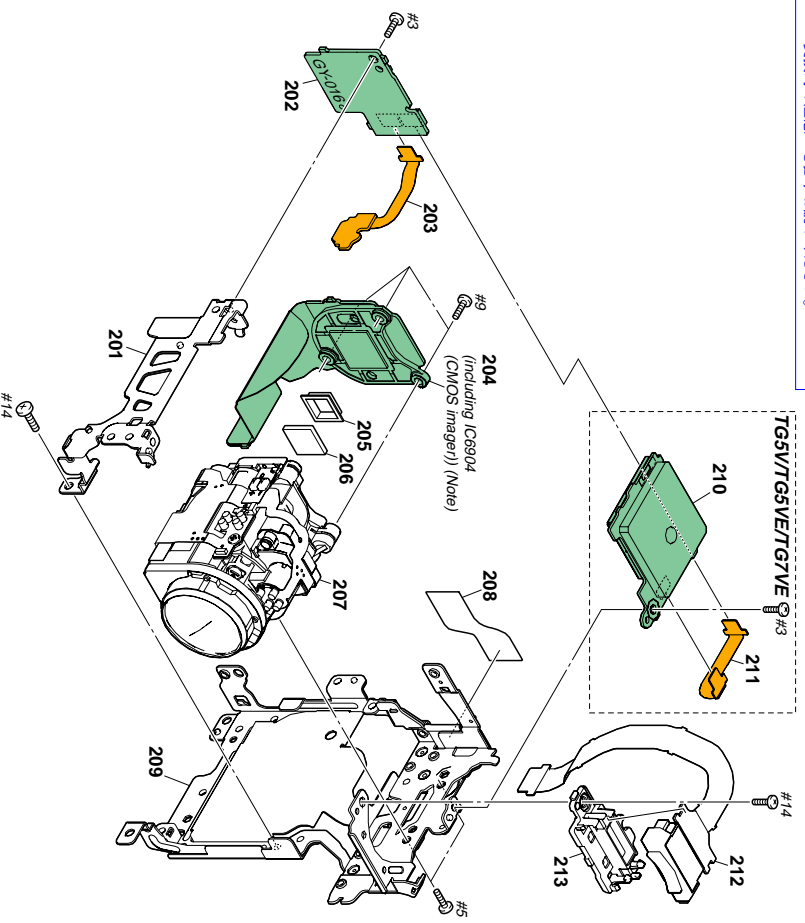

• Refer to page 5-1 for mark Δ .

| Ref. No. | Part No. | Description | Ref. No. | Part No. | Description |
|----------|--------------|--|--------------|--------------|--------------------------------------|
| * 201 | 4-141-279-01 | FRAME (L), LENS | 209 | X-2348-707-1 | FRAME (R) ASSY, LENS |
| 202 | A-1709-851-A | GY-016 BOARD, COMPLETE | 210 | A-1709-859-A | GM-055 ASSY (TG5V/TG5E/TG7VE) |
| 202 | A-1709-852-A | GY-016 BOARD, COMPLETE (TG5V/TG5E/TG7VE) | 211 | 1-878-Q42-11 | FP-1084 FLEXIBLE BOARD |
| 203 | A-1709-857-A | FP-1078 FLEXIBLE BOARD, COMPLETE | Δ 212 | 1-487-138-11 | FLASH UNIT (F13150D) |
| 204 | A-1709-894-A | CM-110 BOARD, COMPLETE (including IC6904 (CMOS imager)) (Note) | * 213 | 4-141-278-01 | HOLDER, STROBOSCOPE |
| 205 | 3-279-478-01 | RUBBER (GH001), SEAL | #3 | 2-660-401-01 | SCREW (M1.7), NEW TRU-STAR, P2 (Red) |
| 206 | 1-788-916-11 | OPTICAL FILTER BLOCK (OPB-05-09) | #5 | 3-080-204-01 | SCREW, TAPPING, P2 (Black) |
| 207 | 1-788-800-11 | OPTICAL UNIT (GH001) | #9 | 3-078-890-21 | SCREW, TAPPING (Silver) |
| * 208 | 4-141-281-01 | SHEET, CM RADIATION | #14 | 2-599-475-11 | SCREW (M1.7) (Silver) |

5. REPAIR PARTS LIST

DISASSEMBLY

HARDWARE LIST

5-1-6. CABINET (R) SECTION

ns: not supplied

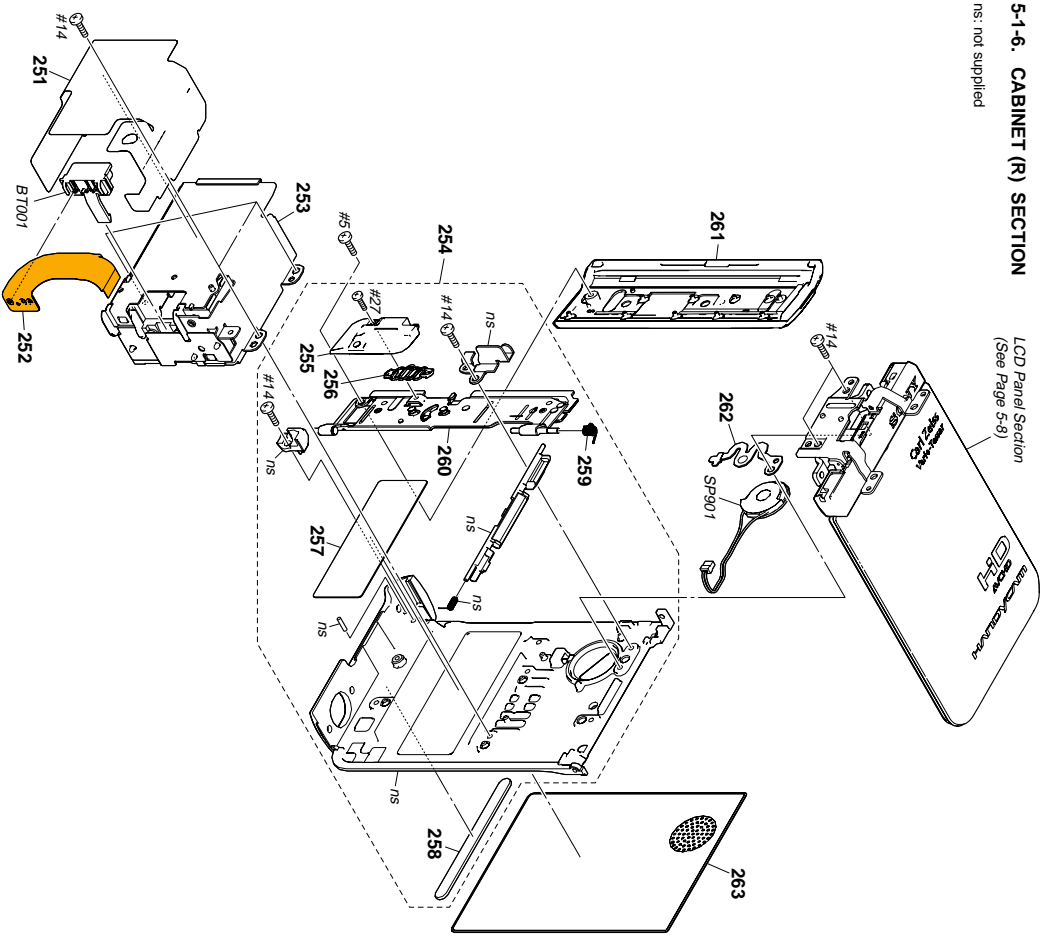

• Refer to page 5-1 for mark Δ.

| Ref. No. | Part No. | Description |
|----------|--------------|------------------------|
| * 251 | 4-141-315-01 | SHEET (BT), RADIATION |
| Δ 252 | 1-878-040-11 | FP-1082 FLEXIBLE BOARD |
| 253 | X-2348-724-1 | FRAME ASSY, BT |
| 254 | X-2348-722-1 | CABINET (R) ASSY |
| 255 | 3-300-000-01 | COVER, BT LINK |
| 256 | 3-299-999-01 | SPRING, BT LINK |
| 257 | 3-300-007-01 | SHEET, BT SLIDER |
| 258 | 4-141-301-01 | CUSHION, PANEL |
| 259 | 4-141-302-01 | SPRING (315), BT LID |
| 260 | X-2348-721-1 | PLATE ASSY, BT SLIDE |

| Ref. No. | Part No. | Description |
|----------|--------------|---|
| 261 | X-2348-709-1 | LID ASSY, BT |
| * 262 | 4-141-316-01 | REMAINER, SPEAKER |
| 263 | 4-141-356-01 | PLATE (R), ORNAMENTAL |
| 263 | 4-141-356-11 | PLATE (R), ORNAMENTAL (T65/TG5E/TG5V/TG6VE) |
| Δ BT001 | 1-780-597-11 | TERMINAL BOARD, BATTERY |
| SP901 | 1-826-837-31 | SPEAKER (1.3CM) |
| #5 | 3-080-204-01 | SCREW, TAPPING, P2 (Black) |
| #14 | 2-599-475-11 | SCREW (M1.7) (Silver) |
| #27 | 2-662-396-11 | SCREW (M1.4), NEW, TRUSTAR, P2 (Black) |

5. REPAIR PARTS LIST

DISASSEMBLY

HARDWARE LIST

5-1-7. LCD PANEL SECTION

Note: Put the marking side together on the position of figure when you install the magnet.

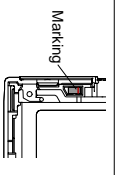

Note: マグネットを取付ける際は、この位置にあるマークの位置にあわせてください。

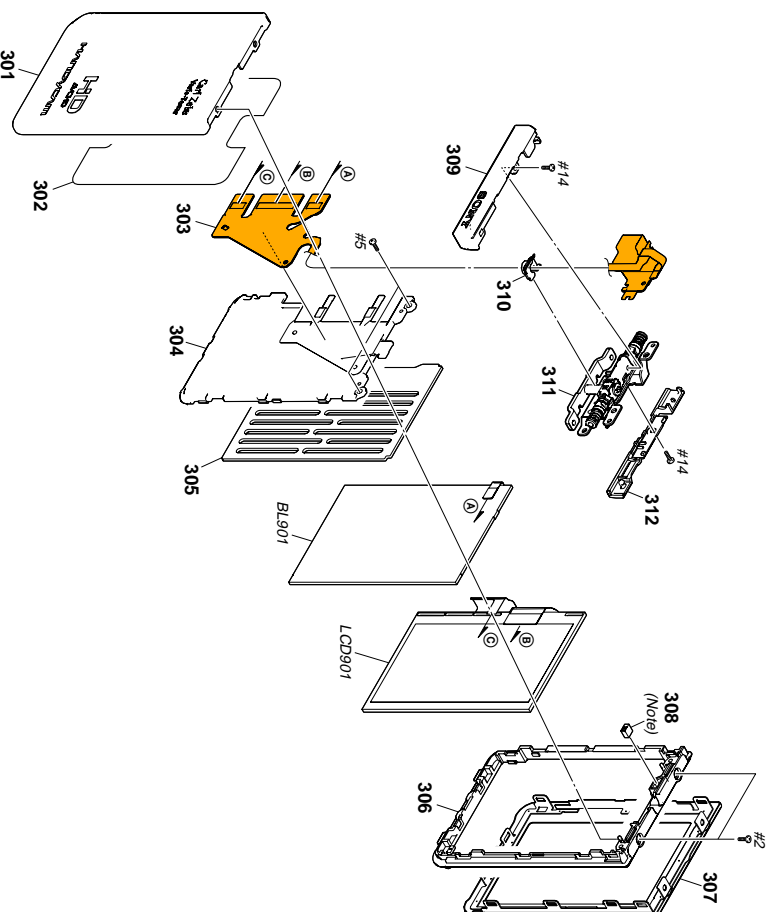
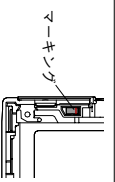

| Ref.No. | PartNo. | Description |
|---------|--------------|----------------------------------|
| 301 | 4-141-341-01 | CABINET (C), P |
| 302 | 4-141-346-01 | SHEET (P CABINET), INSULATING |
| 303 | A-1709-886-A | FP-1077 FLEXIBLE BOARD, COMPLETE |
| 304 | X-2348-727-1 | SPACER ASSY, PANEL |
| 305 | 4-141-343-01 | CUSHION, TP |
| 306 | 4-141-342-01 | CABINET (P), INNER |
| 307 | X-2348-726-1 | CABINET (M) ASSY, P |
| 308 | 1-471-514-11 | W/AGNET (LM-30FH) (Note) |
| 309 | 4-141-317-01 | COVER (FRONT), HINGE |

| Ref.No. | PartNo. | Description |
|---------|--------------|--------------------------------|
| * 310 | 4-141-345-01 | CLAMP, HINGE |
| 311 | X-2348-725-1 | HINGE ASSY |
| 312 | 4-141-344-01 | COVER (REAR), HINGE |
| BL901 | 1-480-681-11 | BLOCK, LIGHT GUIDE PLATE (2.7) |
| LCD901 | 1-802-915-11 | LCD MODULE WITH TOUCH PANEL |
| #2 | 2-635-562-31 | SCREW (M1.7) (Black) |
| #5 | 3-080-204-01 | SCREW, TAPPING, P2 (Black) |
| #14 | 2-599-475-11 | SCREW (M1.7) (Silver) |

Electrical parts list of the CM-110 and DD-312 boards are not shown.
Pages from 5-9 to 5-12 are not shown.

FP-1076

FP-1077

FP-1078

5-2. ELECTRICAL PARTS LIST

| Ref. No. | Part No. | Description |
|----------|--------------|---|
| | A-1709-855-A | FP-1076 FLEXIBLE BOARD, COMPLETE |
| | | ***** |
| | | < CAPACTOR > |
| C0003 | 1-164-933-11 | CERAMIC CHIP 220PF 10% 50V |
| C0004 | 1-164-933-11 | CERAMIC CHIP 220PF 10% 50V |
| | | < CONNECTOR > |
| * CN0001 | 1-821-894-11 | CONNECTOR, BOARD TO BOARD 80P |
| CN0003 | 1-815-794-13 | CONNECTOR (MULTIPLE (AVR)) |
| Δ CN0004 | 1-818-168-61 | CONNECTOR, MULTIPLE (SOCKET) (INTERFACE CONNECTOR) |
| | | < FERRITE BEAD > |
| FB0001 | 1-400-927-31 | BEAD, FERRITE (1005) |
| FB0002 | 1-400-927-31 | BEAD, FERRITE (1005) |
| | | < SENSOR > |
| * SE0001 | 1-480-627-11 | SENSOR, MAGNETIC |
| | | ***** |
| | A-1709-856-A | FP-1077 FLEXIBLE BOARD, COMPLETE |
| | | ***** |
| | | < CONNECTOR > |
| * CN001 | 1-818-619-71 | CONNECTOR, FCC/PPC (ZIF) 6P |
| * CN002 | 1-821-835-71 | CONNECTOR, FCC/PPC (ZIF) 24P |
| * CN003 | 1-818-619-71 | CONNECTOR, FCC/PPC (ZIF) 6P |
| | | ***** |
| | A-1709-857-A | FP-1078 FLEXIBLE BOARD, COMPLETE |
| | | ***** |
| | | < SENSOR > |
| * SE0002 | 1-480-627-11 | SENSOR, MAGNETIC |

Electrical parts list of the GY-016 board is not shown.
Page 5-14 is not shown.

• Refer to page 5-1 for mark Δ.

| Ref. No. | Part No. | Description |
|----------|--------------|--|
| | A-1709-853-A | MS-423 BOARD COMPLETE ***** (MS7308 and BT901 (lithium battery) are not included in MS-423 complete board.) ***** |
| | | < BATTERY SOCKET > |
| | △BH7301 | SOCKET, BATTERY |
| | | < BATTERY > |
| | △BT901 | BATTERY, STORAGE, LITHIUM |

| Ref. No. | Part No. | Description |
|----------|----------|--|
| | | < CAPACITOR > |
| | C5001 | 1-125-777-11 CERAMIC CHIP 0.1uF 10% 10V |
| | C5002 | 1-114-238-91 CERAMIC CHIP 22uF 20% 10V |
| | C5003 | 1-162-960-11 CERAMIC CHIP 220PF 10% 50V |
| | * C5004 | 1-112-746-11 CERAMIC CHIP 4.7uF 10% 6.3V |
| | C5005 | 1-162-915-11 CERAMIC CHIP 10PF 0.5PF 50V |
| | C6001 | 1-100-581-81 CERAMIC CHIP 0.0047uF 10% 50V |
| | C6002 | 1-165-884-11 CERAMIC CHIP 2.2uF 10% 6.3V |
| | C6024 | 1-165-908-11 CERAMIC CHIP 1uF 10% 10V |
| | C6025 | 1-100-567-81 CERAMIC CHIP 0.01uF 10% 25V |
| | C6031 | 1-112-534-11 CERAMIC CHIP 10uF 20% 6.3V |
| | C6032 | 1-127-895-91 TANTALUM CHIP 22uF 20% 4V |
| | C6033 | 1-165-884-11 CERAMIC CHIP 2.2uF 10% 6.3V |
| | C6034 | 1-125-777-11 CERAMIC CHIP 0.1uF 10% 10V |
| | C6035 | 1-164-739-11 CERAMIC CHIP 560PF 5% 50V |
| | C6037 | 1-125-777-11 CERAMIC CHIP 0.1uF 10% 10V |
| | C6038 | 1-100-786-91 TANTALUM CHIP 22uF 20% 6.3V |
| | C6039 | 1-100-567-81 CERAMIC CHIP 0.01uF 10% 25V |
| | C6040 | 1-100-567-81 CERAMIC CHIP 0.01uF 10% 25V |
| | C6041 | 1-100-567-81 CERAMIC CHIP 0.01uF 10% 25V |
| | * C6044 | 1-112-746-11 CERAMIC CHIP 4.7uF 10% 6.3V |
| | * C6045 | 1-112-746-11 CERAMIC CHIP 4.7uF 10% 6.3V |
| | C6046 | 1-125-777-11 CERAMIC CHIP 0.1uF 10% 10V |
| | C6047 | 1-125-889-11 CERAMIC CHIP 2.2uF 10% 10V |
| | C7301 | 1-125-777-11 CERAMIC CHIP 0.1uF 10% 10V |
| | C7302 | 1-112-717-91 CERAMIC CHIP 1uF 10% 6.3V |
| | C7304 | 1-125-777-11 CERAMIC CHIP 0.1uF 10% 10V |
| | C7305 | 1-112-717-91 CERAMIC CHIP 1uF 10% 6.3V |
| | C7307 | 1-165-908-11 CERAMIC CHIP 1uF 10% 10V |
| | C7308 | 1-125-777-11 CERAMIC CHIP 0.1uF 10% 10V |

| Ref. No. | Part No. | Description |
|----------|----------|---|
| | | < CONNECTOR > |
| | * CN7301 | 1-817-829-81 CONNECTOR, PPC (ZIF) 27P |
| | * CN7302 | 1-817-830-71 CONNECTOR, PPC (ZIF) 33P |
| | CN7303 | 1-816-665-61 CONNECTOR, FCC/PPC 6P |
| | * CN7304 | 1-817-942-81 CONNECTOR, PPC (ZIF) 39P |
| | * CN7305 | 1-816-644-51 FCC/PPC CONNECTOR (LIF) 12P |
| | CN7306 | 1-819-611-31 MEMORY STICK DUO CONNECTOR 10P |
| | CN7308 | 1-822-532-11 CONNECTOR, CARD (SIP) |

| Ref. No. | Part No. | Description |
|----------|----------|--|
| | | < DIODE > |
| | D5001 | 6-500-619-01 DIODE RB520S-40TE61 |
| | △D5002 | 6-501-086-01 DIODE CRH2 (TE881) |
| | D7301 | 6-501-216-01 DIODE CL-271RH-C-TS (MS ACCESS) |
| | * D7302 | 6-501-365-01 DIODE MAZ50S630850 |

* Refer to page 5-1 for mark △.

| Ref. No. | Part No. | Description |
|----------|----------|--|
| | | < FERRITE BEAD > |
| | FB7301 | 1-469-580-21 INDUCTOR, FERRITE BEAD (1005) |
| | FB7302 | 1-469-580-21 INDUCTOR, FERRITE BEAD (1005) |
| | FB7303 | 1-469-580-21 INDUCTOR, FERRITE BEAD (1005) |
| | FB7304 | 1-469-580-21 INDUCTOR, FERRITE BEAD (1005) |
| | FB7305 | 1-469-580-21 INDUCTOR, FERRITE BEAD (1005) |
| | FB7306 | 1-469-580-21 INDUCTOR, FERRITE BEAD (1005) |
| | FB7307 | 1-469-580-21 INDUCTOR, FERRITE BEAD (1005) |
| | FB7308 | 1-469-580-21 INDUCTOR, FERRITE BEAD (1005) |

| Ref. No. | Part No. | Description |
|----------|------------|----------------------------------|
| | | < IC > |
| | △* IC63001 | 6-712-975-01 IC BD4215MUV-E2 |
| | IC66001 | 8-753-229-95 IC CXM3006GER-14 |
| | * IC7301 | 6-708-445-01 IC R11140291D-TR-FA |
| | IC7302 | 6-708-445-01 IC R11140291D-TR-FA |

| Ref. No. | Part No. | Description |
|----------|----------|----------------------------|
| | | < COIL > |
| | * L5001 | 1-400-820-11 INDUCTOR 22uH |
| | L6001 | 1-400-588-11 INDUCTOR 10uH |
| | L6002 | 1-400-588-11 INDUCTOR 10uH |
| | L6003 | 1-400-588-11 INDUCTOR 10uH |

| Ref. No. | Part No. | Description |
|----------|----------|--|
| | | < INTERNAL MEMORY > |
| | MS7308 | 1-487-365-11 MEMORY MODULE, SIP (16GB) (TG5V7G6E) (Note 1) |
| | MS7308 | A-7176-857-A SERVICE, MEMORY MODULE SIP 16GB (TG5V7G6V/7G7VE) (Note 1, 2) |
| | | < TRANSISTOR > |
| | * 05001 | 6-551-852-01 TRANSISTOR UP04313608S0 |
| | △* 05002 | 6-552-144-01 TRANSISTOR TI6062TS-TL-E |
| | 06001 | 8-729-427-37 TRANSISTOR XP41F-TXE |
| | 06002 | 8-729-427-67 TRANSISTOR XP42F-TXE |
| | 06010 | 6-550-901-01 TRANSISTOR UNRP2A300AS0 |
| | 06011 | 6-551-184-01 TRANSISTOR MCH6305-TL-E-S |
| | * 06013 | 6-551-157-01 TRANSISTOR 2SA207900AS0 |

CAUTION
Danger of explosion if battery is incorrectly replaced.
Replace only with the same or equivalent type.
Dispose of used batteries according to the instructions.

注意

電池の交換は、正しく行わないと爆発する恐れがあります。
電池を交換する場合には必ず同じ型名の電池又は同等品と交換してください。
使用済が電池は、取扱指示に従って処分してください。

Note 1: When replacing the internal memory (MS7308 that has been inserted in the MS-423 board), start the Adjust Manual in the Adjust Station and refer to the "INTERNAL MEMORY ADJUSTMENTS".

Note 1: 内蔵メモリー (MS-423基板に挿入されたMS7308) を交換の際は、Adjust StationからAdjust Manualを起動させて「INTERNAL MEMORY ADJUSTMENTS」を参照してください。

Note 2: Do not factory check the internal memory (MS7308 that has been inserted in the MS-423 board) in which Map Data is installed (TG5V7G6V/7G7VE). The map data is erased when the factory check is done.

Note 2: 地図データ入り内蔵メモリー (MS-423基板に挿入されたMS7308) (TG5V7G6V/7G7VE) にはマップデータを書き込まないでください。マップデータを書き込むと、地図データが消去されてしまいます。

| Ref. No. | PartNo. | Description |
|--------------|--------------|---------------------------|
| < RESISTOR > | | |
| R5002 | 1-208-923-11 | METAL CHIP 33K 0.5% 1/16W |
| R5003 | 1-208-911-11 | METAL CHIP 10K 0.5% 1/16W |
| R5004 | 1-216-829-11 | METAL CHIP 4.7K 5% 1/10W |
| R5005 | 1-216-809-11 | METAL CHIP 100 5% 1/10W |
| R5006 | 1-218-989-11 | METAL CHIP 1M 5% 1/16W |
| R6041 | 1-218-977-11 | METAL CHIP 100K 5% 1/16W |
| R6042 | 1-218-981-91 | METAL CHIP 220K 5% 1/16W |
| R6043 | 1-218-978-11 | METAL CHIP 120K 5% 1/16W |
| R6061 | 1-218-975-11 | METAL CHIP 68K 5% 1/16W |
| R6064 | 1-208-934-11 | METAL CHIP 91K 0.5% 1/16W |
| R6065 | 1-208-911-11 | METAL CHIP 10K 0.5% 1/16W |
| R6067 | 1-218-965-11 | METAL CHIP 10K 5% 1/16W |
| R7302 | 1-218-953-11 | METAL CHIP 1K 5% 1/16W |
| R7305 | 1-218-942-11 | METAL CHIP 120 5% 1/16W |
| R7306 | 1-218-942-11 | METAL CHIP 120 5% 1/16W |
| R7307 | 1-218-942-11 | METAL CHIP 120 5% 1/16W |
| R7308 | 1-218-942-11 | METAL CHIP 120 5% 1/16W |
| R7310 | 1-218-949-11 | METAL CHIP 470 5% 1/16W |
| R7312 | 1-218-953-11 | METAL CHIP 1K 5% 1/16W |
| R7315 | 1-218-942-11 | METAL CHIP 120 5% 1/16W |
| R7316 | 1-218-942-11 | METAL CHIP 120 5% 1/16W |
| R7317 | 1-218-942-11 | METAL CHIP 120 5% 1/16W |
| R7318 | 1-218-942-11 | METAL CHIP 120 5% 1/16W |
| R7319 | 1-218-989-11 | METAL CHIP 1M 5% 1/16W |

< TRANSFORMER >

△* T5001 1-445-491-21 D.C.-D.C.CONVERTER TRANSFORMER

Electrical parts list of the VC-561 board is not shown.
Pages from 5-17 to 5-19 are not shown.

• Refer to page 5-1 for mark △.

• EXCEPT J MODEL
Checking supplied accessories.

to J MODEL

Note: This item is supplied with the unit as an accessory, but is not prepared as a service part.



AC Adaptor
(AC-L200C/L200D)
▲ 1-487-150-5-1



Power Cord
▲ 1-832-121-4-1 (CH)
▲ 1-832-169-4-1 (UK, HK)
▲ 1-833-892-4-1 (KR)
▲ 1-834-482-3-1 (AEP, E: PAL)
▲ 1-834-484-3-1 (US, GND)
▲ 1-834-882-1-1 (E: NTSC)
▲ 1-835-983-1-1 (AUS)
▲ 1-836-251-1-1 (JE)



Conversion (2P) Adaptor
▲ 1-569-007-1-2
(E: NTSC, JE)



"Handycam" Station Cradle
(DCRA-C250)
1-822-450-1-1

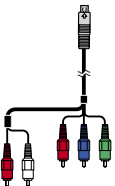

Component AV Cable
1-834-646-1-1

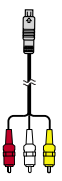

AV Connecting Cable
1-823-156-5-1



USB Cable (Long)
1-829-868-3-1

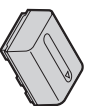

Rechargeable Battery Pack
NP-FH50
(Note)



Wrist Strap
3-299-909-0-1



USB Cable (Short)
(Note)



USB Adaptor Cap
(Note)



Dedicated USB Terminal Adaptor
(Note)

USB Adaptor Assy (USB3T500)
1-487-143-1-1

• Refer to page 5-1 for mark ▲



CD-ROM
"Handycam" Application Software
("PMB" Software, including "PMB Guide")
"Handycam" Handbook (PDF)
4-136-322-02



"Handycam" Handbook (PDF)

The CD-ROM supplied contains all of language version of the "Handycam" Handbook (PDF) for printing.

- The printed matter is not supplied. If required, please order it with the part number below.

• **(Only for destination Japanese model)**
日本国内については日本語のみが印刷での部品供給可能です。

| HDR-TG5/TG5V | HDR-TG5E/TG5VE |
|--------------------------------------|--------------------------------------|
| 4-133-712-01 (JAPANESE) | 4-133-713-11 (ENGLISH) |
| * 4-133-712-11 (ENGLISH) | * 4-133-713-21 (FRENCH) |
| * 4-133-712-21 (FRENCH) | * 4-133-713-31 (GERMAN) |
| * 4-133-712-31 (SPANISH) | * 4-133-713-41 (ITALIAN) |
| * 4-133-712-41 (PORTUGUESE) | * 4-133-713-52 (DUTCH) |
| * 4-133-712-51 (TRADITIONAL CHINESE) | * 4-133-713-61 (SPANISH) |
| * 4-133-712-61 (KOREAN) | * 4-133-713-71 (PORTUGUESE) |
| | * 4-133-713-81 (GREEK) |
| | * 4-133-713-91 (CZECH) |
| | * 4-141-567-11 (HUNGARIAN) |
| | * 4-141-567-21 (SLOVAK) |
| | * 4-141-567-31 (POLISH) |
| | * 4-141-567-41 (SWEDISH) |
| | * 4-141-567-51 (DANISH) |
| | * 4-141-567-61 (FINNISH) |
| | * 4-141-567-71 (ROMANIAN) |
| | * 4-141-567-81 (RUSSIAN) |
| | * 4-141-568-11 (UKRAINIAN) |
| | * 4-141-568-21 (TRADITIONAL CHINESE) |
| | * 4-141-568-31 (SIMPLIFIED CHINESE) |
| | * 4-141-568-41 (ARABIC) |
| | * 4-141-568-51 (PERSIAN) |
| | * 4-141-568-61 (MALAY) |
| | * 4-141-568-71 (INDONESIAN) |
| | * 4-141-568-81 (THAI) |



Operating Guide

HDR-TG5/TG5V
4-133-714-11 (ENGLISH, SPANISH) (US, CND, E, JE)
4-133-714-21 (FRENCH) (CND)
4-133-714-31 (PORTUGUESE) (E, JE)
4-133-714-41 (TRADITIONAL CHINESE) (E)
4-133-714-51 (KOREAN) (KR, JE)

HDR-TG5E/TG5VE/TG7VE

4-133-715-11 (ENGLISH) (AEP, UK, E, HK, AUS, JE)
4-133-715-21 (FRENCH, GERMAN, ITALIAN, DUTCH) (AEP)
4-133-715-31 (SPANISH, PORTUGUESE, TURKISH, GREEK) (AEP)
4-133-715-41 (CZECH, HUNGARIAN, SLOVAK, POLISH) (AEP)
4-133-715-51 (SWEDISH, DANISH, FINNISH, ROMANIAN) (AEP)
4-133-715-61 (RUSSIAN, UKRAINIAN) (NE, JE)
4-133-715-71 (TRADITIONAL CHINESE) (HK)
4-133-715-81 (SIMPLIFIED CHINESE) (E, JE)
4-133-715-91 (ARABIC, PERSIAN) (E)
4-141-570-11 (SIMPLIFIED CHINESE) (CH)



How To Use GPS

HDR-TG5V/TG5VE/TG7VE

4-145-970-11 (ENGLISH, SPANISH, FRENCH)
(US, CND, AEP, UK, AUS)
4-145-970-21 (GERMAN, DUTCH, PORTUGUESE,
ITALIAN, GREEK, TURKISH, POLISH,
CZECH, HUNGARIAN, SLOVAK,
ROMANIAN, SWEDISH, DANISH, FINNISH)
(AEP)

● J MODEL
付属品

Note：当商品はアンテナセンサーとして同梱されており、
「サービス用補修部品」としては準備しておりません。



ACアダプター
(AC-L200C/L200D)
△ 1-487-150-51



電源コード
△ 1-836-251-11



「ハンディカム」スリーション
(DCRA-G250)
1-822-450-11

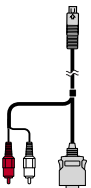

D端子AVケーブル
1-834-646-21



AV接続ケーブル
1-823-156-51

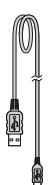

USBケーブル (長)
1-829-868-31



USBケーブル (短)
(Note)



USBアダプターケーブル (USB3.1500)
(Note)
1-487-143-11



専用USB端子アダプター
(Note)

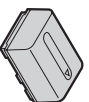

リチウムイオンバッテリーパック
NP-FH50
(Note)



リストストラップ
3-299-909-01

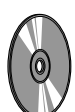

CD-ROM
「Handy cam」 Application Software」
[(PMB)ソフトウェア「PMBガイド」を含む]
「ハンディカム」ソフトウェア[(PDF)]
4-136-322-02



取扱説明書
4-133-714-01 (日本語)



GPSを使うには
4-145-970-01 (日本語)



「ハンディカム」ハンズ」ソフトウェア (PDF)
印刷用の「ハンディカム」ハンズ」ソフトウェア (PDF) は、
すべての言語が付属品のCD-ROMに含まれています。
・印刷物は付属されておらず、
必要な場合は「印刷品番号」にて注文となります。
4-133-712-01 (日本語)

● △マークについては、5-1ページを参照して下さい。

HARDWARE LIST (1/9)

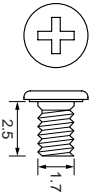
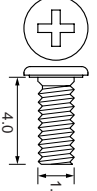
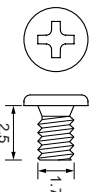
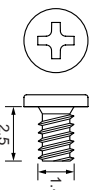
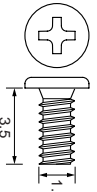
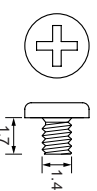
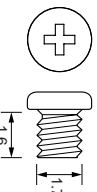
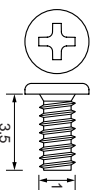
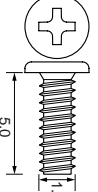
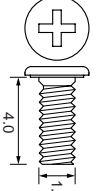
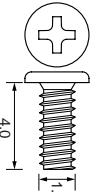
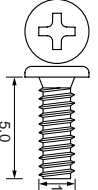
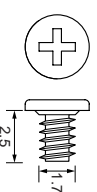
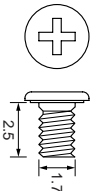
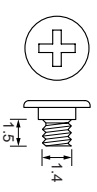
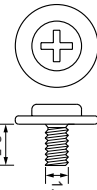
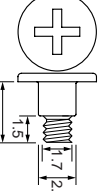
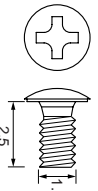
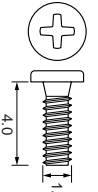
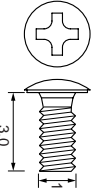
| | | | |
|--|--|--|--|
| <p>#1: M1.7 X 2.5 (Black) 2-635-562-11</p>  | <p>#2: M1.7 X 4.0 (Black) 2-635-562-31</p>  | <p>#3: M1.7 X 2.5 (Red) 2-660-401-01</p>  | <p>#4: M1.4 X 2.5 (Tapping) (Dark Silver) 3-348-998-81</p>  |
| <p>#5: M1.7 X 3.5 (Tapping) (Black) 3-080-204-01</p>  | <p>#6: M1.4 X 1.7 (Silver) 2-598-474-01</p>  | <p>#7: M1.7 X 1.6 (Black) 7-627-552-18</p>  | <p>#8: M1.7 X 3.5 (Tapping) (Silver) 3-078-890-01</p>  |
| <p>#9: M1.7 X 5.0 (Tapping) (Silver) 3-078-890-21</p>  | <p>#10: M1.7 X 4.0 (Silver) 2-599-475-31</p>  | <p>#11: M1.7 X 4.0 (Tapping) (Silver) 3-078-990-11</p>  | <p>#12: M1.7 X 5.0 (Tapping) (Black) 3-080-204-21</p>  |
| <p>#13: M1.7 X 2.5 (Tapping) (Silver) 3-085-397-01</p>  | <p>#14: M1.7 X 2.5 (Silver) 2-599-475-11</p>  | <p>#15: M1.4 X 1.5 (Silver) 3-062-214-01</p>  | <p>#16: M1.4 X 2.5 (Silver) 2-586-337-01</p>  |
| <p>#17: M1.7 X 1.5 (Silver) 2-586-389-01</p>  | <p>#18: M1.4 X 2.5 (Silver) 2-535-591-21</p>  | <p>#19: M1.2 X 4.0 (Tapping) (Red) 3-086-156-21</p>  | <p>#20: M1.4 X 3.0 (Silver) 2-635-591-31</p>  |

HARDWARE LIST (2/9)

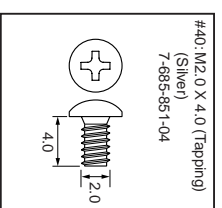
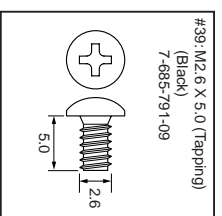
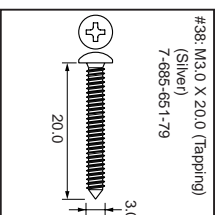
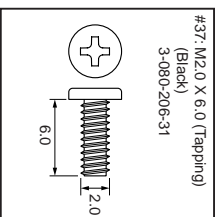
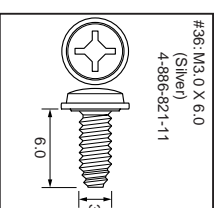
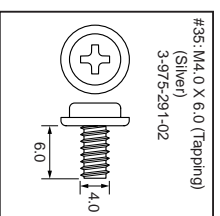
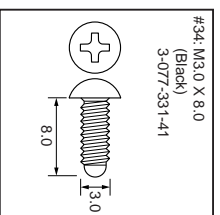
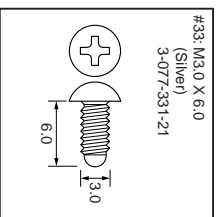
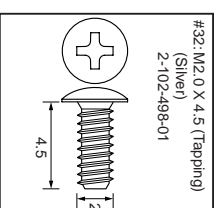
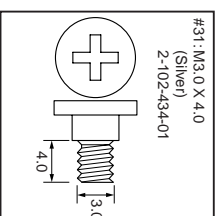
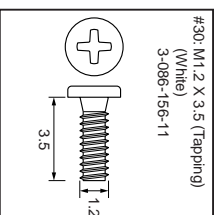
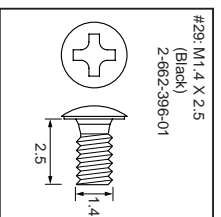
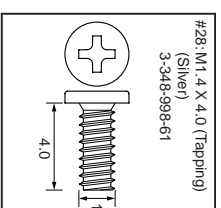
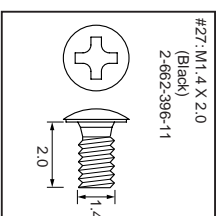
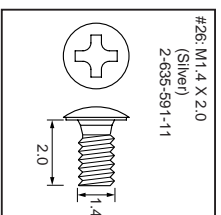
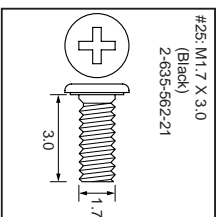
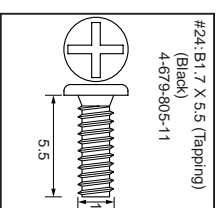
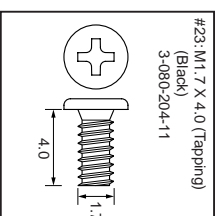
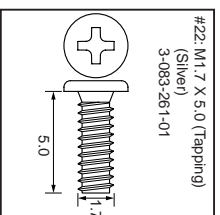
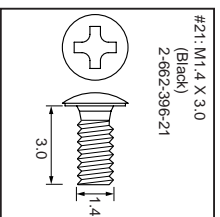

HARDWARE LIST (3/9)

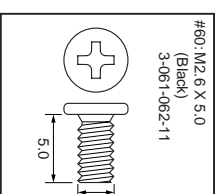
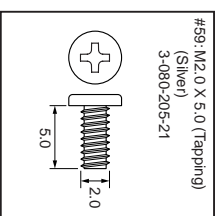
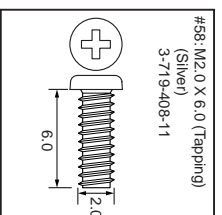
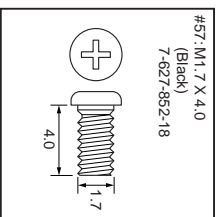
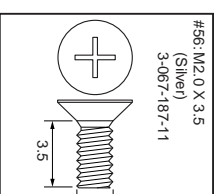
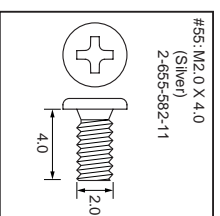
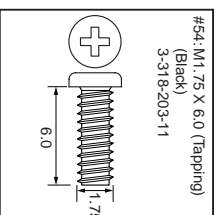
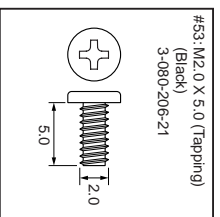
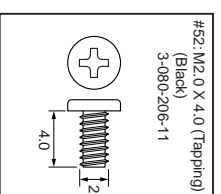
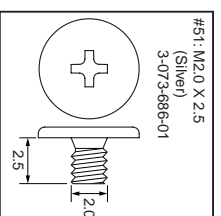
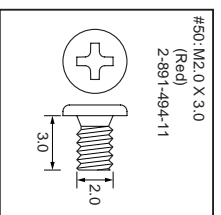
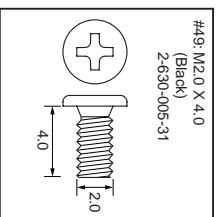
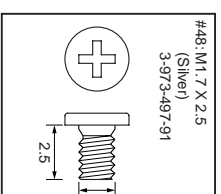
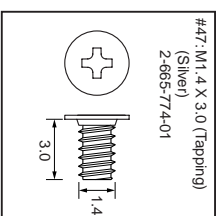
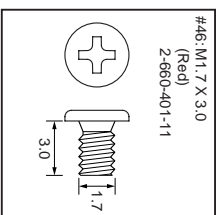
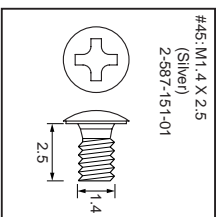
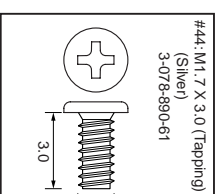
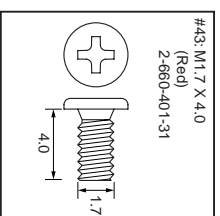
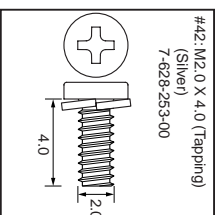
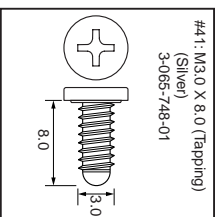

HARDWARE LIST (4/9)

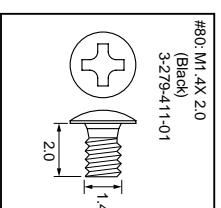
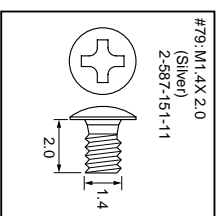
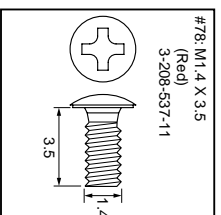
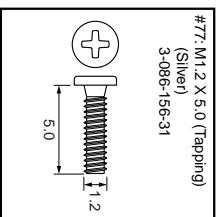
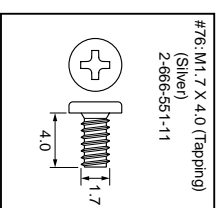
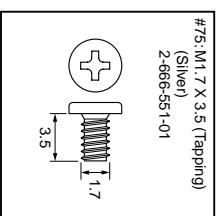
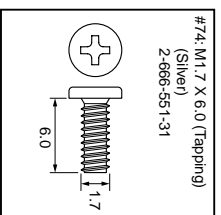
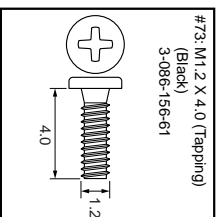
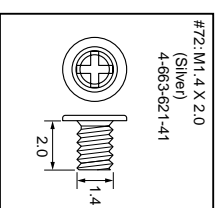
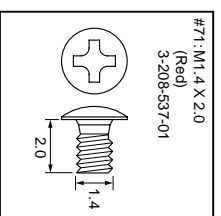
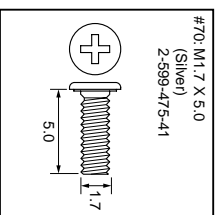
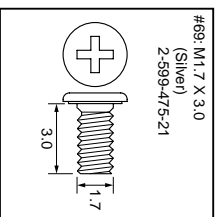
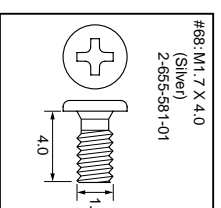
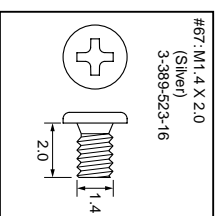
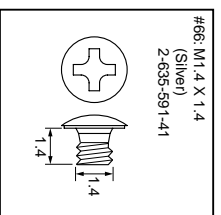
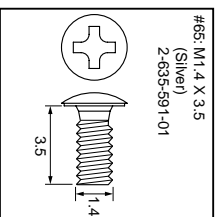
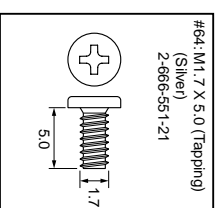
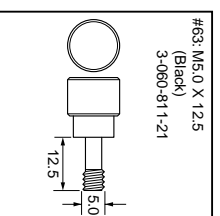
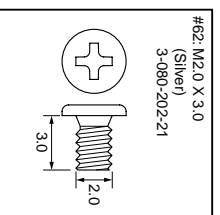
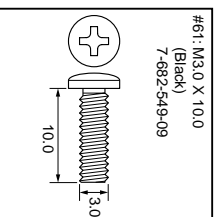

HARDWARE LIST (5/9)

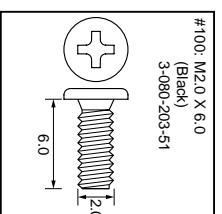
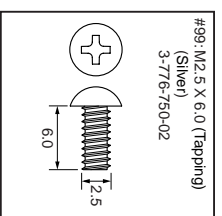
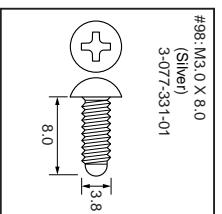
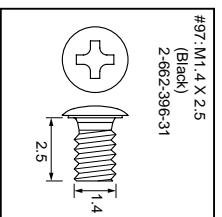
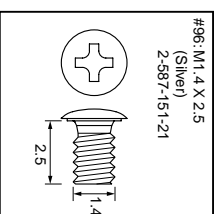
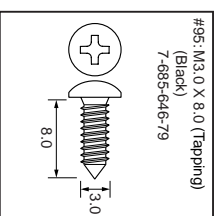
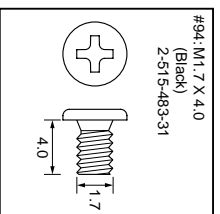
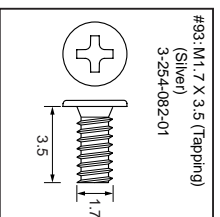
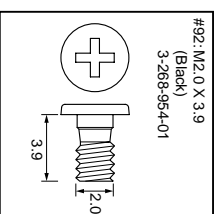
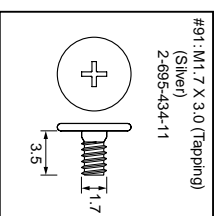
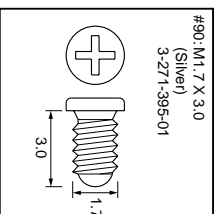
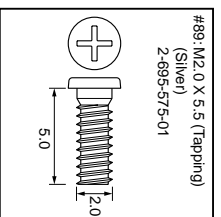
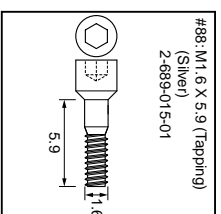
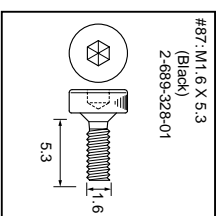
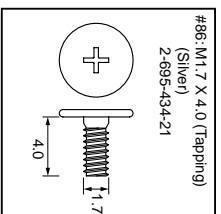
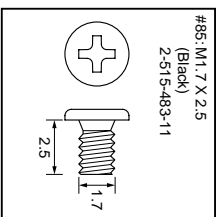
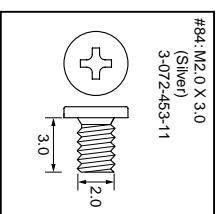
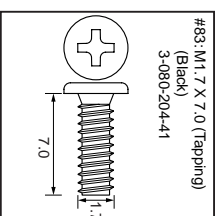
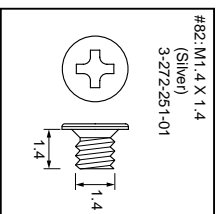
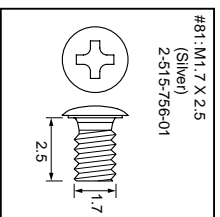

HARDWARE LIST (69)

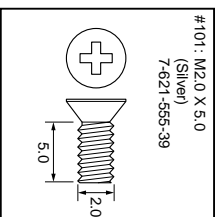

#101: M2.0 X 5.0
(Silver)
7-621-555-39

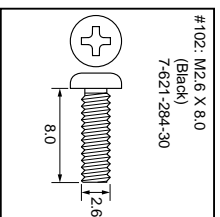

#102: M2.6 X 8.0
(Black)
7-621-294-30

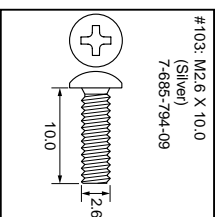

#103: M2.6 X 10.0
(Silver)
7-685-794-09

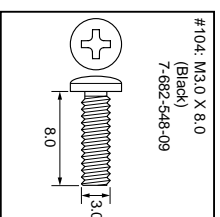

#104: M3.0 X 8.0
(Black)
7-682-548-09

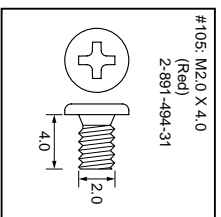

#105: M2.0 X 4.0
(Red)
2-891-494-31

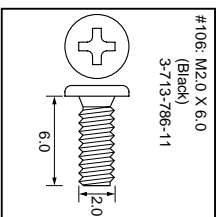

#106: M2.0 X 6.0
(Black)
3-713-786-11

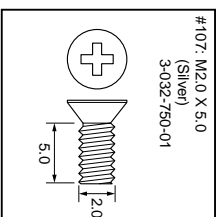

#107: M2.0 X 5.0
(Silver)
3-032-750-01

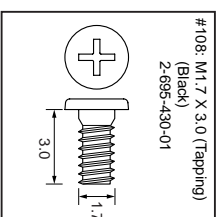

#108: M1.7 X 3.0 (Trapping)
(Black)
2-695-430-01

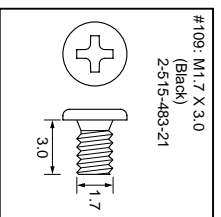

#109: M1.7 X 3.0
(Black)
2-515-483-21

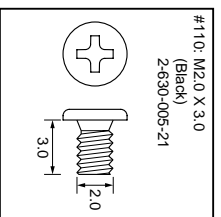

#110: M2.0 X 3.0
(Black)
2-630-005-21

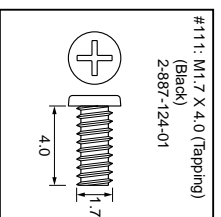

#111: M1.7 X 4.0 (Trapping)
(Black)
2-887-124-01

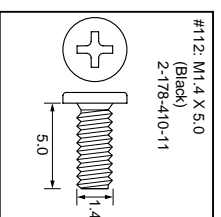

#112: M1.4 X 5.0
(Black)
2-178-410-11

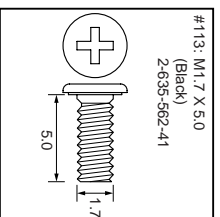

#113: M1.7 X 5.0
(Black)
2-635-562-41

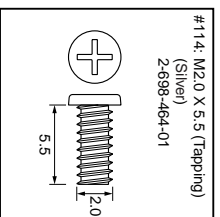

#114: M2.0 X 5.5 (Trapping)
(Silver)
2-698-464-01

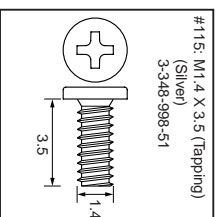

#115: M1.4 X 3.5 (Trapping)
(Silver)
3-348-998-51

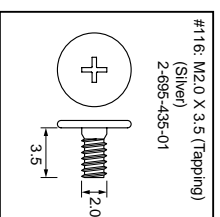

#116: M2.0 X 3.5 (Trapping)
(Silver)
2-695-435-01

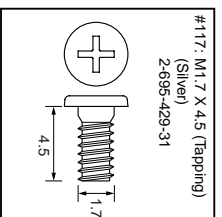

#117: M1.7 X 4.5 (Trapping)
(Silver)
2-695-429-31

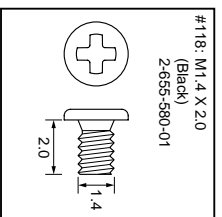

#118: M1.4 X 2.0
(Black)
2-655-580-01

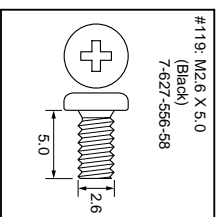

#119: M2.6 X 5.0
(Black)
7-627-556-58

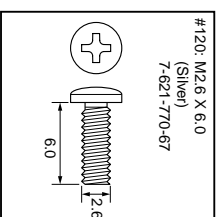

#120: M2.6 X 6.0
(Silver)
7-621-770-67

HARDWARE LIST (7/9)

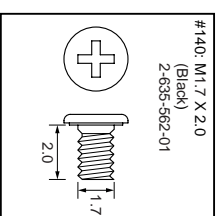
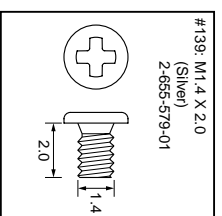
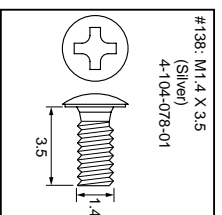
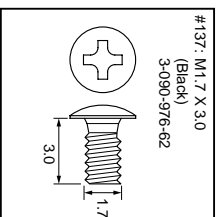
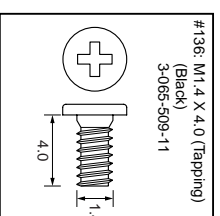
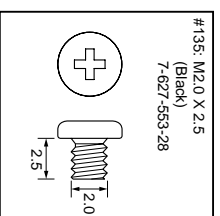
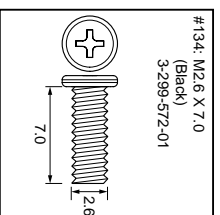
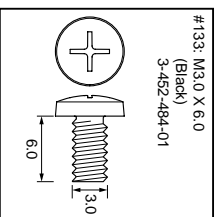
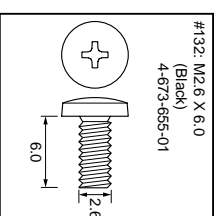
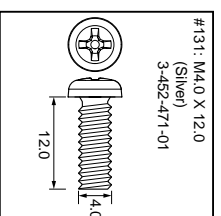
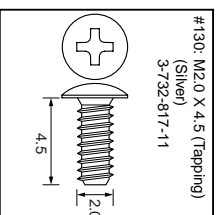
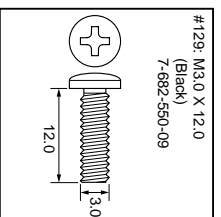
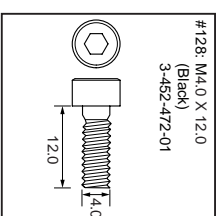
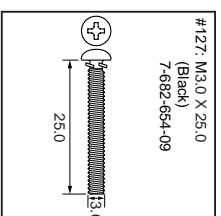
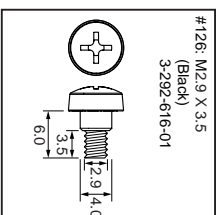
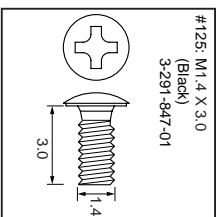
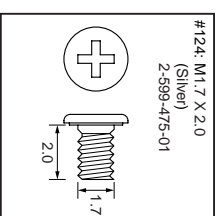
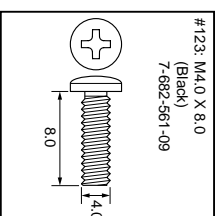
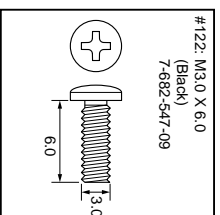
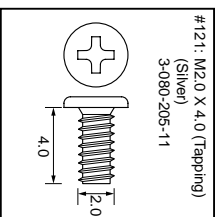

HARDWARE LIST (8/9)

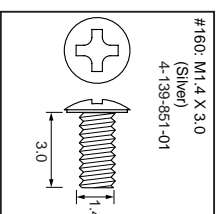
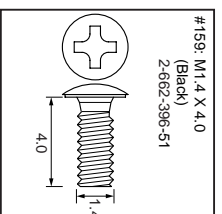
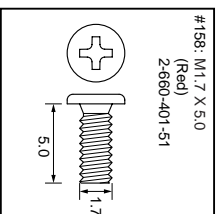
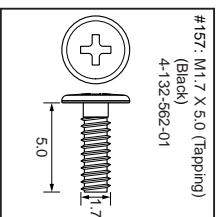
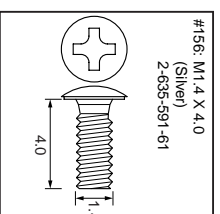
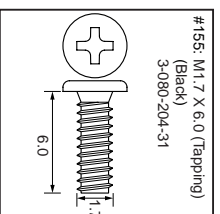
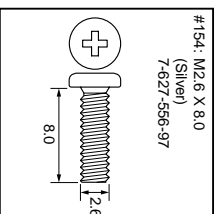
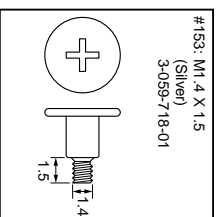
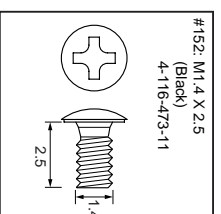
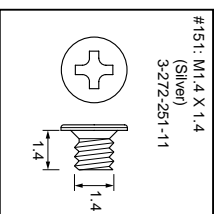
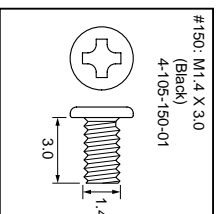
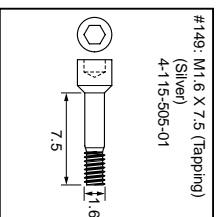
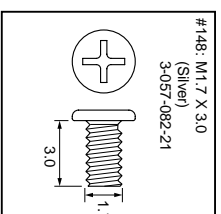
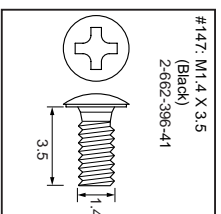
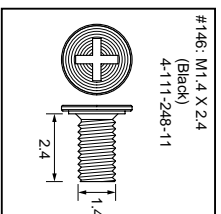
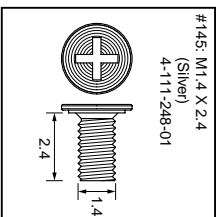
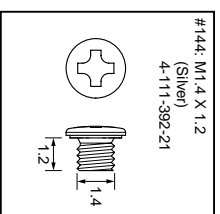
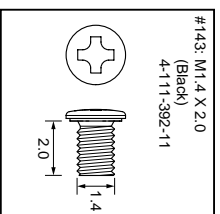
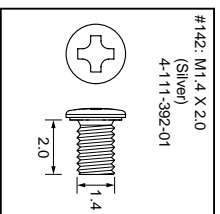
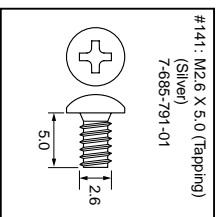

HARDWARE LIST (9/9)

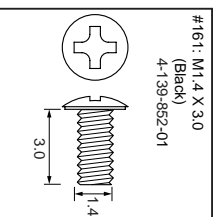

Reverse

965268231.pdf

Revision History

| Ver. | Date | History | Contents | S.M. Rev. Issued |
|------|---------|------------------|----------|------------------|
| 1.0 | 2009.03 | Official Release | — | — |
| | | | | |