

## 2-1. EXPLODED VIEWS

### 2-1-1. OVERALL SECTION-1

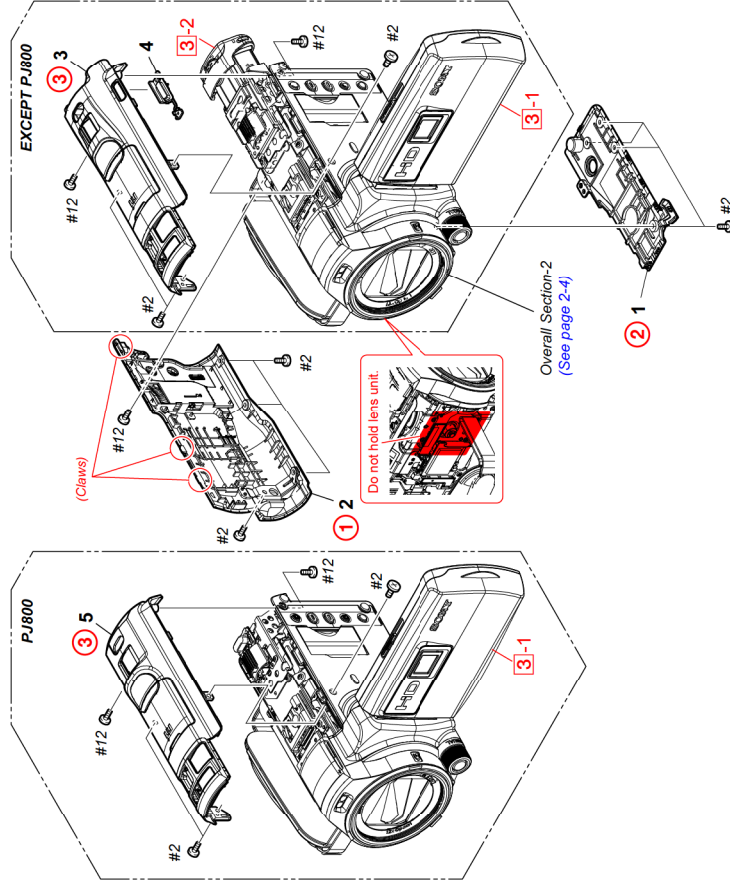

Ref. No.	Part No.	Description
1	4-451-004-01	CABINET (BM)
2	A-1992-239-A	CABINET (U) ASSY
3	A-1992-281-A	CABINET ASSY, TOP
4	4-450-965-01	BUTTON, MODE (EXCEPT P.J800)
5	A-1992-282-A	CABINET ASSY, TOP (BLACK)

Ref. No.	Part No.	Description
5	A-1992-263-A	CABINET ASSY, TOP (BROWN)
#2	2-635-562-31	SCREW (M1.7)
#12	3-080-204-21	SCREW, TAPPING, P2

## DISASSEMBLY

1. Remove in numerical order (1) to (3) in the left figure.

### (1) #2 X 4 → Open the Multi Lid (1) → #12 X 1

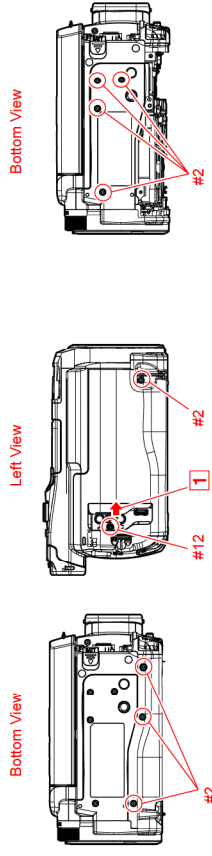

### (3) #12 X 2 → #2 X 2 → Open the LCD (3-1) → #2 X 1 → Slide the EVF (3-2)

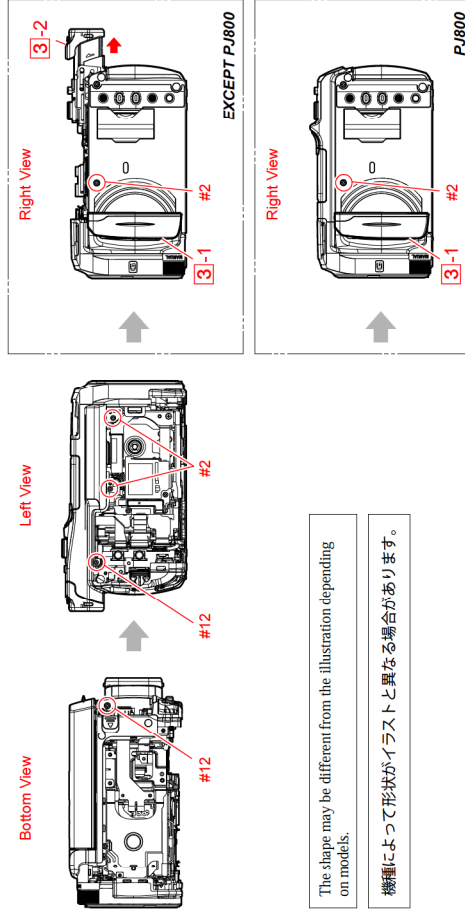

The shape may be different from the illustration depending on models.

機種によって形状がイラストと異なる場合があります。

## Screw

#2: M1.7 X 4.0  
(Black)  
2-635-562-31

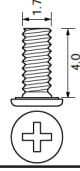

#2: M1.7 X 5.0 (Tapping)  
(Black)  
3-080-204-21

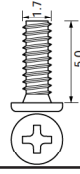

## 2-1-2. OVERALL SECTION-2

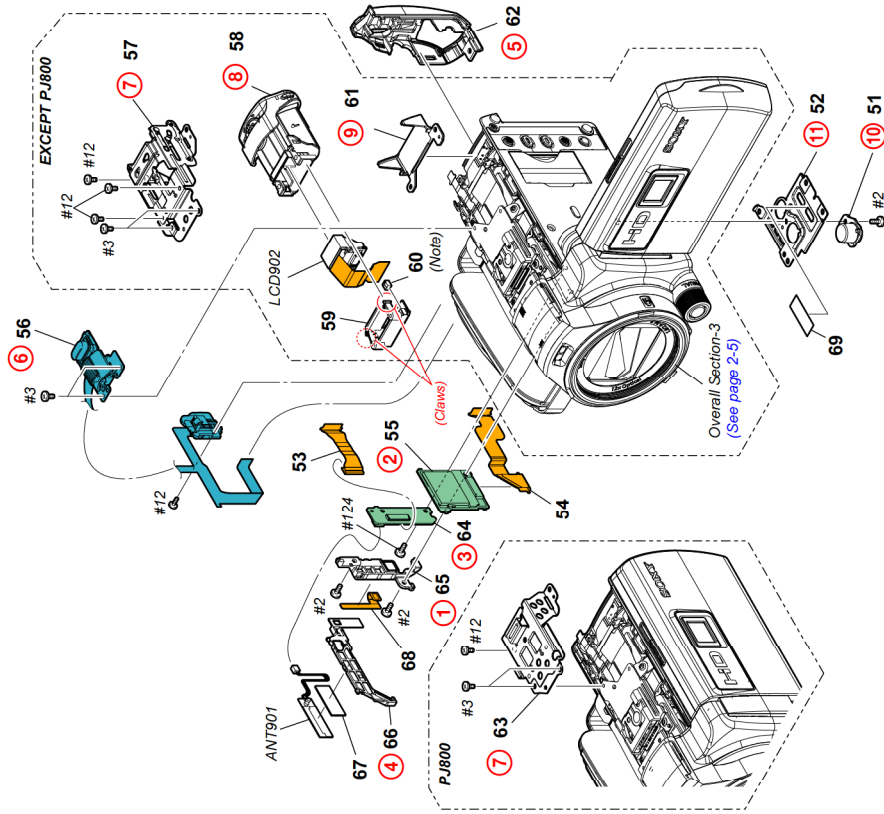

Ref. No.	Part No.	Description
51	3-283-64C-21	SCREW, TRIPOD
52	4-451-066-01	FRAME, CABINET (BM)
53	1-889-086-11	FP-2181 FLEXIBLE BOARD
54	1-889-175-11	FP-2188 FLEXIBLE BOARD
55	A-1999-491-A	MM-102 BOARD, COMPLETE (SERVICE) (PJB10/PJB10E)
55	A-1999-432-A	MM-102 BOARD, COMPLETE (SERVICE) (PJB00/PJB20/PJB20E)
56	1-491-936-11	SWITCH BLOCK, CONTROL (PS4230)
57	X-2586-386-1	FRAME ASSY, VF (EXCEPT PJB00)
58	X-2586-385-1	EYE CUP ASSY (EXCEPT PJB00)
59	4-450-955-01	RETAINER, VF HOLDER (EXCEPT PJB00)
60	1-471-571-11	MAGNET (HOLE SENSOR) (EXCEPT PJB00) (Note)
61	4-451-002-01	BASE, VF (EXCEPT PJB00)
62	4-451-005-01	COVER, L
63	4-450-995-01	FRAME, PS (PJB00)
64	A-1991-231-A	WF-1004 BOARD, COMPLETE
65	4-489-381-01	HOLDER (WF), ANTENNA
66	4-489-382-01	HOLDER (NF), ANTENNA
67	4-489-010-01	SHEET (ANT), ADHESIVE
68	1-889-592-11	AN-1006 FLEXIBLE BOARD
69	4-531-951-11	SHEET (CM), SHIELD
7	#12	SCREW (M1.7)
8	#3	SCREW (M1.7), NEW, TRU-STAR, P2
9	#124	SCREW, TAPPING, P2
10	#2	SCREW (M1.7)
11	#2	SCREW (M1.7)
ANT901	A-2040-499-A	NFC BLOCK ASSY (SERVICE)
LCD902	1-811-013-11	LCD MODULE (FJ0906) (EXCEPT PJB00)
#2	2-635-562-31	SCREW (M1.7)
#3	2-660-401-01	SCREW (M1.7), NEW, TRU-STAR, P2
#12	3-080-204-21	SCREW, TAPPING, P2
#124	2-599-475-01	SCREW (M1.7)

## DISASSEMBLY

1. Remove in numerical order (1) to (11) in the left figure.

① #2 X 2

Left View

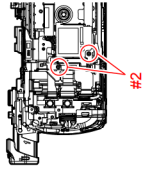

③ #124 X 1

Left View

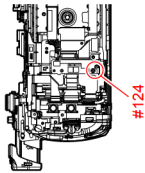

⑤ Open the DC Lid (2)

Left View

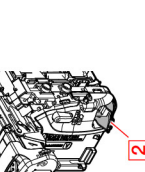

⑥ #12 X 1 → #3 X 2

Left View

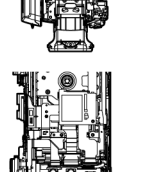

Top View

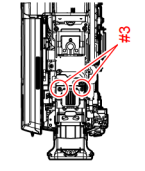

⑦ Slide the EVF (4-1) → #12 X 3 → #3 X 2 → Slide the EVF (4-2) → Slide the EVF (4-3)

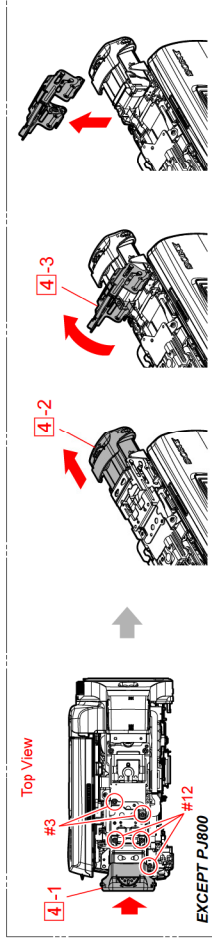

⑦ #12 X 1 → #3 X 2

Top View

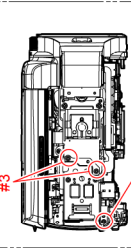

PJB00

The shape may be different from the illustration depending on models.

機種によって形状がイラストと異なる場合があります。

⑩ #2 X 1

Bottom View

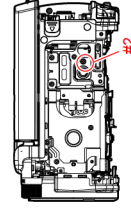

Screw

#2: M1.7 X 4.0  
(Black)  
2-635-562-31

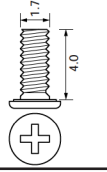

#3: M1.7 X 2.5  
(Red)  
2-660-401-01

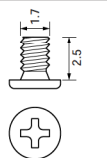

#12: M1.7 X 5.0 (Tapping)  
(Black)  
3-080-204-21

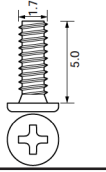

#124: M1.7 X 2.0  
(Silver)  
2-599-475-01

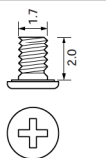

## Note

Note :  
Install the magnet with  
the marking oriented as  
shown below.

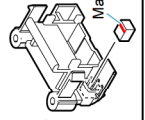

Note :  
マグネットを取付ける  
際は、マーキング面を  
図の位置にあわせて  
ください。

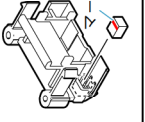

## 2-1-3. OVERALL SECTION-3

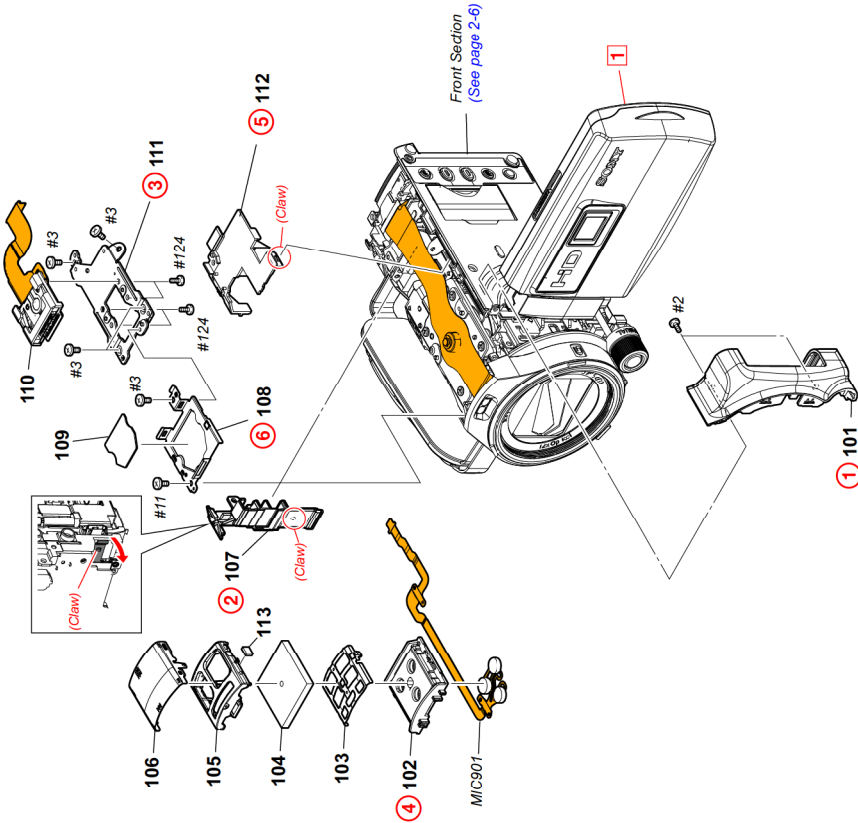

Ref. No.	Part No.	Description
101	4-489-385-01	COVER (R 462), HINGE (BLACK)
101	4-489-385-11	COVER (R 462), HINGE (BROWN)
102	4-449-591-01	INSULATOR, MICROPHONE
103	4-449-592-01	RETAINER, GRILLE
104	4-449-594-01	SCREEN, WIND
105	4-449-574-11	ORNAMENT, MICROPHONE
106	4-449-525-01	GRILLE, MICROPHONE
107	4-451-055-01	HOLDER (L), JACK
108	4-451-057-01	FRAME, MICROPHONE
109	4-451-056-01	CUSHION, MICROPHONE

Ref. No.	Part No.	Description
110	A-1917-913-A	FP-2105 FLEXIBLE BOARD, COMPLETE
111	4-451-058-01	FRAME, HS
112	4-451-055-01	GUARD, VC-FLEXIBLE
113	4-534-181-01	SHEET (MC), SPACER
MIC901	1-542-950-11	MICROPHONE UNIT
#2	2-635-562-31	SCREW (M1.7)
#3	2-660-401-01	SCREW (M1.7), NEW TRU-STAR, P2
#11	3-078-890-11	SCREW, TAPPING
#124	2-589-475-01	SCREW (M1.7)

## DISASSEMBLY

1. Remove in numerical order (1) to (6) in the left figure.

### (1) Open the LCD (1) → #2 X 2

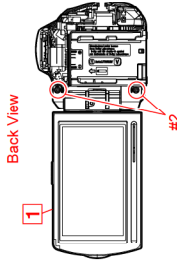

### (3) Disconnect the three connectors (3) → #3 X 5

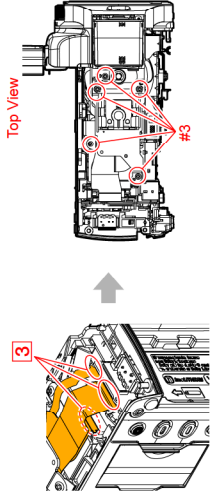

### (6) #11 X 1

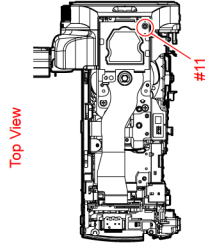

The shape may be different from the illustration depending on models.

機種によって形状がイラストと異なる場合があります。

## Screw

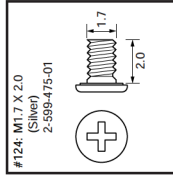
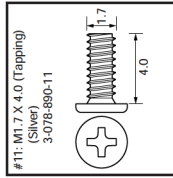
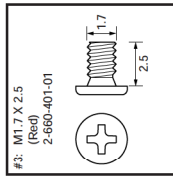
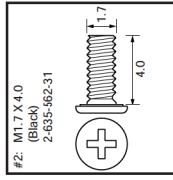

2-1-4. FRONT SECTION

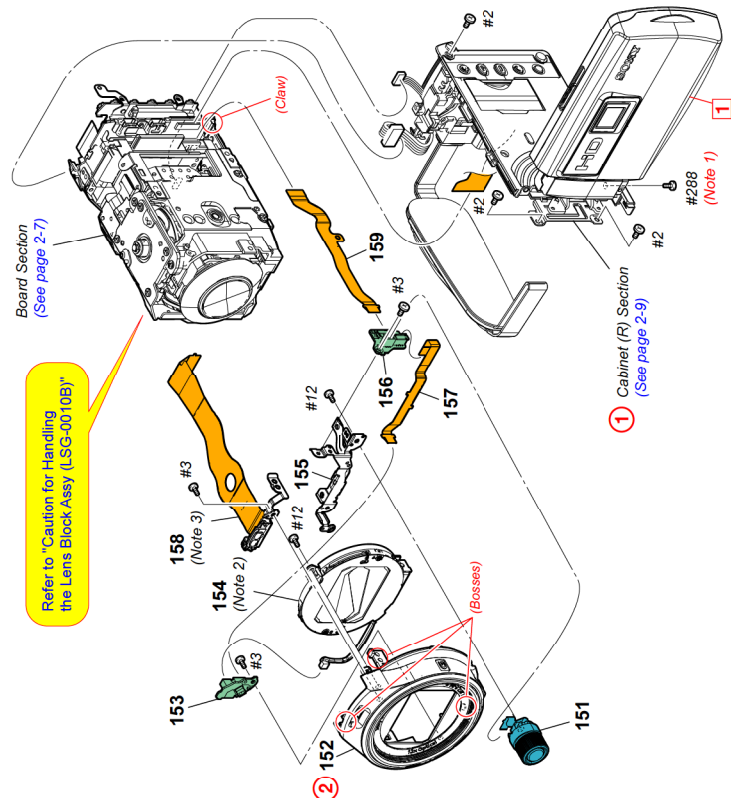

Ref. No.	Part No.	Description	Ref. No.	Part No.	Description
151	1-491-437-11	SWITCH BLOCK CONTROL (RS/42300)	#2	2-635-562-31	SCREW (M1.7)
152	A-1891-212-A	CABINET (F) ASSY	#3	2-660-401-01	SCREW (M1.7), NEW TRU-STAR, P2
153	A-1891-236-A	FR-1008 BOARD, COMPLETE	#12	3-080-204-21	SCREW, TAPPING, P2
154	A-1902-283-A	BARRIER UNIT/LENS (Note 2)	#288	2-187-345-21	SCREW (M1.7), P2 (Note 1)
155	4-449-606-01	FRAME (LOWER), F			
156	A-1891-235-A	OC-1003 BOARD, COMPLETE			
157	1-887-475-11	FP-2102 FLEXIBLE BOARD			
158	A-1891-272-A	ST BLOCK ASSY (Note 3)			
159	1-887-472-11	FP-2099 FLEXIBLE BOARD			

DISASSEMBLY

1. Remove in numerical order (1) to (2) in the left figure.

① #2 X 2 → Open the LCD (1) → #2 X 1 → #288 X 1

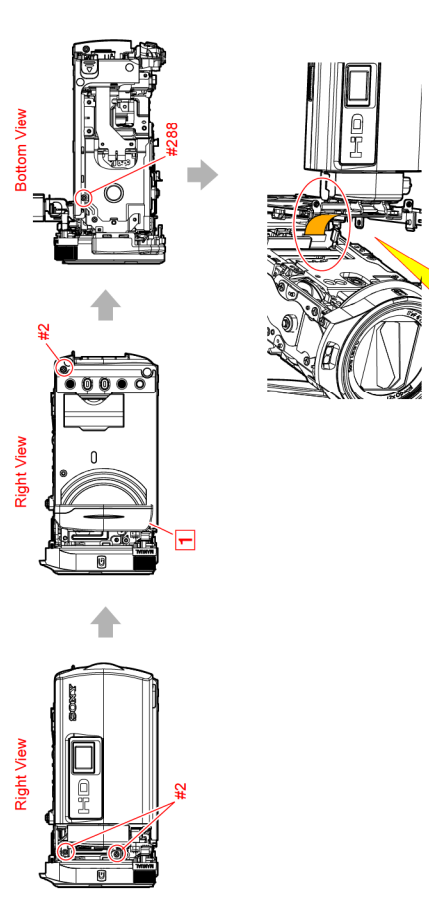

The shape may be different from the illustration depending on models.

機種によって形状がイラストと異なる場合があります。

Screw

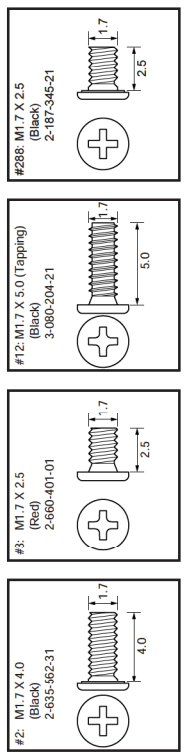

Note

**Note 1:** This screw cannot be reused. Discard the screw removed once in servicing. Instead, use a new screw.

**Note 2:** Refer to "Assembly-1: Notes on Assembling the Lens Barrier Unit," when you assemble.

**Note 3:** This model is provided with a flash unit using LED Flash/Video light. Therefore, the LED Flash/Video light does not have high voltage part and does need to be discharged the capacitor.

**Note 1:** このねじは再利用することができません。サービス対応時に一度でも外した場合は新品のねじと交換してください。

**Note 2:** 組立時は"Assembly-1: Notes on Assembling the Lens Barrier Unit."を参照してください。

**Note 3:** この機種ではLEDを使用したLEDフラッシュ/ビデオライトを使用しております。そのため高電圧部分が無く、コンデンサ放電は不要です。

## 2-1-5. BOARD SECTION

ns: not supplied

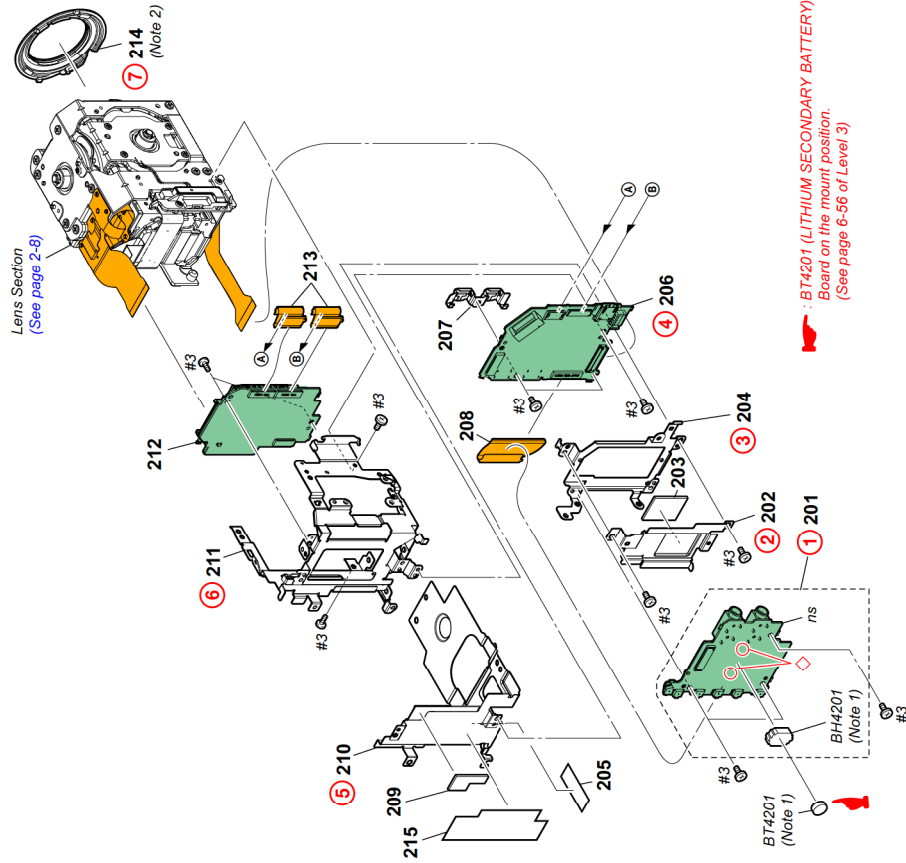

Ref. No.	Part No.	Description
201	A-1991-234-A	RH-1003 BOARD, COMPLETE
* 202	4-451-054-11	HEAT SINK (B) ,/C
203	4-451-055-01	SHEET (B) ,RADIATION
204	4-489-362-01	FRAME, RH
205	4-531-951-01	SHEET (CM) , SHIELD
△ 206	A-1999-450-A	VC-1022 BOARD, COMPLETE (SERVICE)
207	4-527-355-01	RETAINER (462) ,HDMI
208	1-899-125-11	FP-2187 FLEXIBLE BOARD
209	4-451-046-01	SHEET (A) ,RADIATION
* 210	4-451-046-11	HEAT SINK (A) ,/C
211	4-489-361-C1	FRAME, VC
212	A-2043-878-A	LD-1014 BOARD, COMPLETE (SERVICE)
213	1-889-128-11	FP-2186 FLEXIBLE BOARD
214	4-451-698-11	ORNAMENT, LENS (Note 2)
* 215	4-532-772-C1	SHEET (C) , RADIATION
△ BH4201	1-251-928-21	SOCKET BATTERY (Note 1)
△ BT4201	1-756-134-15	BATTERY, LITHIUM (SECONDARY) (Note 1)
#3	2-660-401-C1	SCREW (M1.7) , NEW TRU-STAR, P2

## DISASSEMBLY

- Remove in numerical order (1) to (7) in the left figure.
- The meaning of the symbol in left figure is as follows. Be careful when you remove it.  
◇: X: Solder

### 1 #3 X 3

Back View

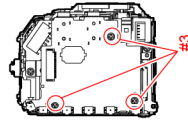

### 2 #3 X 2

Back View

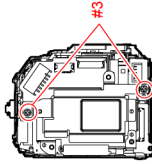

### 4 #3 X 3

Back View

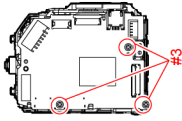

### 6 #3 X 2

Left View

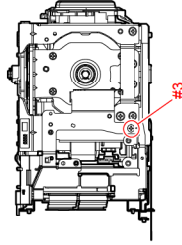

Right View

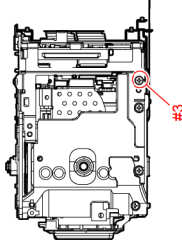

## Screw

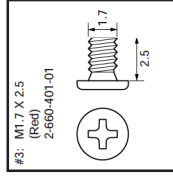

## Note

**Note 1:** Replace the battery holder (BH4201) together when replacing the lithium storage battery (BT4201) on the RH-1003 board.  
(The battery holder removed once cannot be used again.)  
When mounting these parts, mount new battery holder first and attach new lithium storage battery next.

**Note 1:** RH-1003基板のリチウム蓄電池 (BT4201) を交換する場合は、バッテリーホルダ (BH4201) も同時に新品に交換してください。  
(一度使用したバッテリーホルダは再使用できません。)  
部品取り付けの際は、先にバッテリーホルダを取り付けてからリチウム蓄電池を装着してください。

**Note 2:** Refer to "Assembly-2: Notes on Disassembling the Lens Ornament." when you assemble.

**Note 2:** 組立時は"Assembly-2: Notes on Disassembling the Lens Ornament."を参照してください。

## Screw

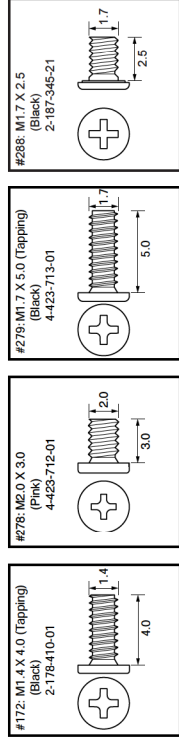

## Note

**Note 1:** This screw cannot be reused. Discard the screw removed once in servicing. Instead, use a new screw.

**Note 2:** Do not reuse the CM Radiation Sheet because its adhesive force decreases when it is removed once.

**Note 3:** Be sure to read "Precautions for Replacement of Imager" on page 6-1 of Level 3 when changing the imager.

**Note 4:** When any of these Flexible Boards is peeled off and decreased adhesive force of the Adhesive Part or wrinkle or break of the Flexible Board is found, replace the defective Flexible Board with a new one.

**Note 5:** Refer to "Assembly-3: How to distinguish the side of Optical Filter Block facing to Lens Device."

**Note 6:** Refer to "1-9. LENS DEVICE (LSV-1400B) REPLACING METHOD," when you exchange parts of Lens Block.

**Note 7:** Cut the SHEET ADHESIVE (4-441-672-01) as shown in the balloon in the figure and use it.

**Note 8:** Cut the polyimide tape for specified size.

**Note 1:** このねじは再利用することができません。サービス対応時に一度でも外した場合は新品のねじと交換してください。

**Note 2:** CM Radiation Sheetは一度剥がすと粘着力が弱くなるため、再利用はしないでください。

**Note 3:** イメージャの交換時はLevel 3の6-1ページ、「イメージャ交換時の注意」を必ずお読みください。

**Note 4:** これらのフレキシブル基板を剥がした場合に、粘着部の粘着力の低下、フレキシブル基板のしわ、折れが認められた場合は新品に交換してください。

**Note 5:** "Assembly-3: How to distinguish the side of Optical Filter Block facing to Lens Device."を参照してください。

**Note 6:** レンズブロックの各部品を交換する際は、「1-9. レンズデバイス (LSV-1400B) の交換方法」を参照してください。

**Note 7:** SHEET ADHESIVE (4-441-672-01) は図中の吹き出しのように切って使用すること。

**Note 8:** ポリイミドシートは、指定の寸法にカットして使用してください。

## 2-1-6. LENS SECTION

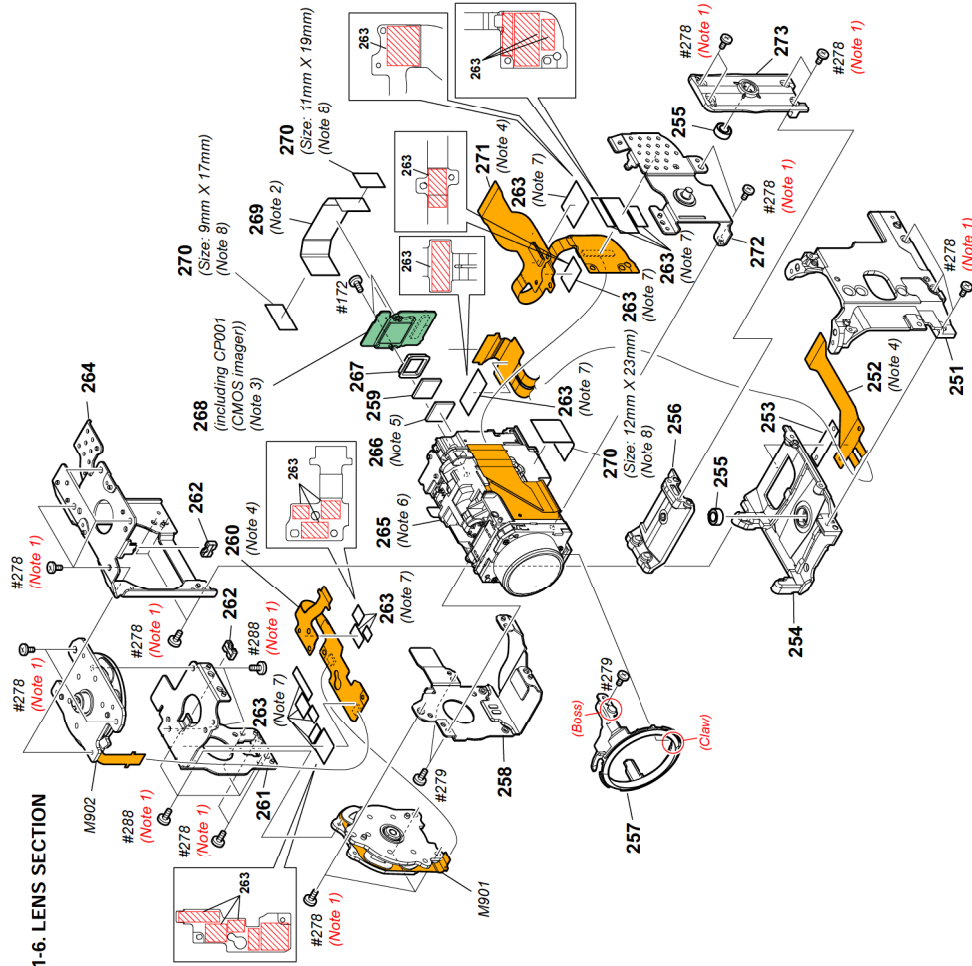

Ref. No.	Part No.	Description	Ref. No.	Part No.	Description
251	4-434-855-01	FRAME-F-SUB-A (0010)	266	1-866-171-21	FILTER BLOCK OPTICAL (Note 5)
252	1-889-091-11	LF-2063 FLEXIBLE BOARD (Note 4)	267	3-216-044-01	RUBBER (1270), SEAL
253	4-531-952-01	SHEET (LE), SPACER	268	A-1900-787-A	CM-1007 BOARD, COMPLETE (Including IC1001 (CMOS imager)) (Note 3)
254	4-434-856-01	FRAME-F-SUB-B (0010)	269	4-531-862-01	SHEET (462), CM RADIATION (Note 2)
255	4-436-436-01	BEARING (FLANGE NON), BALL	270	2-960-751-01	SHEET, POLYIMIDE (Note 8)
256	4-434-854-01	FRAME-E-SUB-B (0010)	271	1-887-303-13	LF-2026 FLEXIBLE BOARD (Note 4)
257	4-434-845-01	ORNAMENT, FRONT (0010)	272	4-434-852-01	SHEET METAL-D-SUB (0010)
258	4-434-845-01	SHEET METAL-A (0010)	273	4-434-853-01	FRAME-E-SUB-A (0010)
259	1-856-172-21	FILTER BLOCK OPTICAL	M901	1-855-220-11	MOTOR-A (0010)
260	A-1917-502-A	LF-2025 FLEXIBLE BOARD, COMPLETE (Note 4)	M902	1-855-221-11	MOTOR-B (0010)
261	4-434-856-01	SHEET METAL-B (0010)	#172	2-178-410-01	TITE (UB TITE) 1.4
262	4-434-857-01	STOPPER (0010)	#278	4-423-712-01	SCREW 0-P2 M2 NEW TRU-STAR (Note 1)
263	4-441-672-01	SHEET ADHESIVE (Note 7)	#279	4-423-713-01	SCREW 0-P2 B1.7
264	4-434-851-01	SHEET METAL-C (0010)	#288	2-187-345-21	SCREW (M1.7), P2 (Note 1)
265	8-848-905-01	DEVICE, LENS LSV-1400B (Note 6)			

## 2-1-7. Cabinet (R) Section

ns: not supplied

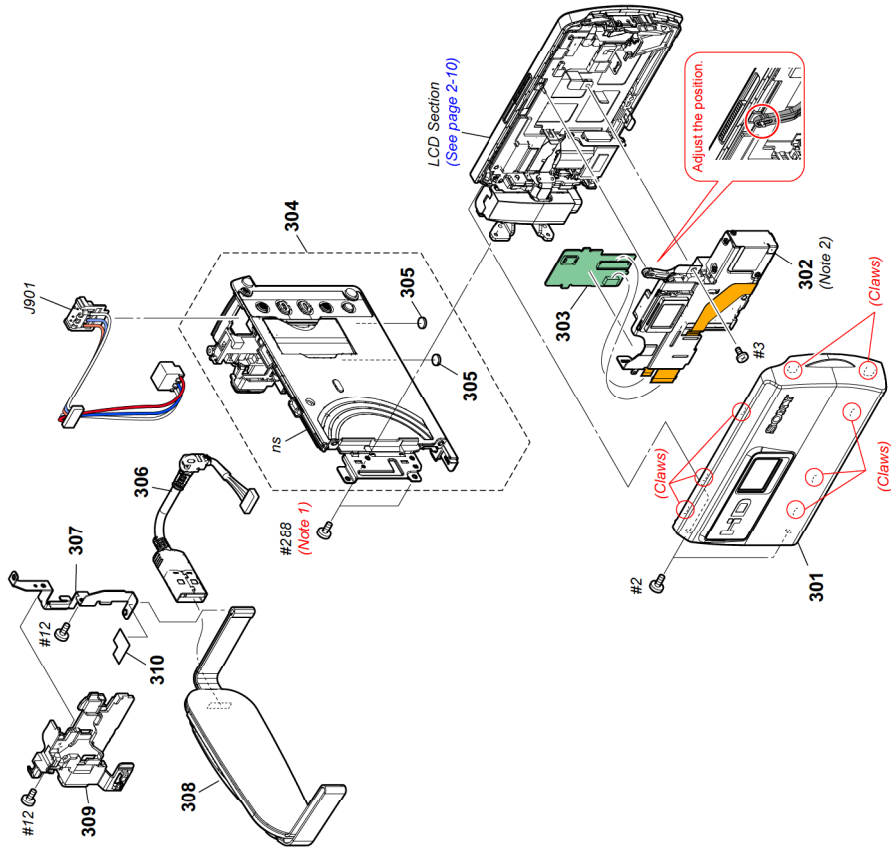

Ref. No.	Part No.	Description	Ref. No.	Part No.	Description
301	A-1992-245-A	CABINET (C) BLOCK ASSY, P (P.800 (BROWN))	308	4-419-611-01	BELT (M), 12 TYPE GRIP
301	A-1992-246-A	CABINET (C) BLOCK ASSY, P (P.810P.810E)	309	4-450-957-01	GUARD, BELT
301	A-1992-247-A	CABINET (C) BLOCK ASSY, P (P.820P.820E)	310	4-531-950-01	SHEET (US), FLEXIBLE GUARD
301	A-1992-248-A	CABINET (C) BLOCK ASSY, P (P.800 (BLACK))	△ J901	1-822-470-22	JACK, DC
302	A-1975-584-A	LSV-1650A (Note 2)	#2	2-635-562-31	SCREW (M1.7)
303	A-1991-241-A	PJ-1008 BOARD, COMPLETE	#3	2-660-401-01	SCREW (M1.7), NEW TRU-STAR, P2
304	A-1992-2-6-A	CABINET (R (462)) ASSY	#12	3-080-204-21	SCREW, TAPPING, P2
305	2-589-376-01	FOOT (395), RUBBER	#288	2-187-345-21	SCREW (M1.7), P2 (Note 1)
306	1-838-712-42	CABLE, BUILT-IN USB			
307	4-450-956-01	SHEET METAL (R), BELT			

## Screw

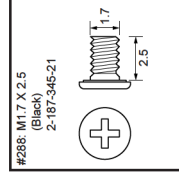
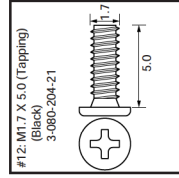
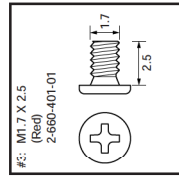
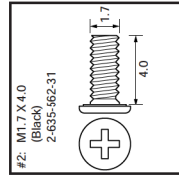

## Note

**Note 1:** This screw cannot be reused. Discard the screw removed once in servicing. Instead, use a new screw.

**Note 1:** このねじは再利用することができません。サービス時時に一度でも外した場合は新品のねじと交換してください。

**Note 2:**  
Do not hold the following part.

Lens

\* Very weak

The projector unit (copper plate in particular) becomes hot after it is used.  
When replacing a part of the projector unit, wait until it is cooled down.

**Note 2:**  
持ってはいけない部分

レンズ

\* 非常に弱い部分

プロジェクターを使用した後は、プロジェクターユニットが熱くなっています。特に銅板の部分は高温になります。部品を交換する時は、温度が下がってから作業を行ってください。

## 2-1-8. LCD SECTION

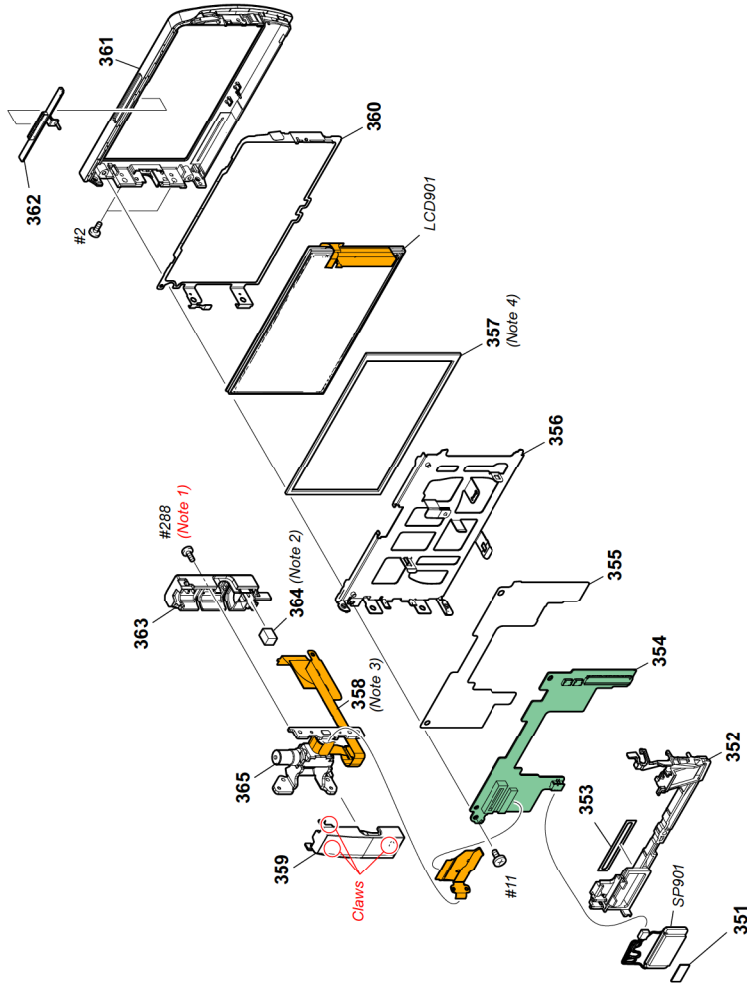

Ref. No.	Part No.	Description
351	4-271-666-01	CUSHION (M)
352	4-489-355-01	HOLDER (462), SP
353	4-489-354-01	CUSHION, SPH
354	A-1991-238-A	PD-1027 BOARD, COMPLETE
355	4-489-366-01	INSULATING SHEET (PD)
356	4-489-357-01	RETAINER (462), LCD
357	4-209-805-01	CUSHION, LCD (Note 4)
358	1-889-086-11	FP-2180 FLEXIBLE BOARD (Note 3)
359	4-489-385-01	COVER (O 462), HINGE (BLACK)
359	4-489-385-11	COVER (O 462), HINGE (BROWN)

Ref. No.	Part No.	Description
360	4-489-356-01	PLATE (P 462), GROUND
361	4-489-355-01	CABINET (M 462), P
362	4-489-359-01	KNOB, FOCUS
363	4-450-923-C4	COVER (U 425), HINGE
364	1-471-573-11	MAGNET (Note 2)
365	X-2865-820-2	HINGE (P) (Y 4071) ASSY
LCD901	A-1970-989-A	DISPLAY MODULE (MG1-WB,DD)
SP901	1-858-528-51	SPEAKER (2-1CM)
#2	2-635-562-31	SCREW (M1.7)
#11	3-078-890-11	SCREW, TAPPING
#288	2-187-345-21	SCREW (M1.7), P2 (Note 1)

## Screw

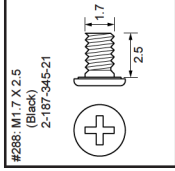
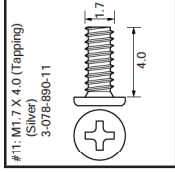
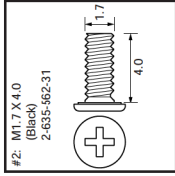

## Note

**Note 1:** This screw cannot be reused. Discard the screw removed once in servicing. Instead, use a new screw.

**Note 2:** Install the magnet with the marking oriented as shown below.

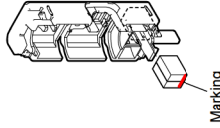

**Note 2:** マグネットを取付ける際は、マーキング面を図の位置にあわせてください。



**Note 3:** Refer to "Assembly 4: The Method of attachment of FP-2180 Flexible Board," when you assemble.

**Note 3:** 組立時「Assembly 4: The Method of attachment of FP-2180 Flexible Board.」を参照してください。

**Note 4:** Refer to "Assembly 5: Notes on Assembling the LCD Cushion," when you assemble.

**Note 4:** 組立時「Assembly 5: Notes on Assembling the LCD Cushion.」を参照してください。



• EXCEPT J MODEL ACCESSORIES

Ref. No.	Part No.	Description	Ref. No.	Part No.	Description
901	1-492-766-11	AC Adaptor (US, E; NTSC, JE, J)	901	4-489-507-01	Help Guide (JAPANESE)
902	1-492-766-21	AC Adaptor (CH)	901	4-489-505-11	Help Guide (ENGLISH)
903	1-492-766-11	AC Adaptor (AEP, NE, E (PAL, Middle East))	901	4-489-505-21	Help Guide (FRENCH)
904	1-492-766-31	AC Adaptor (KR)	901	4-489-505-31	Help Guide (SPANISH)
905	1-492-771-11	AC Adaptor (E; Saudi, HK)	901	4-489-506-41	Help Guide (GERMAN)
906	1-569-007-12	Conversion (2P) Adaptor (E; NTSC, JE)	901	4-489-506-51	Help Guide (ITALIAN)
907	1-838-714-31	USB connection support cable	901	4-489-506-61	Help Guide (DUTCH)
908	1-846-026-21	HDMI cable	901	4-489-506-71	Help Guide (PORTUGUESE)
909	X-2686-388-1	Step Down Ring	901	4-489-506-81	Help Guide (BRAZILIAN PORTUGUESE)
910	1-479-275-51	Wireless Remote Commander	901	4-489-506-91	Help Guide (TURKISH)
911	4-489-506-11	Operating Guide (ENGLISH)	901	4-531-294-11	Help Guide (CZECH)
912	4-489-506-31	Operating Guide (SPANISH)	901	4-531-294-21	Help Guide (HUNGARIAN)
913	4-489-506-41	Operating Guide (TRADITIONAL CHINESE)	901	4-531-294-31	Help Guide (SLOVAK)
914			901	4-531-294-41	Help Guide (POLISH)
915			901	4-531-294-51	Help Guide (SWEDISH)

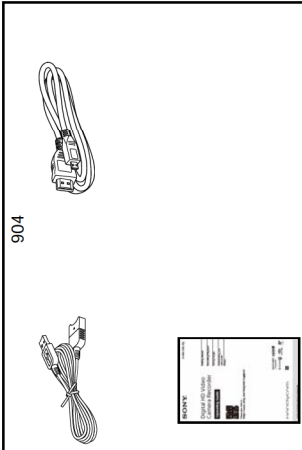

This item is not supplied with the unit as an accessory, but it is prepared as a service part. When the customer requests printed one, ask Head Quarter.

941



Ref. No.	Part No.	Description	Ref. No.	Part No.	Description
941	4-489-506-01	Help Guide (JAPANESE)	911	4-531-294-61	Help Guide (DANISH)
941	4-489-506-11	Help Guide (ENGLISH)	911	4-531-294-71	Help Guide (FINNISH)
941	4-489-506-21	Help Guide (FRENCH)	911	4-531-294-81	Help Guide (RUSSIAN)
941	4-489-506-31	Help Guide (SPANISH)	911	4-531-294-91	Help Guide (UKRAINIAN)
941	4-489-506-41	Help Guide (GERMAN)	911	4-531-295-11	Help Guide (TRADITIONAL CHINESE)
941	4-489-506-51	Help Guide (ITALIAN)	911	4-531-295-21	Help Guide (SIMPLIFIED CHINESE)
941	4-489-506-61	Help Guide (DUTCH)	911	4-531-295-31	Help Guide (KOREAN)
941	4-489-506-71	Help Guide (PORTUGUESE)	911	4-531-295-41	Help Guide (ARABIC)
941	4-489-506-81	Help Guide (BRAZILIAN PORTUGUESE)	911	4-531-295-51	Help Guide (PERSIAN)
941	4-489-506-91	Help Guide (TURKISH)	911	4-531-295-61	Help Guide (INDONESIAN)
941	4-531-294-11	Help Guide (CZECH)	911	4-531-295-71	Help Guide (THAI)
941	4-531-294-21	Help Guide (HUNGARIAN)			
941	4-531-294-31	Help Guide (SLOVAK)			
941	4-531-294-41	Help Guide (POLISH)			
941	4-531-294-51	Help Guide (SWEDISH)			

Ref. No.	Part No.	Description
△	8-022-373-30	Rechargeable battery pack NP-FV50UC (US)
△	8-022-373-50	Rechargeable battery pack NP-FV50ICE (EXCEPT US, ME, CH)
△	8-022-373-55	Rechargeable battery pack NP-FV50RU (NE)
△	8-022-373-71	Rechargeable battery pack NP-FV50CN (CH)