



**LG**

<http://biz.lgservice.com>

# REFRIGERATOR

# SERVICE MANUAL

**CAUTION**  
BEFORE SERVICING THE UNIT, READ THE "SAFETY  
PRECAUTIONS" IN THIS MANUAL.

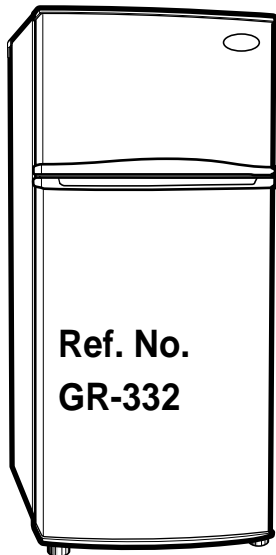

**MODEL: GN-332**

**COLOR: ALL COLOUR**

# 8. EXPLODED VIEW

The parts of refrigerator and the shape of each part are subject to change in different localities.  
Capacitors and fuse are optional parts.

\*: optional parts.

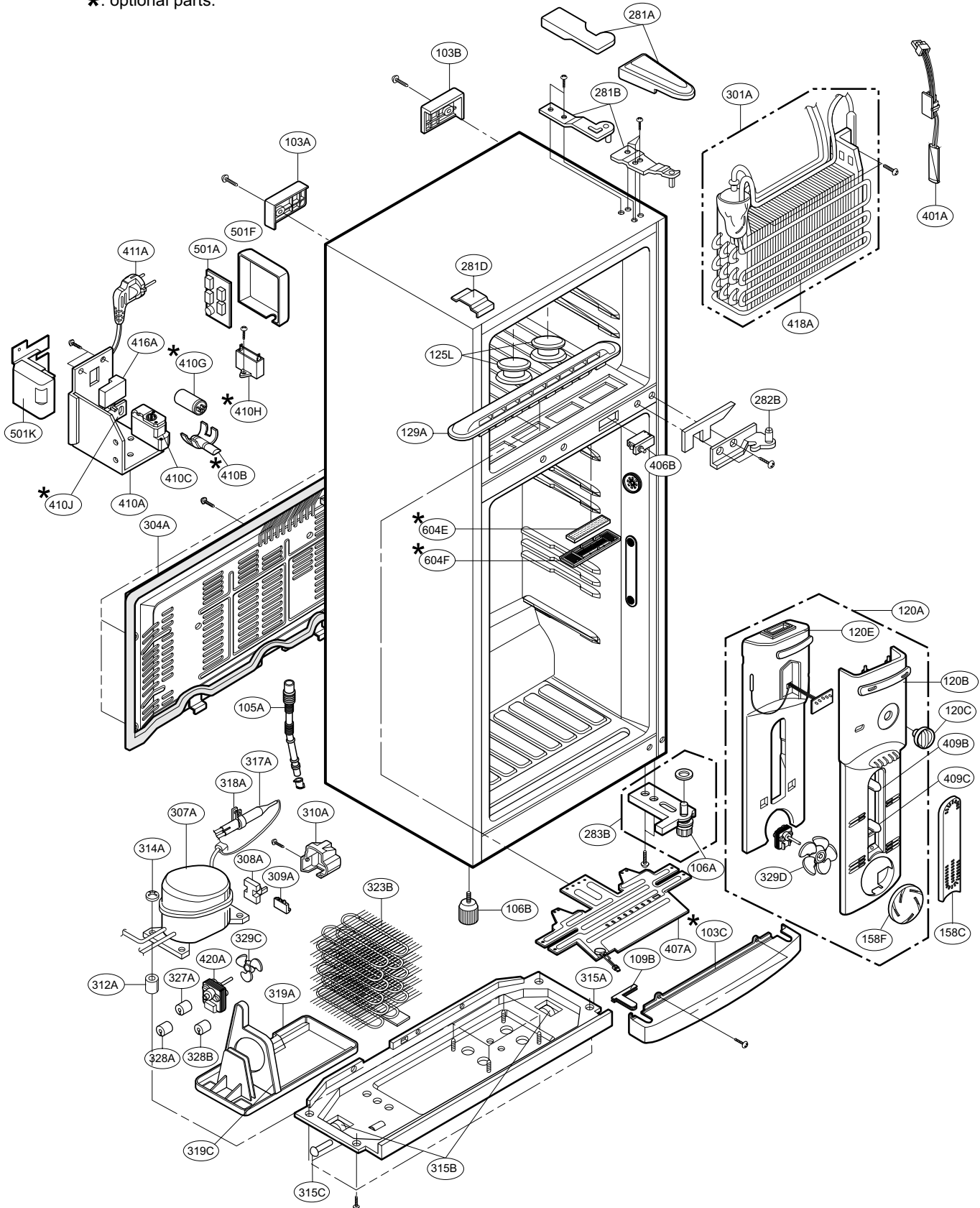

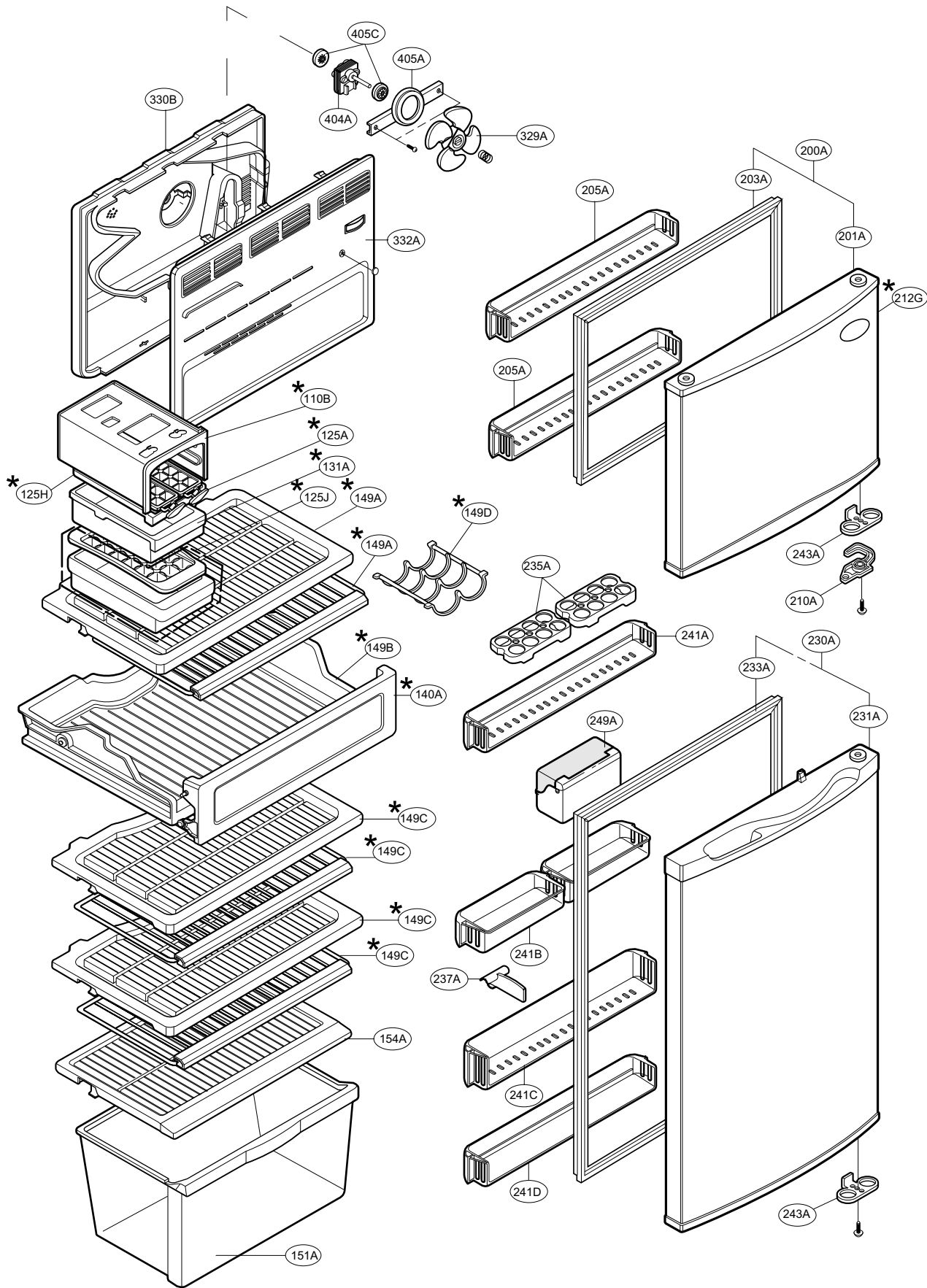



P/No. 3828JD8323J

FEB., 2006 Printed in Korea



Non	Part No	Description	Specification	Loc No
1	0CZZJB2003C	CAPACITE	0CZZJB2003C CR:5	410G
2	2521C-A5711	COMPRESSOR,SET ASSEMBL	MA57LAEM AR1EOIL	307A
3	3103JA1010D			315A
4	3390JA0005A	FIXATION COMPRESSEUR 31	MOLD PP PP NATUR	319A
5	3390JA1058A	BAC A GLACONS	MOLD PP PP SUPER V	125A
6	3390JA1074B	BAC A LEGUMES	MOLD GPPS GPPS CR	151A
7	3390JA1076C	BAC A OEUFS	MOLD GPPS GPPS CR	235A
8	3391JA1015B	CLAYETTE	GR-00 C/ST	149B
9	3531JA1017B	CACHE VENTILATEUR	GR-332,T342 C/WH B	332A
10	3550JA0012A			304A
11	3550JA0020B	COUVERCLE	MOLD PP PP SUPER V	103C
12	3550JA1065B			154A
13	3550JA2042A	COUVERCLE	MOLD ABS GP-2151F	310A
14	3550JA2052A	COUVERCLE	MOLD MIPS MIPS LI	604F
15	3550JA2052A	COUVERCLE	MOLD MIPS MIPS LI	604F
16	3550JA2052C	COVER,DEODORIZER	MOLD MIPS MIPS SK	604F
17	3550JA2083H	CACHE 281A	MOLD PP PP SUPER	281A
18	3550JD1010F			158C
19	3551JA2091C	CLAYETTE	BP7,8-PJT(GR-S392/3	154A
20	3551JA2091C	CLAYETTE	BP7,8-PJT(GR-S392/3	154A
21	3580JA1019A			140A
22	3580JD1028B	DOOR,FRESH ROOM	MOLD GPPS GPPS C	140A
23	3581JA8316C	DOOR ASSEMBLY,F	332SF SW RV GR-332	200A
24	3581JA8317A	PORTE REFRIGERATEUR	332SF SW RV NK	230A
25	3650JA2003S	POIGNEE	MOLD PP M-540 PP_J	103A
26	3650JA2003T	POIGNEE	MOLD PP M-540 PP_J	103B
27	3890JC2778R			BOX
28	3J02312A	GUIDE BANDE	MOLD PE PE NATURA	315B
29	3J04686A	BOUTON 106A	PE-H 43MM 38MM R-	106B
30	3J04686A	BOUTON 106A	PE-H 43MM 38MM R-	106A
31	3J04686A	BOUTON 106A	PE-H 43MM 38MM R-	106B
32	4140JD1020F	NAME PLATE,P(H)	PRINTING - 01 (LG B	212G
33	4620JA2007A	STOP PORTE	MOLD POM POM NAT	210A
34	4680JB1035C	MOTOR(MECH),COOLING	240V 37.5MA 9W 50H	420A
35	4680JB1039F	MOTOR(MECH),FAN	240V 41MA 10W 50H	404A
36	4756JA3001C	FILTRE	COMPLEX MN+CU N	604E
37	4756JA3001C	FILTRE	COMPLEX MN+CU N	604E
38	4756JA3001H	FILTRE	COMPLEX MN+CU N	604E
39	4775JA2020A	CHARNIERE	GR-332 SCP1 3.2	283B
40	4775JA2020A	CHARNIERE	GR-332 SCP1 3.2	283A
41	4775JA3009B	CHARNIERE	GR-332/372 SCP1 3.2	282B
42	4775JA3015C	CHARNIERE	GR-332-482 SCP1 3.2	281B
43	4778JA2008A	LEG PIED	PE-H 9.8MM -MM GR	106B
44	4778JA2008A	LEG PIED	PE-H 9.8MM -MM GR	106B
45	4778JA2008A	LEG PIED	PE-H 9.8MM -MM GR	106B
46	4810JA2005B	BRACKET,TIMER	PRESS SBHG T0.8 SB	410A
47	4810JA3075A	BRACKET,MOTOR	PRESS SPCC T1.2 SC	405A
48	4826JA2004A	SUPPORT	MOLD EPS GR-332,37	303A
49	4930JA3033A	FIXATION	MOLD MIPS MIPS SU	125L
50	4940JA2006A	BOUTON THERMOSTAT	MOLD ABS HG-173 A	120C
51	4974JA1017A	BAC A GLACONS 110B	MOLD MIPS MIPS SU	110B
52	4974JA1023A	GUIDE HELICE	MOLD PP PP MU40 N	319C
53	4974JA1024A	DEFLECTEUR	MOLD HIPS HIPS SU	129A
54	4974JA2013D	GUIDE BAC BOUTEILLE 273A	MOLD PP PP M/BLUE	237A
55	4974JA3031A	FIXATION	PRESS SPCC T2.3 SC	243A

56	4980JA1010A	BAC RECUPERATEUR EAU 12	MOLD MIPS MIPS SU	125H
57	4981JA3004A	SUPPORT	GR-332-482 T.3	104C
58	4987JA1020N	JOINT PORTE CONGEL	R-332(98) (98) F DO	203A
59	4987JA1020F	JOINT PORTE REF	R-332(98) (98) R DO	233A
60	4994JD1028B			120B
61	4995JA1033B	CONTROL BOX ASSEMBLY,R	D2-332,GR-332,T342	120A
62	4995JA1033B	CONTROL BOX ASSEMBLY,R	D2-332,GR-332,T342	120A
63	4999JA1013A	BOITIER 330B	332-- D=110 R-CTRL	330B
64	4J03020A	CALE/ENTRETOIS	MOLD EPDM RUBBE	328A
65	4J03277A	FREIN	T0.7	314A
66	4J04238A	ENSEMBLE PIECES MECANIQ	4J04238A PARALLEL	315C
67	4J04328A	CALE/ENTRETOIS	MOLD EPDM EPDM B	327A
68	5004JA1056B	BASKET DOOR	MOLD GPPS 25SP BA	241B
69	5004JD1086E			205A
70	5004JD1087E	CASIER A OEUFS	GPPS CRYSTSL - JA1	241A
71	5004JD1088E	CASIER A OEUFS	MOLD GPPS GPPS C	241C
72	5004JD1089E	CASIER A OEUFS	GPPS CRYSTSL - JA1	241D
73	5006JA2011H			281D
74	5006JA2020B			109A
75	5006JA3050B	CALE/ENTRETOIS	MOLD PP M540 PP(M	109B
76	5026JA1091B	CLAYETTE CONGEL	MOLD SAN 82TR SA	149A
77	5026JA1092B	CLAYETTE REF (149D)	MOLD SAN SAN (82	149C
78	5040JA3035A	RONDELLE	MOLD EPDM EPDM B	312A
79	5074JA1003A	bac a glace-congel	MOLD GPPS GPPS CR	131A
80	5075JA2004F	CLAYETTE ET CASIER DE PO	- DAIRY(33,37,43,48	249A
81	5208JA1033A	BOITIER 120E	MOLD EPS EPS WHIT	120E
82	5208JA2012A			120G
83	5251JA3003A	TUBE CONDENSATEUR 105A	R-B28,31,36 258MM	105A
84	5300JB1040B	RESISTANCE DEGIVRAGE	240V 51W 382-34 (C	407A
85	5300JB1041B	RESIST SUR EVAPORATEUR	GR-332-372 240V 13	418A
86	5403JA1047A			323B
87	5403JA1055A	CONDENSER ASSEMBLY,WIR	FE(SWST) NATURAL	323B
88	5421JA0007B	EVAPORATEUR	GR-332/372	301A
89	5433JA8305G			201A
90	5433JA8306A			231A
91	5851JA2002M			317A
92	5851JA2003C	DRIER ASSEMBLY	XH-7 8*12 10G DANM	317A
93	5851JA2003E	DRIER ASSY	C1220T HFC 2WAY X	317A
94	5901JA1013A	FAN ASSEMBLY	- 110 3BLADE 3.17 P	329C
95	5901JA1016A	FAN ASSEMBLY	- 110 9BLADE 3.17 P	329A
96	6411JB1022B	POWER CORD ASSEMBLY	C-4/H05VV-F 3X0.75	410C
97	6600JB1002K	SWITCH PORTE	PS100-12K AC 250VA	406B
98	6615JB2003J	CONTROL ASSY,DEF	MECHANICAL -4/13 7	401A
99	6748C-0004C	Thermistor Assembly,PTC	P330MD P330MD LUC	308A
100	6750C-0004B	O.L.P	4TM158RFBYY 520 4	309A
101	6912JB2001C	LAMPE	6912JB2001C 20W 24	409B
102	6914JB2006B	MINUTERIE 410C	200-240V NON 6H35	410C
103	6930JB1003D	THERMOSTAT	3C -1C 250V 4A -	110A
104	J513-00011A	CAPACITOR,DRAWING	J513-00011A VD:0.2	410J
105	J580-00023A	CAPACITE	MOLD ABS AF-303 [M	410B
106	J719-00006A	FIXATION DESYDRATEUR 31	PRESS SBHG T0.5 S	318A
107	J722-00008A			303B
108	J756-00008B	RONDELLE	MOLD RUBBER RUBB	405C
109	J791-00010A	LAMPE	10W 240VAC - - - -	409C