

ERN-368MBW, ERN-368MBI,
ERN-368MBB, ERN-388MBW,
ERN-388MBI, ERN-388MBB

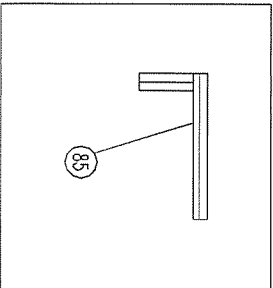
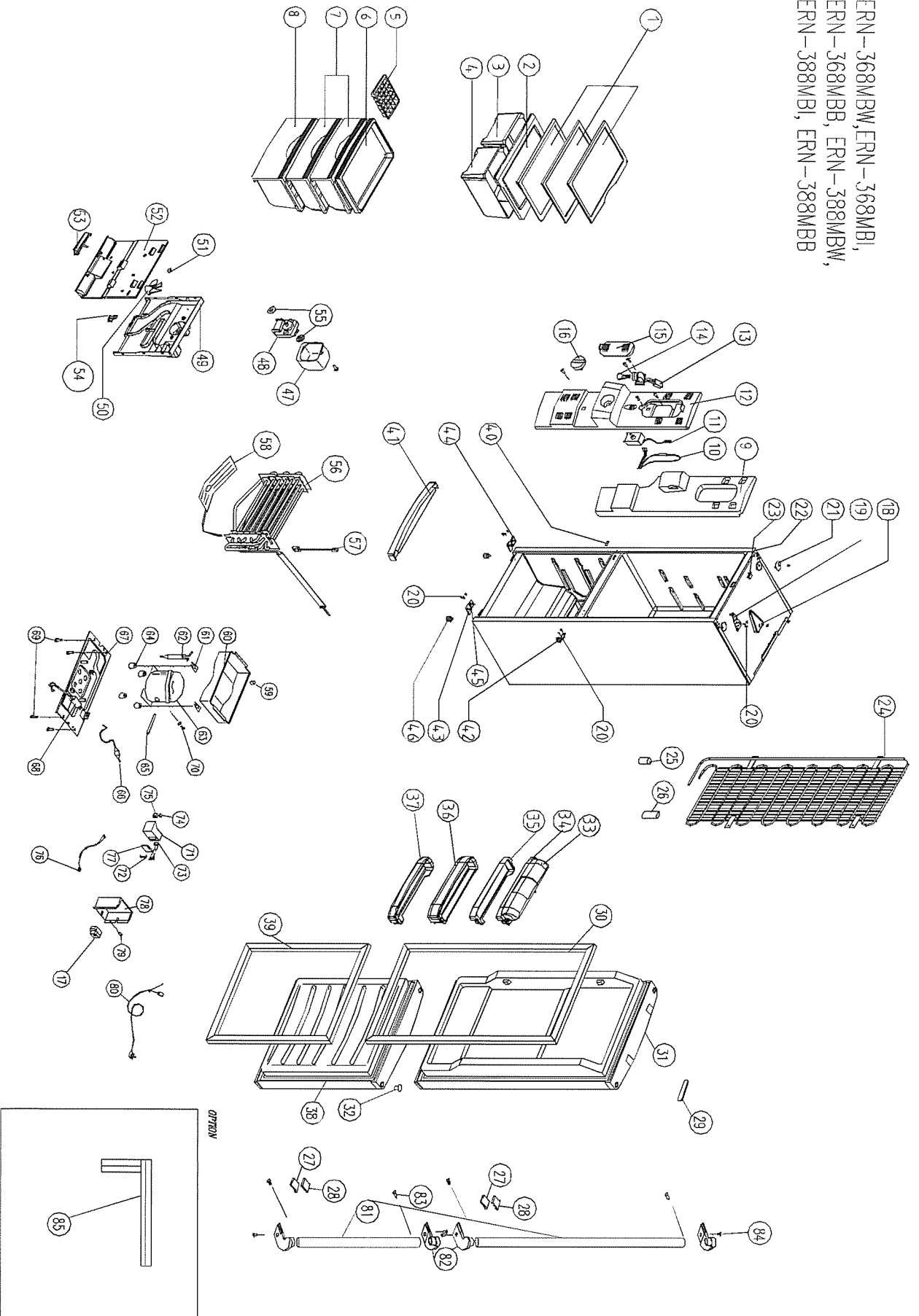

COMERCIAL MODEL NAME: ERN-368MW, 368MBI, 368MBB,388MBW, 388MBI, 388MBB

TECHNICAL NAME: ERF-366MRD, ERF-386MRD

EXPLODE DRAWING N°	PART CODE	PART NAME	COLOUR	HANDLE TYPE	ERN-368MBW (ERF-366MRD)	ERN-368MBI (ERF-366MRD)	ERN-368MBB (ERF-366MRD)	ERN-388MBW (ERF-386MRD)	ERN-388MBI (ERF-386MRD)	ERN-388MBB (ERF-386MRD)	REMARKS
1	3017839400	GLASS SHELF (INSERT TYPE) '04			3	3	3	3	3	3	
2	3001402200	COVER GLASS V/CASE (INSERT TYPE) ERF**4			1	1	1	1	1	1	
3	DMS1181910	CASE VEGETABLE *L '04 BLUE MILKY 2006	BLUE MILKY		1	1	1	1	1	1	
4	DMS1182010	CASE VEGETABLE *R '04 BLUE MILKY 2006	BLUE MILKY		1	1	1	1	1	1	
5	3011163200	CASE ICING 2000			1	1	1	1	1	1	
6	3011181800	CASE F D 04			1	1	1	1	1	1	
7	DMS1184910	CASE FB AS			2	2	2	-	-	-	
7	DMS1185010	CASE F C AS			-	-	-	2	2	2	
8	3011184800	CASE F A AS			1	1	1	1	1	1	
9	3013337100	INSULATOR MULTI DUCT M 36.. / 38.. / 40			1	1	1	1	1	1	
10	3012756710	HARNESS THERMOSTAT AS R600 MEC 2010			1	1	1	1	1	1	
11	3018120920	THERMOSTAT R600 MEC 2010 ("OFF OPTION")			1	1	1	1	1	1	
12	DMS1452040	COVER MULTI DUCT 36.. / 38.. / 40.. (OFF POSITION)			1	1	1	1	1	1	
13	3017903900	SOCKET R LAMP AS			1	1	1	1	1	1	
14	3013600700	LAMP 220V 15W			1	1	1	1	1	1	
15	3015503300	WINDOW LAMP MILKY COMMON			1	1	1	1	1	1	
16	3013401410	KNOB R			1	1	1	1	1	1	
17	3018100940	SWITCH D TIMER(SANKYO) R600 MEC 2010			1	1	1	1	1	1	
18	DMS1494310	COVER *T HINGE SNOW WHITE	WHITE		1	-	-	1	-	-	
18	DMS1494340	COVER *T HINGE (N/G)	NOBLE GREY		-	1	-	-	1	-	
18	DMS1494330	COVER *T HINGE (BLACK)	BLACK		-	-	1	-	-	1	
19	3012922600	HINGE *T AS			1	1	1	1	1	1	
20	3016004900	SPECIAL BOLT C			9	9	9	9	9	9	
21	DMS1477510	COVER CAB HARNESS SNOW WHITE	WHITE		1	-	-	1	-	-	
21	DMS1477540	COVER CAB HARNESS NOBLE GREY	NOBLE GREY		-	1	-	-	1	-	
21	DMS1477530	COVER CAB HARNESS (BLACK)	BLACK		-	-	1	-	-	1	
22	-	ASSY CAB URT 366M			1	1	1	-	-	-	
22	-	ASSY CAB URT 386M			-	-	-	1	1	1	
23	3011755200	SWITCH DOOR CAP *L BAR HANDLE (SNOW WHITE)	WHITE		1	-	-	1	-	-	
23	3011783400	SWITCH DOOR NOBLE GREY	NOBLE GREY		-	1	-	-	1	-	
23	3011782900	SWITCH DOOR (BLACK)	BLACK		-	-	1	-	-	1	
24	3014434501	PIPE WI-CON AS			1	1	1	1	1	1	
25	4016C08014	ABSORBER PIPE C EXTRUSION 20gr			1	1	1	1	1	1	
26	DMS7792302	SEALING DIVISION			1	1	1	1	1	1	
27	DMS1467390	COVER DOOR CAP *L BAR HANDLE (SNOW WHITE)	WHITE		1	-	-	1	-	-	
27	DMS1467360	COVER DOOR CAP *L BAR HANDLE (NOBLE GREY)	NOBLE GREY		-	1	-	-	1	-	
27	DMS1467370	COVER DOOR CAP *L BAR HANDLE (BLACK)	BLACK		-	-	1	-	-	1	
28	DMS1467490	COVER DOOR CAP *R BAR HANDLE (SNOW WHITE)	WHITE		1	-	-	1	-	-	
28	DMS1467460	COVER DOOR CAP *R BAR HANDLE (NOBLE GREY)	NOBLE GREY		-	1	-	-	1	-	
28	DMS1467470	COVER DOOR CAP *R BAR HANDLE (BLACK)	BLACK		-	-	1	-	-	1	
29	3013595400	EMBLEM DAEWOO '04 (CHROME)			1	1	1	1	1	1	
30	3012306600	GASKET R DR 36./38. WHITE			1	1	-	1	1	-	
30	DMS2306630	GASKET R DR 36./38. GRAY COLOR	DARK GREY		-	-	1	-	-	1	
31	DMS0085580	R DOOR BAR (SNOW WHITE) 384NBW (BAR H.D2)	SNOW WHITE	(BAR HND)	1	-	-	1	-	-	
31	DMS0085560	R DOOR BAR (INOX 08) 364MBI, 364MBT (BAR H.D2)	INOX 08	(BAR HND)	-	1	-	-	1	-	
31	DMS0008045	R DOOR BAR BLACK 366 (BAR H.D2)	BLACK	(BAR HND)	-	-	1	-	-	1	
31	DMS0085950	R DOOR HIDDEN (SNOW WHITE) 366M, 386M - HIDDEN H. D2	SNOW WHITE	HIDDEN	-	-	-	-	-	-	
31	DMS0085550	R DOOR HIDDEN (INOX 08) 366M 386M HIDDEN D2	INOX 08	HIDDEN	-	-	-	-	-	-	
32	3010967400	CAP DOOR BUSHING (SNOW WHITE)	WHITE		1	-	-	1	-	-	
32	DMS0967410	CAP DOOR BUSHING (DARK GRAY)	DARK GREY		-	1	1	-	1	1	
33	3011495000	COVER DAIRY POCKET			1	1	1	1	1	1	
34	3019025000	POCKET DAIRY			1	1	1	1	1	1	
35	3019025200	POCKET R 04			1	1	1	1	1	1	
36	DMS9026110	POCKET BOTL AS			1	1	1	1	1	1	
37	3019026200	POCKET MULTI AS			1	1	1	1	1	1	
38	DMS0057570	F DOOR BAR (SNOW WHITE) 364NBW (BAR H.D2)	SNOW WHITE	BAR HND	1	-	-	-	-	-	
38	DMS0085590	F DOOR BAR (SNOW WHITE) 384NBW (BAR H.D2)	SNOW WHITE	BAR HND	-	-	-	1	-	-	
38	DMS0087490	F DOOR BAR (INOX 08) 364MBI, 364MBT, 364MBIT (BAR H. D1/	INOX 08	BAR HND	-	1	-	-	-	-	
38	DMS0085570	F DOOR BAR (INOX 08) 384MBI, 384MBT, 384MBIT (BAR H. D1/	INOX 08	BAR HND	-	-	-	-	1	-	
38	DMS0057650	F DOOR BAR (BLACK) 366 (BAR H. D2)	BLACK	BAR HND	-	-	1	-	-	-	
38	DMS0057620	F DOOR BAR (BLACK) 386 (BAR H. D2)	BLACK	BAR HND	-	-	-	-	-	1	
38	DMS0086770	F DOOR HIDDEN (SNOW WHITE) 384, 386M	SNOW WHITE	HIDDEN	-	-	-	-	-	-	
38	DMS0085540	F DOOR HIDDEN (INOX 08) 384, 386M	INOX 08	HIDDEN	-	-	-	-	-	-	
39	3012306500	GASKET F DR 36./39. WHITE			1	1	-	-	-	-	
39	DMS2306530	GASKET F DR 36./39. GRAY COLOR	DARK GREY		-	-	1	-	-	-	
39	3012306700	GASKET F DR 38./41. WHITE			-	-	-	1	1	-	
39	DMS2306730	GASKET F DR 38./41. GRAY GE COLOR	DARK GREY		-	-	-	-	-	1	
40	3010920300	CAP SCREW HOLE			1	1	1	1	1	1	
41	3011467500	COVER CAB BRACKET L SNOW WHITE	WHITE		1	-	-	1	-	-	
41	DMS1467530	COVER CAB BRACKET L NOBLE GREY	NOBLE GREY		-	1	-	-	1	-	
41	DMS1467550	COVER CAB BRACKET L (BLACK)	BLACK		-	-	1	-	-	1	
42	3012924800	HINGE*M COMMON 2005			1	1	1	1	1	1	
43	3012925510	HINGE UNDER R 36/34/38/39/41/40 2005			1	1	1	1	1	1	
44	3012925500	HINGE UNDER L 36/34/38/39/41/40 2005			1	1	1	1	1	1	
45	3014909100	SHAFT HI *U KOREA 2005			1	1	1	1	1	1	
46	3012104600	FOOT ADJUSTING AS			2	2	2	2	2	2	
47	3010615600	BRACKET FAN MOTOR			1	1	1	1	1	1	

EXPLODE DRAWING N°	PART CODE	PART NAME	COLOUR	HANDLE TYPE	ER-N-368MBW (ERF-366MRD)	ER-N-368MBI (ERF-366MRD)	ER-N-368MBB (ERF-366MRD)	ER-N-388MBW (ERF-386MRD)	ER-N-388MBI (ERF-386MRD)	ER-N-388MBB (ERF-386MRD)	REMARKS
48	3011804710	MOTOR FAN AS SHAFT 3,17 A GRADE 230V/50HZ			1	1	1	1	1	1	
49	3018918900	LOUVER F B 366/396			1	1	1	-	-	-	
49	3018919000	LOUVER FB 386/416			-	-	-	1	1	1	
50	3011801410	FAN GRADO A			1	1	1	1	1	1	
51	3011200520	FIXTURE FAN RING (SPRING) DAEWOO 2005			1	1	1	1	1	1	
52	3018918700	LOUVER F A 366/396			1	1	1	-	-	-	
52	3018918800	LOUVER FA 386/416			-	-	-	1	1	1	
53	3018920700	LOUVER F C			1	1	1	1	1	1	
54	3013410700	KNOB F LOUVER			1	1	1	1	1	1	
55	3010107100	ABSORBER FAN MOTOR (BUSHING)			2	2	2	2	2	2	
56	3017044603	EVAPORATOR COMMON R600 MEC 2010			1	1	1	1	1	1	
57	3017204010	SWITCH BI-METAL FUSE 364M R600 MEC 2010			1	1	1	1	1	1	
58	DMSNR06240	HEATER DRAIN SAMSUNG 3426 S/S NO ROHS			1	1	1	1	1	1	
59	3010919700	CAP DRAIN HOSE			1	1	1	1	1	1	
60	3011162600	CASE VAPORI (Dewoo DH108LIP5 R600)			1	1	1	1	1	1	
61	3012005300	FIXTURE COMP			2	2	2	2	2	2	
62	3016802210	DRYER AS 2005			1	1	1	1	1	1	
63	3956110450	COMPRESSOR DH 108LIP5 (Dewoo DH108LIP5 R600A) 220V-50HZ			1	1	1	1	1	1	
64	3010100201	ABSORBER COMP (Dewoo DH108LIP5 R600)			4	4	4	4	4	4	
65	3014418202	PIPE CHARGE (Dewoo DH108LIP5 R600)			1	1	1	1	1	1	
66	3014449700	MUFFLER AS (H)			1	1	1	1	1	1	
67	DMS0001610	BASE COMPRESSOR (Dewoo DH108LIP5 R600)			1	1	1	1	1	1	
68	DMS6402120	CAPACITOR RUNNING 5UF FAST FIX			1	1	1	1	1	1	
69	3016004300	SPECIAL SCREW A			1	1	1	1	1	1	
70	7001401065	SCREW EARTH (MACHINE) (Dewoo DH108LIP5 R600)			1	1	1	1	1	1	
71	3810506400	RELAY BOX (Dewoo DH108LIP5 R600)			1	1	1	1	1	1	
72	3816100400	BAND RELAY (Dewoo DH108LIP5 R600)			1	1	1	1	1	1	
73	3818200300	CABLE CLAMP (DAEWOO R 600)			1	1	1	1	1	1	
74	3817926400	SWITCH OL 4TM149SHBY-53 (220V-60HZ) (Dewoo DH108LIP5 R600)			1	1	1	1	1	1	
75	3817915400	SWITCH PTC (FROM DONG CHANG) (Dewoo DH108LIP5 R600)			1	1	1	1	1	1	
76	3012778700	HARNESS RELAY R600 MEC 2010			1	1	1	1	1	1	
77	3811401300	RELAY BOX COVER (Dewoo DH108LIP5 R600)			1	1	1	1	1	1	
78	3011454110	COVER MECH HOUSING R600 MEC 2010			1	1	1	1	1	1	
79	7112401011	SCREW TAPPING 4*10			1	1	1	1	1	1	
80	3011303900	POWER CORD AS SCHUK + EARTH + R600 MEC 2010			1	1	1	1	1	1	
81	3014003700	PACKING BAR HANDLE PIPE 364 DIXON II			1	1	1	-	-	-	
81	3014003010	PACKING BAR HANDLE PIPE 384 DIXON II			-	-	-	1	1	1	
82	3014003400	PACKING BAR HANDLE SUPPORT ASSY			1	1	1	1	1	1	
83	3016032500	SCREW MACHINE FLT 4X8 STS			4	4	4	4	4	4	
84	DMS6006000	SPECIAL SCREW G			4	4	4	4	4	4	
85	DMS6032400	WRENCH ALLEN 3mm			1	1	1	1	1	1	