

EXPLODED VIEWS

Cabinet

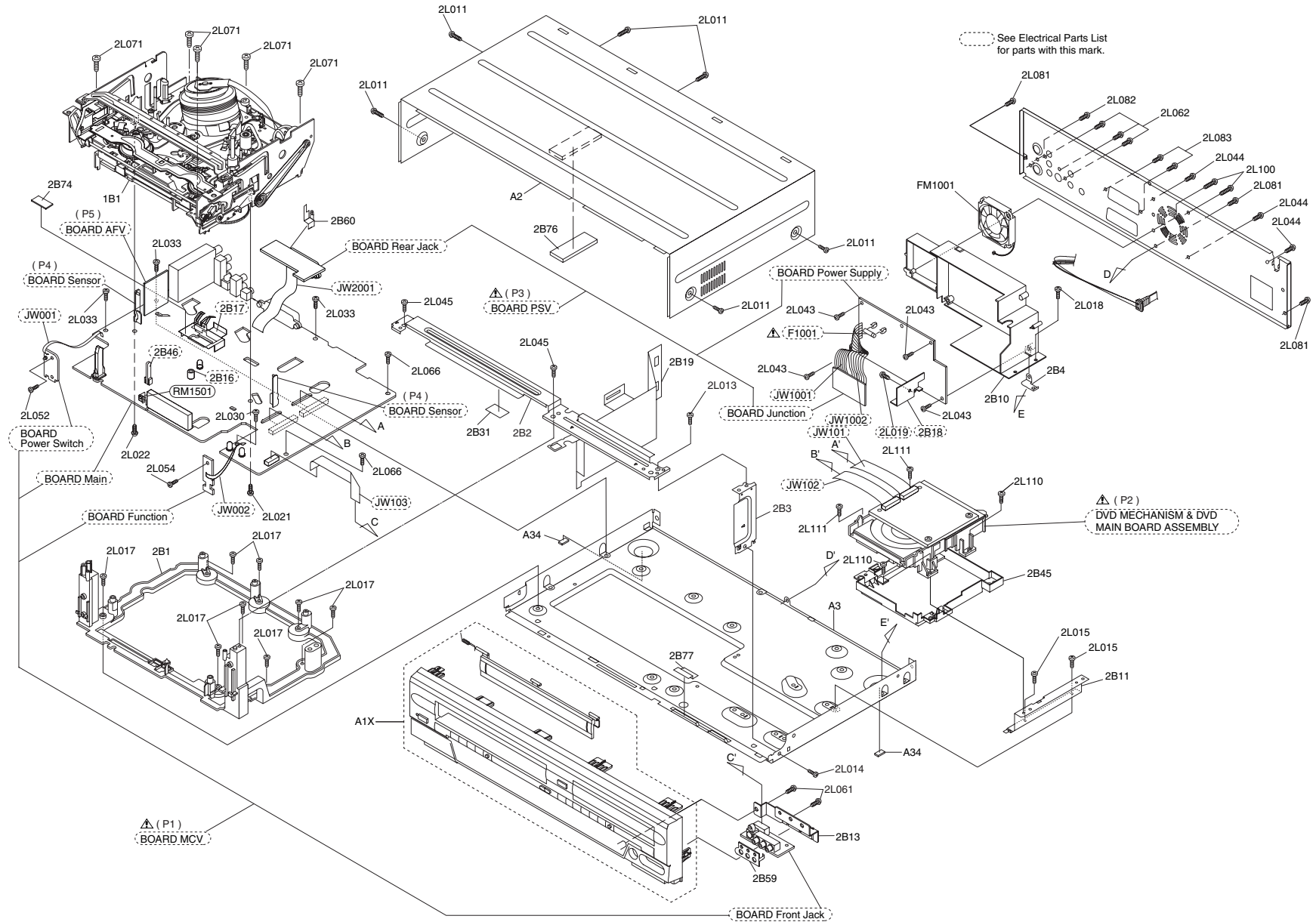

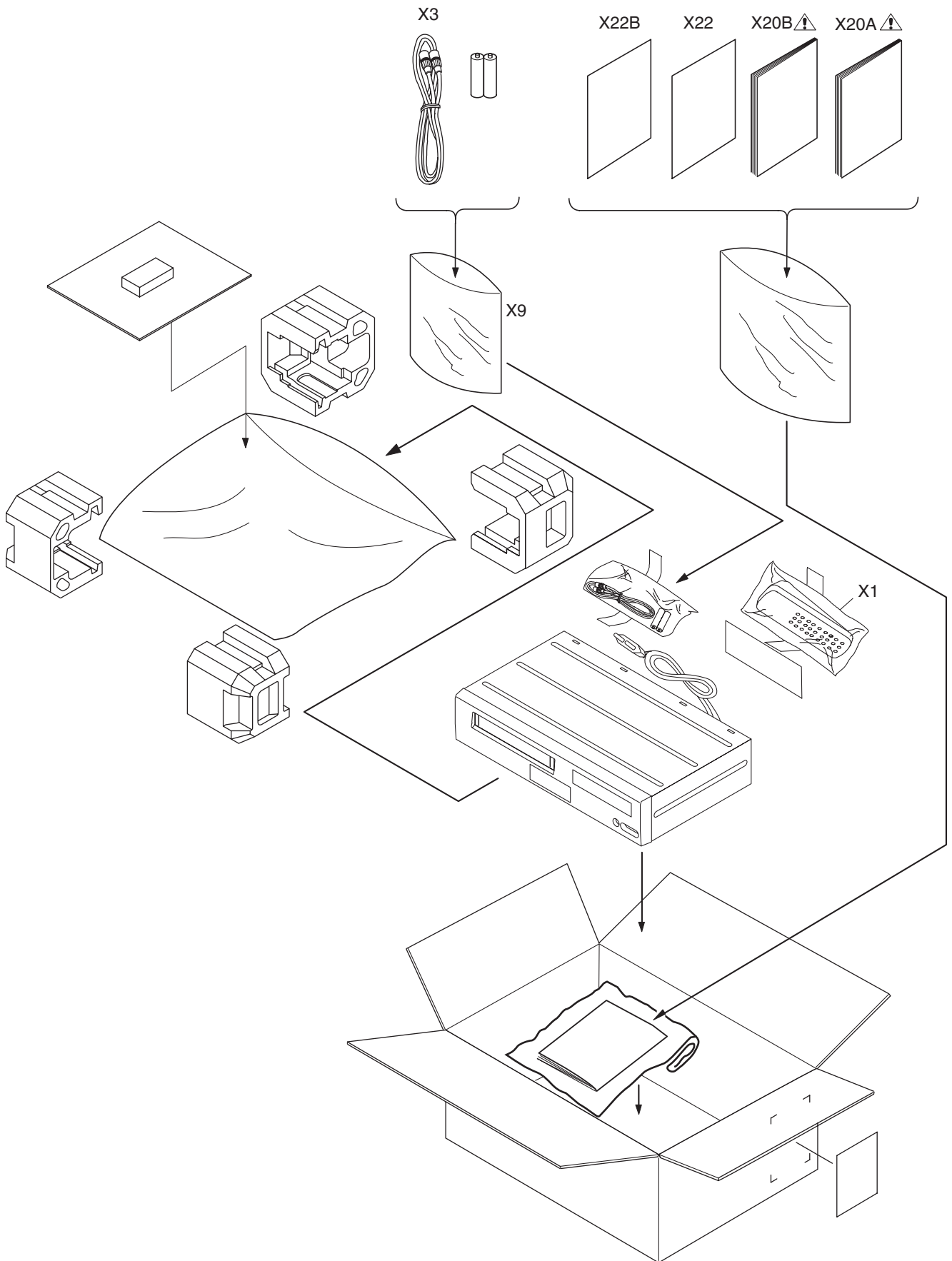

Packing



MECHANICAL PARTS LIST

PRODUCT SAFETY NOTE: Products marked with a  have special characteristics important to safety. Before replacing any of these components, read carefully the product safety notice in this service manual. Don't degrade the safety of the product through improper servicing.

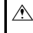
	Location No.	TSB P/N	Reference No.	Description
	A1X	P000480700	1VM222854	PANEL FRONT E9BA4FD
	A2	P000480710	1VM323296	COVER TOP E9AB1CD
	A3		0VM101353H	MAIN CHASSIS E9400UD
	A34		0VM406940A	FOOT H5100UD
	1B1	P000464340	N25E0FL	DECK ASSEMBLY CZD014/ VM25E0
	2B1		1VM120055G	DECK PEDESTAL E9600UD
	2B2		0VM204534C	FRONT BRACKET E9400UD
	2B3		0VM416269A	FRONT BRACKET R E9400UD
	2B4		0VM416272	PLATE EARTH E9400UD
	2B10		1VM120056B	BOARD HOLDER E9700ED
	2B11		1VM421062F	BRACKET R E9600UD
	2B13		0VM416273	JACK BRACKET E9400UD
	2B19		1VM320806A	RADIATION SHEET E9700ED
	2B31		0VM413956	TAPE HIMELON H9206JD
	2B45		1VM222682	DUST COVER(PS) E9B34ED
	2B59		1VM322618	JACK PLATE EARTH E9A80UD
	2B76		1VM424744	RUBBER CUSHION(B) E9B00ED
	2B77		1VM424745	RUBBER CUSHION(C) E9B00ED
	2L011		GBHC3050	SCREW TAP TIGHT M3X5 BIND HEAD+BLK NI
	2L013		GBJS3060	SCREW S-TIGHT M3X6 BIND HEAD+
	2L014		GBJS3060	SCREW S-TIGHT M3X6 BIND HEAD+
	2L015		0VM412937A	SCREW C-TIGHT M3X6 E5610UD
	2L017		0VM413320A	SCREW S-TIGHT 3X8 H9210UD
	2L018		GBJS3060	SCREW S-TIGHT M3X6 BIND HEAD+
	2L021		GBCP3080	SCREW P-TIGHT M3X8 BIND HEAD+
	2L022		GBJS3060	SCREW S-TIGHT M3X6 BIND HEAD+
	2L030		GBJP3080	SCREW P-TIGHT M3X8 BIND HEAD+
	2L033		GBJS3060	SCREW S-TIGHT M3X6 BIND HEAD+
	2L043		GBJP3080	SCREW P-TIGHT M3X8 BIND HEAD+
	2L044		GBJP3080	SCREW P-TIGHT M3X8 BIND HEAD+
	2L045		GBJP3080	SCREW P-TIGHT M3X8 BIND HEAD+
	2L052		GBJP3060	SCREW P-TIGHT M3X6 BIND HEAD+
	2L054		GBJP3060	SCREW P-TIGHT M3X6 BIND HEAD+
	2L061		GBJP3060	SCREW P-TIGHT M3X6 BIND HEAD+
	2L062		GBHB3080	SCREW B-TIGHT M3X8 BIND HEAD+
	2L066		0VM412937A	SCREW C-TIGHT M3X6 E5610UD
	2L071		GCJP3100	SCREW P-TIGHT M3*10 WASHERHEAD+
	2L081		GBHS3060	S-TIGHT SCREW M3X6 BIND HEAD+BLACK
	2L082		GBHS3060	S-TIGHT SCREW M3X6 BIND HEAD+BLACK
	2L083		GBHP3080	SCREW P-TIGHT M3X8 BIND HEAD+ BLK
	2L100		1VM420034A	P-TIGHT SCREW M3X34 E9400UD

	Location No.	TSB P/N	Reference No.	Description
	2L110		GBJS3100	SCREW S-TIGHT M3X10 BIND HEAD+
	2L111		GBJP3120	SCREW P-TIGHT M3*12 BIND+
	FM1001	P000464330	MMEZR12NH003	DC FAN MOTOR D06K-12TS7 01(Ax)
ACCESSORIES				
	X1	P000480770	NB325ED	REMOTE CONTROL UNIT NB325ED
	X3	P000460030	WPZ0122LG001	RF CORD PAL 1.2M
	X9		1VM422101	REMOCON BAG E9704ED
	X20A	P000480740	1VMN23436	OWNERS MANUAL(FRE) E9BA4FD
	X20B	P000480750	1VMN23437	OWNERS MANUAL(ITA) E9BA4FD
	X22	P000480720	1VMN22999B	QUICK GUIDE E9BA2FD
	X22B	P000480730	1VMN23111B	QUICK GUIDE(SP) E9BA2FD

ELECTRICAL PARTS LIST

PRODUCT SAFETY NOTE: Products marked with a \triangle have special characteristics important to safety. Before replacing any of these components, read carefully the product safety notice in this service manual. Don't degrade the safety of the product through improper servicing.

NOTES:

- Parts that are not assigned part numbers (-----) are not available.
- Tolerance of Capacitors and Resistors are noted with the following symbols.

C..... \pm 0.25% D..... \pm 0.5% F..... \pm 1%
 G..... \pm 2% J..... \pm 5% K..... \pm 10%
 M..... \pm 20% N..... \pm 30% Z.....+80/-20%

DVD MECHANISM & DVD MAIN BOARD ASSEMBLY

\triangle	Location No.	TSB P/N	Reference No.	Description
\triangle	P2	P000465140	N78ECCFN	DVD MECHANISM & DVD BOARD MAIN ASSEMBLY

BOARD MCV

\triangle	Location No.	TSB P/N	Reference No.	Description
\triangle	P1	P000465130	1VSA14661	BOARD MCV Consists of the following
			-----	BOARD MAIN (MCV-A)
			-----	BOARD POWER SWITCH (MCV-B)
			-----	BOARD FUNCTION (MCV-C)
			-----	BOARD FRONT JACK (MCV-D)
	P4	P000465450	1VSA11699	BOARD SENSOR

BOARD MAIN

\triangle	Location No.	TSB P/N	Reference No.	Description
			-----	BOARD MAIN (MCV-A) Consists of the following:
CAPACITORS				
	C251		CE1CMAVSL100	ELECTROLYTIC CAP: 10 μ F/16V M H7
	C252		CHD1JZ30F104	CHIP CERAMIC CAP:(1608) F Z 0.1 μ F/50V
	C253		CHD1JK30B102	CHIP CERAMIC CAP:(1608) B K 1000pF/50V
	C254		CE1JMAVSL1R0	ELECTROLYTIC CAP: 1 μ F/50V M H7
	C301		CHD1JK30B223	CHIP CERAMIC CAP:(1608) B K 0.022 μ F/50V
	C302		CE1JMAVSL1R0	ELECTROLYTIC CAP: 1 μ F/50V M H7
	C303		CHD1JZ30F104	CHIP CERAMIC CAP:(1608) F Z 0.1 μ F/50V
	C305		CE1JMAVSL1R0	ELECTROLYTIC CAP: 1 μ F/50V M H7
	C306		CHD1JK30B473	CHIP CERAMIC CAP:(1608) B K 0.047 μ F/50V
	C307		CHD1JK30B223	CHIP CERAMIC CAP:(1608) B K 0.022 μ F/50V
	C308		CHD1JZ30F104	CHIP CERAMIC CAP:(1608) F Z 0.1 μ F/50V

\triangle	Location No.	TSB P/N	Reference No.	Description
	C311		CHD1JZ30F104	CHIP CERAMIC CAP:(1608) F Z 0.1 μ F/50V
	C312		CE1CMAVSL100	ELECTROLYTIC CAP: 10 μ F/16V M H7
	C313		CE1JMASSL1R0	ELECTROLYTIC CAP: 1 μ F/50V M H7
	C314		CHD1JK30B103	CHIP CERAMIC CAP:(1608) B K 0.01 μ F/50V
	C315		CHD1JK30B473	CHIP CERAMIC CAP:(1608) B K 0.047 μ F/50V
	C316		CE1JMAVSL1R0	ELECTROLYTIC CAP: 1 μ F/50V M H7
	C317		CHD1JZ30F104	CHIP CERAMIC CAP:(1608) F Z 0.1 μ F/50V
	C322		CHD1JZ30F104	CHIP CERAMIC CAP:(1608) F Z 0.1 μ F/50V
	C324		CHD1JK30B103	CHIP CERAMIC CAP:(1608) B K 0.01 μ F/50V
	C325		CHD1JK30B822	CHIP CERAMIC CAP: B K 8200pF/50V
	C326		CHD1JZ30F104	CHIP CERAMIC CAP:(1608) F Z 0.1 μ F/50V
	C328		CE0KMAVSL470	ELECTROLYTIC CAP: 47 μ F/6.3V M H7
	C329		CHD1JZ30F104	CHIP CERAMIC CAP:(1608) F Z 0.1 μ F/50V
	C330		CE1CMASDL101	ELECTROLYTIC CAP: 100 μ F/16V M
	C331		CE0KMASDL221	ELECTROLYTIC CAP: 220 μ F/6.3V M
	C333		CHD1JZ30F104	CHIP CERAMIC CAP:(1608) F Z 0.1 μ F/50V
	C334		CE1JMAVSL1R0	ELECTROLYTIC CAP: 1 μ F/50V M H7
	C335		CE0KMAVSL101	ELECTROLYTIC CAP: 100 μ F/6.3V H7
	C336		CHD1JJ3CH221	CHIP CERAMIC CAP: CH J 220pF/50V
	C337		CHD1JZ30F104	CHIP CERAMIC CAP:(1608) F Z 0.1 μ F/50V
	C339		CHD1JJ3CH121	CHIP CERAMIC CAP: CH J 120pF/50V
	C340		CE1JMAVSL1R0	ELECTROLYTIC CAP: 1 μ F/50V M H7
	C341		CHD1JD3CH100	CHIP CERAMIC CAP:(1608) CH D 10pF/50V
	C342		CHD1JJ3CH102	CHIP CERAMIC CAP:(1608) CH J 1000pF/50V
	C343		CE1CMAVSL100	ELECTROLYTIC CAP: 10 μ F/16V M H7
	C344		CP1EMAVSB4R7	ELECTROLYTIC CAP: 4.7 μ F/25V M NP H7
	C345		CE1JMAVSLR47	ELECTROLYTIC CAP: 0.47 μ F/50V M H7
	C347		CHD1EK30B104	CHIP CERAMIC CAP:(1608) B K 0.1 μ F/25V
	C349		CE1JMAVSLR47	ELECTROLYTIC CAP: 0.47 μ F/50V M H7
	C350		CCA1JZTFZ104	CERAMIC CAP:(AX) F Z 0.1 μ F/50V
	C370		CCA1CMT0Y103	CERAMIC CAP:(AX) Y M 0.01 μ F/16V
	C371		CHD1JK30B223	CHIP CERAMIC CAP:(1608) B K 0.022 μ F/50V
	C372		CHD1JZ30F104	CHIP CERAMIC CAP:(1608) F Z 0.1 μ F/50V
	C373		CHD1JZ30F104	CHIP CERAMIC CAP:(1608) F Z 0.1 μ F/50V
	C374		CHD1JZ30F104	CHIP CERAMIC CAP:(1608) F Z 0.1 μ F/50V
	C375		CHD1JK30B103	CHIP CERAMIC CAP:(1608) B K 0.01 μ F/50V
	C376		CHD1JK30B223	CHIP CERAMIC CAP:(1608) B K 0.022 μ F/50V
	C377		CHD1JK30B103	CHIP CERAMIC CAP:(1608) B K 0.01 μ F/50V
	C378		CHD1JK30B103	CHIP CERAMIC CAP:(1608) B K 0.01 μ F/50V

△	Location No.	TSB P/N	Reference No.	Description
	C379		CE1JMAVSLR47	ELECTROLYTIC CAP. 0.47μF/50V M H7
	C381		CHD1JZ30F104	CHIP CERAMIC CAP.(1608) F Z 0.1μF/50V
	C382		CHD1JK30B222	CHIP CERAMIC CAP. B K 2200pF/50V
	C383		CHD1JK30B222	CHIP CERAMIC CAP. B K 2200pF/50V
	C384		CE1JMAVSL2R2	ELECTROLYTIC CAP. 2.2μF/50V M H7
	C402		CMA1JJP00183	FILM CAP.(P) 0.018μF/50V J
	C403		CCD2AKS0B471	CERAMIC CAP. B K 470pF/100V
	C404		CE0KMASSL221	ELECTROLYTIC CAP. 220μF/6.3V M H7
	C405		CE0KMAVSL470	ELECTROLYTIC CAP. 47μF/6.3V M H7
	C407		CHD1JK30B102	CHIP CERAMIC CAP.(1608) B K 1000pF/50V
	C408		CHD1JK30B182	CHIP CERAMIC CAP. B K 1800pF/50V
	C409		CHD1JJ3CH330	CHIP CERAMIC CAP.(1608) CH J 33pF/50V
	C410		CE1CMAVSL100	ELECTROLYTIC CAP. 10μF/16V M H7
	C411		CHD1JK30B103	CHIP CERAMIC CAP.(1608) B K 0.01μF/50V
	C412		CE0KMAVSL330	ELECTROLYTIC CAP. 33μF/6.3V M H7
	C413		CHD1JZ30F104	CHIP CERAMIC CAP.(1608) F Z 0.1μF/50V
	C414		CHD1JK30B223	CHIP CERAMIC CAP.(1608) B K 0.022μF/50V
	C415		CE1EMAVSL4R7	ELECTROLYTIC CAP. 4.7μF/25V M H7
	C416		CHD1JK30B472	CHIP CERAMIC CAP.(1608) B K 4700pF/50V
	C417		CE0KMAVSL220	ELECTROLYTIC CAP. 22μF/6.3V M H7
	C418		CHD1JZ30F104	CHIP CERAMIC CAP.(1608) F Z 0.1μF/50V
	C419		CHD1JJ3CH221	CHIP CERAMIC CAP. CH J 220pF/50V
	C421		CE0KMAVSL470	ELECTROLYTIC CAP. 47μF/6.3V M H7
	C451		CHD1JJ3CH220	CHIP CERAMIC CAP.(1608) CH J 22pF/50V
	C452		CE1CMAVSL100	ELECTROLYTIC CAP. 10μF/16V M H7
	C453		CE1AMAVSL220	ELECTROLYTIC CAP. 22μF/10V M H7
	C454		CHD1JZ30F104	CHIP CERAMIC CAP.(1608) F Z 0.1μF/50V
	C455		CHD1JZ30F104	CHIP CERAMIC CAP.(1608) F Z 0.1μF/50V
	C456		CE1CMAVSL100	ELECTROLYTIC CAP. 10μF/16V M H7
	C457		CE1EMAVSL4R7	ELECTROLYTIC CAP. 4.7μF/25V M H7
	C458		CHD1JK30B103	CHIP CERAMIC CAP.(1608) B K 0.01μF/50V
	C461		CHD1JK30B103	CHIP CERAMIC CAP.(1608) B K 0.01μF/50V
	C462		CHD1JK30B472	CHIP CERAMIC CAP.(1608) B K 4700pF/50V
	C463		CE1AMAVSL220	ELECTROLYTIC CAP. 22μF/10V M H7
	C464		CHD1JK30B103	CHIP CERAMIC CAP.(1608) B K 0.01μF/50V
	C465		CE1CMAVSL100	ELECTROLYTIC CAP. 10μF/16V M H7
	C466		CHD1JZ30F104	CHIP CERAMIC CAP.(1608) F Z 0.1μF/50V
	C467		CHD1JZ30F104	CHIP CERAMIC CAP.(1608) F Z 0.1μF/50V
	C468		CE0KMAVSL221	ELECTROLYTIC CAP. 220μF/6.3V M H7
	C469		CE1AMAVSL220	ELECTROLYTIC CAP. 22μF/10V M H7
	C470		CHD1JK30B472	CHIP CERAMIC CAP.(1608) B K 4700pF/50V

△	Location No.	TSB P/N	Reference No.	Description
	C471		CHD1JK30B103	CHIP CERAMIC CAP.(1608) B K 0.01μF/50V
	C472		CE1EMAVSL4R7	ELECTROLYTIC CAP. 4.7μF/25V M H7
	C473		CE1CMAVSL100	ELECTROLYTIC CAP. 10μF/16V M H7
	C474		CHD1JZ30F104	CHIP CERAMIC CAP.(1608) F Z 0.1μF/50V
	C475		CHD1JZ30F104	CHIP CERAMIC CAP.(1608) F Z 0.1μF/50V
	C476		CE0KMAVSL220	ELECTROLYTIC CAP. 22μF/6.3V M H7
	C477		CHD1JJ3CH220	CHIP CERAMIC CAP.(1608) CH J 22pF/50V
	C478		CHD1JZ30F104	CHIP CERAMIC CAP.(1608) F Z 0.1μF/50V
	C479		CE1CMAVSL100	ELECTROLYTIC CAP. 10μF/16V M H7
	C480		CE1CMAVSL100	ELECTROLYTIC CAP. 10μF/16V M H7
	C481		CE1CMAVSL100	ELECTROLYTIC CAP. 10μF/16V M H7
	C482		CHD1JZ30F104	CHIP CERAMIC CAP.(1608) F Z 0.1μF/50V
	C483		CE1EMAVSL4R7	ELECTROLYTIC CAP. 4.7μF/25V M H7
	C484		CE1EMAVSL4R7	ELECTROLYTIC CAP. 4.7μF/25V M H7
	C485		CE1CMAVSL100	ELECTROLYTIC CAP. 10μF/16V M H7
	C486		CHD1JZ30F104	CHIP CERAMIC CAP.(1608) F Z 0.1μF/50V
	C487		CE1CMAVSL470	ELECTROLYTIC CAP. 47μF/16V M H7
	C488		CHD1JZ30F104	CHIP CERAMIC CAP.(1608) F Z 0.1μF/50V
	C502		CHD1JK30B223	CHIP CERAMIC CAP.(1608) B K 0.022μF/50V
	C505		CHD1JK30B103	CHIP CERAMIC CAP.(1608) B K 0.01μF/50V
	C506		CE1JMASDL1R0	ELECTROLYTIC CAP. 1μF/50V M
	C507		CHD1JK30B102	CHIP CERAMIC CAP.(1608) B K 1000pF/50V
	C508		CHD1JZ30F104	CHIP CERAMIC CAP.(1608) F Z 0.1μF/50V
	C509		CHD1JK30B102	CHIP CERAMIC CAP.(1608) B K 1000pF/50V
	C510		CHD1JK30B472	CHIP CERAMIC CAP.(1608) B K 4700pF/50V
	C511		CHD1JJ3CH101	CHIP CERAMIC CAP.(1608) CH J 100pF/50V
	C512		CHD1JK30B103	CHIP CERAMIC CAP.(1608) B K 0.01μF/50V
	C514		CHD1JK30B331	CHIP CERAMIC CAP. B K 330pF/50V
	C515		CHD1JZ30F104	CHIP CERAMIC CAP.(1608) F Z 0.1μF/50V
	C516		CE0KMAVSL220	ELECTROLYTIC CAP. 22μF/6.3V M H7
	C517		CCA1EZTFZ223	CERAMIC CAP.(AX) F Z 0.022μF/25V
	C518		CE0KMAVSL220	ELECTROLYTIC CAP. 22μF/6.3V M H7
	C519		CHD1JJ3CH561	CHIP CERAMIC CAP. CH J 560pF/50V
	C521		CE0KMAVSL220	ELECTROLYTIC CAP. 22μF/6.3V M H7
	C522		CHD1JK30B103	CHIP CERAMIC CAP.(1608) B K 0.01μF/50V
	C524		CHD1JK30B103	CHIP CERAMIC CAP.(1608) B K 0.01μF/50V
	C527		CCA1JKT0B101	CERAMIC CAP.(AX) B K 100pF/50V
	C531		CHD1JK30B472	CHIP CERAMIC CAP.(1608) B K 4700pF/50V
	C533		CHD1JK30B473	CHIP CERAMIC CAP.(1608) B K 0.047μF/50V
	C534		CE0KMAVSL470	ELECTROLYTIC CAP. 47μF/6.3V M H7

△	Location No.	TSB P/N	Reference No.	Description
	C535		CHD1JZ30F104	CHIP CERAMIC CAP.(1608) F Z 0.1μF/50V
	C536		CHD1JJ3CH561	CHIP CERAMIC CAP. CH J 560pF/50V
	C538		CHD1JJ3CH181	CHIP CERAMIC CAP. CH J 180pF/50V
	C539		CHD1JK30B103	CHIP CERAMIC CAP.(1608) B K 0.01μF/50V
	C540		CHD1JK30B472	CHIP CERAMIC CAP.(1608) B K 4700pF/50V
	C541		CHD1JJ3CH180	CHIP CERAMIC CAP. CH J 18pF/50V
	C542		CHD1JJ3CH180	CHIP CERAMIC CAP. CH J 18pF/50V
	C543		CHD1JJ3CH180	CHIP CERAMIC CAP. CH J 18pF/50V
	C544		CHD1JJ3CH200	CHIP CERAMIC CAP. CH J 20pF/50V
	C545		CHD1JJ3CH220	CHIP CERAMIC CAP.(1608) CH J 22pF/50V
	C546		CHD1JJ3CH220	CHIP CERAMIC CAP.(1608) CH J 22pF/50V
	C547		CHD1JK30B103	CHIP CERAMIC CAP.(1608) B K 0.01μF/50V
	C548		CHD1JZ30F104	CHIP CERAMIC CAP.(1608) F Z 0.1μF/50V
	C549		CE1JMAVSL1R0	ELECTROLYTIC CAP. 1μF/50V M H7
	C550		CE0KMAVSL101	ELECTROLYTIC CAP. 100μF/6.3V H7
	C553		CE1AMAVSL220	ELECTROLYTIC CAP. 22μF/10V M H7
	C554		CE0KMAVSL101	ELECTROLYTIC CAP. 100μF/6.3V H7
	C555		CHD1EK30B104	CHIP CERAMIC CAP.(1608) B K 0.1μF/25V
	C560		CHD1JZ30F104	CHIP CERAMIC CAP.(1608) F Z 0.1μF/50V
	C611		CE1JMASSL220	ELECTROLYTIC CAP. 22μF/50V M H7
	C612		CHD1JK30B472	CHIP CERAMIC CAP.(1608) B K 4700pF/50V
	C614		CHD1JZ30F104	CHIP CERAMIC CAP.(1608) F Z 0.1μF/50V
	C615		CE0KMAVSL101	ELECTROLYTIC CAP. 100μF/6.3V H7
	C616		CHD1JK30B102	CHIP CERAMIC CAP.(1608) B K 1000pF/50V
	C1500		CE1CMASDL470	ELECTROLYTIC CAP. 47μF/16V M
	C1501		CE0KMASDL470	ELECTROLYTIC CAP. 47μF/6.3V M
	C1502		CE0KMASDL470	ELECTROLYTIC CAP. 47μF/6.3V M
	C1503		CHD1JK30B103	CHIP CERAMIC CAP.(1608) B K 0.01μF/50V
	C1506		CE1CMASDL470	ELECTROLYTIC CAP. 47μF/16V M
	C1507		CE1CMASDL100	ELECTROLYTIC CAP. 10μF/16V M
	C1508		OCA1EKT0B104	CERAMIC CAP.(AX) B K 0.1μF/25V
	C1509		CE1CMASDL100	ELECTROLYTIC CAP. 10μF/16V M
	C1510		CE1CMASDL100	ELECTROLYTIC CAP. 10μF/16V M
	C1511		CE1CMASDL221	ELECTROLYTIC CAP. 220μF/16V M
	C1512		CE1CMAVSL100	ELECTROLYTIC CAP. 10μF/16V M H7
	C1513		CHD1JZ30F104	CHIP CERAMIC CAP.(1608) F Z 0.1μF/50V
	C1517		CE1CMASDL470	ELECTROLYTIC CAP. 47μF/16V M
	C1518		CHD1JZ30F104	CHIP CERAMIC CAP.(1608) F Z 0.1μF/50V
	C1519		CHD1AZ30F105	CHIP CERAMIC CAP. F Z 1μF/10V
	C1520		CHD1AZ30F105	CHIP CERAMIC CAP. F Z 1μF/10V

△	Location No.	TSB P/N	Reference No.	Description
	C1521		CHD1AZ30F105	CHIP CERAMIC CAP. F Z 1μF/10V
	C1524		CHD1EK30B104	CHIP CERAMIC CAP.(1608) B K 0.1μF/25V
	C1525		CHD1JK30B103	CHIP CERAMIC CAP.(1608) B K 0.01μF/50V
	C1526		CHD1JZ30F104	CHIP CERAMIC CAP.(1608) F Z 0.1μF/50V
	C1527		CE1EMASDL470	ELECTROLYTIC CAP. 47μF/25V M
	C1528		CE1CMASDL101	ELECTROLYTIC CAP. 100μF/16V M
	C1529		CE0KMASDL471	ELECTROLYTIC CAP. 470μF/6.3V M
	C1530		CE1CMASDL220	ELECTROLYTIC CAP. 22μF/16V M
	C1532		CE1CMASDL100	ELECTROLYTIC CAP. 10μF/16V M
	C1533		CE0KMASDL101	ELECTROLYTIC CAP. 100μF/6.3V M
	C1534		CE0KMASDL101	ELECTROLYTIC CAP. 100μF/6.3V M
	C1535		CE1CMASDL100	ELECTROLYTIC CAP. 10μF/16V M
	C1536		CE1CMASDL100	ELECTROLYTIC CAP. 10μF/16V M
	C1537		CE0KMASSL221	ELECTROLYTIC CAP. 220μF/6.3V M H7
	C1538		CHD1JZ30F104	CHIP CERAMIC CAP.(1608) F Z 0.1μF/50V
	C1539		CHD1JZ30F104	CHIP CERAMIC CAP.(1608) F Z 0.1μF/50V
	C1540		CHD1JZ30F104	CHIP CERAMIC CAP.(1608) F Z 0.1μF/50V
	C1541		CE0KMASSL101	ELECTROLYTIC CAP. 100μF/6.3V M H7
	C1542		CE1CMASDL101	ELECTROLYTIC CAP. 100μF/16V M
	C1543		CHD1JZ30F104	CHIP CERAMIC CAP.(1608) F Z 0.1μF/50V
	C1544		CE0KMAVSL470	ELECTROLYTIC CAP. 47μF/6.3V M H7
	C1546		CHD1JZ30F103	CHIP CERAMIC CAP. F Z 0.01μF/50V
	C1547		CE1CMASDL470	ELECTROLYTIC CAP. 47μF/16V M
	C1548		CHD1JZ30F104	CHIP CERAMIC CAP.(1608) F Z 0.1μF/50V
	C1549		CHD1JZ30F104	CHIP CERAMIC CAP.(1608) F Z 0.1μF/50V
	C1550		CP0KMASNC101	ELECTROLYTIC CAP. 100μF/6.3V M NP
	C1551		CHD1JJ3CH330	CHIP CERAMIC CAP.(1608) CH J 33pF/50V
	C1552		CHD1JJ3CH330	CHIP CERAMIC CAP.(1608) CH J 33pF/50V
	C1553		CHD1JZ30F104	CHIP CERAMIC CAP.(1608) F Z 0.1μF/50V
	C1554		CE1CMASDL100	ELECTROLYTIC CAP. 10μF/16V M
	C1555		CHD1JZ30F104	CHIP CERAMIC CAP.(1608) F Z 0.1μF/50V
	C1556		CE1CMAVSL100	ELECTROLYTIC CAP. 10μF/16V M H7
	C1557		CE1CMASDL470	ELECTROLYTIC CAP. 47μF/16V M
	C1558		CHD1JJ3CH101	CHIP CERAMIC CAP.(1608) CH J 100pF/50V
	C1560		CHD1JZ30F104	CHIP CERAMIC CAP.(1608) F Z 0.1μF/50V
	C1563		CE1CMASDL101	ELECTROLYTIC CAP. 100μF/16V M
	C1564		CHD1JZ30F104	CHIP CERAMIC CAP.(1608) F Z 0.1μF/50V
	C1565		CE0KMASDL101	ELECTROLYTIC CAP. 100μF/6.3V M
	C1566		CE1CMASDL100	ELECTROLYTIC CAP. 10μF/16V M
	C1567		CE1CMASDL470	ELECTROLYTIC CAP. 47μF/16V M

△	Location No.	TSB P/N	Reference No.	Description
	C1569		CE0KMASDL471	ELECTROLYTIC CAP. 470μF/6.3V M
	C1571		CE1EMAVSL4R7	ELECTROLYTIC CAP. 4.7μF/25V M H7
	C1572		CE1CMASDL100	ELECTROLYTIC CAP. 10μF/16V M
	C1573		CE1CMASDL100	ELECTROLYTIC CAP. 10μF/16V M
	C1574		CHD1JZ30F104	CHIP CERAMIC CAP.(1608) F Z 0.1μF/50V
	C1575		CDA1EKPOX183	SEMICONDUCTOR CAP. SR K 0.018μF/25V
	C1576		CHD1JJ3CH271	CHIP CERAMIC CAP.(1608) CH J 270pF/50V
	C1577		CHD1JJ3CH271	CHIP CERAMIC CAP.(1608) CH J 270pF/50V
	C1578		CHD1JK30B103	CHIP CERAMIC CAP.(1608) B K 0.01μF/50V
	C1580		CE1CMASDL220	ELECTROLYTIC CAP. 22μF/16V M
	C1581		CE1JMASDL1R0	ELECTROLYTIC CAP. 1μF/50V M
	C1582		CE1JMASDL1R0	ELECTROLYTIC CAP. 1μF/50V M
	C1583		CE1JMASDL1R0	ELECTROLYTIC CAP. 1μF/50V M
	C1584		CE1JMASDL1R0	ELECTROLYTIC CAP. 1μF/50V M
	C1585		CE0KMASDL101	ELECTROLYTIC CAP. 100μF/6.3V M
	C1586		CHD1JJ3CH470	CHIP CERAMIC CAP.(1608) CH J 47pF/50V
	C1587		CE0KMASDL101	ELECTROLYTIC CAP. 100μF/6.3V M
	C1588		CHD1JJ3CH470	CHIP CERAMIC CAP.(1608) CH J 47pF/50V
	C1589		CHD1JZ30F104	CHIP CERAMIC CAP.(1608) F Z 0.1μF/50V
	C1590		CE1JMASDL1R0	ELECTROLYTIC CAP. 1μF/50V M
	C1591		CE1JMASDL1R0	ELECTROLYTIC CAP. 1μF/50V M
	C1592		CHD1JK30B103	CHIP CERAMIC CAP.(1608) B K 0.01μF/50V
	C1593		CHD1JK30B103	CHIP CERAMIC CAP.(1608) B K 0.01μF/50V
	C1594		CHD1JZ30F104	CHIP CERAMIC CAP.(1608) F Z 0.1μF/50V
	C1595		CE1CMAVSL220	ELECTROLYTIC CAP. 22μF/16V M H7
	C1596		CE1CMASDL220	ELECTROLYTIC CAP. 22μF/16V M
	C1597		CHD1JK30B103	CHIP CERAMIC CAP.(1608) B K 0.01μF/50V
	C1598		CE1JMAVSL1R0	ELECTROLYTIC CAP. 1μF/50V M H7
	C1599		CHD1JZ30F104	CHIP CERAMIC CAP.(1608) F Z 0.1μF/50V
	C1600		CHD1JZ30F104	CHIP CERAMIC CAP.(1608) F Z 0.1μF/50V
	C1601		CE1CMAVSL100	ELECTROLYTIC CAP. 10μF/16V M H7
	C1602		CE1CMAVSL100	ELECTROLYTIC CAP. 10μF/16V M H7
	C1603		CE1JMAVSL1R0	ELECTROLYTIC CAP. 1μF/50V M H7
	C1604		CP1JMAVSB1R0	ELECTROLYTIC CAP. 1μF/50V M H7 NP
	C1605		CE0KMASDL471	ELECTROLYTIC CAP. 470μF/6.3V M
	C1606		CE0KMASDL471	ELECTROLYTIC CAP. 470μF/6.3V M
	C1607		CE0KMASDL471	ELECTROLYTIC CAP. 470μF/6.3V M
	C1608		CHD1JK30B103	CHIP CERAMIC CAP.(1608) B K 0.01μF/50V
	C1609		CHD1JZ30F104	CHIP CERAMIC CAP.(1608) F Z 0.1μF/50V
	C1610		CHD1JK30B103	CHIP CERAMIC CAP.(1608) B K 0.01μF/50V

△	Location No.	TSB P/N	Reference No.	Description
	C1611		CE0KMAVSL470	ELECTROLYTIC CAP. 47μF/6.3V M H7
	C1612		CE0KMAVSL101	ELECTROLYTIC CAP. 100μF/6.3V H7
	C1614		CE0KMASDL471	ELECTROLYTIC CAP. 470μF/6.3V M
	C1615		CE0KMASDL471	ELECTROLYTIC CAP. 470μF/6.3V M
	C1616		CE0KMASDL471	ELECTROLYTIC CAP. 470μF/6.3V M
	C1617		CHD1EK30B104	CHIP CERAMIC CAP.(1608) B K 0.1μF/25V
	C1618		CE0KMASDL471	ELECTROLYTIC CAP. 470μF/6.3V M
	C1619		CHD1JZ30F104	CHIP CERAMIC CAP.(1608) F Z 0.1μF/50V
	C1620		CHD1JK30B103	CHIP CERAMIC CAP.(1608) B K 0.01μF/50V
	C1621		CE1JMASDL100	ELECTROLYTIC CAP. 10μF/50V M
	C1623		CHD1JK30B103	CHIP CERAMIC CAP.(1608) B K 0.01μF/50V
	C1626		CHD1CZ30F224	CHIP CERAMIC CAP. F Z 0.22μF/16V
	C1627		CHD1CZ30F224	CHIP CERAMIC CAP. F Z 0.22μF/16V
	C1628		CHD1JK30B222	CHIP CERAMIC CAP. B K 2200pF/50V
	C1629		CHD1JZ30F104	CHIP CERAMIC CAP.(1608) F Z 0.1μF/50V
	C1630		CHD1JK30B103	CHIP CERAMIC CAP.(1608) B K 0.01μF/50V
	C1631		CHD1JK30B102	CHIP CERAMIC CAP.(1608) B K 1000pF/50V
	C1632		CHD1JK30B222	CHIP CERAMIC CAP. B K 2200pF/50V
	C1633		CHD1JZ30F104	CHIP CERAMIC CAP.(1608) F Z 0.1μF/50V
	C1634		CHD1JZ30F104	CHIP CERAMIC CAP.(1608) F Z 0.1μF/50V
	C1635		CE1JMASDLR33	ELECTROLYTIC CAP. 0.33μF/50V M
	C1636		CE0KMASDL101	ELECTROLYTIC CAP. 100μF/6.3V M
	C1637		CE1JMASDL1R0	ELECTROLYTIC CAP. 1μF/50V M
	C1639		CHD1JK30B222	CHIP CERAMIC CAP. B K 2200pF/50V
	C1640		CHD1JK30B222	CHIP CERAMIC CAP. B K 2200pF/50V
	C1643		CE0KMASDL470	ELECTROLYTIC CAP. 47μF/6.3V M
	C1645		CHD1JJ3CH680	CHIP CERAMIC CAP.(1608) CH J 68pF/50V
	C1648		CHD1JK30B222	CHIP CERAMIC CAP. B K 2200pF/50V
	C1649		CHD1JK30B222	CHIP CERAMIC CAP. B K 2200pF/50V
	C1651		CHD1JJ3CH680	CHIP CERAMIC CAP.(1608) CH J 68pF/50V
	C1657		CE1JMASDL1R0	ELECTROLYTIC CAP. 1μF/50V M
	C1658		CHD1JK30B102	CHIP CERAMIC CAP.(1608) B K 1000pF/50V
	C1659		CE1JMASDL1R0	ELECTROLYTIC CAP. 1μF/50V M
	C1660		CHD1JK30B102	CHIP CERAMIC CAP.(1608) B K 1000pF/50V
	C1661		CE1JMASDL1R0	ELECTROLYTIC CAP. 1μF/50V M
	C1662		CE1JMASDL1R0	ELECTROLYTIC CAP. 1μF/50V M
	C1663		CHD1EK30B104	CHIP CERAMIC CAP.(1608) B K 0.1μF/25V
	C1664		CE1JMASDL1R0	ELECTROLYTIC CAP. 1μF/50V M
	C1665		CHD1JK30B102	CHIP CERAMIC CAP.(1608) B K 1000pF/50V
	C1671		CE1EMASDL4R7	ELECTROLYTIC CAP. 4.7μF/25V M

△	Location No.	TSB P/N	Reference No.	Description
	C1672		CE1EMASDL4R7	ELECTROLYTIC CAP. 4.7μF/25V M
	C1673		CE1CMASDL470	ELECTROLYTIC CAP. 47μF/16V M
	C1675		CE1EMASDL470	ELECTROLYTIC CAP. 47μF/25V M
	C1677		CHD1JK30B102	CHIP CERAMIC CAP.(1608) B K 1000pF/50V
	C1680		CHD1JK30B102	CHIP CERAMIC CAP.(1608) B K 1000pF/50V
	C1681		CE1JMASDL1R0	ELECTROLYTIC CAP. 1μF/50V M
	C1684		CE1EMASDL4R7	ELECTROLYTIC CAP. 4.7μF/25V M
	C1685		CE1EMASDL4R7	ELECTROLYTIC CAP. 4.7μF/25V M
	C1686		CE1EMASDL4R7	ELECTROLYTIC CAP. 4.7μF/25V M
	C1687		CE1EMASDL4R7	ELECTROLYTIC CAP. 4.7μF/25V M
	C1688		CE1JMASDL1R0	ELECTROLYTIC CAP. 1μF/50V M
	C1689		CE1JMASDL1R0	ELECTROLYTIC CAP. 1μF/50V M
	C1691		CHD1JJ3CH470	CHIP CERAMIC CAP.(1608) CH J 47pF/50V
	C1692		CE0KMASDL471	ELECTROLYTIC CAP. 470μF/6.3V M
	C1693		CE0KMASDL471	ELECTROLYTIC CAP. 470μF/6.3V M
	C1694		CHD1AZ30F105	CHIP CERAMIC CAP. F Z 1μF/10V
	C1695		CE1JMASDL1R0	ELECTROLYTIC CAP. 1μF/50V M
	C1696		CE1JMASDL1R0	ELECTROLYTIC CAP. 1μF/50V M
	C1697		CE1EMASDL4R7	ELECTROLYTIC CAP. 4.7μF/25V M
	C1698		CE1EMASDL4R7	ELECTROLYTIC CAP. 4.7μF/25V M
	C1699		CHD1JJ3CH470	CHIP CERAMIC CAP.(1608) CH J 47pF/50V
	C1700		CHD1AZ30F105	CHIP CERAMIC CAP. F Z 1μF/10V
	C1701		CE1CMAVSL100	ELECTROLYTIC CAP. 10μF/16V M H7
	C1702		CE1CMAVSL100	ELECTROLYTIC CAP. 10μF/16V M H7
CONNECTORS				
	CN1503	P000465470	J3PHC02JG017	PH CONNECTOR (WHITE) TOP 2P B2B-PH-K-S(LF)
	CN1504	P000465460	J322C19TG001	242 SERIES CONNECTOR 224202119W1
	CN1505		JCFEJ08JG001	FE CONNECTOR TOP 8P 08FE-BT-VK-N
	CN1506		E9B02AFV	AFV BOARD ASSEMBLY E9B02AFV
DIODES				
	D301		QDTZ001SS133	SWITCHING DIODE 1SS133(T-77)
	D370		QDTZ001SS133	SWITCHING DIODE 1SS133(T-77)
	D502	P000468270	NPQZ10GDS957	LED(GREEN) 204-10GD/S957
	D503	P000468270	NPQZ10GDS957	LED(GREEN) 204-10GD/S957
	D510		QDTZ001SS133	SWITCHING DIODE 1SS133(T-77)
	D511		QDTA00MTZJ7R5	ZENER DIODE MTZJF-777.5A
	D512		QDTZ001SS133	SWITCHING DIODE 1SS133(T-77)
	D555	P000468290	NPZZM1E534A2	LED MIE-534A2
	D1501		NDLZ001N5397	DIODE 1N5397-B
	D1502		NDLZ001N5397	DIODE 1N5397-B
	D1506		NDQZ000SB140	SCHOTTKY BARRIER DIODE SB140
	D1507	P000468260	NDQZ001N4005	RECTIFIER DIODE 1N4005
	D1508		QDTC00MTZJ4R3	ZENER DIODE MTZJF-774.3C
	D1511		QDTB00MTZJ10	ZENER DIODE MTZJF-7710B
	D1512		QDTZ001SS133	SWITCHING DIODE 1SS133(T-77)

△	Location No.	TSB P/N	Reference No.	Description
	D1513		QDTZ001SS133	SWITCHING DIODE 1SS133(T-77)
	D1516		QDTZ001SS133	SWITCHING DIODE 1SS133(T-77)
	D1517		QDTZ001SS133	SWITCHING DIODE 1SS133(T-77)
	D1518		QDTB00MTZJ18	ZENER DIODE MTZJF-7718B
	D1519		QDTB00MTZJ11	ZENER DIODE MTZJF-7711B
	D1521		QDTZ001SS133	SWITCHING DIODE 1SS133(T-77)
	D1523		QDTB00MTZJ5R6	ZENER DIODE MTZJF-775.6B
	D1525		QDTA00MTZJ11	ZENER DIODE MTZJF-7711A
	D1526		QDTA00MTZJ11	ZENER DIODE MTZJF-7711A
	D1528		QDTA00MTZJ11	ZENER DIODE MTZJF-7711A
	D1529		QDTA00MTZJ11	ZENER DIODE MTZJF-7711A
	D1531		QDTA00MTZJ11	ZENER DIODE MTZJF-7711A
	D1532		QDTA00MTZJ11	ZENER DIODE MTZJF-7711A
	D1534		QDTB00MTZJ33	ZENER DIODE MTZJF-7733B
	D1535		QDTA00MTZJ11	ZENER DIODE MTZJF-7711A
	D1537		QDTA00MTZJ11	ZENER DIODE MTZJF-7711A
	D1538		QDTA00MTZJ11	ZENER DIODE MTZJF-7711A
	D1539		QDTA00MTZJ11	ZENER DIODE MTZJF-7711A
	D1540		QDTA00MTZJ11	ZENER DIODE MTZJF-7711A
	D1542		QDTA00MTZJ11	ZENER DIODE MTZJF-7711A
	D1548		QDTA00MTZJ11	ZENER DIODE MTZJF-7711A
	D1549		QDTA00MTZJ11	ZENER DIODE MTZJF-7711A
ICs				
	IC301	P000465590	QSZBA0RSY020	IC Y/C/A LA71750EM-MPB-E
	IC370	P000465860	QSZBA0TSY019	IC SECAM LA70100M-TRM-E
	IC451	P000465600	QSZBA0RSY033	IC HIFI LA72648M-MPB-E
	IC501	P000465580	QSZAB0RHT100	SYSCON IC M3776AMCH-AE8GP
	IC612	P000465560	NSZBA0RG2009	VFD DRIVER IC PT6315(L)
	IC1501	P000465570	NSZBA0TTY142	IC(ANALOG SW) CD4052BPWR
	IC1504	P000457260	QSZBA0SSH054	VOLTAGE REGULATOR PQ070XF01SZH
	IC1505	P000457260	QSZBA0SSH054	VOLTAGE REGULATOR PQ070XF01SZH
	IC1506	P000468640	NSZBA0S2H003	IC OP AMP UTC4580 DIP-8 8PIN
	IC1507	P000457280	QSZBA0TMM150	VIDEO SWITCH MM1697AJBE
	IC1508	P000465630	QSZBA0TTS163	IC SWITCH TC4053BF(EL N F)
	IC1509	P000465630	QSZBA0TTS163	IC SWITCH TC4053BF(EL N F)
	IC1510	P000465630	QSZBA0TTS163	IC SWITCH TC4053BF(EL N F)
	IC1511		QSZBA0TSY049	IC VPS/PDC SLICER LC74793NJM-TLM-E
	IC1513	P000459910	NSZBA0SJY035	IC OP AMP KIA4558P/P
	IC1514	P000457270	QSZBA0TMM102	DRIVER FOR DVD MM1637XVBE
	IC1515	P000465610	QSZBA0TMM108	DRIVER FOR DVD MM1636XWRE
	IC1516	P000457270	QSZBA0TMM102	DRIVER FOR DVD MM1637XVBE
	IC1518	P000465620	QSZBA0TMM152	AV SWITCH MM1443XJBE
COILS				
	L251		LLAXKATTU5R6	INDUCTOR 5.6μH-K-26T
	L302		LLAXKATTU101	INDUCTOR(100μH K) LAP02TA101K
	L370		JW5.0T	BOARD JUMPER D0.6-P5.0
	L402		LLARKBSTU470	INDUCTOR 47μH-K-5FT
	L451		LLARKBSTU470	INDUCTOR 47μH-K-5FT
	L452		JW5.0T	BOARD JUMPER D0.6-P5.0
	L501		LLAXKATTU101	INDUCTOR(100μH K) LAP02TA101K
	L502		JW5.0T	BOARD JUMPER D0.6-P5.0
	L503		LLAXKATTU1R8	INDUCTOR 1.8μH-K-26T
	L1501		LLBD00PKV022	CHOKE COIL 47μH
	L1503		JW5.0T	BOARD JUMPER D0.6-P5.0
	L1504		JW5.0T	BOARD JUMPER D0.6-P5.0
	L1505		LLAXKATTU101	INDUCTOR(100μH K) LAP02TA101K

△	Location No.	TSB P/N	Reference No.	Description
	L1506		JW5.0T	BOARD JUMPER D0.6-P5.0
	L1507		LLBD00PKV022	CHOKE COIL 47 μ H
	L1508		LLAXKATTU100	INDUCTOR 10 μ H-K-26T
	L1509		LLAXKATTU101	INDUCTOR(100 μ H K) LAP02TA101K
	L1510		LLBD00PKV022	CHOKE COIL 47 μ H
	L1513		LLAXKATTUR47	INDUCTOR(0.47 μ H K) LAP02TAR47K
	L1515		-----	BEAD CORE ASSEMBLY E9770ED
	L1515-1		JW35.0T	PCB JUMPER D0.6-P35.0
	L1515-2		XL03010XM001	BEAD CORE B16 RH 3.5X10X1.3
	L1517		JW5.0T	BOARD JUMPER D0.6-P5.0
TRANSISTORS				
	Q301		NQS4KTA1266P	TRANSISTOR KTA-1266-GR-AT/P
	Q302		NQSYKTC3199P	TRANSISTOR KTC3199-Y-AT/P
	Q401		QQ220RN1511F	CHIP TRANSISTOR RN1511(TE85R.F)
	Q403		NQSYKTC3203P	TRANSISTOR KTC3203-Y-AT/P
	Q404		NQS4KTA1266P	TRANSISTOR KTA-1266-GR-AT/P
	Q405		NQSZ0KRA103M	RES. BUILT-IN TRANSISTOR KRA103M-AT/P
	Q406		NQ1YKTC3875S	CHIP TRANSISTOR KTC3875S-Y-RTK/P
	Q451		NQ1ZKRC103SP	TRANSISTOR KRC103S-RTK/P
	Q506		NPWZT2046B12	PHOTO TRANSISTOR PT204-6B-12
	Q513		NQSZKRC103MP	NPN TRANSISTOR KRC103M-AT/P
	Q514		NQS5KTC3199P	TRANSISTOR KTC3199-BL-AT/P
	Q515		NQS5KTC3199P	TRANSISTOR KTC3199-BL-AT/P
	Q516		NQ14KTC3875S	CHIP TRANSISTOR KTC3875S-GR-RTK/P
	Q517		NQ14KTC3875S	CHIP TRANSISTOR KTC3875S-GR-RTK/P
	Q518		NQSZKRC103MP	NPN TRANSISTOR KRC103M-AT/P
	Q519		NQSZKRC103MP	NPN TRANSISTOR KRC103M-AT/P
	Q1501		NQSYKTA1267P	TRANSISTOR KTA1267-Y-AT/P
	Q1502		NQSZKRC103MP	NPN TRANSISTOR KRC103M-AT/P
	Q1507		NQS4KTA1266P	TRANSISTOR KTA-1266-GR-AT/P
	Q1508		NQVYKTA1281P	TRANSISTOR KTA1281Y-AT/P
	Q1509		NQSZKRC103MP	NPN TRANSISTOR KRC103M-AT/P
	Q1510		NQSYKTC3205P	TRANSISTOR KTC3205-Y-AT/P
	Q1511		NQSYKTA1273P	TRANSISTOR KTA1273-Y-AT/P
	Q1512		NQSYKTC3199P	TRANSISTOR KTC3199-Y-AT/P
	Q1513		NQSYKTA1267P	TRANSISTOR KTA1267-Y-AT/P
	Q1514		NQSYKTC3199P	TRANSISTOR KTC3199-Y-AT/P
	Q1515		NQSYKTC3199P	TRANSISTOR KTC3199-Y-AT/P
	Q1516		NQSZ0KRA104M	RES. BUILT-IN TRANSISTOR KRA104M-AT/P
	Q1517		NQSZKRC103MP	NPN TRANSISTOR KRC103M-AT/P
	Q1518		NQSYKTC3205P	TRANSISTOR KTC3205-Y-AT/P
	Q1519		NQSZKRC103MP	NPN TRANSISTOR KRC103M-AT/P
	Q1520		NQSYKTC3199P	TRANSISTOR KTC3199-Y-AT/P
	Q1521		NQSYKTC3199P	TRANSISTOR KTC3199-Y-AT/P
	Q1522		NQSYKTC3199P	TRANSISTOR KTC3199-Y-AT/P
	Q1524		NQ1ZKRC103SP	TRANSISTOR KRC103S-RTK/P
	Q1525		NQSYKTC3199P	TRANSISTOR KTC3199-Y-AT/P
	Q1527		NQ1ZKRC103SP	TRANSISTOR KRC103S-RTK/P
	Q1528		NQ1ZKRC103SP	TRANSISTOR KRC103S-RTK/P

△	Location No.	TSB P/N	Reference No.	Description
	Q1529		NQ1ZKRC103SP	TRANSISTOR KRC103S-RTK/P
	Q1530		NQ1YKTC3875S	CHIP TRANSISTOR KTC3875S-Y-RTK/P
	Q1531		NQ1ZKRC103SP	TRANSISTOR KRC103S-RTK/P
	Q1532		NQS4KTA1266P	TRANSISTOR KTA-1266-GR-AT/P
	Q1533		NQ1YKTC3879P	TRANSISTOR KTC3879-Y-RTK/P
	Q1534		NQSYKTC3199P	TRANSISTOR KTC3199-Y-AT/P
	Q1537		NQSYKTC3199P	TRANSISTOR KTC3199-Y-AT/P
	Q1538		NQSYKTC3199P	TRANSISTOR KTC3199-Y-AT/P
	Q1539		NQSYKTC3199P	TRANSISTOR KTC3199-Y-AT/P
	Q1540		NQSYKTC3199P	TRANSISTOR KTC3199-Y-AT/P
	Q1542		NQSYKTC3198P	TRANSISTOR KTC3198-Y-AT/P
RESISTORS				
	R251		RRXAJR5Z0393	CHIP RES. 1/10W J 39k Ω
	R252		RRXAJR5Z0222	CHIP RES. 1/10W J 2.2k Ω
	R301		RRXAJR5Z0122	CHIP RES. 1/10W J 1.2k Ω
	R303		RRXAJR5Z0562	CHIP RES. 1/10W J 5.6k Ω
	R305		RRXAJR5Z0103	CHIP RES. 1/10W J 10k Ω
	R310		JW5.0T	BOARD JUMPER D0.6-P5.0
	R314		RRXAJR5Z0392	CHIP RES. 1/10W J 3.9k Ω
	R316		RRXAJR5Z0182	CHIP RES. 1/10W J 1.8k Ω
	R319		RRXAJR5Z0102	CHIP RES. 1/10W J 1k Ω
	R320		RRXAJR5Z0473	CHIP RES. 1/10W J 47k Ω
	R321		RRXAJR5Z0151	CHIP RES. 1/10W J 150 Ω
	R322		RRXAJR5Z0103	CHIP RES. 1/10W J 10k Ω
	R323		RRXAJR5Z0222	CHIP RES. 1/10W J 2.2k Ω
	R324		RRXAJR5Z0151	CHIP RES. 1/10W J 150 Ω
	R325		RRXAJR5Z0122	CHIP RES. 1/10W J 1.2k Ω
	R326		RRXAJR5Z0472	CHIP RES. 1/10W J 4.7k Ω
	R327		RRXAJR5Z0682	CHIP RES. 1/10W J 6.8k Ω
	R328		RRXAJR5Z0102	CHIP RES. 1/10W J 1k Ω
	R330		RRXAJR5Z0222	CHIP RES. 1/10W J 2.2k Ω
	R331		RRXAJR5Z0183	CHIP RES. 1/10W J 18k Ω
	R332		RRXAJR5Z0103	CHIP RES. 1/10W J 10k Ω
	R333		RRXAJR5Z0183	CHIP RES. 1/10W J 18k Ω
	R334		RRXAJR5Z0103	CHIP RES. 1/10W J 10k Ω
	R335		RRXAJR5Z0101	CHIP RES. 1/10W J 100 Ω
	R336		RRXAJR5Z0472	CHIP RES. 1/10W J 4.7k Ω
	R337		RRXAJR5Z0682	CHIP RES. 1/10W J 6.8k Ω
	R345		RRXAJR5Z0221	CHIP RES. 1/10W J 220 Ω
	R346		RCX4JATZ0681	CARBON RES. 1/4W J 680 Ω
	R370		RRXAJR5Z0272	CHIP RES. 1/10W J 2.7k Ω
	R371		RCX6JATZ0562	CARBON RES. 1/6W J 5.6k Ω
	R372		RRXAJR5Z0392	CHIP RES. 1/10W J 3.9k Ω
	R401		RCX4JATZ0821	CARBON RES. 1/4W J 820 Ω
	R402		RCX6JATZ0101	CARBON RES. 1/6W J 100 Ω
	R404		RRXAZR5Z0000	CHIP RES.(1608) 1/10W 0 Ω
	R405		RRXAJR5Z0473	CHIP RES. 1/10W J 47k Ω
	R406		RRXAJR5Z0223	CHIP RES. 1/10W J 22k Ω
	R407		RRXAJR5Z0562	CHIP RES. 1/10W J 5.6k Ω
	R408		RRXAJR5Z0123	CHIP RES. 1/10W J 12k Ω
	R409		RRXAJR5Z0562	CHIP RES. 1/10W J 5.6k Ω
	R410		RRXAJR5Z0102	CHIP RES. 1/10W J 1k Ω
	R411		RRXAJR5Z0273	CHIP RES. 1/10W J 27k Ω
	R412		RRXAJR5Z0121	CHIP RES. 1/10W J 120 Ω
	R413		RRXAJR5Z0334	CHIP RES. 1/10W J 330k Ω
	R414		RRXAJR5Z0123	CHIP RES. 1/10W J 12k Ω
	R415		RRXAJR5Z0182	CHIP RES. 1/10W J 1.8k Ω
	R416		RRXAJR5Z0561	CHIP RES. 1/10W J 560 Ω
	R417		RRXAJR5Z0222	CHIP RES. 1/10W J 2.2k Ω
	R418		RRXAJR5Z0123	CHIP RES. 1/10W J 12k Ω
	R419		RRXAJR5Z0103	CHIP RES. 1/10W J 10k Ω
	R420		RRXAJR5Z0472	CHIP RES. 1/10W J 4.7k Ω
	R421		RRXAJR5Z0472	CHIP RES. 1/10W J 4.7k Ω

△	Location No.	TSB P/N	Reference No.	Description
	R451		RRXAJR5Z0223	CHIP RES. 1/10W J 22k Ω
	R452		RRXAJR5Z0333	CHIP RES. 1/10W J 33k Ω
	R453		RRXAJR5Z0562	CHIP RES. 1/10W J 5.6k Ω
	R454		RRXAJR5Z0393	CHIP RES. 1/10W J 39k Ω
	R462		RRXAJR5Z0103	CHIP RES. 1/10W J 10k Ω
	R463		RRXAJR5Z0471	CHIP RES. 1/10W J 470 Ω
	R464		RRXAJR5Z0332	CHIP RES. 1/10W J 3.3k Ω
	R465		RRXAJR5Z0223	CHIP RES. 1/10W J 22k Ω
	R466		RRXAJR5Z0822	CHIP RES. 1/10W J 8.2k Ω
	R467		RRXAJR5Z0562	CHIP RES. 1/10W J 5.6k Ω
	R469		RRXAJR5Z0333	CHIP RES. 1/10W J 33k Ω
	R470		RRXAJR5Z0393	CHIP RES. 1/10W J 39k Ω
	R479		RRXAJR5Z0330	CHIP RES. 1/10W J 33 Ω
	R480		RCX6JATZ0101	CARBON RES. 1/6W J 100 Ω
	R481		RRXAJR5Z0330	CHIP RES. 1/10W J 33 Ω
	R482		RRXAJR5Z0101	CHIP RES. 1/10W J 100 Ω
	R483		RRXAJR5Z0223	CHIP RES. 1/10W J 22k Ω
	R484		RRXAJR5Z0682	CHIP RES. 1/10W J 6.8k Ω
	R509		RRXAJR5Z0181	CHIP RES. 1/10W J 180 Ω
	R510		RRXAJR5Z0473	CHIP RES. 1/10W J 47k Ω
	R511		RCX6GATZ0362	CARBON RES. 1/6W G 3.6k Ω
	R512		RRXAJR5Z0683	CHIP RES. 1/10W J 68k Ω
	R513		RRXAJR5Z0333	CHIP RES. 1/10W J 33k Ω
	R514		RCX6GATZ0103	CARBON RES. 1/6W G 10k Ω
	R516		RCX6GATZ0471	CARBON RES. 1/6W G 470 Ω
	R517		RCX4JATZ0271	CARBON RES. 1/4W J 270 Ω
	R519		RCX6GATZ0223	CARBON RES. 1/6W G 22k Ω
	R523		RCX6GATZ0152	CARBON RES. 1/6W G 1.5k Ω
	R525		RRXAJR5Z0394	CHIP RES. 1/10W J 390k Ω
	R526		RCX6JATZ0394	CARBON RES. 1/6W J 390k Ω
	R528		RCX6GATZ0472	CARBON RES. 1/6W G 4.7k Ω
	R536		RRXAJR5Z0182	CHIP RES. 1/10W J 1.8k Ω
	R537		RRXAJR5Z0681	CHIP RES. 1/10W J 680 Ω
	R539		RRXAJR5Z0103	CHIP RES. 1/10W J 10k Ω
	R540		RRXAJR5Z0103	CHIP RES. 1/10W J 10k Ω
	R541		RRXAJR5Z0183	CHIP RES. 1/10W J 18k Ω
	R542		RRXAJR5Z0562	CHIP RES. 1/10W J 5.6k Ω
	R543		RCX4JATZ0102	CARBON RES. 1/4W J 1k Ω
	R544		RCX6JATZ0103	CARBON RES. 1/6W J 10k Ω
	R545		RCX6JATZ0103	CARBON RES. 1/6W J 10k Ω
	R546		RRXAJR5Z0102	CHIP RES. 1/10W J 1k Ω
	R553		RRXAJR5Z0103	CHIP RES. 1/10W J 10k Ω
	R555		RRXAJR5Z0102	CHIP RES. 1/10W J 1k Ω
	R567		RRXAJR5Z0393	CHIP RES. 1/10W J 39k Ω
	R568		RRXAJR5Z0224	CHIP RES. 1/10W J 220k Ω
	R569		RRXAJR5Z0103	CHIP RES. 1/10W J 10k Ω
	R570		RCX6JATZ0472	CARBON RES. 1/6W J 4.7k Ω
	R572		RRXAJR5Z0102	CHIP RES. 1/10W J 1k Ω
	R574		RRXAJR5Z0102	CHIP RES. 1/10W J 1k Ω
	R575		RRXAJR5Z0334	CHIP RES. 1/10W J 330k Ω
	R577		RRXAJR5Z0152	CHIP RES. 1/10W J 1.5k Ω
	R578		RRXAJR5Z0102	CHIP RES. 1/10W J 1k Ω
	R581		RRXAJR5Z0103	CHIP RES. 1/10W J 10k Ω
	R582		RRXAJR5Z0104	CHIP RES. 1/10W J 100k Ω
	R583		RCX4JATZ0821	CARBON RES. 1/4W J 820 Ω
	R584		RRXAJR5Z0101	CHIP RES. 1/10W J 100 Ω
	R585		RRXAJR5Z0222	CHIP RES. 1/10W J 2.2k Ω
	R586		RRXAJR5Z0821	CHIP RES. 1/10W J 820 Ω
	R588		RRXAJR5Z0471	CHIP RES. 1/10W J 470 Ω
	R595		RCX6JATZ0103	CARBON RES. 1/6W J 10k Ω
	R596		RCX6JATZ0151	CARBON RES. 1/6W J 150 Ω
	R597		RCX6JATZ0221	CARBON RES. 1/6W J 220 Ω
	R598		RCX6JATZ0221	CARBON RES. 1/6W J 220 Ω
	R601		RRXAJR5Z0182	CHIP RES. 1/10W J 1.8k Ω
	R602		RRXAJR5Z0102	CHIP RES. 1/10W J 1k Ω
	R603		RRXAJR5Z0122	CHIP RES. 1/10W J 1.2k Ω

△	Location No.	TSB P/N	Reference No.	Description
	R604		RRXAJR5Z0152	CHIP RES. 1/10W J 1.5k Ω
	R605		RRXAJR5Z0222	CHIP RES. 1/10W J 2.2k Ω
	R606		RRXAJR5Z0392	CHIP RES. 1/10W J 3.9k Ω
	R607		RRXAJR5Z0822	CHIP RES. 1/10W J 8.2k Ω
	R608		RRXAJR5Z0223	CHIP RES. 1/10W J 22k Ω
	R617		JW5.0T	BOARD JUMPER D0.6-P5.0
	R618		RRXAJR5Z0104	CHIP RES. 1/10W J 100k Ω
	R621		RRXAZR5Z0000	CHIP RES.(1608) 1/10W 0 Ω
	R622		RRXAZR5Z0000	CHIP RES.(1608) 1/10W 0 Ω
	R623		RRXAZR5Z0000	CHIP RES.(1608) 1/10W 0 Ω
	R624		RRXAJR5Z0103	CHIP RES. 1/10W J 10k Ω
	R625		RRXAJR5Z0182	CHIP RES. 1/10W J 1.8k Ω
	R626		RRXAJR5Z0102	CHIP RES. 1/10W J 1k Ω
	R627		RRXAJR5Z0122	CHIP RES. 1/10W J 1.2k Ω
	R628		RRXAJR5Z0152	CHIP RES. 1/10W J 1.5k Ω
	R629		RCX4JATZ0222	CARBON RES. 1/4W J 2.2k Ω
	R630		RRXAJR5Z0392	CHIP RES. 1/10W J 3.9k Ω
	R631		RRXAJR5Z0822	CHIP RES. 1/10W J 8.2k Ω
	R632		RRXAJR5Z0223	CHIP RES. 1/10W J 22k Ω
	R643		RRXAJR5Z0101	CHIP RES. 1/10W J 100 Ω
	R644		RRXAJR5Z0101	CHIP RES. 1/10W J 100 Ω
	R645		RRXAJR5Z0332	CHIP RES. 1/10W J 3.3k Ω
	R646		RRXAJR5Z0332	CHIP RES. 1/10W J 3.3k Ω
	R647		RRXAJR5Z0561	CHIP RES. 1/10W J 560 Ω
	R648		RCX4JATZ0102	CARBON RES. 1/4W J 1k Ω
	R649		RRXAJR5Z0561	CHIP RES. 1/10W J 560 Ω
	R650		RCX4JATZ0102	CARBON RES. 1/4W J 1k Ω
	R651		RRXAJR5Z0103	CHIP RES. 1/10W J 10k Ω
	R653		RCX6JATZ0272	CARBON RES. 1/6W J 2.7k Ω
	R654		RRXAJR5Z0472	CHIP RES. 1/10W J 4.7k Ω
	R655		RCX6JATZ0272	CARBON RES. 1/6W J 2.7k Ω
	R656		RRXAJR5Z0472	CHIP RES. 1/10W J 4.7k Ω
	R657		RRXAJR5Z0103	CHIP RES. 1/10W J 10k Ω
	R1500		RCX4JATZ0181	CARBON RES. 1/4W J 180 Ω
	R1501		RCX4JATZ0102	CARBON RES. 1/4W J 1k Ω
	R1502		JW5.0T	BOARD JUMPER D0.6-P5.0
	R1504		RCX4JATZ0181	CARBON RES. 1/4W J 180 Ω
	R1505		RRXAJR5Z0562	CHIP RES. 1/10W J 5.6k Ω
	R1507		RRXAJR5Z0473	CHIP RES. 1/10W J 47k Ω
	R1510		RCX4JATZ0181	CARBON RES. 1/4W J 180 Ω
	R1512		RCX4JATZ0181	CARBON RES. 1/4W J 180 Ω
	R1513		RCX6JATZ0273	CARBON RES. 1/6W J 27k Ω
	R1514		RRXAJR5Z0103	CHIP RES. 1/10W J 10k Ω
	R1519		JW5.0T	BOARD JUMPER D0.6-P5.0
	R1522		RCX4JATZ0102	CARBON RES. 1/4W J 1k Ω
	R1523		RCX4JATZ0391	CARBON RES. 1/4W J 390 Ω
	R1524		RCX6JATZ0473	CARBON RES. 1/6W J 47k Ω
	R1525		RCX6JATZ0821	CARBON RES. 1/6W J 820 Ω
	R1526		RCX4JATZ0681	CARBON RES. 1/4W J 680 Ω
	R1527		RCX4JATZ0681	CARBON RES. 1/4W J 680 Ω
	R1528		RRXAJR5Z0473	CHIP RES. 1/10W J 47k Ω
	R1529		RCX6JATZ0152	CARBON RES. 1/6W J 1.5k Ω
	R1530		RRXAJR5Z0103	CHIP RES. 1/10W J 10k Ω
	R1531		RCX4JATZ0561	CARBON RES. 1/4W J 560 Ω
	R1532		RCX4JATZ0561	CARBON RES. 1/4W J 560 Ω
	R1533		RRXAJR5Z0103	CHIP RES. 1/10W J 10k Ω
	R1536		RCX4JATZ0152	CARBON RES. 1/4W J 1.5k Ω
	R1537		RCX4JATZ0152	CARBON RES. 1/4W J 1.5k Ω
	R1538		RCX4JATZ0331	CARBON RES. 1/4W J 330 Ω
	R1539		RCX4JATZ0122	CARBON RES. 1/4W J 1.2k Ω
	R1540		RRXAJR5Z0333	CHIP RES. 1/10W J 33k Ω
	R1541		RRXAJR5Z0471	CHIP RES. 1/10W J 470 Ω
	R1543		RRXAJR5Z0472	CHIP RES. 1/10W J 4.7k Ω
	R1544		RRXAJR5Z0333	CHIP RES. 1/10W J 33k Ω
	R1547		RRXAJR5Z0472	CHIP RES. 1/10W J 4.7k Ω
	R1550		RCX6JATZ0472	CARBON RES. 1/6W J 4.7k Ω

△	Location No.	TSB P/N	Reference No.	Description
	R1551		RRXAFR5H1002	CHIP RES. 1/10W F 10k Ω
	R1552		RRXAFR5H1002	CHIP RES. 1/10W F 10k Ω
	R1553		RRXAJR5Z0473	CHIP RES. 1/10W J 47k Ω
	R1554		RCX4JATZ0270	CARBON RES. 1/4W J 27 Ω
	R1555		RRXAJR5Z0333	CHIP RES. 1/10W J 33k Ω
	R1556		RRXAFR5H1502	CHIP RES. 1/10W F 15k Ω
	R1557		RRXAJR5Z0103	CHIP RES. 1/10W J 10k Ω
	R1558		RRXAFR5H1002	CHIP RES. 1/10W F 10k Ω
	R1559		RRXAJR5Z0222	CHIP RES. 1/10W J 2.2k Ω
	R1560		RRXAJR5Z0222	CHIP RES. 1/10W J 2.2k Ω
	R1561		RRXAFR5H1200	CHIP RES. 1/10W F 120 Ω
	R1562		RRXAFR5H1501	CHIP RES. 1/10W F 1.5k Ω
	R1563		RRXAJR5Z0333	CHIP RES. 1/10W J 33k Ω
	R1564		RCX6JATZ0223	CARBON RES. 1/6W J 22k Ω
	R1565		RRXAJR5Z0222	CHIP RES. 1/10W J 2.2k Ω
	R1566		RRXAJR5Z0682	CHIP RES. 1/10W J 6.8k Ω
	R1567		RRXAJR5Z0682	CHIP RES. 1/10W J 6.8k Ω
	R1568		RCX6JATZ0332	CARBON RES. 1/6W J 3.3k Ω
	R1569		RCX6JATZ0332	CARBON RES. 1/6W J 3.3k Ω
	R1570		RCX6JATZ0332	CARBON RES. 1/6W J 3.3k Ω
	R1571		RRXAZR5Z0000	CHIP RES.(1608) 1/10W 0 Ω
	R1572		RRXAJR5Z0472	CHIP RES. 1/10W J 4.7k Ω
	R1573		RRXAJR5Z0472	CHIP RES. 1/10W J 4.7k Ω
	R1574		JW5.0T	BOARD JUMPER D0.6-P5.0
	R1576		RRXAZR5Z0000	CHIP RES.(1608) 1/10W 0 Ω
	R1578		RRXAJR5Z0103	CHIP RES. 1/10W J 10k Ω
	R1579		RRXAJR5Z0103	CHIP RES. 1/10W J 10k Ω
	R1581		RCX4JATZ0822	CARBON RES. 1/4W J 8.2k Ω
	R1582		RCX4JATZ0822	CARBON RES. 1/4W J 8.2k Ω
	R1587		RRXAJR5Z0104	CHIP RES. 1/10W J 100k Ω
	R1589		RRXAJR5Z0471	CHIP RES. 1/10W J 470 Ω
	R1590		RRXAJR5Z0104	CHIP RES. 1/10W J 100k Ω
	R1591		RRXAJR5Z0302	CHIP RES. 1/10W J 3k Ω
	R1592		RRXAJR5Z0102	CHIP RES. 1/10W J 1k Ω
	R1593		RRXAJR5Z0123	CHIP RES. 1/10W J 12k Ω
	R1594		RRXAJR5Z0302	CHIP RES. 1/10W J 3k Ω
	R1595		RRXAJR5Z0123	CHIP RES. 1/10W J 12k Ω
	R1596		RRXAJR5Z0682	CHIP RES. 1/10W J 6.8k Ω
	R1597		RRXAJR5Z0151	CHIP RES. 1/10W J 150 Ω
	R1598		RRXAJR5Z0151	CHIP RES. 1/10W J 150 Ω
	R1599		RRXAFR5H2200	CHIP RES. 1/10W F 220 Ω
	R1600		RRXAFR5H2200	CHIP RES. 1/10W F 220 Ω
	R1603		RRXAFR5H1002	CHIP RES. 1/10W F 10k Ω
	R1604		JW5.0T	BOARD JUMPER D0.6-P5.0
	R1605		RRXAFR5H2200	CHIP RES. 1/10W F 220 Ω
	R1606		RRXAFR5H2200	CHIP RES. 1/10W F 220 Ω
	R1607		RRXAJR5Z0332	CHIP RES. 1/10W J 3.3k Ω
	R1608		RRXAJR5Z0151	CHIP RES. 1/10W J 150 Ω
	R1609		RRXAJR5Z0151	CHIP RES. 1/10W J 150 Ω
	R1610		RRXAJR5Z0471	CHIP RES. 1/10W J 470 Ω
	R1611		RRXAJR5Z0471	CHIP RES. 1/10W J 470 Ω
	R1612		RRXAJR5Z0472	CHIP RES. 1/10W J 4.7k Ω
	R1613		RRXAZR5Z0000	CHIP RES.(1608) 1/10W 0 Ω
	R1616		RRXAJR5Z0102	CHIP RES. 1/10W J 1k Ω
	R1619		RCX4JATZ0750	CARBON RES. 1/4W J 75 Ω
	R1620		RCX4JATZ0102	CARBON RES. 1/4W J 1k Ω
	R1630		RRXAFR5H8201	CHIP RES. 1/10W F 8.2k Ω
	R1631		RRXAFR5H8201	CHIP RES. 1/10W F 8.2k Ω
	R1632		RRXAJR5Z0272	CHIP RES. 1/10W J 2.7k Ω
	R1633		RRXAZR5Z0000	CHIP RES.(1608) 1/10W 0 Ω
	R1634		RRXAZR5Z0000	CHIP RES.(1608) 1/10W 0 Ω
	R1636		RRXAJR5Z0103	CHIP RES. 1/10W J 10k Ω
	R1637		RRXAFR5H1302	CHIP RES. 1/10W F 13k Ω
	R1638		RRXAFR5H1302	CHIP RES. 1/10W F 13k Ω
	R1639		RRXAJR5Z0133	CHIP RES. 1/10W J 13k Ω
	R1640		RRXAJR5Z0133	CHIP RES. 1/10W J 13k Ω

△	Location No.	TSB P/N	Reference No.	Description
	R1642		RRXAJR5Z0103	CHIP RES. 1/10W J 10k Ω
	R1643		RCX6JATZ0153	CARBON RES. 1/6W J 15k Ω
	R1644		RRXAFR5H2200	CHIP RES. 1/10W F 220 Ω
	R1647		RRXAJR5Z0222	CHIP RES. 1/10W J 2.2k Ω
	R1648		RRXAJR5Z0223	CHIP RES. 1/10W J 22k Ω
	R1650		RRXAJR5Z0104	CHIP RES. 1/10W J 100k Ω
	R1651		RRXAJR5Z0104	CHIP RES. 1/10W J 100k Ω
	R1652		RRXAJR5Z0103	CHIP RES. 1/10W J 10k Ω
	R1653		RRXAJR5Z0562	CHIP RES. 1/10W J 5.6k Ω
	R1654		RRXAJR5Z0471	CHIP RES. 1/10W J 470 Ω
	R1655		RRXAZR5Z0000	CHIP RES.(1608) 1/10W 0 Ω
	R1656		RRXAJR5Z0471	CHIP RES. 1/10W J 470 Ω
	R1657		RRXAJR5Z0103	CHIP RES. 1/10W J 10k Ω
	R1658		RRXAJR5Z0682	CHIP RES. 1/10W J 6.8k Ω
	R1659		RCX4JATZ0750	CARBON RES. 1/4W J 75 Ω
	R1660		RCX4JATZ0750	CARBON RES. 1/4W J 75 Ω
	R1661		RCX4JATZ0750	CARBON RES. 1/4W J 75 Ω
	R1662		RRXAJR5Z0101	CHIP RES. 1/10W J 100 Ω
	R1663		RRXAJR5Z0331	CHIP RES. 1/10W J 330 Ω
	R1664		RRXAJR5Z0331	CHIP RES. 1/10W J 330 Ω
	R1665		JW5.0T	BOARD JUMPER D0.6-P5.0
	R1666		RCX4JATZ0102	CARBON RES. 1/4W J 1k Ω
	R1669		RRXAJR5Z0182	CHIP RES. 1/10W J 1.8k Ω
	R1670		RRXAJR5Z0222	CHIP RES. 1/10W J 2.2k Ω
	R1671		RRXAJR5Z0102	CHIP RES. 1/10W J 1k Ω
	R1672		RRXAJR5Z0102	CHIP RES. 1/10W J 1k Ω
	R1673		RRXAJR5Z0222	CHIP RES. 1/10W J 2.2k Ω
	R1676		RCX4JATZ0222	CARBON RES. 1/4W J 2.2k Ω
	R1677		RCX4JATZ0102	CARBON RES. 1/4W J 1k Ω
	R1678		RCX4JATZ0331	CARBON RES. 1/4W J 330 Ω
	R1679		RRXAJR5Z0221	CHIP RES. 1/10W J 220 Ω
	R1680		RCX4JATZ0750	CARBON RES. 1/4W J 75 Ω
	R1681		RCX4JATZ0750	CARBON RES. 1/4W J 75 Ω
	R1682		RRXAJR5Z0750	CHIP RES. 1/10W J 75 Ω
	R1683		RRXAJR5Z0750	CHIP RES. 1/10W J 75 Ω
	R1684		RRXAJR5Z0750	CHIP RES. 1/10W J 75 Ω
	R1685		RCX4JATZ0750	CARBON RES. 1/4W J 75 Ω
	R1686		RRXAJR5Z0750	CHIP RES. 1/10W J 75 Ω
	R1688		RRXAJR5Z0750	CHIP RES. 1/10W J 75 Ω
	R1689		RRXAJR5Z0102	CHIP RES. 1/10W J 1k Ω
	R1690		RRXAJR5Z0102	CHIP RES. 1/10W J 1k Ω
	R1691		RCX6JATZ0221	CARBON RES. 1/6W J 220 Ω
	R1692		RCX6JATZ0221	CARBON RES. 1/6W J 220 Ω
	R1693		RCX4JATZ0821	CARBON RES. 1/4W J 820 Ω
	R1694		RRXAJR5Z0104	CHIP RES. 1/10W J 100k Ω
	R1695		RCX4JATZ0821	CARBON RES. 1/4W J 820 Ω
	R1697		RRXAJR5Z0221	CHIP RES. 1/10W J 220 Ω
	R1698		RRXAJR5Z0221	CHIP RES. 1/10W J 220 Ω
	R1699		RRXAJR5Z0222	CHIP RES. 1/10W J 2.2k Ω
	R1700		RRXAZR5Z0000	CHIP RES.(1608) 1/10W 0 Ω
	R1702		RRXAZR5Z0000	CHIP RES.(1608) 1/10W 0 Ω
	R1703		RRXAJR5Z0471	CHIP RES. 1/10W J 470 Ω
	R1704		RRXAJR5Z0223	CHIP RES. 1/10W J 22k Ω
	R1705		RRXAJR5Z0471	CHIP RES. 1/10W J 470 Ω
	R1706		RRXAJR5Z0102	CHIP RES. 1/10W J 1k Ω
	R1708		RCX6JATZ0101	CARBON RES. 1/6W J 100 Ω
	R1709		RCX6JATZ0101	CARBON RES. 1/6W J 100 Ω
	R1710		RCX4JATZ0561	CARBON RES. 1/4W J 560 Ω
	R1711		RCX4JATZ0561	CARBON RES. 1/4W J 560 Ω
	R1712		RRXAJR5Z0122	CHIP RES. 1/10W J 1.2k Ω
	R1713		RRXAJR5Z0333	CHIP RES. 1/10W J 33k Ω
	R1714		RRXAJR5Z0471	CHIP RES. 1/10W J 470 Ω
	R1718		RRXAJR5Z0163	CHIP RES. 1/10W J 16k Ω
	R1719		RRXAJR5Z0163	CHIP RES. 1/10W J 16k Ω
	R1720		RRXAJR5Z0333	CHIP RES. 1/10W J 33k Ω
	R1721		RRXAJR5Z0333	CHIP RES. 1/10W J 33k Ω

△	Location No.	TSB P/N	Reference No.	Description
	R1722		RRXAJR5Z0183	CHIP RES. 1/10W J 18k Ω
	R1723		RRXAJR5Z0273	CHIP RES. 1/10W J 27k Ω
	R1724		RRXAJR5Z0153	CHIP RES. 1/10W J 15k Ω
	R1725		RRXAJR5Z0333	CHIP RES. 1/10W J 33k Ω
	R1726		RRXAJR5Z0183	CHIP RES. 1/10W J 18k Ω
	R1727		RRXAJR5Z0273	CHIP RES. 1/10W J 27k Ω
	R1728		RRXAJR5Z0153	CHIP RES. 1/10W J 15k Ω
	R1729		RRXAJR5Z0333	CHIP RES. 1/10W J 33k Ω
SWITCHES				
	SW506	P000465640	SSC0101MCE03	LEAF SWITCH MXS01830MVPO
	SW507	P000480780	SSR0106KB004	SWITCH ROTARY SSS-53MD-1
	SW521		SST0101HH013	TACT SWITCH KSM0614B
	SW522		SST0101HH013	TACT SWITCH KSM0614B
	SW523		SST0101HH013	TACT SWITCH KSM0614B
	SW524		SST0101HH013	TACT SWITCH KSM0614B
	SW525		SST0101HH013	TACT SWITCH KSM0614B
	SW526		SST0101HH013	TACT SWITCH KSM0614B
	SW527		SST0101HH013	TACT SWITCH KSM0614B
	SW528		SST0101HH013	TACT SWITCH KSM0614B
	SW601		SST0101HH013	TACT SWITCH KSM0614B
	SW603		SST0101HH013	TACT SWITCH KSM0614B
	SW605		SST0101HH013	TACT SWITCH KSM0614B
MISCELLANEOUS				
	2B16		0VM409508	BUSH LED(F) H3700UD
	2B17		1VM424676	SHIELD ASSEMBLY E9B00ED
	2B46		0VM304573	ROHM HOLDER H7770JD
	FL601	P000465660	TVFD1C0FT049	VACUUM FLUORESCENT DISPLAY 7-BT-301NS
	JK1501	P000465540	JXRL030LY116	JACK RCA MSP-213V1-652-B NIL
	JK1502	P000459850	JXGL210LY008	RGB CONNECTOR MRC-021V-05 ABS(B110)
	JK1504	P000465520	JXRL010LY140	JACK RCA MSP-281V41-B(B110)
	JK1505	P000465530	JXRL020LY120	JACK RCA MSP-382V-12 NILF
	JK1506	P000457070	JXEL040LY003	JACK S TYPE MDC-050V-2.4 LF(B110)
	JW101	P000465700	WX1E9B00-003	FFC CABLE 30P FFC/P1.00/140
	JW102	P000465700	WX1E9B00-003	FFC CABLE 30P FFC/P1.00/140
	PS502		QPWZP1302C70	PHOTO INTERRUPTER RPI-302C70
	RM1501	P000457340	USESJRSKK039	REMOTE RECEIVER PIC-37043LU
	TP301		JW11.5T	BOARD JUMPER D0.6-P11.5
	TP501		JW5.0T	BOARD JUMPER D0.6-P5.0
	TP502		JW7.0T	BOARD JUMPER D0.6-P7.0
	TP503		JW7.5T	BOARD JUMPER D0.6-P7.5
	TP504		JW28.0T	BOARD JUMPER D0.6-P28.0
	TU1501	P000461900	UTUNPSLAL005	TUNER UNIT TMFE2-401A
	VR501		VRCB104HH014	CARBON P.O.T. VZ067TL1 B104 PB(F)
	X301	P000468200	FXC445LLN004	XTAL 4.433619MHZ
	X501	P000468220	FXD126LCHE01	QUARTS CRYSTAL 12.000000MHz
	X502	P000459810	FXC323LQUA02	XTAL QTF38-32768K125P20L

BOARD POWER SWITCH

△	Location No.	TSB P/N	Reference No.	Description
			-----	BOARD POWER SWITCH (MCV-B) Consists of the following:
DIODE				
	D673	P000468280	NPQZ1CHJGTNN	LED(GREEN) LTL1CHJGTNN
SWITCH				
	SW673		SST0101HH013	TACT SWITCH KSM0614B

△	Location No.	TSB P/N	Reference No.	Description
MISCELLANEOUS				
	JW001	P000465730	WX1E9B00-007	FLAT CABLE 4P AWG26#2651/P2.0/100

BOARD FUNCTION

△	Location No.	TSB P/N	Reference No.	Description
			-----	BOARD FUNCTION (MCV-C) Consists of the following:
SWITCHES				
	SW681		SST0101HH013	TACT SWITCH KSM0614B
	SW682		SST0101HH013	TACT SWITCH KSM0614B
MISCELLANEOUS				
	JW002	P000465710	WX1E9B00-004	FLAT CABLE 3P AWG26#2651/P2.0/80

BOARD FRONT JACK

△	Location No.	TSB P/N	Reference No.	Description
			-----	BOARD FRONT JACK (MCV-D) Consists of the following:
CAPACITORS				
	C1205		CHD1JK30B222	CHIP CERAMIC CAP. B K 2200pF/50V
	C1206		CHD1JK30B222	CHIP CERAMIC CAP. B K 2200pF/50V
	CN1201		JCFEJ08JG001	FE CONNECTOR TOP 8P 08FE-BT-VK-N
DIODES				
	D1544		QDTA00MTZJ11	ZENER DIODE MTZJT-7711A
	D1545		QDTA00MTZJ11	ZENER DIODE MTZJT-7711A
	D1546		QDTA00MTZJ11	ZENER DIODE MTZJT-7711A
	D1547		QDTA00MTZJ11	ZENER DIODE MTZJT-7711A
RESISTORS				
	R1201		RRXAJR5Z0750	CHIP RES. 1/10W J 75 Ω
	R1202		RRXAJR5Z0750	CHIP RES. 1/10W J 75 Ω
	R1203		RRXAJR5Z0221	CHIP RES. 1/10W J 220 Ω
	R1204		RRXAJR5Z0221	CHIP RES. 1/10W J 220 Ω
	R1205		RRXAJR5Z0750	CHIP RES. 1/10W J 75 Ω
MISCELLANEOUS				
	JK1201	P000465500	JXRL010LY101	JACK RCA(YELLOW) MTJ-032-11B-40 FE01
	JK1202	P000465510	JXRL010LY102	JACK RCA(WHITE) MTJ-032-11B-41 FE01
	JK1203	P000465490	JYRL010LY024	JACK RCA(RED) MTJ-032-11A-31 FE01
	JK1204	P000457070	JXEL040LY003	JACK S TYPE MDC-050V-2.4 LF(B110)
	JW103	P000465670	WX1E9700-002	FFC CABLE 8P FFC/P1.25/120

BOARD SENSOR

△	Location No.	TSB P/N	Reference No.	Description
	P4	P000465450	1VSA11699	BOARD SENSOR Consists of the following:
TRANSISTORS				
	Q503		NPWZT2046B12	PHOTO TRANSISTOR PT204-6B-12
	Q504		NPWZT2046B12	PHOTO TRANSISTOR PT204-6B-12

BOARD PSV

△	Location No.	TSB P/N	Reference No.	Description
△	P3	P000465050	1VSA14664	BOARD PSV Consists of the following:
				Consists of the following
			-----	BOARD POWER SUPPLY (PSV-A)
			-----	BOARD JUNCTION (PSV-B)
			-----	BOARD REAR JACK (PSV-C)

BOARD POWER SUPPLY

△	Location No.	TSB P/N	Reference No.	Description
			-----	BOARD POWER SUPPLY (PSV-A) Consists of the following:
CAPACITORS				
	C013		CE1JMASDL100	ELECTROLYTIC CAP. 10μF/50V M
	C014		CE1CMASDL471	ELECTROLYTIC CAP. 470μF/16V M
	C015		CE1CMASDL101	ELECTROLYTIC CAP. 100μF/16V M
	C017		CE0KMZADL472	ELECTROLYTIC CAP. 4700μF/6.3V SL
	C018		CE0KMASDL471	ELECTROLYTIC CAP. 470μF/6.3V M
	C020		CE1JMASDL220	ELECTROLYTIC CAP. 22μF/50V M
	C022		CE1GMASDL471	ELECTROLYTIC CAP. 470μF/35V M
△	C1001		CT2E683DC011	METALIZED FILM CAP. 0.068μF/250V K
	C1004		CA2H101S6016	ELECTROLYTIC CAP. 100μF/400V M
	C1005		CCD3AKPSL560	CERAMIC CAP. SL K 56pF/1KV
△	C1006		CCN2EMAOE222	SAFTY CAP. 2200pF/250V
	C1007		CE0KMASDL102	ELECTROLYTIC CAP. 1000μF/6.3V M
	C1013		CCA1JYT0B102	CERAMIC CAP.(AX) B J 1000pF/50V
	C1018		CE1AMASDL101	ELECTROLYTIC CAP. 100μF/10V M
	C1021		CCA1CMT0Y103	CERAMIC CAP.(AX) Y M 0.01μF/16V
	C1025		CHD1JK30B103	CHIP CERAMIC CAP.(1608) B K 0.01μF/50V
	C1029		CCA1CKT0X182	CERAMIC CAP.(AX) X K 1800pF/16V
	C1032		CE1CMASDL100	ELECTROLYTIC CAP. 10μF/16V M
	C1033		CCD1JZSYV223	CERAMIC CAP. YV Z 0.022μF/50V
	C1035		CE0KMZADL332	ELECTROLYTIC CAP. 3300μF/6.3V SL
	C1036		CCD2JKP0B471	CERAMIC CAP. B K 470pF/500V
	C1037		CE1CMASDL102	ELECTROLYTIC CAP. 1000μF/16V M
	C1039		CE1CMASDL471	ELECTROLYTIC CAP. 470μF/16V M
	C1106		CE1GMASDL101	ELECTROLYTIC CAP. 100μF/35V M
	C2014		CCD2JKP0B103	CERAMIC CAP. B K 0.01μF/500V
DIODES				
	D013		NDQZ000BA158	RECTIFIER DIODE BA158
	D014		NDQZ000SB190	SCHOTTKY BARRIER DIODE SB190
	D016		NDQZ000SB340	SCHOTTKY BARRIER DIODE SB340
	D017		QDTC00MTZJ15	ZENER DIODE MTZJT-7715C
	D018		NDQZ000BA158	RECTIFIER DIODE BA158
	D019		NDQZ000FR203	RECTIFIER DIODE FR203-B/P
	D1001		NDLZ001N5397	DIODE 1N5397-B
	D1002		NDLZ001N5397	DIODE 1N5397-B

△	Location No.	TSB P/N	Reference No.	Description
	D1003		NDLZ001N5397	DIODE 1N5397-B
	D1004		NDLZ001N5397	DIODE 1N5397-B
	D1006		QDTZ001SS133	SWITCHING DIODE 1SS133(T-77)
	D1008		NDQZ000SB140	SCHOTTKY BARRIER DIODE SB140
	D1011		NDQZ000BA159	RECTIFIER DIODE BA159
	D1012		QDTZ001SS133	SWITCHING DIODE 1SS133(T-77)
	D1016		NDWZ000FR101	RECTIFIER DIODE FR101
	D1017		QDTB00MTZJ18	ZENER DIODE MTZJT-7718B
	D1018		QDTZ001SS133	SWITCHING DIODE 1SS133(T-77)
	D1019		QDTB00MTZJ6R8	ZENER DIODE MTZJT-776.8B
	D1022		QDTZ001SS133	SWITCHING DIODE 1SS133(T-77)
	D1023		JW5.0T	BOARD JUMPER D0.6-P5.0
	D1024		QDTZ001SS133	SWITCHING DIODE 1SS133(T-77)
	D1025		QDTZ001SS133	SWITCHING DIODE 1SS133(T-77)
	D1030		NDWZ000SB240	SCHOTTKY BARRIER DIODE SB240-B/P
	D1031		NDQZ000SB390	SCHOTTKY BARRIER DIODE SB390
	D1032		NDQZ000SB340	SCHOTTKY BARRIER DIODE SB340
IC				
△	IC1001		NPEA000EL817	PHOTOCOUPLER EL817A
COILS				
	L010		LLBD00PKV022	CHOKE COIL 47μH
	L013		LLBD00PKV022	CHOKE COIL 47μH
	L1001		-----	BEAD CORE ASSEMBLY E9770ED
	L1001-1		JW20.0T	BOARD JUMPER D0.6-P20.0
	L1001-2		XL03010XM001	BEAD CORE B16 RH 3.5X10X1.3
	L1002		-----	BEAD CORE ASSEMBLY E9770ED
	L1002-1		JW20.0T	BOARD JUMPER D0.6-P20.0
	L1002-2		XL03010XM001	BEAD CORE B16 RH 3.5X10X1.3
△	L1003		LLBG00ZTU022	LINE FILTER 56MH TLF14CB5630R2
	L1004		XL03010XM001	BEAD CORE B16 RH 3.5X10X1.3
	L1005		-----	BEAD CORE ASSEMBLY E9770ED
	L1005-1		JW20.0T	BOARD JUMPER D0.6-P20.0
	L1005-2		XL03010XM001	BEAD CORE B16 RH 3.5X10X1.3
	L1011		LLBD00PKV022	CHOKE COIL 47μH
	L1013		LLC180KKV007	POWER INDUCTORS TWKBNP-180K
TRANSISTORS				
△	Q1001		QFWZ02SK3566	FET 2SK3566
	Q1003		QQSY2SC1815F	TRANSISTOR 2SC1815-Y(T-E2 F T)
	Q1004		NQSYKTA1267P	TRANSISTOR KTA1267-Y-AT/P
	Q1008		NQSYKTC3199P	TRANSISTOR KTC3199-Y-AT/P
RESISTORS				
	R057		RRXAJR5Z0224	CHIP RES. 1/10W J 220k Ω
	R1001		RCX2565FS001	CARBON RES. 1/2W K 5.6M Ω
	R1002		RCX4JATZ0564	CARBON RES. 1/4W J 560k Ω
	R1003		RCX4JATZ0564	CARBON RES. 1/4W J 560k Ω
	R1004		RN02JZLZ0823	METAL OXIDE FILM RES. 2W J 82k Ω
	R1005		RCX4JATZ0105	CARBON RES. 1/4W J 1M Ω
	R1006		RCX4JATZ0105	CARBON RES. 1/4W J 1M Ω
	R1007		RCX4JATZ0105	CARBON RES. 1/4W J 1M Ω
	R1008		RCX4GATZ0821	CARBON RES. 1/4W G 820 Ω
	R1010		RCX6JATZ0223	CARBON RES. 1/6W J 22k Ω
	R1011		RN01JZLZ01R3	METAL OXIDE FILM RES. 1W J 1.3 Ω

△	Location No.	TSB P/N	Reference No.	Description
	R1020		RCX6JATZ0182	CARBON RES. 1/6W J 1.8k Ω
	R1021		RRXAJR5Z0102	CHIP RES. 1/10W J 1k Ω
	R1022		RRXAJR5Z0472	CHIP RES. 1/10W J 4.7k Ω
	R1023		RRXAFR5H0222	CHIP RES.(1608) 1/10W F 2.2k Ω
	R1024		RRXAJR5Z0683	CHIP RES. 1/10W J 68k Ω
	R1025		RRXAFR5H0562	CHIP RES. 1/10W F 5.6k Ω
	R1029		RCX6JATZ0104	CARBON RES. 1/6W J 100k Ω
	R1032		RCX6JATZ0222	CARBON RES. 1/6W J 2.2k Ω
	R1035		RCX6JATZ0102	CARBON RES. 1/6W J 1k Ω
	R1036		RCX6JATZ0104	CARBON RES. 1/6W J 100k Ω
	R1037		RCX6JATZ0103	CARBON RES. 1/6W J 10k Ω
	R1038		RCX6JATZ0104	CARBON RES. 1/6W J 100k Ω
	R1039		RCX6JATZ0474	CARBON RES. 1/6W J 470k Ω
	R1040		RCX4JATZ08R2	CARBON RES. 1/4W J 8.2 Ω
	R1041		RCX4JATZ05R6	CARBON RES. 1/4W J 5.6 Ω
	R1043		RN012R7ZU001	METAL OXIDE FILM RES. 1W J 2.7 Ω
	R1059		RCX4JATZ0102	CARBON RES. 1/4W J 1k Ω
	R1126		RRXAJR5Z0333	CHIP RES. 1/10W J 33k Ω
MISCELLANEOUS				
	2B18	P000468060	1VM420987	HEAT SINK E6800ED
	2L019		GBJS3080	SCREW S-TIGHT M3X8 BIND HEAD+
△	AC1001	P000468380	WAE0172LW011	POWER CORD PE8G2CG9G0AB05
△	F1001	P000459950	PAGC20BW3162	FUSE T1.6AL/250V
	FH1001		XH01Z00LY002	FUSE HOLDER MSF-015 LF (B110)
	FH1002		XH01Z00LY002	FUSE HOLDER MSF-015 LF (B110)
△	SA1001	P000457210	NVQZ10D471KB	SURGE ABSORBER 470V+-10PER
△	T0011	P000465550	LTTZPE0KT007	TRANS POWER 6711

BOARD JUNCTION

△	Location No.	TSB P/N	Reference No.	Description
			-----	BOARD JUNCTION (PSV-B) Consists of the following:
CONNECTOR				
	CN051A	P000465480	JCTUB19TG002	242 SERIES CONNECTOR TUC-P19X-B1 WHT ST
MISCELLANEOUS				
	JW1001	P000465680	WX1E9700-003	FLAT CABLE 10P AWG26#2651/P2.0/100
	JW1002	P000465690	WX1E9700-004	FLAT CABLE 9P AWG26#2651/P2.0/100

BOARD REAR JACK

△	Location No.	TSB P/N	Reference No.	Description
			-----	BOARD REAR JACK (PSV-C) Consists of the following:
CAPACITORS				
	C2003		CHD1JK30B222	CHIP CERAMIC CAP. B K 2200pF/50V
	C2004		CHD1JK30B222	CHIP CERAMIC CAP. B K 2200pF/50V
	C2005		CHD1JK30B222	CHIP CERAMIC CAP. B K 2200pF/50V
	C2006		CHD1JK30B222	CHIP CERAMIC CAP. B K 2200pF/50V
	C2007		CHD1JK30B222	CHIP CERAMIC CAP. B K 2200pF/50V
	C2008		CHD1JK30B222	CHIP CERAMIC CAP. B K 2200pF/50V
	C2008		CHD1JK30B222	CHIP CERAMIC CAP. B K 2200pF/50V
	C2009		CE1JMASDL1R0	ELECTROLYTIC CAP. 1μF/50V M
	C2010		CE1JMASDL1R0	ELECTROLYTIC CAP. 1μF/50V M
	C2011		CHD1JK30B102	CHIP CERAMIC CAP. B K 1000pF/50V

△	Location No.	TSB P/N	Reference No.	Description
	C2012		CE1JMASDL1R0	ELECTROLYTIC CAP. 1μF/50V M
	C2013		CHD1JK30B102	CHIP CERAMIC CAP. B K 1000pF/50V
DIODES				
	D2001		QDTA00MTZJ11	ZENER DIODE MTZJT-7711A
	D2002		QDTA00MTZJ11	ZENER DIODE MTZJT-7711A
	D2003		QDTA00MTZJ11	ZENER DIODE MTZJT-7711A
	D2004		QDTA00MTZJ11	ZENER DIODE MTZJT-7711A
	D2005		QDTA00MTZJ11	ZENER DIODE MTZJT-7711A
	D2006		QDTA00MTZJ11	ZENER DIODE MTZJT-7711A
	D2007		QDTA00MTZJ11	ZENER DIODE MTZJT-7711A
	D2008		QDTA00MTZJ11	ZENER DIODE MTZJT-7711A
	D2009		QDTA00MTZJ11	ZENER DIODE MTZJT-7711A
	D2010		QDTA00MTZJ11	ZENER DIODE MTZJT-7711A
COILS				
	L2001		-----	BEAD CORE ASSEMBLY E9770ED
	L2001-1		JW35.0T	PCB JUMPER D0.6-P35.0
	L2001-2		XL03010XM001	BEAD CORE B16 RH 3.5X10X1.3
TRANSISTORS				
	Q2002		NQSYKTC3199P	TRANSISTOR KTC3199-Y-AT/P
	Q2003		NQSYKTC3199P	TRANSISTOR KTC3199-Y-AT/P
RESISTORS				
	R2003		RCX4JATZ0750	CARBON RES. 1/4W J 75 Ω
	R2004		RRXAJR5Z0750	CHIP RES. 1/10W J 75 Ω
	R2005		RCX4JATZ0821	CARBON RES. 1/4W J 820 Ω
	R2006		RCX4JATZ0221	CARBON RES. 1/4W J 220 Ω
	R2007		RCX4JATZ0821	CARBON RES. 1/4W J 820 Ω
	R2008		RCX4JATZ0221	CARBON RES. 1/4W J 220 Ω
	R2009		RRXAJR5Z0750	CHIP RES. 1/10W J 75 Ω
	R2010		RRXAJR5Z0750	CHIP RES. 1/10W J 75 Ω
	R2011		RRXAJR5Z0750	CHIP RES. 1/10W J 75 Ω
	R2012		RRXAJR5Z0102	CHIP RES. 1/10W J 1k Ω
	R2013		RRXAJR5Z0102	CHIP RES. 1/10W J 1k Ω
MISCELLANEOUS				
	2B60		1VM423185	21P PLATE EARTH E7B20ED
	JK2001	P000459840	JXGL210LY006	RGB CONNECTOR MRC-021V-03 ABS(B11
	JW2001	P000465720	WX1E9B00-005	FLAT CABLE 14P AWG26#2651/P2.0/85

BOARD AFV

△	Location No.	TSB P/N	Reference No.	Description
	P5	P000465120	1VSA14516	BOARD AFV Consists of the following:
CAPACITORS				
	C1		CHD1JZ30F104	CHIP CERAMIC CAP.(1608) F Z 0.1μF/50V
	C4		CHD1JJ3CH560	CHIP CERAMIC CAP. CH J 56pF/50V
	C5		CHD1JJ3CH220	CHIP CERAMIC CAP.(1608) CH J 22pF/50V
	C6		CHD1JJ3CH560	CHIP CERAMIC CAP. CH J 56pF/50V
	C7		CHD1JC3CH3R0	CHIP CERAMIC CAP. CH C 3pF/50V
	C8		CHD1JC3CH3R0	CHIP CERAMIC CAP. CH C 3pF/50V
	C11		CHD1JK30B103	CHIP CERAMIC CAP.(1608) B K 0.01μF/50V
	C12		CE1CMASSL100	ELECTROLYTIC CAP. 10μF/16V M H7
	C13		CHD1JK30B103	CHIP CERAMIC CAP.(1608) B K 0.01μF/50V
	C14		CHD1JK30B103	CHIP CERAMIC CAP.(1608) B K 0.01μF/50V
	C15		CE1CMASSL100	ELECTROLYTIC CAP. 10μF/16V M H7

△	Location No.	TSB P/N	Reference No.	Description
	C16		CE1CMASL100	ELECTROLYTIC CAP. 10 μ F/16V M H7
	C17		CHD1JZ30F104	CHIP CERAMIC CAP.(1608) F Z 0.1 μ F/50V
	C19		CHD1JZ30F104	CHIP CERAMIC CAP.(1608) F Z 0.1 μ F/50V
	C20		CE1JMASL3R3	ELECTROLYTIC CAP. 3.3 μ F/50V M H7
	C21		CHD1JZ30F104	CHIP CERAMIC CAP.(1608) F Z 0.1 μ F/50V
	C22		CE1CMASL100	ELECTROLYTIC CAP. 10 μ F/16V M H7
	C23		CHD1AZ30F474	CHIP CERAMIC CAP. F Z 0.47 μ F/10V
	C24		CE1JMASLR22	ELECTROLYTIC CAP. 0.22 μ F/50V M H7
	C27		CCA1JZTFZ104	CERAMIC CAP.(AX) F Z 0.1 μ F/50V
CONNECTOR				
	CN1		JTED009ER045	ANGLE PIN HEADER 9P IMSA-6029B-1-09Z003-
DIODE				
	D2		QDTZ001SS133	SWITCHING DIODE 1SS133(T-77)
IC				
	IC1	P000459920	NSZBA0SP3005	IC AUDIO PROCESSOR MSP3417G-QG-B8-V3
COILS				
	L1		LLAXKATTU100	INDUCTOR 10 μ H-K-26T
	L2		JW5.0T	BOARD JUMPER D0.6-P5.0
	L3		LLAXKATTU180	INDUCTOR 18 μ H-K-26T
	L4		LLAXKATTU100	INDUCTOR 10 μ H-K-26T
RESISTORS				
	R1		RRXAJR5Z0102	CHIP RES. 1/10W J 1k Ω
	R2		RRXAZR5Z0000	CHIP RES.(1608) 1/10W 0 Ω
	R4		RRXAJR5Z0124	CHIP RES. 1/10W J 120k Ω
	R5		RRXAZR5Z0000	CHIP RES.(1608) 1/10W 0 Ω
	R6		RRXAZR5Z0000	CHIP RES.(1608) 1/10W 0 Ω
	R7		RRXAJR5Z0122	CHIP RES. 1/10W J 1.2k Ω
MISCELLANEOUS				
	X01	P000468230	FXD186LLN001	XTAL 18.432MHz