

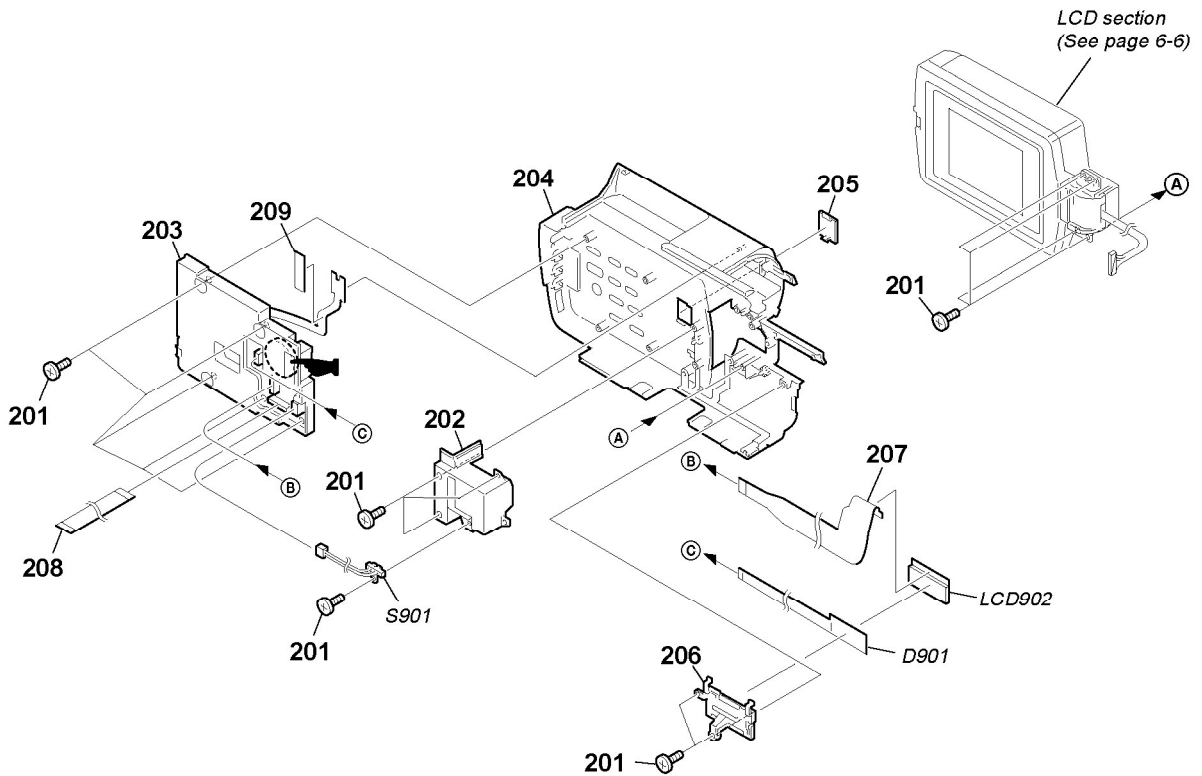

6-1-5. CABINET (R) SECTION



 : BT001 (Lithium battery) CF-1000 on the mount position. (See page 4-27)
The printed wiring board of the Control switch block (CF-1000) on which lithium battery is mounted, is not shown.]

Ref. No.	Part No.	Description	Remarks	Ref. No.	Part No.	Description	Remarks
201	3-948-339-61	TAPPING		207	1-680-201-11	FP-260 FLEXIBLE BOARD	
202	3-065-436-01	BLIND (12), HINGE		208	1-757-397-21	CABLE, FLEXIBLE FLAT (FFC-295)	
203	1-476-425-21	SWITCH BLOCK, CONTROL (CF-1000)		209	3-941-343-21	TAPE (A)	
204	X-3951-223-1	CABINFT R (12) ASSY		▲ D901	1-518-724-11	FI FMFNT, FI FCTRO I UMINOUS	
205	3-059-539-11	LID (103P), CPC		LCD902	1-804-272-11	DISPLAY PANEL, LIQUID CRYSTAL	
206	3-065-451-01	HOLDER (12), LCD		S901	1-771-848-11	SWITCH, PUSH	

Note :
The components identified by mark ▲ or dotted line with mark ▲ are critical for safety. Replace only with part number specified.

Note :
Les composants identifiés par une marque ▲ sont critiques pour la sécurité. Ne les remplacer que par une pièce portant le numéro spécifié.