

7. Exploded Views and Parts List

7-1 Exploded Views

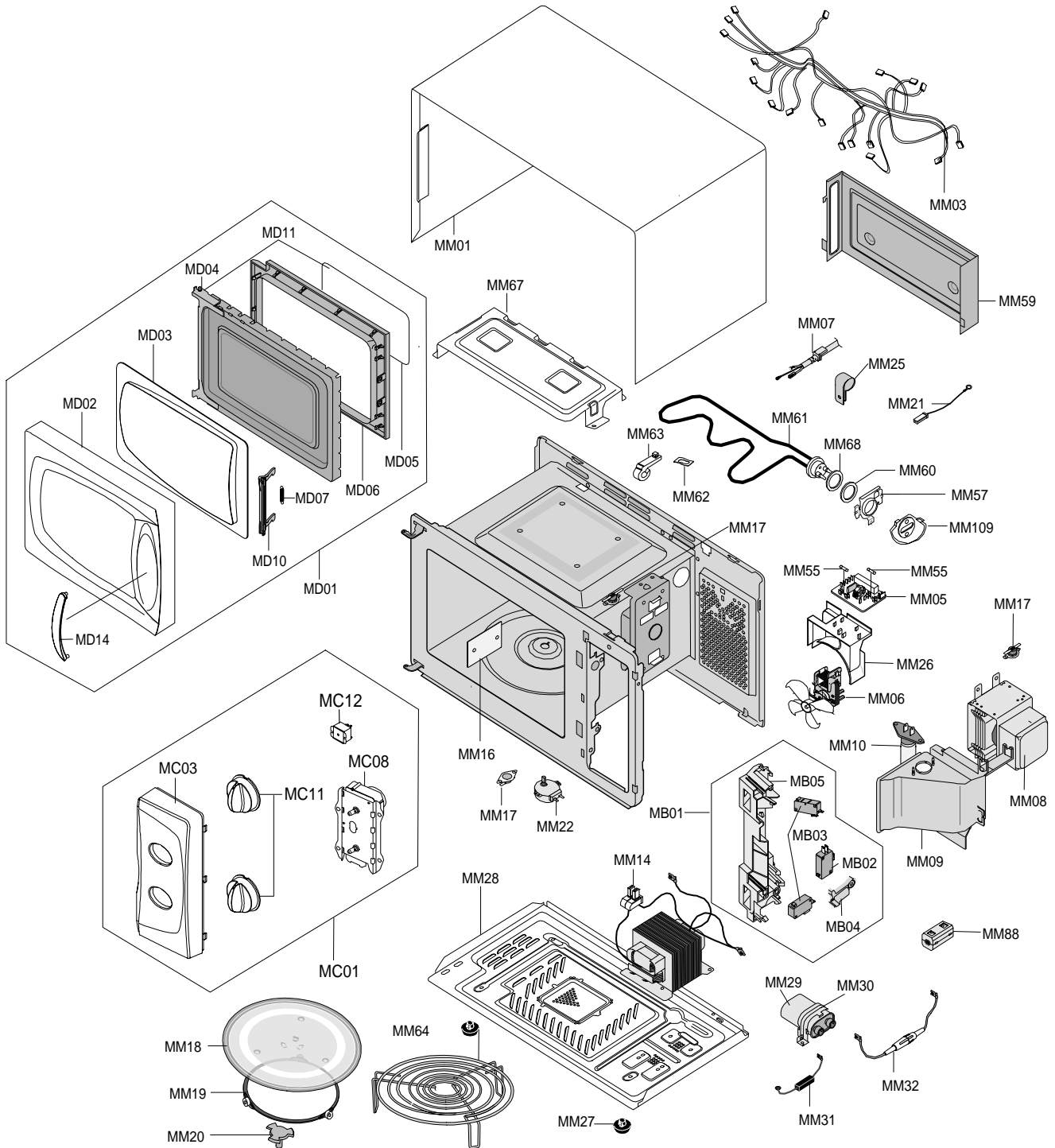

7-2 Main Parts List

No.	Code No.	Description	Specification	Q'ty	Remark
MB01	DE96-00120B	ASSY BODY LATCH	M1717N,NC2000(HANDLE)	1	
MB02	3405-000175	SWITCH-MICRO	250V,15A,200gf,SPST-NO	1	
MB03	3405-000178	SWITCH-MICRO	250V,15A,200gf,SPST-NO	2	
MB041	DE66-00093A	LEVER-SWITCH(A)	NC2000,PP-TH53,-,-,-,N	1	
MB042	DE66-00094A	LEVER-SWITCH(B)	NC2000,PP-TH53,-,-,-,N	1	
MB05	DE72-00137A	BODY-LATCH	NC2000(0.6/0.8/1.2),PP,-,-,-,	1	
MM01	DE70-00184P	PANEL-OUTER	MW850WA,C/STEEL,T0.5,-,-,-,P	1	
MM03	DE39-00037B	WIRE HARNESS-A	CE2713N,-,-,-,-,-,-,-,-	1	
MM05	DE96-00008D	ASSY NOISE FILTER	SN-3WEB(12),250V12A,EU	1	
MM06	DE96-00031A	ASSY-MOTOR FAN	SMF-3RDEA,230V50HZ,2400RP	1	
MM07	DE39-20058L	ASSY POWER CORD	CE2713/XEF,1.5SQ,230V50H	1	
MM08	OM75P(31)ERH	ASSY-MAGNETRON	OM75P(31)ERH	1	
MM09	DE71-60457B	COVER-AIR	3RD-0.7(BTM),PP,-,-,-,-,-	1	
MM10	4713-001046	LAMP-INCANDESCENT	240V,104mA,25W,ORG,-,-	1	CV/AIR
MM109	DE74-80062A	STOPPER-HEATER	3RD-W,SECC,T0.8xW70xL70,-	1	
MM14	DE26-00080A	TRANS-H.V	SHV-EURO2,230V,50HZ,2340V/3.3V	1	
MM16	DE71-00159A	COVER-CEILING	CN2835,MICA SHEET,T0.3,W11	1	
MM17	DE47-00002B	THERMOSTAT	PW2N,-,-,100,110,-,-,-,187H,3	1	GRL-TCO
MM17	DE47-20009A	THERMOSTAT	PW2N-520PB,160/60,250V/7.5A,H	1	MG-TCO
MM17	DE47-20010A	THERMOSTAT	PW-2N(120/60)187Y,250V7.5A,12	1	CAV-TCO
MM18	DE74-20102D	TRAY-COOKING	GLASS,T6,-,-,890g	1	
MM19	DE97-00193B	ASSY-GUIDE ROLLER	NC2000 0.6,T2*P1198(14	1	
MM20	DE67-00140A	COUPLER	NC2000(0.6~0.8),PPS(ESS840),-,3G	1	
MM21	DE39-40409A	WIRE HARNESS-E	230V50HZ,M9G45,CTW,-,-,-	1	H/EART
MM22	DE31-10154A	MOTOR-SYNCHRONOUS	M2HJ49ZR02,ST-16,50/60	1	
MM25	DE65-20014A	CABLE CLAMP	-,-,-,NY-66,-,DA-6N	1	P-CORD
MM26	DE71-00148A	COVER-BLOWER	MW850WA,PP,T1.5,-,-,-,NTR,N	1	
MM27	DE61-40066A	FOOT	-,PP,-,BLK,-,-,-	2	
MM28	DE80-00023A	BASE-PLATE	MW850WA,SGCC1,T0.6,-,-,-,NC2000	1	
MM29	2501-001016	C-OIL	950nF,2.1KV,BK,35x54x80,20mm	1	
MM30	DE61-00139A	BRACKET-HVC	NC2000,SECC,T0.8,-,-,-,0.6/0	1	
MM31	DE59-00002A	DIODE-H.V	ESJC13-12B,12KV,-,-,-,MWO ALL,	1	
MM32	DE91-70061B	ASSY-H.V.FUSE	THV060T-0750-H,5KV/0.75A,R	1	
MM55	3601-001019	FUSE-CARTRIDGE	250V,12A,SLOW-BLOW,CERAMI	1	
MM55	3601-001126	FUSE-CARTRIDGE	250V,1.6A,FAST-ACTING,CER	1	
MM57	DE61-50576A	BRACKET-HEATER	-,STS430,T0.5,W70,L70,-,-	1	
MM59	DE71-60451A	COVER-BACK	3RD-0.7,SECC,T0.5,W115,L332,-	1	
MM60	DE63-20017A	GASKET-HEATER	-,BRASS,T1.5,OD30.5,ID22.5	1	
MM61	DE47-00004A	HEATER-GRILL	SHG-2733E,-,-,1100W(1080W),	1	
MM62	DE61-70060A	SPRING-PLATE	-,SK-5,T0.5,T0.5,-,-,-,-,-	1	
MM63	DE61-30008A	SUPPORT-HEATER	ALUMINA,-,T12,CE745G,-,	1	
MM64	DE74-70071D	RACK-WIRE	MSWR10,PI3,0.7/NC2000,D230,H85	1	
MM67	DE61-00143A	BRACKET-UPPER	MW850WA,SECC,T0.5,-,-,-,NC	1	
MM68	6031-001424	WASHER-PLAIN	PTFE,-,ID22.2,OD28,T1.7,WHT	1	
MM88	DE73-90027B	FERRITE	RU65(RU15*28.6*6.5),-,M2L(Fe2O3+	1	

7-3 Control & Door Parts List

No.	Code No.	Description	Specification	Q'ty	Remark
MC01	-	ASSY CONTROL-BOX	230V50HZ,CE281DN,PURE-W	1	S.N.A
MC03	DE64-00498C	CONTROL-PANEL(D)	CE281DN,ABS(HG0760),-,	1	
MC08	DE45-00003A	TIMER	TMFK60M1A1,-,-,-,-,-,310 GRILL	1	
MC11	DE64-00507A	KNOB-TIMER(D)	M181DN,ABS(HG0760),-,,-,-	2	TIMER&POWER
MD01	DE94-00723E	ASSY DOOR	CE281DN,PURE-WHT,TDS+SAMSUNG,H	1	
MD02	DE64-00494A	DOOR-A	M181DN,ABS(HG0760),-,,-,-,W9501,	1	
MD03	DE64-00496A	SCREEN-DOOR	M181DN,SAN(CR5381),-,,-,-,G	1	
MD04	DE94-00351B	ASSY DOOR-E(COATING)	MW850WA,BLK-COATING	1	
MD05	DE64-00221D	FILM-DOOR	-,T0.15,W264*L143,-,-,-,NC08	1	
MD06	DE64-40008B	DOOR-C	-,PP,CE745G,-,-,-,BLK,-	1	
MD07	DE61-00198A	SPRING-KEY	M1877,HSWR,D6,-,-,-,23 1/4,23 1	1	
MD08	DE61-00299A	HINGE-DOOR	RE-C21,SCP1,T2.0,-,-,-,-,NC20	1	
MD10	DE64-00211A	DOOR-KEY	NC2000(0.6/0.8/1.2),PP,-,BLK,-,	1	
MD14	DE64-00504A	HANDLE-DOOR	M181DN,ABS(HG0760),-,,-,-,W	1	

S.N.A : SERVICE NOT ASSEMBLY

7-4 Standard Parts List

Code No.	Description	Specification	Q'ty	Remark
DE60-30016A	NUT-FLANGE	M4,MSWR10,-,-,-,-,-,-,-,-	2	F-MOTOR
DE60-10082H	SCREW-A	-,-,-,-,2S-4X12,TOOTHED,-,-,-,-	4	OUT-PANEL
DE60-10018A	SCREW-ASSY MACHINE	-,-,WS,MSWR10,SN1,PH,M4X0.7P,-,-,8,-,-	2	BKT-HEATER
DE60-10098A	SCREW-ASSY TAP TITE	-,-,GLD,SWRCH18A,ZPC2,PH,TC,-,M4X8,WT,-	1	BOTT-TCO
DE60-10098A	SCREW-ASSY TAP TITE	-,-,GLD,SWRCH18A,ZPC2,PH,TC,-,M4X8,WT,-	1	CVT-TCO
DE60-10098A	SCREW-ASSY TAP TITE	-,-,GLD,SWRCH18A,ZPC2,PH,TC,-,M4X8,WT,-	1	D-MOTOR
DE60-10098A	SCREW-ASSY TAP TITE	-,-,GLD,SWRCH18A,ZPC2,PH,TC,-,M4X8,WT,-	2	MGT-TCO
DE60-10098A	SCREW-ASSY TAP TITE	-,-,GLD,SWRCH18A,ZPC2,PH,TC,-,M4X8,WT,-	1	-
DE60-10195A	SCREW-STAR POLE	-,-,SWCH18A,4,12,TH,*,-,2,ZNC,-	2	C-BACK
DE60-10063A	SCREW-TAP TH	-,-,FEFN,-,TH,M4,-,L12,-,-	1	P/OUTER
DE60-10070A	SCREW-TAP TH	-,-,FEFZY,2-SLOT,TH,M4,-,L12,-,-	2	B-LATCH
DE60-10070A	SCREW-TAP TH	-,-,FEFZY,2-SLOT,TH,M4,-,L12,-,-	3	B-PLATE
DE60-10070A	SCREW-TAP TH	-,-,FEFZY,2-SLOT,TH,M4,-,L12,-,-	1	BKT-UPPER
DE60-10070A	SCREW-TAP TH	-,-,FEFZY,2-SLOT,TH,M4,-,L12,-,-	1	C-BLOWER
DE60-10070A	SCREW-TAP TH	-,-,FEFZY,2-SLOT,TH,M4,-,L12,-,-	1	CON-BOX
DE60-10070A	SCREW-TAP TH	-,-,FEFZY,2-SLOT,TH,M4,-,L12,-,-	1	COVER-AIR
DE60-10069A	SCREW-TAP TH	-,-,FRFZY,-,TH,M4,-,L10,-,-	2	-
DE60-10069A	SCREW-TAP TH	-,-,FRFZY,-,TH,M4,-,L10,-,-	1	RELAY
DE60-10072A	SCREW-TAP TH	-,-,FEFZY,2-SLOT,TH,M4,-,L16,-,-	4	-
DE60-10012A	SCREW-TAP TITE	-,-,SWR10,M4,L10,TH,+,-,3,ZPC2,-	1	N/FILTER
DE60-10012A	SCREW-TAP TITE	-,-,SWR10,M4,L10,TH,+,-,3,ZPC2,-	1	P-CORD
DE60-10012A	SCREW-TAP TITE	-,-,SWR10,M4,L10,TH,+,-,3,ZPC2,-	1	B/COVER
DE60-10080B	SCREW-WASHER	-,-,2S,SWRCH18A,ZP2,PH,PI5,-,L10,-,-	4	HVT
DE60-10080B	SCREW-WASHER	-,-,2S,SWRCH18A,ZP2,PH,PI5,-,L10,-,-	4	MGT