

This chapter gives you the FRU (Field Replaceable Unit) listing in global configurations of AT1945 & AT1946. Refer to this chapter whenever ordering for parts to repair or for RMA (Return Merchandise Authorization).

**NOTE:** Please note WHEN ORDERING FRU PARTS, that you should check the most up-to-date information available on your regional web or channel (<http://aicsl.acer.com.tw/spl/>). For whatever reasons a part number change is made, it will not be noted in the printed Service Guide. For ACER AUTHORIZED SERVICE PROVIDERS, your Acer office may have a DIFFERENT part number code from those given in the FRU list of this printed Service Guide. You MUST use the local FRU list provided by your regional Acer office to order FRU parts for repair and service of customer machines.

**NOTE:** To scrap or to return the defective parts, you should follow the local government ordinance or regulations on how to dispose it properly, or follow the rules set by your regional Acer office on how to return it.

# Exploded Diagram (Model: AT1945 & AT1946)

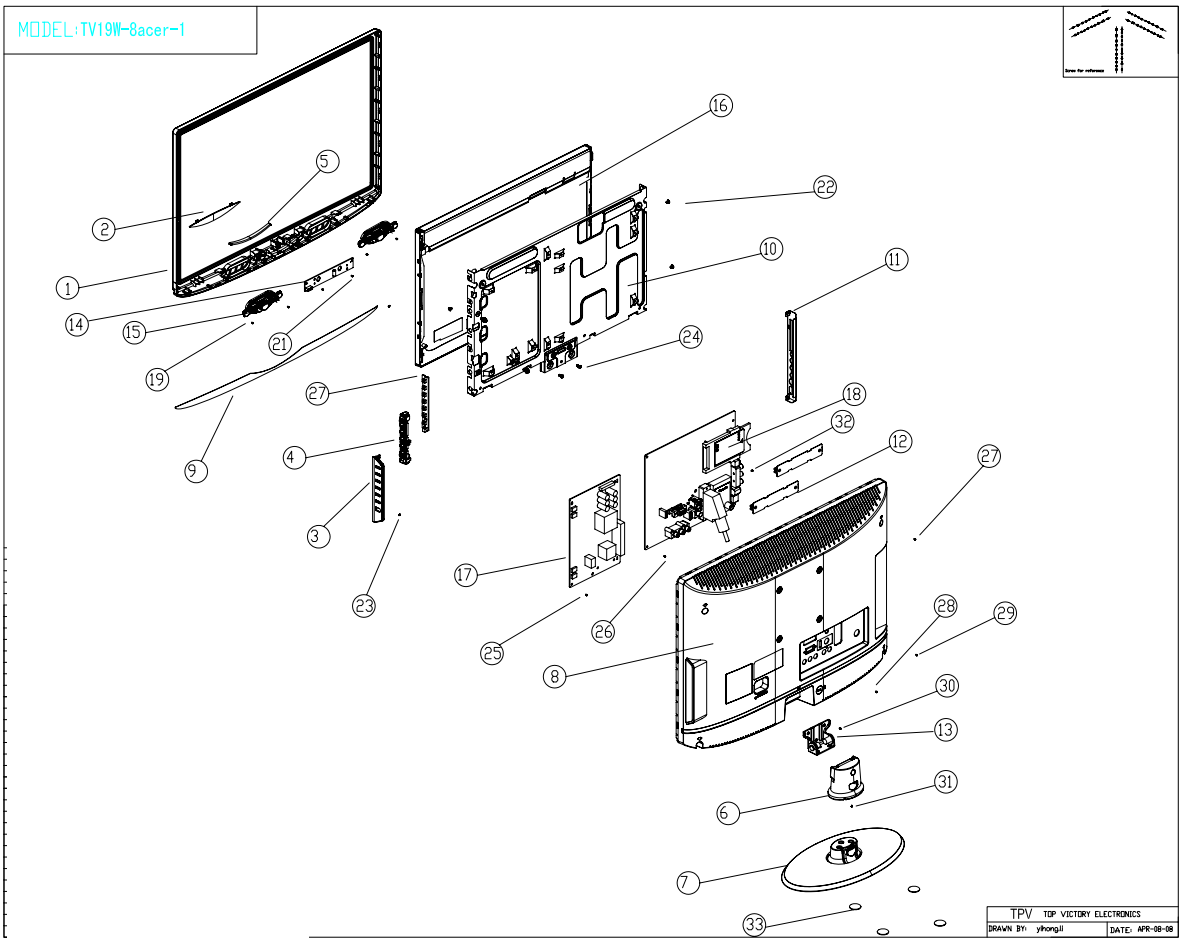

item	DESCRIPTION	item	DESCRIPTION
1	BEZEL	18	MAIN BOARD PCB
2	DECO-ACER	19	SCREW
3	COVER_FUNC-ACER19	20	SCREW
4	BUTTON_FUNC	21	SCREW
5	LED_LENS-ACER	22	SCREW
6	STAND	23	SCREW
7	BASE_S1	24	SCREW
8	REAR COVER 19	25	SCREW
9	Q36T 806 1	26	SCREW
10	MAIN FRAME	27	SCREW
11	BKT SIDE EU	28	SCREW
12	VESA BKT	29	SCREW
13	HINGE ASS'Y	30	SCREW
14	IR BOARD PCB	31	SCREW
15	SPEAKER	32	SCREW
16	PANEL	33	RUBBER WASHER
17	POWER BOARD PCB		