

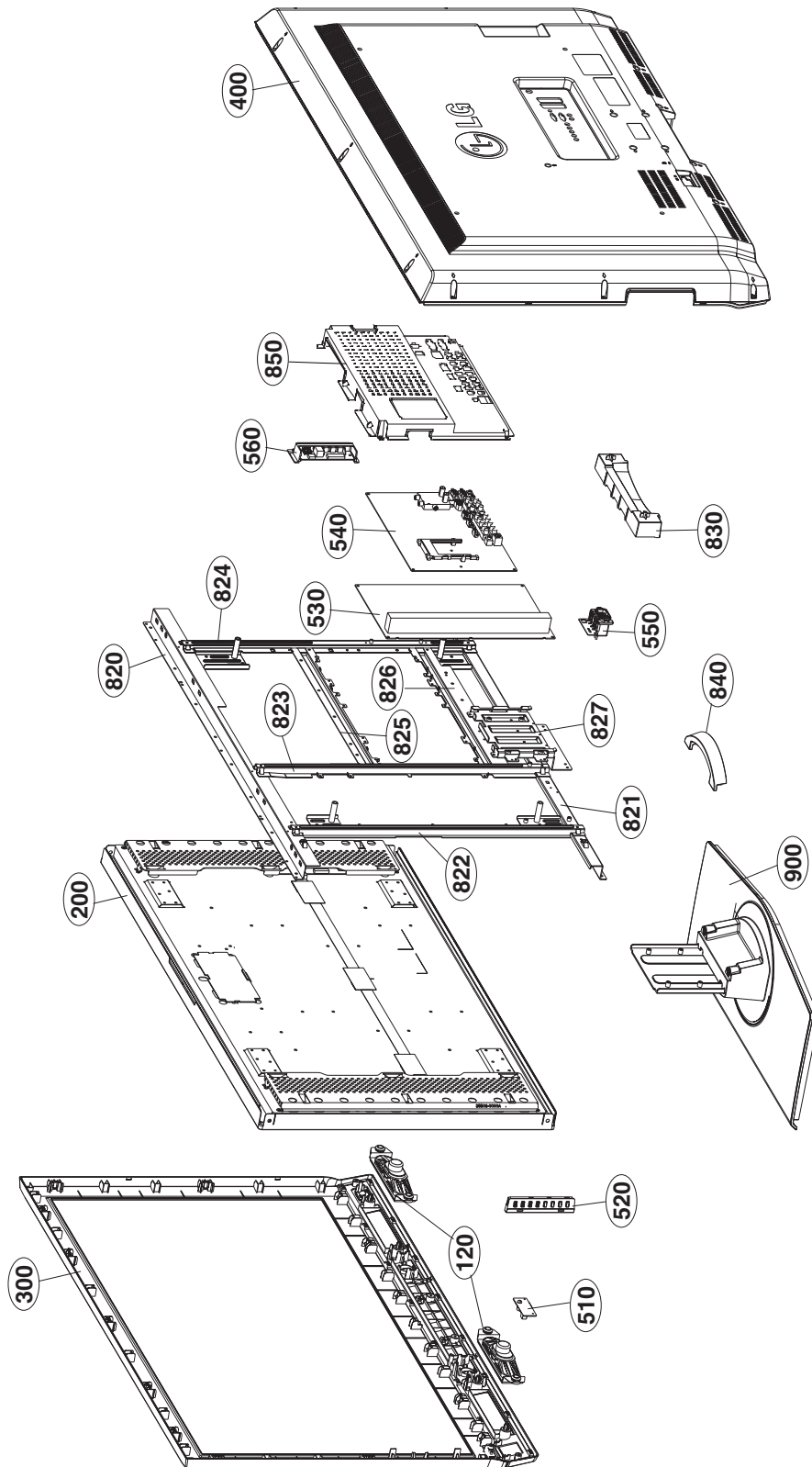





# EXPLODED VIEW



## EXPLODED VIEW PARTS LIST

No.	PART NO.	DESCRIPTION
	120	EAB33775101 Speaker,Full Range, EN1562C-6712 ND 10W 8OHM 82DB 100HZ 193.5 X 42 X 39.9 LUG KOREA TOPTONE
	200	EAJ36547901 LCD,Module-TFT, LC420WX6-SLA2 WXGA 42INCH 1366X768 500CD COLOR 72% 16/9 1000:1(DCR 5000:1) 5ms(GTG),Zero RT Pol. 10000K LG PHILIPS LCD
	300	ABJ32403526 Cabinet Assembly, 42LC51/55/7R/7D-ZA H4&EuroPass3 42" CABINET ASSY for LGEWR LOCAL PHANTOM
	400	ACQ32247927 Cover Assembly, 42LC7R/55/LF65-ZA LD73A-PHANTOM 42" BACK COVER ASSY_42" EUROPASS3_NON_DVR_TORNADO_LOCAL_LGEWR
	510	EBR35734601 PCB Assembly,Sub, SUB T.T LD73A 42LC7D-ZA AEUVLHX IR/LED TOTAL
	520	EBR34778401 PCB Assembly,Sub, SUB T.T LD73A 37LC4D-ZN AEULLHX CONTROL TOTAL
	530	EAY34797001 Power Supply Assembly, Tornado 42inch 42INCH Tornado 42inch LCD LGIT LCD Tornado 42inch (Power+Inverter), PSU LG INNOTEK.,LTD.
	540	EBR37029703 PCB Assembly,Main, MAIN1 T.T LD73A 42LC7D SEUVLJG Without-Tuner MAIN TOTAL
	550	EAM35501401 Filter,AC Line, IF3-N06CEWL1 5.3mH 250VAC 6A 0.22uF 1000pF UL/CSA/VDE/K HOUSING/RING BK DONG IL TECHNOLOGY LTD.
	560	EBR34778601 PCB Assembly,Sub, SUB T.T LD73A 37LC4D-ZN AEULLHX SIDE A/V TOTAL
	820	MGJ32902301 Plate, PRESS EGI 1.2 FRAME SBHG-A 42LY3 METAL BAR TOP FOR LPL MODULE
	821	MGJ32902405 Plate, PRESS EGI 1.6 FRAME SBHG-A 42LC7 METAL BAR BOTTOM ('c')CE pem-nut 'NO') FOR LPL MODULE
	822	MJH34248201 Supporter, PRESS EGI 1.2 GUIDE EGI METAL BAR LEFT FOR V668 MODULE
	823	MGJ32902704 Plate, PRESS EGI 1.2 FRAME SBHG-A 42LC4 METAL BAR CENTER('c')CE pem nut 'NO') V668 module
	824	MGJ32902502 Plate, PRESS EGI 1.2 FRAME SBHG-A 42LC4 METAL BAR RIGHT
	825	MGJ32902803 Plate, PRESS EGI 1.2 FRAME SBHG-A METAL BAR SIDE TOP FOR Europass3
	826	MGJ32902903 Plate, PRESS EGI 1.2 FRAME SBHG-A METAL BAR SIDE BOTTOM FOR Europass3
	827	MJH34000501 Supporter, PRESS EGI 2 GUIDE EGI 42LC4 METAL STAND SUPPORTER
	830	MAZ34241801 Bracket, MOLD HIPS 405AF STAND 42LC5/7 - HIPS 405AF GUIDE
	840	MCK32929601 Cover, MOLD ABS HF-380 42LC4 ABS, HF-380 CABLE MANAGEMENT
	850	MJH32521105 Supporter, PRESS EGI 0.5t GUIDE EGI METAL, REAR SHIELD (37LC4D-ZA),C/SKD
	900	AAN32937105 Base Assembly, STAND 42LC41-ZA LP78A STAND ASSY_NO PRINT_PHANTOM(LGEWR)

# REPLACEMENT PARTS LIST

DATE: 2007. 08. 14.

LOC. NO.	PART NO.	DESCRIPTION / SPECIFICATION	LOC. NO.	PART NO.	DESCRIPTION / SPECIFICATION
<b>ACCESSORY</b>					
A1	MFL34441603	"Manual,Owners" PRINTING USER LD61C LG	C1344	0CE106WH6DC	"Capacitor,AL,Chip" MVK5.0TP25VC10M 10uF 2
A2	MKJ39170804	Remote Controller COMPLEX LD73A 26LC4 EU	C1345	0CE106WH6DC	"Capacitor,AL,Chip" MVK5.0TP25VC10M 10uF 2
A21	3550V00590A	Cover MOLD ABS 50PC3DD-UE.AU	C1345	0CE106WH6DC	"Capacitor,AL,Chip" MVK5.0TP25VC10M 10uF 2
A3	6410TEW010A	Power Cord "CEE,LP-34A&H05VV-FX3C,"	C1350	0CE106WFKDC	"Capacitor,AL,Chip" MVK4.0TP16VC10M 10uF 2
A4	341-746B	Holder MOLD ABS CABLE Holder	C1350	0CE106WFKDC	"Capacitor,AL,Chip" MVK4.0TP16VC10M 10uF 2
A5	EBY36717302	Circuit Diagram DIAGRAM LD73A ITALIAN-Only EU	C1400	0CE475WK6DC	"Capacitor,AL,Chip" MVK5.0TP50VC4.7M 4.7uF
A6	MES36332301	Indicator MOLD ABS LED&PRE AMP 4	C1400	0CE475WK6DC	"Capacitor,AL,Chip" MVK5.0TP50VC4.7M 4.7uF
A7	MGJ38662602	"Plate,Shield" PRESS SAZCC 0.6 SHIELD	C1401	0CE475WK6DC	"Capacitor,AL,Chip" MVK5.0TP50VC4.7M 4.7uF
A8	SAC30033609	Title 26LC45-ZA42PC55-ZB CD	C1401	0CE475WK6DC	"Capacitor,AL,Chip" MVK5.0TP50VC4.7M 4.7uF
<b>CAPACITORS</b>					
C101	0CE476VF6DC	"Capacitor,AL,Chip" VGV476M016S0ANE010 47u	C1407	0CE226WF6DC	"Capacitor,AL,Chip" MVK5.0TP16VC22M 22uF 2
C102	0CE106WFKDC	"Capacitor,AL,Chip" MVK4.0TP16VC10M 10uF 2	C1407	0CE226WF6DC	"Capacitor,AL,Chip" MVK5.0TP16VC22M 22uF 2
C102	0CE106WFKDC	"Capacitor,AL,Chip" MVK4.0TP16VC10M 10uF 2	C1408	0CE107WF6DC	"Capacitor,AL,Chip" MVK6.3TP16VC100M 100uF
C102	0CE476VF6DC	"Capacitor,AL,Chip" VGV476M016S0ANE010 47u	C1408	0CE107WF6DC	"Capacitor,AL,Chip" MVK6.3TP16VC100M 100uF
C103	0CE476VF6DC	"Capacitor,AL,Chip" VGV476M016S0ANE010 47u	C1410	0CE476WF6DC	"Capacitor,AL,Chip" MVK6.3TP16VC47M 47uF 2
C1068	0CE107WF6DC	"Capacitor,AL,Chip" MVK6.3TP16VC100M 100uF	C1410	0CE476WF6DC	"Capacitor,AL,Chip" MVK6.3TP16VC47M 47uF 2
C1068	0CE107WF6DC	"Capacitor,AL,Chip" MVK6.3TP16VC100M 100uF	C1708	0CE226WF6DC	"Capacitor,AL,Chip" MVK5.0TP16VC22M 22uF 2
C110	0CE106WFKDC	"Capacitor,AL,Chip" MVK4.0TP16VC10M 10uF 2	C1708	0CE226WF6DC	"Capacitor,AL,Chip" MVK5.0TP16VC22M 22uF 2
C110	0CE106WFKDC	"Capacitor,AL,Chip" MVK4.0TP16VC10M 10uF 2	C181	0CE106WFKDC	"Capacitor,AL,Chip" MVK4.0TP16VC10M 10uF 2
C118	0CE106WFKDC	"Capacitor,AL,Chip" MVK4.0TP16VC10M 10uF 2	C181	0CE106WFKDC	"Capacitor,AL,Chip" MVK4.0TP16VC10M 10uF 2
C118	0CE106WFKDC	"Capacitor,AL,Chip" MVK4.0TP16VC10M 10uF 2	C226	0CE107WF6DC	"Capacitor,AL,Chip" MVK6.3TP16VC100M 100uF
C1217	0CE106WH6DC	"Capacitor,AL,Chip" MVK5.0TP25VC10M 10uF 2	C226	0CE107WF6DC	"Capacitor,AL,Chip" MVK6.3TP16VC100M 100uF
C1217	0CE106WH6DC	"Capacitor,AL,Chip" MVK5.0TP25VC10M 10uF 2	C227	0CE107WF6DC	"Capacitor,AL,Chip" MVK6.3TP16VC100M 100uF
C1225	0CE106WH6DC	"Capacitor,AL,Chip" MVK5.0TP25VC10M 10uF 2	C227	0CE107WF6DC	"Capacitor,AL,Chip" MVK6.3TP16VC100M 100uF
C1225	0CE106WH6DC	"Capacitor,AL,Chip" MVK5.0TP25VC10M 10uF 2	C412	0CE106WFKDC	"Capacitor,AL,Chip" MVK4.0TP16VC10M 10uF 2
C1232	0CE107WF6DC	"Capacitor,AL,Chip" MVK6.3TP16VC100M 100uF	C412	0CE106WFKDC	"Capacitor,AL,Chip" MVK4.0TP16VC10M 10uF 2
C1232	0CE107WF6DC	"Capacitor,AL,Chip" MVK6.3TP16VC100M 100uF	C414	0CE106WFKDC	"Capacitor,AL,Chip" MVK4.0TP16VC10M 10uF 2
C1236	0CE106WH6DC	"Capacitor,AL,Chip" MVK5.0TP25VC10M 10uF 2	C414	0CE106WFKDC	"Capacitor,AL,Chip" MVK4.0TP16VC10M 10uF 2
C1236	0CE106WH6DC	"Capacitor,AL,Chip" MVK5.0TP25VC10M 10uF 2	C515	0CE107WF6DC	"Capacitor,AL,Chip" MVK6.3TP16VC100M 100uF
C1237	0CE106WH6DC	"Capacitor,AL,Chip" MVK5.0TP25VC10M 10uF 2	C515	0CE107WF6DC	"Capacitor,AL,Chip" MVK6.3TP16VC100M 100uF
C1237	0CE106WH6DC	"Capacitor,AL,Chip" MVK5.0TP25VC10M 10uF 2	C517	0CE227WF6DC	"Capacitor,AL,Chip" MVK8.0TP16VC220M 220uF
C1247	0CE107WF6DC	"Capacitor,AL,Chip" MVK6.3TP16VC100M 100uF	C517	0CE227WF6DC	"Capacitor,AL,Chip" MVK8.0TP16VC220M 220uF
C1247	0CE107WF6DC	"Capacitor,AL,Chip" MVK6.3TP16VC100M 100uF	C519	0CE107WF6DC	"Capacitor,AL,Chip" MVK6.3TP16VC100M 100uF
C1309	0CE475WK6DC	"Capacitor,AL,Chip" MVK5.0TP50VC4.7M 4.7uF	C519	0CE107WF6DC	"Capacitor,AL,Chip" MVK6.3TP16VC100M 100uF
C1309	0CE475WK6DC	"Capacitor,AL,Chip" MVK5.0TP50VC4.7M 4.7uF	C522	0CE107WF6DC	"Capacitor,AL,Chip" MVK6.3TP16VC100M 100uF
C1310	0CE475WK6DC	"Capacitor,AL,Chip" MVK5.0TP50VC4.7M 4.7uF	C522	0CE107WF6DC	"Capacitor,AL,Chip" MVK6.3TP16VC100M 100uF
C1310	0CE475WK6DC	"Capacitor,AL,Chip" MVK5.0TP50VC4.7M 4.7uF	C523	0CE107WF6DC	"Capacitor,AL,Chip" MVK6.3TP16VC100M 100uF
C1313	0CE226WF6DC	"Capacitor,AL,Chip" MVK5.0TP16VC22M 22uF 2	C523	0CE107WF6DC	"Capacitor,AL,Chip" MVK6.3TP16VC100M 100uF
C1313	0CE226WF6DC	"Capacitor,AL,Chip" MVK5.0TP16VC22M 22uF 2	C524	0CE477WF6DC	"Capacitor,AL,Chip" MVK10TP16VC470M 470uF
C1319	0CE335WK6D8	"Capacitor,AL,Chip" MVK4.0TP50VC3.3M 3.3uF	C524	0CE477WF6DC	"Capacitor,AL,Chip" MVK10TP16VC470M 470uF
C1319	0CE335WK6D8	"Capacitor,AL,Chip" MVK4.0TP50VC3.3M 3.3uF	C527	0CE107WF6DC	"Capacitor,AL,Chip" MVK6.3TP16VC100M 100uF
C1325	0CE226WF6DC	"Capacitor,AL,Chip" MVK5.0TP16VC22M 22uF 2	C527	0CE107WF6DC	"Capacitor,AL,Chip" MVK6.3TP16VC100M 100uF
C1325	0CE226WF6DC	"Capacitor,AL,Chip" MVK5.0TP16VC22M 22uF 2	C528	0CE227WF6DC	"Capacitor,AL,Chip" MVK8.0TP16VC220M 220uF
C1341	0CE335WK6D8	"Capacitor,AL,Chip" MVK4.0TP50VC3.3M 3.3uF	C528	0CE227WF6DC	"Capacitor,AL,Chip" MVK8.0TP16VC220M 220uF
C1341	0CE335WK6D8	"Capacitor,AL,Chip" MVK4.0TP50VC3.3M 3.3uF	C533	0CE107WF6DC	"Capacitor,AL,Chip" MVK6.3TP16VC100M 100uF
C1343	0CE107WF6DC	"Capacitor,AL,Chip" MVK6.3TP16VC100M 100uF	C533	0CE107WF6DC	"Capacitor,AL,Chip" MVK6.3TP16VC100M 100uF
C1343	0CE107WF6DC	"Capacitor,AL,Chip" MVK6.3TP16VC100M 100uF	C534	0CE227WF6DC	"Capacitor,AL,Chip" MVK8.0TP16VC220M 220uF
C1344	0CE106WH6DC	"Capacitor,AL,Chip" MVK5.0TP25VC10M 10uF 2	C534	0CE227WF6DC	"Capacitor,AL,Chip" MVK8.0TP16VC220M 220uF



























LOC. NO.	PART NO.	DESCRIPTION / SPECIFICATION	LOC. NO.	PART NO.	DESCRIPTION / SPECIFICATION
D903	ODS226009AA	"Diode,Switching" KDS226 1.2V 85V 300MA	ZD1221	EAH33945901	"Diode,TVS" CDS3C30GTH 30V 50V 120
D903	ODS226009AA	"Diode,Switching" KDS226 1.2V 85V 300MA	ZD1222	EAH33945901	"Diode,TVS" CDS3C30GTH 30V 50V 120
D904	ODS226009AA	"Diode,Switching" KDS226 1.2V 85V 300MA	ZD1222	EAH33945901	"Diode,TVS" CDS3C30GTH 30V 50V 120
D904	ODS226009AA	"Diode,Switching" KDS226 1.2V 85V 300MA	ZD1223	EAH33945901	"Diode,TVS" CDS3C30GTH 30V 50V 120
D905	ODS226009AA	"Diode,Switching" KDS226 1.2V 85V 300MA	ZD1223	EAH33945901	"Diode,TVS" CDS3C30GTH 30V 50V 120
D905	ODS226009AA	"Diode,Switching" KDS226 1.2V 85V 300MA	ZD1224	EAH33945901	"Diode,TVS" CDS3C30GTH 30V 50V 120
D100	EAH33945901	"Diode,TVS" CDS3C30GTH 30V 50V 120	ZD1224	EAH33945901	"Diode,TVS" CDS3C30GTH 30V 50V 120
D101	EAH33946001	"Diode,TVS" CDS3C05GTA 5.6V 6.4V 1	ZD1226	EAH33945901	"Diode,TVS" CDS3C30GTH 30V 50V 120
D102	EAH33946001	"Diode,TVS" CDS3C05GTA 5.6V 6.4V 1	ZD1226	EAH33945901	"Diode,TVS" CDS3C30GTH 30V 50V 120
D103	EAH33945901	"Diode,TVS" CDS3C30GTH 30V 50V 120	ZD1228	EAH33946001	"Diode,TVS" CDS3C05GTA 5.6V 6.4V 1
D104	EAH33945901	"Diode,TVS" CDS3C30GTH 30V 50V 120	ZD1228	EAH33946001	"Diode,TVS" CDS3C05GTA 5.6V 6.4V 1
ZD100	EAH33945901	"Diode,TVS" CDS3C30GTH 30V 50V 120	ZD1229	EAH33946001	"Diode,TVS" CDS3C05GTA 5.6V 6.4V 1
ZD101	EAH33946001	"Diode,TVS" CDS3C05GTA 5.6V 6.4V 1	ZD1229	EAH33946001	"Diode,TVS" CDS3C05GTA 5.6V 6.4V 1
ZD102	EAH33946001	"Diode,TVS" CDS3C05GTA 5.6V 6.4V 1	ZD101	0DZ510009AK	"Diode,Zener" GDZJ5.1B 5.1V 4.94TO5.
ZD103	EAH33945901	"Diode,TVS" CDS3C30GTH 30V 50V 120	ZD102	0DZ510009AK	"Diode,Zener" GDZJ5.1B 5.1V 4.94TO5.
ZD104	EAH33945901	"Diode,TVS" CDS3C30GTH 30V 50V 120	ZD1300	0DZRM00248A	"Diode,Zener" RLZ8.2B 8.2V 7.78TO8.1
ZD1100	EAH33946001	"Diode,TVS" CDS3C05GTA 5.6V 6.4V 1	ZD1300	0DZRM00248A	"Diode,Zener" RLZ8.2B 8.2V 7.78TO8.1
ZD1100	EAH33946001	"Diode,TVS" CDS3C05GTA 5.6V 6.4V 1	ICs		
ZD1101	EAH33946001	"Diode,TVS" CDS3C05GTA 5.6V 6.4V 1	IC1004	EAN33595101	"IC,Analog Multiplexer" STHDMI002A 3.135TO3.46
ZD1101	EAH33946001	"Diode,TVS" CDS3C05GTA 5.6V 6.4V 1	IC1004	EAN33595101	"IC,Analog Multiplexer" STHDMI002A 3.135TO3.46
ZD1104	EAH33945901	"Diode,TVS" CDS3C30GTH 30V 50V 120	IC1400	0ISO206900A	"IC,Analog Switch" CXA2069Q 8.5TO9.5V - -
ZD1104	EAH33945901	"Diode,TVS" CDS3C30GTH 30V 50V 120	IC1400	0ISO206900A	"IC,Analog Switch" CXA2069Q 8.5TO9.5V - -
ZD1105	EAH33945901	"Diode,TVS" CDS3C30GTH 30V 50V 120	IC600	0IPRP00602A	"IC,Analog Switch" TPS2010ADR 2.7TO5.5V 8
ZD1105	EAH33945901	"Diode,TVS" CDS3C30GTH 30V 50V 120	IC600	0IPRP00602A	"IC,Analog Switch" TPS2010ADR 2.7TO5.5V 8
ZD1106	EAH33945901	"Diode,TVS" CDS3C30GTH 30V 50V 120	IC1301	0ILNR00261C	"IC,Audio Amplifier" STA335BW 5TO26V 0 10%
ZD1106	EAH33945901	"Diode,TVS" CDS3C30GTH 30V 50V 120	IC1301	0ILNR00261C	"IC,Audio Amplifier" STA335BW 5TO26V 0 10%
ZD1107	EAH33945901	"Diode,TVS" CDS3C30GTH 30V 50V 120	IC102	0ISTLPH026A	"IC,CMOS" 74LVC14APW 1.2TO3.6V 0
ZD1107	EAH33945901	"Diode,TVS" CDS3C30GTH 30V 50V 120	IC102	0ISTLPH026A	"IC,CMOS" 74LVC14APW 1.2TO3.6V 0
ZD1108	EAH33945901	"Diode,TVS" CDS3C30GTH 30V 50V 120	IC1101	0IPH741400E	"IC,CMOS" 74HC14D 2TO6V 0.002mA
ZD1108	EAH33945901	"Diode,TVS" CDS3C30GTH 30V 50V 120	IC1101	0IPH741400E	"IC,CMOS" 74HC14D 2TO6V 0.002mA
ZD1109	EAH33945901	"Diode,TVS" CDS3C30GTH 30V 50V 120	IC1104	0ITO741570C	"IC,CMOS" TC74LCX157FT 2TO3.6V 0
ZD1109	EAH33945901	"Diode,TVS" CDS3C30GTH 30V 50V 120	IC1104	0ITO741570C	"IC,CMOS" TC74LCX157FT 2TO3.6V 0
ZD1112	EAH33945901	"Diode,TVS" CDS3C30GTH 30V 50V 120	IC1105	0IMCRFA018A	"IC,CMOS" NC7SB3157P6X_NL 1.65TO
ZD1112	EAH33945901	"Diode,TVS" CDS3C30GTH 30V 50V 120	IC1105	0IMCRFA018A	"IC,CMOS" NC7SB3157P6X_NL 1.65TO
ZD1113	EAH33945901	"Diode,TVS" CDS3C30GTH 30V 50V 120	IC1106	0IMCRFA018A	"IC,CMOS" NC7SB3157P6X_NL 1.65TO
ZD1113	EAH33945901	"Diode,TVS" CDS3C30GTH 30V 50V 120	IC1106	0IMCRFA018A	"IC,CMOS" NC7SB3157P6X_NL 1.65TO
ZD1114	EAH33945901	"Diode,TVS" CDS3C30GTH 30V 50V 120	IC300	0ISTLPH003B	"IC,CMOS" 74LVC541APW 1.2TO3.6V
ZD1114	EAH33945901	"Diode,TVS" CDS3C30GTH 30V 50V 120	IC300	0ISTLPH003B	"IC,CMOS" 74LVC541APW 1.2TO3.6V
ZD1201	EAH33946001	"Diode,TVS" CDS3C05GTA 5.6V 6.4V 1	IC301	0IMCRFA013A	"IC,CMOS" 74LCX244MTC 2TO3.6V 0.
ZD1201	EAH33946001	"Diode,TVS" CDS3C05GTA 5.6V 6.4V 1	IC301	0IMCRFA013A	"IC,CMOS" 74LCX244MTC 2TO3.6V 0.
ZD1202	EAH33946001	"Diode,TVS" CDS3C05GTA 5.6V 6.4V 1	IC302	0ISTLPH003B	"IC,CMOS" 74LVC541APW 1.2TO3.6V
ZD1202	EAH33946001	"Diode,TVS" CDS3C05GTA 5.6V 6.4V 1	IC302	0ISTLPH003B	"IC,CMOS" 74LVC541APW 1.2TO3.6V
ZD1203	EAH33945901	"Diode,TVS" CDS3C30GTH 30V 50V 120	IC303	0IMCRFA013A	"IC,CMOS" 74LCX244MTC 2TO3.6V 0.
ZD1203	EAH33945901	"Diode,TVS" CDS3C30GTH 30V 50V 120	IC303	0IMCRFA013A	"IC,CMOS" 74LCX244MTC 2TO3.6V 0.
ZD1211	EAH33946001	"Diode,TVS" CDS3C05GTA 5.6V 6.4V 1	IC404	0ISTLPH026A	"IC,CMOS" 74LVC14APW 1.2TO3.6V 0
ZD1211	EAH33946001	"Diode,TVS" CDS3C05GTA 5.6V 6.4V 1	IC404	0ISTLPH026A	"IC,CMOS" 74LVC14APW 1.2TO3.6V 0
ZD1212	EAH33946001	"Diode,TVS" CDS3C05GTA 5.6V 6.4V 1	IC410	0ITO741570C	"IC,CMOS" TC74LCX157FT 2TO3.6V 0
ZD1212	EAH33946001	"Diode,TVS" CDS3C05GTA 5.6V 6.4V 1	IC410	0ITO741570C	"IC,CMOS" TC74LCX157FT 2TO3.6V 0
ZD1218	EAH33945901	"Diode,TVS" CDS3C30GTH 30V 50V 120	IC100	0IPRP00703C	"IC,Data Controller" STI5100GUC(CUT3.3) 3.3
ZD1218	EAH33945901	"Diode,TVS" CDS3C30GTH 30V 50V 120	IC100	0IPRP00703C	"IC,Data Controller" STI5100GUC(CUT3.3) 3.3
ZD1219	EAH33945901	"Diode,TVS" CDS3C30GTH 30V 50V 120	IC1002	0IMMRAL014D	"IC,EEPROM" AT24C02BN-SH-T 2KBIT 2
ZD1219	EAH33945901	"Diode,TVS" CDS3C30GTH 30V 50V 120	IC1002	0IMMRAL014D	"IC,EEPROM" AT24C02BN-SH-T 2KBIT 2
ZD1220	EAH33945901	"Diode,TVS" CDS3C30GTH 30V 50V 120	IC1003	0IMMRAL014D	"IC,EEPROM" AT24C02BN-SH-T 2KBIT 2
ZD1220	EAH33945901	"Diode,TVS" CDS3C30GTH 30V 50V 120	IC1003	0IMMRAL014D	"IC,EEPROM" AT24C02BN-SH-T 2KBIT 2
ZD1221	EAH33945901	"Diode,TVS" CDS3C30GTH 30V 50V 120	IC1003	0IMMRAL014D	"IC,EEPROM" AT24C02BN-SH-T 2KBIT 2
ZD1221	EAH33945901	"Diode,TVS" CDS3C30GTH 30V 50V 120	IC1003	0IMMRAL014D	"IC,EEPROM" AT24C02BN-SH-T 2KBIT 2

LOC. NO.	PART NO.	DESCRIPTION / SPECIFICATION	LOC. NO.	PART NO.	DESCRIPTION / SPECIFICATION
IC103	0IMP242560A	"IC,EEPROM" 24LC256T-I/SM 256KBIT	L101	6210TCE001G	"Filter,Bead" HH-1M3216-501JT 500OHM
IC103	0IMP242560A	"IC,EEPROM" 24LC256T-I/SM 256KBIT	L101	6210TCE001G	"Filter,Bead" HH-1M3216-501JT 500OHM
IC1100	0IMMRAL014D	"IC,EEPROM" AT24C02BN-SH-T 2KBIT 2	L102	6210TCE001G	"Filter,Bead" HH-1M3216-501JT 500OHM
IC1100	0IMMRAL014D	"IC,EEPROM" AT24C02BN-SH-T 2KBIT 2	L102	6210TCE001G	"Filter,Bead" HH-1M3216-501JT 500OHM
IC701	0IMP242560A	"IC,EEPROM" 24LC256T-I/SM 256KBIT	L103	6210TCE001G	"Filter,Bead" HH-1M3216-501JT 500OHM
IC701	0IMP242560A	"IC,EEPROM" 24LC256T-I/SM 256KBIT	L103	6210TCE001G	"Filter,Bead" HH-1M3216-501JT 500OHM
IC702	EAN34099701	"IC,EEPROM" M2404HEPROM 4KBIT 512	L104	6210TCE001G	"Filter,Bead" HH-1M3216-501JT 500OHM
IC702	EAN34099701	"IC,EEPROM" M2404HEPROM 4KBIT 512	L104	6210TCE001G	"Filter,Bead" HH-1M3216-501JT 500OHM
IC500	EAN36661101	"IC,LDO Voltage Regulator" MIC37100-1.8WS 2.25V ~	L105	6210TCE001G	"Filter,Bead" HH-1M3216-501JT 500OHM
IC500	EAN36661101	"IC,LDO Voltage Regulator" MIC37100-1.8WS 2.25V ~	L105	6210TCE001G	"Filter,Bead" HH-1M3216-501JT 500OHM
IC501	0IPMG00027A	"IC,LDO Voltage Regulator" SC156515M-1.8TR 2.2TO5	L106	6210TCE001G	"Filter,Bead" HH-1M3216-501JT 500OHM
IC501	0IPMG00027A	"IC,LDO Voltage Regulator" SC156515M-1.8TR 2.2TO5	L106	6210TCE001G	"Filter,Bead" HH-1M3216-501JT 500OHM
IC502	EAN36661201	"IC,LDO Voltage Regulator" MIC37100-2.5WS 2.78V ~	L108	6210TCE001G	"Filter,Bead" HH-1M3216-501JT 500OHM
IC502	EAN36661201	"IC,LDO Voltage Regulator" MIC37100-2.5WS 2.78V ~	L108	6210TCE001G	"Filter,Bead" HH-1M3216-501JT 500OHM
IC503	0IPMGKE030A	"IC,LDO Voltage Regulator" KIA78R05F 6TO12V 5V 8W	L1101	6210TCE001L	"Filter,Bead" HB-1T2012-102JT 1000OH
IC503	0IPMGKE030A	"IC,LDO Voltage Regulator" KIA78R05F 6TO12V 5V 8W	L1101	6210TCE001L	"Filter,Bead" HB-1T2012-102JT 1000OH
IC504	0IPMGKE031A	"IC,LDO Voltage Regulator" KIA78R33F 4TO10V 3.3V	L1102	6210TCE001L	"Filter,Bead" HB-1T2012-102JT 1000OH
IC504	0IPMGKE031A	"IC,LDO Voltage Regulator" KIA78R33F 4TO10V 3.3V	L1102	6210TCE001L	"Filter,Bead" HB-1T2012-102JT 1000OH
IC505	0IPMGKE031A	"IC,LDO Voltage Regulator" KIA78R33F 4TO10V 3.3V	L1104	6210TCE001G	"Filter,Bead" HH-1M3216-501JT 500OHM
IC505	0IPMGKE031A	"IC,LDO Voltage Regulator" KIA78R33F 4TO10V 3.3V	L1104	6210TCE001G	"Filter,Bead" HH-1M3216-501JT 500OHM
IC507	0IPMGKE030A	"IC,LDO Voltage Regulator" KIA78R05F 6TO12V 5V 8W	L1105	6210TCE001P	"Filter,Bead" HB-1S2012-121JT(H:1mm)
IC507	0IPMGKE030A	"IC,LDO Voltage Regulator" KIA78R05F 6TO12V 5V 8W	L1105	6210TCE001P	"Filter,Bead" HB-1S2012-121JT(H:1mm)
IC900	0IPMGFA061A	"IC,LDO Voltage Regulator" FAN1587AD33X 4.8TO10.3	L1106	6210TCE001P	"Filter,Bead" HB-1S2012-121JT(H:1mm)
IC900	0IPMGFA061A	"IC,LDO Voltage Regulator" FAN1587AD33X 4.8TO10.3	L1106	6210TCE001P	"Filter,Bead" HB-1S2012-121JT(H:1mm)
IC901	0IPMGFA061A	"IC,LDO Voltage Regulator" FAN1587AD33X 4.8TO10.3	L1107	6210TCE001P	"Filter,Bead" HB-1S2012-121JT(H:1mm)
IC901	0IPMGFA061A	"IC,LDO Voltage Regulator" FAN1587AD33X 4.8TO10.3	L1107	6210TCE001P	"Filter,Bead" HB-1S2012-121JT(H:1mm)
IC901	0IPMGFA061A	"IC,LDO Voltage Regulator" FAN1587AD33X 4.8TO10.3	L1108	6210TCE001P	"Filter,Bead" HB-1S2012-121JT(H:1mm)
IC901	0IPMGFA061A	"IC,LDO Voltage Regulator" FAN1587AD33X 4.8TO10.3	L1108	6210TCE001P	"Filter,Bead" HB-1S2012-121JT(H:1mm)
IC902	0IPMG00107A	"IC,LDO Voltage Regulator" AZ1117H-2.5TR/E1 15V 2	L1109	6210TCE001P	"Filter,Bead" HB-1S2012-121JT(H:1mm)
IC902	0IPMG00107A	"IC,LDO Voltage Regulator" AZ1117H-2.5TR/E1 15V 2	L1109	6210TCE001P	"Filter,Bead" HB-1S2012-121JT(H:1mm)
IC903	0IPMG00027A	"IC,LDO Voltage Regulator" SC156515M-1.8TR 2.2TO5	L1205	6210TCE001G	"Filter,Bead" HH-1M3216-501JT 500OHM
IC903	0IPMG00027A	"IC,LDO Voltage Regulator" SC156515M-1.8TR 2.2TO5	L1205	6210TCE001G	"Filter,Bead" HH-1M3216-501JT 500OHM
IC506	0ISS455880A	"IC,OP Amplifier" KA4558D 12TO22V 6mV -	L1206	6210TCE001Z	"Filter,Bead" HH-1M2012-600JT 600OHM
IC506	0ISS455880A	"IC,OP Amplifier" KA4558D 12TO22V 6mV -	L1206	6210TCE001Z	"Filter,Bead" HH-1M2012-600JT 600OHM
IC202	0IMMRIH038B	"IC,SDRAM" HYB25D(C)256160CE-5 25	L1207	6210TCE001Z	"Filter,Bead" HH-1M2012-600JT 600OHM
IC202	0IMMRIH038B	"IC,SDRAM" HYB25D(C)256160CE-5 25	L1207	6210TCE001Z	"Filter,Bead" HH-1M2012-600JT 600OHM
IC801	0IMMRIH038B	"IC,SDRAM" HYB25D(C)256160CE-5 25	L1208	6210TCE001Z	"Filter,Bead" HH-1M2012-600JT 600OHM
IC801	0IMMRIH038B	"IC,SDRAM" HYB25D(C)256160CE-5 25	L1208	6210TCE001Z	"Filter,Bead" HH-1M2012-600JT 600OHM
IC1300	0IMCRMN028C	"IC,Sound/Audio Processor" MSP4450K-QA-D6 7.6TO8.	L1211	6210TCE001L	"Filter,Bead" HB-1T2012-102JT 1000OH
IC1300	0IMCRMN028C	"IC,Sound/Audio Processor" MSP4450K-QA-D6 7.6TO8.	L1211	6210TCE001L	"Filter,Bead" HB-1T2012-102JT 1000OH
IC1102	0IPRP00009A	"IC,Tx/Rx" ICL3232CBNZ 3VTO5.5V -	L1212	6210TCE001L	"Filter,Bead" HB-1T2012-102JT 1000OH
IC1102	0IPRP00009A	"IC,Tx/Rx" ICL3232CBNZ 3VTO5.5V -	L1212	6210TCE001L	"Filter,Bead" HB-1T2012-102JT 1000OH
IC700	EAN33595901	"IC,Video Processors" FLI8548H-LF-BE 300MVTO	L1215	6210TCE001G	"Filter,Bead" HH-1M3216-501JT 500OHM
IC700	EAN33595901	"IC,Video Processors" FLI8548H-LF-BE 300MVTO	L1215	6210TCE001G	"Filter,Bead" HH-1M3216-501JT 500OHM
IC200	0IPMG78391A	"IC,Voltage Regulator" SC2595STR 2.3TO5V 0 0W	L1300	6210TCE001G	"Filter,Bead" HH-1M3216-501JT 500OHM
IC200	0IPMG78391A	"IC,Voltage Regulator" SC2595STR 2.3TO5V 0 0W	L1300	6210TCE001G	"Filter,Bead" HH-1M3216-501JT 500OHM
IC804	0IPMG78391A	"IC,Voltage Regulator" SC2595STR 2.3TO5V 0 0W	L1301	6210TCE001G	"Filter,Bead" HH-1M3216-501JT 500OHM
IC804	0IPMG78391A	"IC,Voltage Regulator" SC2595STR 2.3TO5V 0 0W	L1301	6210TCE001G	"Filter,Bead" HH-1M3216-501JT 500OHM
IC904	EAN32662801	"IC,Voltage Regulator" KA7809ERTM 35V to 40V	L1302	6210TCE001G	"Filter,Bead" HH-1M3216-501JT 500OHM
IC904	EAN32662801	"IC,Voltage Regulator" KA7809ERTM 35V to 40V	L1302	6210TCE001G	"Filter,Bead" HH-1M3216-501JT 500OHM
<b>COILS &amp; FILTERs &amp; INDUCTORS</b>					
L100	6210TCE001G	"Filter,Bead" HH-1M3216-501JT 500OHM	L1303	6210TCE001G	"Filter,Bead" HH-1M3216-501JT 500OHM
L100	6210TCE001G	"Filter,Bead" HH-1M3216-501JT 500OHM	L1309	6210TCE001S	"Filter,Bead" HU-1M2012-121 120OHM 2
			L1309	6210TCE001S	"Filter,Bead" HU-1M2012-121 120OHM 2
			L1310	6210TCE001S	"Filter,Bead" HU-1M2012-121 120OHM 2





LOC. NO.	PART NO.	DESCRIPTION / SPECIFICATION	LOC. NO.	PART NO.	DESCRIPTION / SPECIFICATION
L1307	EAP32842806	"Inductor,Wire Wound,Chip" NR8040T220M 22UH 20% 2	Q402	OTR387500AA	"TR,Bipolar" 2SC3875S(ALY) NPN 5V 6
L600	0LCTA00003A	"Inductor,Wire Wound,Chip" LEMC3225T6R8M 6.8UH 20	Q500	OTR102009AM	"TR,Bipolar" KRA102S PNP -30V 0V -5
L600	0LCTA00003A	"Inductor,Wire Wound,Chip" LEMC3225T6R8M 6.8UH 20	Q500	OTR102009AM	"TR,Bipolar" KRA102S PNP -30V 0V -5
L601	0LCTA00003A	"Inductor,Wire Wound,Chip" LEMC3225T6R8M 6.8UH 20	Q502	OTR387500AA	"TR,Bipolar" 2SC3875S(ALY) NPN 5V 6
L601	0LCTA00003A	"Inductor,Wire Wound,Chip" LEMC3225T6R8M 6.8UH 20	Q502	OTR387500AA	"TR,Bipolar" 2SC3875S(ALY) NPN 5V 6
L605	0LCTA00003A	"Inductor,Wire Wound,Chip" LEMC3225T6R8M 6.8UH 20	Q503	OTR387500AA	"TR,Bipolar" 2SC3875S(ALY) NPN 5V 6
L605	0LCTA00003A	"Inductor,Wire Wound,Chip" LEMC3225T6R8M 6.8UH 20	Q503	OTR387500AA	"TR,Bipolar" 2SC3875S(ALY) NPN 5V 6
<b>TRANSISTORS &amp; FETs</b>					
IC803	EBK32753101	FET SI4925BDY P-CHANNEL MO	Q504	OTR150400BA	"TR,Bipolar" 2SA1504S(ASY) PNP -5V
IC803	EBK32753101	FET SI4925BDY P-CHANNEL MO	Q504	OTR150400BA	"TR,Bipolar" 2SA1504S(ASY) PNP -5V
Q1001	OTR830009BA	FET BSS83 N-CHANNEL MOSFET	Q602	OTR150400BA	"TR,Bipolar" 2SA1504S(ASY) PNP -5V
Q1001	OTR830009BA	FET BSS83 N-CHANNEL MOSFET	Q602	OTR150400BA	"TR,Bipolar" 2SA1504S(ASY) PNP -5V
Q100	OTR387500AA	"TR,Bipolar" 2SC3875S(ALY) NPN 5V 6	Q603	OTR387500AA	"TR,Bipolar" 2SC3875S(ALY) NPN 5V 6
Q101	OTR387500AA	"TR,Bipolar" 2SC3875S(ALY) NPN 5V 6	Q603	OTR387500AA	"TR,Bipolar" 2SC3875S(ALY) NPN 5V 6
Q1100	OTR387500AA	"TR,Bipolar" 2SC3875S(ALY) NPN 5V 6	Q604	OTR387500AA	"TR,Bipolar" 2SC3875S(ALY) NPN 5V 6
Q1100	OTR387500AA	"TR,Bipolar" 2SC3875S(ALY) NPN 5V 6	Q604	OTR387500AA	"TR,Bipolar" 2SC3875S(ALY) NPN 5V 6
Q1200	OTR387500AA	"TR,Bipolar" 2SC3875S(ALY) NPN 5V 6	Q606	OTR150400BA	"TR,Bipolar" 2SA1504S(ASY) PNP -5V
Q1200	OTR387500AA	"TR,Bipolar" 2SC3875S(ALY) NPN 5V 6	Q606	OTR150400BA	"TR,Bipolar" 2SA1504S(ASY) PNP -5V
Q1201	OTR387500AA	"TR,Bipolar" 2SC3875S(ALY) NPN 5V 6	Q607	OTR150400BA	"TR,Bipolar" 2SA1504S(ASY) PNP -5V
Q1201	OTR387500AA	"TR,Bipolar" 2SC3875S(ALY) NPN 5V 6	Q607	OTR150400BA	"TR,Bipolar" 2SA1504S(ASY) PNP -5V
Q1202	OTR387500AA	"TR,Bipolar" 2SC3875S(ALY) NPN 5V 6	Q608	OTR387500AA	"TR,Bipolar" 2SC3875S(ALY) NPN 5V 6
Q1202	OTR387500AA	"TR,Bipolar" 2SC3875S(ALY) NPN 5V 6	Q608	OTR387500AA	"TR,Bipolar" 2SC3875S(ALY) NPN 5V 6
Q1202	OTR387500AA	"TR,Bipolar" 2SC3875S(ALY) NPN 5V 6	Q609	OTR150400BA	"TR,Bipolar" 2SA1504S(ASY) PNP -5V
Q1202	OTR387500AA	"TR,Bipolar" 2SC3875S(ALY) NPN 5V 6	Q609	OTR150400BA	"TR,Bipolar" 2SA1504S(ASY) PNP -5V
Q1203	OTR102009AM	"TR,Bipolar" KRA102S PNP -30V 0V -5	Q800	OTR387500AA	"TR,Bipolar" 2SC3875S(ALY) NPN 5V 6
Q1203	OTR102009AM	"TR,Bipolar" KRA102S PNP -30V 0V -5	Q800	OTR387500AA	"TR,Bipolar" 2SC3875S(ALY) NPN 5V 6
Q1204	OTR387500AA	"TR,Bipolar" 2SC3875S(ALY) NPN 5V 6	Q900	OTR387500AA	"TR,Bipolar" 2SC3875S(ALY) NPN 5V 6
Q1204	OTR387500AA	"TR,Bipolar" 2SC3875S(ALY) NPN 5V 6	Q900	OTR387500AA	"TR,Bipolar" 2SC3875S(ALY) NPN 5V 6
Q1300	OTR387500AA	"TR,Bipolar" 2SC3875S(ALY) NPN 5V 6	Q901	OTR387500AA	"TR,Bipolar" 2SC3875S(ALY) NPN 5V 6
Q1300	OTR387500AA	"TR,Bipolar" 2SC3875S(ALY) NPN 5V 6	Q901	OTR387500AA	"TR,Bipolar" 2SC3875S(ALY) NPN 5V 6
Q1301	OTR387500AA	"TR,Bipolar" 2SC3875S(ALY) NPN 5V 6	Q902	OTR387500AA	"TR,Bipolar" 2SC3875S(ALY) NPN 5V 6
Q1301	OTR387500AA	"TR,Bipolar" 2SC3875S(ALY) NPN 5V 6	Q902	OTR387500AA	"TR,Bipolar" 2SC3875S(ALY) NPN 5V 6
Q1302	OTR387500AA	"TR,Bipolar" 2SC3875S(ALY) NPN 5V 6	Q903	OTR387500AA	"TR,Bipolar" 2SC3875S(ALY) NPN 5V 6
Q1302	OTR387500AA	"TR,Bipolar" 2SC3875S(ALY) NPN 5V 6	Q903	OTR387500AA	"TR,Bipolar" 2SC3875S(ALY) NPN 5V 6
Q1303	OTR387500AA	"TR,Bipolar" 2SC3875S(ALY) NPN 5V 6	Q904	OTR387500AA	"TR,Bipolar" 2SC3875S(ALY) NPN 5V 6
Q1303	OTR387500AA	"TR,Bipolar" 2SC3875S(ALY) NPN 5V 6	Q904	OTR387500AA	"TR,Bipolar" 2SC3875S(ALY) NPN 5V 6
Q1304	OTR387500AA	"TR,Bipolar" 2SC3875S(ALY) NPN 5V 6	Q905	OTR387500AA	"TR,Bipolar" 2SC3875S(ALY) NPN 5V 6
Q1304	OTR387500AA	"TR,Bipolar" 2SC3875S(ALY) NPN 5V 6	Q905	OTR387500AA	"TR,Bipolar" 2SC3875S(ALY) NPN 5V 6
Q1305	OTR102009AM	"TR,Bipolar" KRA102S PNP -30V 0V -5	<b>RESISTORS</b>		
Q1305	OTR102009AM	"TR,Bipolar" KRA102S PNP -30V 0V -5	AR100	0RJ0472C687	"Resistor,Array" RCA86TRJ47R0 47OHM 5%
Q1400	OTR387500AA	"TR,Bipolar" 2SC3875S(ALY) NPN 5V 6	AR100	0RJ0472C687	"Resistor,Array" RCA86TRJ47R0 47OHM 5%
Q1400	OTR387500AA	"TR,Bipolar" 2SC3875S(ALY) NPN 5V 6	AR101	0RJ0472C687	"Resistor,Array" RCA86TRJ47R0 47OHM 5%
Q1401	OTR387500AA	"TR,Bipolar" 2SC3875S(ALY) NPN 5V 6	AR101	0RJ0472C687	"Resistor,Array" RCA86TRJ47R0 47OHM 5%
Q1401	OTR387500AA	"TR,Bipolar" 2SC3875S(ALY) NPN 5V 6	AR102	0RJ0472C687	"Resistor,Array" RCA86TRJ47R0 47OHM 5%
Q1402	OTR387500AA	"TR,Bipolar" 2SC3875S(ALY) NPN 5V 6	AR102	0RJ0472C687	"Resistor,Array" RCA86TRJ47R0 47OHM 5%
Q1402	OTR387500AA	"TR,Bipolar" 2SC3875S(ALY) NPN 5V 6	AR103	0RJ0472C687	"Resistor,Array" RCA86TRJ47R0 47OHM 5%
Q1403	OTR150400BA	"TR,Bipolar" 2SA1504S(ASY) PNP -5V	AR103	0RJ0472C687	"Resistor,Array" RCA86TRJ47R0 47OHM 5%
Q1403	OTR150400BA	"TR,Bipolar" 2SA1504S(ASY) PNP -5V	AR104	0RJ0472C687	"Resistor,Array" RCA86TRJ47R0 47OHM 5%
Q1404	OTR387500AA	"TR,Bipolar" 2SC3875S(ALY) NPN 5V 6	AR104	0RJ0472C687	"Resistor,Array" RCA86TRJ47R0 47OHM 5%
Q1404	OTR387500AA	"TR,Bipolar" 2SC3875S(ALY) NPN 5V 6	AR105	0RJ0472C687	"Resistor,Array" RCA86TRJ47R0 47OHM 5%
Q400	OTR387500AA	"TR,Bipolar" 2SC3875S(ALY) NPN 5V 6	AR105	0RJ0472C687	"Resistor,Array" RCA86TRJ47R0 47OHM 5%
Q400	OTR387500AA	"TR,Bipolar" 2SC3875S(ALY) NPN 5V 6	AR106	0RJ0472C687	"Resistor,Array" RCA86TRJ47R0 47OHM 5%
Q401	OTR387500AA	"TR,Bipolar" 2SC3875S(ALY) NPN 5V 6	AR106	0RJ0472C687	"Resistor,Array" RCA86TRJ47R0 47OHM 5%
Q401	OTR387500AA	"TR,Bipolar" 2SC3875S(ALY) NPN 5V 6	AR107	0RJ0472C687	"Resistor,Array" RCA86TRJ47R0 47OHM 5%
Q402	OTR387500AA	"TR,Bipolar" 2SC3875S(ALY) NPN 5V 6	AR107	0RJ0472C687	"Resistor,Array" RCA86TRJ47R0 47OHM 5%

LOC. NO.	PART NO.	DESCRIPTION / SPECIFICATION	LOC. NO.	PART NO.	DESCRIPTION / SPECIFICATION
AR108	0RJ0472C687	"Resistor,Array" RCA86TRJ47R0 47OHM 5%	R1363	ORD3301A609	"Resistor,Carbon Film" RDM92T1J3K30 3.3KOHM 5
AR108	0RJ0472C687	"Resistor,Array" RCA86TRJ47R0 47OHM 5%	L1205	0RJ0000G676	"Resistor,Chip" MCR18EZHJ00 0OHM 5% 1/
AR109	0RJ0472C687	"Resistor,Array" RCA86TRJ47R0 47OHM 5%	L1205	0RJ0000G676	"Resistor,Chip" MCR18EZHJ00 0OHM 5% 1/
AR109	0RJ0472C687	"Resistor,Array" RCA86TRJ47R0 47OHM 5%	L1215	0RJ0000G676	"Resistor,Chip" MCR18EZHJ00 0OHM 5% 1/
AR110	0RJ0472C687	"Resistor,Array" RCA86TRJ47R0 47OHM 5%	L1215	0RJ0000G676	"Resistor,Chip" MCR18EZHJ00 0OHM 5% 1/
AR110	0RJ0472C687	"Resistor,Array" RCA86TRJ47R0 47OHM 5%	L1218	0RH0000D622	"Resistor,Chip" MCR10EZHJ000 0OHM 5% 1
AR111	0RJ0472C687	"Resistor,Array" RCA86TRJ47R0 47OHM 5%	L1218	0RH0000D622	"Resistor,Chip" MCR10EZHJ000 0OHM 5% 1
AR111	0RJ0472C687	"Resistor,Array" RCA86TRJ47R0 47OHM 5%	L1219	0RH0000D622	"Resistor,Chip" MCR10EZHJ000 0OHM 5% 1
AR200	0RJ0222C687	"Resistor,Array" RCA86TRJ22R0 22OHM 5%	L1219	0RH0000D622	"Resistor,Chip" MCR10EZHJ000 0OHM 5% 1
AR200	0RJ0222C687	"Resistor,Array" RCA86TRJ22R0 22OHM 5%	L1220	0RH0000D622	"Resistor,Chip" MCR10EZHJ000 0OHM 5% 1
AR201	0RJ0222C687	"Resistor,Array" RCA86TRJ22R0 22OHM 5%	L1220	0RH0000D622	"Resistor,Chip" MCR10EZHJ000 0OHM 5% 1
AR201	0RJ0222C687	"Resistor,Array" RCA86TRJ22R0 22OHM 5%	R100	0RH0000D622	"Resistor,Chip" MCR10EZHJ000 0OHM 5% 1
AR202	0RJ0222C687	"Resistor,Array" RCA86TRJ22R0 22OHM 5%	R100	0RH0000D622	"Resistor,Chip" MCR10EZHJ000 0OHM 5% 1
AR202	0RJ0222C687	"Resistor,Array" RCA86TRJ22R0 22OHM 5%	R101	0RH0000D622	"Resistor,Chip" MCR10EZHJ000 0OHM 5% 1
AR202	0RJ0222C687	"Resistor,Array" RCA86TRJ22R0 22OHM 5%	R101	0RH0752D622	"Resistor,Chip" MCR10EZHJ750 75OHM 5%
AR203	0RJ0222C687	"Resistor,Array" RCA86TRJ22R0 22OHM 5%	R1016	0RJ0222D677	"Resistor,Chip" MCR03EZPJ220 22OHM 5%
AR203	0RJ0222C687	"Resistor,Array" RCA86TRJ22R0 22OHM 5%	R1016	0RJ0222D677	"Resistor,Chip" MCR03EZPJ220 22OHM 5%
AR204	0RJ0222C687	"Resistor,Array" RCA86TRJ22R0 22OHM 5%	R1017	0RJ0222D677	"Resistor,Chip" MCR03EZPJ220 22OHM 5%
AR204	0RJ0222C687	"Resistor,Array" RCA86TRJ22R0 22OHM 5%	R1017	0RJ0222D677	"Resistor,Chip" MCR03EZPJ220 22OHM 5%
AR205	0RJ0222C687	"Resistor,Array" RCA86TRJ22R0 22OHM 5%	R1017	0RJ0222D677	"Resistor,Chip" MCR03EZPJ220 22OHM 5%
AR205	0RJ0222C687	"Resistor,Array" RCA86TRJ22R0 22OHM 5%	R1018	0RJ6800D677	"Resistor,Chip" MCR03EZPJ681 680OHM 5%
AR206	0RJ0222C687	"Resistor,Array" RCA86TRJ22R0 22OHM 5%	R1018	0RJ6800D677	"Resistor,Chip" MCR03EZPJ681 680OHM 5%
AR206	0RJ0222C687	"Resistor,Array" RCA86TRJ22R0 22OHM 5%	R1019	0RJ0222D677	"Resistor,Chip" MCR03EZPJ220 22OHM 5%
AR206	0RJ0222C687	"Resistor,Array" RCA86TRJ22R0 22OHM 5%	R1019	0RJ0222D677	"Resistor,Chip" MCR03EZPJ220 22OHM 5%
AR701	0RZZH033273	"Resistor,Array" MNR04M0ABJ330 33OHM 5%	R1019	0RJ0222D677	"Resistor,Chip" MCR03EZPJ220 22OHM 5%
AR701	0RZZH033273	"Resistor,Array" MNR04M0ABJ330 33OHM 5%	R102	0RH1302D622	"Resistor,Chip" MCR10EZHJ133 13KOHM 5%
AR702	0RZZH033273	"Resistor,Array" MNR04M0ABJ330 33OHM 5%	R102	0RH4700D622	"Resistor,Chip" MCR10EZHJ471 470OHM 5%
AR702	0RZZH033273	"Resistor,Array" MNR04M0ABJ330 33OHM 5%	R102	0RJ0472D677	"Resistor,Chip" MCR03EZPJ470 47OHM 5%
AR704	EBC32260501	"Resistor,Array" MNR04M0APJ000 0OHM 5%	R102	0RJ0472D677	"Resistor,Chip" MCR03EZPJ470 47OHM 5%
AR704	EBC32260501	"Resistor,Array" MNR04M0APJ000 0OHM 5%	R1020	0RJ6800D677	"Resistor,Chip" MCR03EZPJ681 680OHM 5%
AR706	0RZZH033273	"Resistor,Array" MNR04M0ABJ330 33OHM 5%	R1020	0RJ6800D677	"Resistor,Chip" MCR03EZPJ681 680OHM 5%
AR706	0RZZH033273	"Resistor,Array" MNR04M0ABJ330 33OHM 5%	R1021	0RJ0222D677	"Resistor,Chip" MCR03EZPJ220 22OHM 5%
AR708	0RZZH033273	"Resistor,Array" MNR04M0ABJ330 33OHM 5%	R1021	0RJ0222D677	"Resistor,Chip" MCR03EZPJ220 22OHM 5%
AR708	0RZZH033273	"Resistor,Array" MNR04M0ABJ330 33OHM 5%	R1022	0RJ0222D677	"Resistor,Chip" MCR03EZPJ220 22OHM 5%
AR800	EBC32260405	"Resistor,Array" MNR04M0APJ680 68OHM 5%	R1022	0RJ0222D677	"Resistor,Chip" MCR03EZPJ220 22OHM 5%
AR800	EBC32260405	"Resistor,Array" MNR04M0APJ680 68OHM 5%	R1023	0RJ0222D677	"Resistor,Chip" MCR03EZPJ220 22OHM 5%
AR805	EBC32260405	"Resistor,Array" MNR04M0APJ680 68OHM 5%	R1023	0RJ0222D677	"Resistor,Chip" MCR03EZPJ220 22OHM 5%
AR805	EBC32260405	"Resistor,Array" MNR04M0APJ680 68OHM 5%	R103	0RH0000D622	"Resistor,Chip" MCR10EZHJ000 0OHM 5% 1
AR806	EBC32260405	"Resistor,Array" MNR04M0APJ680 68OHM 5%	R103	0RH2203D622	"Resistor,Chip" MCR10EZHJ224 220KOHM 5
AR806	EBC32260405	"Resistor,Array" MNR04M0APJ680 68OHM 5%	R103	0RJ0472D677	"Resistor,Chip" MCR03EZPJ470 47OHM 5%
AR807	EBC32260405	"Resistor,Array" MNR04M0APJ680 68OHM 5%	R103	0RJ0472D677	"Resistor,Chip" MCR03EZPJ470 47OHM 5%
AR807	EBC32260405	"Resistor,Array" MNR04M0APJ680 68OHM 5%	R1038	0RJ0000D677	"Resistor,Chip" MCR03EZPJ000 0OHM 5% 1
AR808	EBC32260405	"Resistor,Array" MNR04M0APJ680 68OHM 5%	R1038	0RJ0000D677	"Resistor,Chip" MCR03EZPJ000 0OHM 5% 1
AR808	EBC32260405	"Resistor,Array" MNR04M0APJ680 68OHM 5%	R1039	0RJ0000D677	"Resistor,Chip" MCR03EZPJ000 0OHM 5% 1
AR809	EBC32260405	"Resistor,Array" MNR04M0APJ680 68OHM 5%	R1039	0RJ0000D677	"Resistor,Chip" MCR03EZPJ000 0OHM 5% 1
AR809	EBC32260405	"Resistor,Array" MNR04M0APJ680 68OHM 5%	R104	0RH2002D622	"Resistor,Chip" MCR10EZHJ203 20KOHM 5%
AR810	EBC32260405	"Resistor,Array" MNR04M0APJ680 68OHM 5%	R104	0RH4700D622	"Resistor,Chip" MCR10EZHJ471 470OHM 5%
AR810	EBC32260405	"Resistor,Array" MNR04M0APJ680 68OHM 5%	R1040	0RJ4702D677	"Resistor,Chip" MCR03EZPJ473 47KOHM 5%
R101	ORD9101Q609	"Resistor,Carbon Film" RDM94T1J9K10 9.1KOHM 5	R1040	0RJ4702D677	"Resistor,Chip" MCR03EZPJ473 47KOHM 5%
R102	ORD3301Q609	"Resistor,Carbon Film" RDM94T1J3K30 3.3KOHM 5	R1041	0RJ4702D677	"Resistor,Chip" MCR03EZPJ473 47KOHM 5%
R103	ORD1101Q609	"Resistor,Carbon Film" RDM94T1J1K10 1.1KOHM 5	R1041	0RJ4702D677	"Resistor,Chip" MCR03EZPJ473 47KOHM 5%
R104	ORD1100Q609	"Resistor,Carbon Film" RDM94T1J110R 110OHM 5%	R1042	0RJ4702D677	"Resistor,Chip" MCR03EZPJ473 47KOHM 5%
R105	ORD9101Q609	"Resistor,Carbon Film" RDM94T1J9K10 9.1KOHM 5	R1042	0RJ4702D677	"Resistor,Chip" MCR03EZPJ473 47KOHM 5%
R106	ORD3301Q609	"Resistor,Carbon Film" RDM94T1J3K30 3.3KOHM 5	R1043	0RJ4702D677	"Resistor,Chip" MCR03EZPJ473 47KOHM 5%
R107	ORD1101Q609	"Resistor,Carbon Film" RDM94T1J1K10 1.1KOHM 5	R1043	0RJ4702D677	"Resistor,Chip" MCR03EZPJ473 47KOHM 5%
R108	ORD1100Q609	"Resistor,Carbon Film" RDM94T1J110R 110OHM 5%	R1044	0RJ3301D677	"Resistor,Chip" MCR03EZPJ332 3.3KOHM 5
R1363	ORD3301A609	"Resistor,Carbon Film" RDM92T1J3K30 3.3KOHM 5	R1044	0RJ3301D677	"Resistor,Chip" MCR03EZPJ332 3.3KOHM 5































LOC. NO.	PART NO.	DESCRIPTION / SPECIFICATION	LOC. NO.	PART NO.	DESCRIPTION / SPECIFICATION
R898	0RJ1500D677	"Resistor,Chip" MCR03EZPJ151 150OHM 5%	R939	0RJ0000D677	"Resistor,Chip" MCR03EZPJ000 0OHM 5% 1
R900	0RJ1002D677	"Resistor,Chip" MCR03EZPJ103 10KOHM 5%	R939	0RJ0000D677	"Resistor,Chip" MCR03EZPJ000 0OHM 5% 1
R900	0RJ1002D677	"Resistor,Chip" MCR03EZPJ103 10KOHM 5%	R940	0RJ0000D677	"Resistor,Chip" MCR03EZPJ000 0OHM 5% 1
R900	0RJ1002D677	"Resistor,Chip" MCR03EZPJ103 10KOHM 5%	R940	0RJ0000D677	"Resistor,Chip" MCR03EZPJ000 0OHM 5% 1
R900	0RJ1002D677	"Resistor,Chip" MCR03EZPJ103 10KOHM 5%	<b>OTHERs</b>		
R901	0RJ1002D477	"Resistor,Chip" MCR03EZPF103 10KOHM 1%	X100	6212AC2002B	Crystal 9H03200164 32.768KHZ 2
R901	0RJ1002D477	"Resistor,Chip" MCR03EZPF103 10KOHM 1%	X100	6212AC2002B	Crystal 9H03200164 32.768KHZ 2
R902	0RJ2002D477	"Resistor,Chip" MCR03EZPF203 20KOHM 1%	X101	6212AB2883A	Crystal HC-49SM 27.00000MHZ 27
R902	0RJ2002D477	"Resistor,Chip" MCR03EZPF203 20KOHM 1%	X101	6212AB2883A	Crystal HC-49SM 27.00000MHZ 27
R910	0RJ0000D677	"Resistor,Chip" MCR03EZPJ000 0OHM 5% 1	X1300	156-A02R	Crystal EUA18.4320F16E33L 18.4
R910	0RJ0000D677	"Resistor,Chip" MCR03EZPJ000 0OHM 5% 1	X1300	156-A02R	Crystal EUA18.4320F16E33L 18.4
R911	0RJ1001D677	"Resistor,Chip" MCR03EZPJ102 1KOHM 5%	X700	6212AB2015J	Crystal HC-49SM 19.66080HZ 19.
R911	0RJ1001D677	"Resistor,Chip" MCR03EZPJ102 1KOHM 5%	X700	6212AB2015J	Crystal HC-49SM 19.66080HZ 19.
R913	0RJ1002D677	"Resistor,Chip" MCR03EZPJ103 10KOHM 5%	J100	6612J10033A	"Jack,Complex" PMJ016-13 13P DIN/RCA
R913	0RJ1002D677	"Resistor,Chip" MCR03EZPJ103 10KOHM 5%	J1000	6612B00015C	"Jack,DIN" DC1R019WDH. SOCKET 21P
R915	0RJ1001D677	"Resistor,Chip" MCR03EZPJ102 1KOHM 5%	J1000	6612B00015C	"Jack,DIN" DC1R019WDH. SOCKET 21P
R915	0RJ1001D677	"Resistor,Chip" MCR03EZPJ102 1KOHM 5%	J1001	6612B00015C	"Jack,DIN" DC1R019WDH. SOCKET 21P
R916	0RJ1001D677	"Resistor,Chip" MCR03EZPJ102 1KOHM 5%	J1001	6612B00015C	"Jack,DIN" DC1R019WDH. SOCKET 21P
R916	0RJ1001D677	"Resistor,Chip" MCR03EZPJ102 1KOHM 5%	J1001	6612B00015C	"Jack,DIN" DC1R019WDH. SOCKET 21P
R917	0RJ1002D677	"Resistor,Chip" MCR03EZPJ103 10KOHM 5%	J1	6612BBBHN4D	"Jack,Fiber Optic" TOTX177 3P TX 2.54MM A
R917	0RJ1002D677	"Resistor,Chip" MCR03EZPJ103 10KOHM 5%	J2	6612BBBHN4D	"Jack,Fiber Optic" TOTX177 3P TX 2.54MM A
R918	0RJ1002D677	"Resistor,Chip" MCR03EZPJ103 10KOHM 5%	J1101	6612F00099A	"Jack,Phone" PEJ024-01 1P 4P STRAIG
R918	0RJ1002D677	"Resistor,Chip" MCR03EZPJ103 10KOHM 5%	J1101	6612F00099A	"Jack,Phone" PEJ024-01 1P 4P STRAIG
R918	0RJ1002D677	"Resistor,Chip" MCR03EZPJ103 10KOHM 5%	J1203	6612J10031B	"Jack,RCA" PPJ209-01 14.0MM 1RX3C
R919	0RJ1002D677	"Resistor,Chip" MCR03EZPJ103 10KOHM 5%	J1203	6612J10031B	"Jack,RCA" PPJ209-01 14.0MM 1RX3C
R919	0RJ1002D677	"Resistor,Chip" MCR03EZPJ103 10KOHM 5%	J600	6612J10023A	"Jack,RCA" KCN-BT-0-0053 10.5MM/1
R920	0RJ3302D677	"Resistor,Chip" MCR03EZPJ333 33KOHM 5%	J600	6612J10023A	"Jack,RCA" KCN-BT-0-0053 10.5MM/1
R920	0RJ3302D677	"Resistor,Chip" MCR03EZPJ333 33KOHM 5%	J1200	6612M00010A	"Jack,Scart" PSC003-01 21P 21P/1C 3
R923	0RJ1001D677	"Resistor,Chip" MCR03EZPJ102 1KOHM 5%	J1200	6612M00010A	"Jack,Scart" PSC003-01 21P 21P/1C 3
R923	0RJ1001D677	"Resistor,Chip" MCR03EZPJ102 1KOHM 5%	J1201	6612M00010A	"Jack,Scart" PSC003-01 21P 21P/1C 3
R924	0RJ1002D677	"Resistor,Chip" MCR03EZPJ103 10KOHM 5%	J1201	6612M00010A	"Jack,Scart" PSC003-01 21P 21P/1C 3
R924	0RJ1002D677	"Resistor,Chip" MCR03EZPJ103 10KOHM 5%	D100	0DLLT0110AA	"LED,DIP" LTL-1BEHJ-1 ROUND 3MM
R925	0RJ1002D677	"Resistor,Chip" MCR03EZPJ103 10KOHM 5%	IC100	6712000013A	Receiver Module TSOP4438SO1 4.5T05.5V
R925	0RJ1002D677	"Resistor,Chip" MCR03EZPJ103 10KOHM 5%	IC201	SAA30310948	"S/W,Firmware" 4.17 5927 EUROPE FLASH
R926	0RJ3302D677	"Resistor,Chip" MCR03EZPJ333 33KOHM 5%	IC201	SAA30310948	"S/W,Firmware" 4.17 5927 EUROPE FLASH
R926	0RJ3302D677	"Resistor,Chip" MCR03EZPJ333 33KOHM 5%	IC802	SAA30310834	"S/W,Firmware" 5.23 DB20 EUROPE FLASH
R927	0RJ4701D677	"Resistor,Chip" MCR03EZPJ472 4.7KOHM 5	IC802	SAA30310834	"S/W,Firmware" 5.23 DB20 EUROPE FLASH
R927	0RJ4701D677	"Resistor,Chip" MCR03EZPJ472 4.7KOHM 5	SW100	EBF32593901	"Switch,Tact" TMUE312GAB 1C1P 12VDC
R928	0RJ0000D677	"Resistor,Chip" MCR03EZPJ000 0OHM 5% 1	SW100	EBF32593901	"Switch,Tact" TMUE312GAB 1C1P 12VDC
R928	0RJ0000D677	"Resistor,Chip" MCR03EZPJ000 0OHM 5% 1	SW101	140-313B	"Switch,Tact" KPT-1115AM 1C1P 12VDC
R930	0RJ1002D677	"Resistor,Chip" MCR03EZPJ103 10KOHM 5%	SW102	140-313B	"Switch,Tact" KPT-1115AM 1C1P 12VDC
R930	0RJ1002D677	"Resistor,Chip" MCR03EZPJ103 10KOHM 5%	SW103	140-313B	"Switch,Tact" KPT-1115AM 1C1P 12VDC
R932	0RJ1001D677	"Resistor,Chip" MCR03EZPJ102 1KOHM 5%	SW104	140-313B	"Switch,Tact" KPT-1115AM 1C1P 12VDC
R932	0RJ1001D677	"Resistor,Chip" MCR03EZPJ102 1KOHM 5%	SW105	140-313B	"Switch,Tact" KPT-1115AM 1C1P 12VDC
R933	0RJ1001D677	"Resistor,Chip" MCR03EZPJ102 1KOHM 5%	SW106	140-313B	"Switch,Tact" KPT-1115AM 1C1P 12VDC
R933	0RJ1001D677	"Resistor,Chip" MCR03EZPJ102 1KOHM 5%	SW107	140-313B	"Switch,Tact" KPT-1115AM 1C1P 12VDC
R934	0RJ1002D677	"Resistor,Chip" MCR03EZPJ103 10KOHM 5%	SW108	140-313B	"Switch,Tact" KPT-1115AM 1C1P 12VDC
R934	0RJ1002D677	"Resistor,Chip" MCR03EZPJ103 10KOHM 5%	SW700	EBF32593901	"Switch,Tact" TMUE312GAB 1C1P 12VDC
R935	0RJ0000D677	"Resistor,Chip" MCR03EZPJ000 0OHM 5% 1	SW700	EBF32593901	"Switch,Tact" TMUE312GAB 1C1P 12VDC
R935	0RJ0000D677	"Resistor,Chip" MCR03EZPJ000 0OHM 5% 1	TU600	EBL32961502	"Tuner,Digital" TDFC-G106P DVB-T/PAL 1
R936	0RJ0000D677	"Resistor,Chip" MCR03EZPJ000 0OHM 5% 1	TU600	EBL32961502	"Tuner,Digital" TDFC-G106P DVB-T/PAL 1
R936	0RJ0000D677	"Resistor,Chip" MCR03EZPJ000 0OHM 5% 1	<b>CONNECTOR</b>		
R937	0RJ0000D677	"Resistor,Chip" MCR03EZPJ000 0OHM 5% 1	J1100	6630G70016A	"Connector,DSUB" A03-7071-094 D-SUB 15P
R937	0RJ0000D677	"Resistor,Chip" MCR03EZPJ000 0OHM 5% 1			
R938	0RJ0000D677	"Resistor,Chip" MCR03EZPJ000 0OHM 5% 1			
R938	0RJ0000D677	"Resistor,Chip" MCR03EZPJ000 0OHM 5% 1			

LOC. NO.	PART NO.	DESCRIPTION / SPECIFICATION	LOC. NO.	PART NO.	DESCRIPTION / SPECIFICATION
J1100	6630G70016A	"Connector,DSUB" A03-7071-094 D-SUB 15P			
J1102	6630G70017A	"Connector,DSUB" A02-0915-101 D-SUB 9P			
J1102	6630G70017A	"Connector,DSUB" A02-0915-101 D-SUB 9P			
P100	6602T12005G	"Connector,Wafer" 12505WR-08A00 8P 1.25M			
P100	6602T20009C	"Connector,Wafer" SMAW200-04P 4P 2.00MM			
P101	6602T20009C	"Connector,Wafer" SMAW200-04P 4P 2.00MM			
P101	6602T20009N	"Connector,Wafer" SMAW200-14P 14P 2.00MM			
P1103	6602T12005G	"Connector,Wafer" 12505WR-08A00 8P 1.25M			
P1103	6602T12005G	"Connector,Wafer" 12505WR-08A00 8P 1.25M			
P1300	6602T25008B	"Connector,Wafer" SMW250-03P 3P 2.50MM 1			
P1300	6602T25008B	"Connector,Wafer" SMW250-03P 3P 2.50MM 1			
P1301	6602T25008C	"Connector,Wafer" SMW250-04P 4P 2.50MM 1			
P1301	6602T25008C	"Connector,Wafer" SMW250-04P 4P 2.50MM 1			
P1400	6602T20008N	"Connector,Wafer" SMW200-14P 14P 2.00MM			
P1400	6602T20008N	"Connector,Wafer" SMW200-14P 14P 2.00MM			
P800	6630V90116A	"Connector,Wafer" FI-X30SSL-HF 30P 1.00M			
P800	6630V90116A	"Connector,Wafer" FI-X30SSL-HF 30P 1.00M			
P900	6602T25008M	"Connector,Wafer" SMW250-13P 13P 2.50MM			
P900	6602T25008M	"Connector,Wafer" SMW250-13P 13P 2.50MM			
P901	6602T25008J	"Connector,Wafer" SMW250-10P 10P 2.50MM			
P901	6602T25008J	"Connector,Wafer" SMW250-10P 10P 2.50MM			
C1	6630V90142A	"Connector,Wafer" TPH254-R-1419-6A 6P 2.			
C2	6630V90142A	"Connector,Wafer" TPH254-R-1419-6A 6P 2.			
C3	6631900012C	"Harness,Single" 6631900012C SMH250 SMH			
C4	6631900019R	"Harness,Single" 4p spk(right) SMH250 T			
C5	6631T20033E	"Harness,Single" SMH200-14P SMH200-14P			
C6	6631T25023R	"Harness,Single" 6631T25023R SMH250 SMH			
C7	6631T25026B	"Harness,Single" 6631T25026B SMH250 350			
C8	EAD35683002	"Harness,Single" LVDS LPL STANDARD FI-X			
C9	EAD35908101	"Harness,Single" 35001HS-02L 65002HS-03			
C10	EAD35908402	"Harness,Single" High Power cable(UL PV			
C11	EAD35982701	"Harness,Single" SMH200-4P SMH200-4P 20			
C12	EAD35983001	"Harness,Single" 12507HS-04L SMH200 500			
C13	EAD35983201	"Harness,Single" 12505HS 12505HS 600MM			
C14	EAD36265201	"Harness,Single" 12505HS 12505HP 70MM 1			