

EXPLODED VIEW

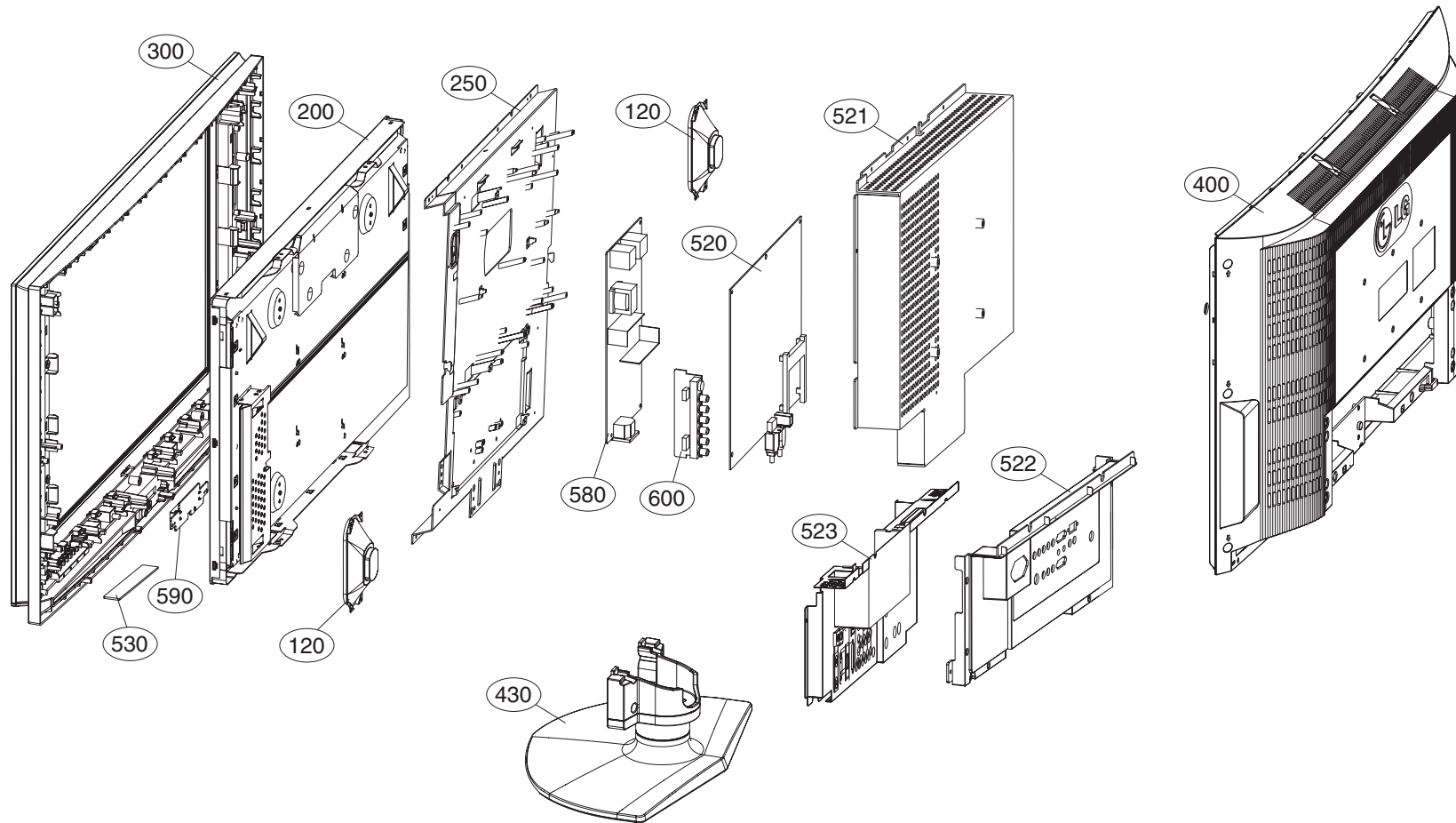

EXPLODED VIEW PARTS LIST

No.	PART NO.	DESCRIPTION
120	EAB30827201	Speaker,Fullrange C112K01K1450. FERRITE 15W 8OHM 83.5DB 170HZ 116 X 42 X 38.5 LUG
200	△ EAJ32763001	LCD,Module-TFT LC320W01-SL18 WXGA 32INCH 1366X768 500CD COLOR 72% 16/9
250	4951TKS222Q	Plate Assembly ASSY METAL,MAIN FRAME 32LX2R-ZJ,C/SKD
300	△ 3091TKE037W	Cover Assembly 32LX2R-ZE 1TONE SPRAY 32" 32LX2R-ZJ 1TONE CABINET ASSY C/SKD
400	△ 3809900197L	Cover Assembly 32LX2R-ZJ H3-M 32" 32LX2R-ZJ H3-M 3808TKE025 C/SKD
430	△ 3043TKK252E	Base Assembly 32LX2R . SILVER. C/SKD
520	EBU33408901	Main Total Assembly 32LX2R-ZJ BRAND LP61A LPL module
521	4951TKK238Q	Plate Assembly ASSY 32LX2R-ZJ H3-M METAL REAR ASSY C/SKD
522	ACQ31531702	Cover Assembly 32LX2R-ZJ H3-M 32" REAR AV BRACKET ASS'Y C/SKD
523	MGJ32266002	Plate,Shield PRESS SPTTE 0.5 AV SPTTE 32LX-ZJ METAL SHIELD A/V C/SKD
530	EBR33954901	PCB Assembly,Sub SUB T.T LP61A 32LX2R-ZJ . Local Key
580	△ 6709900016C	SMPS,AC/DC LGLP2637HEP 90VTO264V 215W 47TO63HZ UL/CSA/SEMKO YY / AT / H&E
590	EBR33414401	PCB Assembly,Sub SUB T.T LP61A 32LX2R-ZJ . Preamp+LED for DMS
600	EBR33416001	PCB Assembly,Sub SUB M.I LP61A 32LX2R-ZJ . Side AV

REPLACEMENT PARTS LIST

For Capacitor & Resistors, the characters at 2nd and 3rd digit in the P/No. means as follows;	CC, CX, CK, CN, CH : Ceramic CQ : Polyester CE : Electrolytic CF : Fixed Film	RD : Carbon Film RS : Metal Oxide Film RN : Metal Film RH : CHIP, Metal Glazed(Chip) RR : Drawing
---	--	---

DATE: 2006. 11. 23.				
*S	*AL	LOC. NO.	PART NO.	DESCRIPTION / SPECIFICATION
MAIN BOARD				
CAPACITOR				
			C1000	0CK104CK56A 0603B104K500CT 100nF 10% 50V
			C1001	0CE107WF6DC MVK6.3TP16VC100M 100uF 20% 1
			C1002	0CK104CK56A 0603B104K500CT 100nF 10% 50V
			C1003	0CE107WF6DC MVK6.3TP16VC100M 100uF 20% 1
			C1004	0CK104CK56A 0603B104K500CT 100nF 10% 50V
			C1006	0CK103CK56A 0603B103K500CT 10nF 10% 50V
			C1007	0CE107WF6DC MVK6.3TP16VC100M 100uF 20% 1
			C1009	0CE107WF6DC MVK6.3TP16VC100M 100uF 20% 1
			C1011	0CK103CK56A 0603B103K500CT 10nF 10% 50V
			C1012	0CK104CK56A 0603B104K500CT 100nF 10% 50V
			C1013	0CK104CK56A 0603B104K500CT 100nF 10% 50V
			C1014	0CK104CK56A 0603B104K500CT 100nF 10% 50V
			C1015	0CK104CK56A 0603B104K500CT 100nF 10% 50V
			C1016	0CE477EJ618 KMG5.0TP35VB470M 470uF 20% 3
			C1017	0CE477WF6DC MVK10TP16VC470M 470uF 20% 16
			C1018	0CE227WF6DC MVK8.0TP16VC220M 220uF 20% 1
			C1019	0CE477WF6DC MVK10TP16VC470M 470uF 20% 16
			C1020	0CE477EJ618 KMG5.0TP35VB470M 470uF 20% 3
			C1021	0CE227WF6DC MVK8.0TP16VC220M 220uF 20% 1
			C1022	0CK104CK56A 0603B104K500CT 100nF 10% 50V
			C1023	0CK104CK56A 0603B104K500CT 100nF 10% 50V
			C1024	0CK104CK56A 0603B104K500CT 100nF 10% 50V
			C1025	0CK104CK56A 0603B104K500CT 100nF 10% 50V
			C1026	0CK103CK56A 0603B103K500CT 10nF 10% 50V
			C1027	0CK104CK56A 0603B104K500CT 100nF 10% 50V
			C1029	0CK103CK56A 0603B103K500CT 10nF 10% 50V
			C1031	0CE107WF6DC MVK6.3TP16VC100M 100uF 20% 1
			C1036	0CK104CK56A 0603B104K500CT 100nF 10% 50V
			C1037	0CK104CK56A 0603B104K500CT 100nF 10% 50V
			C1038	0CE477WF6DC MVK10TP16VC470M 470uF 20% 16
			C1039	0CK103CK56A 0603B103K500CT 10nF 10% 50V
			C1040	0CE476WF6DC MVK6.3TP16VC47M 47uF 20% 16V
			C1043	0CK104CK56A 0603B104K500CT 100nF 10% 50V
			C1045	0CK104CK56A 0603B104K500CT 100nF 10% 50V
			C1046	0CE477WF6DC MVK10TP16VC470M 470uF 20% 16
			C1047	0CE107WF6DC MVK6.3TP16VC100M 100uF 20% 1
			C1048	0CE107WF6DC MVK6.3TP16VC100M 100uF 20% 1
			C1050	0CK104CK56A 0603B104K500CT 100nF 10% 50V
			C1051	0CK104CK56A 0603B104K500CT 100nF 10% 50V
			C1052	0CK104CK56A 0603B104K500CT 100nF 10% 50V
			C1054	0CK104CK56A 0603B104K500CT 100nF 10% 50V
			C1056	0CK103CK56A 0603B103K500CT 10nF 10% 50V
			C1057	0CK103CK56A 0603B103K500CT 10nF 10% 50V
			C1058	0CK103CK56A 0603B103K500CT 10nF 10% 50V
			C1059	0CK104CK56A 0603B104K500CT 100nF 10% 50V
			C1061	0CK103CK56A 0603B103K500CT 10nF 10% 50V
			C1063	0CK103CK56A 0603B103K500CT 10nF 10% 50V
			C1064	0CE107WF6DC MVK6.3TP16VC100M 100uF 20% 1
			C1065	0CE107WF6DC MVK6.3TP16VC100M 100uF 20% 1
			C1066	0CE107WF6DC MVK6.3TP16VC100M 100uF 20% 1
			C1068	0CE107WF6DC MVK6.3TP16VC100M 100uF 20% 1
			C1070	0CE476WF6DC MVK6.3TP16VC47M 47uF 20% 16V

DATE: 2006. 11. 23.				
*S	*AL	LOC. NO.	PART NO.	DESCRIPTION / SPECIFICATION
			C1072	0CK104CK56A 0603B104K500CT 100nF 10% 50V
			C1073	0CK103CK56A 0603B103K500CT 10nF 10% 50V
			C1074	0CE107WF6DC MVK6.3TP16VC100M 100uF 20% 1
			C111	0CK103CK56A 0603B103K500CT 10nF 10% 50V
			C112	0CC102CK41A C1608C0G1H102JT 1nF 5% 50V C
			C113	0CK103CK56A 0603B103K500CT 10nF 10% 50V
			C114	0CC102CK41A C1608C0G1H102JT 1nF 5% 50V C
			C115	0CK103CK56A 0603B103K500CT 10nF 10% 50V
			C116	0CC102CK41A C1608C0G1H102JT 1nF 5% 50V C
			C117	0CK103CK56A 0603B103K500CT 10nF 10% 50V
			C118	0CE227SF6DC MVG6.3TP16VC220M 220uF 20% 1
			C119	0CE227SF6DC MVG6.3TP16VC220M 220uF 20% 1
			C120	0CC102CK41A C1608C0G1H102JT 1nF 5% 50V C
			C124	0CE227SF6DC MVG6.3TP16VC220M 220uF 20% 1
			C125	0CE227SF6DC MVG6.3TP16VC220M 220uF 20% 1
			C126	0CE106WH6DC MVK5.0TP25VC10M 10uF 20% 25V
			C128	0CE106WH6DC MVK5.0TP25VC10M 10uF 20% 25V
			C131	0CE476WF6DC MVK6.3TP16VC47M 47uF 20% 16V
			C134	0CE106WH6DC MVK5.0TP25VC10M 10uF 20% 25V
			C135	0CE106WH6DC MVK5.0TP25VC10M 10uF 20% 25V
			C137	0CK104CK56A 0603B104K500CT 100nF 10% 50V
			C138	0CK104CK56A 0603B104K500CT 100nF 10% 50V
			C141	0CK104CK56A 0603B104K500CT 100nF 10% 50V
			C142	0CE476WF6DC MVK6.3TP16VC47M 47uF 20% 16V
			C163	0CK103CK56A 0603B103K500CT 10nF 10% 50V
			C164	0CK103CK56A 0603B103K500CT 10nF 10% 50V
			C172	0CK682CK51A C1608Y5P1H682KT 6.8nF 10% 50
			C173	0CK682CK51A C1608Y5P1H682KT 6.8nF 10% 50
			C174	0CK682CK51A C1608Y5P1H682KT 6.8nF 10% 50
			C175	0CK682CK51A C1608Y5P1H682KT 6.8nF 10% 50
			C309	0CK103CK56A 0603B103K500CT 10nF 10% 50V
			C310	0CK103CK56A 0603B103K500CT 10nF 10% 50V
			C311	0CC470CK41A C1608C0G1H470JT 47pF 5% 50V
			C312	0CK104CK56A 0603B104K500CT 100nF 10% 50V
			C313	0CE476WF6DC MVK6.3TP16VC47M 47uF 20% 16V
			C316	0CC120CK41A C1608C0G1H120JT 12pF 5% 50V
			C317	0CC120CK41A C1608C0G1H120JT 12pF 5% 50V
			C332	0CK104CK56A 0603B104K500CT 100nF 10% 50V
			C333	0CK104CK56A 0603B104K500CT 100nF 10% 50V
			C334	0CK104CK56A 0603B104K500CT 100nF 10% 50V
			C335	0CK104CK56A 0603B104K500CT 100nF 10% 50V
			C336	0CK104CK56A 0603B104K500CT 100nF 10% 50V
			C337	0CK104CK56A 0603B104K500CT 100nF 10% 50V
			C339	0CK104CK56A 0603B104K500CT 100nF 10% 50V
			C340	0CE107WF6DC MVK6.3TP16VC100M 100uF 20% 1
			C343	0CE476WF6DC MVK6.3TP16VC47M 47uF 20% 16V
			C345	0CE226WF6DC MVK5.0TP16VC22M 22uF 20% 16V
			C347	0CK104CF56A 0603B104K160CT 100nF 10% 16V
			C350	0CK103CK56A 0603B103K500CT 10nF 10% 50V
			C351	0CK104CK56A 0603B104K500CT 100nF 10% 50V
			C352	0CK104CK56A 0603B104K500CT 100nF 10% 50V
			C400	0CK104CK56A 0603B104K500CT 100nF 10% 50V
			C401	0CE476WF6DC MVK6.3TP16VC47M 47uF 20% 16V
			C406	0CK104CK56A 0603B104K500CT 100nF 10% 50V

DATE: 2006. 11. 23.				
*S	*AL	LOC. NO.	PART NO.	DESCRIPTION / SPECIFICATION
		C407	0CK104CK56A	0603B104K500CT 100nF 10% 50V
		C408	0CK104CK56A	0603B104K500CT 100nF 10% 50V
		C409	0CK104CK56A	0603B104K500CT 100nF 10% 50V
		C410	0CK102CK56A	0603B102K500CT 1nF 10% 50V X
		C411	0CK102CK56A	0603B102K500CT 1nF 10% 50V X
		C412	0CK104CK56A	0603B104K500CT 100nF 10% 50V
		C413	0CK104CK56A	0603B104K500CT 100nF 10% 50V
		C414	0CK104CK56A	0603B104K500CT 100nF 10% 50V
		C415	0CK104CK56A	0603B104K500CT 100nF 10% 50V
		C416	0CK104CK56A	0603B104K500CT 100nF 10% 50V
		C417	0CK102CK56A	0603B102K500CT 1nF 10% 50V X
		C419	0CK104CK56A	0603B104K500CT 100nF 10% 50V
		C420	0CK102CK56A	0603B102K500CT 1nF 10% 50V X
		C421	0CK104CK56A	0603B104K500CT 100nF 10% 50V
		C429	0CK822CK46A	0603B822J500CT 8.2nF 10% 50V
		C430	0CK823CF56A	0603B823K160CT 82nF 10% 16V
		C500	0CE477WF6DC	MVK10TP16VC470M 470uF 20% 16
		C502	0CE477WF6DC	MVK10TP16VC470M 470uF 20% 16
		C507	0CK103CK56A	0603B103K500CT 10nF 10% 50V
		C508	0CC270CK41A	C1608C0G1H270JT 27pF 5% 50V
		C509	0CC270CK41A	C1608C0G1H270JT 27pF 5% 50V
		C511	0CK103CK56A	0603B103K500CT 10nF 10% 50V
		C512	0CC101CK41A	C1608C0G1H101JT 100pF 5% 50V
		C513	0CE477WF6DC	MVK10TP16VC470M 470uF 20% 16
		C514	0CK273CK56A	0603B273K500CT 27nF 10% 50V
		C515	0CK103CK56A	0603B103K500CT 10nF 10% 50V
		C516	0CK104CK56A	0603B104K500CT 100nF 10% 50V
		C517	0CK273CK56A	0603B273K500CT 27nF 10% 50V
		C518	0CK104CK56A	0603B104K500CT 100nF 10% 50V
		C521	0CC271CK41A	C1608C0G1H271JT 270pF 5% 50V
		C525	0CE107WF6DC	MVK6.3TP16VC100M 100uF 20% 1
		C604	0CE227WF6DC	MVK8.0TP16VC220M 220uF 20% 1
		C605	0CK104CK56A	0603B104K500CT 100nF 10% 50V
		C606	0CK104CK56A	0603B104K500CT 100nF 10% 50V
		C607	0CK104CK56A	0603B104K500CT 100nF 10% 50V
		C608	0CK104CK56A	0603B104K500CT 100nF 10% 50V
		C609	0CK104CK56A	0603B104K500CT 100nF 10% 50V
		C610	0CK104CK56A	0603B104K500CT 100nF 10% 50V
		C611	0CK104CK56A	0603B104K500CT 100nF 10% 50V
		C612	0CK104CK56A	0603B104K500CT 100nF 10% 50V
		C613	0CK104CK56A	0603B104K500CT 100nF 10% 50V
		C614	0CK104CK56A	0603B104K500CT 100nF 10% 50V
		C615	0CK104CK56A	0603B104K500CT 100nF 10% 50V
		C616	0CK104CK56A	0603B104K500CT 100nF 10% 50V
		C617	0CK104CK56A	0603B104K500CT 100nF 10% 50V
		C618	0CK104CK56A	0603B104K500CT 100nF 10% 50V
		C619	0CK104CK56A	0603B104K500CT 100nF 10% 50V
		C620	0CK104CK56A	0603B104K500CT 100nF 10% 50V
		C621	0CK104CK56A	0603B104K500CT 100nF 10% 50V
		C622	0CK104CK56A	0603B104K500CT 100nF 10% 50V
		C623	0CK104CK56A	0603B104K500CT 100nF 10% 50V
		C624	0CK104CK56A	0603B104K500CT 100nF 10% 50V
		C625	0CK104CK56A	0603B104K500CT 100nF 10% 50V
		C626	0CK103CK56A	0603B103K500CT 10nF 10% 50V
		C627	0CK474CH94A	0603F474Z250CT 470nF -20TO+8
		C628	0CK474CH94A	0603F474Z250CT 470nF -20TO+8
		C629	0CE475WJ6DC	MVK4.0TP35VC4.7M 4.7uF 20% 3
		C630	0CK474CH94A	0603F474Z250CT 470nF -20TO+8
		C631	0CK474CH94A	0603F474Z250CT 470nF -20TO+8
		C632	0CK474CH94A	0603F474Z250CT 470nF -20TO+8
		C633	0CK103CK56A	0603B103K500CT 10nF 10% 50V
		C634	0CK474CH94A	0603F474Z250CT 470nF -20TO+8

DATE: 2006. 11. 23.				
*S	*AL	LOC. NO.	PART NO.	DESCRIPTION / SPECIFICATION
		C635	0CK474CH94A	0603F474Z250CT 470nF -20TO+8
		C636	0CK474CH94A	0603F474Z250CT 470nF -20TO+8
		C637	0CE335WK6D8	MVK4.0TP50VC3.3M 3.3uF 20% 5
		C638	0CK104CK56A	0603B104K500CT 100nF 10% 50V
		C643	0CK332CK56A	C1608X7R1H332KT 3.3nF 10% 50
		C645	0CK332CK56A	C1608X7R1H332KT 3.3nF 10% 50
		C647	0CK332CK56A	C1608X7R1H332KT 3.3nF 10% 50
		C648	0CK332CK56A	C1608X7R1H332KT 3.3nF 10% 50
		C649	0CK104CK56A	0603B104K500CT 100nF 10% 50V
		C650	0CK682CK51A	C1608Y5P1H682KT 6.8nF 10% 50
		C651	0CC560CK41A	C1608C0G1H560JT 56pF 5% 50V
		C652	0CC560CK41A	C1608C0G1H560JT 56pF 5% 50V
		C653	0CK682CK51A	C1608Y5P1H682KT 6.8nF 10% 50
		C654	0CK103CK56A	0603B103K500CT 10nF 10% 50V
		C655	0CC220CK41A	C1608C0G1H220JT 22pF 5% 50V
		C657	0CE226WF6DC	MVK5.0TP16VC22M 22uF 20% 16V
		C658	0CE226WF6DC	MVK5.0TP16VC22M 22uF 20% 16V
		C659	0CE226WF6DC	MVK5.0TP16VC22M 22uF 20% 16V
		C660	0CE226WF6DC	MVK5.0TP16VC22M 22uF 20% 16V
		C661	0CK104CK56A	0603B104K500CT 100nF 10% 50V
		C662	0CK225DK94A	CL21F225ZBFNNNE 2.2uF -20TO+
		C663	0CK104CK56A	0603B104K500CT 100nF 10% 50V
		C664	0CK104CK56A	0603B104K500CT 100nF 10% 50V
		C665	0CK225DK94A	CL21F225ZBFNNNE 2.2uF -20TO+
		C666	0CK225DD66A	LMK212JB225MG-T 2.2uF 20% 10
		C673	0CC220CK41A	C1608C0G1H220JT 22pF 5% 50V
		C674	0CC220CK41A	C1608C0G1H220JT 22pF 5% 50V
		C676	0CE226WF6DC	MVK5.0TP16VC22M 22uF 20% 16V
		C677	0CE226WF6DC	MVK5.0TP16VC22M 22uF 20% 16V
		C682	0CE226WF6DC	MVK5.0TP16VC22M 22uF 20% 16V
		C683	0CE226WF6DC	MVK5.0TP16VC22M 22uF 20% 16V
		C684	0CE226WF6DC	MVK5.0TP16VC22M 22uF 20% 16V
		C685	0CE226WF6DC	MVK5.0TP16VC22M 22uF 20% 16V
		C686	0CE226WF6DC	MVK5.0TP16VC22M 22uF 20% 16V
		C687	0CK104CK56A	0603B104K500CT 100nF 10% 50V
		C688	0CK104CK56A	0603B104K500CT 100nF 10% 50V
		C693	0CK104CK56A	0603B104K500CT 100nF 10% 50V
		C694	0CK104CK56A	0603B104K500CT 100nF 10% 50V
		C695	0CK104CK56A	0603B104K500CT 100nF 10% 50V
		C696	0CK104CK56A	0603B104K500CT 100nF 10% 50V
		C697	0CK104CK56A	0603B104K500CT 100nF 10% 50V
		C704	0CK104CK56A	0603B104K500CT 100nF 10% 50V
		C705	0CK104CK56A	0603B104K500CT 100nF 10% 50V
		C713	0CK104CK56A	0603B104K500CT 100nF 10% 50V
		C719	0CE226WF6DC	MVK5.0TP16VC22M 22uF 20% 16V
		C721	0CK104CK56A	0603B104K500CT 100nF 10% 50V
		C726	0CK104CK56A	0603B104K500CT 100nF 10% 50V
		C727	0CE226WF6DC	MVK5.0TP16VC22M 22uF 20% 16V
		C729	0CK104CK56A	0603B104K500CT 100nF 10% 50V
		C733	0CE226WF6DC	MVK5.0TP16VC22M 22uF 20% 16V
		C735	0CK104CK56A	0603B104K500CT 100nF 10% 50V
		C739	0CK104CK56A	0603B104K500CT 100nF 10% 50V
		C743	0CE226WF6DC	MVK5.0TP16VC22M 22uF 20% 16V
		C744	0CE226WF6DC	MVK5.0TP16VC22M 22uF 20% 16V
		C749	0CK104CK56A	0603B104K500CT 100nF 10% 50V
		C750	0CK225DK94A	CL21F225ZBFNNNE 2.2uF -20TO+
		C753	0CK104CK56A	0603B104K500CT 100nF 10% 50V
		C756	0CE476WF6DC	MVK6.3TP16VC47M 47uF 20% 16V
		C757	0CE106WH6DC	MVK5.0TP25VC10M 10uF 20% 25V
		C758	0CE476WF6DC	MVK6.3TP16VC47M 47uF 20% 16V
		C759	0CE476WF6DC	MVK6.3TP16VC47M 47uF 20% 16V
		C760	0CE476WF6DC	MVK6.3TP16VC47M 47uF 20% 16V

DATE: 2006. 11. 23.				
*S	*AL	LOC. NO.	PART NO.	DESCRIPTION / SPECIFICATION
		C761	0CE476WF6DC	MVK6.3TP16VC47M 47uF 20% 16V
		C762	0CE476WF6DC	MVK6.3TP16VC47M 47uF 20% 16V
		C763	0CE476WF6DC	MVK6.3TP16VC47M 47uF 20% 16V
		C764	0CK106EF56A	C3216X7R1C106KT 10uF 10% 16V
		C765	0CK106EF56A	C3216X7R1C106KT 10uF 10% 16V
		C766	0CK106EF56A	C3216X7R1C106KT 10uF 10% 16V
		C800	0CE107WF6DC	MVK6.3TP16VC100M 100uF 20% 1
		C801	0CK103CK56A	0603B103K500CT 10nF 10% 50V
		C802	0CE226WF6DC	MVK5.0TP16VC22M 22uF 20% 16V
		C803	0CK105CF94A	0603F105Z160CT 1uF -20TO+80%
		C804	0CK105CF94A	0603F105Z160CT 1uF -20TO+80%
		C806	0CK105CF94A	0603F105Z160CT 1uF -20TO+80%
		C807	0CK105CF94A	0603F105Z160CT 1uF -20TO+80%
		C816	0CK225DK94A	CL21F225ZBFNNE 2.2uF -20TO+
		C820	0CK225DK94A	CL21F225ZBFNNE 2.2uF -20TO+
		C821	0CK475EF67A	C3216X5R1C475MT 4.7uF 20% 16
		C822	0CK475EF67A	C3216X5R1C475MT 4.7uF 20% 16
		C823	0CK475EF67A	C3216X5R1C475MT 4.7uF 20% 16
		C824	0CK475EF67A	C3216X5R1C475MT 4.7uF 20% 16
		C825	0CK475EF67A	C3216X5R1C475MT 4.7uF 20% 16
		C827	0CC471CK41A	C1608C0G1H471JT 470pF 5% 50V
		C828	0CE107WK6DC	MVK10TP50VC100M 100uF 20% 50
		C829	0CC471CK41A	C1608C0G1H471JT 470pF 5% 50V
		C830	0CK103CK56A	0603B103K500CT 10nF 10% 50V
		C831	0CK475EF67A	C3216X5R1C475MT 4.7uF 20% 16
		C832	0CK475EF67A	C3216X5R1C475MT 4.7uF 20% 16
		C833	0CK475EF67A	C3216X5R1C475MT 4.7uF 20% 16
		C834	0CK475EF67A	C3216X5R1C475MT 4.7uF 20% 16
		C835	0CK475EF67A	C3216X5R1C475MT 4.7uF 20% 16
		C836	0CK104CK56A	0603B104K500CT 100nF 10% 50V
		C838	0CK104CK56A	0603B104K500CT 100nF 10% 50V
		C839	0CK104CK56A	0603B104K500CT 100nF 10% 50V
		C840	0CK102CK56A	0603B102K500CT 1nF 10% 50V X
		C842	0CK102CK56A	0603B102K500CT 1nF 10% 50V X
		C845	0CK474CH94A	0603F474Z250CT 470nF -20TO+8
		C848	0CK104CK56A	0603B104K500CT 100nF 10% 50V
		C849	0CK474CH94A	0603F474Z250CT 470nF -20TO+8
		C850	0CK104CK56A	0603B104K500CT 100nF 10% 50V
		C851	0CK105CF94A	0603F105Z160CT 1uF -20TO+80%
		C853	0CK103CK56A	0603B103K500CT 10nF 10% 50V
		C854	0CK224CF56A	0603B224K160CT 220nF 10% 16V
		C855	0CK224CF56A	0603B224K160CT 220nF 10% 16V
		C856	0CK105CF94A	0603F105Z160CT 1uF -20TO+80%
		C857	0CK105CF94A	0603F105Z160CT 1uF -20TO+80%
		C858	0CK105CF94A	0603F105Z160CT 1uF -20TO+80%
		C859	0CK105CF94A	0603F105Z160CT 1uF -20TO+80%
		C860	0CE227WJ6DC	MVK10TP35VC220M 220uF 20% 35
		C861	0CE227WJ6DC	MVK10TP35VC220M 220uF 20% 35
		C862	0CK105CF94A	0603F105Z160CT 1uF -20TO+80%
		C863	0CE106WH6DC	MVK5.0TP25VC10M 10uF 20% 25V
		C864	0CK224CF56A	0603B224K160CT 220nF 10% 16V
		C865	0CK224CF56A	0603B224K160CT 220nF 10% 16V
		C866	0CK682CK51A	C1608Y5P1H682KT 6.8nF 10% 50
		C867	0CK682CK51A	C1608Y5P1H682KT 6.8nF 10% 50
		C868	0CE475WJ6DC	MVK4.0TP35VC4.7M 4.7uF 20% 3
		C869	0CE475WJ6DC	MVK4.0TP35VC4.7M 4.7uF 20% 3
		C871	0CC270CK41A	C1608C0G1H270JT 27pF 5% 50V
		C906	0CK104CK56A	0603B104K500CT 100nF 10% 50V
		C908	0CK474CH94A	0603F474Z250CT 470nF -20TO+8
		C912	0CE476WF6DC	MVK6.3TP16VC47M 47uF 20% 16V
		C915	0CK474CH94A	0603F474Z250CT 470nF -20TO+8
		C916	0CK104CK56A	0603B104K500CT 100nF 10% 50V

DATE: 2006. 11. 23.				
*S	*AL	LOC. NO.	PART NO.	DESCRIPTION / SPECIFICATION
		C917	0CE477WF6DC	MVK10TP16VC470M 470uF 20% 16
		C919	0CK104CK56A	0603B104K500CT 100nF 10% 50V
		C921	0CK103CK56A	0603B103K500CT 10nF 10% 50V
		C922	0CE476WF6DC	MVK6.3TP16VC47M 47uF 20% 16V
		C926	0CK104CK56A	0603B104K500CT 100nF 10% 50V
		C927	0CK104CK56A	0603B104K500CT 100nF 10% 50V
		C928	0CK103CK56A	0603B103K500CT 10nF 10% 50V
		C929	0CK103CK56A	0603B103K500CT 10nF 10% 50V
		C930	0CK104CK56A	0603B104K500CT 100nF 10% 50V
		C931	0CE476WF6DC	MVK6.3TP16VC47M 47uF 20% 16V
		C932	0CE476WF6DC	MVK6.3TP16VC47M 47uF 20% 16V
		C933	0CE477WF6DC	MVK10TP16VC470M 470uF 20% 16
		C934	0CK104CK56A	0603B104K500CT 100nF 10% 50V
		C935	0CE477WF6DC	MVK10TP16VC470M 470uF 20% 16
		C936	0CK104CK56A	0603B104K500CT 100nF 10% 50V
		C937	0CK104CK56A	0603B104K500CT 100nF 10% 50V
		C938	0CK104CK56A	0603B104K500CT 100nF 10% 50V
		C939	0CE477WF6DC	MVK10TP16VC470M 470uF 20% 16
		C941	0CK103CK56A	0603B103K500CT 10nF 10% 50V
		C942	0CK103CK56A	0603B103K500CT 10nF 10% 50V
		C943	0CK103CK56A	0603B103K500CT 10nF 10% 50V
		C945	0CK104CK56A	0603B104K500CT 100nF 10% 50V
		C946	0CE107WF6DC	MVK6.3TP16VC100M 100uF 20% 1
		C947	0CE107WF6DC	MVK6.3TP16VC100M 100uF 20% 1
		C948	0CE107WF6DC	MVK6.3TP16VC100M 100uF 20% 1
		C949	0CK103CK56A	0603B103K500CT 10nF 10% 50V
		C950	0CK104CK56A	0603B104K500CT 100nF 10% 50V
		C951	0CE477WF6DC	MVK10TP16VC470M 470uF 20% 16
		C953	0CE477WF6DC	MVK10TP16VC470M 470uF 20% 16
		C955	0CE107WF6DC	MVK6.3TP16VC100M 100uF 20% 1
		C957	0CK104CK56A	0603B104K500CT 100nF 10% 50V
		C958	0CK104CK56A	0603B104K500CT 100nF 10% 50V
		C959	0CK104CK56A	0603B104K500CT 100nF 10% 50V
		C960	0CK104CK56A	0603B104K500CT 100nF 10% 50V
		C961	0CK104CK56A	0603B104K500CT 100nF 10% 50V
		C962	0CK104CK56A	0603B104K500CT 100nF 10% 50V
		C963	0CK104CK56A	0603B104K500CT 100nF 10% 50V
		C964	0CK104CK56A	0603B104K500CT 100nF 10% 50V
		C965	0CK104CK56A	0603B104K500CT 100nF 10% 50V
		C967	0CK103CK56A	0603B103K500CT 10nF 10% 50V
		C968	0CK103CK56A	0603B103K500CT 10nF 10% 50V
		C969	0CK103CK56A	0603B103K500CT 10nF 10% 50V
		C970	0CK103CK56A	0603B103K500CT 10nF 10% 50V
		C972	0CK103CK56A	0603B103K500CT 10nF 10% 50V
		C973	0CK103CK56A	0603B103K500CT 10nF 10% 50V
		C974	0CK103CK56A	0603B103K500CT 10nF 10% 50V
		C975	0CK103CK56A	0603B103K500CT 10nF 10% 50V
		C976	0CK103CK56A	0603B103K500CT 10nF 10% 50V
		C978	0CE476WF6DC	MVK6.3TP16VC47M 47uF 20% 16V
		C979	0CE476WF6DC	MVK6.3TP16VC47M 47uF 20% 16V
		C980	0CE476WF6DC	MVK6.3TP16VC47M 47uF 20% 16V
		C981	0CE476WF6DC	MVK6.3TP16VC47M 47uF 20% 16V
		C982	0CE476WF6DC	MVK6.3TP16VC47M 47uF 20% 16V
		C983	0CE476WF6DC	MVK6.3TP16VC47M 47uF 20% 16V
		C984	0CE476WF6DC	MVK6.3TP16VC47M 47uF 20% 16V
		C985	0CE476WF6DC	MVK6.3TP16VC47M 47uF 20% 16V
		C986	0CE476WF6DC	MVK6.3TP16VC47M 47uF 20% 16V
		C988	0CE106WH6DC	MVK5.0TP25VC10M 10uF 20% 25V
		C989	0CK103CK56A	0603B103K500CT 10nF 10% 50V

DATE: 2006. 11. 23.				
*S	*AL	LOC. NO.	PART NO.	DESCRIPTION / SPECIFICATION
DIODES				
		D1001	0DS226009AA	KDS226 1.2V 85V 300MA 2A 4NS
		D1003	0DS226009AA	KDS226 1.2V 85V 300MA 2A 4NS
		D101	0DS226009AA	KDS226 1.2V 85V 300MA 2A 4NS
		D102	0DS226009AA	KDS226 1.2V 85V 300MA 2A 4NS
		D107	0DS226009AA	KDS226 1.2V 85V 300MA 2A 4NS
		D108	0DS226009AA	KDS226 1.2V 85V 300MA 2A 4NS
		D109	0DS226009AA	KDS226 1.2V 85V 300MA 2A 4NS
		D110	0DS226009AA	KDS226 1.2V 85V 300MA 2A 4NS
		D111	0DS226009AA	KDS226 1.2V 85V 300MA 2A 4NS
		D116	0DS226009AA	KDS226 1.2V 85V 300MA 2A 4NS
		D121	0DS226009AA	KDS226 1.2V 85V 300MA 2A 4NS
		D124	0DS226009AA	KDS226 1.2V 85V 300MA 2A 4NS
		D125	0DS226009AA	KDS226 1.2V 85V 300MA 2A 4NS
		D126	0DS226009AA	KDS226 1.2V 85V 300MA 2A 4NS
		D127	0DS226009AA	KDS226 1.2V 85V 300MA 2A 4NS
		D129	0DRSE00038A	SDC15 1.3V 14.3VTO16.4V 21.2
		D300	0DS226009AA	KDS226 1.2V 85V 300MA 2A 4NS
		D302	0DS226009AA	KDS226 1.2V 85V 300MA 2A 4NS
		D303	0DS226009AA	KDS226 1.2V 85V 300MA 2A 4NS
		D304	0DS226009AA	KDS226 1.2V 85V 300MA 2A 4NS
		D400	0DD184009AA	KDS184 KDS184 TP KEC - 85V -
		D800	0DD184009AA	KDS184 KDS184 TP KEC - 85V -
		D801	0DD184009AA	KDS184 KDS184 TP KEC - 85V -
		D900	0DS226009AA	KDS226 1.2V 85V 300MA 2A 4NS
		D902	0DS226009AA	KDS226 1.2V 85V 300MA 2A 4NS
		D903	0DS226009AA	KDS226 1.2V 85V 300MA 2A 4NS
		D905	0DD200009AF	RU2M 400V 1.2V 10UA 20A 400N
		D906	0DD200009AF	RU2M 400V 1.2V 10UA 20A 400N
		D907	0DD200009AF	RU2M 400V 1.2V 10UA 20A 400N
		ZD1000	0DZKE00048A	KDZ8.2V 8.2V 7.7TO8.7V 20OHHM
		ZD300	0DR050008AA	SD05.TC - 6V 14.5V 24A 350W
		ZD301	0DR050008AA	SD05.TC - 6V 14.5V 24A 350W
		ZD303	0DR050008AA	SD05.TC - 6V 14.5V 24A 350W
		ZD304	0DR050008AA	SD05.TC - 6V 14.5V 24A 350W
		ZD305	0DR050008AA	SD05.TC - 6V 14.5V 24A 350W
		ZD308	0DR050008AA	SD05.TC - 6V 14.5V 24A 350W
		ZD312	0DR050008AA	SD05.TC - 6V 14.5V 24A 350W
		ZD313	0DR050008AA	SD05.TC - 6V 14.5V 24A 350W
		ZD314	0DR050008AA	SD05.TC - 6V 14.5V 24A 350W
IC				
		IC1001	0IPMGKE030A	KIA78R05F 6TO12V 5V 8W DPAK
		IC1003	0IMCRFA010A	KA7809R 11.5TO24V 9V 150W DP
		IC1008	0IPMGSG018D	LD1086DT18TR-LF 30V 1.8V - D
		IC300	0IMMRAL014D	AT24C02BN-10SU-1.8 2KBIT 256
		IC302	0IPRP00009A	ICL3232CBNZ 3VTO5.5V - SSOP
		IC303	0ISTL00031A	MC74HC4066ADR2G MC74HC4066AD
		IC400	0IMMRAL014D	AT24C02BN-10SU-1.8 2KBIT 256
		IC401	0IPRP00701A	"AD9381KSTZ 3.15VTO3.47V,1.7V"
		IC600	0IFA752700A	KA75270Z 2.55TO2.85V 0 200MW
		IC601	0IPRP00689B	VCT6973G-FA-B3-000 1.71VTO1.
		IC602	0IFA742530B	74ACT253SC 4.5TO5.5V 0.004mA
		IC603	0IMMRAL025A	AT24C32AN-10SU-2.7 32KBIT 40
		IC800	0IPRP00665A	TEA6420D 8TO10.2V 8mA 0 SO R
		IC801	0IPRP00700A	TPA3100D2PHPR 10TO26V . . 20
		IC802	0IPRP00743A	MAD4868A 3TO5.25V 0 0 PQFP T
		IC900	0IMCRRH001A	BA033FP-E2 4.3TO25V 3.3V 1W
		IC902	0IPMG00027A	SC156515M-1.8TR 2.2TO5.5V 1.
		IC903	0IMCRRH001A	BA033FP-E2 4.3TO25V 3.3V 1W
			SAA30004217	V3.21 57C7 EUROPE FLASH LCD

DATE: 2006. 11. 23.				
*S	*AL	LOC. NO.	PART NO.	DESCRIPTION / SPECIFICATION
COIL & CORE & INDUCTOR				
			AR400	6210TCE002B HB-4M3216-121JT 120OHM 3.2X1
			AR401	6210TCE002B HB-4M3216-121JT 120OHM 3.2X1
			AR402	6210TCE002B HB-4M3216-121JT 120OHM 3.2X1
			AR403	6210TCE002B HB-4M3216-121JT 120OHM 3.2X1
			AR404	6210TCE002B HB-4M3216-121JT 120OHM 3.2X1
			AR405	6210TCE002B HB-4M3216-121JT 120OHM 3.2X1
			IC604	0TF492509AA SI4925DY P-CHANNEL -30V +-20
			L100	6200J00005R HB-1M1608-501JT 500OHM 1.6X0
			L1000	EAM30764101 MBW3216-501TF 500ohm 3.2X1.6
			L1002	EAM30764101 MBW3216-501TF 500ohm 3.2X1.6
			L1004	6140VB0004B LN-15A1 26uH AC500V 5MA 12X9
			L1007	EAM30764101 MBW3216-501TF 500ohm 3.2X1.6
			L1008	EAM30764101 MBW3216-501TF 500ohm 3.2X1.6
			L101	6200J00005R HB-1M1608-501JT 500OHM 1.6X0
			L1010	EAM30764101 MBW3216-501TF 500ohm 3.2X1.6
			L1011	EAM30764101 MBW3216-501TF 500ohm 3.2X1.6
			L1012	EAM30764101 MBW3216-501TF 500ohm 3.2X1.6
			L1015	EAM30764101 MBW3216-501TF 500ohm 3.2X1.6
			L1016	EAM30764101 MBW3216-501TF 500ohm 3.2X1.6
			L1018	EAM30764101 MBW3216-501TF 500ohm 3.2X1.6
			L102	0LCML00020G MLI-201209-3R3K 3.3UH 10% 0V
			L103	0LCML00020G MLI-201209-3R3K 3.3UH 10% 0V
			L104	0LCML00020G MLI-201209-3R3K 3.3UH 10% 0V
			L105	0LCML00020G MLI-201209-3R3K 3.3UH 10% 0V
			L106	0LCML00020G MLI-201209-3R3K 3.3UH 10% 0V
			L107	0LCML00020G MLI-201209-3R3K 3.3UH 10% 0V
			L108	0LCML00020G MLI-201209-3R3K 3.3UH 10% 0V
			L109	0LCML00020G MLI-201209-3R3K 3.3UH 10% 0V
			L110	6200J00005R HB-1M1608-501JT 500OHM 1.6X0
			L111	6200J00005R HB-1M1608-501JT 500OHM 1.6X0
			L112	6200J00005F HB-1M1608-102JT 1000OHM 1.6X
			L113	6200J00005F HB-1M1608-102JT 1000OHM 1.6X
			L119	0LCML00020G MLI-201209-3R3K 3.3UH 10% 0V
			L120	0LCML00020G MLI-201209-3R3K 3.3UH 10% 0V
			L300	EAM30764201 BG2012B102TF 1000ohm 2.0X1.2
			L301	EAM30764201 BG2012B102TF 1000ohm 2.0X1.2
			L302	EAM30764101 MBW3216-501TF 500ohm 3.2X1.6
			L303	EAM30764101 MBW3216-501TF 500ohm 3.2X1.6
			L304	6210TCE001E HB-1M2012-800JT 80OHM 2X1.25
			L305	EAM30764101 MBW3216-501TF 500ohm 3.2X1.6
			L306	6210TCE001P HB-1S2012-121JT 120OHM 2X1.2
			L307	6210TCE001P HB-1S2012-121JT 120OHM 2X1.2
			L308	6210TCE001P HB-1S2012-121JT 120OHM 2X1.2
			L309	6210TCE001P HB-1S2012-121JT 120OHM 2X1.2
			L310	6210TCE001P HB-1S2012-121JT 120OHM 2X1.2
			L400	EAM30764101 MBW3216-501TF 500ohm 3.2X1.6
			L501	EAM30764101 MBW3216-501TF 500ohm 3.2X1.6
			L502	EAM30764101 MBW3216-501TF 500ohm 3.2X1.6
			L503	0LCML00020G MLI-201209-3R3K 3.3UH 10% 0V
			L600	6200J00005R HB-1M1608-501JT 500OHM 1.6X0
			L601	6200J00005R HB-1M1608-501JT 500OHM 1.6X0
			L801	6140VR0008A SLF12575T-330M3R2 33UH 20% -
			L802	6140VR0008A SLF12575T-330M3R2 33UH 20% -
			L804	0LCML00020C MLI-201212-100K 10UH 10% - 1
			L805	0LCML00020C MLI-201212-100K 10UH 10% - 1
			L806	EAM30764101 MBW3216-501TF 500ohm 3.2X1.6
			L808	6140VR0008A SLF12575T-330M3R2 33UH 20% -
			L809	6140VR0008A SLF12575T-330M3R2 33UH 20% -
			L813	EAM30764101 MBW3216-501TF 500ohm 3.2X1.6
			L814	EAM30764101 MBW3216-501TF 500ohm 3.2X1.6
			L815	6210TCE001P HB-1S2012-121JT 120OHM 2X1.2

DATE: 2006. 11. 23.				
*S	*AL	LOC. NO.	PART NO.	DESCRIPTION / SPECIFICATION
		L816	6210TCE001P	HB-1S2012-121JT 120OHM 2X1.2
		L817	6210TCE001P	HB-1S2012-121JT 120OHM 2X1.2
		L818	6210TCE001P	HB-1S2012-121JT 120OHM 2X1.2
		L819	EAM30764101	MBW3216-501TF 500ohm 3.2X1.6
		L820	EAM30764101	MBW3216-501TF 500ohm 3.2X1.6
		L904	EAM30764101	MBW3216-501TF 500ohm 3.2X1.6
		L905	EAM30764101	MBW3216-501TF 500ohm 3.2X1.6
		L906	EAM30764101	MBW3216-501TF 500ohm 3.2X1.6
		L910	6140VB0004B	LN-15A1 26uH AC500V 5MA 12X9
		L913	EAM30764101	MBW3216-501TF 500ohm 3.2X1.6
		L914	EAM30764101	MBW3216-501TF 500ohm 3.2X1.6
		L915	EAM30764101	MBW3216-501TF 500ohm 3.2X1.6
		L916	EAM30764101	MBW3216-501TF 500ohm 3.2X1.6
		L917	EAM30764101	MBW3216-501TF 500ohm 3.2X1.6
		L918	EAM30764101	MBW3216-501TF 500ohm 3.2X1.6
		L919	EAM30764101	MBW3216-501TF 500ohm 3.2X1.6
		L920	EAM30764101	MBW3216-501TF 500ohm 3.2X1.6
		L921	EAM30764101	MBW3216-501TF 500ohm 3.2X1.6
		L922	6210TCE001P	HB-1S2012-121JT 120OHM 2X1.2
		L923	6210TCE001P	HB-1S2012-121JT 120OHM 2X1.2
		L924	EAM30764101	MBW3216-501TF 500ohm 3.2X1.6

FET & TRANSISTOR

		Q100	0TR387500AA	2SC3875S(ALY) NPN 5V 60V 50V
		Q101	0TR387500AA	2SC3875S(ALY) NPN 5V 60V 50V
		Q102	0TR387500AA	2SC3875S(ALY) NPN 5V 60V 50V
		Q103	0TR387500AA	2SC3875S(ALY) NPN 5V 60V 50V
		Q105	0TR387500AA	2SC3875S(ALY) NPN 5V 60V 50V
		Q106	0TR387500AA	2SC3875S(ALY) NPN 5V 60V 50V
		Q110	0TR387500AA	2SC3875S(ALY) NPN 5V 60V 50V
		Q111	0TR387500AA	2SC3875S(ALY) NPN 5V 60V 50V
		Q112	0TR387500AA	2SC3875S(ALY) NPN 5V 60V 50V
		Q113	0TR387500AA	2SC3875S(ALY) NPN 5V 60V 50V
		Q300	0TR387500AA	2SC3875S(ALY) NPN 5V 60V 50V
		Q301	0TR387500AA	2SC3875S(ALY) NPN 5V 60V 50V
		Q400	0TR387500AA	2SC3875S(ALY) NPN 5V 60V 50V
		Q401	0TR830009BA	BSS83 N-CHANNEL MOSFET 10V -
		Q402	0TR830009BA	BSS83 N-CHANNEL MOSFET 10V -
		Q502	0TR387500AA	2SC3875S(ALY) NPN 5V 60V 50V
		Q503	0TR150400BA	2SA1504S(ASY) PNP -5V -50V -
		Q504	0TR387500AA	2SC3875S(ALY) NPN 5V 60V 50V
		Q505	0TR150400BA	2SA1504S(ASY) PNP -5V -50V -
		Q506	0TR150400BA	2SA1504S(ASY) PNP -5V -50V -
		Q507	0TR387500AA	2SC3875S(ALY) NPN 5V 60V 50V
		Q508	0TR830009BA	BSS83 N-CHANNEL MOSFET 10V -
		Q509	0TR830009BA	BSS83 N-CHANNEL MOSFET 10V -
		Q510	0TR150400BA	2SA1504S(ASY) PNP -5V -50V -
		Q511	0TR150400BA	2SA1504S(ASY) PNP -5V -50V -
		Q512	0TR387500AA	2SC3875S(ALY) NPN 5V 60V 50V
		Q513	0TR387500AA	2SC3875S(ALY) NPN 5V 60V 50V
		Q600	0TR387500AA	2SC3875S(ALY) NPN 5V 60V 50V
		Q605	0TR102009AM	KRA102S PNP -30V - -50V -0.1
		Q606	0TR150400BA	2SA1504S(ASY) PNP -5V -50V -
		Q607	0TR387500AA	2SC3875S(ALY) NPN 5V 60V 50V
		Q608	0TR150400BA	2SA1504S(ASY) PNP -5V -50V -
		Q611	0TR387500AA	2SC3875S(ALY) NPN 5V 60V 50V
		Q613	0TR150400BA	2SA1504S(ASY) PNP -5V -50V -
		Q801	0TR387500AA	2SC3875S(ALY) NPN 5V 60V 50V
		Q802	0TR387500AA	2SC3875S(ALY) NPN 5V 60V 50V
		Q901	0TR387500AA	2SC3875S(ALY) NPN 5V 60V 50V
		Q902	0TR387500AA	2SC3875S(ALY) NPN 5V 60V 50V

DATE: 2006. 11. 23.				
*S	*AL	LOC. NO.	PART NO.	DESCRIPTION / SPECIFICATION
			Q903	0TR387500AA 2SC3875S(ALY) NPN 5V 60V 50V
			Q904	0TR387500AA 2SC3875S(ALY) NPN 5V 60V 50V
			Q905	0TR387500AA 2SC3875S(ALY) NPN 5V 60V 50V
			Q906	0TR387500AA 2SC3875S(ALY) NPN 5V 60V 50V
			Q907	0TR387500AA 2SC3875S(ALY) NPN 5V 60V 50V
			Q908	0TR387500AA 2SC3875S(ALY) NPN 5V 60V 50V
			X600	6202VDT002P HC-49/SM 20.2500MHZ 20.25MH

RESISTORS

			AR600	0RJ0222C687 RCA86TRJ22R0 220OHM 5% 1/16W
			AR601	0RJ0222C687 RCA86TRJ22R0 220OHM 5% 1/16W
			AR602	0RJ0222C687 RCA86TRJ22R0 220OHM 5% 1/16W
			C644	0RJ0000D677 MCR03EZPJ000 0OHM 5% 1/10W 1
			C646	0RJ0000D677 MCR03EZPJ000 0OHM 5% 1/10W 1
			R100	0RJ0752D677 MCR03EZPJ750 750OHM 5% 1/10W
			R1000	0RJ1201D677 MCR03EZPJ122 1.2KOHM 5% 1/10
			R1001	0RJ0752D677 MCR03EZPJ750 750OHM 5% 1/10W
			R1002	0RJ0752D677 MCR03EZPJ750 750OHM 5% 1/10W
			R1003	0RJ1002D677 MCR03EZPJ103 10KOHM 5% 1/10W
			R1008	0RJ0000D677 MCR03EZPJ000 0OHM 5% 1/10W 1
			R101	0RJ0752D677 MCR03EZPJ750 750OHM 5% 1/10W
			R1010	0RJ0000D677 MCR03EZPJ000 0OHM 5% 1/10W 1
			R102	0RJ0000D677 MCR03EZPJ000 0OHM 5% 1/10W 1
			R103	0RJ0752D677 MCR03EZPJ750 750OHM 5% 1/10W
			R104	0RJ9101D677 MCR03EZPJ912 9.1KOHM 5% 1/10
			R105	0RJ0752D677 MCR03EZPJ750 750OHM 5% 1/10W
			R106	0RJ4701D677 MCR03EZPJ472 4.7KOHM 5% 1/10
			R107	0RJ0752D677 MCR03EZPJ750 750OHM 5% 1/10W
			R108	0RJ1002D677 MCR03EZPJ103 10KOHM 5% 1/10W
			R109	0RJ3601D677 MCR03EZPJ362 3.6KOHM 5% 1/10
			R110	0RJ9101D677 MCR03EZPJ912 9.1KOHM 5% 1/10
			R111	0RJ0000D677 MCR03EZPJ000 0OHM 5% 1/10W 1
			R112	0RJ0752D677 MCR03EZPJ750 750OHM 5% 1/10W
			R113	0RJ0752D677 MCR03EZPJ750 750OHM 5% 1/10W
			R114	0RJ0000D677 MCR03EZPJ000 0OHM 5% 1/10W 1
			R115	0RJ0000D677 MCR03EZPJ000 0OHM 5% 1/10W 1
			R116	0RJ0000D677 MCR03EZPJ000 0OHM 5% 1/10W 1
			R117	0RJ2203D677 MCR03EZPJ224 220KOHM 5% 1/10
			R119	0RJ2203D677 MCR03EZPJ224 220KOHM 5% 1/10
			R121	0RJ2203D677 MCR03EZPJ224 220KOHM 5% 1/10
			R123	0RJ2203D677 MCR03EZPJ224 220KOHM 5% 1/10
			R125	0RJ0000D677 MCR03EZPJ000 0OHM 5% 1/10W 1
			R126	0RJ0000D677 MCR03EZPJ000 0OHM 5% 1/10W 1
			R127	0RJ0000D677 MCR03EZPJ000 0OHM 5% 1/10W 1
			R128	0RJ3601D677 MCR03EZPJ362 3.6KOHM 5% 1/10
			R129	0RJ2203D677 MCR03EZPJ224 220KOHM 5% 1/10
			R130	0RJ4703D677 MCR03EZPJ474 470KOHM 5% 1/10
			R131	0RJ0752D677 MCR03EZPJ750 750OHM 5% 1/10W
			R132	0RJ2203D677 MCR03EZPJ224 220KOHM 5% 1/10
			R133	0RJ4703D677 MCR03EZPJ474 470KOHM 5% 1/10
			R134	0RJ2203D677 MCR03EZPJ224 220KOHM 5% 1/10
			R135	0RJ4703D677 MCR03EZPJ474 470KOHM 5% 1/10
			R136	0RJ2203D677 MCR03EZPJ224 220KOHM 5% 1/10
			R137	0RJ4703D677 MCR03EZPJ474 470KOHM 5% 1/10
			R138	0RJ1001D677 MCR03EZPJ102 1KOHM 5% 1/10W
			R139	0RJ1001D677 MCR03EZPJ102 1KOHM 5% 1/10W
			R140	0RJ0000D677 MCR03EZPJ000 0OHM 5% 1/10W 1
			R141	0RJ0752D677 MCR03EZPJ750 750OHM 5% 1/10W
			R142	0RJ1001D677 MCR03EZPJ102 1KOHM 5% 1/10W
			R143	0RJ0000D677 MCR03EZPJ000 0OHM 5% 1/10W 1
			R144	0RJ1001D677 MCR03EZPJ102 1KOHM 5% 1/10W

DATE: 2006. 11. 23.				
*S	*AL	LOC. NO.	PART NO.	DESCRIPTION / SPECIFICATION
		R145	0RJ1001D677	MCR03EZPJ102 1KOHM 5% 1/10W
		R146	0RJ1001D677	MCR03EZPJ102 1KOHM 5% 1/10W
		R147	0RJ1001D677	MCR03EZPJ102 1KOHM 5% 1/10W
		R148	0RJ1001D677	MCR03EZPJ102 1KOHM 5% 1/10W
		R149	0RJ2000D677	MCR03EZPJ201 200OHM 5% 1/10W
		R150	0RJ0000D677	MCR03EZPJ000 0OHM 5% 1/10W 1
		R151	0RJ0000D677	MCR03EZPJ000 0OHM 5% 1/10W 1
		R152	0RJ0000D677	MCR03EZPJ000 0OHM 5% 1/10W 1
		R154	0RJ0000D677	MCR03EZPJ000 0OHM 5% 1/10W 1
		R159	0RJ2001D677	MCR03EZPJ202 2KOHM 5% 1/10W
		R160	0RJ2001D677	MCR03EZPJ202 2KOHM 5% 1/10W
		R161	0RJ6801D677	MCR03EZPJ682 6.8KOHM 5% 1/10
		R162	0RJ0000D677	MCR03EZPJ000 0OHM 5% 1/10W 1
		R163	0RJ4701D677	MCR03EZPJ472 4.7KOHM 5% 1/10
		R164	0RJ2001D677	MCR03EZPJ202 2KOHM 5% 1/10W
		R165	0RJ0822D677	MCR03EZPJ820 820OHM 5% 1/10W
		R166	0RJ0822D677	MCR03EZPJ820 820OHM 5% 1/10W
		R167	0RJ2700D677	MCR03EZPJ271 270OHM 5% 1/10W
		R168	0RJ2001D677	MCR03EZPJ202 2KOHM 5% 1/10W
		R169	0RJ2700D677	MCR03EZPJ271 270OHM 5% 1/10W
		R171	0RJ0822D677	MCR03EZPJ820 820OHM 5% 1/10W
		R172	0RJ0822D677	MCR03EZPJ820 820OHM 5% 1/10W
		R179	0RJ2203D677	MCR03EZPJ224 220KOHM 5% 1/10
		R180	0RJ2203D677	MCR03EZPJ224 220KOHM 5% 1/10
		R181	0RJ0752D677	MCR03EZPJ750 750OHM 5% 1/10W
		R182	0RJ0752D677	MCR03EZPJ750 750OHM 5% 1/10W
		R183	0RJ0752D677	MCR03EZPJ750 750OHM 5% 1/10W
		R185	0RJ2203D677	MCR03EZPJ224 220KOHM 5% 1/10
		R186	0RJ1001D677	MCR03EZPJ102 1KOHM 5% 1/10W
		R187	0RJ1001D677	MCR03EZPJ102 1KOHM 5% 1/10W
		R188	0RJ0000D677	MCR03EZPJ000 0OHM 5% 1/10W 1
		R189	0RJ0000D677	MCR03EZPJ000 0OHM 5% 1/10W 1
		R190	0RJ0000D677	MCR03EZPJ000 0OHM 5% 1/10W 1
		R191	0RJ0752D677	MCR03EZPJ750 750OHM 5% 1/10W
		R197	0RJ2203D677	MCR03EZPJ224 220KOHM 5% 1/10
		R199	0RJ0752D677	MCR03EZPJ750 750OHM 5% 1/10W
		R200	0RJ0000D677	MCR03EZPJ000 0OHM 5% 1/10W 1
		R201	0RJ1002D677	MCR03EZPJ103 10KOHM 5% 1/10W
		R206	0RJ1002D677	MCR03EZPJ103 10KOHM 5% 1/10W
		R208	0RJ0000D677	MCR03EZPJ000 0OHM 5% 1/10W 1
		R209	0RJ0000D677	MCR03EZPJ000 0OHM 5% 1/10W 1
		R212	0RJ2203D677	MCR03EZPJ224 220KOHM 5% 1/10
		R213	0RJ2203D677	MCR03EZPJ224 220KOHM 5% 1/10
		R217	0RJ1001D677	MCR03EZPJ102 1KOHM 5% 1/10W
		R218	0RJ1001D677	MCR03EZPJ102 1KOHM 5% 1/10W
		R222	0RJ1001D677	MCR03EZPJ102 1KOHM 5% 1/10W
		R223	0RJ1001D677	MCR03EZPJ102 1KOHM 5% 1/10W
		R224	0RJ1001D677	MCR03EZPJ102 1KOHM 5% 1/10W
		R225	0RJ1001D677	MCR03EZPJ102 1KOHM 5% 1/10W
		R226	0RJ4701D677	MCR03EZPJ472 4.7KOHM 5% 1/10
		R227	0RJ4701D677	MCR03EZPJ472 4.7KOHM 5% 1/10
		R228	0RJ4701D677	MCR03EZPJ472 4.7KOHM 5% 1/10
		R229	0RJ4701D677	MCR03EZPJ472 4.7KOHM 5% 1/10
		R300	0RJ0000D677	MCR03EZPJ000 0OHM 5% 1/10W 1
		R301	0RJ0000D677	MCR03EZPJ000 0OHM 5% 1/10W 1
		R302	0RJ0000D677	MCR03EZPJ000 0OHM 5% 1/10W 1
		R303	0RJ2203D677	MCR03EZPJ224 220KOHM 5% 1/10
		R304	0RJ2203D677	MCR03EZPJ224 220KOHM 5% 1/10
		R306	0RJ1001D677	MCR03EZPJ102 1KOHM 5% 1/10W
		R307	0RJ0752D677	MCR03EZPJ750 750OHM 5% 1/10W
		R308	0RJ1002D677	MCR03EZPJ103 10KOHM 5% 1/10W
		R310	0RJ1001D677	MCR03EZPJ102 1KOHM 5% 1/10W

DATE: 2006. 11. 23.				
*S	*AL	LOC. NO.	PART NO.	DESCRIPTION / SPECIFICATION
		R311	0RJ1001D677	MCR03EZPJ102 1KOHM 5% 1/10W
		R313	0RJ2001D677	MCR03EZPJ202 2KOHM 5% 1/10W
		R314	0RJ0000D677	MCR03EZPJ000 0OHM 5% 1/10W 1
		R315	0RJ1002D677	MCR03EZPJ103 10KOHM 5% 1/10W
		R316	0RJ0752D677	MCR03EZPJ750 750OHM 5% 1/10W
		R317	0RJ0000D677	MCR03EZPJ000 0OHM 5% 1/10W 1
		R318	0RJ1000D677	MCR03EZPJ101 100OHM 5% 1/10W
		R319	0RJ1000D677	MCR03EZPJ101 100OHM 5% 1/10W
		R320	0RJ0752D677	MCR03EZPJ750 750OHM 5% 1/10W
		R321	0RJ4701D677	MCR03EZPJ472 4.7KOHM 5% 1/10
		R322	0RJ4701D677	MCR03EZPJ472 4.7KOHM 5% 1/10
		R323	0RJ1002D677	MCR03EZPJ103 10KOHM 5% 1/10W
		R326	0RJ0000D677	MCR03EZPJ000 0OHM 5% 1/10W 1
		R327	0RJ0000D677	MCR03EZPJ000 0OHM 5% 1/10W 1
		R328	0RJ0000D677	MCR03EZPJ000 0OHM 5% 1/10W 1
		R329	0RJ0000D677	MCR03EZPJ000 0OHM 5% 1/10W 1
		R330	0RJ1001D677	MCR03EZPJ102 1KOHM 5% 1/10W
		R331	0RJ0000D677	MCR03EZPJ000 0OHM 5% 1/10W 1
		R332	0RJ1001D677	MCR03EZPJ102 1KOHM 5% 1/10W
		R333	0RJ0000D677	MCR03EZPJ000 0OHM 5% 1/10W 1
		R334	0RJ0000D677	MCR03EZPJ000 0OHM 5% 1/10W 1
		R335	0RJ0000D677	MCR03EZPJ000 0OHM 5% 1/10W 1
		R338	0RJ1000D677	MCR03EZPJ101 100OHM 5% 1/10W
		R339	0RJ1000D677	MCR03EZPJ101 100OHM 5% 1/10W
		R343	0RJ2002D677	MCR03EZPJ203 20KOHM 5% 1/10
		R344	0RJ2002D677	MCR03EZPJ203 20KOHM 5% 1/10
		R345	0RJ1000D677	MCR03EZPJ101 100OHM 5% 1/10W
		R346	0RJ1000D677	MCR03EZPJ101 100OHM 5% 1/10W
		R347	0RJ3001D677	MCR03EZPJ302 3KOHM 5% 1/10W
		R348	0RJ3001D677	MCR03EZPJ302 3KOHM 5% 1/10W
		R349	0RJ2202D677	MCR03EZPJ223 22KOHM 5% 1/10W
		R350	0RJ2202D677	MCR03EZPJ223 22KOHM 5% 1/10W
		R351	0RJ0000D677	MCR03EZPJ000 0OHM 5% 1/10W 1
		R352	0RJ1000D677	MCR03EZPJ101 100OHM 5% 1/10W
		R355	0RJ4700D677	MCR03EZPJ471 470OHM 5% 1/10W
		R358	0RJ0000D677	MCR03EZPJ000 0OHM 5% 1/10W 1
		R360	0RJ0000D677	MCR03EZPJ000 0OHM 5% 1/10W 1
		R361	0RJ1000D677	MCR03EZPJ101 100OHM 5% 1/10W
		R362	0RJ1000D677	MCR03EZPJ101 100OHM 5% 1/10W
		R367	0RJ1000D677	MCR03EZPJ101 100OHM 5% 1/10W
		R380	0RJ0000D677	MCR03EZPJ000 0OHM 5% 1/10W 1
		R381	0RJ0000D677	MCR03EZPJ000 0OHM 5% 1/10W 1
		R382	0RJ0000D677	MCR03EZPJ000 0OHM 5% 1/10W 1
		R383	0RJ0000D677	MCR03EZPJ000 0OHM 5% 1/10W 1
		R384	0RJ4701D677	MCR03EZPJ472 4.7KOHM 5% 1/10
		R386	0RJ0000D677	MCR03EZPJ000 0OHM 5% 1/10W 1
		R387	0RJ0000D677	MCR03EZPJ000 0OHM 5% 1/10W 1
		R388	0RJ0000D677	MCR03EZPJ000 0OHM 5% 1/10W 1
		R401	0RJ0000D677	MCR03EZPJ000 0OHM 5% 1/10W 1
		R402	0RJ1002D677	MCR03EZPJ103 10KOHM 5% 1/10W
		R404	0RJ1001D677	MCR03EZPJ102 1KOHM 5% 1/10W
		R405	0RJ1001D677	MCR03EZPJ102 1KOHM 5% 1/10W
		R406	0RJ1000D677	MCR03EZPJ101 100OHM 5% 1/10W
		R407	0RJ1000D677	MCR03EZPJ101 100OHM 5% 1/10W
		R417	0RJ4702D677	MCR03EZPJ473 47KOHM 5% 1/10W
		R418	0RJ4702D677	MCR03EZPJ473 47KOHM 5% 1/10W
		R421	0RJ1000D677	MCR03EZPJ101 100OHM 5% 1/10W
		R422	0RJ1000D677	MCR03EZPJ101 100OHM 5% 1/10W
		R423	0RJ1002D677	MCR03EZPJ103 10KOHM 5% 1/10W
		R424	0RJ1002D677	MCR03EZPJ103 10KOHM 5% 1/10W
		R425	0RJ4990D477	MCR03EZPJ4990 499OHM 1% 1/10
		R426	0RJ0222D677	MCR03EZPJ220 22OHM 5% 1/10W

DATE: 2006. 11. 23.				
*S	*AL	LOC. NO.	PART NO.	DESCRIPTION / SPECIFICATION
		R427	0RJ0222D677	MCR03EZPJ220 220OHM 5% 1/10W
		R428	0RJ0222D677	MCR03EZPJ220 220OHM 5% 1/10W
		R433	0RJ1000D677	MCR03EZPJ101 100OHM 5% 1/10W
		R434	0RJ1000D677	MCR03EZPJ101 100OHM 5% 1/10W
		R435	0RJ0222D677	MCR03EZPJ220 220OHM 5% 1/10W
		R436	0RJ0222D677	MCR03EZPJ220 220OHM 5% 1/10W
		R437	0RJ0222D677	MCR03EZPJ220 220OHM 5% 1/10W
		R438	0RJ0222D677	MCR03EZPJ220 220OHM 5% 1/10W
		R441	0RJ1002D677	MCR03EZPJ103 10KOHM 5% 1/10W
		R442	0RJ1002D677	MCR03EZPJ103 10KOHM 5% 1/10W
		R451	0RJ1501D677	MCR03EZPJ152 1.5KOHM 5% 1/10
		R502	0RJ1002D677	MCR03EZPJ103 10KOHM 5% 1/10W
		R503	0RJ0222D677	MCR03EZPJ220 220OHM 5% 1/10W
		R506	0RJ1001D677	MCR03EZPJ102 1KOHM 5% 1/10W
		R507	0RJ0000D677	MCR03EZPJ000 0OHM 5% 1/10W 1
		R508	0RJ2200D677	MCR03EZPJ221 220OHM 5% 1/10W
		R509	0RJ2200D677	MCR03EZPJ221 220OHM 5% 1/10W
		R510	0RJ4701D677	MCR03EZPJ472 4.7KOHM 5% 1/10
		R511	0RJ4700D677	MCR03EZPJ471 470OHM 5% 1/10W
		R512	0RJ0822D677	MCR03EZPJ820 820OHM 5% 1/10W
		R513	0RJ0000D677	MCR03EZPJ000 0OHM 5% 1/10W 1
		R514	0RJ0000D677	MCR03EZPJ000 0OHM 5% 1/10W 1
		R515	0RJ1000D677	MCR03EZPJ101 100OHM 5% 1/10W
		R516	0RJ1001D677	MCR03EZPJ102 1KOHM 5% 1/10W
		R517	0RJ4701D677	MCR03EZPJ472 4.7KOHM 5% 1/10
		R518	0RJ2000D677	MCR03EZPJ201 200OHM 5% 1/10W
		R519	0RJ2700D677	MCR03EZPJ271 270OHM 5% 1/10W
		R520	0RJ2200D677	MCR03EZPJ221 220OHM 5% 1/10W
		R521	0RJ1001D677	MCR03EZPJ102 1KOHM 5% 1/10W
		R522	0RJ1500D677	MCR03EZPJ151 150OHM 5% 1/10W
		R524	0RJ1001D677	MCR03EZPJ102 1KOHM 5% 1/10W
		R527	0RJ1001D677	MCR03EZPJ102 1KOHM 5% 1/10W
		R529	0RJ1000D677	MCR03EZPJ101 100OHM 5% 1/10W
		R530	0RJ0472D677	MCR03EZPJ470 470OHM 5% 1/10W
		R531	0RJ1000D677	MCR03EZPJ101 100OHM 5% 1/10W
		R534	0RJ1001D677	MCR03EZPJ102 1KOHM 5% 1/10W
		R535	0RJ4702D677	MCR03EZPJ473 47KOHM 5% 1/10W
		R536	0RJ1001D677	MCR03EZPJ102 1KOHM 5% 1/10W
		R540	0RJ7501D677	MCR03EZPJ752 7.5KOHM 5% 1/10
		R600	0RJ0000D677	MCR03EZPJ000 0OHM 5% 1/10W 1
		R601	0RJ1000D677	MCR03EZPJ101 100OHM 5% 1/10W
		R603	0RJ1000D677	MCR03EZPJ101 100OHM 5% 1/10W
		R604	0RJ1001D677	MCR03EZPJ102 1KOHM 5% 1/10W
		R607	0RJ1002D677	MCR03EZPJ103 10KOHM 5% 1/10W
		R620	0RJ1000D677	MCR03EZPJ101 100OHM 5% 1/10W
		R621	0RJ0000D677	MCR03EZPJ000 0OHM 5% 1/10W 1
		R622	0RJ0000D677	MCR03EZPJ000 0OHM 5% 1/10W 1
		R623	0RJ0000D677	MCR03EZPJ000 0OHM 5% 1/10W 1
		R624	0RJ0000D677	MCR03EZPJ000 0OHM 5% 1/10W 1
		R627	0RJ0000D677	MCR03EZPJ000 0OHM 5% 1/10W 1
		R628	0RJ0000D677	MCR03EZPJ000 0OHM 5% 1/10W 1
		R629	0RJ1500D677	MCR03EZPJ151 150OHM 5% 1/10W
		R630	0RJ4700D677	MCR03EZPJ471 470OHM 5% 1/10W
		R631	0RJ1500D677	MCR03EZPJ151 150OHM 5% 1/10W
		R632	0RJ1802D677	MCR03EZPJ183 18KOHM 5% 1/10W
		R633	0RJ1000D677	MCR03EZPJ101 100OHM 5% 1/10W
		R634	0RJ1000D677	MCR03EZPJ101 100OHM 5% 1/10W
		R635	0RJ1000D677	MCR03EZPJ101 100OHM 5% 1/10W
		R636	0RJ1000D677	MCR03EZPJ101 100OHM 5% 1/10W
		R637	0RJ1000D677	MCR03EZPJ101 100OHM 5% 1/10W
		R638	0RJ1001D677	MCR03EZPJ102 1KOHM 5% 1/10W
		R639	0RJ0000D677	MCR03EZPJ000 0OHM 5% 1/10W 1

DATE: 2006. 11. 23.				
*S	*AL	LOC. NO.	PART NO.	DESCRIPTION / SPECIFICATION
		R640	0RJ1000D677	MCR03EZPJ101 100OHM 5% 1/10W
		R641	0RJ0000D677	MCR03EZPJ000 0OHM 5% 1/10W 1
		R645	0RJ1000D677	MCR03EZPJ101 100OHM 5% 1/10W
		R646	0RJ0000D677	MCR03EZPJ000 0OHM 5% 1/10W 1
		R647	0RJ1002D677	MCR03EZPJ103 10KOHM 5% 1/10W
		R648	0RJ1002D677	MCR03EZPJ103 10KOHM 5% 1/10W
		R649	0RJ1002D677	MCR03EZPJ103 10KOHM 5% 1/10W
		R650	0RJ1002D677	MCR03EZPJ103 10KOHM 5% 1/10W
		R651	0RJ1002D677	MCR03EZPJ103 10KOHM 5% 1/10W
		R652	0RJ1002D677	MCR03EZPJ103 10KOHM 5% 1/10W
		R653	0RJ1000D677	MCR03EZPJ101 100OHM 5% 1/10W
		R654	0RJ1000D677	MCR03EZPJ101 100OHM 5% 1/10W
		R656	0RJ1000D677	MCR03EZPJ101 100OHM 5% 1/10W
		R660	0RJ8201D677	MCR03EZPJ822 8.2KOHM 5% 1/10
		R662	0RJ1002D677	MCR03EZPJ103 10KOHM 5% 1/10W
		R663	0RJ1002D677	MCR03EZPJ103 10KOHM 5% 1/10W
		R666	0RJ4701D677	MCR03EZPJ472 4.7KOHM 5% 1/10
		R667	0RJ1000D677	MCR03EZPJ101 100OHM 5% 1/10W
		R668	0RJ1000D677	MCR03EZPJ101 100OHM 5% 1/10W
		R670	0RJ1000D677	MCR03EZPJ101 100OHM 5% 1/10W
		R671	0RJ4701D677	MCR03EZPJ472 4.7KOHM 5% 1/10
		R672	0RJ1000D677	MCR03EZPJ101 100OHM 5% 1/10W
		R673	0RJ6201D677	MCR03EZPJ622 6.2KOHM 5% 1/10
		R675	0RJ1000D677	MCR03EZPJ101 100OHM 5% 1/10W
		R676	0RJ1000D677	MCR03EZPJ101 100OHM 5% 1/10W
		R677	0RJ1000D677	MCR03EZPJ101 100OHM 5% 1/10W
		R678	0RJ1000D677	MCR03EZPJ101 100OHM 5% 1/10W
		R679	0RJ1000D677	MCR03EZPJ101 100OHM 5% 1/10W
		R680	0RJ1000D677	MCR03EZPJ101 100OHM 5% 1/10W
		R681	0RJ2001D677	MCR03EZPJ202 2KOHM 5% 1/10W
		R686	0RJ1000D677	MCR03EZPJ101 100OHM 5% 1/10W
		R687	0RJ1000D677	MCR03EZPJ101 100OHM 5% 1/10W
		R689	0RJ2200D677	MCR03EZPJ221 220OHM 5% 1/10W
		R690	0RJ1000D677	MCR03EZPJ101 100OHM 5% 1/10W
		R691	0RJ2200D677	MCR03EZPJ221 220OHM 5% 1/10W
		R692	0RJ1000D677	MCR03EZPJ101 100OHM 5% 1/10W
		R693	0RJ2200D677	MCR03EZPJ221 220OHM 5% 1/10W
		R694	0RJ1000D677	MCR03EZPJ101 100OHM 5% 1/10W
		R695	0RJ0222D677	MCR03EZPJ220 220OHM 5% 1/10W
		R697	0RJ2001D677	MCR03EZPJ202 2KOHM 5% 1/10W
		R699	0RJ1000D677	MCR03EZPJ101 100OHM 5% 1/10W
		R700	0RJ1000D677	MCR03EZPJ101 100OHM 5% 1/10W
		R702	0RJ1000D677	MCR03EZPJ101 100OHM 5% 1/10W
		R703	0RJ1000D677	MCR03EZPJ101 100OHM 5% 1/10W
		R704	0RJ6202D677	MCR03EZPJ623 62KOHM 5% 1/10W
		R705	0RJ2402D677	MCR03EZPJ243 24KOHM 5% 1/10W
		R708	0RJ1501D677	MCR03EZPJ152 1.5KOHM 5% 1/10
		R709	0RJ4700D677	MCR03EZPJ471 470OHM 5% 1/10W
		R711	0RJ0222D677	MCR03EZPJ220 220OHM 5% 1/10W
		R712	0RJ0222D677	MCR03EZPJ220 220OHM 5% 1/10W
		R713	0RJ0222D677	MCR03EZPJ220 220OHM 5% 1/10W
		R714	0RJ2200D677	MCR03EZPJ221 220OHM 5% 1/10W
		R715	0RJ2200D677	MCR03EZPJ221 220OHM 5% 1/10W
		R718	0RJ4701D677	MCR03EZPJ472 4.7KOHM 5% 1/10
		R721	0RJ4701D677	MCR03EZPJ472 4.7KOHM 5% 1/10
		R728	0RJ1000D677	MCR03EZPJ101 100OHM 5% 1/10W
		R729	0RJ1000D677	MCR03EZPJ101 100OHM 5% 1/10W
		R730	0RJ1000D677	MCR03EZPJ101 100OHM 5% 1/10W
		R732	0RJ1000D677	MCR03EZPJ101 100OHM 5% 1/10W
		R733	0RJ1000D677	MCR03EZPJ101 100OHM 5% 1/10W
		R734	0RJ1000D677	MCR03EZPJ101 100OHM 5% 1/10W
		R735	0RJ0000D677	MCR03EZPJ000 0OHM 5% 1/10W 1

DATE: 2006. 11. 23.				
*S	*AL	LOC. NO.	PART NO.	DESCRIPTION / SPECIFICATION
		R736	0RJ1000D677	MCR03EZPJ101 100OHM 5% 1/10W
		R737	0RJ1000D677	MCR03EZPJ101 100OHM 5% 1/10W
		R738	0RJ0000D677	MCR03EZPJ000 0OHM 5% 1/10W 1
		R742	0RJ6201D677	MCR03EZPJ622 6.2KOHM 5% 1/10
		R744	0RJ1001D677	MCR03EZPJ102 1KOHM 5% 1/10W
		R747	0RJ1000D677	MCR03EZPJ101 100OHM 5% 1/10W
		R748	0RJ1000D677	MCR03EZPJ101 100OHM 5% 1/10W
		R749	0RJ1000D677	MCR03EZPJ101 100OHM 5% 1/10W
		R750	0RJ0000D677	MCR03EZPJ000 0OHM 5% 1/10W 1
		R751	0RJ1000D677	MCR03EZPJ101 100OHM 5% 1/10W
		R752	0RJ1000D677	MCR03EZPJ101 100OHM 5% 1/10W
		R753	0RJ1000D677	MCR03EZPJ101 100OHM 5% 1/10W
		R756	0RJ1000D677	MCR03EZPJ101 100OHM 5% 1/10W
		R757	0RJ1000D677	MCR03EZPJ101 100OHM 5% 1/10W
		R758	0RJ1001D677	MCR03EZPJ102 1KOHM 5% 1/10W
		R759	0RJ1001D677	MCR03EZPJ102 1KOHM 5% 1/10W
		R760	0RJ1001D677	MCR03EZPJ102 1KOHM 5% 1/10W
		R761	0RJ1001D677	MCR03EZPJ102 1KOHM 5% 1/10W
		R762	0RJ1001D677	MCR03EZPJ102 1KOHM 5% 1/10W
		R763	0RJ1001D677	MCR03EZPJ102 1KOHM 5% 1/10W
		R764	0RJ1001D677	MCR03EZPJ102 1KOHM 5% 1/10W
		R765	0RJ1001D677	MCR03EZPJ102 1KOHM 5% 1/10W
		R766	0RJ1001D677	MCR03EZPJ102 1KOHM 5% 1/10W
		R767	0RJ1001D677	MCR03EZPJ102 1KOHM 5% 1/10W
		R768	0RJ1001D677	MCR03EZPJ102 1KOHM 5% 1/10W
		R769	0RJ1001D677	MCR03EZPJ102 1KOHM 5% 1/10W
		R771	0RJ2200D677	MCR03EZPJ221 220OHM 5% 1/10W
		R772	0RJ2200D677	MCR03EZPJ221 220OHM 5% 1/10W
		R773	0RJ0000D677	MCR03EZPJ000 0OHM 5% 1/10W 1
		R774	0RJ0000D677	MCR03EZPJ000 0OHM 5% 1/10W 1
		R775	0RJ0000D677	MCR03EZPJ000 0OHM 5% 1/10W 1
		R777	0RJ0000D677	MCR03EZPJ000 0OHM 5% 1/10W 1
		R779	0RJ0000D677	MCR03EZPJ000 0OHM 5% 1/10W 1
		R780	0RJ0000D677	MCR03EZPJ000 0OHM 5% 1/10W 1
		R781	0RJ3001D677	MCR03EZPJ302 3KOHM 5% 1/10W
		R782	0RJ3001D677	MCR03EZPJ302 3KOHM 5% 1/10W
		R783	0RJ0000D677	MCR03EZPJ000 0OHM 5% 1/10W 1
		R784	0RJ0000D677	MCR03EZPJ000 0OHM 5% 1/10W 1
		R785	0RJ0000D677	MCR03EZPJ000 0OHM 5% 1/10W 1
		R800	0RJ1000D477	MCR03EZPF101 100OHM 1% 1/10W
		R801	0RJ1000D477	MCR03EZPF101 100OHM 1% 1/10W
		R802	0RJ1000D477	MCR03EZPF101 100OHM 1% 1/10W
		R803	0RJ1000D477	MCR03EZPF101 100OHM 1% 1/10W
		R804	0RJ1000D477	MCR03EZPF101 100OHM 1% 1/10W
		R805	0RJ1000D477	MCR03EZPF101 100OHM 1% 1/10W
		R806	0RJ1000D477	MCR03EZPF101 100OHM 1% 1/10W
		R807	0RJ1000D477	MCR03EZPF101 100OHM 1% 1/10W
		R808	0RJ1000D477	MCR03EZPF101 100OHM 1% 1/10W
		R809	0RJ1000D477	MCR03EZPF101 100OHM 1% 1/10W
		R810	0RJ1000D477	MCR03EZPF101 100OHM 1% 1/10W
		R811	0RJ1000D477	MCR03EZPF101 100OHM 1% 1/10W
		R812	0RJ1000D477	MCR03EZPF101 100OHM 1% 1/10W
		R813	0RJ1000D477	MCR03EZPF101 100OHM 1% 1/10W
		R816	0RJ1000D677	MCR03EZPJ101 100OHM 5% 1/10W
		R822	0RJ2001D677	MCR03EZPJ202 2KOHM 5% 1/10W
		R823	0RJ2001D677	MCR03EZPJ202 2KOHM 5% 1/10W
		R828	0RJ4703D677	MCR03EZPJ474 470KOHM 5% 1/10
		R829	0RJ4703D677	MCR03EZPJ474 470KOHM 5% 1/10
		R833	0RJ0000D677	MCR03EZPJ000 0OHM 5% 1/10W 1
		R834	0RJ0000D677	MCR03EZPJ000 0OHM 5% 1/10W 1
		R838	0RJ2001D677	MCR03EZPJ202 2KOHM 5% 1/10W
		R839	0RJ2001D677	MCR03EZPJ202 2KOHM 5% 1/10W

DATE: 2006. 11. 23.				
*S	*AL	LOC. NO.	PART NO.	DESCRIPTION / SPECIFICATION
		R843	0RJ1002D677	MCR03EZPJ103 10KOHM 5% 1/10W
		R844	0RJ1002D677	MCR03EZPJ103 10KOHM 5% 1/10W
		R847	0RJ1003D677	MCR03EZPJ104 100KOHM 5% 1/10
		R848	0RJ1000D677	MCR03EZPJ101 100OHM 5% 1/10W
		R849	0RJ1001D677	MCR03EZPJ102 1KOHM 5% 1/10W
		R850	0RJ1001D677	MCR03EZPJ102 1KOHM 5% 1/10W
		R851	0RJ4701D677	MCR03EZPJ472 4.7KOHM 5% 1/10
		R852	0RJ4701D677	MCR03EZPJ472 4.7KOHM 5% 1/10
		R855	0RJ0000D677	MCR03EZPJ000 0OHM 5% 1/10W 1
		R856	0RJ0000D677	MCR03EZPJ000 0OHM 5% 1/10W 1
		R857	0RJ0000D677	MCR03EZPJ000 0OHM 5% 1/10W 1
		R858	0RJ0000D677	MCR03EZPJ000 0OHM 5% 1/10W 1
		R861	0RJ0000D677	MCR03EZPJ000 0OHM 5% 1/10W 1
		R862	0RJ0000D677	MCR03EZPJ000 0OHM 5% 1/10W 1
		R863	0RJ0000D677	MCR03EZPJ000 0OHM 5% 1/10W 1
		R864	0RJ0000D677	MCR03EZPJ000 0OHM 5% 1/10W 1
		R865	0RJ0000D677	MCR03EZPJ000 0OHM 5% 1/10W 1
		R866	0RJ0000D677	MCR03EZPJ000 0OHM 5% 1/10W 1
		R867	0RJ0000D677	MCR03EZPJ000 0OHM 5% 1/10W 1
		R868	0RJ0000D677	MCR03EZPJ000 0OHM 5% 1/10W 1
		R869	0RJ0000D677	MCR03EZPJ000 0OHM 5% 1/10W 1
		R870	0RJ0000D677	MCR03EZPJ000 0OHM 5% 1/10W 1
		R871	0RJ0000D677	MCR03EZPJ000 0OHM 5% 1/10W 1
		R872	0RJ0000D677	MCR03EZPJ000 0OHM 5% 1/10W 1
		R873	0RJ1002D677	MCR03EZPJ103 10KOHM 5% 1/10W
		R874	0RJ0000D677	MCR03EZPJ000 0OHM 5% 1/10W 1
		R875	0RJ0000D677	MCR03EZPJ000 0OHM 5% 1/10W 1
		R876	0RJ0000D677	MCR03EZPJ000 0OHM 5% 1/10W 1
		R900	0RJ1002D677	MCR03EZPJ103 10KOHM 5% 1/10W
		R902	0RJ1001D677	MCR03EZPJ102 1KOHM 5% 1/10W
		R903	0RJ4701D677	MCR03EZPJ472 4.7KOHM 5% 1/10
		R904	0RJ0000D677	MCR03EZPJ000 0OHM 5% 1/10W 1
		R905	0RJ2000D677	MCR03EZPJ201 200OHM 5% 1/10W
		R906	0RJ0000D677	MCR03EZPJ000 0OHM 5% 1/10W 1
		R909	0RJ1001D677	MCR03EZPJ102 1KOHM 5% 1/10W
		R910	0RJ1001D677	MCR03EZPJ102 1KOHM 5% 1/10W
		R912	0RJ1002D677	MCR03EZPJ103 10KOHM 5% 1/10W
		R913	0RJ1002D677	MCR03EZPJ103 10KOHM 5% 1/10W
		R916	0RJ1002D677	MCR03EZPJ103 10KOHM 5% 1/10W
		R918	0RJ1002D677	MCR03EZPJ103 10KOHM 5% 1/10W
		R919	0RJ1002D677	MCR03EZPJ103 10KOHM 5% 1/10W
		R921	0RJ1002D677	MCR03EZPJ103 10KOHM 5% 1/10W
		R922	0RJ1102D677	MCR03EZPJ113 11KOHM 5% 1/10W
		R923	0RJ2002D677	MCR03EZPJ203. 20KOHM 5% 1/10
		R924	0RJ4701D677	MCR03EZPJ472 4.7KOHM 5% 1/10
		R925	0RJ0000D677	MCR03EZPJ000 0OHM 5% 1/10W 1
		R926	0RJ1001D677	MCR03EZPJ102 1KOHM 5% 1/10W
		R927	0RJ1002D677	MCR03EZPJ103 10KOHM 5% 1/10W
		R928	0RJ1002D677	MCR03EZPJ103 10KOHM 5% 1/10W
		R929	0RJ1002D677	MCR03EZPJ103 10KOHM 5% 1/10W
		R931	0RJ0000D677	MCR03EZPJ000 0OHM 5% 1/10W 1
		R933	0RH0000D622	MCR10EZHJ000 0OHM 5% 1/8W 20
		R934	0RH0000D622	MCR10EZHJ000 0OHM 5% 1/8W 20
		R935	0RH0000D622	MCR10EZHJ000 0OHM 5% 1/8W 20
		R937	0RJ0000D677	MCR03EZPJ000 0OHM 5% 1/10W 1
		R938	0RJ0000D677	MCR03EZPJ000 0OHM 5% 1/10W 1
OTHERs				
		D1004	0DL233309AC	SAM2333 RED/Y-GREEN 2.7V 2.8
		D750	0DL233309AC	SAM2333 RED/Y-GREEN 2.7V 2.8
		TU1	6700MF0017C	TAFV-W303P PAL - - - 75OHM H

DATE: 2006. 11. 23.

*S	*AL	LOC. NO.	PART NO.	DESCRIPTION / SPECIFICATION
CONTROL BOARD				
		R101	0RH9101D622	MCR10EZHJ912 9.1KOHM 5% 1/8W
		R102	0RH3301D622	MCR10EZHJ332 3.3KOHM 5% 1/8W
		R103	0RH1101D622	MCR10EZHJ112 1.1KOHM 5% 1/8W
		R104	0RH0000D622	MCR10EZHJ000 0OHM 5% 1/8W 20
		R105	0RH9101D622	MCR10EZHJ912 9.1KOHM 5% 1/8W
		R106	0RH3301D622	MCR10EZHJ332 3.3KOHM 5% 1/8W
		R107	0RH1101D622	MCR10EZHJ112 1.1KOHM 5% 1/8W
		R108	0RH0000D622	MCR10EZHJ000 0OHM 5% 1/8W 20
		SW101	140-313B	KPT-1115AM 1C1P 12VDC 0.05A
		SW102	140-313B	KPT-1115AM 1C1P 12VDC 0.05A
		SW103	140-313B	KPT-1115AM 1C1P 12VDC 0.05A
		SW104	140-313B	KPT-1115AM 1C1P 12VDC 0.05A
		SW105	140-313B	KPT-1115AM 1C1P 12VDC 0.05A
		SW106	140-313B	KPT-1115AM 1C1P 12VDC 0.05A
		SW107	140-313B	KPT-1115AM 1C1P 12VDC 0.05A
		SW108	140-313B	KPT-1115AM 1C1P 12VDC 0.05A
SIDE A/V BOARD				
		C300	0CH5101K416	C2012C0G1H101JT 100pF 5% 50V
		C301	0CH5101K416	C2012C0G1H101JT 100pF 5% 50V
		R300	0RH2203D622	MCR10EZHJ224 220KOHM 5% 1/8W
		R301	0RH2203D622	MCR10EZHJ224 220KOHM 5% 1/8W
		R302	0RH0752D622	MCR10EZHJ750 750OHM 5% 1/8W 2
		R303	0RH4700D622	MCR10EZHJ471 470OHM 5% 1/8W
		R304	0RH4700D622	MCR10EZHJ471 470OHM 5% 1/8W
		R305	0RH0000D622	MCR10EZHJ000 0OHM 5% 1/8W 20
PREAMP&LED BOARD				
		D200	0DLAU0410AA	SAW5670 ROUND 5mM AMBER/WHIT
		IC201	6712000013A	TSOP4438SO1 4.5TO5.5V 1.5MA
		C202	0CE476VF6DC	VGV476M016S0ANE010 47uF 20%
		C203	0CE476VF6DC	VGV476M016S0ANE010 47uF 20%
		C204	0CE476VF6DC	VGV476M016S0ANE010 47uF 20%
		C200	0CH5101K416	C2012C0G1H101JT 100pF 5% 50V
		C201	0CH5330K416	C2012C0G1H330JT 33pF 5% 50V
		L200	0LC1032101A	FI-C3216-103KJT 10UH 10% - 5
		R200	0RH0000D622	MCR10EZHJ000 0OHM 5% 1/8W 20
		R201	0RH0000D622	MCR10EZHJ000 0OHM 5% 1/8W 20
		R202	0RH6800D622	MCR10EZHJ681 680OHM 5% 1/8W
		R203	0RH0000D622	MCR10EZHJ000 0OHM 5% 1/8W 20
		R204	0RH6801D622	MCR10EZHJ682 6.8KOHM 5% 1/8W
		R205	0RH0000D622	MCR10EZHJ000 0OHM 5% 1/8W 20
		R206	0RH0000D622	MCR10EZHJ000 0OHM 5% 1/8W 20
		R207	0RH0000D622	MCR10EZHJ000 0OHM 5% 1/8W 20
		R208	0RH3901D622	MCR10EZHJ392 3.9KOHM 5% 1/8W
		Q200	0TR387500AA	2SC3875S(ALY) NPN 5V 60V 50V
		Q201	0TR387500AA	2SC3875S(ALY) NPN 5V 60V 50V
		Q202	0TR387500AA	2SC3875S(ALY) NPN 5V 60V 50V