

# EXPLODED VIEW

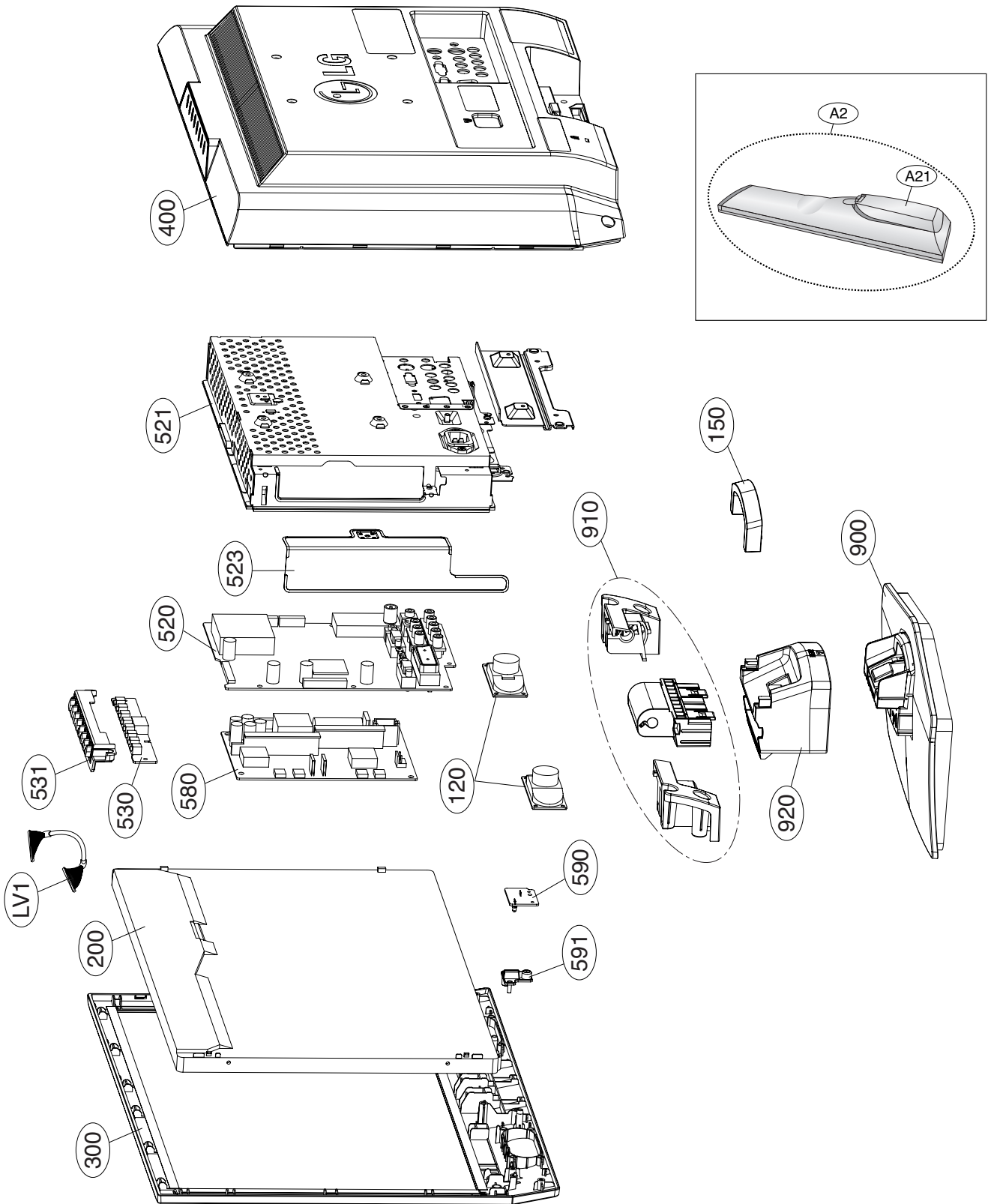

## EXPLODED VIEW PARTS LIST

No.	PART NO.	DESCRIPTION
	120	EAB32761501 Speaker,Full Range L07030A-027 ND35 3W 16OHM 85DB 300HZ 30 X 70 X 22 SOLDER
	150	MCK30233403 Cover MOLD HIPS 51SF LS1R HIPS 51SF 15/20LS1R-holder cable management , 01- CSKD
△	200	EAJ36290801 LCD,Module-TFT LM190WX1-TLC1 DRIVER 1440X900 300CD 16/10 850:1 5ms, 160/160, P7 <b>LPL</b>
△	300	ABJ32770403 Cabinet Assembly 19LS4R . 19" 19LS4R CABINET ASSYc/skd.
△	400	ACQ33853102 Cover Assembly,Rear 19LS4D-ZB back cover assy, CSKD
	520	EBU39798901 Main Total Assembly 19LS4D-ZB LGEMA SKD BRAND LD73B
	521	ADV33853003 Frame Assembly 19LS4D-ZB rear shield assy_EP3, CSKD
	523	MGJ32259302 Plate,Shield PRESS SPT 0.3t SHIELD SPT LAMP 20LS1R CSKD OF 01
	530	EBR36362001 PCB Assembly CONTROL T.T LP69C 22LS4R AEUNLAX 22LS4R CONTROL T.T ASS'Y
	531	MEY36500601 Knob MOLD ABS HF380 SUB CONTROL KNOB LS4R 19LS4R_22LS4R
△	580	EAY38520201 Power Supply Assembly YP1922-4L FREE 22LS4D LCD YUYANG TELECOM DTV 196*156
	590	EBR38502801 PCB Assembly,Sub LED & P/SW T.T LD73B 22LS4D BASIS SUB
	591	MFB36500901 Lens MOLD PMMA PLUS LENS 19LS4R 19LS4R_22LS4R INDICATOR
△	900	AAN32770003 Base Assembly ASSY 19LS4R - 19LS4R STAND BASE ASS'Y C/SKD
△	910	AAN31022507 Base Assembly STAND 19LS4R HINGE COVER ASSY CKD
	920	MCK36500502 Cover,Rear MOLD ABS 380 19LS4R ABS, HF-380 19LS4R STAND BODY COVER C/SKD
	A2	AKB33871401 Remote Controller Assembly 19_22LS4D, EU(PAL), LD73B
	A21	MCK36759201 Cover MOLD ABS HF-380 MKJ339814 ABS, HF-380 TX BATTERY COVER"
	LV1	6631900109E Harness,Single LVDS CABLE(LG) Locking type FI-X30HL SMH200 150mM 1.25MM 30P-28P

# REPLACEMENT PARTS LIST

DATE: 2007. 08. 09.

LOC. NO.	PART NO.	DESCRIPTION / SPECIFICATION	LOC. NO.	PART NO.	DESCRIPTION / SPECIFICATION
<b>CAPACITORS</b>					
C100	0CH5470K618	0402N470M500LT 47pF 5% 50V C0G -55TO+125C	C1217	EAE32755801	CL31A106K5HNNNE 10uF 10% 16V X5R -55TO+85C
C1001	OCK103BH56A	C1005X7R1E103KT- 10nF 10% 25V X7R -55TO+12	C122	OCK104BF56A	C1005X7R104KET 100nF 10% 16V X7R -55TO+125
C1007	OCK104BF56A	C1005X7R104KET 100nF 10% 16V X7R -55TO+125	C1225	EAE32755801	CL31A106K5HNNNE 10uF 10% 16V X5R -55TO+85C
C1009	OCK104BF56A	C1005X7R104KET 100nF 10% 16V X7R -55TO+125	C123	OCK104BF56A	C1005X7R104KET 100nF 10% 16V X7R -55TO+125
C101	OCK103BH56A	C1005X7R1E103KT- 10nF 10% 25V X7R -55TO+12	C1232	OCE107WF6DC	MVK6.3TP16VC100M 100uF 20% 16V 110MA -40TO
C1010	OCE476WC6DC	MVK5.0TP6.3VC47M 47uF 20% 6.3V 36MA -40TO+	C1234	OCK102BK56A	0402B102K500CT 1nF 10% 50V X7R -55TO+125C
C102	OCE106WFKDC	MVK4.0TP16VC10M 10uF 20% 16V 16MA -40TO+10	C1235	OCK102BK56A	0402B102K500CT 1nF 10% 50V X7R -55TO+125C
C103	OCK104BF56A	C1005X7R104KET 100nF 10% 16V X7R -55TO+125	C1236	EAE32755801	CL31A106K5HNNNE 10uF 10% 16V X5R -55TO+85C
C104	OCK105CD56A	C1608X7R1A105KT 1uF 10% 10V X7R -55TO+125C	C1237	EAE32755801	CL31A106K5HNNNE 10uF 10% 16V X5R -55TO+85C
C105	OCK104BF56A	C1005X7R104KET 100nF 10% 16V X7R -55TO+125	C1239	OCK104BF56A	C1005X7R104KET 100nF 10% 16V X7R -55TO+125
C106	OCK104BF56A	C1005X7R104KET 100nF 10% 16V X7R -55TO+125	C124	OCK104BF56A	C1005X7R104KET 100nF 10% 16V X7R -55TO+125
C1068	OCE107WF6DC	MVK6.3TP16VC100M 100uF 20% 16V 110MA -40TO	C1244	OCK103BH56A	C1005X7R1E103KT- 10nF 10% 25V X7R -55TO+12
C107	OCK104BF56A	C1005X7R104KET 100nF 10% 16V X7R -55TO+125	C1246	OCK103BH56A	C1005X7R1E103KT- 10nF 10% 25V X7R -55TO+12
C108	OCK104BF56A	C1005X7R104KET 100nF 10% 16V X7R -55TO+125	C125	OCK104BF56A	C1005X7R104KET 100nF 10% 16V X7R -55TO+125
C109	OCK105CD56A	C1608X7R1A105KT 1uF 10% 10V X7R -55TO+125C	C126	OCK104BF56A	C1005X7R104KET 100nF 10% 16V X7R -55TO+125
C110	OCE106WFKDC	MVK4.0TP16VC10M 10uF 20% 16V 16MA -40TO+10	C127	OCK104BF56A	C1005X7R104KET 100nF 10% 16V X7R -55TO+125
C110	EAE32707901	20SVP22M 22uF 20% 20V 1.45A -55TO+105C SVP	C128	OCK104BF56A	C1005X7R104KET 100nF 10% 16V X7R -55TO+125
C1100	OCK104BF56A	C1005X7R104KET 100nF 10% 16V X7R -55TO+125	C129	OCK104BF56A	C1005X7R104KET 100nF 10% 16V X7R -55TO+125
C1101	OCK104BF56A	C1005X7R104KET 100nF 10% 16V X7R -55TO+125	C130	OCK104BF56A	C1005X7R104KET 100nF 10% 16V X7R -55TO+125
C1102	OCK104BF56A	C1005X7R104KET 100nF 10% 16V X7R -55TO+125	C1300	OCK225DH94A	C2012Y5V225ZF 2.2uF -20TO+80% 25V Y5V -30
C1103	OCK104BF56A	C1005X7R104KET 100nF 10% 16V X7R -55TO+125	C1301	OCE476WH6DC	MVK8.0TP25VC47M 47uF 20% 25V 80MA -40TO+10
C1104	OCK104BF56A	C1005X7R104KET 100nF 10% 16V X7R -55TO+125	C1302	OCK474CH94A	0603F474Z250CT 470nF -20TO+80% 25V Y5V -30
C1105	OCC120CK41A	C1608C0G1H120JT 12pF 5% 50V C0G -55TO+125C	C1303	OCK474CH94A	0603F474Z250CT 470nF -20TO+80% 25V Y5V -30
C1106	OCC120CK41A	C1608C0G1H120JT 12pF 5% 50V C0G -55TO+125C	C1304	OCK474CH94A	0603F474Z250CT 470nF -20TO+80% 25V Y5V -30
C111	OCK104BF56A	C1005X7R104KET 100nF 10% 16V X7R -55TO+125	C1305	OCK474CH94A	0603F474Z250CT 470nF -20TO+80% 25V Y5V -30
C1111	OCK104BF56A	C1005X7R104KET 100nF 10% 16V X7R -55TO+125	C1306	OCK474CH94A	0603F474Z250CT 470nF -20TO+80% 25V Y5V -30
C1112	OCK104BF56A	C1005X7R104KET 100nF 10% 16V X7R -55TO+125	C1307	OCK682CK51A	C1608Y5P1H682KT 6.8nF 10% 50V Y5P -30TO+85
C1113	OCK103BH56A	C1005X7R1E103KT- 10nF 10% 25V X7R -55TO+12	C1308	OCK682CK51A	C1608Y5P1H682KT 6.8nF 10% 50V Y5P -30TO+85
C1114	OCK103BH56A	C1005X7R1E103KT- 10nF 10% 25V X7R -55TO+12	C1309	OCE475WK6DC	MVK5.0TP50VC4.7M 4.7uF 20% 50V 19MA -40TO+
C112	OCK104BF56A	C1005X7R104KET 100nF 10% 16V X7R -55TO+125	C131	OCK104BF56A	C1005X7R104KET 100nF 10% 16V X7R -55TO+125
C1120	OCK104BF56A	C1005X7R104KET 100nF 10% 16V X7R -55TO+125	C1310	OCE475WK6DC	MVK5.0TP50VC4.7M 4.7uF 20% 50V 19MA -40TO+
C1121	OCK104BF56A	C1005X7R104KET 100nF 10% 16V X7R -55TO+125	C1311	OCK104BF56A	C1005X7R104KET 100nF 10% 16V X7R -55TO+125
C1122	OCE476WC6DC	MVK5.0TP6.3VC47M 47uF 20% 6.3V 36MA -40TO+	C1312	OCK103BH56A	C1005X7R1E103KT- 10nF 10% 25V X7R -55TO+12
C1126	OCE476WC6DC	MVK5.0TP6.3VC47M 47uF 20% 6.3V 36MA -40TO+	C1313	OCE226WF6DC	MVK5.0TP16VC22M 22uF 20% 16V 30MA -40TO+10
C1127	OCE476WC6DC	MVK5.0TP6.3VC47M 47uF 20% 6.3V 36MA -40TO+	C1314	OCC030CK01A	0603N3ROC500LT 3pF 0.25PF 50V C0G -55TO+12
C1128	OCE476WC6DC	MVK5.0TP6.3VC47M 47uF 20% 6.3V 36MA -40TO+	C1315	OCC030CK01A	0603N3ROC500LT 3pF 0.25PF 50V C0G -55TO+12
C113	OCK104BF56A	C1005X7R104KET 100nF 10% 16V X7R -55TO+125	C1316	OCK104BF56A	C1005X7R104KET 100nF 10% 16V X7R -55TO+125
C114	OCK104BF56A	C1005X7R104KET 100nF 10% 16V X7R -55TO+125	C1317	OCC560BK41A	C1005C0G1H560JT 56pF 5% 50V C0G -55TO+125C
C115	OCK104BF56A	C1005X7R104KET 100nF 10% 16V X7R -55TO+125	C1318	OCC560BK41A	C1005C0G1H560JT 56pF 5% 50V C0G -55TO+125C
C116	OCK104BF56A	C1005X7R104KET 100nF 10% 16V X7R -55TO+125	C1319	OCE335WK6D8	MVK4.0TP50VC3.3M 3.3uF 20% 50V 14MA -40TO+
C117	OCK104BF56A	C1005X7R104KET 100nF 10% 16V X7R -55TO+125	C132	OCK104BF56A	C1005X7R104KET 100nF 10% 16V X7R -55TO+125
C118	OCE106WFKDC	MVK4.0TP16VC10M 10uF 20% 16V 16MA -40TO+10	C1320	OCK474CH94A	0603F474Z250CT 470nF -20TO+80% 25V Y5V -30
C119	OCK104BF56A	C1005X7R104KET 100nF 10% 16V X7R -55TO+125	C1321	OCK474CH94A	0603F474Z250CT 470nF -20TO+80% 25V Y5V -30
C120	OCK104BF56A	C1005X7R104KET 100nF 10% 16V X7R -55TO+125	C1322	OCK103BH56A	C1005X7R1E103KT- 10nF 10% 25V X7R -55TO+12
C1205	OCK103BH56A	C1005X7R1E103KT- 10nF 10% 25V X7R -55TO+12	C1325	OCE476WC6DC	MVK5.0TP6.3VC47M 47uF 20% 6.3V 36MA -40TO+
C1206	OCK102BK56A	0402B102K500CT 1nF 10% 50V X7R -55TO+125C	C1326	OCK474CH94A	0603F474Z250CT 470nF -20TO+80% 25V Y5V -30
C1207	OCK103BH56A	C1005X7R1E103KT- 10nF 10% 25V X7R -55TO+12	C1327	OCK104BF56A	C1005X7R104KET 100nF 10% 16V X7R -55TO+125
C1208	OCK102BK56A	0402B102K500CT 1nF 10% 50V X7R -55TO+125C	C1328	OCK224DK56A	CS2012X7R224K500NR 220nF 10% 50V X7R -55TO
C121	OCK104BF56A	C1005X7R104KET 100nF 10% 16V X7R -55TO+125	C1329	OCK474CH94A	0603F474Z250CT 470nF -20TO+80% 25V Y5V -30
			C133	OCK104BF56A	C1005X7R104KET 100nF 10% 16V X7R -55TO+125

LOC. NO.	PART NO.	DESCRIPTION / SPECIFICATION	LOC. NO.	PART NO.	DESCRIPTION / SPECIFICATION
C1330	0CK103BH56A	C1005X7R1E103KT- 10nF 10% 25V X7R -55TO+12	C1408	0CE476WF6DC	MVK6.3TP16VC47M 47uF 20% 16V 80MA -40TO+10
C1331	0CK224DK56A	CS2012X7R224K500NR 220nF 10% 50V X7R -55TO	C1409	0CK104BF56A	C1005X7R104KET 100nF 10% 16V X7R -55TO+125
C1332	0CK474CH94A	0603F474Z250CT 470nF -20TO+80% 25V Y5V -30	C141	0CK104BF56A	C1005X7R104KET 100nF 10% 16V X7R -55TO+125
C1333	0CK101BK4EA	C1005C0G1H101JT 100pF 5% 50V C0G -55TO+125	C1410	0CE476WF6DC	MVK6.3TP16VC47M 47uF 20% 16V 80MA -40TO+10
C1334	0CK225DH94A	C2012Y5V225ZFT 2.2uF -20TO+80% 25V Y5V -30	C1411	0CK103BH56A	C1005X7R1E103KT- 10nF 10% 25V X7R -55TO+12
C1335	0CK474CH94A	0603F474Z250CT 470nF -20TO+80% 25V Y5V -30	C1412	0CK104BF56A	C1005X7R104KET 100nF 10% 16V X7R -55TO+125
C1336	0CK225DH94A	C2012Y5V225ZFT 2.2uF -20TO+80% 25V Y5V -30	C1413	0CK104BF56A	C1005X7R104KET 100nF 10% 16V X7R -55TO+125
C1337	0CK225DH94A	C2012Y5V225ZFT 2.2uF -20TO+80% 25V Y5V -30	C1418	0CK474CH94A	0603F474Z250CT 470nF -20TO+80% 25V Y5V -30
C1338	0CK471BK56A	C1005X7R1H471KT 470pF 10% 50V X7R -55TO+12	C1419	0CK474CH94A	0603F474Z250CT 470nF -20TO+80% 25V Y5V -30
C1339	0CK225DH94A	C2012Y5V225ZFT 2.2uF -20TO+80% 25V Y5V -30	C142	0CK104BF56A	C1005X7R104KET 100nF 10% 16V X7R -55TO+125
C134	0CK104BF56A	C1005X7R104KET 100nF 10% 16V X7R -55TO+125	C1420	0CK225DFK4A	C2012Y5V1C225MT 2.2uF 20% 16V Y5V -30TO+85
C1340	0CK103BH56A	C1005X7R1E103KT- 10nF 10% 25V X7R -55TO+12	C1422	0CK474CH94A	0603F474Z250CT 470nF -20TO+80% 25V Y5V -30
C1341	0CE335WK6D8	MVK4.0TP50VC3.3M 3.3uF 20% 50V 14MA -40TO+	C1423	0CK474CH94A	0603F474Z250CT 470nF -20TO+80% 25V Y5V -30
C1342	0CK104BF56A	C1005X7R104KET 100nF 10% 16V X7R -55TO+125	C143	0CK104BF56A	C1005X7R104KET 100nF 10% 16V X7R -55TO+125
C1343	0CE107WF6DC	MVK6.3TP16VC100M 100uF 20% 16V 110MA -40TO	C1439	0CK474CH94A	0603F474Z250CT 470nF -20TO+80% 25V Y5V -30
C1343	0CE476WF6DC	MVK6.3TP16VC47M 47uF 20% 16V 80MA -40TO+10	C144	0CK104BF56A	C1005X7R104KET 100nF 10% 16V X7R -55TO+125
C1344	0CE106WH6DC	MVK5.0TP25VC10M 10uF 20% 25V 25MA -40TO+10	C1440	0CK225DFK4A	C2012Y5V1C225MT 2.2uF 20% 16V Y5V -30TO+85
C1345	0CE106WH6DC	MVK5.0TP25VC10M 10uF 20% 25V 25MA -40TO+10	C1441	0CK474CH94A	0603F474Z250CT 470nF -20TO+80% 25V Y5V -30
C1346	0CK474CH94A	0603F474Z250CT 470nF -20TO+80% 25V Y5V -30	C1442	0CK225DFK4A	C2012Y5V1C225MT 2.2uF 20% 16V Y5V -30TO+85
C1347	0CK474CH94A	0603F474Z250CT 470nF -20TO+80% 25V Y5V -30	C1447	0CK474CH94A	0603F474Z250CT 470nF -20TO+80% 25V Y5V -30
C1348	0CK224DK56A	CS2012X7R224K500NR 220nF 10% 50V X7R -55TO	C1448	0CK474CH94A	0603F474Z250CT 470nF -20TO+80% 25V Y5V -30
C1349	0CK224DK56A	CS2012X7R224K500NR 220nF 10% 50V X7R -55TO	C1449	0CK225DFK4A	C2012Y5V1C225MT 2.2uF 20% 16V Y5V -30TO+85
C135	0CK104BF56A	C1005X7R104KET 100nF 10% 16V X7R -55TO+125	C145	0CK104BF56A	C1005X7R104KET 100nF 10% 16V X7R -55TO+125
C1350	0CE227WJ6DC	MVK10TP35VC220M 220uF 20% 35V 375MA -40TO+	C1451	0CK104BF56A	C1005X7R104KET 100nF 10% 16V X7R -55TO+125
C1351	0CK105DK94A	0805F105Z500CT 1uF -20TO+80% 50V Y5V -30TO	C1452	0CC150BK4AA	C1005C0G1H150JT 15pF 5% 50V C0G -55TO+125C
C1352	0CK104CK56A	0603B104K500CT 100nF 10% 50V X7R -55TO+125	C1453	0CC150BK4AA	C1005C0G1H150JT 15pF 5% 50V C0G -55TO+125C
C1353	0CK105DK94A	0805F105Z500CT 1uF -20TO+80% 50V Y5V -30TO	C146	0CK104BF56A	C1005X7R104KET 100nF 10% 16V X7R -55TO+125
C1354	0CK105DK94A	0805F105Z500CT 1uF -20TO+80% 50V Y5V -30TO	C147	0CK104BF56A	C1005X7R104KET 100nF 10% 16V X7R -55TO+125
C1355	0CC221CK41A	C1608C0G1H221JT 220pF 5% 50V C0G -55TO+125	C148	0CK104BF56A	C1005X7R104KET 100nF 10% 16V X7R -55TO+125
C1356	0CK104CK56A	0603B104K500CT 100nF 10% 50V X7R -55TO+125	C149	0CK104BF56A	C1005X7R104KET 100nF 10% 16V X7R -55TO+125
C1357	0CK683CK56A	0603B683K500CT 68nF 10% 50V X7R -55TO+125C	C150	0CK104BF56A	C1005X7R104KET 100nF 10% 16V X7R -55TO+125
C1358	0CK683CK56A	0603B683K500CT 68nF 10% 50V X7R -55TO+125C	C151	0CK104BF56A	C1005X7R104KET 100nF 10% 16V X7R -55TO+125
C1359	0CK104CK56A	0603B104K500CT 100nF 10% 50V X7R -55TO+125	C152	0CK104BF56A	C1005X7R104KET 100nF 10% 16V X7R -55TO+125
C136	0CK104BF56A	C1005X7R104KET 100nF 10% 16V X7R -55TO+125	C153	0CK104BF56A	C1005X7R104KET 100nF 10% 16V X7R -55TO+125
C1360	0CK104CK56A	0603B104K500CT 100nF 10% 50V X7R -55TO+125	C154	0CK104BF56A	C1005X7R104KET 100nF 10% 16V X7R -55TO+125
C1361	0CK683CK56A	0603B683K500CT 68nF 10% 50V X7R -55TO+125C	C155	0CK104BF56A	C1005X7R104KET 100nF 10% 16V X7R -55TO+125
C1362	0CK683CK56A	0603B683K500CT 68nF 10% 50V X7R -55TO+125C	C156	0CK104BF56A	C1005X7R104KET 100nF 10% 16V X7R -55TO+125
C1367	0CK334CF56A	C1608X7R1C334KT 330nF 10% 16V X7R -55TO+12	C157	0CK104BF56A	C1005X7R104KET 100nF 10% 16V X7R -55TO+125
C1368	0CK334CF56A	C1608X7R1C334KT 330nF 10% 16V X7R -55TO+12	C158	0CK104BF56A	C1005X7R104KET 100nF 10% 16V X7R -55TO+125
C1369	0CK104CK56A	0603B104K500CT 100nF 10% 50V X7R -55TO+125	C159	0CK104BF56A	C1005X7R104KET 100nF 10% 16V X7R -55TO+125
C137	0CK104BF56A	C1005X7R104KET 100nF 10% 16V X7R -55TO+125	C160	0CK104BF56A	C1005X7R104KET 100nF 10% 16V X7R -55TO+125
C1371	0CK104BF56A	C1005X7R104KET 100nF 10% 16V X7R -55TO+125	C161	0CK104BF56A	C1005X7R104KET 100nF 10% 16V X7R -55TO+125
C1372	0CE476WC6DC	MVK5.0TP6.3VC47M 47uF 20% 6.3V 36MA -40TO+	C162	0CK104BF56A	C1005X7R104KET 100nF 10% 16V X7R -55TO+125
C138	0CK104BF56A	C1005X7R104KET 100nF 10% 16V X7R -55TO+125	C163	0CK104BF56A	C1005X7R104KET 100nF 10% 16V X7R -55TO+125
C139	0CK104BF56A	C1005X7R104KET 100nF 10% 16V X7R -55TO+125	C164	0CK104BF56A	C1005X7R104KET 100nF 10% 16V X7R -55TO+125
C140	0CK104BF56A	C1005X7R104KET 100nF 10% 16V X7R -55TO+125	C165	0CK104BF56A	C1005X7R104KET 100nF 10% 16V X7R -55TO+125
C1400	0CE475WK6DC	MVK5.0TP50VC4.7M 4.7uF 20% 50V 19MA -40TO+	C166	0CK106EF56A	C3216X7R1C106KT 10uF 10% 16V X7R -55TO+125
C1401	0CE475WK6DC	MVK5.0TP50VC4.7M 4.7uF 20% 50V 19MA -40TO+	C167	0CK106EF56A	C3216X7R1C106KT 10uF 10% 16V X7R -55TO+125
C1402	0CK682CK51A	C1608Y5P1H682KT 6.8nF 10% 50V Y5P -30TO+85	C168	0CK106EF56A	C3216X7R1C106KT 10uF 10% 16V X7R -55TO+125
C1403	0CK682CK51A	C1608Y5P1H682KT 6.8nF 10% 50V Y5P -30TO+85	C169	0CC100BKF1A	0402N100J500LT 10pF 5% 50V C0G -55TO+125C
C1404	0CK103BH56A	C1005X7R1E103KT- 10nF 10% 25V X7R -55TO+12	C170	0CH5220K618	0402N220M500LT 22pF 5% 50V C0G -55TO+125C
C1406	0CK104BF56A	C1005X7R104KET 100nF 10% 16V X7R -55TO+125	C1700	0CK104BF56A	C1005X7R104KET 100nF 10% 16V X7R -55TO+125
C1406	0CK104BF56A	C1005X7R104KET 100nF 10% 16V X7R -55TO+125	C1701	0CK104BF56A	C1005X7R104KET 100nF 10% 16V X7R -55TO+125
C1407	0CE226WF6DC	MVK5.0TP16VC22M 22uF 20% 16V 30MA -40TO+10	C1702	0CK104BF56A	C1005X7R104KET 100nF 10% 16V X7R -55TO+125
C1408	0CE107WF6DC	MVK6.3TP16VC100M 100uF 20% 16V 110MA -40TO	C1703	0CK104BF56A	C1005X7R104KET 100nF 10% 16V X7R -55TO+125

LOC. NO.	PART NO.	DESCRIPTION / SPECIFICATION	LOC. NO.	PART NO.	DESCRIPTION / SPECIFICATION
C1705	OCK104BF56A	C1005X7R104KET 100nF 10% 16V X7R -55TO+125	C224	OCK103BH56A	C1005X7R1E103KT- 10nF 10% 25V X7R -55TO+12
C1706	OCK104BF56A	C1005X7R104KET 100nF 10% 16V X7R -55TO+125	C226	OCE107WF6DC	MVK6.3TP16VC100M 100uF 20% 16V 110MA -40TO
C1707	OCK104BF56A	C1005X7R104KET 100nF 10% 16V X7R -55TO+125	C227	OCE107WF6DC	MVK6.3TP16VC100M 100uF 20% 16V 110MA -40TO
C1708	OCE476WC6DC	MVK5.0TP6.3VC47M 47uF 20% 6.3V 36MA -40TO+	C228	OCK103BH56A	C1005X7R1E103KT- 10nF 10% 25V X7R -55TO+12
C1709	OCK104BF56A	C1005X7R104KET 100nF 10% 16V X7R -55TO+125	C229	OCK103BH56A	C1005X7R1E103KT- 10nF 10% 25V X7R -55TO+12
C171	OCK103BH56A	C1005X7R1E103KT- 10nF 10% 25V X7R -55TO+12	C230	OCK103BH56A	C1005X7R1E103KT- 10nF 10% 25V X7R -55TO+12
C1710	OCK104BF56A	C1005X7R104KET 100nF 10% 16V X7R -55TO+125	C231	OCK103BH56A	C1005X7R1E103KT- 10nF 10% 25V X7R -55TO+12
C172	OCK103BH56A	C1005X7R1E103KT- 10nF 10% 25V X7R -55TO+12	C232	OCK103BH56A	C1005X7R1E103KT- 10nF 10% 25V X7R -55TO+12
C173	OCK104BF56A	C1005X7R104KET 100nF 10% 16V X7R -55TO+125	C233	OCK103BH56A	C1005X7R1E103KT- 10nF 10% 25V X7R -55TO+12
C174	OCK104BF56A	C1005X7R104KET 100nF 10% 16V X7R -55TO+125	C234	OCK104BF56A	C1005X7R104KET 100nF 10% 16V X7R -55TO+125
C175	OCK103BH56A	C1005X7R1E103KT- 10nF 10% 25V X7R -55TO+12	C235	OCK104BF56A	C1005X7R104KET 100nF 10% 16V X7R -55TO+125
C176	OCK103BH56A	C1005X7R1E103KT- 10nF 10% 25V X7R -55TO+12	C236	OCK104BF56A	C1005X7R104KET 100nF 10% 16V X7R -55TO+125
C177	OCK103BH56A	C1005X7R1E103KT- 10nF 10% 25V X7R -55TO+12	C237	OCK104BF56A	C1005X7R104KET 100nF 10% 16V X7R -55TO+125
C178	OCK104BF56A	C1005X7R104KET 100nF 10% 16V X7R -55TO+125	C238	OCK104BF56A	C1005X7R104KET 100nF 10% 16V X7R -55TO+125
C179	OCK104BF56A	C1005X7R104KET 100nF 10% 16V X7R -55TO+125	C239	OCK104BF56A	C1005X7R104KET 100nF 10% 16V X7R -55TO+125
C180	OCK104BF56A	C1005X7R104KET 100nF 10% 16V X7R -55TO+125	C240	OCK104BF56A	C1005X7R104KET 100nF 10% 16V X7R -55TO+125
C181	OCE106WH6DC	MVK5.0TP25VC10M 10uF 20% 25V 25MA -40TO+10	C241	OCK104BF56A	C1005X7R104KET 100nF 10% 16V X7R -55TO+125
C182	OCK105CD56A	C1608X7R1A105KT 1uF 10% 10V X7R -55TO+125C	C242	OCK104BF56A	C1005X7R104KET 100nF 10% 16V X7R -55TO+125
C183	OCK104BF56A	C1005X7R104KET 100nF 10% 16V X7R -55TO+125	C243	OCK104BF56A	C1005X7R104KET 100nF 10% 16V X7R -55TO+125
C184	OCK104BF56A	C1005X7R104KET 100nF 10% 16V X7R -55TO+125	C301	OCK104BF56A	C1005X7R104KET 100nF 10% 16V X7R -55TO+125
C185	OCK104BF56A	C1005X7R104KET 100nF 10% 16V X7R -55TO+125	C302	OCK104BF56A	C1005X7R104KET 100nF 10% 16V X7R -55TO+125
C186	OCK104BF56A	C1005X7R104KET 100nF 10% 16V X7R -55TO+125	C303	OCK104BF56A	C1005X7R104KET 100nF 10% 16V X7R -55TO+125
C187	OCK104BF56A	C1005X7R104KET 100nF 10% 16V X7R -55TO+125	C304	OCE226WF6DC	MVK5.0TP16VC22M 22uF 20% 16V 30MA -40TO+10
C188	OCK103BH56A	C1005X7R1E103KT- 10nF 10% 25V X7R -55TO+12	C306	OCK104BF56A	C1005X7R104KET 100nF 10% 16V X7R -55TO+125
C189	OCK103BH56A	C1005X7R1E103KT- 10nF 10% 25V X7R -55TO+12	C307	OCK104BF56A	C1005X7R104KET 100nF 10% 16V X7R -55TO+125
C190	OCK103BH56A	C1005X7R1E103KT- 10nF 10% 25V X7R -55TO+12	C308	OCK104BF56A	C1005X7R104KET 100nF 10% 16V X7R -55TO+125
C191	OCK103BH56A	C1005X7R1E103KT- 10nF 10% 25V X7R -55TO+12	C309	OCK104BF56A	C1005X7R104KET 100nF 10% 16V X7R -55TO+125
C192	OCK103BH56A	C1005X7R1E103KT- 10nF 10% 25V X7R -55TO+12	C310	OCK104BF56A	C1005X7R104KET 100nF 10% 16V X7R -55TO+125
C193	OCK822CK46A	0603B822J500CT 8.2nF 10% 50V X7R -55TO+125	C311	OCK104BF56A	C1005X7R104KET 100nF 10% 16V X7R -55TO+125
C194	OCK822CK46A	0603B822J500CT 8.2nF 10% 50V X7R -55TO+125	C312	OCK104BF56A	C1005X7R104KET 100nF 10% 16V X7R -55TO+125
C195	OCH5220K618	0402N220M500LT 22pF 5% 50V C0G -55TO+125C	C313	OCK104BF56A	C1005X7R104KET 100nF 10% 16V X7R -55TO+125
C196	OCC100BK1A	0402N100J500LT 10pF 5% 50V C0G -55TO+125C	C314	OCK104BF56A	C1005X7R104KET 100nF 10% 16V X7R -55TO+125
C197	OCK475CC94A	C1608Y5V0J475ZT 4.7uF -20TO+80% 6.3V Y5V -	C4000	OCN1040K949	CH UP050 F104Z-B-B Z 100nF -20TO+80% 50V Y
C198	OCK475CC94A	C1608Y5V0J475ZT 4.7uF -20TO+80% 6.3V Y5V -	C4001	OCN1040K949	CH UP050 F104Z-B-B Z 100nF -20TO+80% 50V Y
C199	OCK104BF56A	C1005X7R104KET 100nF 10% 16V X7R -55TO+125	C409	OCK104BF56A	C1005X7R104KET 100nF 10% 16V X7R -55TO+125
C200	OCK103BH56A	C1005X7R1E103KT- 10nF 10% 25V X7R -55TO+12	C410	OCK104BF56A	C1005X7R104KET 100nF 10% 16V X7R -55TO+125
C201	OCH5470K618	0402N470M500LT 47pF 5% 50V C0G -55TO+125C	C411	OCK104BF56A	C1005X7R104KET 100nF 10% 16V X7R -55TO+125
C202	OCK101BK4EA	C1005C0G1H101JT 100pF 5% 50V C0G -55TO+125	C412	OCE106WH6DC	MVK5.0TP25VC10M 10uF 20% 25V 25MA -40TO+10
C203	OCK104BF56A	C1005X7R104KET 100nF 10% 16V X7R -55TO+125	C413	OCK104BF56A	C1005X7R104KET 100nF 10% 16V X7R -55TO+125
C204	OCK103BH56A	C1005X7R1E103KT- 10nF 10% 25V X7R -55TO+12	C414	OCE106WH6DC	MVK5.0TP25VC10M 10uF 20% 25V 25MA -40TO+10
C205	OCK104BF56A	C1005X7R104KET 100nF 10% 16V X7R -55TO+125	C415	OCK104BF56A	C1005X7R104KET 100nF 10% 16V X7R -55TO+125
C206	OCK104BF56A	C1005X7R104KET 100nF 10% 16V X7R -55TO+125	C430	OCK104BF56A	C1005X7R104KET 100nF 10% 16V X7R -55TO+125
C207	OCK104BF56A	C1005X7R104KET 100nF 10% 16V X7R -55TO+125	C500	OCK106EF56A	C3216X7R1C106KT 10uF 10% 16V X7R -55TO+125
C209	OCK106EF56A	C3216X7R1C106KT 10uF 10% 16V X7R -55TO+125	C5000	OCH5101K416	C2012C0G1H101JT 100pF 5% 50V C0G -55TO+125
C210	OCK104BF56A	C1005X7R104KET 100nF 10% 16V X7R -55TO+125	C5001	OCH5101K416	C2012C0G1H101JT 100pF 5% 50V C0G -55TO+125
C211	OCK226FF67A	EMK325BJ226MM-T 22uF 20% 16V X5R -55TO+85C	C5002	OCH5470K416	0805N470J500LT 47pF 5% 50V C0G -55TO+125C
C212	OCK106EF56A	C3216X7R1C106KT 10uF 10% 16V X7R -55TO+125	C5003	OCK104DK56A	0805B104K500CT 100nF 10% 50V X7R -55TO+125
C213	OCK106EF56A	C3216X7R1C106KT 10uF 10% 16V X7R -55TO+125	C501	OCK104BF56A	C1005X7R104KET 100nF 10% 16V X7R -55TO+125
C214	OCK226FF67A	EMK325BJ226MM-T 22uF 20% 16V X5R -55TO+85C	C501	OCK106EF56A	C3216X7R1C106KT 10uF 10% 16V X7R -55TO+125
C216	OCK106EF56A	C3216X7R1C106KT 10uF 10% 16V X7R -55TO+125	C502	OCK106EF56A	C3216X7R1C106KT 10uF 10% 16V X7R -55TO+125
C218	OCK103BH56A	C1005X7R1E103KT- 10nF 10% 25V X7R -55TO+12	C503	OCE337WH6DC	MVK10TP25VC330M 330uF 20% 25V 450MA -40TO+
C219	OCK103BH56A	C1005X7R1E103KT- 10nF 10% 25V X7R -55TO+12	C504	OCK104BF56A	C1005X7R104KET 100nF 10% 16V X7R -55TO+125
C220	OCK103BH56A	C1005X7R1E103KT- 10nF 10% 25V X7R -55TO+12	C504	OCK106EF56A	C3216X7R1C106KT 10uF 10% 16V X7R -55TO+125
C221	OCK103BH56A	C1005X7R1E103KT- 10nF 10% 25V X7R -55TO+12	C505	OCK101BK4EA	C1005C0G1H101JT 100pF 5% 50V C0G -55TO+125
C222	OCK103BH56A	C1005X7R1E103KT- 10nF 10% 25V X7R -55TO+12	C506	OCK106EF56A	C3216X7R1C106KT 10uF 10% 16V X7R -55TO+125

LOC. NO.	PART NO.	DESCRIPTION / SPECIFICATION	LOC. NO.	PART NO.	DESCRIPTION / SPECIFICATION
C507	OCE227WF6DC	MVK8.0TP16VC220M 220uF 20% 16V 80MA -40TO+	C558	OCK104CF56A	0603B104K160CT 100nF 10% 16V X7R -55TO+125
C508	OCK104BF56A	C1005X7R104KET 100nF 10% 16V X7R -55TO+125	C559	OCE107WF6DC	MVK6.3TP16VC100M 100uF 20% 16V 110MA -40TO
C508	OCK106EF56A	C3216X7R1C106KT 10uF 10% 16V X7R -55TO+125	C560	OCK104BF56A	C1005X7R104KET 100nF 10% 16V X7R -55TO+125
C509	OCC102CK41A	C1608C0G1H102JT 1nF 5% 50V C0G -55TO+125C	C562	OCK103BH56A	C1005X7R1E103KT- 10nF 10% 25V X7R -55TO+12
C510	OCE107WF6DC	MVK6.3TP16VC100M 100uF 20% 16V 110MA -40TO	C563	OCK101BK4EA	C1005C0G1H101JT 100pF 5% 50V C0G -55TO+125
C511	OCK225DH94A	C2012Y5V225ZFT 2.2uF -20TO+80% 25V Y5V -30	C564	OCK103BH56A	C1005X7R1E103KT- 10nF 10% 25V X7R -55TO+12
C511	OCK225DH94A	C2012Y5V225ZFT 2.2uF -20TO+80% 25V Y5V -30	C565	OCK104BF56A	C1005X7R104KET 100nF 10% 16V X7R -55TO+125
C512	OCE107WF6DC	MVK6.3TP16VC100M 100uF 20% 16V 110MA -40TO	C566	OCE107WF6DC	MVK6.3TP16VC100M 100uF 20% 16V 110MA -40TO
C513	OCK104BF56A	C1005X7R104KET 100nF 10% 16V X7R -55TO+125	C567	OCK104BF56A	C1005X7R104KET 100nF 10% 16V X7R -55TO+125
C514	OCE107WF6DC	MVK6.3TP16VC100M 100uF 20% 16V 110MA -40TO	C568	OCK104BF56A	C1005X7R104KET 100nF 10% 16V X7R -55TO+125
C515	EAE32707901	20SVP22M 22uF 20% 20V 1.45A -55TO+105C SVP	C569	OCK104BF56A	C1005X7R104KET 100nF 10% 16V X7R -55TO+125
C516	OCK104BF56A	C1005X7R104KET 100nF 10% 16V X7R -55TO+125	C571	OCE106WH6DC	MVK5.0TP25VC10M 10uF 20% 25V 25MA -40TO+10
C517	OCK104BF56A	C1005X7R104KET 100nF 10% 16V X7R -55TO+125	C572	OCE226WF6DC	MVK5.0TP16VC22M 22uF 20% 16V 30MA -40TO+10
C518	OCE107WF6DC	MVK6.3TP16VC100M 100uF 20% 16V 110MA -40TO	C573	OCK104BF56A	C1005X7R104KET 100nF 10% 16V X7R -55TO+125
C519	OCK104BF56A	C1005X7R104KET 100nF 10% 16V X7R -55TO+125	C574	OCE107WF6DC	MVK6.3TP16VC100M 100uF 20% 16V 110MA -40TO
C520	OCK474CH94A	0603F474Z250CT 470nF -20TO+80% 25V Y5V -30	C574	OCE476WF6DC	MVK6.3TP16VC47M 47uF 20% 16V 80MA -40TO+10
C521	OCK106EF56A	C3216X7R1C106KT 10uF 10% 16V X7R -55TO+125	C575	OCK104BF56A	C1005X7R104KET 100nF 10% 16V X7R -55TO+125
C522	OCK103CK51A	0603B103K500CT 10nF 10% 50V Y5P -30TO+85C	C576	OCK101BK4EA	C1005C0G1H101JT 100pF 5% 50V C0G -55TO+125
C523	OCE107WF6DC	MVK6.3TP16VC100M 100uF 20% 16V 110MA -40TO	C576	0CZZB00061A	C1005C0G1H050CT 5pF 0.25PF 50V C0G -55TO+1
C524	OCK104BF56A	C1005X7R104KET 100nF 10% 16V X7R -55TO+125	C577	OCK101BK4EA	C1005C0G1H101JT 100pF 5% 50V C0G -55TO+125
C525	OCK104BF56A	C1005X7R104KET 100nF 10% 16V X7R -55TO+125	C577	0CZZB00061A	C1005C0G1H050CT 5pF 0.25PF 50V C0G -55TO+1
C525	OCK106EF56A	C3216X7R1C106KT 10uF 10% 16V X7R -55TO+125	C578	OCC331CK41A	C1608C0G1H331JT 330pF 5% 50V C0G -55TO+125
C526	OCE107WF6DC	MVK6.3TP16VC100M 100uF 20% 16V 110MA -40TO	C579	OCC331CK41A	C1608C0G1H331JT 330pF 5% 50V C0G -55TO+125
C527	OCK104CK56A	0603B104K500CT 100nF 10% 50V X7R -55TO+125	C580	OCE226WJ6DC	MVK6.3TP35VC22M 22uF 20% 35V 40MA -40TO+10
C528	OCK222CK51A	0603B222K500CT 2.2nF 10% 50V Y5P -30TO+85C	C581	OCK104CK56A	0603B104K500CT 100nF 10% 50V X7R -55TO+125
C529	OCK226FF67A	EMK325BJ226MM-T 22uF 20% 16V X5R -55TO+85C	C582	OCE107WF6DC	MVK6.3TP16VC100M 100uF 20% 16V 110MA -40TO
C529	OCK226FF67A	EMK325BJ226MM-T 22uF 20% 16V X5R -55TO+85C	C583	OCK104BF56A	C1005X7R104KET 100nF 10% 16V X7R -55TO+125
C530	OCE227WF6DC	MVK8.0TP16VC220M 220uF 20% 16V 80MA -40TO+	C584	OCE107WF6DC	MVK6.3TP16VC100M 100uF 20% 16V 110MA -40TO
C531	OCK105CF94A	0603F105Z160CT 1uF -20TO+80% 16V Y5V -30TO	C601	OCK101BK4EA	C1005C0G1H101JT 100pF 5% 50V C0G -55TO+125
C532	OCE226WJ6DC	MVK6.3TP35VC22M 22uF 20% 35V 40MA -40TO+10	C602	OCK104BF56A	C1005X7R104KET 100nF 10% 16V X7R -55TO+125
C533	OCE226WF6DC	MVK5.0TP16VC22M 22uF 20% 16V 30MA -40TO+10	C603	OCK103BH56A	C1005X7R1E103KT- 10nF 10% 25V X7R -55TO+12
C534	OCK104BF56A	C1005X7R104KET 100nF 10% 16V X7R -55TO+125	C604	OCC100BK1A	0402N100J500LT 10pF 5% 50V C0G -55TO+125C
C535	OCK104CK56A	0603B104K500CT 100nF 10% 50V X7R -55TO+125	C604	OCH5470K618	0402N470M500LT 47pF 5% 50V C0G -55TO+125C
C539	OCE107WF6DC	MVK6.3TP16VC100M 100uF 20% 16V 110MA -40TO	C605	OCK104BF56A	C1005X7R104KET 100nF 10% 16V X7R -55TO+125
C539	OCE476WF6DC	MVK6.3TP16VC47M 47uF 20% 16V 80MA -40TO+10	C606	OCK104BF56A	C1005X7R104KET 100nF 10% 16V X7R -55TO+125
C540	OCK104BF56A	C1005X7R104KET 100nF 10% 16V X7R -55TO+125	C608	OCK101BK4EA	C1005C0G1H101JT 100pF 5% 50V C0G -55TO+125
C541	OCK104BF56A	C1005X7R104KET 100nF 10% 16V X7R -55TO+125	C609	OCK104BF56A	C1005X7R104KET 100nF 10% 16V X7R -55TO+125
C542	OCE226WF6DC	MVK5.0TP16VC22M 22uF 20% 16V 30MA -40TO+10	C610	OCC271CK41A	C1608C0G1H271JT 270pF 5% 50V C0G -55TO+125
C543	OCK104BF56A	C1005X7R104KET 100nF 10% 16V X7R -55TO+125	C612	OCE476WC6DC	MVK5.0TP6.3VC47M 47uF 20% 6.3V 36MA -40TO+
C543	OCK104CF56A	0603B104K160CT 100nF 10% 16V X7R -55TO+125	C613	OCE107WF6DC	MVK6.3TP16VC100M 100uF 20% 16V 110MA -40TO
C544	OCK104BF56A	C1005X7R104KET 100nF 10% 16V X7R -55TO+125	C615	OCK104CK56A	0603B104K500CT 100nF 10% 50V X7R -55TO+125
C545	OCK104BF56A	C1005X7R104KET 100nF 10% 16V X7R -55TO+125	C616	OCK104CK56A	0603B104K500CT 100nF 10% 50V X7R -55TO+125
C545	OCK104BF56A	C1005X7R104KET 100nF 10% 16V X7R -55TO+125	C623	OCH5470K618	0402N470M500LT 47pF 5% 50V C0G -55TO+125C
C546	OCK104BF56A	C1005X7R104KET 100nF 10% 16V X7R -55TO+125	C624	OCH5470K618	0402N470M500LT 47pF 5% 50V C0G -55TO+125C
C547	OCE226WF6DC	MVK5.0TP16VC22M 22uF 20% 16V 30MA -40TO+10	C625	OCK104BF56A	C1005X7R104KET 100nF 10% 16V X7R -55TO+125
C550	OCK104BF56A	C1005X7R104KET 100nF 10% 16V X7R -55TO+125	C626	OCK104BF56A	C1005X7R104KET 100nF 10% 16V X7R -55TO+125
C551	OCE107WF6DC	MVK6.3TP16VC100M 100uF 20% 16V 110MA -40TO	C627	OCK104BF56A	C1005X7R104KET 100nF 10% 16V X7R -55TO+125
C551	OCE476WF6DC	MVK6.3TP16VC47M 47uF 20% 16V 80MA -40TO+10	C630	OCE107WF6DC	MVK6.3TP16VC100M 100uF 20% 16V 110MA -40TO
C552	OCK104BF56A	C1005X7R104KET 100nF 10% 16V X7R -55TO+125	C630	EAE32707901	20SVP22M 22uF 20% 20V 1.45A -55TO+105C SVP
C553	OCE107WF6DC	MVK6.3TP16VC100M 100uF 20% 16V 110MA -40TO	C633	OCK106CC67A	C1608X5R0J106MT 10uF 20% 6.3V X5R -55TO+85
C554	OCK104BF56A	C1005X7R104KET 100nF 10% 16V X7R -55TO+125	C633	OCK475CC94A	C1608Y5V0J475ZT 4.7uF -20TO+80% 6.3V Y5V -
C555	OCE107WF6DC	MVK6.3TP16VC100M 100uF 20% 16V 110MA -40TO	C635	OCK472CK56A	0603B472K500CT 4.7nF 10% 50V X7R -55TO+125
C556	OCK104BF56A	C1005X7R104KET 100nF 10% 16V X7R -55TO+125	C636	OCK103BH56A	C1005X7R1E103KT- 10nF 10% 25V X7R -55TO+12
C557	OCK104BF56A	C1005X7R104KET 100nF 10% 16V X7R -55TO+125	C637	OCK472CK56A	0603B472K500CT 4.7nF 10% 50V X7R -55TO+125
C558	OCK104BF56A	C1005X7R104KET 100nF 10% 16V X7R -55TO+125	C639	OCE476WC6DC	MVK5.0TP6.3VC47M 47uF 20% 6.3V 36MA -40TO+



LOC. NO.	PART NO.	DESCRIPTION / SPECIFICATION	LOC. NO.	PART NO.	DESCRIPTION / SPECIFICATION
C815	OCK104BF56A	C1005X7R104KET 100nF 10% 16V X7R -55TO+125	D900	ODR340009AA	MBRS340 525MV 40V 4A 0SEC 0F 0W DO214 R/TP
C817	OCK103BH56A	C1005X7R1E103KT- 10nF 10% 25V X7R -55TO+12	ZD1100	EAH33946001	CDS3C05GTA 5.6V 6.4V 19V 1.9A 1W SOD123 R/
C818	OCK104BF56A	C1005X7R104KET 100nF 10% 16V X7R -55TO+125	ZD1101	EAH33946001	CDS3C05GTA 5.6V 6.4V 19V 1.9A 1W SOD123 R/
C824	OCK103BH56A	C1005X7R1E103KT- 10nF 10% 25V X7R -55TO+12	ZD1104	EAH33945901	CDS3C30GTH 30V 50V 120V 1.9A 1W SOD123 R/T
C826	OCK103BH56A	C1005X7R1E103KT- 10nF 10% 25V X7R -55TO+12	ZD1105	EAH33945901	CDS3C30GTH 30V 50V 120V 1.9A 1W SOD123 R/T
C828	OCK104BF56A	C1005X7R104KET 100nF 10% 16V X7R -55TO+125	ZD1106	EAH33945901	CDS3C30GTH 30V 50V 120V 1.9A 1W SOD123 R/T
C830	OCK104BF56A	C1005X7R104KET 100nF 10% 16V X7R -55TO+125	ZD1107	EAH33945901	CDS3C30GTH 30V 50V 120V 1.9A 1W SOD123 R/T
C831	OCK103BH56A	C1005X7R1E103KT- 10nF 10% 25V X7R -55TO+12	ZD1108	EAH33945901	CDS3C30GTH 30V 50V 120V 1.9A 1W SOD123 R/T
C834	OCK104BF56A	C1005X7R104KET 100nF 10% 16V X7R -55TO+125	ZD1109	EAH33945901	CDS3C30GTH 30V 50V 120V 1.9A 1W SOD123 R/T
C836	OCK103BH56A	C1005X7R1E103KT- 10nF 10% 25V X7R -55TO+12	ZD1112	EAH33945901	CDS3C30GTH 30V 50V 120V 1.9A 1W SOD123 R/T
C840	OCK103BH56A	C1005X7R1E103KT- 10nF 10% 25V X7R -55TO+12	ZD1113	EAH33945901	CDS3C30GTH 30V 50V 120V 1.9A 1W SOD123 R/T
C841	OCK103BH56A	C1005X7R1E103KT- 10nF 10% 25V X7R -55TO+12	ZD1114	EAH33945901	CDS3C30GTH 30V 50V 120V 1.9A 1W SOD123 R/T
C844	OCK103BH56A	C1005X7R1E103KT- 10nF 10% 25V X7R -55TO+12	ZD1201	EAH33946001	CDS3C05GTA 5.6V 6.4V 19V 1.9A 1W SOD123 R/
C846	OCK104BF56A	C1005X7R104KET 100nF 10% 16V X7R -55TO+125	ZD1202	EAH33946001	CDS3C05GTA 5.6V 6.4V 19V 1.9A 1W SOD123 R/
C847	OCK104BF56A	C1005X7R104KET 100nF 10% 16V X7R -55TO+125	ZD1203	EAH33945901	CDS3C30GTH 30V 50V 120V 1.9A 1W SOD123 R/T
C850	OCK103BH56A	C1005X7R1E103KT- 10nF 10% 25V X7R -55TO+12	ZD1211	EAH33946001	CDS3C05GTA 5.6V 6.4V 19V 1.9A 1W SOD123 R/
C851	OCK225DFK4A	C2012Y5V1C225MT 2.2uF 20% 16V Y5V -30TO+85	ZD1212	EAH33946001	CDS3C05GTA 5.6V 6.4V 19V 1.9A 1W SOD123 R/
C852	OCE107WFD6C	MVK6.3TP16VC100M 100uF 20% 16V 110MA -40TO	ZD1218	EAH33945901	CDS3C30GTH 30V 50V 120V 1.9A 1W SOD123 R/T
C853	OCE107WFD6C	MVK6.3TP16VC100M 100uF 20% 16V 110MA -40TO	ZD1219	EAH33945901	CDS3C30GTH 30V 50V 120V 1.9A 1W SOD123 R/T
C854	OCK103BH56A	C1005X7R1E103KT- 10nF 10% 25V X7R -55TO+12	ZD1220	EAH33945901	CDS3C30GTH 30V 50V 120V 1.9A 1W SOD123 R/T
C855	OCK103BH56A	C1005X7R1E103KT- 10nF 10% 25V X7R -55TO+12	ZD1221	EAH33945901	CDS3C30GTH 30V 50V 120V 1.9A 1W SOD123 R/T
C856	OCK103BH56A	C1005X7R1E103KT- 10nF 10% 25V X7R -55TO+12	ZD1222	EAH33945901	CDS3C30GTH 30V 50V 120V 1.9A 1W SOD123 R/T
C857	OCK104BF56A	C1005X7R104KET 100nF 10% 16V X7R -55TO+125	ZD1223	EAH33945901	CDS3C30GTH 30V 50V 120V 1.9A 1W SOD123 R/T
C858	OCK104BF56A	C1005X7R104KET 100nF 10% 16V X7R -55TO+125	ZD1224	EAH33945901	CDS3C30GTH 30V 50V 120V 1.9A 1W SOD123 R/T
C859	OCK104BF56A	C1005X7R104KET 100nF 10% 16V X7R -55TO+125	ZD1226	EAH33945901	CDS3C30GTH 30V 50V 120V 1.9A 1W SOD123 R/T
C860	OCK104BF56A	C1005X7R104KET 100nF 10% 16V X7R -55TO+125	ZD1228	EAH33946001	CDS3C05GTA 5.6V 6.4V 19V 1.9A 1W SOD123 R/
C861	OCK104BF56A	C1005X7R104KET 100nF 10% 16V X7R -55TO+125	ZD1229	EAH33946001	CDS3C05GTA 5.6V 6.4V 19V 1.9A 1W SOD123 R/
C862	OCK104BF56A	C1005X7R104KET 100nF 10% 16V X7R -55TO+125	ZD4000	ODZ560009CF	MTZJ5.6B 5.6V 5.45TO5.73V 40OHM 500MW DO34
C863	OCK104BF56A	C1005X7R104KET 100nF 10% 16V X7R -55TO+125	ZD4001	ODZ560009CF	MTZJ5.6B 5.6V 5.45TO5.73V 40OHM 500MW DO34
C864	OCK104BF56A	C1005X7R104KET 100nF 10% 16V X7R -55TO+125	ZD5000	ODZ560009DA	UDZS5.6B 5.6V 5.49TO5.73V 60OHM 200MW SOD3
C865	OCK104BF56A	C1005X7R104KET 100nF 10% 16V X7R -55TO+125			
C866	OCK104BF56A	C1005X7R104KET 100nF 10% 16V X7R -55TO+125			
C867	OCK104BF56A	C1005X7R104KET 100nF 10% 16V X7R -55TO+125			
C868	OCK104BF56A	C1005X7R104KET 100nF 10% 16V X7R -55TO+125			
C869	OCK104BF56A	C1005X7R104KET 100nF 10% 16V X7R -55TO+125			
C870	OCK104BF56A	C1005X7R104KET 100nF 10% 16V X7R -55TO+125			
C871	OCK104BF56A	C1005X7R104KET 100nF 10% 16V X7R -55TO+125			
C872	OCK104BF56A	C1005X7R104KET 100nF 10% 16V X7R -55TO+125			
C873	OCK104BF56A	C1005X7R104KET 100nF 10% 16V X7R -55TO+125			
C874	OCK104BF56A	C1005X7R104KET 100nF 10% 16V X7R -55TO+125			
C875	OCK104BF56A	C1005X7R104KET 100nF 10% 16V X7R -55TO+125			
C876	OCK104BF56A	C1005X7R104KET 100nF 10% 16V X7R -55TO+125			
C877	OCK104BF56A	C1005X7R104KET 100nF 10% 16V X7R -55TO+125			
C878	OCK104BF56A	C1005X7R104KET 100nF 10% 16V X7R -55TO+125			
C90	OCK104BF56A	C1005X7R104KET 100nF 10% 16V X7R -55TO+125			
C91	OCK105CD56A	C1608X7R1A105KT 1uF 10% 10V X7R -55TO+125C			
C92	OCK105CD56A	C1608X7R1A105KT 1uF 10% 10V X7R -55TO+125C			
C93	OCK105CD56A	C1608X7R1A105KT 1uF 10% 10V X7R -55TO+125C			
C94	OCK105CD56A	C1608X7R1A105KT 1uF 10% 10V X7R -55TO+125C			
<b>DIODEs</b>					
D1000	ODSIH00028A	MC2838-T112-1 1.2V 75V 300MA 4A 3NSEC 150M			
D1300	ODS181009AA	KDS181 1.2V 85V 300MA 2A 4NSEC 150MW SOT23			
D1301	ODS181009AA	KDS181 1.2V 85V 300MA 2A 4NSEC 150MW SOT23			
<b>ICs</b>					
IC100	OIPRP00703C	STI5100GUC(CUT3.3) 3.3V 5u 27M PBGA TR 336			
IC1000	OIPRP00623A	CM2021-00TR 1VTO5.5V,0VTO0V,0VTO0V 0W TSSO			
IC1002	OIMMRAL014D	AT24C02BN-SH-T 2KBIT 256x8BIT 1.8VTO5.5V 1			
IC102	OISTLPH026A	74LVC14APW 1.2TO3.6V 0.01mA SCHMITT TRIGGE			
IC103	OIMP242560A	24LC256T-I/SIM 256KBIT 256X8BIT 2.5VTO5.5V			
IC104	OISTL00029A	MC33078DR2G +-5TO+-18V 2mV 0.002% 0W 0W 80			
IC1100	OIMMRAL014D	AT24C02BN-SH-T 2KBIT 256x8BIT 1.8VTO5.5V 1			
IC1101	OIPH741400E	74HC14D 2TO6V 0.002mA SCHMITT TRIGGER INVE			
IC1102	OIPRP00009A	ICL3232CBNZ 3VTO5.5V - SSOP R/TP 16P INTE			
IC1104	OITO741570C	TC74LCX157FT 2TO3.6V 0.01mA MULTIPLEXER TS			
IC1105	OIMCRFA018A	NC7SB3157P6X_NL 1.65TO5.5V 0.001mA SWITCH/			
IC1106	OIMCRFA018A	NC7SB3157P6X_NL 1.65TO5.5V 0.001mA SWITCH/			
IC1300	OIMCRMN028C	MSP4450K-QA-D6 7.6TO8.7V 4.75TO5.25V 3.15T			
IC1301	OIPRP00007A	TPA3005D2PHPRG4 8.5TO18V - 0.1% 6W 4300MW			
IC1400	OISO206900A	CXA2069Q 8.5TO9.5V - - 1.3W QFP TR 64P -			
IC200	OIPMG78391A	SC2595STR 2.3TO5V 0 0W SOIC R/TP 8P SEMTE			
IC202	OIMMRIH038B	HYB25D(C)256160CE-5 256MBIT 4MX16BITX4BANK			
IC300	OISTLPH003B	74LVC541APW 1.2TO3.6V 0.01mA BUFFER/LINE D			
IC301	OIMCRFA013A	74LCX244MTC 2TO3.6V 0.01mA BUFFER/LINE DRI			
IC302	OISTLPH003B	74LVC541APW 1.2TO3.6V 0.01mA BUFFER/LINE D			
IC303	OIMCRFA013A	74LCX244MTC 2TO3.6V 0.01mA BUFFER/LINE DRI			
IC304	OISTLPH048A	74LVC245APW 1.2TO3.6V 0.01mA TRANSCEIVER T			



LOC. NO.	PART NO.	DESCRIPTION / SPECIFICATION
IC305	01STL00083A	74LCX373MTC 2.0V to 3.6V 10uA LATCH TSSOP2
IC306	01STL00083A	74LCX373MTC 2.0V to 3.6V 10uA LATCH TSSOP2
IC402	01TO740800C	TC74LCX08FT 2TO3.6V 10uA AND GATE TSSOP R/
IC403	01MCRPH015A	74LVC32AD 1.2TO3.6V 0.01mA OR GATE SO R/TP
IC404	01STLPH026A	74LVC14APW 1.2TO3.6V 0.01mA SCHMITT TRIGGE
IC410	01TO741570C	TC74LCX157FT 2TO3.6V 0.01mA MULTIPLEXER TS
IC501	01PMGS1010A	SC42151STRT 1.6TO5.5V 3.3V 650MW SOIC R/TP
IC502	01PMGA0010A	AZ1117H-3.3 4.75TO10V 3.3V 0W SOT223 R/TP
IC503	01MCRMZ001A	MP1583DN-Z,LF 4.75TO23V 21V 0W SOIC R/TP 8
IC504	01MCRKE010A	KIA7812AF 14.5TO27V 12V 1.3W DPAK R/TP 3P
IC505	EAN32662801	KA7809ERTM 35V to 40V 9V 1W DPAK R/TP 3P
IC507	EAN38059801	BD9130NV 2.7VTO5.5V 1.0VTO2.5V 900MW SON00
IC508	01PMG00049A	AZ1117H-1.8TR/E1[H13A] 3.2TO10V 1.8V 0W SO
IC509	01PMG00027A	SC156515M-1.8TR 2.2TO5.5V 1.8V 0W TO263 ST
IC509	01PMGS1010A	SC42151STRT 1.6TO5.5V 3.3V 650MW SOIC R/TP
IC510	01PMGKE044A	KIA7808AF 10.5TO23V 8V 1.3W DPAK R/TP 3P
IC511	01PMGA0010A	AZ1117H-3.3 4.75TO10V 3.3V 0W SOT223 R/TP
IC512	01PMG00049A	AZ1117H-1.8TR/E1[H13A] 3.2TO10V 1.8V 0W SO
IC514	01PMG00004A	KIA7805AF 7TO20V 5V 1.3W DPAK R/TP 3P KEC
IC515	01MCRKE010A	KIA7812AF 14.5TO27V 12V 1.3W DPAK R/TP 3P
IC523	EAN38059801	BD9130NV 2.7VTO5.5V 1.0VTO2.5V 900MW SON00
IC600	01PRP00602A	TPS2010ADR 2.7TO5.5V 8.6MSEC 3.4MSEC 727MW
IC700	EAN33595901	FLI8548H-LF-BE 300MVTO3.6V,300MVTO2.75V,30
IC701	01IMP242560A	24LC256T-I/SM 256KBIT 256KX8BIT 2.5VTO5.5V
IC702	EAN34099701	M2404HEPROM 4KBIT 512 x 8bit 2.5VTO5.5V 10
IC800	EAN31729201	HY5DU561622ETP-4 256MBIT 16M * 16bit 2.4VT
IC801	EAN31729201	HY5DU561622ETP-4 256MBIT 16M * 16bit 2.4VT
IC804	01PMG78391A	SC2595STR 2.3TO5V 0 0W SOIC R/TP 8P SEMTE

**TRANSISTORS & FETs**

Q100	OTRIH80002A	2SA1530A-T112-1R PNP -6V -60V -50V -0.15A
Q101	OTRIH80004A	RT1P141C-T112 PNP -10V -50V -50V -0.1A -0.
Q102	OTRIY80001A	2SC3052 NPN 6V 50V 50V 200MA 100NA 150TO80
Q103	OTRIY80001A	2SC3052 NPN 6V 50V 50V 200MA 100NA 150TO80
Q1100	OTRIY80001A	2SC3052 NPN 6V 50V 50V 200MA 100NA 150TO80
Q1101	OTRIY80001A	2SC3052 NPN 6V 50V 50V 200MA 100NA 150TO80
Q1200	OTRIY80001A	2SC3052 NPN 6V 50V 50V 200MA 100NA 150TO80
Q1201	OTRIY80001A	2SC3052 NPN 6V 50V 50V 200MA 100NA 150TO80
Q1202	OTRIY80001A	2SC3052 NPN 6V 50V 50V 200MA 100NA 150TO80
Q1203	OTRIH80004A	RT1P141C-T112 PNP -10V -50V -50V -0.1A -0.
Q1204	OTRIY80001A	2SC3052 NPN 6V 50V 50V 200MA 100NA 150TO80
Q1208	OTRIY80001A	2SC3052 NPN 6V 50V 50V 200MA 100NA 150TO80
Q1209	OTRIY80001A	2SC3052 NPN 6V 50V 50V 200MA 100NA 150TO80
Q1210	OTRIY80001A	2SC3052 NPN 6V 50V 50V 200MA 100NA 150TO80
Q1300	OTRIY80001A	2SC3052 NPN 6V 50V 50V 200MA 100NA 150TO80
Q1301	OTRIY80001A	2SC3052 NPN 6V 50V 50V 200MA 100NA 150TO80
Q1302	OTRIY80001A	2SC3052 NPN 6V 50V 50V 200MA 100NA 150TO80
Q1303	OTRIY80001A	2SC3052 NPN 6V 50V 50V 200MA 100NA 150TO80
Q1304	OTRIY80001A	2SC3052 NPN 6V 50V 50V 200MA 100NA 150TO80
Q1305	OTRIH80004A	RT1P141C-T112 PNP -10V -50V -50V -0.1A -0.
Q1306	OTR150400BA	2SA1504S(ASY) PNP -5V -50V -50V -0.15A -0.
Q1307	OTR387500AA	2SC3875S(ALY) NPN 5V 60V 50V 150MA 100NA 7
Q1400	OTRIY80001A	2SC3052 NPN 6V 50V 50V 200MA 100NA 150TO80
Q1401	OTRIY80001A	2SC3052 NPN 6V 50V 50V 200MA 100NA 150TO80

LOC. NO.	PART NO.	DESCRIPTION / SPECIFICATION
Q1402	OTRIY80001A	2SC3052 NPN 6V 50V 50V 200MA 100NA 150TO80
Q1403	OTRIH80002A	2SA1530A-T112-1R PNP -6V -60V -50V -0.15A
Q1404	OTRIY80001A	2SC3052 NPN 6V 50V 50V 200MA 100NA 150TO80
Q500	OTR387500AA	2SC3875S(ALY) NPN 5V 60V 50V 150MA 100NA 7
Q5001	OTR387500AA	2SC3875S(ALY) NPN 5V 60V 50V 150MA 100NA 7
Q5002	OTR387500AA	2SC3875S(ALY) NPN 5V 60V 50V 150MA 100NA 7
Q501	OTFIR80017B	IRLML5203TRPBF P-CHANNEL MOSFET -30V +-20V
Q502	OTR387500AA	2SC3875S(ALY) NPN 5V 60V 50V 150MA 100NA 7
Q503	OTR387500AA	2SC3875S(ALY) NPN 5V 60V 50V 150MA 100NA 7
Q504	OTR387500AA	2SC3875S(ALY) NPN 5V 60V 50V 150MA 100NA 7
Q505	EBK32753101	SI4925BDY P-CHANNEL MOSFET -30V +20 -7.1A
Q602	OTRIH80002A	2SA1530A-T112-1R PNP -6V -60V -50V -0.15A
Q603	OTRIY80001A	2SC3052 NPN 6V 50V 50V 200MA 100NA 150TO80
Q604	OTRIY80001A	2SC3052 NPN 6V 50V 50V 200MA 100NA 150TO80
Q606	OTRIH80002A	2SA1530A-T112-1R PNP -6V -60V -50V -0.15A
Q607	OTRIH80002A	2SA1530A-T112-1R PNP -6V -60V -50V -0.15A
Q608	OTRIY80001A	2SC3052 NPN 6V 50V 50V 200MA 100NA 150TO80
Q609	OTRIH80002A	2SA1530A-T112-1R PNP -6V -60V -50V -0.15A

**RESISTORS**

AR100	0RR0472T621	MNR04M0ABJ470 470HM 5% 1/16W 4 SMD R/TP 8P
AR101	0RR0472T621	MNR04M0ABJ470 470HM 5% 1/16W 4 SMD R/TP 8P
AR102	0RR0472T621	MNR04M0ABJ470 470HM 5% 1/16W 4 SMD R/TP 8P
AR103	0RR0472T621	MNR04M0ABJ470 470HM 5% 1/16W 4 SMD R/TP 8P
AR104	0RR0472T621	MNR04M0ABJ470 470HM 5% 1/16W 4 SMD R/TP 8P
AR105	0RR0472T621	MNR04M0ABJ470 470HM 5% 1/16W 4 SMD R/TP 8P
AR106	0RR0472T621	MNR04M0ABJ470 470HM 5% 1/16W 4 SMD R/TP 8P
AR107	0RR0472T621	MNR04M0ABJ470 470HM 5% 1/16W 4 SMD R/TP 8P
AR108	0RR0472T621	MNR04M0ABJ470 470HM 5% 1/16W 4 SMD R/TP 8P
AR109	0RR0472T621	MNR04M0ABJ470 470HM 5% 1/16W 4 SMD R/TP 8P
AR110	0RR0472T621	MNR04M0ABJ470 470HM 5% 1/16W 4 SMD R/TP 8P
AR111	0RR0472T621	MNR04M0ABJ470 470HM 5% 1/16W 4 SMD R/TP 8P
AR200	0RJ0222C692	MNR04 M0APJ 220 22OHM 5% 1/16W 1005X4 R/TP
AR201	0RJ0222C692	MNR04 M0APJ 220 22OHM 5% 1/16W 1005X4 R/TP
AR202	0RJ0222C692	MNR04 M0APJ 220 22OHM 5% 1/16W 1005X4 R/TP
AR203	0RJ0222C692	MNR04 M0APJ 220 22OHM 5% 1/16W 1005X4 R/TP
AR204	0RJ0222C692	MNR04 M0APJ 220 22OHM 5% 1/16W 1005X4 R/TP
AR205	0RJ0222C692	MNR04 M0APJ 220 22OHM 5% 1/16W 1005X4 R/TP
AR206	0RJ0222C692	MNR04 M0APJ 220 22OHM 5% 1/16W 1005X4 R/TP
AR303	0RZZH033273	MNR04M0ABJ330 33OHM 5% 1/16W 4 SMD R/TP 8P
AR304	0RZZH033273	MNR04M0ABJ330 33OHM 5% 1/16W 4 SMD R/TP 8P
AR305	0RZZH033273	MNR04M0ABJ330 33OHM 5% 1/16W 4 SMD R/TP 8P
AR306	0RZZH033273	MNR04M0ABJ330 33OHM 5% 1/16W 4 SMD R/TP 8P
AR307	0RZZH033273	MNR04M0ABJ330 33OHM 5% 1/16W 4 SMD R/TP 8P
AR308	0RZZH033273	MNR04M0ABJ330 33OHM 5% 1/16W 4 SMD R/TP 8P
AR309	0RZZH033273	MNR04M0ABJ330 33OHM 5% 1/16W 4 SMD R/TP 8P
AR310	0RZZH033273	MNR04M0ABJ330 33OHM 5% 1/16W 4 SMD R/TP 8P
AR311	0RZZH033273	MNR04M0ABJ330 33OHM 5% 1/16W 4 SMD R/TP 8P
AR312	0RZZH033273	MNR04M0ABJ330 33OHM 5% 1/16W 4 SMD R/TP 8P
AR313	0RZZH033273	MNR04M0ABJ330 33OHM 5% 1/16W 4 SMD R/TP 8P
AR314	0RZZH033273	MNR04M0ABJ330 33OHM 5% 1/16W 4 SMD R/TP 8P
AR700	0RZZH033273	MNR04M0ABJ330 33OHM 5% 1/16W 4 SMD R/TP 8P
AR701	0RZZH033273	MNR04M0ABJ330 33OHM 5% 1/16W 4 SMD R/TP 8P
AR702	0RZZH033273	MNR04M0ABJ330 33OHM 5% 1/16W 4 SMD R/TP 8P

LOC. NO.	PART NO.	DESCRIPTION / SPECIFICATION	LOC. NO.	PART NO.	DESCRIPTION / SPECIFICATION
AR703	0RJ0222C692	MNR04 M0APJ 220 22OHM 5% 1/16W 1005X4 R/TP	R109	0RJ1001C678	MCR01MZPJ102 1KOHM 5% 1/16W 1005 R/TP ROH
AR704	0RJ0222C692	MNR04 M0APJ 220 22OHM 5% 1/16W 1005X4 R/TP	R110	0RJ1002C678	MCR01MZPJ103 10KOHM 5% 1/16W 1005 R/TP RO
AR706	0RZZH033273	MNR04M0ABJ330 33OHM 5% 1/16W 4 SMD R/TP 8P	R1101	0RJ0000C678	MCR01MZPJ000 0OHM 5% 1/16W 1005 R/TP ROHM
AR707	0RZZH033273	MNR04M0ABJ330 33OHM 5% 1/16W 4 SMD R/TP 8P	R1102	0RJ0752C678	MCR01MZPJ750 75OHM 5% 1/16W 1005 R/TP ROH
AR708	0RZZH033273	MNR04M0ABJ330 33OHM 5% 1/16W 4 SMD R/TP 8P	R1103	0RJ1000C678	MCR01MZPJ101 100OHM 5% 1/16W 1005 R/TP RO
AR709	0RZZH033273	MNR04M0ABJ330 33OHM 5% 1/16W 4 SMD R/TP 8P	R1104	0RJ0752C678	MCR01MZPJ750 75OHM 5% 1/16W 1005 R/TP ROH
AR710	0RZZH033273	MNR04M0ABJ330 33OHM 5% 1/16W 4 SMD R/TP 8P	R1105	0RJ1000C678	MCR01MZPJ101 100OHM 5% 1/16W 1005 R/TP RO
AR712	0RJ0222C692	MNR04 M0APJ 220 22OHM 5% 1/16W 1005X4 R/TP	R1106	0RJ1000C678	MCR01MZPJ101 100OHM 5% 1/16W 1005 R/TP RO
AR800	EBC32260405	MNR04M0APJ680 68OHM 5% 1/16W 4 SMD R/TP 8P	R1107	0RJ0752C678	MCR01MZPJ750 75OHM 5% 1/16W 1005 R/TP ROH
AR801	EBC32260405	MNR04M0APJ680 68OHM 5% 1/16W 4 SMD R/TP 8P	R1108	0RJ1000C678	MCR01MZPJ101 100OHM 5% 1/16W 1005 R/TP RO
AR802	EBC32260405	MNR04M0APJ680 68OHM 5% 1/16W 4 SMD R/TP 8P	R1109	0RJ4701C678	MCR01MZPJ472 4.7KOHM 5% 1/16W 1005 R/TP R
AR803	EBC32260405	MNR04M0APJ680 68OHM 5% 1/16W 4 SMD R/TP 8P	R111	0RJ1002C678	MCR01MZPJ103 10KOHM 5% 1/16W 1005 R/TP RO
AR804	EBC32260405	MNR04M0APJ680 68OHM 5% 1/16W 4 SMD R/TP 8P	R1110	0RJ1001C678	MCR01MZPJ102 1KOHM 5% 1/16W 1005 R/TP ROH
AR805	EBC32260405	MNR04M0APJ680 68OHM 5% 1/16W 4 SMD R/TP 8P	R1114	0RJ4701C678	MCR01MZPJ472 4.7KOHM 5% 1/16W 1005 R/TP RO
AR806	EBC32260405	MNR04M0APJ680 68OHM 5% 1/16W 4 SMD R/TP 8P	R1115	0RJ0000C678	MCR01MZPJ000 0OHM 5% 1/16W 1005 R/TP ROHM
AR807	EBC32260405	MNR04M0APJ680 68OHM 5% 1/16W 4 SMD R/TP 8P	R1116	0RJ0222C678	MCR01MZPJ220 22OHM 5% 1/16W 1005 R/TP - R
AR808	EBC32260405	MNR04M0APJ680 68OHM 5% 1/16W 4 SMD R/TP 8P	R1117	0RJ0222C678	MCR01MZPJ220 22OHM 5% 1/16W 1005 R/TP - R
AR809	EBC32260405	MNR04M0APJ680 68OHM 5% 1/16W 4 SMD R/TP 8P	R1118	0RJ1001C678	MCR01MZPJ102 1KOHM 5% 1/16W 1005 R/TP ROH
AR810	EBC32260405	MNR04M0APJ680 68OHM 5% 1/16W 4 SMD R/TP 8P	R1119	0RJ0000C678	MCR01MZPJ000 0OHM 5% 1/16W 1005 R/TP ROHM
C603	0RJ2702C678	MCR01MZPJ273 27KOHM 5% 1/16W 1005 R/TP RO	R112	0RJ1002C678	MCR01MZPJ103 10KOHM 5% 1/16W 1005 R/TP RO
L1218	0RH0000D622	MCR10EZHJ000 0OHM 5% 1/8W 2012 R/TP ROHM	R1120	0RJ0222C678	MCR01MZPJ220 22OHM 5% 1/16W 1005 R/TP - R
L1219	0RH0000D622	MCR10EZHJ000 0OHM 5% 1/8W 2012 R/TP ROHM	R1121	0RJ0000C678	MCR01MZPJ000 0OHM 5% 1/16W 1005 R/TP ROHM
L1220	0RH0000D622	MCR10EZHJ000 0OHM 5% 1/8W 2012 R/TP ROHM	R1122	0RJ0000C678	MCR01MZPJ000 0OHM 5% 1/16W 1005 R/TP ROHM
L607	0RJ0000G676	MCR18EZHJ00 0OHM 5% 1/4W 3216 R/TP . ROHM	R1123	0RJ1000C678	MCR01MZPJ101 100OHM 5% 1/16W 1005 R/TP RO
R100	0RJ0000C678	MCR01MZPJ000 0OHM 5% 1/16W 1005 R/TP ROHM	R1124	0RJ1000C678	MCR01MZPJ101 100OHM 5% 1/16W 1005 R/TP RO
R101	0RJ1000C678	MCR01MZPJ101 100OHM 5% 1/16W 1005 R/TP RO	R1125	0RJ1000C678	MCR01MZPJ101 100OHM 5% 1/16W 1005 R/TP RO
R1010	0RJ0222C678	MCR01MZPJ220 22OHM 5% 1/16W 1005 R/TP - R	R1126	0RJ0000C678	MCR01MZPJ000 0OHM 5% 1/16W 1005 R/TP ROHM
R1011	0RJ0222C678	MCR01MZPJ220 22OHM 5% 1/16W 1005 R/TP - R	R1127	0RJ4701C678	MCR01MZPJ472 4.7KOHM 5% 1/16W 1005 R/TP R
R1018	0RJ6800D677	MCR03EZPJ681 680OHM 5% 1/10W 1608 R/TP RO	R1129	0RJ0000C678	MCR01MZPJ000 0OHM 5% 1/16W 1005 R/TP ROHM
R102	0RJ0472C678	MCR01MZPJ470 47OHM 5% 1/16W 1005 R/TP - R	R113	0RJ1002C678	MCR01MZPJ103 10KOHM 5% 1/16W 1005 R/TP RO
R1021	0RJ0222C678	MCR01MZPJ220 22OHM 5% 1/16W 1005 R/TP - R	R1130	0RJ0000C678	MCR01MZPJ000 0OHM 5% 1/16W 1005 R/TP ROHM
R1022	0RJ0101C678	MCR01MZPJ1R0 1OHM 5% 1/16W 1005 R/TP ROHM	R1131	0RJ1001C678	MCR01MZPJ102 1KOHM 5% 1/16W 1005 R/TP ROH
R1023	0RJ0101C678	MCR01MZPJ1R0 1OHM 5% 1/16W 1005 R/TP ROHM	R1132	0RJ1000C678	MCR01MZPJ101 100OHM 5% 1/16W 1005 R/TP RO
R1024	0RJ0101C678	MCR01MZPJ1R0 1OHM 5% 1/16W 1005 R/TP ROHM	R1133	0RJ1000C678	MCR01MZPJ101 100OHM 5% 1/16W 1005 R/TP RO
R1025	0RJ0101C678	MCR01MZPJ1R0 1OHM 5% 1/16W 1005 R/TP ROHM	R1134	0RJ1002C678	MCR01MZPJ103 10KOHM 5% 1/16W 1005 R/TP RO
R1026	0RJ0101C678	MCR01MZPJ1R0 1OHM 5% 1/16W 1005 R/TP ROHM	R1135	0RJ1002C678	MCR01MZPJ103 10KOHM 5% 1/16W 1005 R/TP RO
R1027	0RJ0101C678	MCR01MZPJ1R0 1OHM 5% 1/16W 1005 R/TP ROHM	R1136	0RJ0000C678	MCR01MZPJ000 0OHM 5% 1/16W 1005 R/TP ROHM
R1028	0RJ0101C678	MCR01MZPJ1R0 1OHM 5% 1/16W 1005 R/TP ROHM	R1137	0RJ0000C678	MCR01MZPJ000 0OHM 5% 1/16W 1005 R/TP ROHM
R1029	0RJ0101C678	MCR01MZPJ1R0 1OHM 5% 1/16W 1005 R/TP ROHM	R1139	0RJ0000C678	MCR01MZPJ000 0OHM 5% 1/16W 1005 R/TP ROHM
R103	0RJ0472C678	MCR01MZPJ470 47OHM 5% 1/16W 1005 R/TP - R	R114	0RJ1002C678	MCR01MZPJ103 10KOHM 5% 1/16W 1005 R/TP RO
R1039	0RJ0000C678	MCR01MZPJ000 0OHM 5% 1/16W 1005 R/TP ROHM	R1140	0RJ1000C678	MCR01MZPJ101 100OHM 5% 1/16W 1005 R/TP RO
R104	0RJ0000C678	MCR01MZPJ000 0OHM 5% 1/16W 1005 R/TP ROHM	R1141	0RJ1000C678	MCR01MZPJ101 100OHM 5% 1/16W 1005 R/TP RO
R1040	0RJ4702C678	MCR01MZPJ473 47KOHM 5% 1/16W 1005 R/TP RO	R1142	0RJ0000C678	MCR01MZPJ000 0OHM 5% 1/16W 1005 R/TP ROHM
R1042	0RJ4702C678	MCR01MZPJ473 47KOHM 5% 1/16W 1005 R/TP RO	R1143	0RJ2203C678	MCR01MZPJ224 220KOHM 5% 1/16W 1005 R/TP R
R1049	0RJ0000C678	MCR01MZPJ000 0OHM 5% 1/16W 1005 R/TP ROHM	R1144	0RJ3301C678	MCR01MZPJ332 3.3KOHM 5% 1/16W 1005 R/TP R
R105	0RJ4701C678	MCR01MZPJ472 4.7KOHM 5% 1/16W 1005 R/TP RO	R1145	0RJ2203C678	MCR01MZPJ224 220KOHM 5% 1/16W 1005 R/TP R
R1050	0RJ0000C678	MCR01MZPJ000 0OHM 5% 1/16W 1005 R/TP ROHM	R1146	0RJ1001C678	MCR01MZPJ102 1KOHM 5% 1/16W 1005 R/TP ROH
R1056	0RJ1002C678	MCR01MZPJ103 10KOHM 5% 1/16W 1005 R/TP RO	R1147	0RJ0000C678	MCR01MZPJ000 0OHM 5% 1/16W 1005 R/TP ROHM
R1058	0RJ1003C678	MCR01MZPJ104 100KOHM 5% 1/16W 1005 R/TP R	R1148	0RJ1001C678	MCR01MZPJ102 1KOHM 5% 1/16W 1005 R/TP ROH
R1059	0RJ2702C678	MCR01MZPJ273 27KOHM 5% 1/16W 1005 R/TP RO	R1149	0RJ1001C678	MCR01MZPJ102 1KOHM 5% 1/16W 1005 R/TP ROH
R106	0RJ0000C678	MCR01MZPJ000 0OHM 5% 1/16W 1005 R/TP ROHM	R115	0RJ1502C678	MCR01MZPJ153 15KOHM 5% 1/16W 1005 R/TP RO
R1060	0RJ3302C678	MCR01MZPJ333 33KOHM 5% 1/16W 1005 R/TP RO	R1150	0RJ1002C678	MCR01MZPJ103 10KOHM 5% 1/16W 1005 R/TP RO
R1065	0RJ0000C678	MCR01MZPJ000 0OHM 5% 1/16W 1005 R/TP ROHM	R1151	0RJ1000C678	MCR01MZPJ101 100OHM 5% 1/16W 1005 R/TP RO
R107	0RJ1002C678	MCR01MZPJ103 10KOHM 5% 1/16W 1005 R/TP RO	R1152	0RH1000D622	MCR10EZHJ101 100OHM 5% 1/8W 2012 R/TP ROH
R108	0RJ1002C678	MCR01MZPJ103 10KOHM 5% 1/16W 1005 R/TP RO	R116	0RJ2001C678	MCR01MZPJ202 20KOHM 5% 1/16W 1005 R/TP ROH

LOC. NO.	PART NO.	DESCRIPTION / SPECIFICATION	LOC. NO.	PART NO.	DESCRIPTION / SPECIFICATION
R117	0RJ2001C678	MCR01MZPJ202 2KOHM 5% 1/16W 1005 R/TP ROH	R1245	0RJ0000C678	MCR01MZPJ000 0OHM 5% 1/16W 1005 R/TP ROHM
R118	0RJ0000C678	MCR01MZPJ000 0OHM 5% 1/16W 1005 R/TP ROHM	R1245	0RJ0752C678	MCR01MZPJ750 75OHM 5% 1/16W 1005 R/TP ROH
R119	0RJ0000C678	MCR01MZPJ000 0OHM 5% 1/16W 1005 R/TP ROHM	R125	0RJ0472C678	MCR01MZPJ470 47OHM 5% 1/16W 1005 R/TP - R
R120	0RJ1802D677	MCR03EZPJ183 18KOHM 5% 1/10W 1608 R/TP RO	R1259	0RJ1001C678	MCR01MZPJ102 1KOHM 5% 1/16W 1005 R/TP ROH
R1200	0RJ0752C678	MCR01MZPJ750 75OHM 5% 1/16W 1005 R/TP ROH	R126	0RJ0472C678	MCR01MZPJ470 47OHM 5% 1/16W 1005 R/TP - R
R1201	0RJ0000C678	MCR01MZPJ000 0OHM 5% 1/16W 1005 R/TP ROHM	R1260	0RJ2001C678	MCR01MZPJ202 2KOHM 5% 1/16W 1005 R/TP ROH
R1202	0RJ0682C678	MCR01MZPJ680 68OHM 5% 1/16W 1005 R/TP ROH	R1261	0RJ2001C678	MCR01MZPJ202 2KOHM 5% 1/16W 1005 R/TP ROH
R1203	0RJ4703C678	MCR01MZPJ474 470KOHM 5% 1/16W 1005 R/TP -	R1262	0RJ0000C678	MCR01MZPJ000 0OHM 5% 1/16W 1005 R/TP ROHM
R1204	0RJ4702C678	MCR01MZPJ473 47KOHM 5% 1/16W 1005 R/TP RO	R1263	0RJ0000C678	MCR01MZPJ000 0OHM 5% 1/16W 1005 R/TP ROHM
R1205	0RJ2203C678	MCR01MZPJ224 220KOHM 5% 1/16W 1005 R/TP R	R1264	0RJ0000C678	MCR01MZPJ000 0OHM 5% 1/16W 1005 R/TP ROHM
R1206	0RJ4701D677	MCR03EZPJ472 4.7KOHM 5% 1/10W 1608 R/TP PL	R127	0RJ1502C678	MCR01MZPJ153 15KOHM 5% 1/16W 1005 R/TP RO
R1207	0RJ2203C678	MCR01MZPJ224 220KOHM 5% 1/16W 1005 R/TP R	R1270	0RJ1001C678	MCR01MZPJ102 1KOHM 5% 1/16W 1005 R/TP ROH
R1208	0RJ1001C678	MCR01MZPJ102 1KOHM 5% 1/16W 1005 R/TP ROH	R1271	0RJ1001C678	MCR01MZPJ102 1KOHM 5% 1/16W 1005 R/TP ROH
R1209	0RJ3002C678	MCR01MZPJ303 30KOHM 5% 1/16W 1005 R/TP RO	R1273	0RJ3301C678	MCR01MZPJ332 3.3KOHM 5% 1/16W 1005 R/TP R
R121	0RJ1202C678	MCR01MZPJ123 12KOHM 5% 1/16W 1005 R/TP RO	R1274	0RJ0752C678	MCR01MZPJ750 75OHM 5% 1/16W 1005 R/TP ROH
R1210	0RJ2203C678	MCR01MZPJ224 220KOHM 5% 1/16W 1005 R/TP R	R1275	0RJ0000C678	MCR01MZPJ000 0OHM 5% 1/16W 1005 R/TP ROHM
R1211	0RJ4703C678	MCR01MZPJ474 470KOHM 5% 1/16W 1005 R/TP -	R1276	0RJ3002C678	MCR01MZPJ303 30KOHM 5% 1/16W 1005 R/TP RO
R1212	0RJ2203C678	MCR01MZPJ224 220KOHM 5% 1/16W 1005 R/TP R	R1277	0RJ2203C678	MCR01MZPJ224 220KOHM 5% 1/16W 1005 R/TP R
R1213	0RJ4703C678	MCR01MZPJ474 470KOHM 5% 1/16W 1005 R/TP -	R1278	0RJ2203C678	MCR01MZPJ224 220KOHM 5% 1/16W 1005 R/TP R
R1214	0RJ0752C678	MCR01MZPJ750 75OHM 5% 1/16W 1005 R/TP ROH	R1279	0RJ4702C678	MCR01MZPJ473 47KOHM 5% 1/16W 1005 R/TP RO
R1215	0RJ1001C678	MCR01MZPJ102 1KOHM 5% 1/16W 1005 R/TP ROH	R128	0RJ0472C678	MCR01MZPJ470 47OHM 5% 1/16W 1005 R/TP - R
R1216	0RJ1001C678	MCR01MZPJ102 1KOHM 5% 1/16W 1005 R/TP ROH	R1280	0RJ1001C678	MCR01MZPJ102 1KOHM 5% 1/16W 1005 R/TP ROH
R1217	0RJ1001C678	MCR01MZPJ102 1KOHM 5% 1/16W 1005 R/TP ROH	R1281	0RJ1001C678	MCR01MZPJ102 1KOHM 5% 1/16W 1005 R/TP ROH
R1218	0RJ1002D677	MCR03EZPJ103 10KOHM 5% 1/10W 1608 R/TP RO	R1282	0RJ2203C678	MCR01MZPJ224 220KOHM 5% 1/16W 1005 R/TP R
R1219	0RJ0752C678	MCR01MZPJ750 75OHM 5% 1/16W 1005 R/TP ROH	R1283	0RJ2203C678	MCR01MZPJ224 220KOHM 5% 1/16W 1005 R/TP R
R122	0RJ0472C678	MCR01MZPJ470 47OHM 5% 1/16W 1005 R/TP - R	R1284	0RJ0000C678	MCR01MZPJ000 0OHM 5% 1/16W 1005 R/TP ROHM
R1220	0RJ2203C678	MCR01MZPJ224 220KOHM 5% 1/16W 1005 R/TP R	R1285	0RJ0000C678	MCR01MZPJ000 0OHM 5% 1/16W 1005 R/TP ROHM
R1221	0RJ0752C678	MCR01MZPJ750 75OHM 5% 1/16W 1005 R/TP ROH	R1286	0RJ0000C678	MCR01MZPJ000 0OHM 5% 1/16W 1005 R/TP ROHM
R1222	0RJ0752C678	MCR01MZPJ750 75OHM 5% 1/16W 1005 R/TP ROH	R1287	0RJ0000C678	MCR01MZPJ000 0OHM 5% 1/16W 1005 R/TP ROHM
R1223	0RJ2203C678	MCR01MZPJ224 220KOHM 5% 1/16W 1005 R/TP R	R1288	0RJ0000C678	MCR01MZPJ000 0OHM 5% 1/16W 1005 R/TP ROHM
R1224	0RJ1001C678	MCR01MZPJ102 1KOHM 5% 1/16W 1005 R/TP ROH	R1289	0RJ0000C678	MCR01MZPJ000 0OHM 5% 1/16W 1005 R/TP ROHM
R1225	0RJ1001C678	MCR01MZPJ102 1KOHM 5% 1/16W 1005 R/TP ROH	R129	0RJ0472C678	MCR01MZPJ470 47OHM 5% 1/16W 1005 R/TP - R
R1226	0RJ1001C678	MCR01MZPJ102 1KOHM 5% 1/16W 1005 R/TP ROH	R1290	0RJ0000C678	MCR01MZPJ000 0OHM 5% 1/16W 1005 R/TP ROHM
R1227	0RJ2201C678	MCR01MZPJ222 2.2KOHM 5% 1/16W 1005 R/TP R	R1291	0RJ0000C678	MCR01MZPJ000 0OHM 5% 1/16W 1005 R/TP ROHM
R1228	0RJ2201C678	MCR01MZPJ222 2.2KOHM 5% 1/16W 1005 R/TP R	R1292	0RJ0000C678	MCR01MZPJ000 0OHM 5% 1/16W 1005 R/TP ROHM
R1229	0RJ0752C678	MCR01MZPJ750 75OHM 5% 1/16W 1005 R/TP ROH	R1293	0RJ0000C678	MCR01MZPJ000 0OHM 5% 1/16W 1005 R/TP ROHM
R123	0RJ0472C678	MCR01MZPJ470 47OHM 5% 1/16W 1005 R/TP - R	R130	0RJ1002C678	MCR01MZPJ103 10KOHM 5% 1/16W 1005 R/TP RO
R1230	0RJ0752C678	MCR01MZPJ750 75OHM 5% 1/16W 1005 R/TP ROH	R1300	0RJ6202D677	MCR03EZPJ623 62KOHM 5% 1/10W 1608 R/TP RO
R1231	0RJ1002C678	MCR01MZPJ103 10KOHM 5% 1/16W 1005 R/TP RO	R1301	0RJ2402D677	MCR03EZPJ243 24KOHM 5% 1/10W 1608 R/TP RO
R1232	0RJ0000D677	MCR03EZPJ000 0OHM 5% 1/10W 1608 R/TP ROHM	R1302	0RJ4700C678	MCR01MZPJ471 470OHM 5% 1/16W 1005 R/TP RO
R1233	0RJ1202D677	MCR03EZPJ123 12KOHM 5% 1/10W 1608 R/TP RO	R1303	0RJ1501C678	MCR01MZPJ152 1.5KOHM 5% 1/16W 1005 R/TP R
R1234	0RJ0000D677	MCR03EZPJ000 0OHM 5% 1/10W 1608 R/TP ROHM	R1307	0RJ1000C678	MCR01MZPJ101 100OHM 5% 1/16W 1005 R/TP RO
R1235	0RJ4703C678	MCR01MZPJ474 470KOHM 5% 1/16W 1005 R/TP -	R1308	0RJ1000C678	MCR01MZPJ101 100OHM 5% 1/16W 1005 R/TP RO
R1236	0RJ4703C678	MCR01MZPJ474 470KOHM 5% 1/16W 1005 R/TP -	R1309	0RJ1000C678	MCR01MZPJ101 100OHM 5% 1/16W 1005 R/TP RO
R1237	0RJ1001C678	MCR01MZPJ102 1KOHM 5% 1/16W 1005 R/TP ROH	R131	0RJ0472C678	MCR01MZPJ470 47OHM 5% 1/16W 1005 R/TP - R
R1238	0RJ1001C678	MCR01MZPJ102 1KOHM 5% 1/16W 1005 R/TP ROH	R1310	0RJ0000C678	MCR01MZPJ000 0OHM 5% 1/16W 1005 R/TP ROHM
R1239	0RJ0000C678	MCR01MZPJ000 0OHM 5% 1/16W 1005 R/TP ROHM	R1311	0RJ1000C678	MCR01MZPJ101 100OHM 5% 1/16W 1005 R/TP RO
R124	0RJ1200C678	MCR01MZPJ121 120OHM 5% 1/16W 1005 R/TP RO	R1312	0RJ1000C678	MCR01MZPJ101 100OHM 5% 1/16W 1005 R/TP RO
R1240	0RJ0752C678	MCR01MZPJ750 75OHM 5% 1/16W 1005 R/TP ROH	R1313	0RJ1000C678	MCR01MZPJ101 100OHM 5% 1/16W 1005 R/TP RO
R1241	0RJ0000C678	MCR01MZPJ000 0OHM 5% 1/16W 1005 R/TP ROHM	R1314	0RJ1000C678	MCR01MZPJ101 100OHM 5% 1/16W 1005 R/TP RO
R1241	0RJ0752C678	MCR01MZPJ750 75OHM 5% 1/16W 1005 R/TP ROH	R1315	0RJ1001C678	MCR01MZPJ102 1KOHM 5% 1/16W 1005 R/TP ROH
R1242	0RJ0752C678	MCR01MZPJ750 75OHM 5% 1/16W 1005 R/TP ROH	R1316	0RJ1001C678	MCR01MZPJ102 1KOHM 5% 1/16W 1005 R/TP ROH
R1243	0RJ0752C678	MCR01MZPJ750 75OHM 5% 1/16W 1005 R/TP ROH	R1317	0RJ4701C678	MCR01MZPJ472 4.7KOHM 5% 1/16W 1005 R/TP R
R1244	0RJ0000C678	MCR01MZPJ000 0OHM 5% 1/16W 1005 R/TP ROHM	R1318	0RJ4701C678	MCR01MZPJ472 4.7KOHM 5% 1/16W 1005 R/TP R
R1244	0RJ0752C678	MCR01MZPJ750 75OHM 5% 1/16W 1005 R/TP ROH	R1319	0RJ0000C678	MCR01MZPJ000 0OHM 5% 1/16W 1005 R/TP ROHM

LOC. NO.	PART NO.	DESCRIPTION / SPECIFICATION	LOC. NO.	PART NO.	DESCRIPTION / SPECIFICATION
R132	0RJ1002C678	MCR01MZPJ103 10KOHM 5% 1/16W 1005 R/TP RO	R143	0RJ2701C678	MCR01MZPJ272 2.7KOHM 5% 1/16W 1005 R/TP -
R1320	0RJ0000C678	MCR01MZPJ000 0OHM 5% 1/16W 1005 R/TP ROHM	R1430	0RJ1201C678	MCR01MZPJ122 1.2KOHM 5% 1/16W 1005 R/TP R
R1321	0RJ2001C678	MCR01MZPJ202 2KOHM 5% 1/16W 1005 R/TP ROH	R1431	0RJ1201C678	MCR01MZPJ122 1.2KOHM 5% 1/16W 1005 R/TP R
R1322	0RJ2001C678	MCR01MZPJ202 2KOHM 5% 1/16W 1005 R/TP ROH	R1433	0RJ1000C678	MCR01MZPJ101 100OHM 5% 1/16W 1005 R/TP RO
R1323	0RJ4703C678	MCR01MZPJ474 470KOHM 5% 1/16W 1005 R/TP -	R144	0RJ0472C678	MCR01MZPJ470 470OHM 5% 1/16W 1005 R/TP - R
R1324	0RJ4703C678	MCR01MZPJ474 470KOHM 5% 1/16W 1005 R/TP -	R145	0RJ2701C678	MCR01MZPJ272 2.7KOHM 5% 1/16W 1005 R/TP -
R1325	0RJ1003C678	MCR01MZPJ104 100KOHM 5% 1/16W 1005 R/TP R	R1452	0RJ1000C678	MCR01MZPJ101 100OHM 5% 1/16W 1005 R/TP RO
R1326	0RJ1001C678	MCR01MZPJ102 1KOHM 5% 1/16W 1005 R/TP ROH	R1453	0RJ4703C678	MCR01MZPJ474 470KOHM 5% 1/16W 1005 R/TP -
R133	0RJ0472C678	MCR01MZPJ470 470OHM 5% 1/16W 1005 R/TP - R	R1454	0RJ4703C678	MCR01MZPJ474 470KOHM 5% 1/16W 1005 R/TP -
R1332	0RJ2200C678	MCR01MZPJ221 220OHM 5% 1/16W 1005 R/TP RO	R1455	0RJ4701C678	MCR01MZPJ472 4.7KOHM 5% 1/16W 1005 R/TP R
R1333	0RJ2200C678	MCR01MZPJ221 220OHM 5% 1/16W 1005 R/TP RO	R1456	0RJ1501C678	MCR01MZPJ152 1.5KOHM 5% 1/16W 1005 R/TP R
R1334	0RJ2200C678	MCR01MZPJ221 220OHM 5% 1/16W 1005 R/TP RO	R146	0RJ2701C678	MCR01MZPJ272 2.7KOHM 5% 1/16W 1005 R/TP -
R1337	0RJ0000C678	MCR01MZPJ000 0OHM 5% 1/16W 1005 R/TP ROHM	R1465	0RJ1000C678	MCR01MZPJ101 100OHM 5% 1/16W 1005 R/TP RO
R1339	0RJ1500C678	MCR01MZPJ151 150OHM 5% 1/16W 1005 R/TP RO	R1466	0RJ1201C678	MCR01MZPJ122 1.2KOHM 5% 1/16W 1005 R/TP R
R134	0RJ0472C678	MCR01MZPJ470 470OHM 5% 1/16W 1005 R/TP - R	R1467	0RJ1001C678	MCR01MZPJ102 1KOHM 5% 1/16W 1005 R/TP ROH
R1340	0RJ4701C678	MCR01MZPJ472 4.7KOHM 5% 1/16W 1005 R/TP R	R1468	0RJ1201C678	MCR01MZPJ122 1.2KOHM 5% 1/16W 1005 R/TP R
R1342	0RJ4701C678	MCR01MZPJ472 4.7KOHM 5% 1/16W 1005 R/TP R	R147	0RJ0472C678	MCR01MZPJ470 470OHM 5% 1/16W 1005 R/TP - R
R1343	0RJ2701D677	MCR03EZPJ272 2.7KOHM 5% 1/10W 1608 R/TP R	R148	0RJ0472C678	MCR01MZPJ470 470OHM 5% 1/16W 1005 R/TP - R
R1344	0RJ1000C678	MCR01MZPJ101 100OHM 5% 1/16W 1005 R/TP RO	R149	0RJ2701C678	MCR01MZPJ272 2.7KOHM 5% 1/16W 1005 R/TP -
R1347	0RJ1203D677	MCR03EZPJ124 120KOHM 5% 1/10W 1608 R/TP R	R150	0RJ0472C678	MCR01MZPJ470 470OHM 5% 1/16W 1005 R/TP - R
R135	0RJ0000C678	MCR01MZPJ000 0OHM 5% 1/16W 1005 R/TP ROHM	R151	0RJ0472C678	MCR01MZPJ470 470OHM 5% 1/16W 1005 R/TP - R
R1350	0RJ0000C678	MCR01MZPJ000 0OHM 5% 1/16W 1005 R/TP ROHM	R152	0RJ0472C678	MCR01MZPJ470 470OHM 5% 1/16W 1005 R/TP - R
R1351	0RJ1203D677	MCR03EZPJ124 120KOHM 5% 1/10W 1608 R/TP R	R153	0RJ0472C678	MCR01MZPJ470 470OHM 5% 1/16W 1005 R/TP - R
R136	0RJ0472C678	MCR01MZPJ470 470OHM 5% 1/16W 1005 R/TP - R	R154	0RJ1002C678	MCR01MZPJ103 10KOHM 5% 1/16W 1005 R/TP RO
R137	0RJ0472C678	MCR01MZPJ470 470OHM 5% 1/16W 1005 R/TP - R	R155	0RJ3303D677	MCR03EZPJ334 330KOHM 5% 1/10W 1608 R/TP
R138	0RJ1002C678	MCR01MZPJ103 10KOHM 5% 1/16W 1005 R/TP RO	R156	0RJ1002C678	MCR01MZPJ103 10KOHM 5% 1/16W 1005 R/TP RO
R139	0RJ0472C678	MCR01MZPJ470 470OHM 5% 1/16W 1005 R/TP - R	R157	0RJ0472C678	MCR01MZPJ470 470OHM 5% 1/16W 1005 R/TP - R
R140	0RJ0472C678	MCR01MZPJ470 470OHM 5% 1/16W 1005 R/TP - R	R158	0RJ1000C678	MCR01MZPJ101 100OHM 5% 1/16W 1005 R/TP RO
R1400	0RJ1501C678	MCR01MZPJ152 1.5KOHM 5% 1/16W 1005 R/TP R	R159	0RJ1000C678	MCR01MZPJ101 100OHM 5% 1/16W 1005 R/TP RO
R1401	0RJ4701C678	MCR01MZPJ472 4.7KOHM 5% 1/16W 1005 R/TP R	R162	0RJ0472C678	MCR01MZPJ470 470OHM 5% 1/16W 1005 R/TP - R
R1402	0RJ1000C678	MCR01MZPJ101 100OHM 5% 1/16W 1005 R/TP RO	R163	0RJ0472C678	MCR01MZPJ470 470OHM 5% 1/16W 1005 R/TP - R
R1403	0RJ1000C678	MCR01MZPJ101 100OHM 5% 1/16W 1005 R/TP RO	R164	0RJ1202C678	MCR01MZPJ123 12KOHM 5% 1/16W 1005 R/TP RO
R1404	0RJ1001C678	MCR01MZPJ102 1KOHM 5% 1/16W 1005 R/TP ROH	R165	0RJ1002C678	MCR01MZPJ103 10KOHM 5% 1/16W 1005 R/TP RO
R1405	0RJ1001C678	MCR01MZPJ102 1KOHM 5% 1/16W 1005 R/TP ROH	R166	0RJ0472C678	MCR01MZPJ470 470OHM 5% 1/16W 1005 R/TP - R
R1406	0RJ0000C678	MCR01MZPJ000 0OHM 5% 1/16W 1005 R/TP ROHM	R167	0RJ1002C678	MCR01MZPJ103 10KOHM 5% 1/16W 1005 R/TP RO
R1407	0RJ0000C678	MCR01MZPJ000 0OHM 5% 1/16W 1005 R/TP ROHM	R168	0RJ1002C678	MCR01MZPJ103 10KOHM 5% 1/16W 1005 R/TP RO
R1408	0RJ0000C678	MCR01MZPJ000 0OHM 5% 1/16W 1005 R/TP ROHM	R169	0RJ0000C678	MCR01MZPJ000 0OHM 5% 1/16W 1005 R/TP ROHM
R1409	0RJ1500C678	MCR01MZPJ151 150OHM 5% 1/16W 1005 R/TP RO	R170	0RJ0000C678	MCR01MZPJ000 0OHM 5% 1/16W 1005 R/TP ROHM
R141	0RJ1002C678	MCR01MZPJ103 10KOHM 5% 1/16W 1005 R/TP RO	R1703	0RJ1000C678	MCR01MZPJ101 100OHM 5% 1/16W 1005 R/TP RO
R1410	0RJ0000C678	MCR01MZPJ000 0OHM 5% 1/16W 1005 R/TP ROHM	R1704	0RJ1000C678	MCR01MZPJ101 100OHM 5% 1/16W 1005 R/TP RO
R1411	0RJ2200C678	MCR01MZPJ221 220OHM 5% 1/16W 1005 R/TP RO	R1706	0RJ0332C678	MCR01MZPJ330 33OHM 5% 1/16W 1005 R/TP ROH
R1412	0RJ2200C678	MCR01MZPJ221 220OHM 5% 1/16W 1005 R/TP RO	R1708	0RJ0332C678	MCR01MZPJ330 33OHM 5% 1/16W 1005 R/TP ROH
R1413	0RJ0000C678	MCR01MZPJ000 0OHM 5% 1/16W 1005 R/TP ROHM	R1709	0RJ1002C678	MCR01MZPJ103 10KOHM 5% 1/16W 1005 R/TP RO
R1414	0RJ1000C678	MCR01MZPJ101 100OHM 5% 1/16W 1005 R/TP RO	R1710	0RJ0222C678	MCR01MZPJ220 22OHM 5% 1/16W 1005 R/TP - R
R1415	0RJ2200C678	MCR01MZPJ221 220OHM 5% 1/16W 1005 R/TP RO	R1713	0RJ4701C678	MCR01MZPJ472 4.7KOHM 5% 1/16W 1005 R/TP RO
R1416	0RJ2200C678	MCR01MZPJ221 220OHM 5% 1/16W 1005 R/TP RO	R1715	0RJ1000C678	MCR01MZPJ101 100OHM 5% 1/16W 1005 R/TP RO
R1417	0RJ1000C678	MCR01MZPJ101 100OHM 5% 1/16W 1005 R/TP RO	R1717	0RJ1002C678	MCR01MZPJ103 10KOHM 5% 1/16W 1005 R/TP RO
R1418	0RJ1000C678	MCR01MZPJ101 100OHM 5% 1/16W 1005 R/TP RO	R1718	0RJ1000C678	MCR01MZPJ101 100OHM 5% 1/16W 1005 R/TP RO
R1419	0RJ1000C678	MCR01MZPJ101 100OHM 5% 1/16W 1005 R/TP RO	R1719	0RJ0332C678	MCR01MZPJ330 33OHM 5% 1/16W 1005 R/TP ROH
R142	0RJ0472C678	MCR01MZPJ470 470OHM 5% 1/16W 1005 R/TP - R	R1720	0RJ1000C678	MCR01MZPJ101 100OHM 5% 1/16W 1005 R/TP RO
R1420	0RJ1000C678	MCR01MZPJ101 100OHM 5% 1/16W 1005 R/TP RO	R1721	0RJ4701C678	MCR01MZPJ472 4.7KOHM 5% 1/16W 1005 R/TP R
R1421	0RJ1000C678	MCR01MZPJ101 100OHM 5% 1/16W 1005 R/TP RO	R1722	0RJ2701C678	MCR01MZPJ272 2.7KOHM 5% 1/16W 1005 R/TP -
R1422	0RJ1000C678	MCR01MZPJ101 100OHM 5% 1/16W 1005 R/TP RO	R1724	0RJ0332C678	MCR01MZPJ330 33OHM 5% 1/16W 1005 R/TP ROH
R1423	0RJ1000C678	MCR01MZPJ101 100OHM 5% 1/16W 1005 R/TP RO	R1726	0RJ1000C678	MCR01MZPJ101 100OHM 5% 1/16W 1005 R/TP RO
R1429	0RJ1001C678	MCR01MZPJ102 1KOHM 5% 1/16W 1005 R/TP ROH	R1727	0RJ0332C678	MCR01MZPJ330 33OHM 5% 1/16W 1005 R/TP ROH



LOC. NO.	PART NO.	DESCRIPTION / SPECIFICATION	LOC. NO.	PART NO.	DESCRIPTION / SPECIFICATION
R246	0RJ0222C678	MCR01MZPJ220 22OHM 5% 1/16W 1005 R/TP - R	R5005	0RH1201D622	MCR10EZJH122 1.2KOHM 5% 1/8W 2012 R/TP RO
R247	0RJ0222C678	MCR01MZPJ220 22OHM 5% 1/16W 1005 R/TP - R	R501	0RJ0000G676	MCR18EZJH00 0OHM 5% 1/4W 3216 R/TP . ROHM
R248	0RJ0222C678	MCR01MZPJ220 22OHM 5% 1/16W 1005 R/TP - R	R502	0RJ2202C678	MCR01MZPJ223 22KOHM 5% 1/16W 1005 R/TP -
R249	0RJ0222C678	MCR01MZPJ220 22OHM 5% 1/16W 1005 R/TP - R	R504	0RJ1000C678	MCR01MZPJ101 100OHM 5% 1/16W 1005 R/TP RO
R250	0RJ0222C678	MCR01MZPJ220 22OHM 5% 1/16W 1005 R/TP - R	R505	0RJ1002C678	MCR01MZPJ103 10KOHM 5% 1/16W 1005 R/TP RO
R251	0RJ0222C678	MCR01MZPJ220 22OHM 5% 1/16W 1005 R/TP - R	R506	0RJ3302C678	MCR01MZPJ333 33KOHM 5% 1/16W 1005 R/TP RO
R255	0RJ4701D477	MCR03EZPF472 4.7KOHM 1% 1/10W 1608 R/TP R	R507	0RJ2201C678	MCR01MZPJ222 2.2KOHM 5% 1/16W 1005 R/TP R
R256	0RJ1002C678	MCR01MZPJ103 10KOHM 5% 1/16W 1005 R/TP RO	R509	0RJ1002C678	MCR01MZPJ103 10KOHM 5% 1/16W 1005 R/TP RO
R257	0RJ0222C678	MCR01MZPJ220 22OHM 5% 1/16W 1005 R/TP - R	R510	0RJ3301C678	MCR01MZPJ332 3.3KOHM 5% 1/16W 1005 R/TP R
R258	0RJ0222C678	MCR01MZPJ220 22OHM 5% 1/16W 1005 R/TP - R	R511	0RJ1001C678	MCR01MZPJ102 1KOHM 5% 1/16W 1005 R/TP ROH
R259	0RJ0222C678	MCR01MZPJ220 22OHM 5% 1/16W 1005 R/TP - R	R512	0RJ2701D677	MCR03EZPJ272 2.7KOHM 5% 1/10W 1608 R/TP R
R260	0RJ0222C678	MCR01MZPJ220 22OHM 5% 1/16W 1005 R/TP - R	R513	0RJ8201C478	MCR01MZPF8201 8.2KOHM 1% 1/16W 1005 R/TP
R301	0RJ0472C678	MCR01MZPJ470 47OHM 5% 1/16W 1005 R/TP - R	R514	0RJ2492C478	MCR01MZPF2492 24.9KOHM 1% 1/16W 1005 R/TP
R302	0RJ1002C678	MCR01MZPJ103 10KOHM 5% 1/16W 1005 R/TP RO	R515	0RJ7501D677	MCR03EZPJ752 7.5KOHM 5% 1/10W 1608 R/TP R
R303	0RJ1002C678	MCR01MZPJ103 10KOHM 5% 1/16W 1005 R/TP RO	R516	0RJ1202C478	MCR01MZPF123 12KOHM 1% 1/16W 1005 R/TP RO
R304	0RJ1002C678	MCR01MZPJ103 10KOHM 5% 1/16W 1005 R/TP RO	R517	0RJ1502C478	MCR01MZPF153 15KOHM 1% 1/16W 1005 R/TP RO
R305	0RJ1002C678	MCR01MZPJ103 10KOHM 5% 1/16W 1005 R/TP RO	R519	0RJ9311D477	MCR03EZPF9311 9.31KOHM 1% 1/10W 1608 R/TP
R306	0RJ1002C678	MCR01MZPJ103 10KOHM 5% 1/16W 1005 R/TP RO	R520	EBC32306001	MCR03EZPF93100 910OHM 1% 1/10W 1608 R/TP
R309	0RJ0472C678	MCR01MZPJ470 47OHM 5% 1/16W 1005 R/TP - R	R522	0RJ1002D477	MCR03EZPF103 10KOHM 1% 1/10W 1608 R/TP RO
R310	0RJ0472C678	MCR01MZPJ470 47OHM 5% 1/16W 1005 R/TP - R	R523	0RJ4701D477	MCR03EZPF472 4.7KOHM 1% 1/10W 1608 R/TP R
R311	0RJ0472C678	MCR01MZPJ470 47OHM 5% 1/16W 1005 R/TP - R	R524	0RJ1002D477	MCR03EZPF103 10KOHM 1% 1/10W 1608 R/TP RO
R312	0RJ0472C678	MCR01MZPJ470 47OHM 5% 1/16W 1005 R/TP - R	R525	0RJ4701D477	MCR03EZPF472 4.7KOHM 1% 1/10W 1608 R/TP R
R313	0RJ0472C678	MCR01MZPJ470 47OHM 5% 1/16W 1005 R/TP - R	R526	0RJ1002C678	MCR01MZPJ103 10KOHM 5% 1/16W 1005 R/TP RO
R314	0RJ0000C678	MCR01MZPJ000 0OHM 5% 1/16W 1005 R/TP ROHM	R527	0RJ1802C478	MCR01MZPF183 18KOHM 1% 1/16W 1005 R/TP RO
R315	0RJ0472C678	MCR01MZPJ470 47OHM 5% 1/16W 1005 R/TP - R	R528	0RJ1802C478	MCR01MZPF183 18KOHM 1% 1/16W 1005 R/TP RO
R316	0RJ0472C678	MCR01MZPJ470 47OHM 5% 1/16W 1005 R/TP - R	R529	0RJ1002C678	MCR01MZPJ103 10KOHM 5% 1/16W 1005 R/TP RO
R319	0RJ1002C678	MCR01MZPJ103 10KOHM 5% 1/16W 1005 R/TP RO	R530	0RJ1002C678	MCR01MZPJ103 10KOHM 5% 1/16W 1005 R/TP RO
R320	0RJ1002C678	MCR01MZPJ103 10KOHM 5% 1/16W 1005 R/TP RO	R531	0RJ0000C678	MCR01MZPJ000 0OHM 5% 1/16W 1005 R/TP ROHM
R321	0RJ0472C678	MCR01MZPJ470 47OHM 5% 1/16W 1005 R/TP - R	R600	0RJ0332C678	MCR01MZPJ330 33OHM 5% 1/16W 1005 R/TP ROH
R322	0RJ0472C678	MCR01MZPJ470 47OHM 5% 1/16W 1005 R/TP - R	R6008	0RJ0000C678	MCR01MZPJ000 0OHM 5% 1/16W 1005 R/TP ROHM
R323	0RJ0472C678	MCR01MZPJ470 47OHM 5% 1/16W 1005 R/TP - R	R6010	0RJ0000C678	MCR01MZPJ000 0OHM 5% 1/16W 1005 R/TP ROHM
R324	0RJ1000C678	MCR01MZPJ101 100OHM 5% 1/16W 1005 R/TP RO	R6011	0RJ0000C678	MCR01MZPJ000 0OHM 5% 1/16W 1005 R/TP ROHM
R325	0RJ1000C678	MCR01MZPJ101 100OHM 5% 1/16W 1005 R/TP RO	R6012	0RJ0000C678	MCR01MZPJ000 0OHM 5% 1/16W 1005 R/TP ROHM
R326	0RJ1000C678	MCR01MZPJ101 100OHM 5% 1/16W 1005 R/TP RO	R6013	0RJ0000C678	MCR01MZPJ000 0OHM 5% 1/16W 1005 R/TP ROHM
R327	0RJ0332C678	MCR01MZPJ330 33OHM 5% 1/16W 1005 R/TP ROH	R6014	0RJ0000C678	MCR01MZPJ000 0OHM 5% 1/16W 1005 R/TP ROHM
R329	0RJ1002C678	MCR01MZPJ103 10KOHM 5% 1/16W 1005 R/TP RO	R603	0RJ0332C678	MCR01MZPJ330 33OHM 5% 1/16W 1005 R/TP ROH
R4000	0RN6801F409	RN-96T1F6K80 6.8KOHM 1% 1/6W 3.2X1.8MM NON	R604	0RJ0332C678	MCR01MZPJ330 33OHM 5% 1/16W 1005 R/TP ROH
R4001	0RN2201F409	RN-96T1F2K20 2.2KOHM 1% 1/6W 3.2X1.8MM NON	R605	0RJ0332C678	MCR01MZPJ330 33OHM 5% 1/16W 1005 R/TP ROH
R4002	0RN1001F409	RN-96T1F1K00 1KOHM 1% 1/6W 3.2X1.8MM 5.0MM	R606	0RJ0332C678	MCR01MZPJ330 33OHM 5% 1/16W 1005 R/TP ROH
R4003	0RN6801F409	RN-96T1F6K80 6.8KOHM 1% 1/6W 3.2X1.8MM NON	R607	0RJ0332C678	MCR01MZPJ330 33OHM 5% 1/16W 1005 R/TP ROH
R4004	0RN2201F409	RN-96T1F2K20 2.2KOHM 1% 1/6W 3.2X1.8MM NON	R608	0RJ0332C678	MCR01MZPJ330 33OHM 5% 1/16W 1005 R/TP ROH
R4005	0RN1001F409	RN-96T1F1K00 1KOHM 1% 1/6W 3.2X1.8MM 5.0MM	R609	0RJ0332C678	MCR01MZPJ330 33OHM 5% 1/16W 1005 R/TP ROH
R412	0RJ0472C678	MCR01MZPJ470 47OHM 5% 1/16W 1005 R/TP - R	R610	0RJ0332C678	MCR01MZPJ330 33OHM 5% 1/16W 1005 R/TP ROH
R413	0RJ0472C678	MCR01MZPJ470 47OHM 5% 1/16W 1005 R/TP - R	R611	0RJ0332C678	MCR01MZPJ330 33OHM 5% 1/16W 1005 R/TP ROH
R421	0RJ0472C678	MCR01MZPJ470 47OHM 5% 1/16W 1005 R/TP - R	R612	0RJ0332C678	MCR01MZPJ330 33OHM 5% 1/16W 1005 R/TP ROH
R438	0RJ0000C678	MCR01MZPJ000 0OHM 5% 1/16W 1005 R/TP ROHM	R613	0RJ0000C678	MCR01MZPJ000 0OHM 5% 1/16W 1005 R/TP ROHM
R439	0RJ1000C678	MCR01MZPJ101 100OHM 5% 1/16W 1005 R/TP RO	R624	0RJ1000C678	MCR01MZPJ101 100OHM 5% 1/16W 1005 R/TP RO
R446	0RJ1000C678	MCR01MZPJ101 100OHM 5% 1/16W 1005 R/TP RO	R625	0RJ1000C678	MCR01MZPJ101 100OHM 5% 1/16W 1005 R/TP RO
R448	0RJ1000C678	MCR01MZPJ101 100OHM 5% 1/16W 1005 R/TP RO	R626	0RJ0332C678	MCR01MZPJ330 33OHM 5% 1/16W 1005 R/TP ROH
R500	0RJ1002C678	MCR01MZPJ103 10KOHM 5% 1/16W 1005 R/TP RO	R627	0RJ1003C678	MCR01MZPJ104 100KOHM 5% 1/16W 1005 R/TP R
R5001	0RH4700D622	MCR10EZJH471 470OHM 5% 1/8W 2012 R/TP ROH	R629	0RJ1000C678	MCR01MZPJ101 100OHM 5% 1/16W 1005 R/TP RO
R5002	0RH1001D622	MCR10EZJH102 1KOHM 5% 1/8W 2012 R/TP ROHM	R632	0RJ0472C678	MCR01MZPJ470 47OHM 5% 1/16W 1005 R/TP - R
R5003	0RH1001D622	MCR10EZJH102 1KOHM 5% 1/8W 2012 R/TP ROHM	R633	0RJ0472C678	MCR01MZPJ470 47OHM 5% 1/16W 1005 R/TP - R
R5004	0RH1001D622	MCR10EZJH102 1KOHM 5% 1/8W 2012 R/TP ROHM	R636	0RJ4701C678	MCR01MZPJ472 4.7KOHM 5% 1/16W 1005 R/TP R
R5005	0RH1001D622	MCR10EZJH102 1KOHM 5% 1/8W 2012 R/TP ROHM	R637	0RJ4700C678	MCR01MZPJ471 470OHM 5% 1/16W 1005 R/TP RO

LOC. NO.	PART NO.	DESCRIPTION / SPECIFICATION	LOC. NO.	PART NO.	DESCRIPTION / SPECIFICATION
R639	0RJ0822C678	MCR01MZPJ820 820OHM 5% 1/16W 1005 R/TP ROH	R737	0RJ4701C678	MCR01MZPJ472 4.7KOHM 5% 1/16W 1005 R/TP R
R642	0RJ1002C678	MCR01MZPJ103 10KOHM 5% 1/16W 1005 R/TP RO	R738	0RJ0222C678	MCR01MZPJ220 220OHM 5% 1/16W 1005 R/TP - R
R644	0RJ1001C678	MCR01MZPJ102 1KOHM 5% 1/16W 1005 R/TP ROH	R739	0RJ1000C678	MCR01MZPJ101 100OHM 5% 1/16W 1005 R/TP RO
R646	0RJ2700C678	MCR01MZPJ271 270OHM 5% 1/16W 1005 R/TP -	R740	0RJ0222C678	MCR01MZPJ220 220OHM 5% 1/16W 1005 R/TP - R
R647	0RJ2200C678	MCR01MZPJ221 220OHM 5% 1/16W 1005 R/TP RO	R741	0RJ1000C678	MCR01MZPJ101 100OHM 5% 1/16W 1005 R/TP RO
R648	0RJ1001C678	MCR01MZPJ102 1KOHM 5% 1/16W 1005 R/TP ROH	R742	0RJ4701C678	MCR01MZPJ472 4.7KOHM 5% 1/16W 1005 R/TP R
R649	0RJ1500C678	MCR01MZPJ151 150OHM 5% 1/16W 1005 R/TP RO	R743	0RJ4701C678	MCR01MZPJ472 4.7KOHM 5% 1/16W 1005 R/TP R
R650	0RJ1000C678	MCR01MZPJ101 100OHM 5% 1/16W 1005 R/TP RO	R744	0RJ0000C678	MCR01MZPJ000 0OHM 5% 1/16W 1005 R/TP ROHM
R652	0RJ2001C678	MCR01MZPJ202 2KOHM 5% 1/16W 1005 R/TP ROH	R745	0RJ1002C678	MCR01MZPJ103 10KOHM 5% 1/16W 1005 R/TP RO
R653	0RJ1002C678	MCR01MZPJ103 10KOHM 5% 1/16W 1005 R/TP RO	R746	0RJ1002C678	MCR01MZPJ103 10KOHM 5% 1/16W 1005 R/TP RO
R654	0RJ0000C678	MCR01MZPJ000 0OHM 5% 1/16W 1005 R/TP ROHM	R747	0RJ1002C678	MCR01MZPJ103 10KOHM 5% 1/16W 1005 R/TP RO
R655	0RJ1002C678	MCR01MZPJ103 10KOHM 5% 1/16W 1005 R/TP RO	R748	0RJ1000C678	MCR01MZPJ101 100OHM 5% 1/16W 1005 R/TP RO
R657	0RJ0222C678	MCR01MZPJ220 220OHM 5% 1/16W 1005 R/TP - R	R749	0RJ0000C678	MCR01MZPJ000 0OHM 5% 1/16W 1005 R/TP ROHM
R658	0RJ2201C678	MCR01MZPJ222 2.2KOHM 5% 1/16W 1005 R/TP R	R750	0RJ0332C678	MCR01MZPJ330 330OHM 5% 1/16W 1005 R/TP ROH
R668	0RJ0000C678	MCR01MZPJ000 0OHM 5% 1/16W 1005 R/TP ROHM	R751	0RJ0222C678	MCR01MZPJ220 220OHM 5% 1/16W 1005 R/TP - R
R669	0RJ0000C678	MCR01MZPJ000 0OHM 5% 1/16W 1005 R/TP ROHM	R752	0RJ0332C678	MCR01MZPJ330 330OHM 5% 1/16W 1005 R/TP ROH
R670	0RJ0000C678	MCR01MZPJ000 0OHM 5% 1/16W 1005 R/TP ROHM	R754	0RJ0562D677	MCR03EZPJ560 560OHM 5% 1/10W 1608 R/TP ROH
R671	0RJ0000C678	MCR01MZPJ000 0OHM 5% 1/16W 1005 R/TP ROHM	R755	0RJ1002C678	MCR01MZPJ103 10KOHM 5% 1/16W 1005 R/TP RO
R672	0RJ0000C678	MCR01MZPJ000 0OHM 5% 1/16W 1005 R/TP ROHM	R756	0RJ0222C678	MCR01MZPJ220 220OHM 5% 1/16W 1005 R/TP - R
R689	0RJ0000C678	MCR01MZPJ000 0OHM 5% 1/16W 1005 R/TP ROHM	R757	0RJ1000C678	MCR01MZPJ101 100OHM 5% 1/16W 1005 R/TP RO
R690	0RJ0000C678	MCR01MZPJ000 0OHM 5% 1/16W 1005 R/TP ROHM	R759	0RJ0562D677	MCR03EZPJ560 560OHM 5% 1/10W 1608 R/TP ROH
R691	0RJ0000C678	MCR01MZPJ000 0OHM 5% 1/16W 1005 R/TP ROHM	R762	0RJ1002C678	MCR01MZPJ103 10KOHM 5% 1/16W 1005 R/TP RO
R692	0RJ0000C678	MCR01MZPJ000 0OHM 5% 1/16W 1005 R/TP ROHM	R764	0RJ0562D677	MCR03EZPJ560 560OHM 5% 1/10W 1608 R/TP ROH
R701	0RJ1002C678	MCR01MZPJ103 10KOHM 5% 1/16W 1005 R/TP RO	R765	0RJ4701C678	MCR01MZPJ472 4.7KOHM 5% 1/16W 1005 R/TP R
R702	0RJ0000C678	MCR01MZPJ000 0OHM 5% 1/16W 1005 R/TP ROHM	R767	0RJ1000C678	MCR01MZPJ101 100OHM 5% 1/16W 1005 R/TP RO
R705	0RJ1000C678	MCR01MZPJ101 100OHM 5% 1/16W 1005 R/TP RO	R769	0RJ0222C678	MCR01MZPJ220 220OHM 5% 1/16W 1005 R/TP - R
R707	0RJ1002C678	MCR01MZPJ103 10KOHM 5% 1/16W 1005 R/TP RO	R770	0RJ0332C678	MCR01MZPJ330 330OHM 5% 1/16W 1005 R/TP ROH
R708	0RJ0222C678	MCR01MZPJ220 220OHM 5% 1/16W 1005 R/TP - R	R771	0RJ0222C678	MCR01MZPJ220 220OHM 5% 1/16W 1005 R/TP - R
R709	0RJ1000C678	MCR01MZPJ101 100OHM 5% 1/16W 1005 R/TP RO	R772	0RJ1000C678	MCR01MZPJ101 100OHM 5% 1/16W 1005 R/TP RO
R710	0RJ1000C678	MCR01MZPJ101 100OHM 5% 1/16W 1005 R/TP RO	R775	0RJ1000C678	MCR01MZPJ101 100OHM 5% 1/16W 1005 R/TP RO
R711	0RJ1002C678	MCR01MZPJ103 10KOHM 5% 1/16W 1005 R/TP RO	R777	0RJ0332C678	MCR01MZPJ330 330OHM 5% 1/16W 1005 R/TP ROH
R712	0RJ0222C678	MCR01MZPJ220 220OHM 5% 1/16W 1005 R/TP - R	R778	0RJ1002C678	MCR01MZPJ103 10KOHM 5% 1/16W 1005 R/TP RO
R713	0RJ0332C678	MCR01MZPJ330 330OHM 5% 1/16W 1005 R/TP ROH	R779	0RJ1000C678	MCR01MZPJ101 100OHM 5% 1/16W 1005 R/TP RO
R714	0RJ0222C678	MCR01MZPJ220 220OHM 5% 1/16W 1005 R/TP - R	R780	0RJ4701C678	MCR01MZPJ472 4.7KOHM 5% 1/16W 1005 R/TP R
R715	0RJ0332C678	MCR01MZPJ330 330OHM 5% 1/16W 1005 R/TP ROH	R781	0RJ1000C678	MCR01MZPJ101 100OHM 5% 1/16W 1005 R/TP RO
R716	0RJ0222C678	MCR01MZPJ220 220OHM 5% 1/16W 1005 R/TP - R	R782	0RJ1000C678	MCR01MZPJ101 100OHM 5% 1/16W 1005 R/TP RO
R717	0RJ1000C678	MCR01MZPJ101 100OHM 5% 1/16W 1005 R/TP RO	R783	0RJ1002C678	MCR01MZPJ103 10KOHM 5% 1/16W 1005 R/TP RO
R718	0RJ1000C678	MCR01MZPJ101 100OHM 5% 1/16W 1005 R/TP RO	R784	0RJ0222C678	MCR01MZPJ220 220OHM 5% 1/16W 1005 R/TP - R
R719	0RJ0222C678	MCR01MZPJ220 220OHM 5% 1/16W 1005 R/TP - R	R785	0RJ1002C678	MCR01MZPJ103 10KOHM 5% 1/16W 1005 R/TP RO
R720	0RJ1002C678	MCR01MZPJ103 10KOHM 5% 1/16W 1005 R/TP RO	R786	0RJ1002C678	MCR01MZPJ103 10KOHM 5% 1/16W 1005 R/TP RO
R721	0RJ0222C678	MCR01MZPJ220 220OHM 5% 1/16W 1005 R/TP - R	R787	0RJ0222C678	MCR01MZPJ220 220OHM 5% 1/16W 1005 R/TP - R
R722	0RJ1002C678	MCR01MZPJ103 10KOHM 5% 1/16W 1005 R/TP RO	R788	0RJ0332C678	MCR01MZPJ330 330OHM 5% 1/16W 1005 R/TP ROH
R723	0RJ0222C678	MCR01MZPJ220 220OHM 5% 1/16W 1005 R/TP - R	R790	0RJ0332C678	MCR01MZPJ330 330OHM 5% 1/16W 1005 R/TP ROH
R724	0RJ0332C678	MCR01MZPJ330 330OHM 5% 1/16W 1005 R/TP ROH	R791	0RJ4701C678	MCR01MZPJ472 4.7KOHM 5% 1/16W 1005 R/TP R
R725	0RJ1000C678	MCR01MZPJ101 100OHM 5% 1/16W 1005 R/TP RO	R792	0RJ0222C678	MCR01MZPJ220 220OHM 5% 1/16W 1005 R/TP - R
R726	0RJ3900C678	MCR01MZPJ391. 390OHM 5% 1/16W 1005 R/TP -	R793	0RJ1002C678	MCR01MZPJ103 10KOHM 5% 1/16W 1005 R/TP RO
R727	0RJ1000C678	MCR01MZPJ101 100OHM 5% 1/16W 1005 R/TP RO	R794	0RJ1002C678	MCR01MZPJ103 10KOHM 5% 1/16W 1005 R/TP RO
R728	0RJ1002C678	MCR01MZPJ103 10KOHM 5% 1/16W 1005 R/TP RO	R795	0RJ0222C678	MCR01MZPJ220 220OHM 5% 1/16W 1005 R/TP - R
R729	0RJ4701C678	MCR01MZPJ472 4.7KOHM 5% 1/16W 1005 R/TP R	R796	0RJ1000C678	MCR01MZPJ101 100OHM 5% 1/16W 1005 R/TP RO
R730	0RJ0222C678	MCR01MZPJ220 220OHM 5% 1/16W 1005 R/TP - R	R797	0RJ1000C678	MCR01MZPJ101 100OHM 5% 1/16W 1005 R/TP RO
R731	0RJ0332C678	MCR01MZPJ330 330OHM 5% 1/16W 1005 R/TP ROH	R799	0RJ4701C678	MCR01MZPJ472 4.7KOHM 5% 1/16W 1005 R/TP R
R733	0RJ0562D677	MCR03EZPJ560 560OHM 5% 1/10W 1608 R/TP ROH	R800	0RJ0000C678	MCR01MZPJ000 0OHM 5% 1/16W 1005 R/TP ROHM
R734	0RJ1000C678	MCR01MZPJ101 100OHM 5% 1/16W 1005 R/TP RO	R801	0RJ0000C678	MCR01MZPJ000 0OHM 5% 1/16W 1005 R/TP ROHM
R735	0RJ1002C678	MCR01MZPJ103 10KOHM 5% 1/16W 1005 R/TP RO	R805	0RJ0222C678	MCR01MZPJ220 220OHM 5% 1/16W 1005 R/TP - R
R736	0RJ0222C678	MCR01MZPJ220 220OHM 5% 1/16W 1005 R/TP - R	R807	0RJ0000C678	MCR01MZPJ000 0OHM 5% 1/16W 1005 R/TP ROHM

LOC. NO.	PART NO.	DESCRIPTION / SPECIFICATION	LOC. NO.	PART NO.	DESCRIPTION / SPECIFICATION
R808	0RJ0000C678	MCR01MZPJ000 0OHM 5% 1/16W 1005 R/TP ROHM	L1206	6210TCE001Z	Filter,Bead HH-1M2012-600JT 60OHM
R811	0RJ0222C678	MCR01MZPJ220 22OHM 5% 1/16W 1005 R/TP - R	L1207	6210TCE001Z	Filter,Bead HH-1M2012-600JT 60OHM
R812	0RJ1002C678	MCR01MZPJ103 10KOHM 5% 1/16W 1005 R/TP RO	L1208	6210TCE001Z	Filter,Bead HH-1M2012-600JT 60OHM
R813	0RJ0222C678	MCR01MZPJ220 22OHM 5% 1/16W 1005 R/TP - R	L1209	0LCML00020G	Inductor,Multilayer,Chip MLI-201209-3R3K 3.3UH
R816	0RJ0000C678	MCR01MZPJ000 0OHM 5% 1/16W 1005 R/TP ROHM	L1210	0LCML00020G	Inductor,Multilayer,Chip MLI-201209-3R3K 3.3UH
R821	0RJ0682C678	MCR01MZPJ680 68OHM 5% 1/16W 1005 R/TP ROH	L1211	6210TCE001L	Filter,Bead HB-1T2012-102JT 1000OHM
R822	0RJ0000C678	MCR01MZPJ000 0OHM 5% 1/16W 1005 R/TP ROHM	L1212	6210TCE001L	Filter,Bead HB-1T2012-102JT 1000OHM
R823	0RJ2700C678	MCR01MZPJ271 270OHM 5% 1/16W 1005 R/TP -	L1213	0LCML00020G	Inductor,Multilayer,Chip MLI-201209-3R3K 3.3UH
R825	0RJ2700C678	MCR01MZPJ271 270OHM 5% 1/16W 1005 R/TP -	L1214	0LCML00020G	Inductor,Multilayer,Chip MLI-201209-3R3K 3.3UH
R826	0RJ0000C678	MCR01MZPJ000 0OHM 5% 1/16W 1005 R/TP ROHM	L1215	6210TCE001G	Filter,Bead HH-1M3216-501JT 500OHM
R827	0RJ0682C678	MCR01MZPJ680 68OHM 5% 1/16W 1005 R/TP ROH	L1216	0LCML00020G	Inductor,Multilayer,Chip MLI-201209-3R3K 3.3UH
R829	0RJ0000C678	MCR01MZPJ000 0OHM 5% 1/16W 1005 R/TP ROHM	L1217	0LCML00020G	Inductor,Multilayer,Chip MLI-201209-3R3K 3.3UH
R843	0RJ1002C678	MCR01MZPJ103 10KOHM 5% 1/16W 1005 R/TP RO	L1218	0LCML00020G	Inductor,Multilayer,Chip MLI-201209-3R3K 3.3UH
R857	0RJ0682C678	MCR01MZPJ680 68OHM 5% 1/16W 1005 R/TP ROH	L1218	6210TCE001Z	Filter,Bead HH-1M2012-600JT 60OHM
R859	0RJ0682C678	MCR01MZPJ680 68OHM 5% 1/16W 1005 R/TP ROH	L1219	0LCML00020G	Inductor,Multilayer,Chip MLI-201209-3R3K 3.3UH
R860	0RJ0682C678	MCR01MZPJ680 68OHM 5% 1/16W 1005 R/TP ROH	L1219	6210TCE001Z	Filter,Bead HH-1M2012-600JT 60OHM
R877	0RJ0682C678	MCR01MZPJ680 68OHM 5% 1/16W 1005 R/TP ROH	L1220	0LCML00020G	Inductor,Multilayer,Chip MLI-201209-3R3K 3.3UH
R880	0RJ0682C678	MCR01MZPJ680 68OHM 5% 1/16W 1005 R/TP ROH	L1220	6210TCE001Z	Filter,Bead HH-1M2012-600JT 60OHM
R881	0RJ0682C678	MCR01MZPJ680 68OHM 5% 1/16W 1005 R/TP ROH	L1221	0LCML00020G	Inductor,Multilayer,Chip MLI-201209-3R3K 3.3UH
R882	0RJ0682C678	MCR01MZPJ680 68OHM 5% 1/16W 1005 R/TP ROH	L1222	0LCML00020G	Inductor,Multilayer,Chip MLI-201209-3R3K 3.3UH
R883	0RJ0682C678	MCR01MZPJ680 68OHM 5% 1/16W 1005 R/TP ROH	L1300	EAP32842806	Inductor,Wire Wound,Chip NR8040T220M 22UH 20%
R884	0RJ0682C678	MCR01MZPJ680 68OHM 5% 1/16W 1005 R/TP ROH	L1301	6210TCE001G	Filter,Bead HH-1M3216-501JT 500OHM
R885	0RJ0682C678	MCR01MZPJ680 68OHM 5% 1/16W 1005 R/TP ROH	L1303	6210TCE001G	Filter,Bead HH-1M3216-501JT 500OHM
R886	0RJ0682C678	MCR01MZPJ680 68OHM 5% 1/16W 1005 R/TP ROH	L1304	EAP32842806	Inductor,Wire Wound,Chip NR8040T220M 22UH 20%
R888	0RJ0682C678	MCR01MZPJ680 68OHM 5% 1/16W 1005 R/TP ROH	L1305	6210TCE001G	Filter,Bead HH-1M3216-501JT 500OHM
R891	0RJ0682C678	MCR01MZPJ680 68OHM 5% 1/16W 1005 R/TP ROH	L1306	EAP32842806	Inductor,Wire Wound,Chip NR8040T220M 22UH 20%
R892	0RJ0682C678	MCR01MZPJ680 68OHM 5% 1/16W 1005 R/TP ROH	L1307	EAP32842806	Inductor,Wire Wound,Chip NR8040T220M 22UH 20%
R893	0RJ0682C678	MCR01MZPJ680 68OHM 5% 1/16W 1005 R/TP ROH	L1308	6210TCE001G	Filter,Bead HH-1M3216-501JT 500OHM
R894	0RJ0682C678	MCR01MZPJ680 68OHM 5% 1/16W 1005 R/TP ROH	L1309	6210TCE001G	Filter,Bead HH-1M3216-501JT 500OHM
R897	0RJ0682C678	MCR01MZPJ680 68OHM 5% 1/16W 1005 R/TP ROH	L1310	6210TCE001G	Filter,Bead HH-1M3216-501JT 500OHM
R898	0RJ0682C678	MCR01MZPJ680 68OHM 5% 1/16W 1005 R/TP ROH	L1311	6210TCE001G	Filter,Bead HH-1M3216-501JT 500OHM
			L1312	6210TCE001G	Filter,Bead HH-1M3216-501JT 500OHM
			L1313	6210TCE001G	Filter,Bead HH-1M3216-501JT 500OHM
			L1401	6210TCE001G	Filter,Bead HH-1M3216-501JT 500OHM
			L1402	6210TCE001G	Filter,Bead HH-1M3216-501JT 500OHM
			L1412	6210TCE001E	Filter,Bead HB-1M2012-800JT(H:1mm) 80OHM
			L1413	6210TCE001E	Filter,Bead HB-1M2012-800JT(H:1mm) 80OHM
			L301	6210TCE001G	Filter,Bead HH-1M3216-501JT 500OHM
			L400	6210TCE001G	Filter,Bead HH-1M3216-501JT 500OHM
			L502	6210TCE001G	Filter,Bead HH-1M3216-501JT 500OHM
			L503	6210TCE001G	Filter,Bead HH-1M3216-501JT 500OHM
			L506	6140VR0008B	Inductor,Wire Wound,Chip SLF12575T-150M4R7 15UH
			L507	EAP32842801	Inductor,Wire Wound,Chip NR8040T2R0M 2UH
			L508	EAP32842801	Inductor,Wire Wound,Chip NR8040T2R0M 2UH
			L509	6210TCE001G	Filter,Bead HH-1M3216-501JT 500OHM
			L510	6210TCE001G	Filter,Bead HH-1M3216-501JT 500OHM
			L513	6210TCE001X	Filter,Bead HU-1H4532-121JT 120OHM
			L514	6210TCE001X	Filter,Bead HU-1H4532-121JT 120OHM
			L516	EAM33010401	Filter,LCR MEM2012P25R0 EMI 25MHZ 100pF
			L517	EAM33010401	Filter,LCR MEM2012P25R0 EMI 25MHZ 100pF
			L518	EAM33010401	Filter,LCR MEM2012P25R0 EMI 25MHZ 100pF
			L600	0LCTA00003A	Inductor,Wire Wound,Chip LEMC3225T6R8M 6.8UH
			L601	0LCTA00003A	Inductor,Wire Wound,Chip LEMC3225T6R8M 6.8UH
			L602	6210TCE001G	Filter,Bead HH-1M3216-501JT 500OHM
			L604	0LCML00020G	Inductor,Multilayer,Chip MLI-201209-3R3K 3.3UH
<b>COILs &amp; FILTERs &amp; INDUCTORS</b>					
L100	6210TCE001G	Filter,Bead HH-1M3216-501JT 500OHM			
L101	6210TCE001G	Filter,Bead HH-1M3216-501JT 500OHM			
L102	6210TCE001G	Filter,Bead HH-1M3216-501JT 500OHM			
L103	6210TCE001G	Filter,Bead HH-1M3216-501JT 500OHM			
L104	6210TCE001G	Filter,Bead HH-1M3216-501JT 500OHM			
L105	6210TCE001G	Filter,Bead HH-1M3216-501JT 500OHM			
L106	6210TCE001G	Filter,Bead HH-1M3216-501JT 500OHM			
L107	6210TCE001G	Filter,Bead HH-1M3216-501JT 500OHM			
L108	6210TCE001G	Filter,Bead HH-1M3216-501JT 500OHM			
L109	0LC1032101A	Inductor,Multilayer,Chip FI-C3216-103KJT 10UH			
L1101	6210TCE001L	Filter,Bead HB-1T2012-102JT 1000OHM			
L1102	6210TCE001L	Filter,Bead HB-1T2012-102JT 1000OHM			
L1103	EAM33010401	Filter,LCR MEM2012P25R0 EMI 25MHZ 100pF			
L1105	EAM33010401	Filter,LCR MEM2012P25R0 EMI 25MHZ 100pF			
L1106	EAM33010401	Filter,LCR MEM2012P25R0 EMI 25MHZ 100pF			
L1107	EAM33010401	Filter,LCR MEM2012P25R0 EMI 25MHZ 100pF			
L1108	EAM33010401	Filter,LCR MEM2012P25R0 EMI 25MHZ 100pF			
L1109	EAM33010401	Filter,LCR MEM2012P25R0 EMI 25MHZ 100pF			
L1110	EAM33010401	Filter,LCR MEM2012P25R0 EMI 25MHZ 100pF			
L1111	6210TCE001G	Filter,Bead HH-1M3216-501JT 500OHM			
L1205	6210TCE001G	Filter,Bead HH-1M3216-501JT 500OHM			



LOC. NO.	PART NO.	DESCRIPTION / SPECIFICATION	LOC. NO.	PART NO.	DESCRIPTION / SPECIFICATION
L605	0LCTA00003A	Inductor,Wire Wound,Chip LEMC3225T6R8M 6.8UH	PA5000	6712SCA232A	Receiver Module TSOP34838SO1 2.7TO5.5V 1.5MA
L606	6210TCE001G	Filter,Bead HH-1M3216-501JT 500OHM	X100	6212AC2002B	Crystal 9H03200164 32.768KHZ 20PPM 12.5pF 6H26
L607	6210TCE001G	Filter,Bead HH-1M3216-501JT 500OHM	X101	6212AB2883A	Crystal HC-49SM 27.00000MHZ 27MHZ 30PPM 16pF
L700	6210TCE001G	Filter,Bead HH-1M3216-501JT 500OHM	X1300	156-A02R	Crystal EUA18.4320F16E33L 18.432MHZ 30PPM 16pF
L701	6210TCE001G	Filter,Bead HH-1M3216-501JT 500OHM	X700	6212AB2015J	Crystal HC-49SM 19.66080HZ 19.6608HZ 30PPM
L702	6210TCE001G	Filter,Bead HH-1M3216-501JT 500OHM		EBL32961504	Tuner,Digital 170MHZTO862MHZ 1.8V_3
L703	6210TCE001G	Filter,Bead HH-1M3216-501JT 500OHM	<b>ACCESSORY</b>		
L704	6210TCE001G	Filter,Bead HH-1M3216-501JT 500OHM	A1	MFL34441609	Manual,Owners USER 25iang EUROPASS 3 EU
L705	6210TCE001G	Filter,Bead HH-1M3216-501JT 500OHM	A3	6410TBW004A	Power Cord LS-60 1.87M 250V 10A H05VV-F 3X0.75MM2
L706	6210TCE001G	Filter,Bead HH-1M3216-501JT 500OHM	A3	6410TEW010A	Power Cord LP-34A LS-60 1.87M 250V 16A
L707	6210TCE001G	Filter,Bead HH-1M3216-501JT 500OHM	A4	SAC30033616	Title CD MANUAL LCD DTV (LD73B) Europa
L708	6210TCE001G	Filter,Bead HH-1M3216-501JT 500OHM			
<b>CONNECTOR</b>					
CN300	6630VE01269	91932-31169LF 68P 1.00MM 1R STRAIGHT SMD R			
JK1100	6630TGA004K	KCN-DS-1-0089 D-SUB 15P 2.29MM STRAIGHT FE			
JK1102	6630G00001C	KCN-DS-1-0088 D-SUB 9P 2.77MM STRAIGHT MAL			
P1100	6602T20009D	SMAW200-05P 5P 2.00MM 1R ANGLE DIP ST NATU			
P1101	6602T20009B	SMAW200-03P 3P 2.00MM 1R ANGLE DIP ST NATU			
P1300	6602T20009C	SMAW200-04P 4P 2.00MM 1R ANGLE DIP ST NATU			
P4000	6602T20009B	SMAW200-03P 3P 2.00MM 1R ANGLE DIP ST NATU			
P500	6602T20008K	SMW200-11P 11P 2.00MM 1R STRAIGHT DIP ST N			
P5000	6602T20009D	SMAW200-05P 5P 2.00MM 1R ANGLE DIP ST NATU			
P800	6630V90219A	SMW200-28C 28P 2.0MM 2R STRAIGHT DIP ST WH			
	6631900022P	SMH200-3P SMH200-3P 400mM 2.00MM 3P UL1061			
	6631900022S	SMH200-11 SMH200-11 100mM 2.00MM 11P UL106			
	6631T20038G	SMH200 SMH200 600mM 2.00MM 5P UL1061 AWG26			
<b>JACKS</b>					
JK1000	6612B00015B	DC1R019WDH SOCKET 21P STRAIGHT SMD R/TP -			
JK1101	6612F00099A	PEJ024-01 1P 4P STRAIGHT TR 3.6MM BLACK DI			
JK1200	6612M00010A	PSC003-01 21P 21P/1C 3.81MM STRAIGHT DIP T			
JK1201	6612M00010A	PSC003-01 21P 21P/1C 3.81MM STRAIGHT DIP T			
JK1203	6612J10031B	PPJ209-01 14.0MM 1RX3C ANGLE BK SCREW HOLE			
	6612J10023A	KCN-BT-0-0053 10.5MM/11.5MM 1RX1C STRAIGHT			
<b>SWITCHes</b>					
SW100	EBF32593901	TMUE312GAB 1C1P 12VDC 0.5A VERTICAL 160GF			
SW4000	6600R00001B	JTP1289 1C1P 15VDC 0.02A VERTICAL 160GF R/			
SW4001	6600R00001B	JTP1289 1C1P 15VDC 0.02A VERTICAL 160GF R/			
SW4002	6600R00001B	JTP1289 1C1P 15VDC 0.02A VERTICAL 160GF R/			
SW4003	6600R00001B	JTP1289 1C1P 15VDC 0.02A VERTICAL 160GF R/			
SW4004	6600R00001B	JTP1289 1C1P 15VDC 0.02A VERTICAL 160GF R/			
SW4005	6600R00001B	JTP1289 1C1P 15VDC 0.02A VERTICAL 160GF R/			
SW4006	6600R00001B	JTP1289 1C1P 15VDC 0.02A VERTICAL 160GF R/			
SW4007	6600R00001B	JTP1289 1C1P 15VDC 0.02A VERTICAL 160GF R/			
SW700	EBF32593901	TMUE312GAB 1C1P 12VDC 0.5A VERTICAL 160GF			
<b>OTHERs</b>					
IC201	SAA30310947	S/W,Firmware 4.17 5927 EUROPE FLASHROM			
IC802	SAA30715332	S/W,Firmware V3.02 B02B EUROPE FLASHROM			
LED5000	0DLLT0110AA	LED,DIP LTL-1BEHJ-1 ROUND 3MM			